

# Fittings

## Tube Connectors

### TUBE CONNECTOR

Model No.	Tube	Thd
30-0001-22	1/8	2 ORB
30-0001-42	1/4	2 ORB
30-0001-44	1/4	4 ORB
30-8010-64	1/4	6 ORB
30-0001-66	3/8	6 ORB

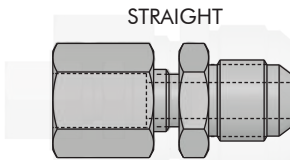
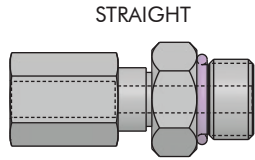

Model No.	Tube	Thd
30-0005-44	1/4	4 JIC
30-8050-66	3/8	6 JIC

45° ADJ ELBOW

90° ADJ ELBOW

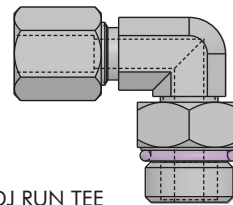
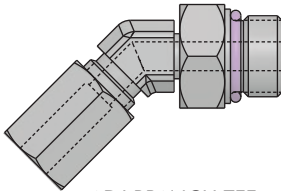

Model No.	Tube	Thd
30-1501-44	1/4	4 ORB
30-1510-64	1/4	6 ORB
30-1510-66	3/8	6 ORB

ADJ BRANCH TEE

ADJ RUN TEE

Model No.	Tube	Thd
30-1610-24	1/4	2 ORB
30-1601-44	1/4	4 ORB
30-1610-64	1/4	6 ORB
30-1601-66	3/8	6 ORB

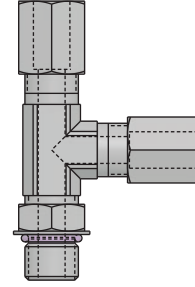
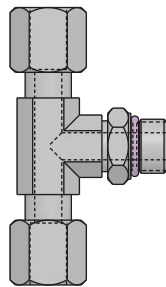

Model No.	Thd	Tube	Tube
30-2410-44	ORB 4	1/4	1/4
30-2410-66	ORB 6	3/8	3/8

Model No.	Thd	Tube	Tube
30-2310-44	ORB 4	1/4	1/4
30-2310-66	ORB 6	3/8	3/8

STRAIGHT

90° ELBOW

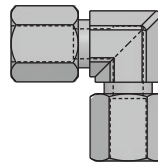
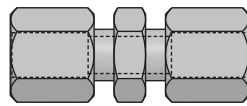

Model No.	Tube	Tube
30-0000-44	1/4	1/4
30-8000-66	3/8	3/8

Model No.	Tube	Tube
30-1600-44	1/4	1/4
30-1600-66	3/8	3/8

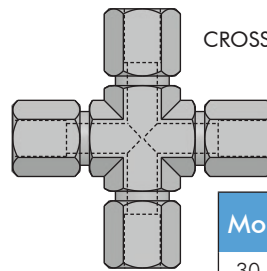
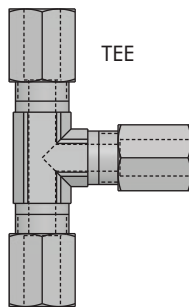

Model No.	Tube	Tube	Tube
30-2000-44	1/4	1/4	1/4
30-2000-66	3/8	3/8	3/8

Model No.	Tube	Tube	Tube	Tube
30-3000-44	1/4	1/4	1/4	1/4
30-3000-66	3/8	3/8	3/8	3/8

FERRULE

NUT

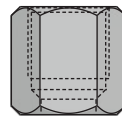

Model No.	Tube
30-5000-44	1/4
30-5000-66	3/8

Model No.	Tube
30-4000-44	1/4
30-4000-66	3/8

PLUG

CAP

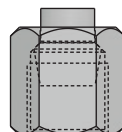
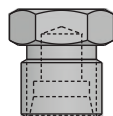

Model No.	Tube
30-6000-44	1/4
30-6000-66	3/8

Model No.	Tube
30-9000-44	1/4
30-9000-66	3/8

ILS300010 REV A



### ORB FITTINGS

STRAIGHT

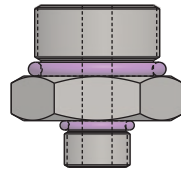

Model No.	Thd	Thd
30-0711-69	6 ORB	12 ORB

ADJ STRAIGHT

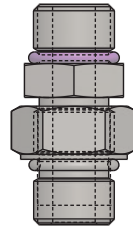

Model No.	Thd	Thd
30-0011-44	4 ORB	4 ORB
30-0011-66	6 ORB	6 ORB

STRAIGHT

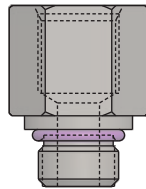

Model No.	Fem/Thd	Thd
30-8012-24	4 ORB	2 ORB
30-7912-44	4 ORB	2 ORB
30-8012-46	6 ORB	4 ORB
30-8012-64	4 ORB	6 ORB
30-7912-66	6 ORB	6 ORB
30-8012-84	4 ORB	8 ORB
30-8012-94	4 ORB	10 ORB
30-8012-96	6 ORB	10 ORB
30-8012-06	6 ORB	12 ORB

STRAIGHT 2 FEMALE

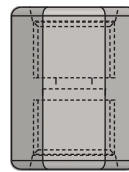

Model No.	Fem/Thd	Fem/Thd
30-8022-44	4 ORB	4 ORB
30-8022-66	6 ORB	6 ORB

90° ADJ ELBOW

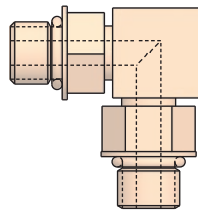

Model No.	Thd	Thd
30-1611-44	4 ORB	4 ORB
30-1611-66	6 ORB	6 ORB

90° ADJ ELBOW

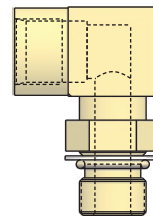

Model No.	Fem/Thd	Tube
30-1621-44	4 ORB	4 ORB
30-1621-66	6 ORB	6 ORB

ADJ RUN TEE

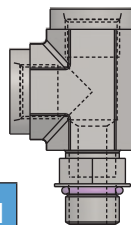

Model No.	Thd	Fem/Thd	Fem/Thd
30-2312-44	4 ORB	4 ORB	4 ORB
30-2312-66	6 ORB	6 ORB	6 ORB

ADJ BRANCH TEE

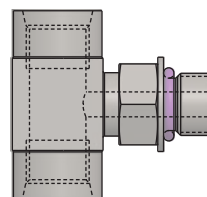

Model No.	Thd	Fem/Thd	Fem/Thd
30-2412-44	4 ORB	4 ORB	4 ORB

PLUG



Model No.	Thd
30-6011-22	2 ORB
30-6011-44	4 ORB
30-6011-66	6 ORB
30-6011-88	8 ORB
30-6011-99	10 ORB
30-6011-12	12 ORB

BREATHER



ILS300011 REV A

Model No.	Thd
91-5900-01	2 ORB
92-0900-01	4 ORB

# Fittings

## JIC Fittings

### JIC FITTINGS

STRAIGHT

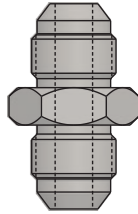

Model No.	Thd	Thd
30-0055-44	4 JIC	4 JIC
30-8055-66	6 JIC	6 JIC

STRAIGHT

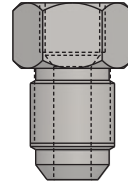

Model No.	Fem/Thd	Thd
30-8056-64	4 JIC	6 JIC

STRAIGHT/BH

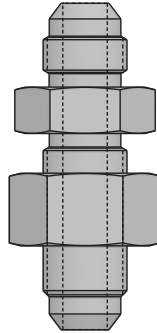

Model No.	Thd	Thd
30-7055-44	4 JIC	4 JIC
30-7055-66	6 JIC	6 JIC

90° ELBOW

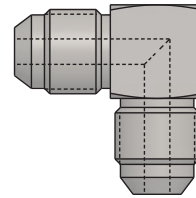

Model No.	Thd	Thd
30-1655-44	4 JIC	4 JIC
30-1655-66	6 JIC	6 JIC

H-3

TEE

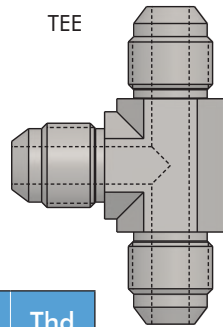

Model No.	Thd	Thd	Thd
30-2055-44	4 JIC	4 JIC	4 JIC
30-2055-66	6 JIC	6 JIC	6 JIC

CROSS

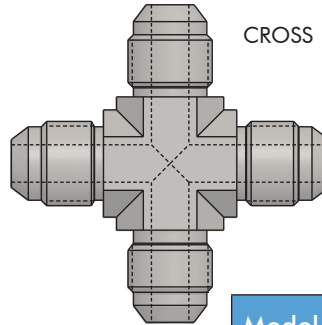

Model No.	Thd	Thd	Thd	Thd
30-3055-44	4 JIC	4 JIC	4 JIC	4 JIC
30-3055-66	6 JIC	6 JIC	6 JIC	6 JIC

CAP

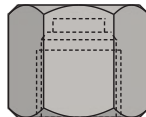

Model No.	Thd
30-9066-44	4 JIC
30-9066-66	6 JIC

PLUG

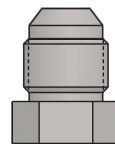

ILS300012 REV A

Model No.	Thd
30-6055-44	4 JIC
30-6055-66	6 JIC

### JIC TO ORB FITTINGS

Model No.	Thd	Thd
30-0015-42	4 JIC	2 ORB
30-0015-45	2 JIC	4 ORB
30-0015-44	4 JIC	4 ORB
30-8015-64	4 JIC	6 ORB
30-8015-66	6 JIC	6 ORB

STRAIGHT

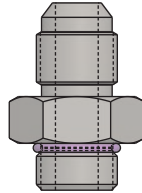

STRAIGHT

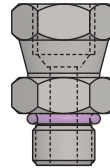

Model No.	Fem/Thd	Thd
30-8016-44	4 JIC	4 ORB
30-8016-66	6 JIC	6 ORB

STRAIGHT/BH

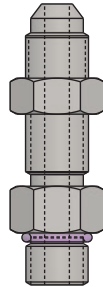

90° ADJ ELBOW

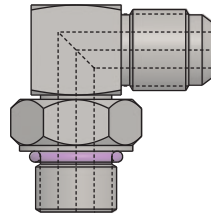

Model No.	Thd	Thd
30-8051-44	4 JIC	4 ORB
30-8151-66	6 JIC	6 ORB

Model No.	Thd	Thd
30-1615-42	4 JIC	2 ORB
30-1615-45	2 JIC	4 ORB
30-1615-44	4 JIC	4 ORB
30-1651-66	6 JIC	6 ORB

45° ADJ ELBOW

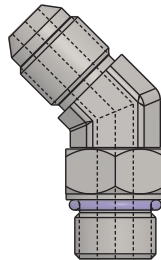

ADJ BRANCH TEE

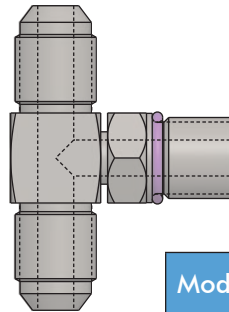

Model No.	Thd	Thd
30-1515-44	4 JIC	4 ORB
30-1551-66	6 JIC	6 ORB

Model No.	Thd	Thd	Thd
30-2415-42	2 ORB	4 JIC	4 JIC
30-2415-44	4 ORB	4 JIC	4 JIC
30-2415-66	6 ORB	6 JIC	6 JIC

ADJ RUN TEE

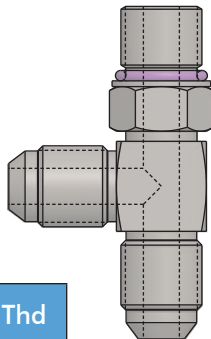

Model No.	Thd	Thd	Thd
30-2315-44	4 ORB	4 JIC	4 JIC
30-2315-66	6 ORB	6 JIC	6 JIC

ILS300013 REV A

# Fittings

## Special Use Adapters

## General Purpose Manifold Adapters

Part No. 30-8711-20  
For Manifold Mounting  
Top Flange Swing Clamps,  
Top Flange Push/Pull Cylinders and  
Tufflink 360 Link Clamps

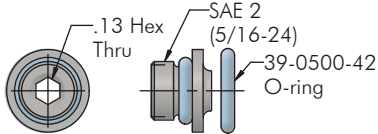

Part No. 30-8711-22  
SAE 2 - 1/2" Bore Adapter

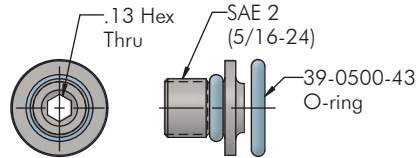

Part No. 30-8711-44  
Male SAE 4 - Male SAE 4

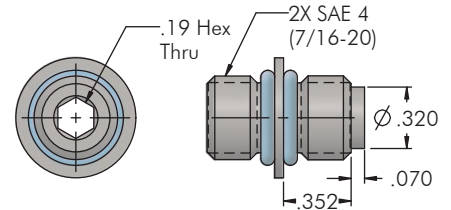

Part No. 30-8711-21  
SAE 2 - 5/8" Bore Adapter

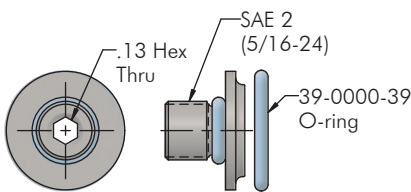

Part No. 30-8711-23  
For Manifold Mounting  
32-1241-00 & 32-1261-01 Single Path,  
32-2242-00 & 32-2262-00 Dual Path and  
32-4244-00 & 32-4264-00 Quad Path  
Rotary Unions

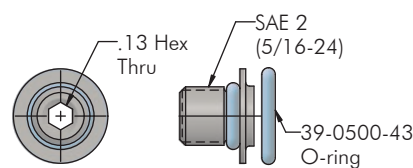

Part No. 30-8711-46  
Male SAE 6 - Male SAE 4

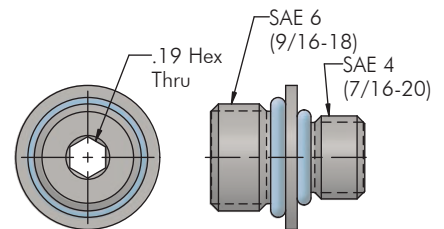

H-5

Part No. 30-8711-40  
For Manifold Porting  
32-1241-00 (SAE 4 Single  
Path) Rotary Unions

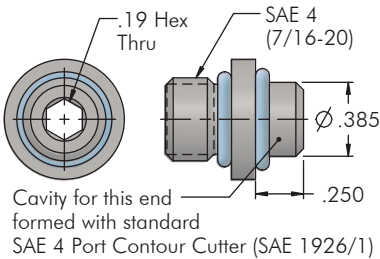

Part No. 30-8711-60  
For Manifold Porting  
32-1261-01 (SAE 6 Single  
Path) Rotary Unions

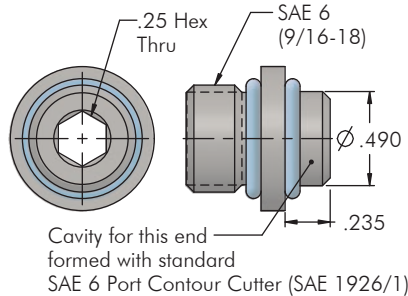

Part No. 30-8711-66  
Adapter for Quick Disconnect  
30-7827-66, 30-7727-66  
30-7827-60, 30-7727-60

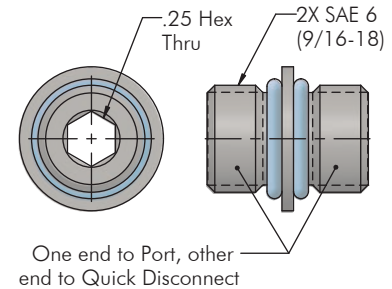

O-rings are furnished with all adapters.

ILS300004 REV H



SAE J1926 /1:  
9/16-18 (SAE 6)  
Straight Thread Port

### Quick Connect with Trigger

Model No.	Description
56-0009-01	Quick Connect with Trigger
For use with Pallet Decouplers or other devices using QD coupler Part No. 30-7727-66	

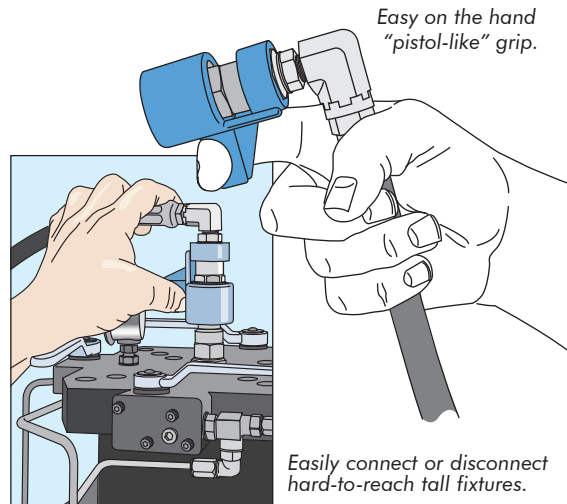

### Model No. 56-0009-01

For use with the following  
Pallet Decouplers or other  
devices using QD coupler  
Part No. 30-7727-66

Model No.

56-0001-01

56-0001-02

56-0001-03

56-0002-01

56-0002-02

56-0002-03

56-0006-06

56-0006-07

ILS 560026 REV C



## Quick Connects and Misc Fittings

### QUICK CONNECTS

30-7727-66  
Male Half, Quick Disconnect.  
SAE 6 (9/16-18) Port.  
Recommended for use on  
main hydraulic supply lines.



30-7827-66  
Female Half, Quick Disconnect.  
SAE 6 (9/16-18) Port  
Recommended for use on  
main hydraulic supply lines.

30-7727-60  
Male Half, Flat Face  
Quick Disconnect.  
SAE 6 (9/16-18) Port

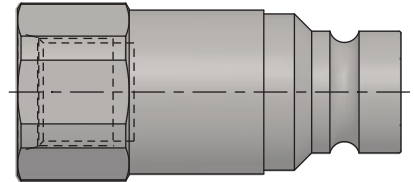
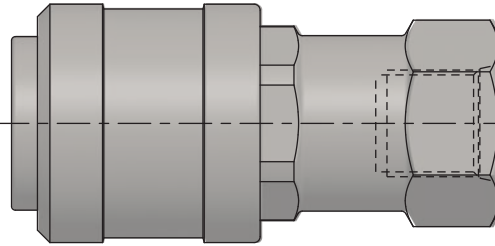
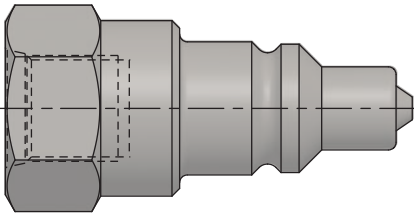

30-7717-44  
Male Half, Quick Disconnect  
SAE 4 (7/16-20) Stud End  
Designed for use in small fixtures.

30-7827-44  
Female Half, Quick Disconnect  
SAE 4 (7/16-20) Port  
Designed for use in small fixtures.

30-7827-60  
Female Half, Flat Face  
Quick Disconnect.  
SAE 6 (9/16-18) Port

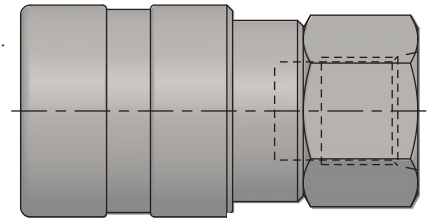
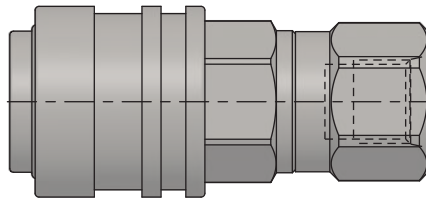
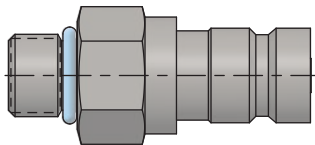

ILS300005 REV H

H-6

### MISC FITTINGS

Model No.	Thd	Thd
30-8085-44	G1/8	4 JIC
30-8085-64	G1/4	4 JIC
30-8085-46	G1/8	6 JIC
30-8085-66	G1/4	6 JIC

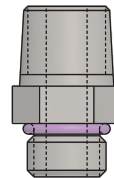
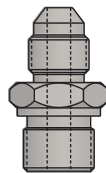

Model No.	Thd	Thd
30-8013-44	1/4 NPT	4 ORB
30-8013-66	3/8 NPT	6 ORB

Model No.	Fem/Thd	Thd
30-8014-22	1/8 NPT	2 ORB
30-8014-42	1/8 NPT	4 ORB
30-8014-44	1/4 NPT	4 ORB
30-8014-64	1/4 NPT	6 ORB
30-8014-66	3/8 NPT	6 ORB

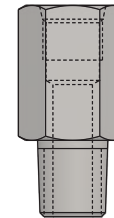
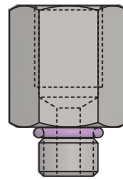

Model No.	Fem/Thd	Thd
30-8032-24	4 ORB	1/8 NPT
30-8032-44	4 ORB	1/4 NPT
30-8032-46	6 ORB	1/4 NPT
30-8032-64	4 ORB	3/8 NPT
30-8032-66	6 ORB	3/8 NPT

Model No.	Fem/Thd	Thd
30-8084-32	1/8 NPT	M5x.08

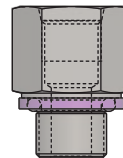
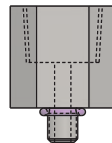

Model No.	Fem/Thd	Thd
30-8782-44	4 ORB	G1/8
30-8782-64	4 ORB	G1/4

Model No.	Fem/Thd	Thd
30-8028-66	6 ORB	G1/4

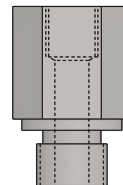
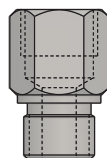

Model No.	Fem/Thd	Thd
30-8098-46	G1/8	G1/4

ILS300014 REV A

