

Furniture Plan

Scope of project includes all items in blue

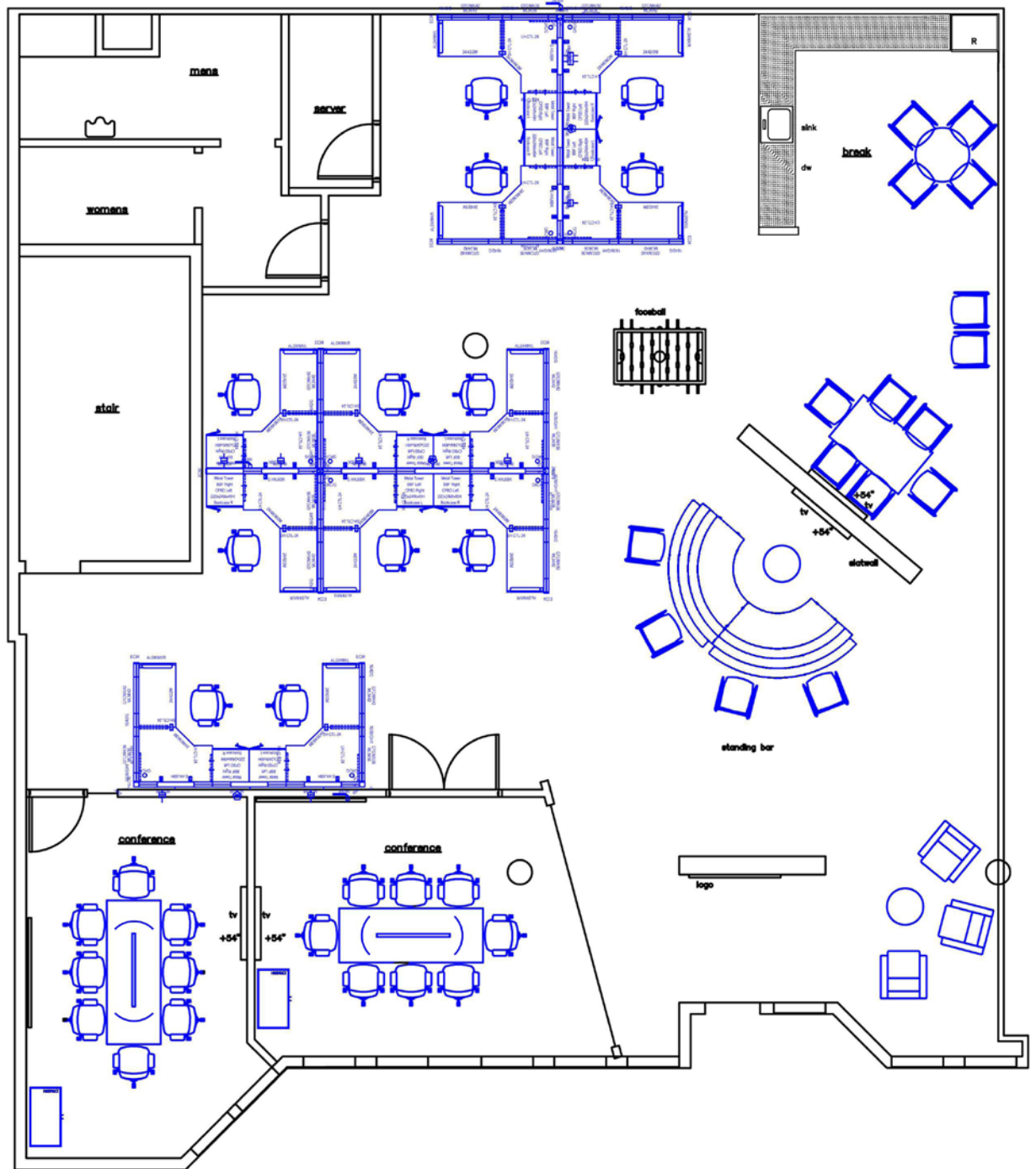

Lounge Area

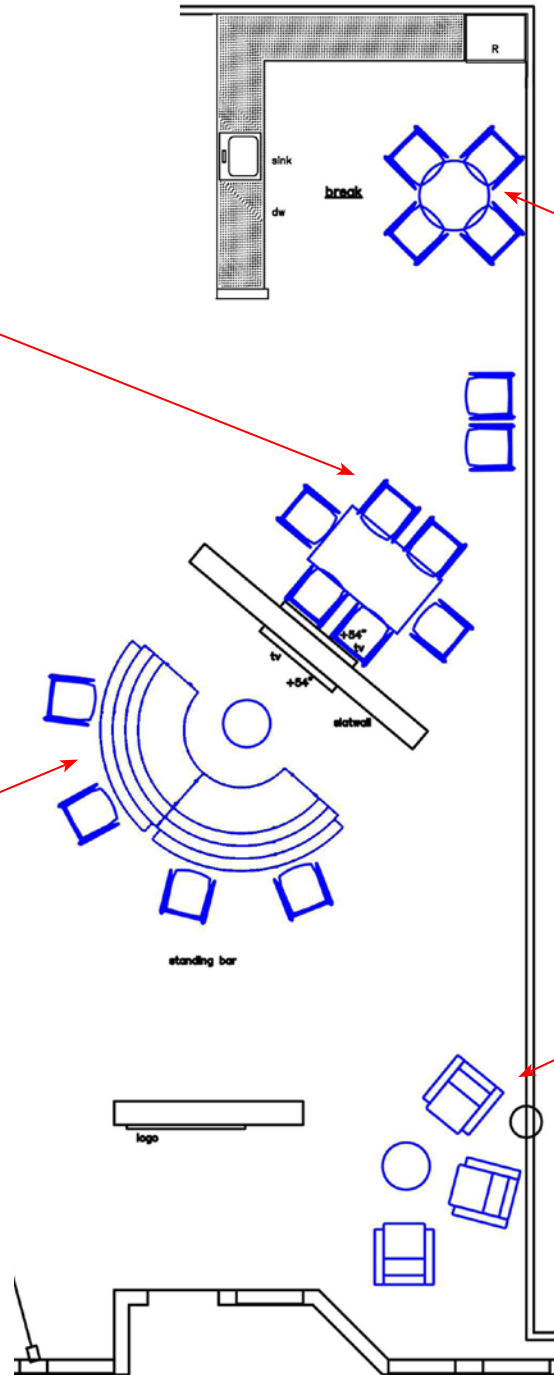
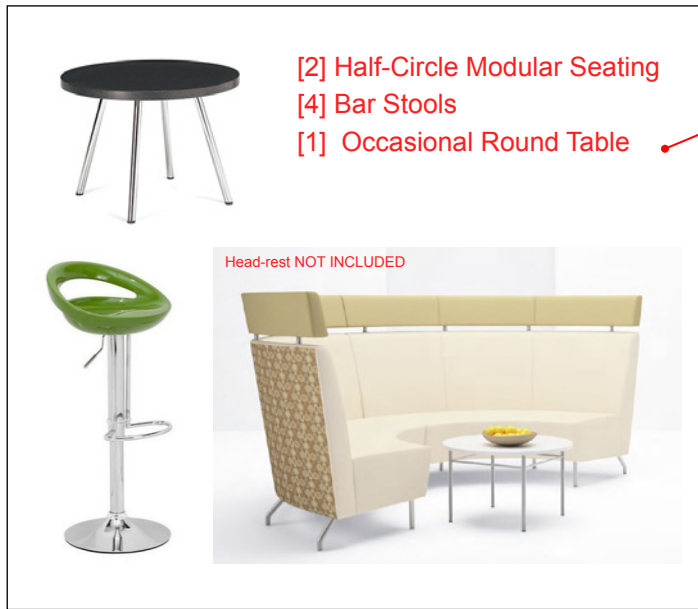
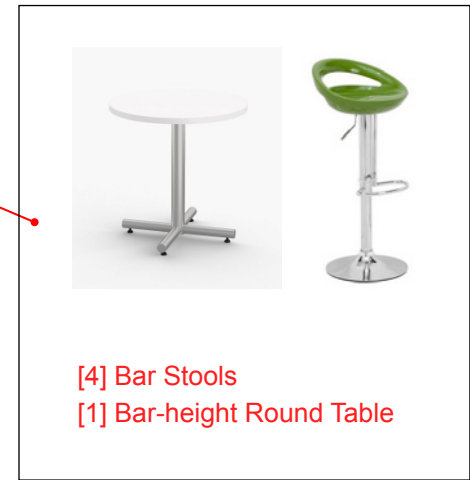

Conference Rooms / Work Stations

[12] AIS Matrix Work Stations

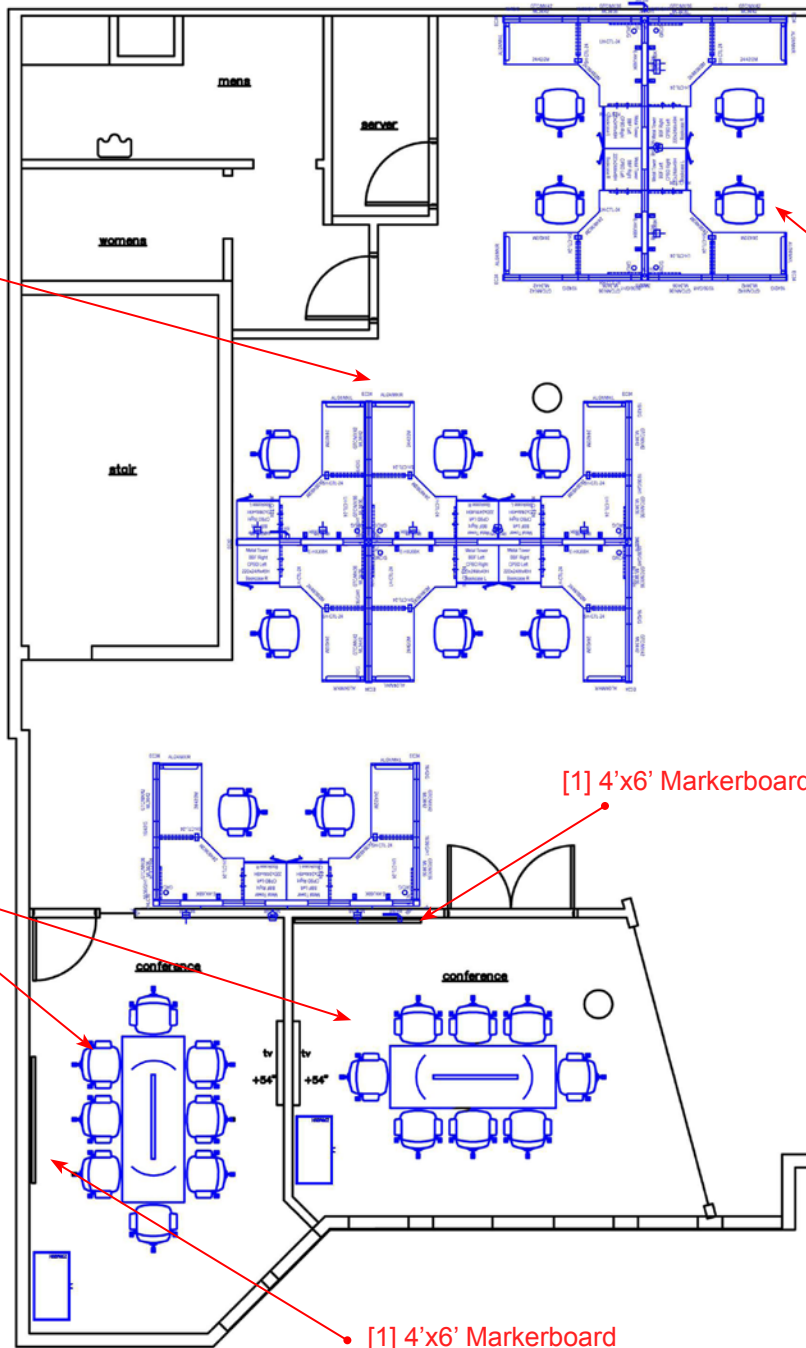

Conference Table Data Unit Cut-Out

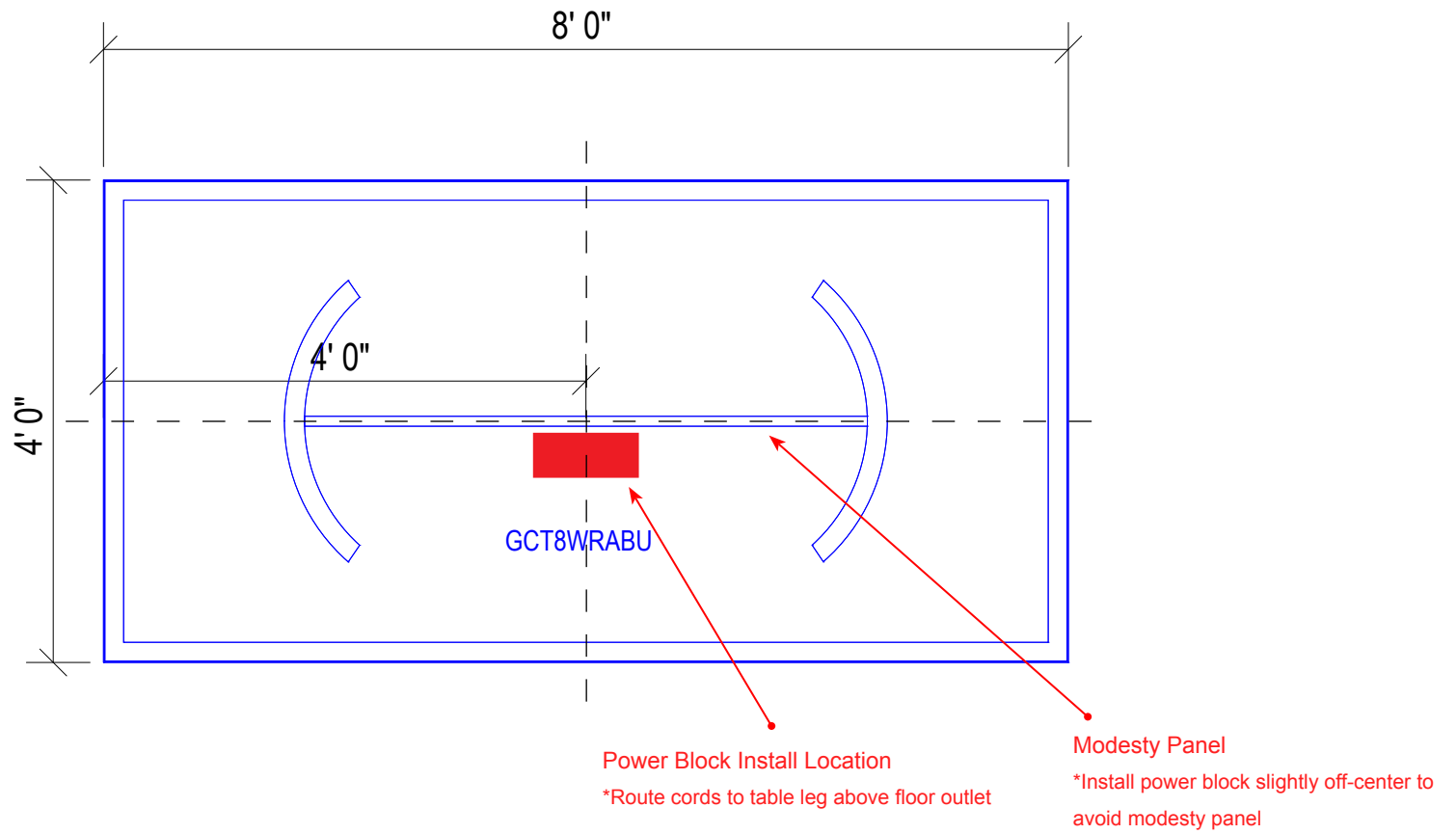

Work Station Details 01

*electrical parts in orange

Panel Tile Configuration

- Refer to Panel Legend on pg.8-9
- Assymmetrical tiles (front and back side different) are indicated in 2 alphabets.
- Ex: "A-b" -> Panel Configuration "A" Side "B"

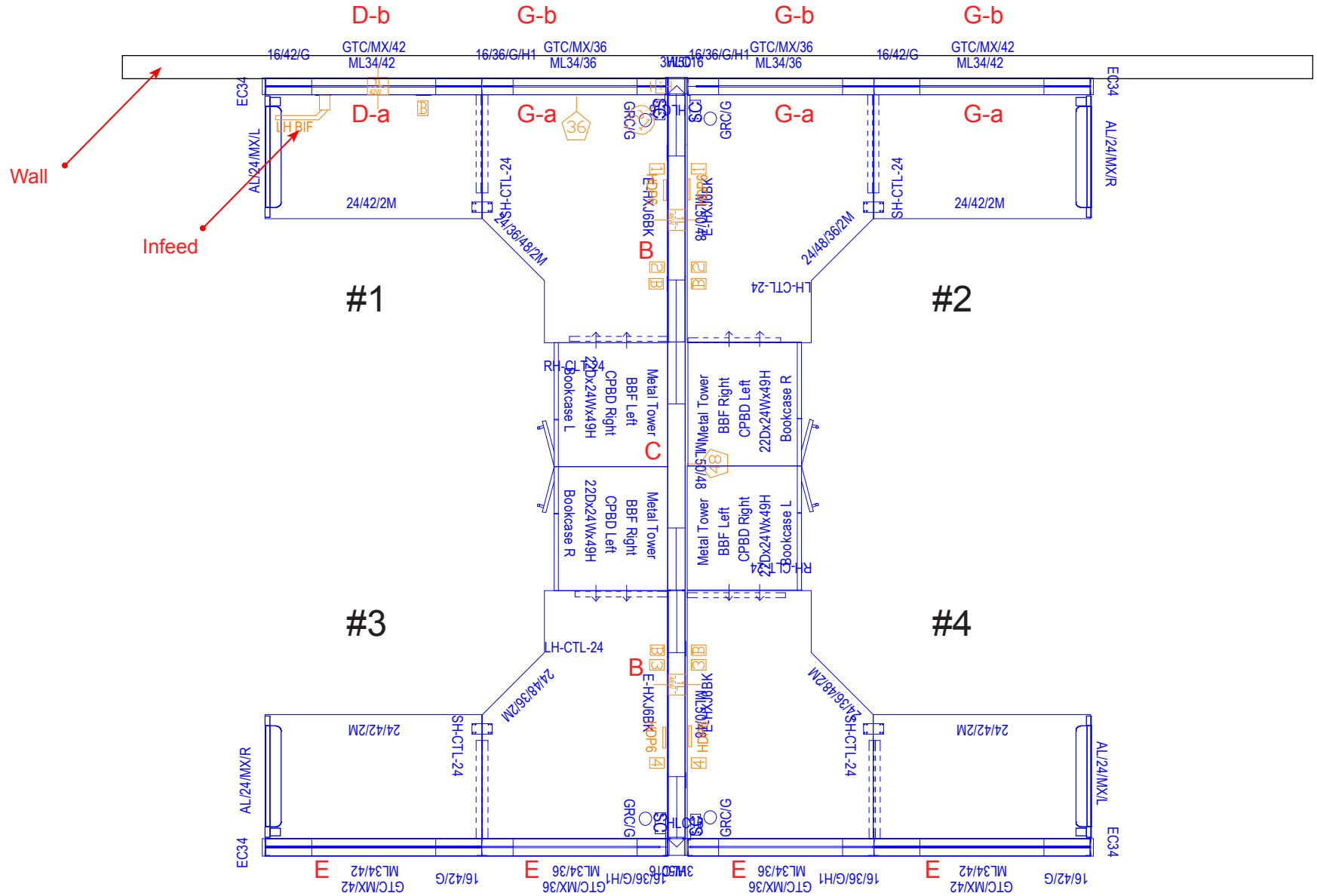

Work Station Details 02

*electrical parts in orange

Panel Tile Configuration

- Refer to Panel Legend on pg.8-9
- Assymetrical tiles (front and back side different) are indicated in 2 alphabets.
- Ex: "A-b" -> Panel Configuration "A" Side "B"

Storage Tower to be nudged forward a bit to pass hardwiring behind

Infeed

Wall

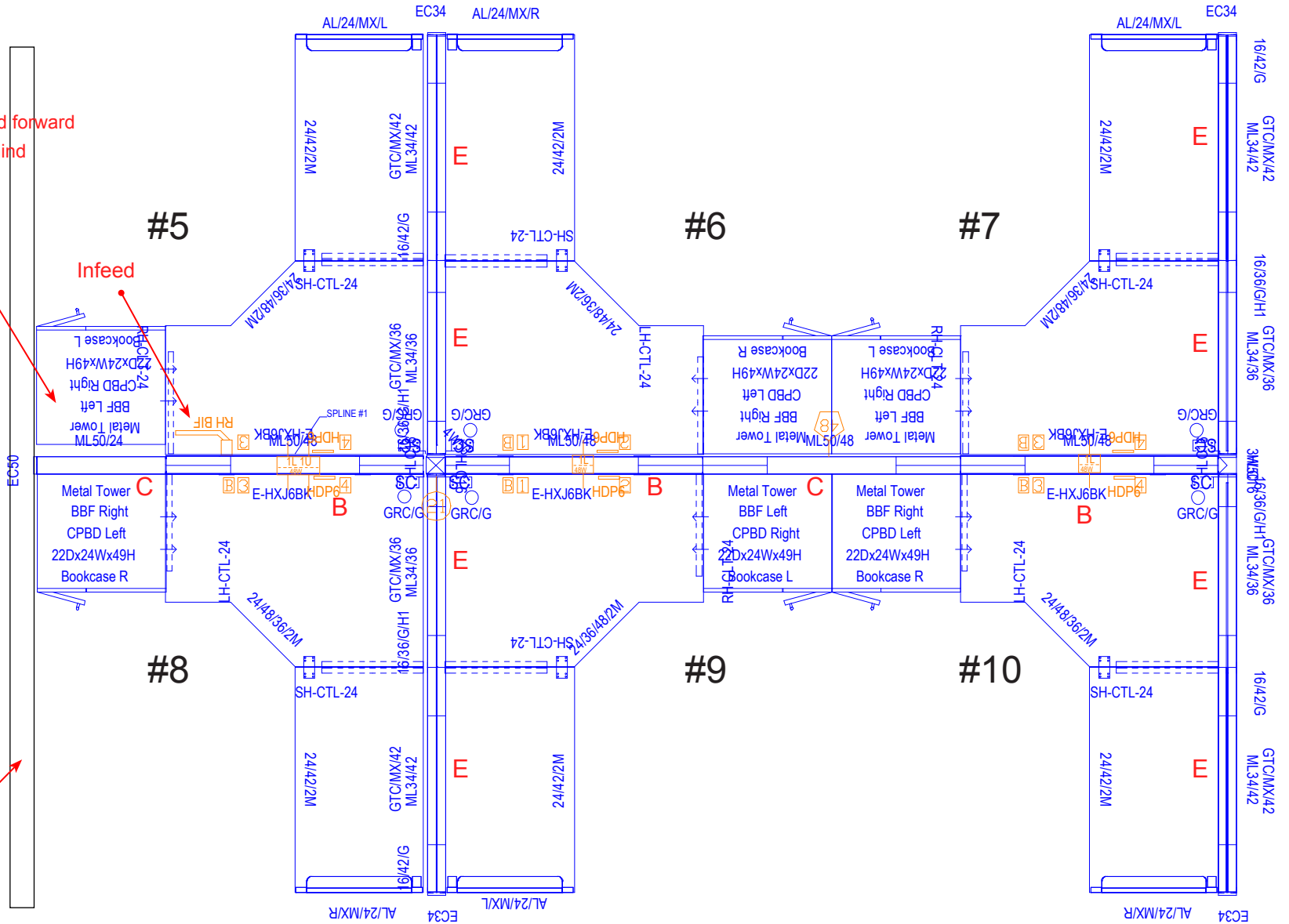

Work Station Details 03

*electrical parts in orange

Panel Tile Configuration

-Refer to Panel Legend on pg.8-9

-Assymmetrical tiles (front and back side different) are indicated in 2 alphabets.

Ex: "A-b" -> Panel Configuration "A" Side "B"

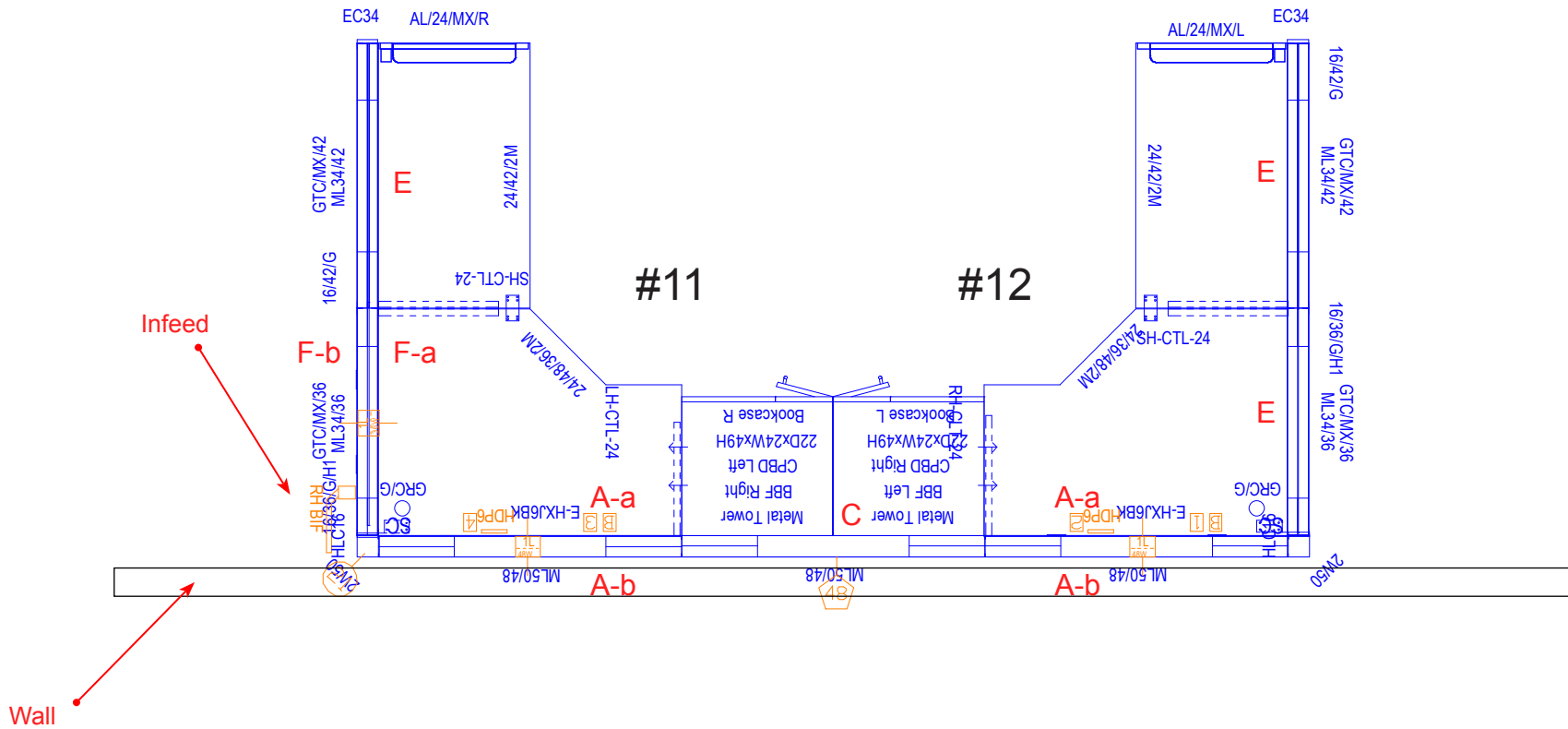

Panel Legend #1

Panel A

16" White Board 16"H P-M2TWB16<W> W1
16" Tackable Acoustic 16"H P-M2TTK16<W>
8" Tackable Acoustic 8"H P-M2TTK08<W>
8" Quad Electrical 8"H P-M2TEQ08<W>

Side A

48" Tackable Acoustic 48"H P-M2TTK48<W>
--

Side B

Panel B

16" White Board 16"H P-M2TWB16<W> W1
16" Tackable Acoustic 16"H P-M2TTK16<W>
8" Tackable Acoustic 8"H P-M2TTK08<W>
8" Quad Electrical 8"H P-M2TEQ08<W>

Side A

16" White Board 16"H P-M2TWB16<W> W1
16" Tackable Acoustic 16"H P-M2TTK16<W>
8" Tackable Acoustic 8"H P-M2TTK08<W>
8" Quad Electrical 8"H P-M2TEQ08<W>

Side B

Panel C

48" Tackable Acoustic 48"H P-M2TTK48<W> F1

Side A

48" Tackable Acoustic 48"H P-M2TTK48<W> F1

Side B

Panel Legend #2

Panel D

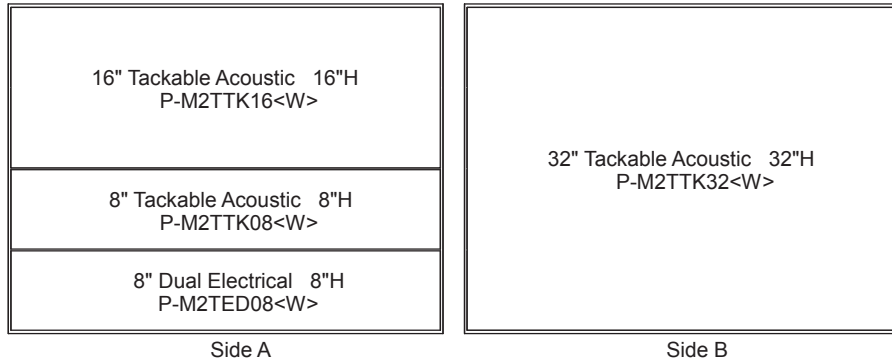

Panel E

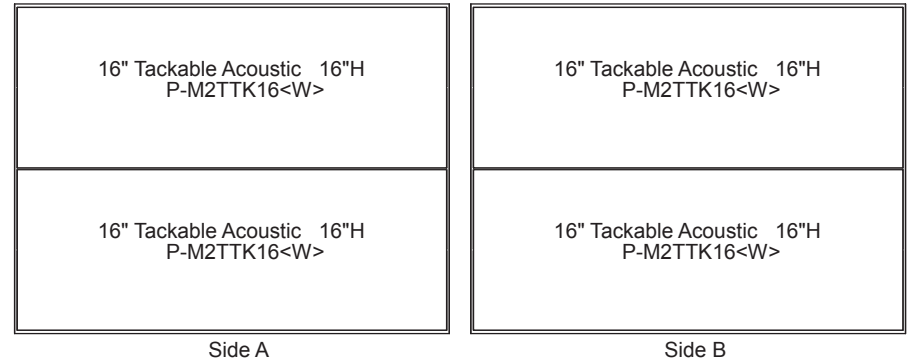

Panel F

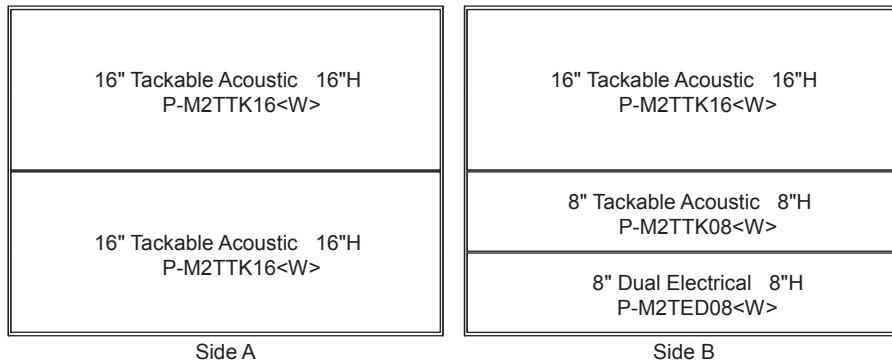

Panel G

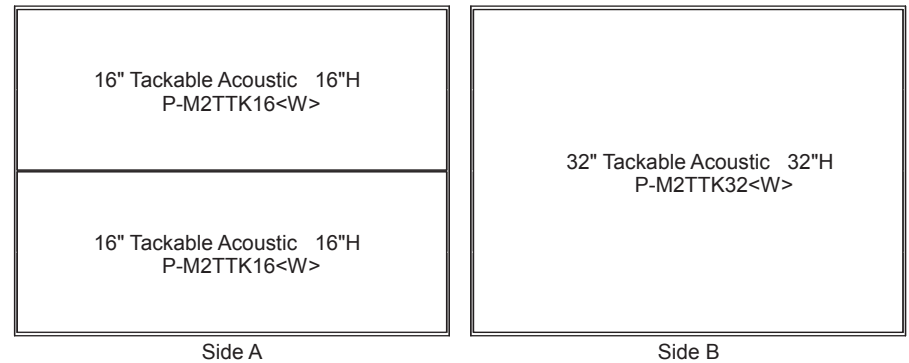

WORK STATIONS (3D VIEW-1)

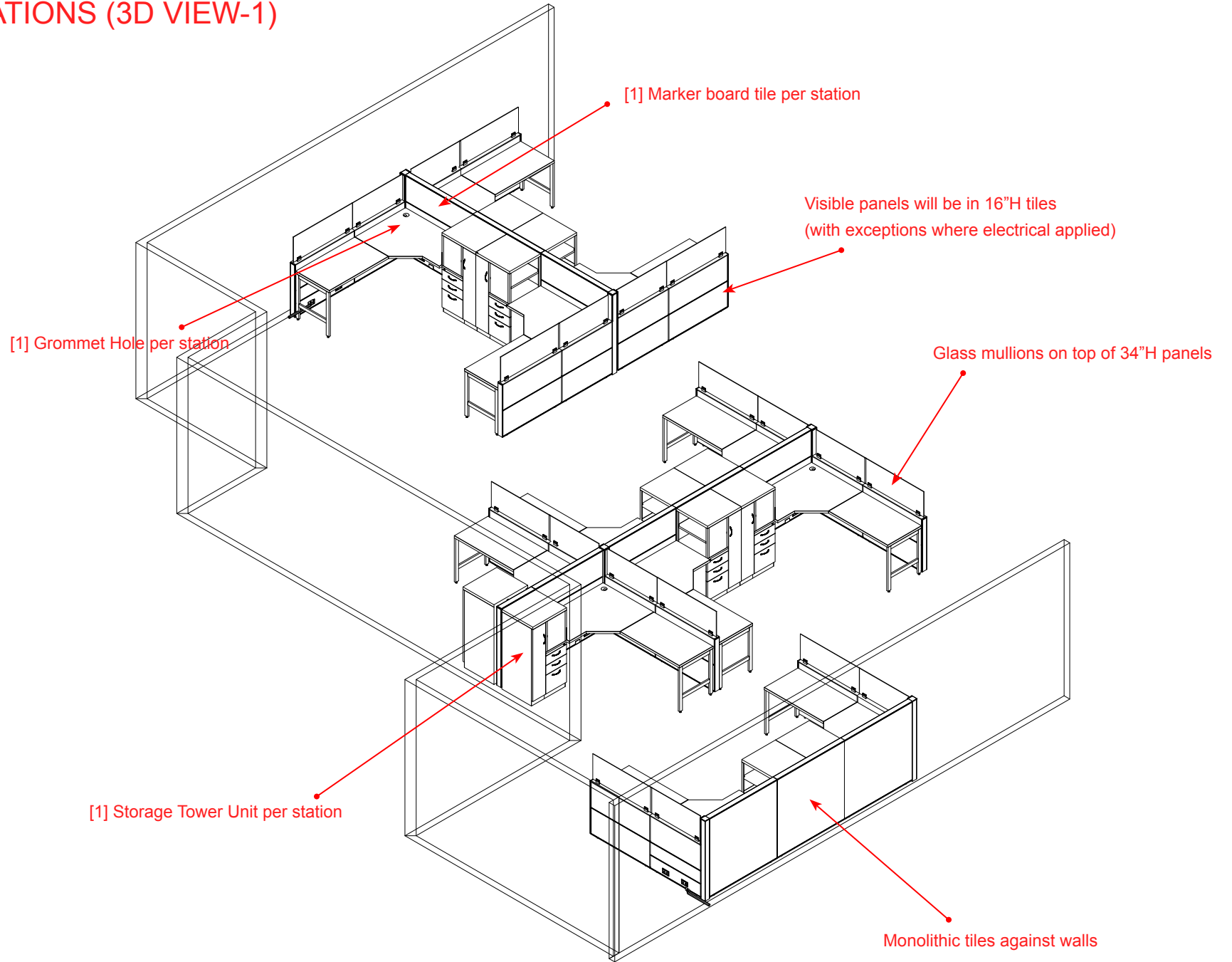

WORK STATIONS (3D VIEW-2)

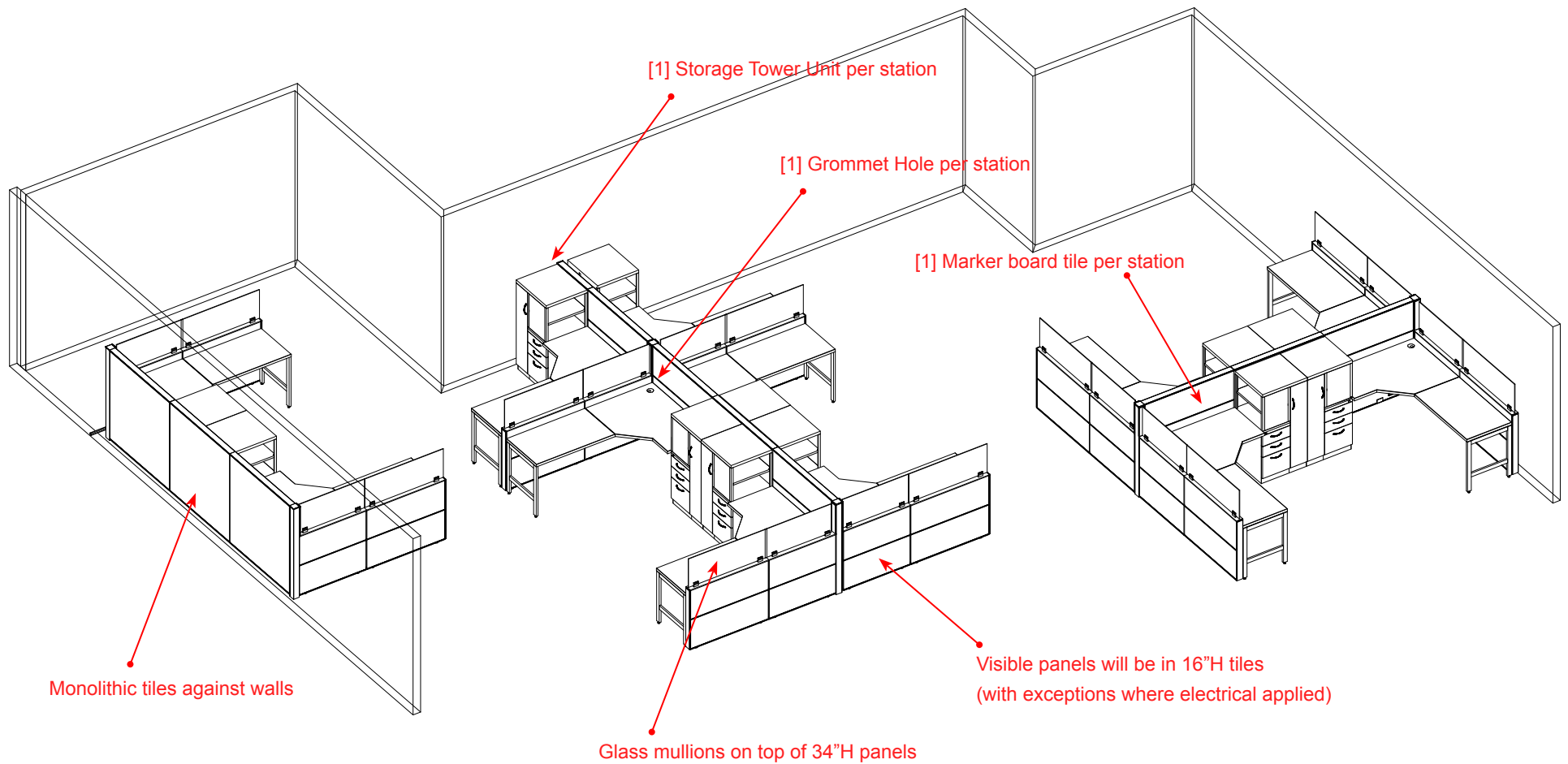

WORK STATIONS (3D DETAILS)

