

Goodwin Street Improvements Marina Street to Summit Avenue

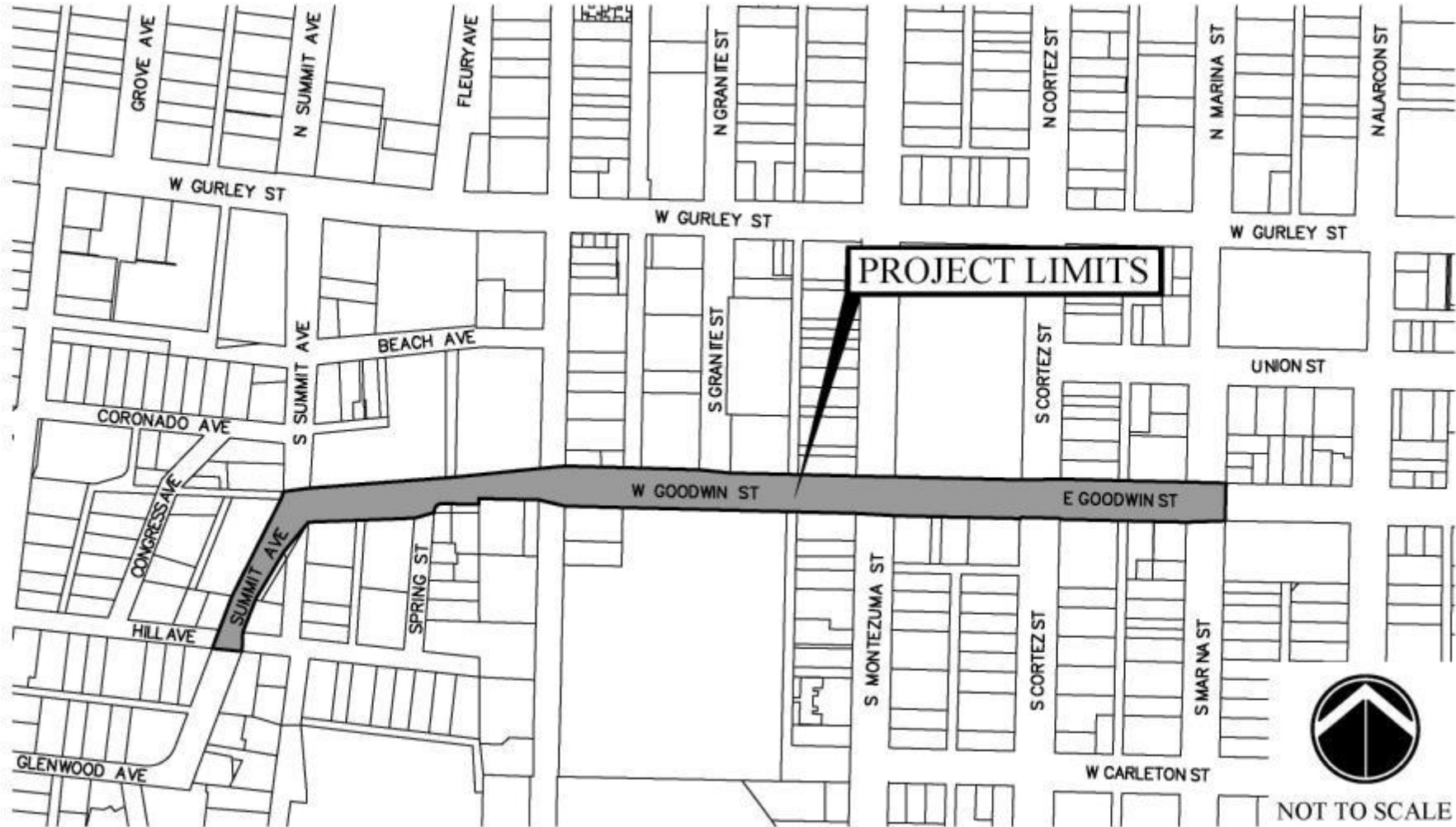

Project Vicinity



Project Purpose

- Reduce flood potential on Whiskey Row
- Replacement of aged sewer and water lines
- Improve parking
- Improve pedestrian safety
- Enhance sidewalks and pedestrian crosswalks
- Provide streetscape/landscape improvements

First Steps

- Contract award to Hoskin Ryan on October 11, 2016
- Field survey completed
- 15% design evaluation completed
- Public meeting in March 1, 2017

Existing Storm Drainage Systems



Storm Drainage - Summit and Goodwin



Storm Drainage - Summit and Goodwin



Storm Drainage - Summit and Goodwin



Goodwin and Montezuma Existing Conditions

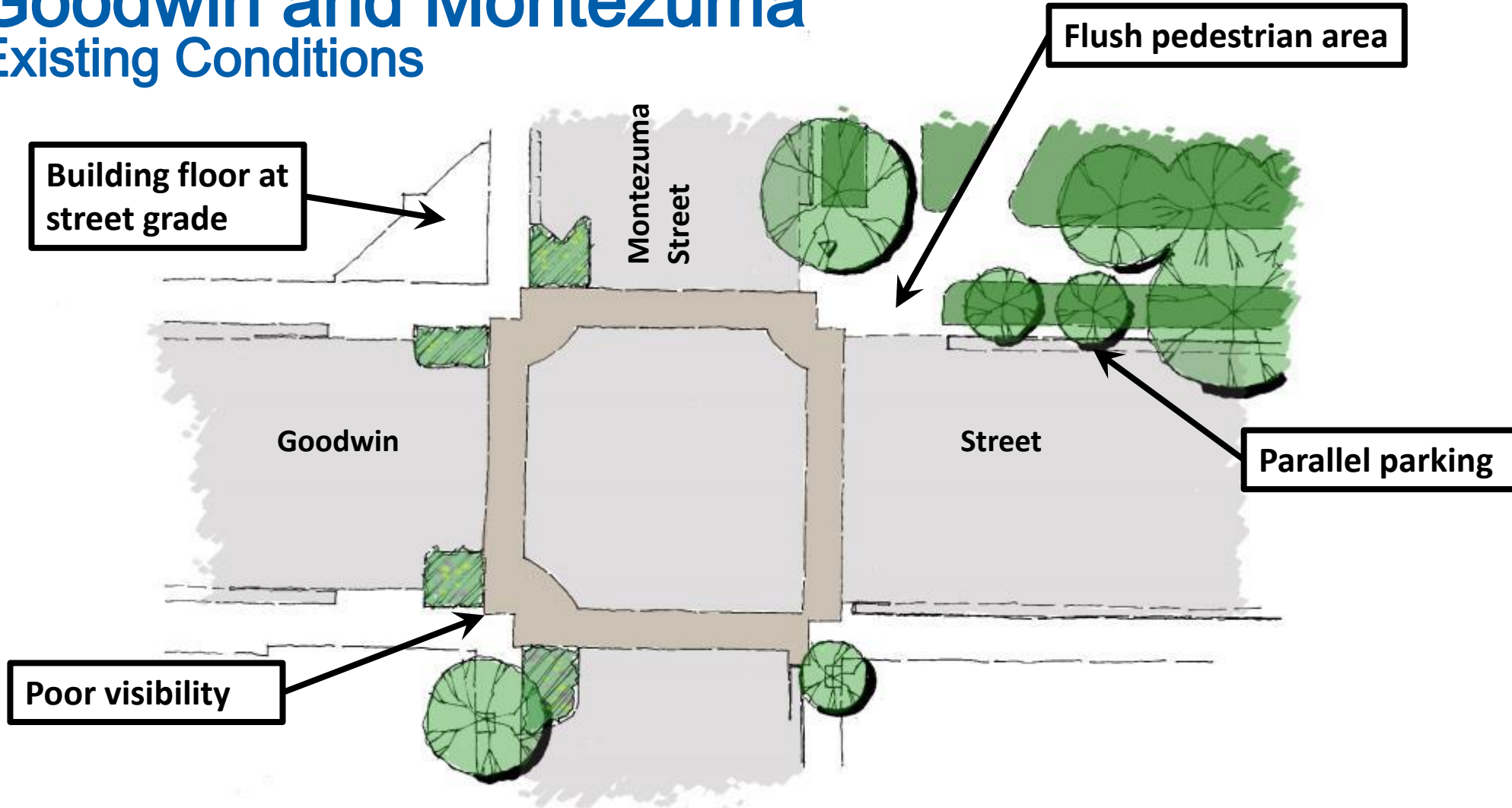

Goodwin and Montezuma Proposed Conditions

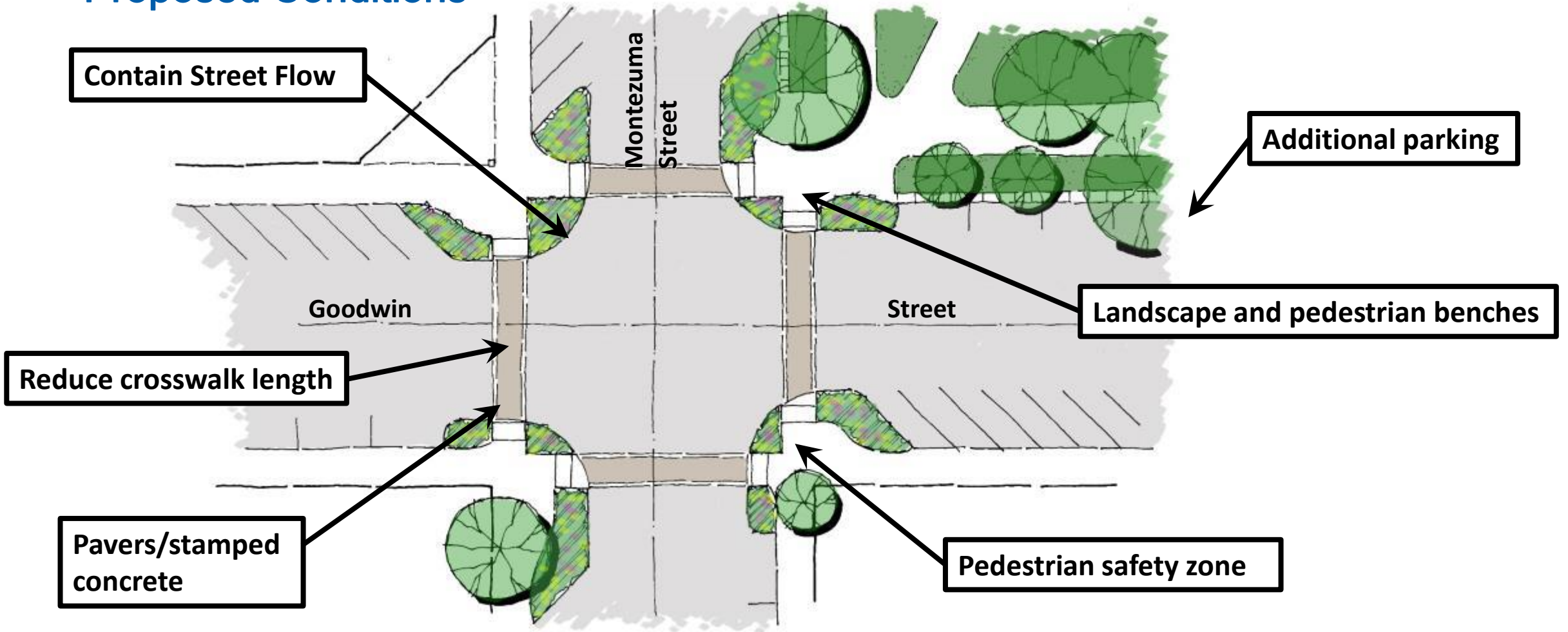

Contain Street Flow

Additional parking

Reduce crosswalk length

Landscape and pedestrian benches

Pavers/stamped concrete

Pedestrian safety zone

Goodwin and Montezuma



Goodwin and Montezuma

Proposed Conditions



Goodwin and Granite

Existing Conditions



Goodwin and Granite

Proposed Conditions

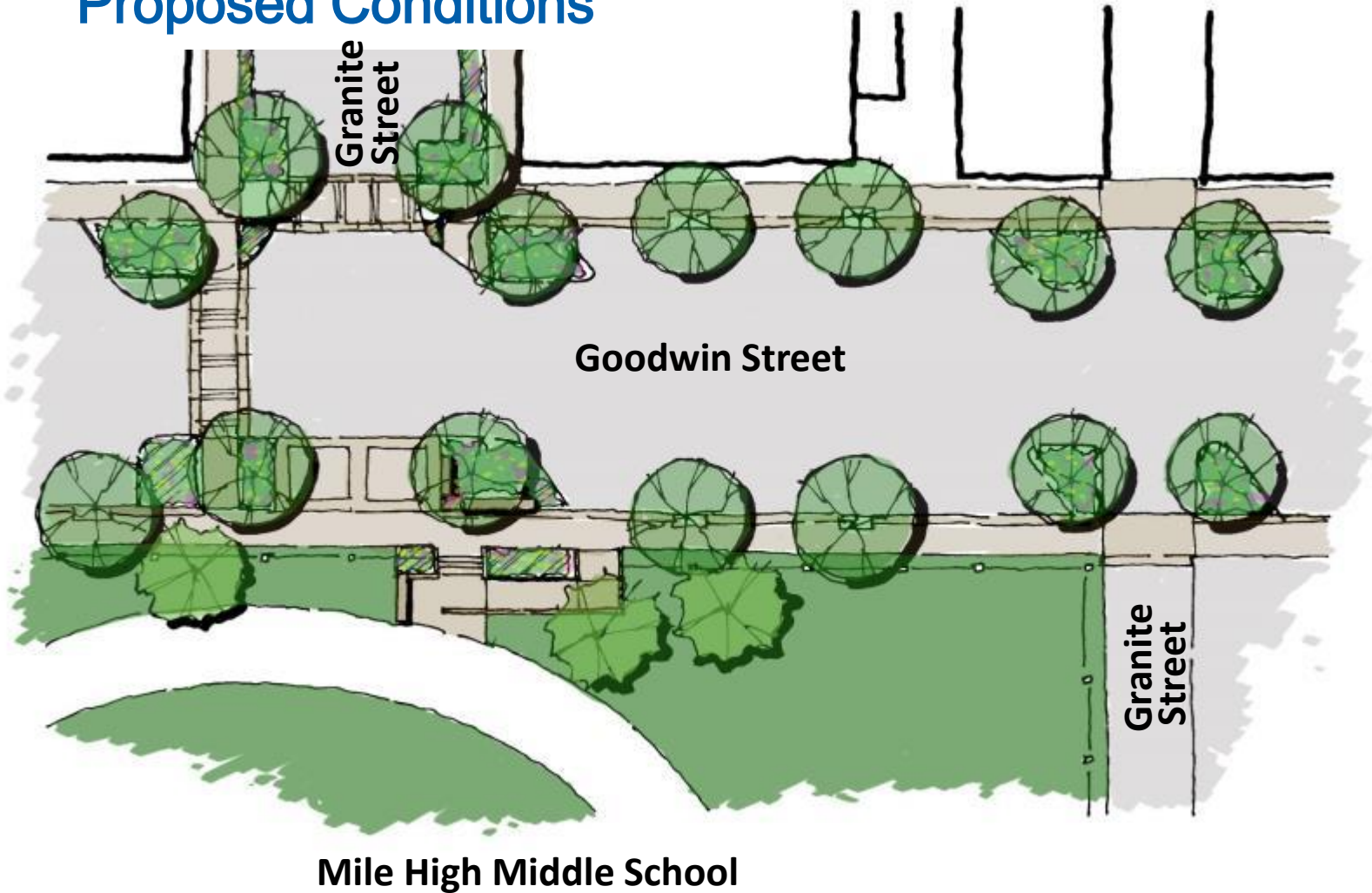

Goodwin and Granite



Goodwin and Summit

Existing Conditions



Current Problems

- 5-way street intersection
- High rate of pedestrian crashes
- Acute Angle of intersection
- Driver confusion

Goodwin and Summit Proposed Roundabout



Solutions

- 4-way street intersection
- Improved circulation
- Improved visibility
- Improved pedestrian safety
- Terminus to downtown

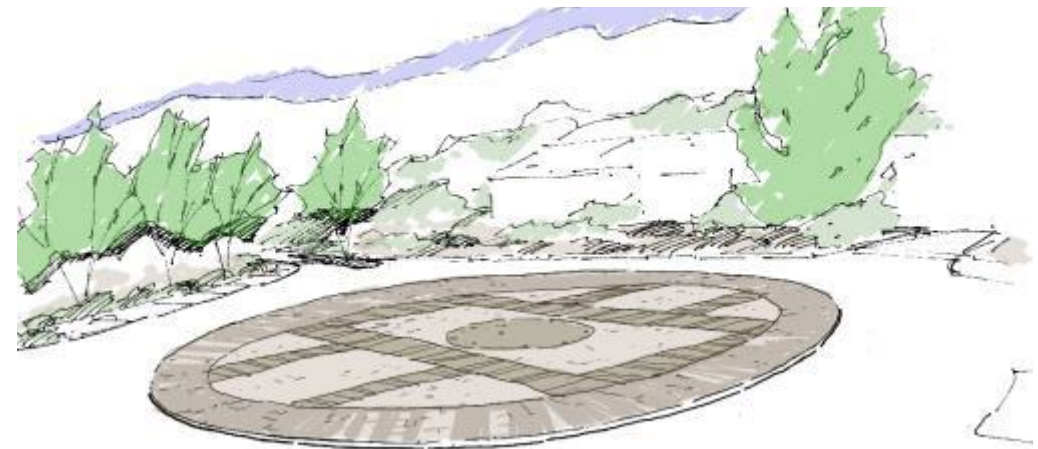

Next Steps

- 30% Design underway
- Public Meeting March 1, 2017
- Design complete Fall 2017
- Construction sequencing to minimize effect on downtown events
- Construction 2018

Goodwin and Summit Proposed Tee Intersection



Solutions

- 4-way stop street intersection
- Improved pedestrian crossings
- Reduced driver confusion

Storm Drainage - Summit and Goodwin

