

NEW



SLIDO 120 SERIES

NEW ARCHITECTURAL SLIDING SYSTEMS
WITH DOUBLE-SIDED SMUSO



Sliding doors have become an essential part of residential and commercial areas due to their versatility, ease of use and countless applications. It therefore has become a necessity to continuously develop and innovate in order to cater to the ever-changing lifestyle and technological demands from these fittings.

Häfele has numerous sliding systems under its SLIDO range catering to varied needs in every area of your life. The new sliding systems in this range - Classic120 W, Classic120 XL, Classic120 F, Classic120 S, Design120 J, Design Ergo120 and Design120 SS act as enhanced versions of the previously available systems under the SLIDO 100 series. They come with improved rollers and tracks and allow you to avail the maximum door height, width or thickness possible for your sliding doors.

To acquire sliding systems with soft opening and closing feature, a new double-sided Smuso system has been developed with a more compact structure and better functionality. The system is modified in such a way that you now require a single universal system that can be used for both single and double doors, easing installation complexities and lessening ordering difficulties. This product communication also introduces two new sliding systems launched within the SLIDO Range, Classic 60 W with double-sided Smuso and Design Ergo 80 for smaller/lighter doors.

SLIDO 120 SERIES - WOODEN SLIDING DOOR SYSTEMS

FEATURES

- > Solid rollers are made of high quality Zamak through one piece die casting
- > Wheels are made of DELRIN which is a special anti-wear compound that offers higher tensile strength, stiffness, and significantly outperforms on impact resistance
- > Ground shielded ball bearings are present around the wheel for silent and smooth sliding
- > High quality hanger is made of Zamak alloy with solid structure and discrete design
- > Premium grade two-way suspension brackets (for 120 W) and one way suspension brackets (for other sliding systems) are made of zinc coated steel. In case of two-way suspension brackets, the suspension screw can be inserted from the front or the side for easy installation.
- > Open structure of the track prevents dust accumulation
- > Compact form of stopper does not afflict the roller wheels so they do not get damaged when the roller set hits the stopper
- > The bottom guide is adjustable (up to 2 mm towards the left or right) for perfect alignment of the door run
- > Highly efficient double-sided soft close technology is embedded into the track for systems compatible for installation with Smuso
- > For flush sliding systems, improved roller installation leaves very less gap between the ceiling and door because the brackets are flushed into the door, reducing the gap between track and door to 3 mm (for 120 XL) and 6 mm (for 120 F)

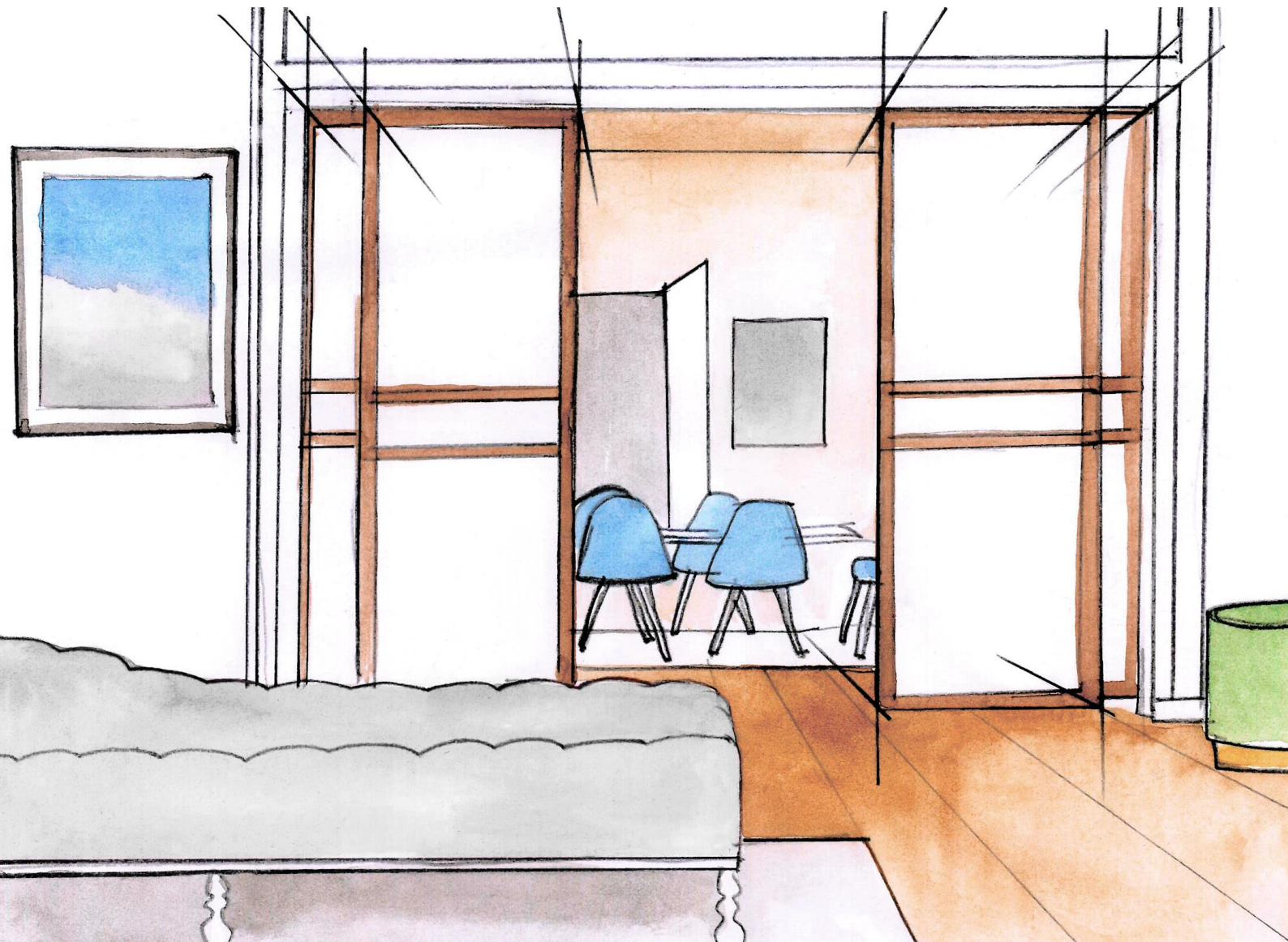

CLASSIC120 W

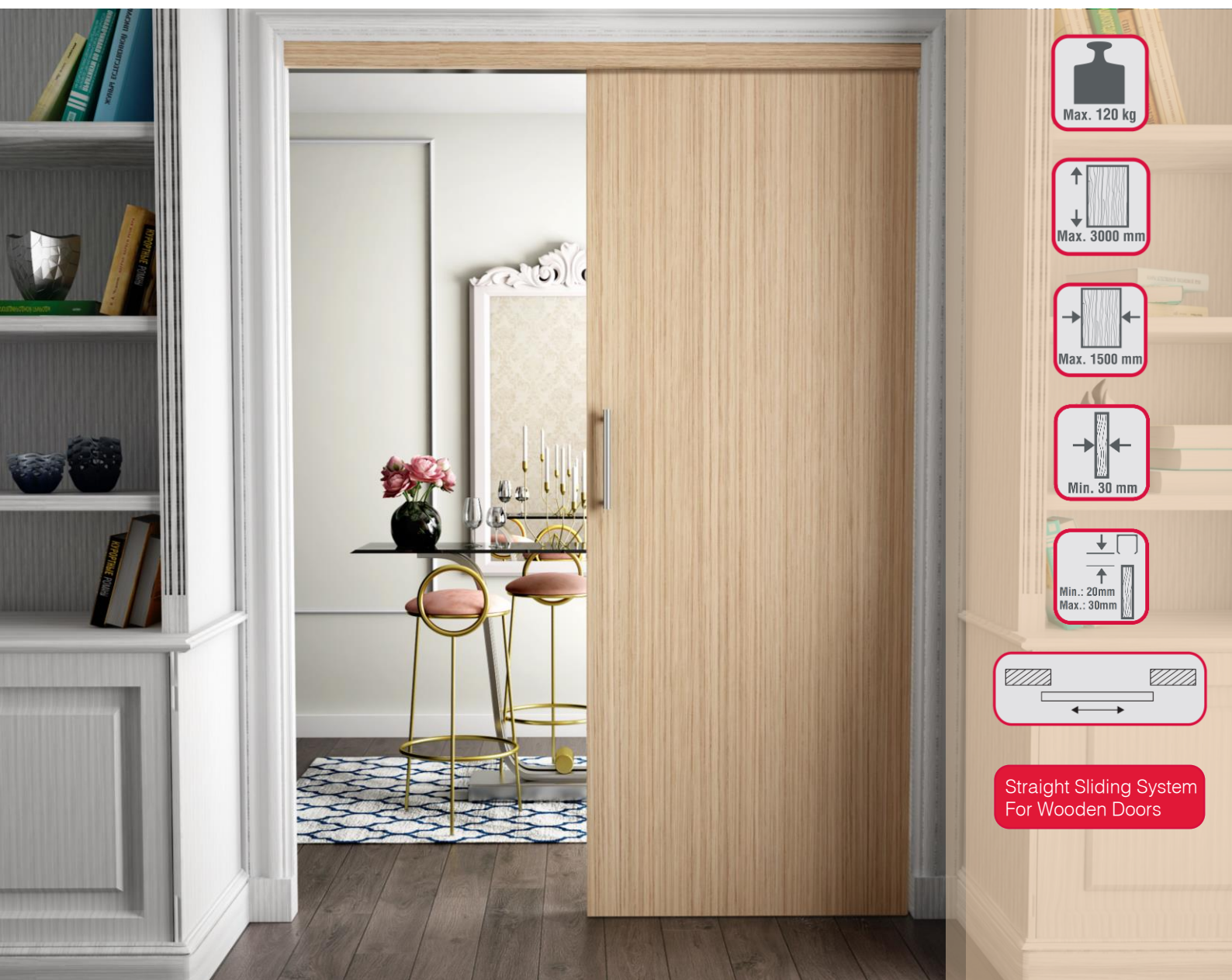

COMPONENTS

**941.10.027: CLASSIC 120 W SLIDING DOOR KIT**

Consists of:

- 2 Rollers with Brackets
- 1 Bottom Guide
- 2 Adjustable Stoppers
- Fixing Accessories

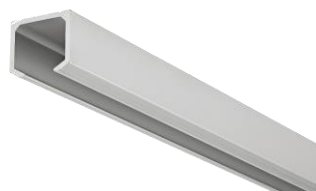
**ALUMINIUM ANODIZED TOP TRACK**

941.10.915	1524 mm	941.10.927	2743 mm
941.10.918	1828 mm	941.10.930	3048 mm
941.10.921	2134 mm	941.10.936	3657 mm
941.10.924	2438 mm		

CLASSIC120 W

TECHNICAL SPECIFICATIONS

A: Door Height, H: Complete Opening Height, W: Door Width

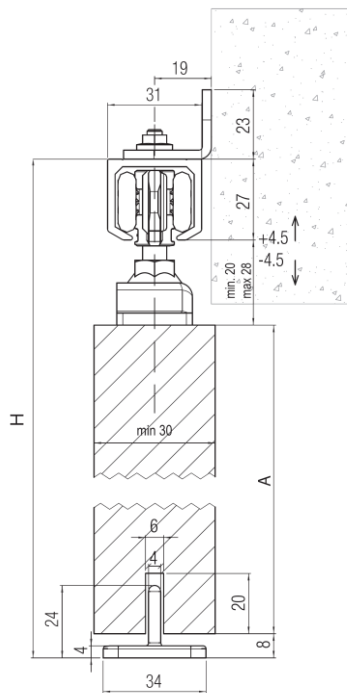

Wall Mounting [Note 1]

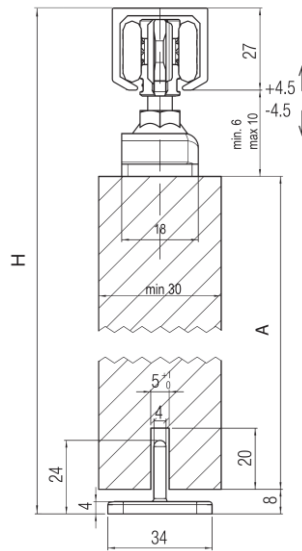

Ceiling Mounting

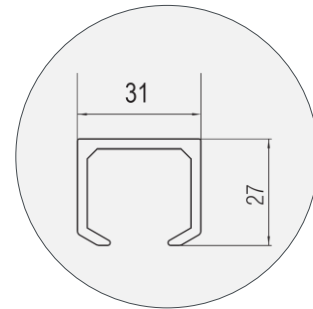

Top Track

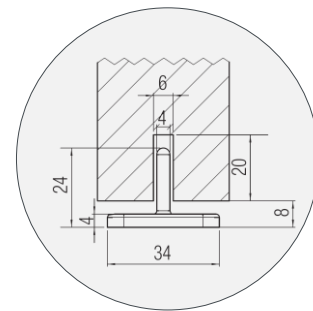

Bottom Guide

$$\text{Door Height (A)} = \text{Total Height Clearance (H)} - [\text{Track Height (Non-concealed)} + \text{Desired Gap (Top + Bottom)}]$$

For example: If the total height clearance is 2700 mm and the desired gaps at the top and bottom are 7 mm and 5 mm respectively, calculate the door height.

According to the above formula, Door Height (A) = Total Height Clearance (H) – [Track Height (Non-concealed) + Desired Gap (Top + Bottom)]
 $= 2700 - [27 + (7 + 5)]$
 $= 2661 \text{ mm}$

Note 1: For wall mounting application, you need to order the mounting bracket separately (940.66.060). Mounting Brackets can be installed at a distance of min. 200 mm to 350 mm from each other.

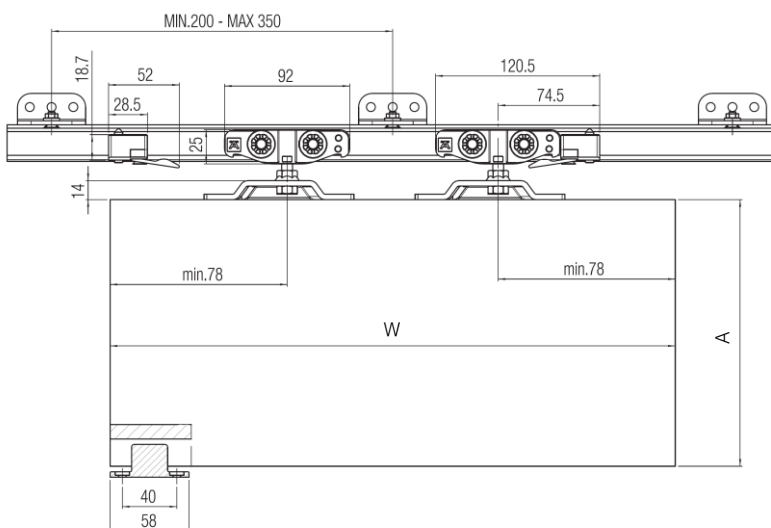

Elevation View

CLASSIC 60 W/ 120 W WITH DOUBLE-SIDED SMUSO



COMPONENTS



941.10.028: CLASSIC 120 W WITH DOUBLE-SIDED SMUSO SLIDING DOOR KIT

941.10.026: CLASSIC 60 W WITH DOUBLE-SIDED SMUSO SLIDING DOOR KIT *

Consists of:

- 1 Two way 120 kg/ 60 kg Smuso with Rollers
- 1 Roller
- 2 Brackets
- 2 Activators
- 1 Bottom Guide
- 2 Adjustable Stoppers
- Fixing Accessories



ALUMINIUM ANODIZED TOP TRACK FOR SMUSO

409.50.603	2000 mm
409.50.604	2400 mm
409.50.605	3000 mm
409.50.606	3600 mm

* Classic 60 W sliding system is intended for light weighted doors and has the same dimensions and specifications as that of Classic 120 W

CLASSIC 60 W /120 W WITH DOUBLE-SIDED SMUSO

TECHNICAL SPECIFICATIONS

A: Door Height, H: Complete Opening Height, W: Door Width

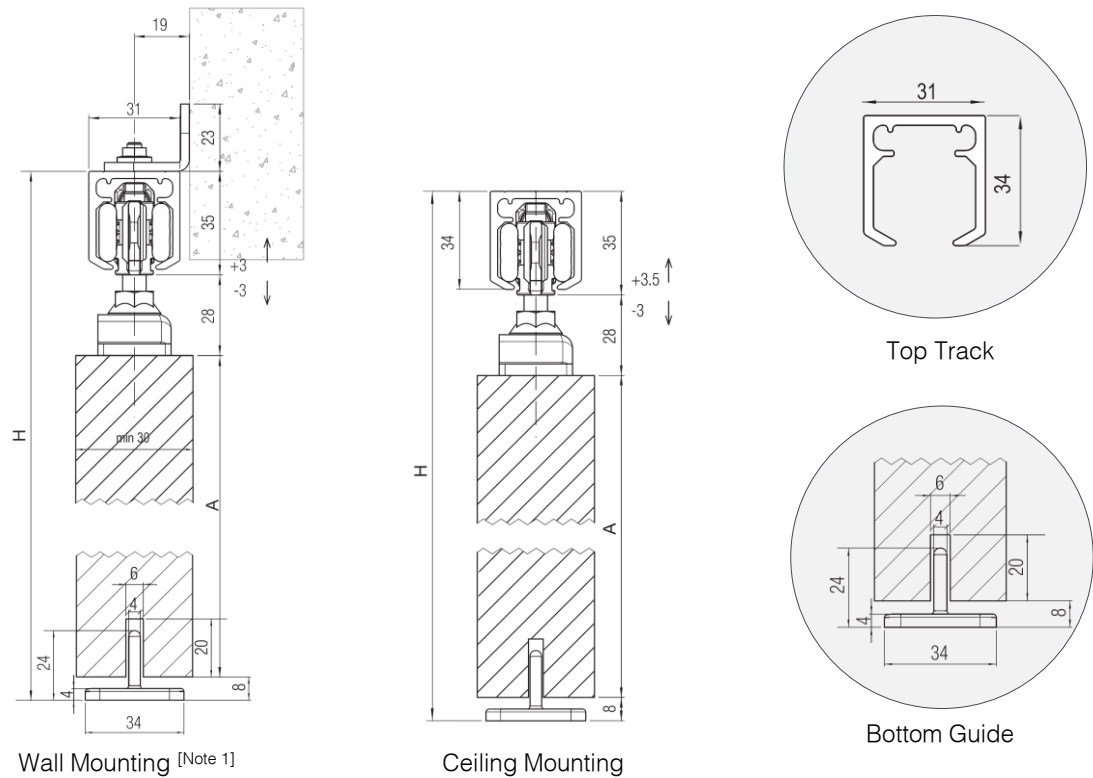

Door Height (A) = Total Height Clearance (H) – [Track Height (Non-concealed) + Desired Gap (Top + Bottom)]

Note 1: For wall mounting application, you need to order the mounting bracket separately (940.66.060). Mounting Brackets can be installed at a distance of min. 200 mm to 350 mm from each other.

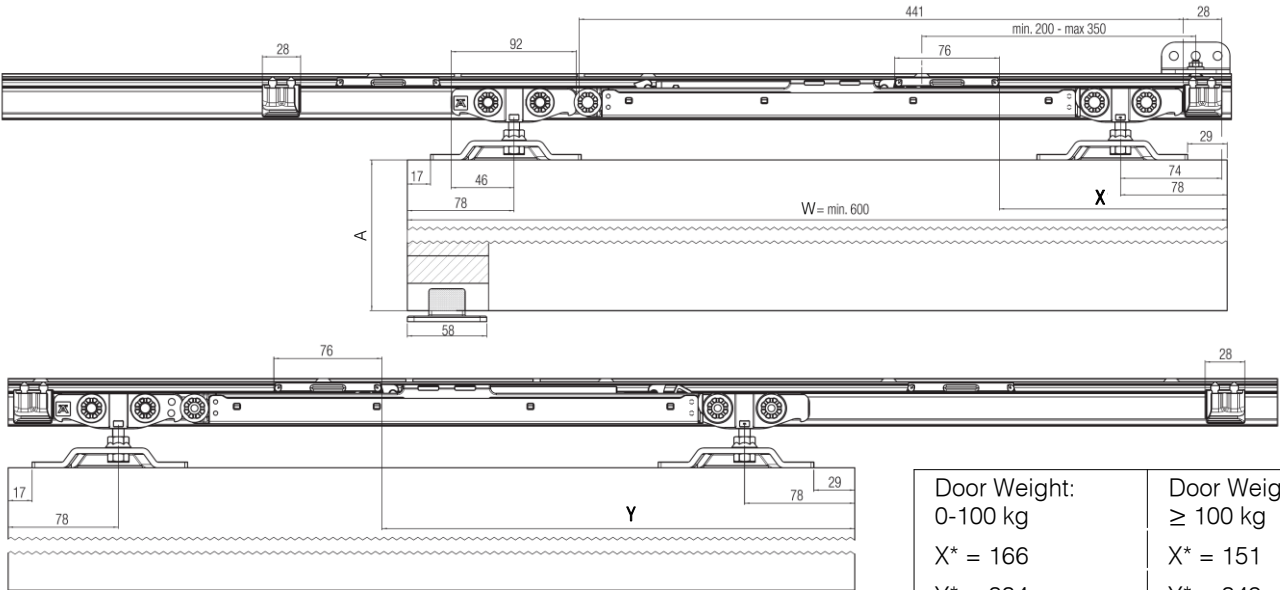

Elevation View

Door Weight: 0-100 kg	Door Weight: ≥ 100 kg
X* = 166	X* = 151
Y* = 334	Y* = 349

X* & Y*: Position of Soft Close Activator

Note 2: To place the Soft Close activators, first close the sliding door and place the first activator at a distance of 'X' as per the weight of the door given in the above table. Then open the sliding door and place the second activator at a distance of 'Y'.

CLASSIC 120 XL

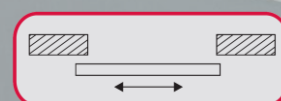

Straight Flush Sliding
System for Wooden
Doors

COMPONENTS

**941.10.029: CLASSIC 120 XL SLIDING DOOR KIT**

Consists of:

- 2 Rollers
- 2 Concealed Brackets and Caps
- 1 Bottom Guide
- 2 Adjustable Stoppers
- Fixing Accessories

ALUMINIUM ANODIZED TOP TRACK

941.10.915	1524 mm	941.10.927	2743 mm
941.10.918	1828 mm	941.10.930	3048 mm
941.10.921	2134 mm	941.10.936	3657 mm
941.10.924	2438 mm		

CLASSIC 120 XL

TECHNICAL SPECIFICATIONS

A: Door Height, H: Complete Opening Height, T: Door Thickness

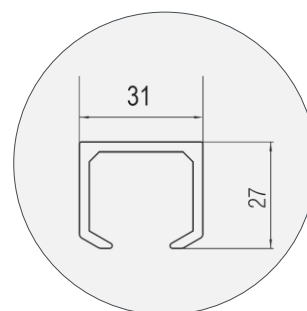
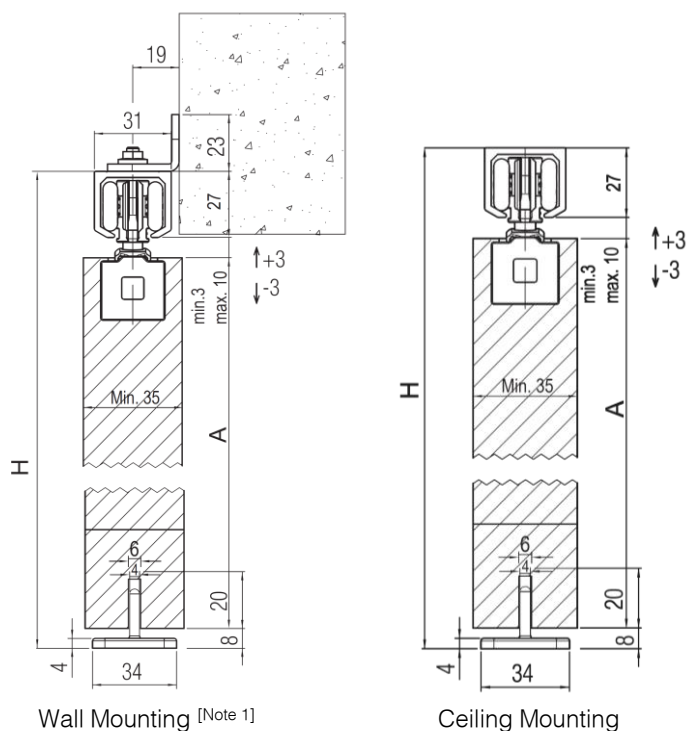

Top Track

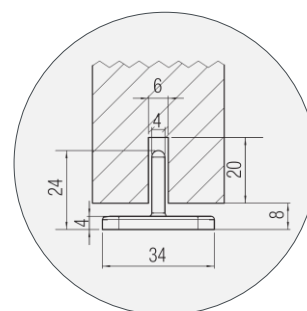

Bottom Guide

$$\text{Door Height (A)} = \text{Total Height Clearance (H)} - [(\text{Track Height (Non-concealed)} + \text{Desired Gap (Top + Bottom)})]$$

Note 1: For wall mounting application, you need to order the mounting bracket separately (940.66.060). Mounting Brackets can be installed at a distance of min 200 mm to 350 mm from each other.

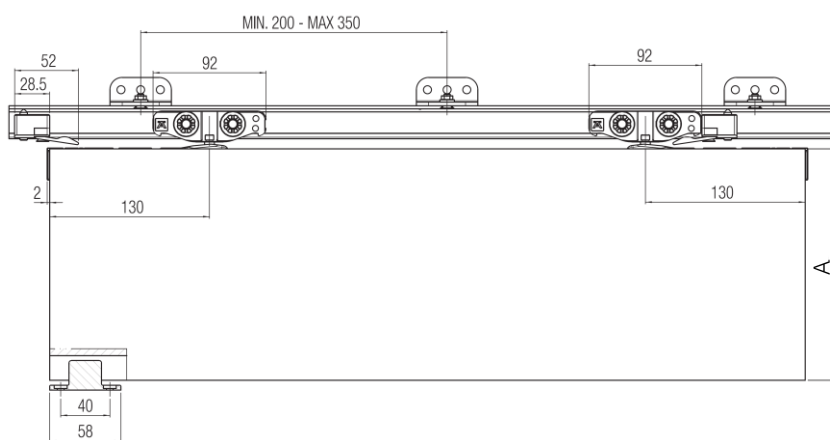

Elevation View

DOOR CUT-OUT DIMENSIONS

T: Door Thickness

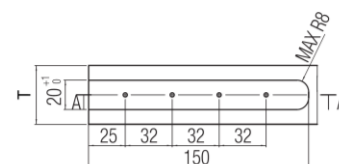
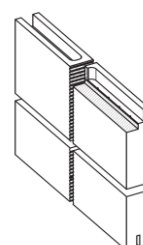

Top View

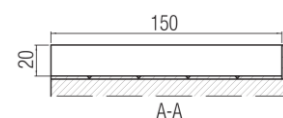

Front View

CLASSIC 120 XL WITH DOUBLE-SIDED SMUSO

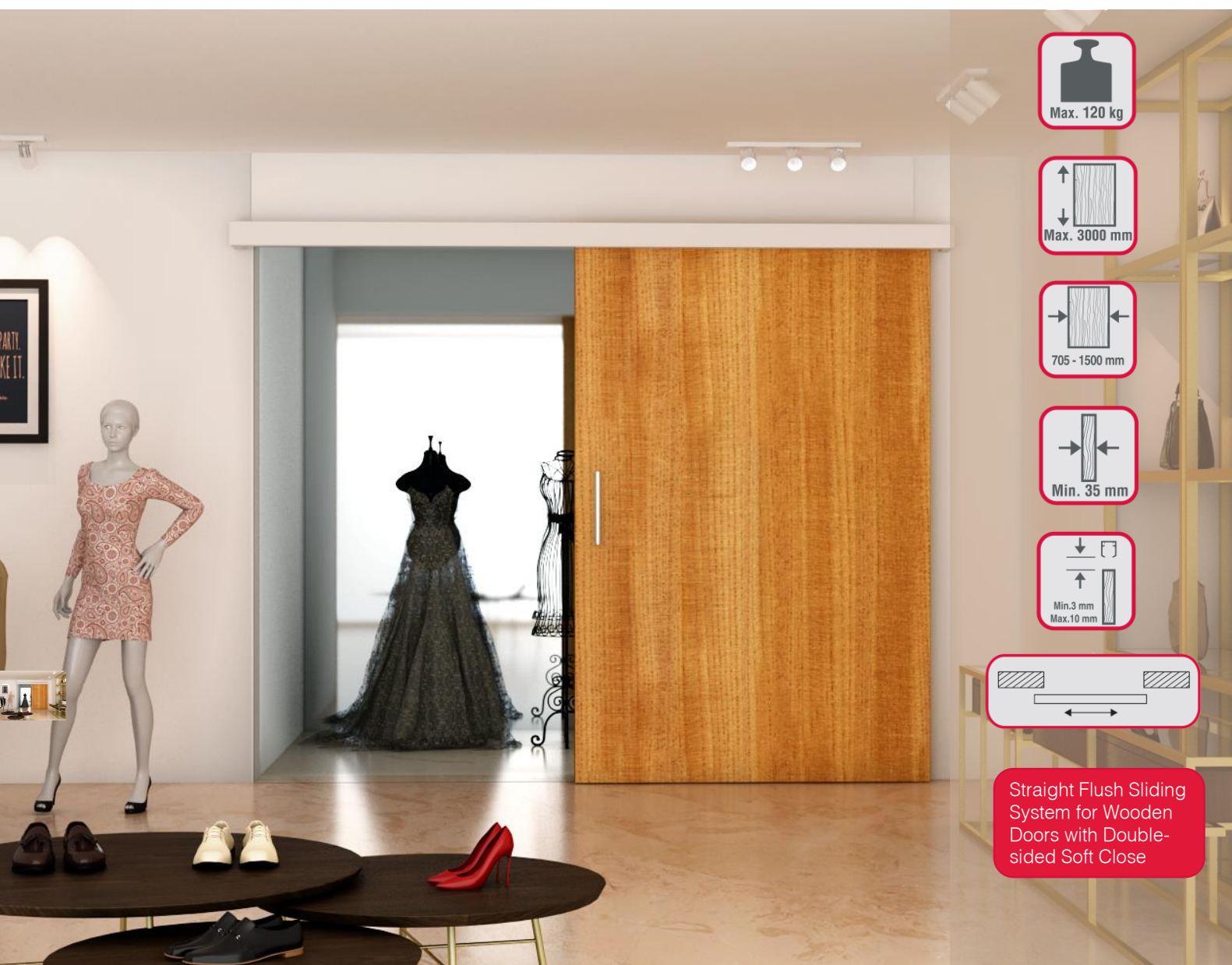

COMPONENTS



941.10.030 : CLASSIC 120 XL WITH DOUBLE-SIDED SOFT CLOSE SLIDING DOOR KIT

Consists of:

- 1 Two-way 120 kg Smuso with Rollers
- 1 Roller
- 2 Flush Brackets with Caps
- 2 Activators and Adjustable Stoppers
- 1 Bottom Guide
- Fixing Accessories

ALUMINIUM ANODIZED TOP TRACK FOR SMUSO

409.50.603	2000 mm
409.50.604	2400 mm
409.50.605	3000 mm
409.50.606	3600 mm

CLASSIC 120 XL WITH DOUBLE-SIDED SMUSO

TECHNICAL SPECIFICATIONS

A: Door Height, H: Complete Opening Height, W: Door Width

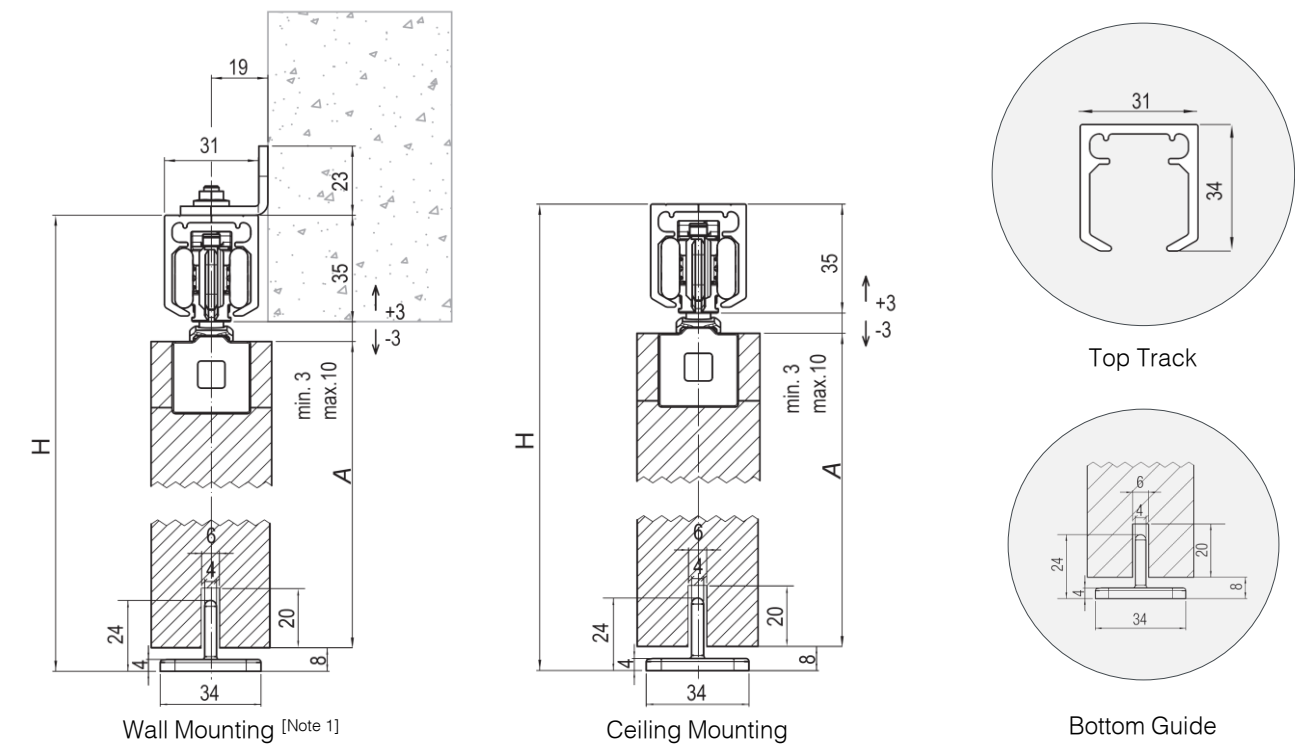

Door Height (A) = Total Height Clearance (H) – [Track Height (Non-concealed) + Desired Gap (Top + Bottom)]

Note 1: For wall mounting application, you need to order the mounting bracket separately (940.66.060). Mounting Brackets can be installed at a distance of min. 200 mm to 350 mm from each other.

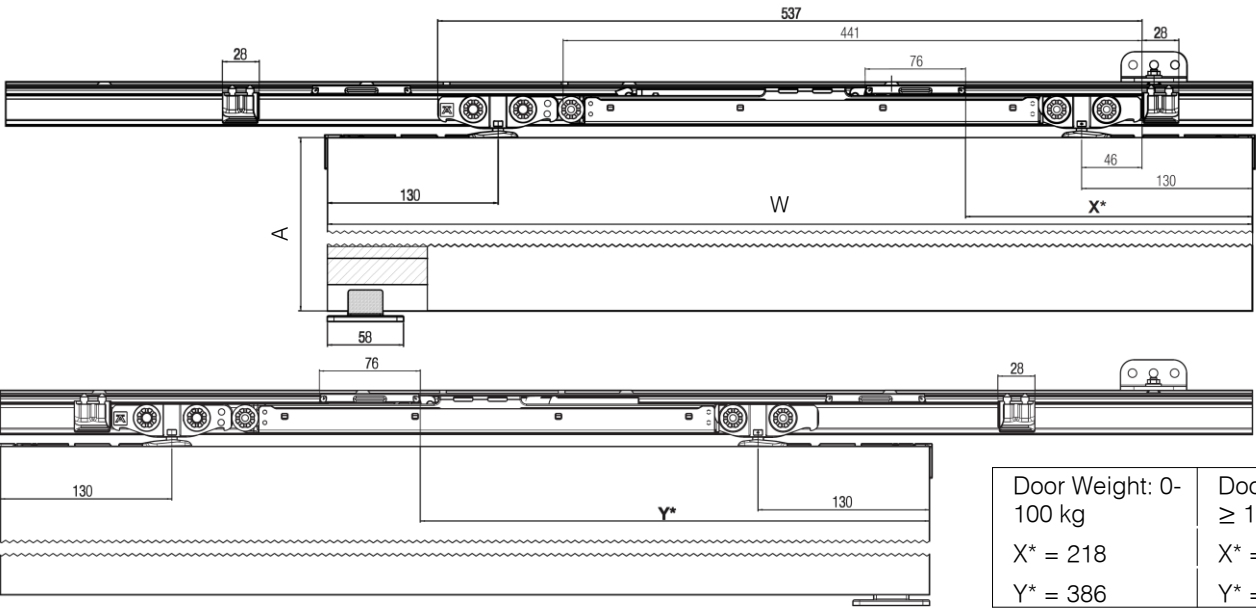

Elevation View

Door Weight: 0-100 kg	Door Weight: ≥ 100 kg
X* = 218	X* = 203
Y* = 386	Y* = 401

X* & Y*: Position of Soft Close Activator

Note 2: To place the Soft Close activators, first close the sliding door and place the first activator at a distance of 'X' as per the weight of the door given in the above table. Then open the sliding door and place the second activator at a distance of 'Y'.
Note 3: Door cut-out dimensions for this system will be the same as Classic 120 XL. For more details on this, please refer to the section 'Door Cut-out Dimensions' on page 9.

CLASSIC 120 F



COMPONENTS



941.10.036: CLASSIC 120 F SLIDING DOOR KIT

Consists of:

- 2 Rollers with Flush Brackets
- 1 Bottom Guide
- 2 Adjustable Stoppers
- Fixing Accessories



ALUMINIUM ANODIZED TOP TRACK

941.10.915	1524 mm	941.10.927	2743 mm
941.10.918	1828 mm	941.10.930	3048 mm
941.10.921	2134 mm	941.10.936	3657 mm
941.10.924	2438 mm		

CLASSIC 120 F

TECHNICAL SPECIFICATIONS

A: Door Height, H: Complete Opening Height, W: Door Width

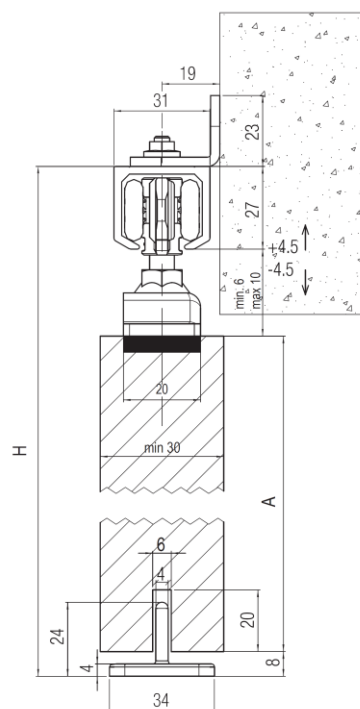

Wall Mounting

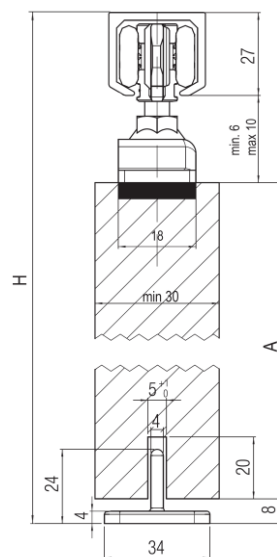

Ceiling Mounting

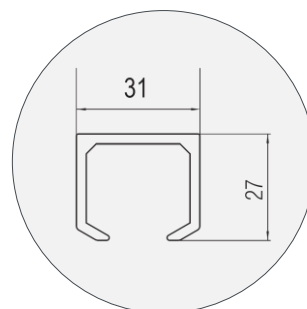

Top Track

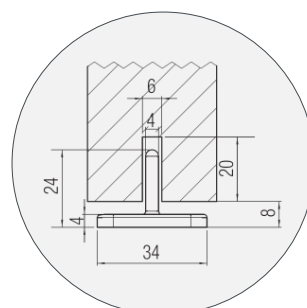

Bottom Guide

$$\text{Door Height (A)} = \text{Total Height Clearance (H)} - [\text{Track Height (Non-concealed)} + \text{Desired Gap (Top + Bottom)}]$$

Note 1: For wall mounting application, you need to order the mounting bracket separately (940.66.060). Mounting Brackets can be installed at a distance of min. 200 mm to 350 mm from each other.

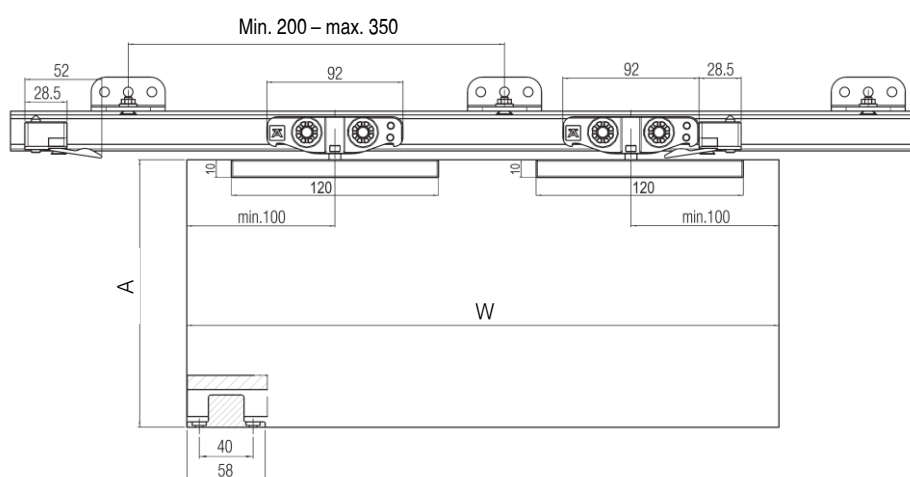

Elevation View

DOOR CUT-OUT DIMENSIONS

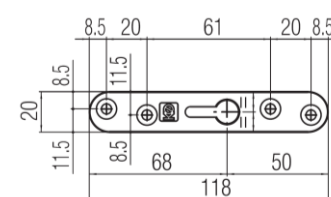

Top View

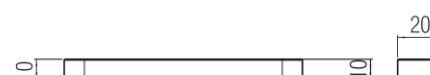

Dimensions of the groove:
10 mm along the height of the door
20 mm along the depth/ thickness of the door

CLASSIC 120 S

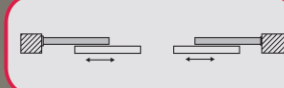

Straight Synchro Sliding
System for Simultaneous
Opening of Both Doors

COMPONENTS

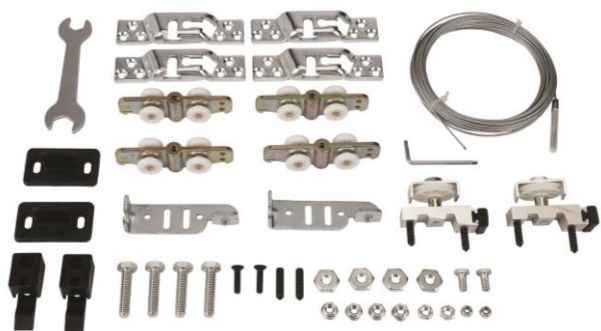
**941.10.035: CLASSIC 120 S SLIDING DOOR KIT**

Consists of:

- 4 Rollers with Brackets
- 2 Bottom Guides
- 2 Pulley Door Profiles
- 2 Cable Brackets
- 8 m Nylon covered Steel Cable
- 2 Adjustable Stoppers
- Fixing Accessories

ALUMINIUM ANODIZED TOP TRACK

941.10.915	1524 mm	941.10.927	2743 mm
941.10.918	1828 mm	941.10.930	3048 mm
941.10.921	2134 mm	941.10.936	3657 mm
941.10.924	2438 mm		

CLASSIC 120 S

TECHNICAL SPECIFICATIONS

A: Door Height, H: Complete Opening Height, W: Door Width

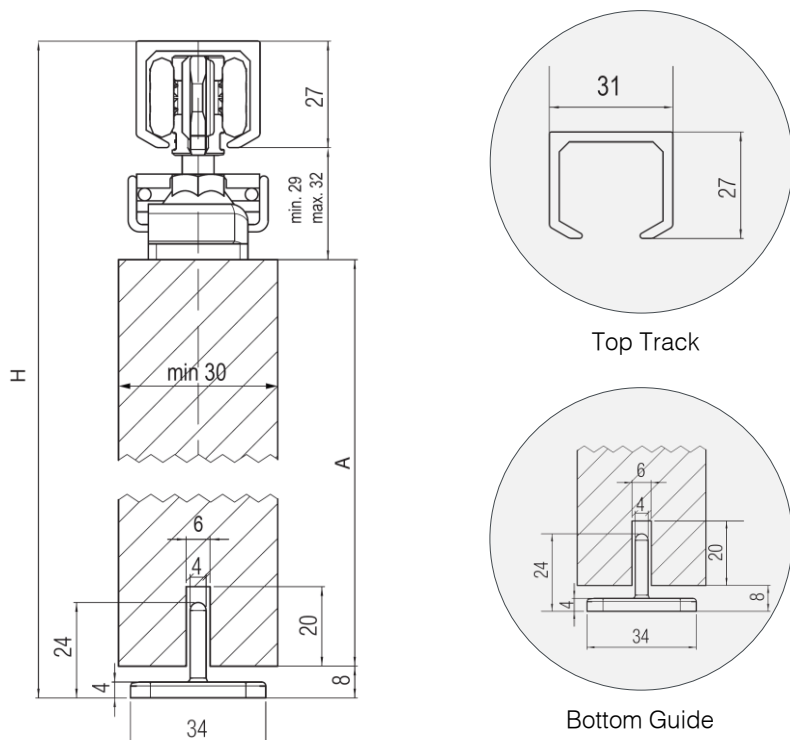

Ceiling Mounting

$$\text{Door Height (A)} = \text{Total Height Clearance (H)} - [\text{Track Height (Non-concealed)} + \text{Desired Gap (Top + Bottom)}]$$

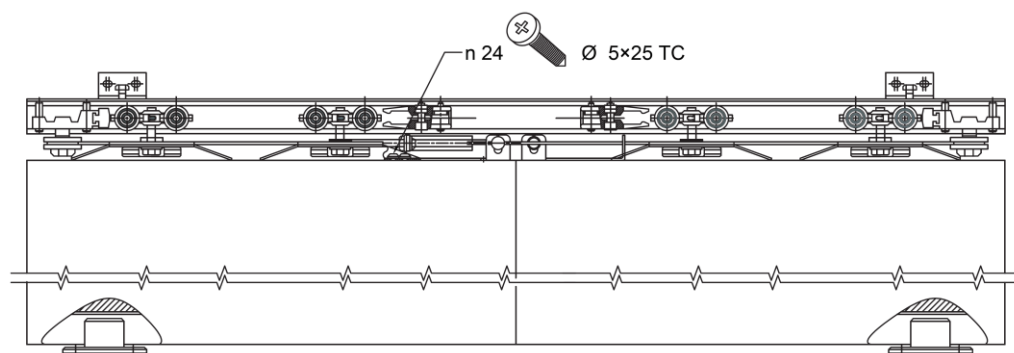

Elevation View : Front

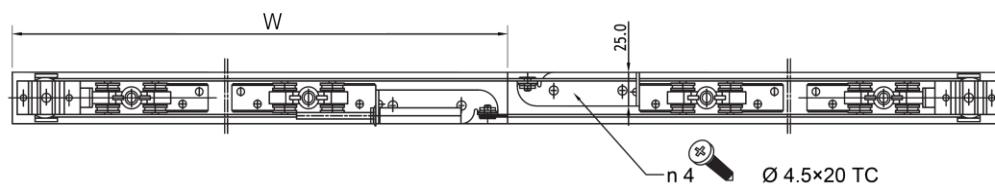

Elevation View : Top

SLIDO 120 SERIES - GLASS SLIDING DOOR SYSTEMS

FEATURES

- > Glass sliding doors are ideal for dividers and internal doors
- > Solid rollers are made of high quality Zamak through one piece die casting
- > Wheels are made of DELRIN which is a special anti-wear compound that offers higher tensile strength, stiffness, and significantly outperforms on impact resistance
- > Rollers have an elastic system for absorbing the irregularities of profile
- > Proven smooth and silent rolling, thanks to the special anti-dust ball bearing system
- > Open structure of the track prevents dust accumulation
- > Compact form of stopper does not afflict the roller wheels so the wheels do not get damaged when the roller set hits the stopper
- > Brackets are sturdy and appealing because of their Stainless Steel 304 material and Stainless Steel Polished finish
- > Highly efficient Double-sided Soft Close technology is embedded into the track for systems compatible for installation with Smuso
- > Adjustment is available in the bottom guide according to thickness of the glass door for Ergo Systems (Design Ergo 80, Design Ergo 120 and Design Ergo 120 with Double-sided Smuso)

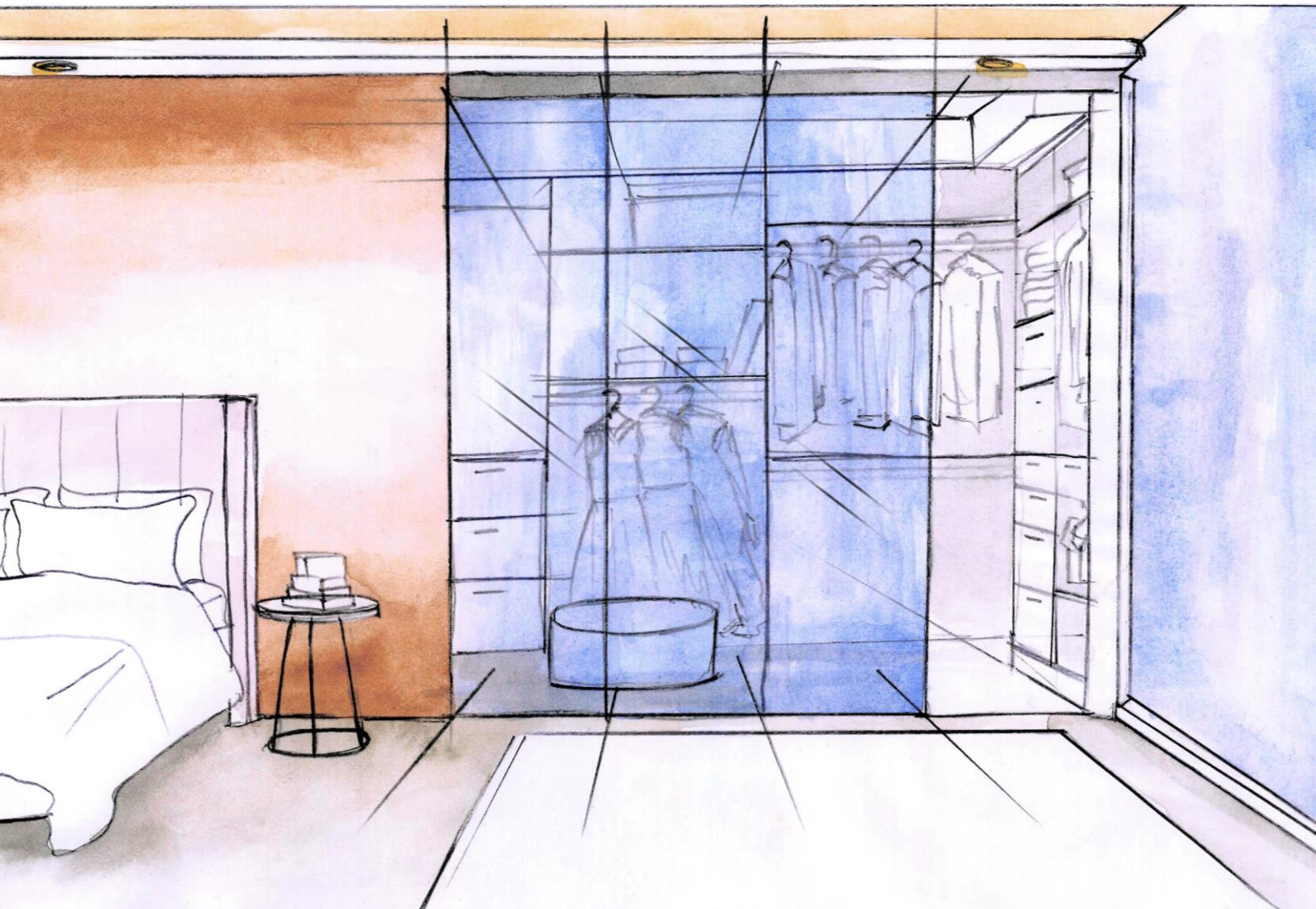

DESIGN ERGO 80

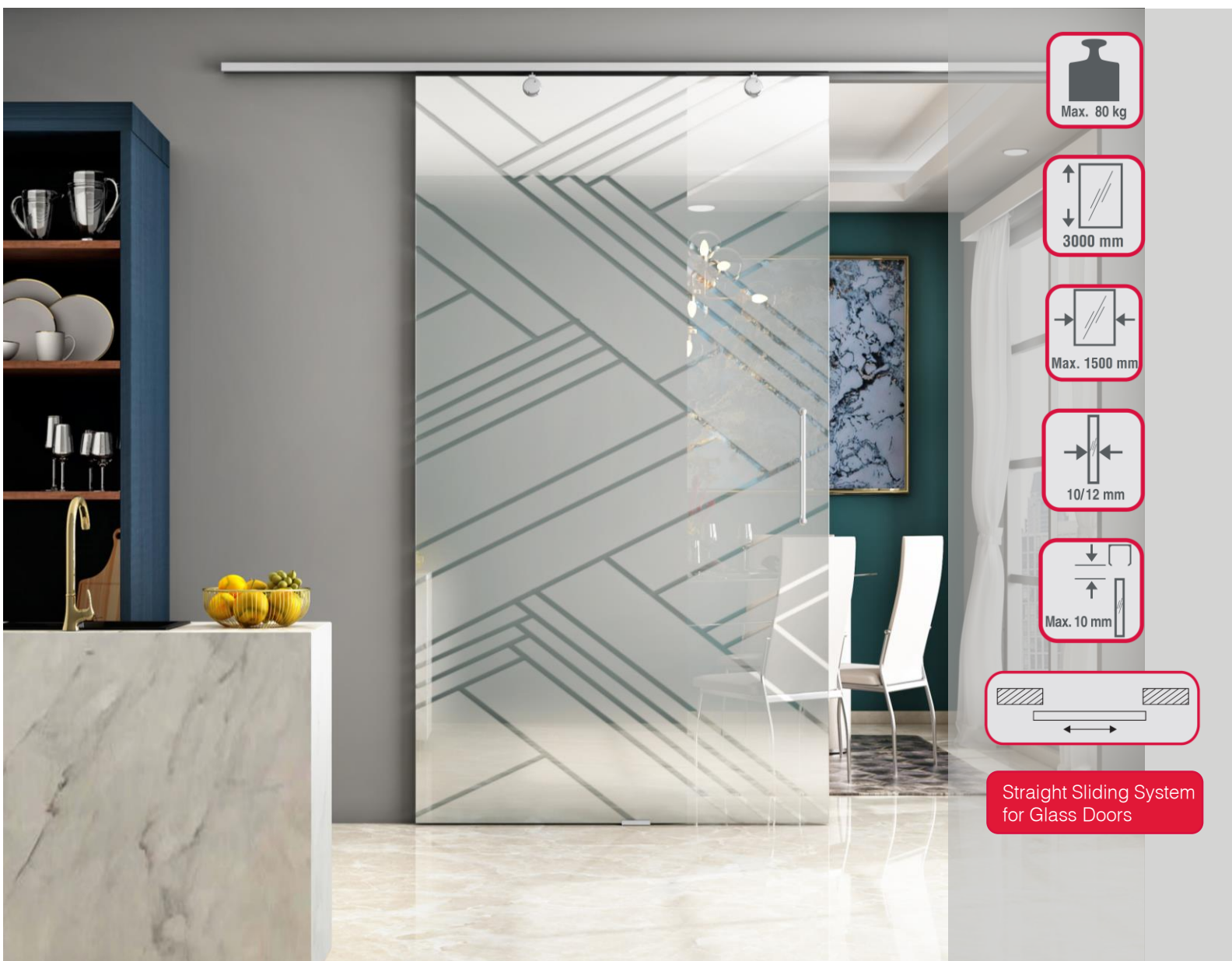

COMPONENTS

**941.10.037: DESIGN ERGO 80 SLIDING DOOR BOM KIT**

Consists of:

- 2 Rollers with Brackets
- 1 Bottom Guide
- 2 Ergo Glass Brackets [Note 4]
- 4 Seals
- 2 Adjustable Stoppers and Other fittings

ALUMINIUM ANODIZED TOP TRACK

409.50.602	2100 mm
941.27.432	3000 mm

Note 4: Ergo brackets are sleek and provide a sophisticated look to your sliding door and require fewer glass cut-outs

DESIGN ERGO 80

TECHNICAL SPECIFICATIONS

A: Door Height, H: Complete Opening Height

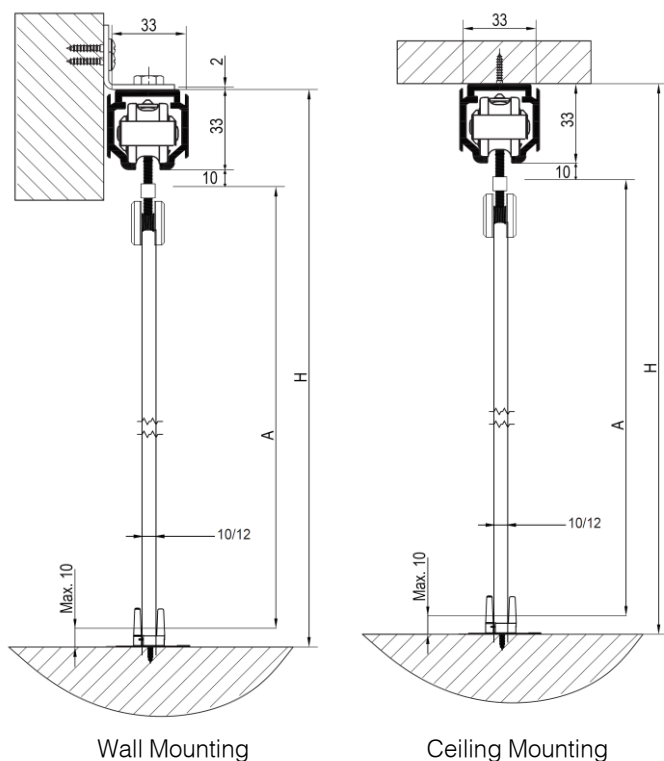

$$A = H - 53$$

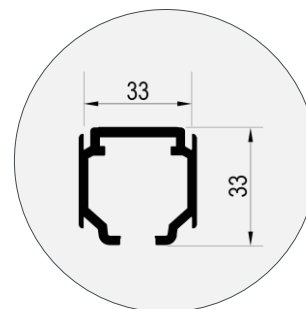

Top Track

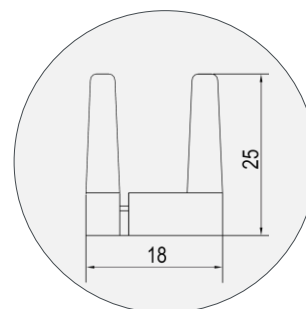

Bottom Guide

Note 1: For wall mounting application, you need to order the mounting bracket separately (940.66.060). Mounting Brackets can be installed at a distance of min. 200 mm to 350 mm from each other.



GLASS CUT-OUT DIMENSIONS

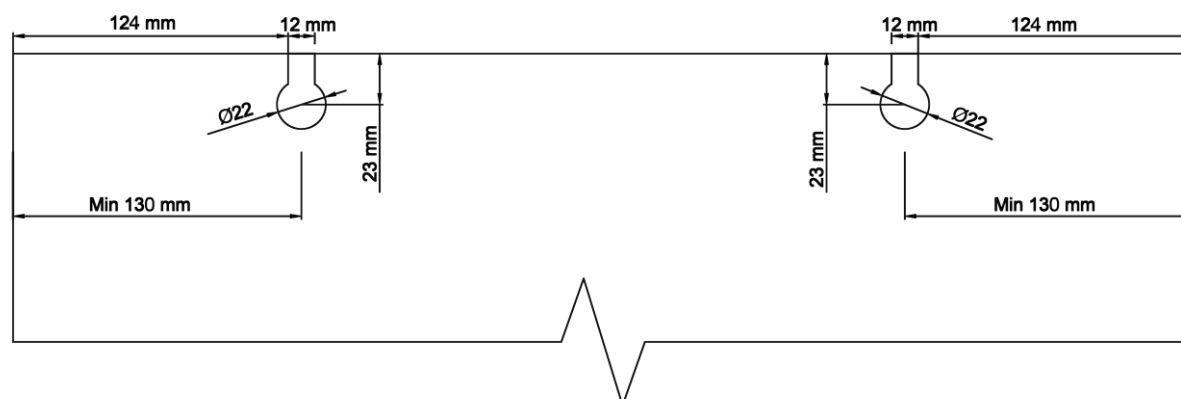

DESIGN ERGO 120

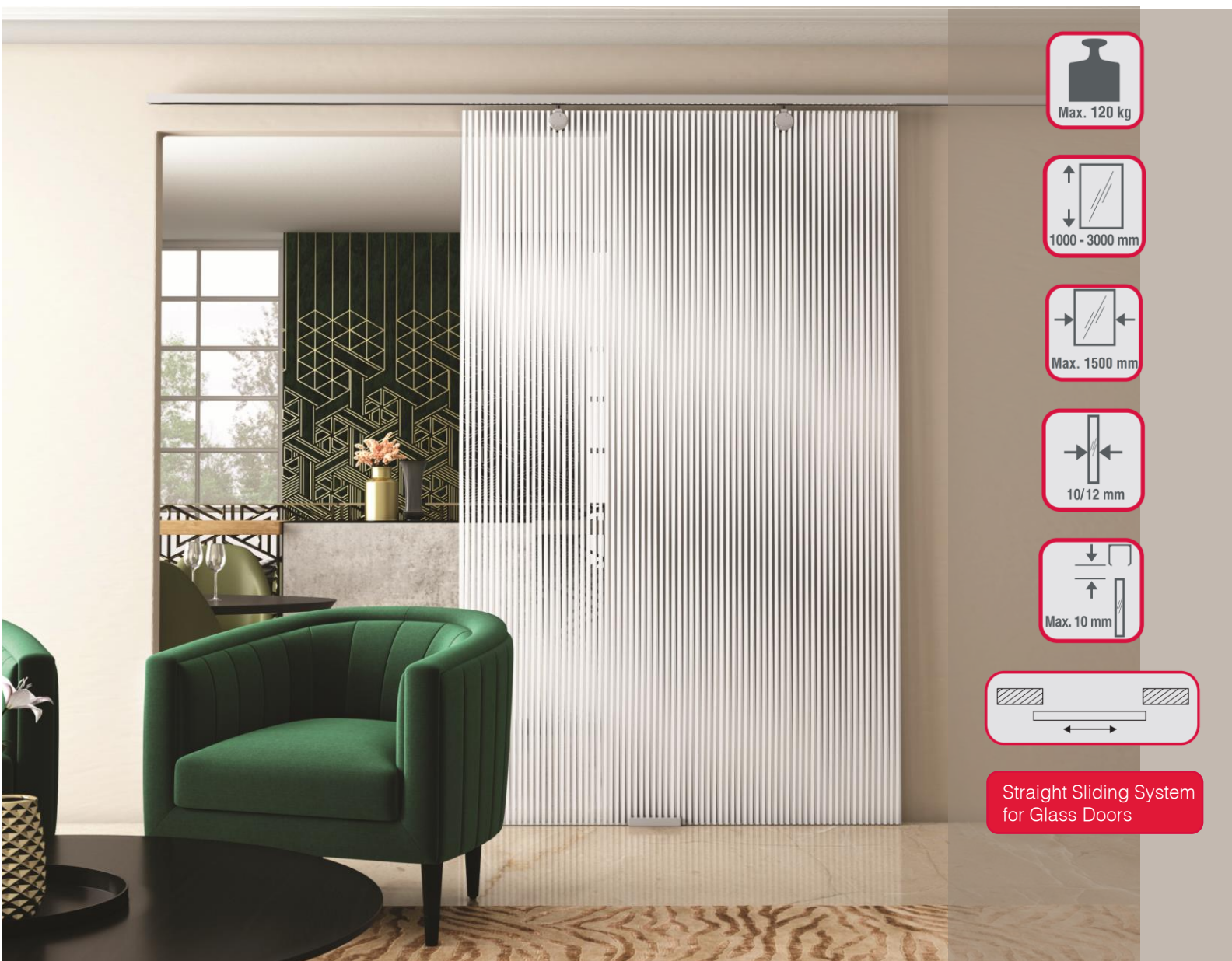

COMPONENTS

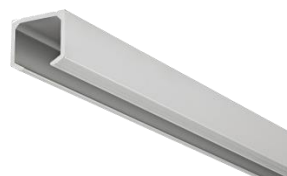
**941.10.038: DESIGN ERGO 120 SLIDING DOOR BOM KIT**

Consists of:

- 1 Double-sided Smuso with Roller
- 1 Roller
- 1 Bottom Guide
- 2 Ergo Glass Brackets ^[Note 4]
- 4 Seals
- 2 Adjustable Stoppers
- Fixing Accessories
- 1 Ergo Bracket

ALUMINIUM ANODIZED TOP TRACK

941.10.915	1524 mm	941.10.927	2743 mm
941.10.918	1828 mm	941.10.930	3048 mm
941.10.921	2134 mm	941.10.936	3657 mm
941.10.924	2438 mm		

Note 4: Ergo brackets are sleek and provide a sophisticated look to your sliding door and require fewer glass cut-outs

DESIGN ERGO 120

TECHNICAL SPECIFICATIONS

A: Door Height, H: Complete Opening Height

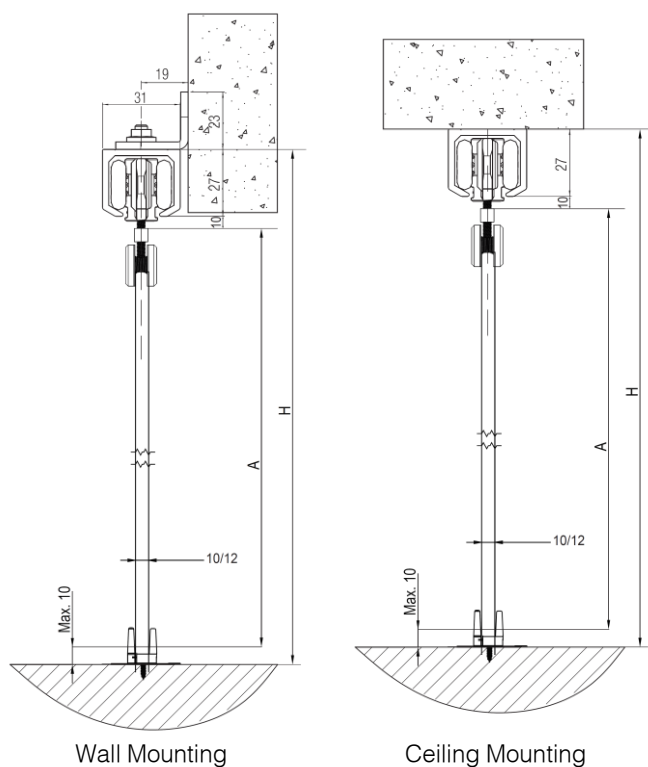

Wall Mounting

Ceiling Mounting

$$A = H - 47$$

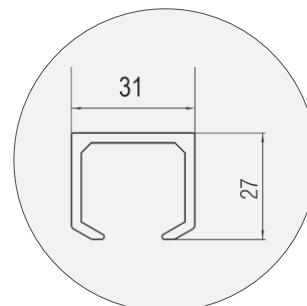

Top Track

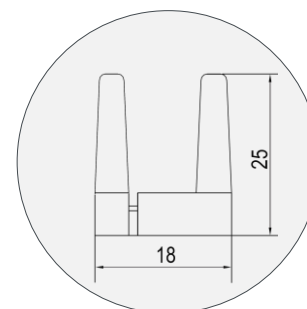

Bottom Guide

Note 1: For wall mounting application, you need to order the mounting bracket separately (940.66.060). Mounting Brackets can be installed at a distance of min. 200 mm to 350 mm from each other.



Note 6: Glass door cut-out dimensions for this system will be the same as Design Ergo 80. For more details on this, please refer to the section 'Glass Door Cut-out Dimensions' on page 18.

DESIGN ERGO 120 WITH DOUBLE-SIDED SMUSO



COMPONENTS

**941.10.042: DESIGN ERGO 120 WITH DOUBLE-SIDED SOFT CLOSE SLIDING DOOR BOM KIT**

Consists of:

- 1 Double-sided Smuso with Roller
- 1 Roller
- 1 Bottom Guide
- 2 Activators and Adjustable Stoppers
- 2 Ergo Glass Brackets [Note 4]
- 4 Seals
- Fixing Accessories

ALUMINIUM ANODIZED TOP TRACK FOR SMUSO

409.50.603	2000 mm
409.50.604	2400 mm
409.50.605	3000 mm
409.50.606	3600 mm

Note 4: Ergo brackets are sleek and provide a sophisticated look to your sliding door and require fewer glass cut-outs

DESIGN ERGO 120 WITH DOUBLE-SIDED SMUSO

TECHNICAL SPECIFICATIONS

A: Door Height, H: Complete Opening Height

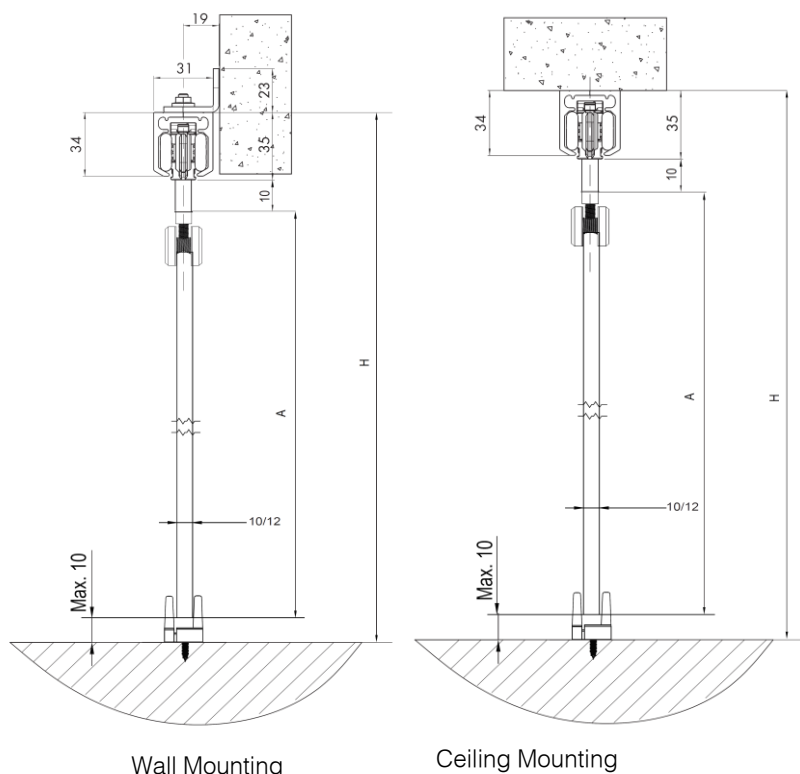

$$A = H - 55$$

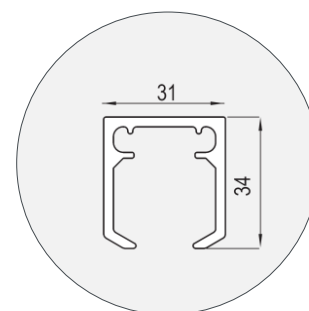

Top Track

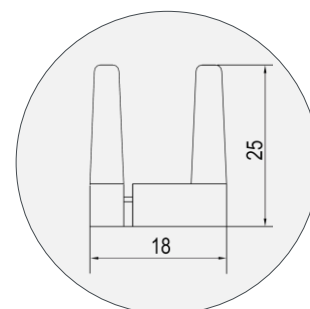

Bottom Guide

Note 1: For wall mounting application, you need to order the mounting bracket separately (940.66.060). Mounting Brackets can be installed at a distance of min 200 mm to 350 mm from each other.



Note 6: Glass door cut-out dimensions for this system will be the same as Design Ergo 80. For more details on this, please refer to the section 'Glass Door Cut-out Dimensions' on page 18.

DESIGN120 J

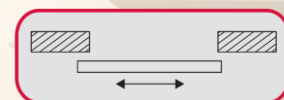
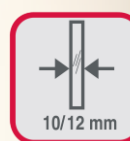

Straight Sliding System
for Glass Doors

COMPONENTS

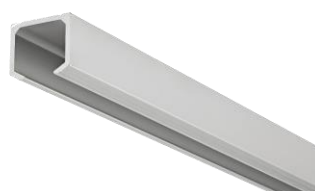

941.10.039: DESIGN 120 J SLIDING DOOR BOM KIT

Consists of:

- 2 Rollers
- 1 Bottom Guide
- 2 Standard Glass Brackets
- 2 Adjustable Stoppers
- Fixing Accessories

ALUMINIUM ANODIZED TOP TRACK

941.10.915	1524 mm	941.10.927	2743 mm
941.10.918	1828 mm	941.10.930	3048 mm
941.10.921	2134 mm	941.10.936	3657 mm
941.10.924	2438 mm		

DESIGN120 J

TECHNICAL SPECIFICATIONS

A: Door Height, H: Complete Opening Height, W: Door Width

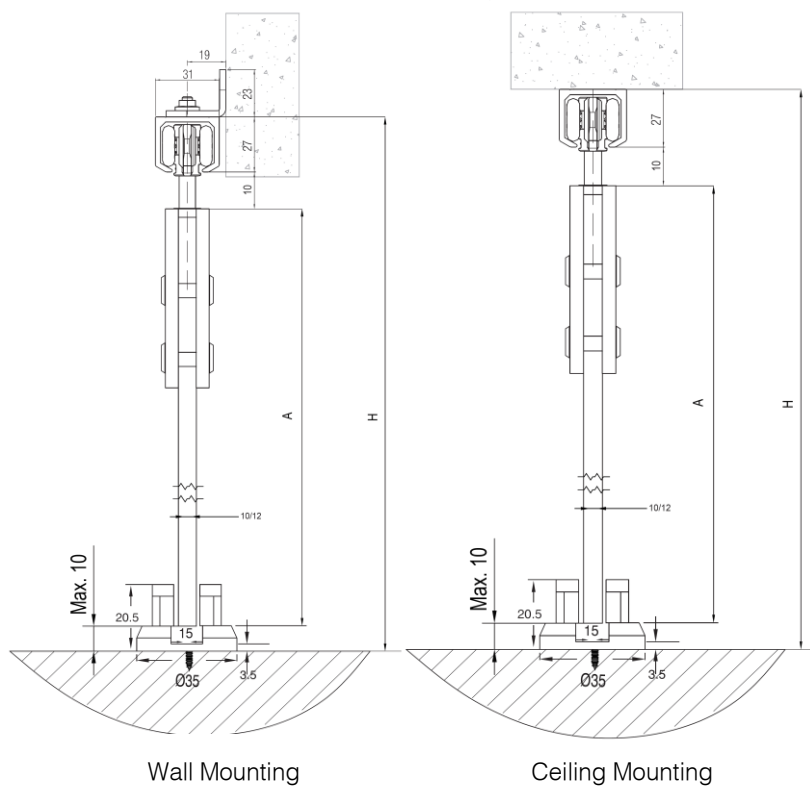

Wall Mounting

Ceiling Mounting

$$A = H - 47$$

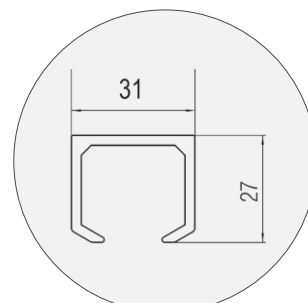

Top Track

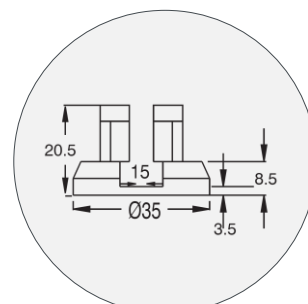

Bottom Guide

Note 1: For wall mounting application, you need to order the mounting bracket separately (940.66.060). Mounting Brackets can be installed at a distance of min. 200 mm to 350 mm from each other.

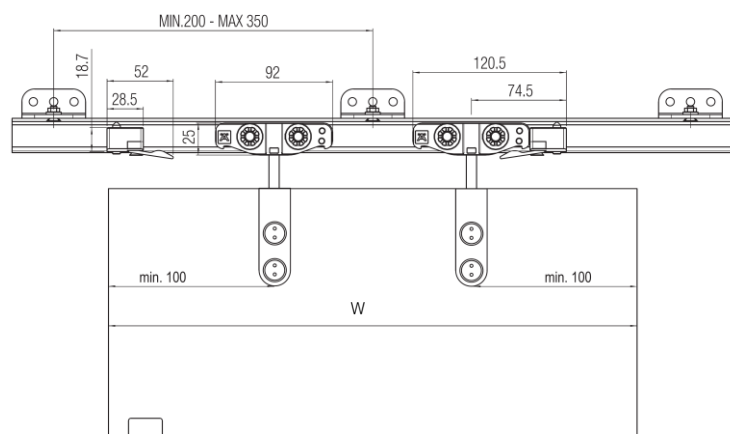

Elevation View

GLASS CUT-OUT DIMENSIONS

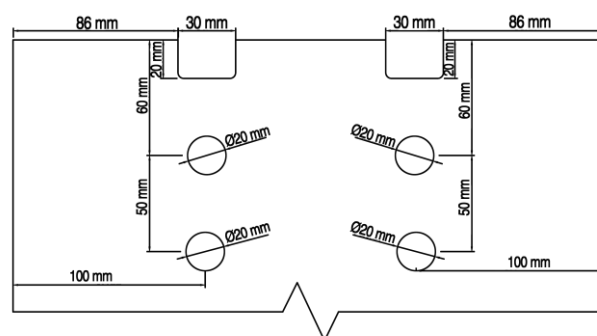

DESIGN120 J WITH DOUBLE-SIDED SMUSO

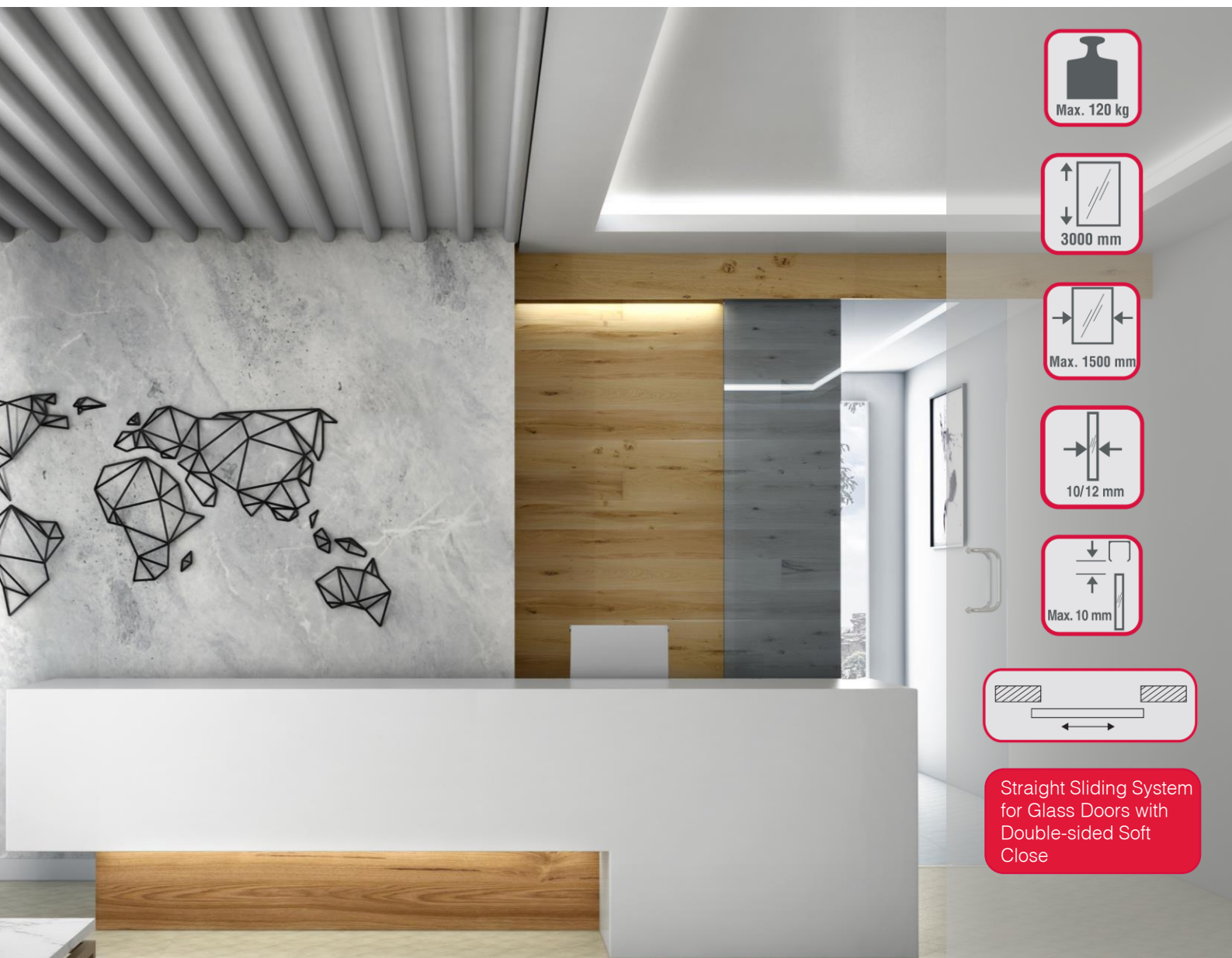

COMPONENTS

**941.10.043: DESIGN 120 J WITH DOUBLE-SIDED SOFT CLOSE SLIDING DOOR BOM KIT**

Consists of:

- 1 Two-way 120 kg Smuso with Rollers
- 1 Roller
- 2 Activators
- 2 Glass Standard Brackets
- 1 Bottom Guide
- 2 Adjustable Stoppers
- Fixing Accessories

ALUMINIUM ANODIZED TOP TRACK FOR SMUSO

409.50.603	2000 mm
409.50.604	2400 mm
409.50.605	3000 mm
409.50.606	3600 mm

DESIGN 120 J WITH DOUBLE-SIDED SMUSO

TECHNICAL SPECIFICATIONS

A: Door Height, H: Complete Opening Height, W: Door Width

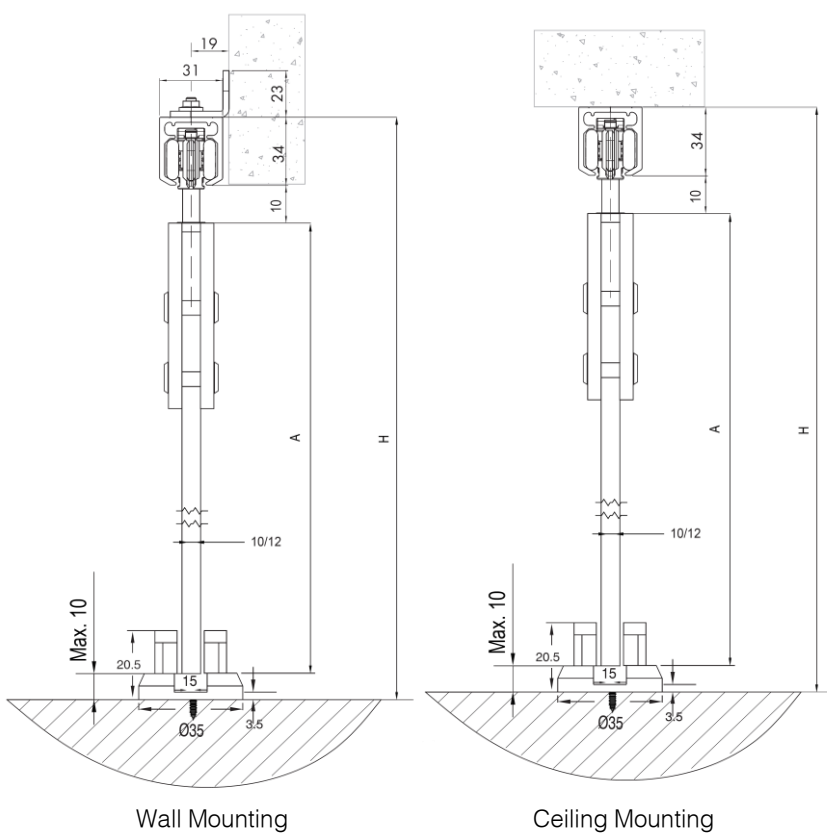

$$A = H - 54$$

Note 1: For wall mounting application, you need to order the mounting bracket separately (940.66.060). Mounting Brackets can be installed at a distance of min. 200 mm to 350 mm from each other.

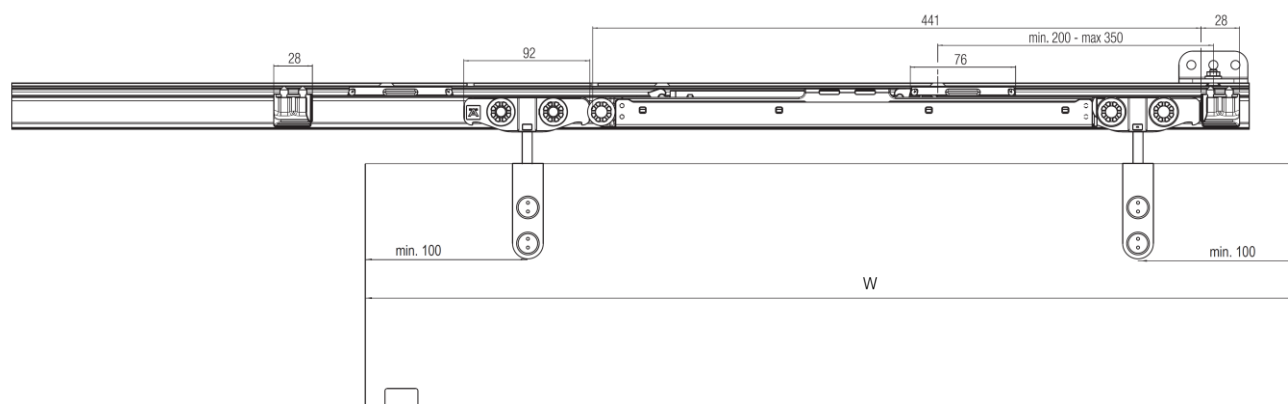

Elevation View

Note 7: Glass door cut-out dimensions for this system will be the same as Design 120 J. For more details on this, please refer to the section 'Glass Door Cut-out Dimensions' on page 24.

DESIGN120 SS

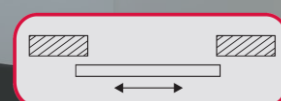

Straight Sliding System
for Glass Doors

COMPONENTS



941.10.040: DESIGN 120 SS SLIDING DOOR BOM KIT

Consists of:

- 2 Rollers
- 1 1280 mm Aluminium Profile and 2 Glass Grippers ^[Note 5]
- 2 Side Covers
- 1 Bottom Guide
- 2 Adjustable Stoppers
- Fixing Accessories

ALUMINIUM ANODIZED TOP TRACK

941.10.915	1524 mm	941.10.927	2743 mm
941.10.918	1828 mm	941.10.930	3048 mm
941.10.921	2134 mm	941.10.936	3657 mm
941.10.924	2438 mm		

Note 5: Glass grippers hold the glass in Design 120 SS instead of brackets. They can be adjusted for different glass thicknesses and come with separate aluminium profiles (1280 mm Aluminium profile) to cover them. Also, there is a safety pin to prevent the door from slipping with time.

DESIGN120 SS

TECHNICAL SPECIFICATIONS

A: Total Door Height (With Profile), H: Complete Opening Height, G: Glass Height, W: Door Width

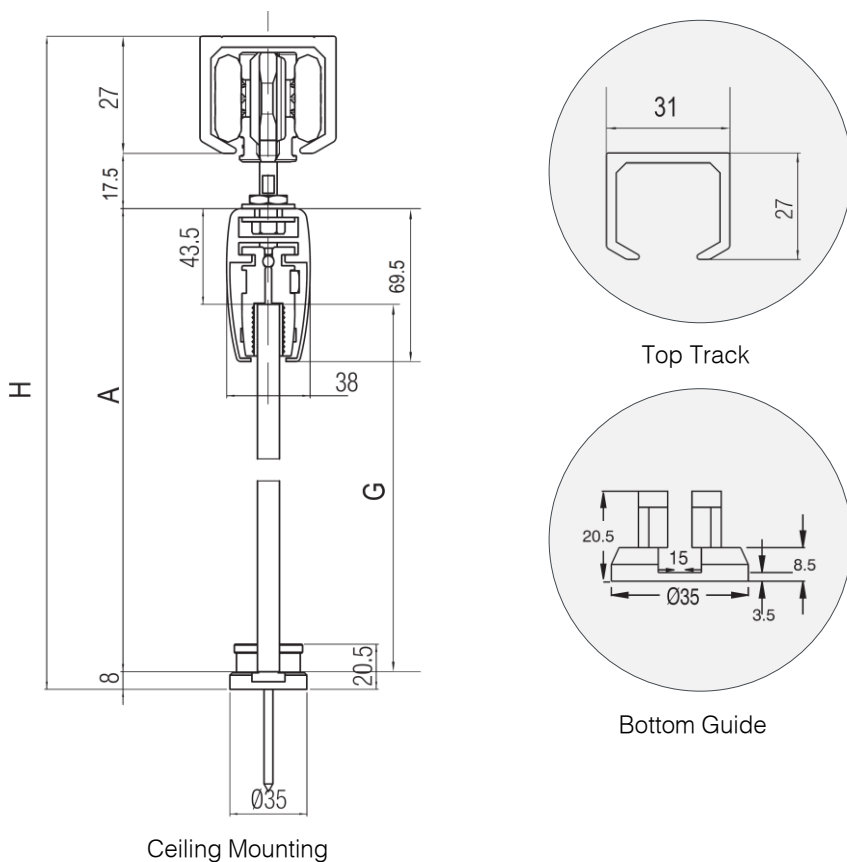

$$A = H - 52.5, G = A - 43.5$$

Note 1: For wall mounting application, you need to order the mounting bracket separately (940.66.060). Mounting Brackets can be installed at a distance of min. 200 mm to 350 mm from each other.

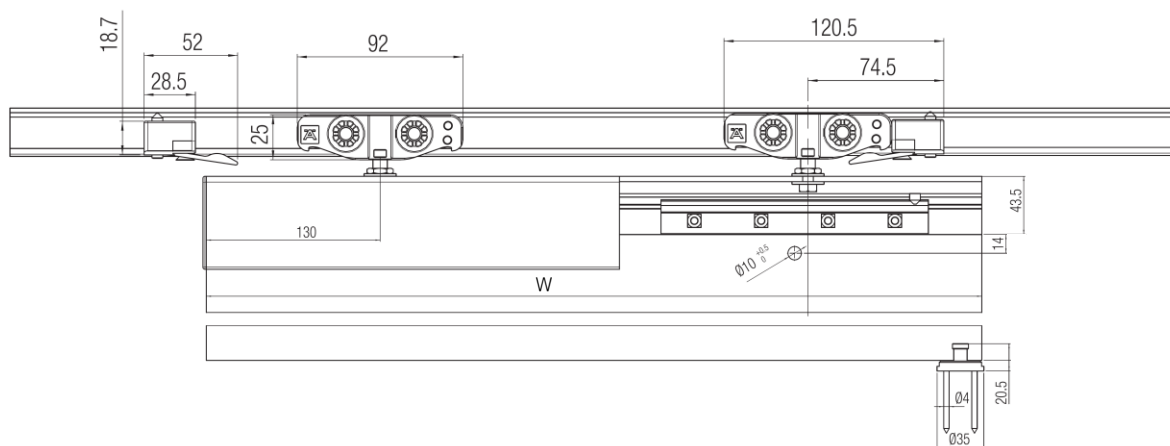

DESIGN120 SS WITH DOUBLE-SIDED SMUSO



COMPONENTS

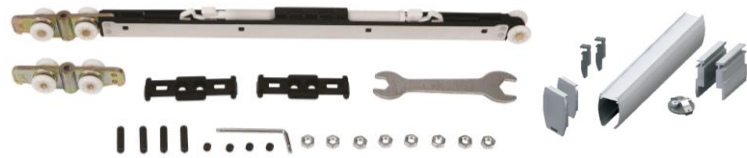

941.10.044: DESIGN 120 SS WITH DOUBLE-SIDED SOFT CLOSE SLIDING DOOR BOM KIT

Consists of:

- 1 Double-sided Smuso with Rollers
- 1 Roller
- 1 1280 mm Aluminium Profile and Glass Grippers [Note 5]
- 1 Bottom Guide
- 2 Side Covers
- 2 Fixing Clamps
- 2 Activators and Adjustable Stoppers
- Fixing Accessories



ALUMINIUM ANODIZED TOP TRACK FOR SMUSO

409.50.603	2000 mm
409.50.604	2400 mm
409.50.605	3000 mm
409.50.606	3600 mm

Note 5: Glass grippers hold the glass in Design 120 SS instead of brackets. They can be adjusted for different glass thicknesses and come with separate aluminium profiles (1280 mm Aluminium profile) to cover them. Also, there is a safety pin to prevent the door from slipping with time.

DESIGN120 SS WITH DOUBLE-SIDED SMUSO

TECHNICAL SPECIFICATIONS

A: Door Height, H: Complete Opening Height, W: Door Width

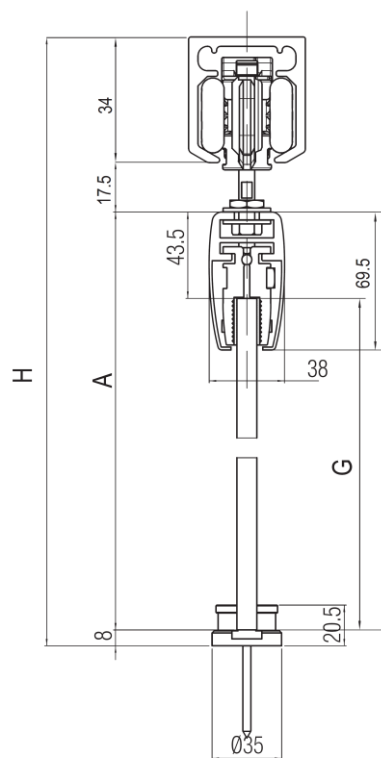

Ceiling Mounting

$$A = H - 59.5, G = A - 43.5$$

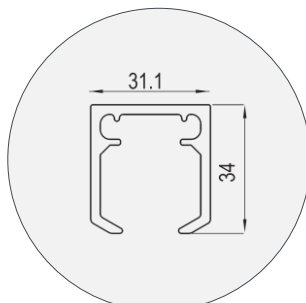

Top Track

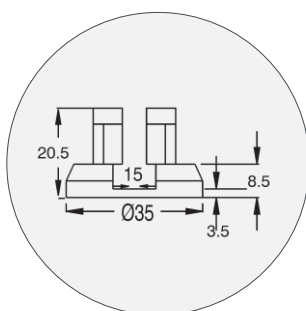

Bottom Guide

Note 1: For wall mounting application, you need to order the mounting bracket separately (940.66.060). Mounting Brackets can be installed at a distance of min 200 mm to 300 mm from each other.

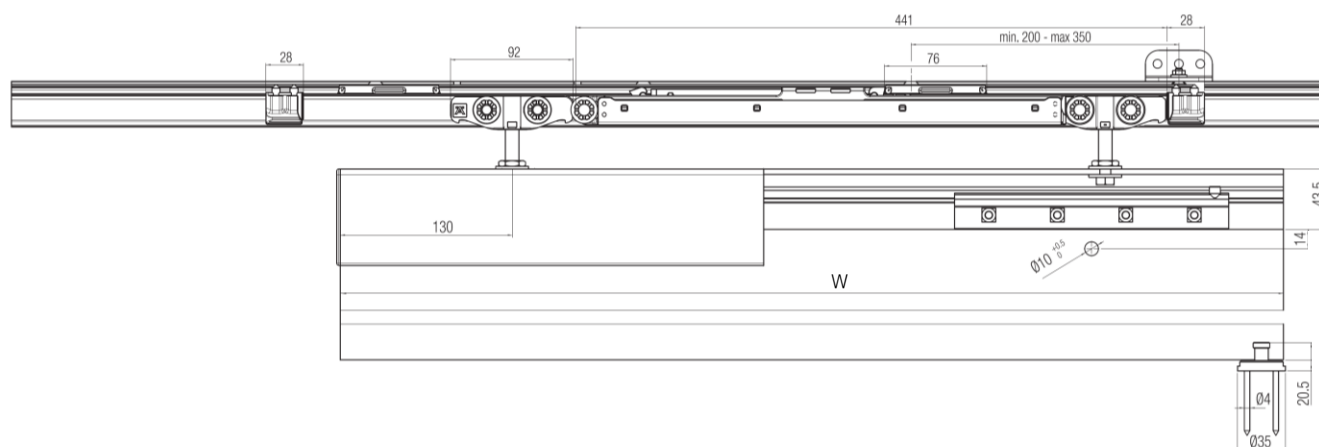

Elevation View

ORDERING INFORMATION

Article No	Description	UOM	QTY	MRP (INR)	
SLIDING DOOR KITS					
Wooden Sliding Door Kits					
941.10.027	Classic 120 W	Set	1	4,451/-	
941.10.028	Classic 120 W with Double-sided Smuso	Set	1	12,076/-	
941.10.026	Classic 60 W with Double-sided Smuso	Set	1	9,127/-	
941.10.029	Classic 120 XL	Set	1	11,246/-	
941.10.030	Classic 120 XL with Double-sided Smuso	Set	1	22,427/-	
941.10.036	Classic 120 F	Set	1	6,446/-	
941.10.035	Classic 120 S	Set	1	24,645/-	
Glass Sliding Door Kits					
941.10.037	Design Ergo 80	Set	1	5,317/-	
941.10.038	Design Ergo 120	Set	1	6,777/-	
941.10.042	Design Ergo 120 with Double-sided Smuso	Set	1	12,456/-	
941.10.039	Design 120 J	Set	1	3,203/-	
941.10.043	Design 120 J with Double-sided Smuso	Set	1	11,246/-	
941.10.040	Design 120 SS	Set	1	27,738/-	
941.10.044	Design 120 SS with Double-sided Smuso	Set	1	33,417/-	
Accessories					
940.66.060	Mounting Bracket	PC	1	352/-	
TOP TRACKS					
941.10.915	For Classic 120 W, 120 XL, 120 S, 120 F and Design 120 J, Ergo 120, 120 SS	1524 mm	PC	1	935/-
941.10.918		1828 mm	PC	1	1,523/-
941.10.921		2134 mm	PC	1	1,729/-
941.10.924		2438 mm	PC	1	1,963/-
941.10.927		2743 mm	PC	1	2,213/-
941.10.930		3048 mm	PC	1	2,262/-
941.10.936		3657 mm	PC	1	2,335/-
409.50.602	For Design Ergo 80	2100 mm	PC	1	1,585/-
941.27.432		3000 mm	PC	1	2,072/-
Top Tracks for Sliding Systems with Smuso					
409.50.603	For Soft Closing Systems of Classic 120 W, 60 W, 120 XL and Design 120 J, Ergo 120, 120 SS	2000 mm	PC	1	2,916/-
409.50.604		2400 mm	PC	1	3,242/-
409.50.605		3000 mm	PC	1	3,394/-
409.50.606		3600 mm	PC	1	3,728/-
INDIVIDUAL COMPONENTS **					
941.10.101	Ergo Glass Brackets Set (For Design Ergo 80, Design Ergo 120, Design Ergo 120 with Double-sided Smuso) Consists of: 2 Ergo Brackets 1 Bottom Guide 4 Seals and Fixing accessories	Set	1	2,020/-	
941.10.020	Standard Glass Brackets Set (For Design 120 J, Design 120 J with Double-sided Smuso) Consists of: 2 Standard Glass Brackets 1 Bottom Guide Fixing Accessories	Set	1	9,073/-	
941.10.009	Slimline Fitting Set (For Design 120 SS, Design120 SS with Double-sided Smuso) Consists of: 1 Aluminium Profile and 2 Side Cover Caps 2 Glass Grippers 1 Bottom Guide Fixing Accessories	Set	1	22,981/-	

** These article numbers are already a part of their respective sliding system BOM kits.



Häfele India Private Limited

Office No. 3, Building "A", BETA, I Think
Techno Campus, Off J.V.L.R, Opp.
Kanjurmarg East, Mumbai – 400 042.
Phone: 022 6142 6100 | **Fax:** 022 6702 0531.

New Delhi | Kolkata | Cochin | Chennai |
Hyderabad | Bangalore | Mumbai | Pune |
Ahmedabad | Srilanka | Bangladesh | Nepal |
Bhutan | Maldives

Toll Free Customer Care No.: 1800 266 6667
Customer Care WhatsApp No.: +91 9769111122
SMS HAFELE to 56070
info@hafeleindia.com
customercare@hafeleindia.com

