

How to start TPO
**TOEFL Practice
Online Manual**

Welcome to TPO !

iBT TOEFL® Practice Online Manual

Table of Contents

1. What are in the tests? _____	2
2. What you should know before taking TPO _____	4
3. Preparation _____	5
4. How to start the test? _____	7
5. What you see on a screen during the test _____	16
6. Frequently Asked Questions _____	21

1. What are in the tests?

Section	TPO	TOEFL iBT Test
Reading	<p>3 passages with 60 minutes</p> <p>Passage 1 12 ~ 14 questions Passage 2 12 ~ 14 questions Passage 3 12 ~ 14 questions</p>	<p>3 passages with 60 minutes or 4 passages with 80 minutes</p> <p>Passage 1 12 ~ 14 questions Passage 2 12 ~ 14 questions Passage 3 12 ~ 14 questions (Passage 4 12 ~ 14 questions)</p>
Listening	<p>Part 1 & 2 with 60 minutes</p> <p>< Part 1 > Conversations 5 questions Lecture 6 questions Lecture 6 questions</p> <p>< Part 2 > Conversations 5 questions Lecture 6 questions Lecture 6 questions</p>	<p>Part 1 & 2 when Reading is 4 passages with 80min or Part 1, 2 & 3 when Reading is 3 passages with 60min</p> <p>< Part 1 > Conversations 5 questions Lecture 6 questions Lecture 6 questions</p> <p>< Part 2 > Conversations 5 questions Lecture 6 questions Lecture 6 questions</p> <p>< Part 3 > Conversations 5 questions Lecture 6 questions Lecture 6 questions</p>
Break	Not mandatory	10 minutes (Mandatory)

Section	TPO	TOEFL iBT Test
Speaking	<p>Scored by <i>SpeechRater SM</i>, an automated scoring system 6 questions with 20 minutes (Section as a whole is not timed with 6 questions)</p> <p>Independent Task 2 questions Express an opinion on a familiar topic</p> <p>Integrated Task 4 questions Speak based on reading and listening tasks</p>	<p>Scored by Human Raters Number of questions and the test format are the same as TPO</p> <p>The differences in functions ▼ While you can replay and record your speaking answers multiple times in the Complete Practice Test, you may answer only once for each question in the real TOEFL iBT Test.</p>
Writing	<p>Scored by <i>e-rater®</i>, automated scoring technology 2 questions with 50 minutes</p> <p>Integrated Task (20 minutes) Writing based on Reading and Listening</p> <p>Independent Task (30minutes) Writing based on Knowledge and Experience</p>	<p>Scored by Human Raters with <i>e-rater®</i> Number of questions and the test format are the same as TPO</p>

2. What you should know before taking TPO?

1

Once a TPO has been completed, **it cannot be retaken**.
You can review your completed test for **30 days** after completing it.

2

You may not browse through the test before you start. You must take the test in order of Reading, Listening, Speaking and Writing section just like the real TOEFL iBT Test.

3

The Speaking and Writing sections of the TPO are scored by automated scoring programs SpeechRater/e-rater software, while the real TOEFL iBT Test will have those sections scored by evaluating some, but not all, evaluated by human raters.
The score you receive on the practice materials may not be the same as what you would receive on the TOEFL iBT Test.

4

In order to take TPO, an installation of the Test Browser is necessary. You can check and prepare through Site Capacity Check and **Check system on NEXT Page**

3.

Preparation

ABOUT THIS GUIDE

This guide will give you information about how to use ETS TOEFL Practice Online. If you have questions that are not answered in this guide, please contact ETS TOEFL Practice Online Technical Support at toefl@chosun.com

Check this
Before
test registration
< System >

IMPORTANT

TOEFL Practice Online

OS : You must use '**Windows**'

Browser : You must use '**Internet Explorer**'

* The test can only be run in a Windows PC environment.

* This Mock Test does not run on Android, iOS, Mac, Parallels desktop, Mac boot camp, tablet and other operating systems.

JAVA : You must have java installed on your computer
(can be downloaded at java.com, see next slide)

Preparation

Before Test Registration

Go to this website to download Java (Java.com)

Check this
Before
test registration
< Java >

IMPORTANT INFORMATION REGARDING THE SECURITY OF JAVA SE

Java™ Download Help

Search

JAVA + YOU,
DOWNLOAD
TODAY!

Free Java Download

» What is Java? » Do I have Java? » Need Help? » Uninstall

About Java

Go Java Alice Greenfoot JavaOne ORACLE ACADEMY Java Magazine

go.java Java + Alice Java + Greenfoot Java Developer Conference Oracle Academy Java Magazine

Select Language | About Java | Support | Developers | Feedback
Privacy | Cookie Preferences | Terms of Use | Trademarks | Disclaimer

ORACLE

Download the latest version of Java.

4.

HOW to START TEST

Step 1
Go to this site.
(etest.chosun.com)

Step 2
Sign In or Register
(Click the Black box)

ETS 공식 토플모의고사 즐겨찾기 추가

처음으로 | 회원가입 | 로그인 | 쿠폰/코드 등록



ETS 소개

TOEFL iBT

토플모의고사

S&W 첨삭

TOPC

커뮤니티

QUICK

- 마이페이지
- 구입하기
- 시험센터
- 이용방법

ETS토플모의고사 구입하기

영역	지문수	문항수	Topic
읽기	3	42	The Origin of Writing 외 2개
듣기	6	34	Music House 외 5개
말하기	통합형-4 독립형-2	6	Benefit of Using Internet 외 5개
쓰기	통합형-1 독립형-1	2	Electronic Medical Records 외 1개

구입하기

아이디

비밀번호

로그인

회원가입 | ID/ 찾기 | ID저장

Sign In or Register

정규토플 D - 2

점수 바로가기

ETS 공식 토플시험장

ETS TOEFL

정기방문

만점 STRATEGY 단독공개

도플시험일정

2017 2월

S	M	T	W	T	F	S
			1	2	3	4
5	6	7	8	9	10	11
12	13	14	15	16	17	18

공지 사항

- [광화문센터] 03월 '토플시험장 방문모의고사' 일정 안내
- 02월 19일(일) ~ 20일(월), 서버 점검에 따른 채점서버...
- [공지] ETS 공식 토플모의고사 새로운 볼륨46 출시!
- 설 연휴 고객센터 및 S&W첨삭 휴무 안내
- [이벤트공지] 모의고사 2개사면 할인받고 커피받게! 이벤트

도플 후기

- 광화문 토플센터 정규시험 살짝 후기
- 계 공부됩니다.
- 드디어 졸업합니다..ㅠㅠ
- 모두 힘내시라고 계 비루한 정규시험 점수 공유해요.
- 실제 시험과 똑같네요. 모의시험



ETS 소개 TOEFL iBT 토플모의고사 S&W 검색 TOPC 커뮤니티

QUICK



마이페이지



구입하기



시험센터



이용방법

회원확인

대한민국 토플의 중심 ETS토플모의고사에 오신것을 환영합니다.

HOME > 회원확인

일반회원

가입하기

For foreigners

Join members

개인정보취급방침 | 이용약관 | 찾아오시는길



사업자등록번호: 104-81-37808 / 서울특별시 중구 세종대로21길 52 조선일보 광화문빌딩 6층
(주)디지털조선일보 / 대표이사 김찬 / 고객센터 Tel. 02-3701-2000 E-mail. TOEFL@chosun.com



ETS, the ETS Logo and "TOEFL" are registered trademarks of Educational Testing Service, Princeton, New Jersey, U.S.A. used under license.
ETS, ETS 로고 및 "TOEFL"은 미국교육평가원(Educational Testing Service, 미국 뉴저지주 프린스턴)의 등록된 상표로서 승인 하에 사용됩니다.

HOW to START TEST

Step 1

Click "For foreigners"
(Click the Black box)

HOW to START TEST

Step 1
Fill out the form and click 'Create your Account'

QUICK

마이페이지

구입하기

시험센터

이용방법

토플모의고사 시험센터 소개

대한민국 토플의 중심 ETS토플에 오시기를 환영합니다.

terms and conditions

■ 이용약관

[제 1 장 총칙]

제 1 조 (목적)
이 약관은 디지털조선일보(이하 "회사"라 합니다)가 제공하는 인터넷 관련 제반 서비스(이하 "서비스"라 한다)를 이용함에 있어 회사와 이용자와의 권리, 의무 및 책임 사항, 기타 필요한 사항을 규정하는데 목적이 있습니다.

제 2 조 (약관의 명시, 효력 및 개정)
① 이 약관의 내용은 "회원"이 쉽게 알 수 있도록 서비스 화면에 게시합니다.
② 회사는 필요하다고 인정되는 경우 본 약관을 변경할 수 있으며, 회사가 약관을 변경할 경우에는 적용일자 및 변경사유를 명시하여 제 1항과 같은 방법으로 그 적용일자 30일 전일까지 공지

I do not accept the User Agreement I accept the User Agreement

■ 개인정보 취급방침

디지털조선일보(이하 "회사"라 합니다)가 운영하는 모든 인터넷 서비스 사이트들은 통신비밀보호법, 정보통신망 이용촉진 및 정보보호 등에 관한 법률 등 정보통신서비스 제공자가 준수하여야 할 관련 법령상의 개인정보보호 규정을 준수하며, 관련 법령에 의거한 개인정보취급방침을 정하여 이용자 권익 보호에 최선을 다하고 있습니다.

1. 수집하는 개인정보의 항목과 수집방법

1) 수집하는 개인정보의 항목
① 회사는 회원가입, 원활한 고객상담, 각종 서비스의 제공을 위해 최초 회원 가입 당시 아래와 같은 개인정보를 수집하고 있습니다.

I do not accept the Privacy Policy I accept the Privacy Policy

HOME > 토플모의고사 > 시험센터

ID

Password

Re-type Password

Full Name

E-mail

You must include numbers and special characters or symbols in your password.

HOW to START TEST

Step 1

Log in
(Enter ID and password and click the blue button)

* If you have an existing ID that you don't remember, please contact the service center.



ETS 소개

TOEFL iBT

토플모의고사

S&W 첨삭

TOPC

커뮤니티

QUICK

- 마이페이지
- 구입하기
- 시험센터
- 이용방법

ETS토플모의고사 구입하기

S&W 첨삭 구입하기

TOPC 구입하기

영역	지문수	문항수	Topic
읽기	3	42	The Origin of Writing 외 2개
듣기	6	34	Music House 외 5개
말하기	통합형-4 독립형-2	6	Benefit of Using Internet 외 5개
쓰기	통합형-1 독립형-1	2	Electronic Medical Records 외 1개

구입하기

로그인

Log In

정규토플 D - 2

점수 바로 보기

공지 사항 more

- [광화문센터] 03월 "토플시험장 방문모의고사" 일정 안내
- 02월 19일(일) ~ 20일(월), 서버 점검에 따른 채점서버...
- [공지] ETS 공식 토플모의고사 새로운 볼륨46 출시!
- 설 연휴 고객센터 및 S&W 첨삭 휴무 안내
- [이벤트공지] 모의고사 2개사면 할인받고 커피받게! 이벤트

토플 후기 more

- 광화문 토플센터 정규시험 살짝 후기
- 제 공부법입니다.
- 드디어 졸업합니다..ㅠㅠ
- 모두 힘내시라고 제 비루한 정규시험 점수 공유해요.
- 실제 시험과 똑같네요. 모의시험

토플시험 일정 전체 보기

		S	M	T	W	T	F	S
2017				1	2	3	4	
2월		5	6	7	8	9	10	11
		12	13	14	15	16	17	18

ETS TOEFL

만점 STRATEGY 단독공개

HOW to START TEST

Step 1
Click the Value pack Registration banner

* You can find the banner at the bottom of the page (right)
Click this banner

QUICK

- 마이페이지
- 구입하기
- 시험센터
- 이용방법

쓰기	통합월-1 독립월-1	2	Electronic Medical Records 의 1개
----	----------------	---	---------------------------------

공지 사항 more

- [광화문센터] 03월 "토플시험장 방문모의고사" 일정 안내
- 02월 19일(일) ~ 20일(월), 서버 점검에 따른 채점서버...
- [공지] ETS공식 토플모의고사 새로운 볼륨46 출시!
- 설 연휴 고객센터 및 S&W철차 휴무 안내
- [이벤트공지] 모의고사 2개사면 할인받고 커피받게! 이벤트

토플 후기 more

- 광화문 토플센터 정규시험 살짝 후기
- 제 공부팁입니다.
- 드디어 졸업합니다...ㅠㅠ
- 모두 힘내시라고 제 비루한 정규시험 점수 공유해요.
- 실제 시험과 똑같네요. 모의시험

토플 Q&A more

- 문의드립니다
- [RE] 문의드립니다
- 모의고사 다운로드...
- [RE] 모의고사 다운로드...
- 문의드립니다

토플 Tips more

- [1주일에 리딩 한 개] 50. The Media Influence Theory
- [RC 고득점으로 가는 길] 역할 파악 문제
- [1주일에 리딩 한 개] 49. Emergence
- [RC고득점으로 가는 길]: 문장 재구성 문제 풀이
- [1주일에 리딩 한 개] 48. The History of Cartography

토플 지수

· 평균점수 **80.6** (▼-1.50) · Monthly Best Performer

구분	전일	전주	전월	1	2	3
최고점수	115	117	119	송경호	117점	
				조은아	115점	
				옥경원	115점	

토플모의고사 고객센터

☎ 정일

운영시간 : 09시30분 ~ 18시30분

점심시간 : 12시 ~ 13시 ETS 토플모의고사 관련 정보 /
기술지원 및 원격지원 상담 제공

전화번호 : 02-3701-2000 - 주말 및 공휴일은 휴무입니다.

정규토플 시험 접수

시험 접수 / 취소 문의 (무료전화)
00-7981-4203-0248

성적표 문의 (무료전화)
00-308-13-2544

문의 시간 AM 9:00 ~ PM 6:00

원격지원서비스

ETS 공식시험장

ETS TOEFL

정기방문 토플모의고사
시험을 구입하고,
지금 바로 점수하세요!

접수 바로가기

ETS TOEFL

만점 STRATEGY 단독공개

EK
Eason Kim
이케이아카데미

CLICK HERE

↑ Value pack 등록방법

How to Register Value pack

개인정보취급방침 | 이용약관 | 찾아오시는길



사업자등록번호 104-81-37808 / 서울특별시 중구 세종대로21길 52 조선일보 광화문빌딩 6층
(주)디지털조선일보 / 대표이사 김찬 / 고객센터 Tel. 02-3701-2000 E-mail. TOEFL@chosun.com



ETS, the ETS Logo and "TOEFL" are registered trademarks of Educational Testing Service, Princeton, New Jersey, U.S.A., used under license.
ETS, ETS 로고 및 "TOEFL"은 미국교육평가원(Educational Testing Service, 미국 뉴저지주 프린스턴)의 등록된 상표로서 승인 하에 사용됩니다.

HOW to START TEST

Step 1
Enter your authorization code in the space provided and click the blue button.

ETS 공식 토플모의고사 즐겨찾기 추가

ETS 소개 TOEFL iBT 토플모의고사

밸류팩 등록

▶ **Value pack registration**

- Instructions

- ① Sign up
- ② Log in
- ③ Enter the authorization code received from ETS below.
- ④ Click the Register button **등록**
- ⑤ Take the registered test.
Go to My Page (마이 페이지)
 - ▷ Test Status (응시현황)

▶ **Warning**

1. Once the code is registered successfully, you will automatically be redirected to the appropriate page, and if the code is not entered properly, a pop-up will advise you to enter your code correctly.

밸류팩 등록하기

- 순서

1. 회원가입을 한다.
2. 로그인을 한다.
3. 아래 빈칸에 ETS로부터 받은 authorization code를 입력한다.
4. '등록' 버튼을 누른다.
5. 마이페이지 -> 응시현황에서 등록된 시험을 응시한다.

- 주의사항

1. 코드등록이 정상적으로 등록되면 마이페이지로 자동 이동하며, 코드등록이 정상적으로 입력이 되지 않았을 경우, 코드를 정확히 입력하라는 팝업창이 뜹니다.

- authorization code 등록

등록

Register Authorization Code

HOW to START TEST

Step 1
Click 'My Page'

시험센터에 직접 가서 시험보자!

토플시험장의 느낌 그대로!
토플 실전감각 직접 경험해보세요.

자세히 보기 GO

QUICK

- 마이페이지
- 구입하기
- 시험센터
- 이용방법

ETS토플모의고사 구입하기

영역	지문수	문항수	Topic
읽기	3	42	The Origin of Writing 외 2개
듣기	6	34	Music House 외 5개
말하기	통할형-4 독립형-2	6	Benefit of Using Internet 외 5개
쓰기	통할형-1 독립형-1	2	Electronic Medical Records 외 1개

S&W 첨삭 구입하기

TOPC 구입하기

공지 사항 [more](#)

- [광화문센터] 03월 "토플시험장 방문모의고사" 일정 안내
- 02월 19일(일) ~ 20일(월), 서버 점검에 따른 체험서버...
- [공지] ETS 공식 토플모의고사 새로운 볼륨46 출시!
- 설 연휴 고객센터 및 S&W첨삭 휴무 안내
- [이벤트공지] 모의고사 2개사며 할인받고 커피받게! 이벤트

토플 후기 [more](#)

- 광화문 토플센터 정규시험 살짝 후기
- 제 공부팁입니다.
- 드디어 졸업합니다...ㅠㅠ
- 모두 힘내시라고 제 비루한 정규시험 점수 공유해요.
- 실제 시험과 똑같네요. 모의시험

토플도우미_m님

로그아웃

마이페이지

장바구니

구입하기

My Page

토플시험 일정

전체보기

	S	M	T	W	T	F	S
2017			1	2	3	4	
2월	5	6	7	8	9	10	11
	12	13	14	15	16	17	18
	19	20	21	22	23	24	25
시험일	26	27	28				

HOW to START TEST

Step 1
Click "Test Status" as shown below.

QUICK

- 마이페이지
- 마이페이지
- 응시현황**
- 구입하기
- 1:1 문의내역
- 시험센터
- 이용방법

구입내역

대한민국 토플의 중심 ETS토플모의고사에 오신것을 환영합니다.

Test status

HOME > 마이페이지 > 구입내역

전체구입내역
토플모의고사
TOPC
S&W 참사

토플도우미_m 고객님,
토플모의고사 복수구입 할인혜택을 이용하세요!

- 토플모의고사 반복구입 혜택: 첫 구입 후 2개월 이내에 재구입 시 최대 15% 할인
- 토플모의고사 복수구입 혜택: 한번에 2개 이상 구입 시 최대 15% 할인

최종 구입일 : 2016-11-03
할인 만료일 : 2017-01-03
할인유효기간 : 만료

▶ 전체 구입내역 - ETS토플모의고사는 '응시현황' 페이지에서 응시할 수 있습니다. ▶ '응시현황'으로 이동하기

TEST	수량	구매일	결제일	결제수단	금액	결제여부
TOEFL iBT Complete Practice Test Volume 47	1	2017.02.16	2017.02.16	무상제공	0	결제완료
TOEFL iBT Half Practice Test Volume 49 (R/L) Timed	1	2017.02.13	2017.02.13	무상제공	0	결제완료
TOEFL iBT Half Practice Test Volume 48 (R/L) Timed	1	2017.02.13	2017.02.13	무상제공	0	결제완료
TOEFL iBT Complete Practice Test Volume 46	1	2017.02.06	2017.02.06	무상제공	0	결제완료
TOEFL iBT Complete Practice Test volume 44 (Timed)	1	2017.02.02	2017.02.02	무상제공	0	결제완료

1 2 3 4 5 6

HOW to START TEST

Step 1
Click "OK" as shown below.

* A message appears on the screen that describes the error and how to correct it.

ETS 공식 토크모의고사 즐겨찾기 추가 | 토크도우미_m 님 | 처음으로 | 마이페이지 | 장바구니 | 정보수정 | 로그아웃 | 쿠폰/코드 등록

ETS TOEFL
대한민국 토크모의고사

ETS 소개 | TOEFL iBT | 토크모의고사 | S&W 참사 | TOPC | 커뮤니티

QUICK
마이페이지 | 구입내역 | **인강** | 시험안내 | 구입하기 | 성적분석 | 1:1 문의내역 | 시험센터 | 정보수정 | 이용방법

마이페이지

HOME > 마이페이지 > 응시현황

남은기간 | 응시

5 | 546일 | **시험시작**

기간 | 응시일 | 응시

TOEFL iBT Complete Practice Test volume C | 2017.01.02 | 2018.07.02 | 501일 | 2017.02.16 13:33 | **계속하기**

TOEFL iBT Complete Practice Test Volume 46 | 2017.02.06 | 2018.08.06 | 536일 | 2017.02.16 12:52 | **계속하기**

TOEFL iBT Complete Practice Test volume B | 2016.12.19 | 2018.06.19 | 488일 | 2017.02.06 15:08 | **계속하기**

TOEFL iBT Complete Practice Test volume 44 (Timed) | 2017.02.02 | 2018.08.02 | 532일 | 2017.02.06 15:07 | **계속하기**

TOEFL iBT Complete Practice Test volume C | 2017.01.02 | 2018.07.02 | 501일 | 2017.01.03 18:50 | **계속하기**

1 2 3 4 5

확인 완료 **OK**

완료한 시험 [문제해결가이드]

TEST | 구매일 | 시험완료일 | 응시

HOW to START TEST

Step 1
Start the Test by clicking the green box or orange box that is shown below.

QUICK

- 마이페이지
- 마이페이지
- 구입하기
- 시험센터
- 이용방법

마이페이지

- 구입내역
- 응시현황**
- 성적분석
- 1:1 문의내역
- 정보수정

응시현황

대한민국 토플이 제시 ETS 토플에 오신것을 환영합니다.

New test

▶ 시작하지 않은 시험

Purchase date Effective date Remaining period Test taking

TEST	구매일	유효일	남은기간	응시
TOEFL iBT Complete Practice Test Volume 47	2017.02.16	2018.08.16	546일	시험시작

Ongoing test

▶ 진행 중인 시험

TEST	구매일	유효일	남은기간	응시일	응시
TOEFL iBT Complete Practice Test volume C	2017.01.02	2018.07.02	501일	2017.02.16 13:33	계속하기
TOEFL iBT Complete Practice Test Volume 46	2017.02.06	2018.08.06	536일	2017.02.16 12:52	계속하기
TOEFL iBT Complete Practice Test volume B	2016.12.19	2018.06.19	488일	2017.02.06 15:08	계속하기
TOEFL iBT Complete Practice Test volume 44 (Timed)	2017.02.02	2018.08.02	532일	2017.02.06 15:07	계속하기
TOEFL iBT Complete Practice Test volume C	2017.01.02	2018.07.02	501일	2017.01.03 18:50	계속하기

1 2 3 4 5

start the test

Continue the test

HOW to START TEST

Step 1

After the Digital Chosunilbo logo launches, the test begins

The screenshot shows the website <http://etest.chosun.com> with a pop-up window. The pop-up window contains the following text:

ETS 공식 토폴모의고사는
디지털조선일보에서 제공합니다.

ChosunMedia
디지털조선일보
etest.chosun.com

The background of the website shows a list of TOEFL iBT Complete Practice Test volumes with columns for volume number, purchase date, expiration date, price, and status.

구분	구입내역	유효기간	가격	응시일	응시
TOEFL iBT Complete Practice Test Volume 46	2017.02.06	2018.08.06	544원	2017.02.07 09:30	응시하기
TOEFL iBT Complete Practice Test volume C	2017.01.02	2018.07.02	509원	2017.02.06 15:08	응시하기
TOEFL iBT Complete Practice Test volume B	2016.12.19	2018.06.19	496원	2017.02.06 15:08	응시하기
TOEFL iBT Complete Practice Test volume 44 (Timed)	2017.02.02	2018.08.02	540원	2017.02.06 15:07	응시하기
TOEFL iBT Complete Practice Test volume C	2017.01.02	2018.07.02	509원	2017.01.03 18:50	응시하기

HOW to see Your score

We offer Review function after the test.

Step 1

Continue the Test by clicking the purple box that is shown below

1:1 문의내역

시험센터

이용방법

정보수정

TEST	구매일	유효일	남은기간	응시
TOEFL iBT Complete Practice Test Volume 47	2017.02.16	2018.08.16	545일	시험시작

1

▶ 진행 중인 시험 [문제해결가이드](#)

TEST	구매일	유효일	남은기간	응시일	응시
TOEFL iBT Complete Practice Test volume C	2017.01.02	2018.07.02	500일	2017.02.16 13:33	계속하기
TOEFL iBT Complete Practice Test Volume 46	2017.02.06	2018.08.06	535일	2017.02.16 12:52	계속하기
TOEFL iBT Complete Practice Test volume B	2016.12.19	2018.06.19	487일	2017.02.06 15:08	계속하기
TOEFL iBT Complete Practice Test volume 44 (Timed)	2017.02.02	2018.08.02	531일	2017.02.06 15:07	계속하기
TOEFL iBT Complete Practice Test volume C	2017.01.02	2018.07.02	500일	2017.01.03 18:50	계속하기

Completed test

1 2 3 4 5

▶ 완료한 시험 [문제해결가이드](#)

TEST	구매일	시험완료일	응시
TOEFL iBT Half Practice Test Volume 49 (R/L) Timed	2017.02.13	2017.02.13~2017.03.13	성적보기
TOEFL iBT Half Practice Test Volume 48 (R/L) Timed	2017.02.13	2017.02.13~2017.03.13	성적보기
TOEFL iBT Complete Practice Test Volume (3)	2016.12.13	2016.12.13~2017.01.06	성적보기
TOEFL iBT Complete Practice Test Volume (1)	2016.12.09	2016.12.09~2017.01.09	성적보기
TOEFL iBT Semi Practice Test Volume 46A	2016.12.06	2016.12.06~2017.01.06	성적보기

1 2 3

Confirm report cards

개인정보취급방침 | 이용약관 | 찾아오시는길

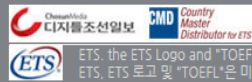

사업자등록번호 104-81-37808 / 서울특별시 중구 세종대로21길 52 조선일보 광화문빌딩 6층
(주)디지털조선일보 / 대표이사 김찬 / 고객센터 Tel. 02-3701-2000 E-mail. TOEFL@chosun.com

ETS, the ETS Logo and "TOEFL" are registered trademarks of Educational Testing Service, Princeton, New Jersey, U.S.A, used under license.
ETS, ETS 로고 및 "TOEFL"은 미국교육평가원(Educational Testing Service, 미국 뉴저지주 프린스턴)의 등록된 상표로서 승인 하에 사용됩니다.

HOW to see REVIEW

Step 1

Click each section as shown below. Then, you'll be able to re-check the incorrect or the correct question.

* Provide this Review to check your answer for a month

TOEFL® Practice Online

Official TOEFL iBT® Practice Test

Volume 49 Score Report

The purpose of this practice test is to help you prepare for the TOEFL iBT®. Performance on this test is not necessarily a predictor of how you might perform during an actual TOEFL® administration because you are not taking this test under regular testing conditions. However, you are encouraged to use this practice test to get a better sense of the TOEFL iBT® content and format, as well as receive scoring information on this preparation experience. *Scores and information presented in this score report are for preparation use only and are not official test scores.*

Test Taker Profile:

Name	Test Mode	Test Start	Test End	Total Scaled Score
토플도우미_m	Timed Mode	2017-02-13 15:46	2017-02-13 16:40	0

Summary Analysis:

Click on a section to review the questions for that section. Click on the "% Correct" to review all incorrect questions. If on the test customization page, you selected the untimed version and selected "Mark Guesses", click on "% Guessed" to see all questions marked as

Section	Total Number of Correct Responses	%Correct	Scaled Score	%Guessed*	%Correct of Guessed
Reading	0 of 45	0%	0	0%	0
Listening	4 of 34	12%	0	0%	0

*These scores available only if on the test customization page, you selected to mark the answers on which you guessed.

Feedback Analysis:

Reading	Level	Your Performance
Reading	Low	<p>Test takers who receive a score at the LOW level, as you did, typically understand some of the information presented in academic texts in English that require a wide range of reading abilities, but their understanding is limited.</p> <p>Test takers who receive a score at the LOW level typically:</p> <ul style="list-style-type: none"> • have a command of basic academic vocabulary, but their understanding of less common vocabulary is inconsistent; • have limited ability to understand and connect information, have difficulty recognizing paraphrases of text information, and often rely on particular words and phrases rather than a complete understanding of the text; • have difficulty identifying the author's purpose, except when that purpose is explicitly stated in the text or easy to infer from the text; and • can sometimes recognize major ideas from a text when the information is clearly presented, memorable or illustrated by examples, but have difficulty doing so when the text is more demanding.
Listening	Level	Your Performance

5. What you see on a screen during the test

Toolbar

You will find the [toolbar](#) in each section of the test. It allows you to navigate through the test. The main buttons shown on the toolbar of TPO are [Pause Test](#), [Section Exit](#), [Help](#) and [Hide Time](#).

[Pause Test](#) and [Section Exit](#)

[Pause Test](#) and [Section Exit](#) are always found in the upper left corner of the toolbar.



PAUSE TEST SECTION EXIT

[Pause Test](#)

Click [Pause Test](#) when you want to pause the test. It can be taken in multiple sittings by pausing the test and then continuing at a later time. The test will resume where you left off.

(Note) The real TOEFL iBT Test does not have [Pause Test](#).

! Use [Pause Test](#) in Listening Section

When you pause the test during Listening Section, click [Pause Test](#) **after** you answer the questions to the audio you just heard.

If you pause before you see the questions, the test will start from the questions and you may not hear the audio.

A pop up window opens when you click 「Pause Test」 asking you to choose to click on “Return” to the test and continue working or to click on “Continue” to pause the test.

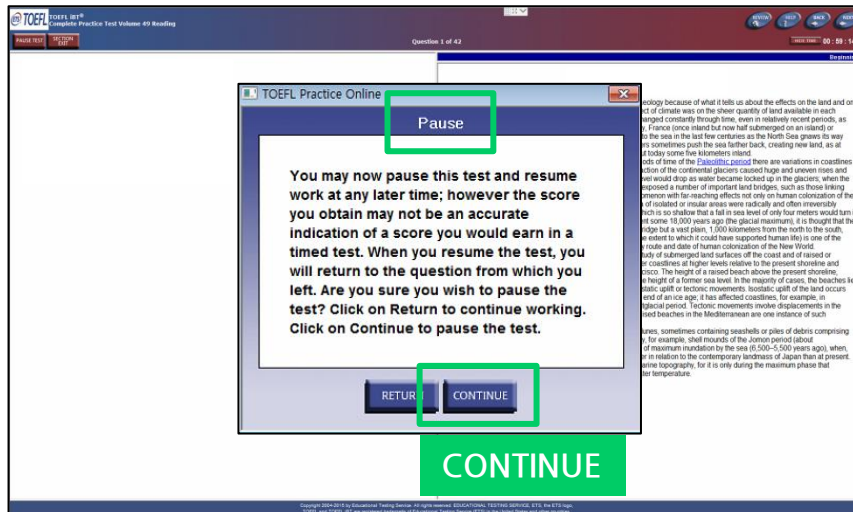

Please click 「CONTINUE」 if you want to pause the test.

To restart the test,

1. Go to the website <http://etest.chosun.com>
2. On the right, enter your ID and Password
3. Click on “My page” and “Test Status”
4. Then click on “Continue the test”

「Section Test」

Click 「Section Exit」 when you want to exit the section you are currently working on.

(Note) If you exit a section, you are not able to return to the section to answer the rest of the questions. It will go to the next section of the test.

A pop up window opens when you click 「Section Exit」 asking you to choose to click on “Return” to the test and continue working or to click on “Continue” to exit the section.

It also says

“Once you leave this section and proceed to the next, you WILL NOT be able to return to it.”

Please make sure that you are certain to leave the section and proceed to the next.

「Help」

When you click 「Help」, you can see how to answer the section you are working on.

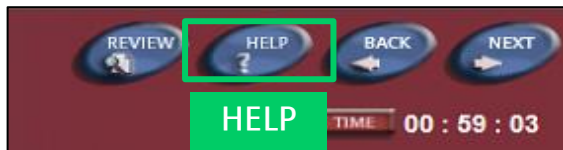

(Note) The countdown timer does not stop while you are using this feature.

「Volume」

You should adjust the volume of the PC before starting the test. However if the volume is too loud or too quiet while you hear the audio, click 「Volume」 to adjust the volume.



(Note) Make sure the “Mute” is off on your PC.

「Hide time」 with Timed mode



The right side of 「Hide Time」 shows the remaining time of the section. When you are hiding time by clicking 「Hide Time」, 「Show Time」 will be on the toolbar instead. Please click 「Show Time」 to show time again.

When the **time expires**

When you are taking a test in **Timed Mode** and the standard time for the section expires, the following message will be up on a screen.

If you choose **“Return”**, your test mode will be changed to Untimed Mode for the rest of your test (Not just the section you are working but the following sections also) but you can keep working on the section.

If you choose **“Continue”**, you will exit the current section and proceed to the next section.

6. Frequently Asked Questions

<Register Authorization Code>

Q1. When entering the Authorization Code, "The authorization code you entered has already been used. ~" appears.

A. Authorization codes are meant to be used one time. Once you have entered your Authorization Code, you only need to log in with your ID and password to access your test again.

- You do not need to enter the Authorization Code each time you try to restart a test.

Q2. When entering the Authorization Code, "The authorization code you entered is invalid. ~" appears.

A. When you copy and paste the code, this message may appear. Please try entering the code again without using copy and paste.

Q3. Can I change a test mode from Untimed Mode to Timed Mode during a test?

A. No, you can't change the test mode from Untimed to Timed once you start the test. However you will be asked if you want to change from Timed Mode to Untimed Mode if the time has expired in the current section you are working on. Please note you cannot change back to

<Scoring 01 >

Q4. Why did I receive a zero in the score in Reading or Listening section?

A. The reason why you received a zero in the score report in these sections is because either

- You have answered all of the questions wrong. Or,
- You exited out the section without answering any questions.

< Scoring 02 >

Q5. The score report shows “**Retake**” in Speaking section.

A. Your six speaking tasks were scored by the SpeechRater program, an automated scoring system. If 2 or more responses get a Technical Difficulty or not being answered, the examinee can try the items again. Please click the link(s) and retake the part of the Speaking section. **You should try answering as long as possible with loud and clear voice.** If the scoring engine still cannot score your answers after retakes, Speaking section will not be scored and the total score will show as Not Completed.

Q6. In a score report, Speaking/Writing sections say “Waiting for scores” or “have not completed scoring yet.”

A. The scores for the Speaking and Writing sections should be available within 24 hours after you complete the test.

Q7. The total score says “**Not Completed**” on a score report.

A. “Not Completed” means the Speaking section could not be scored by the SpeechRater program. If the speaking section tasks say “Click here to retake”, please do so by answering them as many as and as long as possible to get them scored.

Q8. Writing score appears as 0.

A. The reason why you received a zero in the score report is because the scoring engine could not reliably determine the structure of the essay. There were no paragraph breaks in the essays which caused this issue to occur. A score of zero is also possible for off-topic responses. While these practice materials are designed to help you better prepare for the TOEFL iBT test, the score you receive on the practice materials may not be the same as what you would receive on the TOEFL iBT test.

< Scoring 03 >

For more information regarding automated scoring systems, please refer to the Frequently Asked Questions page at https://www.ets.org/s/toefl/pdf/toefl_tpo_faq.pdf

Q9. Can I retake a section where I accidentally exited out?

A. Once you leave a section, you cannot go back to that section. The section will not be reopened. Please pay full attention **not to click on SECTION EXIT button** unless you mean to exit and proceed to the next section.

More Resources

Please check our website (in Korean only) for more information regarding TOEFL® Practice Online.

If you would like to get help directly from TOEFL® Practice Online,

·Technical Support: toefl@chosun.com

6F ,52, Sejong-daero 21-gil, Jung-gu, Seoul, Republic of Korea

TEL 02-3701-2000 (09 : 30 ~ 18 : 30) Voice Guidance1 FAX 02-3701-2999

Digital Chosunilbo, TOEFL Practice Online shop

<http://etest.chosun.com>

서울시 중구 세종대로 21길 52 조선미디어 광화문센터 6층

ETS, TOEFL, TOEFL iBT, TPO are registered trademarks of Educational Testing Service (ETS)
used by Digital Chosunilbo in Korea pursuant to license.

**Good Luck on
Your Test!**

Thank you !