

# **HYDRAULIC PRODUCT CATALOGUE**

***Published September 2016***

**Hydraulic Rams,  
Control Valves, Hydraulic Hose  
Reusable Hydraulic Fittings  
Hydraulic unions and Fittings  
Hydraulic Pumps**



***www.discounttractorparts.co.nz***

**DISCOUNT TRACTOR PARTS**

**Ph 0800 872 272**

**0800 TRACPART**

**E-mail [sales@discounttractorparts.co.nz](mailto:sales@discounttractorparts.co.nz)**

**Prices contained in this catalogue are plus gst and subject to change**

**7 Manga Rd, Silverdale**

*New expanded clevis ram range from*



Part No	Price	Bore	Stroke	Sp Diameter	Closed Length	Ports
3088	\$172	38mm	100mm	22mm	350mm	9/16 UNF 0
3085	\$180		150mm	22mm	400mm	
3035	\$214		200mm	32mm	500mm	3/4 UNF O
3092	\$240		250mm	32mm	500mm	
3079	\$234		300mm	32mm	565mm	
3093	\$268	52mm	350mm	32mm	610mm	
3080	\$277		450mm	32mm	710mm	
3081	\$317		600mm	32mm	870mm	
3082	\$460		1200mm	32mm	1456mm	
3087	\$213		150mm	38mm	406mm	
3031	\$246		200mm	38mm	500mm	
3036	\$264	63mm	300mm	38mm	565mm	
3091	\$270		300mm	38mm	610mm	
3094	\$299		450mm	38mm	768mm	
3095	\$330		600mm	38mm	900mm	
3029	\$279		200mm	38mm	500mm	
3030	\$325		300mm	38mm	565mm	
3089	\$340	76mm	300mm	38mm	615mm	
3037	\$358		450mm	38mm	705mm	
3090	\$364		450mm	38mm	770mm	
3096	\$422		600mm	38mm	920mm	
3038	\$294	89mm	200mm	44mm	500mm	
3097	\$468		600mm	44mm	920mm	
3039	\$340		200mm	52mm	515mm	
3083	\$378	104mm	300mm	52mm	554mm	
3084	\$493		450mm	52mm	705mm	
3086	\$515		600mm	52mm	870mm	

Available from Discount Tractor Parts

Ph 0800 872272 e mail [jleedtp2@ihug.co.nz](mailto:jleedtp2@ihug.co.nz)

*All prices are plus gst and subject to change*

## SCREW CAP HEAVY DUTY RAMS

An extra heavy duty ram with oversize spear for strength and quick return travel.

Has boss end pivots and 3/4" o-ring ports.

Suitable for a whole range of applications where strength and reliability are required.

3000 lb sq" continuous working pressure.



Part No	Price	Bore	Stroke	Spear Diam	Closed Lgth	Body end	Spear end	Pin size
3028	\$199.00	52mm	204mm	38mm	380mm	66mm	44mm	19mm
3017	\$260.00	63mm	305mm	38mm	500mm	80mm	52mm	19mm
3025	\$314.00	63mm	450mm	38mm	660mm	80mm	52mm	19mm
3026	\$333.00	63mm	600mm	38mm	810mm	80mm	52mm	19mm
3021	\$340.00	76mm	450mm	44mm	660mm	95mm	58mm	25mm
3018	\$376.00	76mm	600mm	44mm	810mm	95mm	58mm	25mm
3019	\$426.00	89mm	600mm	52mm	810mm	104mm	63mm	25mm
3027	\$446.00	102mm	500mm	58mm	810mm	120mm	102mm	32mm

## THROUGH BOLT RAMS

Top quality ram for budget requirements

Comes complete with clevis and pin each end and is rated to 2500 psi continuous.



Part No	Price	Bore	Stroke	Spear Diam	Closed Lgth	Port Size
3022	\$154.00	52mm	204mm	29mm	512mm	3/8in NPT
7434	\$210.00	63mm	204mm	29mm	512mm	3/8in NPT
3013	\$208.00	63mm	305mm	29mm	564mm	3/8in NPT
3015	\$220.00	76mm	204mm	32mm	512mm	1/2in NPT
3016	\$220.00	76mm	305mm	32mm	564mm	1/2in NPT
3023	\$270.00	76mm	400mm	32mm	666mm	1/2in NPT
3020	\$299.00	76mm	450mm	32mm	715mm	1/2in NPT
3014	\$240.00	89mm	204mm	32mm	512mm	1/2in NPT
3024	\$270.00	102mm	204mm	32mm	512mm	1/2in NPT

Available from **DISCOUNT TRACTOR PARTS**

Ph 0800 872272 09 8337483

E mail [jleedtp2@ihug.co.nz](mailto:jleedtp2@ihug.co.nz)

*Prices plus gst & subject to change*

# MONOBLOCK CONTROL VALVES

A new range of 3/8 " & 1/2 " port hydraulic Control valves.  
 Rated at 45 and 60 litres per minute.  
 Open and closed centre options  
 BSP ports  
 After sales parts back up.

## Single spool

3/8 Single acting \$270  
 3/8 Double acting \$270

1/2" Single acting \$320  
 1/2" Double acting \$320



## Four spool

3/8 Single x 2 / double x 2 \$590  
 3/8 Double x 4 \$590

1/2 Single x 2 / double x 2 \$698  
 1/2 Double x 4 \$698



## Double spool

3/8 Single / double \$385  
 3/8 Single / single \$385  
 3/8 Double / double \$385

1/2 Single / double \$440  
 1/2 Single / single \$440  
 1/2 Double / double \$440



## Triple spool

3/8 Single / double x 2 \$515  
 3/8 Double x 3 \$515

1/2 Single / double x 2 \$578  
 1/2 Double x 3 \$578



## Remote cable assemblies

Cable length	1.50 mtr	\$275
	1.75	\$275
	2.00	\$285
	3.00	\$315



Available from Discount Tractor Parts Ph 0800 872 272

All prices are plus gst

# Hydraulic Top Links



## Category one

Medium duty link with cat 1 balls

Part no.	Cat.	"A" Min	"A" max	piston diam	price	Port size
TL 1/2	1 / 1	470	660	52	\$265	9/16 UNF
TL 1/3	1 / 1	520	710	52	\$265	O-ring
TL 1/4	1 / 1	610	812	52	\$265	

## Category two

Heavy duty link with Cat 2 heavy duty ball end and 25mm knuckle link

TL 2/2	2 / 2	546	750	63	\$298	3/4 UNF
TL 2/3	2 / 2	622	812	63	\$310	O-ring



## Category three

Heavy duty link with Cat 3 32mm knuckle and option of cat three ball end or cat 3 claw and ball.

TL 3/3 ball	3/3	620	890	80	\$773	3/8 BSP
TL 3/3 claw	3/3	620	890	80	\$813	3/8 BSP

## Hose Kits

Contains 2 x 900 mm hoses with standard 1/2" male couplings \$135  
Or, can be ordered to requirements.



In line flow restrictor  
\$76



Male Tips

QR Hydraulic Couplings

1/4", 3/8", 1/2" \$40 set  
Male only \$16  
Female only \$32

**DISCOUNT TRACTOR PARTS**

**Ph 0800 872272**

**Prices plus GST & subject to change**

Ph 8337483  
E mail [jleedtp@ihug.co.nz](mailto:jleedtp@ihug.co.nz)

# Build Your Own Log Splitter



**24 Tonne Ram \$436 + gst**

500mm stroke x 104mm bore x 58mm spear  
Smaller sizes available.

## Pressure Return Control Valve

Designed for log splitter application

90 litre per minute

Built in pressure release valve set at 2240 psi

Return detent set at 1250 psi

**Price \$360 + gst**



## Two Stage Hydraulic Pumps

DS8 6.29+2.09cc=30 lpm at 3600rpm both pump sections combined 30 lpm up to 650psi [44.8bar] requires 3.5hp [2.6kw] at 650psi. The larger 6.29cc pump section unloads and bypasses to the pump inlet. If the directional valve relief is set to 3000 psi the small pump section will deliver 7.5 lpm up to 3000psi.  
**RECOMMENDED 5.5hp \$482 plus GST**

DS11 8.8cc+3.59cc=44.6 lpm at 3600 rpm both pump sections combined 44.6 lpm up to 650psi [44.8 bar] requires 5hp [3.7kw] Small pump section 3.59cc will deliver 12.9 lpm up to 3000psi.  
**RECOMMENDED 7hp \$494 plus GST**

DS16 13cc+4.19cc=61.8 lpm at 3600rpm both pump sections combined. 61.8 lpm up to 650 psi [44.8 bar] requires 7hp [5.2kw]. Small pump section 4.19cc will deliver 15 lpm up to 3000psi.  
**RECOMMENDED 11hp \$537 plus GST**  
*Drive couplings extra*

**In line filter assembly. 3/4" ports. \$98 + gst**



*From* **Discount Tractor Parts**  
**Ph 0800 872 272**  
**E mail jleedtp2@ihug.co.nz**  
*All Prices plus gst*

# Build Your Own Logsplitter



## Hydraulic Rams

Stroke	Bore	Spear	Price
450	76	44	\$340
600	76	44	\$376
600	89	52	\$428
500	100	58	\$436

Rams rated to 3000 psi continuous



Auto return  
control valve  
90 ltr per min \$360

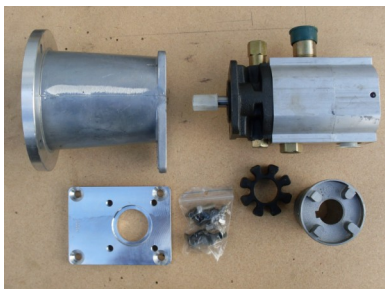
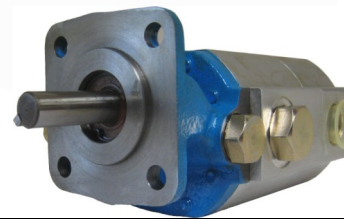

## Two stage hydraulic pumps

Suitable for stationary engines 5 hp to 13 hp  
Pumps from \$482 to \$537 Engine bell housings and couplings to suit pumps available. Bell housing and adaptor plate from \$190 Three piece coupling \$95.  
Larger pumps available POA

## Pump & fitting kit

Includes, 61 ltr pump, bell housing and fitting kit, three piece coupling to suit 25mm or 1" engine shaft Kit price \$800

## 13HP Petrol powered power pack

Includes 13 HP Sinopower engine, 61 lpm 2 stage hydraulic pump, bell housing & coupling \$1798



Prices plus gst & subject to change  
Kits can be made to suit requirements  
Free technical help line available

Component Kit contains 100 x 500 Ram, Control valve, 61 ltr pm 2 stage pump, bell housing and coupling, 4 mtrs 1/2" hydraulic hose, fittings and unions to make and fit 4 x pressure hoses. Kit price \$1790

Available from Discount Tractor Parts

Ph 0800 872272

Email [jleedtp2@ihug.co.nz](mailto:jleedtp2@ihug.co.nz)

# Discount Tractor Parts

Ph 0800 872272

## IMPLEMENT PINS

10% discount on orders of 10 or more pins (assorted size)

B75	Cat 1 Top Link	19x98mm	\$4.00
B215	Cat 1 Lower	22x105mm	\$7.30
B81	Cat 2 Top Link	25x105mm	\$6.80
B216	Cat 2 Lower	28x105mm	\$9.10
B2597	Cat 3 Top Link	32x115mm	\$15.00
B3517	Cat 3 Lower	36x203mm	\$25.75



## Drawbar Pins

B3077	12.7x90mm	\$5.15
B3078	16x108mm	\$5.85
B404	19x160mm	\$8.80
B405	22x160mm	\$10.40
B410	25x160mm	\$10.00
B412	28x160mm	\$18.15
B415	32x160mm	\$19.50
B417	38x185mm	\$28.50
B7417	50x185mm	\$45.00

## Stepped implement pins

B2971	Cat 1 / 2 top link	\$11.25
B100	Cat 1 / 2 lower link	\$112.05

## HOSE CLIPS-

Max ID	
16mm	\$1.50
19mm	\$1.80
27mm	\$2.00
32mm	\$2.20
38mm	\$2.40
44mm	\$3.00
51mm	\$3.20
57mm	\$3.40
70mm	\$3.80
76mm	\$4.00
89mm	\$4.50
102mm	\$5.00



Stainless Steel Construction

20 % discount on orders of 20 or more clips assorted size

## LINCH PINS

pin diam	
B4	4.5 mm
B2	6mm
B3	8mm
B6	11mm

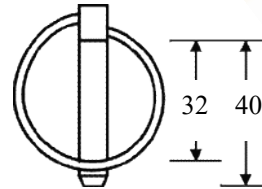

B& Super lynch \$1.50

\$1.00 ea , 3 for \$2.00 , 10 for \$5.00 (assorted)

## D SHACKLES Zinc Plated,

Pin size	
6mm	\$1.00
8mm	\$1.20
10mm	\$1.50
12mm	\$2.50
16mm	\$5.00
19mm	\$7.00
25mm	\$12.00



## R CIIPS



	wire diam	suit shaft diam	price each
B8	2mm	6-11mm	0.50c
B9	2.5mm	8-12mm	0.50c
B10	3mm	10-12mm	0.50c
B12	4mm	12-22mm	1.00
B13	5mm	16-27mm	1.50
B14	6mm	19-32mm	2.50
B15	7mm	25-38mm	3.00

## SHAFT LOCKING PIN

B8100 6mm pin  
 B6100 8mm pin  
 B6101 10mm pin \$2.00 ea  
 10 % discount on 10 or more lock pins assorted sizes.

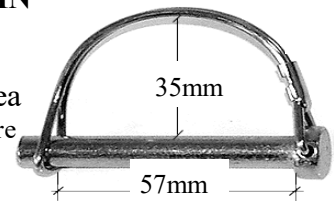

## IMPLEMENT MOUNTING PINS

B198	cat 1	19mm thread	\$7.00
B200	cat 1	22mm thread	\$7.00
B197	cat 2	19mm thread	\$11.00
B202	cat 2	22mm thread	\$10.00
Other sizes available			



## TOP LINKS

Std duty Cat 1 &2  
 \$45.00 ea

## LINKAGE DRAWBARS

Cat 1 \$67.50  
 Cat 2 \$72.00



Also available Large range of lock collars , clevis pins , bushes , linkage balls , tow balls.



Prices plus gst and subject to change



## **Planetary Posthole Digger Motor Gearbox Assembly**

### *Features*

**Auger drive speed**

**62 rpm @ 35 litres / min**

**100 rpm @ 70 litres / min**

**Incorporates 200cc (12.2cu in)  
hydraulic motor**

**Gearbox Ratio 3.6 : 1**

**High pressure motor seals**

**Output shaft diameter 52mm.**



***\$1720 + gst***

### **Augers**

**Full range of Heavy  
duty double cut augers  
available**

### **SPECIAL DEAL**

**Motor Gearbox Assembly,  
& 300mm cut Auger**

**Special Price \$2160**

Available from

**DISCOUNT TRACTOR PARTS**

**Ph 0800 872 272**

**09 8337483**

# HYDRAULIC MOTORS



## *Features*

- \* Roller type gear stator
- \* Uses taper roller brgs
- \* High pressure motor seals
- \* Case drain not required
- \* These motors are suitable for continuous operation under rough operating conditions such as high operating temperatures, thin oil, or frequent reverse cycling.

Available in 3 models.

All with SAE "A" 4 bolt hole flange

Motors all just \$646 each plus gst

Pump	Shaft size	Displace	max speed	Flow	Torque	pressure
DM1	1 1/4" x 14 spl	200 cc	375 rpm	75 lt pm	400 Nm	2030 psi
DM2	1 3/8" x 6 spl	100cc	748 rpm	75 lt pm	240 Nm	2538 psi
DM3	1 3/8" x 6 spl	160cc	470 rpm	75 lt pm	360 Nm	2176 psi

*All speed, torque and pressure specs are continuous ratings. For intermittent ratings, add 12% to 18% to continuous ratings*

*Available from*  
**Discount Tractor Parts**  
**Ph 0800 872 272**

# Crimp end Hydraulic Hoses

*Twin wire SAE 100 R2 AT hose with swaged fittings*

*We will make hydraulic hoses to order, or choose from the selection below.*

*Hoses listed below are available, made with any BSP combination of male, female swivel or 90 deg swept fittings*



Hose assemblies available in hose diam x length in mm

1/4 x 750 \$45.00	3/8 x 500 \$45.00	1/2 x 500 \$48.50
1/4 x 1000 \$49.00	3/8 x 750 \$49.00	1/2 x 750 \$50.00
	3/8 x 1000 \$53.50	1/2 x 1000 \$55.00
	3/8 x 1200 \$60.20	1/2 x 1200 \$64.00
	3/8 x 1600 \$68.00	1/2 x 1600 \$72.00
		1/2 x 1800 \$75.00
	3/8 x 2000 \$76.00	1/2 x 2000 \$80.80
	3/8 x 2500 \$83.00	1/2 x 2500 \$88.00
	3/8 x 3000 \$89.00	1/2 x 3000 \$94.00
	3/8 x 3500 \$96.50	1/2 x 3500 \$102.00



## Male nipples

A x B	
1/4 x 1/4	\$4.13
1/4 x 3/8	\$4.13
3/8 x 3/8	\$5.15
3/8 x 1/2	\$5.15
1/2 x 1/2	\$5.15
1/2 x 3/4	\$8.60

## Elbows



A x B	
1/4 x 1/4	\$13.04
3/8 x 3/8	\$15.45
1/2 x 1/2	\$16.14
3/4 x 3/4	\$22.65



## Swivel Extensions

A x B	
3/8 x 3/8	\$8.91
1/2 x 1/2	\$12.05

## BSP Male Tee Pieces

1/4"	\$10.29
3/8"	\$11.50
1/2"	\$15.45
3/4"	\$23.75



## Male Tips



## Q R Couplings

Male female sets  
3/8" & 1/2" \$40set  
Male only \$15  
Female only \$28

## Hydraulic hose

mounting clamps.

Available for 3/8" & 1/2" hose sizes \$14 ea

*Available from*

**Discount Tractor Parts Ph 0800 872272**

E mail [jleedtp2@ihug.co.nz](mailto:jleedtp2@ihug.co.nz) Prices plus gst



## Discount Tractor Parts    Hydraulic fittings price list

<b>Re-usable Ferrules</b>	Size	1/4"	3/8"	1/2"	3/4"	1"
	Ferrule	\$7.40	\$7.60	\$8.80	\$15.00	\$45.00

*Double wire braid - non skive - SAE 100 R2 rated    Prices per mtr*

<b>Hydraulic Hose</b>	\$12.40	\$14.70	\$15.95	\$21.70	\$29.80
-----------------------	---------	---------	---------	---------	---------

### Re-usable Inserts

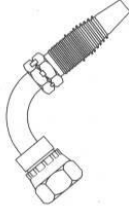
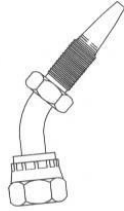
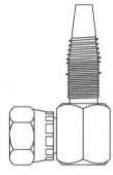
						
	HOSE x THREAD	MALE INSERT	FEMALE INSERT	90° FEMALE INSERT	135° FEMALE INSERT	90° FEMALE COMPACT
BSP	1/4" x 1/4"	\$9.57	\$9.57	\$16.50	\$12.80	
	1/4" x 3/8"	\$11.39	\$10.60			
	3/8" x 3/8"	\$7.20	\$8.70	\$14.40	\$13.75	POA
	3/8" x 1/2"	\$8.70	\$12.87	\$17.00	\$13.75	
	1/2" x 3/8"	\$9.00	\$13.54	\$18.85		
	1/2" x 1/2"	\$8.80	\$9.90	\$119.50	\$22.50	POA
	3/4" x 3/4"	\$19.80	\$24.50	\$29.00		\$32.00
	1" x 1"	\$32.45	\$38.00	\$39.50		
	JIC	1/4" x 1/2"				
1/4" x 9/16"			\$14.25			
3/8" x 9/16"		\$11.14	\$9.60	\$15.45		
3/8" x 3/4"		\$11.50	\$10.70	\$16.38		
1/2" x 3/4"		\$14.85	\$11.55	\$19.80		
1/2" x 7/8"		\$14.85	\$13.20	\$22.80		
3/4" x 1.1/16"						

**Discount Tractor Parts    Ph 0800 872272**

**sales@discounttractorparts.co.nz**

**7B Manga Rd, Silverdale**

All prices listed are plus gst and subject to change. Updated February 2017