

*Indiana University of Pennsylvania Building Site*

## AIA Middle PA Chapter and Pennsylvania Railroad Chapter CSI Joint Meeting

The Pennsylvania Railroad Chapter CSI and the Middle PA Chapter AIA had another opportunity to participate in a joint meeting on October 7, 2010. A scheduled tour of the Indiana University of Pennsylvania provided a preview of the new Convocation Building.



Mr. Steve Horell, Construction Administrator from L R Kimball represented the professional for the tour.



The photographs on this page were taken and submitted by Mr. David Reasinger. The photos show the various angles of the still uncompleted building.



- 1** IUP Convocation Building Tour
- 2** Message From the President
- 3** Associates Corner
- 3** For the Good of the Order
- 4** Young Architects Forum
- 4** Final Continuing Ed Seminar
- 5** Affiliate News
- 6** Innovation in Porcelain Tile Technologies
- 7** Indian Valley High School Tour Flyer
- 8** BIM For Construction Flyer

## **AIA MIDDLE CHAPTER ADDRESS**

If you are using the U. S. Postal Service to Contact the AIA Middle PA Chapter, please use the following:

AIA Middle PA Chapter  
c/o Carmen Wyckoff, AIA LEED AP  
Hayes Large Architects LLP  
200 W. Beaver Ave #200  
State College PA 16801

## **NEXT MID POINTS**

Deadline for articles and information for the next newsletter is:

**January 7, 2011**

Please contact Dee Columbus,  
Editor, [tdta2000@comcast.net](mailto:tdta2000@comcast.net)

## **STAY CONNECTED**

Please send new member information and any changes and/or additions in your contact information including email addresses to:

David E. Reasinger, Associate AIA  
Pennsylvania State University  
1113 Physical Plant Building  
University Park, PA 16802  
P: 814.863.3868  
F: 814.865.3737  
[der19@psu.edu](mailto:der19@psu.edu)

## **WWW.AIAMIDDLEPA.ORG**

Please be sure to visit the AIA Middle PA Chapter website to view the following:

- Chapter Officers
- Calendars
- Newsletter Archive
- Executive Committee Minutes
- Membership Information
- AIA Links
- Sponsorship and Advertising
- Mission Statement
- Project Photos

## **Message From the President**

Rick Cyman, AIA

You know the old saying 'time flies when you're having fun'; well, it certainly rings true for me. From both a personal and professional perspective, serving as the AIA Middle Chapter President for the past two years has been enjoyable, memorable and very rewarding. During my term, I have learned a great deal about the AIA and what it hopes to provide to its members. By attending Grass Roots Workshops, working with AIA PA, traveling to the National AIA Convention and working with our Middle Chapter Board, I have gained a better understanding about what the AIA is doing to benefit architects, the role it plays in the legislative process and, most importantly, the value it brings to our profession. In addition, I have great respect for our Middle Chapter Board Members and believe that they do an outstanding job at providing leadership to the chapter. There are many dedicated members of the board, past and present, who give generously of their time, resources and expertise to assure that our chapter is managed at a very high level....it has been a pleasure and a privilege to work along side these talented individuals. I would like to thank all of the members of the Middle Chapter for their support and the opportunity to serve as the President for the past two years—it has been the highlight of my 17 years of membership in the AIA.

Best Regards,

Rick

## AIA Associates Corner — 2010 Links

**Seth H. Wentz, Associate AIA**

AIA PA Regional Associate Director  
swentz@lscdesign.com

**Mellisa Berstine, Associate AIA**

AIA PA Associate Director  
mbernstein@klingstubbins.com

**David E. Reasinger, Associate AIA**

PA Associate Committee Member  
der19@psu.edu

**Arthur Sheffield, Associate AIA**

PA Coordinator, Intern Development Program (IDP)  
idp@aia.org

---

### ***For the Good of the Order***

Comments on the Profession of Architecture by Tom Columbus Jr., AIA, LEED AP

#### **CHANGES IN AIA MEMBERSHIP**

By now everyone has received their yearly “renew your membership” blurb from the AIA. I won’t go into the staple benefits of being a member. You know these already, or you would not be reading this Newsletter as an AIA member or affiliate. Rather, I would like to point out two major changes that were enhanced to better our membership benefits.

The continuing education documentation has been transferred from the original “keeper of the records” University of Oklahoma, to an AIA in-house management platform called the AIA CES Discovery. It provides your CES records on demand, tracks your requirements, and the best part, provides access to “thousands” (didn’t have time to count them) of providers and courses.

The second change is the official AIA magazine changing from “Architectural Record” to “Architect”. In addition, digital copies will be available of “Residential Architect”, “EcoHome”, and “Eco-Structure”. All this for the same membership price it was in 2009!

## **YOUNG ARCHITECTS FORUM**

We are looking for a representative from the Middle Pennsylvania Chapter AIA to be a local liaison for the Young Architects Forum (YAF).

Young Architects ( 0 - 10 yrs. ) licensed have already been recruited from the Central, Eastern , Pittsburgh and the Philadelphia chapters.

If you are interested or may know of someone who is interested, please contact Denise Thompson by email ( DThompson@franciscauffman.com ) with your contact information. If you cannot fill this position but know someone that is interested, please forward that person's name and contact information.

AIAPA charter for YAF was approved by the State Board of Directors. Facebook page and Linked -In page are up and running. YAF National and the College of Fellows are developing a mentoring program. More to come as this develops.

## **FINAL 2010 CONTINUING ED SEMINAR**

The final free continuing education seminar provided by the AIA Middle Chapter occurred on October 27, 2010. This event was hosted by Sheetz Inc. at their Facilities Support Center located in Claysburg Pa.

The seminar provided a total of three continuing education credits, one in Sustainability/HSW and two in HSW.

The first credit was provided by Mr. Paul Goldrick of Englert Inc., Perth Amboy, NJ. Mr. Goldrick reviewed building integrated photovoltaic procedures and solar panel type possibilities. He also explained the cool roof theory and coatings available on the market for metal roofs. Solar energy harvesting has become more financially attractive due to cost rebates provided by the Government and utility company requirements to purchase "green electricity" to provide to customers. These factors make ROI's possible in 5-7 years in many instances.

The second presentation was given by Mr. Roger Boucher of Abet Laminati Inc. The presentation addressed building rain screen wall construction. Possible rain screen wall details were reviewed with photos of building examples. The closest building example to Claysburg is the Alcoa Building in Pittsburgh. The pressure equalizer rain screen wall methodology was also reviewed.

Mr. Boucher continued in to the third and final presentation by explaining the differences of interior high pressure laminate (HPL) wall panels and direct pressure laminate (DPL) wall panels. These prefinished laminate wall panels can obtain points or help obtain points in the LEED system. Attachment detailing to the backer wall was also explained.

This seminar concluded the 2010 free continuing education program. The AIA Middle Chapter expresses its sincere thanks to Sheetz Inc. for providing a free venue and tasty lunch to participants. We would also like to thank the many vendor companies in providing their programs to enlighten the participants.

# Affiliate News

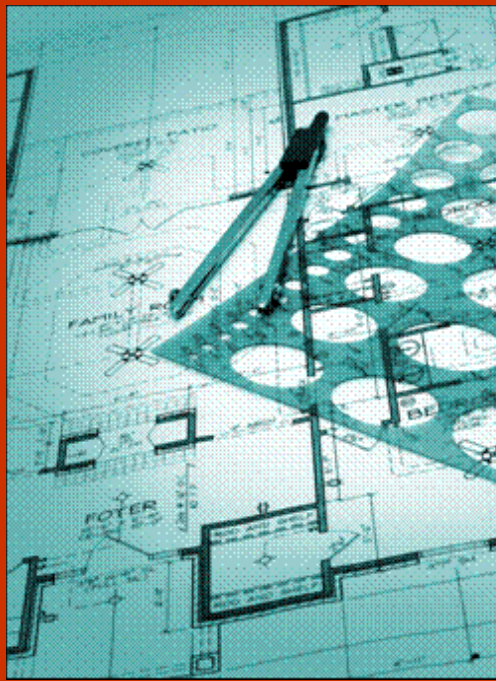

## Greetings, AIA Middle PA Chapter!

As most of you may know, we have been working with Anne McGrath of *McGrath Consulting* to develop an AIA Affiliate Membership Brochure in order to reach out to our Consultants, Contractors and Business Associates.

Now that the brochure is complete, we are asking for your help to get the word out. Please forward the attached brochure to anyone whom you feel may be interested in becoming an Affiliate Member of our AIA Middle PA Chapter.

Thanks!

## **CORRECTION**

The name of one of our newest Affiliate Members was incorrectly reported in our last newsletter edition. The company name is **P. Joseph Lehman, Inc., Consulting Engineers**.

The Editorial Staff wishes to apologize for any inconvenience this error may have caused.

## ***Welcome New Affiliate Members!***

We're pleased to welcome **Joe Keller, Paul Kirby** and **Randy Diviney** from **Keller Engineers** as AIA-MPC Corporate Affiliate members. For more info on this Hollidaysburg-based firm, check out [www.keller-engineers.com](http://www.keller-engineers.com).

Affiliate membership renewal reminders for 2011 will be going out in December. If you know of any non-architectural firms that might be interested in joining AIA-MPC as an affiliate member for the coming year, please feel free to send their contact info to Anne McGrath at [annemcgrath@verizon.net](mailto:annemcgrath@verizon.net). She'll be sure they receive a membership application.

---

---

## **Innovation in Porcelain Tile Technologies**

It's an exciting time in the porcelain tile business! Two recent breakthroughs are revolutionizing the way tile is made. First, fired tile can now be recycled and made part of the body of new tile. At the same time, advances in High Definition Porcelain (HDP) technology creates tile so realistic, it's hard to tell it from the real thing.

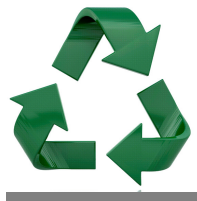

These two innovations mean that architects and design professionals can choose tile that deliver beautiful realism - and environmental responsibility.

For years, manufacturers looked for a way to avoid sending fired tiles that could not be sold to landfills. Unfired bisque has always been recycled into the body of new tiles, but once fired, they would end up in landfills. Now, new technology allows manufacturers to grind and return fired bisque to the body of new tiles. This has made it possible to even take back tile that has been installed and regrind it. Millions of pounds of tile are now being diverted annually from landfills.

High Definition Porcelain (HDP) sounds simple, yet it took decades of research to make it a reality. HDP porcelains use ink jet glazing technology to produce tiles so real that they are virtually indistinguishable from the original stone or wood that is being replicated. Similar to the ink jet printer you use to print documents and photos, this printer dispenses glazes, instead of ink. Some products have as many as 180 tiles before a repeat. In addition, this technology uses only the right amount of glaze needed for each tile without waste and eliminates "picture framing" on the edge of the tile.

Many new products using high definition glazing and containing recycled content have been introduced in 2010 and we can expect many more in the near future. The tile business will never be the same.

*Jim Tasillo has been in the tile and flooring business for over 30 years and is General Manager of Fierst Distributing Company in Pittsburgh. Fierst Distributing Company is focused on distributing tile, hardwood, rubber flooring and installation systems from manufacturers located within 500 miles of Pittsburgh. For more info on HDP or other flooring questions, contact Jim at [jkt2@consolidated.net](mailto:jkt2@consolidated.net).*

 **AIA** Middle Pennsylvania

*in association with*



**Please join us  
for a tour of the**



**INDIAN VALLEY  
HIGH SCHOOL**



Mifflin County School District  
501 Sixth Street, Lewistown

**Tuesday, November 23, 2010 - 4:00 pm**

The tour will be led by:

S. Dwight Knouse II, AIA, LEED<sup>AP</sup>, Executive Partner

George Wirick, Contract Administrator

both of Hayes Large Architects, LLP &

Jerry Myers, Project Manager, Reynolds Construction Management

**Dinner will follow at 6:00 pm**

Cost:

Only \$15 per person

Checks payable to AIA Middle PA Chapter

RSVP by Thursday, November 18<sup>th</sup> to:

Tyne Palazzi at [tpalazzi@sheetz.com](mailto:tpalazzi@sheetz.com)

or 814-947-5366

Sponsorship provided by:

**Reynolds**  
Construction Management

Please see page 2



105 South Logan Blvd.,  
Burnham

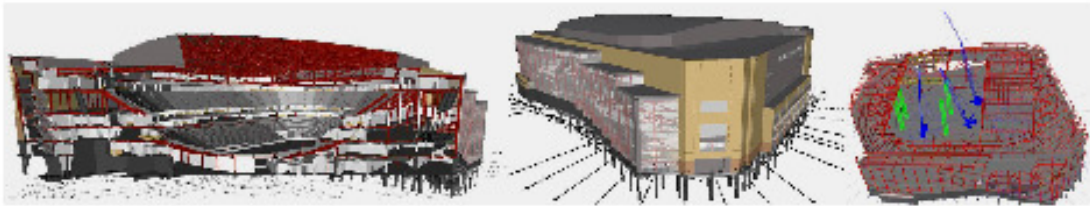

*Case Technologies Collaborative Construction Seminar Series and buildingSMART Alliance Joint Program*

## BIM for Construction The Consol Energy Center Case Study

The use of Building Information Modeling for construction coordination processes has increased significantly over the past several years. Progressive contractors are finding that committing to a virtual facility prototype provides significant value in the construction planning, coordination, fabrication and installation processes.

In this seminar, the construction team of the recently completed Consol Energy Center will highlight and demonstrate the BIM processes they employed on this significant project, describe the benefits they recognized and discuss the ramifications of working in a more collaborative environment.

Furthermore, the panelists will address issues they see that are preventing widespread adoption on more projects and by more project participants throughout the project lifecycle.

They will also address any questions and thoughts you may have as we encourage a healthy dialogue on the significant process changes facing the industry.

### Who Should Attend?

Anyone interested or currently involved with Building Information Modeling:

- **CM's and GC's** who would like to explore using emerging technologies to better manage construction projects.
- **Trade Contractors** to better understand the requirements and value of using BIM for construction coordination and how to integrate shop drawing or fabrication processes.
- **Designers** to see how BIM is being used downstream and consider how integration might better occur for overall project success.
- **Facility Owners** to better understand the value that BIM may provide your projects and how you might prescribe BIM processes for more successful projects.

**Date:** Tuesday November 16, 2010  
**Time:** 6:00 pm – 8:30 pm  
**Location:** **Consol Energy Center**  
 Lexus Club  
 1001 Fifth Avenue  
 Pittsburgh, PA 15219  
**Cost:** *Free* --  
 Hors D'Oeuvres will be provided

### Featured Panelists:

**Matthew Baker**  
PJ Dick

**Jim Regan**  
McKamish, Inc.

**Alan Rowe**  
SimplexGrinnell LP

**Theron Dipietrantonio**  
Lighthouse Electric

**Ken Stowe**  
Renowned construction technology expert  
Autodesk, Inc

**RSVP:** Email: [events@casetech.com](mailto:events@casetech.com)  
 Or call: 412-276-0500



**Autodesk**

building**SMART**alliance

 ALA Pittsburgh

 **MBA**  
PITTSBURGH CHAPTER



---

**SPECIAL THANKS TO OUR ADVERTISERS**

YOUR ADVERTISEMENT HERE!

YOUR ADVERTISEMENT HERE!

YOUR ADVERTISEMENT HERE!

YOUR ADVERTISEMENT HERE!

YOUR ADVERTISEMENT HERE!

YOUR ADVERTISEMENT HERE!

Please call Dee Columbus at 814-749-7952 to place  
an advertisement here.