



INSTRUCTION BOOK AND PARTS LIST

MODEL 618P . . . MODEL 618PT . . . MODEL 618H

**POWER TABLE
POWER CROSS FEED**

**POWER TABLE
HAND CROSS FEED**

**HAND TABLE
HAND CROSS FEED**

REID BROTHERS



COMPANY, INC.

TO OUR CUSTOMER:

We greatly appreciate that you have selected a new REID Precision Surface Grinder for your grinding department.

We have prepared this operation manual and parts book for your assistance in obtaining ultimate satisfaction with this quality tool. The new 'exploded' drawings of all assemblies have been adopted to facilitate repairs when required, and for ready identification of components. This booklet should be kept handy for the assistance of your operator. Should an additional copy be desired, please feel free in calling upon us.

We shall look forward to serving you, and take this opportunity to wish you well with your new REID Surface Grinder.

Very truly yours,

REID BROTHERS COMPANY, INC.



Walter W. Perkins, President

VARIABLE SPEED DRIVE ASSEMBLY
MODELS 618 P & 618 PT

REF. NO.	PART NO.	N A M E
1	618-62	Vari Speed Handwheel
2	S618-69	220/3/60
	S618-70	440/3/60
	S618-71	220/440/3/60
	S618-72	220/2/60
	S618-73	550/3/60
		1/6 H.P. Gear Head Motors
3	618-490	Motor Platform
4	618-491	Support Rod (2)
5	S618-5	Pulley
6	S618-3	33" lg. B Section V-Belt (2)
7	618-63	Vari Speed Adjusting Pin
8	618-61	Vari Speed Lever
	618-65	Stud to Lever
9	S618-45	Vari Speed Pulley
10		Drip Line to Vari Speed Pulley
11	S27-2	Oiler (normally not used)
12	S618-5	Pulley
13	S125-6	Spring (2)
14	618-72	Rod (2)
	RAX-5	Collar (2)

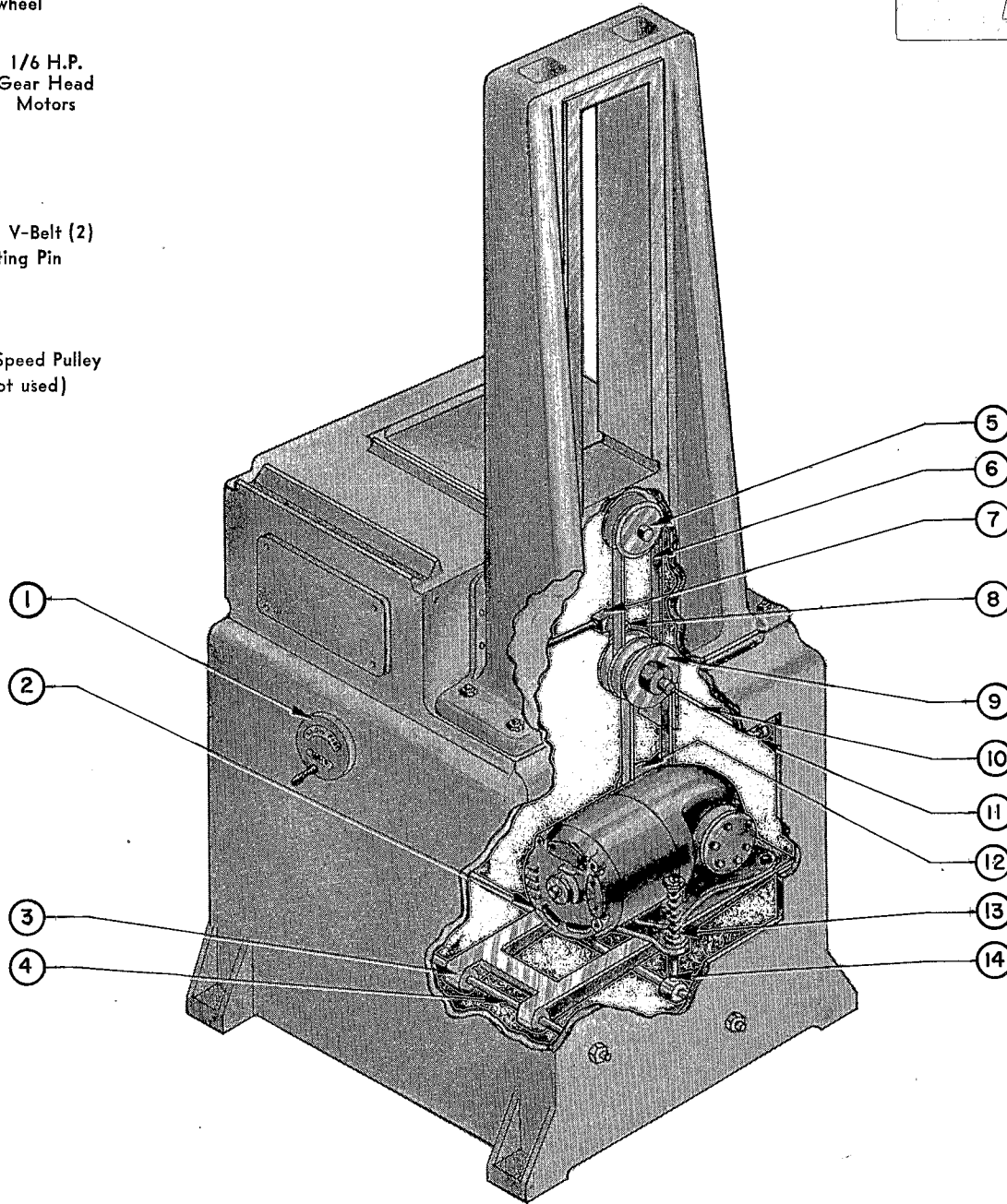

MODEL 618P POWER TABLE . POWER CROSS FEED MODEL 618PT

INSTALLATION



Mount the machine on a firm foundation and bolt to the floor if possible. Mounting pads will assist in eliminating excess vibration. It is important that the machine be mounted level.

On three phase grinders, incoming power supply should be connected to terminals L1, L2, and L3 of starter contactor. On two phase grinders, incoming power supply should be connected to terminals L1, L2, L3, and L4 of starter contactor. After connecting power supply start spindle motor. Spindle should turn clockwise. If not change any two wires of the input power supply.

LUBRICATION



Keep a constant check on the level of the oil reservoir. Under normal use the oil reservoir should require filling approximately every three weeks.

STARTING

On hand feed models, push button for spindle motor and operate by hand.

On power feed models, turn on both motors at push

button station by moving selector switch to on position and pushing start button. Depress handle on left side of machine (illustrated at right) for power table traverse.

If it is desired to run only the spindle motor, leave or set the on-off selector switch in the off position. Set cross feed adjusting arm for power cross feed.

To stop power cross feed of table, set adjusting arm at neutral. To stop longitudinal feed of table, raise handle on left side of machine.

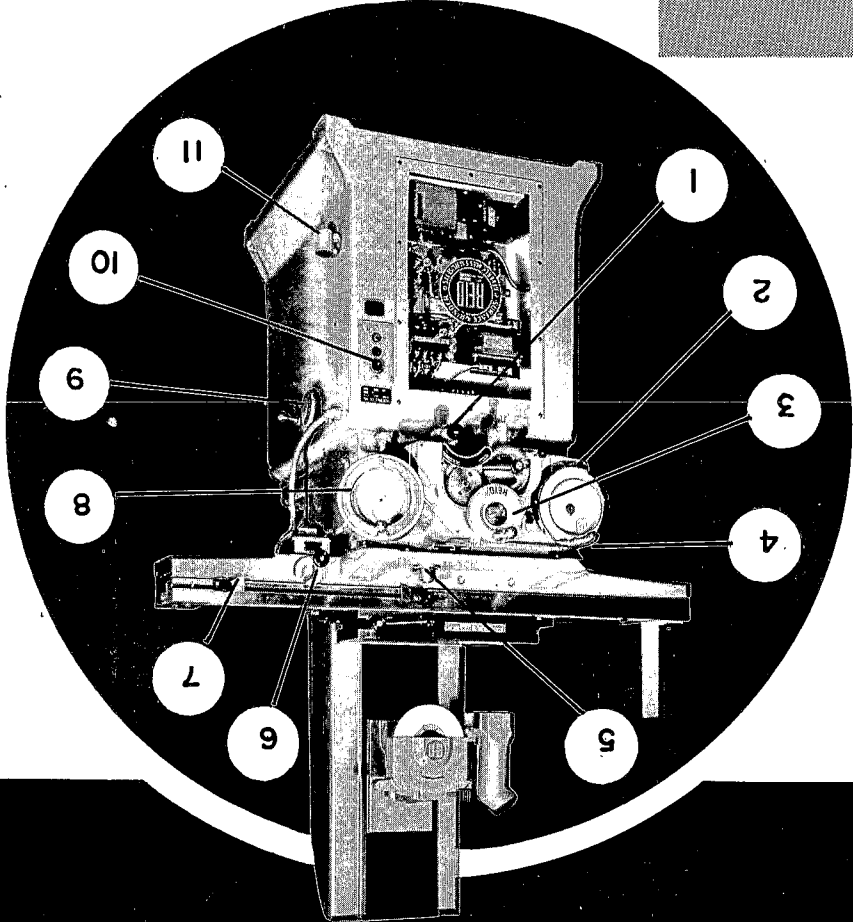
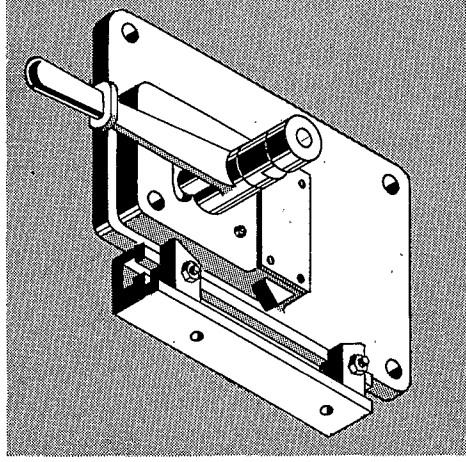

- 1 Cross Feed Selector Control
- 2 Table Traverse Handwheel
- 3 Cross Feed Handwheel
- 4 Power Table Traverse Control
- 5 Cross Slide Lock
- 6 Reversing Switch
- 7 Reversing Dog (2)
- 8 Head Elevating Handwheel
- 9 Variable Table Speed Control
- 10 Rotary Selector Switch
- 11 Oil Filler Cap

ADJUSTMENTS . . .

Power cross feed is adjustable from .006 to .100 by adjusting fulcrum screw from center of crank outward to edge of crank.

Correct tension on table drive belt is obtainable by adjusting belt tensioning device located on the underside of both ends of the table.

In the case of a sticking head assembly, loosen head back, cover screws, flush ways with kerosene, re-oil, and re-tighten screws.

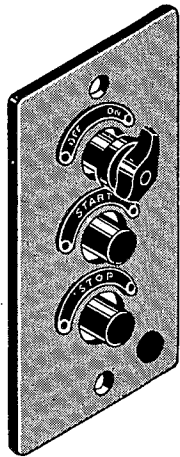

Power feed motor in base switch. Turn off for hand feed operation.

Spindle motor switch. ('ON')

'OFF' Switch. (All power to both motors).

Limit switch handle protruding from right front of cross slide.

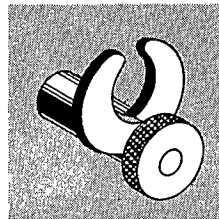

Turn this to right under wiring installation instructions. Prongs are tripped by table dogs for table reversing.

IMPORTANT "DON'TS"

- Don't overtighten table drive belt.
- Don't adjust table dogs too close on power feed models. Short strokes for an extended period of time will overheat motor.
- Don't hold power feed control handle down when power crossfeed is engaged. Damage will occur if pin (see cut opposite page) forces outside dogs.
- Don't engage cross feed unless table is in operation.



GRINDER "TIPS"

Grind the underside of chuck before mounting on table. After bolting chuck to table, grind top of chuck before using machine.

Use correct grade and grit of wheel for work to be ground. When wheel burns or glazes, wheel is too hard.

Wheels should be in balance.

True wheel with diamond dressing tool to clean cutting surface and correct wear in face.

Consult your wheel supplier for recommended grades of wheels for various materials to be ground.



IN BIJUR PUMP USE SOCONY-MOBIL OIL VACTRA #2 OR EQUIVALENT

AUTOMATIC LUBRICATION SYSTEM

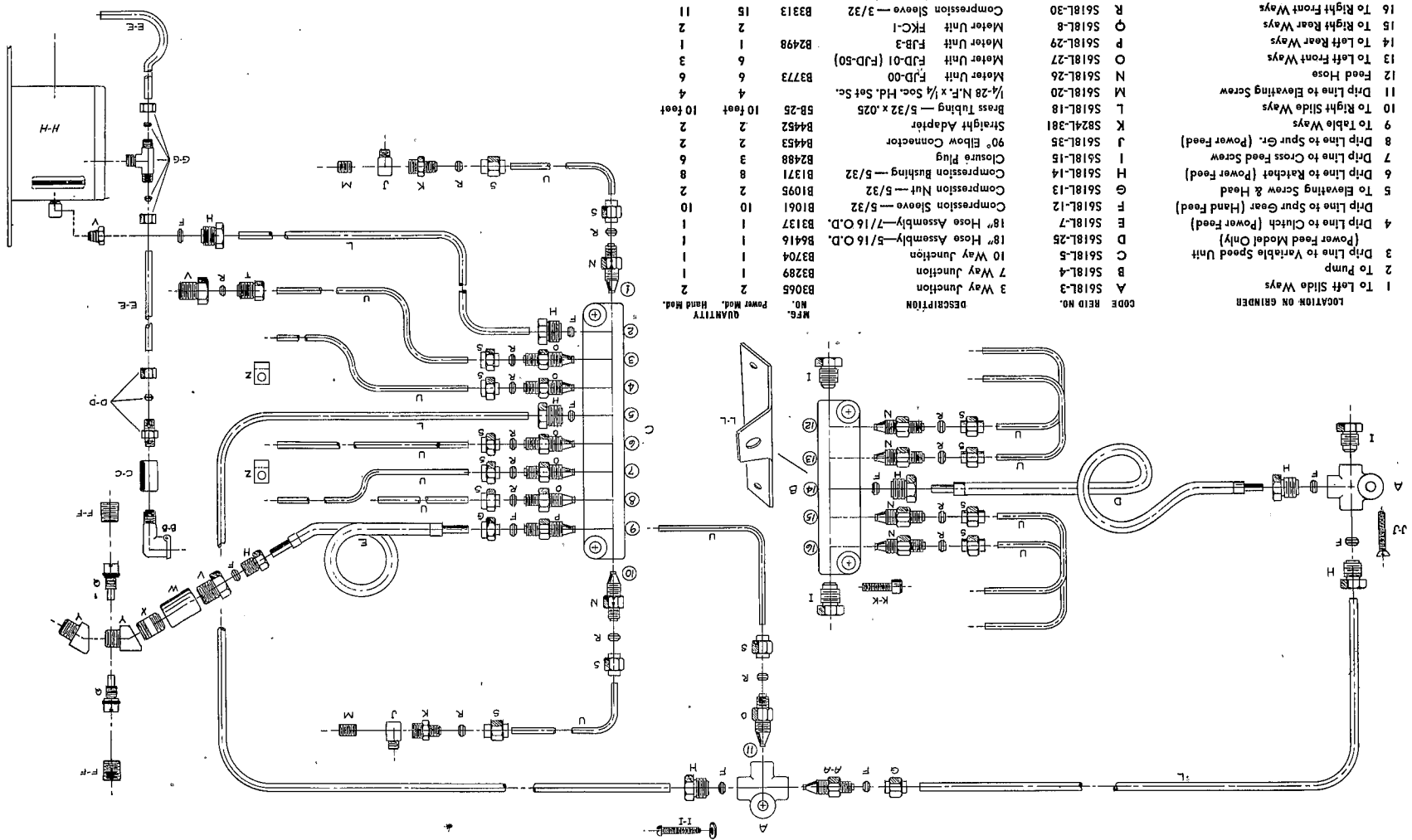

CODE	REID NO.	DESCRIPTION	QUANTITY	MPG.
E-E	5618	Copper Tubing — 3/8 x .032	2	2/2 foot
F-F	5618-21	Hex. Soc. Pipe Plug — 1/4-18 N.P.T.	2	
G-G	5618L-264	Compression Fitting Tee — 3/8 x 1/4	1	
H-H	5618-152-1	Lubricat'g Pump & Motor Assembly.	1	
I-I		Rd. Hd. Mach. Sc. #8-32 N.C. x 1" Ig. & Washer	1	
J-J		Flat Hd. Mach. Sc. #10-32 N.F. x 1 1/2" Ig.	1	
K-K		Soc. Hd. Cap Sc. 1/4-20 NC x 1" Ig.	4	
L-L	618-558	Junction Bracket	1	

CODE	REID NO.	DESCRIPTION	QUANTITY	MPG.
B3065		3 Way Junction	2	
B3289		7 Way Junction	2	
B3704		10 Way Junction	1	
B416		18" Hose Assembly—5/16 O.D.	1	
B3137		18" Hose Assembly—7/16 O.D.	1	
B1061		Compression Sleeve — 5/32	10	
B1095		Compression Nut — 5/32	2	
B1371		Compression Bushing — 5/32	8	
B4488		Closure Plug	6	
B4453		90° Elbow Connector	2	
B4452		Straight Adapter	2	
5B-25		10 foot 10 foot	10	10 foot
5B-25		10 foot 10 foot	10	10 foot
5B-25		10 foot 10 foot	10	10 foot
B3773		Motor Unit FJD-00	6	
B3773		Motor Unit FJD-01 (FJD-50)	6	
B2498		Motor Unit FJB-3	1	
B2498		Motor Unit FKC-1	2	
B313		Compression Sleeve — 3/32	11	
B3610		Compression Nut — 3/32	14	
B3373		Compression Bushing — 3/32	3	
3520		Steel Tubing — 3/32 x .020	15	15 foot
A2835		Straight Adapter	3	
W	S-19-1	1/8 Pipe Coupling	1	
X	S-32-1	1/8 Nipple — 1 1/2 Ig.	1	
Y	5618L-17	Elbow — 30° Connector	2	
Z	5618L-34	Clip	2	
A-A	5618L-11	Motor Unit FJB-00	1	
B-B	5618L-228	Oil Cup — Style "A"	1	
C-C	5618-226	3/8 Pipe Coupling	1	
D-D	5618-227	Straight Compression Adapter	1	

- LOCATION ON GRINDER
- 1 To Left Slide Ways
 - 2 To Pump
 - 3 Drip Line to Variable Speed Unit (Power Feed Modal Only)
 - 4 Drip Line to Clutch (Power Feed)
 - 5 Drip Line to Ratchet (Power Feed)
 - 6 To Elevating Screw & Head
 - 7 Drip Line to Cross Feed Screw
 - 8 Drip Line to Spur Gr. (Power Feed)
 - 9 To Table Ways
 - 10 To Right Slide Ways
 - 11 Drip Line to Elevating Screw
 - 12 Feed Hose
 - 13 To Left Front Ways
 - 14 To Left Rear Ways
 - 15 To Right Rear Ways
 - 16 To Right Front Ways

**BASIC MACHINE ASSEMBLY
ALL MODELS**

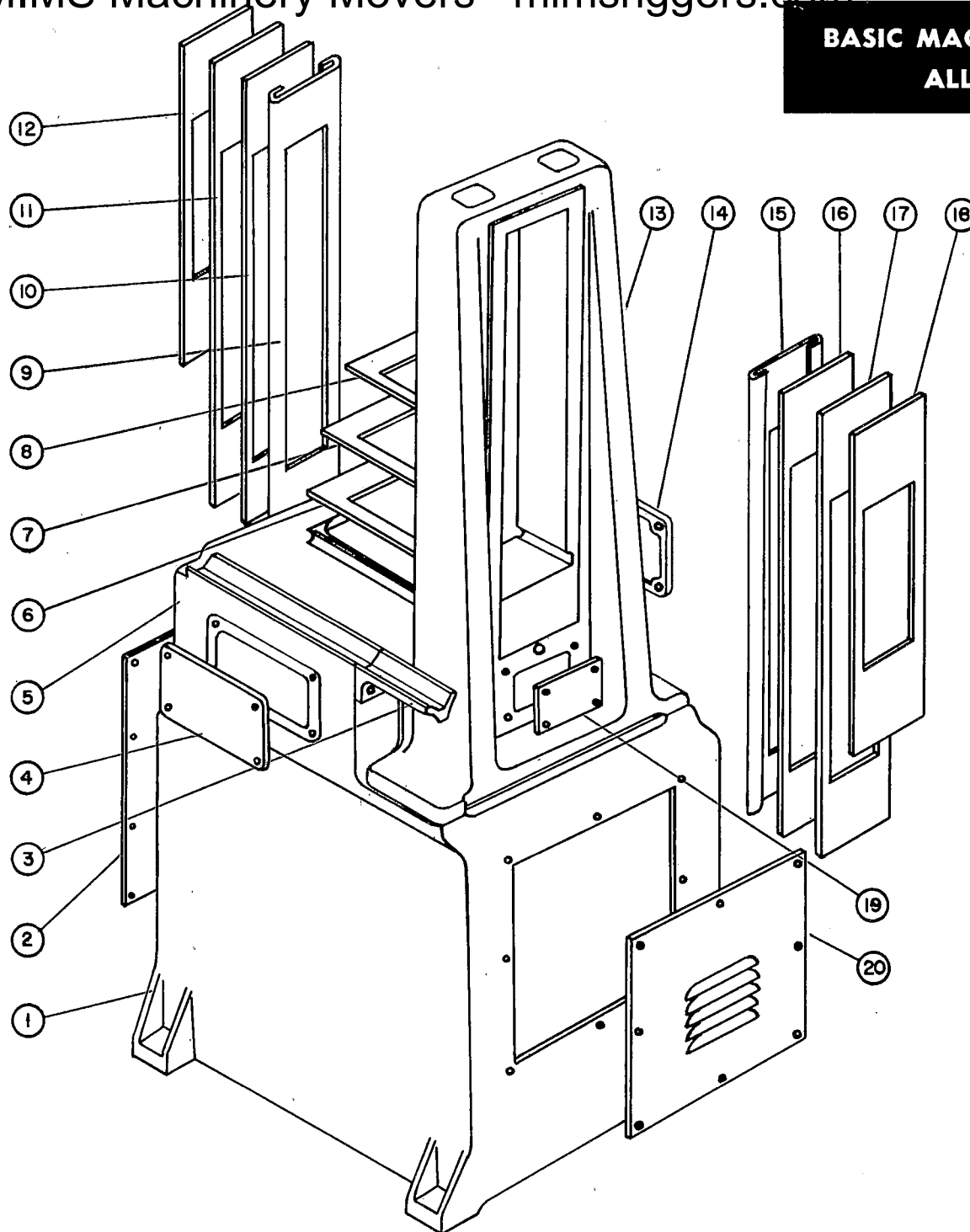

NO.	PART NO.	NAME
1	618-4V-1	Base
2	618-488	Cover
3	618-492	Vee Extension (2)
4	618-496	Side Cover R.H.
5	618-531	Middle Section
6	2-287	Dust Plate (Lower)
7	2-543	Dust Plate (Middle)
8	2-544	Dust Plate (Top)
9	618-286	Dust Plate
10	618-417	Dust Plate
11	618-287	Dust Plate
12	618-288	Dust Plate
13	618-3-1	Arm
14	3-9*	Side Cover L.H.
15	618-286	Dust Plate
16	618-417	Dust Plate
17	618-287	Dust Plate
18	618-288	Dust Plate
19	618-215-1	Plate
20	618-33	Cover

* Used on Model 618H Only

REF. NO.	PART NO.	NAME
1	618-506	Drain Plate
2	2-69	Chip Breaker
3	618-505	Drain Plate Gasket
4	2-294	Stop Pin
5	2-104	Tee Bolt
6	2-102-2	L.H. Stop Block
7		3/16" x 1/2" Pin
8	2-101-1	Reversing Dog
9	2-309-1	L.H. Dog Nut
10	2-104	Tee Bolt
11	2-294	Stop Pin
12	2-103-1	R.H. Stop Block
13		3/16" x 1/2" Pin
14	2-101-1	Reversing Dog
15	2-554	R.H. Dog Nut
16	618-372	Dust Rail (2)
17	2-513-3	Table

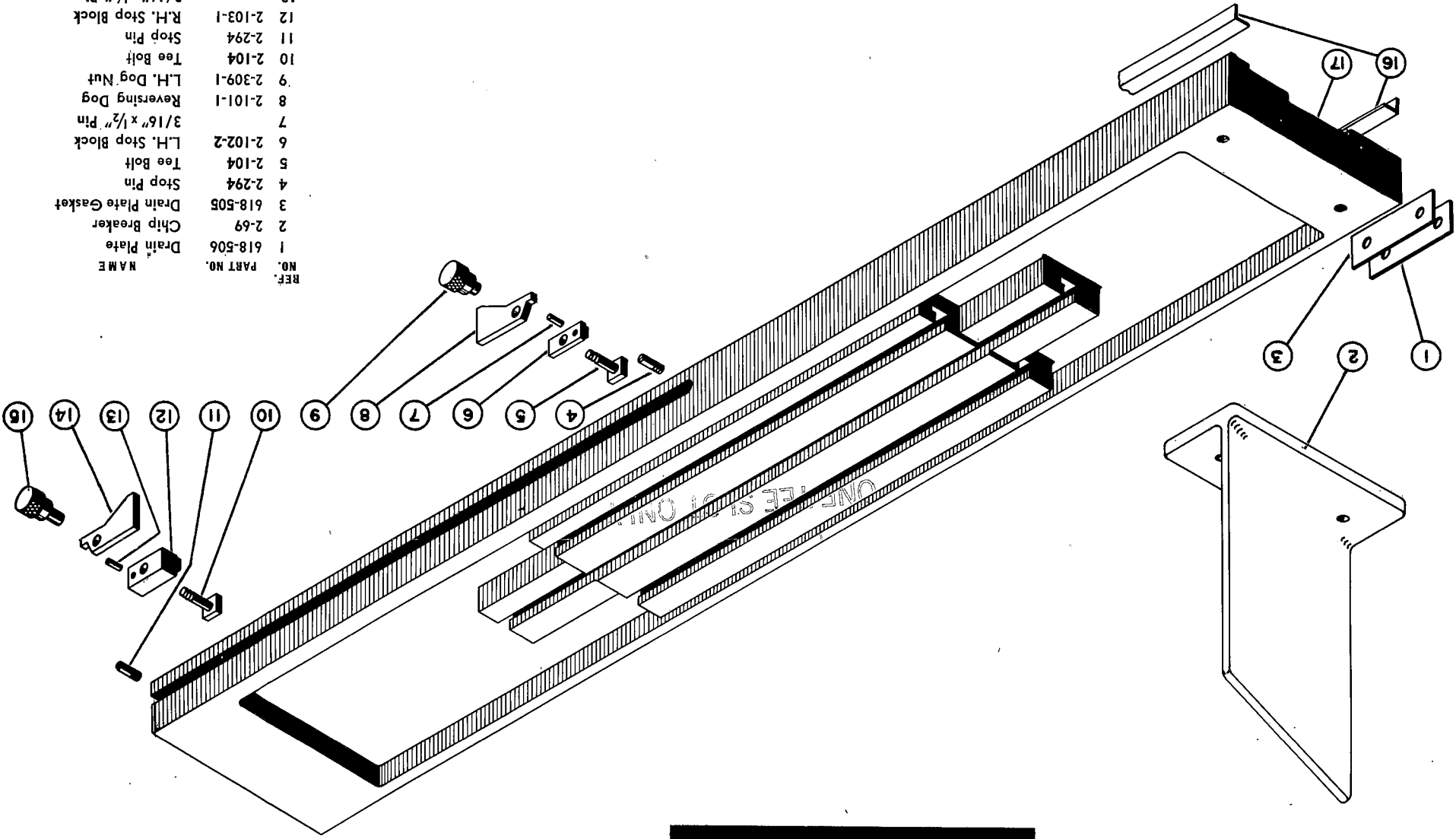

**TABLE ASSEMBLY
MODELS 618 P & 618 PT**

**TABLE ASSEMBLY
MODEL 618 H**

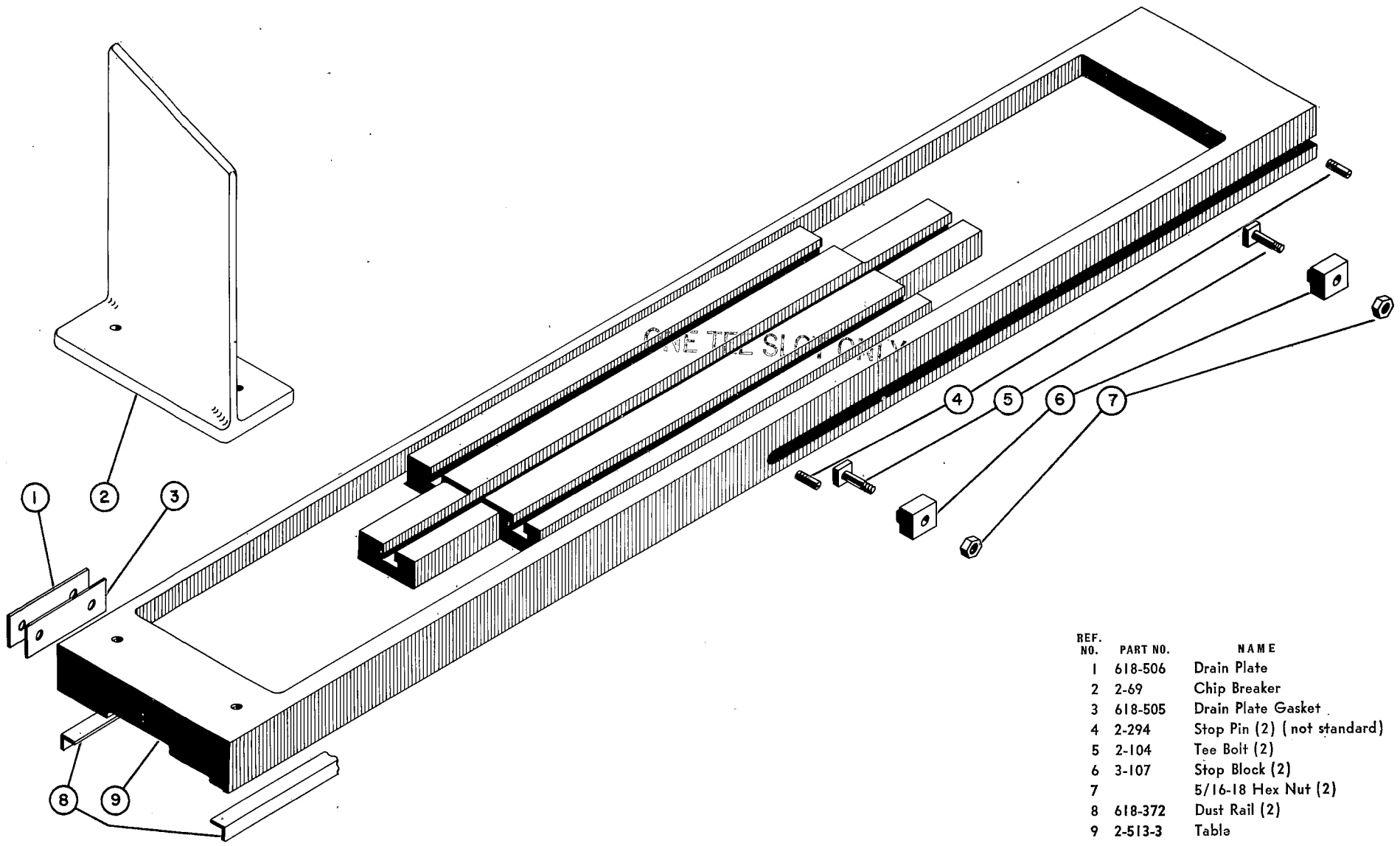

REF. NO.	PART NO.	NAME
1	618-506	Drain Plate
2	2-69	Chip Breaker
3	618-505	Drain Plate Gasket
4	2-294	Stop Pin (2) (not standard)
5	2-104	Tee Bolt (2)
6	3-107	Stop Block (2)
7		5/16-18 Hex Nut (2)
8	618-372	Dust Rail (2)
9	2-513-3	Table

CROSS SLIDE ASSEMBLY
MODELS 618 P & 618 PT

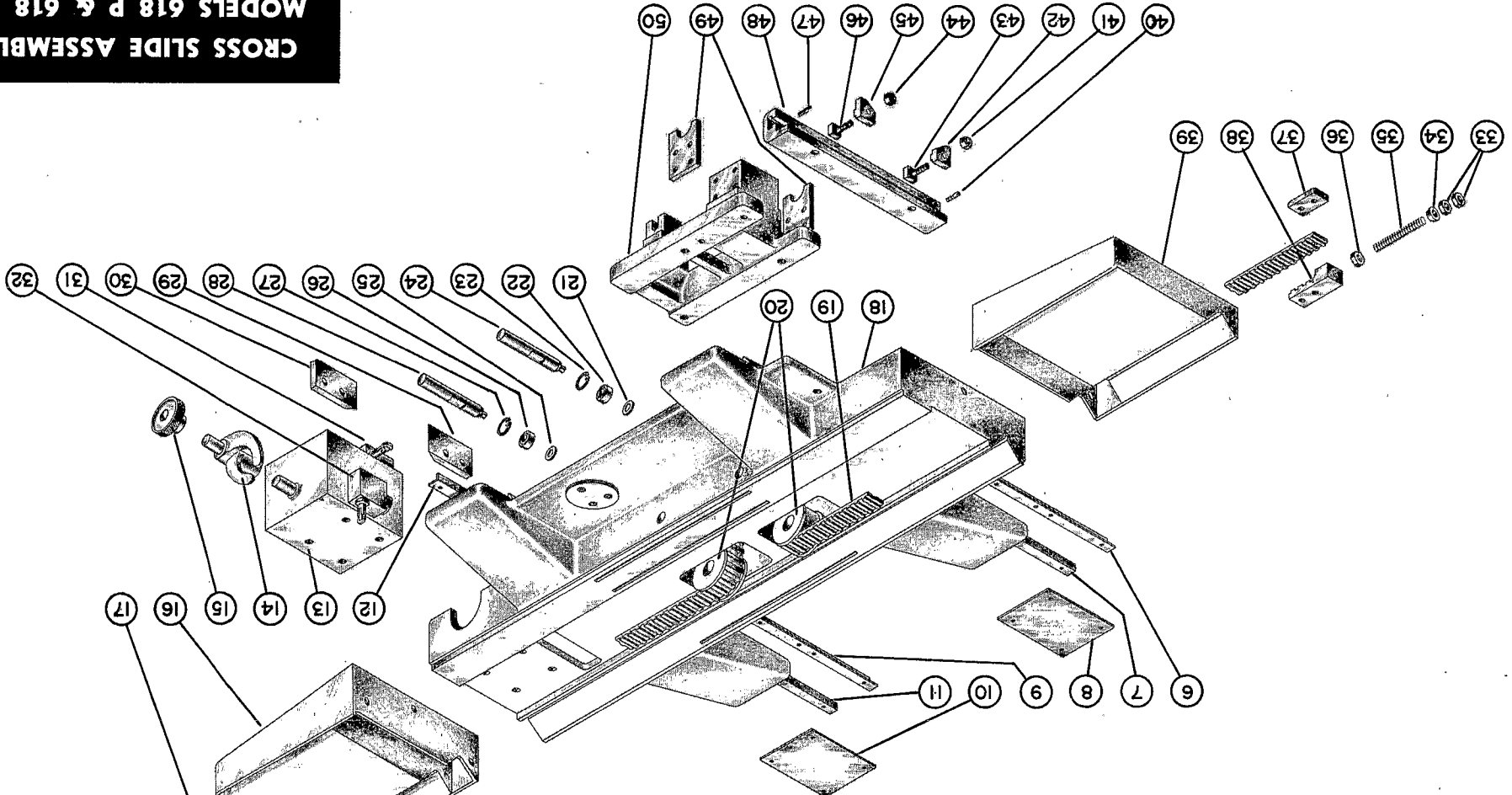

REF. NO.	PART NO.	N A M E
1	618-509	Bolt Holder
2	S247-2	Adjusting Nut
3	618-293	Tension Screw
4	824-344	Washer
5	S247-2	Adjusting Nut
6	618-525	Dust Rail
7	618-524	Dust Rail
8	618-527	Dust Plate
9	618-525	Dust Rail
10	618-527	Dust Plate
11	618-498	Dust Rail
12	618-498	Dust Rail
13	S60-1	Limit Switch
14	618-406	Reversing Dog
15	2-603	Knob
16	618-494-1	R.H. End Guard
17	618-510	Bolt Clamp

18	2-4-5	Cross Slide
19	618-563	Bolt
20	618-290	Idler Pulley
21	#6 Burr Washer	Washer
22	RGX-9-1	Bearing
23	RFX-2	Retaining Ring
24	618-332-1	Shaft (2 used - 1 not shown)
25	#6 Burr Washer	Washer
26	RGX-9-1	Bearing
27	RFX-2	Retaining Ring (2 used - 1 not shown)
28	618-332-1	Shaft
29	618-473*	L.H. Trip Dog
30	618-502*	R.H. Trip Dog
31	S61-1	Micro Switch
32	S61-1	Micro Switch
33	S247-2	Adjusting Nut
34	824-344	Washer
35	618-293	Tension Screw
36	S247-2	Adjusting Nut
37	618-510	Bolt Clamp
38	618-509	Bolt Holder
39	618-495-1	L.H. End Guard
40	2-294*	Stop Pin
41	5/16"-18 Hex Nut	Hex Nut
42	2-183*	L.H. Dog
43	2-104*	Toe Bolt
44	5/16"-18 Hex Nut	Hex Nut
45	2-182*	R.H. Dog
46	2-104*	Toe Bolt
47	2-294*	Stop Pin
48	2-168*	Knock Off Bar
49	618-419	Nut Bracket
50	618-418	Nut Bracket

* Used on Model 618 P Only

REF. NO.	PART NO.	N A M E
1	618-509	Bolt Holder
2		5/16"-18 Hex Nut
3	618-293	Tension Screw
4	824-344	Washer
5		5/16"-18 Hex Nuts
6	618-525	Dust Rail
7	618-524	Dust Rail
8	618-527	Dust Plate
9	618-525	Dust Rail
10	618-527	Dust Plate
11	618-526	Dust Rail
12	618-580	Dust Rail
13	3-246-1	Stop Base
14	3-288	Lock Screw
15	3-286-2	Plunger
16	3-287-1	Knob
17	618-494-1	R.H. End Guard
18	618-510	Belt Clamp
19	2-4-5	Cross Slide
20	618-563	Belt

REF. NO.	PART NO.	N A M E
21	618-290	Idler Rolls
22		#6 Burr Washer
23	RGX-9-1	Bearing
24	RFX-2	Retaining Ring (2 used - 1 not shown)
25	618-332-1	Shaft
26		#6 Burr Washer
27	RGX-9-1	Bearing
28	RFX-2	Retaining Ring (2 used - 1 not shown)
29	618-332-1	Shaft
30		5/16"-18 Hex Nuts
31	824-344	Washer
32	618-293	Tension Screw
33		5/16"-18 Hex Nut
34	618-509	Bolt Holder
35	618-510	Belt Clamp
36	618-495-1	L.H. End Guard
37	618-419	Wear Plate
38	618-418	Nut Bracket

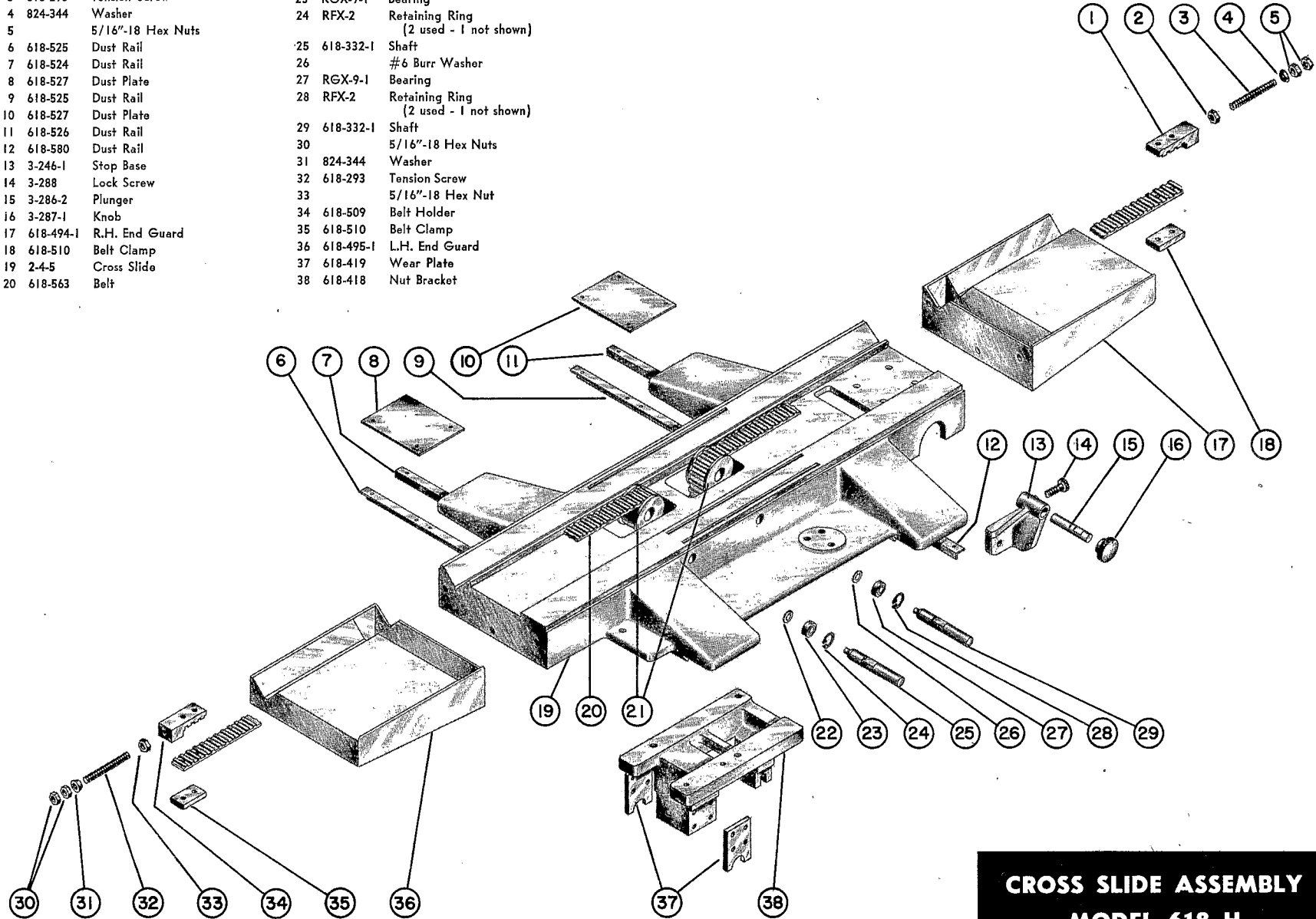

**CROSS SLIDE ASSEMBLY
MODEL 618 H**

REF. NO.	PART NO.	NAME
1	S618-235	Bushing
2	618-519	Flange
3	618-522	Locking Pin
4	618-521	Locking Skid
5	S10-8	Washer
6	C-5121	Plate
7	618-570	Bracket

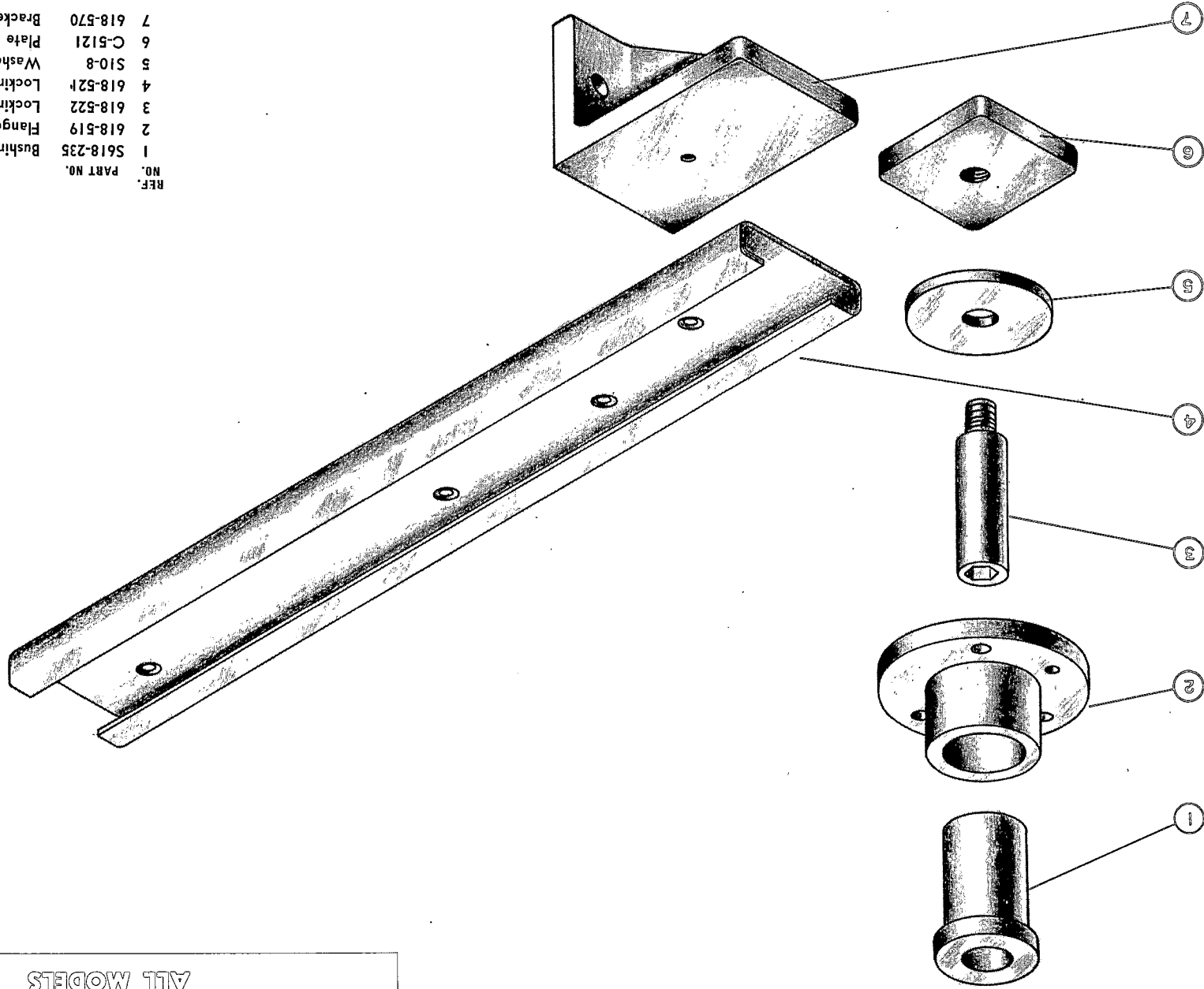

GROSS SLIDE-LOCKING VICE ASSEMBLY
ALL MODELS

**CROSS FEED ASSEMBLY
MODEL 618 P**

REF. NO.	PART NO.	NAME	REF. NO.	PART NO.	NAME
1	S618-149	Ring	23	618-452	Brake Shoe
2		5/16-18 Standard Nut	24	S618-146	Locknut
3	2-100	Collar		S618-145	Lockwasher (not shown)
4	S618-154	Bushing	25	S618-144	Bearing - Cone
5	2-93	Rack	26	S618-144	Bearing - Cup
6	2-99	Sleeve	27	S618-146	Locknut
7	2-98	Sleeve - Bolt		S618-145	Lockwasher (not shown)
8	618-441	Cross Feed Crank	28	618-440	64 Tooth Gear
9	618-442	Bearing Cap	29	618-435	Gear Box
10	S618-139	Bearing	30	S618-144	Bearing - Cup
11	S618-220	Bushing	31	S618-144	Bearing - Cone
12	618-443	Spacer (long)	32	S618-144	Bearing - Cone
13		3/8-24 Lt Jm Nut (3 req.)	33	S-10-7	Washer
14	618-460	26 Tooth Gear (3 req.)	34	S618-144	Bearing - Cup
15	S618-151	Cam Roll (3 req.)	35	S618-144	Bearing - Cup
16	S-55	Handle	36	S618-147	Hypro - Key
17	618-569	Handwheel	37	S618-144	Bearing - Cone
18	618-467	Knurled Nut	38	S-10-7	Washer
19	618-466	Hinge Screw	39	618-438	Shaft
20	S618-67	Spring	40		1/4-20 Nut (2 req.)
21	2-526-1	Adjusting Screw	41	S-47-6	Bearing
22	2-585	Lock Case	42	618-439	Feed Pawl Case

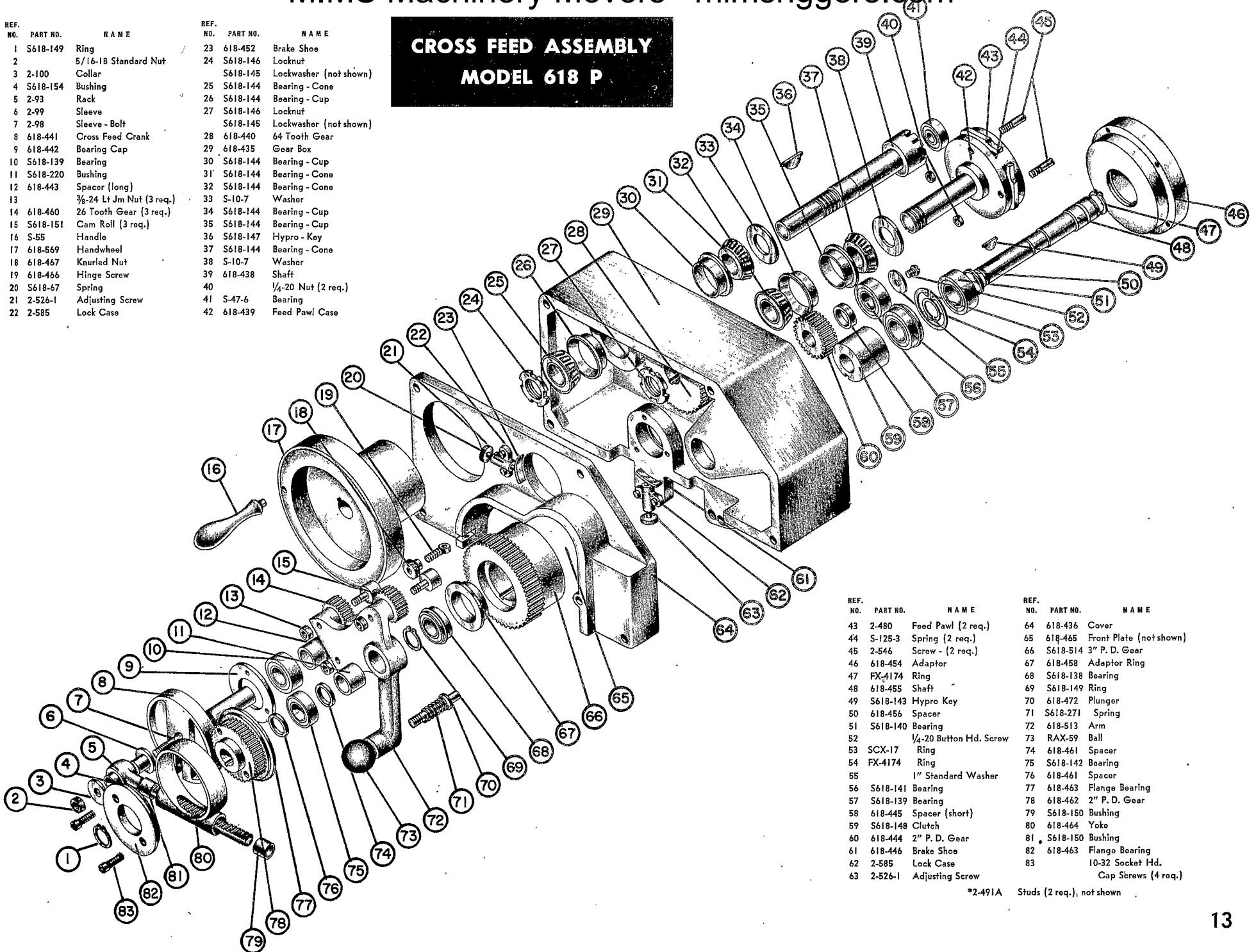

REF. NO.	PART NO.	NAME	REF. NO.	PART NO.	NAME
43	2-480	Feed Pawl (2 req.)	64	618-436	Cover
44	S-125-3	Spring (2 req.)	65	618-465	Front Plate (not shown)
45	2-546	Screw - (2 req.)	66	S618-514	3" P. D. Gear
46	618-454	Adaptor	67	618-458	Adaptor Ring
47	FX-4174	Ring	68	S618-138	Bearing
48	618-455	Shaft	69	S618-149	Ring
49	S618-143	Hypro Key	70	618-472	Plunger
50	618-456	Spacer	71	S618-271	Spring
51	S618-140	Bearing	72	618-513	Arm
52		1/4-20 Button Hd. Screw	73	RAX-59	Ball
53	SCX-17	Ring	74	618-461	Spacer
54	FX-4174	Ring	75	S618-142	Bearing
55		1" Standard Washer	76	618-461	Spacer
56	S618-141	Bearing	77	618-463	Flange Bearing
57	S618-139	Bearing	78	618-462	2" P. D. Gear
58	618-445	Spacer (short)	79	S618-150	Bushing
59	S618-148	Clutch	80	618-464	Yoke
60	618-444	2" P. D. Gear	81	S618-150	Bushing
61	618-446	Brake Shoe	82	618-463	Flange Bearing
62	2-585	Lock Case	83		10-32 Socket Hd. Cap Screws (4 req.)
63	2-526-1	Adjusting Screw			

*2-491A Studs (2 req.), not shown

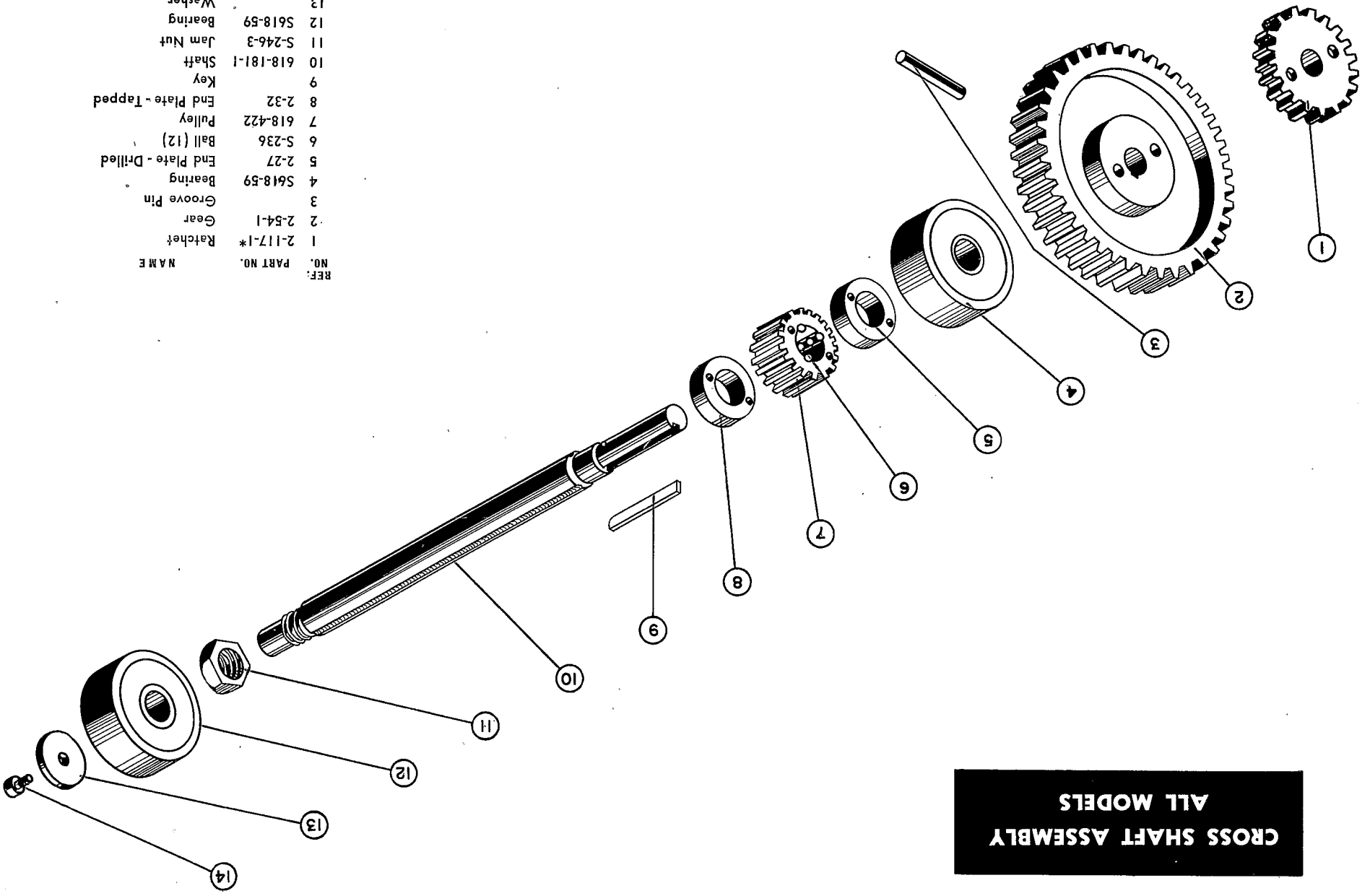

**CROSS SHAFT ASSEMBLY
ALL MODELS**

REF. PART NO. NAME

1 2-117-1* Ratchet

2 2-54-1 Gear

3 Groove Pin

4 S618-59 Bearing

5 2-27 End Plate - Drilled

6 S-236 Ball (12)

7 618-422 Pulley

8 2-32 End Plate - Tapped

9 Key

10 618-181-1 Shaft

11 S-246-3 Jam Nut

12 S618-59 Bearing

13 Washer

14 3/8-16 x 1/2 LG. Cap Screw

* Used on Power Feed Machines Only

**FRONT PLATE ASSEMBLY
MODEL 618 H**

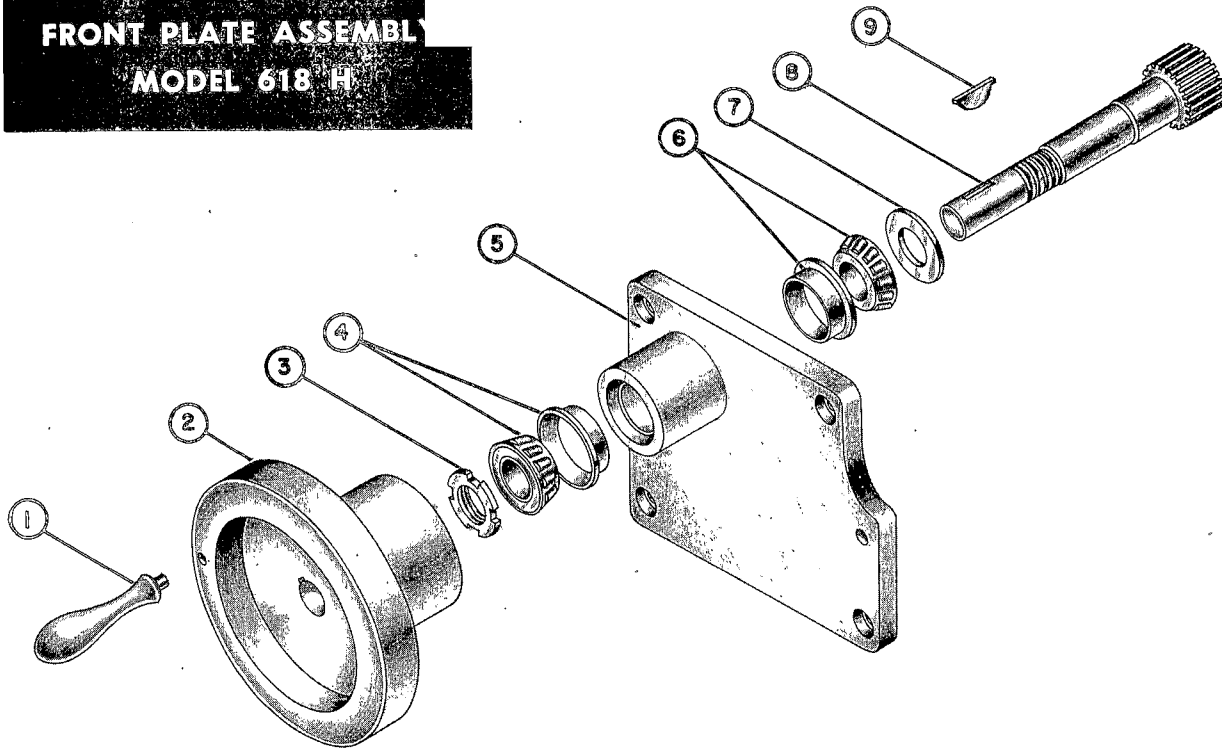

REF. NO.	PART NO.	NAME
1	S-55	Handle
2	618-569	Handwheel
3	S618-146	Locknut
	S618-145	Lockwasher (not shown)
4	S618-144	Bearing
5	618-511	Front Plate
6	S618-144	Bearing
7	S10-7	Washer
8	618-512	Shaft & Gear
9	S618-147	Hypro Key

REF. NO.	PART NO.	NAME
1	S-55	Handle
2	618-569	Handwheel
3	S618-146	Locknut
	S618-145	Lockwasher (not shown)
4	S618-144	Bearing
5	618-511	Front Plate
6	S618-144	Bearing
7	S10-7	Washer
8	S618-147	Hypro Key
9	618-438	Clutch Shaft
10	S47-6	Bearing

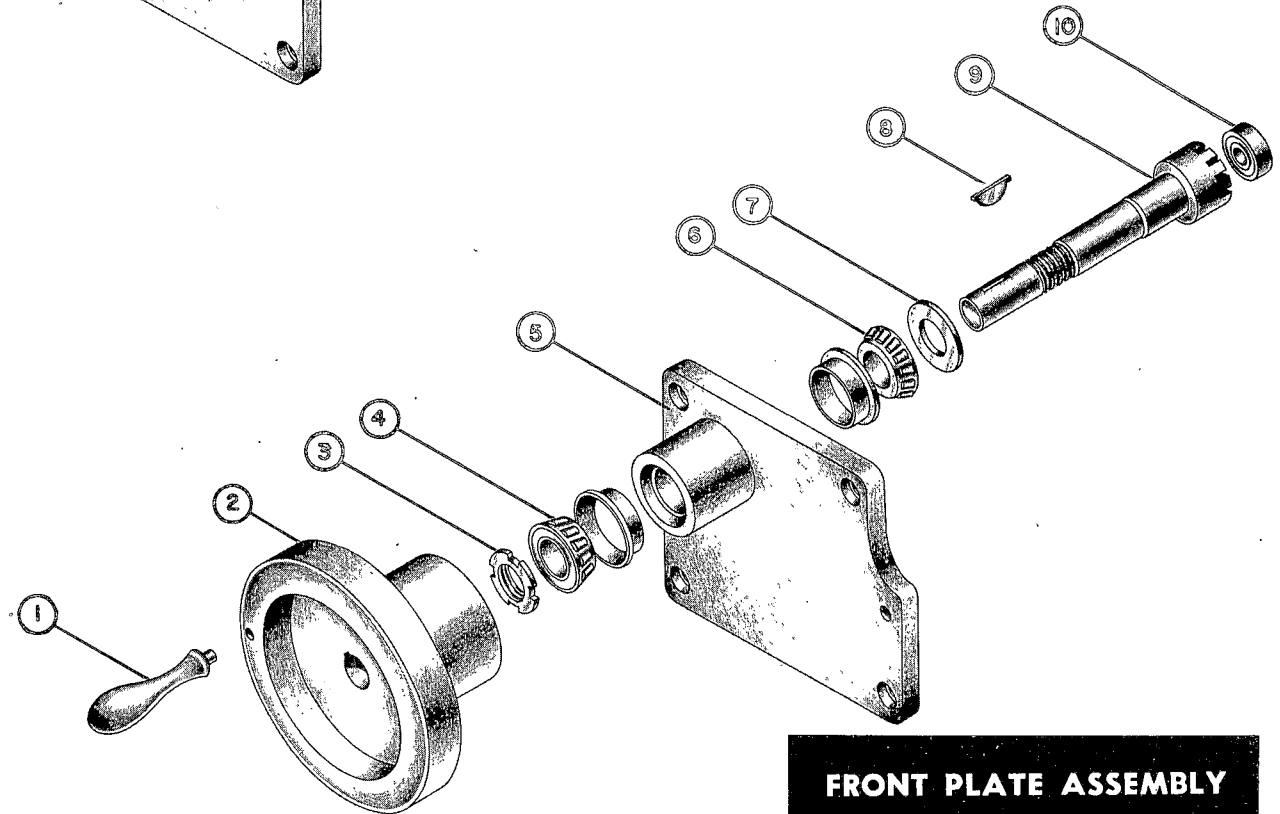

**FRONT PLATE ASSEMBLY
MODEL 618 PT**

ALL MODELS
HEAD ELEVATING SCREW ASSEMBLY

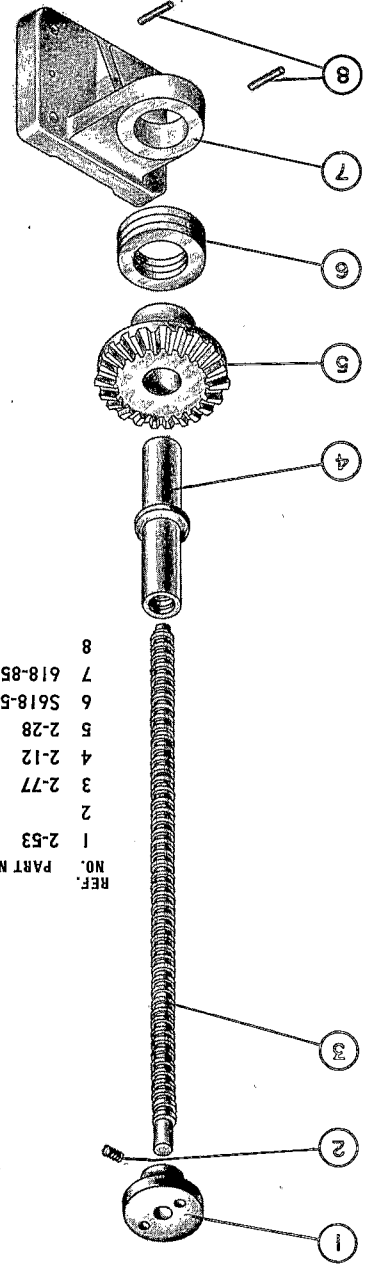

REF. NO.	PART NO.	NAME
1	2-53	Collar
2	2	$\frac{3}{8}$ "-16 x $\frac{3}{8}$ " Long S.H.S.S.
3	2-77	Screw
4	2-12	Nut
5	2-28	Gear
6	S618-58	Bearing
7	618-85	Support
8		$\frac{1}{4}$ " x 1" Long Groove Pin

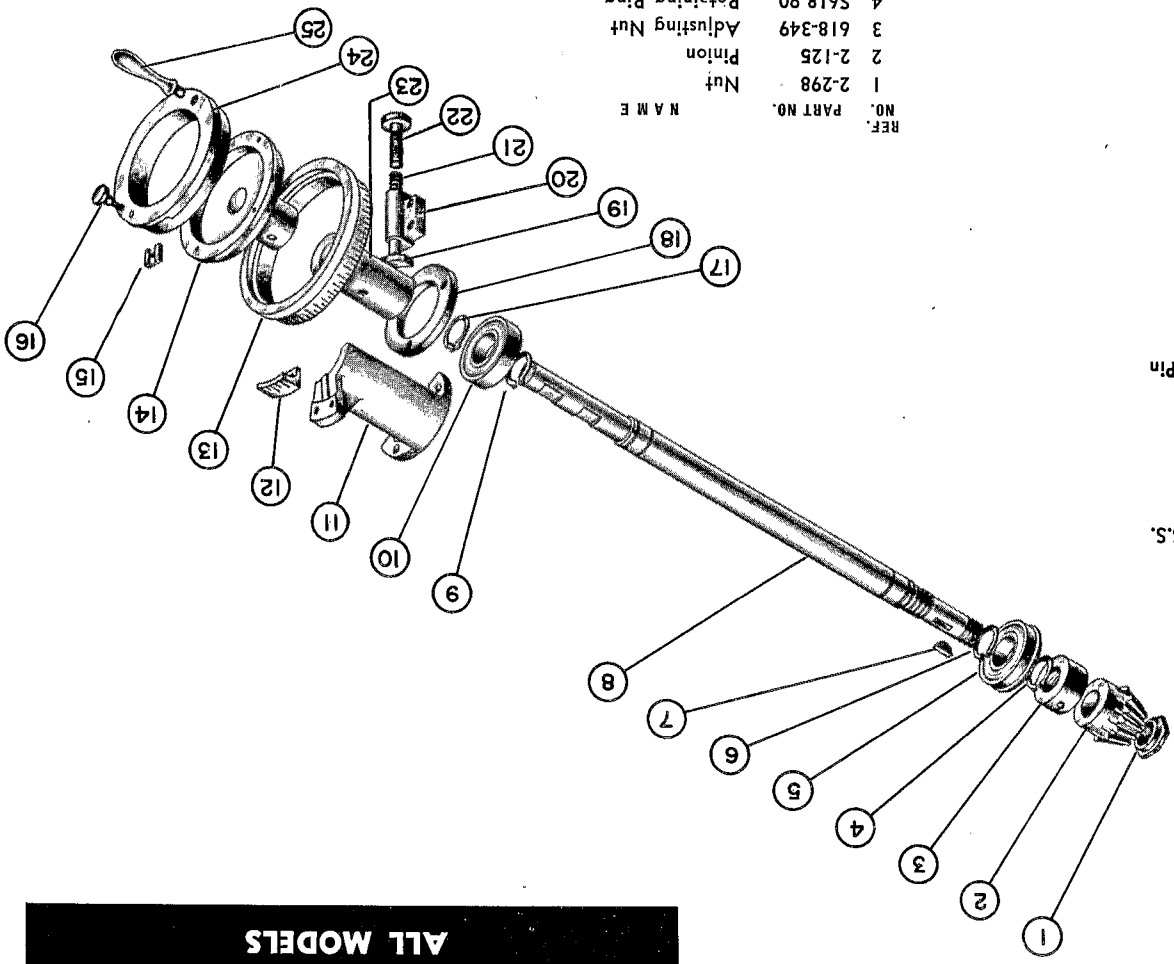

REF. NO.	PART NO.	NAME
1	2-298	Nut
2	2-125	Pinion
3	618-349	Adjusting Nut
4	S618-90	Retaining Ring
5	S618-89	Rear Bearing
6	S618-90	Retaining Ring
7		#9 Woodruff Key
8	618-348	Shaft
9	S618-90	Retaining Ring
10	S618-88	Front Bearing
11	618-564	Bracket
12	824-147	Vernier Pointer
13	824-142	Graduated Rim
14	618-503	Handwheel
15	824-128	Clamp
16	824-148	Clamp Screw

17	S618-90	Retaining Ring
18	618-347	Retainer Ring
19	3-282-1	Lock
20	3-283-1	Case
21	S125-1	Lock Spring
22	3-285-1	Adjusting Screw
23	2-517-1	Spacer
24	824-141	Wheel Rim
25	S-55	Handle

ALL MODELS
HEAD ELEVATING SHAFT ASSEMBLY

KNOCK-OFF HOUSING ASSEMBLY
MODELS 618 P & 618 PT

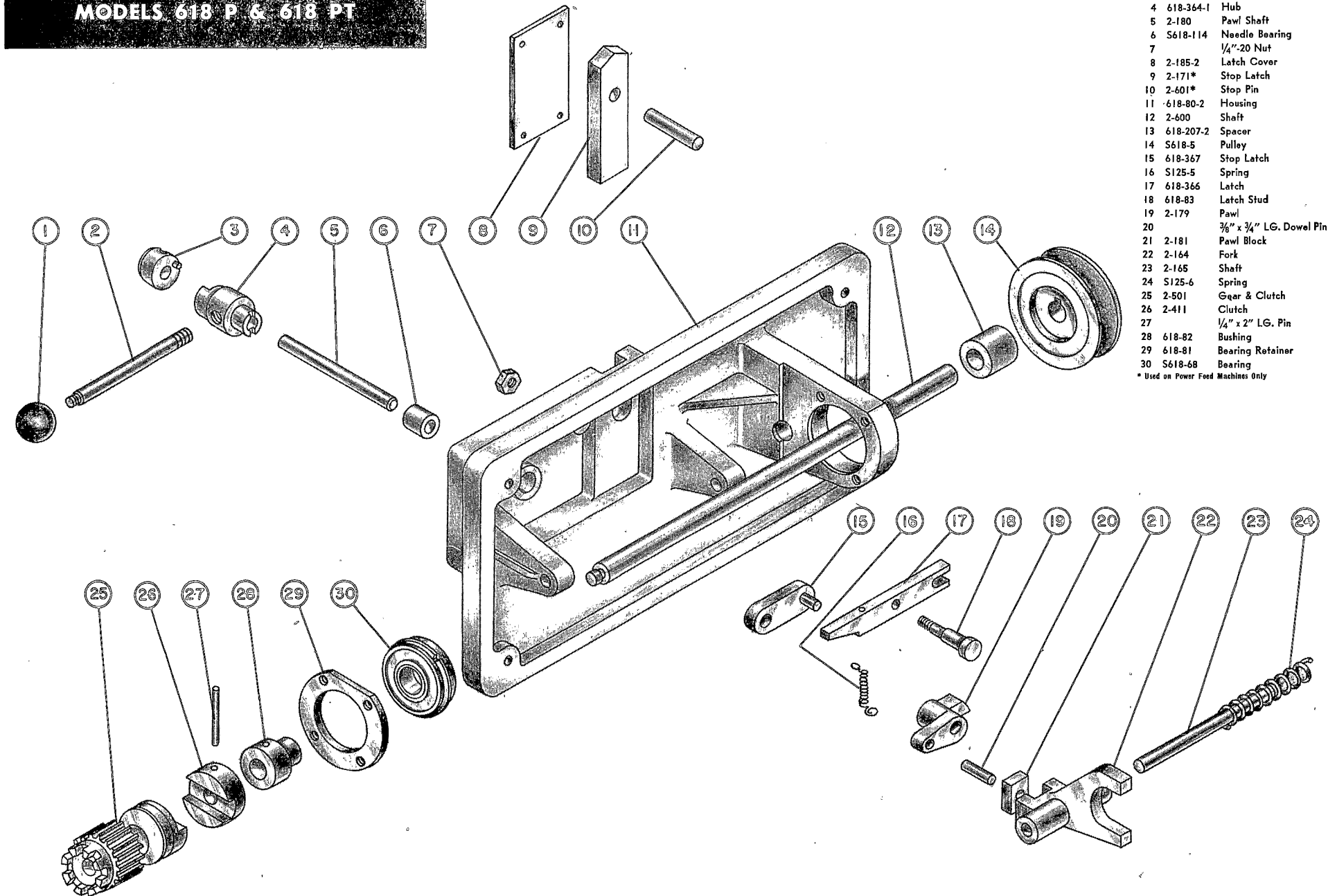

REF. NO.	PART NO.	NAME
1	RAX-59	Ball
2	618-365	Lever
3	618-331	Collar
4	618-364-1	Hub
5	2-180	Pawl Shaft
6	S618-114	Needle Bearing
7		1/4\"-20 Nut
8	2-185-2	Latch Cover
9	2-171*	Stop Latch
10	2-601*	Stop Pin
11	618-80-2	Housing
12	2-600	Shaft
13	618-207-2	Spacer
14	S618-5	Pulley
15	618-367	Stop Latch
16	S125-5	Spring
17	618-366	Latch
18	618-83	Latch Stud
19	2-179	Pawl
20		3/8" x 3/4" LG. Dowel Pin
21	2-181	Pawl Block
22	2-164	Fork
23	2-165	Shaft
24	S125-6	Spring
25	2-501	Gear & Clutch
26	2-411	Clutch
27		1/4" x 2" LG. Pin
28	618-82	Bushing
29	618-81	Bearing Retainer
30	S618-68	Bearing

* Used on Power Feed Machines Only

HEAD ASSEMBLY
ALL MODELS

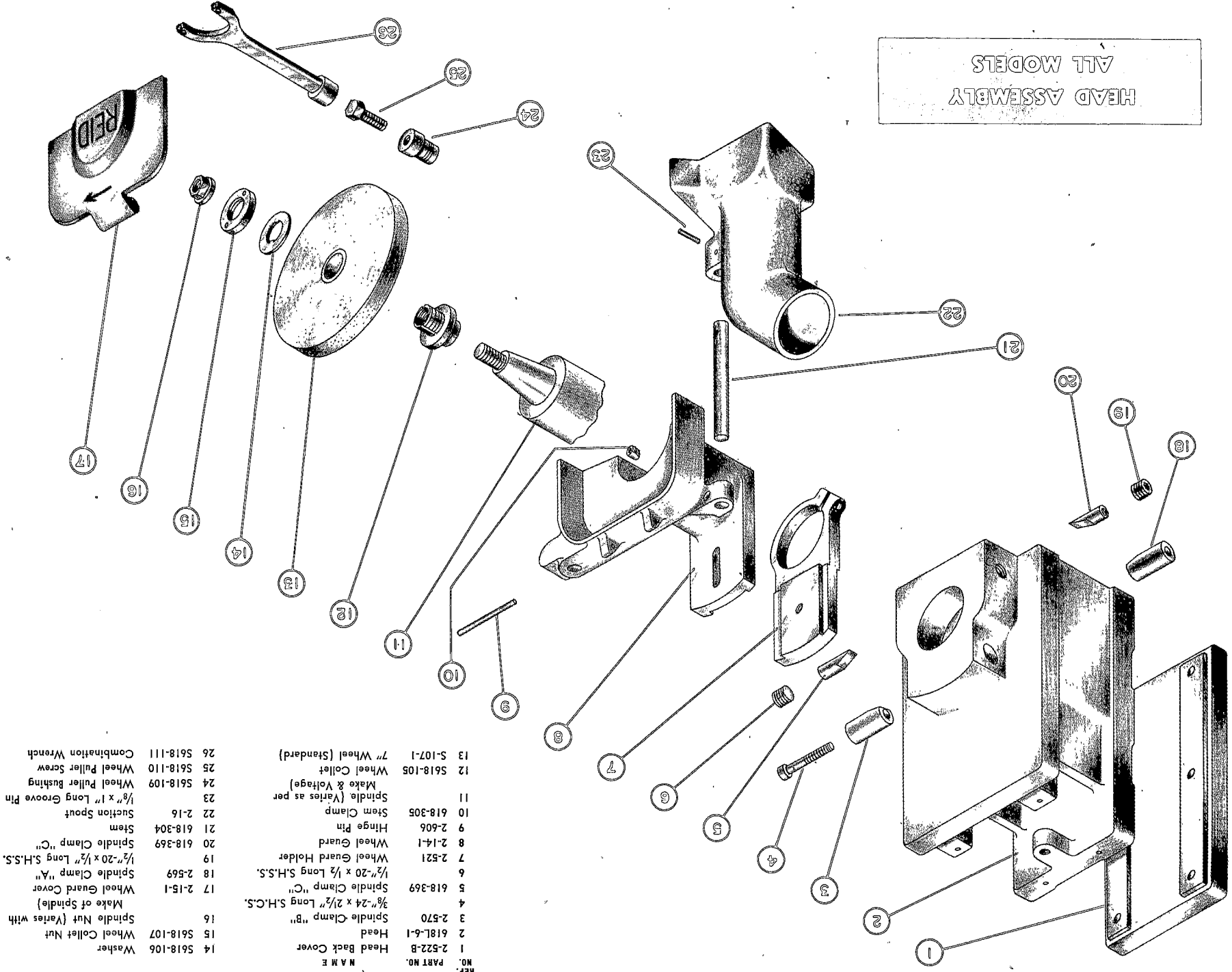

REF. NO.	PART NO.	NAME
1	2-522-B	Head Back Cover
2	618L-6-1	Head
3	2-570	Spindle Clamp "B"
4	618-369	Spindle Clamp "C"
5	618-369	Spindle Clamp "A"
6	1/2"-20 x 1/2" Long S.H.S.S.	Wheel Guard Holder
7	2-521	Wheel Guard
8	2-14-1	Hinge Pin
9	2-606	Stem Clamp
10	618-305	Spindle (Varies as per Make & Voltage)
11		Spindle Collar
12	5618-105	7" Wheel (Standard)
13	5-107-1	Washer
14	5618-106	Wheel Collar Nut
15	5618-107	Wheel Collar Nut
16		Spindle Nut (Varies with Make of Spindle)
17	2-15-1	Wheel Guard Cover
18	2-569	Spindle Clamp "A"
19	1/2"-20 x 1/2" Long S.H.S.S.	Spindle Clamp "C"
20	618-369	Spindle Clamp "C"
21	618-304	Stem
22	2-16	Suction Spout
23		1/8" x 1" Long Groove Pin
24	5618-109	Wheel Puller Bushing
25	5618-110	Wheel Puller Screw
26	5618-111	Combination Wrench

ELECTRICAL CONTROL PANEL COMPONENTS

MODELS 618 P & 618 PT

PART NO.	NAME
618-489	Switch Panel
618-560	Clamp for Capacitor
S67-1	Reversing Switch
S618-41	Rotary - Start - Stop Switch
S618-42	Terminal Strip
S618-152-1	Lubricating Unit & Motor
S618-221	Heaters — 440V
S618-222	Heaters — 550V
S618-223	Transformer — 550V
S618-224-1	Reset Button
S618-224-2	Reset Button (Reversing Switch)
S618-245	Heaters — 220V
S618-249	Magnetic Starter 2 Phase
S618-250	Overload Block
S618-251	Terminal Strip
S824-260	Transformer 220/440
S824-263	Magnetic Starter 3 Phase

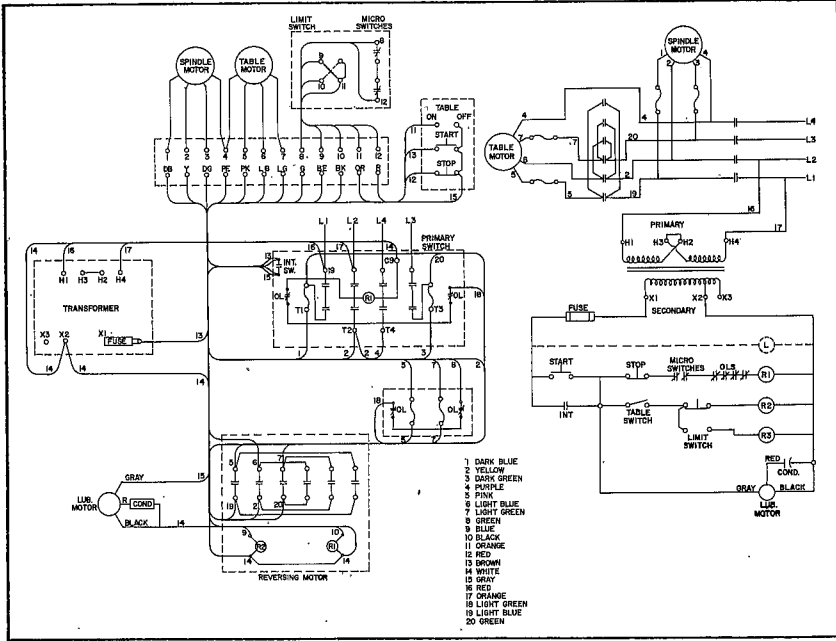

**MODELS 618 P & 618 PT
2 PHASE**

**TABLE MOTOR and SPINDLE
Motor Voltages to be the same as Machine
Power Supply as per customer's specifica-
tions.**

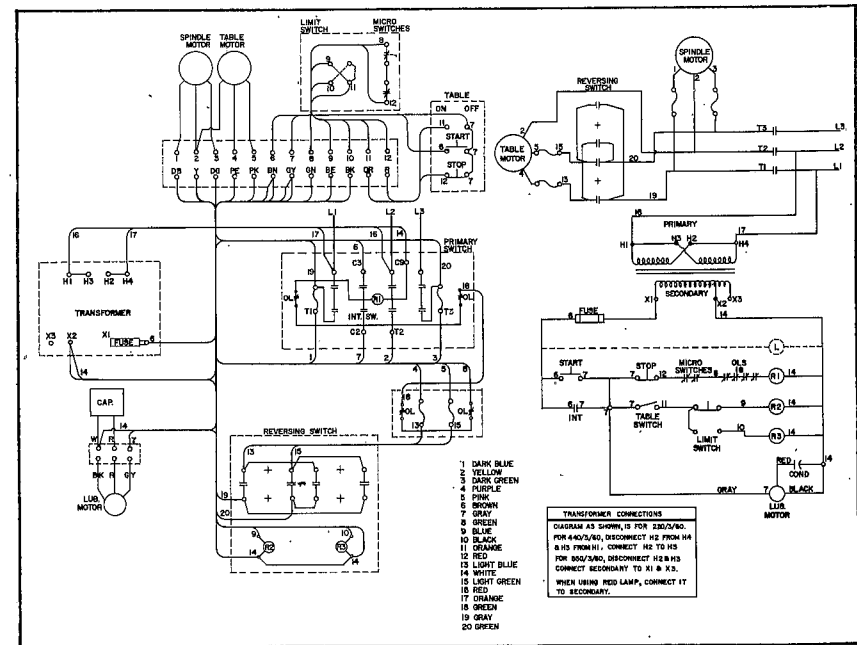

**MODELS 618 P & 618 PT
3 PHASE**

Spindle Motor Voltage to be the same as Machine Power Supply as per customer's specifications.

2 PHASE
MODEL 618 H

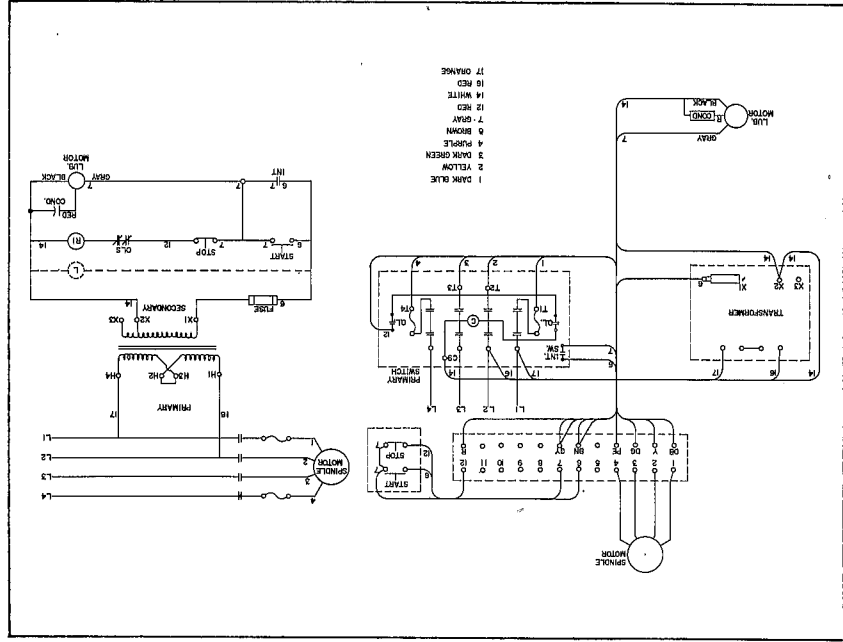

- | PART NO. | NAME |
|------------|--------------------------|
| 618-489 | Switch Panel |
| 618-560 | Clamp for Capacitor |
| S618-251 | Terminal Strip |
| S618-42 | Terminal Strip |
| S618-152-1 | Lubricating Unit & Motor |
| S618-221 | Heaters — 440V |
| S618-222 | Heaters — 550V |
| S618-223 | Transformer — 550V |
| S618-224-1 | Reset Button |
| S618-229 | Start & Stop Switch |
| S618-245 | Heaters — 220V |
| S618-249 | Magnetic Starter 2 Phase |
| S618-250 | Overload Block |
| S824-260 | Transformer — 220/440 |
| S824-263 | Magnetic Starter 3 Phase |

ELECTRICAL CONTROL PANEL COMPONENTS
MODEL 618 H

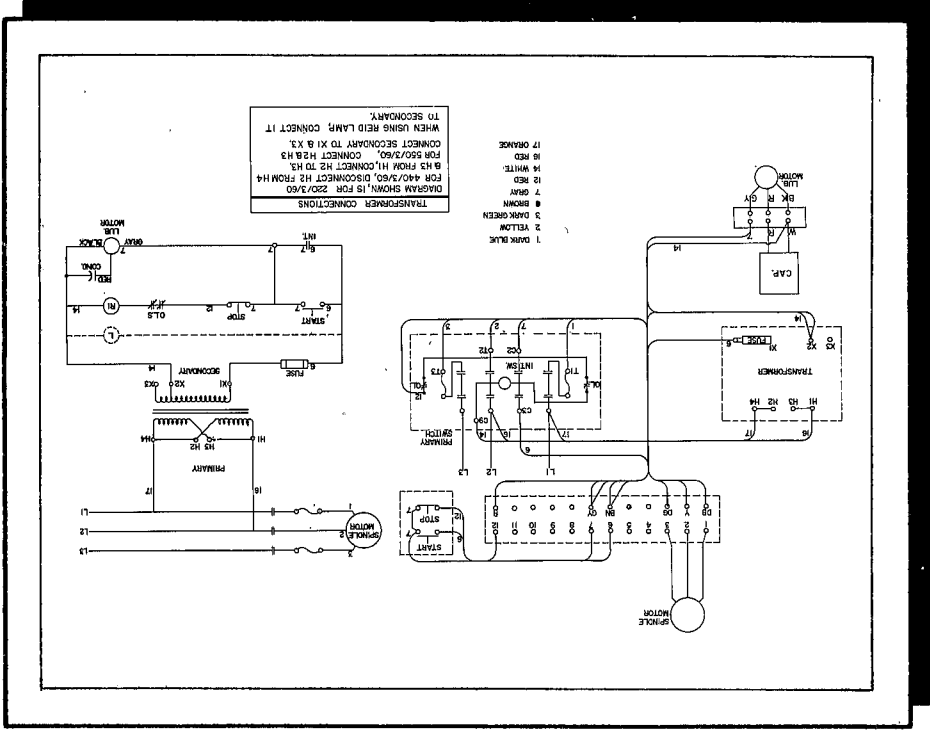

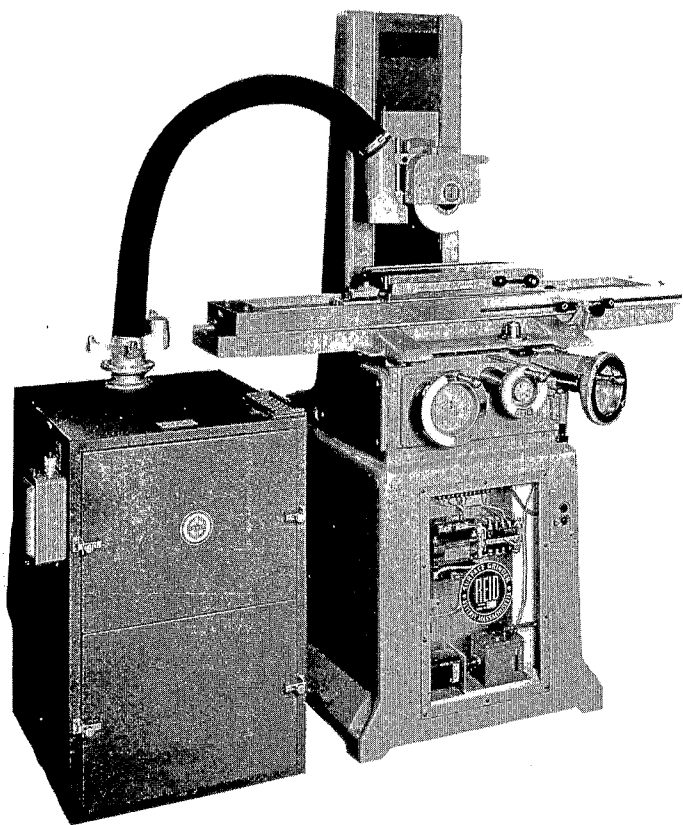

**MODEL 618 H WITH
 DUST COLLECTOR . . .**

Reid features the No. 66 Dust Collector, which may be readily installed for use with your Reid Surface Grinder. Unit is cabinet type, operated by a separate electric motor which effectively draws off all grit and dust, controlling dust over the entire working area. The No. 66 unit will handle dust requirements of a single Reid Grinder; larger models are available with hose connections to handle two or more units.

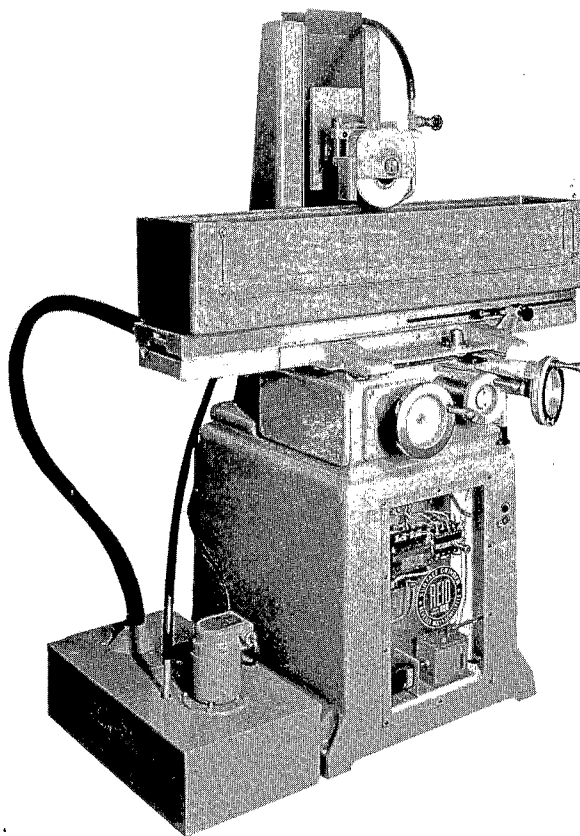

**MODEL 618 H WITH WET
 GRIND ATTACHMENT . . .**

The Reid Wet Grinding Attachment features a flow of coolant over the work from a coolant tank with motor-driven pump. Guards are placed on the table; effectively shielding the work being ground by this method. These guards are adjustable for work of varying heights.

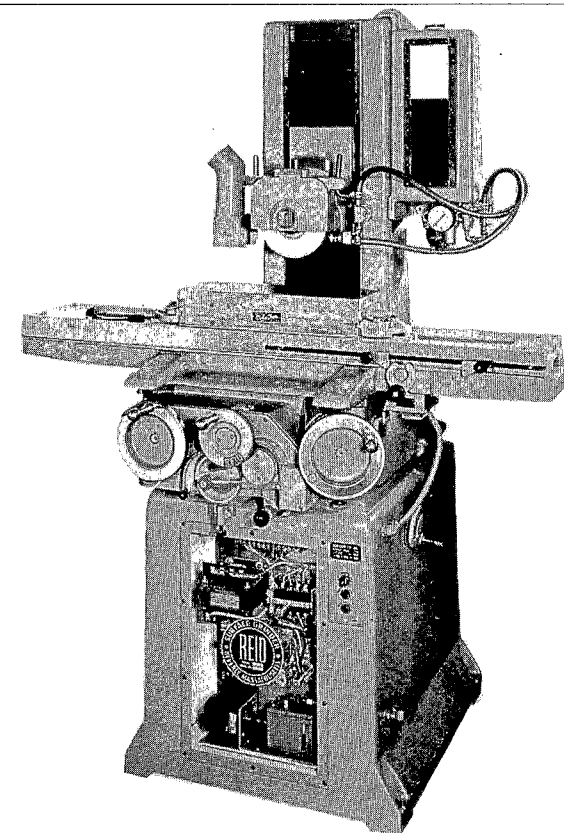

**MODEL 618 P WITH COOL
 GRIND ATTACHMENT . . .**

The Reid Cool Grinding Attachment features a jet of spray coolant directed at point of grinding wheel contact under pressure. This jet spray eliminates need for return tray and pump, as spray evaporates after contact. It keeps work cool and eliminates dust.

Reid Brothers  **Company, Inc.**

Reid Precision Surface Grinders may be equipped with other attachments for special operations, i.e., cylindrical, crush, or visual grinding. Reid Brothers Company, Inc., will welcome any requests for further information pertaining to these attachments.



ORDER PARTS DIRECT FROM REID BROTHERS COMPANY, INC.

Always send serial number of surface grinder with parts orders.

Number is located on front of machine, right side, below elevating hand wheel lock.