

# Remington



## SLIDE ACTION • BIG GAME GAMEMASTER

### Repeating RIFLE • CARBINE

CLIP MAGAZINE - INTERCHANGEABLE - EXTRA MAGAZINES

## MODEL 760

# INSTRUCTION FOLDER and PARTS PRICE LIST

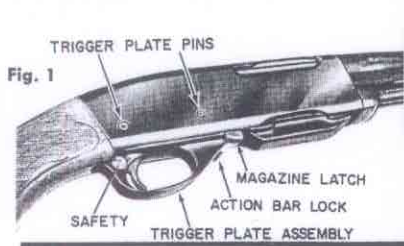

The American walnut stock features a cheekpiece and Monte Carlo comb on the BDL grade. For left hand shooters, a cheekpiece and left hand safety are available in the BDL. In both grades, the form fitting pistol grip has been accentuated with a black cap and white spacer. A black fore-end tip and white spacer are also standard items on the fore-ends of both grades.

Custom checkering has been applied to the stock and fore-end. An attractive basket weave pattern highlights the BDL grade while a neat "skip line" design is offered in the standard. The tough Du Pont RK-W wood finish adds a lustrous quality appearance to both grades.

**SAFETY (Fig. 1)**—Cross bolt type at rear of trigger. Red band marking on safety will not show when safety is pushed across to ON SAFE stop position. Trigger cannot be pulled to fire cartridge.

**Caution:** Before firing make sure barrel is clean, free of heavy oil, grease, snow, or any obstruction.

**To FIRE**—Push safety to FIRE position. Red band marking on safety will show.

**REPEAT FIRING**—Trigger must be pulled each time. Slide fore-end back and forth to eject fired cartridge case and reload barrel.

**TO SINGLE LOAD BARREL**—Push safety ON SAFE. Unlock action by pressing upward on action bar lock (Fig. 1). Slide fore-end back to open action. Drop cartridge into open receiver port and upon empty magazine. Close action to load cartridge in barrel.

**TO MAGAZINE LOAD**—Push safety ON SAFE. Rotate magazine latch (Fig. 1) forward and pull out magazine. Load cartridges toward small front end of magazine. Press cartridges down into magazine one upon the other, until held in a stagger column. When fully loaded, magazine will hold four (4) cartridges. To replace magazine, operate latch again, push magazine evenly into gun. Release latch as magazine clicks into locked position.

**TO UNLOAD MAGAZINE**—Remove from gun and slide cartridges carefully forward and out of magazine. Extra magazines may be carried for fast reloading.

**TO UNLOAD BARREL**—Push safety ON SAFE. Remove magazine. Press action bar lock upward to unlock action. Open action slowly, and carefully remove live cartridge from receiver.

**SIGHT ADJUSTMENT**—Factory sights on Remington high power rifles are targeted at 100 yards and carefully adjusted at factory for average shooters. If your rifle does not appear to shoot accurately it does not necessarily mean that sights are improperly aligned. Individual differences in eyesight or method of shooting may require sight re-alignment. Make sure that adjustable dovetail front sight (where supplied) is centered on barrel. Before attempting to re-align sights it should be realized that the greater the group size the more difficult it becomes to determine where rifle is shooting (center of impact). A consistent method of holding rifle, aiming and squeezing trigger will aid in obtaining a small group size. Different sight settings are required for each cartridge type, bullet type and weight, barrel length, each range and wind condition and, most likely, each individual shooter.

To test rifle for accuracy place large target in safe area at desired range. (Before testing at a longer range it is advisable to fire a few rounds at 50 yards. At this range, bullets will generally hit somewhere on target.)

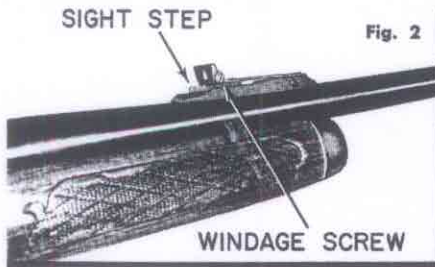

Shoot from a prone or sitting position giving body and elbows solid support. Fire four or five shots per group, using ammunition with which you plan to hunt. Shoot carefully and deliberately. If groups are at desired point, sights are correctly adjusted. If not, you should adjust sights.

If shots are too high, lower rear sight. If shots are too low, rear sight should be raised. If rifle shoots left, rear sight should be moved right by turning windage screw counter clockwise. Should rifle shoot to right, move rear sight to left, turning screw clockwise. Always move rear sight in direction you want rifle to shoot.

Information about trajectory or ballistics of your favorite load may be found in the Remington Firearms and Ammunition Catalog. A free copy may be obtained from Remington

dealers or by writing to Remington Arms Co., Inc., 939 Barnum Ave., Bridgeport, Conn. 06600.

**HANDLING**—Wipe barrel, receiver, and all steel parts to prevent rusting. Invisible "prints" of moisture can cause rust unless removed. After cold weather use, when gun is returned to warm room temperature, condensation and wetness may form. Take care that this is removed. In particular wipe dry cartridge chamber in breech of barrel, barrel bore, breech bolt, and other action parts. Lubricate sparingly unless for storage, then lubrication should be quite thorough. For cold weather shooting, use dry graphite instead of light oil. Use sparingly—a clean gun performs best.

(BDL Shown)



REMINGTON ARMS COMPANY, INC.

ILION, NEW YORK, U.S.A.

"Gamemaster" is Reg. U.S. Pat. Off. by Remington Arms Company, Inc., Bridgeport 2, Conn.

# MODEL 760

# SLIDE ACTION—HIGH POWER RIFLE • CARBINE

# COMPONENT PARTS

# PRICE LIST

Note: Basic 30-06 Caliber listed below.  
See Sectional View for proper identity of parts.

**When ordering parts—Model No., Part No. and Part Name must be given.**

View No.	Part No.	NAME OF PART	List Price	View No.	Part No.	NAME OF PART	List Price
2	25595	Action Bar Assembly, (includes Action Bar, Fore-end Tube, Fore-end Tube Plug, Fore-end Tube Yoke)	\$ 5.80	45	16454	Rear Sight Base	\$ .90
3	18609	Action Bar Lock	1.10	46	16023	Rear Sight Base Screw	.25
4	19478	Action Bar Lock Spring	.25	47	16456	Rear Sight Screw	.25
6	25605	Action Tube Assembly (includes Action Tube Ring also)	3.05	48	28095	Rear Sight Step (selected sizes)	.25
9	15215	Action Tube Ring	.40	49	16968	Rear Sight Washer	.25
10	24615	Barrel Assembly, 30-06 (includes Barrel, Barrel Extension, Breech Ring)	} Price on Application	21490	Receiver Assembly (includes Receiver, Barrel Bracket Bolt, Receiver Plug Screw (4), Receiver Stud, Stock Bearing Plate)	20.00	
	25915	Barrel Assembly, 30-06 Carbine		50	15907	Receiver Assembly, BDL	22.00
11	18602	Barrel Bracket Bolt	.25	51	17034	Receiver Plug Screw	.25
12	20674	Bolt Carrier	6.60	52	18551	Receiver Stud	.25
13	15017	Bolt Carrier Spring	.25	53	25115	Safety	.40
14	25660	Breech Bolt Assembly (includes Breech Bolt, Ejector, Ejector Retaining Pin, Ejector Spring, Extractor, Extractor Rivet, Bolt Carrier Spring)	} Price on Application	54	23223	Safety Detent Ball	.25
				55	17514	Safety Spring	.25
15	14472	Butt Plate	1.10	56	17515	Safety Spring Retaining Pin	.25
16	25410	Butt Plate Screw	.25	57	18750	Sear	.90
	14473	Butt Plate Spacer	.25	58	17463	Sear Pin	.25
17	18384	Cam Pin (lg.) (also used in old style Bolt Carrier)	.25	59	17518	Sear Spring	.25
18	19673	Cam Pin (sm.)	.25	30490	Stock Assembly (includes Stock, Butt Plate, Butt Plate Spacer, Butt Plate Screw (2), Grip Cap, Grip Cap Spacer)	18.50	
19	17419	Connector, Left	.40	60	28590	Stock Assembly, Right Hand, BDL Grade (includes Stock, Grip Cap, Grip Cap Spacer, Butt Plate, Butt Plate Screw (2))	22.50
20	17551	Connector, Right	.25		28591	Stock Assembly, Left Hand, BDL Grade	22.50
21	17420	Connector Pin	.25	62	19621	Stock Bearing Plate	.25
22	19945	Ejection Port Cover	.35	63	18571	Stock Bolt	.45
23	16291	Ejector	.55	64	18572	Stock Bolt Lock Washer	.25
24	18325	Ejector Retaining Pin	.25	65	18573	Stock Bolt Washer	.25
25	16292	Ejector Spring	.25	66	25370	Trigger	1.10
26	16254	Extractor	1.35	20610	Trigger Assembly (includes Trigger, Connector, Right; Connector, Left; Connector Pin)	1.85	
27	27340	Extractor Rivet	.25	67	17533	Trigger Pin	.25
28	18326	Firing Pin	1.35	68	20100	Trigger Plate, R.H.	3.30
29	18382	Firing Pin Retaining Pin	.25		20101	Trigger Plate, L.H.	3.30
30	15913	Fore-end Assembly, BDL Grade (includes Fore-end, Fore-end Cap, Fore-end Cap Spacer, Fore-end Screw)	10.50	21575	Trigger Plate Assembly, R.H. (includes Action Bar Lock, Action Bar Lock Spring, Hammer, Hammer Pin, Hammer Plunger, Hammer Spring, Magazine Latch, Safety, Safety Plunger, Safety Spring, Safety Spring Retaining Pin, Sear, Sear Pin, Sear Spring, Trigger Assembly, Trigger Pin; Trigger Plate, R.H.; Trigger Plate Pin Bushing, Front; Trigger Plate Pin Bushing, Rear; Trigger Plate Pin Detent Spring, Front; Trigger Plate Pin Detent Spring, Rear)	8.25	
	30500	Fore-end Assembly (includes Fore-end, Fore-end Cap, Fore-end Cap Spacer, Fore-end Screw)	10.50	21576	Trigger Plate Assembly, L.H. (includes same as Part No. 21575 except Trigger Plate, L.H. used)	8.25	
32	15012	Fore-end Cap Screw	.25	69	17417	Trigger Plate Pin Bushing, Front	.40
34	23805	Front Sight	.70	70	17541	Trigger Plate Pin Bushing, Rear	.40
	25750	Front Sight, Carbine	.70	71	17539	Trigger Plate Pin Detent Spring, Front	.25
	25751	Front Sight, Carbine (Low)	.70	72	17540	Trigger Plate Pin Detent Spring, Rear	.25
35	28510	Front Sight Ramp	1.50	73	20602	Trigger Plate Pin, Front	.25
36	28505	Front Sight Ramp Screw	.25	74	20607	Trigger Plate Pin, Rear	.25
36a	15331	Grip Cap	.45				
	15697	Grip Cap BDL	.25				
36b	30505	Grip Cap Spacer	.25				
	15696	Grip Cap Spacer BDL	.25				
37	18339	Hammer	.85				
38	18455	Hammer Pin	.40				
39	17465	Hammer Plunger	.25				
40	19014	Hammer Spring	.25				
41	23030	Magazine Assembly, 30-06 (includes Magazine, Magazine Follower, Magazine Spring)	3.90				
42	28005	Magazine Latch (selected sizes)	.85				
43	18423	Magazine Latch Spring	.25				
44	24525	Rear Sight Assembly (includes Rear Sight Colar, Rear Sight Eyepiece, Rear Sight Leaf, Rear Sight Windage Screw)	3.30				

### MODEL 760—ACCESSORIES (Extra Cost)

15902	Sling Strap and Mountings, complete Q.D. (includes Barrel Band, Q.D.; Sling Strap Assembly (7/8 inch), Swivel Assembly (2) Q.D., Rear Swivel Screw Q.D.)	\$ 9.10
-------	--	---------

DELIVERIES ARE F.O.B. ILION, N. Y.

PARTS AND PRICES SUBJECT TO CHANGE WITHOUT NOTICE

## INSTRUCTIONS FOR ORDERING PARTS

(Please read carefully)

**WHEN ORDERING PARTS . . . MODEL NUMBER, PART NUMBER and PART NAME MUST BE GIVEN.** Give also serial number (if any), and state caliber or gauge and choke needed. Please identify from the component parts, picture or section view. When ordering interchangeable shotgun barrels, please list on separate order form. This will speed up shipment to you.

Cover only one subject in letter or order. Do not order spare parts and give instructions on repair of a gun or guns in the same letter — this delays service.

Please do not ship sample parts to Firearms Factory unless it is impossible to identify from the Parts List or Instruction Folder. See shipping instructions concerning FACTORY SERVICE.

Parts will be furnished for discontinued models as long as the supply is available. We are unable to supply parts for models or repair guns not listed in Complete Line Parts List.

The sale of the following parts and certain other parts is restricted because special tools and gauges are required during assembly to make sure the firearm will operate properly.

• Barrel • Breech Block or Bolt • Receiver

The sale of barrels and bolts is restricted. Special tools, and gauges are required for assembly.

All parts will be shipped as ordered, but since they are made to close dimensions, the particular part may require slight adjustment or fitting to assure proper functioning of the arm.

**IMPORTANT: Do not combine Part Orders with Gun Service Orders.**

Please send Part Orders direct to:

**REMINGTON ARMS COMPANY, INC.**  
PARTS DEPT.  
ARMS SERVICE DIVISION  
Ilion, New York 13357

## INSTRUCTIONS FOR FACTORY SERVICE

**Please read carefully before making shipment to the Firearms Plant at ILION, NEW YORK 13357**

Please package carefully when shipping firearms to factory. Use plenty of cushioning material to prevent movement of gun or gun parts in package during transit.

Please do not ship gun in a gun case, or special container that must be returned from the factory. The return of your gun or parts will be greatly speeded if properly packaged in a throw-away carton.

All shipments should have forwarding and return address clearly marked on gun package as well as on attached letter.

To further improve service — please attach complete letter of information securely on outside of each package returned to the factory for repairs.

Please do not return gun accessories such as sling straps, quick release swivels, special boots, covers, telescopes, mounts or any special equipment to the factory with the gun shipment.

Give full details of the contents of the shipment — state whether complete gun or part. List model name and model number, serial number (if any), and caliber or gauge.

Give full condition of contents — stock and fore-end damage (if any), metal damage (if any), barrel bent or damaged (if any), parts missing, etc. A full description will enable us to more accurately list the needed repairs.

Cover only one subject in letter or order. Do not order spare parts

and give instructions on repair of a gun or guns in the same letter — this delays service.

THEN — to avoid all possible delay in starting work on your gun or parts, please include in your first order or letter the trouble you wish corrected, any changes you desire, or parts you wish replaced.

If an estimate is required before the work is started, please advise. Otherwise we will proceed with the necessary work and send a statement of the cost to you. In this manner your gun or parts can be reshipped at the earliest possible date.

Unless you specify otherwise, shipments will be made by way of Parcel Post on small packages, Express on larger packages.

Remington gun parts are not interchangeable with those of any other make of gun. For this reason the Remington Arms Company, Inc. cannot service any gun not of our manufacture.

Repairs will be made on discontinued models as long as the supply of parts is available. However, repairs cannot be made for models which are not listed in Complete Line Parts List.

**IMPORTANT: Before packaging guns for return to factory, ALL LIVE AMMUNITION SHOULD BE REMOVED.**

If live ammunition is included in package, shipment cannot be made by Insured Mail. All other shipments may be made by Insured Mail, Express, Motor Transport, or Freight.

Please send repairs direct to:

**REMINGTON ARMS COMPANY, INC.**  
ARMS SERVICE DIVISION  
Ilion, New York 13357

*Remington*

Repeating  
RIFLE • CARBINE

MODEL  
760

REPLACEMENT PARTS: Parts may be identified from the Sectional View.

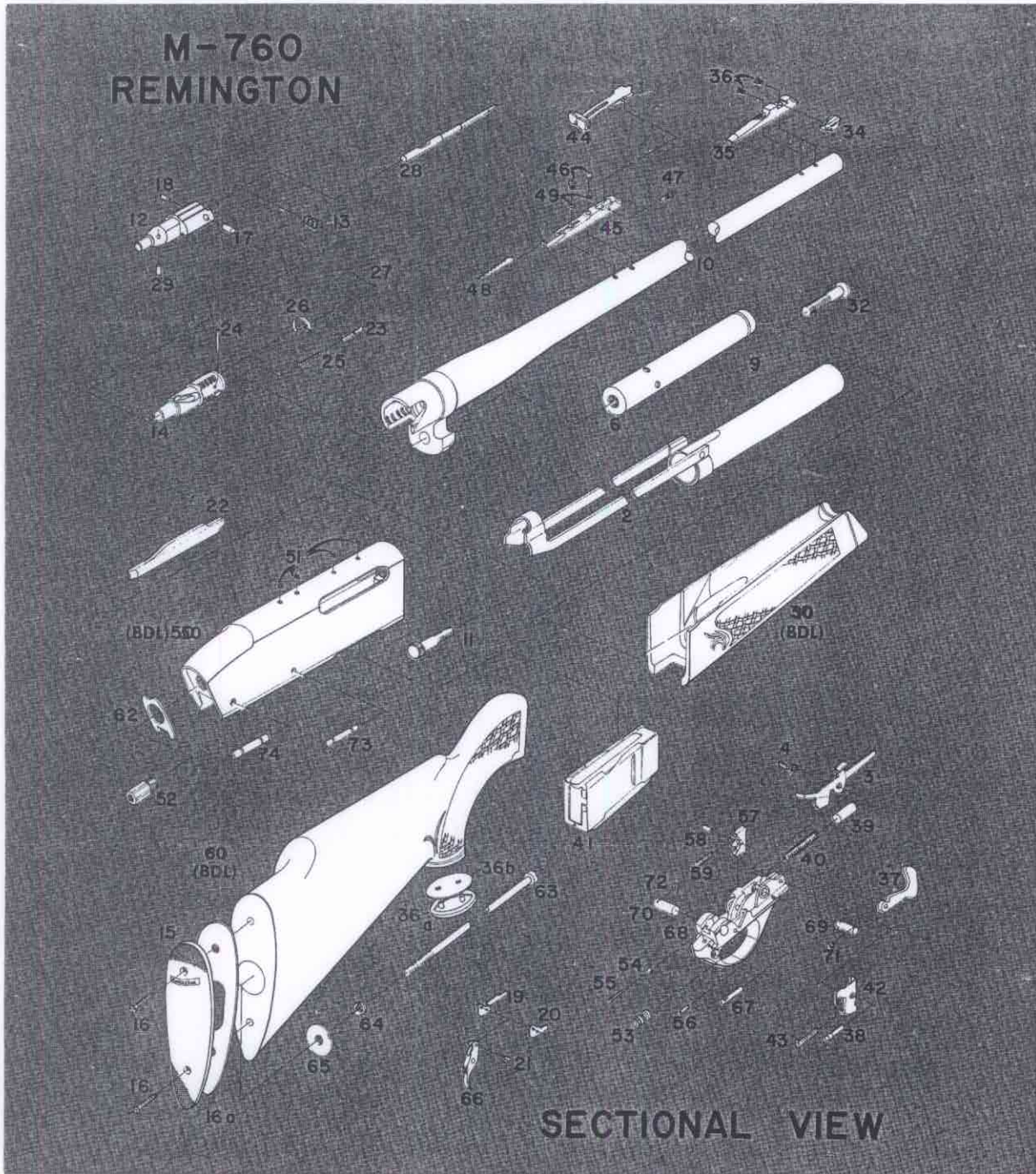

Send all guns for factory service and inquiries on service and parts to  
REMINGTON ARMS COMPANY, INC.  
Arms Service Division  
Ilion, New York 13357

All other inquiries are to be addressed to  
REMINGTON ARMS COMPANY, INC.  
Bridgeport, Connecticut 06602

**ADDITIONAL CALIBERS**  
(Not Shown in Sectional View)

**Remington**

**COMPONENT PARTS**

SLIDE ACTION — HIGH POWER

**MODEL**

270 Win., 308 Win., 223 Rem., 243 Win.

**760**

Note: Part not listed same as 30-06 Caliber.

**When ordering parts — Model No., Part No. and Part Name must be given.**

Part No.	NAME OF PART	List Price	Part No.	NAME OF PART	List Price	
<b>MODEL 760 — Additional Calibers</b> (Not Shown in Sectional View)						
24623	Barrel Assembly, 243 Win. ....	} Price on Application	22050	Barrel Filler Block (replaces Rear Sight if receiver sight is used) .....	\$ .55	
24618	Barrel Assembly, 270 Win. ....		23630	Breech Bolt Assembly (30-06, 270 Win., 280 Rem., 308 Win. Calibers) .....	} Price on Application	
24619	Barrel Assembly, 308 Win. ....		23631	Breech Bolt Assembly (35 Rem. Caliber) .....		
27955	Barrel Assembly, 223 Rem. ....		23632	Breech Bolt Assembly (223 Rem. Caliber) .....		
25918	Barrel Assembly, 308 Win. Carbine .....		16601	Butt Plate .....	1.10	
25662	Breech Bolt Assembly, 223 Rem. ....		18378	Butt Plate .....	1.10	
15852	Ejector, 223 Rem. ....		\$ .55	19459	Ejector Part Cover .....	.90
17019	Ejector Spring, 223 Rem. ....		.25	18324	Ejector .....	.55
15850	Extractor, 223 Rem. ....		1.35	18374	Ejector Spring .....	.25
27342	Extractor Rivet, 223 Rem. ....		.25	15865	Fore-end, Carbine .....	8.80
27965	Magazine Assembly, 223 Rem. ....	3.90	15872	Fore-end .....	8.80	
23033	Magazine Assembly, 270 Win. ....	3.90	15018	Fore-end Cap, Carbine .....	.55	
23718	Magazine Assembly, 308 Win. ....	3.90	18607	Fore-end Tube Nut .....	.90	
21385	Recoil Pad (with 2 screws) .....	3.75	16717	Front Sight Ramp, 223 Rem. ....	1.50	
23721	Magazine Assembly, 243 Win. ....	3.90	24477	Front Sight Ramp Pin, 223 Rem. ....	.25	
<b>MODEL 760 — Discontinued Calibers and Grades</b> (Not Shown)						
24617	Barrel Assembly, 35 Rem. ....	} Price on Application	19025	Front Sight Ramp Screw, 223 Rem. ....	.25	
25919	Barrel Assembly, 35 Rem. Carbine .....		19643	Grip Cap .....	.45	
25917	Barrel Assembly, 270 Win. Carbine .....		25380	Grip Cap Screw .....	.25	
25916	Barrel Assembly, 280 Rem. Carbine .....		18708	Rear Sight Assembly .....	2.20	
24621	Barrel Assembly, 280 Rem. ....		28200	Rear Sight Assembly, Complete (includes Rear Sight Assembly, Rear Sight Base, Rear Sight Base Screw (2), Rear Sight Screw, Rear Sight Step, Rear Sight Washer (2)) .....	5.70	
23621	Barrel Assembly, 300 Sav. ....		28098	Rear Sight Step, Carbine .....	.25	
20675	Bolt Carrier, 222 - 244 Rem., 300 Sav., 257 Robts. ....		18708	Rear Sight Assembly .....	2.20	
23631	Breech Bolt Assembly, 35 Rem. ....		25620	Rear Sight Assembly, Carbine (includes Rear Sight Collar, Rear Sight Dovetail, Rear Sight Eyepiece, Rear Sight Leaf) .....	3.30	
25661	Breech Bolt Assembly, 35 Rem. Carbine .....		27851	Stock Assembly .....	13.45	
24310	Breech Bolt Assembly, 222 Rem. (Extractor Rivet not used) .....					
23716	Magazine Assembly, 35 Rem. ....					
23034	Magazine Assembly, 280 Rem. ....					
19857	Ejector, 222 Rem. ....	.55	<b>SUPERSEDED ACCESSORIES</b>			
17019	Ejector Spring, 222 Rem. ....	.25	22796	Action Tube Cap (for swivel) .....	\$ 1.10	
20467	Extractor, 222 Rem. (Extractor Rivet not used) .....	2.40	15261	Barrel Band Swivel (Carbine) .....	1.50	
18608	Fore-end .....	5.50	22305	Front Swivel Assembly (includes Front Swivel, Front Swivel Collar) .....	.90	
19871	Fore-end, BDL Grade .....	12.10	113	Front Swivel Screw .....	.25	
15016	Fore-end, Carbine .....	5.50	22241	Front Swivel Screw (Q.D.) .....	.40	
23720	Magazine Assembly, 222 Rem. ....	3.90	20430	Quick Detachable Swivel (Q.D.) Front or Rear, each .....	2.50	
23719	Magazine Assembly, 244 Rem. ....	3.90	20895	Stock Swivel Rear Assembly (includes Stock Swivel, Stock Swivel Screw, Stock Swivel Pin) .....	1.10	
23717	Magazine Assembly, 257 Robts. ....	3.90	17680	Stock Swivel Screw .....	.85	
23715	Magazine Assembly, 300 Sav. ....	3.90	20215	Sling Strap Assembly 1-inch .....	3.05	
24660	Stack Assembly .....	9.90	25546	Sling Strap and Mountings Complete (includes Action Tube Cap, Sling Strap Assembly, Front Swivel Assembly, Front Swivel Screw, Stock Swivel Rear Assembly) .....	5.40	
<b>MODEL 760 — Superseded or Service Parts</b> (Not Shown)						
19036	Action Tube Cap Assembly Pin .....	\$ .25	26920	Sling Strap and Mountings, Complete (Carbine use) (includes Sling Strap Assembly, Barrel Band Swivel, Stock Swivel Rear Assembly) .....	5.40	
22660	Action Bar Assembly .....	5.80	25547	Quick Detachable (Q.D.) Sling Strap Assembly, Complete (Not used on Carbine) .....	9.10	
21200	Action Tube Assembly .....	3.05				
22795	Action Tube Cap .....	1.00				
19936	Action Tube Guard .....	.40				
23620	Barrel Assembly, 30-06 (includes Barrel, Barrel Extension, Breech Ring, Front Sight Ramp, Front Sight Ramp Pin) .....	} Price on Application				
23622	Barrel Assembly, 35 Rem. ....					
23623	Barrel Assembly, 270 Win. ....					
23625	Barrel Assembly, 308 Win. ....					
23626	Barrel Assembly, 244 Rem. ....					
24275	Barrel Assembly, 222 Rem. ....					

PARTS AND PRICES SUBJECT TO CHANGE WITHOUT NOTICE

DELIVERIES ARE F.O.B. ILION, N. Y.

**BARREL CLEANING** — Push safety ON SAFE. Caution: Always make certain no live cartridge remains in barrel. Remove magazine, open action, and look into empty barrel chamber. For temporary cleaning, use lightly oiled cloth patches. Pull cleaning rod from breech to muzzle. Scrub bore and cartridge chamber in barrel with cleaning solvent, if necessary. Re-oil very lightly.

During field use, Remington guns will remain clean longer and continue to give all-weather satisfaction, if very little oil or lubrication is used.

**TAKE DOWN INSTRUCTION** — (see Sectional View) Push safety ON SAFE. Open action. Remove magazine. Tap out trigger plate pins and remove trigger plate assembly. Note: **Trigger Plate Assembly** (Fire Control) may be cleaned without further disassembly. (See Fig. 1).

---

This Remington rifle has been designed to satisfy your fullest expectations for excellence. Quality materials and sound manufacturing practices went into the making of this gun. The receiver was expertly milled and finish cut to design specifications. The barrel was forged and rifled by skilled barrel makers. The coloring vats have added a dense gun metal coating to metal parts.

Stock and forearm have been fully seasoned in wood kilns, then shaped by experienced wood workers. Then a durable and long lasting wood finish has been applied to bring out the natural wood grain. All parts have been carefully assembled to make a strong and smooth working action. Finally, gallery testing in shooting butts and at the range have certified that a fine rifle has been produced for your shooting pleasure and lasting satisfaction.