

AGES 4+  
70232 Asst.



## INSTRUCTION MANUAL



© 2003 Hasbro. All Rights Reserved.  
® denotes Reg. U.S. Pat. &TM Office.  
U.S. Patent Pending  
70232 P/N 6246690000

**TIGER**  
ELECTRONICS

[TIGERTOYS.COM](http://TIGERTOYS.COM)  
For new products and offers

Questions? Call: 1-800-327-826



Thank you for purchasing the FURREAL FRIENDS Puppy toy, the family friend that moves and sounds like a REAL puppy!

Requires 3 x 1.5V "AA"/LR6 alkaline batteries (not included). Phillips/cross head screwdriver (not included) needed to insert batteries.

FURREAL FRIENDS Puppy is a cute and playful puppy who wants to come home with you! This puppy is like a REAL puppy - he likes attention, loves to play with you and adores being petted! Treat him to his special puppy bone when he's being good!

Be sure to take good care of your Puppy by following the instructions in this booklet!

To begin playing with your Puppy, you must first install batteries.

## TO INSTALL BATTERIES

Pull back the plush flap, and using a Phillips/cross head screwdriver, loosen screw in battery compartment cover (screw stays attached to cover) on the bottom. Insert 3 X 1.5V "AA"/LR6 alkaline batteries. Replace cover and tighten screw.

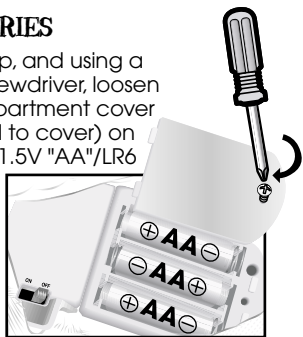

## CAUTION: TO AVOID BATTERY LEAKAGE

- Be sure to insert the batteries correctly and always follow the toy and battery manufacturers' instructions;
- Do not mix old batteries and new batteries or alkaline, standard (carbon-zinc) or rechargeable (nickel-cadmium) batteries;
- Always remove weak or dead batteries from the product.

## IMPORTANT: BATTERY INFORMATION

Please retain this information for future reference. Batteries should be replaced by an adult.



## CAUTION:

1. Always follow the instructions carefully. Use only batteries specified and be sure to insert item correctly by matching the + and - polarity markings.
2. Do not mix old batteries and new batteries or standard (carbon-zinc) with alkaline batteries.
3. Remove exhausted or dead batteries from the product.
4. Remove batteries if product is not to be played with for a long time.
5. Do not short circuit the supply terminals.
6. Should this product cause, or be affected by, local electrical interference, move it away from other electrical equipment. Reset (switching off and back on again or removing and re-inserting batteries) if necessary.
7. RECHARGEABLE BATTERIES: Do not mix these with any other types of battery. Always remove from the product before recharging. Recharge batteries under adult supervision.  
DO NOT RECHARGE OTHER TYPES OF BATTERIES.

## GETTING STARTED

Your Puppy consists of the following parts:

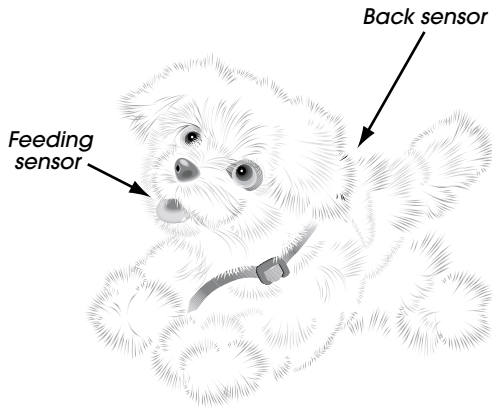

Your Puppy makes a variety of realistic dog sounds:

- Barks
- Pants
- Sniffs
- Licks
- Yawns
- Whines

AND...Growls – but not scary!

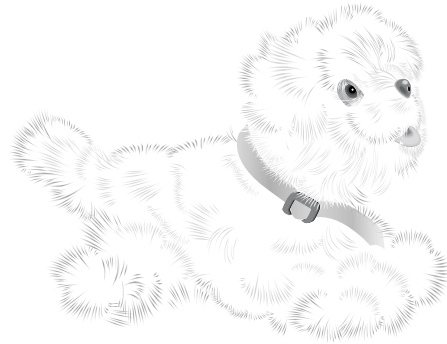

## HOW TO PLAY WITH YOUR PUPPY

To turn your Puppy **ON**, pull back the plush flap over the battery door and switch the **ON/OFF** switch to **ON**. Then replace the flap.

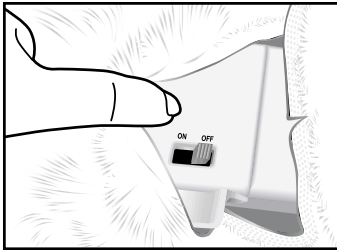

Once turned on, your Puppy will sit up, bark and pant excitedly. Now it's time to play with your Puppy!

Note: Your Puppy will go to sleep and shut down if he is not played with for a few minutes. You can wake him up by petting his back. Please remember to turn the ON/OFF switch to the OFF position if he will not be played for a while, to conserve battery life.

Your Puppy is like a real puppy in many ways. Pet him gently on his back and he will move up and down excitedly while panting and occasionally barking happily.



All puppies love treats! Your Puppy comes with a very special bone. "Feed" the bone to your Puppy just like you would a real puppy, and he will act very excited and happy! You will hear him making content licking sounds.

*Feeding Sensor*



You can also tease your Puppy with the bone, by placing the bone near his mouth and then taking it away gently. He will try to encourage you to give him back his bone, and when you do he will get excited again and make lots of cute puppy sounds.

But treat your Puppy nicely, because if you tease him too much, he will get upset and growl at you!

## CLEANING INSTRUCTIONS

To clean your Puppy's fur, gently brush him with a cloth or soft brush to loosen any dirt. Then use a slightly damp cloth to remove stains.

- DO NOT PUT IN THE WASHING MACHINE
- DO NOT SUBMERGE IN WATER
- DO NOT GET WET EXCEPT A DAMP CLOTH ON THE FUR
- TO PREVENT STAINING THE FUR, WIPE DIRT OFF IMMEDIATELY
- IF THE PUPPY GETS WET, REMOVE THE BATTERIES AND DRY THE FUR
- ONCE COMPLETELY DRY, REPLACE THE BATTERIES
- DO NOT USE DETERGENT OR STAIN REMOVERS ON THE FUR



High temperature will destroy the unit. Do no leave unit in direct sunlight.



Clean only with a piece of soft dry cloth.

- Prevent spills of food and beverage on the unit.
- Do not throw or kick the product, and do not push sharp objects through the speaker openings.

## FCC STATEMENT

This equipment has been tested and found to comply with the limits for a Class B digital device, pursuant to Part 15 of the FCC Rules. These limits are designed to provide reasonable protection against harmful interference in a residential installation. This equipment generates, uses and can radiate radio frequency energy, and, if not installed and used in accordance with the instructions, may cause harmful interference to radio communications. However, there is no guarantee that interference will not occur in a particular installation. If this equipment does cause harmful interference to radio or television reception, which can be determined by turning the equipment off and on, the user is encouraged to try to correct the interference by one or more of the following measures:

- Reorient or relocate the receiving antenna.
- Increase the separation between the equipment and the receiver.
- Consult the dealer or an experienced radio/TV technician for help