

LOTO LEGEND

INSTRUCTION MANUAL



LOTO LEGEND



INVENTORY

1. Take out the device.
2. Unscrew the bottom of the device.
3. Remove the Carb Ring and Air Intake Grommet.
4. An itemized description of the Legend components are as follows:
 - A. Mouth Piece
 - B. Magnetic Nail (Inside Silicone Concentrate Case)
 - C. Magnetic Nail Holder
 - D. Carb Ring
 - E. Air Intake Tube
 - F. Air Intake Grommet (Inside device)
 - G. U-Pipe
 - H. Center Device Grommet (Pre-attached to the device)
 - I. Adapter (Pre-attached to the device)
 - J. Dab Tool
 - K. Brush
 - L. Power Adapter
 - M. Bottom Plate
 - N. Device



ASSEMBLY



COMPLETE GLASS AIR PATH

Legend comes disassembled to ensure all glass components are protected during transport. Review the diagram above to see how the components fit together inside the unit and follow the steps on the following pages.



1. Keeping your device upright, insert the Air Intake Tube into the coil area (flanged side up).

2. Place the Air Intake Grommet inside the device and connect it to the bottom of the Air Intake Tube.

3. Insert the U-Pipe into the Air Intake Grommet and Center Device Grommet.

4. Screw Bottom Plate back into place.

(Steps Continued on Next Page)

HOW TO VAPE

5. Place Magnetic Nail in Holder with open side up.

6. Place Magnetic Nail Holder in bowl on top of Carb Ring.

7. Place Carb Ring on top of bowl/coil area.

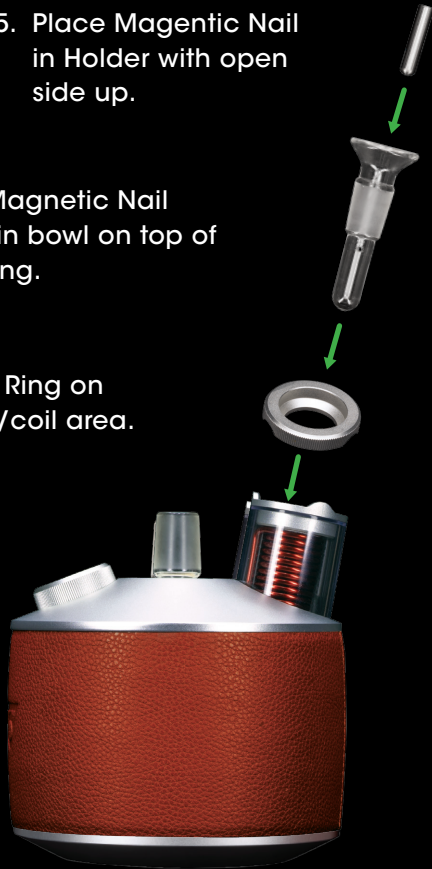

8. Fill Mouth Piece with water slightly above the holes.

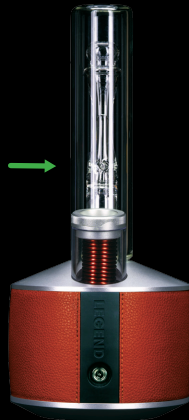

9. Place Mouth Piece onto adapter.

10. Connect Power Adapter to back of unit.



USING THE DEVICE



1. Have material ready on the end of the dab tool before proceeding.
2. Push Button.
3. Turn Button to desired power setting (as indicated by color).
4. Using the Dab Tool, put material into chamber and press against the magnetic nail.
5. Inhale.
6. Remove Dab Tool from the chamber.
7. Turn Carb Ring while inhaling to clear vapor from Mouth Piece.
8. Press Button to turn device off.
9. Exhale.

SETTINGS



POWER LEVELS

Legend has 6 power levels. Level 1 is the lowest power (coolest) and Level 6 is the most power (hottest). The mouth piece will light up according to the power level selected.

-  Level 0 - Idle (No heat)
-  Level 1
-  Level 2
-  Level 3
-  Level 4
-  Level 5
-  Level 6



BRIGHTNESS

You can adjust the brightness of the lights on your Legend.

1. Press Button 2 times quickly to enter brightness adjustment. Legend will light up white.
2. Turn Button to adjust brightness level.
3. Press Button once to exit brightness adjustment.



ERROR MODES

NO MAGNETIC NAIL DETECTED

Legend will flash yellow-orange until Magnetic Nail is inserted. Legend will flash for 10 seconds and automatically shut down if no Magnetic Nail is detected.

OVER TEMPERATURE

Legend will flash yellow-orange 3 times then shut down until cooled completely. Remove Carb Ring, Magnetic Nail Holder and place in Accessory Stand (sold separately).

UNIT MALFUNCTION

Remains yellow-orange for 10 seconds, then device shuts down.



APP

The App unlocks full control of your Legend. You will also be able to update the software or firmware on the Legend as features and versions become available.

1. Go to lotolabs.com/app for links to the latest App.
2. Download and Install the App on your phone.
3. Open the App and follow the directions.



BLUETOOTH

After downloading the App and following the directions, you can pair Legend with your phone.

1. Press and hold down Button on Legend.
2. Legend will enter pairing mode and flash a teal blue color.
3. The Legend will hold a solid teal blue color when the device pairs.

DEVICE CARE

MICROFIBER WRAP

Keep the microfiber away from dust and moisture, prolonged sun exposure, high-temperature environments as well as acidic and alkaline substances.

CLEANING THE MICROFIBER WRAP

1. Only clean with water and mild detergent.
2. Use water that is not greater than 40° C to clean the product.
3. Avoid using petroleum or organic solvents.

GLASS AIR PATH

QUICK CLEANING

1. Wait for device to cool completely.
2. Insert brush or pipe-cleaner into air intake hole to clean.

DEEP CLEANING

1. Wait for device to cool completely.
2. Remove Mouth Piece.
3. Remove Carb Ring with Magnetic Nail and Holder.
4. Unscrew Bottom Plate.
5. Remove U-Pipe and Air Intake Grommet carefully.
6. Use a cotton swab (Q-Tip) to clean Center Grommet and other glass mating areas.
7. Soak all parts in alcohol for at least 2 hours, overnight is suggested.
8. Clean glass parts with brush or pipe-cleaner.
9. Let dry.
10. Rinse with water and dry.
11. Follow assembly instructions, use the device, and repeat.



SAFETY AND WARNINGS

Only use Legend with the power supply provided and certified by Loto Labs.

Keep Legend and its components out of reach of children and pets.

Do not operate Legend with the mouth piece off.

Do not attempt to remove the magnetic nail from the induction coil until it has cooled completely.

Do not use Legend if it appears to be damaged, broken, or operating in an unusual manner.

Do not use Legend if it is unusually hot to the touch.

Do not expose Legend to, or store your Legend in, extremely high or low temperatures.

Do not store the Legend on or near heat sources.

Do not use if it becomes immersed in any liquid.

Do not use if you are a minor.

Do not use this product if you have an allergy or sensitivity to inhalants.

Do not use if you are pregnant or breastfeeding, have heart disease, diabetes, high blood pressure, asthma or any other serious medical condition.

Seek medical attention if you experience symptoms such as nausea, vomiting, dizziness, diarrhea, weakness, or rapid heart beat.

Ingestion of small parts can present a choking hazard.

Seek medical attention in the case of dizziness, drowsiness, accidental exposure, or if you feel unwell

This product is not intended for the mitigation, treatment, or prevention of any disease or condition.

This product is not intended for use with illegal substances.

WARRANTY

Legend is covered by a limited 2-year manufacturer's warranty. Please visit lotolabs.com/warranty for details.

Email: hello@lotolabs.com

Website: lotolabs.com

Copywrite ©2019 Loto Labs Inc. All rights reserved.

Loto Labs name, Legend name and associated. Taglines are trademarks of Loto Labs Inc. US and international patents pending. Patent: lotolabs.com/patent

This device complies with part 15 of the FCC rules. Operation is subject to the following two conditions. (1) This device may not cause harmful interference. (2) This device must accept any interference received, including interference that may cause undesired operation.

Adult use 21+ only. Only use with supplied power adapter.



[LOTOLABS.COM](https://lotolabs.com)