



January 6, 2009

School Board Member  
Loudon County Schools  
100 River Road  
Loudon, TN 37774

Dear Loudon County Board Member:

We are very excited to begin 2009 with the possibility of partnering with the Loudon County Board of Education; we would be honored to help provide some of the students of Loudon County with new educational facilities. We are pleased that you are considering Community Tectonics Architects as a possibility in assisting you with a design for a new middle school.

To that end, I have attached four project data sheets for your review. Also attached is a sheet that shows a cover of the text book "The Exemplary Middle School" by Paul S. George and William H. Alexander. As you can see Cleveland Middle School, a Community Tectonics design, is used as a model in this college level architectural design textbook. This is something we are very proud of.

As you browse through these data sheets should you have any questions, please do not hesitate to give me a call at the office, 637-0890 or on my cell phone 567-9534.

Sincerely,

A handwritten signature in black ink, appearing to read "Michael D. Treadway".

Michael D. Treadway  
Vice President of Operations

# Vonore Middle School



**Location**  
Sweetwater, TN

**Owner/Contact**  
Monroe County Board of Education  
205 Oak Grove Road  
Madisonville, TN 37354  
423-442-2373

**Type of Building**  
Middle School, 6th-8th

**Year Complete**  
2005

**Construction Cost**  
\$6,256,000

**Square Footage**  
64,490

**Capacity**  
Student: 450

The Tennessee School Boards Association (TSBA) honored the school as the second place winner in its Middle School Design category, awarding it the 2006 School of the Year Award in Architectural Design.

Vonore Middle School consists of two separate wings for the grade levels, one containing the sixth grade level and the other containing the seventh and eighth grade levels. Each wing has its own restrooms, work rooms and storage areas. Each classroom has individual access to the building exterior. The academic wings are separated from the kitchen, commons area and gymnasium by corridors and support spaces.

The building site provides for both grassy and hard surface playing areas. There are separate student drop-offs for autos and buses and parking for faculty and visitors.



# Cleveland Middle School



## *Location*

Cleveland, TN

## *Owner/Contact*

Dr. Rick Denning  
Cleveland City Schools  
4300 Mouse Creek Road  
Cleveland, TN 37312  
423-472-9573

## *Type of Building*

Middle School, 6th-8th

## *Year Complete*

2001

## *Construction Cost*

\$20,687,502

## *Square Footage*

219,083

## *Capacity*

Student: 1,200

Core: 1,400

The Tennessee School Boards Association (TSBA) honored the school as the first place winner in its Middle School Design category, awarding it the 2001 School of the Year Award in Architectural Design.



This nationally recognized school has been hailed as offering “the best in current Middle School building design”<sup>1</sup> in *The Exemplary Middle School*.

Cleveland Middle School features a separate classroom wing for each grade level containing 20 classrooms, a teacher planning area and student and staff restrooms. A total of 75 classrooms is provided. A fine arts wing includes a 4,251 square foot Little Theater to seat 607 students, along with four music classrooms. Two art and two consumer science classrooms are also included.



<sup>1</sup> George, Paul S., William M. Alexander. *The Exemplary Middle School*. 3rd Edition. Thomas - Wadsworth.



---

We didn't write the book on Middle Schools, but we have been recognized in *the* book.

---

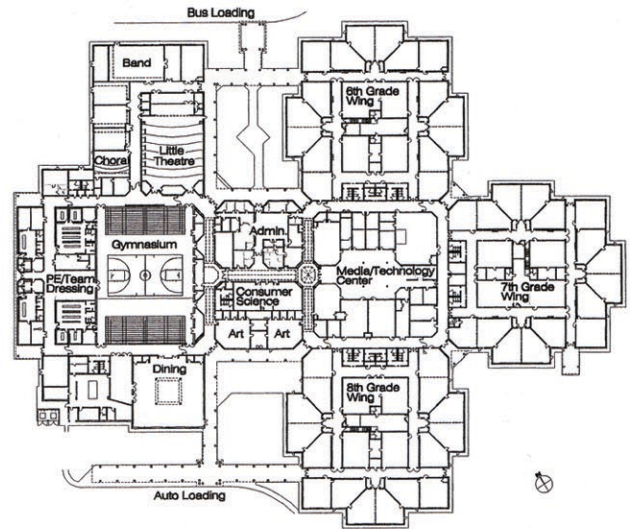
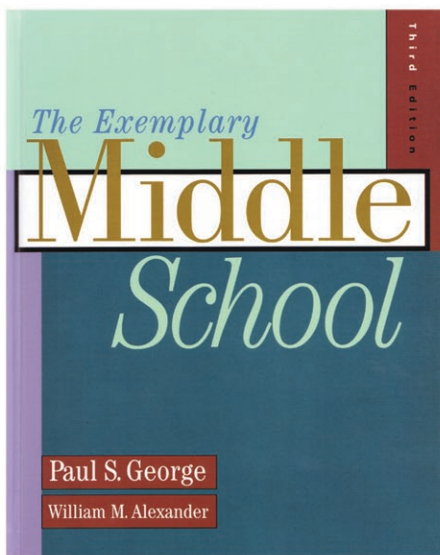

---

“The new Cleveland Middle School building offers the best in current Middle School building design.”<sup>1</sup>



<sup>1</sup> The Exemplary Middle School by Paul George, William Alexander 3rd Edition, Thomas - Wadsworth



COMMUNITY  
**TECTONICS**  
ARCHITECTS

**"We are honored to be recognized for our design of a middle school that is used as a widely viewed model."**

**- Don Shell, CEO**

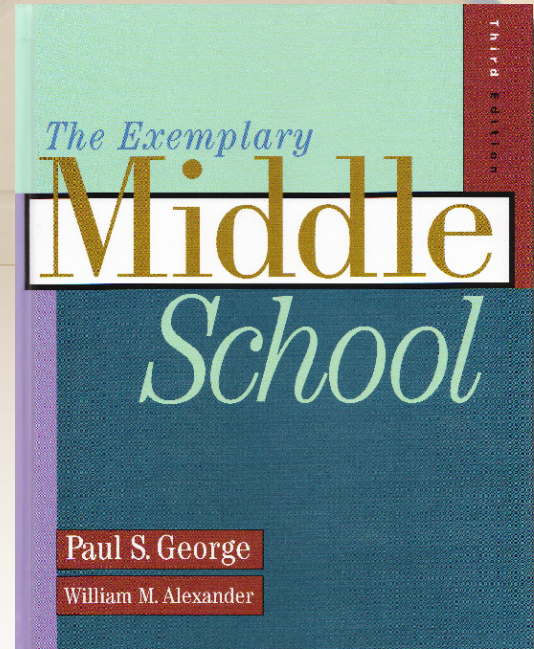

**"The new Cleveland Middle School building offers the best in current Middle School building design."<sup>1</sup>**

<sup>1</sup> *The Exemplary Middle School* by Paul George, William Alexander 3rd Edition, Thomas - Wadsworth

# West Middle School



**Location**  
Tullahoma, TN

**Owner/Contact**  
Dr. Dan Lawson  
Tullahoma City Board of Education  
510 South Jackson Street  
Tullahoma, TN 37388  
931-454-2600

**Type of Building**  
Middle School, 6th-8th

**Year Complete**  
2003

**Construction Cost**  
\$8,128,349

**Square Footage**  
82,657

**Capacity**  
550

The Tennessee School Boards Association (TSBA) honored the school as the first place winner in its Middle School Design category, awarding it the 2004 School of the Year Award in Architectural Design.

The site consists of approximately 34 acres that offered design challenges to incorporate the necessary amenities in coordination with the new building itself. Other design concerns included coordination of the site design with a new road that would be constructed during the same timeframe as the school project.

The most notable feature of the building is the vaulted main entry. The main entry canopy extends into the foyer and continues on through the student dining area. The main entrance storefront and metal entry design is repeated throughout the vaulted area.



Glass block is featured in the main corridor intersections. Exterior brick and stone create a contrast to accent distinctive parts of the interior such as classrooms, entrances and the gymnasium.





# Mosheim Middle School

**Location**  
Mosheim, TN

**Owner/Contact**  
Dr. Joe Parkins  
Greene County Board of Education  
910 W. Summer Street  
Greeneville, TN 37743  
423-639-4194

**Type of Building**  
Middle School, 6th-8th

**Year Complete**  
2003

**Construction Cost**  
\$4,404,057

**Square Footage**  
49,213

**Capacity**  
375

The addition of Mosheim Middle School was located close to the existing elementary school. A short corridor and vestibule connects the two facilities. The new middle school serves up to 375 students initially, with future expansion possible to handle up to 425 students. The main portion of the addition included 13 large classrooms, a science lab, a computer lab, a library/media center, an in-school suspension room, a cafeteria and a band room. A new gymnasium was also added. Parking areas remained much the same with one portion being developed into a bus loop for loading at both schools. Canopies were designed to cover the sidewalks to the loading area. New parking was added behind and beside the addition adjacent to Mosheim's Municipal Park. With more than 900 students, overcrowding at the current Mosheim Elementary was alleviated by the addition of the new middle school. The middle school houses grades 6-8, allowing much-needed space for the K-5 grades in the elementary school.

