

# SAMPLER QUILT

## Part 1

Designed by Kim Diehl

Finished quilt size: 28½" x 28½"



*Sew all pieces with right sides together and a ¼" seam allowance unless otherwise noted. For complete "How to Quilt" instructions, please visit [shopmartingale.com/howtoquilt](http://shopmartingale.com/howtoquilt). Use your favorite technique for the appliqué portions of this sampler quilt, or refer to any of Kim's "Simple" series of books for her easy invisible machine-appliqué method.*

## MATERIALS

### FOR ONE COMPLETE SAMPLER QUILT

- 2 fat quarters (18" x 22") of assorted neutral prints
- 5 fat eighths (9" x 22") of assorted neutral prints
- 20 chubby sixteenths (9" x 11") of assorted prints
- 20 charm squares (5" x 5") of assorted prints
- ½ yard of black print for sashing and binding
- 1 yard of fabric of your choice for backing
- 36" x 36" square of batting
- Bias bar to make ⅜"-wide stems
- Clover Quick Yo-Yo Maker, extra small
- Standard quilting supplies and supplies for your favorite appliqué method
- Liquid glue for fabric, water-soluble and acid-free (Quilter's Choice by Beacon Adhesives is Kim's favorite brand)

## PROJECT NOTES

*This little sampler quilt combines several of Kim's favorite blocks and elements from collections 1 and 2 of her Simple Whatnots Club, and is filled with a variety of prints, colors, and fun-to-stitch techniques. For easy-to-follow instructions, the components that make up this quilt have been divided into a four-part series of handouts.*

*This project is designed to be scrap-friendly and incorporate a wide range of fabrics, so specific prints haven't been noted in the materials list. The pictured quilt uses a mix of fabrics from Kim's Vintage Farmhouse and Heritage Hollow collections, but any combination of prints can be used — let your stash be your guide!*

*The blocks and units that make up the quilt center are assembled in three horizontal rows before the patchwork border is pieced and added. For greater ease, cutting instructions are provided as each portion of the quilt top is stitched and assembled. The pictured quilt can be referred to as you cut your fabrics, or you can create your own mix of colors and placement of prints to personalize the look of your quilt. Please be sure to cut all pieces across the width of the fabric in the order given unless otherwise noted.*

## IDAHO LILY BLOCK

**FINISHED BLOCK SIZE:**  
8" x 8"

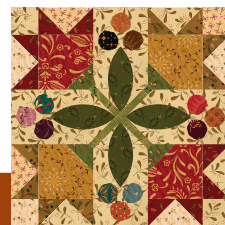

### CUTTING

**From assorted neutral prints, cut a combined total of:**

- 8 rectangles, 1½" x 2½"
- 4 squares, 1½" x 1½"
- 2 rectangles, 2½" x 3½"
- 1 rectangle, 2½" x 8½"

**From one red print and one gold print, cut:**

- 2 squares, 2½" x 2½", from each print (combined total of 4)

**From one coordinating red print and one coordinating gold print, cut:**

- 8 squares, 1½" x 1½", from each print (combined total of 16)

### From assorted green prints, cut:

- 4 matching print squares, 1½" x 1½"
- 2 matching print bias strips, 1¼" x 4"
- 4 matching print leaf appliques using the pattern on page 5

### From assorted prints:

Use the Clover Quick Yo-Yo Maker to cut and prepare 12 yo-yos, following the manufacturer's instructions.

## BLOCK ASSEMBLY

- 1 Use an acrylic ruler and pencil to draw a diagonal line on the wrong side of each red, gold, and green print 1½" square.
- 2 Layer a prepared green print square on one corner of a red print 2½" square. Stitch the pair together on the drawn line. Fold the resulting inner triangle open, aligning the corner with the corner of the red print square; press. Trim away the excess layers beneath the top triangle, leaving a ¼" seam allowance. Repeat with the remaining red and gold print 2½" squares to make a total of four flower base units.



Make 2 red and 2 gold.

- 3 Layer a prepared 1½" red square onto one end of a neutral 1½" x 2½" rectangle. Stitch, fold, press, and trim as instructed in step 2. Repeat with a second prepared 1½" red square to form a mirror-image point. Repeat for a total of four pieced red flying geese units and four pieced gold flying geese units measuring 1½" x 2½", including the seam allowances.

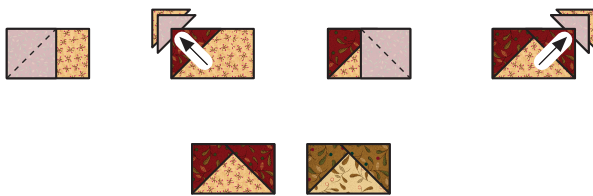

Make 4 red and 4 gold.

- 4 Referring to the illustration, lay out one red flower base unit, two red flying geese units, and one neutral print 1½" square in two horizontal rows. Join the pieces in each row. Press the seam allowances as shown. Join the rows. Press the seam allowances as shown. Repeat to make two red flower units and two gold flower units measuring 3½" square, including the seam allowances.

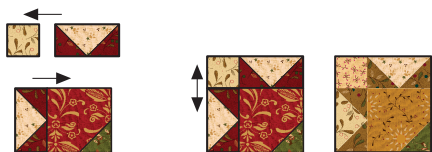

Make 2 red and 2 gold.

- 5 Referring to the illustration, lay out two red flower units, two gold flower units, two neutral 2½" x 3½" rectangles, and the neutral 2½" x 8½" rectangle. Join and press the pieces as shown to make one Idaho Lily block measuring 8½" square, including the seam allowances.

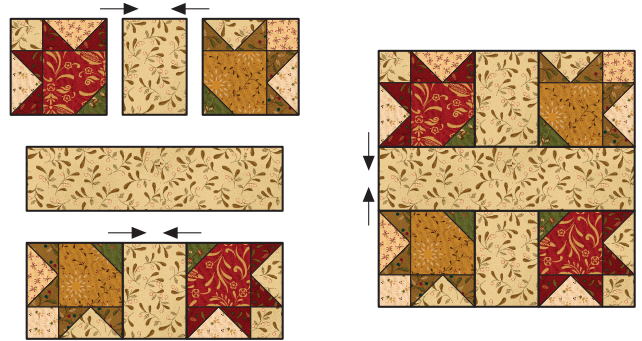

- 6 With wrong sides together, fold each green print bias strip in half lengthwise and use a scant ¼" seam allowance to stitch along the long raw edges. Use the bias bar to press each resulting stem flat, centering the seam allowances so they will be hidden from the front. Apply tiny dots of liquid fabric glue underneath the pressed seam of each stem at approximately ½" intervals. Use a hot, dry iron to heat set the seam allowances and anchor them in place.

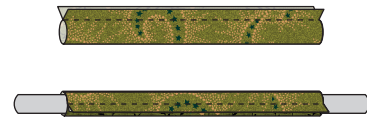

- 7 Fold the raw ends of the bias stems under, sizing the folds so that each stem will overlap onto the flower base approximately ¼" when positioned diagonally on the block as shown in the pictured block. Apply tiny dots of liquid glue or fabric glue stick underneath the folds at each end and use a hot, dry iron to heat set and anchor them in place. Dot the seam allowance of each prepared stem with liquid basting glue at approximately ½" intervals. Referring to the pictured block, position the stems on the block. From the back of the block, use a hot, dry iron to heat set the stems and anchor them in place.

- 8 Use your favorite method to appliqué the stems, four leaves, and 12 yo-yos to the block as shown.





## HONEYCOMB BLOCK

FINISHED BLOCK SIZE: 4" x 8"



### CUTTING

From assorted neutral prints, cut a *combined total of:*

8 squares, 2½" x 2½"

### BLOCK ASSEMBLY

- Using the Honeycomb hexie pattern on page 5, use a pencil, acrylic ruler, and rotary cutter to trace and cut eight freezer paper pattern pieces exactly on the pattern lines; the seam allowances will be added later as you cut and prepare the shapes from fabric.
- Use the prepared freezer paper pattern pieces from step 1 and your favorite appliqué method to cut and prepare eight hexie appliqué from assorted prints. Reserve the prepared appliqué for later use, as the shapes will be appliqué to the background block after the quilt center has been assembled.
- Lay out the assorted neutral print 2½" squares in four rows of two squares. Join the squares in each horizontal row. Press the seam allowances open. Join the rows. Press the seam allowances open. The pieced Honeycomb background block should measure 4½" x 8½", including the seam allowances.

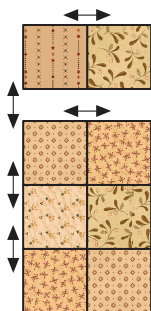

## BARN STAR BLOCK

FINISHED BLOCK SIZE: 4" x 4"



### CUTTING

From each of three assorted prints, cut a matching set of:  
4 squares, 1½" x 1½" (combined total of 12)

From assorted prints, cut a *combined total of:*  
24 squares, 1½" x 1½"

From assorted neutral prints, cut a *combined total of:*  
12 squares, 1" x 1"  
12 rectangles, 1½" x 2½"  
12 squares, 1½" x 1½"

### BLOCK ASSEMBLY

- Reserving the three matching sets of assorted print 1½" squares, use a pencil and an acrylic ruler to draw a diagonal sewing line on the wrong side of each neutral print 1" square and the remaining assorted print 1½" squares.
- Select a reserved set of 1½" squares. Layer a prepared neutral 1" square onto one corner of an assorted print 1½" square from the set. Stitch, press, and trim as instructed in step 2 of the Idaho Lily block instructions, page 2. Repeat for a total of four pieced squares measuring 1½" x 1½", including the seam allowances.

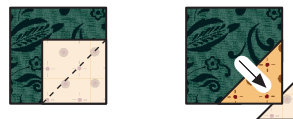

Make 4.

- Lay out the pieced squares from step 2 in two horizontal rows to form the star center unit. Join and press the pieces as shown.

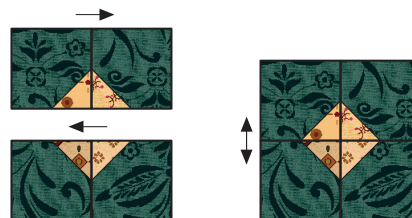

- Select eight prepared assorted print 1½" squares from step 1 and four assorted neutral print 1½" x 2½" rectangles. Referring to step 3 of the Idaho Lily block instructions on page 2, make four flying geese units measuring 1½" x 2½", including the seam allowances.

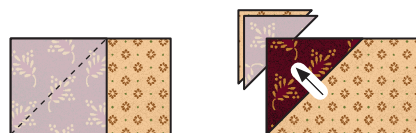

Make 4.

- Join a flying geese unit to the right and left sides of the star center unit to form star points; press as shown.

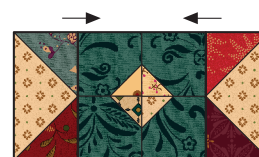

- 6 Join a neutral print  $1\frac{1}{2}$ " square to each end of the remaining flying geese units; press as shown.



- 7 Join the step 6 pieced flying geese units to the remaining sides of the step 5 star center unit; press as shown.

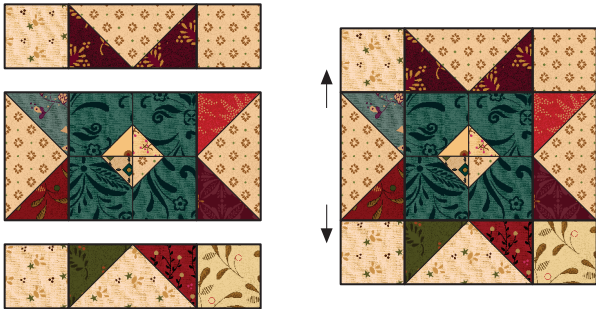

- 8 Repeat steps 2 through 7 to make a total of three Barn Star blocks measuring  $4\frac{1}{2}$ " square, including the seam allowances. Do not join the blocks together at this time.

## HEN PECKED BLOCK

FINISHED BLOCK SIZE: 4" x 4"



### CUTTING

From assorted neutral prints, cut a **combined total of:** 8 squares,  $1\frac{7}{8}$ " x  $1\frac{7}{8}$ "; cut each square in half diagonally once to yield a total of 16 triangles. *Note: For a bit of the "make do" look, Kim substituted a handful of light assorted neutral print triangles in place of a few neutral print triangles, and adjusted the number of pieces to be cut accordingly.*

From assorted prints, cut a **combined total of:** 16 squares,  $1\frac{7}{8}$ " x  $1\frac{7}{8}$ "; cut each square in half diagonally *once* to yield a total of 32 triangles. (Please note that you'll only use one triangle from each print. If you'd like to be more frugal in your cutting, simply use 8 squares, cutting each one in half to yield the 16 needed triangles. Each print will be used twice and with this approach, you'll have no waste.)

### BLOCK ASSEMBLY

- 1 Join an assorted print and a neutral print  $1\frac{7}{8}$ " triangle along the long diagonal edges. Press the seam allowance away from the neutral print. Trim away the dog-ear points. Repeat for a total of 16 half-square-triangle units measuring  $1\frac{1}{2}$ " square, including the seam allowances.



Make 16.

- 2 Select four half-square-triangle units from step 1. Join and press as shown. Repeat to make rows 1 and 3 of the Hen Pecked block.



- 3 Repeat step 2 to make rows 2 and 4 of the Hen Pecked block, pressing the seams in the opposite direction as shown.



- 4 Referring to the pictured quilt, join the rows, alternating the even- and odd-numbered rows so the seams will nest together. Press the seam allowances of each row open. The pieced Hen Pecked block should measure  $4\frac{1}{2}$ " square, including the seam allowances.

## ASSEMBLING

### ROW 1 OF THE QUILT CENTER

- 1 Using the pictured quilt as a guide, join the left edge of the pieced Honeycomb background unit to the right edge of the Idaho Lily block. Press the seam allowances toward the Honeycomb unit.
- 2 Lay out the three Barn Star blocks and the Hen Pecked block as shown. Join the pieces in each horizontal row. Press the seam allowances of the top row to the right. Press the seam allowances of the bottom row to the left, away from the Hen Pecked block. Join the rows. Press the seam allowances open.

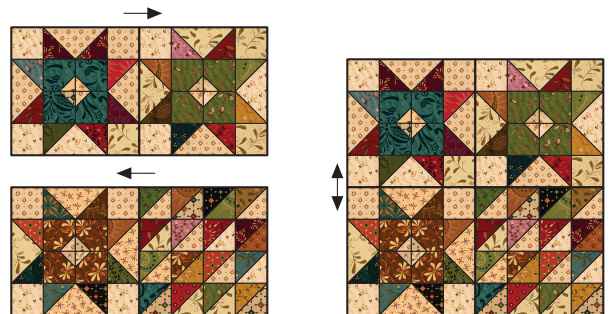

- 3 Referring to the pictured quilt, join the right edge of the Idaho Lily/Honeycomb unit from step 1 to the left edge of the Barn Stars/Hen Pecked unit from step 2. Press the seam allowances toward the Honeycomb unit. The pieced Row 1 unit should now measure  $8\frac{1}{2}$ " x  $20\frac{1}{2}$ ", including the seam allowances. Continue to reserve the Honeycomb hexie appliqués until the entire quilt center has been pieced.

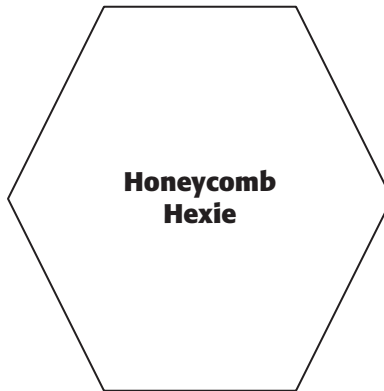
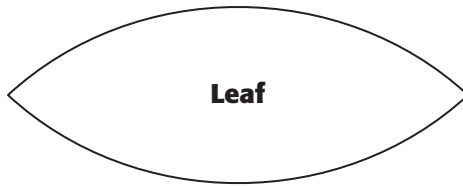

Patterns do not include seam allowances.



Turn off scaling when printing this page.  
The box at left should measure 1/2" x 1/2".