

It's more than a text. It's an experience.

Learn more at PearsonSchool.com/ElevateSci

elevate science

It's the Science of Doing!



PearsonSchool.com
800-848-9500

Copyright Pearson Education, Inc., or its affiliates. All rights reserved.
SAM 9780134969824
ADV 9780134969992

Get Fresh Ideas for Teaching: Blog.PearsonSchool.com

Join the Conversation:
Twitter.com/PearsonPreK12
Facebook.com/PearsonPreK12

SC581R347



Pearson

K-5 DIGITAL
REVIEWER GUIDE

W DO!
W Learn!



elevatescience

elevate^{science}

Realize the Potential!

Elevate Science is accessible as a fully customizable digital curriculum through PearsonRealize.com. All content, resources and student data is organized and viewable on multiple devices. Realize™ works with your school's information system and is integrated with Google® Classroom. A full

suite of personalized teaching resources is just a click away!





Let Pearson do the work!

EasyBridge saves you time by creating your classes, enrolling your students, syncing nightly with your rosters, and providing single sign-on services.



Elevate Your Digital Experience

Go Digital

This groundbreaking digital experience provides anytime interactive learning both online and offline.

Experience Science

Elevate Science includes a wealth of labs, multimedia, and interactive content to explain and reinforce concepts.

Work with Ease

PearsonRealize.com is an easy-to-use online platform that allows you to quickly find and assign content to individual students, groups, or the entire class.

Personalize Learning

Elevate Science includes a suite of resources to effectively and efficiently meet the needs of all students.

Easy Three-Part Organization

Realize has an easy three-part organization. This simple and intuitive interface delivers all content to students from one place. The interactive features within Realize increase the student's ability to think critically and builds collaboration within and beyond the science classroom!



Programs is the digital library. Customize topics and lessons. You can also assign resources to students.

Classes manages your digital classroom. Create small groups, monitor assignments, and encourage student discourse with online classroom discussion boards.

Data breaks down the online assessments into various reports based on mastery of standards, progress over time, and usage reports.

Start Here

1. Visit **PearsonSchool.com/ElevateSci**.
2. Click **"Try it Now"** to submit your information.
3. Check your personal email for the **Username** and **Password**.
4. Log into **PearsonRealize.com**.
5. Click **Sign-In**.
6. Click on **Programs**.
7. **Select the course** you would like to review.

Turn the page to begin exploring
the **Digital Course Resources!**

Finding Your Digital Resources

The ***Elevate Science*** Digital Course contains the student and teacher digital text, videos, labs, assessments, and includes thousands of additional resources through the integrated OpenEd search feature. Follow the steps below to preview some of these resources:

1. **Table of Contents** lists folders for all the topics, Spanish, and Program Resources.
2. **eText** links to the student interactive etext and the Teacher Edition.
3. **Tools** provide access to an Assessment Download Center where you can download the ExamView® Assessment Suite and build your own quizzes and tests.
4. Use the **Magnifying Glass** to search program resources by topic or standard, plus vetted resources through the integrated **OpenEd** search feature.
5. **Welcome to the Course** provides a Program Overview, and Professional Development.
6. **Navigating Your Course** supplies “how-to” support for the Realize Reader™ eText and general Digital Course.
7. **Topic titles** identify the topic content in the *Elevate Science* program.
8. **Digital Reader Library** contains the Leveled Phenomena and STEM readers with full audio plus lesson plans for every Topic.
9. **Spanish Resources** houses a collection of course-level resources in Spanish.
10. Click on **Program Resources**.



The **Program Resources** folder allows you to quickly locate resources to support students: different language needs, a variety of labs, targeted literacy lessons, and test-taking support.

1. **Learning Strategies** contains an English and Spanish glossary with full audio support and Close Read Activities.
2. **Program Games** challenges students to interact with important science concepts.
3. **Labs** are organized by topic. This folder also contains Master Materials Lists for the course.
4. **STEM Invention Toolbox Activities** provides leveled extension lab activities and lesson plans connected with our partner, littleBits™.
5. **Course Tests** are available in the forms of pre-/post-, benchmark, and end-of-course assessments.



Don't forget to scroll
to see all of the folders
on the page!

Click on **Table of Contents** and select a **Topic**. Turn to the next page to begin exploring **Topic Level Resources**.

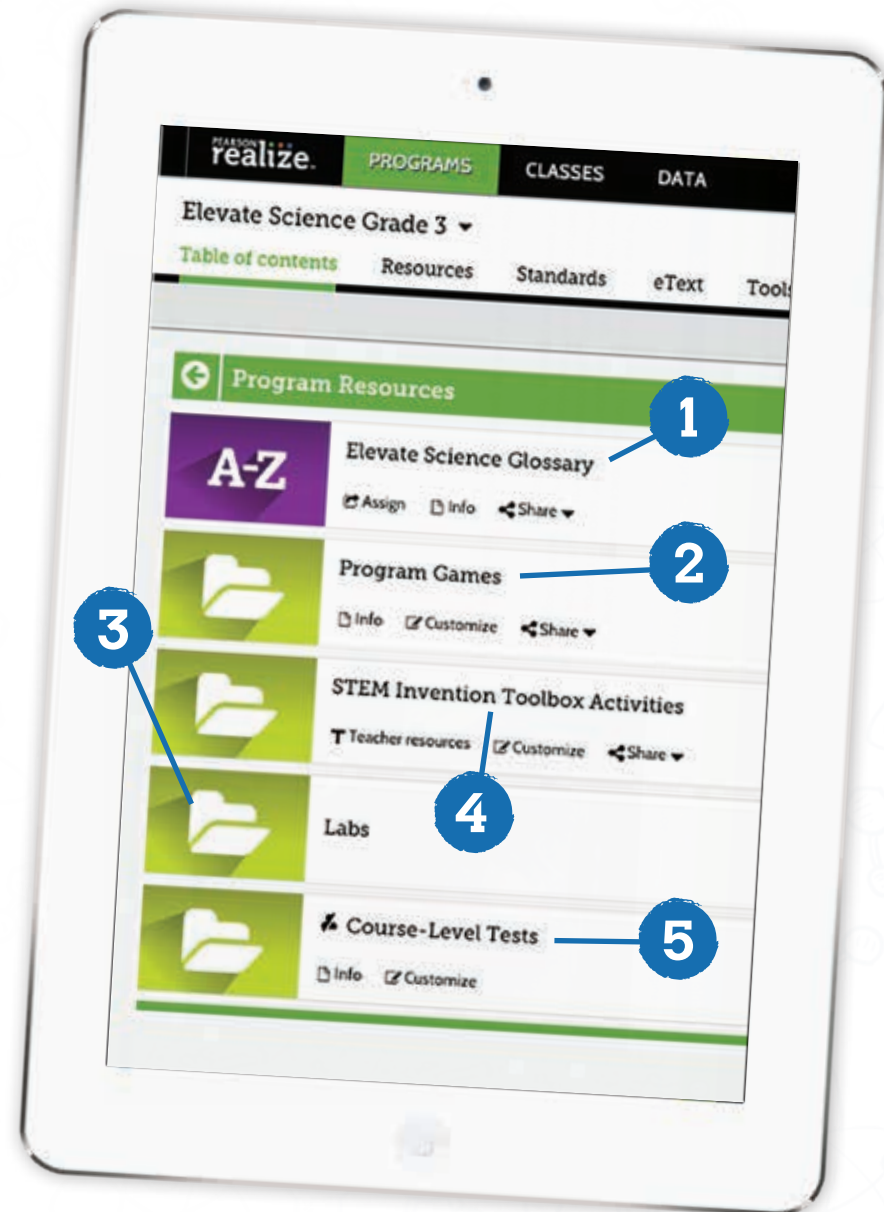

Topics

Although each Topic will contain a different number of lessons, all Topics will have this same consistent structure.

- 1. Topic Launch** contains a phenomena-based investigation, called a Quest, that sets the scenario and purpose of study. *uConnect Labs* actively connect students to the content.
- 2. Lessons** contains a variety of assignable resources such as labs, virtual labs, interactivities, eText activities, and quizzes.
- 3. Topic Close** contains Topic-Level Reviews, Evidence-Based Assessments, Traditional Topic Assessments, Quest Project-Based Findings, and performance-based assessment labs called *uDemonstrate*.

Click on a **Lesson** to view specific lesson resources.



Lessons

All **Lessons** follow the 5E Lesson Model. The resources found within this model ensure students are exposed to the SEPs, DCIs, and CCCs, mastering the NGSS to the depth and complexity in which it was written.

1. **Show Teacher Resources** will provide links to the Teacher's Edition, PD videos, and other resources to assist in planning a successful lesson.
2. **Bell ringer writing activities, quick labs, and interactivities** engage students to develop their communication skills and connect them to the content.
3. **eText** links students directly to the interactive student digital text.
4. **Interactivities, Virtual labs, and uInvestigate Labs** allow students to explore the content through open inquiry experiences.
5. **Career videos and Topic videos** present opportunities to investigate content and careers with closed caption features so students can see themselves as scientists.
6. **Quest Check-Ins and Quest Labs** guide students to take what they have learned in a lesson and connect it to their Quest projects.
7. **Quizzes and Lesson Checks** inform teaching and improve learning. Remediation opportunities and resources are available should the need arise.
8. **Teacher Resources** includes additional teacher support, modification ideas, printable versions of the activity, answer keys, and more.

Turn to the next page to learn how to find and navigate your Student eText.



Use Customize

at the lesson level to rearrange resources or add web links and integrate teacher-created resources from your computer or Google Drive!

Navigating the Student eText

Students will be able to fully interact with the student eText, called the **Realize Reader™**, online and offline. They can access videos, interactives, and their notebook at point of use, with a simple click.

1. Click on a resource with a **Book Icon** or **eText** in the tool bar.
2. Click "Open in new window" when prompted. (Not shown)
3. Click **Menu** to access Table of Contents, Bookmarks, Annotations & Highlights, Notebook, and Glossary.
4. **Back** and **Next** will move one page forward or backwards.
5. **Bookshelf** allows you to access all of your eTexts.
6. Use **Settings** to adjust size of font.
7. Close the eText window. (Not shown)
8. Click **Exit** in the upper left corner to return to the Lesson resources. (Not shown)

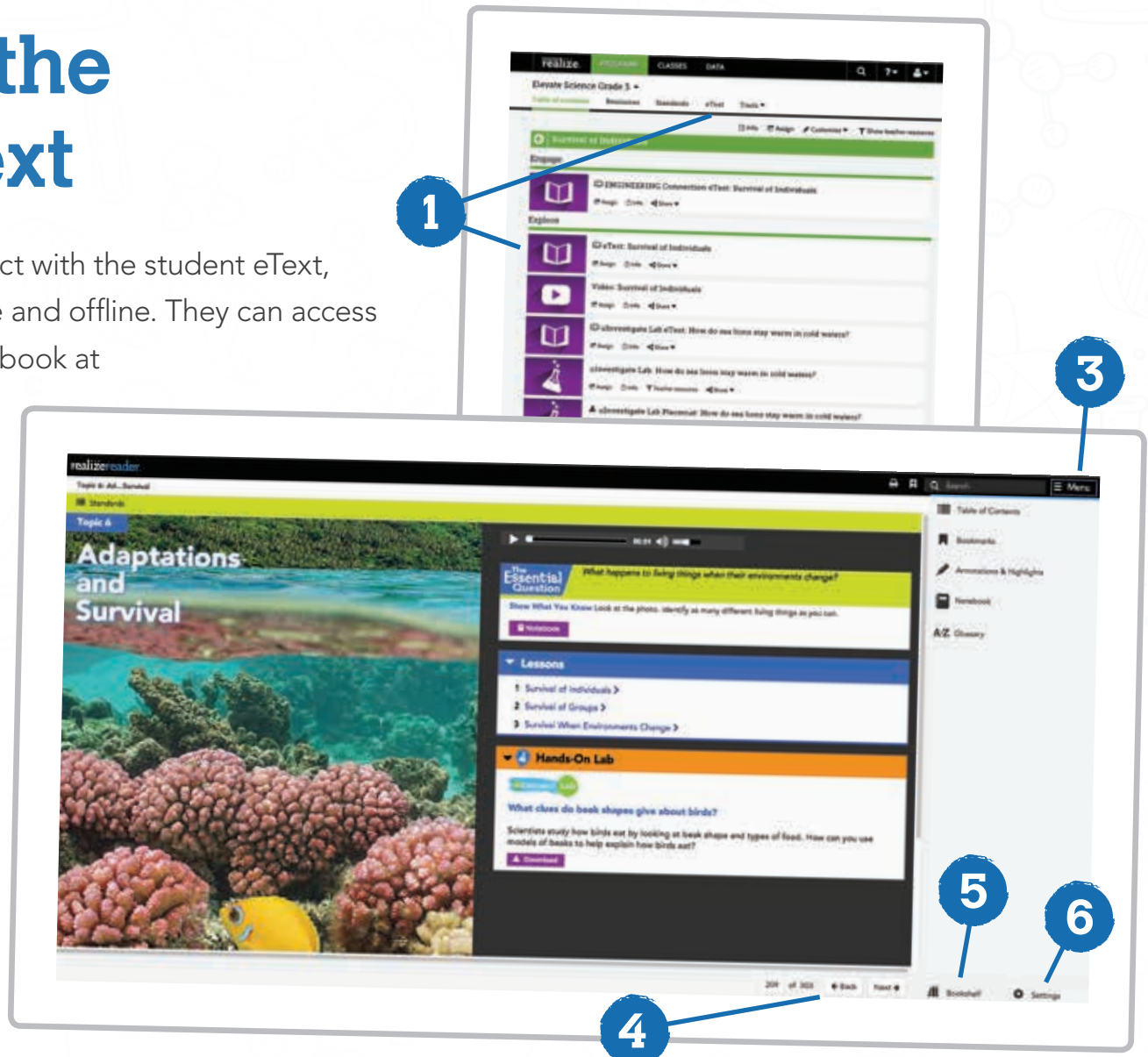

Searching for Additional Resources

Easily search **Elevate Science** resources by keyword or topic plus thousands of additional vetted resources with the integrated OpenEd search feature. Follow the steps below to see how to easily search and filter for preferred resources within Realize and OpenEd.

1. Click on the **Magnifying Glass** in the upper right corner.
2. Type in a name of a resource or a **keyword** to search for content.
3. **Filter** resources by grade, type, and program.
4. Click **See results from OpenEd** to view additional resources outside of *Elevate Science*.
5. Click on **See results from Realize** to go back to the *Elevate Science* Resources in Realize.



Turn to the next page to learn how to **Create and Manage Assignments**.

1

2

3

4

5



QUICK TIP **Don't forget to scroll!**
You can find additional pages of resources at the bottom of the page.

Assigning Resources

Elevate Science resources support any modality or learner level. Every student resource is assignable to an entire class, a small group, or an individual student—making it easier to target teaching, provide documentation for parent meetings, and meet required modifications.

1. **Share** allows you to link *Elevate Science* resources to your Google Classroom.
2. **Assign** allows you to directly assign resources within Realize to students. **Click on Assign**.
3. **Set Start** and **End Times** to assist students in managing deadlines for assignments.
4. Use **Instructions** box to provide directions for assignments and modifications.
5. Type in a **student name, designated group of students, or class name** to quickly assign resources. **Click Assign**.

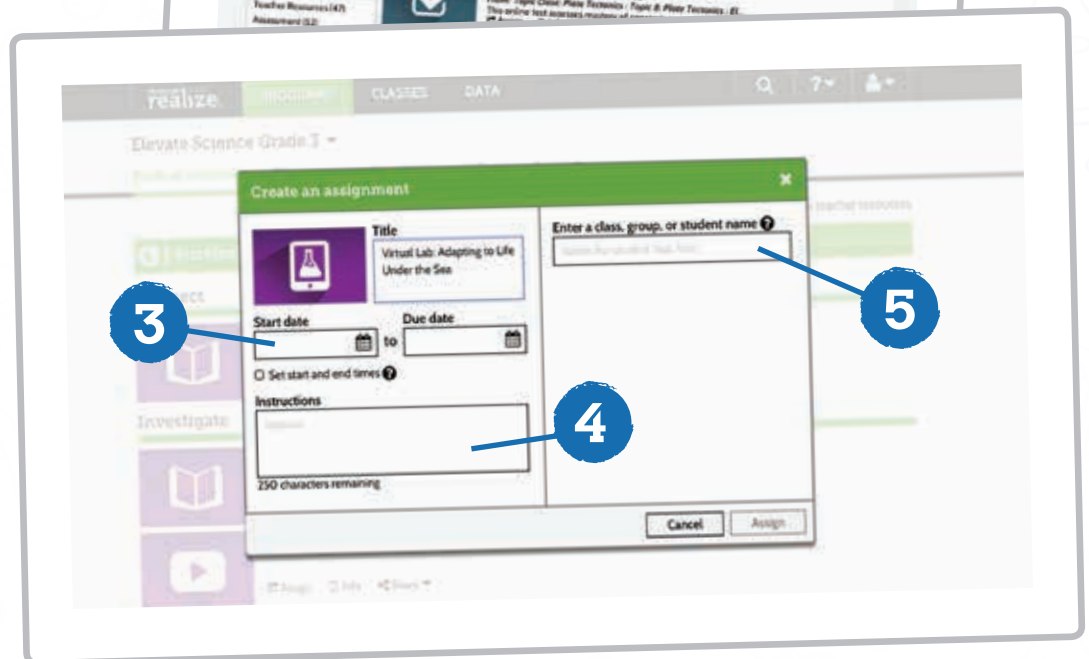

Managing Assignments and Classes

Click on **Classes**. You can monitor student assignment progress, start online discussions, and create special learning groups.

1. **Assignments** lets you view a class or a student's progress on individual assignments. It also provides class averages or individual student grades for auto-graded assignments.
2. **Discuss** provides a safe location for students to engage digitally in student discourse within and outside the classroom.
3. **Students & Groups** allows you to view your student roster at a glance and to group students to easily assign differentiated resources.

Click on **Data** at the top of the Realize page to see a variety of teacher and administrator reports.

The image shows two tablets displaying the Realize interface. The top tablet shows the 'Assignments' page for 'ELEVATE SCIENCE'. The page has a navigation bar with 'realize', 'PROGRAMS', 'CLASSES', and 'DATA'. Below the navigation bar, there are tabs for 'Assignments', 'Calendar', 'Discuss', 'Students & Groups', and 'Class Settings'. The 'Assignments' tab is selected. The page shows a table of assignments with columns for 'Title', 'Student status', 'Due Date', and 'Average'. The assignments listed are: 'Quiz: Physical Changes' (0/1 Completed, 02/04/18 10:59pm), 'Quiz: States of Matter' (1/1 Completed, 02/04/18 10:59pm, 83%), 'Interactivity: How We Use Earth's Resources' (0/1 Completed, 03/20/18 8:59pm), and 'Interactivity: Bear Adaptations' (0/1 Completed, 03/28/18 8:59pm). A blue circle with the number '1' points to the 'Assignments' tab.

The bottom tablet shows the 'Discuss' page for 'ELEVATE SCIENCE'. The page has the same navigation bar. The 'Discuss' tab is selected. The page shows a 'Discussion Prompts' section with a red speech bubble icon and the text 'Create a reusable discussion prompt and assign it to start a discussion with your students!'. Below this is a 'Create a prompt' form with a 'Save prompt!' button. The form has fields for 'Prompt title' and 'Prompt text', and a 'Prompt color' section with five color options: red, green, blue, purple, and black. A blue circle with the number '2' points to the 'Discuss' tab, and a blue circle with the number '3' points to the 'Students & Groups' tab.

Teacher Reports

The **Data** tab provides access to class and student data showing standards mastery on assessments, overall progress, and the amount of time students have spent on their assignment.

1. **Class results by assignment mastery** allows you to view the class and student mastery of content and how it aligned to the standards.
2. **Class results by assignment** allows you to see the mastery of assignments or standards by student, or an item analysis of student scores by question responses.
3. **Progress Data Chart** will show the class average and which students have completed their assignments and who has fallen behind.
4. **Usage Chart** displays the average time it took to complete the assignments.
5. **Export data** showing progress, scores, and assessments as a CSV file to import into a gradebook, or to a spreadsheet program for data analysis.



Administrative Reports

Realize has a special reporting system for administrators to see data across all classes and schools within the district. Administrators will be able to access a variety of reports using a unique username and password. Once teachers and students begin using Realize, data is collected and reports are auto-generated.

The different reports generated include:

- **Teacher Usage** to determine professional development needs in using the digital resources.
- **Student Usage by Class, School, and District** for a district snapshot of device and resource needs.
- **Scores by Standard Summary** will show the scores achieved by each student on each standard, the percent score on the most recent test containing the standard, and the average percent score on the standard across all tests.
- **Scores on Selected Assessments** allows administrators to select from tests submitted and view student test scores grouped by class and school.
- **Item Details Report** shows the score on every question. It will show the standard(s) mapped to each question. It is grouped by class and school to facilitate comparisons.

