



Powering Business Worldwide



## Installation Instructions for Lighthouse SS Power Pedestal

Rev. 3 5/20/14

### **DANGER**



**Hazardous voltage. Can cause severe injury or death.**

Turn off main power before opening panel.

### **WARNING**

**Eaton Electrical Inc. strongly recommends that these products be installed by a qualified electrician.**

### **IMPORTANT - INSTALL EQUIPMENT IN CONFORMANCE WITH CODES**

This product must be installed in accordance with the National Electric Code (NEC) or the Canadian Electrical Code (CEC) and any applicable local codes. Before installing equipment, check with your local electrical inspector for requirements and information. If you have questions or need assistance, contact a qualified electrician.

### **WARNING**

**Turn off or disconnect the power supplying this equipment before beginning work.**

This may require that you contact your electric utility to disconnect power to an existing load-center. The line side of the main breaker is energized unless power is disconnected upstream. Eaton Electrical, Inc. will not assume responsibility for property damage or personal injury resulting from misuse of the information in this publication.

## Wiring Diagram

### Wire Colors

(Line 1)	L1	Black
(Neutral)	N	White
(Line 2)	L2	Red
(Line 3)	L3	Blue
(Ground)	G	Green

TORQUE BRONZE NUT TO 150 IN. LBS.

FOAMING SILICONE SEALANT AT WIRE ENTRY/EXIT



### Compression Terminals (Not Included)

Contractor needs to crimp terminals to line wires and place on provided stud lug connector.

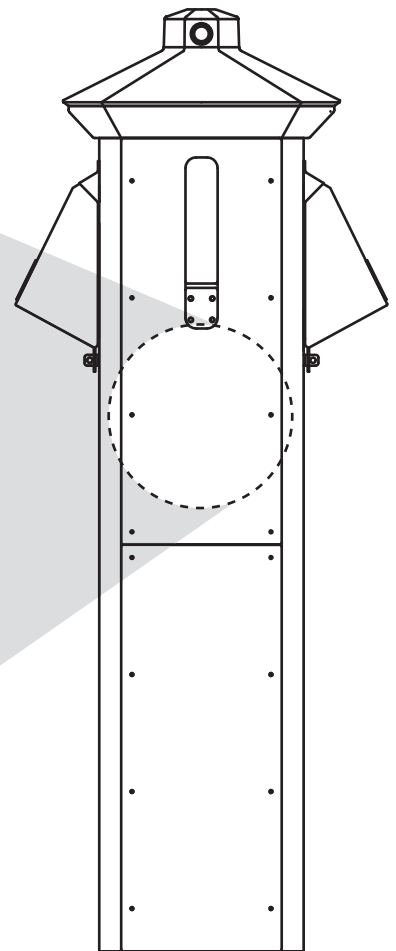
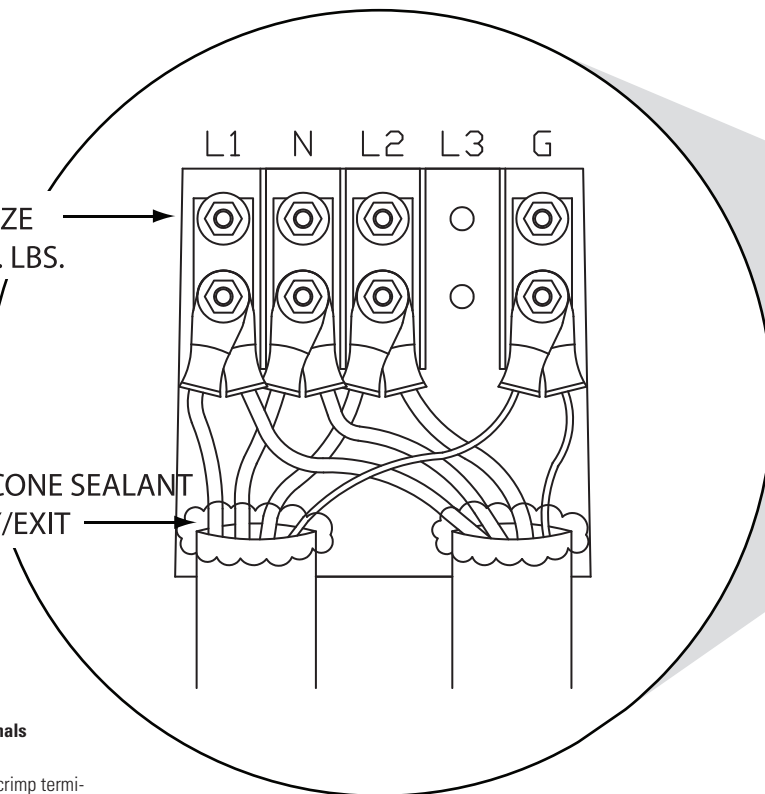

## Installation

### Note

We strongly recommend that a qualified electrical contractor install this unit.

The ease and simplicity of installing the Lighthouse makes it the pedestal of choice for many electricians. The design allows all work to be completed out in the open with no confining workspaces.

### 1 Securing the Base and Mounting the Pedestal

Always use stainless steel hardware and a stainless steel washer between the bolt head and the mounting feet.

See the attached dimensional drawing of the base of the Lighthouse. Suggested locations for the power supply as well as water, phone and cable TV utilities are identified. We recommend that you prepare the mounting of the base as follows:

(Refer to mounting base diagram)

#### • On Concrete Docks

At each corner, utilize four 3/8" compression bolts or threaded rod set in the concrete on 11.75" centers for through-hole mounting of the Lighthouse base.

#### • On Wood Docks

At each corner, utilize four 3/8" bolts or lag screws on 11.75" center for through-hole mounting of the Lighthouse base. Always use stainless bolts and washers to prevent damage while mounting the base.

#### • On Both Concrete and Wood Docks

The mounting surface must be flat and

level. If cupped deck boards or an irregular concrete surface are under the base mount feet, stainless washers should be used to shim the base level before the tightening the mounting bolts or screws.

### 2 Connecting Power Supply to the Pedestal Buss Bars

The loop feed 3/8" compression style stud lug buss bars are located in clear view in the center of the pedestal. An electrician will need to crimp wire terminations on power supply lines and attach the leads as directed by the wiring diagram instructions located below the buss bars. A silicone bronze flat washer, Belleville washer (cupped spring), and a nut are provided for each incoming supply line.

### 3 Water Connection

There are four access panels located on each side of the base. The water assembly is mounted on one specialized panel with two 1/4 turn ball valves.

Remove the water panel to access the backside of the two ball valves (3/4" female fitting) for connection. We recommend attaching a flexible stainless or black-poly hose(s) from your waterline.

Pull the hose(s) out from under the base and connect it to the back of the two ball valves.

Guide the hose(s) back into the base and reinstall the panel.

### 4 Phone, Internet, and Cable TV Connection

The phone, Internet, and cable TV receptacles are mounted on another specialized base access panel. Connection is similar to working on the water assembly above.

Remove the access panel.

Pull the phone line and cable out from under the base and connect them to the back side of the receptacles.

Guide the wires back into the base and reinstall the panel.

## Maintenance

Eaton - Marina Power and Lighting produces units that are designed to withstand the harsh marine environment. Very little maintenance is required to keep the units looking new for many years and to keep the warranty effective.

### 1 Exterior Maintenance

To remove of dirt, grime, and bird droppings, use a mild solution of dishwashing detergent at approximately one teaspoon per gallon of warm water. Once clean, follow up with a water based insect spray to kill the spiders around the base and main housing of the unit.

DO NOT use a petroleum based insect spray.

DO NOT use any solvent or corrosion inhibiting products on any part of the unit. This can cause serious stress cracking of the engineered resins and will void warranty.

### 2 Interior Maintenance

Before attempting the following maintenance procedures, turn off the power to the unit at the power supply panel.

### Note

The breakers on the unit DO NOT turn the unit power supply off and the buss bars will be energized.

### • Exposing the Buss Bar Assembly

Annually, remove the access panel (14 screws) to expose the buss bars.

### • Maintenance of Buss Bar Assembly

On all units, the buss bars should be visually examined for excessive heating. If potentially faulty or loose joints are found, they should be tightened or replaced.

In the cases where mechanical lugs instead of the stud-lug buss assembly are used, it is very important that they be examined closely. Most mechanical lugs are made of aluminum and are very susceptible to galvanic corrosion.

If the set screw cannot be tightened, replace the lug. If there appears to be corrosion around the copper to aluminum connection, remove the copper wire and clean the wire, coat the wire with an anti-corrosion grease, and retighten the assembly.

### • Receptacles and Breakers

The receptacles and breakers should be examined annually, and if any sign of heating is evident, the receptacles or breakers should be replaced.

### • Solvents

DO NOT spray any solvents on the electrical components. Solvents will cause stress cracking of the polymeric materials and will void warranty.

### 3 Lighting Assembly

To test the lighting assembly, the photocell should be covered with a piece of black tape and in about 2-3 minutes the light should illuminate. If this does not occur, the following items should be checked: photocell and bulb.

## Dimensions

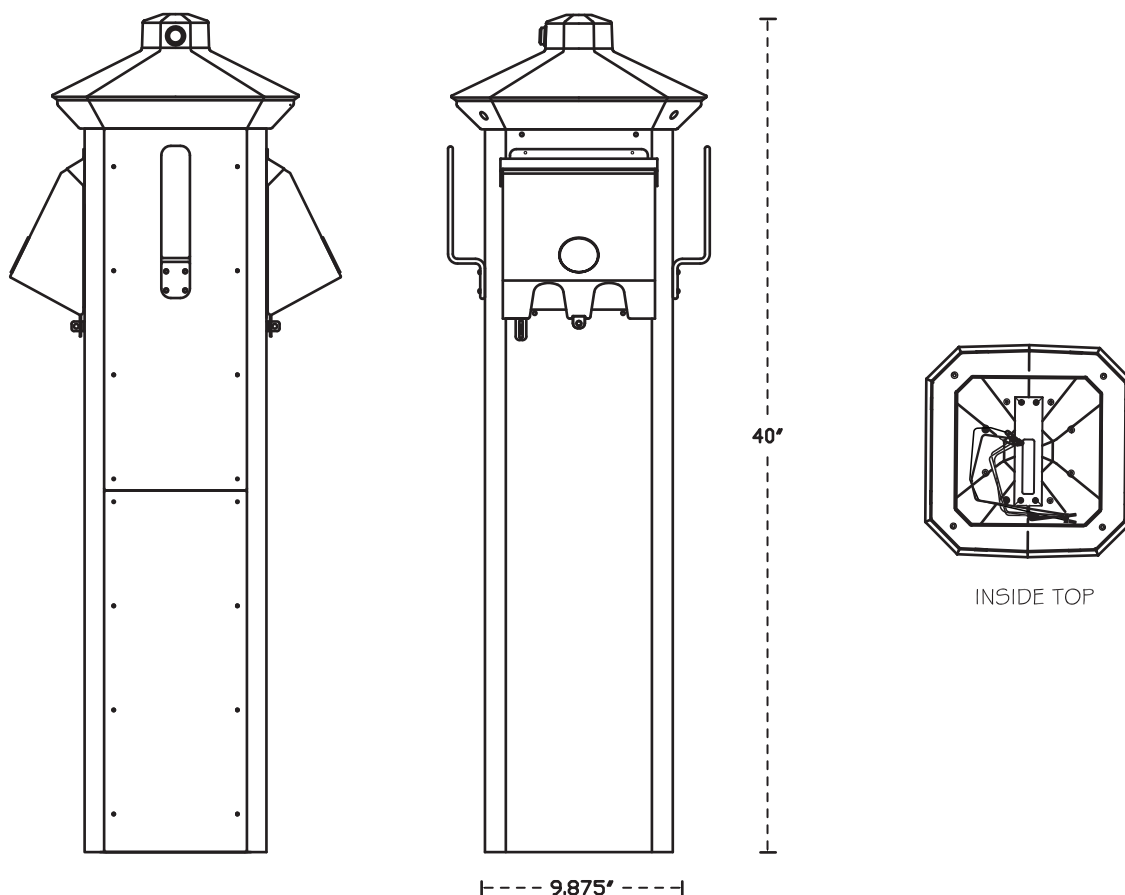

### 4 Winterizing

The water system should be purged with air and each ball valve should be opened and closed after the system has been drained. This will remove the slug of water that remains in the ball. No other winterizing functions are required.

## Operation

### 1 Connect Power Cord to Boat

Insert the proper end of the shore power cord into the boat's power inlet connection, twist the plug to lock, then tighten the locking plug retainer by twisting the large nut until the unit is tight to the boat.

### 2 Connect Power Cord to Pedestal

With the breakers off, insert the shore power cord into the receptacle and twist the plug clockwise until the plug locks into the receptacle.

### 3 Turn Breaker ON

With both connections secured, turn on the breaker. The power indicator on the boat should indicate a successful attachment of the plug and the receptacle.

## Parts

Please visit [www.marinapower.com](http://www.marinapower.com) for a full parts listing.

To request a parts handbook:

- Call 1-800-723-8009 or
- E-mail [marinaparts@eaton.com](mailto:marinaparts@eaton.com)

## Eaton Marina Power & Lighting Warranty Information

### Our Quality Pledge

Eaton is dedicated to developing and manufacturing the highest quality products while keeping true to our corporate ethics. Our warranty is one way that we strive to be the most admired company in our markets.

### Product Warranties

To obtain warranty service, discuss extended warranties or for questions contact us at [www.marinapower.com](http://www.marinapower.com) or call us at 800-258-8800.

Eaton Corporation  
Marina Power and Lighting  
149 Warwick Court  
Williamsburg, VA 23185  
United States  
tel: 1-800-723-8009  
fax: 757-258-8805  
[www.marinapower.com](http://www.marinapower.com)

## Base Diagram

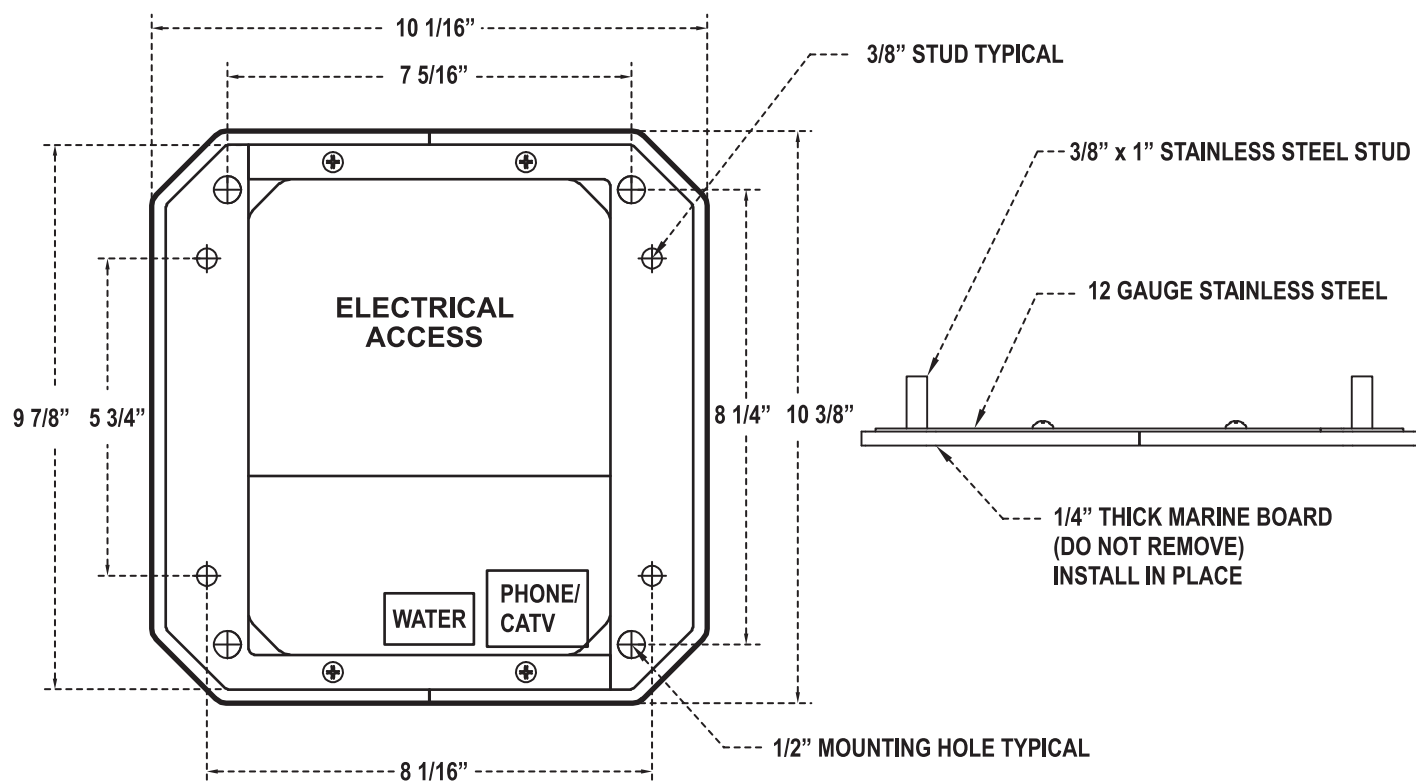

## Buss Bar Assemblies

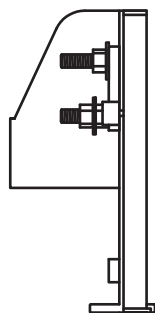
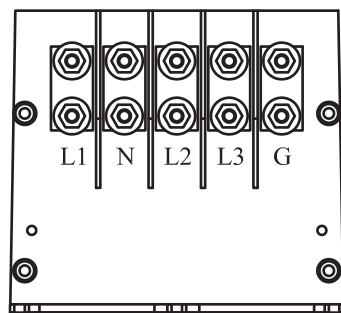

STANDARD LOOP FEED  
BUSS BAR ASSEMBLY  
SINGLE PHASE OR THREE PHASE

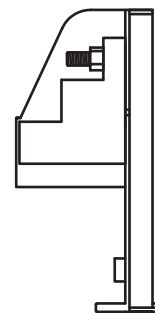
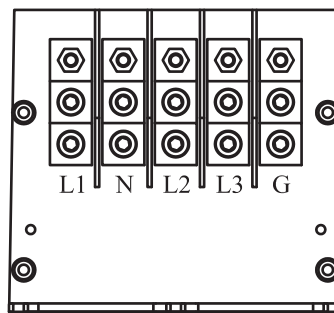

MECHANICAL LUG  
BUSS BAR ASSEMBLY  
SINGLE PHASE OR THREE PHASE

**Telephone and Cable TV  
Assembly**

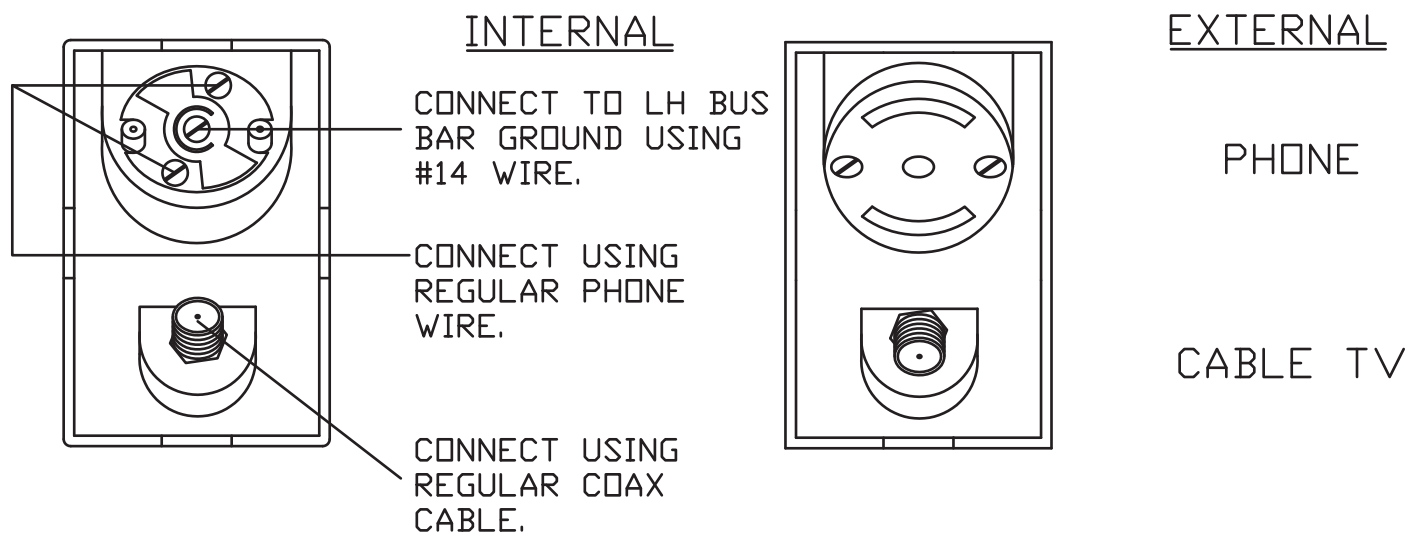

**Water Assembly**

