

PINNACLE®
SRI PETALING



ONE



LOCATION



COMMUNITY



PLACE



Type A1

2  2 

built-up area: 709 sq.ft.

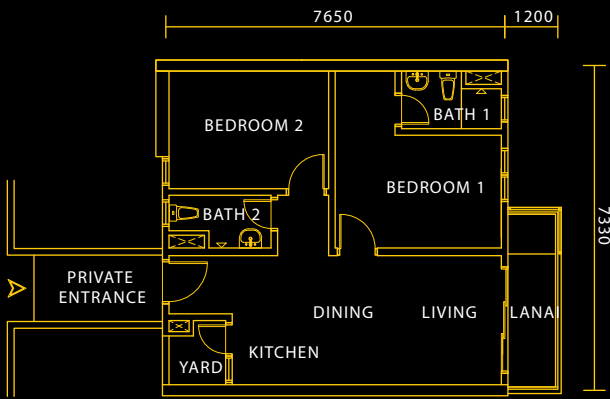

Type B1a

3  3 

built-up area: 812 sq.ft.

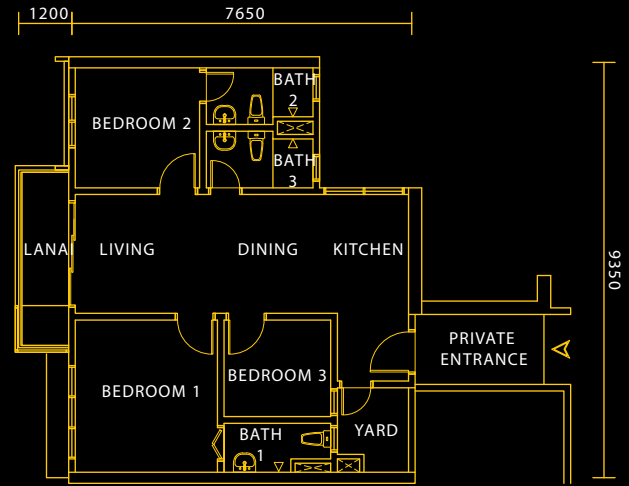

Type C1

3  3 

built-up area: 937 sq.ft.

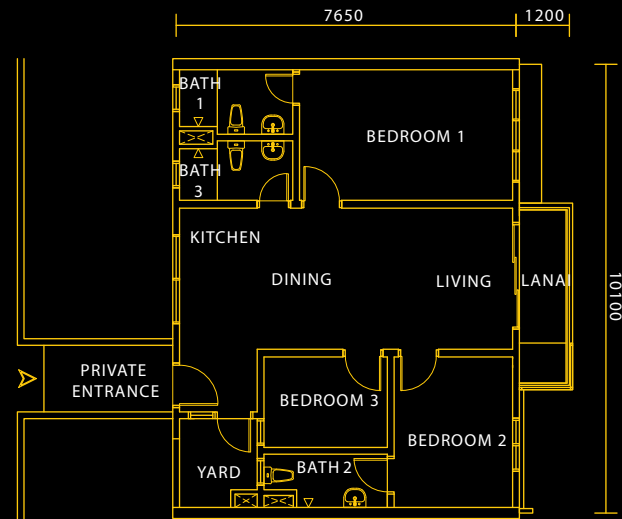

Type C1a

3+1  3 

built-up area: 1022 sq.ft.

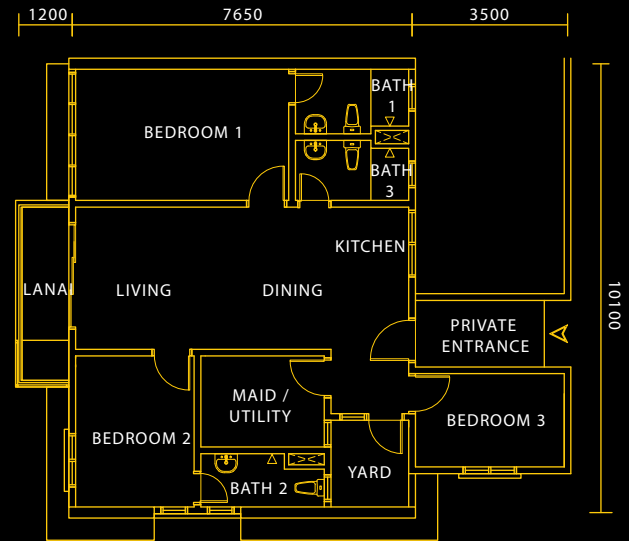

Type C1b

3  2 

built-up area: 884 sq.ft.

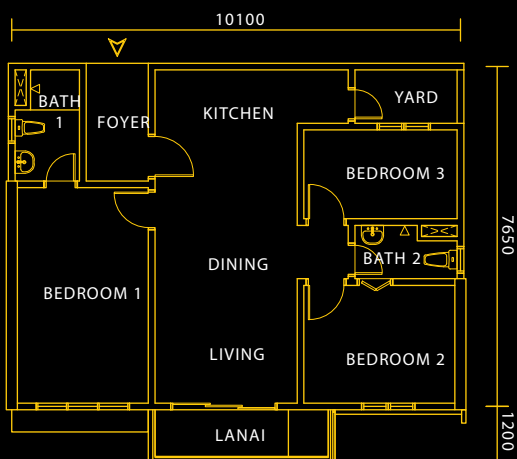

Type C2

3  3 

built-up area: 884 sq.ft.

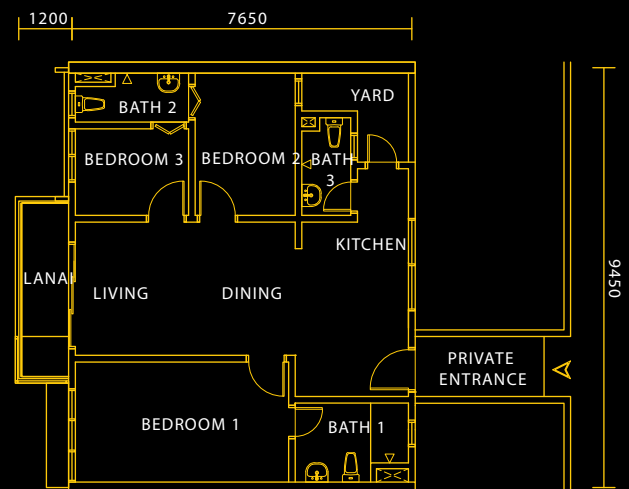

Type C2a

3 3

built-up area: 900 sq.ft.

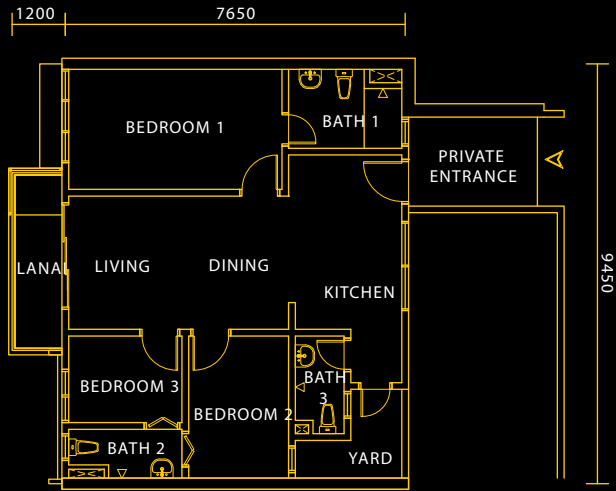

Type C3

3 3

built-up area: 914 sq.ft.

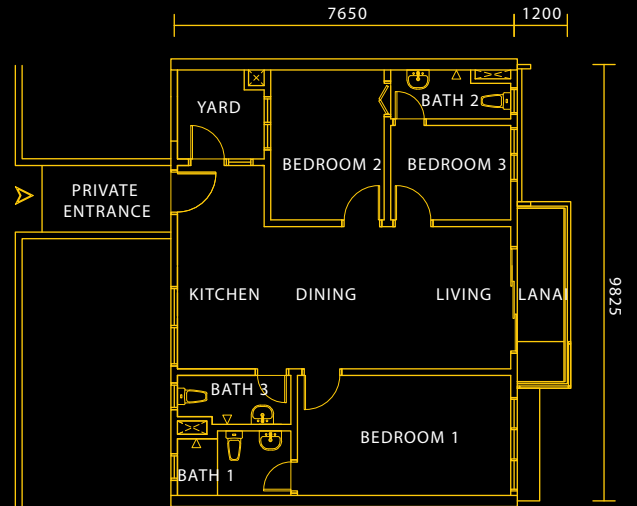

Type C4

3+1 3

built-up area: 975 sq.ft.

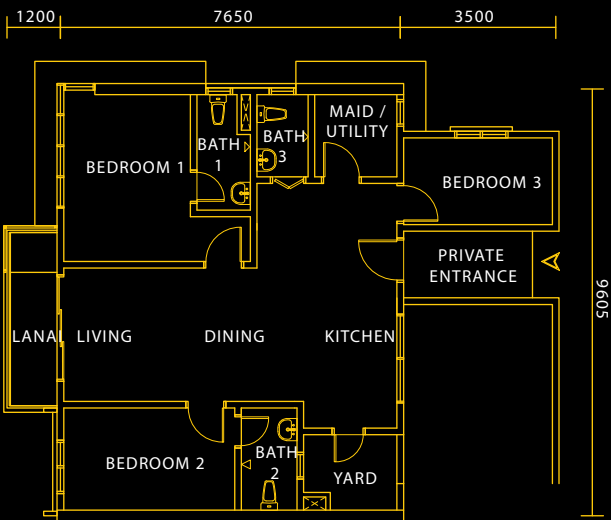

Type C4b

3+1 3

built-up area: 982 sq.ft.

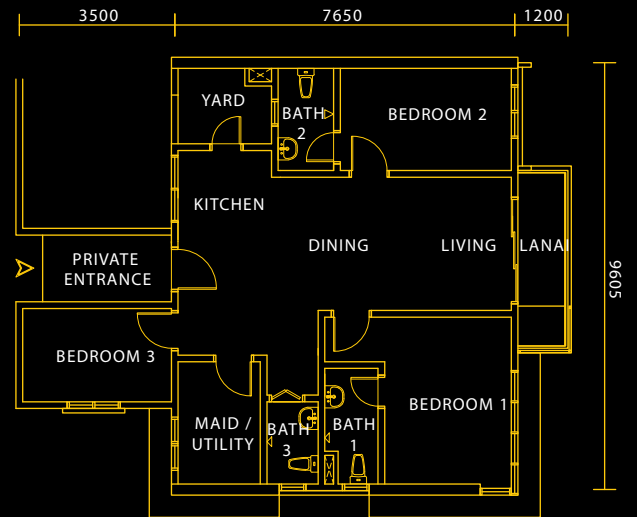

Type C5

3 3

built-up area: 855 sq.ft.

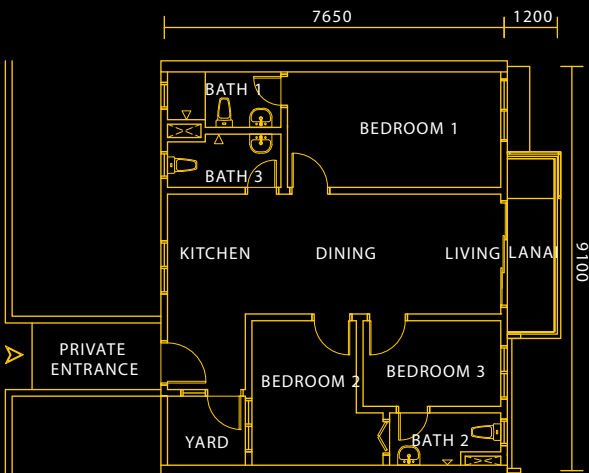

Type C6

3 3

built-up area: 911 sq.ft.

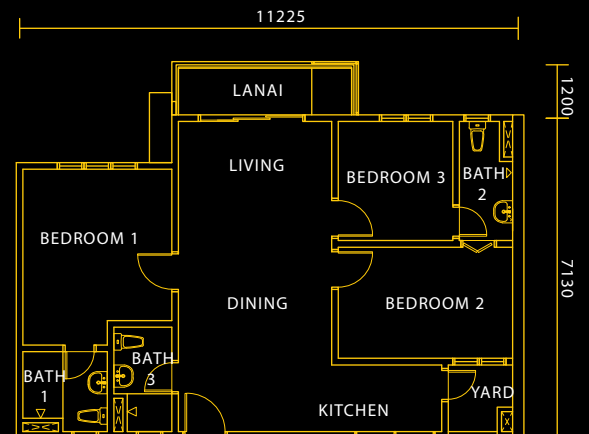



Level
10

Elevate Your Everyday Experience

At Pinnacle Sri Petaling, there's utter privacy and comfort within your own home. Yet, you can step out and instantly immerse yourself into an exquisite lifestyle with your own dedicated clubhouse.

- | | |
|-----------------------|---------------------------------------|
| 1 : Clubhouse | 09 : Jacuzzi |
| 2 : Multipurpose hall | 10 : Children's playground |
| 3 : Yoga deck | 11 : Toilets & changing rooms (m & f) |
| 4 : Daycare centre | 12 : Jogging track |
| 5 : Surau (m & f) | 13 : Zen garden |
| 6 : Gym room | 14 : BBQ pit |
| 7 : Swimming pool | 15 : Viewing deck
(above level 38) |
| 8 : Kid's pool | |

Facilities



artist's impression only

Viewing deck (above Level 38)



artist's impression only

Swimming pool @ Level 10



artist's impression only

Gymnasium @ Level 10

Interior



artist's impression only

Living area



artist's impression only

Bedroom



For more information please call:

+603-7932 2268

Developer:

Pinnacle Homes SP Sdn Bhd (Co. No. 828584-T)

Level 26A, Tower B, Pinnacle PJ, Jalan Utara C, 46200 Petaling Jaya, Selangor. F: +603-7932 2928

Pemaju : Pinnacle Homes SP Sdn Bhd (No. Sykt. 828584-T) Level 26A, Tower B, Pinnacle PJ, Jalan Utara C, 46200 Petaling Jaya, Selangor • Property Type : Apartment • Developer's License No : 14604-1/01-2021/01184(L) • Validity Date : 11/01/2020 – 10/01/2021 • Advertising & Sales Permit No : 14604-1/01-2021/01184(P) • Validity Date : 11/01/2020 – 10/01/2021 • Approving Authority : Dewan Bandaraya Kuala Lumpur • Building Plan No : BP S3 OSC 2016 1254 • Land Tenure: Leasehold 99 years (expiring 27 December 2115) • Restrictions in interest of land: This land can only be transferred, leased or changed upon approval of the state authority • Land Encumbrances : Maybank Islamic Berhad • Expected Date of Completion : December 2020 (48 months)

"THIS ADVERTISEMENT HAS BEEN APPROVED BY NATIONAL HOUSING DEPARTMENT."