



Logitech® G430 Surround Sound Gaming Headset

Guía de configuración

Guia de instalação



Logitech G430 Surround Sound Gaming Headset

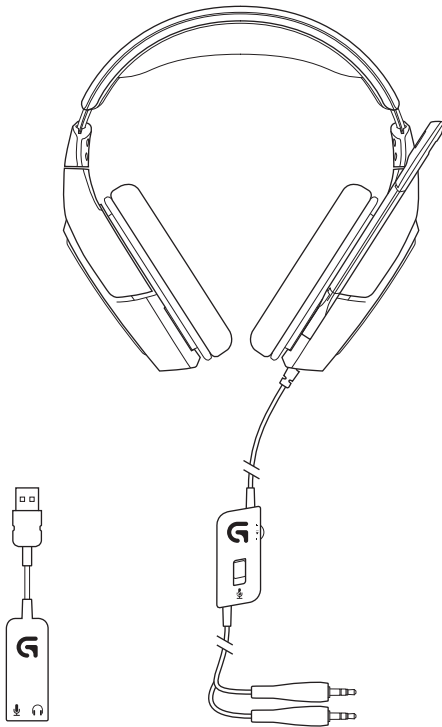

Español	4	Português	9
www.logitech.com/support 			15

Funciones

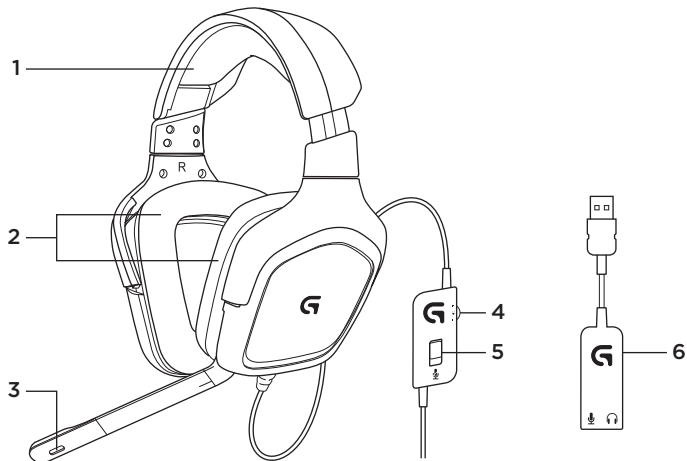

1. Audífono

2. Almohadillas extraíbles

3. Micrófono

4. Control de volumen

5. Conmutador de silencio de micrófono

6. Adaptador de audio USB

Configuración

1

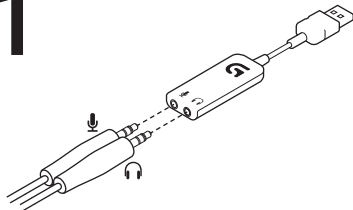

2

www.logitech.com/support/g430

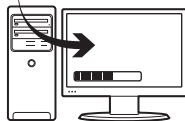

3

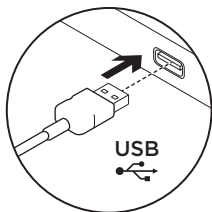

4



Inicia el software de G430 para una mejor experiencia.

Cambiar la configuración del audífono

Configuración de volumen y ecualizador

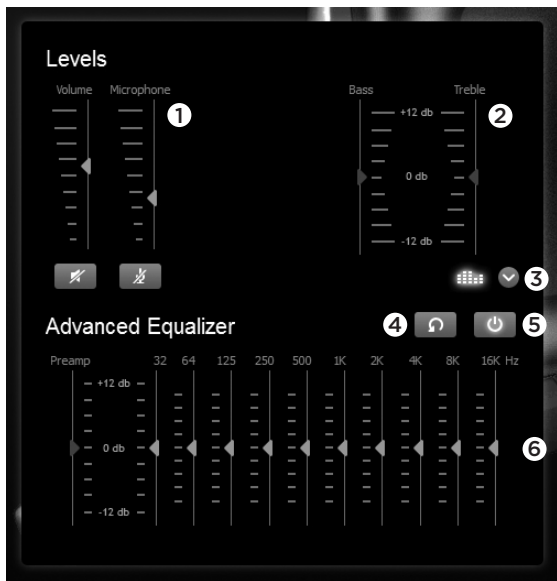

1. Volumen de auriculares y micrófono
2. Control de graves y agudos
3. Selección de ecualizador avanzado

4. Restablecer la configuración de EQ
5. Activar ecualización avanzada
6. Configuración de EQ

Configuración de envolvente

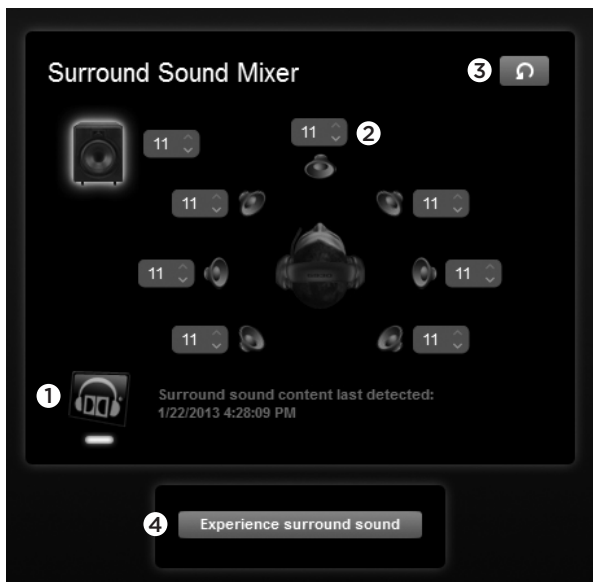

1. Conmutador de sonido envolvente
2. Ajustes de volumen de la fuente de sonido
3. Restablecer los niveles de la fuente de sonido
4. Probar sonido envolvente

Limpieza de las almohadillas

1. Extracción

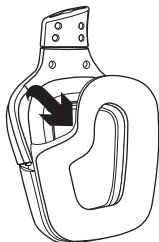

2. Lavado

- a. Una vez extraídas, las almohadillas se pueden lavar en agua templada.
- b. Para secar, presionar con una toalla suave; no retorcer.
- c. Dejar secar al aire antes de volver a colocar.

3. Sustitución

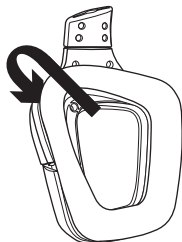

¿Cuál es tu opinión?

Nos gustaría conocerla, si puedes dedicarnos un minuto.
Te agradecemos la adquisición de nuestro producto.

www.logitech.com/ithink

Recursos

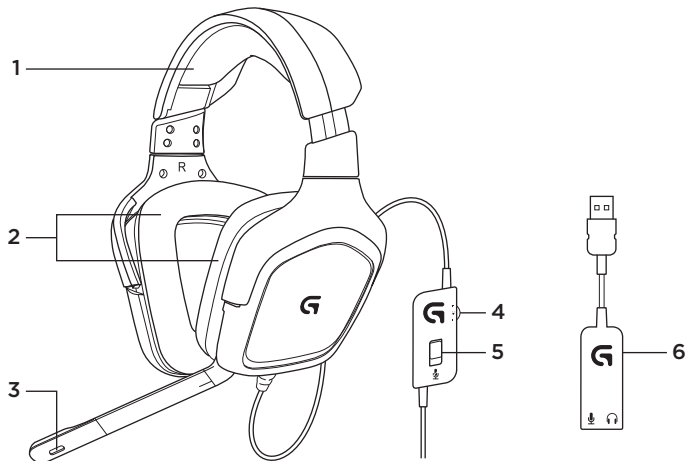

1. Headset

2. Conchas de ouvido removíveis

3. Microfone

4. Controle de volume

5. Interruptor de mute do microfone

6. Adaptador de áudio USB

Instalação

1

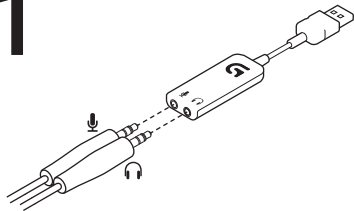

2

www.logitech.com/support/g430

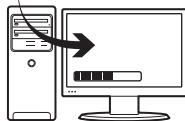

3

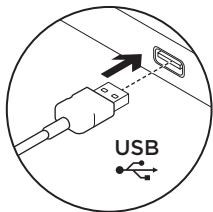

4



Inicie o software G430 para obter a melhor experiência.

Mudar as configurações do headset

Configurações de volume e equalizador

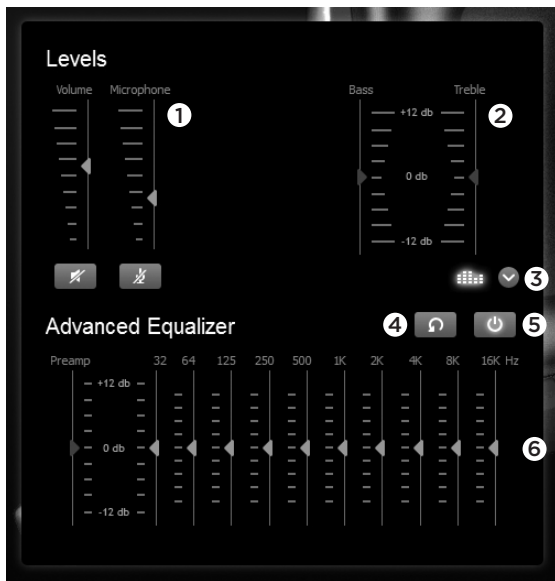

1. Volume do headset e microfone
2. Controle de graves e agudos
3. Seleção avançada do equalizador

4. Redefinir configurações do equalizador
5. Ligar equalização avançada
6. Configurações de equalização

Configurações de surround

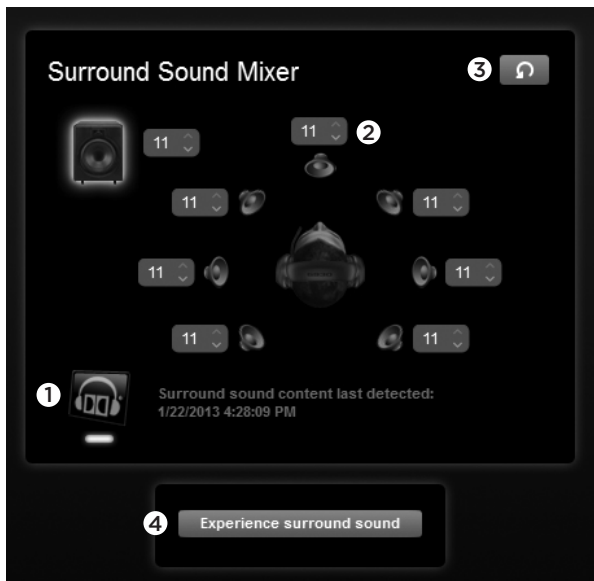

1. Interruptor de som surround
2. Ajustes de volume de fontes de som
3. Redefinir níveis de fontes de som
4. Testar som surround

Limpeza das conchas de ouvido

1. Remoção

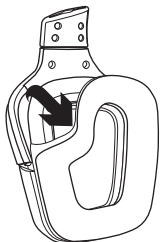

2. Lavagem

- a. Uma vez removidas, as conchas podem ser lavadas a mão em água morna.
- b. Para secar, pressione com toalha macia, não torça.
- c. Antes de recolocá-las, deixe-as secar naturalmente.

3. Substituição

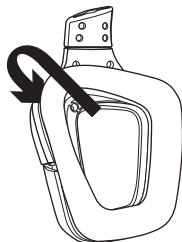

O que acha?

Reserve um momento para nos informar. Obrigado por adquirir nosso produto.

www.logitech.com/ithink

www.logitech.com/support/g430



Argentina	+00800-555-3284
Brasil	+0 800-891-4173
Canada	+1 866-934-5644
Chile	1230 020 5484

Colombia	01-800-913-6668
Latin America	+1 800-578-9619
Mexico	01.800.800.4500
United States	+1 646-454-3200



www.logitech.com

© 2013 Logitech. All rights reserved. Logitech, the Logitech logo, and other Logitech marks are owned by Logitech and may be registered. Manufactured under license from Dolby Laboratories. Dolby, Pro Logic, and the double-D symbol are registered trademarks of Dolby Laboratories. Confidential unpublished works. Copyright 2004 Dolby Laboratories. All rights reserved. All other trademarks are the property of their respective owners. Logitech assumes no responsibility for any errors that may appear in this manual. Information contained herein is subject to change without notice.

620-005115.003

Model: A-00060; A-00061