

**RUSHMORE**

# RUSHMORE

Luxury Fifth Wheels



**CROSSROADS**  
Recreational Vehicles

**CROSSROADS**  
Recreational Vehicles



**RF35CK floor plan shown in Sage décor**

The Rushmore ushers in a whole new era of RV living. These visionary fifth wheels lead the way in comfort, luxury, and innovation with interiors that rival a fine home. The Rushmore kitchen goes way beyond the essentials with quality features and details that make the difference between ordinary and outstanding. Like all Rushmore floor plans, this beautiful island kitchen features ample solid surface countertops, a large double sink with brushed nickel high rise faucet, and rich natural cherry wood cabinetry with enough storage space for even large pots and pans.



**RF35CK shown in Sage décor**

Bask in the warm glow of this stunning floor-to-ceiling slate-look stone fireplace in the Rushmore 35CK living room. Increasing your enjoyment is the 40 inch HD LCD television with telescoping mounting bracket for maximum viewing. All these extraordinary standard features make it hard to believe this is a home on wheels!

**RF36SB shown in sage with optional roll-away island and fireplace**

Take hearth and home wherever you go. This model features a beautifully equipped, fully functional kitchen with optional roll-away island. Enjoy your culinary creations in front of the cozy fireplace.





**RF38CK shown in Mocha with optional fireplace**

The Rushmore's residential features enhance the RV living experience of every floor plan. Available features include built-in hutch, entertainment center, and an innovative roll-out desktop, cleverly concealed below the 40 inch HD LCD TV. Enjoy the home theater surround sound system, five-disc changer, and five ceiling flush mount speakers. Innovative thinking and highly efficient design create a relaxing, spacious living environment.



Optional roll-away island

**RF38CK shown in Mocha décor**

Each Rushmore floor plan has been designed with careful attention to detail. Two sky view windows enhance your home with plenty of refreshing natural lighting. You'll also appreciate the extra storage capacity of the handsome built-in hutch, the bonus 19 inch HD LCD TV in the kitchen, residential ceiling fan, and energy efficient halogen lighting.



In-sofa arm storage

**RF34SB shown in Mocha décor**

The Rushmore living room is furnished with two luxurious leather recliners that swivel and a relaxing leather hide-a-bed sofa with large storage space cleverly hidden in each arm. In the dining area, entertain family and guests in comfort and style at the lovely dinette table with two solid back fabric chairs plus two convenient stow-away chairs.



Generous bathroom storage



**RF34SB shown in Mocha décor**

Stepped-up cathedral style natural cherry wood cabinets are not only pleasing to the eye, but also house the over-the-sink light. All Rushmore kitchens come standard equipped with spacious pantries, a large eight cubic foot gas/electric refrigerator, microwave, generous 22 inch oven, three-burner stovetop, and flush mount range hood.

Walk all the way around this pillow-top queen bed or upgrade to the optional memory foam king size bed. Either way, end your day stretched out in quiet comfort and blissful support in your elegant master bedroom.

This nightly refuge includes additional abundantly-sized multiple storage spaces. Stow your stuff in his and hers wardrobe closet, the beautiful etched glass paneled over-bed cabinets, the under-bed storage areas, or in the stackable washer/dryer closet.

# RUSHMORE

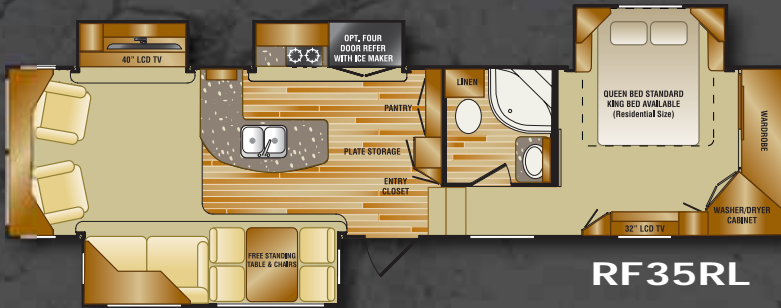
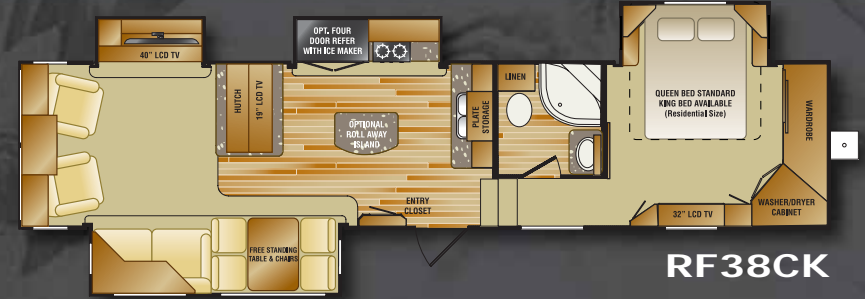
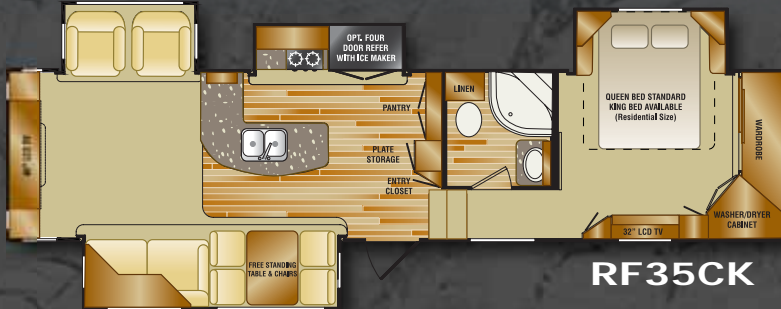
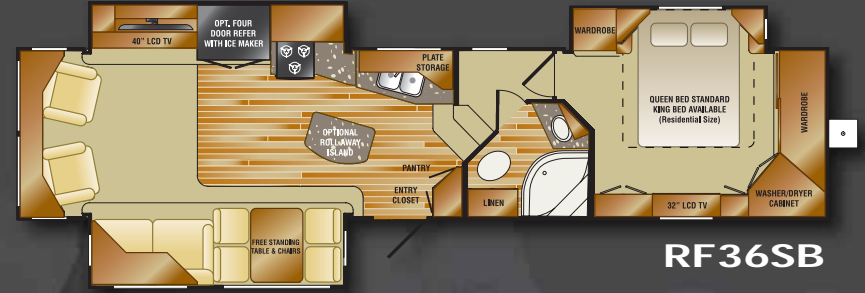

SPECIFICATIONS	RF34SB	RF35CK	RF35RL	RF36SB	RF38CK
Dry Weight	11352	11995	11888	12129	12575
Carrying Capacity	4148	3505	3612	3371	2925
Hitch Weight	2514	2550	2533	2618	2295
Axle Weight	8838	9445	9355	9511	10280
Exterior Length	35' 11"	37' 6"	37' 6"	39' 1"	39' 11"
Ext. Height with AC	12' 9"	12' 9"	12' 9"	12' 11"	12' 11"
Tire Size	ST235/8016E	ST235/8016E	ST235/8016E	ST235/8016E	ST235/8016E



Best Warranty in the Industry

### Tanks

- Fresh water capacity - 58 gallons
- Black water capacity - 40 gallons
- Grey/galley capacity - 80 gallons



## STANDARD FEATURES



# linc

## Bringing you into the future of RV'ing

- First ever: touch screen wireless remote system for your RV!
- Conveniently control multiple functions from one device.
- Store reference guides and owner's manuals for rapid access and quick troubleshooting.
- Screens feature the intuitive and familiar "iPod™" style button configuration.



Owner's Manuals



Quick Reference Guides



Power Awnings



Multiple Slide Rooms



Hot Water Heaters



Generators



Interior/Exterior Lights



Power Landing Gear



Stabilizer Jacks

## IntelliJacks™

Makes your landing gear intelligent



**Automated System for Your Fifth Wheel**  
 IntelliJacks takes the guesswork out of connecting, disconnecting and leveling your fifth wheel. With the single press of a button, IntelliJacks moves the fifth wheel to the exact position for connecting, disconnecting and leveling.

### One Touch Control

- Connect Position
- Disconnect Position
- Level
- Leg Retraction



## RVLOCK

— KEYLESS —

### NEW RV Lock™ Integrated Locking System

RV Lock Systems encompass over ONE MILLION combinations, making it the most secure system on the market. Locks feature wiring fully integrated within the lock and operate dependably and securely with fewer necessary parts.



# RUSHMORE



Roll-out desktop



Entry light with separate wall switch



(washer/dryer not included)

Stackable washer/dryer closet



(N/A on RF34SB)

Entry broom/coat closet



Water management system



Solid surface countertop with pull-out high-rise faucet



(Optional)

King size residential memory foam mattress



Stowaway dinette chairs & storage under bed



Sky view windows and solid cherry wood fascia on slide-outs



Easy to access pass-thru storage with slam latch



Toolbox storage on door side under awning



Standard bedroom dresser with optional 32" LCD TV



40" LCD TV standard on all models



Standard Trailair Equa-Flex™ Equalizer suspension ensures a smoother ride, more stable towing and improved coach and vehicle safety. On broken pavement at 55 mph, Equa-Flex™ reduced G-force up to 89% (360Hz) at the trailer frame. It's the ultimate rough road remover!



Optional Trailair Rota-Flex™ Pin Box. This pivoting head pin box utilizes a proprietary rubber compound that dramatically reduces fore to aft movement, or "chucking," typically felt inside the tow vehicle.

[  Applied Consumer Idea ]

## STANDARDS & OPTIONS

### Camping Package

- 8 cubic foot gas & electric refrigerator
- 40" HD LCD TV in living room
- Champagne colored high-gloss gel coat fiberglass
- Electric awning
- 16" aluminum wheels
- Full extension ball bearing drawer guides
- Satellite prep (on roof)
- Black tank flush
- Water management system
- Entry light with separate wall switch (pg. 10)
- Cook-top lighting above range
- Central command station behind cabinet door

### Scenic Touring Package

- Slam latch luggage doors
- Queen bed w/ pillow top innerspring mattress
- 15,000 BTU A/C
- Upgrade "Polartec" Insulation
- Spare tire & under mount carrier
- 10 gallon gas/electric water heater
- Central vac system
- 30" Over the range microwave
- Lexus Leather Luxury Touring hide-a-bed sofa
- Equa-Flex rubber suspension system

### Exterior Standards

- TV antenna with cable input
- High gloss chocolate colored exterior metal skirting
- Non-slip rubber flooring in pass through storage compartment
- 50 AMP detachable power cord
- 75 AMP power converter
- Toolbox storage located on the forward door-side under awning (pg. 10)
- IntelliJacks™ (pg. 9)
- RV Lock keyless entry with lighted threshold (pg. 9)
- Linc multi-functional remote system (pg. 9)
- Outside shower (pg. 10)
- Rear ladder

### Living Standards

- (2) Lexus leather luxury touring recliner gliders
- (2) Sky view window/windows
- Flush floor slide-outs with cherry wood slide-out fascia
- Home theater surround sound system, 5 disc changer, sub woofer, and 5 ceiling flush mount speakers
- Ceiling fan with light
- Flush mount halogen lighting

### Kitchen Standards

- Solid surface countertops
- 22" oven with 3 burner stovetop and flush mount range cover
- 8 cu. ft. refrigerator
- Natural cherry wood raised panel cathedral cabinet doors with hidden hinges
- Full camper water purifier
- Pull out high-rise faucet and sprayer
- Solid surface sink covers
- Double pantry
- Designer lighting
- Free standing dinette with 2 folding storage chairs and 2 dinette chairs

### Bedroom Standards

- Prep for 2nd A/C
- Giant under-bed storage with gas struts
- Stackable washer & dryer prep
- Lighted steps
- Luxury pillow package
- Pillow-top queen size bed
- Overstuffed pleated bedspread to coordinate with fabric décor choice
- Designer headboard

### Bath Standards

- Power vent with fan
- Solid surface countertop with large sink
- Extra large linen closet
- Neo angled fiberglass shower with glass shower door
- Skylight in shower
- Porcelain foot flush toilet
- EZ winterization kit with water heater bypass
- Medicine cabinet
- Large double door linen cabinet (pg. 7)

### Décor Standards

- Day/night shades throughout
- 6 panel raised passage door for bathroom
- Designer passage door with full length mirror in bedroom
- Brushed nickel hardware and fixtures throughout
- Natural cherry real wood stiles

### Construction Standards

- 6 sided aluminum framing
- 7,000lb axles
- 235/80R "E" rated 16" tires
- 10" steel I beam drop frames
- Premium plywood roof and floor decking

### Safety Standards

- Fire extinguisher
- LP detector
- Smoke detector

### Options

- Rota-Flex pin box
- Fantastic fan rain sensor - bathroom
- Fantastic fan rain sensor - kitchen
- Low profile 13.5 AC bedroom (ducted)
- Maximum linoleum in living room
- Insulated windows
- Slide-out awning - main
- Slide-out awning - bedroom
- Slide-out awning - 3rd
- Slide-out awning - 4th
- Cloth sofa
- Modern air HAB IPO innerspring HAB
- Fireplace (standard in 35CK)
- 5.5 Onan LP generator installed
- Generator prep
- King bed with memory foam mattress
- 12 Cubic foot side by side refrigerator with ice maker
- 32" HD TV in bedroom
- Rollaway island kitchen (38CK, 36SB, 34SB)
- Convection microwave
- "Level Up" 6 point hydraulic leveling system

# RUSHMORE



facebook twitter



**THOR**  
INDUSTRIES, INC.

Thor Industries' strong financial position and industry leadership are your assurance that we will be here to serve you for years to come.



The company conserving today  
to protect tomorrow.

**888-226-7496**

Standards, options & specifications subject to change without notice. 2/11 © 2011 CrossRoads RV

YOUR LOCAL DEALER



WWW.CROSSROADSRV.COM

