



# M-9603-M50CJ COLD AIR INTAKE INSTALLATION INSTRUCTIONS

NO PART OF THIS DOCUMENT MAY BE REPRODUCED WITHOUT PRIOR AGREEMENT AND WRITTEN PERMISSION OF FORD RACING PERFORMANCE PARTS.

Please visit [www.fordracingparts.com](http://www.fordracingparts.com) for the most current instruction information

**!!! PLEASE READ ALL OF THE FOLLOWING INSTRUCTIONS CAREFULLY PRIOR TO INSTALLATION.  
AT ANY TIME YOU DO NOT UNDERSTAND THE INSTRUCTIONS, PLEASE CALL THE FORD RACING  
TECHLINE AT 1-800-367-3788 !!!**



Factory Ford shop manuals are available from Helm Publications, 1-800-782-4356



# M-9603-M50CJ COLD AIR INTAKE INSTALLATION INSTRUCTIONS

NO PART OF THIS DOCUMENT MAY BE REPRODUCED WITHOUT PRIOR AGREEMENT AND WRITTEN PERMISSION OF FORD RACING PERFORMANCE PARTS.

## COLD AIR INTAKE KIT:

ITEM NO.	P/N	Description	REV-A/QTY.
1	997-457	Ford Racing Filter	1
2	KIT320T	TUBE, ASSY.	1
3	KIT238CAD	Cool Air Box	1
4	KITHUMPHS37	Silicone Hump Hose	1
5	KIT320MAFADA	Filter Adapter	1
6	KITWSTRIP03	Weather Strip 25"	1
7	KIT15DHC3050	1/4-20 x 1/2" Button Head Cap Screw	3
8	KIT09FWZ019	1/4" Flat Washer	3
9	KIT158HC3038	8-32 x 3/8" Button Head Cap Screw	2
10	KITHS72	#72 Hose Clamp	2
11	KITHS80	#80 Hose Clamp	1
12	KITFITTING15	PCV FITTING	1
13	KITGRMT10	GROMMET	1

\*Denotes previously removed from vehicle

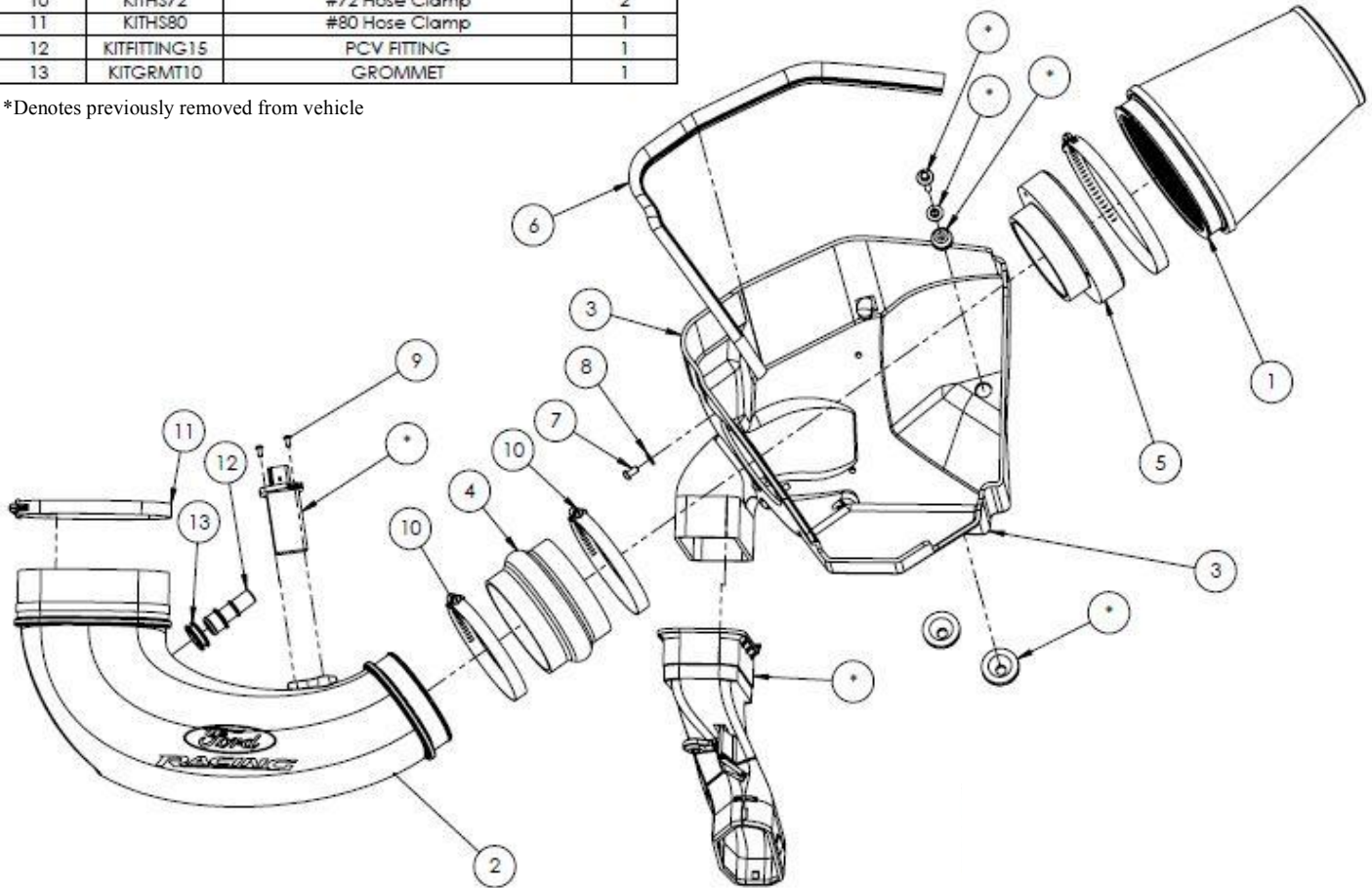

Factory Ford shop manuals are available from Helm Publications, 1-800-782-4356

NO PART OF THIS DOCUMENT MAY BE REPRODUCED WITHOUT PRIOR AGREEMENT AND WRITTEN PERMISSION OF FORD RACING PERFORMANCE PARTS.

## INSTALLATION INSTRUCTIONS:

**Note:** Installation shown on 2012/13 Boss 302. Cold air kit (M-9603-M50CJ) must be used when using intake manifold (M-9424-M50CJ) and throttle body (M-9926-CJ 65 or equivalent oval throttle body).

**STEP 1:** Disconnect battery.

**STEP 2:** Unplug the mass airflow sensor by releasing the safety clip and unclipping the connector.



**STEP 3:** Remove intake resonator tube by depressing the hose clamp. Remove the tube.



**STEP 4:** Remove bolt holding resonator tube to the frame rail. Remove tube from the bulkhead by pulling gently.



Factory Ford shop manuals are available from Helm Publications, 1-800-782-4356

NO PART OF THIS DOCUMENT MAY BE REPRODUCED WITHOUT PRIOR AGREEMENT AND WRITTEN PERMISSION OF FORD RACING PERFORMANCE PARTS.

**STEP 5:** Install firewall grommet into the resulting opening in the bulkhead from STEP 4.

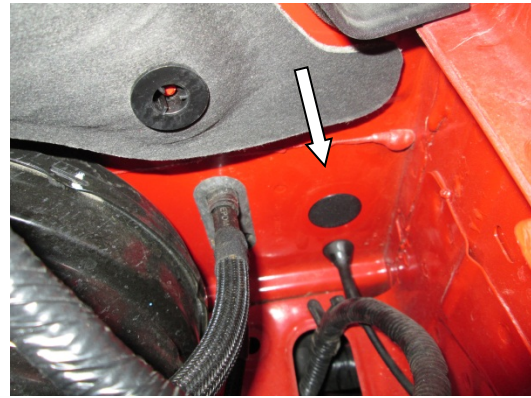
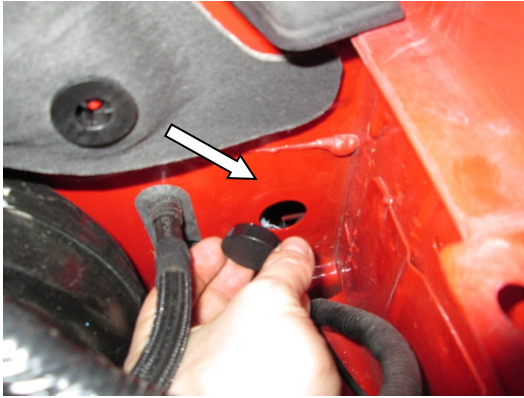

**STEP 6:** Remove breather hose by depressing safety clip and sliding the tube off of the intake tube.



**STEP 7:** Loosen both intake tube hose clamps at the throttle body and air-box assembly.

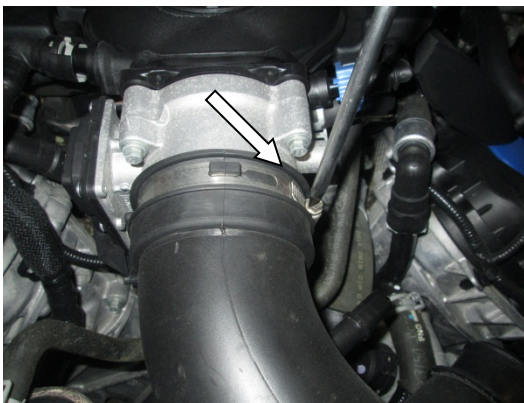

NO PART OF THIS DOCUMENT MAY BE REPRODUCED WITHOUT PRIOR AGREEMENT AND WRITTEN PERMISSION OF FORD RACING PERFORMANCE PARTS.

**STEP 8:** Gently slide the intake tube off of the throttle body then off of the air-box. Remove from car.



**STEP 9:** Remove the air-box retaining bolt. Remove air-box from car.



**STEP 10:** Remove 2 screws from the mass airflow sensor and remove from the production intake tube.

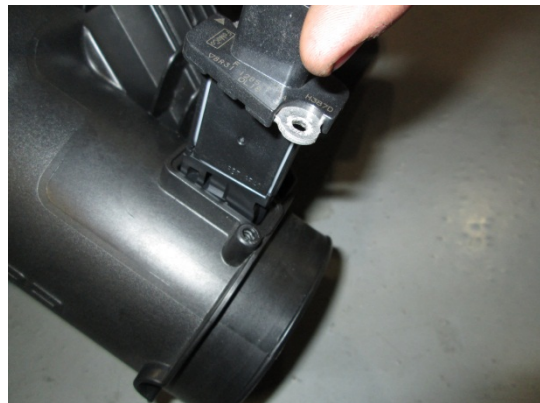

NO PART OF THIS DOCUMENT MAY BE REPRODUCED WITHOUT PRIOR AGREEMENT AND WRITTEN PERMISSION OF FORD RACING PERFORMANCE PARTS.

**STEP 11:** Install the mass airflow sensor into the new intake tube, ensuring proper orientation. Install the 2 provided MAF screws and tighten.



**STEP 12:** Install the provided grommet into the provision on the intake tube. Install the aluminum fitting into the grommet. A small amount of white lithium grease on the aluminum fitting will aid in the installation of the fitting.



NO PART OF THIS DOCUMENT MAY BE REPRODUCED WITHOUT PRIOR AGREEMENT AND WRITTEN PERMISSION OF FORD RACING PERFORMANCE PARTS.

- STEP 13:** Install the urethane hump hose onto the intake tube with 1 medium hose clamp and tighten. Torque to 44.25 in-lb +/- 1.75 in-lb (5.0 Nm +/- 0.2 Nm).

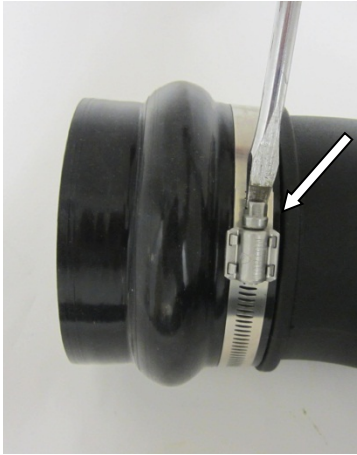

- STEP 14:** Install the filter adapter into the air-box using the 3 provided button head bolts and tighten.

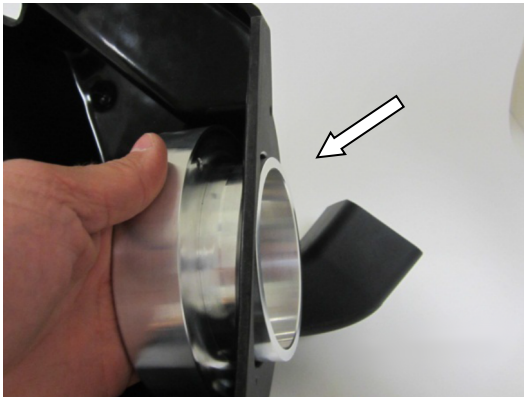

Factory Ford shop manuals are available from Helm Publications, 1-800-782-4356

NO PART OF THIS DOCUMENT MAY BE REPRODUCED WITHOUT PRIOR AGREEMENT AND WRITTEN PERMISSION OF FORD RACING PERFORMANCE PARTS.

**STEP 15:** Install the new air-box assembly by sliding it into the OEM air scoop. Reinstall the air-box retaining bolt removed in STEP 9. Note: Use the 2 rubber grommets from the underside of the removed air-box on the new air-box.

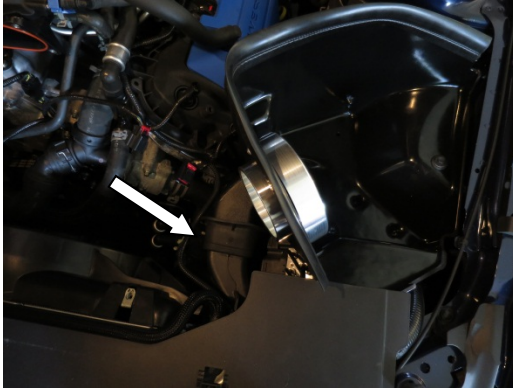

**STEP 16:** Install the provided weather strip around the perimeter of the newly installed air-box.



**STEP 17:** Install the intake tube onto the throttle body with 1 large hose clamp then over the air filter adapter with 1 medium hose clamp. Torque all clamps to 44.25 in-lb +/- 1.75 in-lb (5.0 Nm +/- 0.2 Nm).

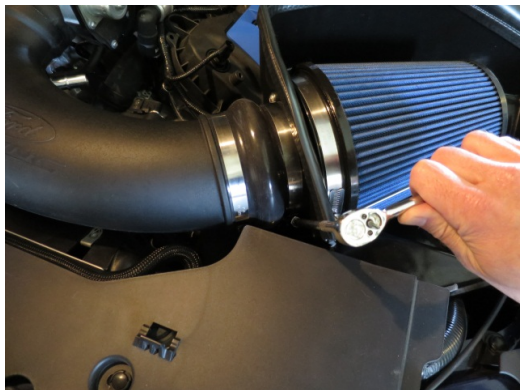

Factory Ford shop manuals are available from Helm Publications, 1-800-782-4356



NO PART OF THIS DOCUMENT MAY BE REPRODUCED WITHOUT PRIOR AGREEMENT AND WRITTEN PERMISSION OF FORD RACING PERFORMANCE PARTS.

**STEP 18:** Install the breather hose onto the intake tube aluminum fitting.



**STEP 19:** Connect the mass airflow meter connector, ensuring the safety clip is in the locked position.



**STEP 20:** Install the new air filter onto the air filter adapter and tighten.

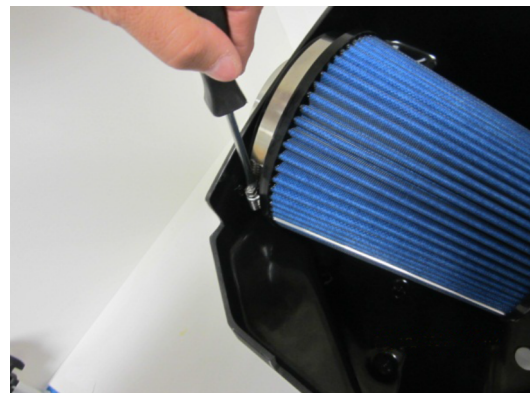
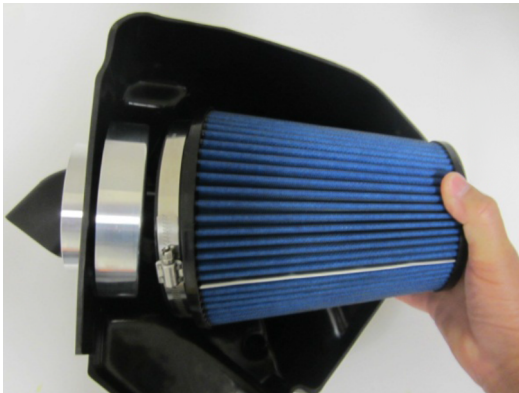



## M-9603-M50CJ COLD AIR INTAKE INSTALLATION INSTRUCTIONS

NO PART OF THIS DOCUMENT MAY BE REPRODUCED WITHOUT PRIOR AGREEMENT AND WRITTEN PERMISSION OF FORD RACING PERFORMANCE PARTS.

**STEP 21:** Reconnect the battery.



Factory Ford shop manuals are available from Helm Publications, 1-800-782-4356