



MAGNETOS

SUPER MAG SERIES MAGNETOS

SUPER-MAG III and SUPER MAG IV

Designed specifically for use in Monster Trucks, Tractor Pulling, drag racing and other short duration motorsports applications, the SUPER-MAG III and IV Series magnetos offers reliability and dependability at an affordable price. These magnetos are an excellent choice for turbocharged, or supercharged engines burning primarily alcohol/methanol, or nitro methane based fuels.

SUPER MAG III

Features At A Glance:

- Locked advance
- Available with either Mallory's COMP 9000 Series cap or a low profile flat cap where clearance is a problem
- 3.8 to 4.0 Amp output generator delivers 50-55 milli-amps of spark plug current
- Available with or without a mechanical tach drive
- Sold as complete magneto system with transformer or as separate generator and drive assemblies
- Additional models available for most popular 4 and 8 cylinder applications on a special order basis

SUPER MAG IV

Features At A Glance:

- Locked advance
- Neodymium-Iron-Boron Rare Earth Magnets never need recharging
- Available with either Mallory's COMP 9000 Series cap or a low profile flat cap where clearance is a problem
- 4.0 to 4.3 Amp output generator delivers 58-64 milli-amps of spark plug current
- Sold as complete magneto system with transformer or as separate generator and drive assemblies
- Available with or without a mechanical tach drive
- Additional models available for most popular 4 and 8 cylinder applications on a special order basis



3536544



28900A



7179044



28900A

Unless otherwise noted, products listed on pages 122-125 are not legal for sale or use in California on pollution controlled motor vehicles.

SUPER MAG APPLICATION CHART

Application/Description	SuperMag III			SuperMag IV		
	Flat Cap	Small Cap	Large Cap	Flat Cap	Small Cap	Large Cap
American Motors						
290, 304, 360, 390, 401 V-8	3553124	3553114	3553144	7153124	7153114	7153144
Chrysler						
331, 354 V-8	3527024	3527014	3527044	7127024	7127014	7127044
392, 417 Donovan V-8	3533724	3533714	3533744	7133724	7133714	7133744
340, 360 V-8	3549724	3549714	3549744	7149724	7149714	7149744
383, 400 V-8	3534624	3534614	3534644	7134624	7134614	7134644
413, 426W, 440 V-8	3536524	3536514		7136524	7136514	
426H, KB, JP-1, TFX	3536524	3536514		7136524	7136514	
Chevrolet						
262-502 (except 348,409 & tall/trk blocks)	3559524	3559514	3559544	7159524	7159514	7159544
Tall Block	3559024	3559014	3559044	7159024	7159014	7159044
Super Block w/ adjustable collar	3579024	3579014	3579044	7179024	7179014	7179044
Ford						
260, 289, 302 V-8	3544924	3544914	3544944	7144924	7144914	7144944
351W V-8	3556324	3556314	3556344	7156324	7156314	7156344
351C, 429, 460 V-8	3554624	3554614	3554644	7154624	7154614	7154644
351C, 429, 460 V-8 (1 1/4" shorter)	3559224	3559214	3559244	7159224	7159214	7159244
Oldsmobile						
400, 455 V-8	3550124	3550114	3550144	7150124	7150114	7150144
Pontiac						
389, 400, 428, 455 V-8 (exc. SD)	3531224	3531214	3531244	7131224	7131214	7131244

Contact factory for other applications

Unless otherwise noted, products listed on pages 122-125 are not legal for sale or use in California on pollution controlled motor vehicles.



MAGNETOS

SPRINTMAG SERIES

Mallory's famous SPRINTMAG Series offer outstanding reliability in Sprint Car, Midget Modifieds, Supermodifieds, and drag racing along with other forms of motorsports. They work equally well with gasoline, and alcohol/methanol based fuels.

SPRINTMAG

Features At A Glance:

- Excellent dependability at an affordable price
- Designed with a low profile flat cap for use where space is at a premium
- Locked advance for stable timing throughout the entire RPM range
- Models available for most popular V-8 engine applications
- Available as a complete magneto system complete with transformer or as separate generator and lower drive assemblies for additional flexibility
- 2.3 AMP output generator delivers an extra long spark with 28-30 milli-amps of current

SPRINTMAG II

Features At A Glance:

- Excellent dependability at an affordable price
- Designed with either a Mallory Super-Duty cap for use where space is at a premium or with Mallory's famous COMP 9000 large diameter cap assembly
- Locked advance for stable timing throughout the entire RPM range
- Models available for most popular 4 and 8 cylinder engine applications
- Available as a complete magneto system complete with transformer or as separate generator and lower drive assemblies for additional flexibility
- 2.3 AMP output generator delivers an extra long spark with 28-30 milli-amps of current



3959524



28900A



4359524



4331014



28900A

Unless otherwise noted, products listed on pages 122-125 are not legal for sale or use in California on pollution controlled motor vehicles.

MAGNETOS

SPRINTMAG SERIES



SPRINTMAG III

Features At A Glance:

- Lightest weight magneto system available – Period
- Designed with either a Mallory Super-Duty cap for use where space is at a premium or Mallory's famous COMP 9000 large diameter cap assembly
- Locked advance for stable timing throughout the entire RPM range
- Models available for most popular V-8 cylinder engine applications
- Available as a complete magneto system complete with transformer or as separate generator and lower drive assemblies for additional flexibility
- 50% more powerful – never needs recharging
- Lower drive combines stability of a ball bearing with the long life of a bushing for maximum stability and RPM

5358514



APPLICATION CHART

Application/Description	SPRINTMAG		SPRINTMAG II		SPRINTMAG III	
	Flat Cap		Small Cap	Large Cap	Small Cap	Large Cap
Chrysler						
331, 354 V-8	3927024		4327024	4327014		
392, 417 Donovan V-8	3933724		4333724	4333714		
340, 360 V-8	3949724		4349724	4349714	5329114	5329144
383, 400 V-8	3934624		4334625	4334614		
413, 426W, 440 V-8	3936524		4336524			
426H, KB, JP-1, TFX	3936524		4336524			
Chevrolet						
262-502 (except 348,409 & tall/trk blocks)	3959524		4359524	4359514	5358514	5358644
Above with adjustable collar						5358744
Tall Block	3959024		4359024	4359014		
Super Block w/ adjustable collar	3979024		4379024	4379014		
Ford						
260, 289, 302 V-8	3944924		4344924	4344914		
351W V-8	3956324		4356324	4356314	5356314	
351C, 429, 460 V-8	3954624		4354624	4354614		5354644
351C, 429, 460 V-8 (1 1/4" shorter)	3959224		4354624	4359214		
Oldsmobile						
400, 455 V-8	3950124		4350124	4350114		
Pontiac						
SD 2.5L/151 Iron Duke			4368624	4368614		
389, 400, 428, 455 V-8 (exc. SD)	3931224		4331224	4331214		
Volkswagen						
Air cooled flat 4			4354124	4354114		
Contact factory for other applications						

Unless otherwise noted, products listed on pages 122-125 are not legal for sale or use in California on pollution controlled motor vehicles.



MAGNETOS

MAGNETO DRIVE ASSEMBLIES



- Complete Drive Assembly
- New CNC Machined Housing
- Centerless Ground Shaft
- Aluminum-Bronze Drive Gear
- Stainless Steel Band Clamp
- Available With or Without Mechanical Tach Drive
- Timing Pointer

DRIVE ASSEMBLIES

Series	Description	Part No
310 Engine Series	Mag Drive w/o TD	35310
312 Engine Series	Mag Drive w/o TD	35312
337 Engine Series	Mag Drive w/o TD	35337
343 Engine Series	Mag Drive w/o TD	35343
346 Engine Series	Mag Drive w/o TD	35346
365 Engine Series	Mag Drive w/o TD	35365
449 Engine Series	Mag Drive w/o TD	35449
497 Engine Series	Mag Drive w/o TD	35497
498 Engine Series	Mag Drive w/o TD	35498
531 Engine Series	Mag Drive w/o TD	35531
541 Engine Series	Mag Drive w/o TD	35541
546 Engine Series	Mag Drive w/o TD	35546
563 Engine Series	Mag Drive w/o TD	35563
590 Engine Series	Mag Drive w/o TD	35590
591 Engine Series	Mag Drive w/o TD	35591
592 Engine Series	Mag Drive w/o TD	35592
594 Engine Series	Mag Drive w/o TD	35594
595 Engine Series	Mag Drive w/o TD	35595
686 Engine Series	Mag Drive w/o TD	35686
790 Engine Series	Mag Drive w/o TD	35790
310 Engine Series	Mag Drive w/TD	36310
312 Engine Series	Mag Drive w/TD	36312
337 Engine Series	Mag Drive w/TD	36337
343 Engine Series	Mag Drive w/TD	36343
346 Engine Series	Mag Drive w/TD	36346
365 Engine Series	Mag Drive w/TD	36365
449 Engine Series	Mag Drive w/TD	36449
497 Engine Series	Mag Drive w/TD	36497
541 Engine Series	Mag Drive w/TD	36541
546 Engine Series	Mag Drive w/TD	36546
563 Engine Series	Mag Drive w/TD	36563
590 Engine Series	Mag Drive w/TD	36590
592 Engine Series	Mag Drive w/TD	36592
291 Engine Series	Mag Drive SPRINT III	53291
546 Engine Series	Mag Drive SPRINT III	53546
563 Engine Series	Mag Drive SPRINT III	53563
585 Engine Series	Mag Drive SPRINT III	53585
586 Engine Series	Mag Drive SPRINT III	53586
587 Engine Series	Mag Drive SPRINT III	53587

MAGNETOS



MAGNETO GENERATOR ASSEMBLIES

- Complete Generator Assembly
- Includes Cap and Rotor



GENERATOR ASSEMBLIES

Type	Engine	Rotation	Cap Type	Cap No.	Part No
SprintMag (I)	8 cyl	RH	Stack Cap	204	29166
SprintMag (I)	8 cyl	LH	Stack Cap	204	29167
SprintMag (I)	8 cyl	RH	Flat Cap	221F	29162
SprintMag (I)	8 cyl	LH	Flat Cap	221F	29163
SprintMag (I)	4 cyl	RH	Stack Cap	206	29168
SprintMag (I)	4 cyl	LH	Stack Cap	206	29169
SprintMag II	8 cyl	RH	Pro Cap	29745	29228
SprintMag II	8 cyl	LH	Pro Cap	29745	29229
SprintMag II	8 cyl	RH	Stack Cap	205	29230
SprintMag II	8 cyl	LH	Stack Cap	205	29231
SprintMag II	4 cyl	RH	Pro Cap	29741	29232
SprintMag II	4 cyl	LH	Pro Cap	29741	29233
SprintMag II	4 cyl	RH	Stack Cap	207	29234
SprintMag II	4 cyl	LH	Stack Cap	207	29235
SprintMag III	8 cyl	RH	Stack Cap	208	29236
SprintMag III	8 cyl	LH	Stack Cap	208	29237
SprintMag III	8 cyl	RH	Pro Cap	29745	29238
SprintMag III	8 cyl	LH	Pro Cap	29745	29239
SuperMag III	8 cyl	RH	Stack Cap	205	29160
SuperMag III	8 cyl	RH	Pro Cap	29745	29160-3
SuperMag III	4 cyl	RH	Stack Cap	207	29161
SuperMag III	4 cyl	RH	Pro Cap	29741	29161-3
SuperMag III	8 cyl	LH	Stack Cap	205	29170
SuperMag III	8 cyl	LH	Pro Cap	29745	29170-3
SuperMag III	4 cyl	LH	Stack Cap	207	29171
SuperMag III	4 cyl	LH	Pro Cap	29741	29171-3
SuperMag IV	4 cyl	RH	Stack Cap	207	29144
SuperMag IV	4 cyl	RH	Pro Cap	29741	29144-3
SuperMag IV	4 cyl	LH	Stack Cap	207	29154
SuperMag IV	4 cyl	LH	Pro Cap	29741	29154-3
SuperMag IV	8 cyl	RH	Stack Cap	205	29164
SuperMag IV	8 cyl	RH	Pro Cap	29745	29164-3
SuperMag IV	8 cyl	LH	Stack Cap	205	29174
SuperMag IV	8 cyl	LH	Pro Cap	29745	29174-3



MAGNETOS

MAG SERVICE PARTS

Magneto Tune-Up Parts

SPRINT MAGS

SUPERMAGS

	I	II	III	II	III	IV	V (Points)	V (Elect)	VI	VII	X	XI
Point Set	25758M	25758M	25758M	25758M	25758M	25758M	25758M					
Condenser	28005A	28005A	28005	28005	28005	28005						
Distributor Cap, Rotor, Components (See Below)												

4 Cylinder Engines

Small Stack Cap 4 Cyl 4 Lobe Cam	206M	207M		207M	207M	207M						
Rotor for Above- LH Rot	28995A	28995A		28995A	28995A	28995A						
Rotor for Above- RH Rot	28995	28995		28995	28995	28995						
Large Stack Cap 4 Cyl 4 Lobe Cam		29741		29741	29741	29741						
Rotor for Above- LH Rot		29773C		29773C	29773C	29773C						
Rotor for Above- RH Rot		29772C		29772C	29772C	29772C						
Small Stack Cap 4 Cyl 8 Lobe Cam LH				257M	257M	257M						
Rotor for Above- LH Rot				28995A	28995A	28995A						
Small Stack Cap 4 Cyl 8 Lobe Cam RH				256	256	256						
Rotor for Above- RH Rot				28995	28995	28995A						

8 Cylinder Engines

Flat Cap- 8 Cyl	221F			28709	28709	28709						
Rotor for Above- LH Rot	28995A			29031	29031	29031						
Rotor for Above- RH Rot	28995			29030	29030	29030						
Small Stack Cap 8 Cyl	204	205M	208M	205M	205M	205M						
Rotor for Above- LH Rot	28995A	28995A	28995A	28995A	28995A	28995A						
Rotor for Above- RH Rot	28995	28995	28995	28995	28995	28995						
Large Stack Cap 8 Cyl		29745	29745	29745	29745	29745	29745	29745	29745	29745	29745	29745
Rotor for Above- LH Rot		29773C	29773C	29773C	29773C	29773C	29791C	29791	29795		29791	29791
Rotor for Above- RH Rot		29772C	29772C	29772C	29772C	29772C	29790C	29790	29794		29790	29790

Distributor Cap & Rotor Components

Large Stack Cap Wire Retainer		29744	29744	29744	29744	29744	29744	29744	29744	29744	29744	29744
Large Stack Cap Adapter Shield		29749	29749	29749	29749	29479	29749	29742	29742	29749	29742	29742
Rotor Adapter	29038	29038	29038	29038	29038	29038	29038					
Large Flat Cap Conversion Kit- LH				29375	29375	29375						
Large Flat Cap Conversion Kit- RH				29374	29374	29374						
Large Stack Cap Conversion Kit- LH		29774		29774	29774	29774						
Large Stack Cap Conversion Kit- RH		29771		29771	29771	29771						

Miscellaneous Service Parts

Advance Lock Out- 2 & 4 Pin	28103A	28103A	29073	28103A	28103A	28103A						
Band Clamp- Standard Duty				26041B								
Band Clamp- Heavy Duty					26041A	26041A	26041A	26041A	26041A	26041A	26041A	26041A
Capacitor (2 required for 8 amp mag)							28009					
Drive Flange 2 Pin	26007A	26007A	26007C									
Drive Flange 4 Pin				26007B	26007B	26007B	26007B	26007B	26007B	26007B	26007B	26007B
Electronic Trigger								606	606		606	606
Transformer- Oil Filled	28900A	28900A	28900A	28900A	28900A	28900A				28900A		
Transformer- Epoxy	28900B	28900B	28900B	28900B	28900B	28900B				28900B		

Wire Harnesses

Short 2 Wire Orange & Yellow	28998	28998	28860	28998	28998	28998						
Long 2 Wire Orange & Yellow	28862	28862	28861	28862	28862	28862		28862	28862		28862	28862
Short 2 Wire Generator							28133					
Long 3 Wire Gen. To Transformer							28131					
Long 3 Wire Gen. To Elect Cont Box								28134	28134		28134	28134

MAGNETO ACCESSORIES



Transformers for SUPERMAG, and SPRINTMAG Applications

SUPERMAG, Transformers are now available in two models. They are both externally mounted which makes for a more efficient transformer and more powerful magneto. Both SUPERMAG, Transformers comes with brass contact terminals including a spark plug type coil wire terminal for more positive coil wire retention.

Oil Cooled Transformer features a rugged, glass-filled polyester case. The oil is especially formulated to cool and insulate the winding inside. 28900A

Epoxy Transformer is designed to resist high vibrations and allow for more flexibility with regards to mounting position 28900B



Magneto Kill Switches

The Magneto Kill Switch is a positive action on/off magneto ignition switch. Push in the knob and it locks to kill the magneto ignition. Turn the knob clockwise to release the lock. Also, the internal contact area is sealed to prevent corrosion and the contact block is replaceable.

- For Single Magneto Ignitions 26072
- For Dual Magneto Ignitions. 26073
- Toggle Switch 26074
- Replacement Contact Block 26076



Magneto Start Assist Box

A magneto normally requires good crankshaft speed to produce enough ignition output to start the engine. When the magneto is hot, higher crankshaft speeds are required. The Magneto Start Assist Box is designed to electronically connect the magneto ignition system to the engine's starter solenoid. During starting, the Magneto Start Assist Box "boosts" the magneto output creating a strong starting spark even at very low cranking RPM. It is important to note that the Magneto Ignition System must be modified before it can be used with the Magneto Start Assist Box. Contact the factory for details.

Mallory SPRINTMAG, and SPRINTMAG, II Magnetos 660

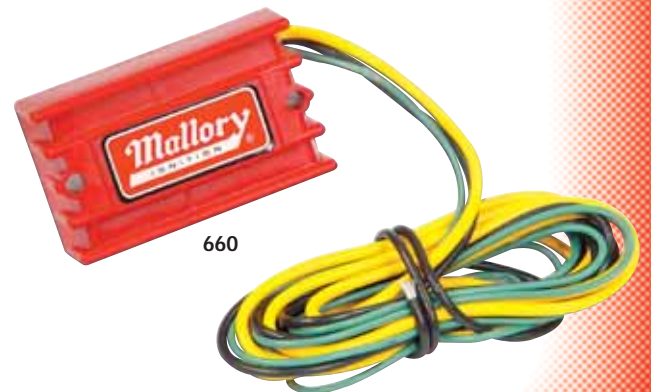



MAGNETO ACCESSORIES



28355

Static Timer and Continuity Tester

The Static timer and Continuity Tester is especially designed to meet the requirements of professional racing mechanics.

Static Timer: An audible sound and red light signal indicate breaker point opening and closing so that setting the ignition timing can be accomplished without starting the engine. Compatible with all breaker point ignition systems including magneto ignition systems.

Continuity Tester: Tests the continuity of circuits, primary wires and connections.

Static Timer and Continuity Tester

(9V battery included) 28355



29011

Oil Pump Primer

Starting an engine without oil in the engine block, even though oil is in the oil pan, can cause serious engine wear and component damage. When installing a replacement camshaft, crankshaft, or new engine, the oiling system in the engine block is empty upon initial start-up. Avoid this needless wear and potential permanent damage to vital engine components by using the Mallory Oil Pump Primer. Unlike most other oil pump primers, the Mallory Oil Pump Primer drops in once the distributor is removed and locks in place using the original distributor hold down clamp. All Mallory Oil Pump Primers prime the entire engine oiling system including the lifters, pushrods and rocker assemblies. Fits any 3/8" reversible drill.

Chevrolet V8 265-454, 502, semi-even and even-fire 90° V6(CW rotation). 29010

Ford V8 221-302 (CCW rotation). 29011

Ford V8 352-428 (CCW rotation) 29012

Ford V8 351W, 351C/M, 400, 429 and 460 (CCW rotation) 29013

ASSEMBLY DRAWINGS

SPRINTMAG® MAGNETOS

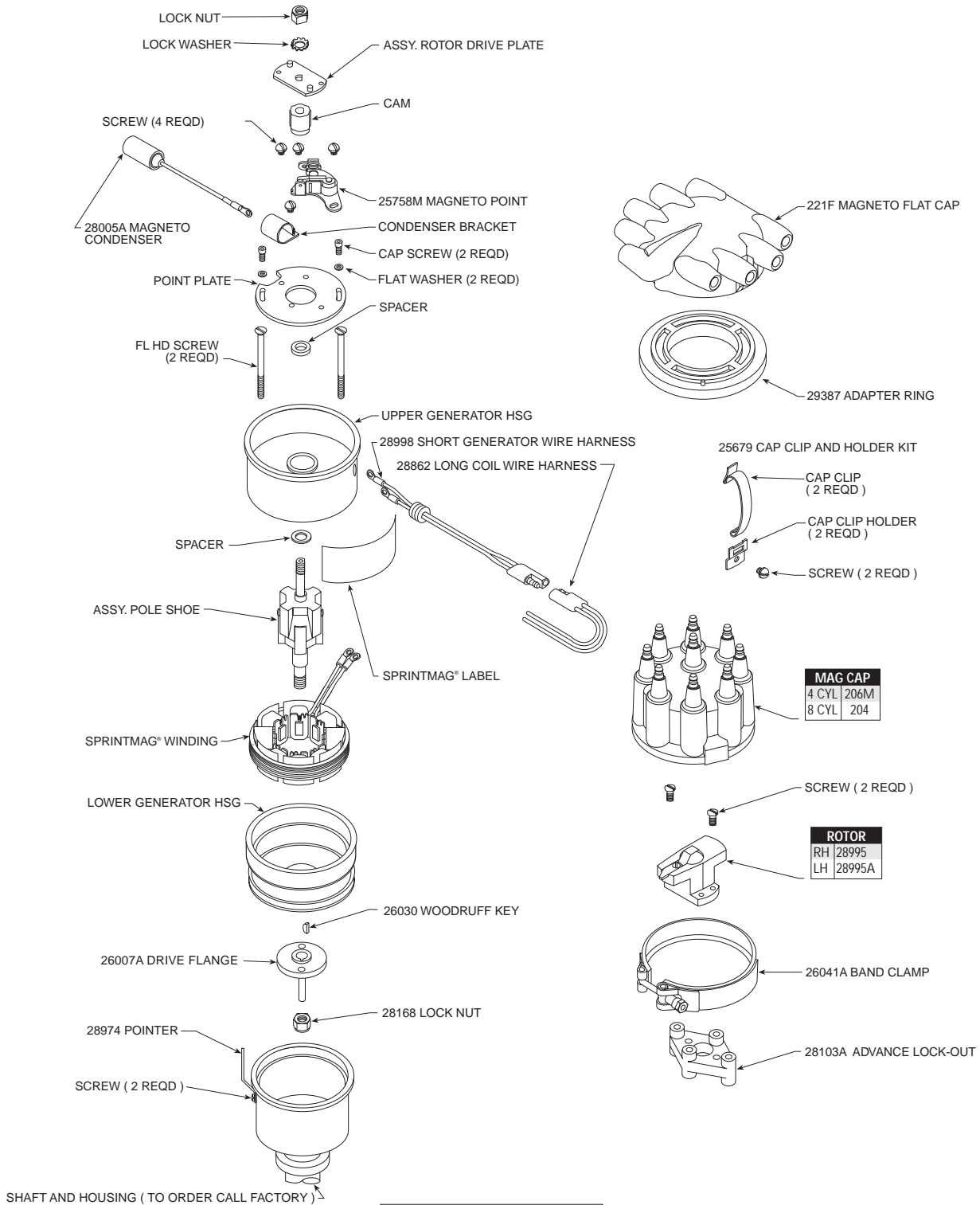

CONTACT POINT SETTING .016"



ASSEMBLY DRAWINGS

SPRINTMAG® II MAGNETOS

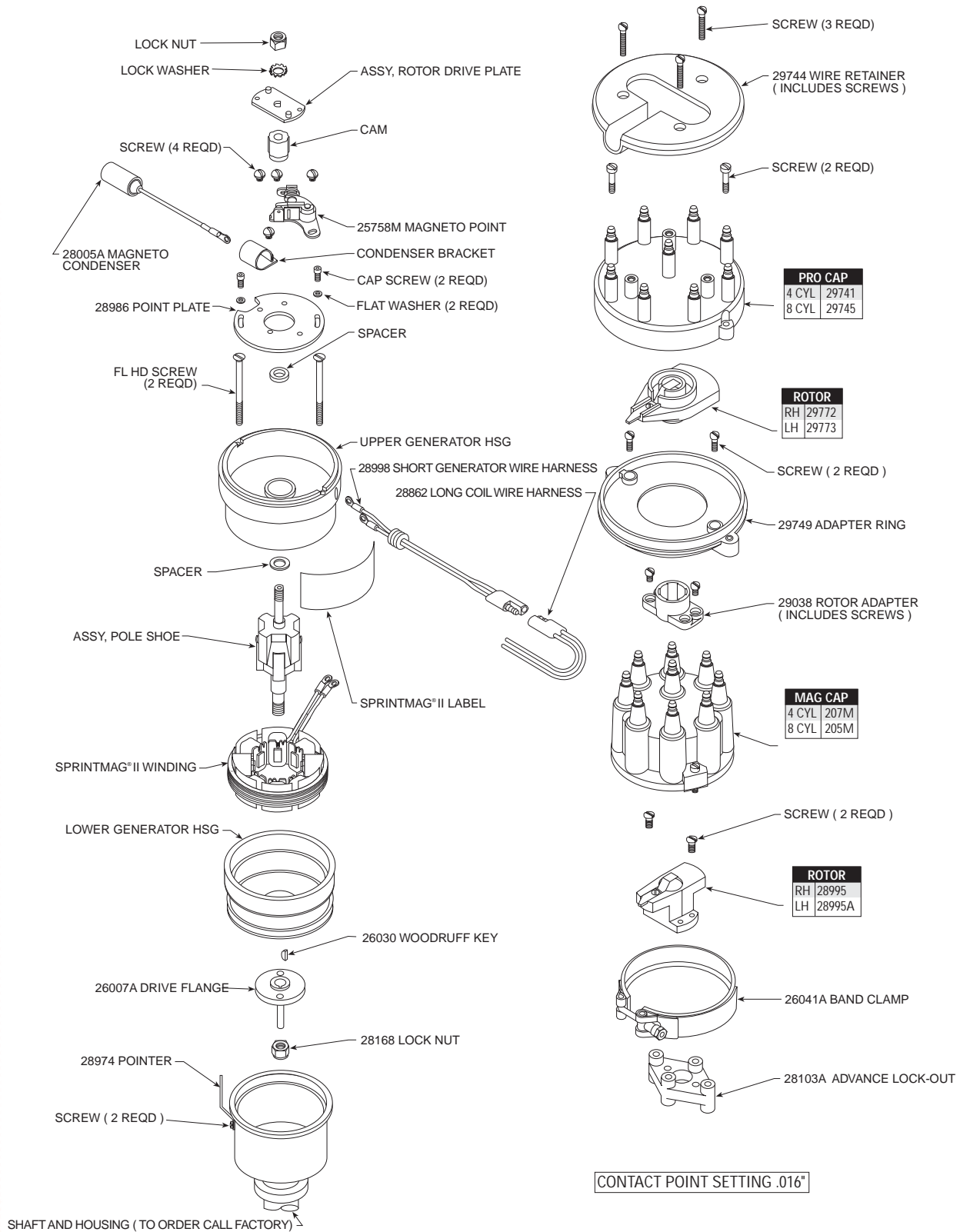

ASSEMBLY DRAWINGS

SPRINTMAG® III MAGNETOS

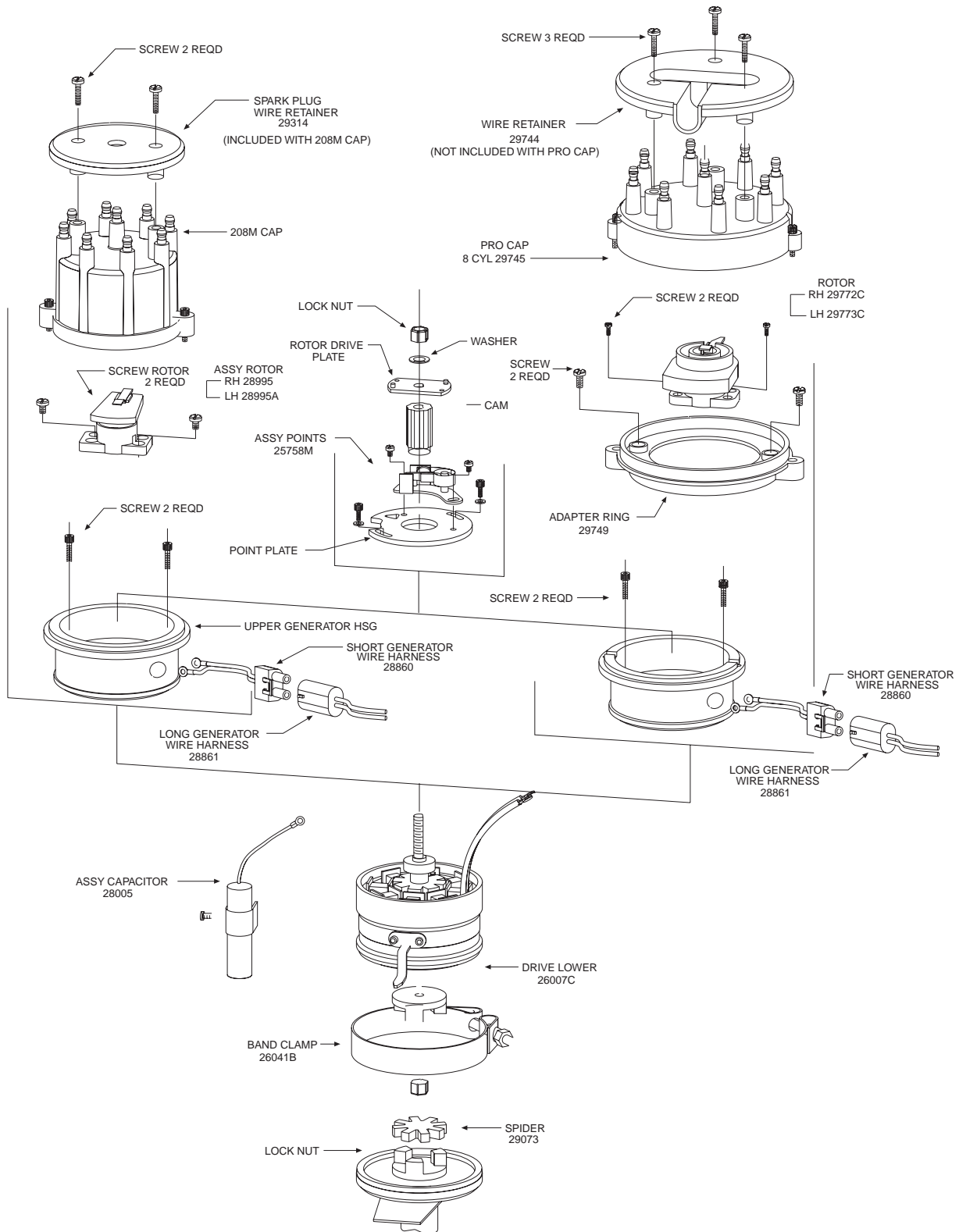



ASSEMBLY DRAWINGS

SUPER-MAG® III AND IV MAGNETOS

