



# Manatee High School Bands

www.manateebands.com  
John Schindler, Director  
schindler2j@manateeschools.net



## Solo and Ensemble Parent Information Letter

To: All FBA District 11 Solo and Ensemble Parents  
From: John Schindler, Director of Bands, Manatee High School  
Re: Details concerning upcoming Solo and Ensemble Performances

Dear Solo and Ensemble Parent:

We are pleased that you and your child will be with us on Friday the 7<sup>th</sup>, and Saturday the 8<sup>th</sup>, 2020 at Manatee High School, and want you to know that we will be doing everything possible to make your child's performance experience as positive as possible.

As a means of better communication, we are providing this "Parent Information Letter" to inform you of some important details to assist you in the quality of your experience on the performance day.

Have your child contact his/her director for directions to Manatee and a map of the school with room locations and parking information.

We would like to remind you of these very important points:

1. It is important to plan to arrive at least 30 minutes prior to your child's scheduled performance time.
2. You will receive your Performance Room Time and Assignment from your Director.
3. We will have guides available around campus to help you with directions if you need assistance.
4. Solo and Ensemble performance schedules are affected by many variables that might mean that your child will not perform at the exact time as scheduled. Please be patient.
5. It is very important that you do not interrupt a performance once it has begun.
6. Please remember to turn off all cell phones and pagers prior to entering the performance area.
7. It is important that the warm-up rooms and hall areas be kept as quiet and accessible as possible. Please assist us in keeping the "noise" level to a minimum, especially outside of performance rooms.
8. There will be food available for you and your child at the performance site. Please be sure to keep all food and drink in the designated areas and out of the warm-up and performance rooms.
9. After your child has performed, results will not be posted this year. Please see your band director for the best way to receive your results.
10. The Adjudicator Sheet will only be made available to your Music Director or designated replacement at the end of the performance day.
11. The FBA Office is for Directors only. Students, parents, accompanists and private teachers should contact their director if there is an issue.

If you should have any further questions, please contact your child's school music teacher for clarification.



DEPARTMENT OF  
CAPITAL  
PROJECTS

**MATZKE SUPPORT CENTER**  
1 MATZKE WAY  
BRADENTON, FL 34208  
(941) 708-8800

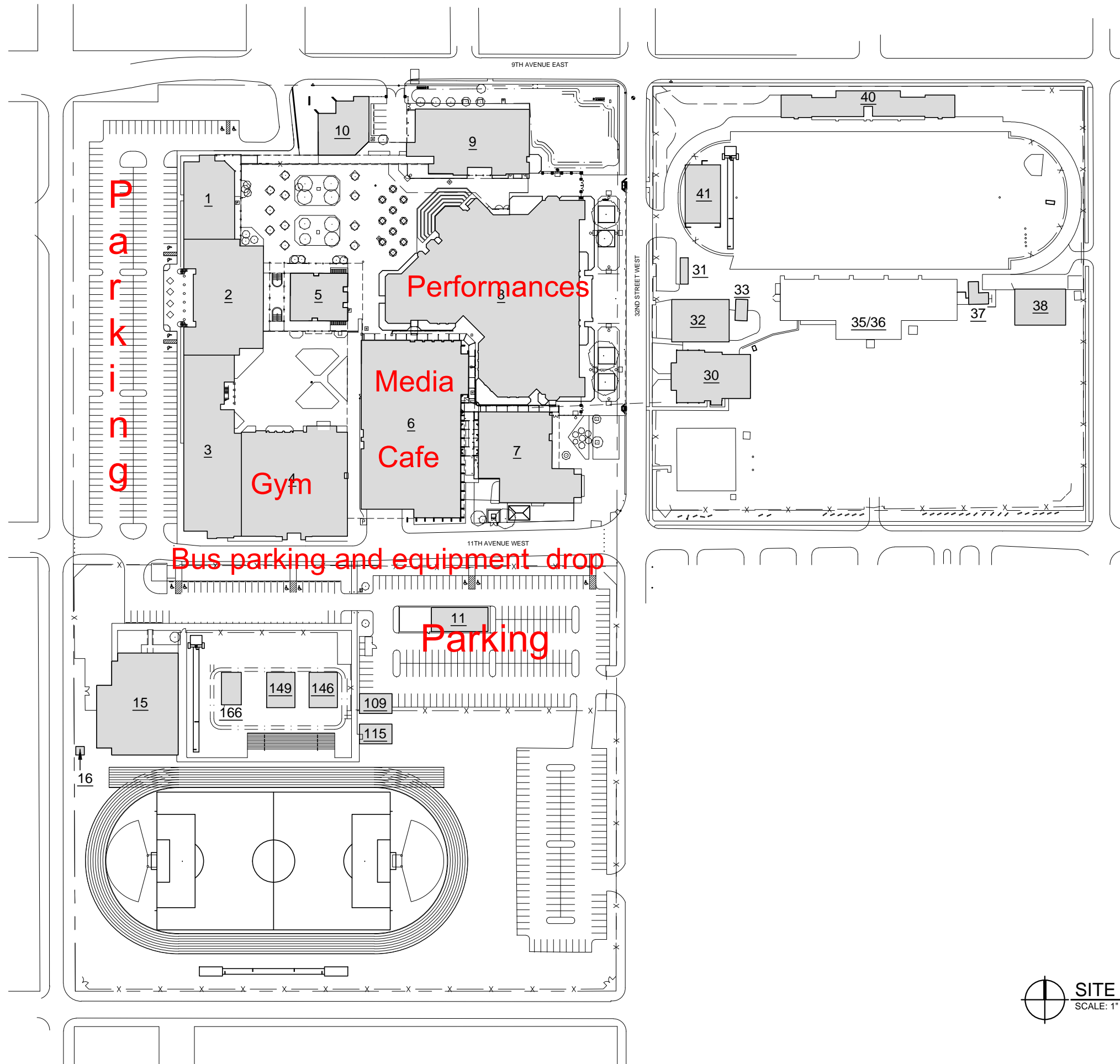

**MANATEE  
HIGH SCHOOL**

902 33RD STREET COURT W.  
BRADENTON, FL 34205

FISH #	007
DATE	06/20/14
SHEET	1 OF 26

FISH  
SITE PLAN

 **SITE PLAN**  
SCALE: 1" = 150'-0"





# Manatee High School Bands

www.manateebands.com  
John Schindler, Director  
schindler2j@manateeschools.net



## 2020 FBA District 11 Solo and Ensemble Judge Assignments

Room #	Type	Piano	Judge
Gym	Auxiliary	Sound System	Steven Alia
148	Woodwind	Electric	Kimberlee Aliapoulos
143	Woodwind	Upright	Joann Kinder
139	Woodwind	Upright	Dana Burt
202	Woodwind	Electric	Margaret Flood
204	Woodwind	Electric	Gloria Vagi
208	Woodwind	Electric	Joshua Autrey
213	Woodwind	Electric	Melton Mustafa
215	Woodwind	Electric	John Davis
217	Woodwind	Electric	Jamie Roth
221	Brass	Electric	Manuel Suarez
114	Brass	Electric	Michael Vail
112	Brass	Electric	Christopher Ellis
129	Brass	Electric	Greg Urban
135	Brass	Electric	Benny Bolden
133	Brass	Electric	Paul Morton
140	Brass	Upright	Dalaine Chapman
144	Percussion	Upright	Michael Fraley
Auditorium	Percussion	Grand	Rick Morales
141	Percussion	Upright	David Heilman
Cafeteria	Warm-Up	None	
Media Center	FBA Office		
Media Center	Director Hospitality		
715	Judge Hospitality		

902 33<sup>rd</sup> Street Court West – Bradenton, FL 34205  
Band Office: (941) 714-7300 ext. 72082



DEPARTMENT OF CAPITAL PROJECTS

MATZKE SUPPORT CENTER  
1 MATZKE WAY  
BRADENTON, FL 34208  
(941) 708-8800

ROOM LEGEND

- 103A VESTIBULE 46 SF
- 110 STAGE STORAGE 108 SF
- 110A PIANO 64 SF
- 124 CUSTODIAL 28 SF
- 127 ELEV MECH 52 SF
- 131 WOMENS TOILET 48 SF
- 132 MENS TOILET 48 SF
- 103A ELECTRICAL 112 SF
- 138B DATA 112 SF
- 139D VESTIBULE 111 SF
- 140B TEACHER PLAN 160 SF
- 140C REFERENCE 149 SF, 150 SF PGM
- 140D INSTRUMENT STORAGE 147 SF, 600 SF PGM TOTAL
- 140F VESTIBULE 111 SF
- 144C REFERENCE 143 SF, 150 SF PGM
- 151A INST REPAIR 100 SF, 100 SF PGM
- 151B CATWALK 76 SF
- 152 PRACTICE 75 SF, 70 SF PGM
- 153 PRACTICE 77 SF, 70 SF PGM
- 154 PRACTICE 81 SF, 70 SF PGM
- 155 PRACTICE 80 SF, 70 SF PGM
- 156 PRACTICE 79 SF, 70 SF PGM
- 157 PRACTICE 83 SF, 70 SF PGM

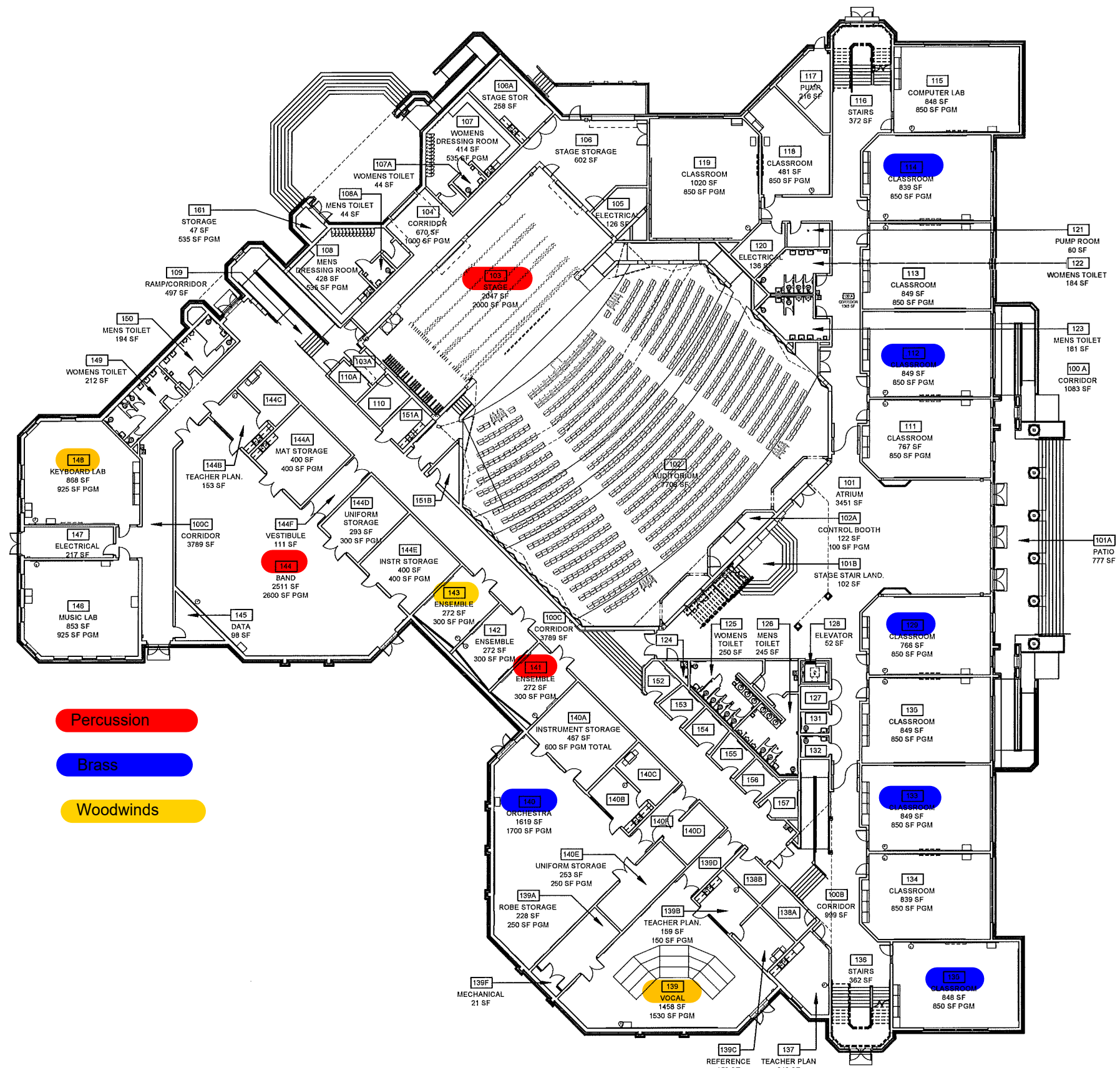

- Percussion
- Brass
- Woodwinds

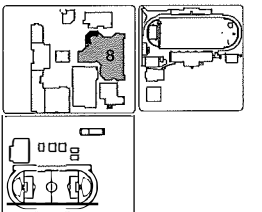

KEY PLAN

MANATEE HIGH SCHOOL

902 33RD STREET COURT W.  
BRADENTON, FL 34205

FISH # 007  
DATE 09/24/12  
SHEET 15 OF 26

FISH  
BUILDING 8  
FIRST  
FLOOR PLAN

BUILDING 8 FIRST FLOOR PLAN  
SCALE: 1/32" = 1'-0"





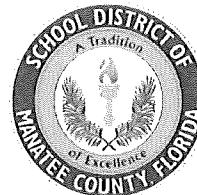

DEPARTMENT OF  
CAPITAL  
PROJECTS

MATZKE SUPPORT CENTER  
1 MATZKE WAY  
BRADENTON, FL 34208  
(941) 708-8800

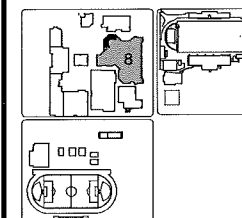
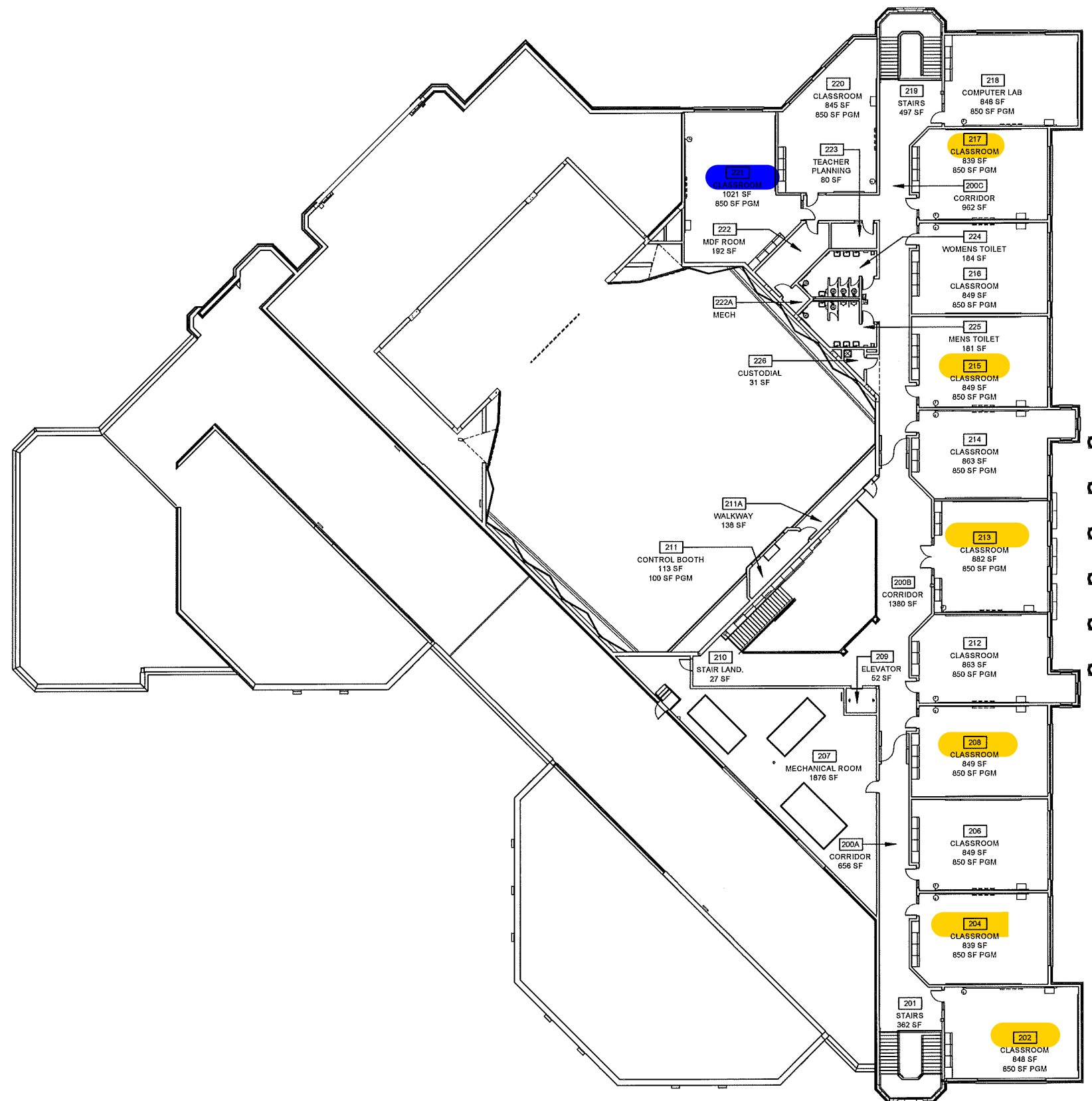

KEY PLAN

**MANATEE  
HIGH SCHOOL**

902 33RD STREET COURT W.  
BRADENTON, FL 34205

FISH # 007  
DATE 09/24/12  
SHEET 16 OF 26

FISH  
BUILDING 8  
SECOND  
FLOOR PLAN



 **BUILDING 8 SECOND FLOOR PLAN**  
SCALE: 1/32" = 1'-0"

**2020 FBA District 11 Solo and Ensemble MPA**  
*Helpful Hints*  
**Manatee High School**

**Copy Machines:** As copyright laws prohibit the copying of music, copy machines **will not** be available during the festival.

**FBA Office:** The FBA Office will be in Building 6 – Media Center. This is for directors only. Students, parents, accompanists and private teachers are not permitted. Please contact your director if you have an issue and your director will contact the appropriate person.

**Director’s Lounge:** Hospitality will be available in the Media Center for participating directors only.

**Judge’s Score / Music:** Students are to provide their judge with an original of their music with the measures numbered. Please have the student’s name, school and group on the music as well. This will aid in the return of lost music.

**Lunch/Dinner and Snacks:** The cafeteria will be open throughout the day. Please keep all items within the cafeteria seating area. Concession will be sold throughout the event.

**Parking:** Please park in the student parking lot on the south side of the campus. Buses should drop students off in the bus loop and then remain parked there. We will have guides to help direct buses and parking.

**Percussion:** Please bring your own mallets/sticks and cymbals for your students to use. Braden River will provide the following percussion equipment in two performance areas:

**Room 144:** concert bass drum, 1 xylophone, 1 Vibraphone, 1 Yamaha 4.3 Octave Marimba, 1 Set of Orchestra Bells, 1 Set of Chimes, 4 Ludwig timpani (23”, 26”, 29”, 32”), 1 tam-tam.

**Auditorium:** 1 Adams 4.3 Octave Marimba, 1 Vibraphone

**Pianos:** Pianos will be furnished in each performance room, **but not in any warm-up room**. Please note that many pianos will be electronic.

**Results:** Results will not be posted this year, please see your band director for the best way to receive your results.

**Schedule Issues:** All schedule conflicts and contest related items will be addressed in the FBA Office. Judges are not to be disturbed.

**Security:** Manatee High School is not responsible for any lost or stolen equipment or personal belongings. There will be an armed officer on the MHS Campus throughout the two-day event.

**Smoking Policy:** The School District of Manatee County does not permit smoking in any part of the buildings or on school grounds.

**Warm-up Rooms:** Warm-up rooms are indicated in the program. Please be aware that more than one performance room may be sharing a warm-up room. We ask that all students are courteous to others in the room and keep the warm-up room doors closed.

# Manatee Hurricanes Concession

## Price List

ITEM	PRICE
<b><u>SANDWICHES</u></b>	
QUARTER POUND STEAK BURGER	\$3 OR 2/\$5
QUARTER POUND STEAK CHEESEBURGER	\$3 OR 2/\$5
CHICKEN SANDWICH	\$3 OR 2/\$5
BBQ PORK SANDWICH	\$3 OR 2/\$5
JUMBO HOT DOG	\$2 OR 2/\$3
<b><u>DRINKS</u></b>	
ALL CAN DRINKS /WATER	\$1.00
GATORADE	\$2.00
<b><u>EXTRA ITEMS</u></b>	
FRIES SMALL	\$3.00
FRIES LARGE	\$5.00
ADD CHEESE/CHILI	\$1.00
CANDY	\$2.00
AIRHEADS CHEWY CANDY	3/\$1
LARGE NACHOS	\$4.00
LARGE BBQ PORK NACHOS	\$5.00
CHIPS	2/\$1