

MEETING & EVENT GUIDE

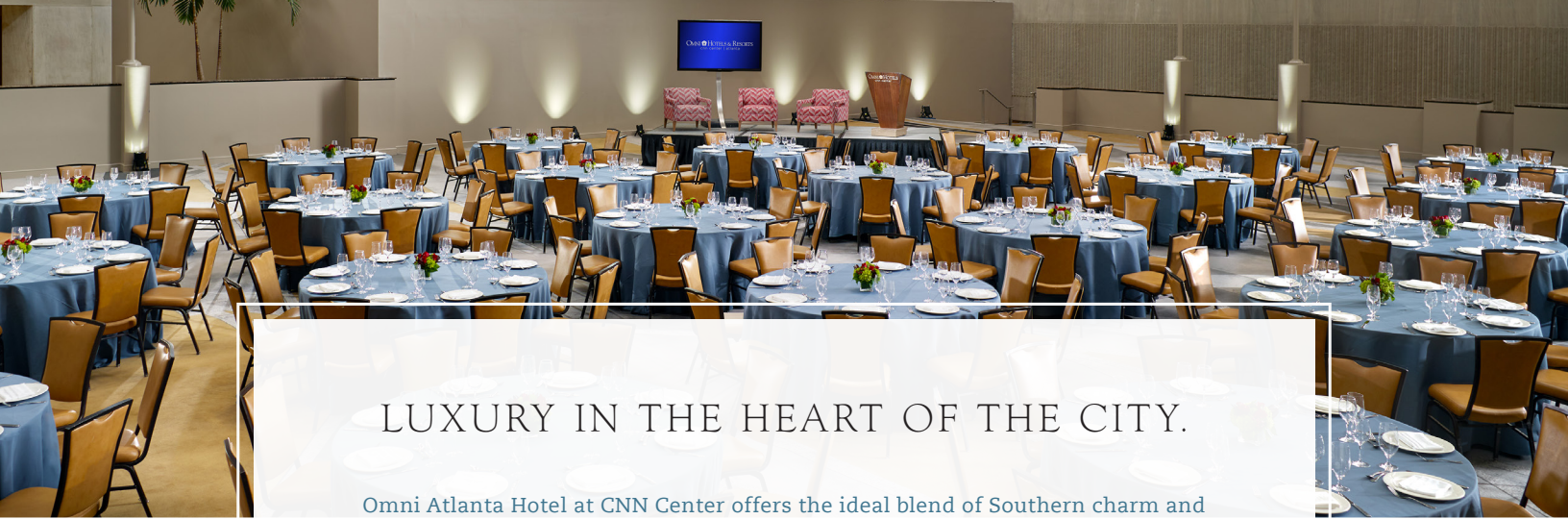

OMNI  HOTELS
& RESORTS
cnn center | atlanta

OMNIHOTELS.COM/ATLANTA



LUXURY IN THE HEART OF THE CITY.

Omni Atlanta Hotel at CNN Center offers the ideal blend of Southern charm and contemporary style in an unrivaled downtown location. A broad array of dining options, guest amenities and services make every visit an elegant and memorable occasion.

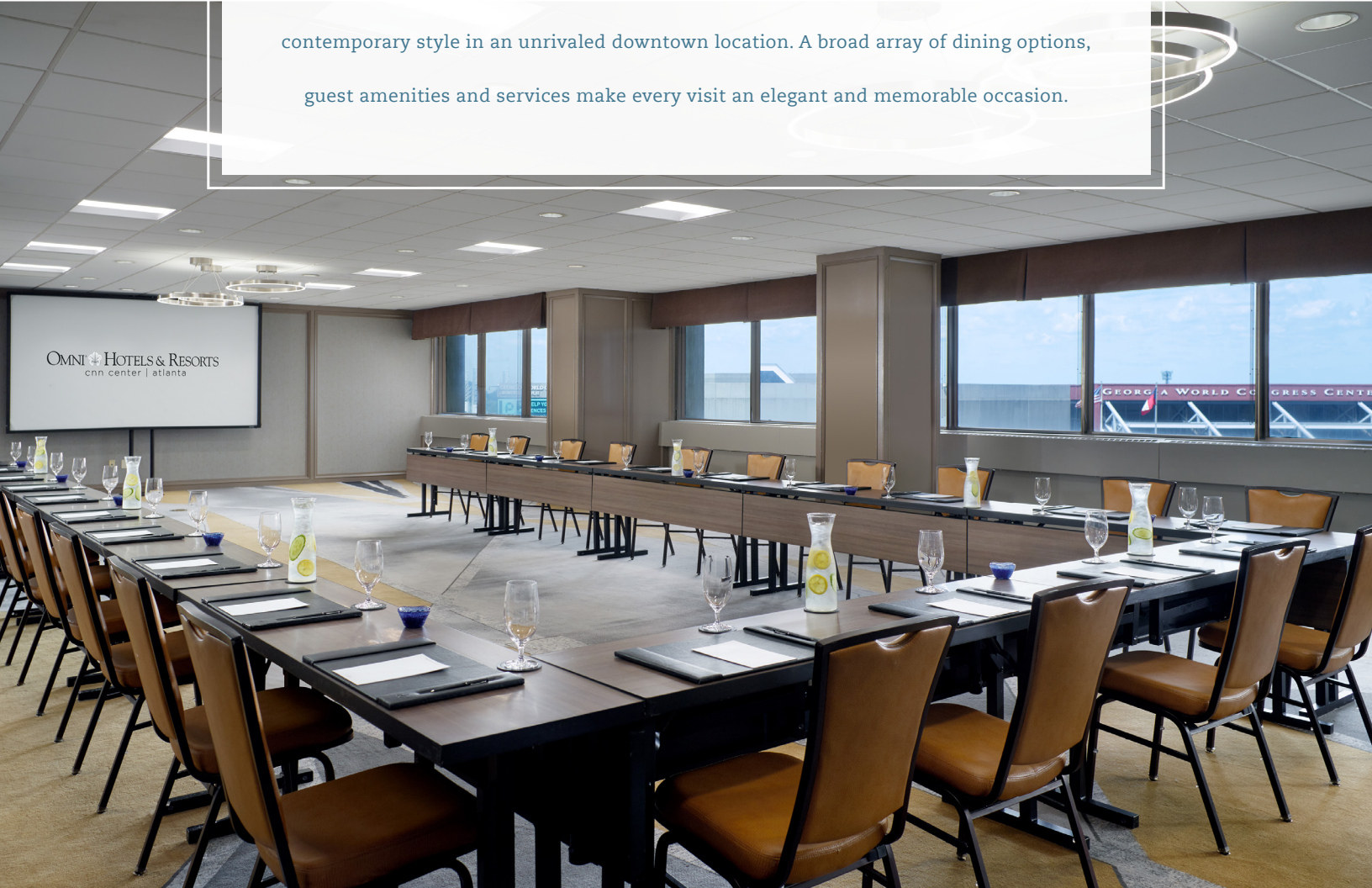



NEVER STAY THE SAME

- 1,067 richly appointed guest rooms and suites
- More than 120,000 square feet of premier meeting space featuring 19,864 and 14,196 square foot ballrooms with a total of 45 meeting rooms and a 10,080 square foot glass-enclosed atrium terrace
- State-of-the-art audio-visual equipment with a full-service, 24-hour FedEx Office Business Center
- Wi-Fi and hard-wired internet access

PRIME MERIDIAN

This elegant South Tower restaurant offers guests a sophisticated menu comprised of innovative dishes featuring fresh, local ingredients. Diners are treated to magnificent city views of Centennial Olympic Park and the Fountain of Rings.

MORSEL'S

Located in the North Tower, Morsel's offers an assortment of Peet's Coffee & Tea® and light snacks for guests on the go.

GUEST ROOM DINING

For guests who wish to enjoy extraordinary cuisine in the comfort and privacy of their room, guest room dining is available for breakfast and dinner.

LATITUDES BISTRO AND LOUNGE

The ideal place to gather before or after events for perfectly crafted cocktails, creative appetizers and a lively atmosphere. Located in the South Tower, Latitudes offers guests spectacular views of the city.

POOL & SUN DECK

Our outdoor heated pool is available to guests year-round, offering a fantastic spot to take a swim or just bask on the sun deck.

FITNESS CENTER

Our state-of-the-art, full-service fitness center is available to guests 24 hours. Treadmills, free weights, ellipticals and an assortment of equipment are on hand to help travelers maintain their fitness regimen.

OMNI ATLANTA HOTEL AT CNN CENTER MEETING SPACE

SOUTH TOWER | ATRIUM TERRACE LEVEL

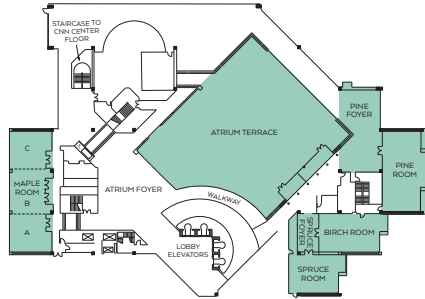

NORTH TOWER | M6

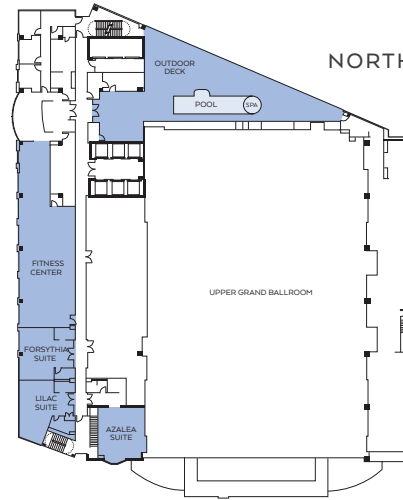

SOUTH TOWER | HOTEL LOBBY LEVEL

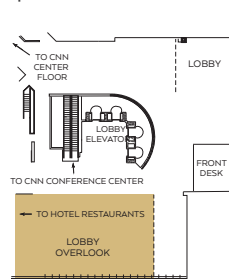

NORTH TOWER | M4

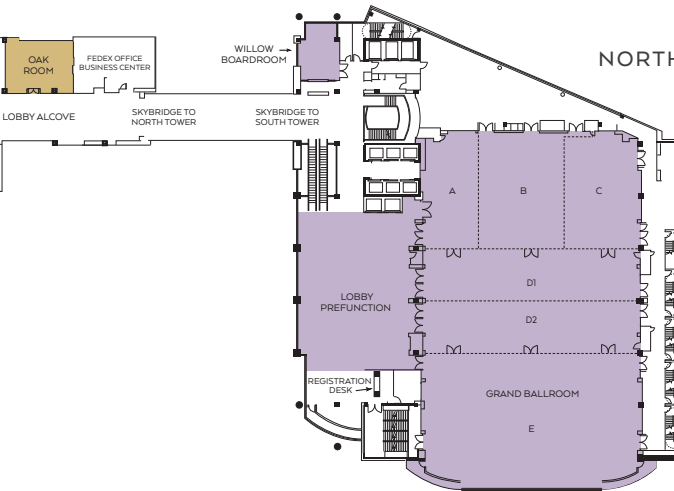

NORTH TOWER | M3

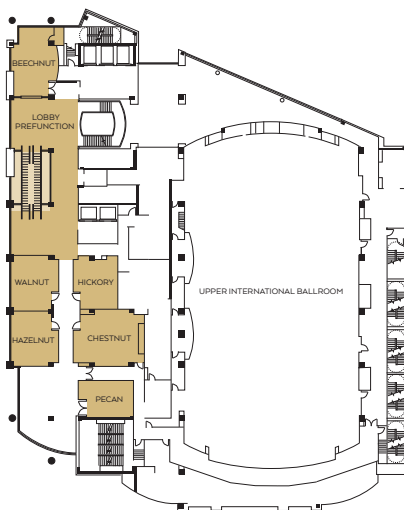

NORTH TOWER | M2

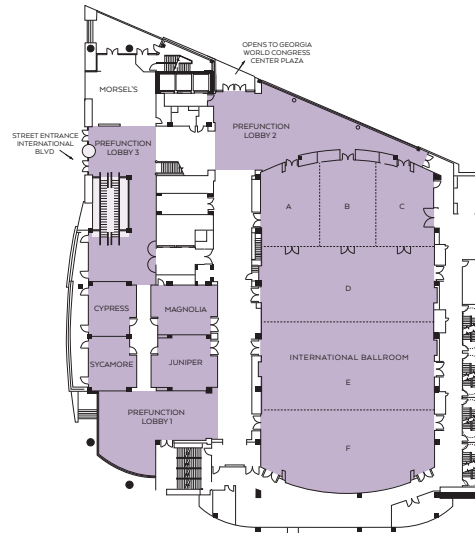

NORTH TOWER | M1

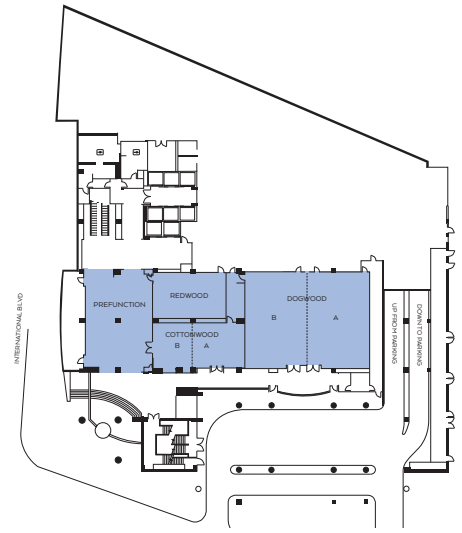

OMNI ATLANTA HOTEL AT CNN CENTER MEETING ROOM CAPACITY

	SQUARE FOOTAGE	DIMENSIONS	CEILING HEIGHT	PORTABLE WALLS	THEATER	CLASSROOM 18"	CLASSROOM 30"	BANQUET 60"	BANQUET 72"	RECEPTION	HOLLOW SQUARE	EXHIBITS 8' X 10'	EXHIBITS 10' X 10'
SOUTH TOWER ATRIUM													
ATRIUM TERRACE	10,080	—	15 STORIES	NO	1,000	525	—	—	720	1,000	—	60	50
MAPLE ROOM	2,200	88' x 25'	10'	YES	210	120	—	—	140	210	84	—	—
MAPLE ROOM A	725	29' x 25'	10'	YES	60	33	—	—	60	70	24	—	—
MAPLE ROOM B	750	30' x 25'	10'	YES	60	33	—	—	60	70	24	—	—
MAPLE ROOM C	725	29' x 25'	10'	YES	60	33	—	—	60	70	24	—	—
PINE ROOM	1,596	57' x 28'	8'9"	NO	160	99	—	—	100	120	60	—	—
PINE FOYER	1,300	—	15 STORIES	NO	—	—	—	—	70	100	—	—	—
BIRCH ROOM	1,080	27' x 40'	8'9"	NO	112	72	—	—	60	75	36	—	—
SPRUCE ROOM	1,036	37' x 28'	8'9"	NO	91	60	—	—	60	75	30	—	—
SPRUCE FOYER	560	28' x 20'	10'	NO	—	—	—	—	—	50	—	—	—
NORTH TOWER M6													
FITNESS CENTER	4,670	—	—	—	—	—	—	—	—	—	—	—	—
POOL & DECK	3,724	—	—	—	—	—	—	—	—	—	—	—	—
FORSYTHIA SUITE	856	—	—	—	—	—	—	30	—	—	—	—	—
LILAC SUITE	818	—	—	—	—	—	—	30	—	—	—	—	—
AZALEA SUITE	768	—	—	—	—	—	—	30	—	—	—	—	—
SOUTH TOWER LOBBY LEVEL													
LOBBY OVERLOOK	—	43' x 55'	15'	NO	—	—	—	—	100	200	—	—	—
OAK ROOM	1,200	30' x 40'	14'	NO	125	75	50	72	90	120	40	—	—
NORTH TOWER M4													
GRAND BALLROOM	19,864	184' x 108'	21'	YES	2,212	1,302	—	—	1,450	2,000	—	124	100
BALLROOM A	2,233	57'10" x 37'9"	21'	YES	216	108	—	—	150	200	60	14	11
BALLROOM B	1,940	57'10" x 33'9"	21'	YES	216	108	—	—	150	200	60	12	10
BALLROOM C	2,238	57'10" x 37'9"	21'	YES	216	108	—	—	150	200	60	13	11
BALLROOM D1 & D2	5,963	54' x 108'10"	21'	YES	676	360	—	—	400	330	—	38	30
BALLROOM E	7,490	63'10" x 108'10"	21'	YES	767	450	—	—	490	800	—	47	38
PREFUNCTION LOBBY	6,444	—	—	NO	—	—	—	—	—	—	—	20	21
WILLOW BOARDROOM	596	30'11" x 16'10"	15'	NO	—	—	—	—	—	—	12	—	—

Meeting room capacities are determined by the use of the "Arranger & Comfort Calculator," a standardized meeting room capacity measurement system used by Meeting

OMNI ATLANTA HOTEL AT CNN CENTER MEETING ROOM CAPACITY

	SQUARE FOOTAGE	DIMENSIONS	CEILING HEIGHT	PORTABLE WALLS	THEATER	CLASSROOM 18"	CLASSROOM 30"	BANQUET 60"	BANQUET 72"	RECEPTION	HOLLOW SQUARE	EXHIBITS 8' X 10'	EXHIBITS 10' X 10'
NORTH TOWER M3													
PREFUNCTION LOBBY	3,840	—	—	—	—	—	—	—	—	—	405	—	—
WALNUT	737	28'5" x 28'1"	10'6"	83	51	42	56	60	79	18	—	—	—
HICKORY	734	35'10" x 19'6"	10'6"	83	51	42	56	60	79	18	—	—	—
CHESTNUT	624	24'8" x 18'4"	10'6"	66	39	33	48	50	63	14	—	—	—
HAZELNUT	624	27'6" x 21'2"	10'6"	66	39	33	48	50	63	14	—	—	—
BEECHNUT	512	27'6" x 21'2"	10'6"	—	—	—	—	—	—	12	—	—	—
PECAN	472	18'2" x 23'3"	10'6"	55	33	27	40	40	53	14	—	—	—
NORTH TOWER M2													
INTERNATIONAL BALLROOM	14,196	163' X 87'	18'	YES	1,580	861	—	—	1,170	1,500	—	110	82
BALLROOM A	1,181	36'4" x 29'3"	18'	YES	133	63	—	—	60	100	32	4	3
BALLROOM B	1,226	42' x 28'8"	18'	YES	133	63	—	—	60	100	32	4	3
BALLROOM C	1,187	36'4" x 29'3"	18'	YES	133	63	—	—	60	100	32	4	3
BALLROOM D	3,320	38' x 87'2"	18'	YES	340	192	—	—	210	200	—	20	16
BALLROOM E	3,320	38' x 87'2"	18'	YES	340	192	—	—	210	200	—	20	16
BALLROOM F	3,962	38'9" x 87'2"	18'	YES	450	231	—	—	270	300	—	25	20
PREFUNCTION LOBBY 2	5,200	—	—	NO	—	—	—	—	—	100	—	10	5
PREFUNCTION LOBBY 1	1,540	—	—	NO	—	—	—	—	—	160	—	4	4
JUNIPER	774	24'9" x 26'8"	10'6"	NO	76	51	—	—	50	60	24	—	—
CYPRESS	623	27'6" x 21'2"	10'6"	NO	50	33	—	—	30	40	18	—	—
SYCAMORE	623	27'6" x 21'2"	10'6"	NO	50	33	—	—	30	40	18	—	—
MAGNOLIA	814	26'7" x 26'8"	10'6"	NO	76	48	—	—	50	40	24	—	—
NORTH TOWER M1													
DOGWOOD	3,547	49'9" X 69'6"	11'6"	YES	400	246	204	288	290	375	94	22	18
DOGWOOD A	1,955	49'9" X 38'5"	11'6"	YES	222	138	114	160	160	211	52	12	10
DOGWOOD B	1,592	49'9" X 31'1"	11'6"	YES	177	108	90	128	130	162	42	10	8
PREFUNCTION	2,850	—	—	NO	—	—	—	—	—	300	—	—	—
COTTONWOOD	1,243	24'5" X 50'7"	11'	YES	138	84	69	96	100	130	30	—	—
COTTONWOOD A	611	24'5" X 24'5"	11'	YES	66	39	33	48	50	63	14	—	—
COTTONWOOD B	632	24'5" X 25'3"	11'	YES	72	45	36	48	50	68	16	—	—
REDWOOD	997	24'9" X 39'6"	11'	NO	111	69	57	80	80	105	24	—	—

Meeting room capacities are determined by the use of the "Arranger & Comfort Calculator," a standardized meeting room capacity measurement system used by Meeting

OMNI ATLANTA HOTEL AT CNN CENTER GUEST ROOM INVENTORY



ROOM CATEGORY	SOUTH TOWER GUEST ROOMS	NORTH TOWER GUEST ROOMS	TOTAL GUEST ROOMS	SQUARE FOOTAGE	SPECIAL FEATURES
DELUXE DOUBLE/DOUBLE	165	350	515	392	Beautifully appointed rooms with oversized work desks, flat screen HD televisions and elegant décor
DELUXE KING	167	156	323	414	Luxury rooms with modern amenities, beautiful appointments and spacious marble baths
PARK VIEW DOUBLE/DOUBLE	66	23	89	414	See Centennial Olympic Park like never before in a handsomely appointed Park View room
PARK VIEW KING	18	31	49	414	Beautifully furnished featuring panoramic park views and elegant décor
PARK VIEW DOUBLE/DOUBLE WITH BALCONY	14	—	14	414	Luxurious rooms with private balconies offering unparalleled views of Centennial Olympic Park
PARK VIEW KING WITH BALCONY	24	—	24	414	Premiere accommodations with a private balcony overlooking Centennial Olympic Park
KING CORNER	—	21	21	364	Handsomely appointed rooms featuring wrap around windows with magnificent views
JUNIOR SUITE	1	—	1	571	Newly renovated suite with elegant décor and views of the CNN atrium
ATLANTA SUITE	—	14	14	728	Beautiful suites with separate living rooms perfect for hospitality gatherings
EXECUTIVE SUITE	8	—	8	728	Newly renovated and beautifully appointed, these luxurious suites feature views of the CNN atrium
HOSPITALITY SUITES	—	3	3	728	One- to three-room suites accommodating up to 50 guests with dining tables for four to eight people, wet bars and full kitchenettes
GOVERNOR'S SUITE	—	1	1	1,120	Luxury suite featuring a full kitchenette, wet bar, separate dining room, marble foyer entry and other luxury appointments
CAPITOL SUITE PHOENIX SUITE SARGE SUITE	3	—	3	728	Global connectivity meets modern design on the fifteenth floor of the South Tower in these beautifully renovated suites
PRESIDENTIAL SUITE	—	1	1	1,456	Spacious and elegant suite featuring a large living room and windows overlooking beautiful Centennial Olympic Park
OMNI SUITE	1	—	1	2,324	Fresh design meets modern luxury in this bi-level, three-bedroom suite featuring stunning views of CNN's global headquarters
TOTAL	467	600	1,067		

ATLANTA HIGHLIGHTS

Located 12 miles from the Hartsfield-Jackson Atlanta International Airport, the hotel is connected to the Georgia World Congress Center, the Chick-fil-A College Football Hall of Fame, CNN World Headquarters and State Farm Arena, overlooking Centennial Olympic Park.

ATTRACTIONS

Chick-fil-A College Football Hall of Fame
Mercedes-Benz Stadium
State Farm Arena
Georgia Aquarium
World of Coca-Cola
SkyView Ferris Wheel
Zoo Atlanta
Six Flags Over Georgia

ARTS & CULTURE

National Center for Civil & Human Rights
Children's Museum of Atlanta
Jimmy Carter Library & Museum
Fernbank Museum of Natural History
The Fox Theatre
High Museum of Art
Atlanta Botanical Gardens
Martin Luther King Jr. National Historic Site
The Tabernacle

SHOPPING

Ponce City Market
Westside Provisions District
Atlantic Station

OMNI ATLANTA HOTEL
AT CNN CENTER
100 CNN CENTER
ATLANTA, GA 30303
404-818-4320
OMNIHOTELS.COM/ATLANTA

