

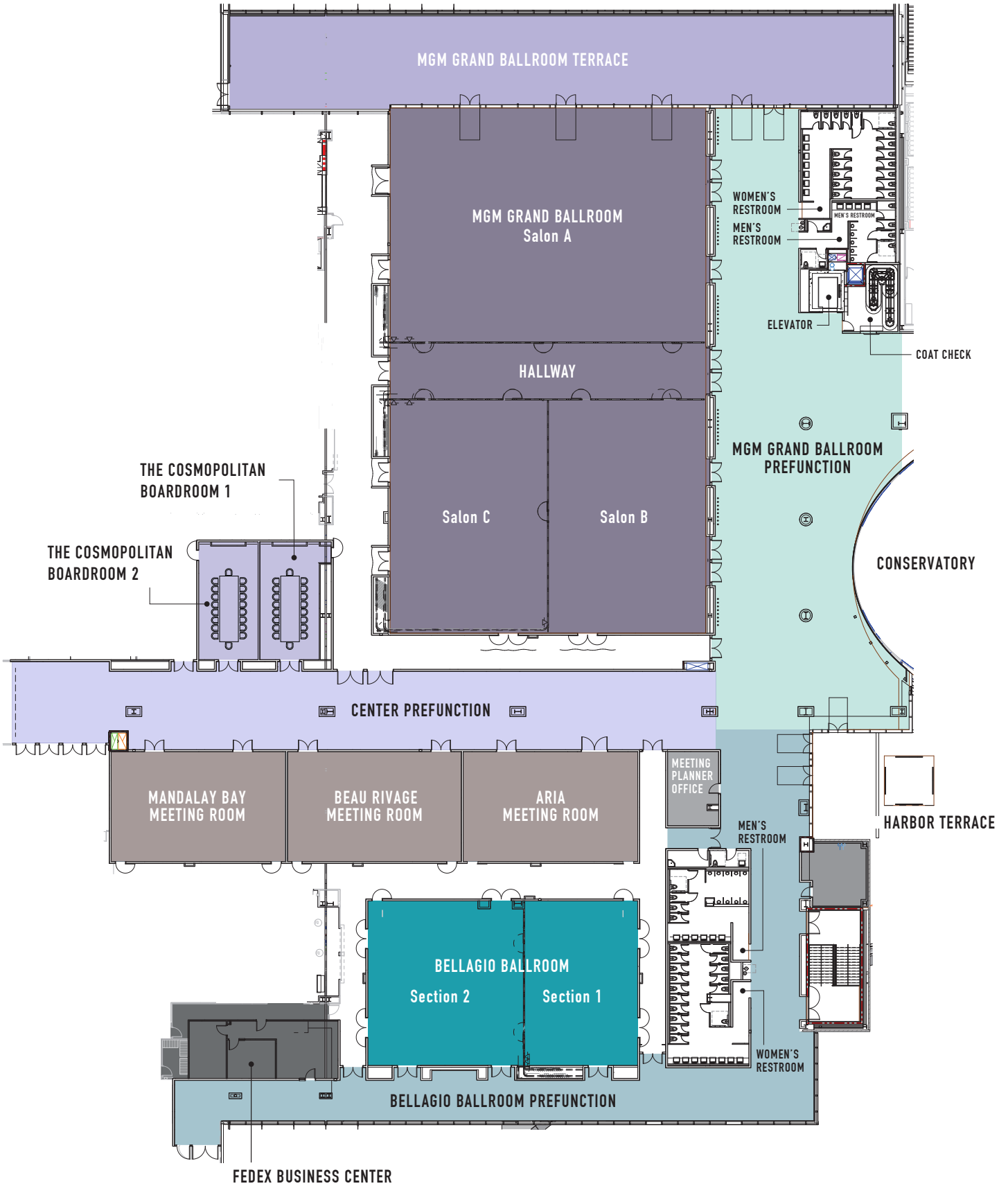

MEETING FACILITIES GUIDE





ROOM CAPACITIES

	SQUARE FEET	DIMENSIONS (LxW)	CEILING HEIGHT	THEATER	CLASSROOM	ROUNDS OF 10	RECEPTION	CONFERENCE	HOLLOW SQUARE	U-SHAPE
MGM GRAND BALLROOM	16,137	99'x163'	24'3"	1,600	900	1050	1,800	132	170	144
Salon A	7,227	99'x73'	24'3"	800	450	480	500	56	84	72
Salon B	3,577	49'x73'	24'3"	400	225	200	250	44	60	48
Salon C	3,577	49'x73'	24'3"	400	225	200	250	44	60	48
Salon B-C	7,227	99'x73'	24'3"	800	450	480	500	56	84	72
Hallway	1,683	99'x17'	24'3"							
MGM Grand Ballroom Prefunction	8,628	163' x 69'	30'							
MGM Grand Ballroom Terrace	6,010	206' x 27'	∞							

	SQUARE FEET	DIMENSIONS (LxW)	CEILING HEIGHT	THEATER	CLASSROOM	ROUNDS OF 10	RECEPTION	CONFERENCE	HOLLOW SQUARE	U-SHAPE
MEETING ROOMS										
ARIA	1,838	54'x34'	12'	208	90	80	124	42	54	42
Beau Rivage	1,838	54'x34'	12'	208	90	80	124	42	54	42
Mandalay Bay	1,838	54'x34'	12'	208	90	80	124	42	54	42
Center Prefunction	5,453	185' x 24'	30'							

	SQUARE FEET	DIMENSIONS (LxW)	CEILING HEIGHT	THEATER	CLASSROOM	ROUNDS OF 10	RECEPTION	CONFERENCE	HOLLOW SQUARE	U-SHAPE
BELLAGIO BALLROOM	4,284	84'x51'	19'6"	378	180	280	305	70	108	81
Section 1	1,785	35'x51'	19'6"	148	72	120	130	35	48	39
Section 2	2,499	49'x51'	19'6"	230	108	160	175	35	60	42
Bellagio Ballroom Prefunction	5,338	140' x 12'	20'							
Harbor Terrace	1,870	69' x 60'	∞							

	SQUARE FEET	DIMENSIONS (LxW)	CEILING HEIGHT	THEATER	CLASSROOM	ROUNDS OF 10	RECEPTION	CONFERENCE	HOLLOW SQUARE
THE COSMOPOLITAN BOARDROOM 1	648	18'x36'	11'6"	N/A	N/A	N/A	N/A	18	N/A

THE COSMOPOLITAN BOARDROOM 2	648	18'x36'	11'6"	N/A	N/A	N/A	N/A	18	N/A
-------------------------------------	------------	----------------	--------------	------------	------------	------------	------------	-----------	------------

MEETING PLANNER OFFICE	330	22'x15'	8'11"	N/A	N/A	N/A	N/A	8	N/A
-------------------------------	------------	----------------	--------------	------------	------------	------------	------------	----------	------------

- Classroom will be set 3 seats per 6' table
- Conference will be set 3 seats per 6' table
- Hollow Square will be set 3 seats per 6' table
- U-Shape will be set 3 seats per 6' table
- Banquet seating based on 10 people at 72" Rounds
- Capacities will change when staging, audiovisual and catering requirements are finalized.

THE THEATER

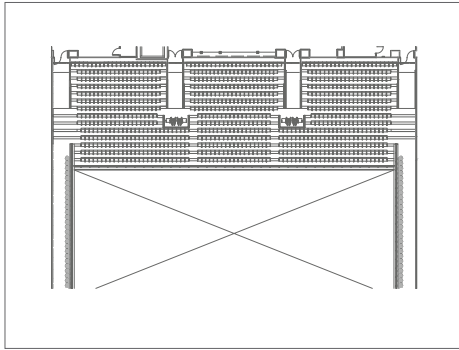

BALCONY LEVEL

900 Fixed Seating 4 Voms
45 Stools 945 Seats

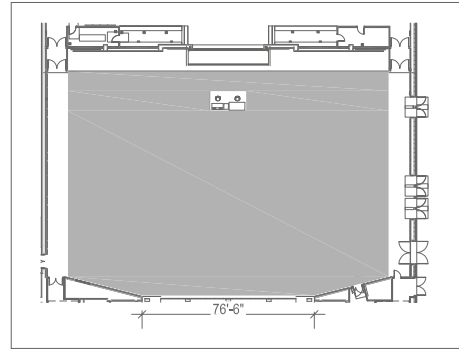

ORCHESTRA LEVEL

Orchestra Level Configuration with Rounds
73 Rounds of 10 = 730 seats
73 Rounds of 12 = 876 seats
Reception Capacity = 950 people

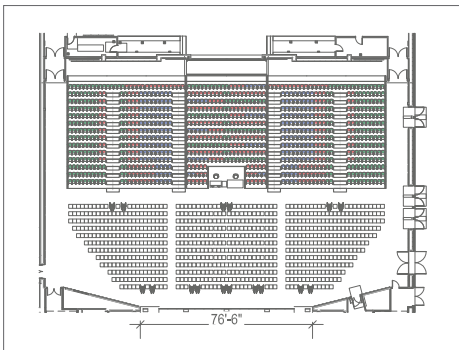

ORCHESTRA LEVEL

953 Telescoping 16 ADA Floor
778 Orchestra 1,747 Seats

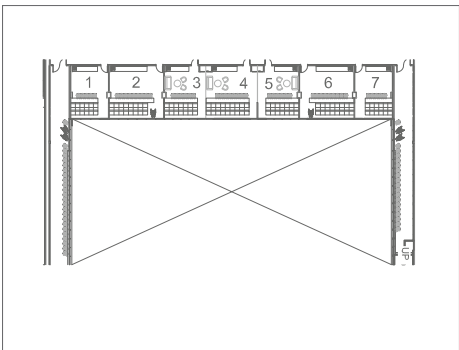

VIP LEVEL

VIP SUITES

SUITE	SQUARE FEET	DIMENSIONS	SEATS
Suite #1	368	16'x23'	13
Suite #2	552	24'x23'	25
Suite #3	414	18'x23'	16
Suite #4	506	22'x23'	22
Suite #5	414	18'x23'	16
Suite #6	552	24'x23'	25
Suite #7	368	16'x23'	13
Suite #3-4	920	40'x23'	38
Suite #4-5	920	40'x23'	38
Suite #3-5	1,334	58'x23'	54



THEATER RECEPTION SETTING



THEATER VIP SUITES



THEATER LOBBY



MGM GRAND BALLROOM SALON B AND C CLASSROOM



MGM GRAND BALLROOM PREFUNCTION AREA



THE COSMOPOLITAN BOARDROOM

NOTES

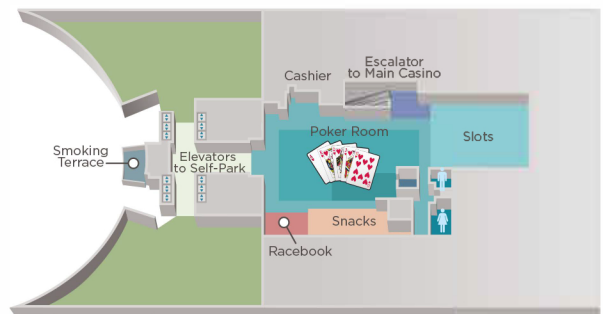
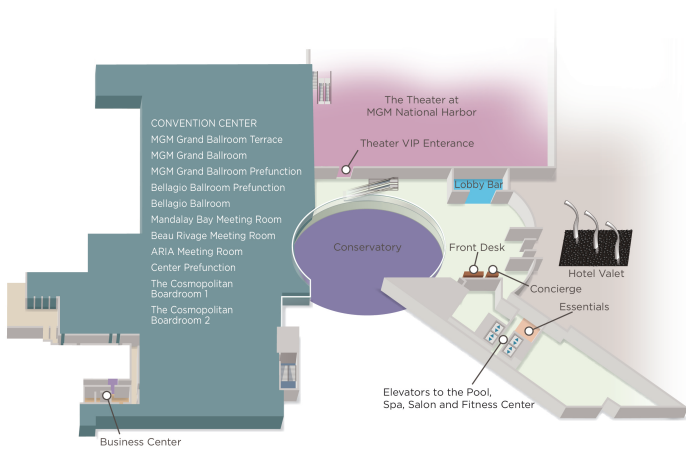
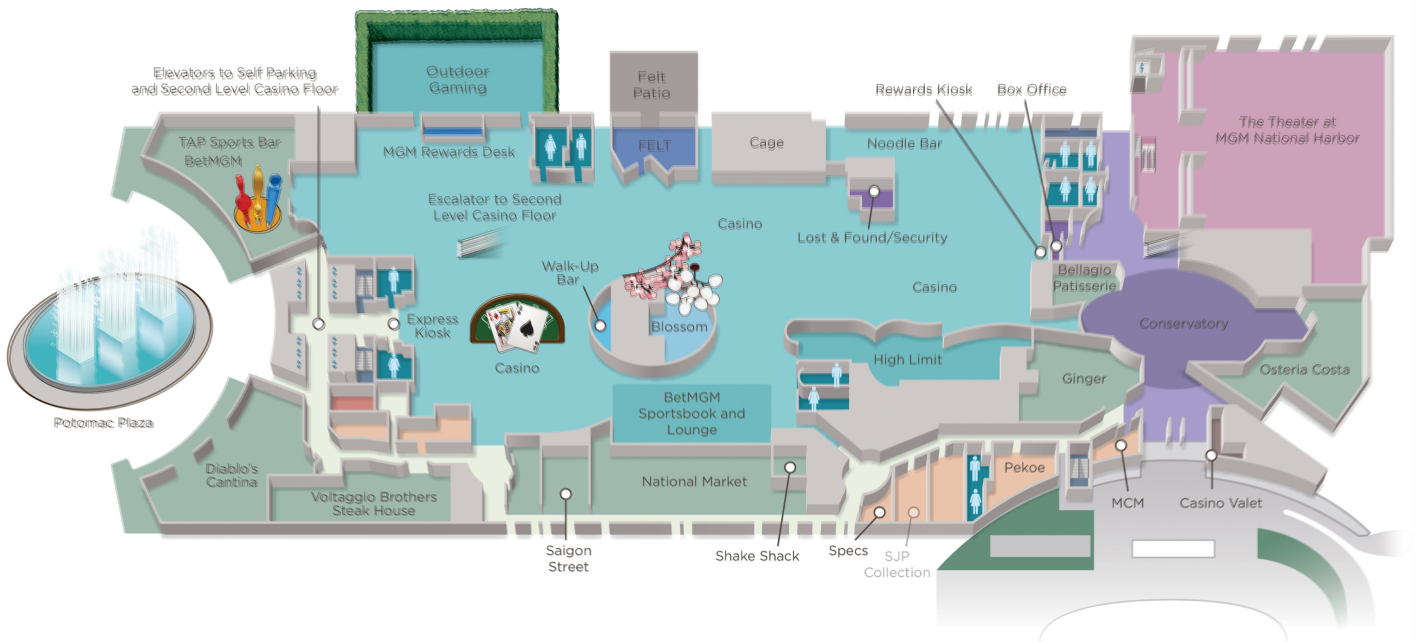



101 MGM NATIONAL AVENUE, NATIONAL HARBOR, MD 20745 | 301.971.5800 | WWW.MGMNATIONALHARBOR.COM