

# MERCURY INFLATABLE BOATS

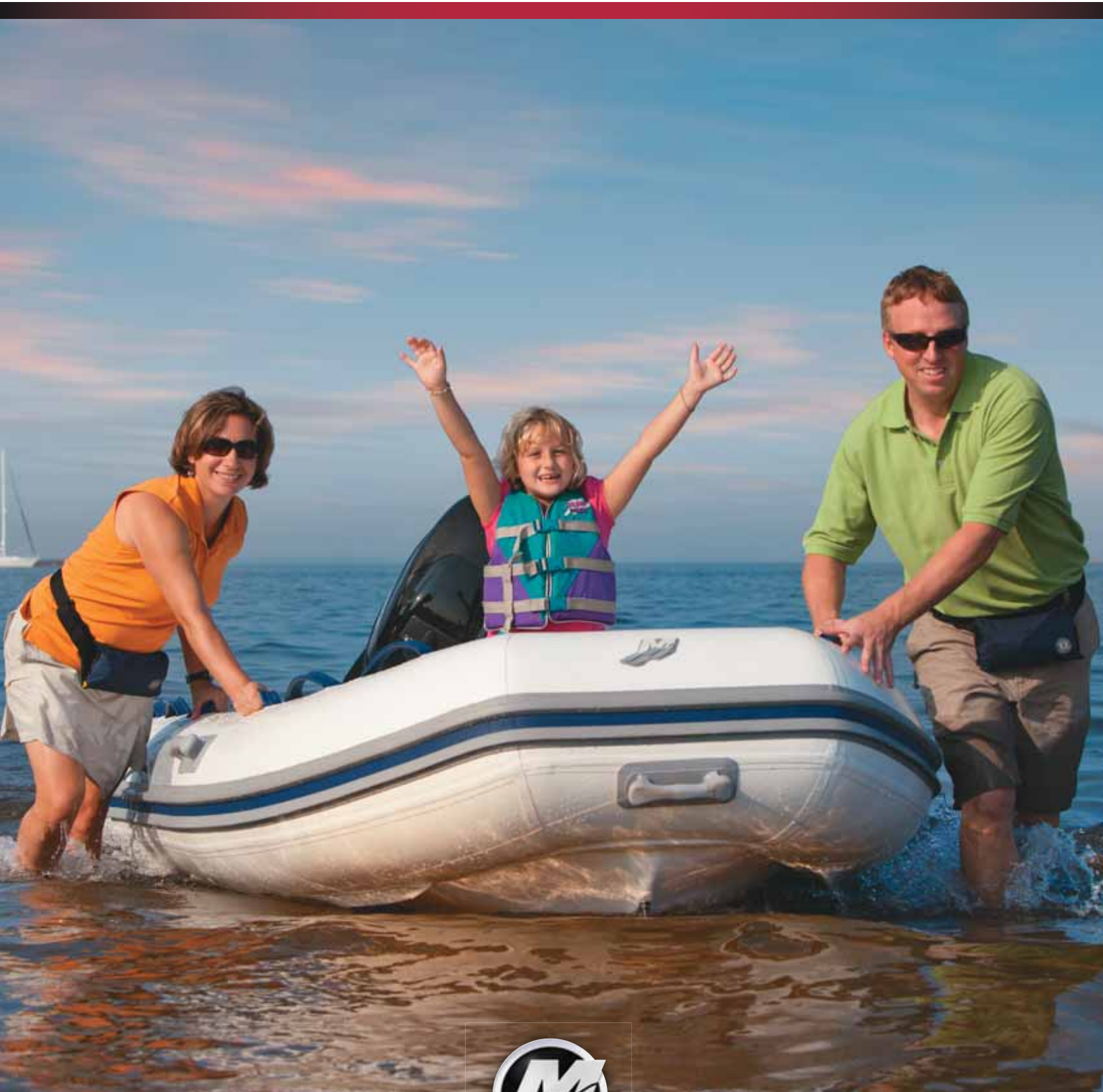



350 Ocean Runner



# Mercury Inflatable Boats

At Mercury, we are dedicated to manufacturing the finest marine products in the world. Our line of inflatable boats is no exception. Mercury Inflatable Boats utilizes the most current and highest-quality processes in the industry. This commitment to building a top-of-the-line boat is at the heart of our High-Performance Product Development (HPPD) philosophy.

Mercury's ISO 9001:2000 certified factories assure a level of excellence in all aspects of production, making our boat packages the best - from bow to stern.

Our Performance Inflatable Boats are technologically advanced with VITECH hulls and thermo-welded fabric.

<b>Features &amp; Equipment</b>	<b>4</b>
<b>Dinghy Series</b>	<b>6</b>
<b>Roll-up Series</b>	<b>7</b>
<b>Sport Series</b>	<b>8</b>
<b>Air Deck Series</b>	<b>9</b>
<b>Dynamic Series</b>	<b>10</b>
<b>Ocean Runner</b>	<b>11</b>
<b>Heavy Duty Series</b>	<b>12</b>
<b>Amanzi Series</b>	<b>13</b>
<b>Specifications</b>	<b>14</b>





# The Mercury Advantage



Mercury Inflatable PVC boats are produced with Mehler Haku, a heavy-duty, long-life fabric, which offers excellent resistance against UV, cuts, abrasions and normal wear and tear. PVC fabric also offers maximum resistance against temperature, moisture and dirt.

Mercury Inflatable PVC boats offer one of the best guarantees in the market including a 5-year limited warranty on the Haku fabric and air-holding thermowelded seams giving you assurance of our commitment to quality.



All accessories on Mercury Inflatable PVC boats are adhered by High-Frequency welding, which provides superior durability and a stronger bond between the accessory and the boat. The High-Frequency welding technique also eliminates excess glue marks, which turn yellow with exposure to the sun.



Mercury Inflatable PVC boat accessories are designed and produced for Mercury Inflatable Boats which differentiate our products from our competitors. The PVC accessories feature the following: feathering rowlock, combined oar holder / life line attaching point, combined cleat / grab handle, styled lifeline attaching points and oars / paddles designed without aluminum / aluminum joints for extra strength and corrosion resistance.



Mercury Inflatable HP boats are produced with Achilles Chlorosulfonated Polyethylene, a super-tough, long-lasting fabric, which offers superior performance in most extreme conditions: resistance to abrasion, hydrocarbons, UV light and fading.

Mercury Inflatable HP boats offer the best guarantee in the market including a 10-year limited warranty on the Achilles fabric and air-holding seams giving you assurance of our commitment to quality.

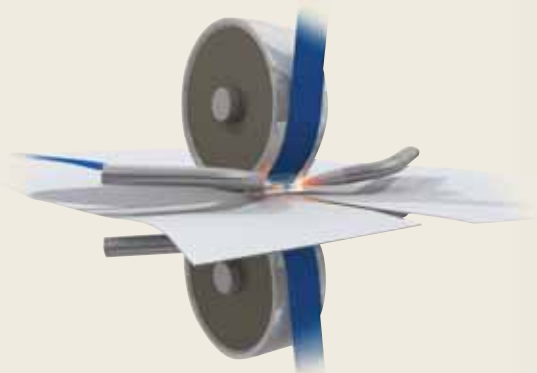

The Haku fabric tubes on Mercury Inflatable PVC boats are assembled using our exclusive thermo-welding technique. This process combines fusion welding with high-pressure bonding of double internal/external tapes, and is used to assemble the different parts of the tubes with welds stronger than the material itself.



Mercury Inflatable HP boat accessories are all made of 100% HP (Chlorosulfonated Polyethylene) formulated by a US laboratory, the identical material used in the fabric of the boat. The 100% HP accessories are extremely strong against weathering, UV light and most chemical pollutants. Mercury Inflatable HP boat accessories are the only 100% HP components on the market, making them far superior to the EPDM or MPR accessories used by the competitors.

# Standard Features & Benefits



**Bow Handles:** Extra handles inside the tube provide a more secure grip as well as additional holding points.



**Inflatable Keel:** All models are equipped with an inflatable keel under the floor for better performance (excluding rigid hull boats).



**Fiber-Reinforced Polymer (FRP) Seat:** All Mercury Inflatable Boats feature a durable FRP seat to eliminate cracking, decay and slivers.

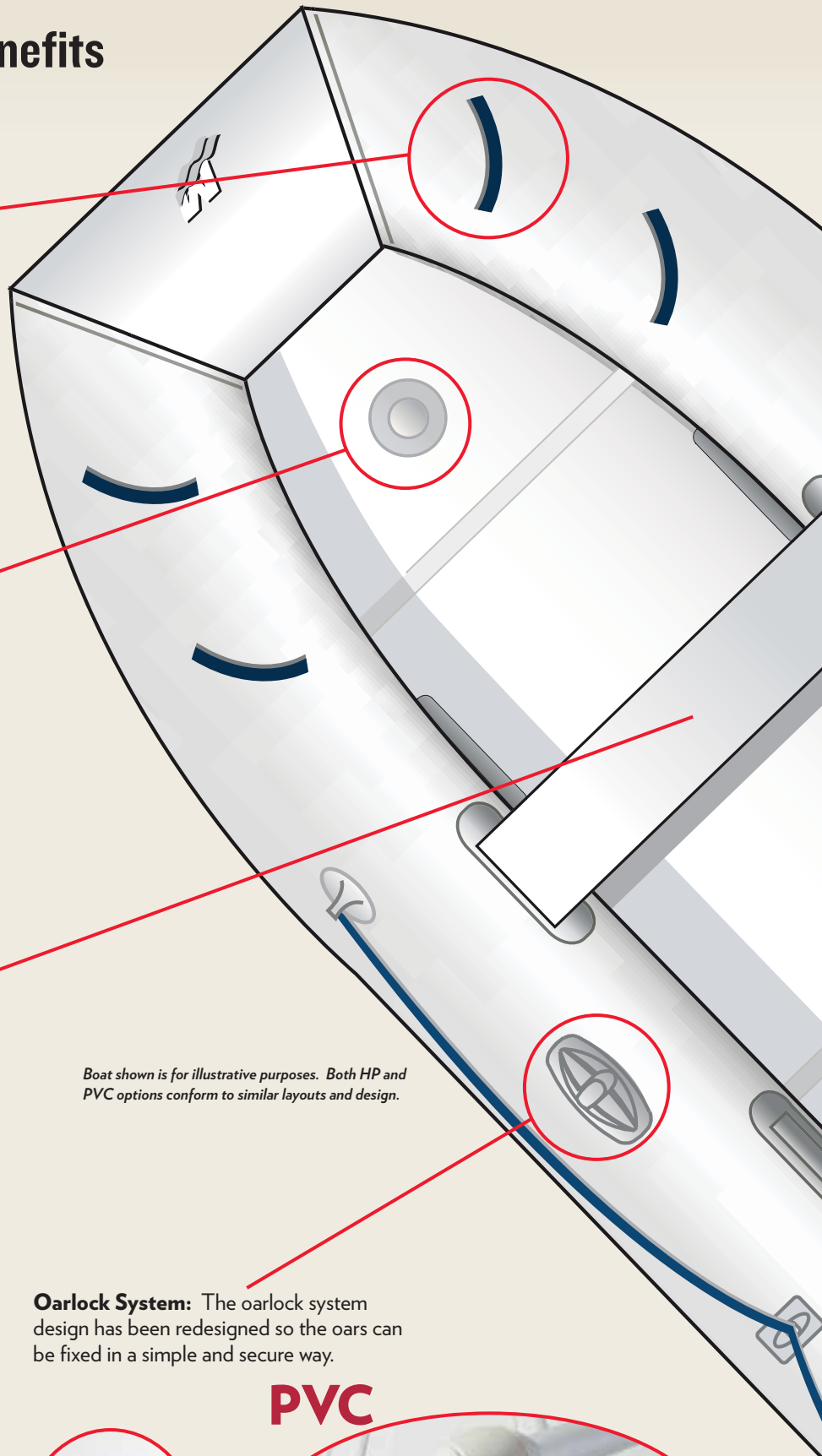

*Boat shown is for illustrative purposes. Both HP and PVC options conform to similar layouts and design.*

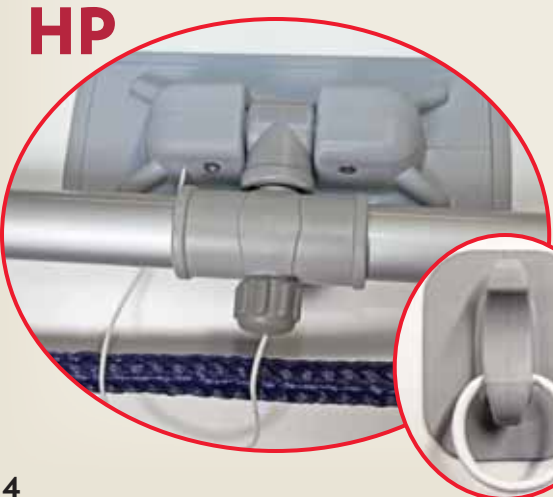

**HP**

**Oarlock System:** The oarlock system design has been redesigned so the oars can be fixed in a simple and secure way.



**PVC**

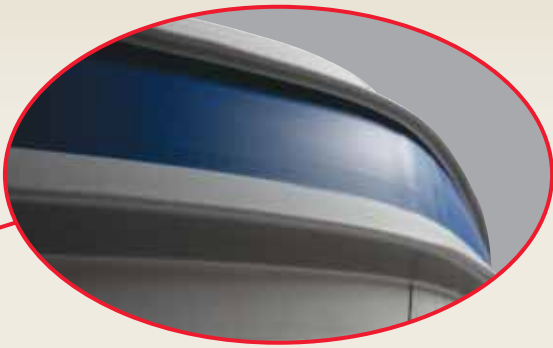

**Double tear-drop rub strake:** The double tear-drop rub strake helps to reduce splashing and provide your boat with better shock resistance.



**HP**



**PVC**

**Lifting Handles:** The boats are equipped with contemporary lifting handles that also can be used as efficient rope holders.



**Drain Plug:** The inside drain valve provides you the luxury of draining from the inside, quickly and easily.



**ABS-Coated Transom:** The ABS coating protects against cracking and decay. All transoms are made waterproof by two heavy-duty ABS layers, which ensure greater durability compared to traditional plywood transoms.

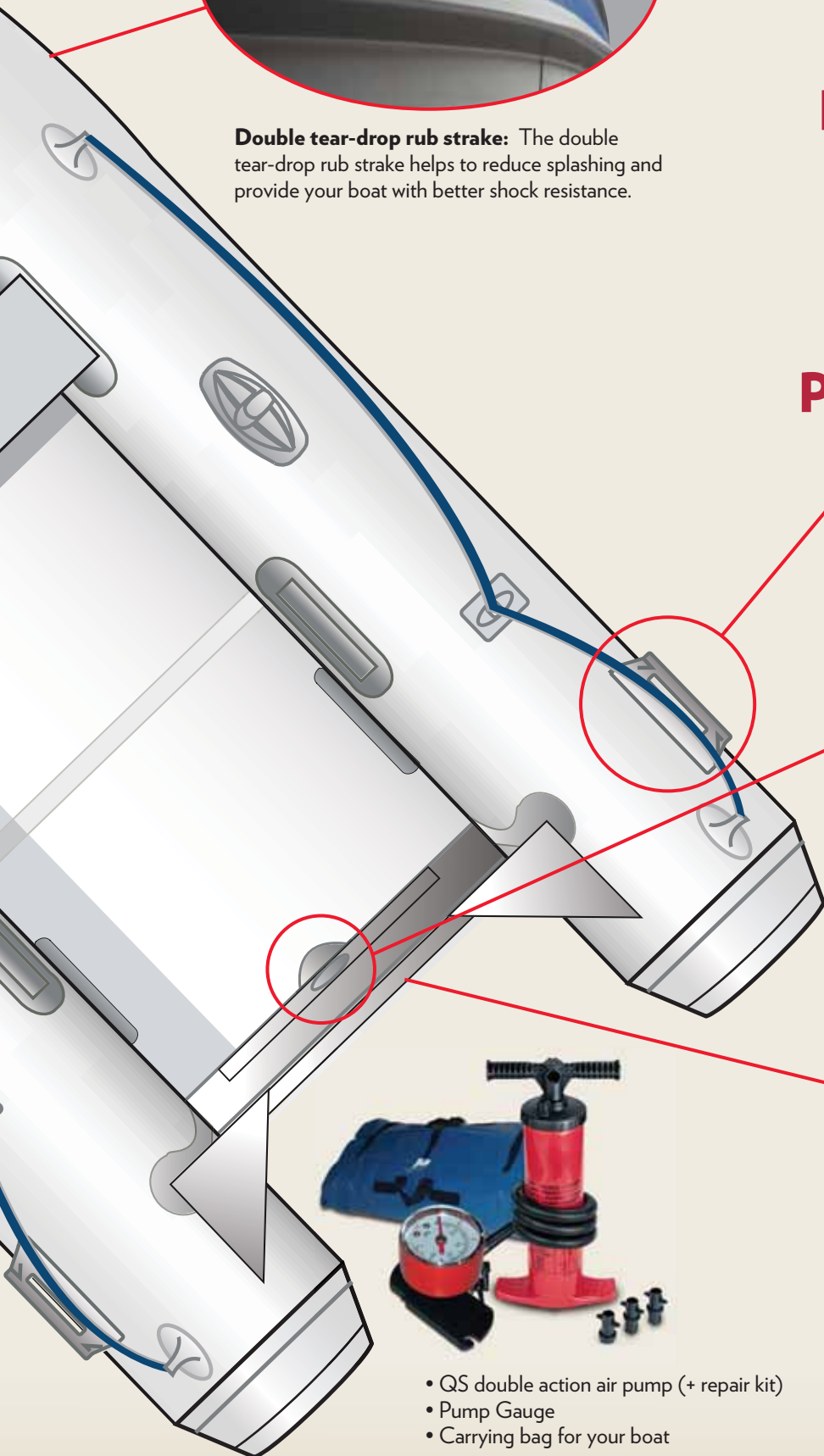

- QS double action air pump (+ repair kit)
- Pump Gauge
- Carrying bag for your boat





200 Dinghy

# Dinghy

200 / 240 / 270



## First-Time Boat Owners

The NEW Dinghy models are compact and very economical for the first-time inflatable boat buyer. These new models offer two additional inflatable compartments (floor and keel) to accompany the internal air chambers to increase safety. The Dinghy models are ideal for families on vacation who want to have fun near the shore, or the individual who has space constraints and cannot transport a large boat. The Dinghy offers a five-year limited warranty.

Model	Length	Weight	Persons	Max hp
200 PVC light gray	6' 7" (200cm)	35 lb (16kg)	2	2.5
240 PVC light gray	7' 10" (240cm)	44 lb (20kg)	3	3.5
270 PVC light gray	8' 10" (270cm)	50 lb (28kg)	3	5





# Roll Up 240



## Ship-to-Shore & More

Compact and lightweight, this economical inflatable boat is ideal as a ship-to-shore tender when speed is not your first priority.

The Roll Up is also great for the family on the go. Bring your boat with you to the lake, the beach or wherever!

With a set-up time of just minutes, no trailer and no special equipment, this boat will allow easy access to some of those places you've only seen from the shore.



Model	Length	Weight	Persons	Max hp
240 PVC light gray	7' 3" (220cm)	40 lb (18kg)	3	4



240 Roll Up



270 Sport

# Sport / Adventure

## 240 / 270 / 310 / 340



### Capable, Very Capable

The Sport series boats are versatile, designed to be an ideal alternative to their aluminum and fiberglass counterparts. Beyond their portability and economy, the Sport & Adventure Series boast serious strength, maneuverability and performance. With lower center of gravity and high-strength FRP floors, these boats are made to go the distance.

**Mercury's Fiber-Reinforced Polymer (FRP)** floorboards are waterproof, offer no degradation and are long-lasting, while providing more flexibility than the standard wooden floorboards. FRP floorboards also have a non-skid surface to improve the safety of your passengers.

Model	Length	Weight	Persons	Max hp
240 PVC light gray	7' 3" (220cm)	85 lb (39kg)	3	4
270 PVC light gray	8' 4" (250cm)	101 lb (46kg)	4	8
310 PVC light gray	9' 6" (290cm)	112 lb (51kg)	4	15
340 PVC light gray	10' 6" (320cm)	124 lb (56kg)	5	20
270 PVC green	8' 4" (250cm)	101 lb (46kg)	4	8
310 PVC green	9' 6" (290cm)	112 lb (51kg)	4	15
340 PVC green	10' 6" (320cm)	124 lb (56kg)	5	20





# Air Deck

## 240 / 270 / 310 / 340



### Convenience & Comfort

These general-purpose boats offer the lightweight ease of transport with the body-pleasing feel of an air-filled floor—soft enough to give up to five people a stable deck surface. These maneuverable boats boast a roomy interior, ready for ship-to-shore use or for regular family outings. Transport has never been easier—with no floor boards, Air Deck boats can be stowed most anywhere. Take the fun of boating wherever you go. Mercury Air Deck boats are the perfect complement to your outdoor lifestyle.

**X-stitched air floor** – high-pressure air floor offers quick assembly and small storage space while still providing excellent support. Thousands of X-stitched fibers give the Mercury air floor 50% more rigidity than traditional air floor systems.

Model	Length	Weight	Persons	Max hp
240 PVC light gray*	7' 3" (220cm)	70 lb (32kg)	3	4
240 HP white	7' 3" (220cm)	74 lb (32kg)	3	4
270 PVC light gray*	8' 4" (250cm)	76 lb (34kg)	4	8
270 HP white	8' 4" (250cm)	86 lb (39kg)	4	8
310 PVC light gray*	9' 6" (290cm)	83 lb (38kg)	4	15
310 HP white	9' 6" (290cm)	93 lb (42kg)	4	15
340 PVC light gray*	10' 6" (320cm)	90 lb (41kg)	5	20
340 HP white	10' 6" (320cm)	102 lb (46kg)	5	20

\*PVC models are also available in White



310 Air Deck



310 Dynamic RIB

# Dynamic RIB

## 260 / 280 / 310



### Best of Both Worlds

Mercury's Dynamic Rigid Inflatable Boat (RIB) gives you the hull strength of a conventional craft with the exceptional stability of an inflatable boat. Each model in the Dynamic RIB Series features a laminated fiberglass hull manufactured using the VITECH (Vacuum Injection Technology) process, molding the hull and transom as one piece for incredible strength and durability. The roomy interiors allow for carrying plenty of cargo.

**Single-skin VITECH hulls** provide incredible strength-to-weight ratio while the non-skid deck provides increased safety when entering/exiting. These super-lightweight boats are strong performers that give you reliability and a fun time on the water.

Model	Length	Weight	Persons	Max hp
260 PVC light gray	8' 2" (250cm)	65 lb (30kg)	3	5
260 HP white	8' 2" (250cm)	71 lb (32kg)	3	5
280 PVC light gray	8' 10" (270cm)	74 lb (34kg)	4	8
280 HP white	8' 10" (270cm)	81 lb (37kg)	4	8
310 HP light gray	9' 10" (300cm)	100 lb (46kg)	4	15
310 HP white	9' 10" (300cm)	105 lb (48kg)	4	15





# Ocean Runner

## 300 / 350 / 430



**The sandwich-laminated fiberglass V-hull** offers incredible maneuverability and performance.

*The aggressive styling will definitely catch your eye. The way these boats perform will have you catching your breath.*

### Nothing Dinghy About It

The Ocean Runner Series brings a truly performance-engineered, stepped fiberglass V-hull together with a very stable inflatable tube, making Ocean Runner one of the finest Rigid Inflatable Boats (RIB) in its price range. The extremely strong, durable hull and transom are able to take up to a 30 EFI FourStroke. Ocean Runner's tight handling and outright performance will amaze you.

Model	Length	Weight	Persons	Max hp
300 PVC light grey	9' 6" (290cm)	131 lb (60kg)	4	10
300 HP white	9' 6" (290cm)	136 lb (62kg)	4	10
350 PVC light grey	11' 2" (340cm)	185 lb (84kg)	5	25
350 HP white	11' 2" (340cm)	193 lb (88kg)	5	25
430 PVC light grey	13' 9" (419cm)	235 lb (107kg)	7	40
430 HP white	13' 9" (419cm)	242 lb (110kg)	7	40



### Optional Console and Seat



350 Ocean Runner



430 Heavy Duty

# Heavy Duty

## 380 / 430 / 470 / 530

### Built to Take It – Plus Your Crew and Gear... Most Anywhere

Mercury's Heavy Duty Series of inflatable boats is designed for daily pleasure or professional use. They are built strong enough to take larger engines, with the largest model able to take up to a 30 hp FourStroke. Special reinforced fabrics and a durable aluminum floor will handle you and all of your gear, year after year. Amazing is simply an understatement. Whether you choose to stay on board or roll off the pliable sides with your dive tank on, the Heavy Duty Series is ready for your next outing.



Model	Length	Weight	Persons	Max hp
380 PVC red	12' (365cm)	205 lb (93kg)	6	25
380 HP red	12' (365cm)	221 lb (100kg)	6	25
430 PVC red	13' 9" (419cm)	253 lb (115kg)	8	30
430 HP red	13' 9" (419cm)	267 lb (121kg)	8	30





# Amanzi 350 / 400

## Incredibly Complete

With a standard list of features and options like no other in its class, the Amanzi is the perfect 'get you there in style' boat. Whether it's a day excursion with the family or a ship-to-shore tender for dinner on the shore, the Amanzi will impress you from bow to stern.



Model	Length	Weight	Persons	Max hp
350 HP white	11' 5" (348cm)	425 lb (193kg)	4	40
400 HP white	13' 1" (399cm)	475 lb (216kg)	5	50



350 Amanzi

# Specifications

<b>Model</b>	<b>Color</b>	<b>Fabric</b>	<b>Fabric Thickness (Mm)</b>	<b>Max People</b>	<b>Max Engine HP</b>	<b>Max Eng. Weight Lbs/kg</b>	<b>Weight Complete Lbs/kg</b>
200 Dinghy	Grey	PVC	0.6	2	3.3	44 / 20	35 / 16
240 Dinghy	Grey	PVC	0.6	3	3.5	44 / 20	44 / 20
270 Dinghy	Grey	PVC	0.6	3	5	66 / 30	50 / 23
240 Roll Up	Grey	PVC	0.7	3	4	40 / 18	52 / 24
240 Sport	Grey	PVC	0.85	3	5	66 / 30	85 / 39
270 Sport	Grey	PVC	0.85	4	8	88 / 40	101 / 46
310 Sport	Grey	PVC	0.85	4	15	132 / 60	112 / 51
340 Sport	Grey	PVC	0.85	5	20	132 / 60	124 / 56
270 Adventure Sport	Green	PVC	0.85	4	8	88 / 40	101 / 46
310 Adventure Sport	Green	PVC	0.85	4	15	132 / 60	112 / 51
340 Adventure Sport	Green	PVC	0.85	5	20	132 / 60	124 / 56
240 Air Deck	Grey/White	PVC	0.85	3	4	66 / 30	70 / 32
240 Air Deck HP	White	HP	0.84	3	4	66 / 30	74 / 33
270 Air Deck	Grey/White	PVC	0.85	4	8	88 / 40	76 / 34
270 Air Deck HP	White	HP	0.84	4	8	88 / 40	86 / 39
310 Air Deck	Grey/White	PVC	0.85	4	15	132 / 60	83 / 38
310 Air Deck HP	White	HP	0.84	4	15	132 / 60	93 / 42
340 Air Deck	Grey/White	PVC	0.85	5	20	132 / 60	90 / 41
340 Air Deck HP	White	HP	0.84	5	20	132 / 60	102 / 46
260 Dynamic	Grey	PVC	0.85	3	5	66 / 30	65 / 30
260 Dynamic HP	White	HP	0.84	3	5	66 / 30	71 / 32
280 Dynamic	Grey	PVC	0.85	4	8	88 / 40	74 / 15
280 Dynamic HP	White	HP	0.84	4	8	88 / 40	81 / 37
310 Dynamic	Grey	PVC	0.85	4	15	99 / 45	100 / 46
310 Dynamic HP	White	HP	0.84	4	15	99 / 45	105 / 48
300 Ocean Runner	Grey	PVC	0.85	4	10	99 / 45	131 / 60
300 Ocean Runner HP	White	HP	0.84	4	10	99 / 45	136 / 62
350 Ocean Runner	Grey	PVC	0.85	5	25	187 / 85	185 / 84
350 Ocean Runner HP	White	HP	0.84	5	25	187 / 85	193 / 88
430 Ocean Runner	Grey	PVC	0.85	7	30	187 / 85	235 / 107
430 Ocean Runner HP	White	HP	0.84	7	30	187 / 85	242 / 110
380 Heavy Duty	Red	PVC	1.15	6	25	187 / 85	205 / 93
380 Heavy Duty HP	Red	HP	1.1	6	25	187 / 85	221 / 100
430 Heavy Duty	Red	PVC	1.15	8	30	187 / 85	253 / 115
430 Heavy Duty HP	Red	HP	1.1	8	30	187 / 85	267 / 121
350 Amanzi HP	White	HP	0.84	4	40	227 / 103	425 / 193
400 Amanzi HP	White	HP	0.84	5	50	247 / 112	475 / 216



<b>Boat Length Ft / CM</b>	<b>Beam Width Ft / CM</b>	<b>Tube Diameter In/CM</b>	<b>Tube Pressure Psi/bar</b>	<b>Air Chambers</b>	<b>Air Keel</b>	<b>Bagged Dimensions CM</b>	<b>Floor Material</b>
6'7" / 201	4'1" / 124	13" / 33	3.6 / 1.63	2+keel+floor	Yes	100x56x26	Air
7'10" / 239	4'4" / 132	13" / 33	3.6 / 1.63	2+keel+floor	Yes	100x56x26	Air
8'10" / 269	4'4" / 132	13" / 33	3.6 / 1.63	2+keel+floor	Yes	100x56x26	Air
7'3" / 220	4'7" / 140	14" / 36	3.6 / 1.63	2	No	100x56x26	Slat
7'3" / 220	5'0" / 152	16" / 41	3.6 / 1.63	3+keel	Yes	102x56x30	Fiberglass
8'4" / 250	5'0" / 152	16" / 41	3.6 / 1.63	3+keel	Yes	102x56x35	Fiberglass
9'6" / 290	5'0" / 152	16" / 41	3.6 / 1.63	3+keel	Yes	102x56x40	Fiberglass
10'6" / 320	5'0" / 152	16" / 41	3.6 / 1.63	3+keel	Yes	102x56x46	Fiberglass
8'4" / 250	5'0" / 152	16" / 41	3.6 / 1.63	3+keel	Yes	102x56x35	Fiberglass
9'6" / 290	5'0" / 152	16" / 41	3.6 / 1.63	3+keel	Yes	102x56x40	Fiberglass
10'6" / 320	5'0" / 152	16" / 41	3.6 / 1.63	3+keel	Yes	102x56x46	Fiberglass
7'3" / 220	5'0" / 152	16" / 41	3.6 / 1.63	3+keel+floor	Yes	102x56x30	Air
7'3" / 220	5'0" / 152	16" / 41	3.6 / 1.63	3+keel+floor	Yes	102x56x30	Air
8'4" / 250	5'0" / 152	16" / 41	3.6 / 1.63	3+keel+floor	Yes	102x56x35	Air
8'4" / 250	5'0" / 152	16" / 41	3.6 / 1.63	3+keel+floor	Yes	102x56x35	Air
9'6" / 290	5'0" / 152	16" / 41	3.6 / 1.63	3+keel+floor	Yes	102x56x40	Air
9'6" / 290	5'0" / 152	16" / 41	3.6 / 1.63	3+keel+floor	Yes	102x56x40	Air
10'6" / 320	5'0" / 152	16" / 41	3.6 / 1.63	3+keel+floor	Yes	102x56x46	Air
10'6" / 320	5'0" / 152	16" / 41	3.6 / 1.63	3+keel+floor	Yes	102x56x46	Air
8'2" / 249	4'9" / 145	15" / 38	3.6 / 1.63	3	No	185 x 96 x 45	Fiberglass
8'2" / 249	4'9" / 145	15" / 38	3.6 / 1.63	3	No	185 x 96 x 45	Fiberglass
9'2" / 279	4'8" / 142	15" / 38	3.6 / 1.63	3	No	215x96x45	Fiberglass
9'2" / 279	4'8" / 142	15" / 38	3.6 / 1.63	3	No	215x96x45	Fiberglass
10'2" / 307	5'3" / 160	16" / 41	3.6 / 1.63	3	No	240x112x45	Fiberglass
10'2" / 307	5'3" / 160	16" / 41	3.6 / 1.63	3	No	240x112x45	Fiberglass
9'8" / 295	5'4" / 163	16" / 41	3.6 / 1.63	4	No	245x115x50	Fiberglass
9'8" / 295	5'4" / 163	16" / 41	3.6 / 1.63	4	No	245x115x50	Fiberglass
11'6" / 350	5'9" / 175	16" / 41	3.6 / 1.63	5	No	270x120x50	Fiberglass
11'6" / 350	5'9" / 175	16" / 41	3.6 / 1.63	5	No	270x120x50	Fiberglass
14'1" / 430	5'11" / 180	19" / 48	3.6 / 1.63	7	No	320x110x65	Fiberglass
14'1" / 430	5'11" / 180	19" / 48	3.6 / 1.63	7	No	320x110x65	Fiberglass
12'6" / 371	5'9" / 175	18" / 46	3.6 / 1.63	3+keel	Yes	128x62x35	Aluminum
12'6" / 371	5'9" / 175	18" / 46	3.6 / 1.63	3+keel	Yes	128x62x35	Aluminum
14'1" / 430	6'2" / 188	19" / 48	3.6 / 1.63	3+keel	Yes	145x65x38	Aluminum
14'1" / 430	6'2" / 188	19" / 48	3.6 / 1.63	3+keel	Yes	145x65x38	Aluminum
11'6" / 350	6'0" / 183	17" / 43	3.6 / 1.63	3	No	-	Fiberglass
13'0" / 396	6'2" / 188	18" / 46	3.6 / 1.63	3	No	-	Fiberglass



## FOR MORE INFORMATION ABOUT MERCURY POWER,

including its full lineup of engines, propellers, parts and accessories, visit the ultimate resource for Mercury outboards at [www.mercurymarine.com](http://www.mercurymarine.com). You'll also find special promotions, Mercury news, service and support information, side-by-side comparison charts, photos, videos and much more to help you achieve maximum engine performance and an unbeatable driving experience on the water.



135 hp - 430 hp



150 hp - 350 hp



2.5 hp - 30 hp



40 hp - 115 hp



75 hp - 250 hp

DIVE IN AT [WWW.MERCURYMARINE.COM](http://WWW.MERCURYMARINE.COM)

**MERCURY**  
Inflatable Boats