

**SPARE PARTS LIST
FOR**



**MOTOR CYCLE
LIGHT WEIGHT**

MODEL NUMBER 810.94010

**SEARS, ROEBUCK AND CO. U.S.A.
SIMPSONS-SEARS, LTD. CANADA**

ALLSTATE LIGHT WEIGHT MOTOR CYCLE —

SPECIAL TOOLS

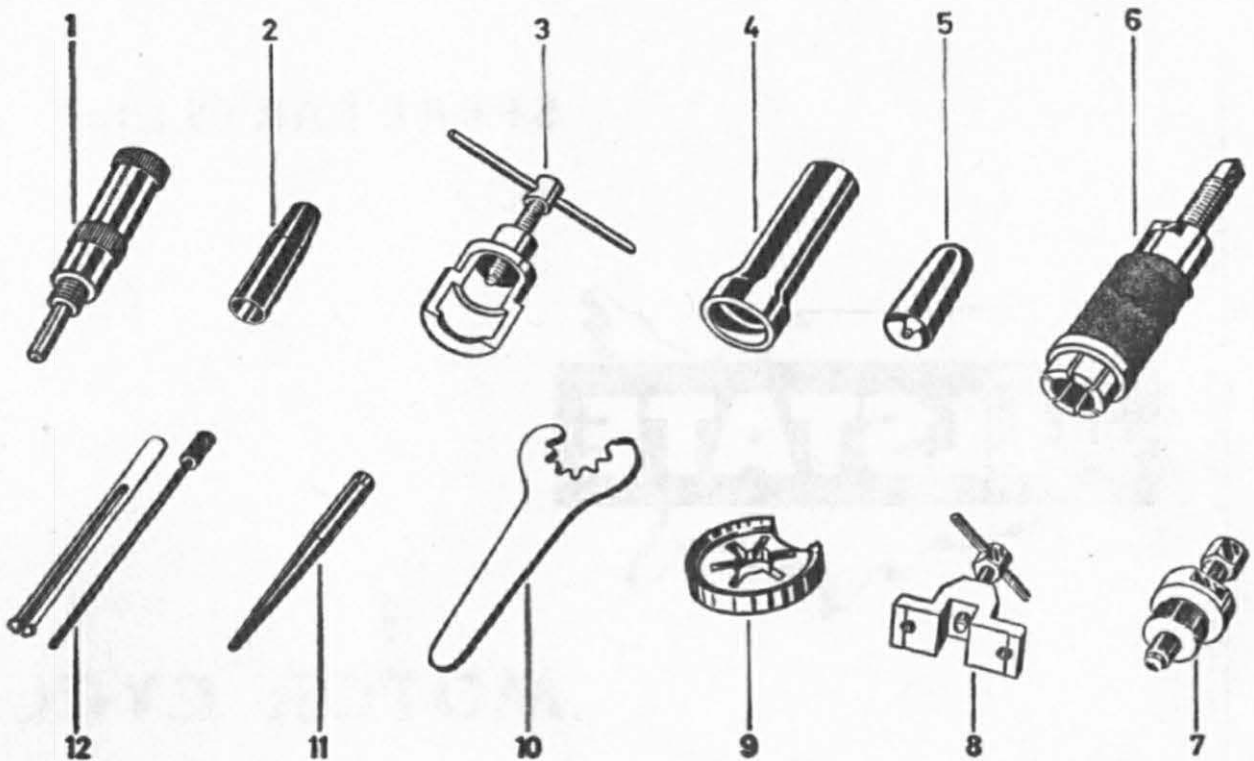

MS/ST/70S/1

Ref. No.	Part No.	Description	Requd. No.
1	050.1000.0-L 28	Ignition point adjusting gauge	1
2	050.1000.0-W 23	Guide sleeve (for mounting the packing ring on the crankshaft)	1
3	050.1.1000.0-W38	Extractor (for intermediate disc on gear shaft)	1
4	050.1000.0-W 41	Mounting sleeve (for fitting inner rings of crankshaft bearing)	1
5	050.4.1332.2-W 2	Mounting bolt (for fitting snap ring on pedal shaft)	1
6	050.7011	Extractor (for crankshaft bearing)	1
7	050.7012	Extractor (for flywheel magneto of generator)	1
8	050.7013	Extractor (for engine sprocket)	1
9	360.1.70.014.1	Holder (for large driving pinion)	1
10	050.7015	Sprocket holder (for gear sprocket 12 teeth)	1
11	—	Not for this model	—
12	050.7029	Pressing-out tool (for ball bearings of front and rear wheel hub)	1

SPARE PARTS CATALOG

Table of Contents

Engine	1	Crankcase
	2	Blower
	3	Cylinder
	4	Engine Parts
	5	Clutch
	6	Gearbox
	7	Starter Mechanism
	8	Pedals
	9	Gearshift
	10	Carburettor
Chassis	11	Fuel Tank, Exhaust
	12	Frame, Mudguards (Fenders)
	13	Saddle, Luggage Carrier
	14	Pivoted Fork, Prop Stand
	15	Shock Absorber
Front Fork	16	Front Fork and Steering
	17	Handlebar, Gearshift and Throttle Twist Grips
	18	Bowden Cables
Road Wheels	19	Front Wheel
	20	Speedometer with Drive
	21	Rear Wheel, Driving Chain
Electrical Equipment	22	Generator
	23	Headlamp, Horn, Tail-Stop-Light and Switch
Accessories	24	Tools, Bell, Tire Pump

1 CRANKCASE

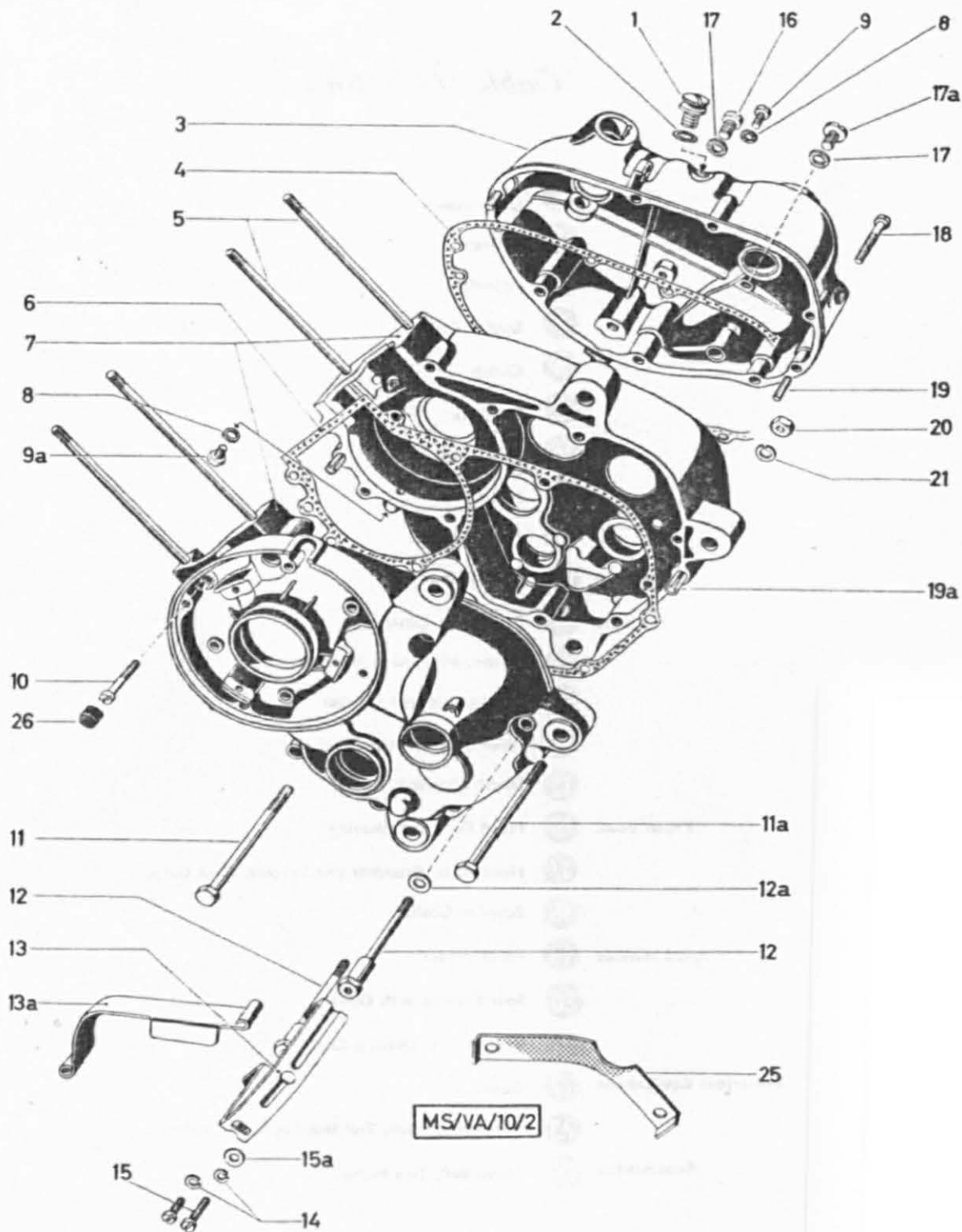

Ref. No.	Part No.	Description	Requd. No.
—	302.6.10.000.0	Engine complete	1
1	364.1.10.660.1	Oil filler plug	1
2	27071	Seal washer A 10x14 DIN 7603	1
3	350.3.10.035.1	Crankcase cover right	1
4	050.1.1049	Crankcase cover gasket	1
5	050.1078	Stud bolt M 6, 103 long	4
6	050.10.1031	Crankcase gasket	1
7	050.10.1032.0	Crankcase complete	1
8	24365	Seal washer A 6x12 DIN 7603	2
9	900.1305	Fillister head screw M 6x8 DIN 84 for oil control	1
9a	25403	Hexagon head screw M 6x8 Din 933 for crankcase breathing	1
10	900.1319	Fillister head screw M 6x35 DIN 84 for crankcase assembly	8
11	900.1136	Hexagon head screw M 8x1x65	3
11a		DIN 960 — 8 G	
12	050.2.1076	Screw (M 6, 50 long)	3
12a	24804	Washer 6,4 DIN 433	2
13	050.5.1075.2	Fixing clip	1
13a	350.6.10.092.1	Chain safety bow	1
14	29190	Spring ring B 5 DIN 127	2
15	900.1312	Fillister head screw AM 5x10 DIN 84	1
	900.1308	Fillister head screw AM 5x30 DIN 84	1
15a	24803	Washer 5,3 DIN 433	1
16	900.1342	Fillister head screw AM 8x10	1
		DIN 84 for oil drain plug	
17	26482	Seal washer A 8x14 DIN 7603	1
17a	900.1512	Lens head screw AM 8x10 DIN 85	1
	900.1206	Fillister head screw M 6x30 DIN 84 for crankcase cover	
18	900.1319	Fillister head screw M 6x35 DIN 84 for crankcase cover	1
		Cylindrical pin 6 h 8x18 DIN 7	
19	900.4810	Spacer	2
19a	050.10.1054	Hexagon nut M 8x1 DIN 934—6 S	3
20	900.2021	Spring ring B 8 DIN 127	1
21	26819	Locking plate for nuts	1
25	050.1.1096	Rubber plug for crankcase	1
26	050.10.1088	12.5 mm dia., 10,5 long	2

2 BLOWER

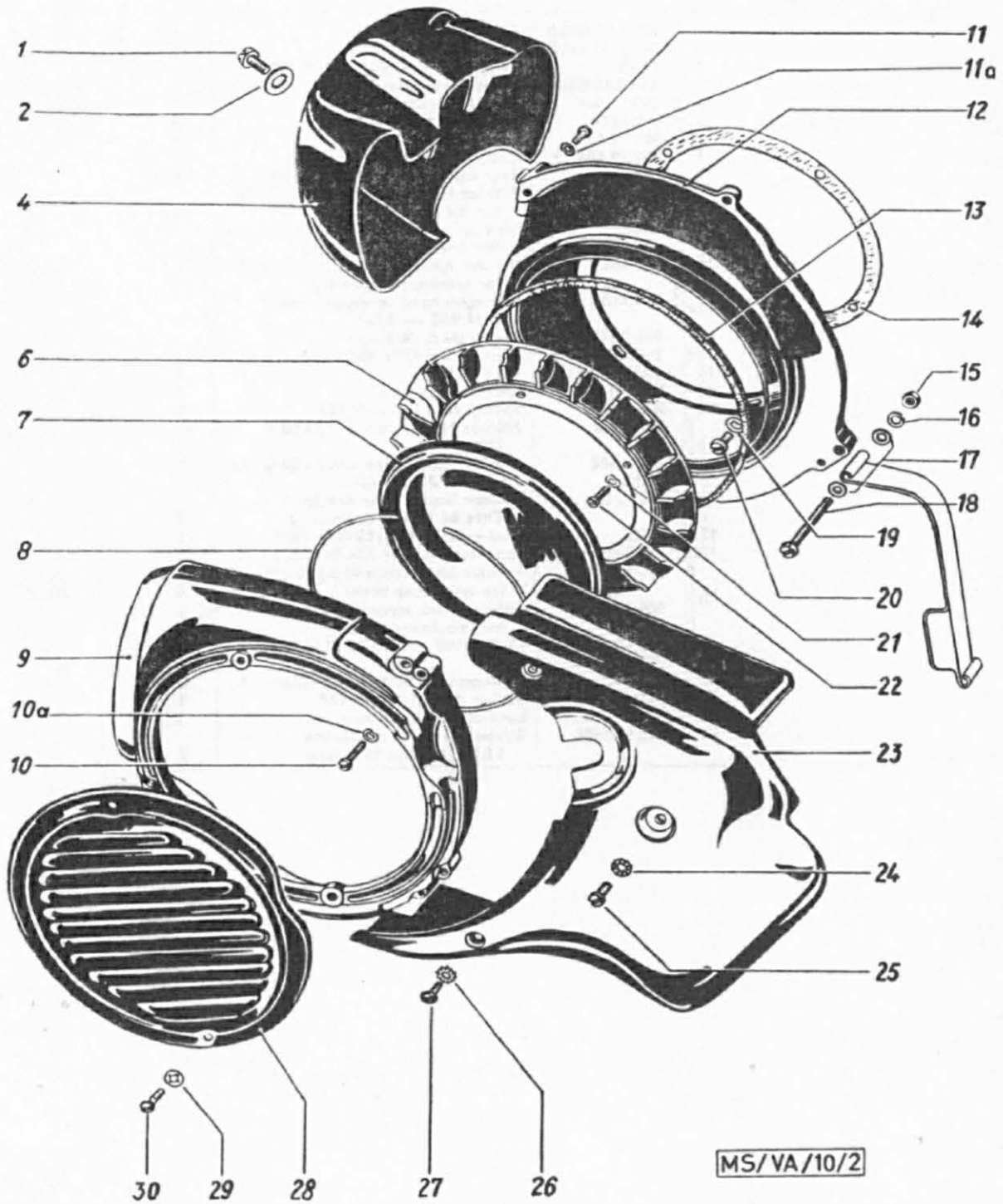

Ref. No.	Part No.	Description	Requd. No.
1	900.1514	Lens head screw M 6x10 DIN 85	2
2	900.3456	Securing washer JZC 6	2
4	364.1.10.065.1	Blower hood	1
6	350.4.10.072.1	Blower fan wheel	1
7	050.10.1073	Cover plate	1
8	350.1.10.074.1	Spring ring (securing ring)	1
9	050.10.1062	Blower housing	1
10	900.1520	Lens head screw M 4x20 DIN 85	2
10a	900.3202	Spring washer A 4 DIN 137	2
11	900.1506	Lens head screw M 4x12 DIN 85	2
11a	900.3202	Spring washer A 4 DIN 137	2
12	350.4.10.061.2	Blower base plate with felt washer	1
13	050.1.1037	Felt washer for blower base plate	1
14	050.10.1036	Gasket 122,5 mm dia. (paper)	1
15	900.2105	Hexagon nut M 5 DIN 555	1
16	29190	Spring ring B 5 DIN 127	1
17	24803	Washer 5,3 DIN 433	2
18	900.1335	Fillister head screw AM 5x50 DIN 84	1
19	900.3218	Spring washer 9/5,2/1	4
20	23099	Fillister head screw AM 5x12 DIN 84	4
21	900.3205	Spring washer A 5 DIN 137	4
22	23099	Fillister head screw AM 5x12 DIN 84	4
23	303.1.10.064.1	Fairing plate	1
24	900.3401	Securing washer JAC 5,3	1
25	900.1513	Lens head screw M 5x10 DIN 85	1
26	900.3464	Securing washer AZ 4,2	2
27	900.1506	Lens head screw M 4x12 DIN 85	2
28	050.10.1068	Blower louvre cover	1
29	900.3964	Clamp Disc 4	2
30	050.1.1084	Lens head screw (M 4x10)	2

3

CYLINDER

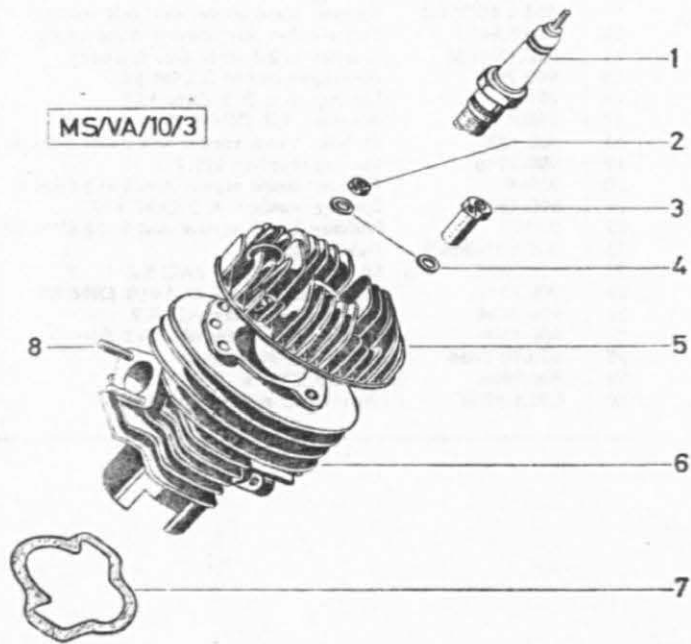

CYLINDER

3

Ref. No.	Part No.	Description	Requd. No.
1	Allst. No. 60410	Spark plug	1
2	24773	Hexagon nut M 6 DIN 934	2
3	050.1.1003	Round neck nut (M 6) for cylinder head	2
4	24795	Washer 6,4 DIN 125	4
5	350.1.10.201.1	Cylinder head	1
6	050.10.1005.2	Cylinder normal, 38 mm dia.	1
6	050.10.1005.3	Cylinder, 38,5 mm dia.	1
6	52.1.1005.0	Cylinder with compl. piston, 38 mm dia.	1
6	52.1.1005.6	Cylinder with compl. piston, 38,5 mm dia.	1
7	050.1.1013	Cylinder base flange gasket	1
8	050.1.1014	Stud bolt M 6x16	2

4

ENGINE PARTS

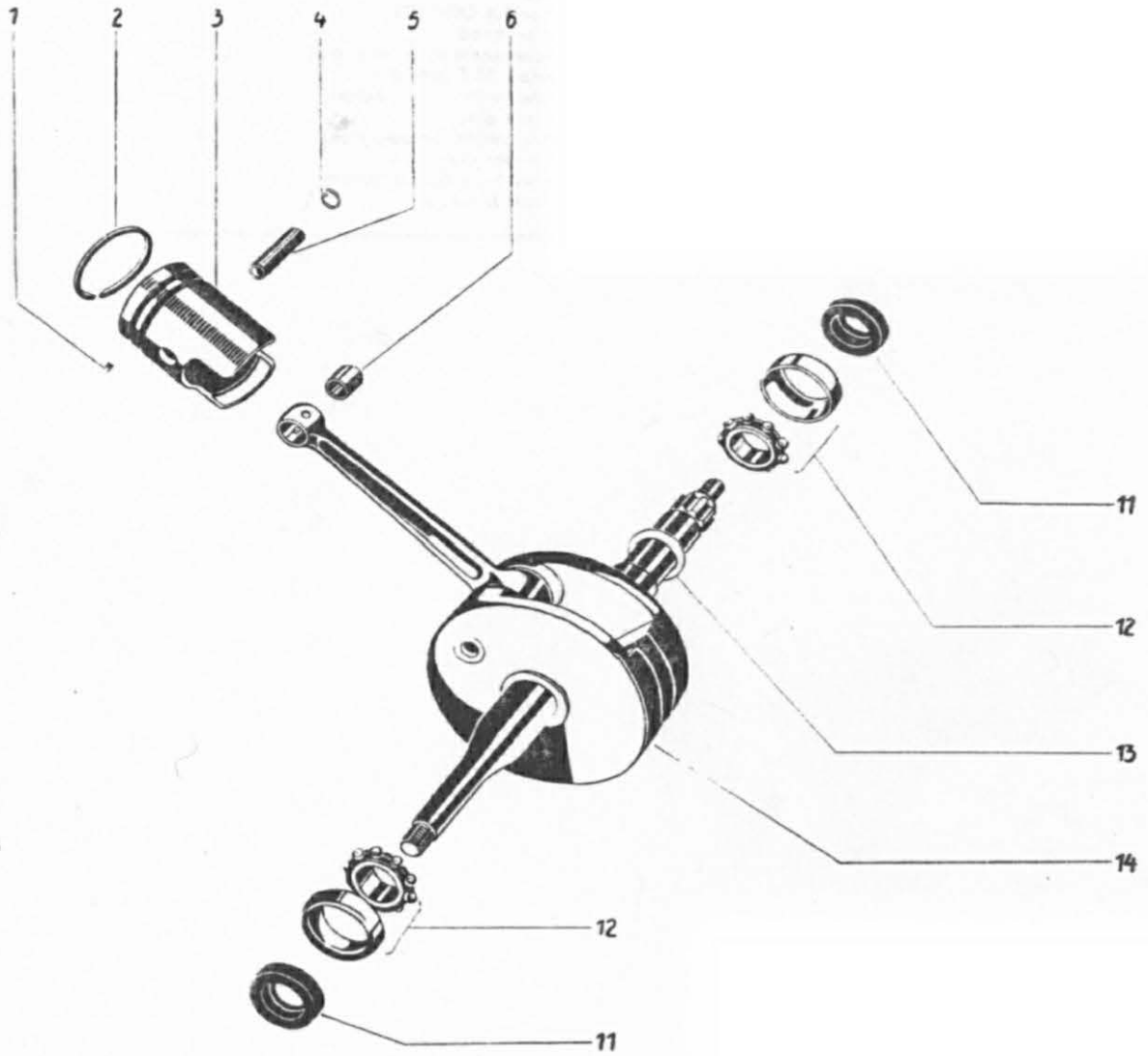

ENGINE PARTS

4

Ref. No.	Part No.	Description	Requd. No.
1	900.4855	Notched locking pin 2x6 DIN 1473	2
2	320.1.10.060.1	Piston ring AZ 38x2ac DIN 73102	2
2	320.1.10.060.3	Piston ring, oversize I, AZ 38,5x2 ac DIN 73102	—
(3)	364.1.10.506.0	Piston complete (parts 1—3), normal 38 mm dia.	1
(3)	364.1.10.506.4	Piston complete (parts 1—3), oversize I, 38,5 mm dia.	—
4	900.4714	Wire lock washer B 10 DIN 73123	2
5	050.1011	Wrist pin 10 mm dia., 32 mm long	1
6	050.1052	Bushing for connecting rod, 9,4/12/13	1
6	050.1052.3	Bushing for connecting rod, oversize	1
11	900.3807	Seal ring BA 35/17/7	2
12	900.6007	Ball bearing L 17a 40/17/10 DIN 615	2
13	900.3922	Spacer shim 24/17,1/0,1	—
13	900.3923	Spacer shim 24/17,1/0,2	—
13	900.3992	Spacer shim 24/17,1/0,05	—
14	302.1.10.015.0	Crankshaft complete with connecting rod	1

5 CLUTCH

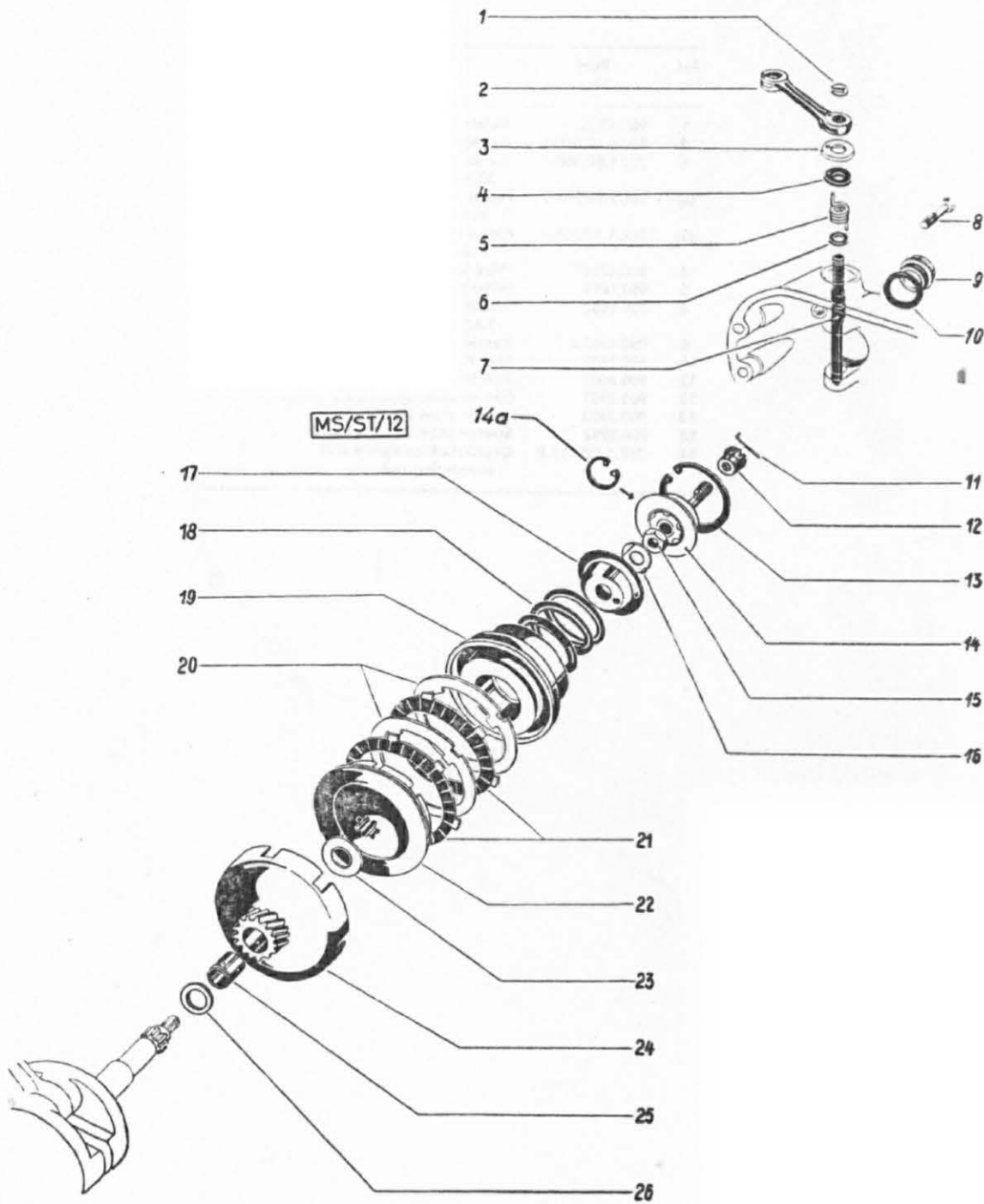

Ref. No.	Part No.	Description	Requd. No.
1	900.4606	Circlip 6 DIN 6799	1
2	050.2.1231	Declutching lever	1
3	050.1219	Cap	1
4	050.1221	Rubber disc 20/7,8/2	1
5	050.1222	Torsion spring	1
6	050.1220	Rubber disc 13/7,5/2	1
7	050.1228	Declutching shaft	1
8	050.1.1229	Screw M 5x18	1
9	050.1.1233	Centering screw	1
10	900.3718	Fibre seal washer 26,5/22/1	1
11	050.1237	Wire pin 1,4 mm dia.	1
12	050.1234	Ball nut	1
13	900.4745	Snap ring Sg 45x1,75 DIN 472	1
14	050.2.1230.0	Set bolt (compl. w. ball bearing, bearing shell and snap ring)	1
—	050.1240.2	Set bolt (compl. w. ball bearing, without bearing shell)	1
—	050.2.1210.2	Bearing shell	1
14a	900.4721	Snap ring Sg 21x1 DIN 472	1
15	26820	Hexagon nut M 8x1 DIN 934	1
16	050.1214	Locking plate 8/20 mm dia.	1
17	050.1207	Spring collar	1
18	050.1206	Clutch spring	1
19	050.1205	Spring cage	1
20	050.1212	Interior clutch disc	2
21	050.1224.2	Exterior clutch disc (with friction lining)	2
22	050.1204	Clutch hub	1
23	050.1215	Thrust washer 26/15/1	1
24	350.1.12.002.2	Clutch housing (19 teeth)	1
25	050.1211	Bearing bushing 17/15/16,3	1
26	050.1213	Thrust washer 22/15/1,7	1

6

GEARBOX

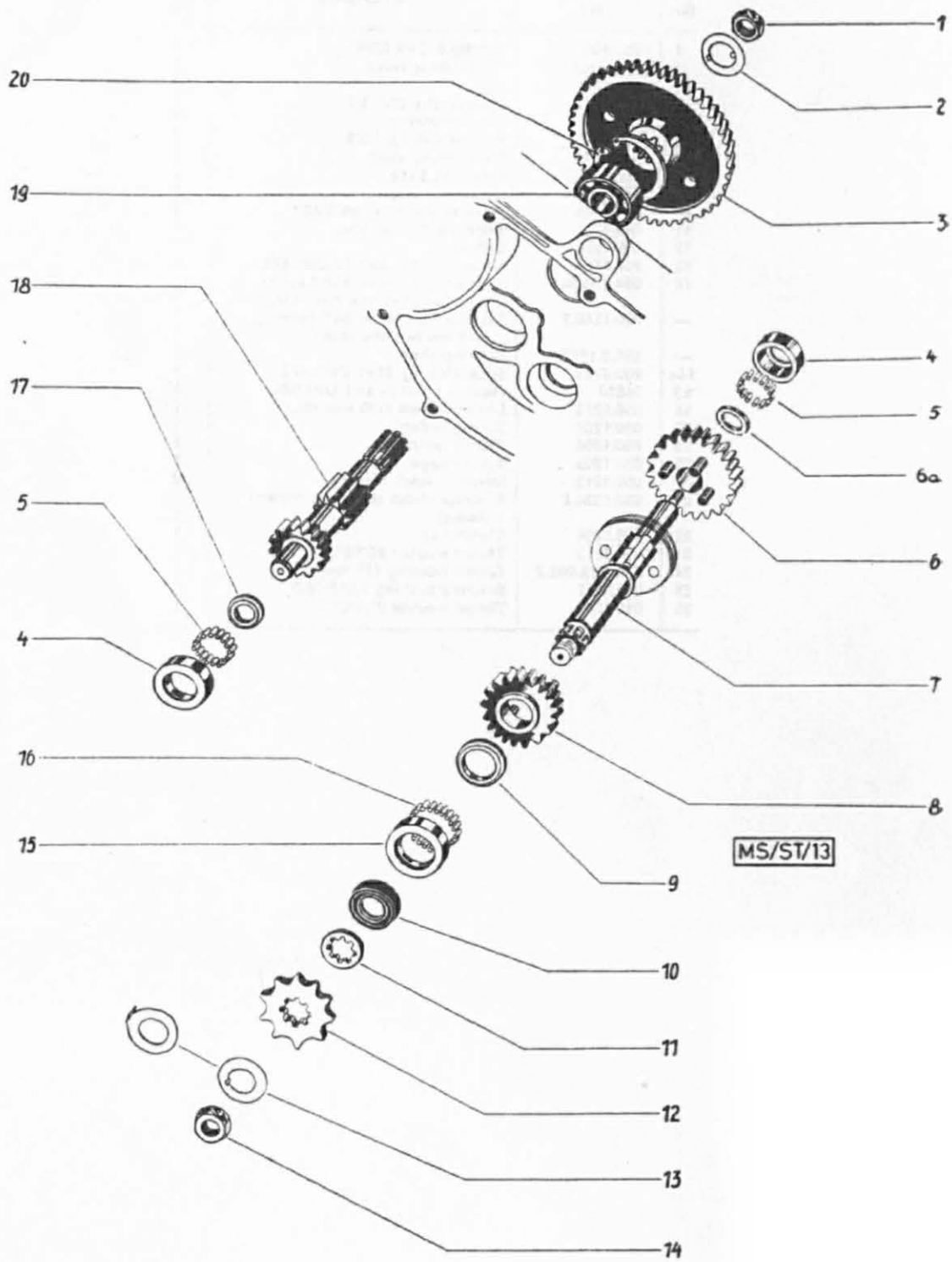

Ref. No.	Part No.	Description	Requd. No.
(1)	24787	Hexagon nut M 12x1	1
(2)	360.1.13.004.1	Locking plate 22/12,5 mm dia. (flaps outwards)	1
3	350.1.13.000.1	Driving pinion (helical gear 69 teeth)	1
4	050.1.1310	Roller race 28 mm dia. (for main and counter shafts)	2
5	900.6104	Roller 3,5x7,5 (14 rollers to each race)	28
6	352.1.13.011.1	First-speed gear (30 teeth) without collar	1
6a	350.1.13.075.1	Disc 18/12,5/1,6	—
6a	350.1.13.078.1	Disc 18/12,5/1,8	—
6a	350.1.13.076.1	Disc 18/12,5/2	—
6a	350.1.13.079.1	Disc 18/12,5/2,25	—
6a	350.1.13.077.1	Disc 18/12,5/2,5	—
6a	350.1.13.080.1	Disc 18/12,5/2,75	—
7	050.1.1320	Main shaft	1
8	050.1.1312	Second-speed gear (23 teeth)	1
9	050.1.1366	Thrust washer 24/17 mm dia.	1
10	050.1321	Seal washer BA 28/17/7	1
11	050.1.1319	Intermediate disc	1
12	050.1317	Gearbox chain sprocket (12 teeth) standard equipment	1
13	050.1318	Locking plate 12/25 mm dia. (flaps outwards)	1
14	24787	Hexagon nut M 12x1	1
15	050.1.1365	Outer bearing race 32 mm dia.	1
16	900.6104	Roller 3,5 mm dia. x7,5	18
17	050.1.1306	Thrust washer 12,5/20 mm dia.	1
18	352.1.13.001.1	Counter shaft (9/16 teeth)	1
19	900.6202	Deep-row ball bearing 6202 35/15/11 DIN 625	1
20	900.4735	Snap ring Sg 35x1,5 DIN 472	1

7

STARTER MECHANISM

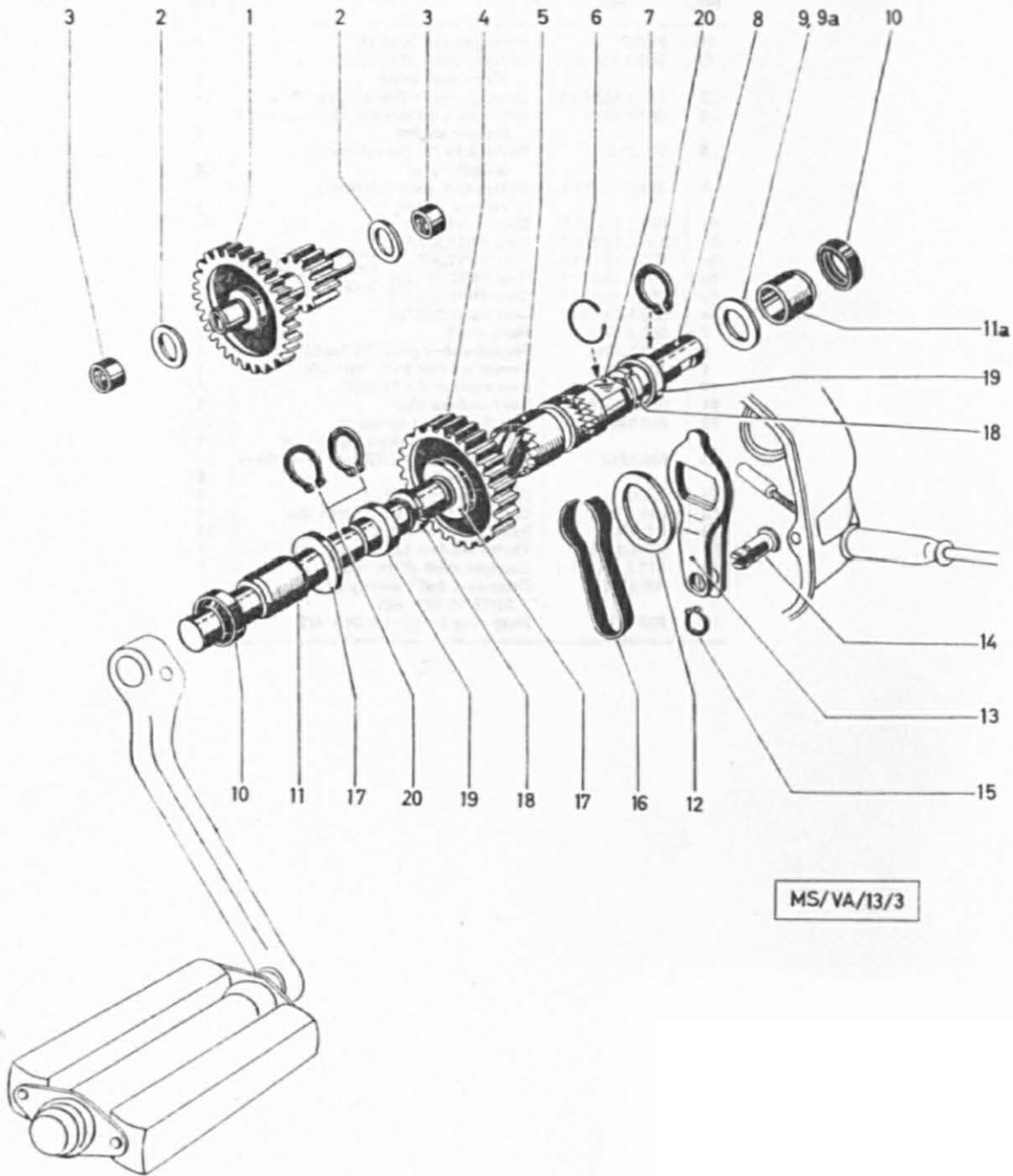

MS/VA/13/3

STARTER MECHANISM

7

Ref. No.	Part No.	Description	Requd. No.
1	350.2.13.030.2	Starter intermediate shaft (33 and 15 teeth)	1
2	050.1329	Thrust washer 20,5/14/1,9	2
2	050.1329.2	Thrust washer 20,5/14/2	2
2	050.1329.3	Thrust washer 20,5/14/2,1	2
2	050.1329.4	Thrust washer 20,5/14/2,4	2
3	050.1333	Bearing bushing 19/14/9,5	2
4	364.1.13.031.1	Starter gear (31/20 teeth)	1
5	050.4.1327	Driver (20 teeth)	1
6	900.3221	Spring ring 2 mm dia. x 30 mm dia. for claw collar	1
7	050.4.1337	Claw collar (20 teeth)	1
8	350.3.13.032.1	Pedal shaft	1
9	050.4.1353	Thrust washer 26/16,2/1	1
9a	900.3922	Spacer shim 24/17,1/0,1	as required
	900.3923	Spacer shim 24/17,1/0,2	
	900.3924	Spacer shim 24/17,1/0,5	
10	050.1335	Rubber seal ring BACOF 24/16/7	2
11	050.1342	Bearing bushing 20/16/20	1
11a	350.3.13.054.1	Bearing bushing 20/16/17	1
12	900.3987	Washer 38/27/2,5	1
13	350.2.13.038.2	Brake lever	1
14	350.2.13.047.1	Clevis bolt	1
15	900.4610	Snap ring Sg 10x1 DIN 471	1
16	050.1.1334	Brake spring for driver	—
—	050.1.1336	Retaining bolt, pressed into housing as required	—
—	24795	Washer 6,4 DIN 125 for retaining bolt as required	—
17	050.1343	Thrust washer 26/16/2	2
18	350.3.13.051.1	Spring ring	2
19	350.3.13.052.1	Catching ring	2
20	900.4616	Snap ring Sg 16x1 DIN 471	3

8 PEDALS

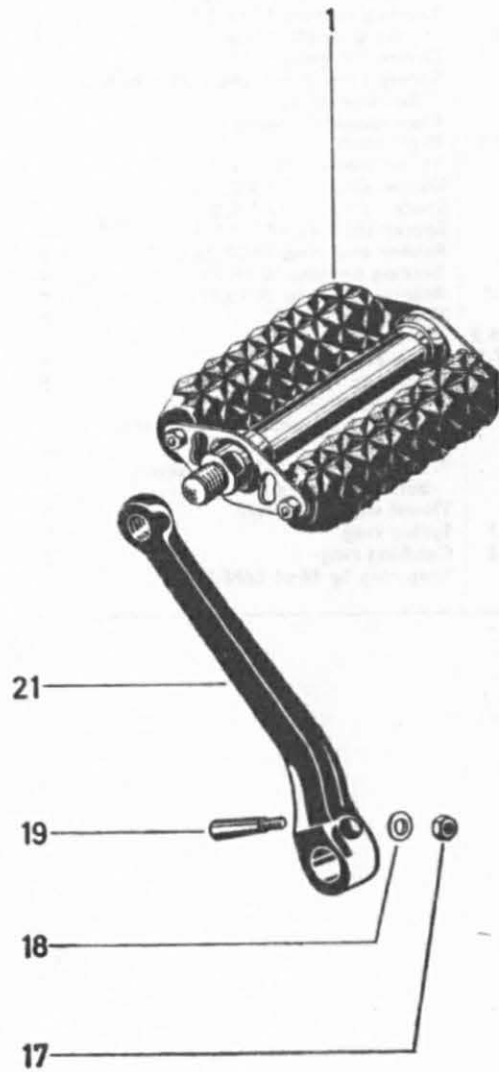

MS/ST/13/8/3

PEDALS

8

Ref. No.	Part No.	Description	Requd. No.
—	600.1.18.016.0	Pedal compl. (chrome, with black rubber)	per pair
1	600.2.18.016.0	Left pedal compl.	1
—	600.3.18.016.0	Right pedal compl.	1
17	900.2909	Hexagon nut 1/4"	2
18	900.3926	Washer for crank 14/6,5/2	2
19	605.1313	Cotter for crank	2
—	050.1341	Crank, left	1
21	050.1340	Crank, right	1

9 GEARSHIFT

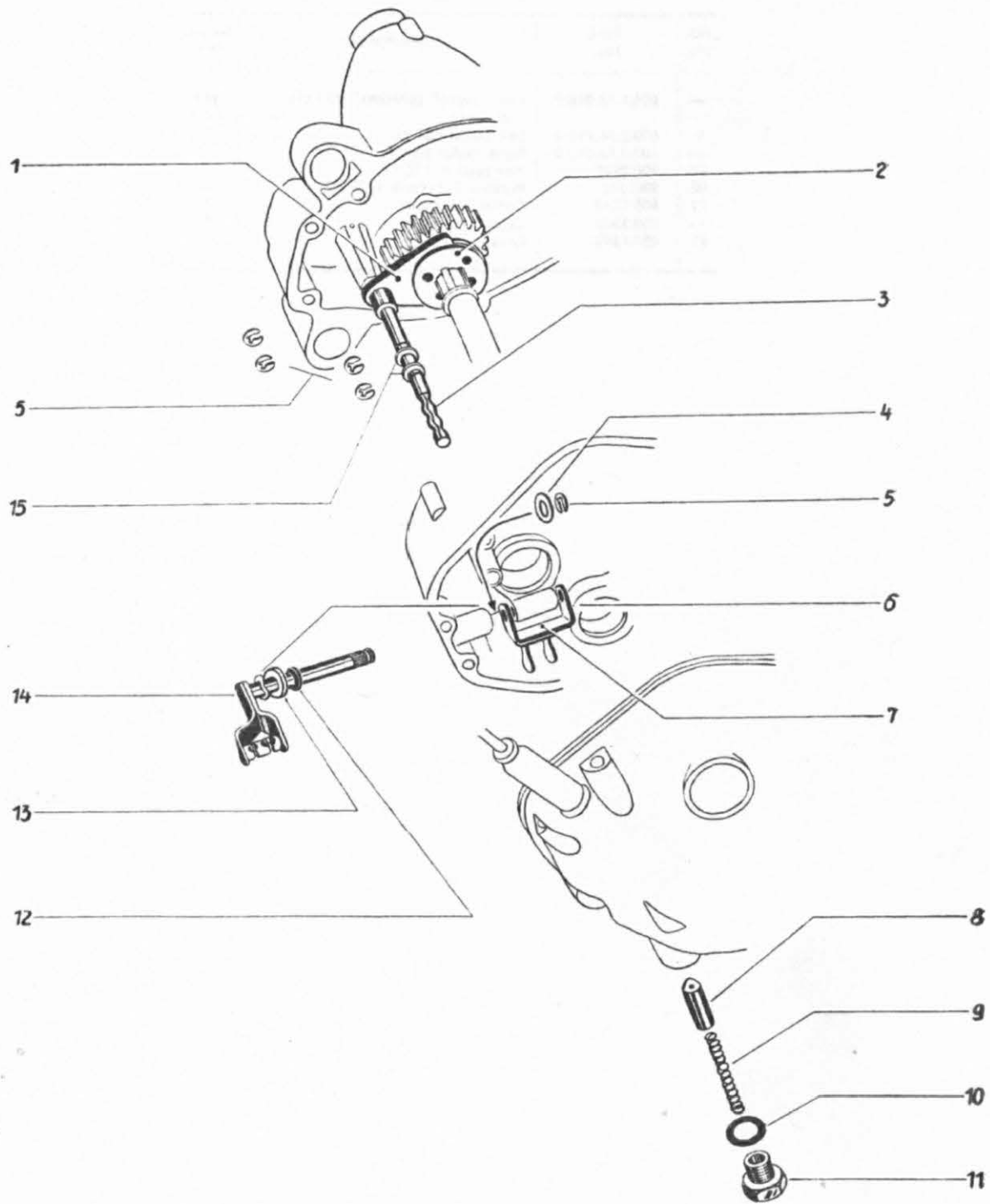

Ref. No.	Part No.	Description	Requd. No.
1	050.1.1425.2	Gearshift fork	1
2	050.1.1410	Gearshift socket	1
3	050.1.1424	Gearshift rail	1
4	900.3949	Washer 15/8,5/0,75 for gearshift shaft	1
5	900.4606	Circlip 6 DIN 6799	6
6	050.1.1426	Spring washer	1
7	050.2.1403.2	Interior gearshift lever	1
8	050.1.1421	Catch	1
9	100.1423	Catch spring	1
10	900.4212	Fibre seal washer 18/12/1	1
11	050.1.1422	Catch guide screw	1
12	050.1.1406	Rubber seal washer 12/8 mm dia.	1
13	255.2423	Washer 17/8,3/3 for gearshift shaft	1
14	050.2.1402.2	Gearshift shaft	1
15	050.1.1416	Supporting disc 12/7,2/2	2

10 CARBURETTOR

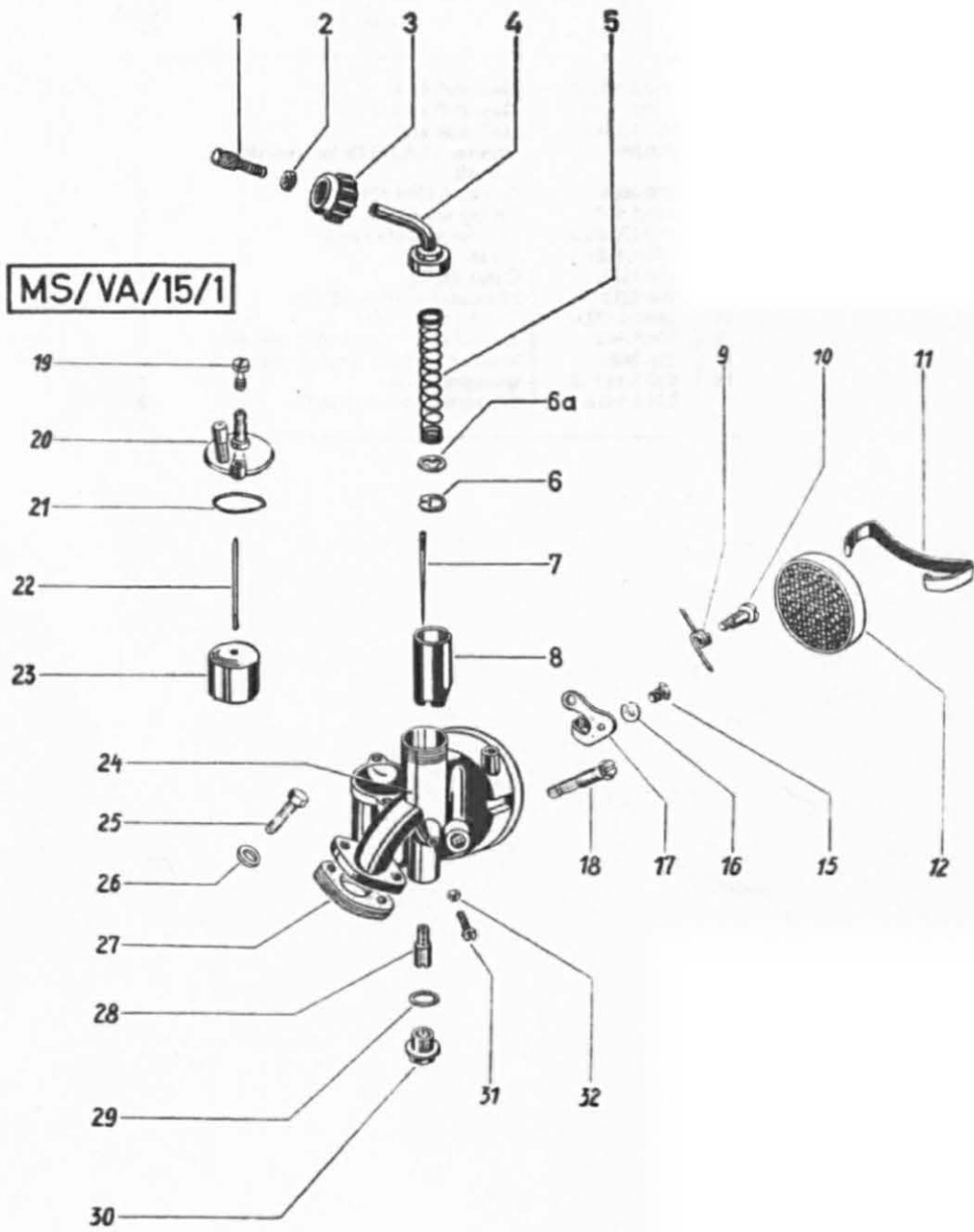

Ref. No.	Part No.	Description	Requd. No.
—	364.1.15.001.0/62	Carburettor compl., without air filter (Bing 12 mm dia., jet No. .)*	1
1	050.1520	Bowden cable adjusting screw (M 5)	1
2	900.2115	Flat hexagon nut BM 5 DIN 439 (identical with 050.1517)	1
3	050.1519	Screw cover	1
4	050.1518	Head with tube bend	1
5	050.1531	Thrust spring for throttle slide	1
6	050.1513	Clamp spring	1
6a	350.1.15.014.1	Disc 11 mm dia., 0,5 strong for clamp spring	1
7	050.1516**	Jet needle	1
8	050.1515**	Throttle slide	1
9	050.1555	Torsion spring	1
10	050.1552	Shoulder screw	1
11	050.1529	Spring clip for air filter	1
12	050.1540.2	Air filter	1
15	350.4.15.056.1	Nipple	1
16	050.1559	Locking plate	1
17	050.1553	Choke	1
18	050.1509/62	Main jet No. 62	1
18	050.1509/..*	Main jet No. ..* if required	—
19	050.1535	Cap screw	2
20	364.1.15.032.2**	Float chamber cover with tickler	1
21	050.1536	Float chamber cover gasket	1
22	050.1530	Float needle	1
23	050.1525	Float	1
24	050.10.1501	Carburettor body	1
25	900.1107	Hexagon head screw M 6x25 DIN 933	2
26	24804	Washer 6,4 DIN 433	2
27	050.1521	Carburettor flange gasket	1
28	050.1508**	Needle jet	1
29	27071	Seal washer A 10x14 DIN 7603	1
30	050.1523	Screw plug	1
31	050.1511	Throttle slide stop screw	1
32	24771	Hexagon nut M 4 DIN 934	1

* Please state jet number.

** Please give stamped-on number.

11 FUEL TANK, EXHAUST

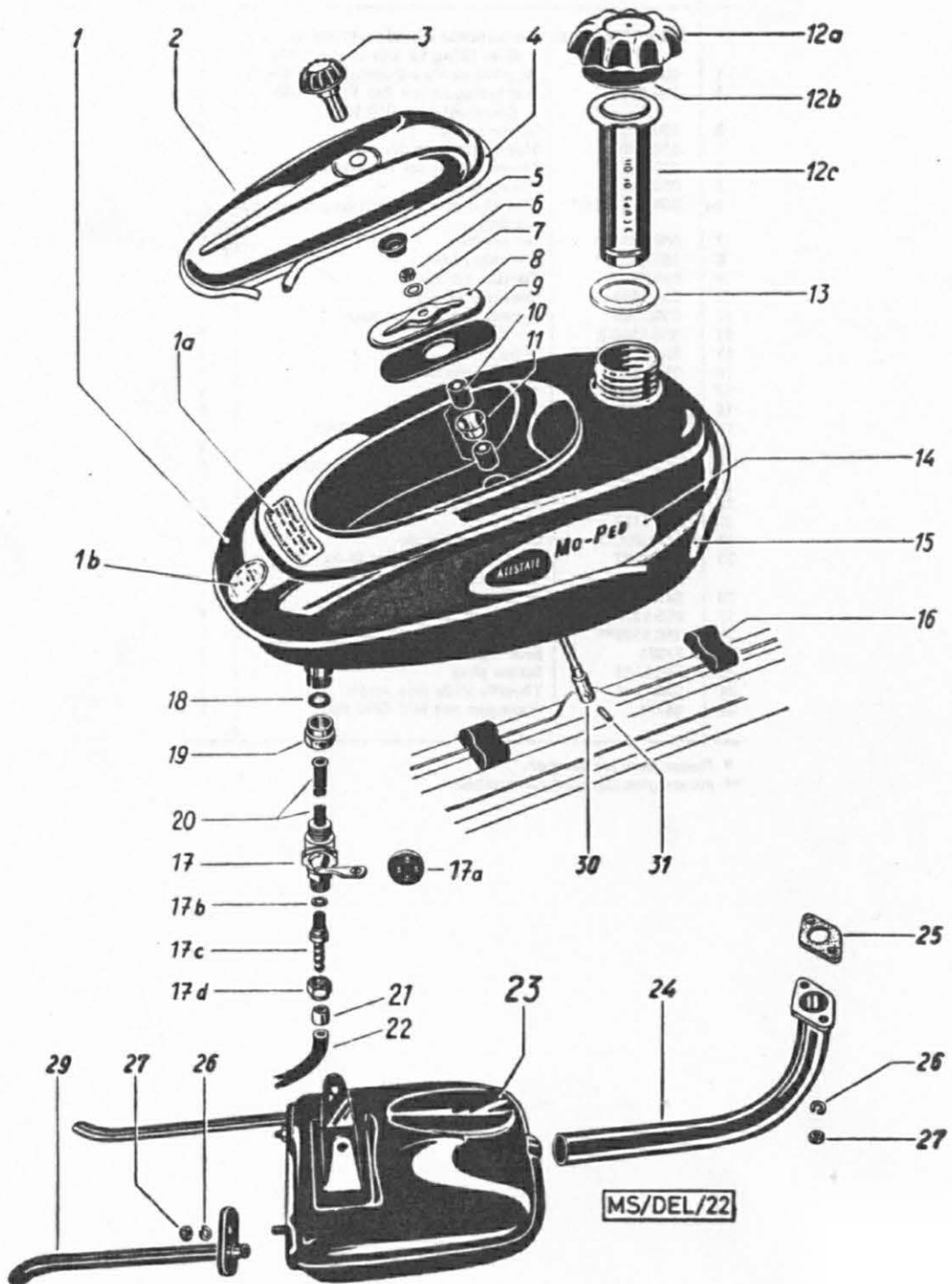

FUEL TANK, EXHAUST

11

Ref. No.	Part No.	Description	Requd. No.
1	050.10.2200.2/10	Fuel tank (separate) (identical with 302.7.22.000.2/80)	1
1a	302.1.22.010.1	Transfer picture-ratio of mixture	1
1b	050.1.2250	Transfer picture	1
2	050.10.2216/23	Tool box lid chrome	1
3	050.10.2210.2	Lock nut	1
4	050.2217	Bordering for toolbox lid (endless)	1
5	050.10.2224	Fixing ring (plastic)	1
6	900.2106	Hexagon nut M 6 DIN 555	1
7	24804	Washer 6,4 DIN 433	1
8	050.10.2231	Thrust plate	1
9	050.1.2233	Rubber base	1
10	050.10.2206	Rubber intermediate ring 11/6,5/12	2
11	050.10.2204	Rubber carrier	1
12a	302.1.22.020.1/10	Filler cap	1
12b	050.1.2248	Seal ring 42,5/18/1	1
12c	050.6.2245.0	Oil filler	1
13	350.2.22.023.1	Gasket (rubber 42,5/30/3)	1
14	302.1.22.026.0	Transfer picture left:right	per pair
15	050.2.2225	Bordering for fuel tank (endless)	1
16	050.2.2214	Rubber base	2
17	050.4.2230.0	Fuel cock complete	1
17a	101.2.2235	Cork packing 17 mm dia. /1,5	1
17b	101.2.2234	Seal washer 10,7/8/1	1
17c	050.4.2228.2	Lower fuel filter for	1
17d	101.2.2210	Union nut fuel cock	1
18	050.2.2237	Seal washer 14/7/1	1
19	27634	Union nut M 16x1	1
20	050.2.2238.2	Fuel filter	1
21	24456	Fuel hose sleeve	2
22	25597.1	Fuel hose 9/5 mm dia., (150 mm long) p. m.	—
23	050.3.1600.0	Exhaust silencer complete (with end pipes)	1
24	050.1.1620.2	Exhaust pipe	1
25	050.1615	Exhaust flange gasket	1
26	26834	Spring ring B 6 DIN 127	4
27	24773	Hexagon nut M 6 DIN 934	4
29	050.3.1605.2	End pipe	2
30	050.10.2207.2	Tension bolt (M 6), 120 mm long	1
31	050.2208	Hinge bolt 5/3/13,5	1

ALLSTATE LIGHT WEIGHT MOTOR CYCLE —

12

FRAME, MUDGUARDS (FENDERS)

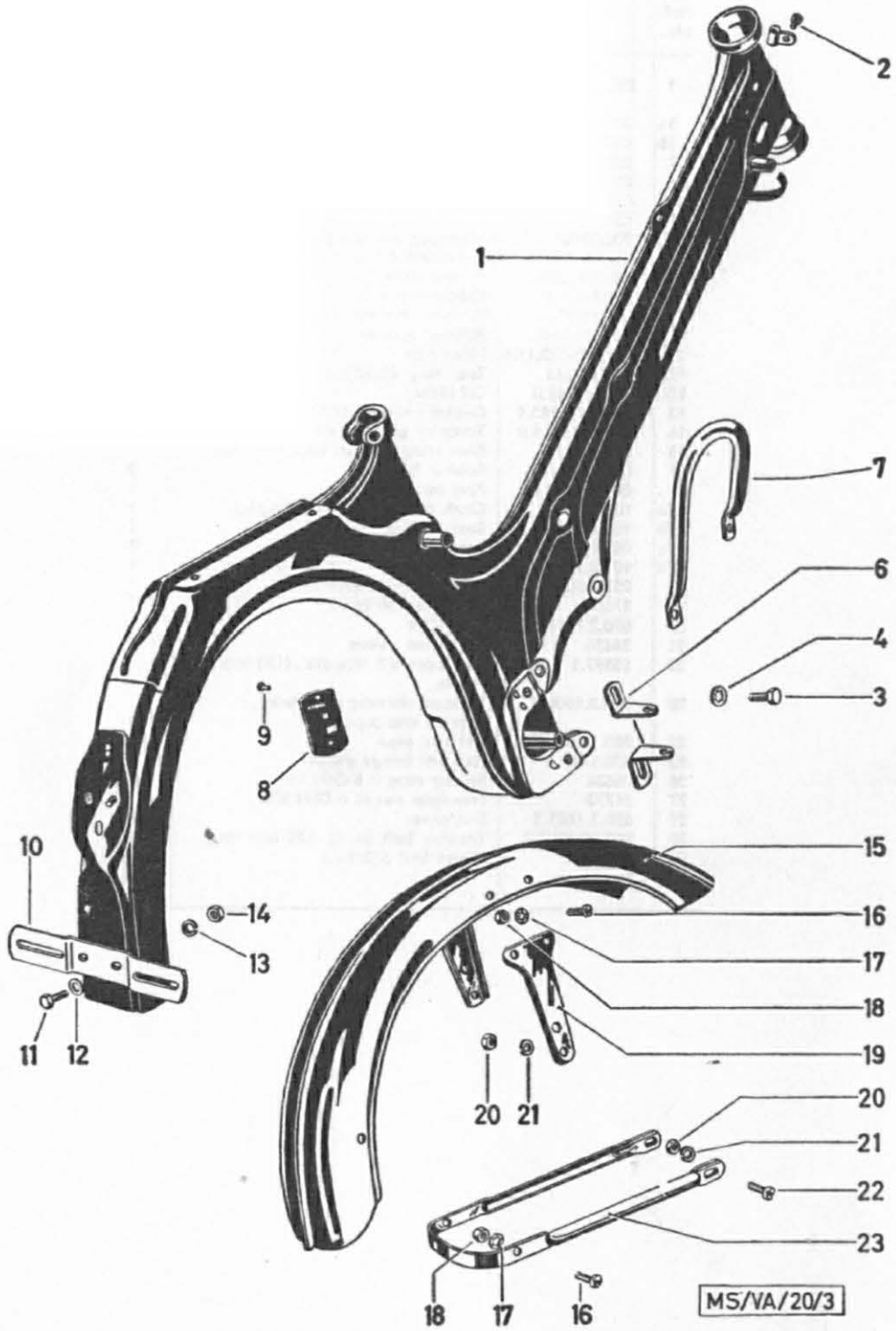

FRAME, MUDGUARDS (FENDERS)

12

Ref. No.	Part No.	Description	Requd. No.
1	302.4.20.000.0/72	Frame compl. (without tension bolt, but with steering bearing seat)	1
2	23020	Fillister head screw AM 5x6 DIN 84	1
3	25399	Hexagon head screw M 6x10 DIN 933	2
4	900.3456	Securing washer JZC 6	2
6	050.1429	Setting angle	2
7	050.2050.2	Carrying handle	1
8	302.8.20.033.1	Nomenclature plate (Model number 810.94040)	1
9	900.4027	Rivet 2,6x5 DIN 660	2
10	170.2733	License plate bracket	1
11	25399	Hexagon head screw M 6x10 DIN 933	4
12	28909	Washer 14/6,4/1	2
13	26834	Spring ring B 6 DIN 127	4
14	900.2106	Hexagon nut M 6 DIN 555	4
15	050.2.2700.0/72	Front mudguard (fender) compl. (w. stays)	1
15	050.2.2700.2/72	Front mudguard (fender) (separate)	1
16	1426	Fillister head screw AM 5x8 DIN 84	6
17	900.3401	Securing washer JAC 5,3	6
18	900.2105	Hexagon nut M 5 DIN 555	6
19	050.2.2702/72	Mudguard holder	2
20	24773	Hexagon nut M 6 DIN 934	6
21	26834	Spring ring B 6 DIN 127	6
22	900.1321	Fillister head screw AM 6x12 DIN 84	2
23	050.2.2712.2/72	Mudguard (fender) stay	1

13 SADDLE, LUGGAGE CARRIER

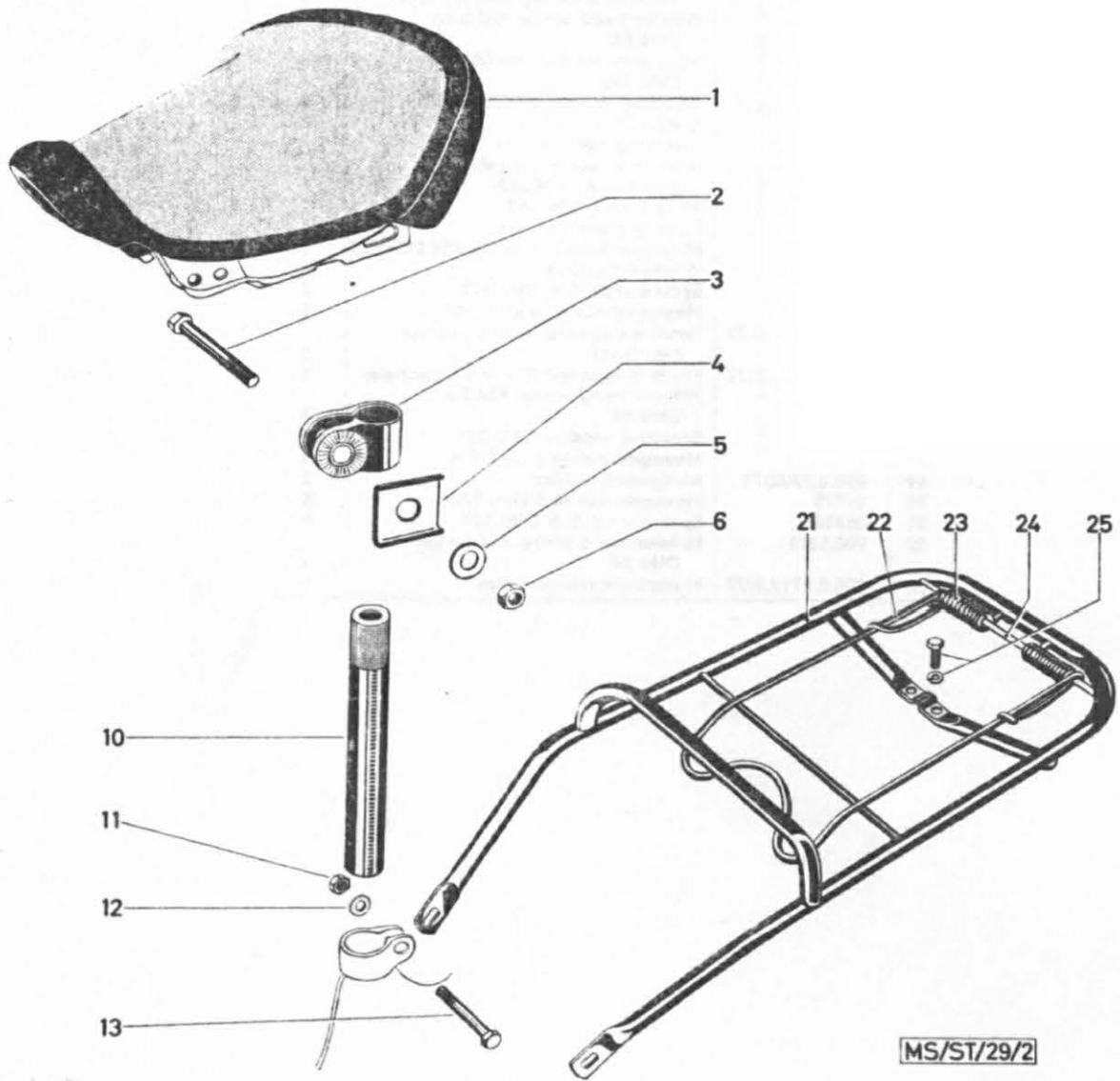

SADDLE, LUGGAGE CARRIER



Ref. No.	Part No.	Description	Requd. No.
—	350.4.23.000.0	Saddle complete	1
1	350.4.23.010.1	Saddle cover	1
2	22849	Hexagon head screw M10x55 DIN 931	1
3	050.2303	Clamp dog	1
4	350.4.23.004.1	Guide rail	2
5	900.3943	Washer 24/10,5/2	2
6	24776	Hexagon nut M 10 DIN 934	1
10	050.2301	Saddle bracket	1
11	24775	Hexagon nut M 8 DIN 934	1
12	24806	Washer 8,4 DIN 433	1
13	22856.1	Hexagon head screw M 8x45 DIN 931—8 G	1
21	51.1.2920.0	Luggage Carrier compl. with spring clip chrome	1
22	51.1.2927	Spring clip	1
23	51.1.2925	Torsion spring, left	1
	51.1.2926	Torsion spring, right	1
24	51.1.2924	Spring cross bar 6 mm dia., 180 long	1
	24927	Hexagon head screw M 6x12 DIN 933	2
25	26834	Spring ring B 6 DIN 127	2

14

PIVOTED FORK, PROP STAND

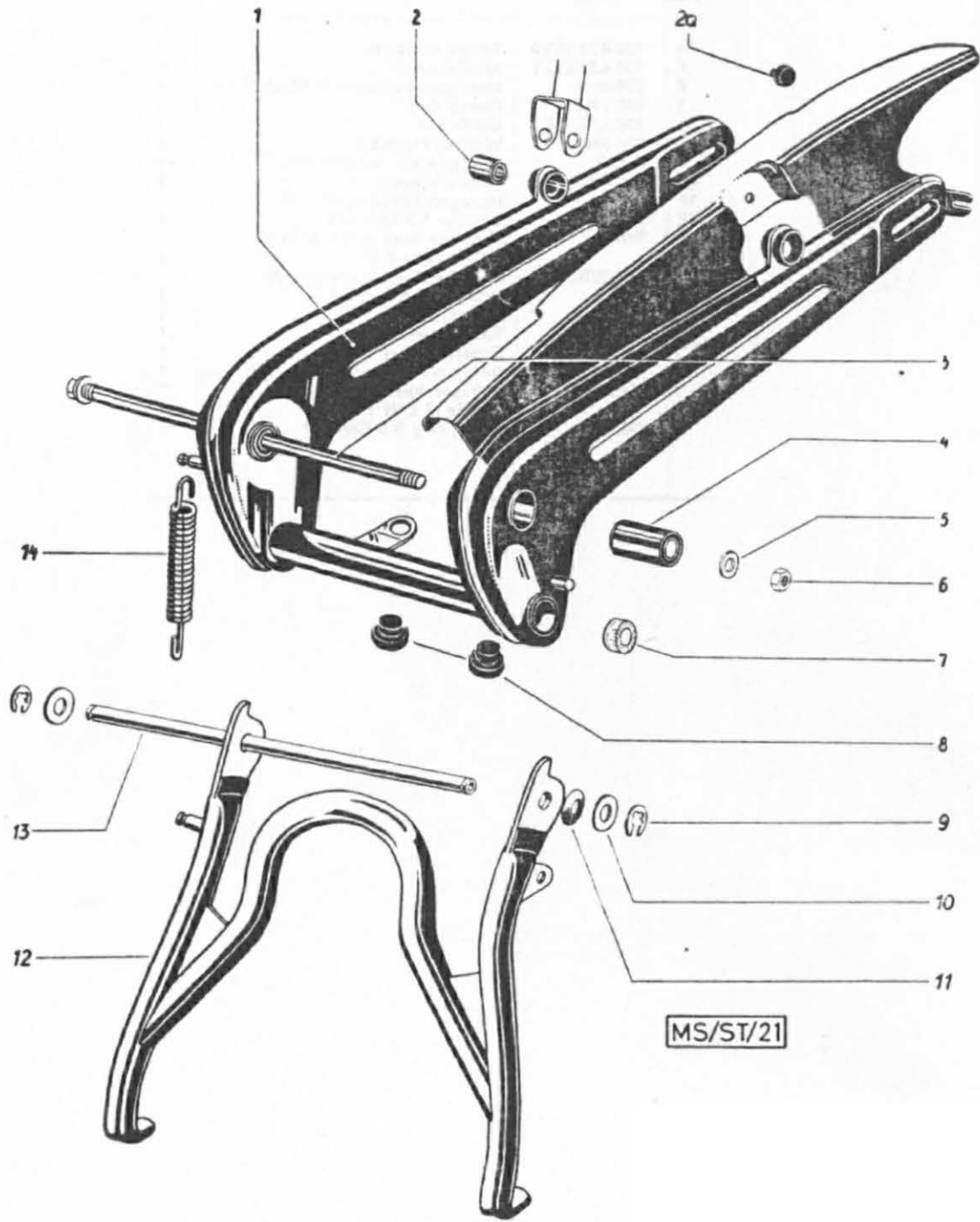

PIVOTED FORK, PROP STAND

14

Ref. No.	Part No.	Description	Requd. No.
1	050.5.2100.0/72	Pivoted fork compl. (with pressed-in silent blocs)	1
2	128.2315	Silent bloc (for shock absorber) 16/8/17	2
2a	050.1.2122	Rubber base for chain guard	1
3	050.2.2110.2	Pivoted fork spindle (M 10x1)	1
4	050.2111.2	Silent bloc (for pivoted fork bearing) 22/10/33	2
5	24807	Washer 10,5 DIN 433	1
6	24789	Hexagon nut M 10x1 DIN 934	1
7	050.2114	Prop stand bearing bushing 18,3/10,2/10	2
8	050.1.2123	Rubber buffer for prop stand stop	2
9	900.4609	Circlip 9 DIN 6799	2
10	14778	Washer 21/10,5/1	2
11	100.1.1235	Spring washer	1
12	050.4.2400.2/72	Center prop stand	1
13	050.1.2413	Prop stand bearing axle 10 mm dia., 195 long	1
14	050.1.2410	Prop stand spring	1

15

SHOCK ABSORBER

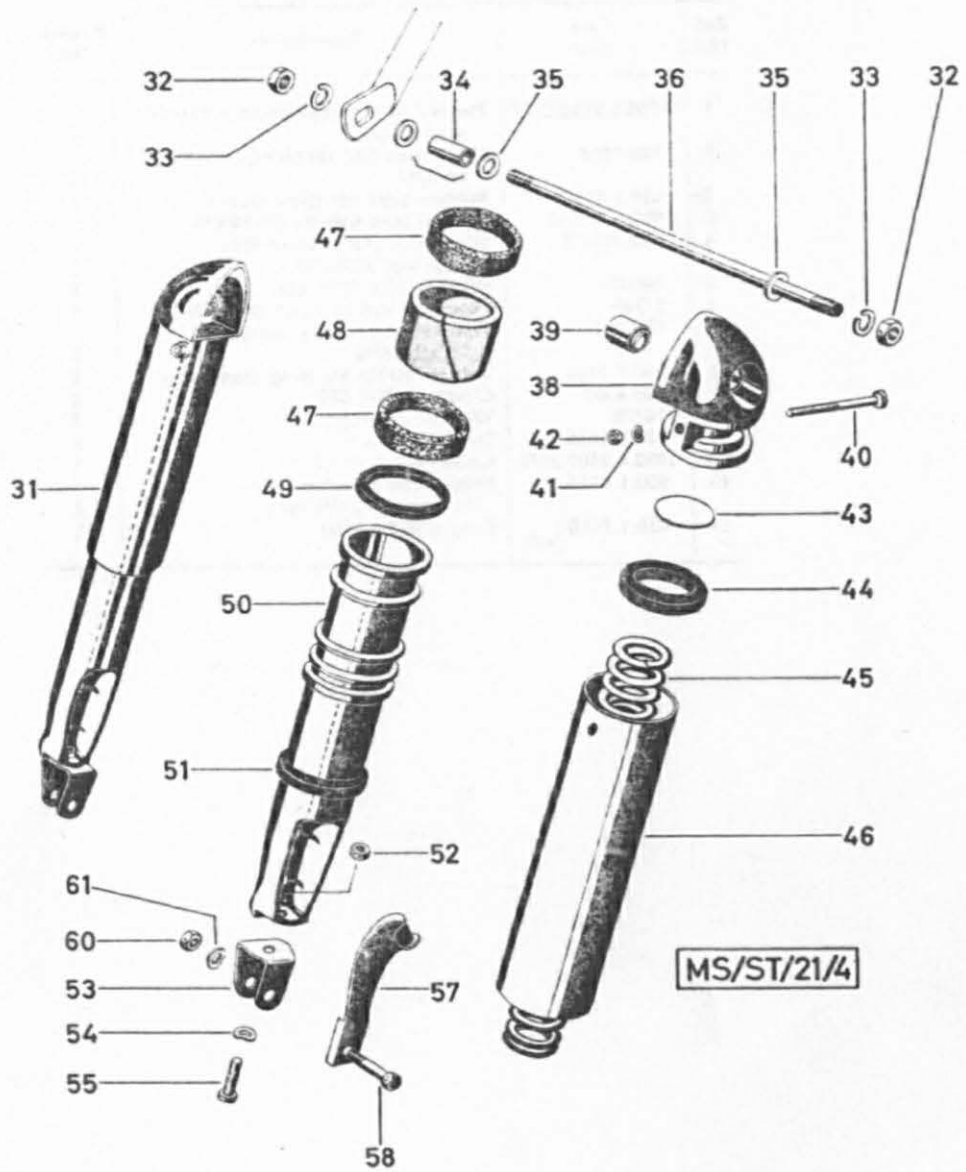

SHOCK ABSORBER

15

Ref. No.	Part No.	Description	Requd. No.
31	050.5.2129.0	Shock absorber left, complete (with the parts 38—55)	1
31	050.5.2130.0	Shock absorber right, complete (with the parts 38—55)	1
32	24775	Hexagon nut M 8 DIN 934	2
33	26819	Spring ring B 8 DIN 127	2
34	350.1.21.014.1	Spacer 11/8/15	2
35	27780	Washer 13/8,4/2	4
36	350.1.21.013.1	Bolt (M8, 214 long)	1
38	364.1.21.032.1	Strut head	2
39	128.2315	Silent bloc 16 mm dia., 17 long	2
40	900.1522	Lens head screw M 5x50 DIN 85	2
41	900.3205	Spring washer A 5 DIN 137	2
42	24772	Hexagon nut M 5 DIN 934	2
43	050.5.2136	Closure washer 27 mm dia.	2
44	050.5.2133	Buffer ring (rubber 43/29,5/8)	2
45	050.5.2134	Thrust spring, 200 long, size of wire 5 mm dia.	2
46	050.5.2131	Sliding tube (45 mm dia., 145 long)	2
47	050.5.2141	Guide bushing (plastic 43/37,5/9)	4
48	050.5.2139	Grease felt 126,5x27x3	2
49	050.5.2143	Felt washer, 112 long	2
50	050.5.2140	Lower sliding tube	2
51	050.5.2138	Stop ring 41/34/6	2
52	24773	Hexagon nut M 6 DIN 934	2
53	050.5.2137	Supporting bracket	2
54	900.3213	Spring washer B 6 DIN 137	2
or	22804	Toothed Lock washer J 6,4 DIN 6797	2
55	900.1309	Fillister head screw M 6x15 DIN 84	2
or	24928	Hexagon head screw M 6x15 DIN 933	2
57	350.1.25.017.1	Holder for brake control cable	1
58	900.1121	Hexagon head screw M 8x30 DIN 933	2
60	900.2016	Hexagon nut M 8 DIN 934	2
61	900.3211	Spring washer B 8 DIN 137	2

16

ALLSTATE LIGHT WEIGHT MOTOR CYCLE - FRONT FORK AND STEERING

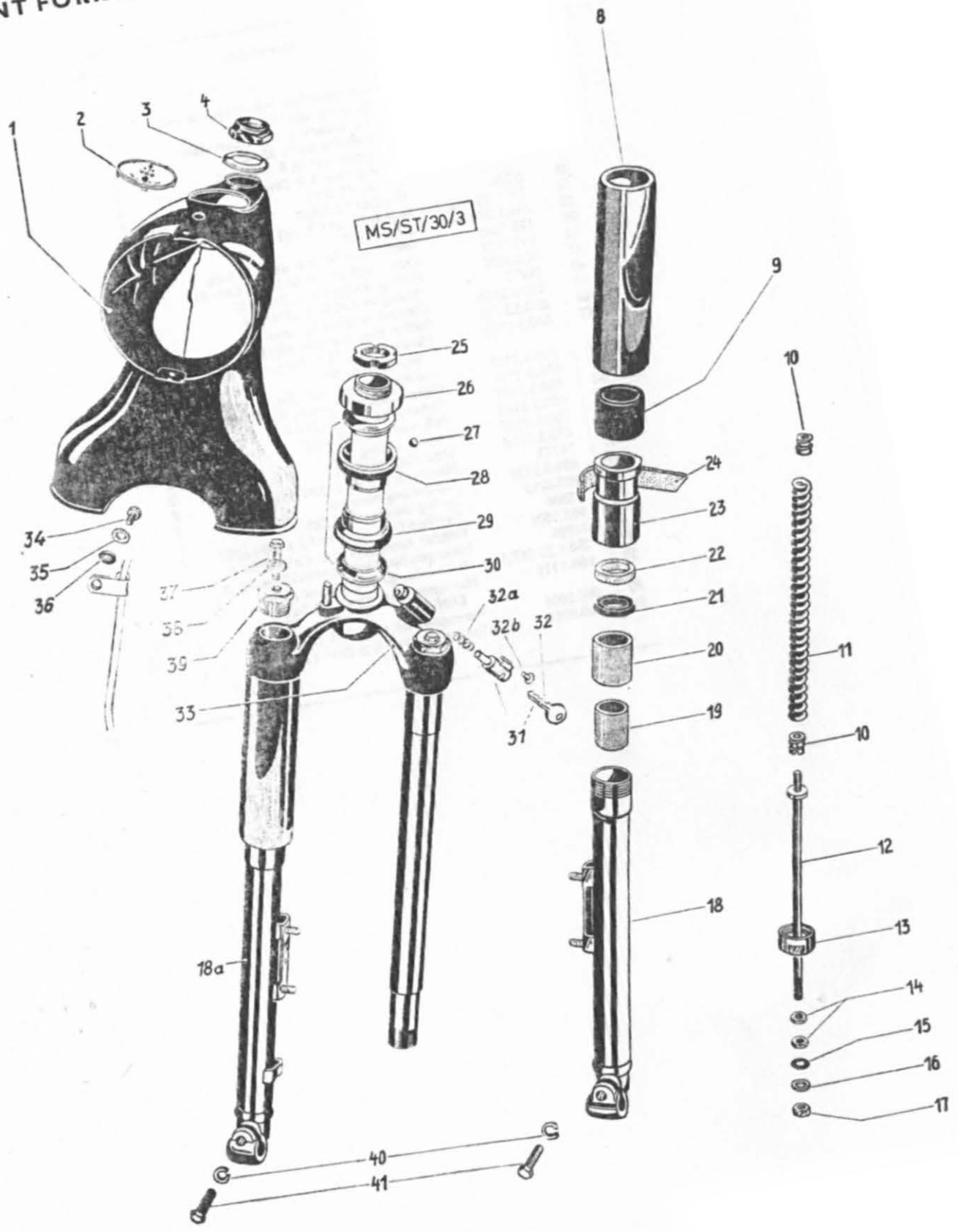

FRONT FORK AND STEERING

16

Ref. No.	Part No.	Description	Requd. No.
—	350.3.30.000.0/72	Front fork complete	1
1	050.3.3043.2/10	Headlamp bracket	1
2	050.3045	Cover for speedometer opening (only for special order)	1
3	050.3033	Connecting washer	1
4	3759	Fork tube nut	1
8	050.3037	Exterior fork tube	2
9	050.3036	Rubber buffer 35,5/24,5/32	2
10	050.3035	Threaded coupling	4
11	350.1.30.034.1	Thrust spring (14 mm dia., 235 mm long)	2
12	350.1.30.030.2	Spring bolt, 156 mm long	2
13	050.3010	Bottom joint of fork stanchion	2
14	24417	Flat hexagon nut AM 6 DIN 439	4
15	900.3883	Rubber seal RS 9/6/1,5	2
16	24795	Washer 6,4 DIN 125	2
17	900.2106	Hexagon nut M 6 DIN 555	2
18	050.2.3015.2/72	Sliding tube left 240 mm long	1
18a	050.2.3016.2/72	Sliding tube right 240 mm long	1
19	050.3009	Bottom guide bushing 25,7/20,5/26	2
20	050.3026	Top guide bushing 27,6/22/26	2
21	050.3029	Seal for annular grooves 30/20,5/5	2
22	050.3049	Felt washer 29/22/6	2
23	050.3027	Grooved shell	2
24	050.3039	Felt strip 14x3,2, 105 mm long	2
25	250.3104	Slotted circular nut	1
26	25222	Dust cap	1
27	25226	Ball 5 mm dia.	42
28	25221	Top steering bearing seat	1
29	25225	Bottom steering bearing seat	1
30	25220	Steering cone	2
31	330.1.20.052.0	Lock (with 2 Keys) (Neiman Nr. 2)	1
32	350.2.30.023.1	Spare key (please, quote key number!)	—
32a	330.1.20.059.1	Thrust spring	1
32b	330.1.20.060.1	Al-Notched rivet	1
33	350.3.30.006.2/72	Fork lug	1
34	900.1513	Lens head screw M 5x10 DIN 85	2
35	900.3455	Securing washer JZC 5	2
36	21526	Seal washer 9/5, 3/1	1
37	22872	Hexagon head screw M 6x30 DIN 931	2
38	24795	Washer 6,4 DIN 125	2
39	050.3012	Screw plug	2
40	29189	Spring ring B 7 DIN 127	2
41	900.1128	Hexagon head screw M 7x20 DIN 933	2

17

HANDLEBAR, GEARSHIFT AND THROTTLE TWIST GRIPS

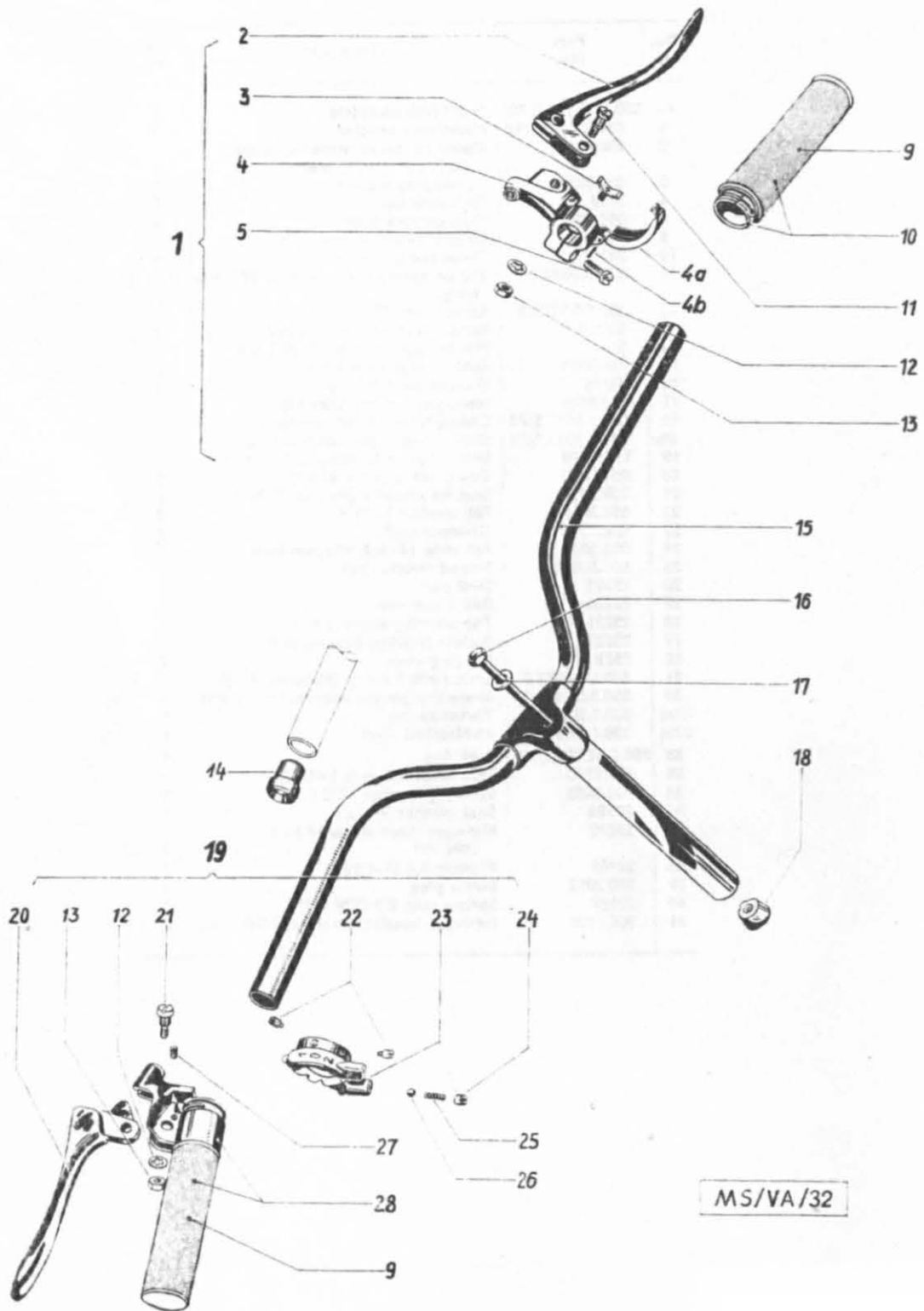

MS/VA/32

HANDLEBAR, GEARSHIFT AND THROTTLE TWIST GRIPS



Ref. No.	Part No.	Description	Requd. No.
1	050.3205.0	Throttle twist grip compl.	1
2	050.2.3228	Brake lever	1
3	050.3225.2	Brake spring with screw	1
4	050.3221.0	Twist grip housing compl. (with brake spring and lens head screw)	1
4a	050.3223	Cover	1
4b	900.4805	Notched dowel pin 1,5x12 DIN 1472	1
5	050.3222	Lens head screw (M 6x15)	1
9	050.3216	Twist grip cover	2
10	050.3226.0	Throttle twist grip tube complete (with rubber)	1
11	050.3227	Lever bolt (M 5)	2
12	22803	Toothed lock washer J 5,3 DIN 6797 (for part Nos. 11 and 21)	2
13	24772	Hexagon nut M 5 DIN 934	2
14	364.1.32.021.1	Centering plug (as required)	2
15	050.8.3200.2	Handlebar	1
16	050.1.3251	Clamping spindle, 200 long-8 G	1
17	186	Washer 20/8,4/3,5	1
18	3247	Clamp wedge	1
19	050.3204.0	Gearshift twist grip compl. (2-speed circular pull)	1
20	050.3217	Clutch control lever	1
21	050.3214	Lever bolt (M 5)	1
22	050.3211	Threaded pin (M 6x7)	2
23	050.3210.0	Gearshift twist grip housing compl. (with ball, spring, screw)	1
24	050.3213	Threaded pin (M 6x5)	1
25	050.3212	Thrust spring	1
26	22754	Ball 3/16"	1
27	900.1950	Threaded pin M 4x4 DIN 551	1
28	050.3215.0	Gearshift twist grip tube compl. (with rubber and threaded pin)	1

18

BOWDEN CABLES

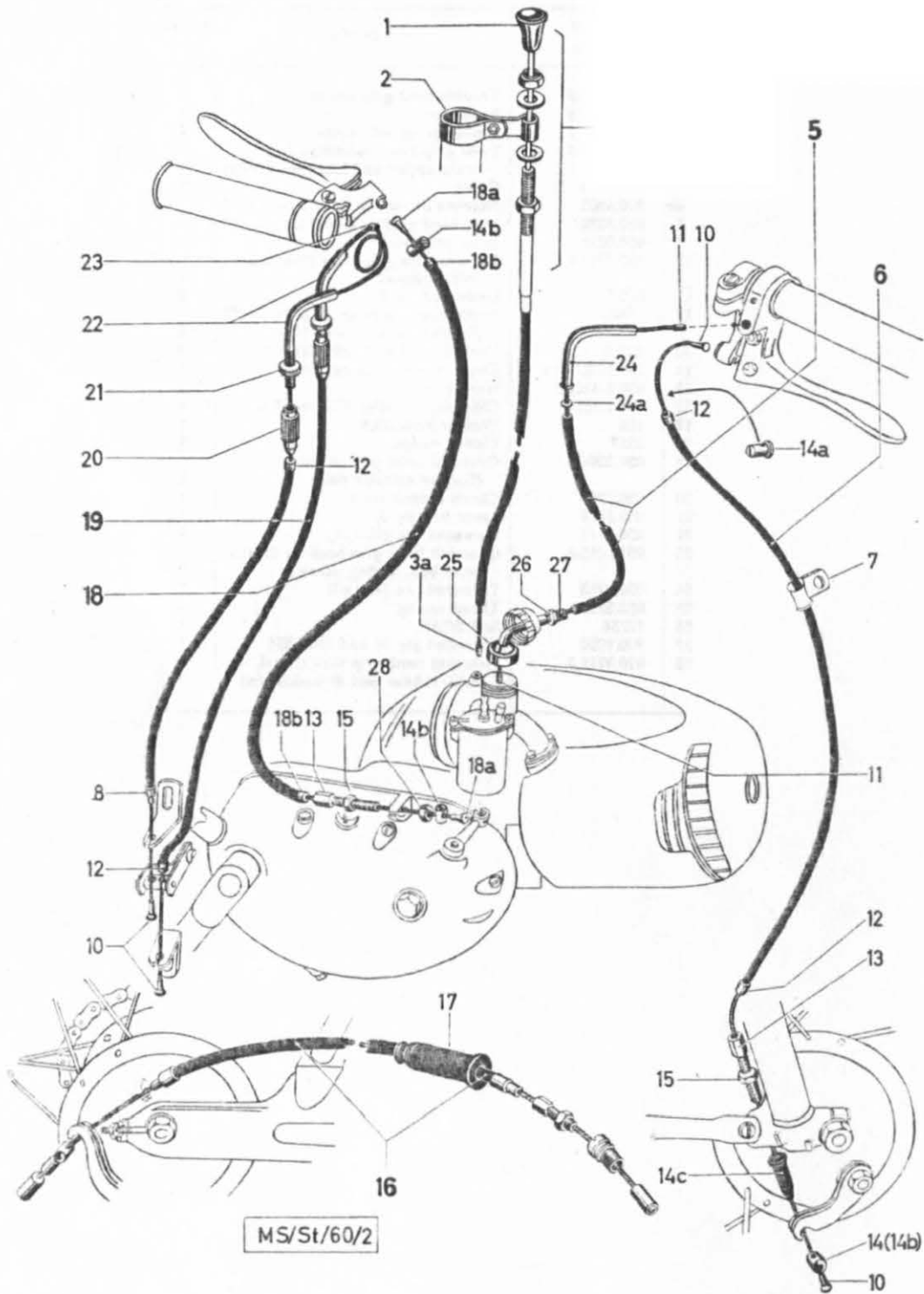

Ref. No.	Part No.	Description	Requd. No.
1	050.3.6503.2	Pull knob with wire	1
2	050.6504.0	Shackle compl. for choke control cable	1
3	350.4.65.003.0	Control cable compl. for choke	1
3a	050.2.6506	Soldering nipple 3/1,2 mm dia.	1
5	050.6500.2	Carburettor control cable compl. (wire 937 mm, covering 780 mm)	1
6	050.6300.2	Brake control cable compl. for front wheel (wire 955 mm, covering 815 mm)	1
7	128.6305	Shackle for brake control cable	1
8	050.1.1428	Supporting shell	1
10	050.1419	Soldering nipple	4
11	050.6505	Soldering nipple compl.	2
12	050.2.6203	Shell	7
13	250.6010	Adjusting screw	2
14	24384	Nipple holder	3
14a	050.1.3208	Nipple holder for brake lever	1
	050.2.3228		2
14b	250.6208	Nipple holder, slotted	2
14c	050.1.6209	Cable socket	as requd.
15	24774	Hexagon nut M 7 DIN 934	3
16	050.5.2500.2*	Brake control cable compl. for rear wheel (wire 571 mm, covering 380 mm)	1
17	250.6103	Cable socket	1
18	360.3.62.000.0	Clutch control cable compl. (wire 1160 mm, covering 1060 mm)	1
18a	360.1.62.015.1	Soldering nipple	2
18b	25483	Shell	2
19	050.6600.2	Gearshift control cable compl. (wire 2510 mm, covers 1080 and 1055 mm)	1
20	050.3220	Adjusting nut	2
21	050.3219	Knurled thumb nut	2
22	050.3218	Deflection tube for gearshift control cable	2
23	050.6605.0	Catch nipple	1
24	050.3229	Deflection tube for carburettor control cable	1
24a	900.3102	Washer 2,2 DIN 433 (as required)	—
25	050.1518	Head with tube bend, as required	—
26	900.2115	Flat hexagon nut BM 5 DIN 439 (identical with 050.1517)	1
27	050.1520	Bowden cable adjusting screw	—
28	250.6007	Hexagon nut M 7, slotted	1
—	26646	Wire 1,6 mm dia.	per meter
—	050.6501.1	Covering 4,9/2,2 mm dia. } as required	
—	26647	Wire 2 mm dia.	per meter
—	26645	Covering 5,5/3 mm dia. } as required, only for clutch control cable	

* Only the complete brake control cable is obtainable.

19

FRONT WHEEL

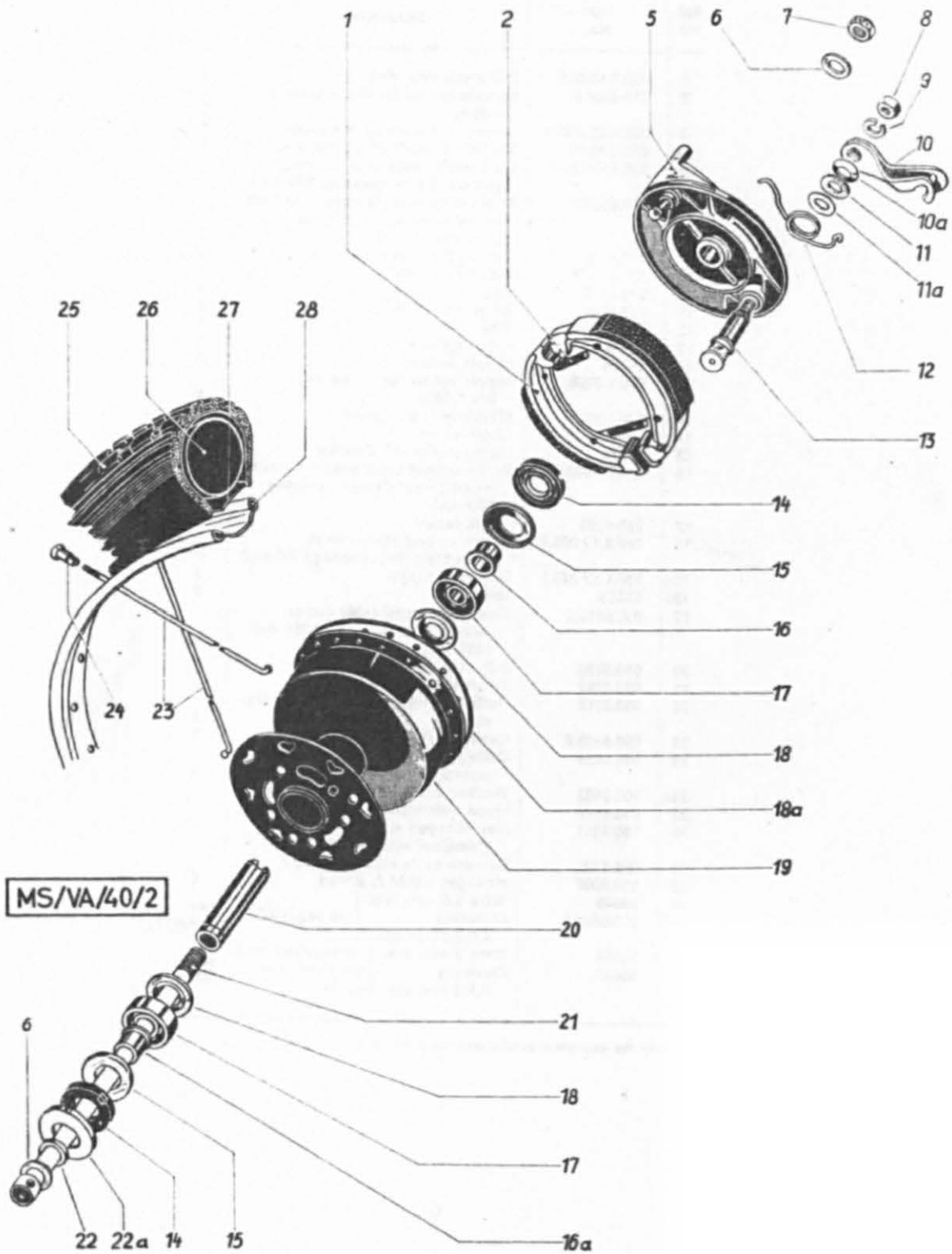

Ref. No.	Part No.	Description	Requd. No.
—	350.4.40.000.0/23	Front wheel compl. (without tire) with chrome rim	1
—	350.4.40.002.0	Front wheel hub compl. (with interior parts)	1
1	050.4015.0	Pair of brake shoes with glued lining	1
2	050.4019	Brake shoe spring	2
5	350.4.40.007.1	Brake cover plate	1
6	050.1.4029	Washer 18/10,5/2,5	2
7	900.2011	Hexagon nut M 10x1 DIN 934—8 G	1
8	26820	Hexagon nut M 8x1 DIN 934	1
9	26819	Spring ring B 8 DIN 127	1
10	350.4.40.013.2	Brake lever	1
10a	900.3219	Curved washer 12,5 mm dia.	1
11	128.2504	Rubber washer 20/12/3	1
11a	900.3938	Washer 18/12,3/1	2
12	050.2.4115	Restoring spring	1
13	350.4.40.009.2	Brake cam	1
14	050.2.4025	Packing ring 30/16/5	2
15	050.1.4021	Cover 30/16 mm dia.	2
16	050.1.4024	Intermediate ring, 9 mm high (right)	1
16a	050.2.4034	Intermediate ring, 17,5 high (left)	1
17	900.6200	Deep-row ball bearing 6200 30/10/9 DIN 625	2
18	050.1.4022	Supporting disc 30/16 mm dia.	2
18a	050.1.4008	Cover for hub	1
19	050.1.4003.2/23	Hub body, chrome	1
20	050.1.4023	Spacer tube, 37 mm long	1
21	364.2.40.026.1	Front wheel axle (knock-out axle)	1
22		{ Only used, if no speedometer	
22a		{ is mounted	
23	050.2.4030	Spoke, long 2,5 mm dia. x204	18
23	050.2.4031	Spoke, short 2,5 mm dia. x196	18
24	600.4007	Nipple 48 turns p. in.	36
25	900.0894	Tire 23" — 2,25 (black-ivory) (black)	1
26	900.0861	Inner tube 23" — 2,25	1
27	900.0840	Chafing strip 19"	1
28	050.2.4033/23	Rim 19" for tire 23" — 2,25 chrome	1

20 SPEEDOMETER WITH DRIVE

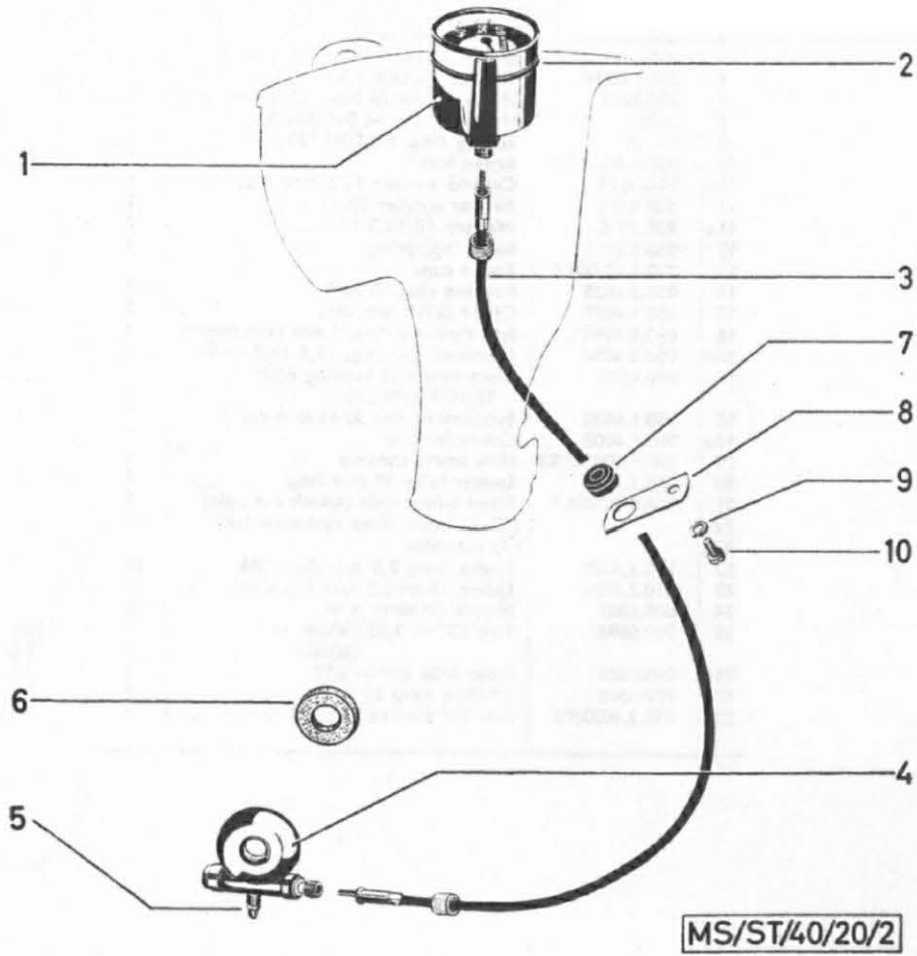

SPEEDOMETER WITH DRIVE

20

Ref. No.	Part No.	Description	Requd. No.
1	050.2.5324	Speedometer ready for fitting 48/45	1
2	050.5327	Rubber ring 49/44/1.5	1
—	050.1.5322	Speedometer glass 51 mm dia.	1
—	050.1.5323	Rubber ring 1,3 []x40 mm dia. for inside of speedometer glass	1
3	050.1.5325.0	Driving shaft, 600 mm long	1
—	050.1.5325	Driving shaft (core)	1
4	050.3.4050.0	Speedometer drive compl.	1
5	26821	Grease nipple	1
6	050.3.4051	Soft rubber packing 36/18/5 for speedometer drive	1
7	501.1.8506	Rubber socket	1
8	350.1.30.059.1	Holder for driving shaft	1
9	29190	Spring ring B 5 DIN 127	1
10	23020	Fillister head screw AM 5x6 DIN 84	1

21

REAR WHEEL, DRIVING CHAIN

MS/SI/41/2

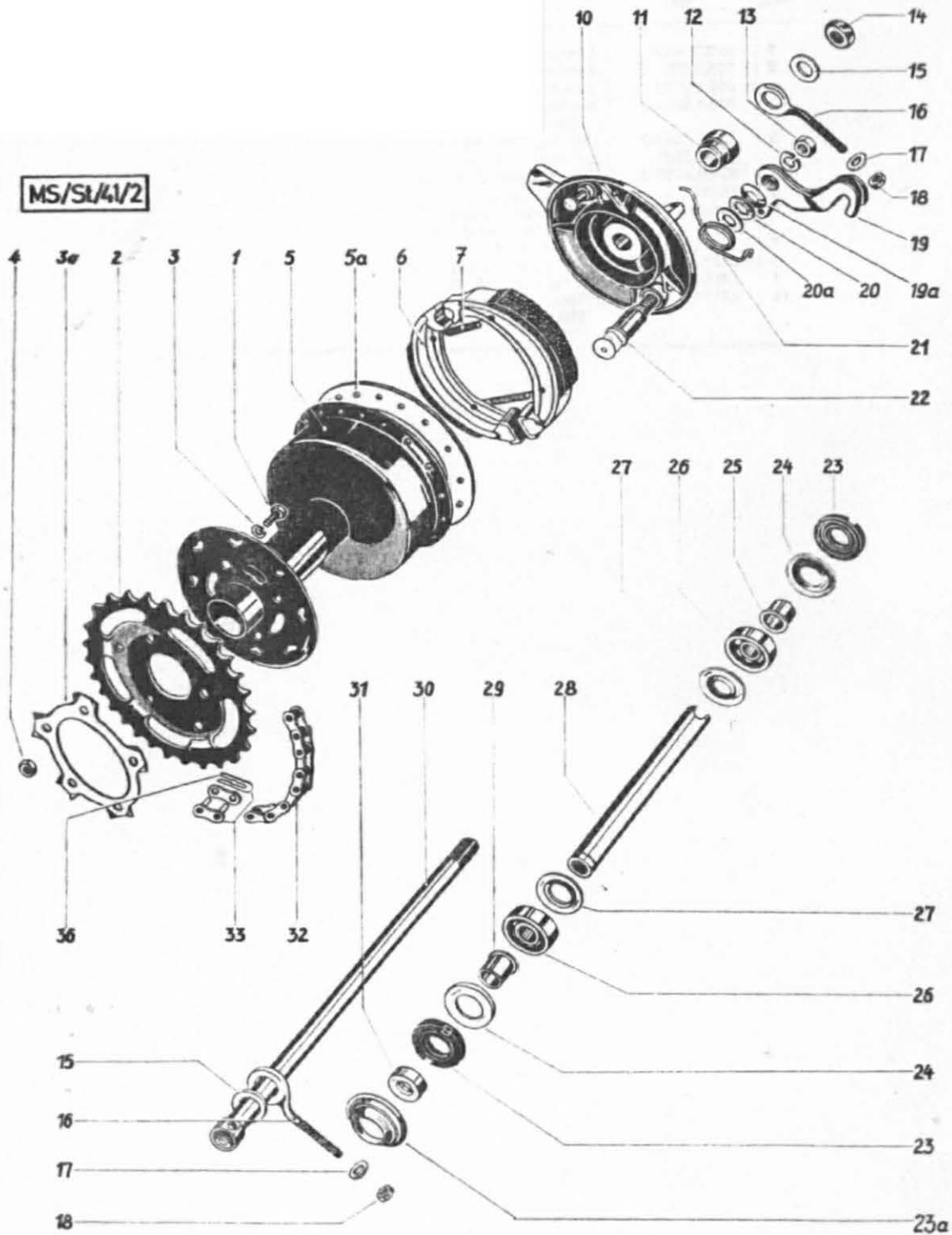

REAR WHEEL, DRIVING CHAIN

21

Ref. No.	Part No.	Description	Requd. No.
—	302.2.41.000.0/23	Rear wheel compl. (without tire) with chrome rim	1
—	302.2.41.002.0	Rear wheel hub compl. with interior parts	1
1	26422	Hexagon head screw M 7x15 DIN 933—8G	5
2	050.4.4109	Chain sprocket (34 teeth)	1
3	29189	Spring ring B7 DIN 127	5
3a	350.1.41.010.1	Securing plate	1
4	24774	Hexagon nut M 7 DIN 934	5
5	050.1.4103.2/23	Hub body chrome	1
5a	050.1.4008	Cover for hub	1
6	050.4015.0	Pair of brake shoes with glued lining	1
7	050.4019	Brake shoe spring	1
10	350.4.41.007.2	Brake cover plate	1
11	050.1.4106	Hub core	1
12	26819	Spring ring B 8 DIN 127	1
13	26820	Hexagon nut M 8x1 DIN 934	1
14	900.2011	Hexagon nut M 10x1 DIN 934—8 G	1
15	050.1.4029	Washer 18/10,5/2,5	2
16	050.4118	Chain tension adjuster	2
17	24803	Washer 5,3 DIN 433	4
18	900.2105	Hexagon nut M 5 DIN 555	4
19	350.5.41.013.2	Brake lever	1
19a	900.3219	Curved washer 12,5mm dia.	1
20	128.2504	Rubber washer 20/12/3	1
20a	900.3938	Washer 18/12,3/1	2
21	050.2.4115	Restoring spring	1
22	350.4.40.009.2	Brake cam	1
23	050.2.4025	Packing ring 30/16/5	2
23a	050.4122	Dust cap	1
24	050.1.4021	Cover 30/16 mm dia.	2
25	050.1.4024	Intermediate ring (9 mm high)	1
26	900.6200	Deep row ball bearing 6200 30/10/9 DIN 625	2
27	050.1.4022	Supporting disc 30/16	2
28	050.1.4123	Spacer tube, 80 mm long	1
29	050.1.4124	Intermediate ring (13 mm high)	1
30	350.1.41.026.1	Rear wheel axle (knock-out axle)	1
31	050.1.4125	Thrust washer	1
—	050.2.4030	Spoke, long, 2,5 mm dia. x 204	18
—	050.2.4031	Spoke, short, 2,5 mm dia. x 196	18
—	600.4007	Nipple, 48 turns p. in.	36
—	900.0894	Tire 23"—2,25, black-ivory, black	1
—	900.0861	Inner tube 23"—2,25	1
—	900.0840	Chafing strip 19"	1
—	050.2.4033/23	Rim 19" for tire 23"—2,25 chrome	1
32	050.4.2810.0	Driving chain 1/2 x 3/16", 94 rollers	1
33	050.4.2820.0	Chain master link	1
36	1150	Chain master link spring	1

27

GENERATOR

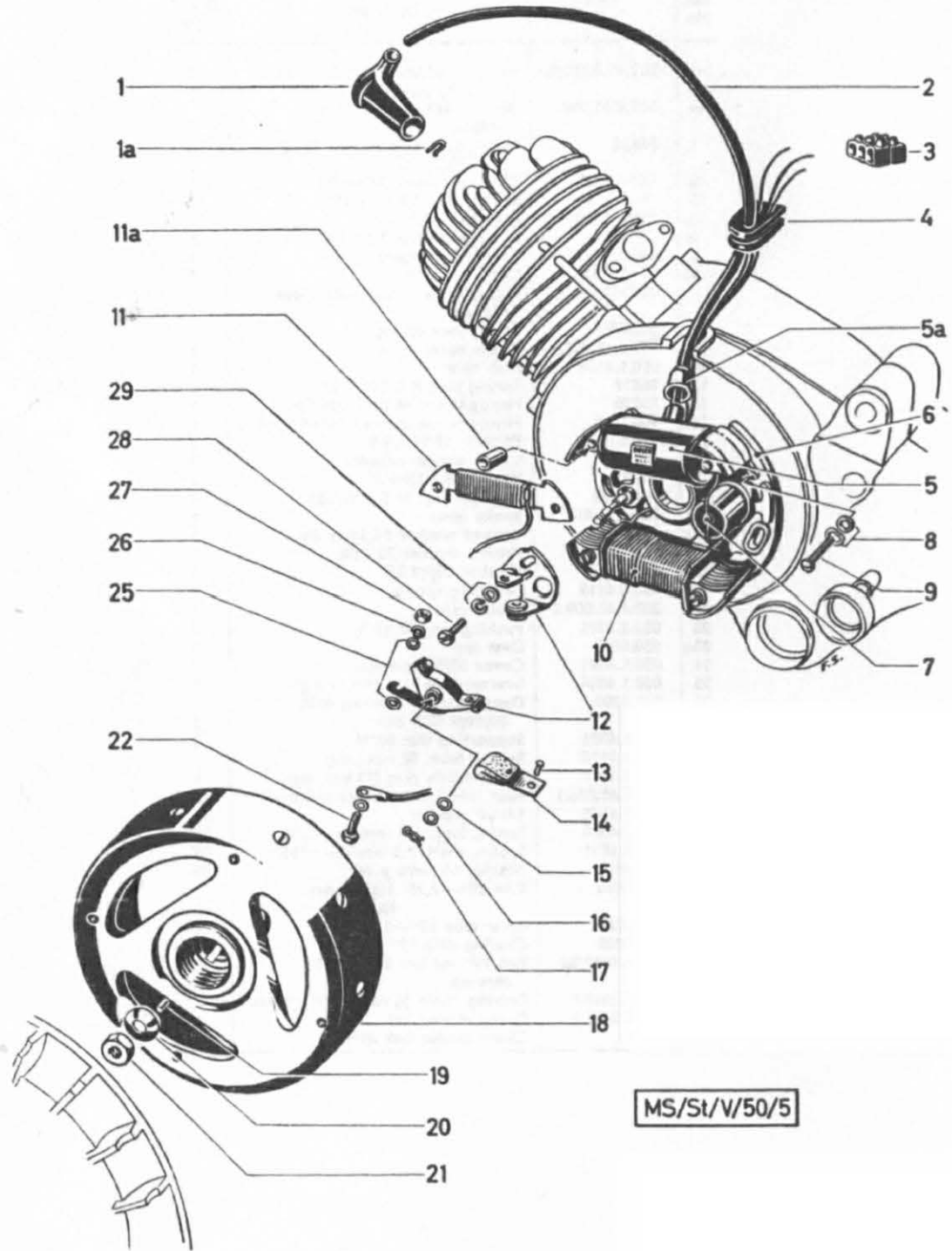

MS/St/V/50/5

ALLSTATE LIGHT WEIGHT MOTOR CYCLE -

GENERATOR

77

Ref. No.	Part No.	Description	Requd. No.
—	302.2.50.000.0	Flywheel magneto generator (Bosch 0212 125 001=LM/URC1/116 27/5L1)	1
1	050.5205.2	Cable plug	1
1a	050.5206	Securing spring (inside cable plug)	1
2	050.5207	Ignition cable 5 mm dia. per meter	—
3	170.5703	Soft rubber terminal (three-rows)	1
4	352.2.10.010.1	Rubber socket	1
5	360.2.50.012.2	Ignition-armature	1
5a	360.2.50.019.1	Rubber cap	1
6	302.2.50.009.1	Armature plate	1
7	302.1.50.013.2	Condenser	1
8	900.3951	Washer 10/4,3/1	3
8	900.3202	Spring washer A 4 DIN 137	3
9	27458	Lens head screw AM 4x15 DIN 85	3
10	302.2.50.011.2	Light armature	1
11	302.2.50.014.2	Stop light armature	1
11a	302.2.50.020.1	Spacer bushing	2
12	302.2.50.015.0	Contact set compl.	1
13	900.0798	Tubular rivet for lubricator felt pad	1
14	900.0794	Lubricator felt pad	1
15	24802	Washer 4,3 DIN 433	2
16	900.3946	Spacer shim 8/4,3/0,1	} as required
16	900.3946.2	Spacer shim 8/4,3/0,2	
17	100.3599	Securing spring	1
17	302.2.50.010.2	Flywheel	1
19	28776	Roller 3 mm dia. x5	1
20	100.1.1235	Spezial washer	1
21	900.2011	Hexagon nut M 10x1 DIN 934-8 G	1
22	900.1133	Hexagon head screw M 3x10 DIN 933	1
25	900.3003	Washer 3,7 DIN 125	3
26	900.3203	Spring ring B 3 DIN 127	1
27	24770	Hexagon nut M 3 DIN 934	1
28	28881	Fillister head screw M 4x10 DIN 86	1
29	22796	Spring ring B 4 DIN 127	1
29	24793	Washer 4,3 DIN 125	1

23

HEADLAMP, HORN, TAIL-STOP-LIGHT AND SWITCH

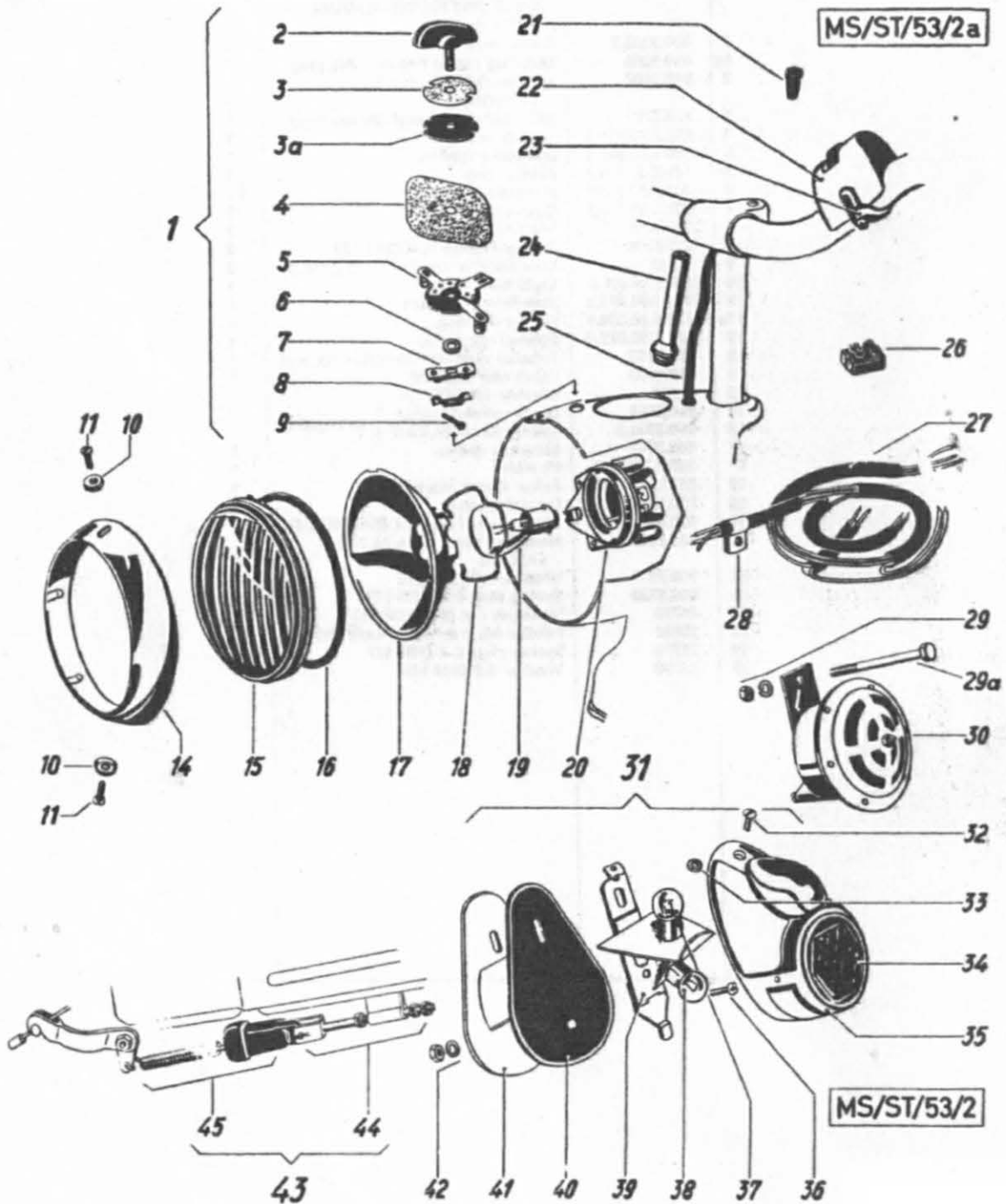

HEADLAMP, DIMMER SWITCH, HORN, TAIL LIGHT

23

Ref. No.	Part No.	Description	Requis. No.
1	050.2.5317.0	Headlamp switch compl.	1
2	050.5315	Switch grip	1
3	050.1.5318	Insulating shim 300	1
3a	050.5313	Shim	1
4	050.5310	Insulating plate	1
5	050.2.5317.2	Base plate	1
6	24803	Washer 3,3 DIN 433	1
7	050.5311	Contact bridge	1
8	050.5312	Switch spring	1
9	24893	Split pin 1.5x10 DIN 94	1
—	050.3300.0	Headlamp interior parts compl. (Halla) with lamp socket, but without bulb	1
10	100.5311	Washer for headlamp attachment	2
11	28721	Oval countersunk head screw M 4x8 DIN 91	2
14	050.5303	Headlamp rim	1
15	050.5304	Headlamp glass	1
16	050.5306	Rubber packing 93/86/1	1
17	050.5308	Reflector	1
18	050.5309	Retaining spring	1
19	900.0721	Bulb Bilux & V 15/15 W	1
20	050.5319.0	Lamp socket	1
21	050.1.3206	Cable socket for dimmer switch	1
22	126.5320.0	Electric dimmer switch	1
23	126.5326	Clamping shackle for dimmer switch	1
24	050.1009	Cable socket for dimmer switch cable	2
25	900.0710	Dimmer switch cable	1
26	51.1.5703	Soft rubber terminal (two-row)	1
27	050.7.5700.0	Light cable compl. (cable assembly)	1
28	050.3705	Light cable shackle	1
29	26834	Spring ring B & DIN 127	1
—	24773	Hexagon nut M & DIN 934	1
—	900.1040	Hexagon head screw M 6x80 DIN 931 (as required)	1
30	900.0727	Horn	1
31	050.4.5500.0	Tail light complete	1
32	28877	Oval head countersunk screw for Tail light AM 4x10-DIN 68	1
33	900.3942	Fibre securing disc 7/6/1	1
34	170.5505.2	Rear reflector (red, as required)	1
35	170.5500.2	Tail light housing (with rear reflector and window)	1
36	33099	Flister head-screw M 5x12 DIN 84	2
37	170.5528	Bulb for stop light G 6 V / 3 W DIN 72601	1
38	900.0721	Bulb for Tail light G V / 2.4 W	1
39	050.4.5518.0	Rear lamp holder	1
40	170.5317	Rubber boss washer	1
41	050.1.5550	Interaxial plate	1
42	29190	Spring ring B & DIN 127	2
—	900.2105	Hexagon nut M 5 DIN 555	2
43	050.1.5520.0	Stop light switch compl.	1
44	050.1.5521.0	Regulating screw compl.	1
45	250.5520	Stop light switch	1

24 TOOLS, BELL, TIRE PUMP

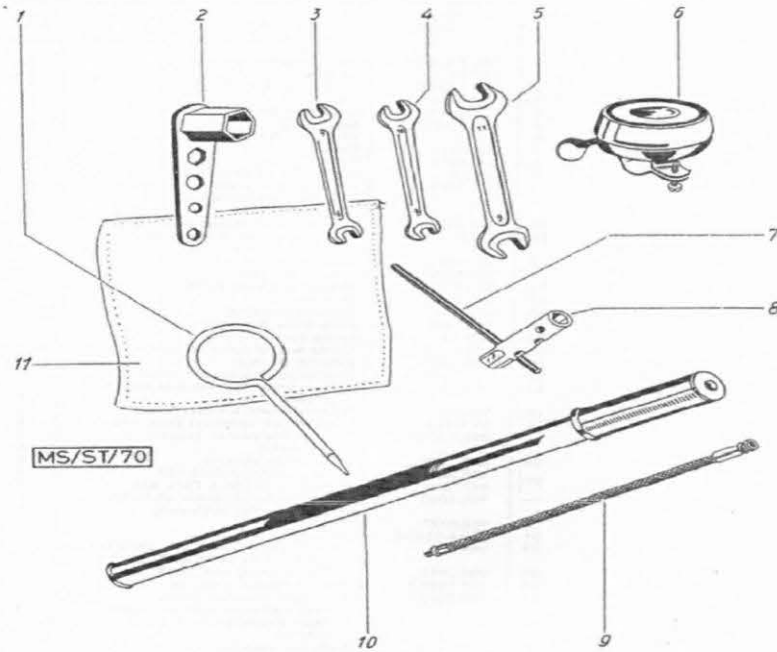

TOOLS, BELL, TIRE PUMP 24

Ref. No.	Part No.	Description	Requ. No.
—	050.3.7010.0	Set of tools complete	1
1	050.2.7021	Screw driver	1
2	050.7001.2	Socket wrench for spark plug	1
3	19599	Wrench 6/7 DIN 895	1
4	10181	Wrench 8/9 DIN 895	1
5	24324	Wrench 9/11 DIN 895	1
6	050.5607	Bell chrome plated (instead of horn on special request)	1
7	050.7022	Pin 6 \varnothing , 115 mm long	1
8	250.7008	Socket wrench	1
9	050.7023.2	Tire pump tube, 200 mm long	1
10	050.7024.0	Tire pump	1
11	050.7004	Cleaning rag	1

VARIOUS STANDARD PARTS 25

Part No.	Description	Dimension	DIN
24792	Washer	3,2	125
24793	Washer	4,3	125
24794	Washer	5,3	125
24795	Washer	6,4	125
24796	Washer	7,4	125
24797	Washer	8,4	125
900.3102	Washer	2,2	433
24802	Washer	4,3	433
24803	Washer	5,3	433
24804	Washer	6,4	433
24805	Washer	7,4	433
24806	Washer	8,4	433
24807	Washer	10,5	433
24770	Nut	M3	934
27508	Nut	3,5	934
24771	Nut	4	934
24772	Nut	5	934
24773	Nut	6	934
24774	Nut	7	934
24775	Nut	8	934
24776	Nut	10	934
900.3203	Lock washer	B3	127
27625	Lock washer	3,5	127
22796	Lock washer	4	127
29190	Lock washer	5	127
26834	Lock washer	6	127
29189	Lock washer	7	127
26819	Lock washer	8	127
29192	Lock washer	10	127
29193	Lock washer	12	127
900.3214	Lock washer	14	127
900.4603	Circlip	Bz 3,2	6799
900.4606	Circlip	6	6799
900.4607	Circlip	7	6799
900.4609	Circlip	9	6799