

Mower / Conditioner Parts

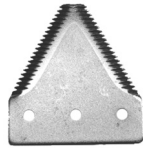
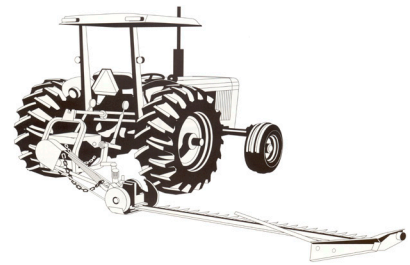

K231271

Sickle Sections

ORDER NO.	DESCRIPTION	STOCK	RETAIL
K211022 (25/box)	Section, underserrated, black, heavy section. Fits John Deere mowers and mower conditioners except 140, 160, 580, & 590. Fits all Ford mowers except model 505.	788	\$1.24
K212082 (25/box)	Section, underserrated, chrome, heavy section. Fits John Deere mowers and mower conditioners except 140, 160, 580, & 590. Fits all Ford mowers except model 505.	7418	\$2.10
K212241 (25/box)	Section, chrome, top serrated, extra heavy, "Big Tooth". Fits JD mowers and mower conditioners except 140, 160, 580, & 590. Fits all Ford mowers except model 505.	3318	\$1.90
K231271 (25/box)	Section, black, Big Tooth, extra heavy, top serrated. Fits Case-IH, Ford, New Holland, New Idea, Hesston, Gehl/Owatonna.	9117	\$1.70

End Sections

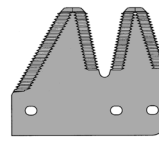

ORDER NO.	DESCRIPTION	STOCK	RETAIL
K712730	Section and a half, 2 pcs. on card with rivets.	34015	\$14.90

Bolts for Sections

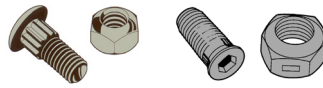

ORDER NO.	DESCRIPTION	STOCK	RETAIL
KDC55	Section bolts and nuts, 5/8" long, box of 50.	8275	\$10.40
KDC5501	Section bolts and nuts, 1" long, box of 25.	5787	\$12.50
KDC55114	Section bolts and nuts, 1-1/4" long, box of 25.	5788	\$12.50
K904525	Countersunk bolt and lock nut, 5/8" long. Box of 50.	0088	\$11.43
K904528	Countersunk bolt and lock nut, 1" long. Box of 50.	7958	\$8.53

Wear Plates and Holddown Clips



SDC468



K5116



K800

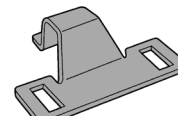

BDC5150H

ORDER NO.	DESCRIPTION	STOCK	RETAIL
SDC468	Steel wear plate, heat treated, fits all mowers and mower/conditioners.	4518	\$2.20
K800	Hold down clip, steel, fits all single drive mowers and mower/conditioners. (515-066)	3048	\$5.75
K5116	Hold down clip, fits all John Deere mowers and haybines. For use with riveted or bolted sickles. (Kondex 515-116).	3554	\$7.90
BDC5150H	High arch hold down clip for use at the drive head area.(Kondex 515-126)	8856	\$8.40





Hay/Mower Guards





Universal Single Prong Guard

ORDER NO.	DESCRIPTION	STOCK	RETAIL
BU107	Single prong guard, universal. Fits AC, Case, Deere, IHC, New Holland, Oliver, New Idea and other mowers with a 7/16" cutter bar. Replaces DM700	3847	\$6.90

John Deere



	ORDER NO.	DESCRIPTION	STOCK	RETAIL
	BU220	Double prong guard. Fits Deere mower models 37, 38, 39, 250, 350, 450 and mower conditioner models 480, 483, 485, 215, 215A, 780, 800, 880. Replaces Deere no. E48093 and E82559. Uses 7/16" plow bolts when mounting.	10018	\$14.30
	BU221	Double prong guard. Used on JD mower conditioner models 1207, 1209 and 1214. Also 1219 prior to s/n 710000. Replaces JD no's E62000 and E52667. **Double heat treated guard **	3798	\$13.90
	BU254	Non-clog guard. Use with 7/16" carriage bolts. Fits John Deere mower conditioners 1207, 1209, 1214; 1217 and 1219 prior to s/n 710000; 1380, 1424. Windrower auger platforms 183, 220, 230, 240. Windrower drapers 78, 120. Mowers 350, 450. Replaces John Deere E59625, E52547, E57752, E88907.	5498	\$13.50
	BU906	Hold down clip with single bolt adjustment. Use with BU254 non-clog guards. Replaces 3-piece adjustable hold down. Replaces JD no's AE57173; E88906.	3389	\$11.90

Gehl

	ORDER NO.	DESCRIPTION	STOCK	RETAIL
	BU220	Double prong guard. Fits Gehl models 770, 880, 1070, 1090, replaces Gehl no. 072057. Uses 7/16" plow bolts when mounting.	10018	\$14.30
	BU270	Double prong guard. Fits Gehl MA206A, HK108, HK440. Uses 7/16" plow bolts when mounting.	43119	\$16.20
	BU245	Double prong guard. Fits Gehl models 2130, 2160, 2230, 2262. **Double heat treated guard **	31113	\$15.90

For Stub Guards see page 211.

MacDon

	ORDER NO.	DESCRIPTION	STOCK	RETAIL
	BU344	Double Prong Guard. Double heat treated. Fits MacDon 3000, 3020, 4000, 5000, 5010, 5020, 7000, 8000, 9000, A30S Series Windrowers and Conditioners; 912, 922 Auger Header. Replaces MacDon 23064, 28013, 118344, 118484. This guard uses 7/16" carriage bolts. **Double heat treated guard **	26415	\$20.90
	BU345	Drive head guard. Used on the same models as BU344 shown above. Replaces MacDon 28014, 118345. This guard uses 7/16" carriage bolts.	96414	\$20.99

Hesston and Case-IH



ORDER NO.	DESCRIPTION	STOCK	RETAIL
BU245	Double prong guard. Replaces Hesston no. 49239 and 700700845. Case-IH models 8300 series, 8210, 8220, 8230, 8240, 8820, 8830. **Double heat treated guard **	31118	\$15.90



BU215	Double prong guard. Fits Case-IH 8300 series mower conditioners 525, 625, 8320, 8330, 8340, 8350, 8360, 8370, 8380, SC412, SC414 and SC416 windrowers 8210, 8220, 8230, 8240, 8820, 8830, 8840, DHX182, DHX212, DHX252, DHX302, DHX362, HDX121, HDX122, HDX141, HDX142, HDX161, HDX162, HDX181, HDX182, SCX100 and SMX91. Hesston mower conditioners 1109, 1110, 1120, 1130, 1150, 1160, 1170, 1260, 1265, 1270, 1275, 2270 and 2275; headers 8010, 8020, 8100, 8200, 8400, 9020, 9125, 9145.**Double heat treated guard **	38118	\$16.90
-------	---	-------	---------



BU270	Double prong guard. Case-IH 100, 110, 115, 120, 1190, 1290, 1490, 1590, 75, 210, 230, 275, 375, 4000, 5000, 5500.	43119	\$16.20
-------	---	-------	---------



BU210	Double prong guard. Fits Case-IH mower/conditioner models 170, 175, 200, 225, 816, 990, and others. Replace CIH numbers 1326787C3, 483500R4, and 187346A1.	05015	\$15.00
-------	--	-------	---------

BU472717DH	Single Prong Guard, use as required on mowers 100, 110, 115, 200, 230, 1000, 1100, 1110, 1200, 1300; mower conditioners 990, 1190, 1490, 1590.	7098	\$12.95
------------	--	------	---------



New Holland



ORDER NO.	DESCRIPTION	STOCK	RETAIL
BU215	Double prong guard. Fits all New Holland mower/conditioners, replaces NH no. 219191, 858778, and 86521587. Will interchange with BU245. This guard uses 7/16" carriage bolts.**Double heat treated guard **	38119	\$16.90

For Stub Guards see the next page.

New Idea



ORDER NO.	DESCRIPTION	STOCK	RETAIL
BU280	Double prong guard. Fits New Idea mower conditioners 290 and 299; Ford 535 mower conditioners; Massey Ferguson 81 Hay Tender. Replaces New Idea 290385	55118	\$16.50
BU270	Double prong guard. Fits New Idea 507, 509, 512, 514, 5107, 5109, 5112, 5114. Use 3 BU210 guards at the drive head area. This guard uses 7/16" carriage bolts.	43118	\$16.20
BU472717DH	Single Prong Guard to fit New Idea mowers 521, 522. Replaces NI no. H472717R2. ** Double Heat Treat **	7099	\$12.95

Tie Guards

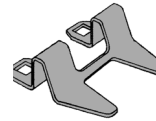
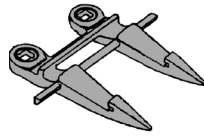

ORDER NO.	DESCRIPTION	STOCK	RETAIL
BT260	Tie guard, used on Case-IH, Gehl, Hesston, New Holland.	51012	\$14.50
BT262	Tie plate, high arch, used with BT260.	5950	\$8.50
BT261	Tie plate, low arch, used with BT260.	5131	\$4.50

Stub Guards

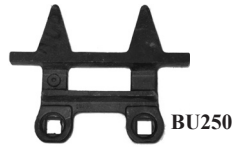

ORDER NO.	DESCRIPTION	STOCK	RETAIL
BU250	Stub guard used on Case-IH, Gehl, Hesston, Macdon, New Holland mower conditioners and windrowers. Replaces Gehl 060494; Hesston 049312; New Holland 257634; Case-IH 049312; Macdon 34974.	8689	\$12.40
BU251	Lo-arch guard clip used with BU250 guard. Fits Case-IH, Gehl, Hesston, Macdon, New Holland mower conditioners and windrowers.	4630	\$5.20
BU252	Hi-arch guard clip used with BU250 guard. Fits Case-IH, Gehl, Hesston, Macdon, New Holland mower conditioners and windrowers.	3048	\$5.75

Drive Heads/Bushings/Sickles

New Holland



ORDER NO.	REFERENCE	DESCRIPTION	STOCK	RETAIL
K901033	289488	Drive head, fits 474, 489, 492.	297015	\$134.90
K901034	577866	Drive head, fits 495, 1495.	02974	\$99.00
K901051	134182	Drive head bushing, fits 460-469. (920-434)	04835	\$48.00
K901052	254132	Drive head bushing, fits 472, 479. (920-437)	04834	\$48.00
K901074	701401	Drive head bushing, fits 474, 489. (920-406)	02365	\$79.00
CR19615		7' New Holland bolted sickle assembly, NO drive head. Fits models 451, 456, 461, 467, 477, and 478.	006628	\$380.00
CR24776		9' New Holland bolted sickle assembly, NO drive head. Fits models 469, 488, 489, 492, 495, and 1469.	004437	\$430.00

John Deere Sickle

ORDER NO.	DESCRIPTION	STOCK	RETAIL
CR24759	9' JD bolted sickle assembly, NO drive head. Fits models 1209 and 1219.	002137	\$390.00
K725003	Knifehead Pin Kit for JD. Mowers: 47, 50, 250, 350, 450, 3700. Mower Conditioners: 1217, 1219, 1380, 1424, 1525 with 300 Twin Knife Drive, 1600 prior to S/N 880,001 Windrowers: 2280, 2320, 2420, Auger Platforms 230, 240, Draper Platforms 130, 135, 3430, 3830 with 300 & 300A Twin Knife Drive prior to S/N 880,000.	25148	\$51.90



Bean Windrower Teeth



ORDER NO.	DESCRIPTION	WT.	STOCK	RETAIL
IBTLK	Bean windrower tooth, to fit 1" round tube.	.5	3025	\$2.90

Rubber Mounted Rake Teeth



ORDER NO.	DESCRIPTION	STOCK	RETAIL
MRMT188	Universal Rubber mounted rake tooth, to fit 1 1/2" round tube.	0828	\$4.00
MRMT114	Rubber Rake Tooth, fits New Holland 259 Rolobar rakes. Also fits New Holland 216 and 258 rakes; Allen and TwinStar rakes with left hand hook. Replaces New Holland no. 65668 and 850613.	9233	\$4.70
MRMT213	Rubber Rake Tooth, fits New Holland 260 Rolobar rakes. Also fits New Holland 216 rakes, Allen and TwinStar rakes with right hand hook. Replaces New Holland no. 139041, 850614.	9231	\$4.70
MRMT718	Rubber Rake Tooth for John Deere & Vermeer. Fits John Deere 700, 705. Vermeer Models: R-9, R-21, R-23, R-23A, R-24, R-24A. Replaces John Deere no. AE56204 Vermeer no. 2888-001	0535	\$5.00
MRMT012	Rubber Rake Tooth for John Deere. Fits John Deere 70, 71, 640, 650, 652, 660, 662, 670, 671, 672, 673, 896A. Replaces John Deere no. AE24953; AE47389.	4636	\$5.20
MRMT052	Double Rubber Rake Tooth. Fits wheel rakes made by Circle C, Darf, Farmland, H & S, Morrill, New Idea, Pequea, John Deere & others. Replace John Deere no. 2117RH, 400341 & 491478.	9677	\$10.99

Baler Pickup Tooth



ORDER NO.	DESCRIPTION	STOCK	RETAIL
S12033	Pickup tooth for Agco Balers. AGCO-Hesston balers 2150, 2170, 2846, 2846A, 2856, 2856A, 2946, 2946A, 2956, 2956A, 7423, 7424, 7433, 7434, 7444. Challenger balers LB23B, LB24B, LB33B, LB34B, LB34BXD, LB44B, RB46B, RB46C, RB46CA, RB56, RB56C, RB56CA, 2250, 2270XD, 2290, 2946, 2946A, 2956, 2956A. Massey-Ferguson balers 2140, 2150, 2160, 2170, 2170XD, 2190, 2270, 2270XD, 2846, 2846A, 2856, 2856A, 2946, 2946A, 2956, 2956A. Over all length: 8-1/4". Inside coil diameter: 1-11/16". Inside width between legs: 2-3/8"	9726	\$3.99
MRMT619	Double Baler pickup tooth. Fits Vermeer Balers: Most Baler Models. Massey Ferguson Models: 1440, 1455, 1550, and 1565. Replaces no's Vermeer 27997-001, Massey Ferguson 1059176M1.	2066	\$8.60
MRMT883	Double Baler pickup tooth. Fits New Holland Hayheads: 345, 366, 350, 355, 346, 365, 990, 340, 356. Balers: BB940S, BB960S, BB960AR, BR7070, BB940R, BB960R, 585, BB940P, BB900P, BB940AR, BR7090, BR7060. Replaces NH no. 9847572.	0077	\$10.00
S26505	Baler pickup tooth. For John Deere round balers with Mega pickup 440E, 446, 447, 448, 449, 450M, 456, 457, 458, 458S, 459, 459SS, 460M, 460R, 466, 467, 468, 468S, 469, 469P, 469SS, 546, 547, 556, 557, 558, 559, 559SS, 550M, 560M, 560R, 566, 567, 568, 569, 569P, 569SS. Large square balers L331, L341. Mega pickup teeth bolt on to square tubing with angle iron on front edge. Replaces JD no. FH304576; AFH202304.	9433	\$4.99

Baler Actuators



ORDER NO.	DESCRIPTION	STOCK	RETAIL
GF12-1002	Actuator for JD Balers. Used on Round balers electric twine arm drive. Fits Round Baler models 335, 375, 385, 446, 447, 448, 449, 456, 457, 458, 459, 466, 467, 468, 469, 546, 547, 556, 557, 558, 559, 565, 566, 567, 568, 572, 575, 578, 582, 592, 644, 678, 842, 852, 854, 862, 864, 960, 990.	029157	\$649.00
GF12-1033	Actuator for AGCO Baler. Baler twine wrap on: AGCO, Hesston, Massey Ferguson 514, 745, 1745, 1746, 1756, 5145, 5146, 5156. Case-IH 3440, 3450, 3640, 3650, 8480. Challenger RB452, RB462, RB562. New Idea 483, 484, 485, 486; 4844, 4845, 4865 without potentiometer; 6254. Pickup on: Hesston 814. New Idea 4844, 4845, 4854, 4855, 4865.	021938	\$489.00
GF12-1045	Actuator for baler electric twine wrap or net wrap. Fits New Holland balers: 640, 644, 648, 650, 654, 658, 660, 664, 678, 688, 855, BR740, BR740A, BR750, BR750A, BR770, BR770A, BR780, BR780A, BR7060, BR7070, BR7080, BR7090, BU7060*, Roll-Belt 450*. Fits Case-IH balers: RB454, RB455A*, RB464, RB554, RB564, RBX451, RBX452, RBX453, RBX461, RBX462, BX463, RBX552, RBX553, RBX561, RBX562, RBX563. *Net wrap only on BU7060, Roll-Belt 450, RB455A.	029158	\$649.00

Sickle Repair Kits

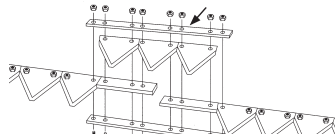

ORDER NO.	DESCRIPTION	STOCK	RETAIL
K711010	Repair kit for 7000 (2 1/16" centers) series sickles. (JD, IH, NH)	70828	\$40.10
K711012	Repair kit for 6000 (2" centers) series sickles. (AC, MF, HC)	07827	\$42.00
K711011	Repair kit for 2 1/8" spacing. (MacDon)	38239	\$46.90