

## Guards, Hold Down Clips, Wear Plates



ORDER No.	DESCRIPTION	STOCK	RETAIL
BU275	Double prong guard, replaces Love LB208 and LB214. Replaces MF number 1036339M1, and NH numbers 271971 and 273846. Fits all Love floating cutterbars.	9096	\$12.99
SDC468	Steel wear plate, replaces Love no. 220. Fits all Love floating cutterbars.	3318	\$1.90
K515016	Hold down clip, cast. Used on riveted or bolted sickles.	99012	\$15.70

## Sickles - Split sickle with bolted sections

ORDER No.	DESCRIPTION	STOCK	RETAIL
CR19463	Sickle, 15' with "Big Tooth" sections.	000028	\$250.00
CR19464	Sickle, 16' with "Big Tooth" sections.	006124	\$270.00
CR19466	Sickle, 20' with "Big Tooth" sections.	002725	\$340.00

## Sickle Bar Drive Head

ORDER No.	DESCRIPTION	STOCK	RETAIL
DCLOVE	Drive head with stabilizer bar.	00240	\$60.00

## Mower / Conditioner Parts

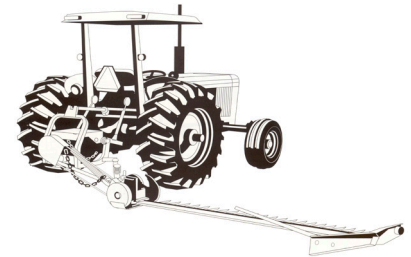

## Sickle Sections

ORDER No.	DESCRIPTION	STOCK	RETAIL
K211022 (25/box)	Section, underserrated, black, heavy section. Fits John Deere mowers and mower conditioners except 140, 160, 580, & 590. Fits all Ford mowers except model 505.	478	\$1.06
K212082 (25/box)	Section, underserrated, chrome, heavy section. Fits John Deere mowers and mower conditioners except 140, 160, 580, & 590. Fits all Ford mowers except model 505.	9218	\$1.84
K212241 (25/box)	Section, chrome, top serrated, extra heavy, "Big Tooth". Fits JD mowers and mower conditioners except 140, 160, 580, & 590. Fits all Ford mowers except model 505.	6118	\$1.66
K231271 (25/box)	Section, black, Big Tooth, extra heavy, top serrated. Fits Case-IH, Ford, New Holland, New Idea, Hesston, Gehl/Owatonna.	097	\$1.29

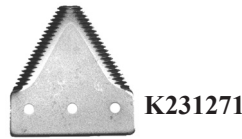

## Bolts for Sections

ORDER No.	DESCRIPTION	STOCK	RETAIL
KDC55	Section bolts and nuts, 5/8" long, box of 50.	8465	\$9.26
KDC5501	Section bolts and nuts, 1" long, box of 25.	8744	\$6.83
KDC55114	Section bolts and nuts, 1-1/4" long, box of 25.	4253	\$7.50
K904525	Countersunk bolt and lock nut, 5/8" long. Box of 50.	0088	\$11.43
K904528	Countersunk bolt and lock nut, 1" long. Box of 50.	7958	\$8.53
KBDC174	Section bolts and nuts, 1/4" x 5/8", 50 pcs.	9874	\$11.25
KBDC174N	Section nuts, 1/4" self locking, 50 pcs.	5243	\$6.01

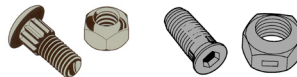

## Wear Plates and Holddown Clips



SDC468



K5116



K800

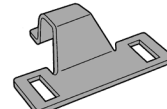

BDC5150H

ORDER NO.	DESCRIPTION	STOCK	RETAIL
SDC468	Steel wear plate, heat treated, fits all mowers and mower/conditioners.	3318	\$1.90
IDC468N	Nylon wear plate, fits all mowers and mower/conditioners. Reduces friction.	5016	\$1.50
K800	Hold down clip, steel, fits all single drive mowers and mower/conditioners. (515-066)	0928	\$4.14
K5116	Hold down clip, fits all John Deere mowers and haybines. For use with riveted or bolted sickles. (515-116).	9134	\$4.56
BDC5150H	High arch hold down clip for use at the drive head area.(515-126)	7246	\$6.10

## End Sections

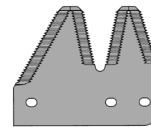

ORDER NO.	DESCRIPTION	STOCK	RETAIL
K612220	Blank end half section.	4931	\$5.63
K712730	Section and a half, 2 pcs. on card with rivets.	3095	\$12.90

## Hay/Mower Guards

### Universal Single Prong Guard



ORDER NO.	DESCRIPTION	STOCK	RETAIL
BU107	Single prong guard, universal. Fits AC, Case, Deere, IHC, New Holland, Oliver, New Idea and other mowers with a 7/16" cutter bar. Replaces DM700	3847	\$6.90

### John Deere



ORDER NO.	DESCRIPTION	STOCK	RETAIL
BU220	Double prong guard. Fits Deere mower models 37, 38, 39, 250, 350, 450 and mower conditioner models 480, 483, 485, 215, 215A, 780, 800, 880. Replaces Deere no. E48093 and E82559. Uses 7/16" plow bolts when mounting.	5498	\$13.50
BU221	Double prong guard. Used on JD mower conditioner models 1207, 1209 and 1214. Also 1219 prior to s/n 710000. Replaces JD no's E62000 and E52667.	0198	\$13.00
BU254	Non-clog guard. Use with 7/16" carriage bolts. Fits John Deere mower conditioners 1207, 1209, 1214; 1217 and 1219 prior to s/n 710000; 1380, 1424. Windrower auger platforms 183, 220, 230, 240. Windrower drapers 78, 120. Mowers 350, 450. Replaces John Deere E59625, E52547, E57752, E88907.	5498	\$13.50

## Gehl



ORDER No.	DESCRIPTION	STOCK	RETAIL
BU220	Double prong guard. Fits Gehl models 770, 880, 1070, 1090, replaces Gehl no. 072057. Uses 7/16" plow bolts when mounting.	5498	\$13.50
BU270	Double prong guard. Fits Gehl MA206A, HK108, HK440. Uses 7/16" plow bolts when mounting.	5789	\$12.50
BU245	Double prong guard. Fits Gehl models 2130, 2160, 2230, 2262.	7894	\$14.10

*For Stub Guards see the next page.*

## Hesston and Case-IH



ORDER No.	DESCRIPTION	STOCK	RETAIL
BU245	Double prong guard. Replaces Hesston no. 49239 and 700700845. Case-IH models 8300 series, 8210, 8220, 8230, 8240, 8820, 8830.	4298	\$13.20
BU215	Double prong guard. Fits Case-IH 8300 series mower conditioners 525, 625, 8320, 8330, 8340, 8350, 8360, 8370, 8380, SC412, SC414 and SC416 windrowers 8210, 8220, 8230, 8240, 8820, 8830, 8840, DHX182, DHX212, DHX252, DHX302, DHX362, HDX121, HDX122, HDX141, HDX142, HDX161, HDX162, HDX181, HDX182, SCX100 and SMX91. Hesston mower conditioners 1109, 1110, 1120, 1130, 1150, 1160, 1170, 1260, 1265, 1270, 1275, 2270 and 2275; headers 8010, 8020, 8100, 8200, 8400, 9020, 9125, 9145.	7198	\$13.10
BU270	Double prong guard. Case-IH 100, 110, 115, 120, 1190, 1290, 1490, 1590, 75, 210, 230, 275, 375, 4000, 5000, 5500.	5789	\$12.50
BU210	Double prong guard. Fits Case-IH mower/conditioner models 170, 175, 200, 225, 816, 990, and others. Replace CIH numbers 1326787C3, 483500R4, and 187346A1.	3795	\$13.90

## MacDon



ORDER No.	DESCRIPTION	STOCK	RETAIL
BU344	Double Prong Guard. Double heat treated. Fits MacDon 3000, 3020, 4000, 5000, 5010, 5020, 7000, 8000, 9000, A30S Series Windrowers and Conditioners; 912, 922 Auger Header. Replaces MacDon 23064, 28013, 118344, 118484. This guard uses 7/16" carriage bolts.	8685	\$12.40
BU345	Drive head guard. Used on the same models as BU344 shown above. Replaces MacDon 28014, 118345. This guard uses 7/16" carriage bolts.	1394	\$13.30

## New Holland



ORDER No.	DESCRIPTION	STOCK	RETAIL
BU215	Double prong guard. Fits all New Holland mower/conditioners, replaces NH no. 219191, 858778, and 86521587. Will interchange with BU245. This guard uses 7/16" carriage bolts.	7198	\$13.10

*For Stub Guards see the next page.*

## New Idea

ORDER NO.	DESCRIPTION	STOCK	RETAIL
BU280	Double prong guard. Fits New Idea mower conditioners 290 and 299; Ford 535 mower conditioners; Massey Ferguson 81 Hay Tender. Replaces New Idea 290385	0098	\$12.86
BU270	Double prong guard. Fits New Idea 507, 509, 512, 514, 5107, 5109, 5112, 5114. Use 3 BU210 guards at the drive head area. This guard uses 7/16" carriage bolts.	5788	\$12.50

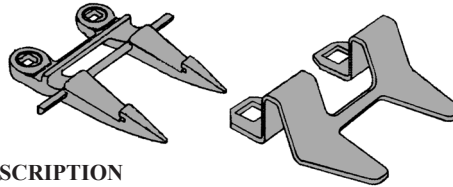

## Tie Guards

ORDER NO.	DESCRIPTION	STOCK	RETAIL
BT260	Tie guard, used on Case-IH, Gehl, Hesston, New Holland.	0892	\$14.00
BT262	Tie plate, high arch, used with BT260.	5950	\$8.50
BT261	Tie plate, low arch, used with BT260.	5131	\$4.50

## Stub Guards



BU250



BU251



BU252

ORDER NO.	DESCRIPTION	STOCK	RETAIL
BU250	Stub guard used on Case-IH, Gehl, Hesston, Macdon, New Holland mower conditioners and windrowers. Replaces Gehl 060494; Hesston 049312; New Holland 257634; Case-IH 049312; Macdon 34974.	0482	\$12.00
BU251	Lo-arch guard clip used with SH250 guard. Fits Case-IH, Gehl, Hesston, Macdon, New Holland mower conditioners and windrowers.	3430	\$4.90
BU252	Hi-arch guard clip used with SH250 guard. Fits Case-IH, Gehl, Hesston, Macdon, New Holland mower conditioners and windrowers.	5838	\$5.50

## Drive Heads/Bushings/Sickles



### New Holland

ORDER NO.	REFERENCE	DESCRIPTION	STOCK	RETAIL
K901033	289488	Drive head, fits 474, 489.	02185	\$116.00
K901034	577866	Drive head, fits 495, 1495.	02974	\$99.00
K901051	134182	Drive head bushing, fits 460-469. (920-434)	73625	\$32.96
K901052	254132	Drive head bushing, fits 472, 479. (920-437)	06524	\$32.00
K901074	701401	Drive head bushing, fits 474, 489. (920-406)	08735	\$54.00
CR19615	7'	New Holland sickle assembly, NO drive head. Fits models 451, 456, 461, 467, 477, and 478.	002118	\$140.00
CR24776	9'	New Holland sickle assembly, NO drive head. Fits models 469, 488, 489, 492, 495, and 1469.	004417	\$180.00

### John Deere Sickle

ORDER NO.	DESCRIPTION	STOCK	RETAIL
CR24759	9' JD sickle assembly, NO drive head. Fits models 1209 and 1219.	004417	\$180.00

# Sickle Repair Kits

ORDER NO.	DESCRIPTION	WT.	STOCK	RETAIL
K711010	Repair kit for 7000 (2 1/16" centers) series sickles. (JD, IH, NH)	1	52918	\$27.50
K711012	Repair kit for 6000 (2" centers) series sickles. (AC, MF, HC)	1	71027	\$28.81

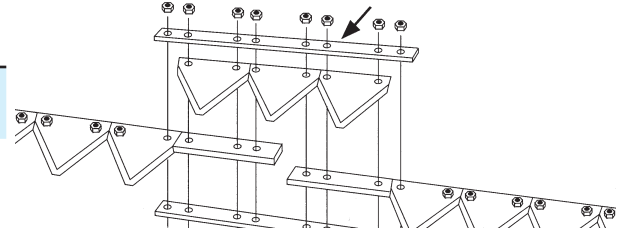

# Disc & Drum Mower Components



A



B



C

*Blades are sold by the piece.*

## Blades

## Kuhn

ORDER NO.	STYLE	MODELS	SIZE	HOLE SIZE	HDWE	STOCK	RETAIL
56151210 (LH)	B	GMD44, 55, & 66 with standard disc.	3.74" x 1.77" x .14"	.64"	B2/N1	963	\$0.99
56151310 (RH)	B	GMD44, 55, & 66 with standard disc.	3.74" x 1.77" x .14"	.64"	B2/N1	965	\$0.99
56451200 (LH)	B	GMD44, 55, 66, & 77 with Heavy Duty disc.	4.84" x 1.77" x .16"	.72"	B1/N2	795	\$1.39
56451300 (RH)	B	GMD44, 55, 66, & 77 with Heavy Duty disc.	4.84" x 1.77" x .16"	.72"	B1/N2	796	\$1.39

## Vicon

ORDER NO.	STYLE	MODELS	SIZE	HOLE SIZE	HDWE	STOCK	RETAIL
58699 (LH)	C	AM3200, CM165, 167, 240, 247, 1700, KM240, 241, 321, & 281 Early models with 2 blades per disc.	4.72" x 1.89" x .16"	.72"	B3/N3	799	\$1.39
58700 (RH)	C	AM3200, CM165, 167, 240, 247, 1700, KM240, 241, 321, & 281 Early models with 2 blades per disc.	4.72" x 1.89" x .16"	.72"	B3/N3	797	\$1.39
90261559 (LH)	C	AM2800, CM216, 217, 2200, & 281 late models with 3 blades per disc.	4.21" x 1.89" x .16"	.72"	B3/N3	092	\$1.29
90261560 (RH)	C	AM2800, CM216, 217, 2200, & 281 late models with 3 blades per disc.	4.21" x 1.89" x .16"	.72"	B3/N3	095	\$1.29

## Krone

ORDER NO.	STYLE	MODELS	SIZE	HOLE SIZE	HDWE	STOCK	RETAIL
1398880 (LH)	C	323 shaft drive.	4.41" x 1.89" x .16"	.75"	-	987	\$1.27
1398890 (RH)	C	323 shaft drive.	4.41" x 1.89" x .16"	.75"	-	985	\$1.27

## New Holland

ORDER NO.	STYLE	MODELS	SIZE	HOLE SIZE	HDWE	STOCK	RETAIL
56151210 (LH)	B	442, 452, & 462 with standard disc. Replaces NH no. 766726.	3.74" x 1.77" x .14"	.64"	B2/N1	963	\$0.99
56151310 (RH)	B	442, 452, & 462 with standard disc. Replaces NH no. 766727.	3.74" x 1.77" x .14"	.64"	B2/N1	965	\$0.99
56451200 (LH)	B	442, 452, 462, 463, & 465 with Heavy Duty disc. Replaces NH no. 784220.	4.84" x 1.77" x .16"	.72"	B1/N2	795	\$1.39
56451300 (RH)	B	442, 452, 462, 463, & 465 with Heavy Duty disc. Replaces NH no. 784221.	4.84" x 1.77" x .16"	.72"	B1/N2	796	\$1.39

**Note A:** Discs with lifters use B7; with out lifters use B6.

## John Deere

ORDER NO.	STYLE	MODELS	SIZE	HOLE SIZE	HDWE	STOCK	RETAIL
56151210 (LH)	B	1320, 1326, 1327, 240, 260 with standard disc. Replaces JD no's. CC20500, CC4407.	3.74" x 1.77" x .14"	.64"	B2/N1	963	\$0.99
56151310 (RH)	B	1320, 1326, 1327, 240, 260 with standard disc. Replaces JD no's. CC20501, CC4406.	3.74" x 1.77" x .14"	.64"	B2/N1	965	\$0.99
56451200 (LH)	B	1320, 1326, 1327, 240, 260 with heavy duty disc. Replaces JD no's. CC21780, CC44005.	4.84" x 1.77" x .16"	.72"	B1/N2	795	\$1.39
56451300 (RH)	B	1320, 1326, 1327, 240, 260 with heavy duty disc. Replaces JD no's. CC21781, CC44004.	4.84" x 1.77" x .16"	.72"	B1/N2	796	\$1.39



A



B



C

*Blades are sold by the piece.*

## Blades

## Hardware for Disc & Drum Mower Blades

*Packed & Priced in quantities of 6.*



ORDER NO.	MODELS	REFERENCE (HDWE COLUMN)	STOCK	RETAIL
56210100	Kuhn	B2 (Bolt)	4365	\$9.06
81160	Vicon	B3 (Bolt)	2762	\$9.60
80201052	Kuhn, New Holland	N1 (Nut)	6025	\$2.94
30577100	Vicon	N3 (Nut)	079	\$1.00
86515265	New Holland	N5 (Nut)	38115	\$16.90