

# ms Oosterdam

## DECK PLANS & STATEROOMS

The deck plans are color-coded by category of stateroom, and the category letter precedes the stateroom number in each room. All staterooms are equipped with flat-panel television, DVD player, mini-bar, mini-safe, data port, telephone and multichannel music.

**Important Note:** Not all staterooms within each category have the same furniture configuration and/or facilities. Appropriate symbols within the rooms on the deck plans describe differences from the stateroom descriptions below.

All information is subject to change.

### STATEROOM SYMBOL LEGEND

- Triple (2 lower beds, 1 sofa bed)
- Quad (2 lower beds, 1 sofa bed, 1 upper)
- △ Partial sea view
- × Fully obstructed view
- + Connecting rooms
- \* Shower only
- ♣ Single sink vanity
- ◆ Staterooms have solid steel verandah railings instead of clear-view Plexiglas® railings
- ♿ Suites SY8068, SC6175, SC6164, SY5002 & SY5001 are wheelchair accessible, bathtub and roll-in shower. Suite SS6108 and staterooms I-8037, VA8032, VA8031, VA6049, VB6004, VB6003, VA5140, VA5137, VA5054, VA5051, VA4132, VA4131, H4090, H4089, VA4052, VA4051, D1100, C1082, C1081, J1074, K1012 & K1011 are wheelchair accessible, roll-in shower only.

### OCEAN-VIEW STATEROOMS

**C** **D** **DD** **E** **F**

**Large:** 2 lower beds convertible to 1 queen-size bed, bathtub & shower.  
Approximately 174–180 sq. ft.

### INTERIOR STATEROOMS

**J**

**Large:** 2 lower beds convertible to 1 queen-size bed, shower.  
Approximately 151–233 sq. ft.

**K**

**Large or Standard:** 2 lower beds convertible to 1 queen-size bed, shower.  
Approximately 151–233 sq. ft.

## DECK 1 – MAIN DECK

Staterooms 1001–1127

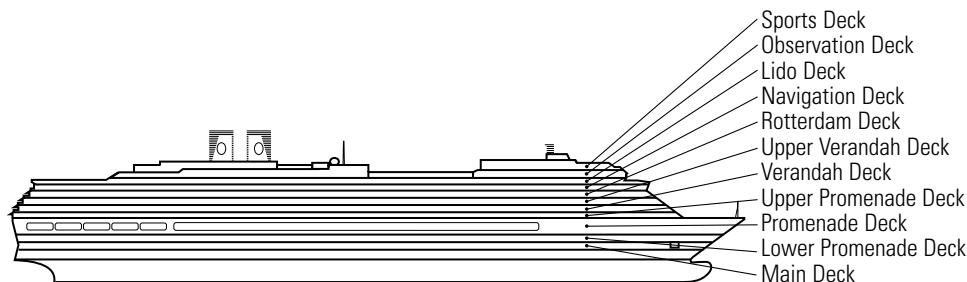
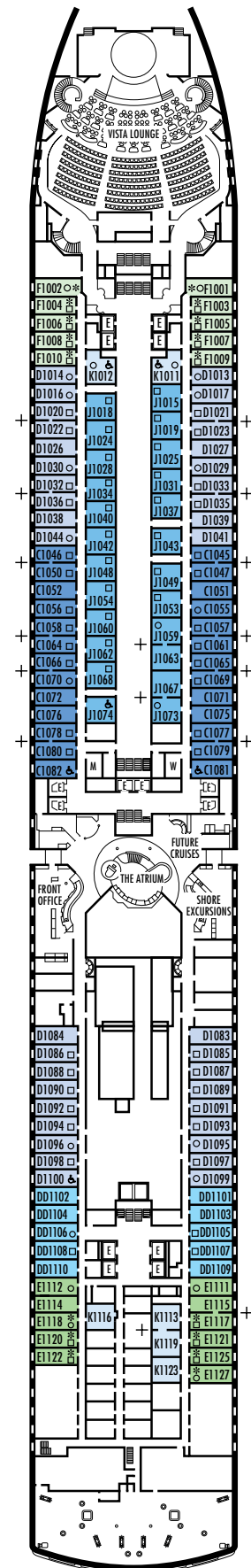

## ms Oosterdam

### DECK PLANS & STATEROOMS

The deck plans are color-coded by category of stateroom, and the category letter precedes the stateroom number in each room. All staterooms are equipped with flat-panel television, DVD player, mini-bar, mini-safe, data port, telephone and multichannel music.

**Important Note:** Not all staterooms within each category have the same furniture configuration and/or facilities. Appropriate symbols within the rooms on the deck plans describe differences from the stateroom descriptions below.

All information is subject to change.

#### STATEROOM SYMBOL LEGEND

- Triple (2 lower beds, 1 sofa bed)
- Quad (2 lower beds, 1 sofa bed, 1 upper)
- △ Partial sea view
- × Fully obstructed view
- + Connecting rooms
- \* Shower only
- ♣ Single sink vanity
- ◆ Staterooms have solid steel verandah railings instead of clear-view Plexiglas® railings
- ♿ Suites SY8068, SC6175, SC6164, SY5002 & SY5001 are wheelchair accessible, bathtub and roll-in shower. Suite SS6108 and staterooms I-8037, VA8032, VA8031, VA6049, VB6004, VB6003, VA5140, VA5137, VA5054, VA5051, VA4132, VA4131, H4090, H4089, VA4052, VA4051, D1100, C1082, C1081, J1074, K1012 & K1011 are wheelchair accessible, roll-in shower only.

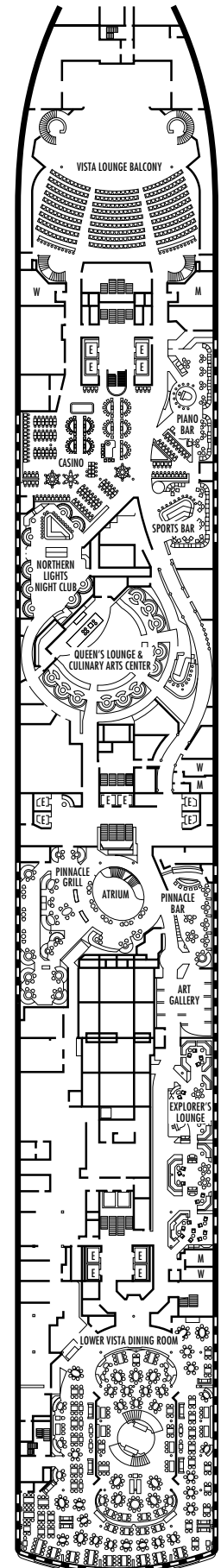
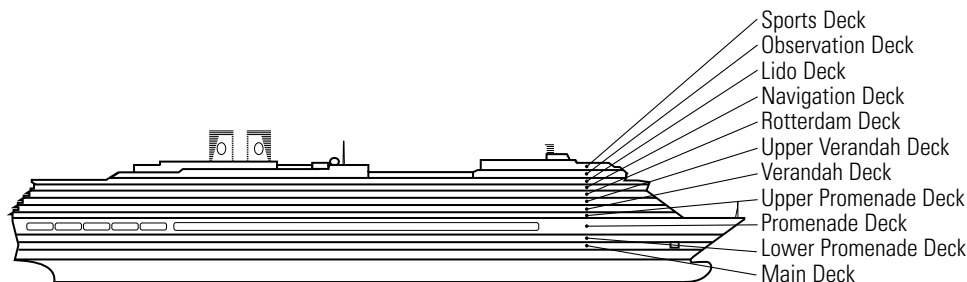

# ms Oosterdam

## DECK PLANS & STATEROOMS

The deck plans are color-coded by category of stateroom, and the category letter precedes the stateroom number in each room. All staterooms are equipped with flat-panel television, DVD player, mini-bar, mini-safe, data port, telephone and multichannel music.

**Important Note:** Not all staterooms within each category have the same furniture configuration and/or facilities. Appropriate symbols within the rooms on the deck plans describe differences from the stateroom descriptions below.

All information is subject to change.

### STATEROOM SYMBOL LEGEND

- Triple (2 lower beds, 1 sofa bed)
- Quad (2 lower beds, 1 sofa bed, 1 upper)
- △ Partial sea view
- × Fully obstructed view
- + Connecting rooms
- \* Shower only
- ♣ Single sink vanity
- ◆ Staterooms have solid steel verandah railings instead of clear-view Plexiglas® railings
- ♿ Suites SY8068, SC6175, SC6164, SY5002 & SY5001 are wheelchair accessible, bathtub and roll-in shower. Suite SS6108 and staterooms I-8037, VA8032, VA8031, VA6049, VB6004, VB6003, VA5140, VA5137, VA5054, VA5051, VA4132, VA4131, H4090, H4089, VA4052, VA4051, D1100, C1082, C1081, J1074, K1012 & K1011 are wheelchair accessible, roll-in shower only.

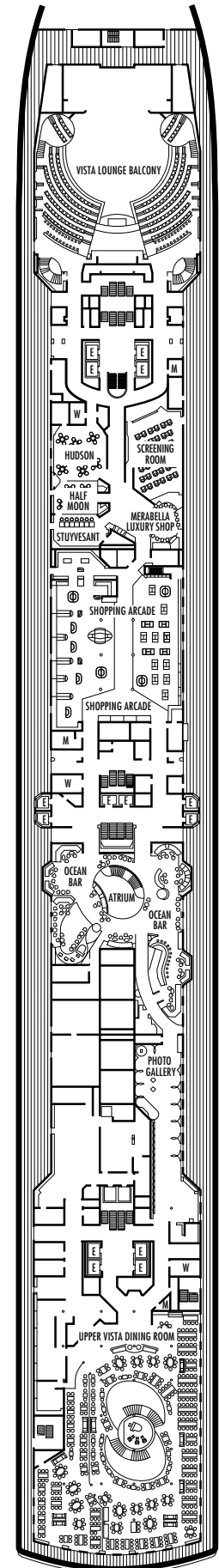
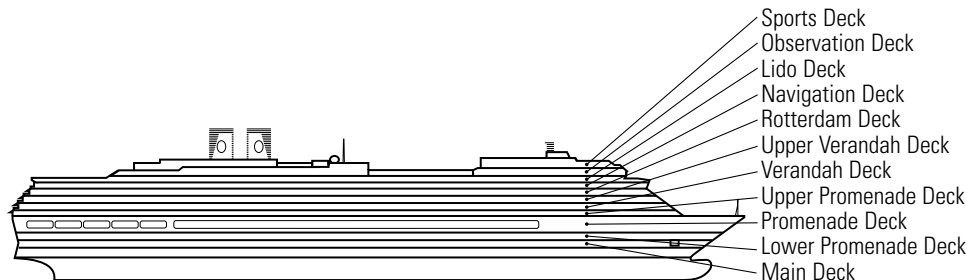

# ms Oosterdam

## DECK PLANS & STATEROOMS

The deck plans are color-coded by category of stateroom, and the category letter precedes the stateroom number in each room. All staterooms are equipped with flat-panel television, DVD player, mini-bar, mini-safe, data port, telephone and multichannel music.

**Important Note:** Not all staterooms within each category have the same furniture configuration and/or facilities. Appropriate symbols within the rooms on the deck plans describe differences from the stateroom descriptions below.

All information is subject to change.

### STATEROOM SYMBOL LEGEND

- Triple (2 lower beds, 1 sofa bed)
- Quad (2 lower beds, 1 sofa bed, 1 upper)
- △ Partial sea view
- × Fully obstructed view
- + Connecting rooms
- \* Shower only
- ♣ Single sink vanity
- ◆ Staterooms have solid steel verandah railings instead of clear-view Plexiglas® railings
- ♿ Suites SY8068, SC6175, SC6164, SY5002 & SY5001 are wheelchair accessible, bathtub and roll-in shower. Suite SS6108 and staterooms I-8037, VA8032, VA8031, VA6049, VB6004, VB6003, VA5140, VA5137, VA5054, VA5051, VA4132, VA4131, H4090, H4089, VA4052, VA4051, D1100, C1082, C1081, J1074, K1012 & K1011 are wheelchair accessible, roll-in shower only.

### VERANDAH SUITES

#### SB

**Neptune Suites:** 2 lower beds convertible to 1 king-size bed, bathroom with dual sink vanity, full-size whirlpool bath & shower & additional shower stall, large sitting area, dressing room, private verandah, 1 sofa bed for 2 persons, floor-to-ceiling windows. Approximately 500–712 sq. ft. including verandah.

### VERANDAH STATEROOMS

#### VA VB VC VE VF VH

**Verandah:** 2 lower beds convertible to 1 queen-size bed, bathtub & shower, sitting area, private verandah, floor-to-ceiling windows. Approximately 212–359 sq. ft. including verandah.

### OCEAN-VIEW STATEROOMS

#### D

**Large:** 2 lower beds convertible to 1 queen-size bed, bathtub & shower. Approximately 174–180 sq. ft.

#### G H HH

**Large:** 2 lower beds convertible to 1 queen-size bed, bathtub & shower. All G-category staterooms have partial sea views. All H- & HH-category staterooms have fully obstructed views. Approximately 174–180 sq. ft.

### INTERIOR STATEROOMS

#### K

**Large or Standard:** 2 lower beds convertible to 1 queen-size bed, shower. Approximately 151–233 sq. ft.

#### L N

**Standard:** 2 lower beds convertible to 1 queen-size bed, shower. Approximately 151–233 sq. ft.

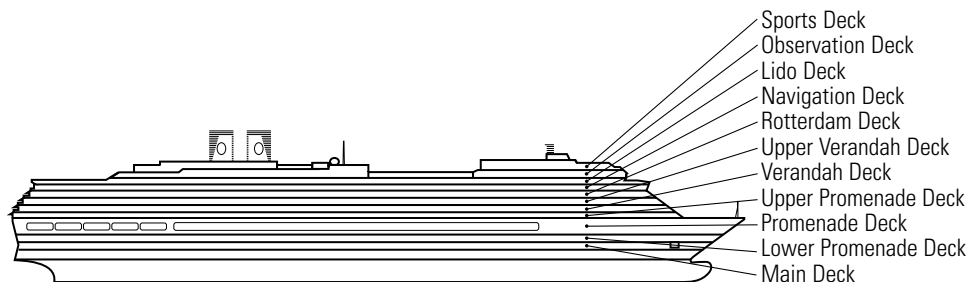
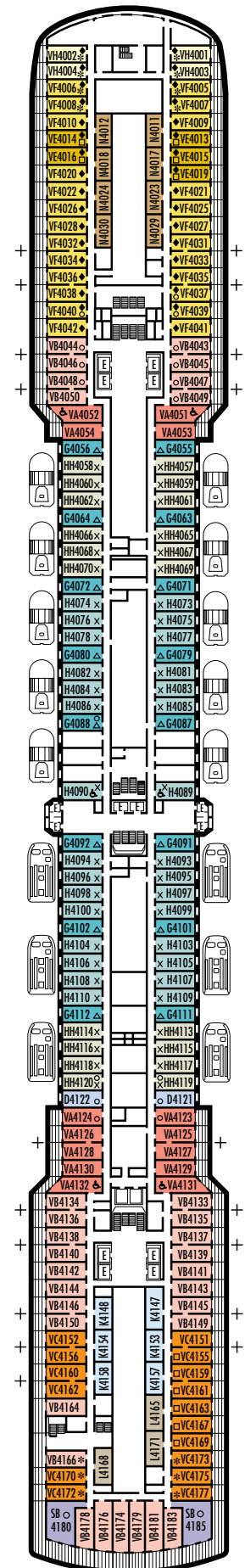

# ms Oosterdam

## DECK PLANS & STATEROOMS

The deck plans are color-coded by category of stateroom, and the category letter precedes the stateroom number in each room. All staterooms are equipped with flat-panel television, DVD player, mini-bar, mini-safe, data port, telephone and multichannel music.

**Important Note:** Not all staterooms within each category have the same furniture configuration and/or facilities. Appropriate symbols within the rooms on the deck plans describe differences from the stateroom descriptions below.

All information is subject to change.

### STATEROOM SYMBOL LEGEND

- Triple (2 lower beds, 1 sofa bed)
- Quad (2 lower beds, 1 sofa bed, 1 upper)
- △ Partial sea view
- X Fully obstructed view
- + Connecting rooms
- \* Shower only
- ♠ Single sink vanity
- ◆ Staterooms have solid steel verandah railings instead of clear-view Plexiglas® railings
- ♿ Suites SY8068, SC6175, SC6164, SY5002 & SY5001 are wheelchair accessible, bathtub and roll-in shower. Suite SS6108 and staterooms I-8037, VA8032, VA8031, VA6049, VB6004, VB6003, VA5140, VA5137, VA5054, VA5051, VA4132, VA4131, H4090, H4089, VA4052, VA4051, D1100, C1082, C1081, J1074, K1012 & K1011 are wheelchair accessible, roll-in shower only.

### VERANDAH SUITES

#### SB

**Neptune Suites:** 2 lower beds convertible to 1 king-size bed, bathroom with dual sink vanity, full-size whirlpool bath & shower & additional shower stall, large sitting area, dressing room, private verandah, 1 sofa bed for 2 persons, floor-to-ceiling windows.  
Approximately 500–712 sq. ft. including verandah.

#### SY

**Signature Suites:** 2 lower beds convertible to 1 queen-size bed, bathroom with dual sink vanity, full-size whirlpool bath & shower & additional shower stall, large sitting area, private verandah, 1 sofa bed for 1 person, floor-to-ceiling windows.  
Approximately 372–384 sq. ft. including verandah.

### VERANDAH STATEROOMS

#### VA VB VC

**Verandah:** 2 lower beds convertible to 1 queen-size bed, bathtub & shower, sitting area, private verandah, floor-to-ceiling windows.  
Approximately 212–359 sq. ft. including verandah.

### INTERIOR STATEROOMS

#### K

**Large or Standard:** 2 lower beds convertible to 1 queen-size bed, shower.  
Approximately 151–233 sq. ft.

#### L

**Standard:** 2 lower beds convertible to 1 queen-size bed, shower.  
Approximately 151–233 sq. ft.

**NOTE: Connecting staterooms VB5046 & VB5048, VB5043 & VB5045, VB5146 & VB5148, VB5143 & VB5145, VC5160 & VC5162, VC5157 & VC5159, VC5168 & VC5170, VC5163 & VC5167 are not available until April 18, 2016.**

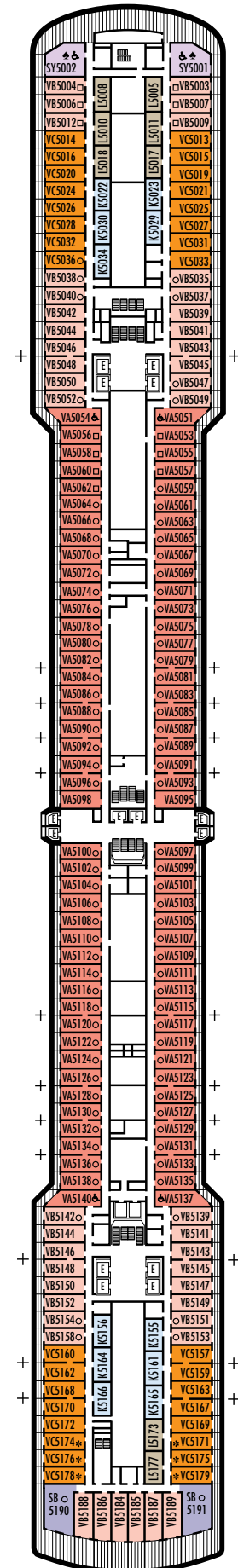
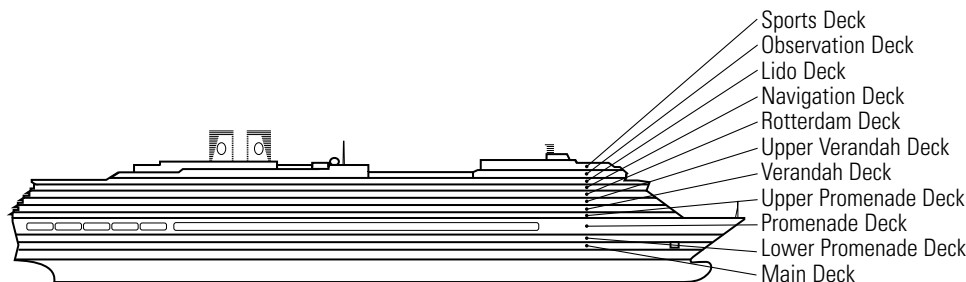



# ms Oosterdam

## DECK PLANS & STATEROOMS

The deck plans are color-coded by category of stateroom, and the category letter precedes the stateroom number in each room. All staterooms are equipped with flat-panel television, DVD player, mini-bar, mini-safe, data port, telephone and multichannel music.

**Important Note:** Not all staterooms within each category have the same furniture configuration and/or facilities. Appropriate symbols within the rooms on the deck plans describe differences from the stateroom descriptions below.

All information is subject to change.

### STATEROOM SYMBOL LEGEND

- Triple (2 lower beds, 1 sofa bed)
- Quad (2 lower beds, 1 sofa bed, 1 upper)
- △ Partial sea view
- × Fully obstructed view
- + Connecting rooms
- \* Shower only
- ♣ Single sink vanity
- ◆ Staterooms have solid steel verandah railings instead of clear-view Plexiglas® railings
- ♿ Suites SY8068, SC6175, SC6164, SY5002 & SY5001 are wheelchair accessible, bathtub and roll-in shower. Suite SS6108 and staterooms I-8037, VA8032, VA8031, VA6049, VB6004, VB6003, VA5140, VA5137, VA5054, VA5051, VA4132, VA4131, H4090, H4089, VA4052, VA4051, D1100, C1082, C1081, J1074, K1012 & K1011 are wheelchair accessible, roll-in shower only.

### VERANDAH SUITES

**SB SC**

**Neptune Suites:** 2 lower beds convertible to 1 king-size bed, bathroom with dual sink vanity, full-size whirlpool bath & shower & additional shower stall, large sitting area, dressing room, private verandah, 1 sofa bed for 2 persons, floor-to-ceiling windows. Approximately 500–712 sq. ft. including verandah.

**SS**

**Signature Suites:** 2 lower beds convertible to 1 queen-size bed, bathroom with dual sink vanity, full-size whirlpool bath & shower & additional shower stall, large sitting area, private verandah, 1 sofa bed for 1 person, floor-to-ceiling windows. Approximately 372–384 sq. ft. including verandah.

### VERANDAH STATEROOMS

**VA VB VC VD**

**Verandah:** 2 lower beds convertible to 1 queen-size bed, bathtub & shower, sitting area, private verandah, floor-to-ceiling windows. Approximately 213–359 sq. ft. including verandah.

### OCEAN-VIEW STATEROOMS

**F**

**Large:** 2 lower beds convertible to 1 queen-size bed, bathtub & shower. Approximately 174–180 sq. ft.

### INTERIOR STATEROOMS

**I K**

**Large or Standard:** 2 lower beds convertible to 1 queen-size bed, shower. Approximately 151–233 sq. ft.

**L**

**Standard:** 2 lower beds convertible to 1 queen-size bed, shower. Approximately 151–233 sq. ft.

**NOTE: Connecting staterooms VC6110 & VC6112, VC6119 & VC6121, VC6114 & VC6116, VC6123 & VC6125, VC6122 & VC6128, VC6133 & VC6137, VD6132 & VD6136, VD6141 & VD6145 are not available until April 18, 2016.**

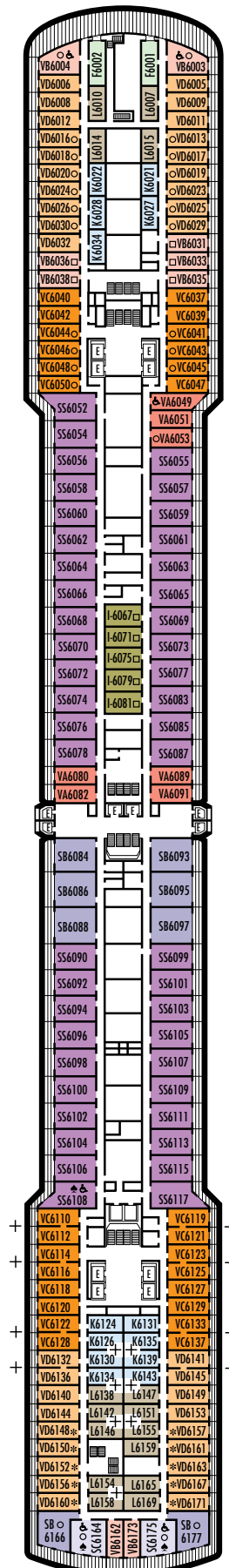
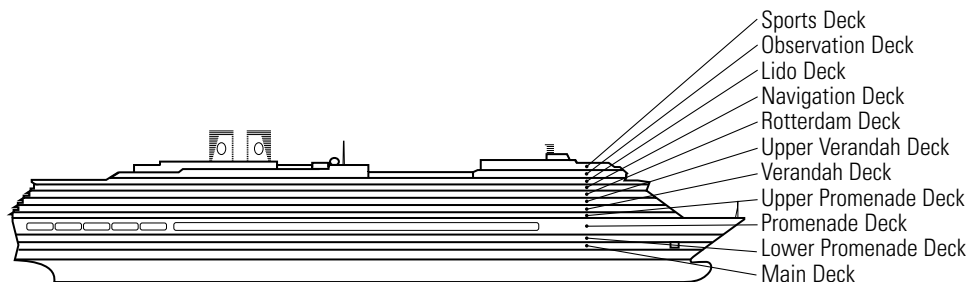

# ms Oosterdam

## DECK PLANS & STATEROOMS

The deck plans are color-coded by category of stateroom, and the category letter precedes the stateroom number in each room. All staterooms are equipped with flat-panel television, DVD player, mini-bar, mini-safe, data port, telephone and multichannel music.

**Important Note:** Not all staterooms within each category have the same furniture configuration and/or facilities. Appropriate symbols within the rooms on the deck plans describe differences from the stateroom descriptions below.

All information is subject to change.

### STATEROOM SYMBOL LEGEND

- Triple (2 lower beds, 1 sofa bed)
- Quad (2 lower beds, 1 sofa bed, 1 upper)
- △ Partial sea view
- X Fully obstructed view
- + Connecting rooms
- \* Shower only
- ♠ Single sink vanity
- ◆ Staterooms have solid steel verandah railings instead of clear-view Plexiglas® railings
- ♿ Suites SY8068, SC6175, SC6164, SY5002 & SY5001 are wheelchair accessible, bathtub and roll-in shower. Suite SS6108 and staterooms I-8037, VA8032, VA8031, VA6049, VB6004, VB6003, VA5140, VA5137, VA5054, VA5051, VA4132, VA4131, H4090, H4089, VA4052, VA4051, D1100, C1082, C1081, J1074, K1012 & K1011 are wheelchair accessible, roll-in shower only.

### VERANDAH SUITES

**PS**  
**Pinnacle Suites:** Bedroom with 1 king-size bed, oversized whirlpool bath & shower & additional shower stall, living room, dining room, dressing room, private verandah with whirlpool, pantry, 1 sofa bed for 2 persons, microwave, refrigerator, guest toilet, private stereo system, floor-to-ceiling windows.  
Approximately 1,150 sq. ft. including verandah.

**SA SB SC**  
**Neptune Suites:** 2 lower beds convertible to 1 king-size bed, bathroom with dual sink vanity, full-size whirlpool bath & shower & additional shower stall, large sitting area, dressing room, private verandah, 1 sofa bed for 2 persons, floor-to-ceiling windows.  
Approximately 500–712 sq. ft. including verandah.

### VERANDAH STATEROOMS

**VB VD VE**  
**Verandah:** 2 lower beds convertible to 1 queen-size bed, bathtub & shower, sitting area, private verandah, floor-to-ceiling windows.  
Approximately 212–359 sq. ft. including verandah.

### INTERIOR STATEROOMS

**I**  
**Large or Standard:** 2 lower beds convertible to 1 queen-size bed, shower.  
Approximately 151–233 sq. ft.

**L M**  
**Standard:** 2 lower beds convertible to 1 queen-size bed, shower.  
Approximately 151–233 sq. ft.

**NOTE: Connecting staterooms VD7092 & VD7094, VD7097 & VD7099, VD7102 & VD7106, VD7107 & VD7111 are not available until April 18, 2016.**

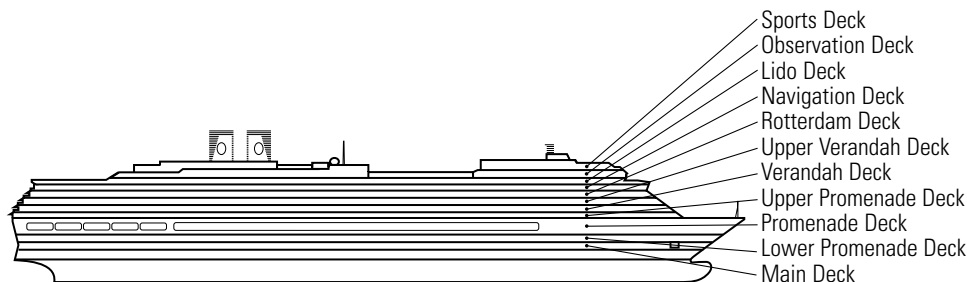
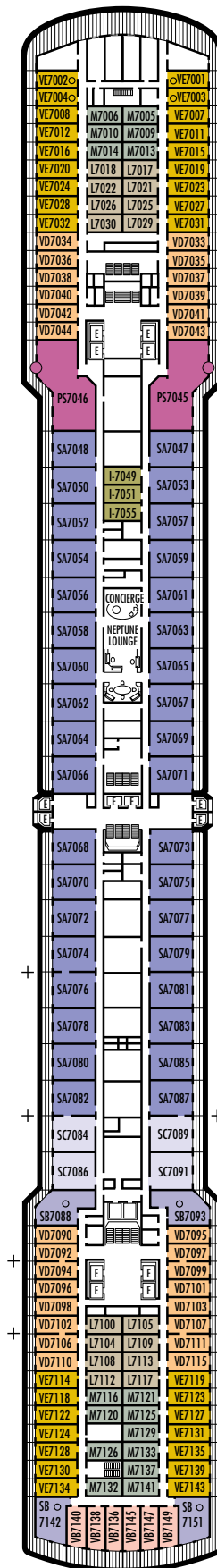

# ms Oosterdam

## DECK PLANS & STATEROOMS

The deck plans are color-coded by category of stateroom, and the category letter precedes the stateroom number in each room. All staterooms are equipped with flat-panel television, DVD player, mini-bar, mini-safe, data port, telephone and multichannel music.

**Important Note:** Not all staterooms within each category have the same furniture configuration and/or facilities. Appropriate symbols within the rooms on the deck plans describe differences from the stateroom descriptions below.

All information is subject to change.

### STATEROOM SYMBOL LEGEND

- Triple (2 lower beds, 1 sofa bed)
- Quad (2 lower beds, 1 sofa bed, 1 upper)
- △ Partial sea view
- X Fully obstructed view
- + Connecting rooms
- \* Shower only
- ♠ Single sink vanity
- ◆ Staterooms have solid steel verandah railings instead of clear-view Plexiglas® railings
- ♿ Suites SY8068, SC6175, SC6164, SY5002 & SY5001 are wheelchair accessible, bathtub and roll-in shower. Suite SS6108 and staterooms I-8037, VA8032, VA8031, VA6049, VB6004, VB6003, VA5140, VA5137, VA5054, VA5051, VA4132, VA4131, H4090, H4089, VA4052, VA4051, D1100, C1082, C1081, J1074, K1012 & K1011 are wheelchair accessible, roll-in shower only.

### VERANDAH SUITES

**SB**  
**Neptune Suites:** 2 lower beds convertible to 1 king-size bed, bathroom with dual sink vanity, full-size whirlpool bath & shower & additional shower stall, large sitting area, dressing room, private verandah, 1 sofa bed for 2 persons, floor-to-ceiling windows.  
Approximately 500–712 sq. ft. including verandah.

**SY SZ**  
**Signature Suites:** 2 lower beds convertible to 1 queen-size bed, bathroom with dual sink vanity, full-size whirlpool bath & shower & additional shower stall, large sitting area, private verandah, 1 sofa bed for 1 person, floor-to-ceiling windows.  
Approximately 372–384 sq. ft. including verandah.

### VERANDAH STATEROOMS

**VA VC VE VF**  
**Verandah:** 2 lower beds convertible to 1 queen-size bed, bathtub & shower, sitting area, private verandah, floor-to-ceiling windows.  
Approximately 212–359 sq. ft. including verandah.

### INTERIOR STATEROOMS

**I MM**  
**Large or Standard:** 2 lower beds convertible to 1 queen-size bed, shower.  
Approximately 151–233 sq. ft.

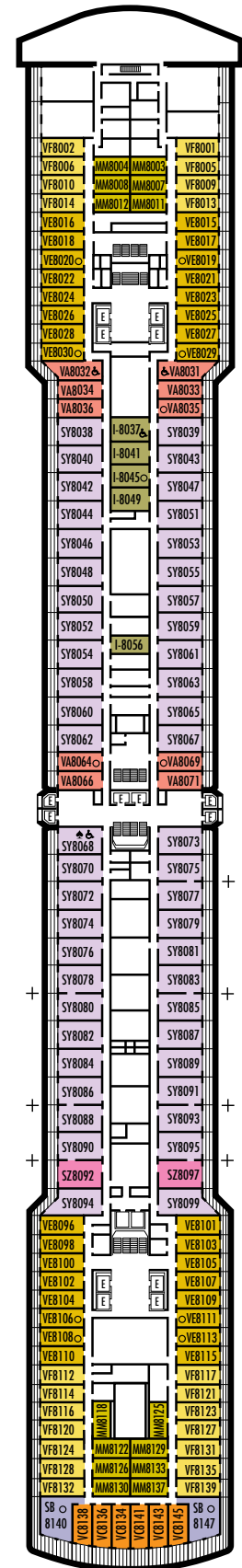
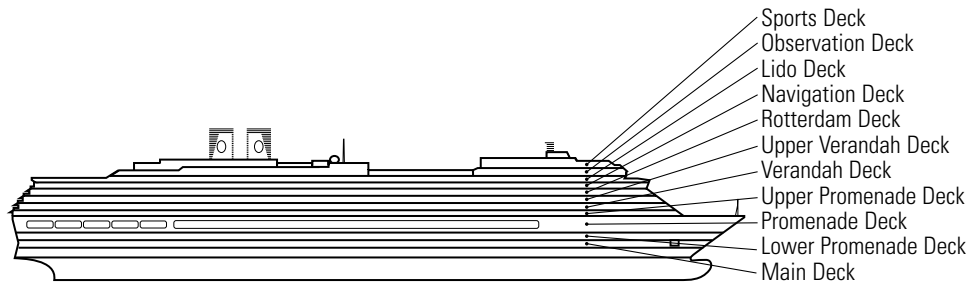



# ms Oosterdam

## DECK PLANS & STATEROOMS

The deck plans are color-coded by category of stateroom, and the category letter precedes the stateroom number in each room. All staterooms are equipped with flat-panel television, DVD player, mini-bar, mini-safe, data port, telephone and multichannel music.

**Important Note:** Not all staterooms within each category have the same furniture configuration and/or facilities. Appropriate symbols within the rooms on the deck plans describe differences from the stateroom descriptions below.

All information is subject to change.

### STATEROOM SYMBOL LEGEND

- Triple (2 lower beds, 1 sofa bed)
- Quad (2 lower beds, 1 sofa bed, 1 upper)
- △ Partial sea view
- × Fully obstructed view
- + Connecting rooms
- \* Shower only
- ♣ Single sink vanity
- ◆ Staterooms have solid steel verandah railings instead of clear-view Plexiglas® railings
- ♿ Suites SY8068, SC6175, SC6164, SY5002 & SY5001 are wheelchair accessible, bathtub and roll-in shower. Suite SS6108 and staterooms I-8037, VA8032, VA8031, VA6049, VB6004, VB6003, VA5140, VA5137, VA5054, VA5051, VA4132, VA4131, H4090, H4089, VA4052, VA4051, D1100, C1082, C1081, J1074, K1012 & K1011 are wheelchair accessible, roll-in shower only.

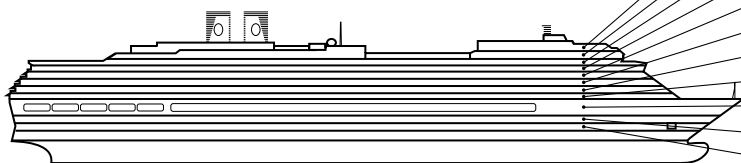

- Sports Deck
- Observation Deck
- Lido Deck
- Navigation Deck
- Rotterdam Deck
- Upper Verandah Deck
- Verandah Deck
- Upper Promenade Deck
- Promenade Deck
- Lower Promenade Deck
- Main Deck

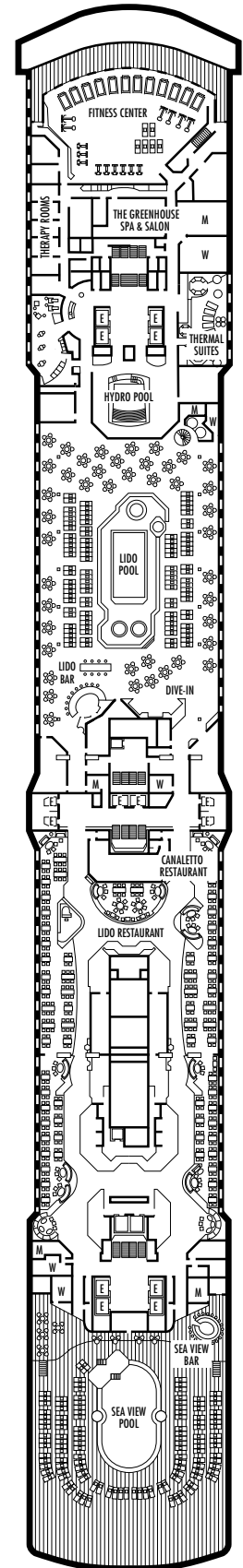

# ms Oosterdam

## DECK PLANS & STATEROOMS

The deck plans are color-coded by category of stateroom, and the category letter precedes the stateroom number in each room. All staterooms are equipped with flat-panel television, DVD player, mini-bar, mini-safe, data port, telephone and multichannel music.

**Important Note:** Not all staterooms within each category have the same furniture configuration and/or facilities. Appropriate symbols within the rooms on the deck plans describe differences from the stateroom descriptions below.

All information is subject to change.

### STATEROOM SYMBOL LEGEND

- Triple (2 lower beds, 1 sofa bed)
- Quad (2 lower beds, 1 sofa bed, 1 upper)
- △ Partial sea view
- × Fully obstructed view
- + Connecting rooms
- \* Shower only
- ♣ Single sink vanity
- ◆ Staterooms have solid steel verandah railings instead of clear-view Plexiglas® railings
- ♿ Suites SY8068, SC6175, SC6164, SY5002 & SY5001 are wheelchair accessible, bathtub and roll-in shower. Suite SS6108 and staterooms I-8037, VA8032, VA8031, VA6049, VB6004, VB6003, VA5140, VA5137, VA5054, VA5051, VA4132, VA4131, H4090, H4089, VA4052, VA4051, D1100, C1082, C1081, J1074, K1012 & K1011 are wheelchair accessible, roll-in shower only.

**NOTE:** These staterooms are not available until April 18, 2016

### VERANDAH STATEROOMS

**VB**

**Verandah:** 2 lower beds convertible to 1 queen-size bed, bathtub & shower, sitting area, private verandah, floor-to-ceiling windows. Approximately 212–359 sq. ft including verandah.

### INTERIOR STATEROOMS

**K**

**Large or Standard:** 2 lower beds convertible to 1 queen-size bed, shower. Approximately 151–233 sq. ft.

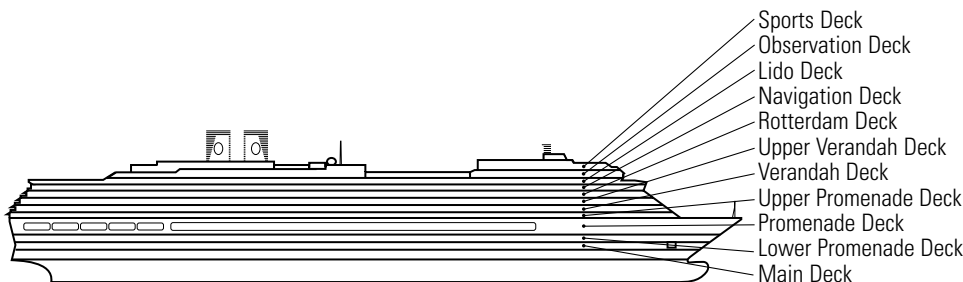
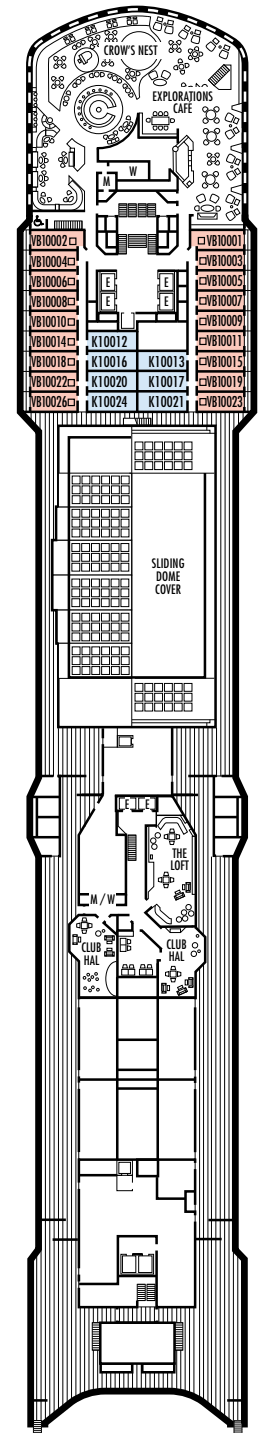

# ms Oosterdam

## DECK PLANS & STATEROOMS

The deck plans are color-coded by category of stateroom, and the category letter precedes the stateroom number in each room. All staterooms are equipped with flat-panel television, DVD player, mini-bar, mini-safe, data port, telephone and multichannel music.

**Important Note:** Not all staterooms within each category have the same furniture configuration and/or facilities. Appropriate symbols within the rooms on the deck plans describe differences from the stateroom descriptions below.

All information is subject to change.

### STATEROOM SYMBOL LEGEND

- Triple (2 lower beds, 1 sofa bed)
- Quad (2 lower beds, 1 sofa bed, 1 upper)
- △ Partial sea view
- × Fully obstructed view
- + Connecting rooms
- \* Shower only
- ♣ Single sink vanity
- ◆ Staterooms have solid steel verandah railings instead of clear-view Plexiglas® railings
- ♿ Suites SY8068, SC6175, SC6164, SY5002 & SY5001 are wheelchair accessible, bathtub and roll-in shower. Suite SS6108 and staterooms I-8037, VA8032, VA8031, VA6049, VB6004, VB6003, VA5140, VA5137, VA5054, VA5051, VA4132, VA4131, H4090, H4089, VA4052, VA4051, D1100, C1082, C1081, J1074, K1012 & K1011 are wheelchair accessible, roll-in shower only.

**NOTE:** Retreat area and cabanas are not available until April 18, 2016

