

ACR COPPER TUBES
12' LONG

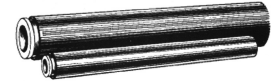

Tube is manufactured in accordance with ASTM B88 Type L. Cleaned in accordance with ASTM B280.

Order No.	Outside Dia.	Wall Thicknes	Wt. per Length	Price
1/4ACR	1/4"	0.030"	0.96 lb.	\$13.10
3/8ACR	3/8"	0.030"	1.51 lbs.	\$14.78
1/2ACR	1/2"	0.035"	2.38 lbs.	\$22.18
5/8ACR	5/8"	0.040"	3.42 lbs.	\$27.89
3/4ACR	3/4"	0.042"	4.34 lbs.	\$36.96
7/8ACR	7/8"	0.045"	5.46 lbs.	\$44.02
1-1/8ACR	1 1/8"	0.050"	7.85 lbs.	\$62.50
1-3/8ACR	1 3/8"	0.055"	10.61 lbs.	\$86.02
1-5/8ACR	1 5/8"	0.060"	13.71 lbs.	\$110.54
2-1/8ACR	2 1/8"	0.070"	21 lbs.	\$174.72
2-5/8ACR	2 5/8"	0.080"	29.73 lbs.	\$244.94
3-1/8ACR	3 1/8"	0.090"	39.89 lbs.	\$342.38
3-5/8ACR	3 5/8"	0.100"	51.48 lbs.	\$434.11
4-1/8ACR	4 1/8"	0.110"	64.56 lbs.	\$561.46

3

MUELLER BRASS CO.

REFRIGERATION SERVICE TUBING
STREAMLINE® SEALED COPPER TUBE

Dehydrated and nitrogen purged, dried thoroughly and packaged in individual cartons. Manufactured in accordance with ASTM B 280 and ANSI B9. 1.

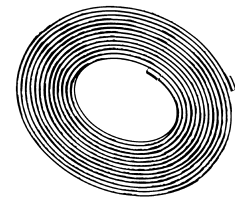

Order No.	Tube OD	Length	Wall Thickness	Safe Working Internal Pressure (psi)				Price
				@ 150°F	@ 250°F	@ 350°F	@ 400°F	
1/8" X 50'	1/8"	50'	.030"	2660	2450	2080	1570	\$31.73
3/16" X 50'	3/16"	50'	.030"	1690	1560	1320	1000	\$36.66
1/4" X 50'	1/4"	50'	.030"	1230	1130	970	720	\$34.98
5/16" X 50'	5/16"	50'	.032"	1040	960	820	610	\$46.90
3/8" X 50'	3/8"	50'	.032"	860	790	670	500	\$51.50
1/2" X 50'	1/2"	50'	.032"	630	580	490	370	\$69.87
5/8" X 50'	5/8"	50'	.035"	540	500	430	320	\$92.67
3/4" X 50'	3/4"	50'	.035"	440	400	350	260	\$112.42
7/8" X 50'	7/8"	50'	.045"	500	460	390	300	\$175.15
1-1/8" X 50'	1 1/8"	50'	.050"	430	400	340	250	\$279.86
1-3/8" X 50'	1 3/8"	50'	.055"	390	360	300	230	\$389.97
1-5/8" X 50'	1 5/8"	50'	.060"	370	340	280	220	\$499.52

CAPILLARY TUBE
FOR REFRIGERATION AND AIR CONDITIONING UNITS 1/20 HP-5 HP

Application chart enclosed, replacement tubes available separately.

Order No.	ID	OD	Length	Price Per Foot
09-TC26	.026"	.072"	16'	\$0.80
09-TC31	.031"	.083"	12'	\$0.79
09-TC36	.036"	.087"	12'	\$0.83
09-TC42	.042"	.093"	12'	\$0.89
09-TC44	.044"	.109"	100'	\$1.04
09-TC49	.049"	.099"	11'	\$1.01
09-TC50	.050"	.114"	100'	\$1.17
09-TC54	.054"	.106"	11'	\$0.99
09-TC64	.064"	.125"	10'	\$1.22
09-TC80	.080"	.145"	10'	\$1.36

SHEET INSULATION, SOLDERS & BRAZING MATERIALS

RUBATEX® SHEET INSULATIONS

Closed cell structure forms a high thermal-efficient insulation to control condensation and to retard vapor transmission. The material can be fabricated to conform to most irregular shapes. Comes in 48" x 36" sheets.

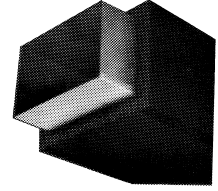

Order No.	Thickness	Size	Ft/Ctn.	Price
3/8X36X48	3/8"	48 x 36	216	\$44.56
1/2X36X48	1/2"	48 x 36	156	\$47.19
5/8X36X48	5/8"	48 x 36	—	\$59.06
3/4X36X48	3/4"	48 x 36	108	\$71.13

INSULATION ADHESIVES AND COATINGS

R-373 should be applied to clean, dry surfaces by either brush or spray. To brush, apply a thin, even coat to both surfaces being bonded. Rubatex 374 provides a tough, flexible semi-gloss finish that is decorative as well as protective, therefore, it is suitable for both indoor and outdoor applications. Available in white only. 374 may be applied by spray as well as brush or a short nap roller. For best results use a two coat application.

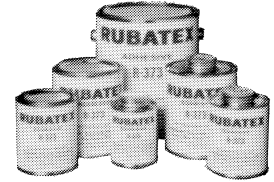

3

INSULATION CONTACT ADHESIVES

Order No.	Can Size	Can Top	Coverage (sq.ft. Per Gallon)	Color	Minimum Dry Time	Price
R320-1/2-PINT	1/2 pt.	Brush top	Up to 200	Yellow	2-4 min.	\$13.42
R320-1-PINT	1 pt.	Brush top	Up to 200	Yellow	2-4 min.	\$20.51
R320-1-QUART	1 quart	Plain	Up to 200	Yellow	2-4 min.	\$32.53
R373-1/2-PINT	1/2 pt.	Brush top	Up to 200	Blue	5-10 min.	\$12.35
R373-1-PINT	1 pt.	Brush top	Up to 200	Blue	5-10 min.	\$18.87
R373-1-QUART	1 quart	Plain	Up to 200	Blue	5-10 min.	\$29.93

Note: Seams freshly jointed with Rubatex R-373 are not affected by the Rubatex 374 Coating.

Caution: These adhesives contain solvents which are flammable and toxic—not to be used near fire or flame or in unventilated areas.

INSULATION PROTECTIVE COATING

Order No.	Product Code	Catalog No.	Can Size	Price
PCG1-GALLON	908-37400	PCG	Gallon	\$117.32

STAY-BRITE® SILVER SOLDER

Lower working temperatures eliminate the weakening of the base metals caused by annealment from high brazing heat. Available in 1, 5, and 20 lb. spools.

SPECIFICATIONS

Composition: Tin & silver

Color: Bright silver, non-oxidizing

Elongation: 48%



Order No.	Diameter ¹	Melting Range		Joint In Tensions	Price
		Solidus	Liquidus		
STAY-BRITE²					
10001	1/8"	430°F	430°F	14,000 psi	\$83.00
STAY-BRITE #8³					
10009	1/8"	430°F	535°F	15,000 psi	\$98.36

1. Comes in other diameters including 3/32" and 3/64".

2. Low temperature solder for all metals except aluminum. Used in refrigeration joints. NSF accepted.

3. Similar to Stay-Brite. Plastic range useful in bridging wider gaps. NSF accepted.

SOLDERS & BRAZING MATERIALS

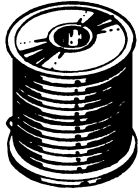

COMMON WIRE SOLDERS

Order No.	Description	Melting Range		Price	Wire Dia.	Unit Size
		Solidus	Liquidus			
10030	95/5 tin-antimony	452°F	464°F	1/8"	1 lb. spool	\$29.73
16000- BRIDGIT	Bridgit® lead free	460°	630°	1/8"	1 lb. spool	\$33.73

Note: Tin-antimony solders are not recommended for use on brass. Lead-bearing solders are not to be used in potable water systems.

3



J.W. HARRIS SAFETY-SILV® BRAZING ALLOYS CADMIUM FREE SILVER SOLDER

Order No.	Silver Content	Size	Dia.	Solidus	Liquidus	Price
SAFETY-SILV® 45T (FORMERLY 1245)						
45T	45%	1 oz. pkg.	1/16"	1,195°F	1,265°F	\$30.24



SILFOS AND SOLDERS

Order No.	Description	Price
15520R1	Stay-Silv, JW Harris, 15% silver content, 3/32" x 20" stick.	\$5.22
60-111	15% silver content Engelhard silfos, 1/8" x 24", per stick.	\$8.33
60-113	15% silver content Engelhard silfos, 3/32" x 24", per stick.	\$5.17
60-131	45% silver content Engelhard 1-ozT, 1/16", cadmium free.	\$24.27
76224	JW Harris flux coated 45% Safety-Silv, 1 stick, 3/32" dia.	\$19.33
76339	JW Harris flux coated 45% Safety-Silv, 1 stick, 1/16" dia.	\$16.62



DYNAFLOW® BRAZING ALLOY FOR ALL COPPER-TO-COPPER AND COPPER-TO-BRASS COOLING APPLICATIONS

Order No.	Size	Description	Solidus	Liquidus	Price
66000	.050" x 1/8" x 20", 1 lb.	Melts, flows and fills like a 15% silver alloy. Use Stay-Silv Flux for brass or bronze applications.	1,190°F	1,465°F	\$2.39

Note: Not recommended for use on the ferrous metals or alloys containing more than 10% Nickel.



SOLDERING AND BRAZING ALLOYS

Order No.	Type	Description	Size	Price
0386-0421	Silverflow	Substitute for 6–15 silver content brazing alloys. Brazing range 1,350–1,500°F, very fluid. Medium temperature brazing alloy. Self-fluxing on copper. Ideally suited for air conditioning, plumbing and electrical connections.	1 lb. bg.	\$37.91
0386-0422	Bronzeflow	Flux coated brazing rod. Low fuming bronze. Range 1,500–1,700°F. Ideal alloy for maintenance repairs on plumbing and heating piping as well as steel materials other than stainless steel, 3/32" dia., 18" length.	1 lb. bg.	\$52.68
0386-0423	Aluma-Weld	Aluminum brazing alloy. Excellent affinity to virtually all aluminum products. Ideal for refrigerant coil and tubing repair, joining of copper to aluminum and aluminum to steel. Kit includes rod and self-cleaning flux.	12 lb. bx.	\$57.92

SOLDERS & BRAZING MATERIALS

STAY-CLEAN® LIQUID FLUX

For copper, brass, stainless, chrome, monel, and all other metals excluding aluminum, magnesium or titanium. Forms joints on galvanized iron without damage to the zinc coating. Use with all low temperature solders including Stay-Brite, 95-5, and tin-lead alloys.

Order No.	Size	Price
40003	16 oz.	\$15.76



STAY-SILV® WHITE BRAZING FLUX

For use with silver brazing alloys on all metals other than aluminum, magnesium or titanium. Effective to 1,600°F.

Order No.	Size	Price
40022	6½ oz. brush cap	\$16.81



3

STAY-CLEAN® PASTE SOLDERING FLUX

For joining copper to copper and copper to brass connections. Meets federal spec. 506C, Type 1, Form A. connections.

Order No.	Size	Price
STAY CLEAN® PASTE		
40027	4 oz. brush cap	\$11.01
BRIDGIT LEAD FREE PASTE		
40057	4 oz. brush cap	\$9.27



Caution: Not recommended for use on electrical or electronic applications.

ACID BRUSHES

C33 SERIES ACID BRUSHES

Ideal for thread sealant, flux and paste solders. The long stiff 100% horsehair bristles are evenly placed and securely crimped into the tinned acid-resisting handles.

Order No.	Description	Quantity	Price
15-C33808	½"(W) medium	10	\$9.43



WELDING AIDS

RAPID COOL DOWN & HEAT BARRIER SPRAY COLD FIRE

Order No.	Description	Price
0386-0560	32 fl. oz. pump spray. Safety & time saving formula for HVACR, plumbing & welding	\$38.88

FLAME-GARD™ REAL FLAME PROTECTION FOR SOLDERING/BRAZING

Order No.	Description	Size	Price
2400	Protects wood, painted, or metal surfaces from the heat and flame of a torch (also your hand).	9" x 12"	\$36.23

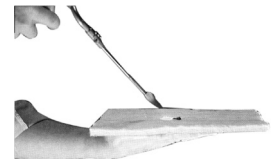

CAPS, COUPLINGS, BUSHINGS & UNIONS

CAPS, COUPLINGS, BUSHINGS & UNIONS

Manufactured in accordance with ANSI B16.22. All sizes given in OD measurements. Nominal I.D. size is 1/8" less than first dimension.

Order No.	Size	Pieces Per Ctn.	Price
CAPS			
W-7004	3/8"	50	\$0.98
W-7006	1/2"	50	\$1.54
W-7007	5/8"	100	\$0.65
W-7008	3/4"	50	\$1.70
W-7009	7/8"	50	\$1.20
W-7011	1 1/8"	50	\$3.22
W-7012	1 3/8"	25	\$4.61
W-7013	1 5/8"	25	\$6.73
W-7014	2 1/8"	—	\$12.30
W-7015	2 5/8"	—	\$39.47
W-7016	3 1/8"	—	\$48.31
W-7017	3 5/8"	—	\$166.31
W-7018	4 1/8"	—	\$102.19

Order No.	Size	Pieces Per Ctn.	Price
COUPLINGS, ROLLED STOP			
W-1000	1/8"	100	\$0.82
W-1001	3/16"	100	\$0.82
W-1003	1/4"	100	\$0.92
W-1006	5/16"	100	\$1.23
W-1009	3/8"	50	\$0.82
W-1017	1/2"	50	\$1.13
W-1022	5/8"	100	\$0.69
W-1028	3/4"	25	\$2.52
W-1034	7/8"	50	\$1.44
W-1047	1 1/8"	25	\$3.35
W-1055	1 3/8"	25	\$5.90
W-1063	1 5/8"	10	\$7.78
W-1072	2 1/8"	—	\$12.96
W-1082	2 5/8"	—	\$27.44
W-1092	3 1/8"	—	\$41.96
W-10100	3 5/8"	—	\$82.15
W-10107	4 1/8"	—	\$98.85

Order No.	1 x 2	Pieces Per Ctn.	Price
REDUCING COUPLINGS			
W-1006	1/4" x 1/8"	50	\$1.23
W-1011	3/8" x 1/4"	50	\$5.59
W-1019	1/2" x 3/8"	50	\$1.81
W-1023	5/8" x 1/2"	50	\$1.70
W-1025	5/8" x 3/8"	50	\$1.70
W-1029	3/4" x 5/8"	100	\$4.11
W-1030	3/4" x 1/2"	100	\$4.11
W-1035	7/8" x 3/4"	100	\$2.93
W-1036	7/8" x 5/8"	50	\$2.45
W-1037	7/8" x 1/2"	50	\$2.92
W-1038	7/8" x 3/8"	50	\$3.25
W-1049	1 1/8" x 7/8"	25	\$5.42
W-1050	1 1/8" x 3/4"	25	\$5.42
W-1051	1 1/8" x 5/8"	25	\$5.42

Order No.	1 x 2	Pieces Per Ctn.	Price
REDUCING COUPLINGS (CONT.)			
W-1056	1 3/8" x 1 1/8"	10	\$8.64
W-1058	1 3/8" x 7/8"	10	\$8.64
W-1060	1 3/8" x 5/8"	10	\$8.64
W-1064	1 5/8" x 1 3/8"	10	\$13.88
W-1065	1 5/8" x 1 1/8"	10	\$13.88
W-1067	1 5/8" x 7/8"	10	\$13.88
W-1073	2 1/8" x 1 5/8"	—	\$21.53
W-1074	2 1/8" x 1 3/8"	—	\$21.53
W-1075	2 1/8" x 1 1/8"	—	\$21.53
W-1083	2 5/8" x 2 1/8"	—	\$47.72
W-1084	2 5/8" x 1 3/8"	—	\$47.72
W-1085	2 5/8" x 1 1/8"	—	\$47.72
W-10110	4 1/8" x 2 5/8"	—	\$125.57

Order No.	Size	Pieces Per Ctn.	Price
REDUCING BUSHINGS			
W-1302	1/4" x 1/8"	50	\$2.04
W-1306	3/8" x 1/4"	50	\$2.04
W-1312	1/2" x 3/8"	50	\$2.34
W-1315	5/8" x 1/2"	50	\$1.98
W-1317	5/8" x 3/8"	50	\$1.98
W-1320	3/4" x 5/8"	100	\$4.58
W-1321	3/4" x 1/2"	100	\$4.58
W-1322	3/4" x 3/8"	100	\$4.58
W-1325	7/8" x 3/4"	100	\$3.27
W-1326	7/8" x 5/8"	50	\$3.03
W-1327	7/8" x 1/2"	50	\$3.03
W-1337	1 1/8" x 7/8"	25	\$4.88
W-1338	1 1/8" x 3/4"	25	\$4.88
W-1339	1 1/8" x 5/8"	25	\$4.88
W-1343	1 3/8" x 1 1/8"	10	\$9.09
W-1345	1 3/8" x 7/8"	10	\$9.09
W-1347	1 3/8" x 5/8"	10	\$9.09
W-1350	1 5/8" x 1 3/8"	10	\$11.68
W-1351	1 5/8" x 1 1/8"	10	\$11.68
W-1353	1 5/8" x 7/8"	10	\$11.68
W-1358	2 1/8" x 1 5/8"	—	\$21.99
W-1359	2 1/8" x 1 3/8"	—	\$21.99
W-1360	2 1/8" x 1 1/8"	—	\$21.99
W-1362	2 1/8" x 7/8"	—	\$21.99
W-1367	2 5/8" x 2 1/8"	—	\$43.36
W-1368	2 5/8" x 1 3/8"	—	\$43.36
W-1370	2 5/8" x 1 1/8"	—	\$43.36
W-1376	3 1/8" x 2 5/8"	—	\$56.76
W-1377	3 1/8" x 2 1/8"	—	\$56.76
W-1381	3 5/8" x 3 1/8"	—	\$88.83
W-1382	3 5/8" x 2 5/8"	—	\$88.83
W-1383	3 5/8" x 2 1/8"	—	\$88.83
W-1387	4 1/8" x 3 1/8"	—	\$114.21
W-1388	4 1/8" x 2 5/8"	—	\$114.21
W-1389	4 1/8" x 2 1/8"	—	\$114.21

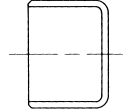

C

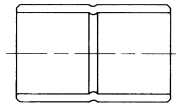

C x C

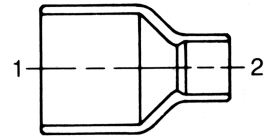

C x C

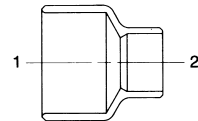

FTG x C

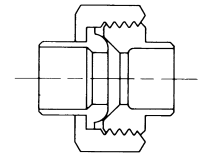

C x C

3

Do not fear the unknown find a way to make it known.

COPPER FITTINGS

Order No.	Size	Pieces Per Ctn.	Price
COUPLINGS, UNION			
W-8001	3/8"	25	\$20.10
W-8002	1/2"	25	\$19.41
W-8003	5/8"	25	\$11.47

Order No.	Size	Pieces Per Ctn.	Price
COUPLINGS, UNION (CONT.)			
W-8004	7/8"	10	\$14.00
W-8005	1 1/8"	10	\$29.23

PLUGS, BENDS, TEES, TRAPS PLUGS, RETURN BENDS, TEES, TRAPS

Manufactured in accordance with ANSI B16.22. All sizes given in OD measurements. Nominal I.D. size is 1/8" less than first dimension.

Order No.	Size	A	B	Pieces Per Ctn.	Price
RETURN BENDS					
W-6020	3/8"	1 1/2"	1 5/16"	25	\$4.71
W-6045	1/2"	4"	2 5/16"	—	\$5.28
W-6032	1/2"	1 1/2"	1"	50	\$5.28
W-6060	5/8"	3"	1 13/16"	25	\$13.67
W-6053	5/8"	1 7/8"	1 1/4"	25	\$13.67
W-6051	5/8"	1 3/16"	1 3/32"	25	\$13.67
W-6073	3/4"	2"	1 3/8"	10	\$37.51
W-6092	7/8"	2 1/2"	1 11/16"	10	\$14.71
W-60111	1 1/8"	3 1/4"	2 3/16"	5	\$33.75
W-60110	1 1/8"	3"	2 1/16"	5	\$33.75
W-60121	1 3/8"	3 3/4"	2 9/16"	5	\$53.13
W-60131	1 5/8"	4 1/2"	3 1/16"	—	\$70.80
W-60140	2 1/8"	5 1/2"	3 29/32"	—	\$195.03

Order No.	Size	A	B	C	Pieces Per Ctn.	Price
TEES						
W-40302	3/16"	—	—	—	50	\$7.27
W-40306	1/4"	5/32"	5/32"	5/32"	100	\$7.27
W-40313	5/16"	9/32"	9/32"	9/32"	50	\$8.52
W-4000	3/8"	13/64"	13/64"	3/16"	50	\$7.27
W-4001	1/2"	17/64"	17/64"	1/4"	50	\$5.95
W-4006	5/8"	21/64"	21/64"	21/64"	50	\$1.59
W-4017	3/4"	13/32"	13/32"	25/64"	25	\$13.68
W-4031	7/8"	19/32"	19/32"	29/64"	25	\$4.38
W-4048	1 1/8"	31/64"	31/64"	9/16"	10	\$13.76
W-4068	1 3/8"	23/32"	23/32"	45/64"	5	\$21.93
W-4084	1 5/8"	53/64"	53/64"	53/64"	5	\$30.35
W-40102	2 1/8"	19/64"	19/64"	19/64"	5	\$51.05
W-40123	2 5/8"	19/16"	19/16"	19/16"	2	\$90.17
W-40152	3 1/8"	1 41/64"	1 41/64"	1 19/32"	2	\$136.25
W-40190	3 5/8"	1 55/64"	1 55/64"	1 55/64"	1	\$352.65
W-40200	4 1/8"	2 1/64"	2 1/64"	2 11/64"	1	\$251.13

Order No.	1 x 2 x 3	A	B	C	Pieces Per Ctn.	Price
REDUCING TEES						
W-4002	1/2" x 1/2" x 3/8"	7/32"	7/32"	9/32"	50	\$10.81
W-4034	7/8" x 7/8" x 1/2"	21/64"	21/64"	55/64"	25	\$4.86
W-4035	7/8" x 7/8" x 3/8"	21/64"	21/64"	19/16"	25	\$5.64
W-4049	1 1/8" x 1 1/8" x 7/8"	15/32"	15/32"	49/64"	10	\$14.05

1. Reducing Outlet
2. Reducing on Run
3. Increasing on branch

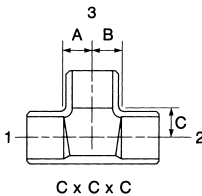
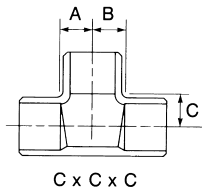
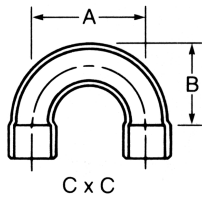

3

Value your resources! Especially Time, Information and People.

PLUGS, BENDS, TEES, TRAPS (cont.)

Order No.	Size	A	B	C	Pieces Per Ctn.	Price
SUCTION LINE P-TRAPS						
W-60999	5/8"	6"	5 1/2"	1 1/2"	100	\$36.86
W-61008	3/4"	5 7/8"	5 3/8"	1 1/2"	100	\$54.94
W-61000	7/8"	5 3/4"	5 1/4"	1 1/2"	50	\$43.61
W-61001	1 1/8"	5 1 9/32"	5 3/32"	1 1/2"	30	\$62.30
W-61002	1 3/8"	6 3/16"	5 9/32"	1 7/8"	4	\$96.18
W-61003	1 5/8"	8 2 1/32"	7 2 9/32"	2 1/2"	1	\$147.61
W-61009	2 1/8"	9 2 9/32"	8 2 1/32"	3"	1	\$302.56

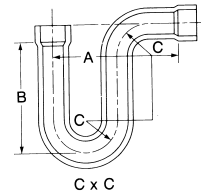

STREAMLINE® WROT PRESSURE FITTINGS—ELBOWS

Manufactured in accordance with ANSI B16.22. All sizes given in OD measurements. Nominal I.D. size is 1/8" less than first dimension.

Order No.	Size	A	Pieces Per Ctn.	Price
45° ELLS				
W-3005	1/4"	3/16"	50	\$6.75
W-3012	3/8"	3/16"	50	\$6.34
W-3021	1/2"	1 9/64"	50	\$5.12
W-3026	5/8"	1 7/64"	50	\$1.66
W-3030	3/4"	5/16"	50	\$9.77
W-3034	7/8"	2 9/64"	25	\$2.88
W-3044	1 1/8"	1 5/32"	25	\$8.87
W-3050	1 3/8"	2 5/32"	10	\$12.26
W-3055	1 5/8"	1 9/16"	10	\$14.63
W-3059	2 1/8"	1 1/4"	10	\$23.96
W-3063	2 5/8"	1 9/16"	5	\$56.23
W-3067	3 1/8"	1 2 1/32"	2	\$73.47
W-3070	3 5/8"	1 3/4"	2	\$126.23

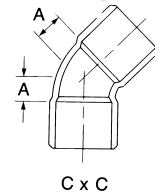

Order No.	Size	A	B	Pieces Per Ctn.	Price
45° STREET ELLS					
W-3312	3/8"	9/16"	3/16"	100	\$24.21
W-3321	1/2"	2 1/32"	1 3/64"	100	\$6.54
W-3326	5/8"	1 3/16"	1 7/64"	50	\$1.90
W-3330	3/4"	1"	5/16"	50	\$16.88
W-3334	7/8"	1 1 1/64"	2 3/64"	25	\$3.69
W-3344	1 1/8"	1 7/16"	1 5/32"	25	\$11.86
W-3350	1 3/8"	1 1 3/16"	2 5/32"	10	\$14.47
W-3355	1 5/8"	2 3/64"	1 5/16"	10	\$18.77
W-3359	2 1/8"	2 4 1/64"	1 1/4"	5	\$28.15

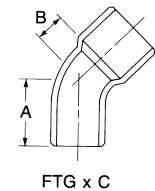

Order No.	Size	A	B	Pieces Per Ctn.	Price
90° ELLS, SHORT RADIUS					
W-2003	1/4"	3/8"	3/8"	50	\$3.59
W-2009	3/8"	3/8"	3/8"	50	\$3.33
W-2017	1/2"	1/2"	1/2"	50	\$3.33
W-2022	5/8"	1 9/32"	1 9/32"	100	\$2.62
W-2028	3/4"	7/8"	7/8"	50	\$7.12
W-2034	7/8"	1 3/16"	1 3/16"	50	\$4.66
W-2047	1 1/8"	1 1/16"	1 1/16"	25	\$6.29
W-2084	1 3/8"	1 1/16"	1 1/16"	25	\$9.94
W-2085	1 5/8"	1 7/32"	1 7/32"	10	\$15.08
W-2086	2 1/8"	1 9/16"	1 9/16"	10	\$26.95
W-2087	2 5/8"	1 1 3/16"	1 1 3/16"	5	\$53.13
W-2088	3 1/8"	2 1/16"	2 1/16"	5	\$67.46
W-2089	3 5/8"	2 1 3/32"	2 1 3/32"	2	\$198.37
W-2090	4 1/8"	2 2 3/32"	2 2 3/32"	2	\$153.62

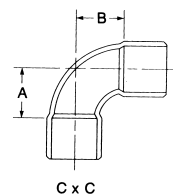

COPPER FITTINGS

Order No.	Size	A	B	Pieces Per Ctn.	Price
90° ELLS, LONG RADIUS					
W-2701	3/16"	13/32"	13/32"	100	\$7.78
W-2715	1/4"	1/2"	1/2"	50	\$7.29
W-2710	9/16"	9/16"	9/16"	50	\$7.23
W-2716	3/8"	3/4"	3/4"	50	\$4.99
W-2717	1/2"	3/4"	3/4"	50	\$6.02
W-2722	5/8"	7/8"	7/8"	50	\$5.37
W-2728	3/4"	1 1/8"	1 1/8"	50	\$6.36
W-2734	7/8"	1 3/16"	1 3/16"	25	\$8.06
W-2747	1 1/8"	1 1/2"	1 1/2"	10	\$10.61
W-2055	1 3/8"	1 7/8"	1 7/8"	10	\$17.03
W-2063	1 5/8"	2 1/4"	2 1/4"	5	\$22.67
W-2072	2 1/8"	2 7/8"	2 7/8"	5	\$53.58
W-2082	2 5/8"	3 11/16"	3 11/16"	5	\$104.86
W-2092	3 1/8"	4 5/8"	4 5/8"	2	\$131.58
W-2093	3 5/8"	5 1/4"	5 1/4"	1	\$539.66
W-2095	4 1/8"	5 7/8"	5 7/8"	1	\$380.03

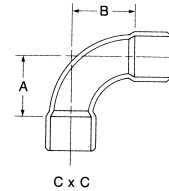

3

Order No.	Size	A	B	Pieces Per Ctn.	Price
90° STREET ELLS, SHORT RADIUS					
W-2305	1/4"	49/64"	3/8"	50	\$6.36
W-2312	3/8"	3/4"	3/8"	50	\$5.85
W-2321	1/2"	15/16"	1/2"	50	\$3.41
W-2326	5/8"	1 5/32"	19/32"	50	\$3.88
W-2330	3/4"	1 9/16"	7/8"	25	\$7.29
W-2334	7/8"	1 5/8"	1 3/16"	25	\$6.33
W-2344	1 1/8"	2 1/32"	1 1/16"	25	\$9.77
W-2384	1 3/8"	2 5/64"	1 1/16"	25	\$14.03
W-2385	1 5/8"	2 3/8"	1 7/32"	10	\$18.38
W-2386	2 1/8"	2 31/32"	1 9/16"	10	\$41.02
W-2387	2 5/8"	3 11/32"	1 13/16"	5	\$74.81
W-2388	3 1/8"	3 29/32"	2 1/16"	2	\$101.52
W-2389	3 5/8"	4 3/8"	2 13/32"	1	\$487.57
W-2390	4 1/8"	4 19/16"	2 23/32"	2	\$235.77

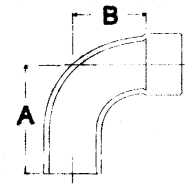

Order No.	Size	A	B	Pieces Per Ctn.	Price
90° STREET ELLS, LONG RADIUS					
W-2809	3/8"	1 1/8"	3/4"	50	\$7.53
W-2817	1/2"	1 3/16"	3/4"	50	\$12.47
W-2822	5/8"	1 7/16"	7/8"	50	\$8.87
W-2828	3/4"	1 13/16"	1 1/8"	25	\$10.45
W-2834	7/8"	2"	1 1/8"	25	\$10.70
W-2847	1 1/8"	2 15/32"	1 1/2"	10	\$17.23
W-2350	1 3/8"	2 29/32"	1 7/8"	10	\$24.33
W-2355	1 5/8"	3 7/16"	2 1/4"	5	\$31.31
W-2359	2 1/8"	4 9/32"	2 7/8"	5	\$58.40
W-2363	2 5/8"	5 7/32"	3 21/32"	5	\$112.21
W-2368	3 1/8"	6 11/32"	4 5/8"	2	\$181.00
W-2393	3 5/8"	7 7/32"	5 1/4"	1	\$641.85
W-2395	4 1/8"	8 3/32"	5 7/8"	1	\$598.44

**Check out our web site at www.independentsupply.com
for current promotions, educational events and
convenient manufactures information.**

45° FLARE NUTS

Order No.	Model No.	Flare	Tube	Pieces Per Ctn.	Price
LONG FORGED NUTS					
N4-4	A-440	1/4"	1/4"	25	\$2.38
N4-5	A-1110	5/16"	5/16"	25	
N4-6	A-441	3/8"	3/8"	25	\$4.49
N4-8	A-442	1/2"	1/2"	10	\$4.21
N4-10	A-1112	5/8"	5/8"	5	\$12.47
N4-12	A-4731	3/4"	3/4"	5	
SHORT FORGED NUTS					
NS4-3	A-5238	3/16"	3/16"	50	
NS4-4	A-5051	1/4"	1/4"	50	\$1.02
NS4-5	A-5239	5/16"	5/16"	25	\$1.74
NS4-6	A-5052	3/8"	3/8"	25	\$1.24
NS4-8	A-5053	1/2"	1/2"	15	\$1.74
NS4-10	A-5157	5/8"	5/8"	10	\$2.49
NS4-12	A-5222	3/4"	3/4"	10	\$4.89
SHORT FORGED REDUCING NUTS					
NRS4-43	A-5132	1/4"	3/16"	10	\$4.93
NRS4-54	A-5247	5/16"	1/4"	10	\$9.09
NRS4-64	A-5140	3/8"	1/4"	25	\$2.38
NRS4-65	A-5282	3/8"	5/16"	10	\$4.77
NRS4-86	A-5141	1/2"	3/8"	15	\$3.00
NRS4-108	A-5228	5/8"	1/2"	15	\$5.80

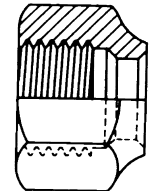
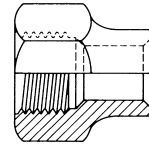

3

45° FLARE FITTINGS—SEALS, GASKETS, ADAPTERS

Order No.	Model No.	Flare	Pieces Per Ctn.	Price
COPPER FLARE SEAL BONNETS				
B1-4	A-414	1/4"	100	\$0.68
B1-6	A-415	3/8"	100	\$0.53
B1-8	A-416	1/2"	100	\$1.02
B1-10	A-485	5/8"	20	\$44.35
COPPER FLARE GASKETS				
B2-4	A-401	1/4"	100	\$7.28
B2-6	A-402	3/8"	100	\$7.38
B2-8	A-403	1/2"	100	\$7.95
B2-10	A-5186	5/8"	50	\$0.68
FLARE PLUGS				
P2-4	A-121	1/4"	15	\$1.34
P2-6	A-122	3/8"	15	\$1.52
P2-8	A-123	1/2"	25	\$19.60
P2-10	A-4536	5/8"	15	\$3.28
FLARE SEAL CAPS				
N5-4	A-4544	1/4"	50	\$0.64
N5-6	A-4545	3/8"	25	\$1.39
N5-8	A-4546	1/2"	25	\$1.72
N5-10	A-4560	5/8"	10	\$2.62

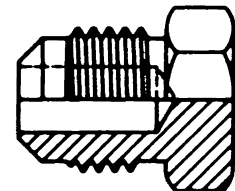
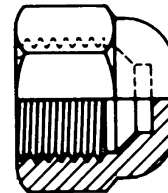
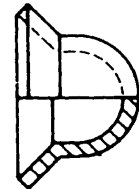

BRASS FITTINGS

45° FLARE FITTINGS—SEALS, GASKETS, ADAPTERS (cont.)

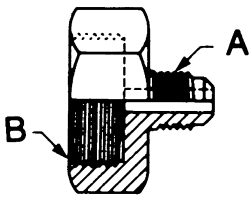

Order No.	Model No.	Flare A	NPSM B	Pieces Per Ctn.	Price
REFRIGERANT DRUM ADAPTERS—FLARE TO INTERNAL STRAIGHT PIPE (NPSM)¹					
K1-1	A-8073	1/4"	3/4"	10	\$10.25
K1-3	A-8274	3/8"	3/4"	10	\$12.87
K1-5	A-8276	1/2"	3/4"	10	\$23.60
K1-8	A-8166	1/4"	1/2"	10	\$8.04

1. Furnished with gasket

Order No.	Straight Pipe Size (NPSM)	Price
REPLACEMENT GASKET FOR USE WITH DRUM ADAPTERS		
A-8074	3/4"	\$0.23

Order No.	Model No.	NPTE	Melting Temp.	Pieces Per Ctn	Price
FUSIBLE PIPE PLUGS					
FPA 283	A-14058	1/8"	283°F	10	\$5.42
FPB 283	A-14059	1/4"	283°F	15	\$8.67
FPC 283	A-14060	3/8"	283°F	15	\$11.60
FPA 210	A-14017	1/8"	210°F	10	\$6.19
FPB 210	A-14018	1/4"	210°F	15	\$8.51
FPC 210	A-14021	3/8"	210°F	15	\$8.67

3

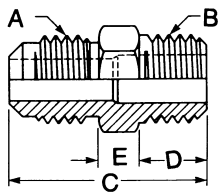

45° FLARE FITTINGS—CONNECTORS & UNIONS

Order No.	Model No.	Flare A	NPTE					Hex	Pieces Per Ctn.	Price
			B	C	D	E				
CONNECTORS, HALF UNION										
U1-4A	A-330	1/4"	1/8"	1 1/16"	3/8"	3/16"	7/16"	25	\$0.90	
U1-4B	A-4585	1/4"	1/4"	1 1/4"	9/16"	3/16"	9/16"	25	\$1.02	
U1-4C	A-1197	1/4"	3/8"	1 5/16"	9/16"	1/4"	1 1/16"	25	\$2.03	
U1-6A	A-5003	3/8"	1/8"	1 1/4"	3/8"	1/4"	5/8"	25	\$1.59	
U1-6B	A-332	3/8"	1/4"	1 7/16"	9/16"	1/4"	5/8"	25	\$1.63	
U1-6C	A-1199	3/8"	3/8"	1 7/16"	9/16"	1/4"	1 1/16"	25	\$1.45	
U1-6D	A-4993	3/8"	1/2"	1 11/16"	3/4"	5/16"	7/8"	25	\$2.25	
U1-8C	A-334	1/2"	3/8"	1 5/8"	9/16"	5/16"	3/4"	10	\$2.25	
U1-8D	A-4780	1/2"	1/2"	1 3/16"	3/4"	5/16"	7/8"	10	\$2.84	
U1-8E	A-5066	1/2"	3/4"	1 5/16"	3/4"	7/16"	1 1/16"	10	\$4.23	
U1-10C	A-1195	5/8"	3/8"	1 3/16"	9/16"	3/8"	7/8"	10	\$3.35	
U1-10D	A-4540	5/8"	1/2"	2"	3/4"	3/8"	7/8"	10	\$3.15	

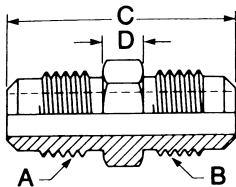

Order No.	Model No.	Flare A	Flare B	C	D	Hex	Pieces Per Ctn	Price
UNIONS								
U2-4	A-325	1/4"	1/4"	1 3/16"	3/16"	7/16"	25	\$0.86
U2-6	A-327	3/8"	3/8"	1 1/2"	1/4"	5/8"	25	\$1.57
U2-8	A-329	1/2"	1/2"	1 3/16"	5/16"	3/4"	15	\$2.47
U2-10	A-4845	5/8"	5/8"	2 1/8"	3/8"	7/8"	10	\$3.72
REDUCING UNIONS								
UR2-64	A-1171	3/8"	1/4"	1 3/8"	1/4"	5/8"	15	\$2.53
UR2-84	A-356	1/2"	1/4"	1 9/16"	5/16"	3/4"	15	\$3.28
UR2-86	A-149	1/2"	3/8"	1 11/16"	5/16"	3/4"	25	\$3.26
UR2-106	A-5334	5/8"	3/8"	1 7/8"	3/8"	7/8"	10	\$4.12
UR2-108	A-4.61	5/8"	1/2"	2"	3/8"	7/8"	15	\$4.41

REDUCING UNION

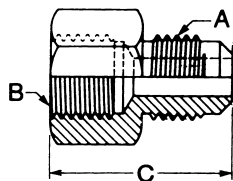
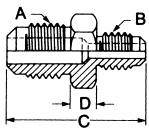

Order No.	Model No.	Flare A	Flare B	C	Hex	Pieces Per Ctn.	Price
INTERNAL PIPE THREAD CONNECTORS, HALF UNION							
U3-4A	A-4622	1/4"	1/4"	1 1/32"	9/16"	25	\$0.97
U3-4B	A-4625	1/4"	1/4"	1 1/4"	1 1/16"	25	\$1.76
U3-6A	A-4927	3/8"	1/8"	1 3/8"	5/8"	10	\$2.93

45° FLARE FITTINGS—CONNECTORS & UNIONS (cont.)

Order No.	Model No.	Flare A	Flare B	C	Hex	Pieces Per Ctn.	Price
INTERNAL PIPE THREAD CONNECTORS, HALF UNION (CONT.)							
U3-6B	A-4624	3/8"	1/4"	1 5/16"	1 1/16"	25	\$1.98
U3-6C	A-4627	3/8"	3/8"	1 3/8"	1 3/16"	15	\$2.80
U3-6D	A-8104	3/8"	1/2"	1 5/8"	1"	15	\$4.85
U3-8B	A-4928	1/2"	1/4"	1 13/32"	3/4"	15	\$3.26

Order No.	Model No.	Flare A	Flare B	C	Hex	Pieces Per Ctn.	Price
INTERNAL FLARE TO EXTERNAL FLARE ADAPTERS							
UR3-46	A-5041	1/4"	3/8"	1 1/8"	5/8"	15	\$3.52
UR3-64	A-479	3/8"	1/4"	1 7/32"	1 3/16"	15	\$3.66
UR3-68	A-4888	3/8"	1/2"	1 13/32"	1 3/16"	15	\$4.91
UR3-84	A-480	1/2"	1/4"	1 3/8"	1 5/16"	15	\$6.12
UR3-86	A-481	1/2"	3/8"	1 7/16"	1 5/16"	15	\$4.98
UR3-810	A-4879	1/2"	5/8"	1 5/8"	1 5/16"	10	\$6.12
UR3-108	A-4770	5/8"	1/2"	1 11/16"	1 1/16"	10	\$6.52

Note: 1 soft copper gasket furnished with each part

Order No.	Model No.	OD Solder	Flare	A	Pieces Per Ctn.	Price
SOLDER BY EXTERNAL FLARE CONNECTORS, HALF UNION						
US3-46	A-3494	5/16"	1/4"	1 1/16"	—	\$1.81
US3-66	A-3492	5/16"	3/8"	7/8"	—	\$2.53
US3-68	A-3547	1/2"	3/8"	7/8"	—	\$4.87
US3-88	A-3546	1/2"	1/2"	1 1/16"	—	\$2.36
US3-108	A-3519	1/2"	5/8"	1 1/4"	—	\$8.09
US3-1010	A-2258	5/8"	5/8"	1 1/4"	—	\$5.88
US3-1012	A-2272	3/4"	5/8"	1 1/4"	—	\$10.73
US3-1014	A-2378	7/8"	5/8"	1 1/4"	—	\$10.80

Order No.	Model No.	Flare	Hex	A	B	Pieces Per Ctn.	Price
INTERNAL FLARE UNIONS¹							
U4-4	A-385	1/4"	5/8"	1"	1/4"	10	\$4.14
U4-6	A-386	3/8"	1 3/16"	1 1/4"	3/8"	10	\$5.73
U4-8	A-387	1/2"	1 5/16"	1 7/16"	1/2"	10	\$7.75
U4-10	A-405	5/8"	1 1/16"	1 11/16"	5/8"	10	\$11.04
INTERNAL FLARE SWIVEL UNIONS							
US4-4	A-13563	1/4"	5/8"	1 3/8"	3/16"	15	\$4.23
US4-6	A-13565	3/8"	1 3/16"	1 9/16"	5/16"	15	\$4.63
US4-8	A-13567	1/2"	1 5/16"	1 13/16"	7/16"	15	\$5.99
US4-10	A-13568	5/8"	1 1/16"	2 1/16"	9/16"	15	\$7.93

1. 2 soft copper gaskets furnished with each part.

Order No.	Model No.	Flare	NPTE	Hex	A	B	C	D	Melting Temp.	Pieces Per Ctn.	Price
FUSIBLE CONNECTORS, HALF UNION											
FU4B 283	A-14062	1/4"	1/4"	5/16"	3/16"	1 1/4"	5/16"	3/16"	283°F	10	\$11.23

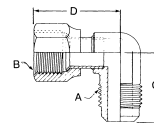
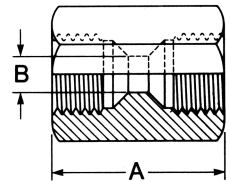
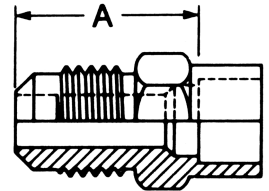
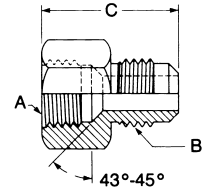

3

**Decisions made up front have the greatest impact on productivity.
Take the time to make the best ones!**

BRASS FITTINGS

Order No.	Model No.	Flare A	Flare B	C	D	Pieces Per Ctn.	Price
90° SWIVEL ELBOWS—INTERNAL FLARE TO EXTERNAL FLARE ADAPTER							
ES4-44	A-15940	1/4"	1/4"	29/32"	1 1/4"	4	\$7.01
ES4-66	A-15941	3/8"	3/8"	1 1/32"	1 11/32"	4	\$9.30
ES4-88	A-15943	1/2"	1/2"	1 7/32"	1 17/32"	4	\$10.25
ES4-1010	A-15944	5/8"	5/8"	1 13/32"	1 3/4"	4	\$15.11

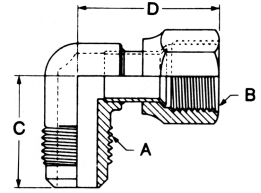

BRASS FLARE FITTINGS

FLARE FITTINGS—TEES & CROSSES

TEES AND CROSSES

Order No.	Model No.	Flare A	NPTE B	C	D	Pieces Per Ctn.	Price
TWO WAY TEES							
T1-4A	A-345	1/4"	1/8"	13/16"	25/32"	25	\$3.79
T1-4B	A-4859	1/4"	1/4"	29/32"	1 1/32"	25	\$5.90
T1-6C	A-4922	3/8"	3/8"	1 1/16"	1 3/32"	15	\$7.34
T1-8C	A-349	1/2"	3/8"	1 7/32"	1 1/8"	15	\$7.71
T1-8D	A-4924	1/2"	1/2"	1 11/32"	1 3/8"	10	\$12.27
T1-10D	A-4754	5/8"	1/2"	1 13/32"	1 3/8"	10	\$11.43

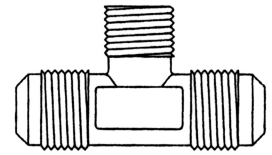

Order No.	Model No.	Flare A	NPTE B	C	D	E	Pieces Per Ctn	Price
RIGHT ANGLE TWO WAY TEES								
T3-4A	A-127	1/4"	1/8"	7/8"	25/32"	13/16"	25	\$4.17
T3-4B	A-4998	1/4"	1/4"	7/8"	31/32"	29/32"	25	\$4.27
T3-6B	A-133	3/8"	1/4"	1 1/16"	1 1/16"	1 1/16"	25	\$8.77

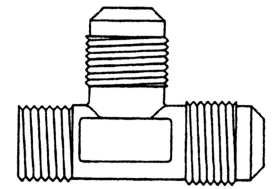

Order No.	Model No.	Flare	A	Pieces Per Ctn.	Price
THREE WAY TEES					
T2-4	A-340	1/4"	7/8"	25	\$3.59
T2-6	A-342	3/8"	1 1/16"	15	\$4.58
T2-8	A-344	1/2"	1 7/32"	15	\$7.03
T2-10	A-4541	5/8"	1 13/32"	10	\$10.11

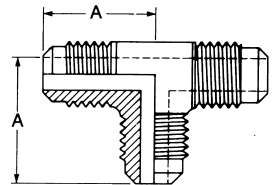

Order No.	Model No.	Flare	Flare	Hex	A	Pieces Per Ctn.	Price
THREE WAY TEES, INTERNAL BRANCH¹							
T6-4	A-6330	1/4"	1/4"	15/16"	3/4"	25	\$10.08

1. 1 soft copper gasket furnished with each part

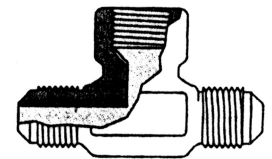

BRASS PIPE FITTINGS

PIPE FITTINGS

Order No.	Pipe Thread Size	Hex	Length	Flow Dia.	Price
COUPLING					
207P-2	1/8"	9/16"	.75"	.328"	\$1.36
207P-4	1/4"	3/4"	1.12"	.422"	\$2.12
207P-6	3/8"	7/8"	1.12"	.562"	\$2.84
207P-8	1/2"	1 1/16"	1.50"	.688"	\$4.27
207P-12	3/4"	1 3/8"	1.53"	.900"	\$10.69

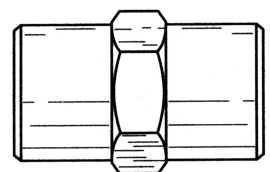

BRASS PIPE FITTINGS

PIPE FITTINGS (cont.)

Order No.	Pipe Thread Size	Hex	Length	Flow Dia.	Price
REDUCER COUPLING					
208P-4-2	1/4" x 1/8"	—	—	—	\$2.18
208P-6-4	3/8" x 1/4"	—	—	—	\$2.73
208P-8-4	1/2" x 1/4"	1 1/16"	1.28"	.422"	\$4.45
208P-8-6	1/2" x 3/8"	1 1/16"	1.38"	.562"	\$3.90
208P-12-6	3/4" x 3/8"	1 3/8"	1.32"	.562"	\$5.84
208P-12-8	3/4" x 1/2"	1 3/8"	1.50"	.688"	\$6.41
BUSHING					
209P-6-2	1/8" x 3/8"	1 1/16"	.75"	.328"	\$1.50
209P-8-2	1/8" x 1/2"	7/8"	1.00"	.328"	\$2.27
209P-8-4	1/4" x 1/2"	7/8"	1.00"	.422"	\$2.18
209P-12-4	1/4" x 3/4"	1 1/8"	1.00"	.422"	\$4.41
209P-12-6	3/8" x 3/4"	1 1/8"	1.00"	.562"	\$3.90
CLOSE NIPPLE					
215PN-2	1/8"	—	.75"	.281"	\$0.57
215PN-4	1/4"	—	.88"	.375"	\$0.95
215PN-6	3/8"	—	1.00"	.500"	\$1.28
215PN-8	1/2"	—	1.13"	.625"	\$1.87
215PN-12	3/4"	—	1.31"	.750"	\$4.01
HEX NIPPLE					
216P-2	1/8"	7/16"	.97"	.220"	\$0.84
216P-4	1/4"	9/16"	1.38"	.314"	\$1.28
HEX NIPPLE REDUCERS					
216P-4-2	1/4" x 1/8"	9/16"	1.19"	.220"	\$1.28
216P-6-2	3/8" x 1/8"	1 1/16"	1.22"	.220"	\$2.51
216P-6-4	3/8" x 1/4"	1 1/16"	1.41"	.314"	\$2.09
216P-8-4	1/2" x 1/4"	7/8"	1.62"	.314"	\$3.64
216P-8-6	1/2" x 3/8"	7/8"	1.62"	.440"	\$3.59
216P-12-8	3/4" x 1/2"	1 1/16"	1.80"	.564"	\$5.66
HEX-HEAD PLUG					
218P-2	1/8"	7/16"	.560"	—	\$0.51
218P-4	1/4"	9/16"	.750"	—	\$0.84
218P-6	3/8"	1 1/16"	.780"	—	\$1.41
218P-8	1/2"	7/8"	.970"	—	\$2.23
ADAPTER					
222P-2-2	1/8" x 1/8"	9/16"	.880"	.218"	\$1.02
222P-4-2	1/4" x 1/8"	3/4"	1.06"	.218"	\$1.57
222P-4-4	1/4" x 1/4"	3/4"	1.25"	.314"	\$1.89
222P-6-2	3/8" x 1/8"	7/8"	1.10"	.218"	\$5.62
222P-6-4	3/8" x 1/4"	7/8"	1.25"	.314"	\$2.53
222P-6-6	3/8" x 3/8"	7/8"	1.25"	.440"	\$2.84
222P-8-4	1/2" x 1/4"	1"	1.47"	.312"	\$5.09
222P-8-6	1/2" x 3/8"	1 1/16"	1.47"	.440"	\$4.19
222P-8-8	1/2" x 1/2"	1 1/16"	1.66"	.562"	\$4.01
222P-12-6	3/4" x 3/8"	1 3/8"	1.50"	.440"	—
222P-12-8	3/4" x 1/2"	1 3/8"	1.69"	.562"	\$13.04
222P-12-12	3/4" x 3/4"	1 3/8"	1.69"	.751"	—
90° UNION ELBOW					
2200P-2-2	1/8"	—	—	.328"	\$2.78
2200P-4-4	1/4"	—	—	.422"	\$3.88
2200P-6-6	3/8"	—	—	.563"	\$4.60
2200P-8-8	1/2"	—	—	.687"	\$7.78

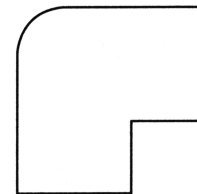
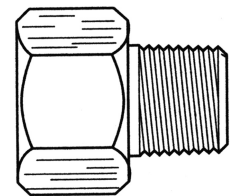
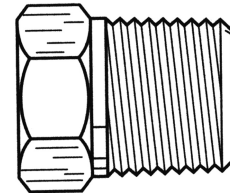
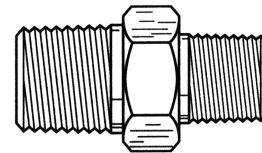
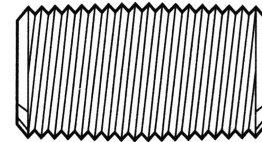
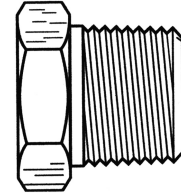
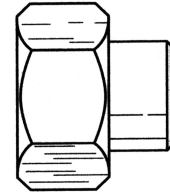

3

PIPE FITTINGS (cont.)

Order No.	Pipe Thread Size	Hex	Length	Flow Dia.	Price
90° STREET ELBOW					
2202P-2-2	1/8" x 1/8"	—	—	.220"	\$1.65
2202P-4-2	1/4" x 1/8"	—	—	.209"	
2202P-4-4	1/4" x 1/4"	—	—	.312"	\$2.49
2202P-4-6	1/4" x 3/8"	—	—	.438"	
2202P-6-6	3/8" x 3/8"	—	—	.428"	\$3.90
2202P-8-8	1/2" x 1/2"	—	—	.552"	\$7.45
2202P-12-12	3/4" x 3/4"	—	—	.750"	\$12.05
UNION TEE					
2203P-2	1/8"	—	1.06"	.328"	\$2.87
2203P-4	1/4"	—	1.52"	.422"	\$4.39
2203P-6	3/8"	—	1.68"	.562"	\$6.57
2203P-8	1/2"	—	2.14"	.687"	\$9.83
2203P-12	3/4"	—	2.28"	.900"	\$17.94

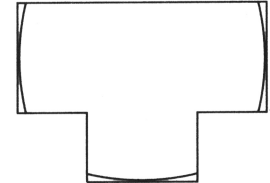
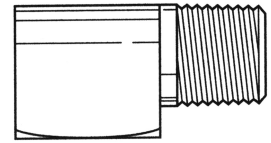

3

DUBL-BARB FITTINGS

Compact one-piece, push-on barbed fitting for a quick, economical way to connect polyethylene tubing. In addition to the styles shown, custom DUBL-BARB fittings to meet your exact requirements are available.

Order No.	Description	Size	Box Quantity	Price
22-5/32	Union (tube to tube)	5/32"	50	\$0.49
22-4	Union (tube to tube)	1/4"	50	\$0.49
22-4-5/32	Union Reducer (tube to tube)	1/4" x 5/32"	—	\$0.57
224-4	Union Tee (tube to tube to tube)	1/4"	100	\$1.52
28-4-5/32-2	Male pipe to barb	5/32-1/4" x 5/32"	100	\$1.52
28-4-4	Male pipe to barb	1/4" x 1/4"	100	\$1.57

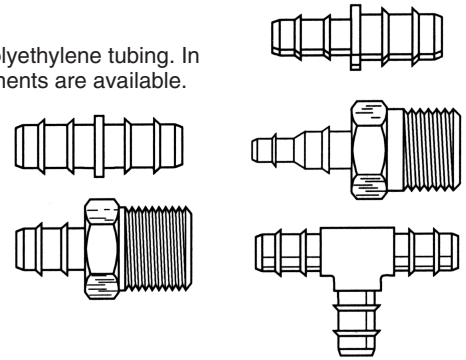

BRASS COMPRESSION FITTINGS

COMPRESSION FITTINGS

Order No.	Tube Size	A	D	L	Price
SLEEVE					
60C-2	1/8"	.187"	.130"	.19"	
60C-3	3/16"	.266"	.192"	.22"	\$0.18
60C-4	1/4"	.344"	.255"	.25"	\$0.16
60C-5	5/16"	.406"	.318"	.25"	\$0.16
60C-6	3/8"	.469"	.382"	.25"	\$0.18
60C-7	7/16"	.531"	.444"	.31"	
60C-8	1/2"	.594"	.507"	.38"	\$0.26
60C-10	5/8"	.719"	.632"	.38"	\$0.49
60C-12	3/4"	.875"	.758"	.44"	\$0.81
60C-14	7/8"	1.000"	.883"	.41"	\$1.43

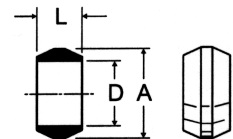

Order No.	Plastic Tube Wall	Tube Wall	A	D	L	Price
DELTRIN SLEEVE						
60PT-4	1/4"	.040"	.375"	.254"	.19"	
60PT-5	5/16"	.062"	.438"	.317"	.19"	
60PT-6	3/8"	.062"	.500"	.379"	.19"	
60PT-8	1/2"	.062"	.631"	.507"	.25"	\$0.22
60PT-10	5/8"	.062"	.747"	.632"	.22"	
60PT-12	3/4"	.062"	.931"	.760"	.25"	

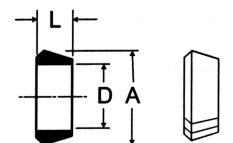

BRASS COMPRESSION FITTINGS

Order No.	Tube Size	Pipe Thread	Straight Thread	C Hex	L	M	Flow Dia. D	Price
MALE CONNECTOR (CONT.)								
68C-6-6	3/8"	3/8"	9/16"-24	1 1/16"	1.44"	1.16"	.312"	\$2.14
68C-6-8	3/8"	1/2"	9/16"-24	7/8"	1.53"	1.25"	.312"	\$2.97
68C-7-4	7/16"	1/4"	5/8"-24	5/8"	1.50"	1.17"	.312"	
68C-8-4	1/2"	1/4"	1 1/16"-20	1 1/16"	1.62"	1.22"	.312"	\$3.81
68C-8-6	1/2"	3/8"	1 1/16"-20	1 1/16"	1.60"	1.20"	.406"	\$2.89
68C-8-8	1/2"	1/2"	1 1/16"-20	7/8"	1.71"	1.31"	.406"	\$3.66
68C-10-6	5/8"	3/8"	1 3/16"-18	1 3/16"	1.73"	1.31"	.406"	\$5.27
68C-10-8	5/8"	1/2"	1 3/16"-18	7/8"	1.90"	1.48"	.500"	\$4.56
68C-10-12	5/8"	3/4"	1 3/16"-18	1 1/16"	1.98"	1.56"	.500"	\$6.74
68C-12-8	3/4"	1/2"	1"-18	1"	2.05"	1.60"	.562"	\$8.79
68C-12-12	3/4"	3/4"	1"-18	1 1/16"	2.08"	1.63"	.656"	\$9.19
68C-14-12	7/8"	3/4"	1 3/8"-18	1 1/8"	1.76"	1.41"	.750"	\$9.45

3

Order No.	Tube Size	Straight Thread	L	M	Flow Dia. D	Price
UNION TEE						
164C-2	1/8"	5/16"-24	.82"	.61"	.094"	\$5.93
164C-4	1/4"	7/16"-24	.86"	.61"	.188"	\$4.01
164C-5	5/16"	1/2"-24	.98"	.71"	.250"	\$7.01
164C-6	3/8"	9/16"-24	1.03"	.74"	.312"	\$5.51
164C-8	1/2"	1 1/16"-20	1.34"	.93"	.406"	\$10.88
164C-10	5/8"	1 3/16"-18	1.54"	1.08"	.500"	\$14.23

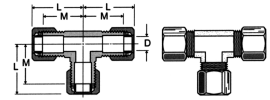

GARDEN HOSE FITTINGS

Order No.	I.D. Hose Size	Hose Thread	C Hex	L	Flow Dia. D	Price
HOSE BARB TO MALE HOSE THREAD						
53GH-8-12	1/2"	3/4"	1 1/16"	1.88"	.375"	\$6.52
54GH-10-12	5/8"	3/4"	1 1/16"	1.88"	.500"	\$7.18

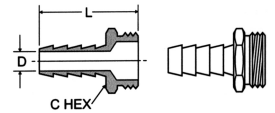

Order No.	Hose Thread	Pipe Thread	C Hex	L	Flow Dia. D	Price
MALE HOSE TO MALE PIPE						
70GH-12-8	3/4"	1/2"	1 1/16"	1.39"	.531"	\$4.21

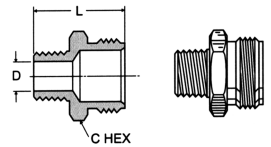

Order No.	Hose Thread	Pipe Thread	ID Hose Size	L	M	Flow Dia. D	Price
SWIVEL CONNECTOR FEMALE GARDEN HOSE TO MALE PIPE							
88GH-12-6	3/4"	3/8"	—	1.54"	1.15"	.406"	\$9.83
SWIVEL CONNECTOR FEMALE GARDEN HOSE TO HOSE BARB							
90GH-12-6	3/4"	—	3/8"	1.21"	1.15"	.281"	\$10.05
90GH-12-8	3/4"	—	1/2"	1.21"	1.15"	.375"	\$9.61
90GH-12-10	3/4"	—	5/8"	1.93"	1.19"	.500"	\$13.33

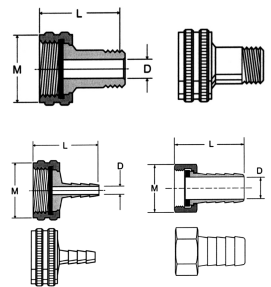

Value your resources! Especially Time, Information and People.

NYLON FITTINGS

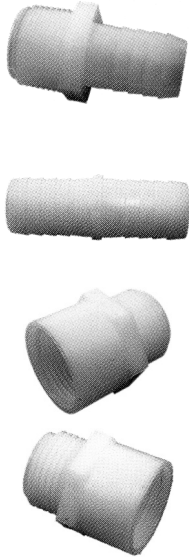

Order No.	Description	Std. Pack	Price
701-002	Adapter—1/2" Barb x 3/4" MPT	2	\$3.92
701-014	Adapter—5/8" Barb x 3/4" MPT	2	\$5.54
701-017	Bushing—3/4" MPT x 1/2" FPT	2	\$5.16
701-019	Elbow—1/2" Barb x 3/4" FPT	2	\$6.43
701-020	Elbow—1/2" Barb x 3/4" MPT	2	\$5.27
701-025	Elbow—3/4" Barb x 3/4" MPT	2	\$5.86
701-028	Elbow—5/8" Barb x 3/4" MPT	2	\$5.54
701-040	Elbow—5/8" Barb	2	\$6.12
701-044	Elbow—1/2" MPT x 3/4" Barb	2	\$5.66
701-029	Hose Mender—1/2" Barb	2	\$4.13
701-030	Hose Mender—1/4" Barb	2	\$3.17
701-031	Hose Mender—3/4" Barb	2	\$4.61
701-032	Hose Mender—3/8" Barb	2	\$3.40
701-033	Hose Mender—5/8" Barb	2	\$4.28
701-034	Tee—1/2" Barb	2	\$5.60
701-039	Tee—5/8" Barb	2	\$5.60

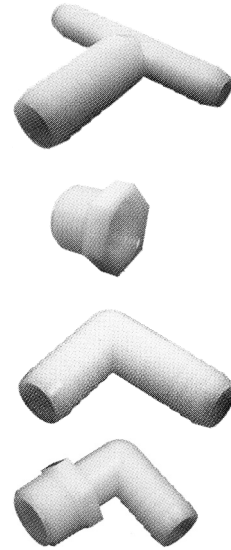

3

POLY-VINYL TUBING

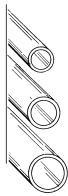

Non-toxic, clear, strong, flexible, tough tubing made of Poly-Vinyl Chloride (PVC). Has a durometer of 85 on Shore A scale. Resists oils, acids, alkalis, abrasion. Ingredients used are F.D.A. sanctioned. An excellent tubing for high quality applications. Each roll packaged in an easy-to-use carton. An excellent tubing for condensate removal, recirculating, pump vents, instrument controls, laboratory applications.

Order No.	ID	OD	Wall	Max. psi @ 70°F	Ft. Per Roll	Price
08-2500	1/4"	3/8"	.062	55	100'	\$0.27
08-2501	3/8"	1/2"	.062	45	100'	\$0.35
08-2502	1/2"	5/8"	.062	30	100'	\$0.45
08-2503	5/8"	3/4"	.062	25	100'	\$0.56
08-2504	3/4"	29/32"	.078	20	50'	\$1.13
08-2505	7/8"	1 1/16"	.093	15	50'	\$1.57

Available: Other sizes, colors and durometer.

KUT-ALL PLASTIC TUBE AND HOSE CUTTER



Order No.	Description	Price
PK-2	For cutting up to 1 1/8" ID plastic tubing, reinforced plastic tubing, rigid plastic pipe, and rubber hose.	\$44.29

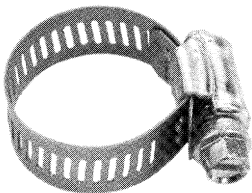

300 SERIES STAINLESS STEEL HOSE CLAMPS

Partial stainless, worm drive, adjustable. Stainless steel 1/2" band with 5/16" slotted hex head screw and housing. Recommended for most applications. 100% interlock construction features one-piece housing which directly locks into the band. Spot weld free design.

Order No.	Description	Price
B-4H	No. 4, 7/32-5/8" dia., 3/16-5/16" hose ID.	\$1.76
B-6H	No. 6, 3/8-7/8" dia., 1/4-3/8" hose ID.	\$1.76
B-8H	No. 8, 7/16-1" dia., 5/16-1/2" hose ID.	\$1.76
B-10H	No. 10, 9/16-1 1/16" dia., 3/8-5/8" hose ID.	\$1.76
B-12H	No. 12, 5/8-1 1/4" dia., 5/8-3/4" hose ID.	\$1.96
B-16H	No. 16, 1 1/16-1 1/2" dia., 3/4-1" hose ID.	\$1.96
B-20H	No. 20, 3/4-1 3/4" dia., 1-1 1/4" hose ID.	\$1.96
B-24H	No. 24, 1 1/16-2" dia., 1 1/4-1 1/2" hose ID.	\$1.96
B-28H	No. 28, 1 3/16-2 1/4" dia., 1 1/4-1 3/4" hose ID.	\$1.96
B-32H	No. 32, 1 9/16-2 1/2" dia., 1 1/2-2" hose ID.	\$1.96
B-36H	No. 36, 1 13/16-2 3/4" dia., 1 3/4-2 1/4" hose ID.	\$1.96

2-3" PVC DWV FITTINGS SLIP x SLIP

Order No.	Size	Price
COUPLINGS		
5-100020	2"	\$1.33
5-100030	3"	\$3.88
510-D102338	3" x 2"	\$8.92
90 ELBOW		
5-300020	2"	\$2.61
510-D304020	2" long sweep	\$5.22
5-300030	3"	\$7.88
510-D304030	3" long sweep	\$13.80
45 ELBOW		
5-321020	2"	\$3.25
5-321030	3"	\$7.19



3

3/4" PVC FITTINGS—SCHEDULE 40

NSF approved.

Order No.	Description	Std. Pack	Price
TEE (SLIP x SLIP x SLIP)			
5-401007	3/4"	100	\$0.80
90° ELL (SLIP x SLIP)			
5-406007	3/4"	100	\$0.64
90° ELL (SLIP x FPT)			
5-407007	3/4"	50	\$0.80
90° STREET ELL (SPIG x SLIP)			
5-409007	3/4"	50	\$1.91
90° STREET ELL (MIPT x SLIP)			
5-410007	3/4"	50	\$1.44
COUPLING (SLIP x SLIP)			
5-429007	3/4"	100	\$0.53
FEMALE ADAPTER (SLIP x FIPT)			
5-435007	3/4"	100	\$0.80
MALE ADAPTER (MIPT x SLIP)			
5-436007	3/4"	100	\$0.58
CAP (SLIP)			
5-447007	3/4"	100	\$0.58
CAP (FIPT)			
5-448007	3/4"	100	\$1.17
TRAPS (SLIP x SLIP)			
5-408	3/4" "P" Trap	100	\$2.13
5-409	3/4" Running "P" Trap	100	\$2.13
5-410 3/4	3/4" Mini "P" Trap	100	\$2.19

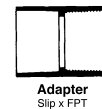
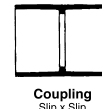
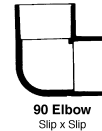
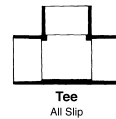

PVC CONDENSATE PIPE

NSF approved.

Order No.	Description	Linear Feet	Price
3/4X10	3/4" dia. PVC	10' straight end	\$9.50
5-404	2" dia. PVC—Schedule 40	10' straight end	\$19.71
5-405	3" dia. PVC—Schedule 40	10' straight end	\$37.67

SWIVEL NUT ACCESS VALVES

Order No.	Connection Size	Price
02-C31734	1/4" female flare forged swivel nut/permanent depressor	\$7.96

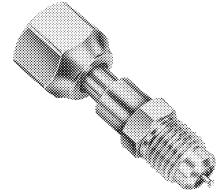

HALF UNION

ELIMINATES LEAKS ON BACK SEATING SERVICE VALVES

Order No.	Quantity	Connection Size	Price
02-C31482	5	1/8" MPT or 1/4" OD solder	\$2.68
02-C31484	5	1/4" MPT or 5/16" OD solder	\$3.15

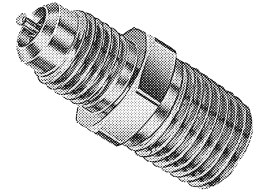
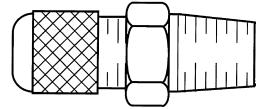

3

STRAIGHT SOLDER TYPE UNIONS

Order No.	Connection Size	Price
02-C31722	1/8" OD tube or 1/4" solder fitting/swaged tube	
02-C31723	3/16" OD tube or 1/4" solder fitting/swaged tube	\$6.95
02-C31724	1/4" OD tube or 3/8" solder fitting/swaged tube	\$2.92
02-C31725	5/16" OD tube or 1/2" solder fitting/swaged tube	
02-C31726	3/8" OD tube or 1/2" solder fitting/swaged tube	

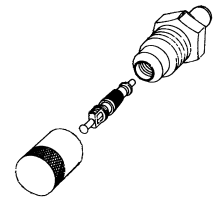

3 WAY SOLDER TYPE UNIONS

Order No.	Connection Size	Qty.	Price
02-C31720	For 3/16" OD tube or 1/4" and 3/8" solder fitting/swaged tube	5/pkg.	\$5.72

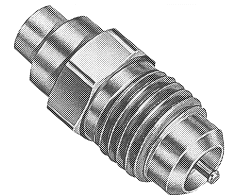

QUICK SEAL CAPS

Order No.	Description	Qty.	Price
02-NFT54-B	1/4" tubular seal gasket. To seal access valves and other 1/4" male SAE connections. Wrench/pliers not required.	10/pkg.	\$0.83
02-NFT56	3/8" "O" ring seal cap. To seal access valves and other 3/8" male SAE connections. Wrench/pliers not required.	3/pkg.	\$3.40
02-C31992	1/4" plastic seal cap with plastic retainer strap.	—	\$2.72

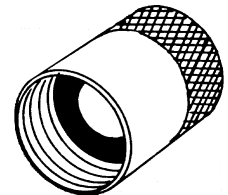
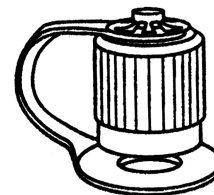

QUICK COUPLERS

Order No.	Description	Price
02-CQC-S4A	1/4" quick coupler x 1/8" FPT thread.	\$18.70
02-QCS4A-134	134a automotive. 1/4" quick coupler x 1/2" male Acme thread.	\$32.29

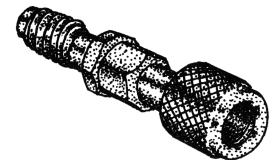
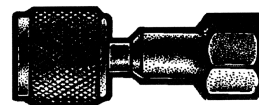

"PIGGY-BACK" VALVE CORE TOOL

HOLDS INTERCHANGEABLE VALVE CORE BITS FOR 1/4" ACCESS VALVES

Hollow, transparent handle for storage of extra valve cores and tool bit.

Order No.	Description	Price
02-C32004	1/4" bit with 6 extra 1/4" valve cores and new thread chaser kit.	\$22.87

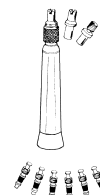

19 SERIES YELLOW JACKET® QUICK COUPLER GASKETS

Order No.	Description	Price
19109	¼" SealRight Str. × ¼" male fl.	\$29.96
19209	¼" SealRight 90° × ¼" male fl.	\$32.74

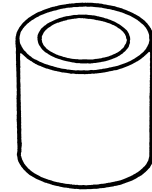

19 SERIES YELLOW JACKET® QUICK COUPLERS

Includes patented CH14 "Adjust-a-valve" opener in all ¼" female Quick Coupler ends.

Order No.	Description	Old Part No.	Price
STRAIGHT QUICK COUPLERS			
19101	¼" female QC × ¼" male flare	4814	\$18.05
19120	¾" female QC × ¼" male flare	4813	\$21.08

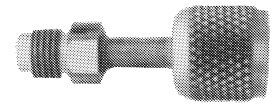

3

SNAP-IT™ COUPLER

Snaps on over ¼" flare threads with schrader core. Forms tight connection immediately. Instantly activates the schrader in the access fitting. Shuts off end of hose when sleeve is pulled back and coupler pops off access fitting.

Order No.	Description	Price
19090	Snap-it™ coupler	\$101.04



FULL CONTROL BALL VALVES FOR VACUUM/CHARGING

Order No.	Size ¹	Price
93833	¼" SAE, M. FL × ¼" FPT	\$31.70
93834	¼" SAE, M. FL × M. FL	\$37.95

1. U.L. listed.



BALL VALVE

4 IN 1 VACUUM/CHARGE VALVE & CORE TOOL

Order No.	Description	Price
18975	Vacuum/charge ball valve	\$120.73



6" FLEXFLOW ADAPTER HOSES

An easy way to retrofit existing Plus II hoses with FlexFlow capabilities. Flexible hose between valve and fitting provides convenient handling in tight areas.

Order No.	Description	Price
25002	¼" yellow	\$51.49
25202	¼" blue	\$51.49
25602	¼" red	\$51.49
25980	3-pak: 25002, 25202, 25602	\$150.59



VIBRATION PADS

EXTREME VIBRATION ATTENUATION

The latest generation in vibration dampening technology. The most effective vibration dampening pad available on the market today. We tested the EVA Pad against other pads at four different vibration settings. In the most severe vibration extremes, the new EVA Pad outperforms cork and rubber by a margin of greater than 3:1, and outperforms our competitor's "waffle" pad by a margin of greater than 8:1. This enhanced performance is due to the special composite foam center. The composite foam is much more structurally sound than cork. It is not affected by oils or chemicals that can sometimes break down cork, and is much more effective at vibration dampening than solid rubber. In essence, the EVA Pad gives you the best of both worlds, at a very competitive price.



Order No.	Size	Price
MP-4E	4" x 4" x 1/8"	\$6.38
MP-12E	12" x 12" x 1/8"	\$67.21

3

ANCHORS

"HAMMER DRIVE" NAIL-IN ANCHORS—METAL ZAMAC

Order No.	Size	Min Embed.	Box Qty.	Price
59016	1/4 x 1	3/4"	100 ¹	\$60.71

1. These items are packaged in cardboard boxes.

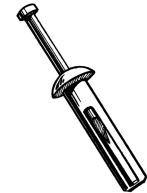

LEAD ANCHORS—ACCEPTS SHEET METAL OR WOOD SCREWS

Order No.	Lag Screw Diameter	Length	Drill Diameter	Min. Depth	Box Qty ¹	Price
60802	#6-8	3/4"	1/4"	3/4"	100	\$36.40
60804	#6-8	1"	1/4"	1"	100	\$37.35
60810	#10-12-14	1"	5/16"	1"	100	\$42.64

1. These items are packaged in cardboard boxes.

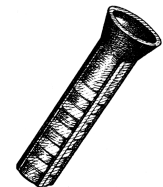

FULL SIZE EZ-ANCHORS

Order No.	Description	Box Qty	Price
59510	#8 Zinc EZ-Anchor, screws not included.	100 ¹	\$58.03
59515	#8 Zinc EZ-Anchor white plastic, includes anchors only.	100	\$45.55

1. These items are packaged in cardboard boxes.



EZ-ANCHOR KITS

Order No.	Description	Price
39915	#8 zinc EZ-Ancor - Sq/Phil kit, 101 piece kit, 50 EZ-Ancor-Zinc, 50 #8 x 1 1/4 Sq/Phil combo screws, #2-2" hex power bit.	\$48.61
39920	#8 EZ-Ancor white plastic sq./phil kit, 101 piece kit, 50 EZ Ancors-plastic, 50 #8 x 1" slot/phil combo screws, #2-2" hex power bit.	\$48.61

ALLIGATOR ANCHORS—PLASTIC

Order No.	Description	Alligator #	Drill Size	Box Qty	Price
ALLIGATOR 100 PACKS					
59411	#8-10 alligator with flange	AF5	3/16	100	\$50.80

RED PLASTIC CONICAL ANCHORS

Order No.	Description	Drill Size	Box Qty	Price
59410	#8-10 red conical anchors	3/16	100	\$6.88
59412	#10-12 red conical anchors	1/4	100	\$7.86



ANCHORS & HANGER MATERIAL

COACH SCREW ROD

Order No.	Length	Specification Data			Recom. Max. Load (lbs.)	Price
		A	B	C		
618	8"	3/8"	2"	2 1/2"	390	\$3.50

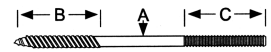

HANGER MATERIAL

CHANNEL

Order No.	Channel Dimensions (H x W)	Steel Thickness	Price
E1000	1 5/8" x 1 5/8"	14 Ga.	\$44.30
E1000T	Slotted 1 5/8" x 1 5/8"	12 Ga.	\$63.19
E3300	1 3/16" x 1 5/8"	12 Ga.	\$38.46
E3300T	Slotted 1 3/16" x 1 5/8"	12 Ga.	\$48.76
P4000	1 3/16" x 1 5/8"	16 Ga.	\$76.34

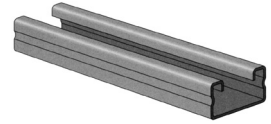

CHANNEL NUTS WITH SPRINGS

Order No.	Size	Thread	Use with Channel	Price
P1008	3/8"	16	P1000, P1100, P2000 & P3000 series	\$3.19
P1010	1/2"	13	P1000, P1100, P2000 & P3000 series	\$3.33
P4008	3/8"	16	3300, 4000 & 4100 series	\$3.19
P4010	1/2"	13	3300, 4000 & 4100 series	\$3.06

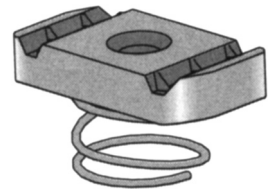

GRINNELL CORP.

ALL THREAD RODS

CONTINUOUS THREAD: 146

Material: carbon steel; rod machine threaded complete length. Finish: black or electro-galvanized.

Order No.	Size	Price
ZINC PLATED STEEL		
3/8"X10FT-PLATED	3/8" x 10'	\$8.13
1/2"X10FT-PLATED	1/2" x 10'	\$13.26

PIPE CLAMPS

CUSH-A-CLAMP ASSEMBLY

TUBE SERIES

Order No.	Copper & Steel Tube O.D. Size	Price	Order No.	Copper & Steel Tube O.D. Size	Price
004T008	1/4"	\$4.59	026N030	1 5/8"	\$9.18
006T010	3/8"	\$4.59	030N034	1 7/8"	\$11.38
008T012	1/2"	\$4.59	034N040	2 1/8"	\$14.87
010T014	5/8"	\$4.77	038N044	2 3/8"	\$16.34
012T016	3/4"	\$5.32	042N048	2 5/8"	\$17.44
014T018	7/8"	\$5.51	046N052	2 7/8"	\$18.73
018T022	1 1/8"	\$6.79	050N056	3 1/8"	\$22.22
022T026	1 3/8"	\$8.08	066N074	4 1/8"	\$37.93

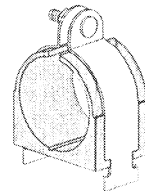

Maximize an attitude of the Heart.

PIPE CLAMPS

M SERIES CABLE AND CONDUIT CLAMPS ONE-PIECE

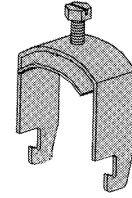

Order No.	Max. OD	Price	Order No.	Max. OD	Price
M5025-EG	3/8"	\$4.05	M5041-EG	2 3/8"	\$9.62
M5026-EG	1/2"	\$4.19	M5044-EG	2 3/4"	\$9.86
M5028-EG	3/4"	\$4.29	M5048-EG	3 1/4"	\$12.19
M5030-EG	1"	\$4.57	M5052-EG	3 3/4"	\$14.39
M5032-EG	1 1/4"	\$4.81	M5054-EG	4"	\$14.90
M5034-EG	1 1/2"	\$5.43	M5057-EG	4 3/8"	\$15.39
M5038-EG	2"	\$7.25	M5060-EG	4 3/4"	\$17.10

P SERIES UNISTRUT CLAMP®

For OD tubing, transit pipe, fibre duct, or ceramic tubes.

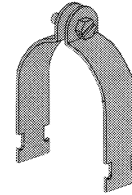

3

Order No.	Tube Size	Price	Order No.	Tube Size	Price
P2024-EG	1/4" OD	\$2.85	P2039-EG	2 1/8" OD	\$4.67
P2025-EG	3/8" OD	\$2.66	P2043-EG	2 5/8" OD	\$5.19
P2026-EG	1/2" OD	\$2.78	P2047-EG	3 1/8" OD	\$5.77
P2027-EG	5/8" OD	\$1.89	P2049-EG	3 3/8" OD	\$5.91
P2028-EG	3/4" OD	\$2.06	P2051-EG	3 5/8" OD	\$9.96
P2029-EG	7/8" OD	\$2.06	P2053-EG	3 7/8" OD	\$11.43
P2031-EG	1 1/8" OD	\$3.09	P2055-EG	4 1/8" OD	\$11.56
P2033-EG	1 3/8" OD	\$3.09	P2059-EG	4 5/8" OD	\$12.29
P2035-EG	1 5/8" OD	\$3.57	P2062-EG	5" OD	\$12.55
P2037-EG	1 7/8" OD	\$4.43			

Includes: Slotted hex head screw and nut.

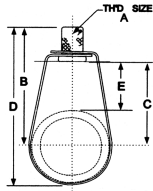

ADJUSTABLE SWIVEL RING HANGER

Order No.	Series	Copper Tube Size	Specification Data					Rec. Max. Load (lbs.)	Price
			A	B	C	D	E		
42 SERIES - PRE-GALVANIZED CARBON STEEL									
411	41	1"	3/8"	2 13/16"	1 15/16"	3 7/16"	1 1/4"	400	\$0.79
412	41	2"	3/8"	3 7/16"	2 9/16"	4 9/16"	1 3/8"	400	\$0.86
413	41	3"	3/8"	4"	3 1/8"	5 5/8"	1 3/8"	600	\$1.89
414	41	4"	3/8"	4 5/8"	3 3/4"	6 7/8"	1 1/2"	1,000	\$2.37
4112	41	1/2"	3/8"	2 13/16"	1 15/16"	3 1/4"	1 5/16"	400	\$0.86
4134	41	3/4"	3/8"	2 13/16"	1 15/16"	3 1/4"	1 3/8"	400	\$0.86
41112	41	1 1/2"	3/8"	3 3/8"	2 1/4"	4"	1 1/4"	400	\$0.86
41114	41	1 1/4"	3/8"	2 15/16"	2 1/16"	3 3/4"	1 3/16"	400	\$0.86
41212	41	2 1/2"	3/8"	3 1 1/16"	2 13/16"	5 1/16"	1 3/8"	600	\$1.72
41 SERIES - COPPER PLATED CARBON STEEL									
421	42	1"	3/8"	2 13/16"	1 15/16"	3 1/4"	1 3/8"	400	\$2.27
422	42	2"	3/8"	3 7/16"	2 9/16"	4 9/16"	1 3/8"	400	\$2.75
423	42	3"	3/8"	4"	3 3/8"	5 5/8"	1 3/8"	600	\$5.87
424	42	4"	3/8"	4 5/8"	3 3/4"	6 7/8"	1 1/2"	1000	\$5.94
4212	42	1/2"	3/8"	2 13/16"	1 15/16"	3 1/4"	1 5/16"	400	\$2.09
4234	42	3/4"	3/8"	2 13/16"	1 15/16"	3 1/4"	1 5/16"	400	\$2.09
42112	42	1 1/2"	3/8"	2 15/16"	2 1/16"	3 3/4"	1 3/16"	400	\$2.58
42114	42	1 1/4"	3/8"	2 13/16"	1 15/16"	3 7/16"	1 1/4"	400	\$2.34
42212	42	2 1/2"	3/8"	3 1 1/16"	2 13/16"	5 1/16"	1 3/8"	600	\$4.67

PLASTIC PIPE CLAMPS

Order No.	Size	Price
PC-1/2	1/2"	\$0.22
PC-3/4	3/4"	\$0.22
PC-1	1"	\$1.39
PC-1-1/4	1 1/4"	\$4.49
PC-1-1/2	1 1/2"	\$5.85
PC-2	2"	\$7.89

CEILING FLANGE

Order No.	Rod Size	Specification Data						Recom. Max. Load (lbs.)	Price
	A	B	C	D	E	F			
28R38	3/8"	3 5/16"	1 3/8"	1/2"	3/16"	2 1/4"	180	\$2.75	
28R12	1/2"	3 5/16"	1 3/8"	1/2"	3/16"	2 1/4"	180	\$3.74	

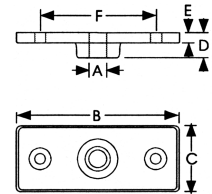

SMALL MOUTH TOP BEAM CLAMP

Order No.	Rod Size	6 Specification Data						Pipe Size	Recom. Max. Load (lbs.)	Price
	A	B	C	D	E	F	G			
40612	1/2"	1 5/32"	1 1/2"	7/8"	1"	5/8"	7/8"	2 1/2"–3 1/2"	500	\$4.81
40638	3/8"	1 5/32"	1 1/2"	7/8"	1"	5/8"	7/8"	1/2"–2"	500	\$3.13
40658	5/8"	1 11/16"	1 3/4"	1 9/32"	1 1/4"	7/8"	1 1/8"	4"–5"	600	\$11.51

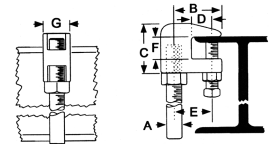

WIDE MOUTH TOP BEAM CLAMP

Order No.	Rod Size	6 Specification Data						Pipe Size	Recom. Max. Load (lbs.)	Price
	A	B	C	D	E	F	G			
40712	1/2"	1 5/16"	2"	9/16"	1"	1"	1 5/16"	2 1/2"–3 1/2"	500	\$5.94
40738	3/8"	1 5/16"	2"	9/16"	1"	1"	1 5/16"	1/2"–2"	440	\$5.15

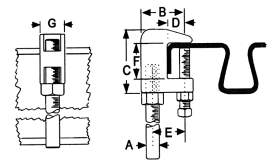

Q DECK HANGERS

Order No.	Description	Price
QD-14	1/4" Q deck clamp	\$3.26
QD-38	3/8" Q deck clamp	\$3.40
QD-12	1/2" Q deck clamp	\$4.98

ANGULAR FITTINGS

Order No.	"A"	"B"	Price
P1186	45°	3 1/8"	\$7.50

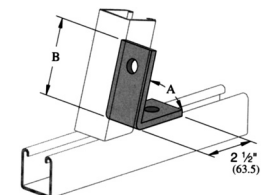

FENDER WASHERS KIT

Order No.	Box Count	Contents			Price
		$\frac{3}{16} \times 1\frac{1}{4}$	$\frac{1}{4} \times 1\frac{1}{4}$	$\frac{3}{8} \times 1\frac{1}{4}$	
39519	120 pcs	40	40	40	\$39.20

HEX NUTS

Order No.	Size	Box Qty. ¹	Price
ZINC PLATED			
40105	6-32	100	\$2.50
40110	8-32	100	\$2.69
40115	10-24	100	\$15.42
40120	10-32	100	\$2.84
40125	$\frac{1}{4}$ -20	100	\$3.63
40135	$\frac{3}{8}$ -16	100	\$607.08
40140	$\frac{1}{2}$ -13	100	\$17.31
SPECIALTY HEX NUTS—NYLOK HEX NUTS			
40425	$\frac{1}{4}$ -20	100	\$16.10
40435	$\frac{3}{8}$ -16	100	\$31.75

1. These items are packaged in cardboard boxes.

JOB JARS

Order No.	Size	Jar Qty.	Price
40135-6	$\frac{3}{8}$ -16	250	\$18.18

WASHERS

Order No.	Size	Box Qty. ¹	Price
FLAT CUT WASHERS—ZINC PLATED			
40310	#8	100	\$3.90
40315	#10	100	\$40.23
40325	$\frac{1}{4}$	100	\$4.88
40335	$\frac{3}{8}$	100	\$9.60
40340	$\frac{1}{2}$	100	\$18.67

FENDER WASHERS—ZINC PLATED			
40715	$\frac{3}{16} \times 1\frac{1}{4}$	100	\$10.96
40720	$\frac{1}{4} \times 1$	100	\$9.72
40725	$\frac{1}{4} \times 1\frac{1}{4}$	100	\$12.82
40735	$\frac{5}{16} \times 1\frac{1}{4}$	100	\$13.31
40745	$\frac{3}{8} \times 1\frac{1}{2}$	100	\$18.14

Order No.	Size	Box Qty. ¹	Price
SPLIT LOCK WASHERS—ZINC PLATED			
40525	$\frac{1}{4}$	100	\$4.08
40535	$\frac{3}{8}$	100	\$6.96
40540	$\frac{1}{2}$	100	\$12.10

1. These items are packaged in cardboard boxes.

BOLTS

GRADE 5 HEX CAP SCREWS—ZINC—SOLD INDIVIDUALLY

Order No.	Size ¹	Price
55013	$\frac{1}{4}$ -20 \times $\frac{3}{4}$	\$0.25
55025	$\frac{1}{4}$ -20 \times $1\frac{1}{2}$	\$0.41
55033	$\frac{1}{4}$ -20 \times 2	\$0.51
55409	$\frac{3}{8}$ -16 \times $\frac{1}{2}$	\$0.47
55413	$\frac{3}{8}$ -16 \times $\frac{3}{4}$	\$0.51
55417	$\frac{3}{8}$ -16 \times 1	\$0.57

Order No.	Size ¹	Price
55425	$\frac{3}{8}$ -16 \times $1\frac{1}{2}$	\$0.75
55433	$\frac{3}{8}$ -16 \times 2	\$0.93
55817	$\frac{1}{2}$ -13 \times 1	\$1.13
55825	$\frac{1}{2}$ -13 \times $1\frac{1}{2}$	\$1.33

1. Larger sizes available. Call for details.

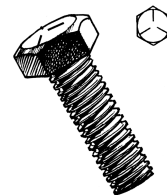

BOLTS & WINGS

TOGGLE BOLTS—ZINC—MUSHROOM HEAD SQ/SLOTTED—INCLUDES WINGS

Order No.	Size	Price
58348	$\frac{3}{16} \times 3$	\$0.57

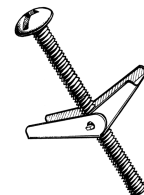

SCREWS (cont.)

Order No.	Size	Bit Size	Box Qty/Std. Pk.	Price
FLAT HEAD WOOD SCREWS—SQUARE DRIVE—ZINC				
12820	8 × 1¼	#2	100	\$7.48
12824	8 × 1½	#2	100	\$8.58
12832	8 × 2	#2	50	\$6.09
STAINLESS SHEET METAL SCREWS—PANHEAD SQ. DRIVE				
70812	8 × ¾	#2	100	\$22.80
70816	8 × 1	#2	100	\$26.80

Order No.	Size	Head Size	Box Qty/Std. Pk.	Price
HEX WASHER HEAD SHEET METAL SCREWS—SLOT/PHIL—ZINC				
77008	10 × ½	⅝"	100	\$10.36
77012	10 × ¾	⅝"	100	\$11.68
77408	14 × ½	¾"	100	\$24.42
77412	14 × ¾	¾"	100	\$25.21
77416	14 × 1	¾"	50	\$13.65
77420	14 × 1¼	¾"	50	\$15.69
77424	14 × 1½	¾"	50	\$19.32
77432	14 × 2	¾"	25	\$11.68
77440	14 × 2½	¾"	100	\$51.52

Order No.	Size	Head Size	Box Qty/Std. Pk.	Price
HEX WASHER HEAD "TEK" SELF DRILLING SCREWS—ZINC				
78808	8-18 × ½	¼"	100	\$6.73
78812	8-18 × ¾	¼"	100	\$7.26
78816	8-18 × 1	¼"	100	\$8.96
78820	8-18 × 1¼	¼"	100	\$10.17
78824	8-18 × 1½	¼"	100	\$11.49
79008	10-16 × ½	⅝"	100	\$8.54
79010	10-16 × ⅝	⅝"	100	\$9.22
79012	10-16 × ¾	⅝"	100	\$9.34
79016	10-16 × 1	⅝"	100	\$10.17
79020	10-16 × 1¼	⅝"	100	\$11.53
79024	10-16 × 1½	⅝"	50	\$8.01
79212	12-14 × ¾	⅝"	100	\$15.61
79216	12-14 × 1	⅝"	100	\$15.80
79224	12-14 × 1½	⅝"	50	\$9.57
79232	12-14 × 2	⅝"	50	\$12.44

CULLY CONCRETE SCREWS—HARD AGGREGATE

Order No.	Size	Box Qty.	Price
HEX WASHER HEAD—FREE ⅜ × 3½" DRILL BIT IN EACH BOX			
61020	12 × 1¼	100	\$84.97

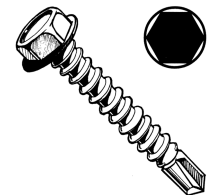

3

DRILL BITS

HIGH SPEED JOBBER DRILLS—118° POINT—STEEL

Order No.	Size	Price	Order No.	Size	Price
91601	1/16	\$2.31	91612	15/64	\$5.33
91602	5/64	\$2.12	91613	1/4	\$5.97
91603	3/32	\$2.19	91614	17/64	\$7.45
91604	7/64	\$2.19	91615	9/32	\$8.17
91605	1/8	\$2.65	91617	5/16	\$9.68
91606	9/64	\$3.02	91619	11/32	\$12.51
91607	5/32	\$3.33	91621	3/8	\$14.59
91608	11/64	\$3.52	91623	13/32	\$17.54
91609	3/16	\$3.93	91625	7/16	\$20.45
91610	13/64	\$4.61	91627	15/32	\$23.78
91611	7/32	\$4.95	91629	1/2	\$25.21



