

# Exhaust System and Muffler Manufacturing Machinery

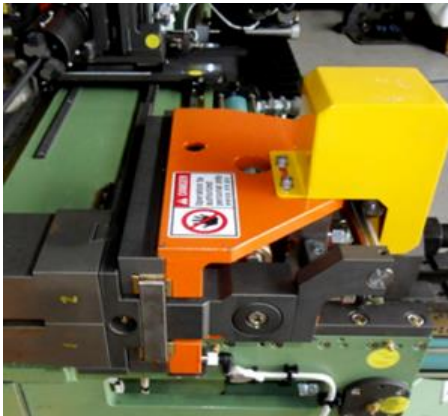

344 Bloor Street W. Suite 607 Toronto, ON Canada M5S 3A7  
[www.lprglobal.com](http://www.lprglobal.com) | [www.uskoreahotlink.com](http://www.uskoreahotlink.com)  
Phone: +1 416 423 5590  
Email: [info@lprglobal.com](mailto:info@lprglobal.com)

LPR GLOBAL

# Exhaust Systems and Mufflers

Our Machinery Produce Exhaust Systems.

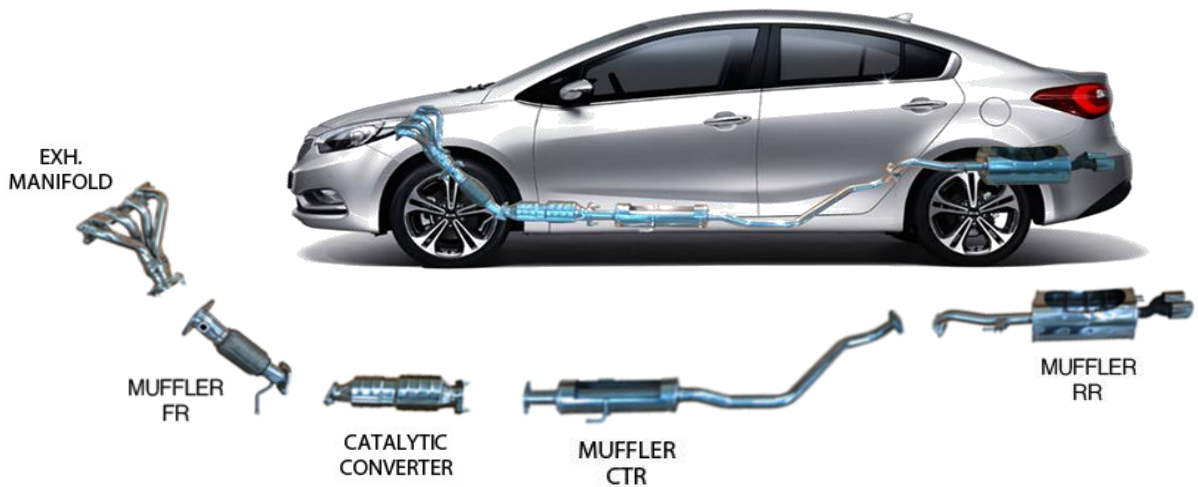

We produce machinery making exhaust systems, including exhaust manifold, catalytic converter, silencer (Muffler-Main/Sub), exhaust pipe, exhaust system support (hanger and hanger rubber) and vibration isolator (bellows).

344 Bloor Street W. Suite 607 Toronto, ON Canada M5S 3A7  
[www.lprglobal.com](http://www.lprglobal.com) | [www.uskoreahotlink.com](http://www.uskoreahotlink.com)  
Phone: +1 416 423 5590  
Email: [info@lprglobal.com](mailto:info@lprglobal.com)

LPR GLOBAL

# Cold End Manufacturing Line

## ■ Resonator (Jacket) Boxing

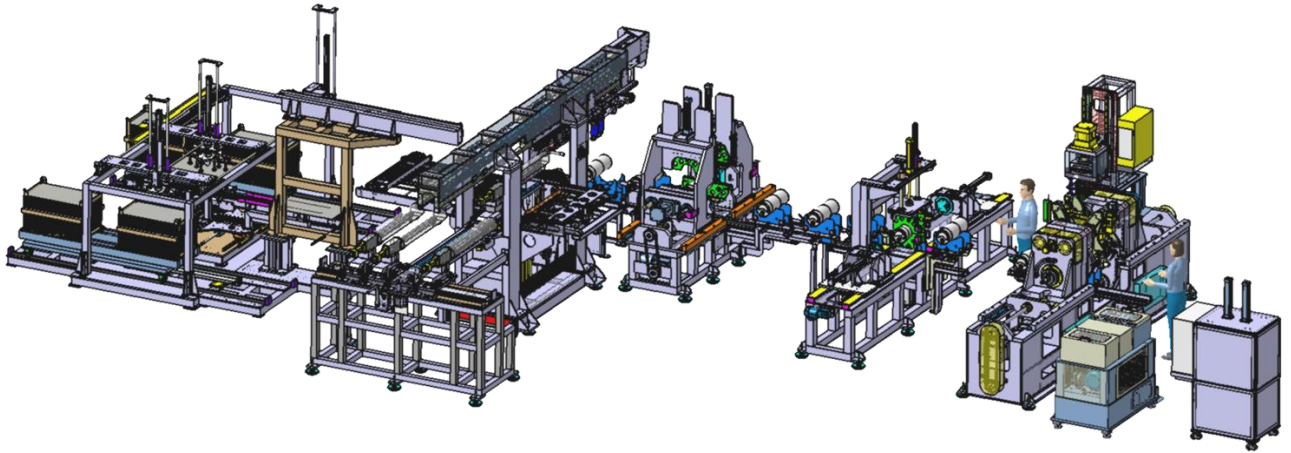

Leak Test

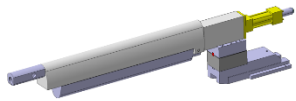

Lock Seaming

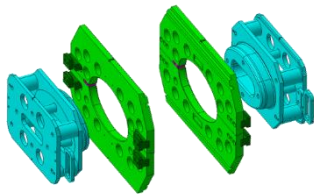

Double Flange

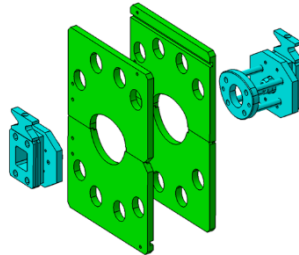

Baffle Inserting

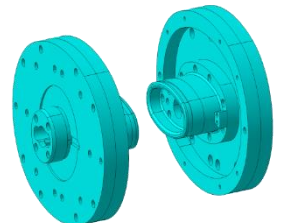

Double Seaming

# Automotive Exhaust System and Muffler Manufacturing Equipment



Muffler Forming Line



Pipe Processing Line



Exhaust System  
Welding Line

## Muffler Forming Line

- Lock Seaming Machine
- Double Flanging Machine
- Baffle Inserting and Jacket Stuffing Machine
- Double Seaming Machine
- Ridge Locking Machine

## Pipe Processing Line

- Pipe Bending Machine
- Pipe Expanding and Reducing Machine
- Pipe Chamfering Machine

## Exhaust System Welding Line

- Robotic CO2 Welding for Bellows and Exhaust Pipes
- Robotic CO2 Welding for Main Exhaust Systems
- CO2 Welding for Pipe and Flange
- Spot Welding for Catalytic Converter Shells

# Lock Seaming Machine | Muffler Forming Line

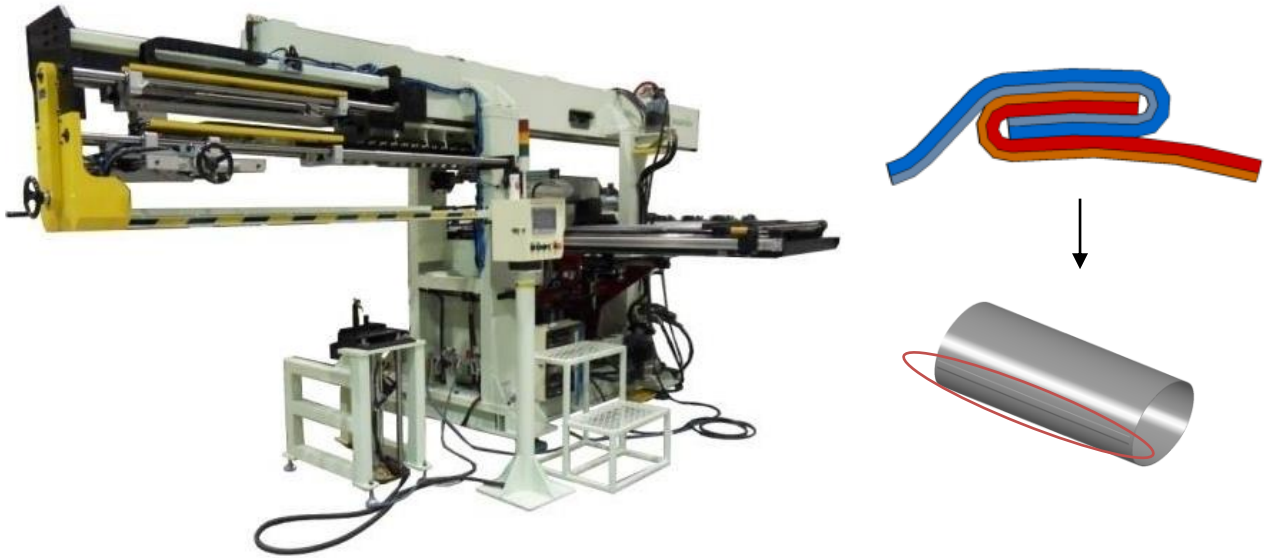

After loading the sheets using an automatic feeding system, the Lock Seaming Machine folds and seams both edges of the steel plate to form the main muffler shell.

SPECIFICATIONS	
Size	7500mm X 3500mm X 2800 mm
Weight	8000 kg
Voltage	380V, 50Hz
Working Height	1800 mm
Power	30 kW
Air Pressure	6 kgf/cm <sup>2</sup>
Motor	63L 4P 1800RPM 126L 4P 1800RPM

# Double Flanging Machine | Muffler Forming Line



The Double Flanging Machine bends both edges of the muffler shell by 90°. This operation is performed after the Lock Seaming Process.

SPECIFICATIONS	
Size	2600mm X 2000mm X 2500 mm
Weight	3000 kg
Voltage	380V, 50Hz
Working Height	1055 mm
Power	15 kW
Air Pressure	6 kgf/cm <sup>2</sup>
Motor	42L 6P 1200RPM

# Baffle Inserting Machine | Muffler Forming Line



The Jacket Stuffing Machine inserts pre-assembled baffles into the muffler shell. Combined Spot Welding and Baffle Inserting Machines are available on request.

SPECIFICATIONS	
Size	Customized
Tooling	Quick tool-change-over type Size-to-fit
Insertion Force	Insertion force measuring system built-in
Direction	Horizontal Type
Calibration	Calibration after insertion built in
Motor	Servo motor slide

# Double Seaming Machine | Muffler Forming Line

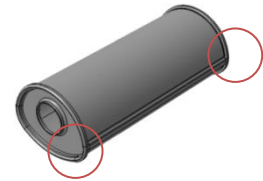

The Double Seaming Machine uses rolls to seal the muffler shell by simultaneously seaming end caps onto both ends.

SPECIFICATIONS	
Size	4900mm X 2400mm X 2000 mm
Weight	8000 kg
Voltage	415V, 50Hz
Working Height	1200 mm
Power	37 kW
Air Pressure	6 kgf/cm <sup>2</sup>
Motor	42L 6P 1200RPM



# Ridge Locking Machine | Muffler Forming Line

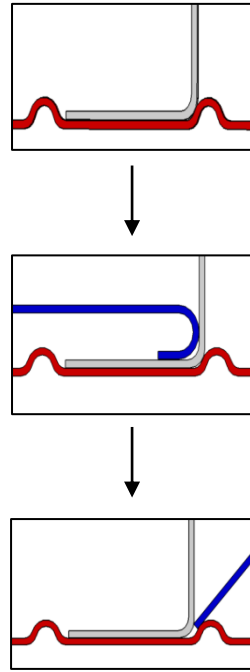

The Ridge Locking Machine creates ridges to combine muffler baffles and tubes into one structure without any need for welding.

SPECIFICATIONS	
Size	2060mm X 1725mm X 2675 mm
Weight	3500 kg
Voltage	380V, 50Hz
Working Height	1260 mm
Motor	44L 4P 1200RPM

# Pipe Bending Machine | Pipe Processing Line



## Customized Pipe Bending Tooling

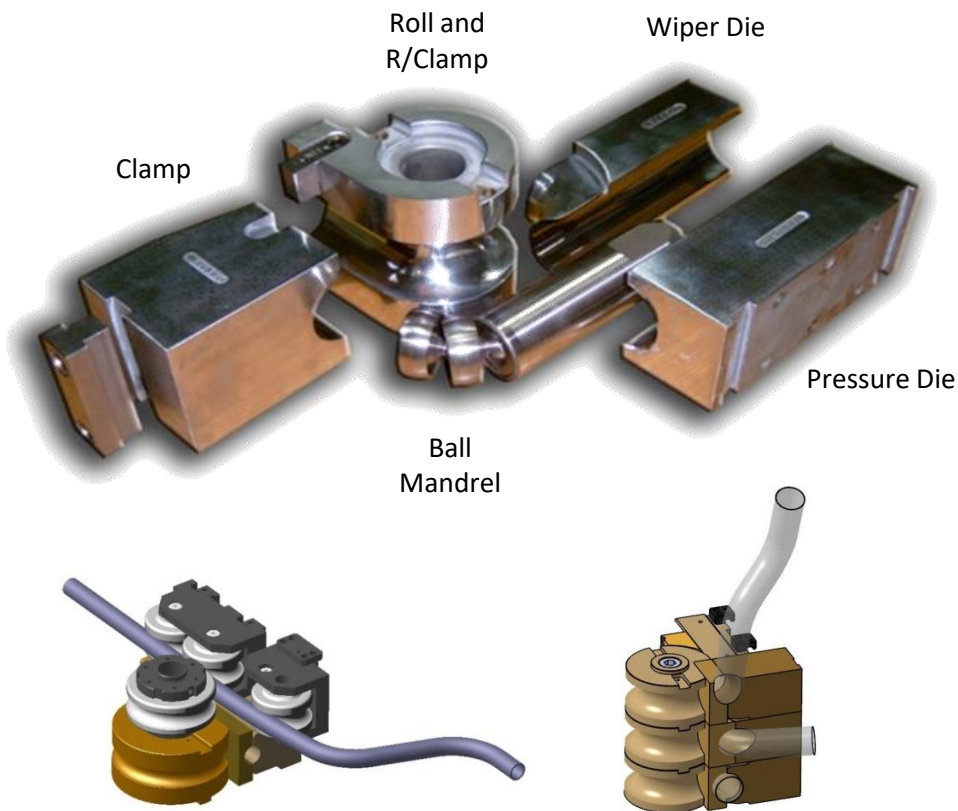

# Pipe End Forming Machine | Pipe Processing Line



One Head and Leak Tester



Two Head



Three Head

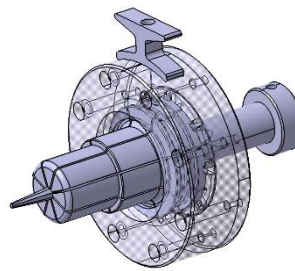
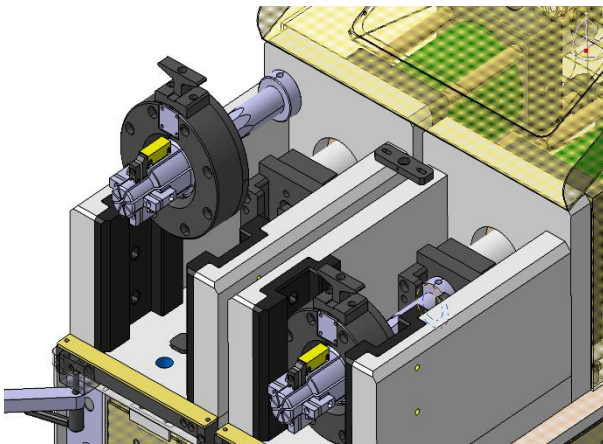

Expanding Tool

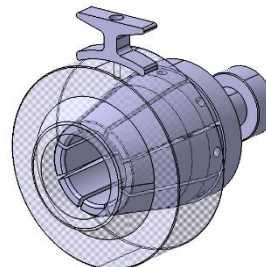

Reducing Tool

# Pipe Chamfering Machine | Pipe Processing Line



Front view



Inside view

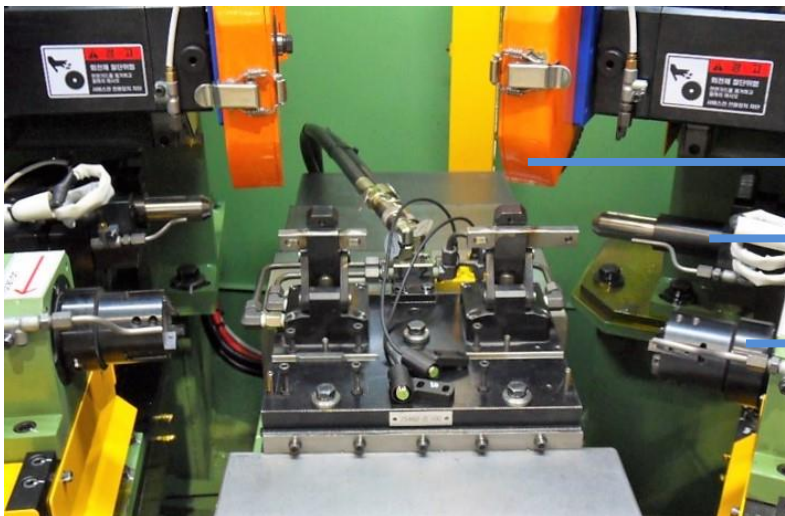

Saw cutting unit

Forming unit

Chamfering unit

# CO2 and Spot Welding Machines | Exhaust System Welding Line

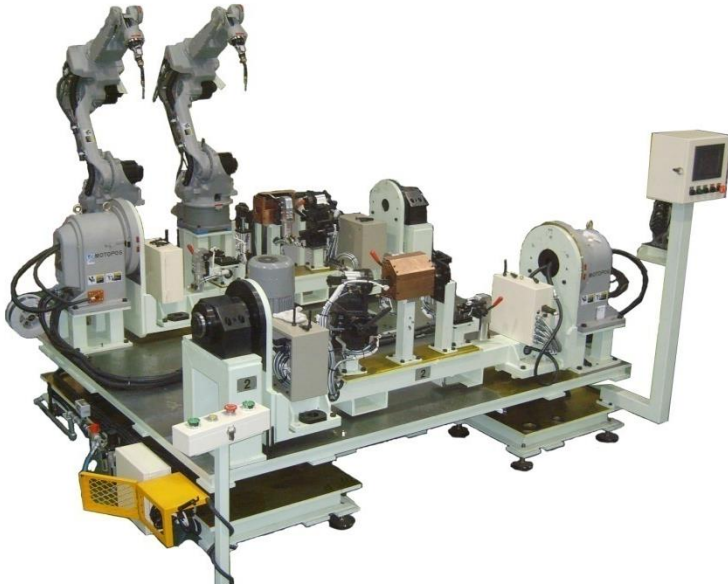

CO2 Welding for Exhaust Pipes and Bellows



CO2 Welding for Main Exhaust System



CO2 Welding for Exhaust Pipes and Flanges



Spot Welding for Catalytic Converter Shells

# Hot End Manufacturing Welding Line

## ■ LNT&DPF Robotic Welding Machine

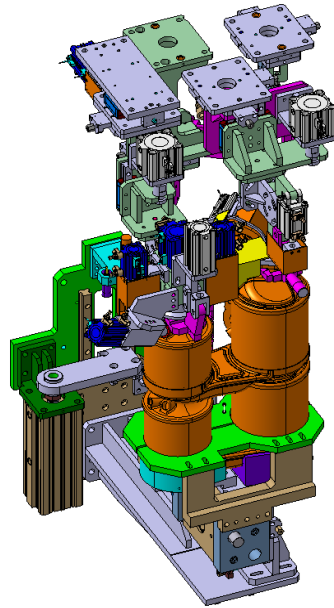
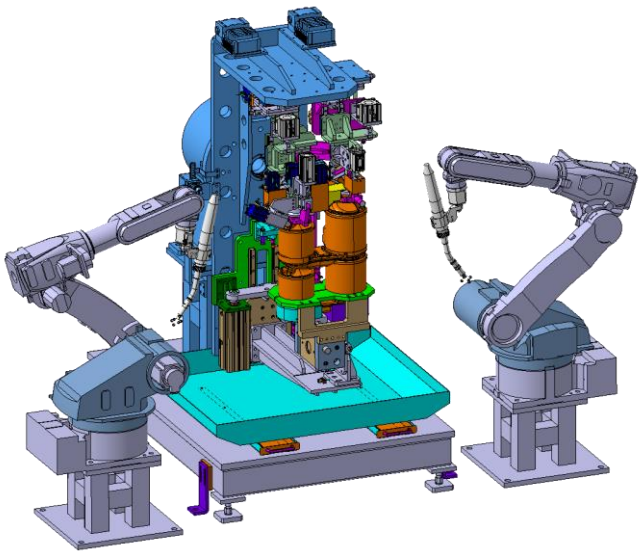

## ■ Heat Shield Spot Welding Machine

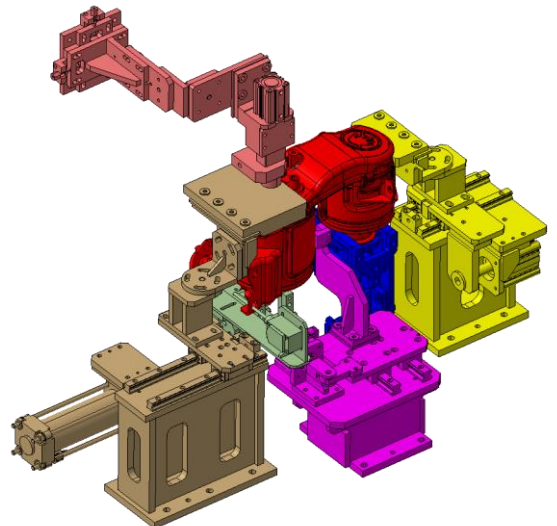
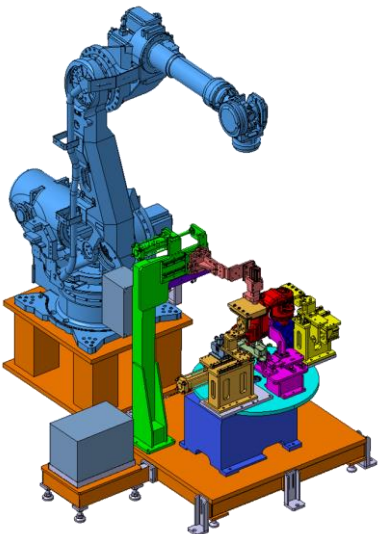

# Hot End Manufacturing Welding Line

## ■ Synchronous Welding Machine

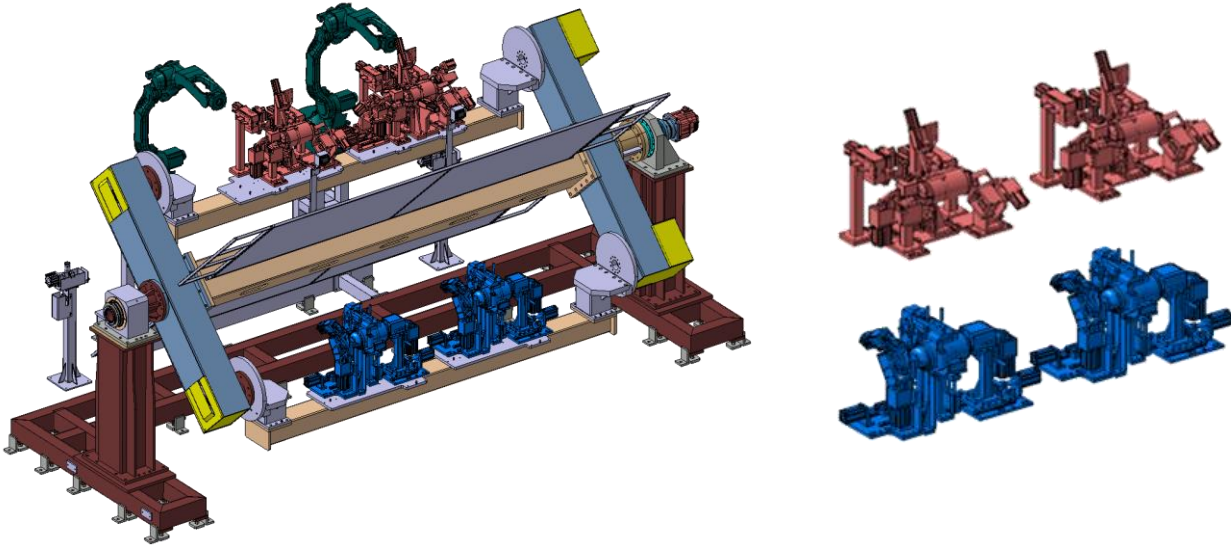

## ■ Inlet & Outlet Pipe Robotic Welding Machine

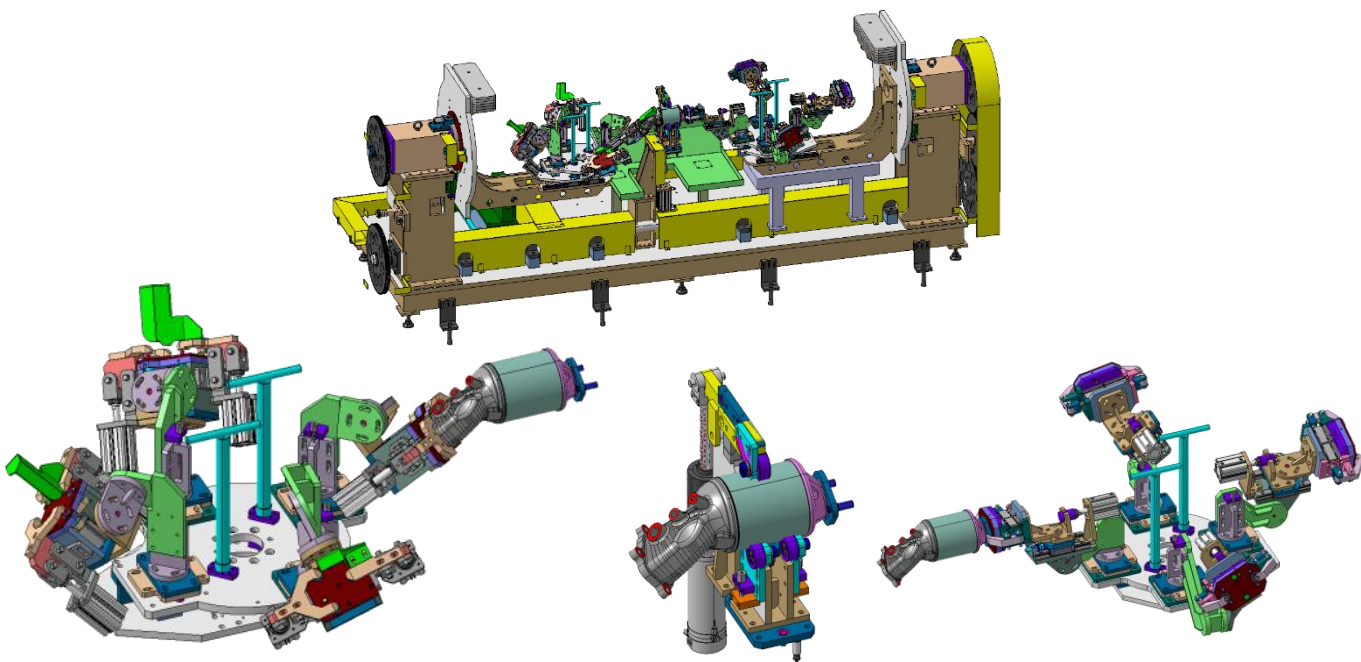

# Hot End Manufacturing Welding Line

## ■ Bracket Robotic Welding Machine

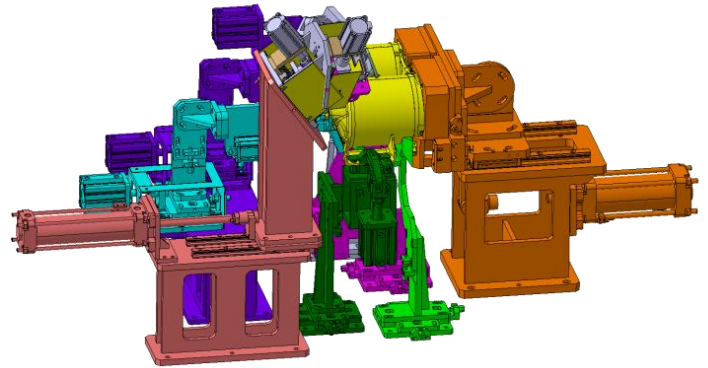
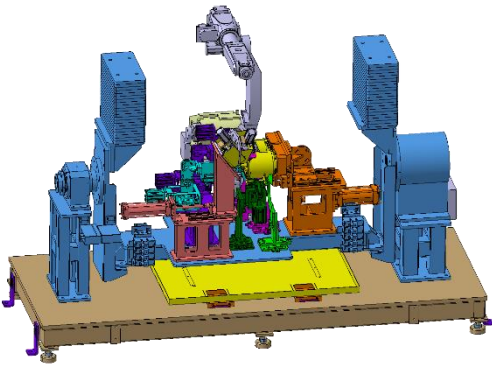

## ■ Catalytic Converter Checking Fixture

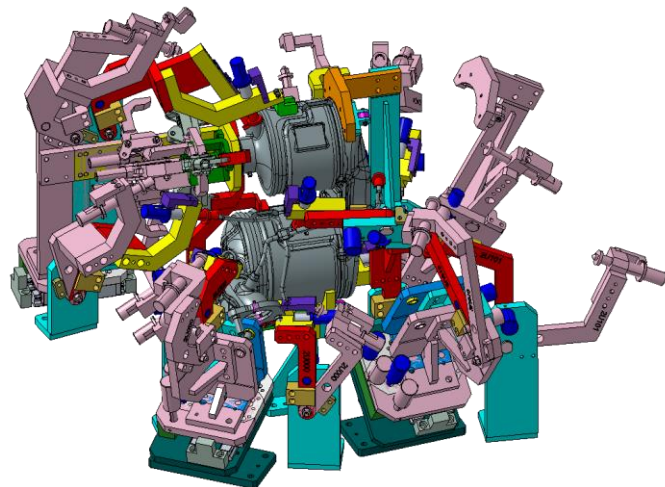
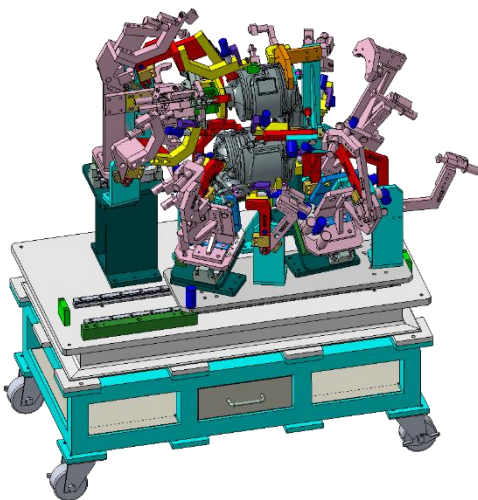



# Hot End Manufacturing Welding Line

## ■ Conveyor

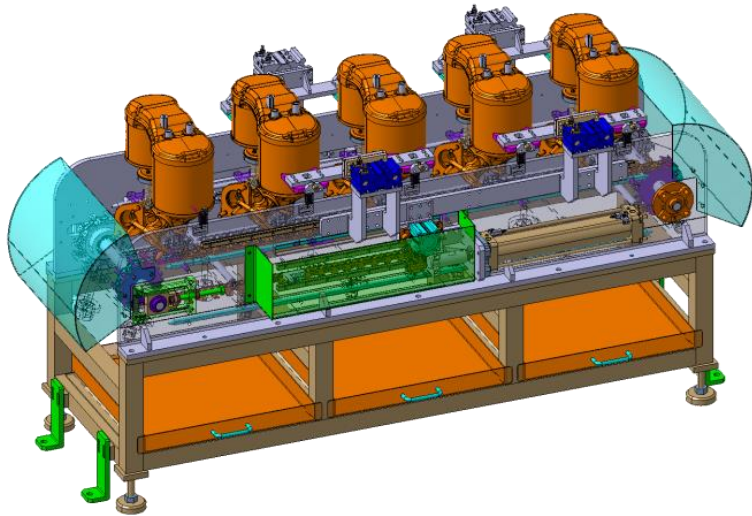

## ■ Automatic Loader

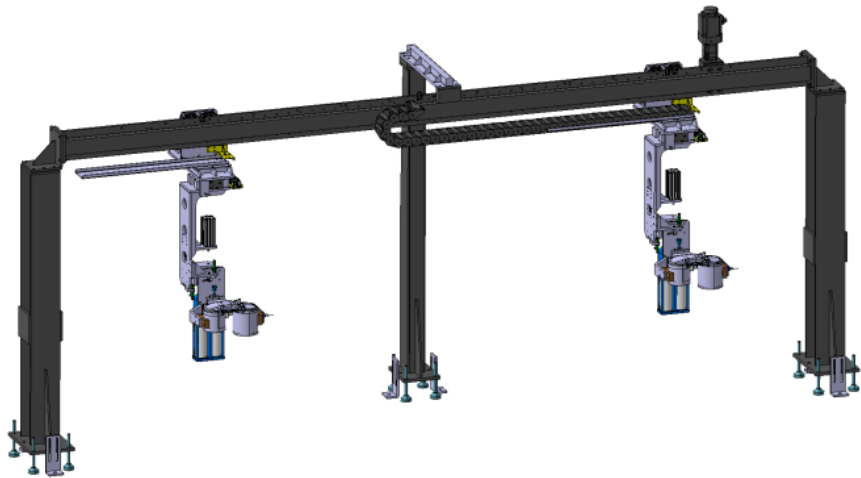

# Hot End Manufacturing Welding Line

## ■ Robot Grippers & Hangers

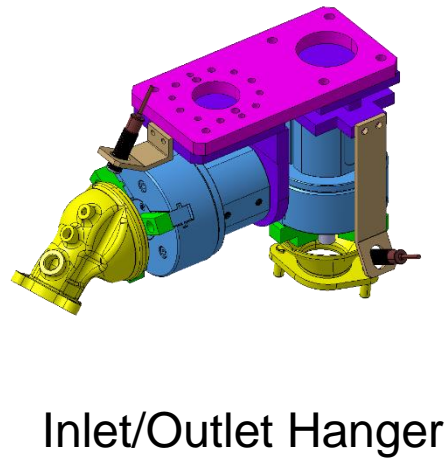
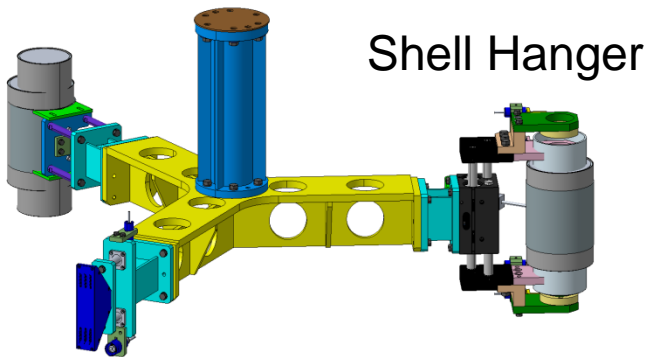

## Internal DPF Hangers

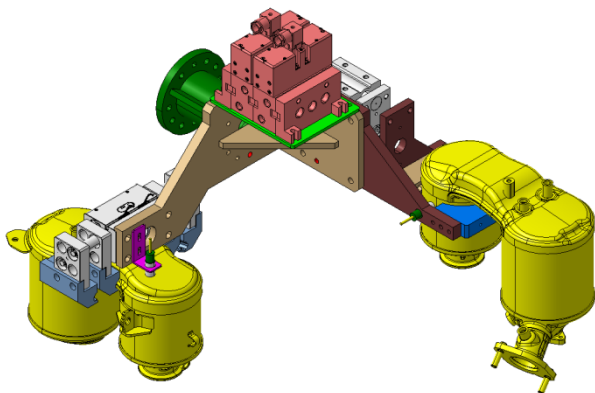

## Front Pipe Hangers

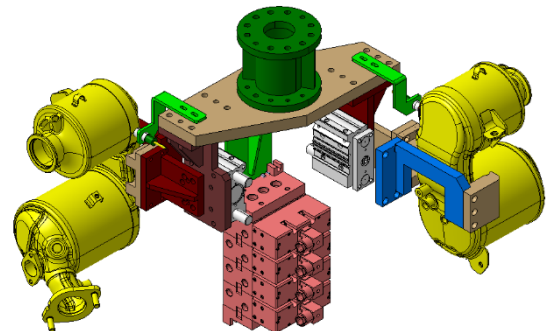

**LPR GLOBAL**



---

**LPR GLOBAL**

344 Bloor Street W., Suite 607, Toronto, ON, Canada M5S 3A7

TEL. +1-416-423-5590

EMAIL [info@LPRGlobal.com](mailto:info@LPRGlobal.com)