

| | | |
|------|-----------------------------|---|
| 1 | REAR FORK | 1 |
| 2 | NEEDLE BEARING, REAR AXLE | 2 |
| 3 | BUSH, REAR FORK | 1 |
| 4 | DUST COVER, REAR FORK | 2 |
| 5 | GUIDE CUSHION, CHIAN | 1 |
| 6 | RIDING WHEEL, CHAIN | 1 |
| 7 | TENSION ROLLER BRACKET | 1 |
| 8 | TENSION ROLLER SPRING | 1 |
| 9 | PROTECTOR, REAR FORK | 1 |
| 10 | PROTECTOR STATOR, REAR AXLE | 1 |
| 11 | REAR AXLE ASSY | 1 |
| 11-1 | CONNECTER HOLDER,REAR AXLE | 1 |
| 11-2 | BEARING | 2 |
| 11-3 | OIL SEAL | 2 |
| 11-4 | BUSH | 1 |
| 12 | BRACKET, REAR BRAKE | 1 |
| 13 | BUSH, REAR BRAKE | 1 |
| 14 | CIRCLIP | 1 |
| 15 | FLANGE BOLT | 5 |
| 16 | FLANGE BOLT | 4 |
| 17 | FLANGE BOLT | 1 |
| 18 | SELF-LOCKING NUT | 1 |
| 19 | SELF-LOCKING NUT | 5 |
| 20 | SELF-LOCKING NUT | 1 |
| 21 | FLAT GASKET | 1 |
| 22 | TENSION ROLLER BOLT | 1 |

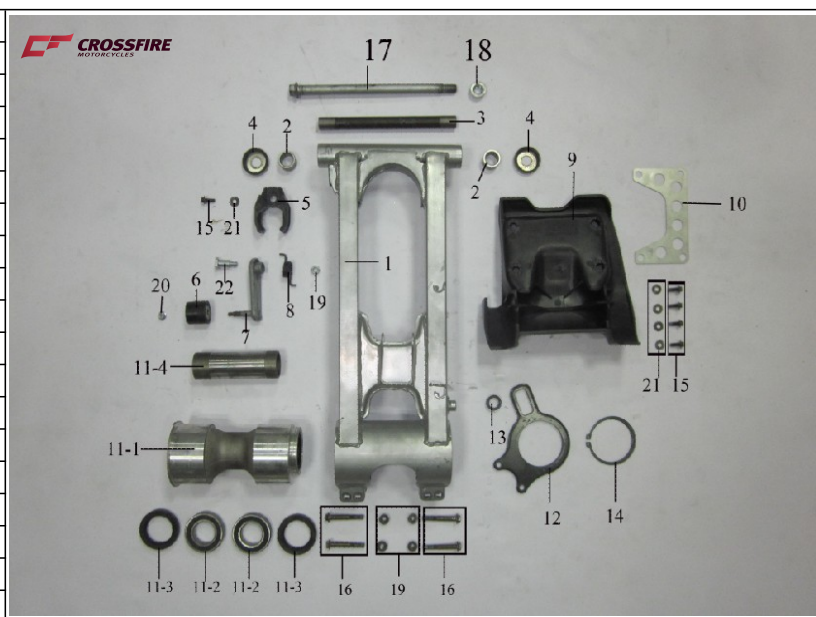

| | | |
|----|-------------------------------|---|
| 1 | REAR AXLE | 1 |
| 2 | REAR SPROCKET | 1 |
| 3 | HOLDER, SPROCKET | 1 |
| 4 | CHAIN | 1 |
| 5 | HOLDER, DISC BRAKE | 1 |
| 6 | LOCK NUT, REAR AXLE | 1 |
| 7 | HELP LOCK BOLT | 2 |
| 8 | LOCK SPRING WASHER, REAR AXLE | 1 |
| 9 | BOLT, SPROCKET | 4 |
| 10 | SELF-LOCKING NUT | 4 |
| | | |
| | | |
| | | |
| | | |
| | | |
| | | |
| | | |
| | | |
| | | |
| | | |
| | | |
| | | |
| | | |
| | | |
| | | |

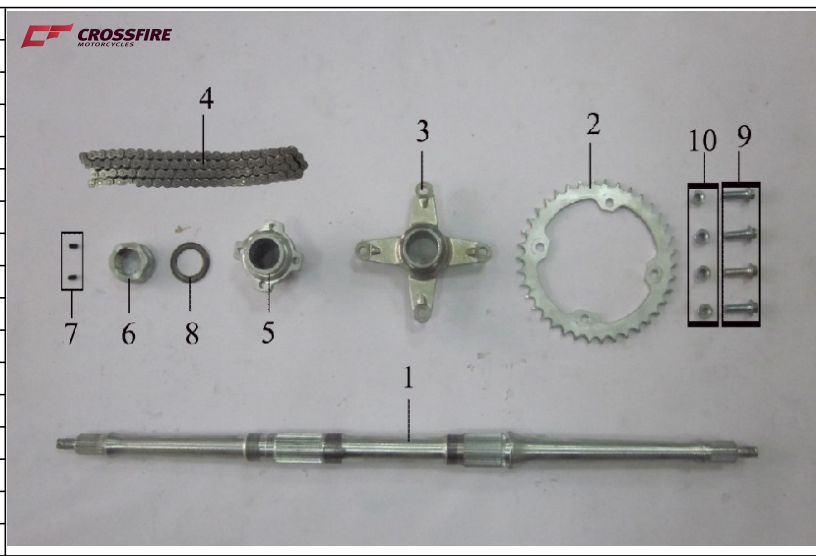

| | | |
|---|------------------|---|
| 1 | REAR SUSPENSION | 1 |
| 2 | FLANGE BOLT | 2 |
| 3 | SELF-LOCKING NUT | 2 |
| | | |
| | | |
| | | |
| | | |
| | | |
| | | |
| | | |
| | | |
| | | |
| | | |
| | | |
| | | |
| | | |
| | | |
| | | |
| | | |
| | | |
| | | |
| | | |
| | | |

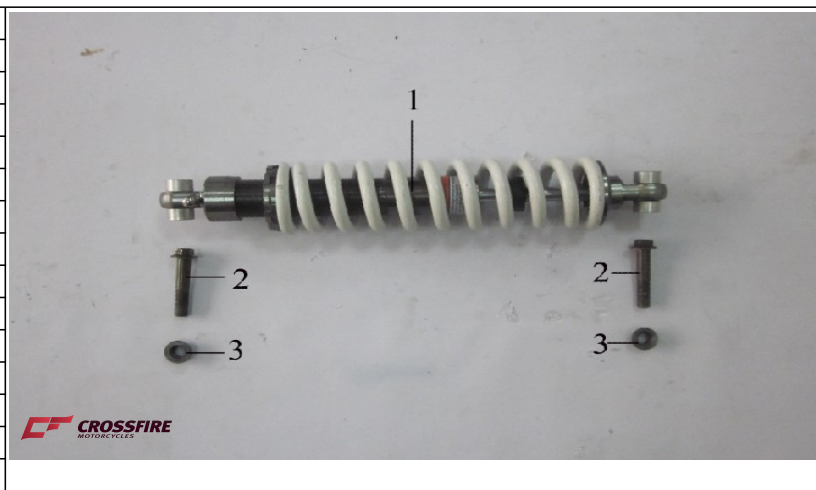

| | | |
|----|---------------------------------|---|
| 1 | STEERING PLOE | 1 |
| 2 | FIXING BLOC, STEERING PLOE | 2 |
| 3 | FIXING BLOC BUSH, STEERING PLOE | 2 |
| 4 | LOCK PLATE, STEERING PLOE | 1 |
| 5 | DEEP GROOVE BALL BEARING | 1 |
| 6 | OIL SEAL | 1 |
| 7 | OIL SEAL | 1 |
| 8 | BUSH, STEERING PLOE | 1 |
| 9 | TURNING SHAFT | 2 |
| 10 | SLOTTED NUT | 1 |
| 11 | FLAT GASKET | 1 |
| 12 | SPLIT PIN | 1 |
| 13 | ORDINARY HEX BOLT | 2 |
| 14 | SPRING WASHER | 2 |
| 15 | SLOTTED NUT | 4 |
| 16 | SPLIT PIN | 4 |
| | | |
| | | |

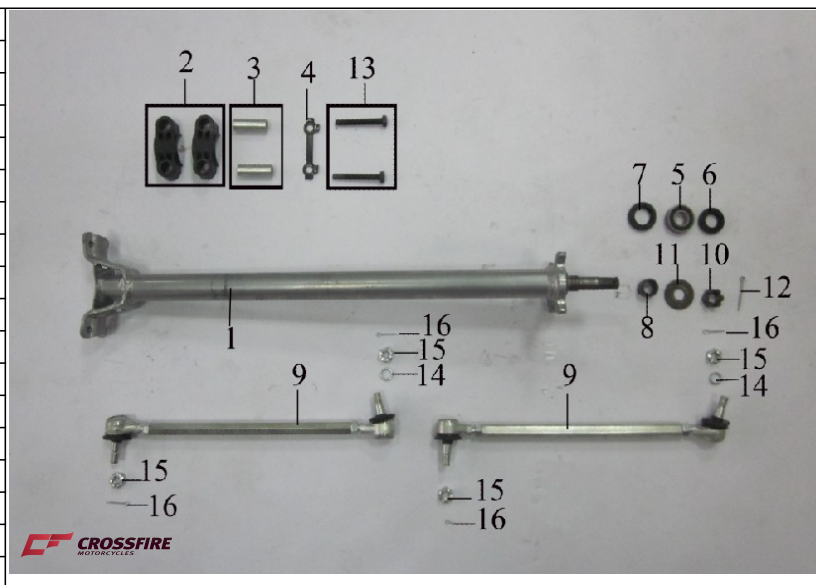

| | | |
|-----|----------------------------------|---|
| 1 | FRONT BRAKE | 1 |
| 1-1 | FRONT BRAKE PAD | 2 |
| 1-2 | FRONT BRAKE LEVER | 1 |
| 1-3 | OIL PIPE, FRONT BRAKE UPPER PUMP | 1 |
| 1-4 | OIL PIPE, FRONT BRAKE LOWER PUMP | 2 |
| 2 | FRONT BRAKE DISC | 2 |
| 3 | OIL PIPE BUCKLE, FRONT BRAKE | 2 |
| 4 | FLANGE BOLT | 4 |
| 5 | SPRING WASHER | 4 |
| 6 | HEX FLANGE BOLT | 4 |
| 7 | FLANGE BOLT | 2 |
| 8 | FLANGE BOLT | 1 |
| 9 | SELF-LOCKING NUT | 1 |
| | | |
| | | |
| | | |
| | | |
| | | |
| | | |
| | | |
| | | |
| | | |

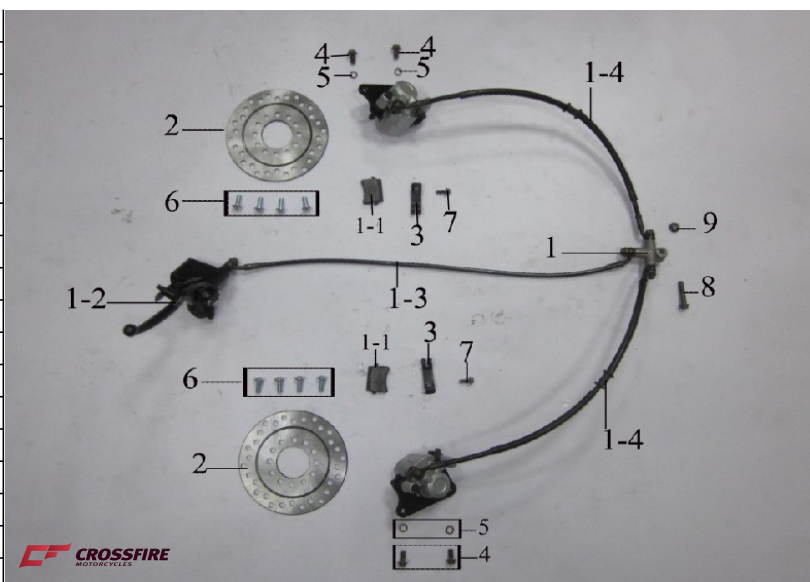

| | | |
|-----|-------------------------|---|
| 1 | REAR BRAKE | 1 |
| 1-1 | REAR BRAKE PAD | 2 |
| 1-2 | REAR BRAKE PUMP | 1 |
| 1-3 | OIL PIPE, REAR BRAKE | 1 |
| 2 | REAR BRAKE DISC | 1 |
| 3 | BUCKLE, SINGLE OIL PIPE | 1 |
| 4 | BUCKLE, DOUBLE OIL PIPE | 1 |
| 5 | FLANGE BOLT | 2 |
| 6 | SPRING WASHER | 2 |
| 7 | HEX FLANGE BOLT | 4 |
| 8 | CROSS SLOT BOLT | 2 |
| 9 | FLANGE BOLT | 2 |
| 10 | SELF-LOCKING NUT | 2 |
| | | |
| | | |
| | | |
| | | |
| | | |
| | | |
| | | |
| | | |

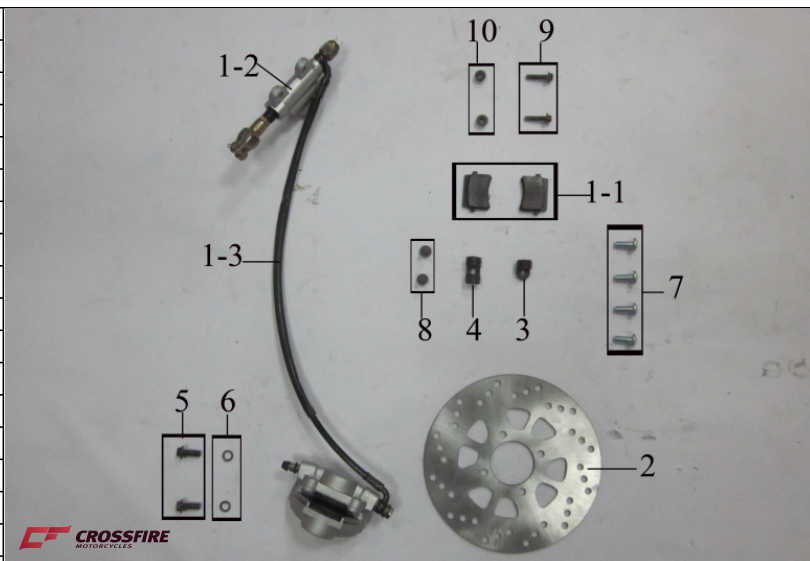

| | | |
|----|----------------------------|---|
| 1 | LEFT FOOTREST | 1 |
| 2 | RIGHT FOOTREST | 1 |
| 3 | FOOT BRAKE LEVER | 1 |
| 4 | SPRING, FOOT BRAKE LEVER | 1 |
| 5 | LEFT PEDAL | 1 |
| 6 | RIGHT PEDAL | 1 |
| 7 | BELT | 2 |
| 8 | MAIN BRACKET, LEFT FENDER | 1 |
| 9 | MAIN BRACKET, RIGHT FENDER | 1 |
| 10 | VICE BRACKET, LEFT FENDER | 1 |
| 11 | VICE BRACKET, RIGHT FENDER | 1 |
| 12 | CONNECT BUCKLE, FENDER | 8 |
| 13 | REAR LEFT FENDER | 1 |
| 14 | REAR RIGHT FENDER | 1 |
| 15 | FLANGE BOLT | 6 |
| 16 | FLAT GASKET | 1 |
| 17 | WAVE WASHER | 1 |
| 18 | CIRCLIP | 1 |
| 19 | FLANGE BOLT | 4 |
| 20 | SELF-LOCKING NUT | 4 |
| 21 | FLAT GASKET | 6 |
| 22 | HEX FLANGE BOLT | 6 |
| 23 | HEX FLANGE BOLT | 2 |
| 24 | FLANGE BOLT | 2 |
| 25 | FLAT GASKET | 8 |
| 26 | SELF-LOCKING NUT | 8 |
| | | |
| | | |
| | | |
| | | |
| | | |
| | | |
| | | |
| | | |

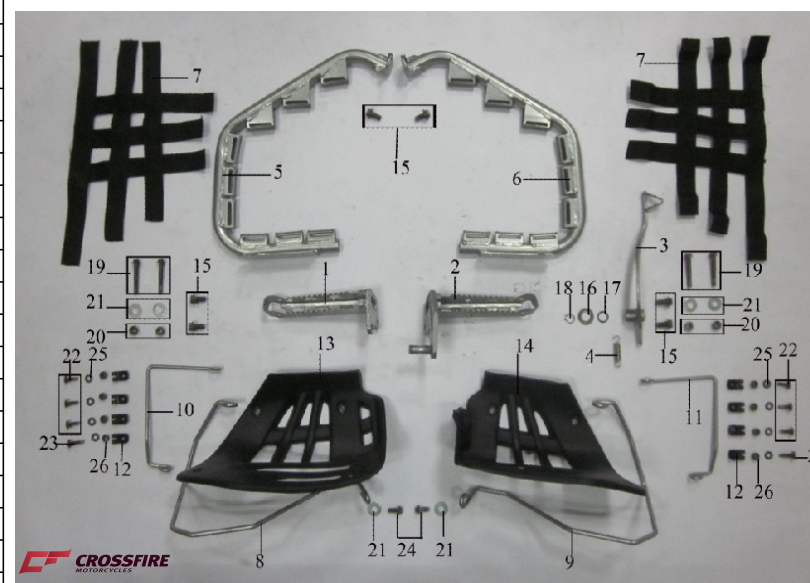

| | | |
|-----|-------------------|---|
| 1 | OIL TANK ASSY | 1 |
| 1-1 | OIL TANK | 1 |
| 1-2 | CAP, OIL TANK | 1 |
| 1-3 | CUSHION RUBBER | 4 |
| 1-4 | BUSH, OIL TANK | 4 |
| 2 | OIL SWITCH | 1 |
| 3 | OIL PIPE | 3 |
| 4 | OIL PIPE | 1 |
| 5 | CIRCLIP, OIL PIPE | 6 |
| 6 | FLANGE BOLT | 4 |
| 7 | FLANGE BOLT | 1 |
| | | |
| | | |
| | | |
| | | |
| | | |
| | | |
| | | |
| | | |
| | | |

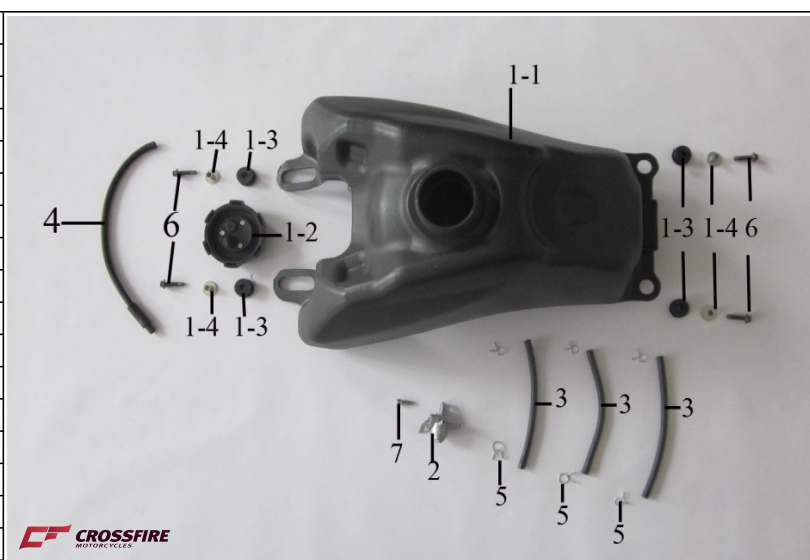

| | | |
|---|-----------------------------------|---|
| 1 | FRONT PLASTIC BODY | 1 |
| 2 | CONNECT PLATE, FRONT PLASTIC BODY | 1 |
| 3 | LEFT BRACKET, FRONT PLASTIC BODY | 1 |
| 4 | RIGHT BRACKET, FRONT PLASTIC BODY | 1 |
| 5 | BOW CAP | 1 |
| 6 | REAR PLASTIC BODY | 1 |
| 7 | LEFT BRACKET, REAR PLASTIC BODY | 1 |
| | | |
| | | |
| | | |
| | | |
| | | |
| | | |
| | | |
| | | |
| | | |

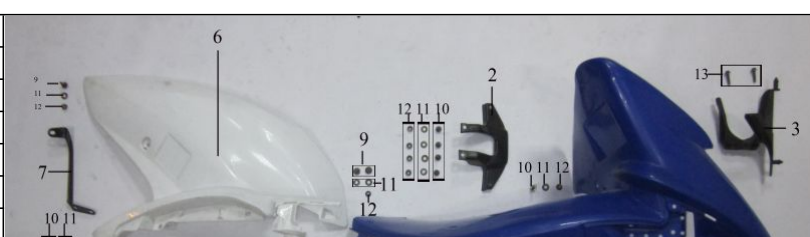

| | | |
|----|----------------------------------|----|
| 8 | RIGHT BRACKET, REAR PLASTIC BODY | 1 |
| 9 | HEX FLANGE BOLT | 8 |
| 10 | HEX FLANGE BOLT | 9 |
| 11 | FLAT GASKET | 15 |
| 12 | SELF-LOCKING NUT | 10 |
| 13 | FLANGE BOLT | 4 |
| 14 | EXPAND BOLT | 2 |
| | | |
| | | |



| | | |
|---|--------------------------|--|
| 1 | ORDINARY STICKER | |
| 2 | WARNING STICKER | |
| 3 | CUSTOMER SPECIAL STICKER | |

| | | |
|---|-------------------|---|
| 1 | FRONT LEFT LIGHT | 1 |
| 2 | FRONT RIGHT LIGHT | 1 |
| 3 | FLANGE BOLT | 2 |
| | | |
| | | |
| | | |
| | | |
| | | |
| | | |
| | | |
| | | |



| | | |
|---|-----------------------|---|
| 1 | TAIL LIGHT | 1 |
| 2 | REFLECTOR | 1 |
| 3 | FLANGE CHECK BACK NUT | 3 |
| 4 | FLAT GASKET | 2 |
| | | |
| | | |
| | | |
| | | |
| | | |
| | | |
| | | |

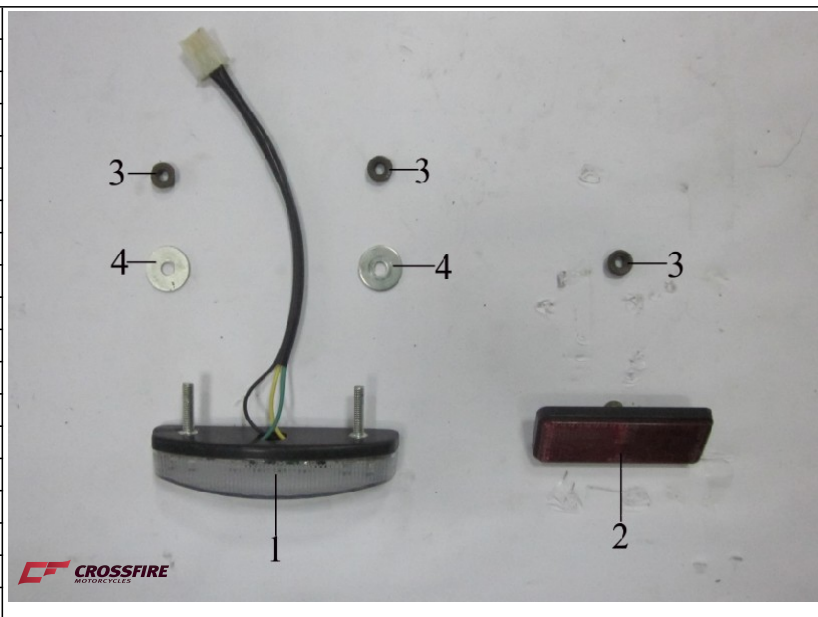

| | | |
|----|--------------------------|---|
| 1 | HANDLEBAR | 1 |
| 2 | GRIP, HANDLEBAR | 2 |
| 3 | FIXING BLOCK, HANDLE BAR | 2 |
| 4 | THROTTLE LEVER | 1 |
| 5 | SWITCH, L. HANDLE BAR | 1 |
| 6 | CLUTCH LEVER | 1 |
| 7 | INDICATOR COVER | 1 |
| 8 | NEUTRAL GEAR LIGHT | 1 |
| 9 | REAR GEAR LIGHT | 1 |
| 10 | CLUTCH CABLE | 1 |
| 11 | FLANGE BOLT | 4 |
| 12 | NYLON TIES | 2 |
| | | |
| | | |
| | | |
| | | |

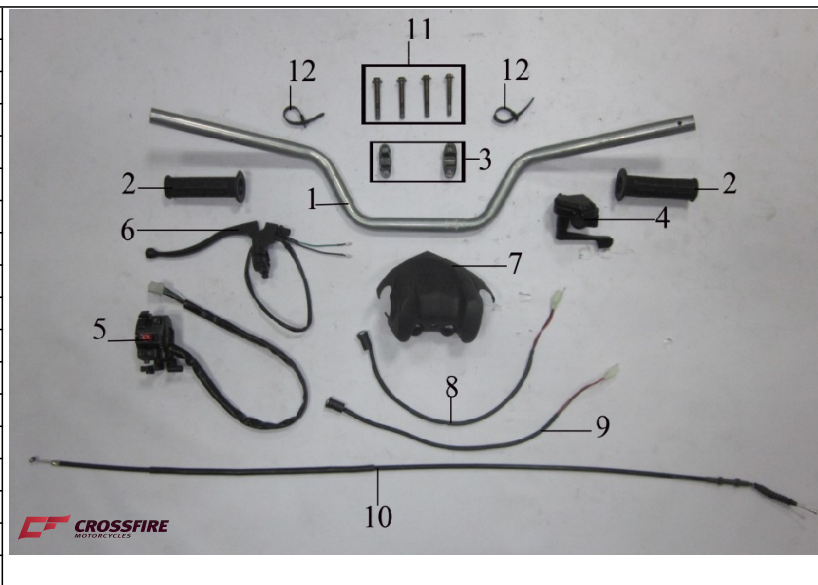

| | | |
|----|---------------------------------|---|
| 1 | SPEEDOMETER | 1 |
| 2 | BRACKET, SPEEDOMETER | 1 |
| 3 | FRONT LEFT TURN LIGHT | 1 |
| 4 | FRONT RIGHT TURN LIGHT | 1 |
| 5 | REAR LEFT TURN LIGHT | 1 |
| 6 | REAR RIGHT TURN LIGHT | 1 |
| 7 | BRACKET, FRONT LEFT TURN LIGHT | 1 |
| 8 | BRACKET, FRONT RIGHT TURN LIGHT | 1 |
| 9 | BRACKET, REAR LEFT TURN LIGHT | 1 |
| 10 | BRACKET, REAR RIGHT TURN LIGHT | 1 |
| 11 | FLASHER | 1 |
| 12 | HORN | 1 |
| 13 | REAR VIEW MIRROR | 2 |

| | | |
|---|------------------|---|
| 1 | FRONT TYRE | 2 |
| 2 | FRONT RIM | 2 |
| 3 | SELF-LOCKING NUT | 8 |
| 4 | | |
| 5 | | |
| | | |
| | | |
| | | |
| | | |
| | | |
| | | |
| | | |
| | | |
| | | |
| | | |
| | | |
| | | |
| | | |
| | | |
| | | |
| | | |
| | | |
| | | |
| | | |

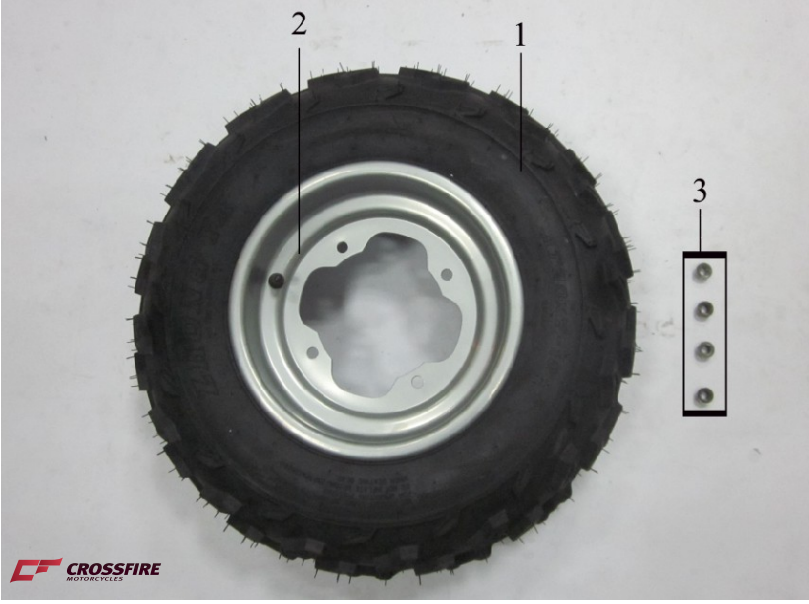

Diagram showing the front tyre assembly. A black tyre is mounted on a silver rim. Three self-locking nuts are shown to the right of the tyre, with lines pointing to their locations on the rim. The tyre has a tread pattern with sipes. The rim has a central hub and four mounting points. A logo for 'CROSSFIRE MOTORCYCLES' is visible in the bottom left corner of the image.

| | | |
|---|----------------------|---|
| 1 | REAR TYRE | 2 |
| 2 | REAR RIM | 2 |
| 3 | CONNECTER, REAR TYRE | 2 |
| 4 | SELF-LOCKING NUT | 8 |
| 5 | SLOTTED NUT | 2 |
| 6 | FLAT GASKET | 2 |
| 7 | SPLIT PIN | 2 |
| | | |
| | | |
| | | |
| | | |
| | | |
| | | |
| | | |
| | | |
| | | |
| | | |
| | | |
| | | |
| | | |
| | | |
| | | |
| | | |
| | | |
| | | |
| | | |
| | | |



Diagram showing the rear tyre assembly. A black tyre is mounted on a silver rim. To the right of the tyre are various components: a connector, self-locking nuts, a slotted nut, a flat gasket, and a split pin. Lines point from these labels to the corresponding parts. The tyre has a tread pattern with sipes. The rim has a central hub and four mounting points. A logo for 'CROSSFIRE MOTORCYCLES' is visible in the bottom left corner of the image.

| | | |
|---|-------------------------|---|
| 1 | SEAT | 1 |
| 2 | SEAT LOCK LEVER | 1 |
| 3 | SPRING, SEAT LOCK LEVER | 1 |
| | | |
| | | |
| | | |
| | | |
| | | |
| | | |
| | | |
| | | |
| | | |
| | | |
| | | |
| | | |
| | | |
| | | |
| | | |
| | | |
| | | |
| | | |
| | | |
| | | |
| | | |

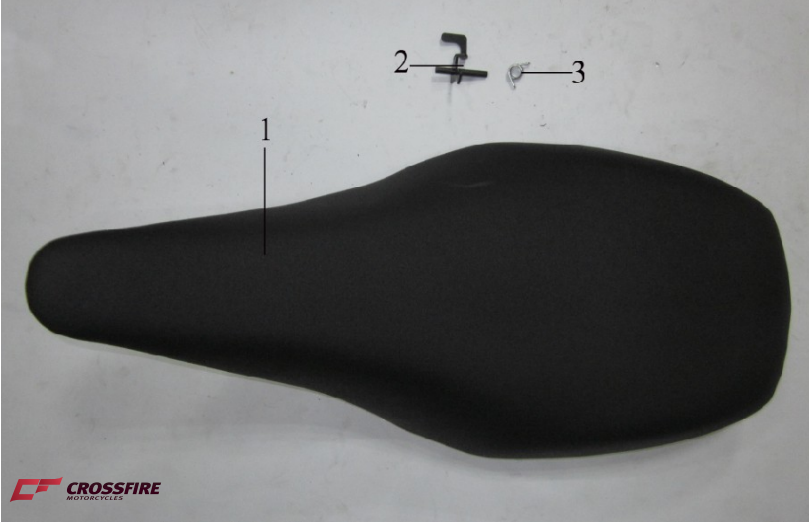

Diagram showing the seat assembly. A black seat is shown. To the right of the seat are a seat lock lever and a spring. Lines point from these labels to the corresponding parts. The seat has a contoured shape. A logo for 'CROSSFIRE MOTORCYCLES' is visible in the bottom left corner of the image.

| | | |
|---|--------------------|---|
| 1 | FRONT BUMPER | 1 |
| 2 | RR. LIFTING HANDLE | 1 |
| 3 | FLANGE BOLT | 1 |
| 4 | FLANGE BOLT | 2 |
| 5 | SELF-LOCKING NUT | 1 |
| 6 | FLANGE BOLT | 4 |
| | | |
| | | |
| | | |
| | | |
| | | |
| | | |
| | | |
| | | |
| | | |
| | | |
| | | |
| | | |
| | | |
| | | |
| | | |
| | | |
| | | |
| | | |
| | | |
| | | |
| | | |

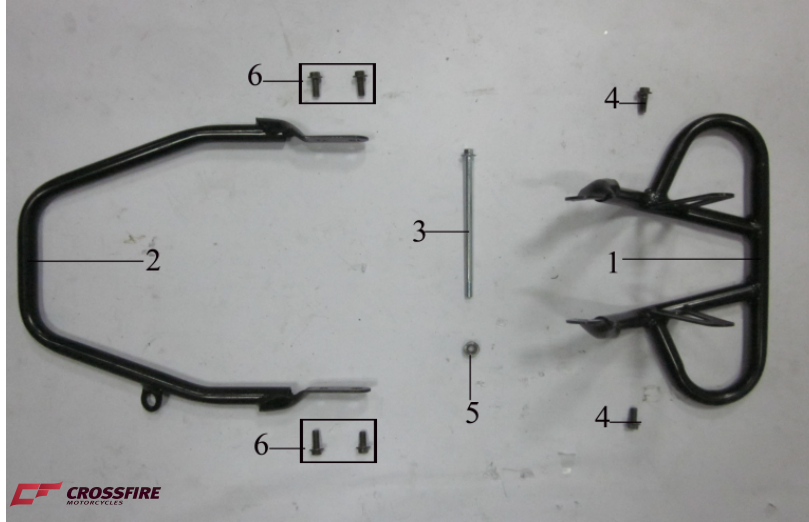

Diagram showing the front bumper and rear lifting handle assembly. The front bumper is a black U-shaped metal bar. The rear lifting handle is a black metal handle with two loops. Various bolts and nuts are shown, with lines pointing to their locations on the bumper and handle. A logo for 'CROSSFIRE MOTORCYCLES' is visible in the bottom left corner of the image.

| | | |
|---|---------------------|---|
| 1 | PACKING STEEL FRAME | 1 |
| 2 | CARTON | 1 |
| 3 | CARDBOARD | 1 |
| 4 | TOOLKIT | 1 |
| 5 | MANUAL | 1 |
| 6 | PACKING BAG | |
| 7 | TIES | |
| 8 | PACKING BELT | |
| 9 | STANDARD PARTS | |