

NetApp Certified Implementation Engineer - SAN, E-Series

Network Appliance NS0-515 Dumps Available Here at:

<https://www.certification-questions.com/network-appliance-exam/ns0-515-dumps.html>

Enrolling now you will get access to 60 questions in a unique set of NS0-515 dumps

Question 1

Click the Exhibit button.

Rock_Group

(Optimal) (14 drives, 17820.00 GiB capacity, [2 free capacity areas](#))



Secure-capable Yes not enabled | DA No

An administrator is asked to create a 5532 GiB volume from the volume group. Referring to the exhibit, how would the administrator complete this request?

Options:

- A. Create the volume after performing space reclamation
- B. Create the volume after consolidating the capacity
- C. Create the volume from the available capacity
- D. Create the volume after adjusting the preservation capacity

Answer: C

Question 2

A customer intends to use an E2812 system without expansion shelves. The specification for their Windows host requires that six E-Series data volumes be used.

In this scenario, how should the system be configured?

Options:

- A. one DDP with all the volumes
- B. three DDPs with the volumes divided equally
- C. one DDP for each volume
- D. two DDPs with the volumes divided equally

Answer: A

Explanation:

Reference: <https://www.netapp.com/us/media/tr-4725.pdf> (37)

Question 3

Click the Exhibit button.

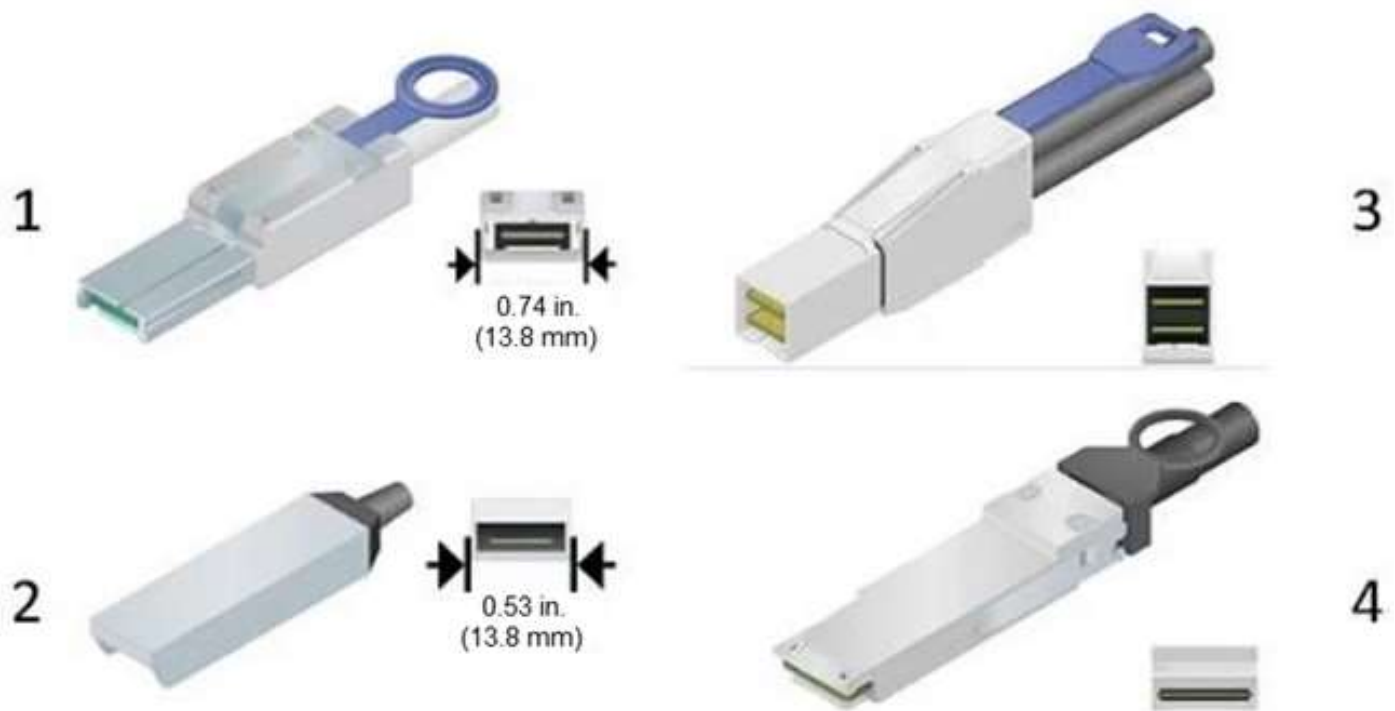

Referring to the exhibit, which SAS connector is supported on the NetApp E2800 E-Series family?

Options:

- A. 1
- B. 4

C. 2

D. 3

Answer: D

Explanation:

Reference: <https://slideplayer.com/slide/11944194/>

Question 4

A company implemented Automatic Load Balancing (ALB). When the controller workloads are monitored, it becomes obvious that there is an imbalance and that ALB is not working correctly.

In this scenario, what are two causes of the problem? (Choose two.)

Options:

- A. The company implemented a load balancing min-min algorithm that does not support ALB
- B. The company implemented an adaptive load balancing agent that does not support ALB
- C. The company implemented a host multipath driver that does not support ALB
- D. The company implemented a host type that does not support ALB

Answer: C, D

Explanation:

Reference: <https://mysupport.netapp.com/NOW/public/eseries/sam/index.html#page/GUID-8538272A-B802-49D9-9EA2-96C82DAD26A2/GUID-90A829B6-ACEE-41C6-8595-91C7D90554EB.html>

Question 5

A company wants the most scalable host-side connection topology for E-Series systems.

In this scenario, which FC topology would satisfy the requirement?

Options:

- A. direct connect
- B. fabric attach
- C. private loop
- D. arbitrated loop

Answer: B

Question 6

Click the Exhibit button.

E2812 and E2824 controller shelf and EF280 flash array: Weight

Unit	Weight		
	Maximum*	Empty**	Shipping***
E2812 controller shelf, with twelve 3.5 in. (8.89 cm) SAS-3 drives each with 6 TB capacity	63.9 lb (29.0 kg)	17.08 (7.75 kg)	80 lb (36.2 kg)
E2824 controller shelf and EF280 flash array, with twenty-four 2.5 in. (6.35) SAS-3 drives each with 900 GB capacity	60.5 lb (27.4 kg)	17.4 lb (7.89 kg)	91 lb (41.2 kg)
<p>* Maximum weight indicates a controller shelf, fully-loaded with the heaviest drives and all other components installed. Because drive weights can vary greatly, this value can vary, depending on the drives installed. Refer to the next table for weight ranges by drive type.</p> <p>** Empty weight indicates a controller shelf with the controller canister, the power fan-canister, and the drives removed.</p> <p>*** Shipping weight indicates the maximum weight of the controller shelf and all shipping material.</p>			

Component	Weight
Controller canister	5.47 lb (2.48 kg)
Power-fan canister	5.2 lb (2.35 kg)
2.5 in. SAS drive	0.6 lb (0.27 kg)
3.5 in. SAS drive	2.09 lb (0.95 kg)
2.5 in. SSD (solid-state disk)	1.33 lb (0.6 kg)

A customer has a raised floor with a weight limit of 700 lb. per floor tile. The customer's data cabinet weighs 90 lb. and covers a single floor tile.

Referring to the exhibit, what is the maximum number of E2824 shelves possible to be installed?

Options:

- A. 22
- B. 10
- C. 6
- D. 14

Answer: A

Question 7

Click the Exhibit button.

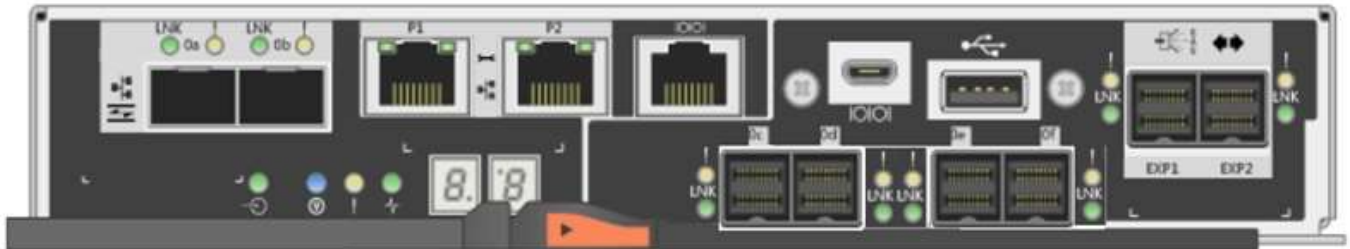

Referring to the exhibit, which three statements are true? (Choose three.)

Options:

- A. There are two SAS expansion ports available
- B. There are six SAS host ports available
- C. There are two Base-T iSCSI ports available
- D. There are two FC/iSCSI host ports available
- E. There are four SAS host ports available

Answer: B, C, D

Question 8

You are cabling drive expansion shelves for an E2800 storage system. In this scenario, which cabling method should you use?

Options:

- A. You use SAS expansion port EXP1 and reserve SAS expansion port EXP2 for a second drive expansion stack.
- B. The controller A and the controller B SAS expansion ports (EXP1 & EXP2) should be divided between the A-side and B-side IOM-12 modules for all the expansion shelves.
- C. You use SAS expansion port EXP2 and reserve SAS expansion port EXP1 for a second drive expansion stack.

D. The controller A and the controller B SAS expansion ports (EXP1 & EXP2) should not be divided between the A-side and B-side IOM-12 modules for all of the expansion shelves.

Answer: B

Explanation:

Reference https://library.netapp.com/ecm/ecm_download_file/ECMLP2773537

Question 9

A customer needs to add an EF280 with FC into its existing Brocade fabric but the FC ports in the SANtricity System Manager are showing the FC ports as down and the LED on the FC HIC is amber. Which three tasks does the installer need to complete to solve this problem? (Choose three.)

Options:

- A. Verify that the ports are enabled on the switch
- B. Verify that the cables are plugged into the switch
- C. Verify that the server HBA has the boot BIOS enabled
- D. Verify that the EF280s management port is up
- E. Verify that the switch zone has the WWPNs for the EF280 and Server HBAs

Answer: A, B, E

Question 10

Click the Exhibit button.

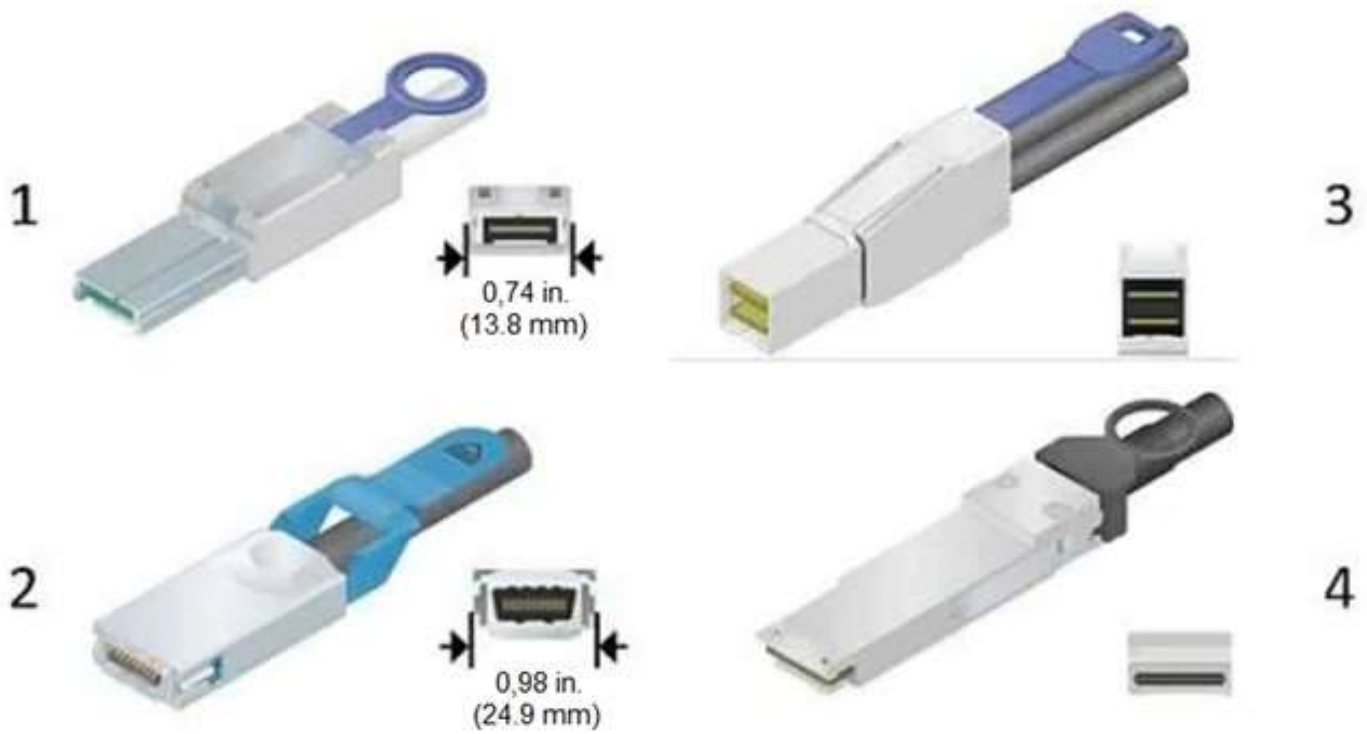

Referring to the exhibit, which cable is an InfiniBand 4X connector?

Options:

- A. 3
- B. 1
- C. 2
- D. 4

Answer: C

Explanation:

Reference: http://www.admin-sys.org/IMG/pdf/Hardware_Universe.pdf

Would you like to see more? Don't miss our NS0-515 PDF file at:

<https://www.certification-questions.com/network-appliance-pdf/ns0-515-pdf.html>