

BEAVER MARQUIS® | 2007

BEAVER MARQUIS® | 2007



BEAVER MARQUIS® | 2007

In a class all its own.

Rich wood. High gloss. Sumptuous comfort and unexpected treasures. Welcome to the 2007 Beaver Marquis, unlike any other RV on the road today. We've taken the latest in technology and wrapped it in the natural splendor of exotic woods. And the results are stunning. Every inch of the Marquis is designed to delight and inspire. Of course, we know that looks aren't everything. So we worked to ensure that its performance rivals its aesthetics. It's equipped to handle the road easily and safely. What's more, it's rugged and durable – built to last and to maintain its appeal for years to come.

The 2007 Marquis from Beaver. An instant classic.



BEAVER SELECT WOODS #001

Beaver's legendary high-gloss finish is created without any stain so the natural splendor of the wood grain shows through. Layer upon layer of lacquer is applied with hand sanding and buffing between each layer. The result is a rich, natural finish that literally shines with beauty.

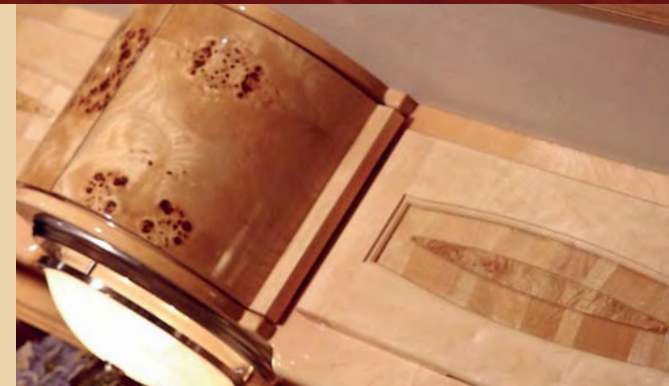



BEAVER MARQUIS® | 2007

The best of both worlds.

While the handcrafted wood is the first thing people notice, the Marquis has a wealth of treasures to discover. Such as the 40" Sony LCD TV located in the living area ceiling, now standard and the sumptuous comfort of the OptimaLeather™ cockpit seats with electric lumbar and heat. Or the optional computer table, which when combined with the optional large bay window, provides a perfect setting for reflecting on travels.





The difference can be found in the details.

The size of the Marquis is impressive, especially since we increased the interior ceiling height to a full seven feet. Just as remarkable are the small details. Niceties that add comfort, such as the ample leg room the new side-slide, solid surface fixed dining table offers. An extra bit of convenience that makes life on the road an indulgence.



BEAVER SELECT WOODS # 0 0 2

Never content with the average woods, we search the globe to find the best wood available. And we're just as discriminating when it comes to quality. We only accept wood of the highest caliber, hand selecting trees for a consistent overall look in grain, texture and color.



ROADMASTER AND CHASSIS CONSTRUCTION

A foundation for success.

Knowing full well the importance of a strong base, the Beaver Marquis relies exclusively on the incomparable Roadmaster chassis for its foundation. Roadmaster builds each chassis to the exact specifications of Beaver models and floorplans. What's more, because Roadmaster's entire focus is luxury motorhomes, the design, craftsmanship and quality of their chassis are second to none. Some of the most important benefits of a Roadmaster chassis are spelled out here. For a closer look, visit our website at www.beavermotorcoaches.com and look for the Roadmaster link.

POWERED BY CATERPILLAR®

Beaver is proud to offer Caterpillar® 525 HP C-13 engines with ACERT® technology. Road tested for millions of miles, Cat engines offer unbeatable reliability and durability. Plus, a Cat with ACERT® technology gives you high performance with the lowest operating costs in the industry. In fact, its maintenance intervals are 30,000 miles, compared with 25,000 for other engines. The C-13 outperforms the competition in horsepower and torque and features the tremendous responsiveness of series turbo charging. The Cat is also backed by an industry-leading 5-year/200,000 mile warranty with no deductible. And finally, ACERT® technology gives you the cleanest-running engine available – and is fully compliant with EPA-mandated standards.

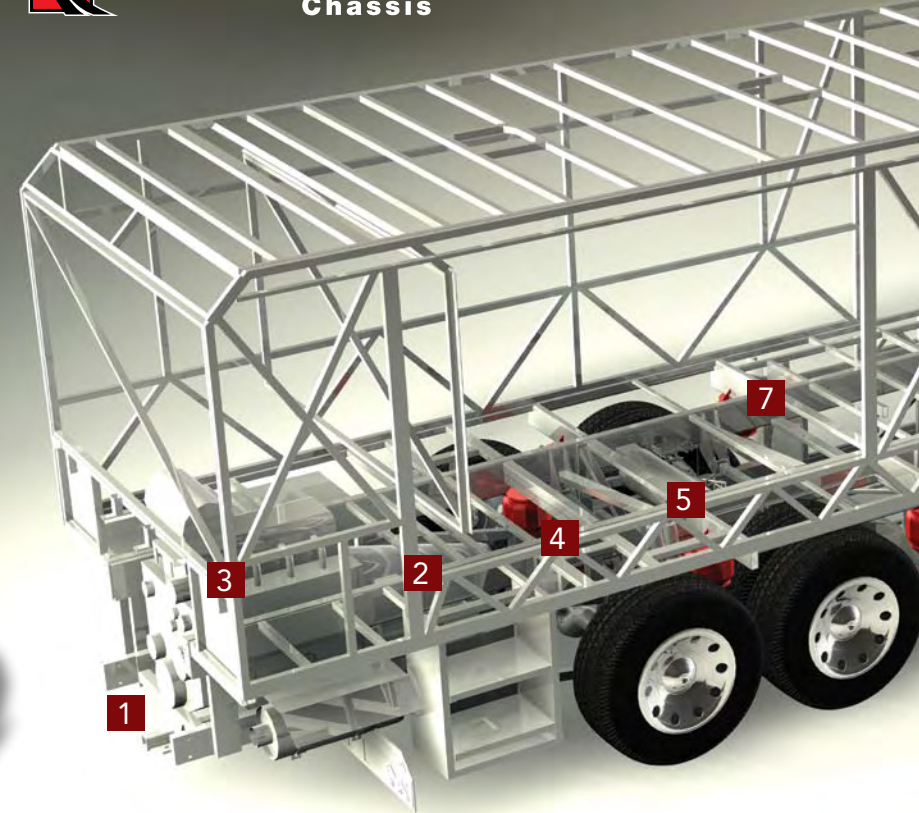

- 1 10,000 lb. hitch receiver offers powerful towing capacity with 7/4-way trailer plug. The coach also has a new prewire for a supplemental braking system.
- 2 The three-point engine mounting system lowers the coach's center of gravity and reduces the amount of vibration that reaches the coach. The mounting also makes the engine easier to service by allowing the engine to be easily lowered through the bottom of the coach.
- 3 Caterpillar® 525 HP ACERT® C-13 Engine.
- 4 Allison® 4000 MH 6-speed transmission for smooth shifting; our exclusive use of synthetic transmission fluid allows for up to three-year maintenance intervals.
- 5 Cushion Air-Glide suspension system positions ten Bilstein® shocks and ten air bags, eight of which are outboard mounted with auto-leveling for greater stability, a smoother ride and the best handling in its class.
 - Unique three-degree rear axle tilt aligns the engine, transmission and differential, minimizing stress on the drivetrain and reducing noise and vibration in the coach.
 - Automatic Traction Control (ATC) eliminates wheel slippage in slick conditions and heightens control.
 - Tag axle lifts for added maneuverability in tight spots.



Aladdin™ makes it easy to keep track of many important functions, including tank levels, temperatures, mileage and much more.



With the GPS option, you're free to explore the middle of nowhere and always know exactly where you are.

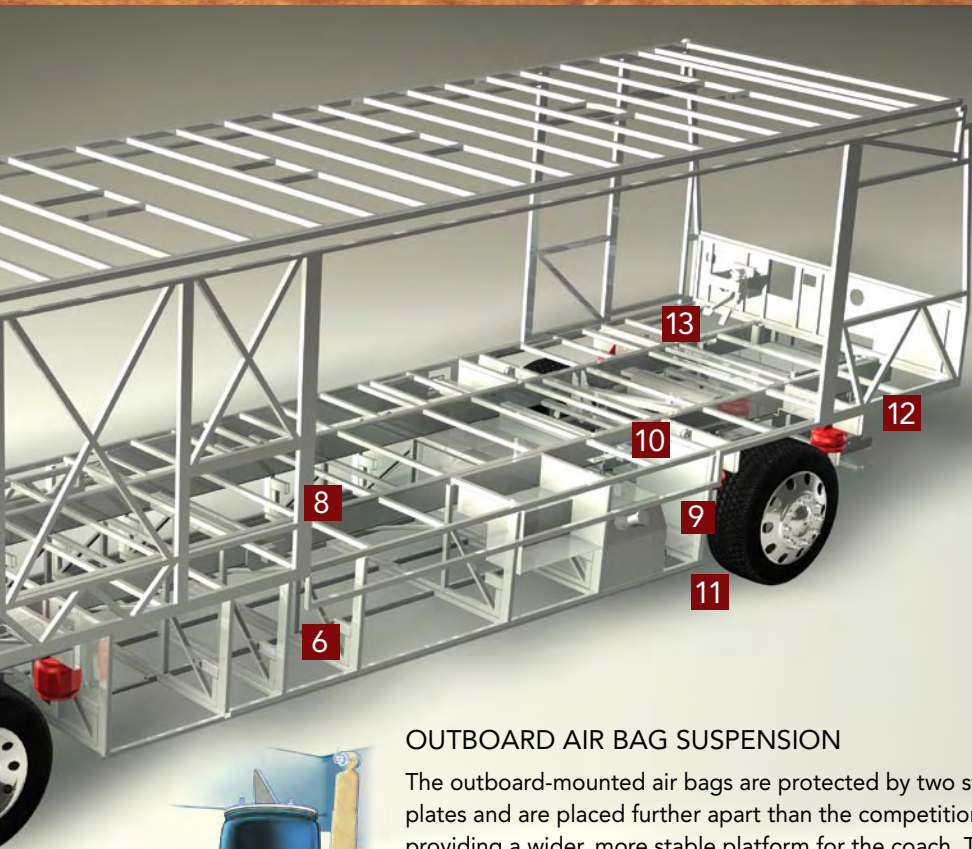

OUTBOARD AIR BAG SUSPENSION

The outboard-mounted air bags are protected by two steel plates and are placed further apart than the competition, providing a wider, more stable platform for the coach. The active suspension automatically adjusts the pressure of the air bags as you drive and virtually eliminates nosediving and the side-to-side body sway associated with high wind conditions, curvy roads and emergency maneuvers.

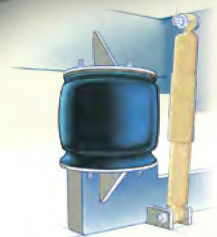

- 6 Basement structure rust inhibitor: To prevent corrosion, the basement storage area is constructed with pre-primed steel with rust-inhibiting paint.
- 7 Full-length frame rails fabricated from 3" by 8" by 1/4" 60,000 PSI structural steel; rails are spaced 46" on center for a wider stance and unmatched strength.
- 8 The semi-monocoque design, with trussed superstructure, distributes stress evenly throughout the entire chassis and adds strength to sidewalls and bays.
- 9 Cat® compression two-stage engine brake system assures you of safely traveling steep grades while 6-wheel anti-lock brakes with disc brakes in front help you maintain control in severe road conditions.

ROOF CONSTRUCTION (top to bottom)

- One-piece 1/4" thick fiberglass roof, crowned for water runoff and seamlessly joined with front and rear end caps
- Vapor barrier
- 3 1/2" tapered bead foam supports the crowned roof; the center tunnel houses wiring and air conditioner ducts
- 1/4" marine grade plywood sheeting
- Tubular steel framework
- R 7.5 closed cel foam seals every nook and crevice
- Luaun and vinyl paneling are Vac-U-Bonded
- Sound-absorbing, easy-to-clean padded vinyl interior headliner

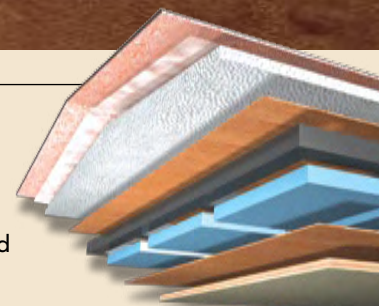

WALL CONSTRUCTION (left to right)

- Gel coat fiberglass outer wall
- Luaun paneling
- Heavy-gauge tubular steel and 4" steel plate backers
- R 7.5 closed cel foam seals every nook and crevice
- Luaun paneling; walls are Vac-U-Bonded together
- Decorative wall coverings



FLOOR CONSTRUCTION (top to bottom)

- Tile, or 1/2" carpet pad and carpeting
- Dyna-Span flooring
- Decibel layer
- Dyna-Span flooring
- Waterproof fiberglass underbelly

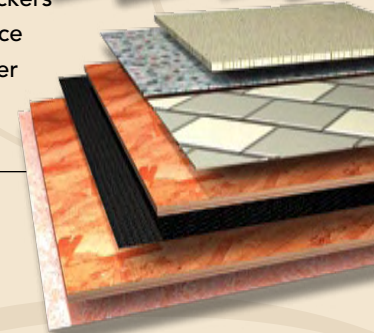

- 10 Dual ping air tanks with 3/4" air lines for quicker response and improved ride and handling.
- 11 P295/80R Goodyear steel belted all-season tires ensure a safe and quiet ride (G670 RV tire).
- 12 The TRW power steering box allows for a 50-degree front wheel turn angle in both directions for better maneuverability and returns the steering wheel back to its center position to eliminate driver fatigue.
- 13 All chassis are equipped with steel cage construction, steel firewall and steel stepwell for added safety.

EATON
VORAD)))

This optional collision avoidance system utilizes a combination of sensors, software and radar to warn you of potential hazards on the road ahead and alongside your coach, which may be outside your view.

ACTIVE CONTROL DAMPENING (ACD)

This state-of-the-art system monitors suspension and chassis movement thousands of times per second and adapts the suspension to the input. The result: superior control and unbeatable ride quality.

BEAVER MARQUIS® | 2007

The luxury of choice.

The Marquis offers a variety of color, fabric and exterior package options – each as stunning as the next. And because it's from Beaver, the quality is just as impressive. The richness of the colors are matched



ASPEN MEADOW



GOLDEN ONYX

by the opulence of the fabrics. And to protect the vibrant exterior from nicks and scratches, the 2007 Marquis features an innovative 3M® Film Front Mask.

FABRICS | EXTERIOR | COLORS

- | | |
|--------------|---|
| 1. DINETTE | A |
| 2. BEDSPREAD | B |
| 3. CARPET | C |
| 4. SOFA | D |



SAHARA DUNES



TUSCANY PALACE
BEDSPREAD FABRIC COMING SOON

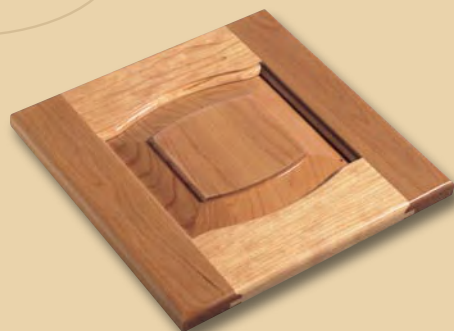

CHERRY

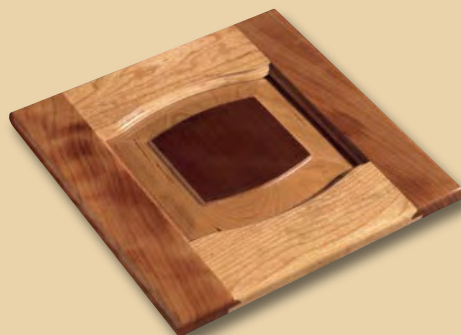

CHERRY W/ MAKORI INLAY

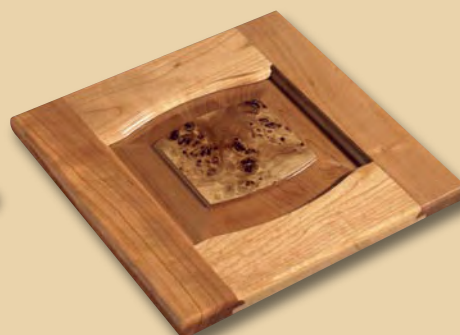

CHERRY W/ MAPPA BURL INLAY

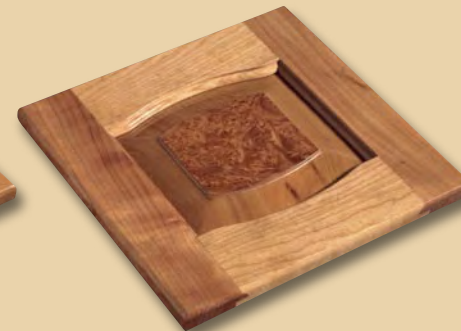

CHERRY W/ MAPLE BURL INLAY

BEAVER MARQUIS® | 2007

A modern classic.

The true artistry of the 2007 Marquis is found in its rich wood. Handcrafted by experienced craftsmen from superior hardwoods, Beaver wood cabinets and burl inlays create a look reminiscent of grand estates and fine hotels. But here they are, right at home on the road, bringing old world charm and glamour to today's modern lifestyle. Choose from traditional wood cabinets or add striking burl inlays to create a style all your own.

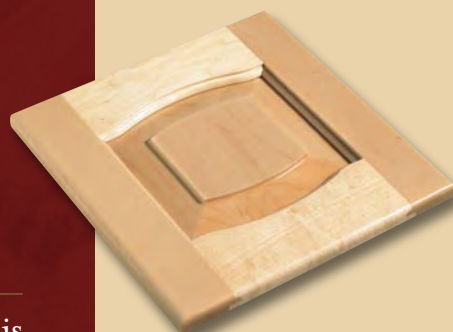

MAPLE



MAPLE W/ BIRD'S EYE MAPLE INLAY



MAPLE W/ MAPPA BURL INLAY



MAHOGANY



MAHOGANY W/ MAPLE BURL INLAY

No compromises necessary.

Personal opinions and individual preferences are taken into account with the revised floorplans for the 2007 Marquis. We asked Beaver owners what they wanted...which options they enjoyed...

what they would like to see. Then we took their suggestions and created several distinct designs, which we believe gives everyone the opportunity to find their own ideal floorplan.

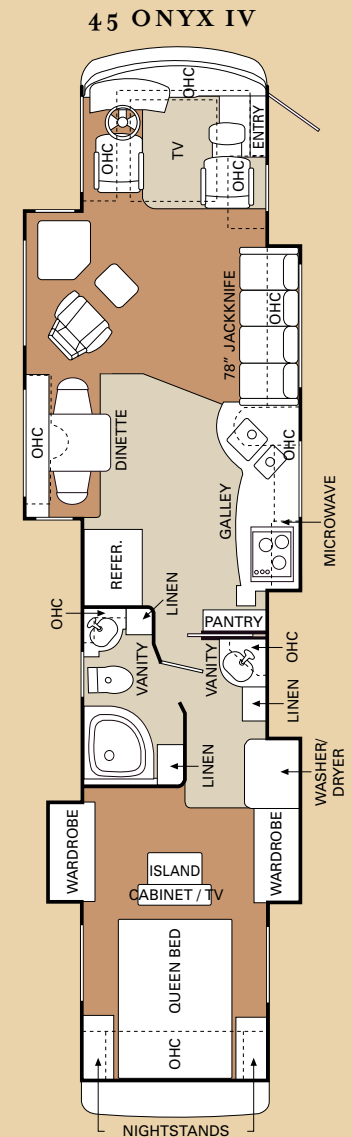
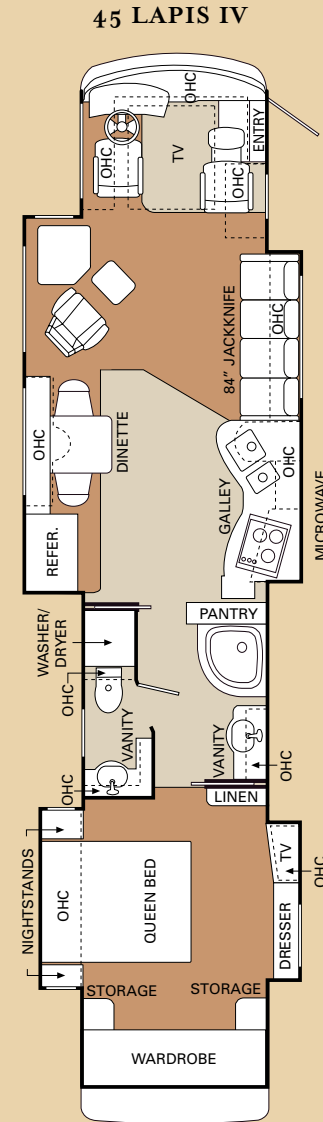
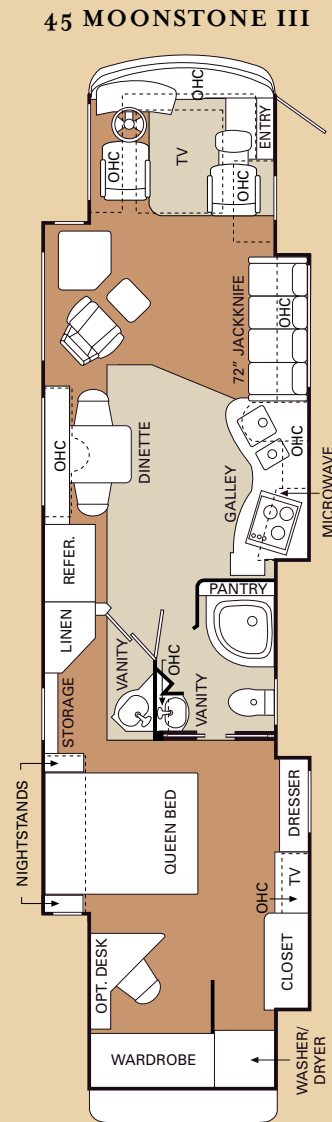
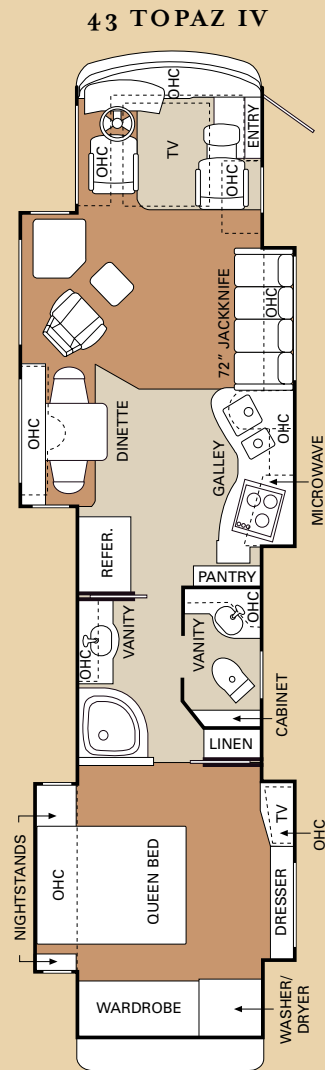
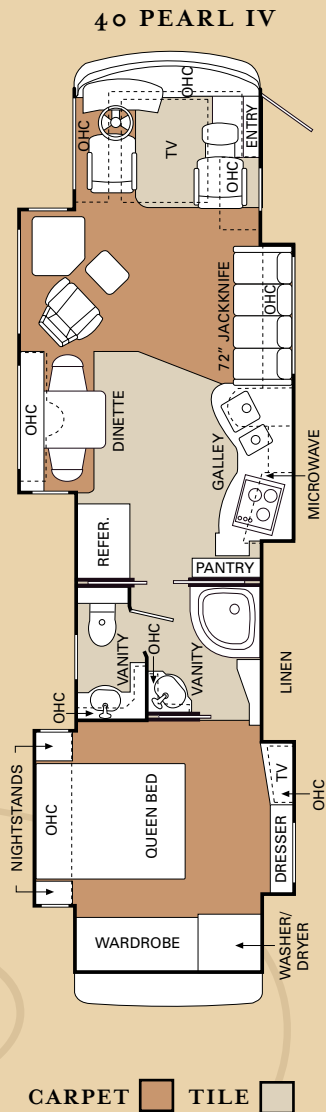

WEIGHTS	40 Pearl IV	43 Topaz IV	45 Moonstone III	45 Lapis IV	45 Onyx IV
Gross Vehicle Weight Rating (Lbs.)	48,160	48,160	48,160	48,160	48,160
Gross Combined Weight Rating ¹ (Lbs.)	58,160	58,160	58,160	58,160	58,160
Front Gross Axle Weight Rating (Lbs.)	15,160	15,160	15,160	15,160	15,160
Rear Gross Axle Weight Rating (Lbs.)	23,000	23,000	23,000	23,000	23,000
Tag Gross Axle Weight Rating (Lbs.)	10,000	10,000	10,000	10,000	10,000
MEASUREMENTS	40 Pearl IV	43 Topaz IV	45 Moonstone III	45 Lapis IV	45 Onyx IV
Wheelbase	250 3/4"	271"	280"	280"	280"
Overall Length	41' 7"	43' 1"	44' 11"	44' 11"	44' 11"
Overall Height ² (12' 6" to Top of A/C)	12' 8"	12' 8"	12' 8"	12' 8"	12' 8"
Exterior Width	100.5"	100.5"	100.5"	100.5"	100.5"
Interior Height (Carpet to Vinyl)	84"	84"	84"	84"	84"
TANK CAPACITIES	40 Pearl IV	43 Topaz IV	45 Moonstone III	45 Lapis IV	45 Onyx IV
Gray Tank (Gal.)	56	56	56	56	56
Black Tank (Gal.)	56	56	56	56	56
Fresh Tank (Gal.)	100	100	100	100	100
Fuel Tank (Gal.)	150	150	150	150	150

¹ Towing capacity is limited by GCWR; your vehicle's towing capacity is the difference between the GCWR and the actual vehicle weight, including all water, fuel, passengers and cargo. Your towed vehicle should be equipped with auxiliary brakes if the weight of the towed vehicle exceeds 1,000 lbs. Consult your Owner's Manual for further towing information.

² Height measurements include roof satellite.

All tank capacities are estimated based upon calculations provided by the tank manufacturers and represent approximate capacities. The actual "usable capacity" may be greater or less than the estimated capacities based upon fabrication and installation of the tanks.

The actual overall length of the recreational vehicle may differ from that indicated in the brochure due to variances in the manufacturing process and/or installed components. The actual length may be greater or less than that indicated.

Due to the large variety of options and floorplan arrangements available to our customers, actual weights for each unit may differ. Beaver Motor Coaches provides a weight sticker on each unit we produce, which includes that unit's tank capacities and approximate weight. Consult your local Beaver Motor Coaches dealer for unit availability and further information. The information printed in this brochure reflects product design, fabrication, and component parts at the date of printing. The manufacturer reserves the right, at any time, to make changes in product design, material or component specifications as its sole option, without notice. This includes the substitution of components of a different brand or trade name, which will result in comparable performance.

Component part and appliance manufacturers issue limited warranties covering those portions of the recreational vehicle not covered by the Limited Warranties issued by Monaco Coach Corporation. To learn which specific component parts and appliances are excluded from the Limited Warranties issued by Monaco Coach Corporation, please contact your selling dealership or Monaco Coach Corporation directly, or review the warranty packet inside the recreational vehicle. All information printed in this brochure is subject to change after the date of printing. Some features shown or mentioned in this brochure are optional and may only be available in selected floorplans. Photographs may show props or decorations that are not standard equipment on Beaver Motor Coach models. Beaver Motor Coaches, the Beaver logo and its design, are registered trademarks. All other products and company names are trademarks and/or registered trademarks of their respective holders.

BODY CONSTRUCTION

FEATURES				OPTIONS
	<ul style="list-style-type: none"> › Heavy-Duty Steel Superstructure with Steel Cage Cockpit Construction › Seamless One-Piece Molded Crowned Fiberglass Roof › All-Season Foam Insulated Roof › Laminated Gel Coat Fiberglass Sidewalls › Five-Layer Flooring with Two Layers of OSB Flooring › Deluxe Full-Body Paint › One-Piece Windshield 	<ul style="list-style-type: none"> › Triple Head Power Controlled Heated Chrome Exterior Mirrors with Turn Indicator Lights › Daytime Running Lights › Halogen Driving Lights › Recessed Side Docking Lights › Dual Trumpet Air Horns › Rear Ladder › Insulated Aluminum Baggage Doors with Power Locks 	<ul style="list-style-type: none"> › Lined Pass-Through Storage Compartments › Interlocking Aluminum Framed Slide-Out Houses › Interior Paneling with 1 1/2" Insulation › Storage Bay Slide-Out Tray (Full Pass-Through) › Rear Ladder › Full-Length "Beaver" Mud Flap › 3M® Film Front Mask 	<ul style="list-style-type: none"> › Additional Manual Storage Bay Slide-Out Storage Tray (One Side) › Additional Manual Storage Bay Slide-Out Storage Tray (Full Pass-Through) › Electric Slide-Out Storage Tray (Full Pass-Through) › Exterior Sunscreens

CHASSIS/ENGINE/SUSPENSION

FEATURES				OPTIONS
	<ul style="list-style-type: none"> › Roadmaster S-Series: Semi Monocoque Chassis › CAT® 525 HP C-13 and Allison® 4000 MH 6-Speed World Transmission with Electronic Shifter › Torque: (@ 1,200 RPM)1650 lbs./ft. Max › Engine Displacement: 763 Cu. In. /12.5L › Dual Fuel Fill › 200 Amp Alternator › Rear Axle Ratio: 4.33:1 	<ul style="list-style-type: none"> › Tires: 295/80R/22.5 › Polished Aluminum Wheels › Full Cushion Air Glide Suspension with Ten Outboard-Mounted Air Bags and Ten Shock Absorbers › Air Suspension with Ping Tank › Automatic Traction Control › Air Disc Brake System with ABS › Tag Axle with Anti-Lock Braking System › Auto Slack Adjusters on Brakes 	<ul style="list-style-type: none"> › CAT® Compression Two-Stage Engine Brake › Pre-Wire for Supplemental Braking System › Engine Block Heater › Hydraulic Leveling System › Undercoating › 10,000 Lb. Hitch Receiver and 7/4-Way Trailer Plug › Remote Inflation Connector 	<ul style="list-style-type: none"> › Series 60 Detroit Diesel 515 HP Engine with Allison® 4000 MH 6-Speed World Transmission and Electronic Shifter with 1560 lbs./ft. Max Torque @ 1,200 RPM and 858" Engine Displacement › CAT® 600HP C-15 and Allison® 4000 MH 6-Speed World Transmission and Electronic Shifter with 1850 lbs./ft. Max Torque @ 1,200 RPM & 928" Engine Displacement › Electronic Adjustable Suspension System › Dual Leveling System (Air/Hydraulic) › Automatic Air Leveling System (Replaces Hydraulic Leveling)

COCKPIT

FEATURES				OPTIONS
	<ul style="list-style-type: none"> › Fiberglass Automotive Dash with Bird's Eye Bordeaux Instrumentation Panel, Black Gauges with Gray Lettering and Gun Metal Bezels › In-Dash Stereo with AM/FM Stereo with Multi-Disc CD Changer › GPS Navigation System with Touchscreen › Color Rear Vision System with Color Monitor › CB Radio Prep 	<ul style="list-style-type: none"> › Aladdin™ Video Coach System with SEE-Vision Security Cameras, Integrated Compass and Temperature Gauge › Power Privacy Cab Drapes › Power Sunvisors with Driver and Passenger Switch › Pilot Side Window Manual Sunscreens › Adjustable Accelerator and Brake Pedals › Audible Turn Signals › Cruise Control Light on Dash 	<ul style="list-style-type: none"> › Two-Tone Leather VIP Lighted Smartwheel® with Controls for Windshield Wipers, ICC and Cruise Control › 6-Way Power OptimaLeather™ Pilot and Co-Pilot Seat with Electric Lumbar and Heat; Electric Sliding Seat Cushion and Memory Capabilities on Pilot Seat and Adjustable Headrest on Both; Footrest on Passenger Seat › Carpeted Driver and Passenger Floor Mats 	<ul style="list-style-type: none"> › CB Radio › XM Satellite Stereo (Requires Subscription) › Sirius Satellite Stereo (Requires Subscription)

APPLIANCES AND ACCESSORIES

FEATURES				OPTIONS
	<ul style="list-style-type: none"> › Residential Refrigerator with 4 Additional Batteries › Recessed High-Output 3-Burner Cooktop › Spacesaver Convection Microwave with Touch Control › Electric TV Antenna 	<ul style="list-style-type: none"> › Fully Automatic Digital Satellite System with Receiver in Living Area and Bedroom › 40" LCD TV in Living Area Ceiling › 26" LCD TV with Remote Control in Bedroom › Home Theater System: AM/FM Stereo, Accoustimass Bass Module, Surround Sound Speakers 	<ul style="list-style-type: none"> › Bose® Wave Radio in Bedroom › Bedroom DVD Player › Universal Remote System (Living Area TV) › Combination Washer/Dryer 	<ul style="list-style-type: none"> › Stack Washer/Dryer › Central Vacuum System › Dishwashing Drawer › In-Motion Digital Satellite System › In-Motion Digital Satellite System with HD-Ready Receiver (HD N/A on Bedroom TV) › Exterior 32" Sharp LCD TV on Passenger Side (N/A on Floorplans without Patio Slide) › Bose® 3-2-1 II Entertainment System in Bedroom

INTERIOR

FEATURES

- › High-Gloss Euro-Finish Cabinetry with Exotic Wood Inlays
- › Lined Cabinet Shelves
- › Dinette Wall Cabinet with Solid Surface Top
- › Wineglass Cabinet
- › Built-In Storage Area for Kitchen Sink and Cooktop Covers
- › Bedroom Dresser
- › Low-Friction Roller Drawer Guides
- › Vinyl Ceiling with Tiered Design
- › Solid Surface Countertops Throughout
- › Integrated Corian® Sinks in Vanity and Galley
- › Mosaic Tile Galley and Vanity Backsplash Design
- › Sculpted Glass Splash Guard at Edge of Galley
- › Power Roman Shades with Pleated Shades in Living Area

- › Day/Night Shades with Blackouts Throughout
- › Mini Blinds in Bathroom and Galley Windows
- › Vinyl Wallpaper
- › Cutting Boards in Kitchen
- › Plush Carpet in Living Room and Bedroom
- › Sculptured Carpet Design in Living Area
- › Ceramic Tile Flooring in Kitchen and Bath Area
- › Ceramic Tile Flooring in Cockpit Area
- › Bedspread with Pillows
- › Nightstands with Solid Surface Countertops
- › Solid Surface Windowsills in Living Area
- › Recessed Living Area Surround Sound Speakers
- › Decorative Hardware Throughout
- › Large Pot and Pan Drawer in Kitchen Area
- › Decorative Hardwood Slide-Out Fascia Trim

OPTIONS

- › Interior Decors: Tuscany Palace, Sahara Dunes, Golden Onyx, Aspen Meadow
- › Ceiling Fan in Bedroom
- › Gloss Finish Cabinetry Choices:
 - Cherry, Mahogany, Maple
 - Mahogany Cabinetry with Maple Burl Accent Cabinet Door Inserts
 - Maple Cabinetry with Bird's Eye Maple Accent Cabinet Door Inserts
 - Maple Cabinetry with Mappa Burl Accent Cabinet Door Inserts
 - Cherry Cabinetry with Makori Accent Cabinet Door Inserts

- Cherry Cabinetry with Mappa Burl Accent Cabinet Door Inserts
- Cherry Cabinetry with Maple Burl Accent Cabinet Door Inserts

FURNITURE

FEATURES

- › Queen Bed with Pillowtop Hinged Mattress (N/A: 45 Lapis IV)
- › Curbside: Fabric Sofa with Drawer
- › Roadside: One OptimaLeather™ Euro-Recliner with Ottoman
- › Roadside: Leather Hide-a-Bed
- › Roadside: Leather Hide-a-Bed with Air Mattress

- › TV Module at Foot of Bed (45 Onyx IV Only)
- › Solid Surface Fixed Living Area Table
- › Side-Slide, Solid Surface Fixed Dining Table with Dinette Cabinet

OPTIONS

- › King Bed with Pillowtop Hinged Mattress
- › King Air Mattress with Remote
- › Roadside: One OptimaLeather™ Recliner
- › Roadside: Leather Hide-a-Bed
- › Roadside: Leather Hide-a-Bed with Air Mattress
- › Curbside: OptimaLeather™ L-Sofa with Drawer
- › Curbside: OptimaLeather™ Jackknife Sleeper Sofa with Drawer

- › Curbside: Fabric "Rest Assured" with Air Mattress
- › Roadside: Computer Desk (Requires Recliner)
- › Fabric/Leather Sectional Booth Dinette Ensemble (Requires New Galley)
- › Dinette Table, Wood Round with 12" Leaf with Two Freestanding Dinette Chairs and Two Folding Chairs (Opera Windows next to Table; Replaces Dinette Cabinet)

ELECTRICAL SYSTEMS AND LIGHTS

FEATURES

- › 50 Amp 120/240V Distribution Panel and Power Cord with Quick Disconnect Power Cord Reel
- › Onan® 12.5 kW Quiet Diesel Generator on Power Slide-Out Tray with Auxiliary Start Switch and Automatic Temperature Start
- › 2800 Watt Pure Sine Wave Inverter with Auto Gen Start and Auto Temp Start
- › Computer Hook-Up with Phone Jack at Dinette Area and Dash
- › Decorative Lighting in Living Area and Bedroom
- › Pilot/Co-Pilot Reading Lights
- › Cosmetic Vanity Light in Bathroom
- › Adjustable Bedroom Overhead Lights with Switches above Bed

- › Recessed Halogen Lighting under Living Room and Dinette Overhead
- › Halogen Lighting in Ceiling Throughout
- › 120V Outlet in Private Bath
- › 120V Outlet in Bed Base
- › 120V Receptacle in Outside Storage Compartment
- › Porch Light
- › Doorbell
- › Lighted Exterior Storage Compartments
- › Eight 6V Deep Cycle Coach Batteries
- › Two 12V Deep Cycle Chassis Batteries
- › Surge Guard™ Automatic Transfer Switch
- › Multiplex 12V Wiring Throughout Interior of Coach

- › Locking Battery Disconnect Switch inside Coach
- › Battery Disconnect Switch in Battery Compartment
- › Two Solar Panels with Regulator (100 Watt)

OPTIONS

- › 5 Glass Matt Batteries and 270 Amp Alternator (40 Pearl IV, 43 Topaz IV, 45 Moonstone)
- › Glass Matt Batteries (Replaces House and Chassis Batteries)

PLUMBING AND LP SYSTEMS

FEATURES

- › Central Water Filtration System in Service Bay
- › Manifold Water Control System
- › Insulated Systems Compartment with Easy Access to Hook-Ups
- › Water Pump Switches in Galley, Bathroom and Service Bay
- › China Toilet
- › Super Service Center
- › Solid Surface Shower with Mosaic Tile Inlay Design and Solid Surface Shower Caddy
- › RV Sani-Con Tank Drainage System
- › Black and Gray Tank Flush
- › Water Sprayer in Outside Bay
- › Power Water Hose Reel
- › One Touch Pullout Faucet
- › Insta-Hot® Water System in Kitchen
- › Fresh Water Tank with "Auto Fill"

OPTIONS

- › Garden Tub w/Clear Surround (N/A: 40 Pearl IV, 43 Topaz IV)
- › Electric Automatic Winterization

HEATING, VENTS AND AIR CONDITIONING

FEATURES

- › Aqua-Hot® Heating System
- › Two Low-Profile Ducted 15,000M BTU Roof Air Conditioners with Heat Pumps (40 Floorplans)
- › Three Low-Profile Ducted 15,000M BTU Roof Air Conditioners with Heat Pumps (N/A: 40' Floorplans)
- › Electronic AC/Heat Climate Control System
- › Dual Climate Controls
- › Dash Heating and Air Conditioner System with Defroster
- › 12V Attic Fan with Sensor and Wall Switch in Kitchen, Bath and Vanity Area

OPTIONS

- › Low-Profile Baseboard Heater

WINDOWS, DOORS AND AWNINGS

FEATURES

- › Flush-Mount Radius Dual Pane Safety Glass Tinted Windows
- › Front Entry Door with Air Seal and Removable Top Screen
- › Keyless Remote Entry System with Pocket Remote
- › Tinted Skylight in Bathroom
- › Topper Slide-Out Awnings
- › Roof-Mounted Girard® Automatic Front Patio Awning

OPTIONS

- › Large Bay Window in Living Area (Replaces Living Area Overheads on Driver and Passenger Side)
- › Automatic Front Door Awning
- › Roof-Mounted Girard® Automatic Rear Patio Awning
- › Girard® Awning Package (Includes: Rear Patio Awning, Automatic Entry Door Awning, Slide-Out Topper Awnings and Window Awnings)

SAFETY

FEATURES

- › Back-Up Alarm
- › Fire Extinguisher
- › Deadbolt Lock on Entrance Door
- › Lighted Interior and Exterior Grab Handles
- › 120V GFI Protected Circuit
- › Smoke Detector
- › Carbon Monoxide Detector
- › Integrated Pilot and Co-Pilot Three-Point Seatbelts
- › Third Brake Safety Light
- › Egress Window(s)
- › Security Safe
- › Deluxe Security System

OPTIONS

- › Collision Avoidance System

The Inside Track.

Beaver dealer links, service center finders, owner news and the latest information on the 2007 Marquis can be found on our website. It's a direct link to everything Beaver that can be accessed anytime day or night from home or on the road.

www.beavermotorcoaches.com



BEAVER MARQUIS® | 2007



ARTISTRY IN MOTION.

The 2007 Beaver Marquis is not a typical RV. The intention was never overwhelming popularity. Instead, it was designed to appeal to a more discriminating audience. Those in touch with nature. People who are inspired by natural beauty. And individuals who appreciate the finer things in life.

Inspired engineering paired with mesmerizing technology. Unquestionable safety wrapped in unbelievable beauty. Luxurious comfort down to the smallest details. This is the legacy of the 2007 Marquis from Beaver. A true work of art.



MONACO COACH CORPORATION

Monaco is traded on the New York Stock Exchange under the listing MNC.

© 2006, Monaco Coach Corporation Litho in USA

0306 NPN:BROBMARQ

THE BEAVER LINE OF MOTOR COACHES:
MARQUIS® • PATRIOT® • MONTEREY



One coach at a time. Yours.™

BEAVER MOTOR COACH

91320 Coburg Industrial Way, Coburg, OR 97408

www.beavermotorcoaches.com

Daily factory tours.

(800) 634-0855