

Simplicity

Simplicity[®]

The vacuum you'll *flip* over.[™]

OWNER'S MANUAL

DOMESTIC USE ONLY

Please read this document carefully before installing and/or using your vacuum cleaning system.

Model : _____ Serial Number : _____

Installation

Operating
Instructions

Maintenance

Troubleshooting

Warranty
Information

IMPORTANT SAFETY INSTRUCTIONS

When using an electrical appliance, basic precautions should always be followed, including the following.

Read all instructions before using this appliance

WARNING – To reduce the risk of fire, electric shock, or injury:

1. Do not leave appliance when plugged in. Unplug from outlet when not in use and before servicing.
2. Do not use outdoors or on wet surfaces.
3. Do not allow to be used as a toy. Close attention is necessary when used by or near children.
4. Use only as described in this manual. Use only manufacturer's recommended attachments.
5. Do not use with damaged cord or plug. If appliance is not working as it should, has been dropped, damaged, left outdoors, or dropped into water, return it to a service center.
6. Do not pull or carry by cord, use cord as a handle, close a door on cord, or pull cord around sharp edges or corners. Do not run appliance over cord. Keep cord away from heated surfaces.
7. Do not unplug by pulling on cord. To unplug, grasp the plug, not the cord.
8. Do not handle plug or appliance with wet hands.
9. Do not put any objects into openings. Do not use with any opening blocked; keep free of dust, lint, hair, and anything that may reduce air flow.
10. Keep hair, loose clothing, fingers, and all parts of body away from openings and moving parts.
11. Do not pick up anything that is burning or smoking, such as cigarettes, matches, or hot ashes.
12. Do not use without dust bag and/or filters in place.
13. Turn off all controls before unplugging.
14. Use extra care when cleaning on stairs.
15. Do not use to pick up flammable or combustible liquids such as gasoline or use in areas where they may be present.
16. Connect to a properly grounded outlet only. See Grounding Instructions.

SAVE THESE INSTRUCTIONS

Preface	4
Schematic – Units without Bags	5
Schematic – Units with Bags.....	5

Installation

Unit Installation	6
Dos & Don'ts.....	7
Muffler Installation - (CI100 and BF100 models).....	10
Muffler installation - other models	11
Electric Connections.....	11
Grounding Instructions	12
Low Voltage Connections	13

Operating instruction

Hose Hook-up & Inlets.....	14
Using the integrated inlet	15
Progressive Start	16
Automatic Stop.....	16
LED indicator.....	16
Information center	17

Operating instruction

Motor.....	17
Hi Flow Hepa Bag (B20, BF40, BF60 and BF100 models).....	18
Dirt Receptacle (C20, CI40, CI60 and CI100 models)	19
Filters (C20, CI40, CI60 and CI100 models).....	19
Carbon Dust Filter (BF40, BF60 and BF100 models).....	20

Troubleshooting

General Information	21
Decrease in suction strength	22
Vacuum will not start.....	24
Vacuum will not stop	25

Warranty Information

Limited Lifetime Warranty	26
---------------------------------	----

PREFACE

Your new Simplicity central vacuum system was designed and manufactured in Blainville, Quebec, by the largest central vacuum cleaner manufacturer in Canada, providing a high-quality, state-of-the-art product. Our extensive network of qualified professionals ensures first quality service near you. Contact us for the location of the Simplicity authorized service center in your area.

SCHEMATIC – UNITS WITHOUT BAGS (C20, C140, C160 AND C1100 MODELS)

1. Circuit Breaker
2. Low Voltage Connector
3. Serial Number
4. Integrated Inlet*
5. Air Intake
6. Integrated Switch*
7. Information center*
8. Air Exhaust
9. Muffler

* except C20 model

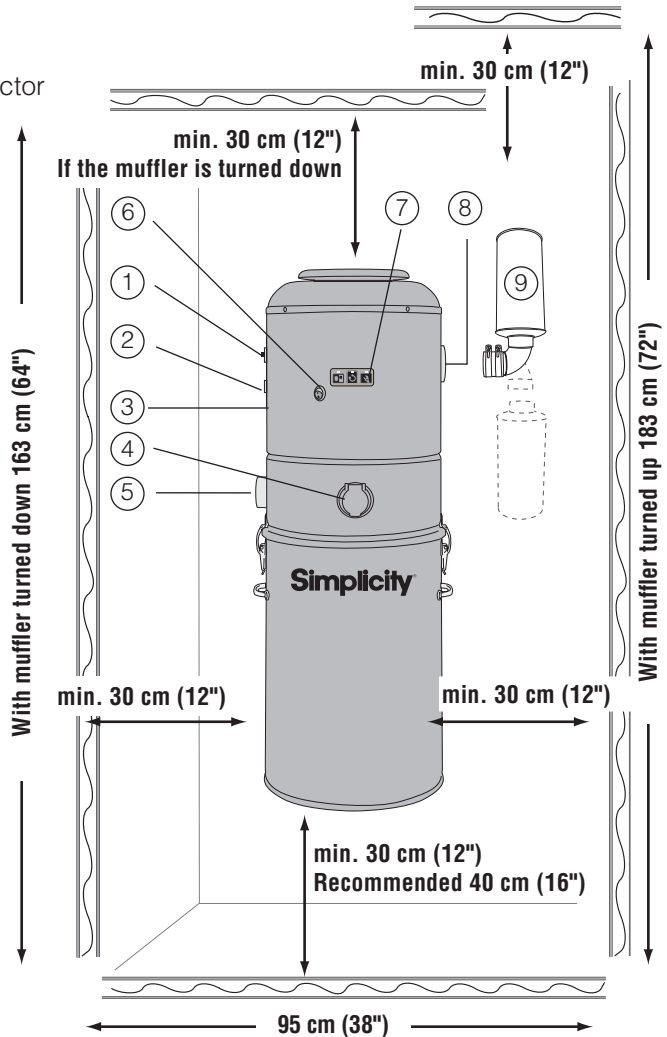

SCHEMATIC – UNITS WITH BAGS (B20, BF40, BF60 AND BF100 MODELS)

1. Circuit Breaker
2. Information center *
3. Low Voltage Connector
4. Serial Number
5. Upper Round Drum Filter (part #CF-B)
6. Air Intake
7. Carbon Dust Filter*
8. Muffler

* *except B20 model*

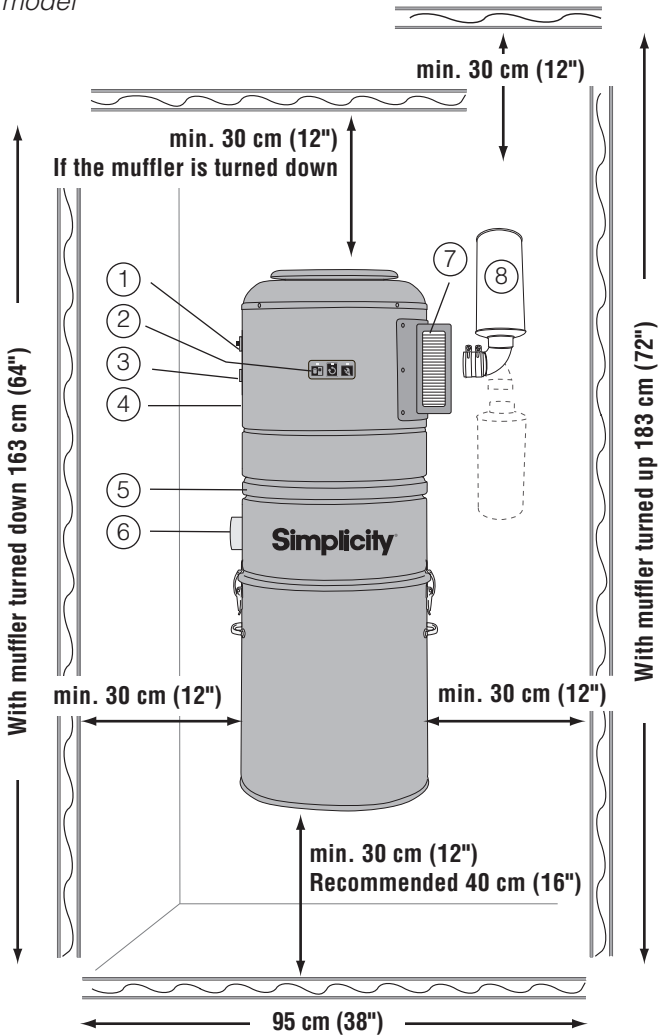

UNIT INSTALLATION

Using the mounting plate provided with your vacuum cleaner, secure the unit to the wall (**figure 1**), at a height allowing easy access for maintenance of the filters, dirt receptacle and/or bags (see pages 6 and 7).

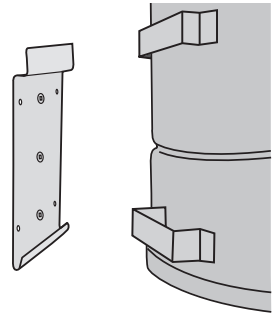

figure 1

The connections to the piping system will require some basic tools: a mitre box and small saw or a pipe cutter (**figure 2**). See pages 9 and 10 for general instructions pertaining to the preparation of PVC pipes. To simplify matters, installation kits, including necessary fittings, pipes, glue and wiring, as well as a detailed instructions booklet, are available from Simplicity service centers.

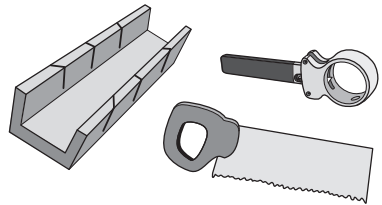

figure 2

Contrary to all other connections in the piping system, **do not glue the last fitting to your unit**. Simplicity central vacuums are equipped with an adjustable air intake valve (**figure 3**), which does not require glue. An air-tight fit is achieved with the screw-type adjustment on the fitting itself.

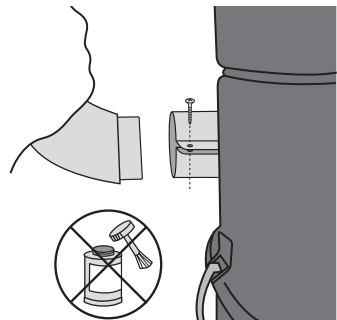
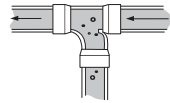
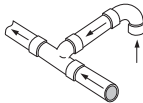
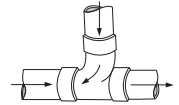
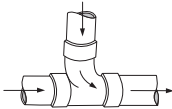
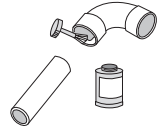
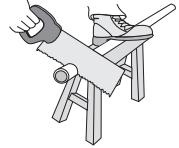
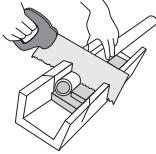

figure 3

Dos & DON'TS

Installing Conduits



Dos & DON'TS

Installing Conduits

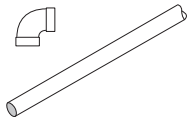
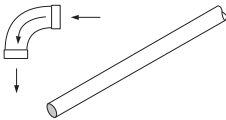
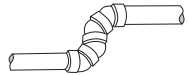
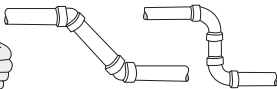
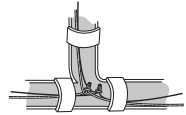
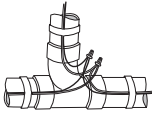
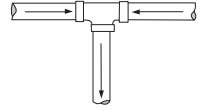
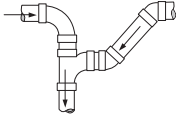

Dos & DON'TS

Installing Inlets

When installing your vacuum inlets, we recommend that the principle of electric polarity be taken into account. Ensure that the wire connected onto contact A on inlet 1 is the same as that connected to contact A on inlet 2, and so on. Do not cross, reverse or interchange wires.

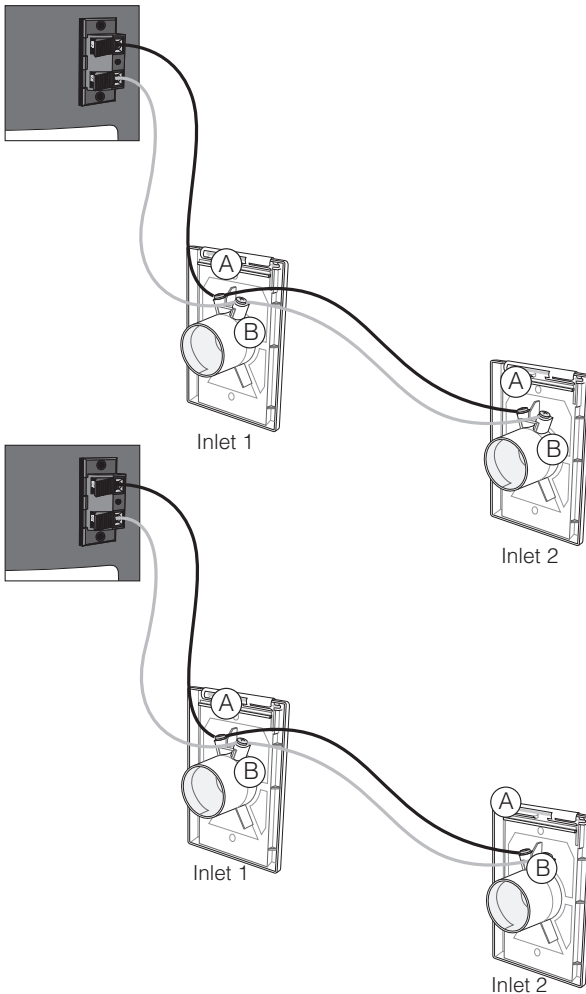

MUFFLER INSTALLATION (OPTIONAL)

BF100 AND CI100 MODELS

1. Insert the rubber coupling on the vacuum air exhaust.
2. Using a screwdriver, tighten the clamp collars to ensure adequate sealing.
3. Insert the metal elbow into the rubber coupling, and tighten the clamp collars as per instructions in step 2.
4. Apply metal glue to the metal pipe, and insert it into the 90° elbow female end.
5. Slide the rubber sleeve on the metal pipe and 90° elbow, all the way to the rubber coupling.
6. Insert another rubber coupling onto the metal pipe end (0.5 inch, under the sleeve), and tighten the clamp collars.
7. Insert the male-male adaptor into the rubber coupling, and tighten the clamp collars.
8. Apply PVC glue to the visible part of the male-male adaptor, and insert the muffler.

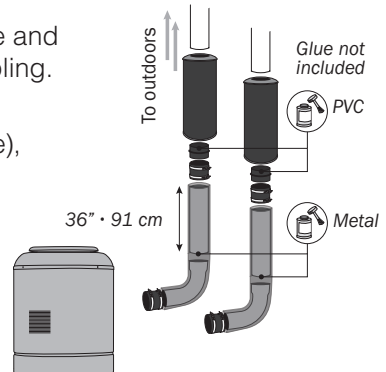

* **Must be vented outside.**

Warning BF100 AND CI100 MODELS

- Do not install in a small enclosed place
- Never reduce air exhaust volume.
- Each motor exhaust must be separately connected to metal conduits of at least 2 inches (5cm) in diameter for a length of 10 inches (25cm). Do not connect both exhausts to the same conduit.

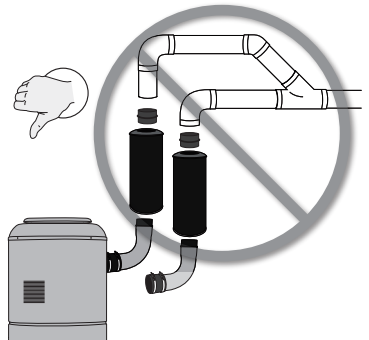
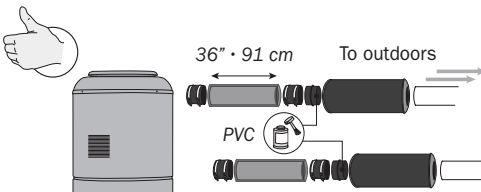

MUFFLER INSTALLATION (OPTIONAL)

OTHER MODELS

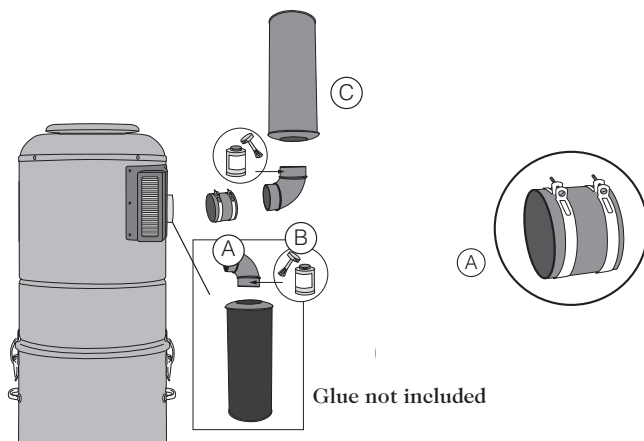

ELECTRIC CONNECTIONS

There should be an electric outlet within 1 meter (3 feet) of your central vacuum unit. Once the appliance is installed in a suitable location, connect your central unit to an electric outlet on an dedicated* grounded circuit. Do not use extension cords or modify the length of your vacuum cleaner's power cord.

Dedicated* grounded circuit

- North America
120V / 240V All models: 15A

Your central vacuum cleaner has a thermal safety device or a circuit breaker to protect against any over voltage or electrical defect. If that protection should fail, contact your authorized service center.

*Please reserve a circuit breaker dedicated only to the connections for your central vacuum.

If you find that installing your vacuum cleaner is too difficult, ask your service center to install it for you. When in doubt, it is better to have the work done by a professional and ensure that the unit is properly installed. Any installation that does not comply with the specified norms could alter or invalidate the warranty.

GROUNDING INSTRUCTIONS

This appliance must be grounded. If it should malfunction or breakdown, grounding provides a path of least resistance for electric current to reduce the risk of electric shock. This appliance is equipped with a cord having an equipment-grounding conductor and grounding plug. The plug must be inserted into an appropriate outlet that is properly installed and grounded in accordance with all local codes and ordinances. No adaptor should be used with this appliance.

WARNING

Improper connection of the equipment-grounding conductor can result in a risk of electric shock. Check with a qualified electrician or service person if you are in doubt as to whether the outlet is properly grounded. Do not modify the plug provided with the appliance – if it will not fit the outlet; have a proper outlet installed by a qualified electrician.

120 V Models

This appliance is for use on a nominal 120V circuit, and has a grounded plug (**figure 4**). Make sure that the appliance is connected to an outlet having the same configuration as the plug. No adaptor should be used with this appliance.

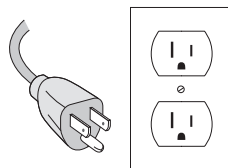
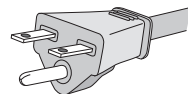

figure 4

220 V/240 V Models (BF100 AND C100 MODELS ONLY)

This appliance is for use on a circuit having a nominal rating more than 120V and is factory-equipped with a specific cord and plug to permit connection to a proper electric circuit. Make sure that the appliance is connected to an outlet having the same configuration as the plug. No adaptor should be used with this appliance. If the appliance must be reconnected for use on a different type of electric circuit, the reconnections should be made by a qualified service personnel.



LOW VOLTAGE CONNECTIONS

Connect the low voltage wires to the low voltage inlet on your unit.

To do so:

1. Strip wires over 1 cm (1/2 inch) (**figure 5**).
2. Gently press on the toggle to open the connector (**figure 6**).
3. Insert stripped wire (**figure 7**).
4. Release toggle to secure wire in connector (**figure 8**).
5. Repeat for second wire.

To disconnect:

1. Gently press on the toggle to open the connector.
2. Remove low voltage wire from connector.

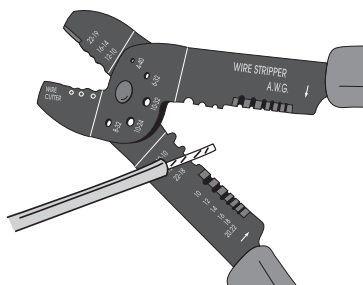

figure 5

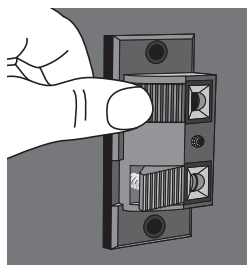

figure 6

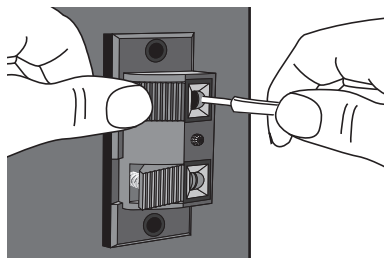

figure 7

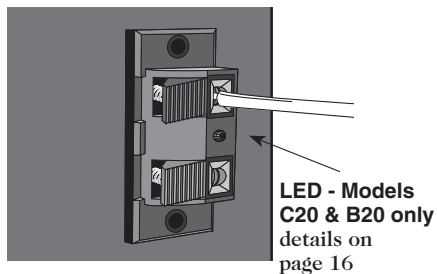

figure 8

HOSE HOOK-UP & INLETS

Before operating your central vacuum...

Please verify that it is properly connected to the piping system, and to a grounded electrical outlet, and that the low voltage wires are connected to the unit (see pages 8 to 16). Then read the complete owner's manual and proceed with a quick verification of your unit's installation:

- Check filter and bag to be sure they are properly installed.
- Check rubber seals in each vacuum inlet.
- Plug the hose alternatively into each vacuum inlet, to ensure that each one works properly.
- While the hose is still plugged into one inlet and the system is operational, check other inlets for leaks.

To start your central vacuum, simply insert the hose in the vacuum inlet of your choice. Please ensure that the tab on the hose end is properly lined up with the slot in the inlet opening (**figure 7**). If your hose handle has an integrated on/off switch, simply slide the switch to the "on" position.

Do not try to open another inlet while your system is in operation, as it may damage the inlet's rubber seal.

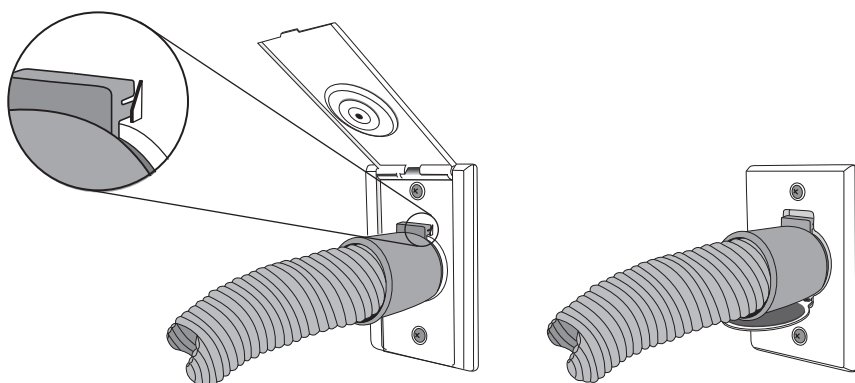

figure 5

USING THE INTEGRATED INLET

(CI40, CI60 AND CI100 MODELS)

To use the vacuum inlet integrated into your central vacuum, simply connect the hose and flip the integrated switch to the "on" position. Please note that the integrated switch will start the power unit, even if there is no hose connected to the inlet.

Caution : Your central vacuum must not be operated without a hose or when all inlets are closed. This could cause irreversible damage to the power unit.

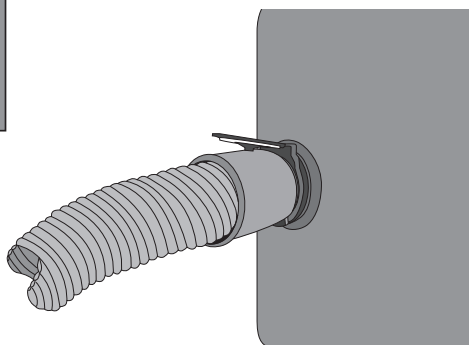
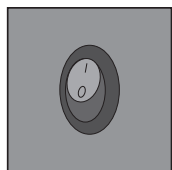

PROGRESSIVE START

(CI40, CI60, CI100, BF40, BF60 AND BF100 MODELS)

Each model is equipped with a special module allowing for a smooth and gradual start-up of the vacuum system, to prolong motor durability.

AUTOMATIC STOP

(CI40, CI60, CI100, BF40, BF60 AND BF100 MODELS)

In case you've forgotten to turn off your vacuum, or it's been turned on by mistake, your vacuum system will automatically shut off after one hour of uninterrupted use. Simply restart the vacuum system with the switch on the hose handle.

LED INDICATOR

(C20, B20 MODELS)

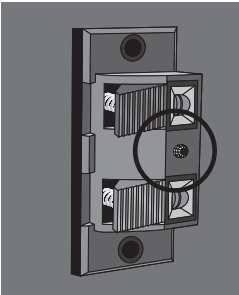

LED – On low voltage connector

Steady green – indicates unit is connected to a power source

INFORMATION CENTER

(C140, C160, C1100, BF40, BF60 AND BF100 MODELS)

Your central vacuum unit is equipped with an electronic timing device which will recommend proper maintenance of your vacuum system. These signals are only suggestions and will do not indicate a problem with your vacuum system. They will not stop or hinder the use of the vacuum.

- ❶ Flashing LED - Empty dirt receptacle or change bag
- ❷ Press to stop the flashing LED

Please note that the information/pictograms seen on the power unit information center are also available on the indicator hose handle (see details below).

- ❸ Flashing LED - Have unit checked by service center



MOTOR

Please note that Simplicity motors do not require lubrication. Each motor contains two carbon brushes which will wear normally, and may eventually require replacement. For warranty purposes, this should be done by an authorized service center. Brush life is affected by the number of hours used, frequency of start-ups and shut-downs, humidity, altitude, and temperature. In order to avoid damage to the motor itself, brushes should be replaced before they are completely worn out. We therefore recommend that you have your unit and motors inspected by a service center every 5-6 years.

HI FLOW HEPA BAG (B20, BF40, BF60 AND BF100 MODELS)

Change the bag when the one in place is full. Frequency will depend on the use of the unit. For models BF40, BF60 and BF100, the information center will indicate when to change the bag. These indications are provided by an electronic timing device, only as a reference guide.

1. To access the bag, unlatch the two clips and remove the dust receptacle (**figure 8**).
2. Remove the used bag and seal bag opening (adhesive seal provided on each bag). Discard used bag.
3. Install the new bag, ensuring the tabs on the bag adaptor are aligned with the slots in the bag collar (**figure 9**).
4. Ensure adequate sealing by inserting bag as far as the retention ring.
5. Replace dust receptacle and seal by latching both clips.

Use only genuine Simplicity replacement bags. Failure to do so could void the warranty on your vacuum unit.

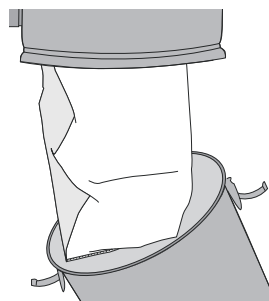

figure 6

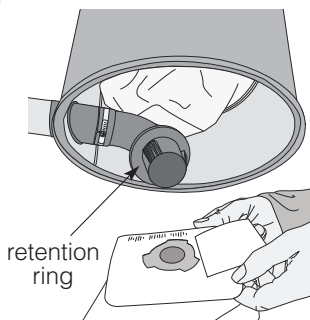

figure 7

UPPER ROUND DRUM FILTER

This drum-shaped filter requires no particular maintenance. Should you want to replace this filter, note that its part number is: #CF-B.

DIRT RECEPTACLE (C20, CI40, CI60 AND CI100 MODELS)

Occasional maintenance of the dirt receptacle is necessary to ensure constant, lasting performance. We recommend that it be emptied at least every season, depending on frequency of use. For models CI40, CI60 and CI100 the information center will indicate when to empty the canister. These indications are provided by an electronic timing device, only as a reference guide.

To empty the dust receptacle, first disconnect your vacuum cleaner from its power source. Then release the two clamps, lower and empty the recipient, then replace it and seal by refastening the metal clamps.

FILTERS (C20, CI40, CI60 AND CI100 MODELS)

Your central vacuum system is equipped with a Teflon* filter. This filter is designed to ensure high performance and long term reliability of your vacuum motor(s). It's recommended to clean the filter when emptying the dirt container.

To clean the filter, first remove the dirt container. Next, remove the filter by grabbing the filter strap and pulling the filter downward (**figure 10**). You may shake the filter, wash the filter or replace the filter. Before re-installing the filter, inspect it for tears or punctures. If damaged or worn, replace with a new filter. Do not re-install a damaged filter or one that is still wet or damp.

Carefully install the filter in the support groove (**figure 11**) to ensure adequate protection of the motor(s).

Note: When washing the filter, wash in cold water (no bleach) and dry at a low temperature. It is important that the filter is completely dry before it is re-installed.

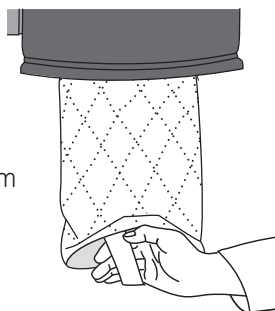

figure 8

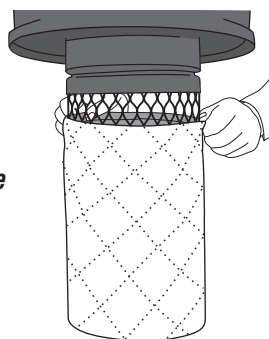

figure 9

*Teflon is a registered trademark of E.I. du Pont de Nemours company and is used under license by APC Filtration, INC.

CARBON DUST FILTER ***(BF40, BF60 AND BF100 MODELS)***

We recommend changing this filter after three bag replacements. The integrated monitor will indicate when to change the filter. These indications are provided by an electronic timing board, only as a reference guide.

To do so:

1. Unlatch the opening on the carbon filter case and gently flip it upward (**figure 12**).
2. Remove the used filter, and discard (**figure 13**).
3. Insert the new filter. When doing so, please ensure that the arrow printed on the filter itself points outwards (**figure 14**).
4. Close casing, and latch.

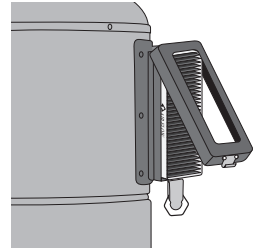

figure 12

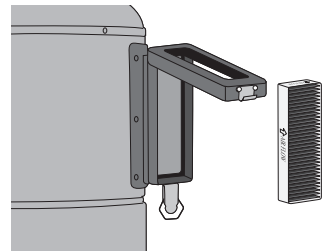

figure 13

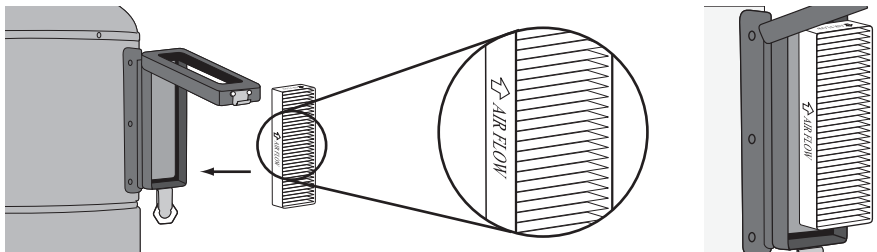

figure 14

GENERAL INFORMATION

If the vacuum unit does not work, check the fuse or breaker on the unit and/or in the electrical panel in your home, and replace any defective part (s) as deemed necessary. Please verify that the unit has been installed properly, according to the instructions in this manual.

Your vacuum cleaning system is designed to collect everyday dry matter (dust). It is approved by authorized testing agencies for dry use only. Do not use on wet surfaces.

Should you accidentally vacuum liquids, immediately unplug the unit from the electric outlet, then empty and wipe the dust recipient with a dry cloth. Then operate the system from the vacuum inlet through which you vacuumed the liquid, in order to eliminate all moisture in the piping system.

We strongly recommend against vacuuming abrasive materials such as cement, plaster and gyproc dust. This fine dust could work its way into the motor, causing considerable damage. Should you do so inadvertently, immediately clean the filters and, as a precautionary measure, contact your authorized service center to determine the extent of the damage to the unit.

Remember that in order for your warranty to remain valid, maintenance of the motor and repairs to the unit itself must be carried out by an authorized service center, using original Simplicity parts.

TROUBLESHOOTING

<i>Problem</i>	<i>Possible cause</i>	<i>Corrective action</i>
<i>Decrease in suction strength</i>	Dirt recipient / Bag is full	Empty dirt recipient / change bag (see page 17 to 18).
	Dirt recipient is not properly attached	Check clamps holding dirt recipient, to make sure they are tight, and dirt recipient is aligned.
	Open vacuum inlet	Close all vacuum inlets not in use. For bagless units also check vacuum inlet on power unit
	Exhaust line is clogged	Verify that no object is blocking the exhaust.
	Blocked hose	Plug the handle end of the hose into the suction inlet, thus reversing the suction in the hose. Cover the gap around the handle, to ensure suitable suction strength, and ensure contact with inlet contacts to start the unit. This should clear the hose.

TROUBLESHOOTING

<i>Problem</i>	<i>Possible cause</i>	<i>Corrective action</i>
<i>Decrease in suction strength (cont.)</i>	Obstruction in the piping system	Remove the screw from the air intake connector, to free the central vacuum unit from the piping system (see figure 3 on page 6). Start the unit by plugging the hose into a vacuum inlet. By placing your extended hand over the air intake opening on the unit, check the suction strength on the unit itself. If suction strength is normal, the obstruction is in the piping system. If suction strength is diminished or completely absent, have the unit checked by an authorized service center.

If none of these suggestions restore suction strength, contact your authorized service center.

TROUBLESHOOTING

<i>Problem</i>	<i>Possible cause</i>	<i>Corrective action</i>
<i>Vacuum will not start</i>	The electrical power is not connected properly	Ensure that the power cord is plugged into a dedicated grounded electrical outlet, according to specifications on pages 11 and 12.
	Low voltage wire not connected properly	Verify the low voltage wires, make sure they are properly inserted into the low voltage inlet, as per instructions on page 13.
	Faulty vacuum inlet	Start the vacuum unit from other inlets in your home, to identify the defective inlet.
	Faulty switch	Push the switch on the power unit to the on position. If the system starts, the problem lies within the LV wiring.
	Unit circuit breaker is off	Press the reset button to reset the unit circuit breaker. If unit restarts and automatically shuts off shortly after, contact an authorized service center.
	In-house circuit breaker is off	Reset the circuit breaker in your electrical panel. Verify that your central vacuum unit is connected on a dedicated grounded circuit (see pages 11 and 12).
	Defective on/off hose	Turn the hose 1/4 turn in the vacuum inlet. If unit starts, have the vacuum hose checked by a certified service center.

TROUBLESHOOTING

<i>Problem</i>	<i>Possible cause</i>	<i>Corrective action</i>
<i>Vacuum will not stop</i>	Hose improperly inserted into vacuum inlet	Ensure that the hose end is properly placed in the vacuum inlet: the tab on the hose should fit into the slots on the inlet, to ensure adequate contacts for the hose switch to function (see page 14).
	Defective on/off hose	If the hose is properly placed in the vacuum inlet, and the unit continues running despite the fact that the hose switch is in the "off" position, have the hose checked by a service center.
	Low voltage wire not connected properly	While vacuum is on, unplug low voltage wires from unit. If vacuum stops, there's a faulty low voltage wire. Contact your installer or authorized service center.

LIMITED LIFETIME WARRANTY

WHAT IS COVERED / HOW LONG COVERAGE LASTS:

All permanently installed components of a Simplicity central system are warranted to be free of defects in material and workmanship under normal use to the original purchaser at the original installation address. Motor and electrical components are warranted for ten (10) years.

All Simplicity central system accessories are warranted to be free from defects in material and workmanship under normal use for three (3) years from the date of original consumer purchase.

In the event of a defect in permanently installed components of a Simplicity central system, an authorized Simplicity retailer should be contacted. The retailer will repair or replace (at our option) any defective part or parts at your location at no labor cost for a period of three (3) years. Thereafter, repaired or replacement (at our option) part or parts will be provided to you for items under warranty.

WHAT IS NOT COVERED:

- Damage to the central vacuum which occurs from neglect, abuse, alterations, accident, misuse or improper maintenance.
- This warranty does not extend to any power nozzle accessory kit or accessories used in conjunction with this power unit. Simplicity power nozzle accessory kits are covered under a separate warranty.

WHAT SIMPLICITY WILL DO:

This warranty provides, at no cost to you, all labor and parts to keep this central vacuum power unit in correct operating condition during the warranted period.

HOW TO GET SERVICE:

Warranty service can only be obtained by contacting an Authorized Simplicity Retailer. A proof-of-purchase and product serial number will be required before service is rendered. To locate your nearest Simplicity Retailer, please call 1-888-9SIMPLY or visit the Simplicity website at www.simplicityvac.com.

THIS WARRANTY IS EXCLUSIVE AND IN LIEU OF ANY AND ALL OTHER WARRANTIES WHETHER WRITTEN, ORAL, EXPRESSED OR IMPLIED, (INCLUDING ANY WARRANTY OF MERCHANTABILITY OR FITNESS FOR A PARTICULAR PURPOSE). THIS WARRANTY DISCLAIMS LIABILITY FOR INCIDENTAL, OR CONSEQUENTIAL DAMAGES.

HOW STATE LAW APPLIES:

This warranty gives you specific legal rights, and you may also have other rights which vary from state to state

