

CONGRATULATIONS ON YOUR CHOICE OF A CRIMESTOPPER PREMIUM UNIVERSAL, FRONT OR REAR MOUNTABLE PARKING ASSIST SYSTEM. THIS BOOKLET CONTAINS ALL OF THE NECESSARY INFORMATION FOR CONNECTING AND USING YOUR PARKING ASSIST SYSTEM. IF ANY QUESTIONS SHOULD ARISE, CONTACT YOUR INSTALLATION FACILITY OR CHECK OUT THE KNOWLEDGE BASE AT WWW.CRIMESTOPPER.COM

CRIMESTOPPER

S A F E T Y & S E C U R I T Y

WARRANTY

Rockford Corporation offers a limited warranty on all CrimeStopper products as detailed below and on the following terms:

ALL SAFETY PRODUCTS

Length Of Warranty - 3 Year

SECURITY AND REMOTE START PRODUCTS

Length Of Warranty

Limited Lifetime, CrimeStopper will repair or replace defective modules with a comparable new or refurbished module during reasonable usage and the lifetime of the vehicle in which it is originally installed provided that the module is returned to Rockford, shipping pre-paid and accompanied by a legible copy of the original sales receipt from the authorized dealer containing; the consumer's name, authorized dealer's name, date of purchase, item or sku number, product description, and the year make and model of the vehicle in which it is installed. The additional componentry of the system, including but not limited to remotes, antennas and harnesses, are covered by a one year warranty from the date of original purchase. Products received for repair or replacement without proof of purchase from an authorized dealer will be denied.

WHAT IS COVERED

This warranty applies only to CrimeStopper products sold to consumers by authorized CrimeStopper dealers in the United States of America. Products purchased by consumers from an Authorized CrimeStopper Dealer in any other country are covered only by that country's Distributor and not by Rockford Corporation.

WHO IS COVERED

This warranty covers only the original purchaser of CrimeStopper product purchased from an authorized CrimeStopper dealer. In order to receive service, the purchaser must provide Rockford Corporation with a copy of the original sales receipt stating the customer name, dealer name, product purchased and date of purchase. Products found to be defective during the warranty period will be repaired or replaced with a product deemed to be equivalent at Rockford's sole discretion.

WHAT IS NOT COVERED

- Damage caused by accident, abuse, improper installation, operations, water, and theft
- Any cost or expense related to the removal or reinstallation of product
- Any product which has had the serial number defaced, altered, or removed
- Subsequent damage to other components
- Any product not purchased from an authorized CrimeStopper dealer

LIMIT ON IMPLIED WARRANTIES

Any implied warranties including warranties of fitness for use and merchantability are limited in duration to the period of the express warranty set forth above. Some states do not allow limitations on the length of an implied warranty, so this limitation may not apply. No person is authorized to assume for Rockford Corporation any other liability in connection with the sale of the product.

HOW TO OBTAIN SERVICE

Please call 1-800-998-6880 for Rockford Customer Service. You must obtain an RA# (Return Authorization number) to return any product to Rockford Corporation. You are responsible for shipment of product to Rockford. cs.support@rockfordcorp.com

The PARK-PMCU is designed as a universal parking assist system. It will work in either the front or back of a vehicle with metal or plastic bumpers and with or without LED displays (displays sold separately). This system was designed to be flexible enough that no matter the vehicle it is being installed into, you will have the correct parts needed.

TABLE OF CONTENTS

Warranty	2
Introduction	3
Wiring	4-5
Specifications	6
Key Features	7
Settings	8-12
Self Test/ Learning Functions	13-18
Sensor Mounting	19-24
Speaker/ Display Mounting	25-29
Testing	30
Troubleshooting	31
French	32-62
Spanish	63-87

FRONT WIRING HARNESS

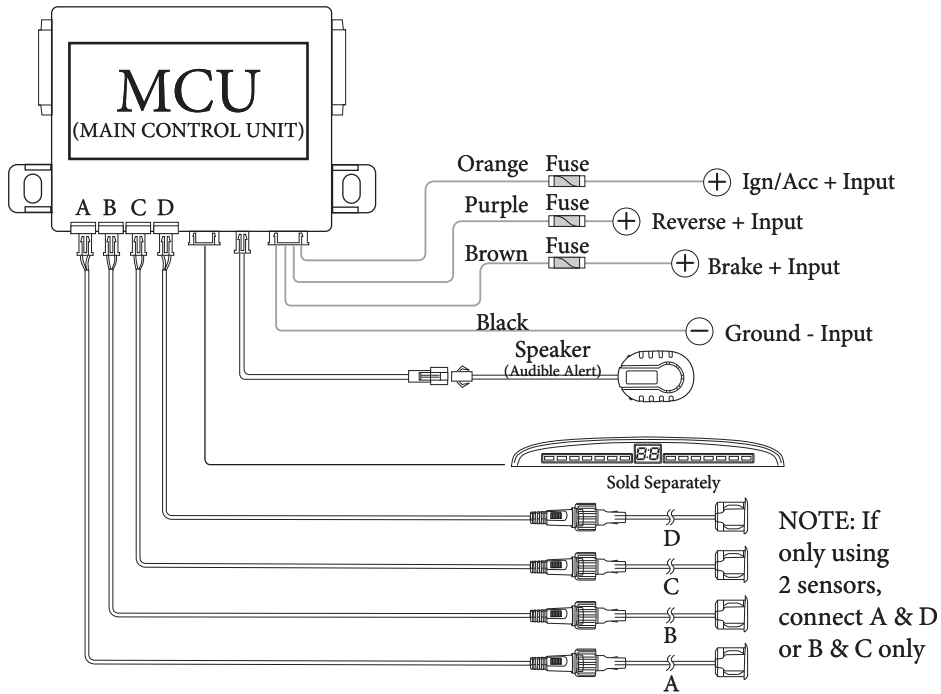

REAR WIRING DIAGRAM

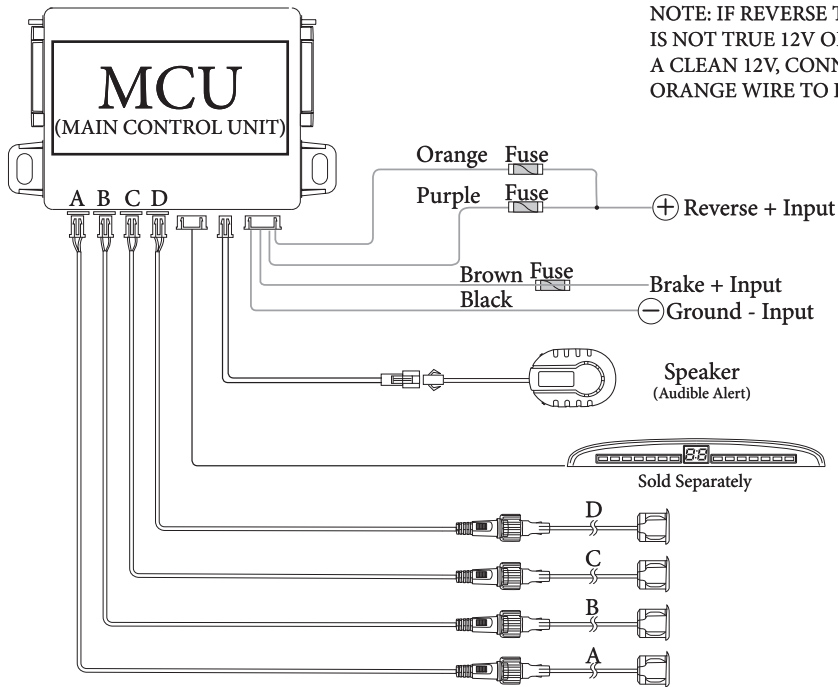

NOTE: IF REVERSE TRIGGER IS NOT TRUE 12V OR IS NOT A CLEAN 12V, CONNECT THE ORANGE WIRE TO IGN/ACC

SPECIFICATIONS

OPERATING VOLTAGE	12/24V DC
OPERATING CURRENT DRAW	MAX DRAW @ 12V, LESS THAN 110mA
DETECTION RANGE	FRONT: 0.3-0.9M/ 1-3FT REAR: 0.3-2.5M/ 1-8.2FT
NUMBER OF SENSORS	4 FRONT OR REAR
SENSORS PAINTABLE	YES, PAINT TRAY INCLUDED
AUDIBLE ALERT	YES, INCLUDED. ADJUSTABLE VOLUME
VISUAL ALERT	YES, SOLD SEPERATELY
SELF TEST FUNCTION	YES
INTELLIGENT DETECTION (KNOWS IF THERE IS A SPARE OR HITCH ON VEHICLE)	YES, FRONT AND REAR

Key Features:

- **Dual purpose** – This system can be used in the front or rear of a vehicle
- **2 sensor options** – This system can be installed with either 2 or 4 sensors (using 4 provides a more accurate reading).
- **Visual displays** – There are 2 optional visual alerts sold separately (PARK-PLED1, PARK-PLED2).
- **Intelligent detection** – This system can learn to “ignore” objects on the front or rear of the vehicle like spare tires, push bars, hitches, tow bars, etc. that may give false alerts.
- **Self-testing** – This system will self-test itself every time it is powered on.
- **All weather design** – This system was designed to work in all weather conditions
- **Sensor mounting options** – The sensors in this system are designed to work in either metal or plastic bumpers

VOLUME ADJUSTMENT

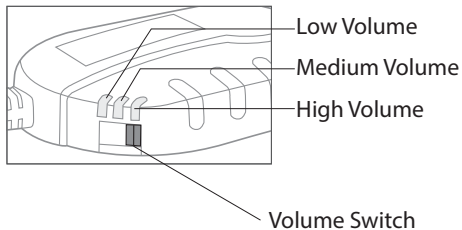

FREQUENCY ADJUSTMENT

The audible alert can be changed to make it easier to tell the difference between the front or rear audible alerts.

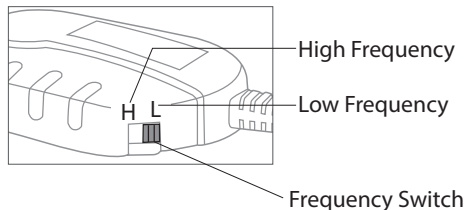

FRONT/REAR SELECTION

This system can be installed in the front or rear of a vehicle.

- Change the settings from front to rear by moving the indicated jumper plug.

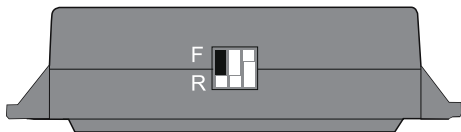

JUMPER POSITION "F"

- Designates the system is installed into the front of the vehicle.

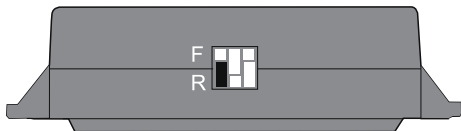

JUMPER POSITION "R"

- Designates the system is installed into the rear of the vehicle.

SENSOR INSTALLATION HEIGHT

- This will tell the system how high the sensors are from the ground.

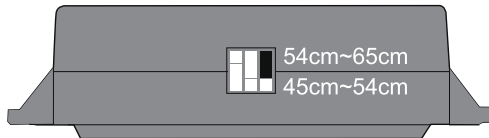

JUMPER POSITION "54cm-65cm"

Select if sensors are mounted 54cm/21.25" – 65cm/25.5" from the ground.

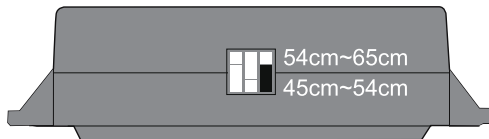

JUMPER POSITION "45cm-54cm"

Select if sensors are mounted 45cm/17.7" – 54cm/21.25" from the ground.

FRONT SYSTEM ACTIVE TIME

- When installed in the front of a vehicle the system is activated by pressing the brake.
- Once the brake is released the system will remain active either 8 or 20 seconds.



JUMPER POSITION "1" (DEFAULT)

- The system will stay active for 8 seconds after releasing the foot brake.
- NOTE: This setting is recommended for automatic transmission vehicles.

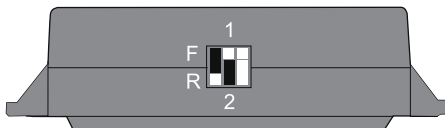

JUMPER POSITION "2"

- The system will stay active for 20 seconds after releasing the foot brake.
- NOTE: This setting is recommended for manual transmission vehicles.

SMART SETTINGS

- Allows the system to account for a rear mounted spare tire or hitch installed on the vehicle.
- Gives you proper warnings without false alarms when backing up.



JUMPER POSITION "1" (DEFAULT)

- Normal stopping distance

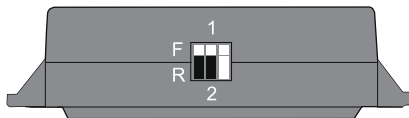

JUMPER POSITION "2"

- Used when you have objects on the rear of the vehicle.
- Extends warning range outward by 20cm/7.75".

SELF TEST

SELF-TEST

This will test all of the connected sensors to make sure that they are working as intended. If there are no issues found during this test, the system will make no alerts. If there is a damaged sensor, the system will give an audible alert 3 times. If the system gives 3 audible alerts (meaning 1 or more of the sensors have damage) the remaining sensor(s) will continue to work.

NOTE: If you are using an optional display, the display read out will show which sensor is faulting.

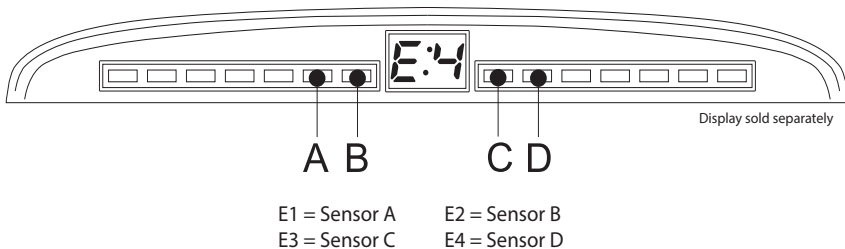

FRONT INSTALL

- The system will perform a self-test when the vehicle's Ignition/Accessory is turned ON.

REAR INSTALL

- The system will perform a self-test when the vehicle's gearshift is placed in "REVERSE".

FRONT INSTALLATIONS:

If you have something attached to the front of your vehicle, you will need to “teach” the system to not look at the object mounted in the front.

To do this:

- Turn the Ignition/Accessory to the ON position
- Press and release the brake pedal 10 times in 10 seconds.
- On the 10th time, hold the pedal down for 6 seconds
- After 6 seconds, you will hear a short alert followed by a long alert
- The learning process has been completed.

To clear the learned setting:

- Turn the Ignition/Accessory to the ON position
- Press and release the brake pedal 12 times in 12 seconds
- On the 12th time, hold the brake pedal down for 8 seconds
- After 8 seconds, you will hear a short alert followed by a second short alert
- The learning process has been cleared.

NOTE: You have 3 minutes to carry out the above procedures from the time you start. If you do not complete the process in the 3 minutes, turn the Ignition/Accessory OFF and then back ON.

NOTE: If at any time in the process you make a mistake, simply release the foot brake for 3 seconds and start the procedure over again.

FRONT SYSTEM FUNCTION

Pressing the brake pedal will activate the front mounted system.

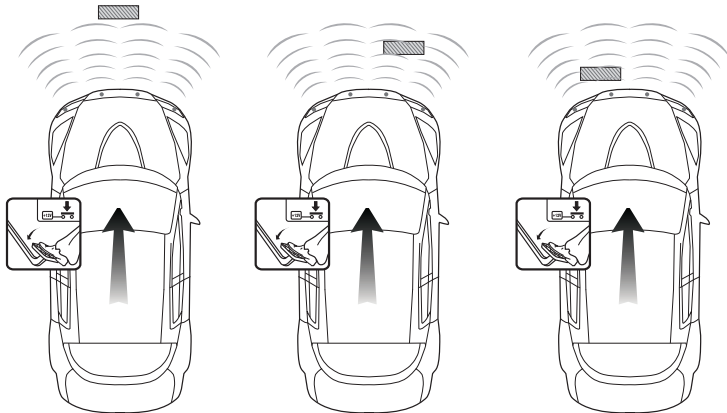

No beep



Distance: 0.9m/3.0ft

Be — Be —



Distance: 0.5m/1.6ft

Be —



Distance: <0.3m/1ft

REAR INSTALLATIONS:

If you have something attached to the rear of your vehicle, you will need to “teach” the system to not look at the object mounted in the rear.

To do this:

- Turn the Ignition/Accessory to the ON position
- Change the gear selector from “N” to “R” 10 times in 10 seconds
- On the 10th time, keep the gear selector in “R” for 6 seconds
- After 6 seconds, you will hear a short alert followed by a long alert
- The learning process has been completed.

To clear the learned setting:

- Turn the Ignition/Accessory to the ON position
- Change the gear selector from “N” to “R” 12 times in 12 seconds
- On the 12th time, keep the gear selector in “R” for 8 seconds
- After 8 seconds, you will hear a short alert followed by a second short alert
- The learning process has been cleared.

NOTE: You have 3 minutes to carry out the above procedures from the time you start. If you do not complete the process in the 3 minutes, turn the Ignition/Accessory OFF and then back ON.

NOTE: If at any time in the process you make a mistake, simply remove the gear selector from “R” for 3 seconds and start the procedure over again.

REAR SYSTEM FUNCTION

Placing the vehicle in Reverse will activate the rear mounted system.

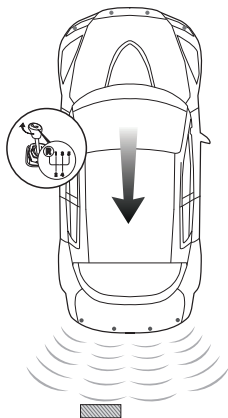

No beep



Distance: 0.7m/2.3ft

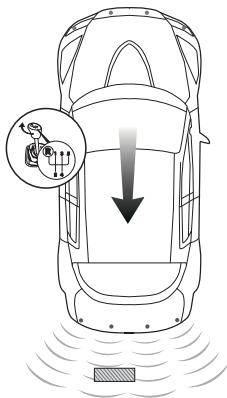

Be--Be--Be--



Distance: 0.5m/1.6ft

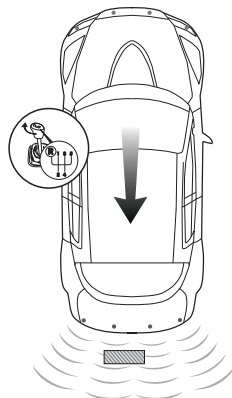

Be

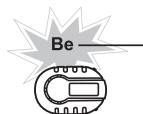

Distance: <0.3m/1ft

AUDIBLE ALERTS

REAR AUDIBLE ALERT

Continuous alert

Faster multiple
repeating alerts

Multiple,
repeating alerts

Faster,
repeating alert

Single,
repeating alert

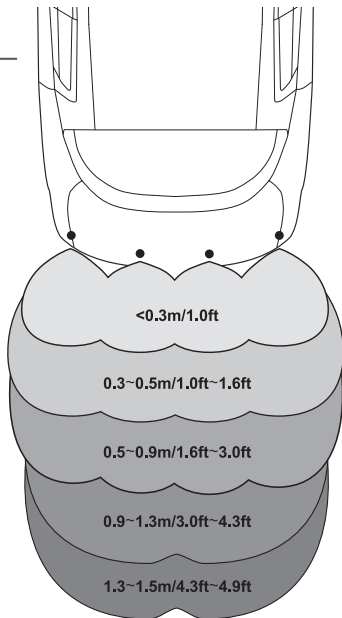

FRONT AUDIBLE ALERT

Continuous alert

Faster multiple
repeating alerts

Multiple,
repeating alerts

Single,
repeating alert

SENSOR INSTALLATION:

- The mounting height of the sensors should be .45m/1.5' to .6m/2'.
- For optimum performance sensors should be evenly spaced across the front/ rear of the vehicle with as little curve as possible.
- In most vehicle's this may be an issue due to license plates or objects behind the bumper, so we recommend the following:

4 SENSOR SYSTEM:

- Find the middle of the bumper
- Find the outer most flat surface where you can mount 2 sensors
- Measure between the outer most sensor location to the middle of the bumper.
- Divide that by 2 and that will give you your best mounting spot for your inner sensor
- If you are not able to use that location, install the sensor as close as possible.

2 SENSOR SYSTEM:

- Find the middle of the bumper
- Find the outer most flat surface where you could mount sensors
- Measure between the outer most location to the middle of the bumper.
- Divide that by 2 to get the best mounting spot for your sensors
- If you are not able to use that location, install the sensor as close as possible.
- Be sure to plug the sensors into ports A and D or B and C only.

NOTE: Before drilling any holes, be sure to check behind the bumper for objects, wiring harnesses or other items to avoid possible damage.

SENSOR MOUNTING LOCATIONS

Use tape that will not damage the vehicles paint to mark your sensor locations

Mark locations before drilling

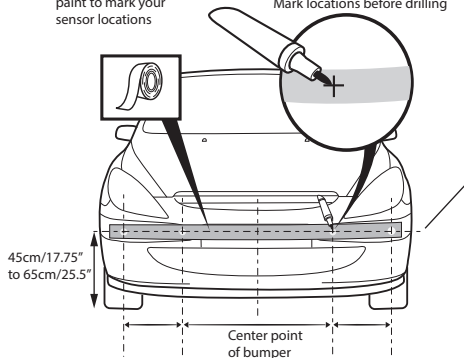

45cm/17.75"
to 65cm/25.5"

Center point
of bumper

Outer Most
Flat Surface
to Mount
Sensor

Optimum
location
for Inner
Sensors

Optimum
location
for Inner
Sensors

Outer Most
Flat Surface
to Mount
Sensor

FRONT SENSOR LOCATIONS

Use tape that will not damage the vehicles paint to mark your sensor locations

Mark locations before drilling

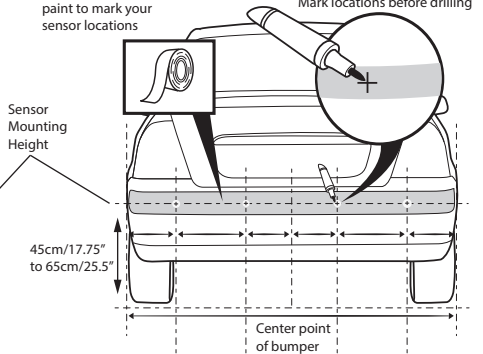

45cm/17.75"
to 65cm/25.5"

Sensor
Mounting
Height

Center point
of bumper

Outer Most
Flat Surface
to Mount
Sensor

Optimum
location
for Inner
Sensors

Optimum
location
for Inner
Sensors

Outer Most
Flat Surface
to Mount
Sensor

REAR SENSOR LOCATIONS

SENSOR ANGLE

CHANGING THE SENSOR HEAD ANGLE

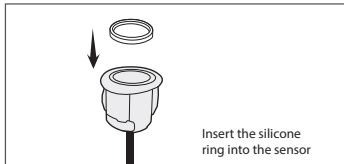
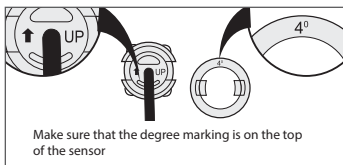
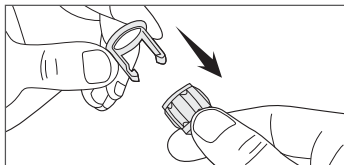
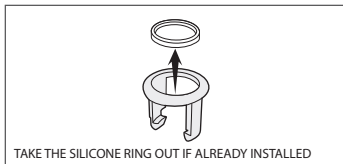
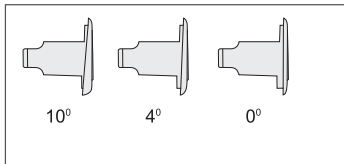
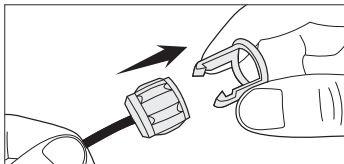
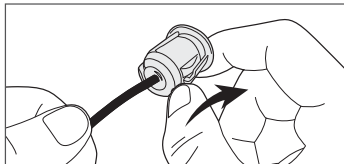
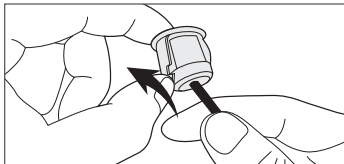

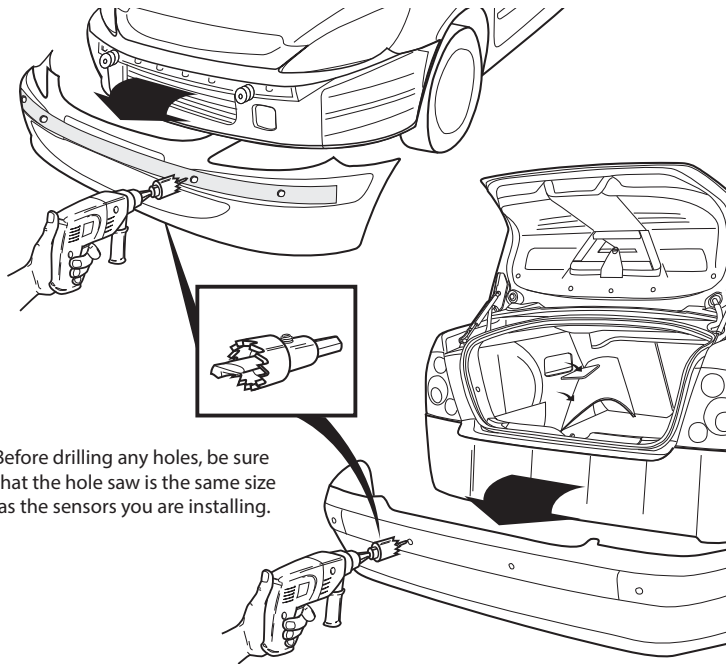

Before drilling any holes, be sure that the hole saw is the same size as the sensors you are installing.

The sensors come mounted in a paint tray with the rubber “O” rings not installed. This will allow for easy color match painting. Once the paint has dried, be sure to install the rubber “O” rings prior to installing the sensors into the vehicle.

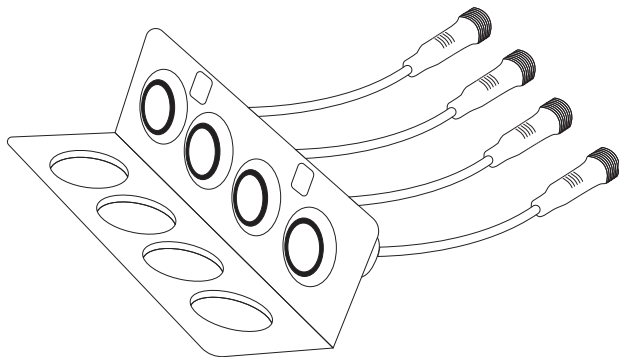

After painting the sensors, let them completely dry before installing the silicone ring.

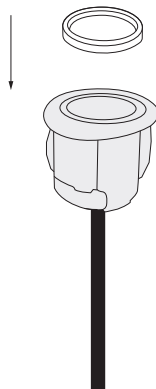

ANGLE ADJUSTMENT

If there is a gap found between the bumper and the sensor head when using the 10 degree angle head, adjust the angle of the hole as shown below.

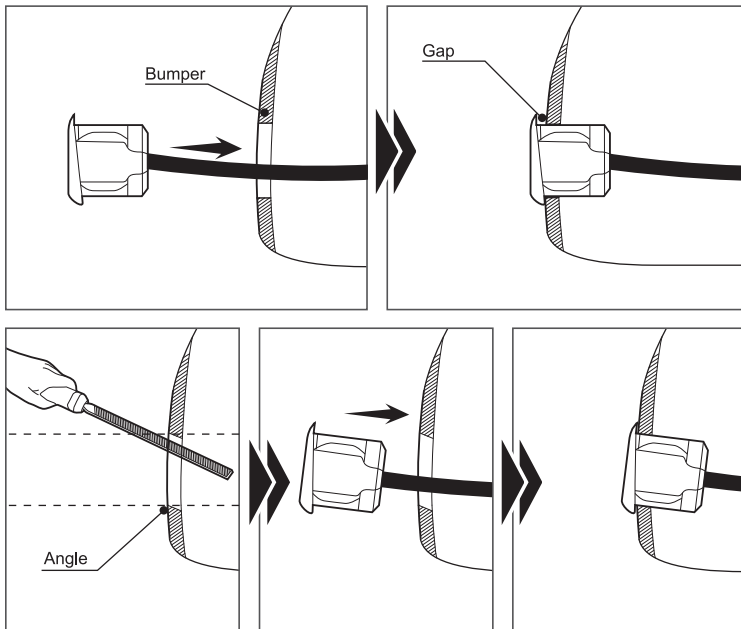

MOUNTING THE SPEAKER

MOUNTING THE AUDIBLE ALERT

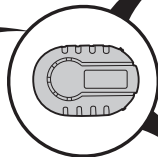
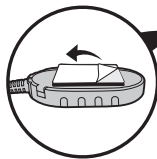

FRONT MOUNT

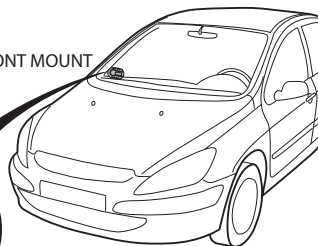

Recommended speaker placement

REAR MOUNT

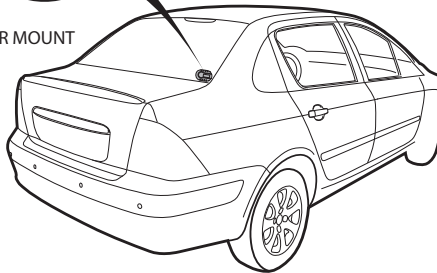

DISPLAY PLACEMENT

DISPLAY PLACEMENT (optional)

Both the PARK-PLD1 and PARK-PLD2 have multiple mounting options. Within these mounting options you will need to change the way the display reads. Below are the different mounting options.

E1 – Dash mount

E2 – Roof mount, front of vehicle

E3 – Roof mount, rear of vehicle. Can be viewed from the rear view mirror.

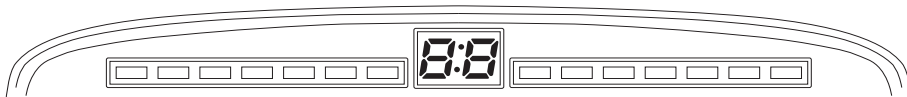

E1 installation mode:

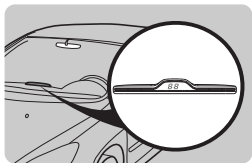

Dashboard mount

E2 installation mode:

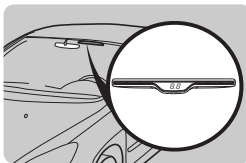

Roof mount, front of vehicle

E3 installation mode:

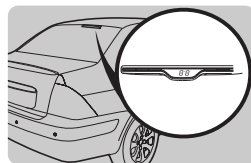

Roof mount, rear of vehicle.
Can be viewed from the
rear view mirror

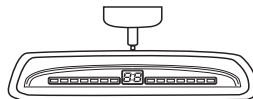

Display Placement Settings

- Turn the Ignition/Accessory ON and place the gear select in "R"
- Press and hold the SET button for 5 seconds until you hear an audible tone.
- Press and release the set button again to cycle through the available setting options.
- The SET button can be accessed through the small hole in top of the display.
- The system will automatically save and exit settings mode after 2 seconds of inactivity.

Default Setting: E1

Three Available Modes: E1, E2, E3

E1 - Dashmount

E2 - Roof Mount Front

E3 - Roof Mount Rear

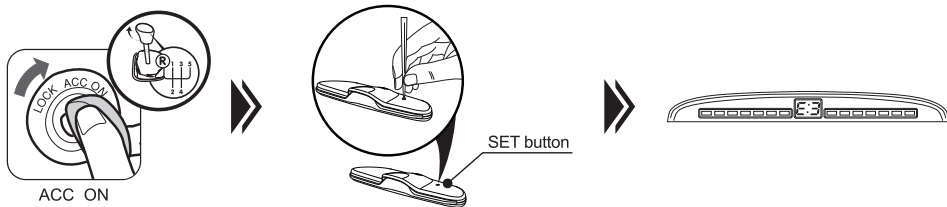

VOLUME ADJUSTMENT

- Turn the Ignition/Accessory ON and place the gear select in "R"
- Press and release the SET button to adjust the volume.
- The SET button can be accessed through the small hole in top of the display.
- The system will automatically save and exit adjustment after 2 seconds of inactivity.

Settings: Default is High

PARK-PLD1: High – 2, Medium – 1, Low – 0

PARK-PLD2: High – 3, Medium – 2, Low – 1

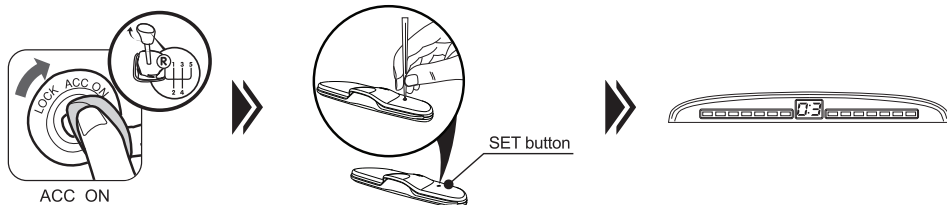

VOICE PROMPTS/ALERTS

The PARK-PLD2 has the option of having voice prompts/alerts. This can be turn ON or OFF using the setting button.

- To turn this feature ON or OFF: Default setting is ON
- Turn the Ignition/Accessory ON and place the vehicle gear select into "R".
- Press the SET button for 2 seconds.
- Press the SET button to turn it ON or OFF

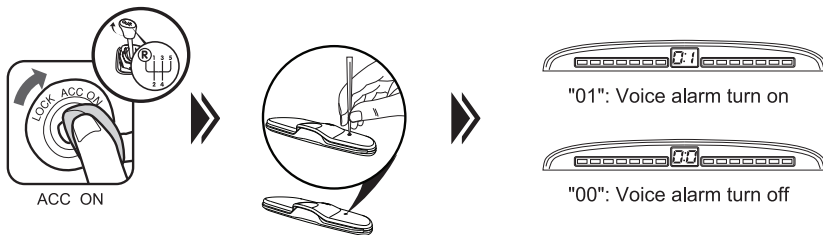

TESTING THE SYSTEM

- To test the system, use a piece of wood (approx. .3mX1m/ 1'X3.3').
- With the board beyond the furthest trigger point, back up to the board.
- The system should trigger once in sensor range.

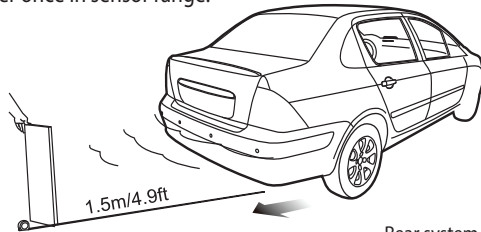

Rear system check

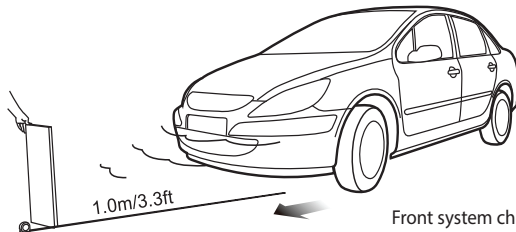

Front system check

- To test front sensors, repeat the test driving towards the board.

TROUBLESHOOTING

After the installation, the audible alert doesn't work.

- A. Are all of the cables connected properly?
- B. Is the vehicles Ignition ON?

There is a damaged sensor detected.

- A. Are all of the sensors plugged into the main control unit correctly and tightly?
- B. Is there a sensor wire broken or damaged?
- C. Is the sensor covered by snow or mud?
- D. Is the sensor itself damaged?

Getting a false warning.

- A. Are all of the sensors plugged into the main control unit correctly and tightly?
- B. Do any of the sensors detect the ground?

Display alarm sound is too low or too high.

- A. Press the SET button to adjust the volume to a suitable level

Any other questions should be directed to CrimeStopper technical support at 1-800-998-6880.

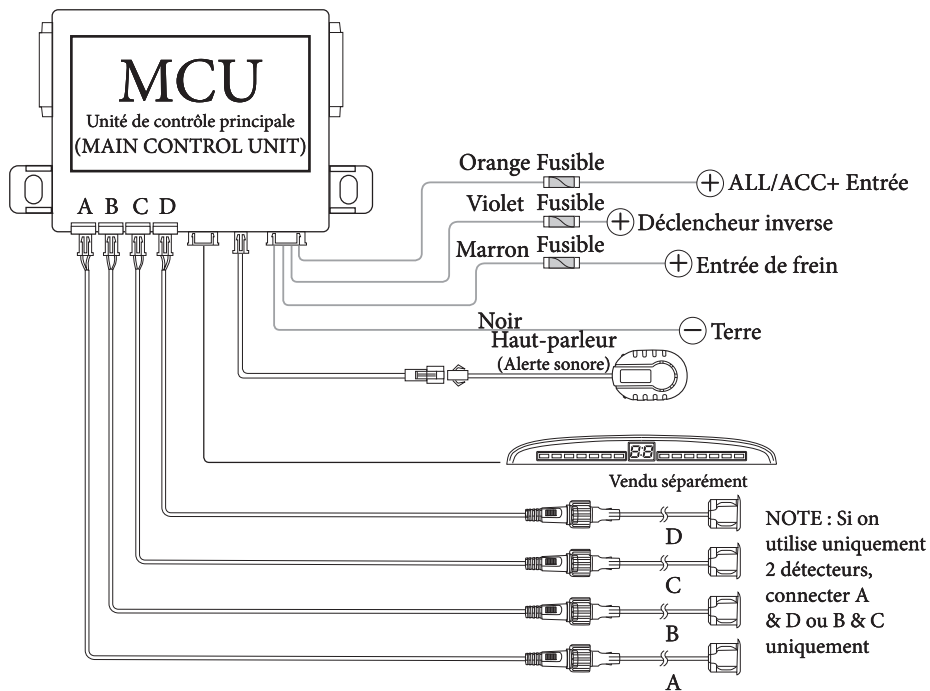

SCHEMA DE CÂBLAGE ARRIÈRE

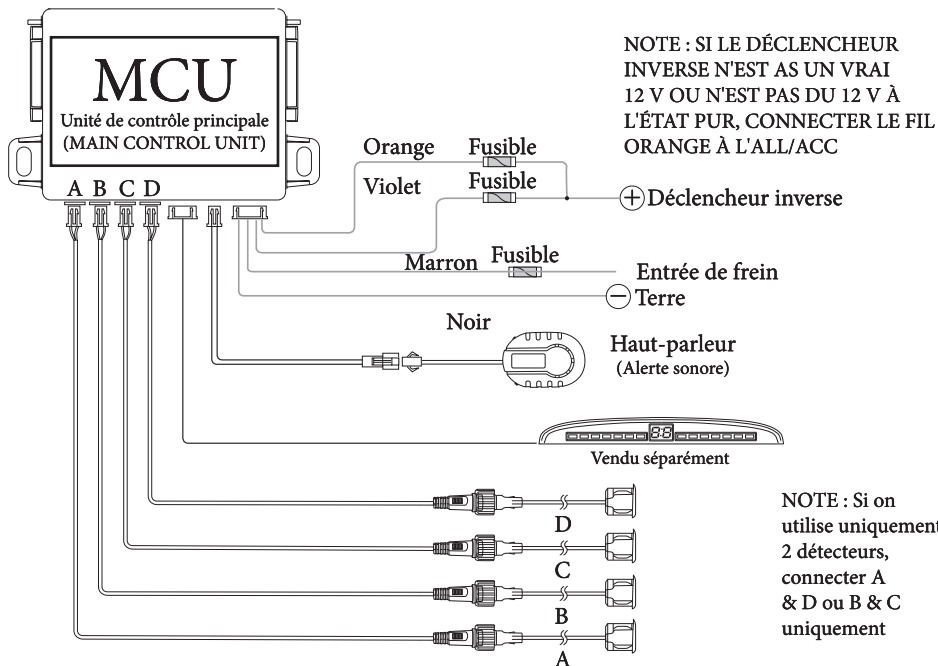

SPÉCIFICATIONS

TENSION DE FONCTIONNEMENT	12 / 24 V c.c.
CONSOMMATION DE COURANT DE FONCTIONNEMENT	CONSOMMATION MAXI à 12 V, MOINS QUE 110 mA
PLAGE DE DÉTECTION	AVANT 0,3-0,9 M/1-3 pi ARRIÈRE 0,3-2,5 M/ 1-8,2 pi
NOMBRE DE DÉTECTEURS	AVANT OU ARRIERE
DÉTECTEURS À PEINDRE	OUI, LE BAC À PEINTURE EST INCLUS
ALERTE SONORE	OUI, INCLUSE VOLUME RÉGLABLE
ALERTE VISUELLE	OUI, VENDUE SÉPARÉMENT
FONCTION D'ESSAI AUTOMATIQUE	OUI
DÉTECTION INTELLIGENTE (SAIT S'IL Y A UNE ROUE DE SECOURS OU UNE REMORQUE SUR LE VÉHICULE)	OUI, AVANT ET ARRIÈRE

Fonctions clés :

- **Double usage** – Ce système peut être utilisé à l'avant ou à l'arrière d'un véhicule
- **2 options de détecteurs** – Ce système peut être installé avec soit 2 soit 4 détecteurs (l'utilisation de 4 détecteurs fournit un relevé plus précis).
- **Affichages visuels** – Il y a 2 alertes visuelles optionnelles vendues séparément (PARK-PLD1, PARK-PLD2).
- **Détection intelligente** – Ce système peut apprendre à « ignorer » les objets sur l'avant ou l'arrière du véhicule tels que des roues de secours, barres de poussée, remorques, barres de remorquage, etc. qui peuvent donner des fausses alertes.
- **Test automatique** – Ce système se testera automatiquement à chaque fois qu'il est mis sous tension.
- **Conception tous temps** – Ce système a été conçu pour fonctionner dans toutes les conditions météorologiques
- **Options de montage des détecteurs** – Les détecteurs dans ce système sont conçus pour fonctionner dans des pare-chocs en métal ou en plastique

VOLUME ADJUSTMENT

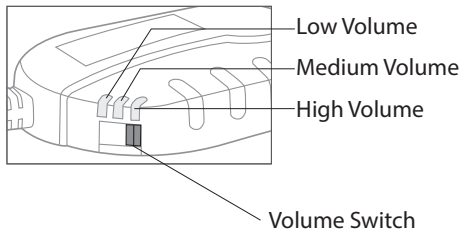

FREQUENCY ADJUSTMENT

The audible alert can be changed to make it easier to tell the difference between the front or rear audible alerts.

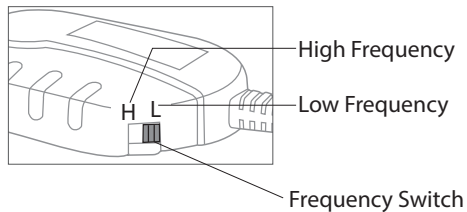

This system can be installed in the front or rear of a vehicle.

- Change the settings from front to rear by moving the indicated jumper plug.

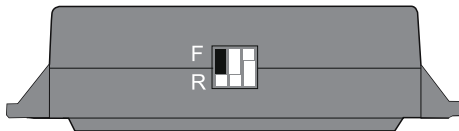

JUMPER POSITION "F"

- Designates the system is installed into the front of the vehicle.

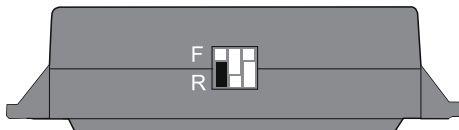

JUMPER POSITION "R"

- Designates the system is installed into the rear of the vehicle.

SENSOR INSTALLATION HEIGHT

- This will tell the system how high the sensors are from the ground.

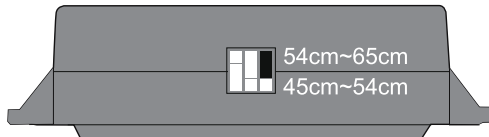

JUMPER POSITION "54cm-65cm"

Select if sensors are mounted 54cm/21.25" – 65cm/25.5" from the ground.

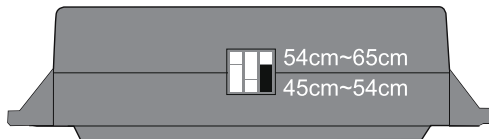

JUMPER POSITION "45cm-54cm"

Select if sensors are mounted 45cm/17.7" – 54cm/21.25" from the ground.

FRONT SYSTEM ACTIVE TIME

- When installed in the front of a vehicle the system is activated by pressing the brake.
- Once the brake is released the system will remain active either 8 or 20 seconds.



JUMPER POSITION "1" (DEFAULT)

- The system will stay active for 8 seconds after releasing the foot brake.
- NOTE: This setting is recommended for automatic transmission vehicles.

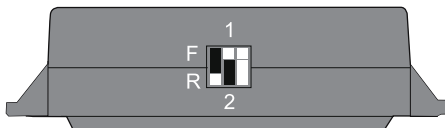

JUMPER POSITION "2"

- The system will stay active for 20 seconds after releasing the foot brake.
- NOTE: This setting is recommended for manual transmission vehicles.

SMART SETTINGS

- Allows the system to account for a rear mounted spare tire or hitch installed on the vehicle.
- Gives you proper warnings without false alarms when backing up.



JUMPER POSITION "1" (DEFAULT)

- Normal stopping distance

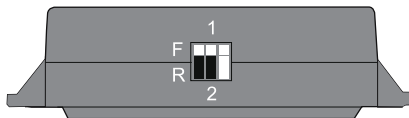

JUMPER POSITION "2"

- Used when you have objects on the rear of the vehicle.
- Extends warning range outward by 20cm/7.75".

SELF-TEST

This will test all of the connected sensors to make sure that they are working as intended. If there are no issues found during this test, the system will make no alerts. If there is a damaged sensor, the system will give an audible alert 3 times. If the system gives 3 audible alerts (meaning 1 or more of the sensors have damage) the remaining sensor(s) will continue to work.

NOTE: If you are using an optional display, the display read out will show which sensor is faulting.

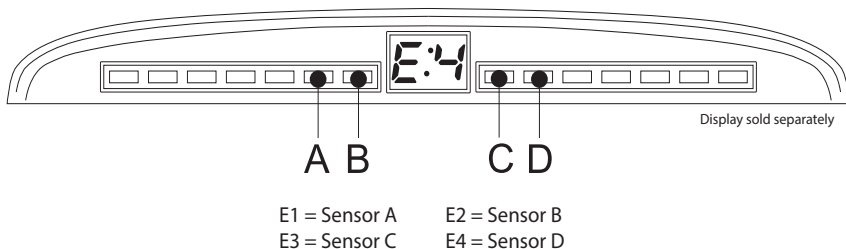

FRONT INSTALL

- The system will perform a self-test when the vehicle's Ignition/Accessory is turned ON.

REAR INSTALL

- The system will perform a self-test when the vehicle's gearshift is placed in "REVERSE".

INSTALLATIONS AVANT

S'il y a quelque chose d'attaché sur l'avant du véhicule, il faudra « apprendre » au système d'ignorer l'objet monté sur l'avant.

Pour ce faire :

- Mettre le contact/accessoire en position ON (marche).
- Appuyer sur et relâcher la pédale de frein à 10 reprises en 10 secondes.
- À la dixième reprise, maintenir la pédale enfoncée pendant 6 secondes
- Au bout de 6 secondes, une courte alarme retentira suivie d'une longue alarme
- Le processus d'apprentissage est terminé.

Pour effacer le paramètre appris :

- Mettre le contact/accessoire en position ON (marche).
- Appuyer sur et relâcher la pédale de frein à 12 reprises en 12 secondes.
- À la douzième reprise, maintenir la pédale enfoncée pendant 8 secondes
- Au bout de 8 secondes, une courte alarme retentira suivie d'une deuxième courte alarme
- Le processus d'apprentissage est terminé.

NOTE : Il y a 3 minutes pour exécuter les procédures ci-dessus à partir du moment où l'on commence. Si le processus n'est pas fini dans les 3 minutes, mettre l'allumage/accessoire sur OFF puis à nouveau sur ON.

NOTE : En cas d'erreur pendant le processus, il suffit de relâcher le frein à pied pendant 3 secondes et relancer la procédure.

Pressing the brake pedal will activate the front mounted system.

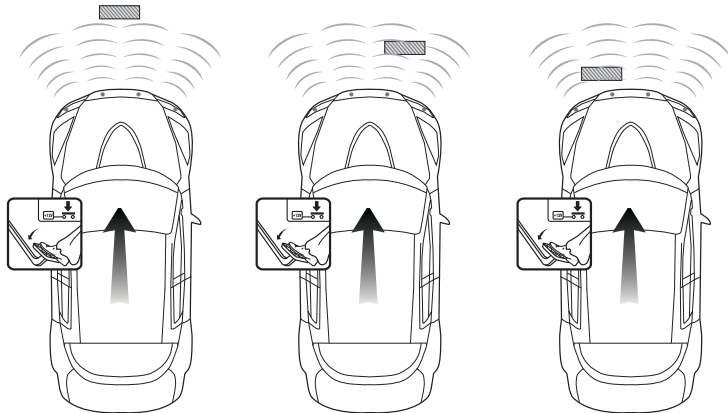

No beep



Distance: 0.9m/3.0ft

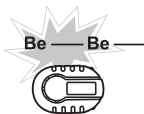

Distance: 0.5m/1.6ft

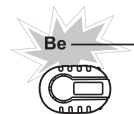

Distance: <0.3m/1ft

INSTALLATIONS ARRIÈRE :

S'il y a quelque chose d'attaché à l'arrière du véhicule, il faudra « apprendre » au système d'ignorer l'objet monté à l'arrière.

Pour ce faire :

- Mettre le contact/accessoire en position ON (marche).
- Changer le levier de vitesse de « N » à « R » à 10 reprises en 10 secondes
- À la dixième reprise, maintenir le levier de vitesse en « R » pendant 6 secondes
- Au bout de 6 secondes, une courte alarme retentira suivie d'une longue alarme
- Le processus d'apprentissage est terminé.

Pour effacer le paramètre appris :

- Mettre le contact/accessoire en position ON (marche).
- Changer le levier de vitesse de « N » à « R » à 12 reprises en 12 secondes
- À la douzième reprise, maintenir le levier de vitesse en « R » pendant 8 secondes
- Au bout de 8 secondes, une courte alarme retentira suivie d'une deuxième courte alarme
- Le processus d'apprentissage est terminé.

NOTE : Il y a 3 minutes pour exécuter les procédures ci-dessus à partir du moment où l'on commence. Si le processus n'est pas fini dans les 3 minutes, mettre l'allumage/accessoire sur OFF puis à nouveau sur ON.

NOTE : En cas d'erreur pendant le processus, il suffit de retirer le levier de vitesse de « R » pendant 3 secondes et relancer la procédure.

Placing the vehicle in Reverse will activate the rear mounted system.

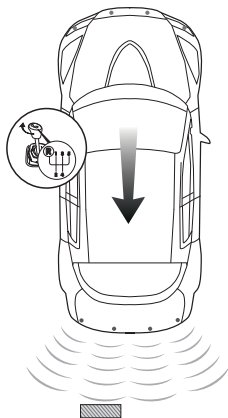

No beep



Distance: 0.7m/2.3ft

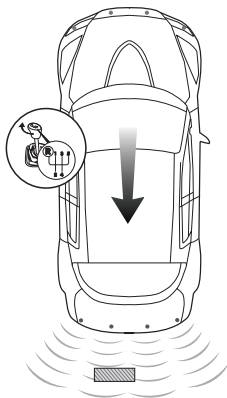

Be--Be--Be--

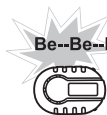

Distance: 0.5m/1.6ft

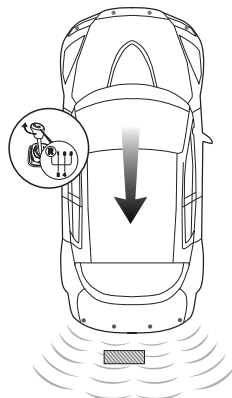

Be

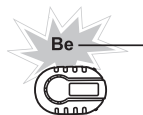

Distance: <0.3m/1ft

REAR AUDIBLE ALERT
<p>Continuous alert</p> <p>Faster multiple repeating alerts</p> <p>Multiple, repeating alerts</p> <p>Faster, repeating alert</p> <p>Single, repeating alert</p>

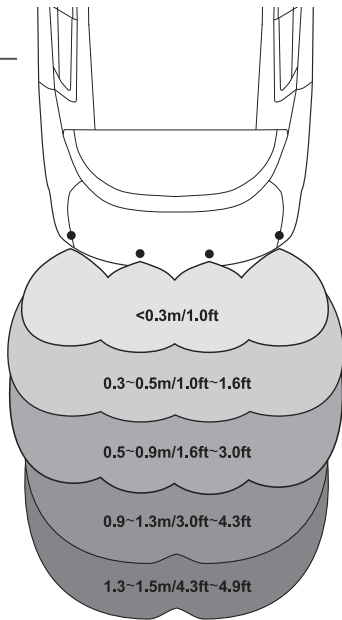

FRONT AUDIBLE ALERT
<p>Continuous alert</p> <p>Faster multiple repeating alerts</p> <p>Multiple, repeating alerts</p> <p>Single, repeating alert</p>

INSTALLATION DES DÉTECTEURS

- La hauteur de montage des détecteurs doit être de 0,45 m/1,5' à 0,60 m/2'.
- Pour une performance optimale, les détecteurs doivent être uniformément espacés sur l'avant et l'arrière du véhicule avec le moins de courbe possible.
- Dans certains véhicules, cela peut être un problème en raison des plaques d'immatriculation ou des objets derrière le pare-chocs, il est donc recommandé de faire ce qui suit :

SYSTÈME DE 4 DÉTECTEURS

- Trouver le milieu du pare-chocs
- Trouver la surface externe la plus plate où l'on peut monter 2 détecteurs
- Mesurer le point le plus externe du détecteur au centre du pare-chocs.
- Diviser cela par 2 et cela donnera le meilleur point de montage pour le détecteur interne
- S'il est impossible d'utiliser cet endroit installer le détecteur aussi près que possible.

SYSTÈME DE 2 DÉTECTEURS

- Trouver le milieu du pare-chocs
- Trouver la surface externe la plus plate où l'on peut monter des détecteurs
- Mesurer le point le plus externe du détecteur au centre du pare-chocs.
- Diviser cela par 2 pour obtenir le meilleur point de montage pour les détecteurs
- S'il est impossible d'utiliser cet endroit, installer le détecteur aussi près que possible.
- S'assurer de brancher les détecteurs dans les ports A et D ou B et C uniquement.

NOTE : Avant de percer des trous, s'assurer de vérifier derrière le pare-chocs pour des objets, faisceaux de câblage ou autres articles pour éviter tout dommage possible.

EMPLACEMENTS DE MONTAGE DES DÉTECTEURS

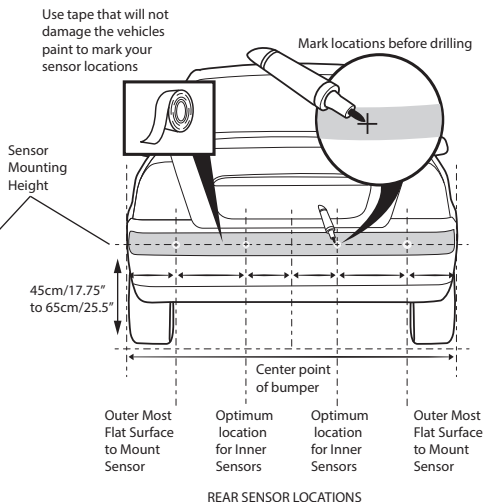
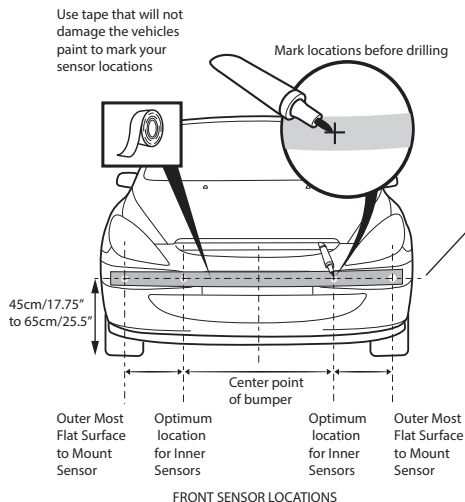

ANGLE DE DÉTECTEUR

CHANGING THE SENSOR HEAD ANGLE

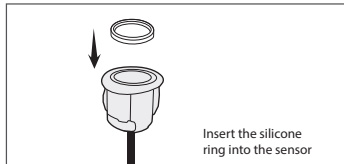
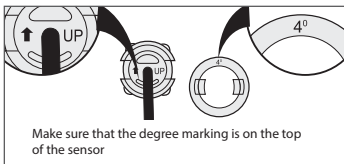
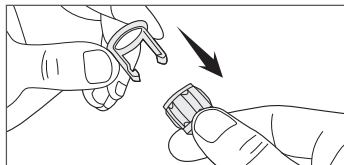
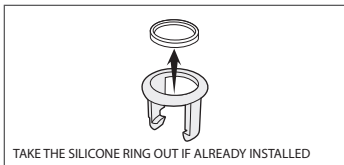
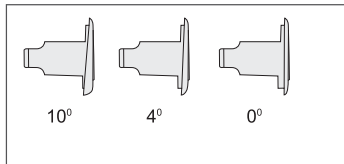
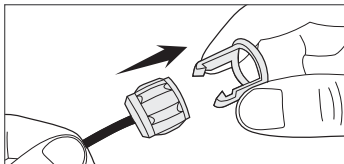
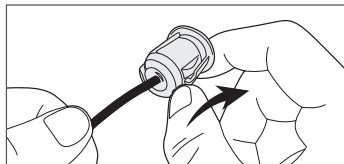
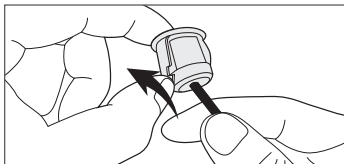

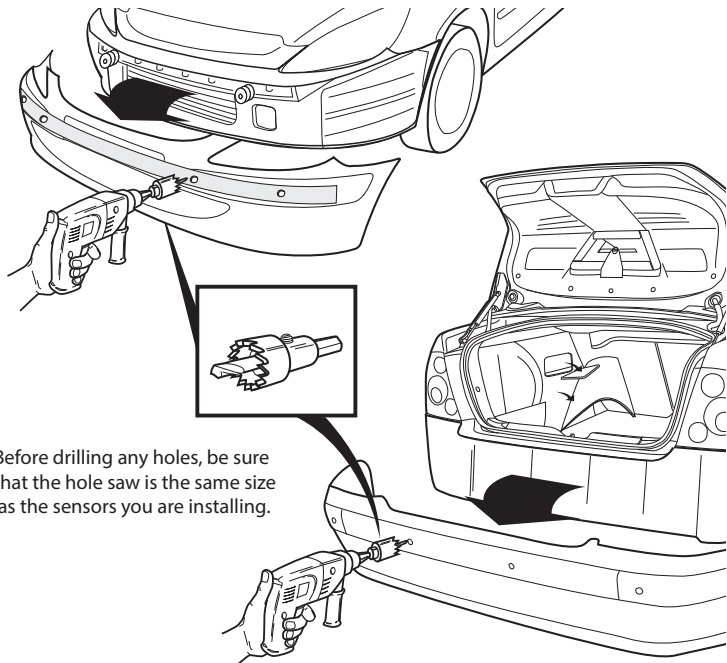

Before drilling any holes, be sure that the hole saw is the same size as the sensors you are installing.

Les détecteurs sont livrés montés dans un bac à peinture avec les joints toriques en caoutchouc non installés. Ce qui permettra de peindre en assortissant facilement les couleurs. Une fois la peinture sèche, veiller à installer les joints toriques en caoutchouc avant d'installer les détecteurs dans le véhicule.

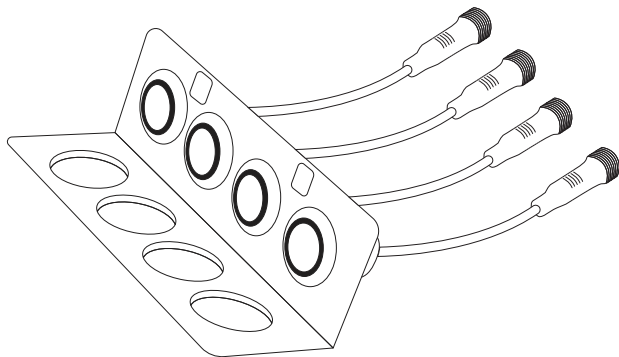

After painting the sensors, let them completely dry before installing the silicone ring.

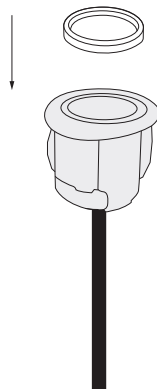

AJUSTEMENT DE L'ANGLE

If there is a gap found between the bumper and the sensor head when using the 10 degree angle head, adjust the angle of the hole as shown below.

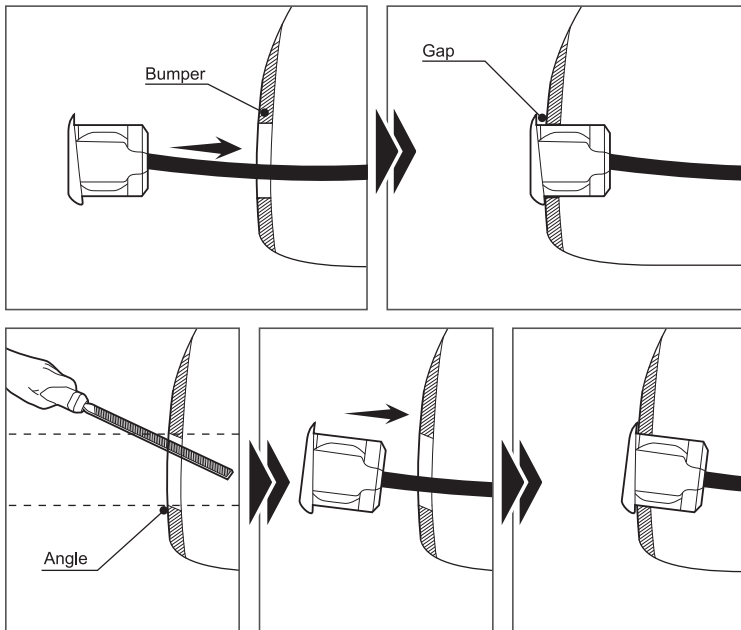

MOUNTING THE AUDIBLE ALERT

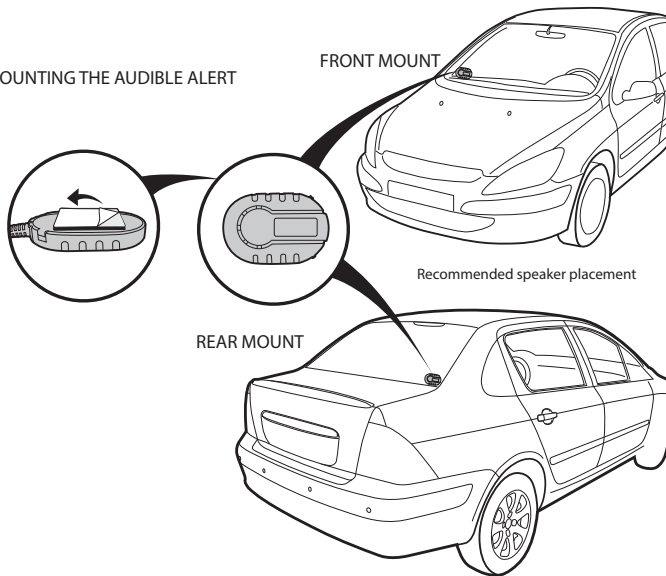

DISPLAY PLACEMENT (optional)

Both the PARK-PLD1 and PARK-PLD2 have multiple mounting options. Within these mounting options you will need to change the way the display reads. Below are the different mounting options.

E1 – Dash mount

E2 – Roof mount, front of vehicle

E3 – Roof mount, rear of vehicle. Can be viewed from the rear view mirror.

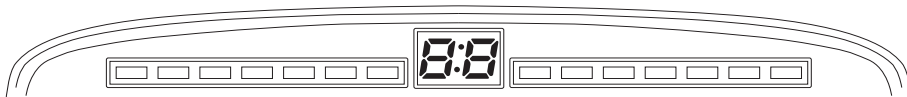

E1 installation mode:

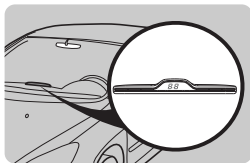

Dashmount

E2 installation mode:

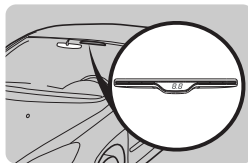

Roof mount, front of vehicle

E3 installation mode:

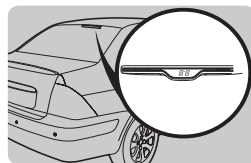

Roof mount, rear of vehicle.
Can be viewed from the
rear view mirror

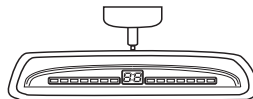

Display Placement Settings

- Turn the Ignition/Accessory ON and place the gear select in "R"
- Press and hold the SET button for 5 seconds until you hear an audible tone.
- Press and release the set button again to cycle through the available setting options.
- The SET button can be accessed through the small hole in top of the display.
- The system will automatically save and exit settings mode after 2 seconds of inactivity.

Default Setting: E1

Three Available Modes: E1, E2, E3

E1 - Dashmount

E2 - Roof Mount Front

E3 - Roof Mount Rear

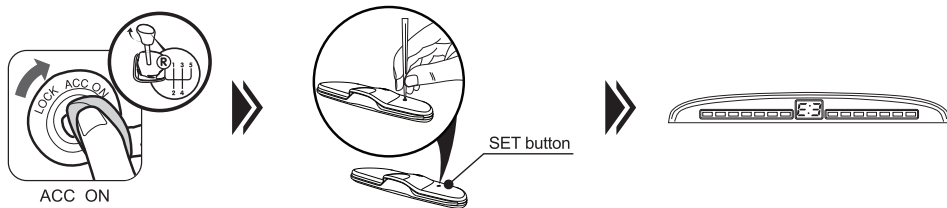

VOLUME ADJUSTMENT

- Turn the Ignition/Accessory ON and place the gear select in "R"
- Press and release the SET button to adjust the volume.
- The SET button can be accessed through the small hole in top of the display.
- The system will automatically save and exit adjustment after 2 seconds of inactivity.

Settings: Default is High

PARK-PLED1: High – 2, Medium – 1, Low – 0

PARK-PLED2: High – 3, Medium – 2, Low – 1

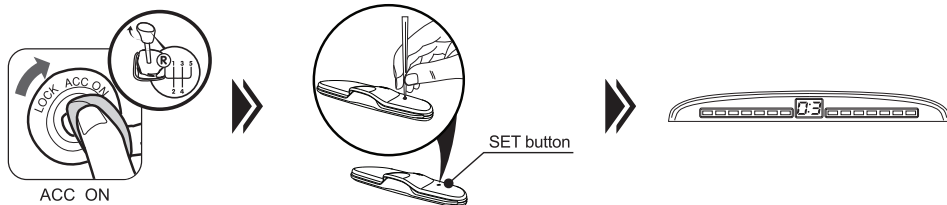

VOICE PROMPTS/ALERTS

The PARK-PLD2 has the option of having voice prompts/alerts. This can be turn ON or OFF using the setting button.

- To turn this feature ON or OFF: Default setting is ON
- Turn the Ignition/Accessory ON and place the vehicle gear select into "R".
- Press the SET button for 2 seconds.
- Press the SET button to turn it ON or OFF

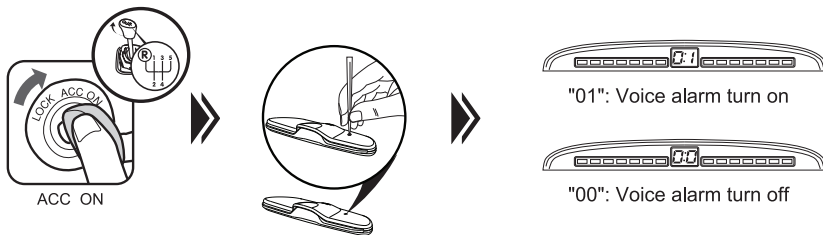

TEST DU SYSTÈME

- To test the system, use a piece of wood (approx. .3mX1m/ 1'X3.3').
- With the board beyond the furthest trigger point, back up to the board.
- The system should trigger once in sensor range.

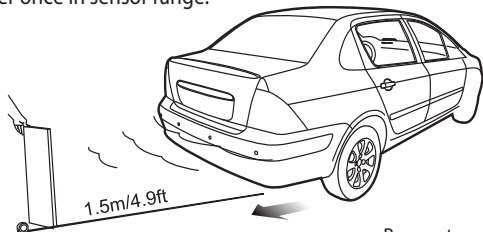

Rear system check

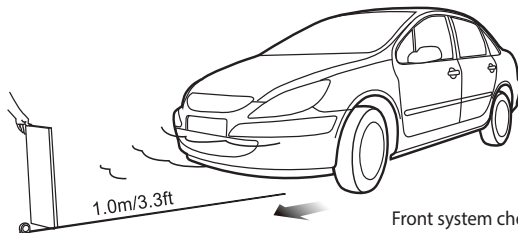

Front system check

- To test front sensors, repeat the test driving towards the board.

DEPANNAGE

Après l'installation, l'alarme sonore ne fonctionne pas.

- A. Tous les câbles sont-ils correctement connectés ?
- B. Le contact du véhicule est-il sur ON ?

Un détecteur endommagé est détecté.

- 1A. Tous les détecteurs sont-ils bien branchés correctement dans la principale unité de contrôle ?
- B. Y a-t-il un fil de détecteur cassé ou endommagé ?
- C. Le détecteur est-il couvert par la neige ou la boue ?
- D. Le détecteur lui-même est-il endommagé ?

Obtenir un faux avertissement

- 1A. Tous les détecteurs sont-ils bien branchés correctement dans la principale unité de contrôle ?
- B. L'un des détecteurs détecte-il la terre ?

Le son d'alarme d'affichage est trop bas ou trop haut.

- A. Appuyer sur le bouton SET pour ajuster le volume à un niveau convenable

Toute autre question doit être adressée au support technique CrimeStopper en composant le 1-800-998-6880.

ARNÉS DE CABLEADO DELANTERO



DIAGRAMA DE CABLEADO TRASERO



NOTA: SI EL DISPARO DE REVERSA NO ES DE 12V VERDADEROS, O 12V SIN ALTIBAJOS, CONECTE EL CABLE NARANJA A IGN/ACC

NOTA: Si solamente está usando 2 sensores, conecte A y D o B y C solamente

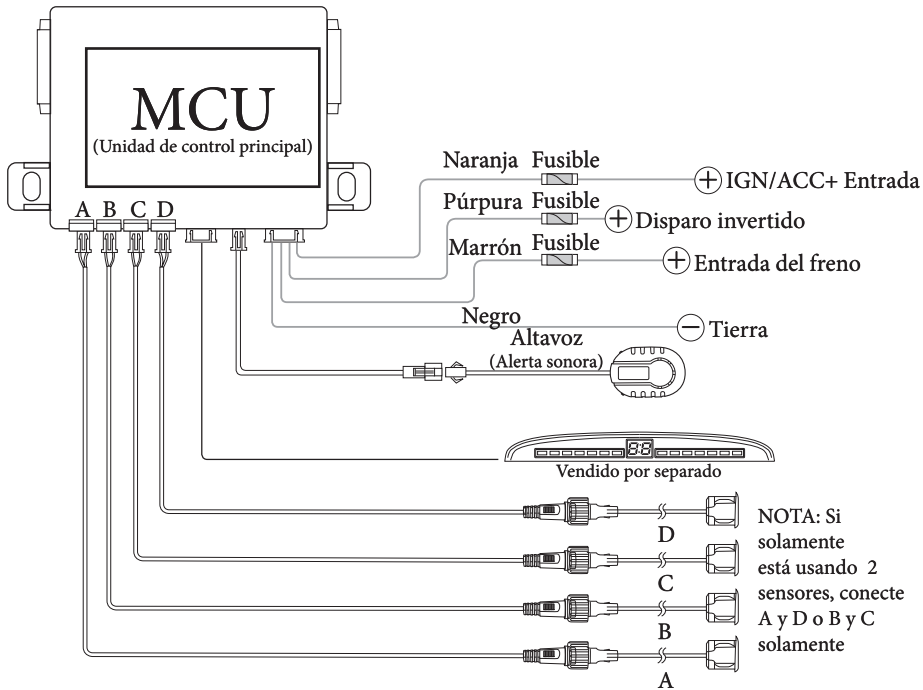
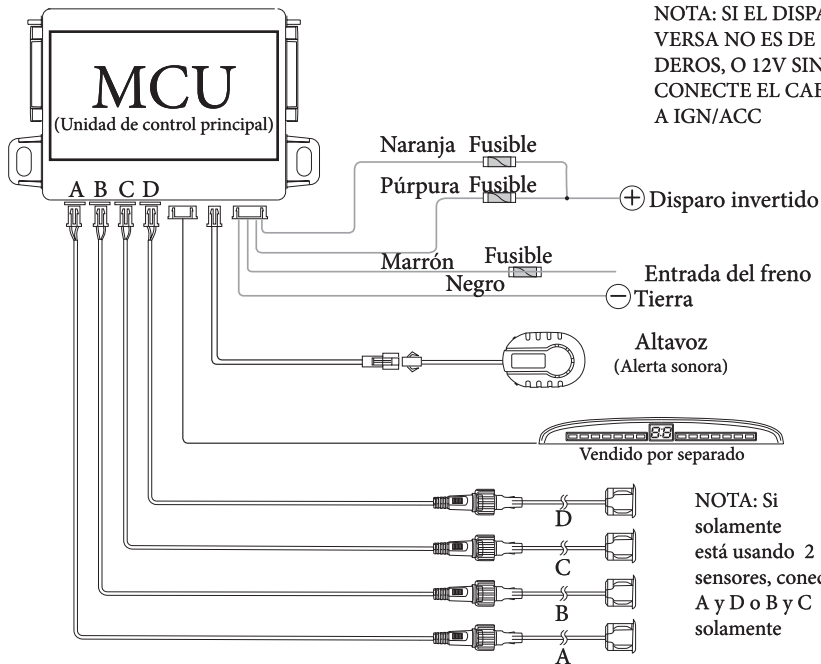
VOLTAJE DE FUNCIONAMIENTO	12/24V CC
CONSUMO DE CORRIENTE EN FUNCIONAMIENTO	CONSUMO MÁXIMO A 12V, MENOS DE 110mA
ALCANCE DE DETECCIÓN	DELANTERA: 0.3-0.9 M / 1-3 PIES TRASERA: 0.3-2.5 M / 1-8.2 PIES
CANTIDAD DE SENSORES	4 DELANTEROS O TRASEROS
SE PUEDEN PINTAR LOS SENSORES	SI, SE INCLUYE UNA BANDEJA DE PINTURA
ALERTA SONORA	SI, INCLUIDA VOLUMEN AJUSTABLE
ALERTA VISUAL	SI, SE VENDE POR SEPARADO
FUNCIÓN DE AUTOCOMPROBACIÓN	SÍ
DETECCIÓN INTELIGENTE (SABE SI HAY UNA RUEDA DE REPUESTO O UN ENGANCHE EN EL VEHÍCULO)	SI, ADELANTE Y ATRÁS

Características claves:

- **Propósito doble** – Se puede usar este sistema en la parte delantera o trasera de un vehículo
- **2 opciones de sensor** – Se puede instalar este sistema con 2 o 4 sensores (usar 4 proporciona una lectura más exacta).
- **Visualizaciones** – Hay 2 alertas visuales opcionales que se venden por separado (PARK-PLED1, PARK-PLED2).
- **Detección inteligente** – Este sistema puede aprender a “ignorar” objetos en la parte delantera o trasera del vehículo como ruedas de repuesto, barras de empuje, enganches, barras de remolque, etc. que podrían dar alertas falsas.
- **Autocomprobación** – Este sistema se hará una autocomprobación cada vez que se enciende.
- **Diseño para todo tipo de tiempo** – Se diseñó este sistema para que funcione en todo tipo de condiciones meteorológicas
- **Opciones de montaje de sensores** – Los sensores en este sistema fueron diseñados para que funcionen en parachoques de metal o plástico

VOLUME ADJUSTMENT

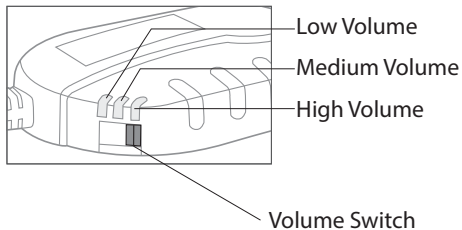

FREQUENCY ADJUSTMENT

The audible alert can be changed to make it easier to tell the difference between the front or rear audible alerts.

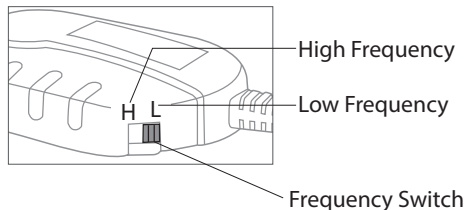

SELECCIÓN DELANTERA/TRASERA

This system can be installed in the front or rear of a vehicle.

- Change the settings from front to rear by moving the indicated jumper plug.

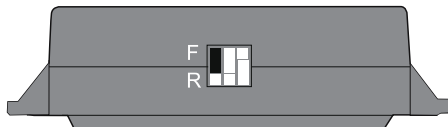

JUMPER POSITION "F"

- Designates the system is installed into the front of the vehicle.

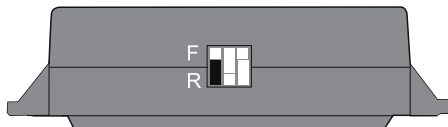

JUMPER POSITION "R"

- Designates the system is installed into the rear of the vehicle.

SENSOR INSTALLATION HEIGHT

- This will tell the system how high the sensors are from the ground.

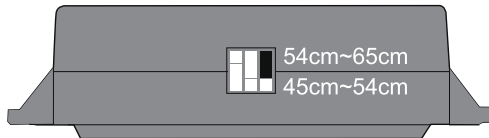

JUMPER POSITION "54cm-65cm"

Select if sensors are mounted 54cm/21.25" – 65cm/25.5" from the ground.

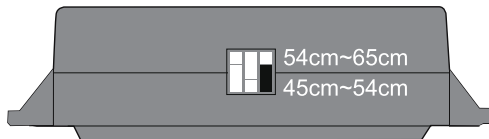

JUMPER POSITION "45cm-54cm"

Select if sensors are mounted 45cm/17.7" – 54cm/21.25" from the ground.

FRONT SYSTEM ACTIVE TIME

- When installed in the front of a vehicle the system is activated by pressing the brake.
- Once the brake is released the system will remain active either 8 or 20 seconds.



JUMPER POSITION "1" (DEFAULT)

- The system will stay active for 8 seconds after releasing the foot brake.
- NOTE: This setting is recommended for automatic transmission vehicles.

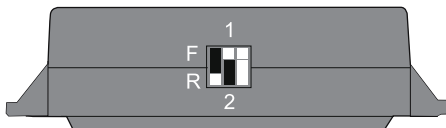

JUMPER POSITION "2"

- The system will stay active for 20 seconds after releasing the foot brake.
- NOTE: This setting is recommended for manual transmission vehicles.

SMART SETTINGS

- Allows the system to account for a rear mounted spare tire or hitch installed on the vehicle.
- Gives you proper warnings without false alarms when backing up.



JUMPER POSITION "1" (DEFAULT)

- Normal stopping distance

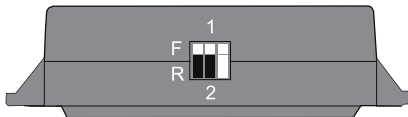

JUMPER POSITION "2"

- Used when you have objects on the rear of the vehicle.
- Extends warning range outward by 20cm/7.75".

SELF-TEST

This will test all of the connected sensors to make sure that they are working as intended. If there are no issues found during this test, the system will make no alerts. If there is a damaged sensor, the system will give an audible alert 3 times. If the system gives 3 audible alerts (meaning 1 or more of the sensors have damage) the remaining sensor(s) will continue to work.

NOTE: If you are using an optional display, the display read out will show which sensor is faulting.

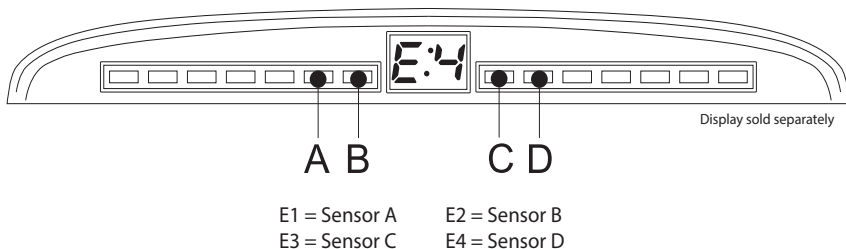

FRONT INSTALL

- The system will perform a self-test when the vehicle's Ignition/Accessory is turned ON.

REAR INSTALL

- The system will perform a self-test when the vehicle's gearshift is placed in "REVERSE".

INSTALACIONES DELANTERAS

Si tiene algo conectado a la parte delantera de su vehículo, deberá "enseñar" al sistema que no mire a ese objeto montado en la parte delantera.

Para hacerlo:

- Coloque el encendido/accesorio en la posición de activado "ON".
- Presione y suelte el pedal de freno 10 veces en 10 segundos.
- La décima vez, sostenga el pedal apretado durante 6 segundos
- Después de 6 segundos, escuchará una breve alerta seguida por una alerta prolongada
- Se ha completado el proceso de aprendizaje.

Para eliminar la configuración aprendida:

- Coloque el encendido/accesorio en la posición de activado "ON".
- Presione y suelte el pedal de freno 12 veces en 12 segundos.
- La duodécima vez, sostenga el pedal apretado durante 8 segundos
- Después de 8 segundos, escuchará una breve alerta seguida por una segunda breve alerta
- Se ha eliminado el proceso de aprendizaje.

NOTA: Tiene 3 minutos para hacer los procedimientos anteriores desde el momento que comienza. Si no completa el proceso en los 3 minutos, apague (OFF) el encendido/accesorio y luego vuelva a colocarlo en ON (encendido).

NOTA: Si en algún momento del proceso comete un error, simplemente suelte el freno de pie durante 3 segundos y vuelva a comenzar el procedimiento.

FUNCIÓN DEL SISTEMA DELANTERO

Pressing the brake pedal will activate the front mounted system.

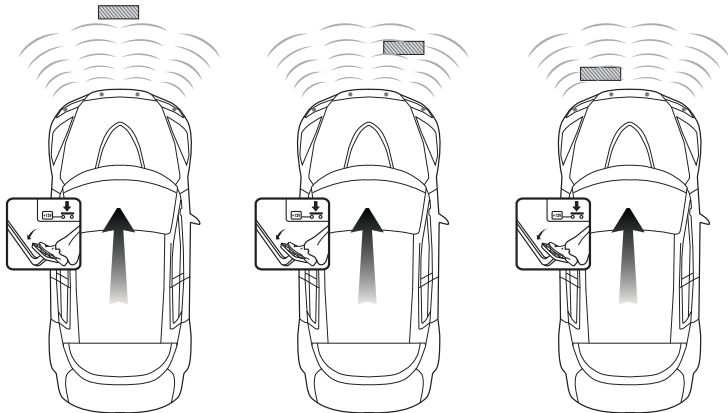

No beep



Distance: 0.9m/3.0ft

Be — Be —



Distance: 0.5m/1.6ft

Be —



Distance: <0.3m/1ft

INSTALACIONES EN LA PARTE TRASERA

Si tiene algo conectado a la parte trasera de su vehículo, deberá "enseñar" al sistema que no mire a ese objeto montado en la parte trasera.

Para hacerlo:

- Coloque el encendido/accesorio en la posición de encendido "ON".
- Cambie el cambio de marcha desde "N" a "R" 10 veces en 10 segundos
La décima vez, sostenga el cambio de marcha en "R" durante 6 segundos
- Después de 6 segundos, escuchará una breve alerta seguida por una alerta prolongada
- Se ha completado el proceso de aprendizaje.

Para eliminar la configuración aprendida:

- Coloque el encendido/accesorio en la posición de activado "ON".
- Cambie el cambio de marcha desde "N" a "R" 12 veces en 12 segundos
- La duodécima vez, sostenga el cambio de marcha en "R" durante 8 segundos
- Después de 8 segundos, escuchará una breve alerta seguida por una segunda breve alerta
- Se ha eliminado el proceso de aprendizaje.

NOTA: Tiene 3 minutos para hacer los procedimientos anteriores desde el momento que comienza. Si no completa el proceso en los 3 minutos, apague (OFF) el encendido/accesorio y luego vuelva a colocarlo en ON (encendido).

NOTA: Si en cualquier momento durante el proceso comete un error simplemente saque el cambio de marcha de "R" durante 3 segundos y comience de nuevo el procedimiento.

Placing the vehicle in Reverse will activate the rear mounted system.

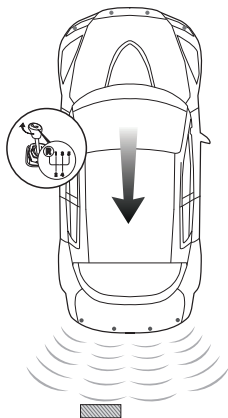

No beep



Distance: 0.7m/2.3ft

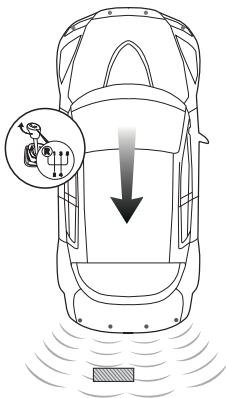

Be--Be--Be--

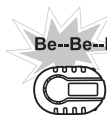

Distance: 0.5m/1.6ft

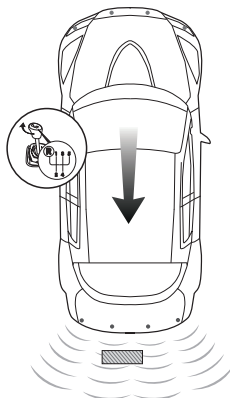

Be

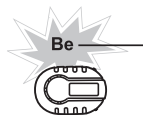

Distance: <0.3m/1ft

REAR AUDIBLE ALERT		FRONT AUDIBLE ALERT
<p>Continuous alert</p> <p>Faster multiple repeating alerts</p> <p>Multiple, repeating alerts</p> <p>Faster, repeating alert</p> <p>Single, repeating alert</p>	 <p><math><0.3\text{m}/1.0\text{ft}</math></p> <p>0.3~0.5m/1.0ft~1.6ft</p> <p>0.5~0.9m/1.6ft~3.0ft</p> <p>0.9~1.3m/3.0ft~4.3ft</p> <p>1.3~1.5m/4.3ft~4.9ft</p>	<p>Continuous alert</p> <p>Faster multiple repeating alerts</p> <p>Multiple, repeating alerts</p> <p>Single, repeating alert</p>

INSTALACIÓN DEL SENSOR

- La altura de montaje de los sensores debe ser de 0.45 m / 1.5 pies hasta 0.6 m / 2 pies.
- Para un desempeño óptimo, los sensores deben estar espaciados uniformemente a través de la parte trasera del vehículo con la menor curvatura posible.
- En la mayoría de los vehículos, esto puede ser un problema debido a placas de licencia u objetos detrás del parachoques, por lo que recomendamos lo siguiente:

SISTEMA DE 4 SENSORES:

- Encuentre la mitad del parachoques
- Encuentre la superficie plana más exterior donde pueda instalar 2 sensores
- Mida entre la ubicación más exterior para sensor hasta la mitad del parachoques.
- Divida eso por 2 y eso le dará su mejor punto de montaje para su sensor interno
- Si no puede usar esa ubicación, instale el sensor lo más cerca posible.

SISTEMA DE 2 SENSORES:

- Encuentre la mitad del parachoques
- Encuentre la superficie plana más exterior donde podría montar 2 sensores
- Mida entre la localidad más exterior hasta la mitad del parachoques.
- Divida eso por 2 para obtener el mejor punto de montaje para sus sensores.
- Si no puede usar esa ubicación, instale el sensor lo más cerca posible.
- Asegúrese de insertar los sensores solamente en los puertos A y D o B y C.

NOTA: Antes de perforar orificios, asegúrese de mirar detrás del parachoques en busca de objetos, arneses de cableado u otros elementos para evitar posibles daños.

UBICACIONES PARA EL MONTAJE DE SENSORES

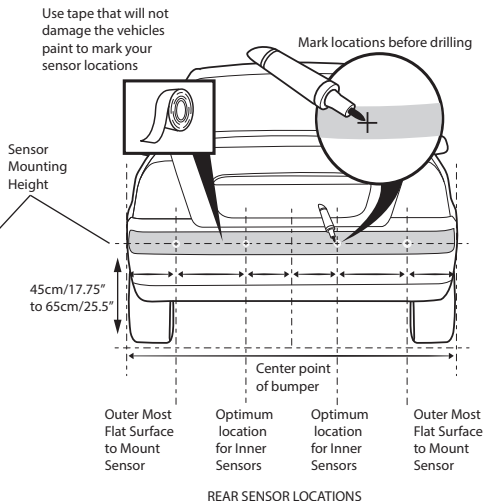
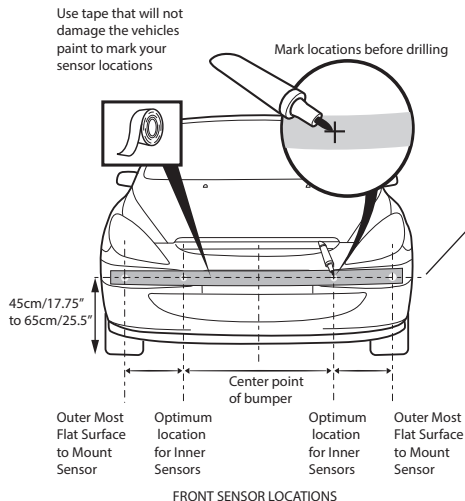

ANGULO DEL SENSOR

CHANGING THE SENSOR HEAD ANGLE

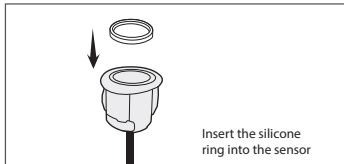
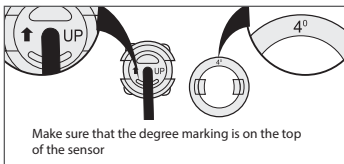
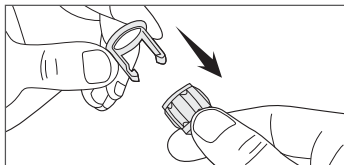
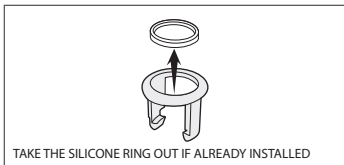
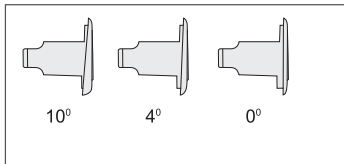
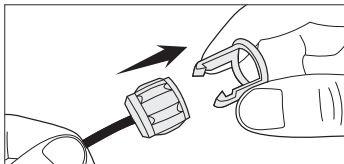
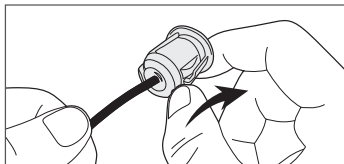
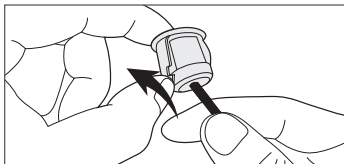

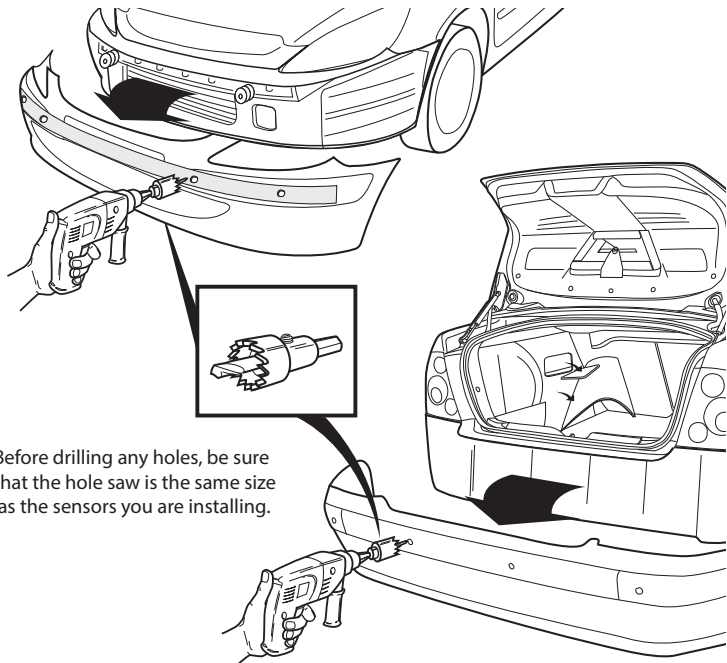

Before drilling any holes, be sure that the hole saw is the same size as the sensors you are installing.

Los sensores vienen montados en una bandeja de pintura con las juntas tóricas ("O" rings) de caucho no instaladas. Esto permitirá pintar para tener una fácil combinación de colores. Una vez que la pintura se haya secado, asegúrese de instalar las juntas tóricas de caucho ("O" rings) antes de instalar los sensores en el vehículo.

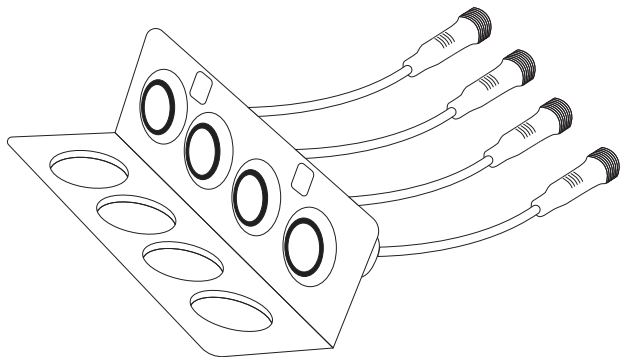

After painting the sensors, let them completely dry before installing the silicone ring.

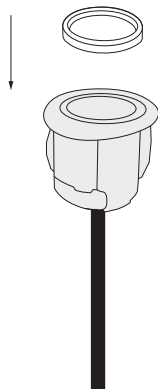

AJUSTES DEL ÁNGULO

If there is a gap found between the bumper and the sensor head when using the 10 degree angle head, adjust the angle of the hole as shown below.

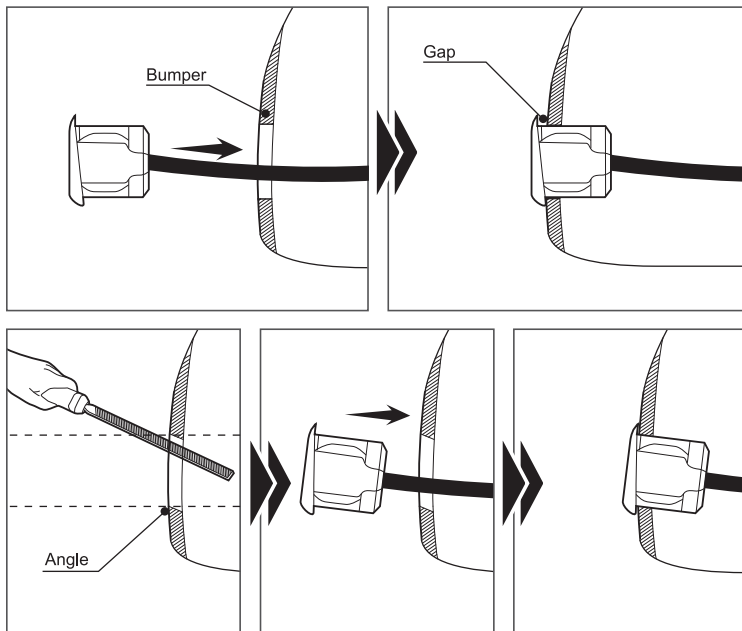

MOUNTING THE AUDIBLE ALERT

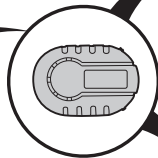
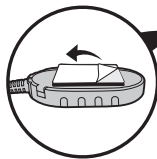

FRONT MOUNT

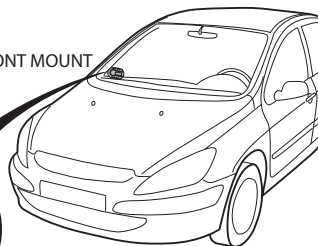

Recommended speaker placement

REAR MOUNT

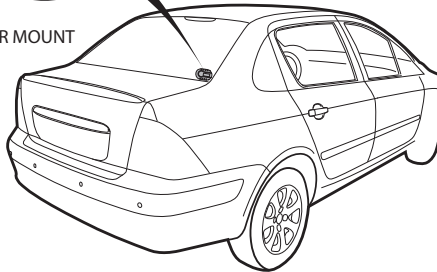

DISPLAY PLACEMENT (optional)

Both the PARK-PLD1 and PARK-PLD2 have multiple mounting options. Within these mounting options you will need to change the way the display reads. Below are the different mounting options.

E1 – Dash mount

E2 – Roof mount, front of vehicle

E3 – Roof mount, rear of vehicle. Can be viewed from the rear view mirror.

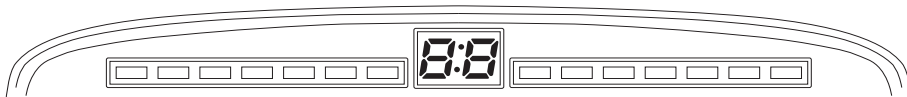

E1 installation mode:

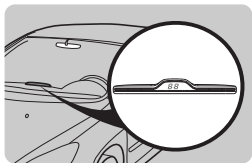

Dashboard mount

E2 installation mode:

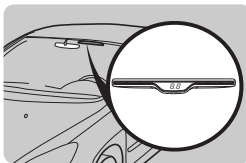

Roof mount, front of vehicle

E3 installation mode:

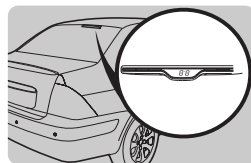

Roof mount, rear of vehicle.
Can be viewed from the
rear view mirror

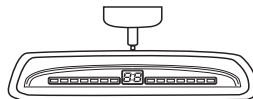

Display Placement Settings

- Turn the Ignition/Accessory ON and place the gear select in "R"
- Press and hold the SET button for 5 seconds until you hear an audible tone.
- Press and release the set button again to cycle through the available setting options.
- The SET button can be accessed through the small hole in top of the display.
- The system will automatically save and exit settings mode after 2 seconds of inactivity.

Default Setting: E1

Three Available Modes: E1, E2, E3

E1 - Dashmount

E2 - Roof Mount Front

E3 - Roof Mount Rear

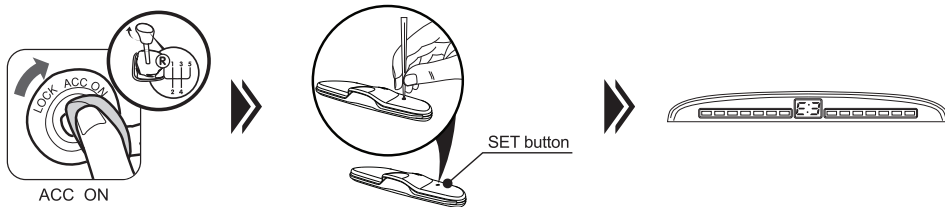

VOLUME ADJUSTMENT

- Turn the Ignition/Accessory ON and place the gear select in "R"
- Press and release the SET button to adjust the volume.
- The SET button can be accessed through the small hole in top of the display.
- The system will automatically save and exit adjustment after 2 seconds of inactivity.

Settings: Default is High

PARK-PLED1: High – 2, Medium – 1, Low – 0

PARK-PLED2: High – 3, Medium – 2, Low – 1

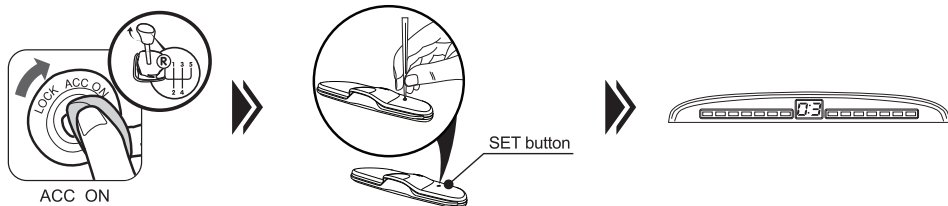

VOICE PROMPTS/ALERTS

The PARK-LED2 has the option of having voice prompts/alerts. This can be turn ON or OFF using the setting button.

- To turn this feature ON or OFF: Default setting is ON
- Turn the Ignition/Accessory ON and place the vehicle gear select into "R".
- Press the SET button for 2 seconds.
- Press the SET button to turn it ON or OFF

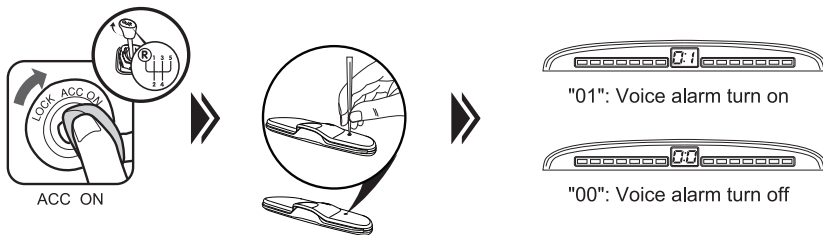

PRUEBA DEL SISTEMA

- To test the system, use a piece of wood (approx. .3mX1m/ 1'X3.3').
- With the board beyond the furthest trigger point, back up to the board.
- The system should trigger once in sensor range.

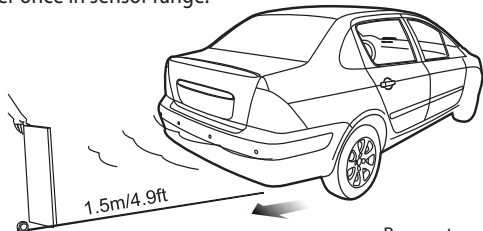

Rear system check

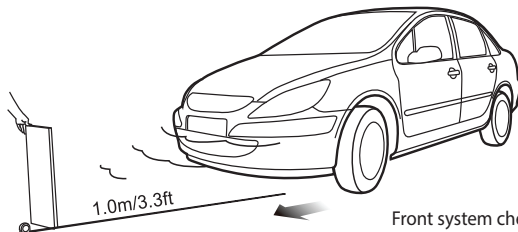

Front system check

- To test front sensors, repeat the test driving towards the board.

IDENTIFICACIÓN DE FALLAS

Después de la instalación no funciona la alerta sonora.

- A. ¿Están conectados correctamente todos los cables?
- B. ¿El encendido de los vehículos está en ON (encendido)?

Se detectó un sensor dañado.

- A. ¿Están todos los sensores conectados a la unidad de control principal de forma correcta y ajustada?
- B. ¿Hay un cable del sensor roto o dañado?
- C. ¿El sensor está cubierto por nieve o barro?
- D. ¿Está dañado el sensor?

Se obtiene una advertencia falsa.

- A. ¿Están todos los sensores conectados a la unidad de control principal de forma correcta y ajustada?
- B. ¿Alguno de los sensores detecta el suelo?

El sonido de la alarma de la pantalla es demasiado alto o bajo.

- A. Presione el botón SET para ajustar el volumen a un nivel adecuado

Se debe dirigir cualquier otra pregunta al apoyo técnico de CrimeStopper al 1-800-998-6880.

CRIMESTOPPER
SAFETY & SECURITY