

Stop Sale Campaign AB02 - Check seat belt end fittings

Vehicle Type: **911 Speedster (997) / 911 GT3 RS 4.0 (997)**

Model Year: **2011**

Concerns: Seat belt end fittings

Situation: **It is possible that seat belts in which the bore diameter in the belt end fitting is too small have been fitted in the affected vehicles.**

If the diameter of the seat belt end fitting bore is too small, the end fitting will not completely fit onto the fastening screw collar.

The seat belt end fitting is then pressed firmly against the body when the screw is tightened and does not rotate.

Action Required: Check that the belt end fitting is free to move.

Affected Vehicles: Only the vehicles assigned to the campaign (see also PIWIS Vehicle Information)

Part Nos.: No parts are required to check the seat belt end fittings.

If one or more seat belts have to be replaced, the part numbers and the color code of the seat belts needed are listed on the label of the seat belts.

Special Tools: Torque wrench Nr.90 Pos.5

Procedure:



Information

If the seat belt end fitting bore is the **correct** size, the end fitting can be ⇒ *Figure 1 -Pos. 1-completely pushed onto* the fastening screw collar ⇒ *Figure 1 -Pos. 2-* ⇒ *Figure 1 -links-*.

The seat belt end fitting can then **rotate freely** around the fastening screw collar to ensure the optimum seat belt position for every seating position.

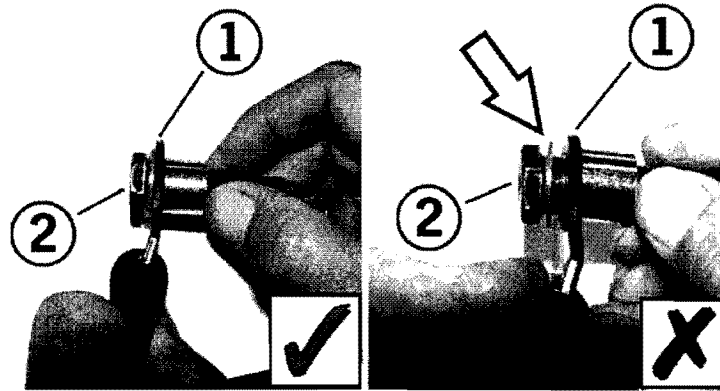

Figure 1

If the diameter of the seat belt end fitting bore is **too small**, the end fitting \Rightarrow Figure 1 -Pos. 1- **does not completely fit onto** the fastening screw collar \Rightarrow Figure 1 -Pos. 2- \Rightarrow Figure 1 -rechts, Pfeil-. The seat belt end fitting is then pressed firmly against the body when the screw is tightened and **does not rotate**.

- 1 Ensure accessibility to the seat belt end fitting fastening screw.
 - 1.1 Fold the seat backrest of the left front seat forward.
 - 1.2 Move the left front seat completely forward.

**Information**

The seat belt end fitting is affixed directly to the seat in vehicles equipped with sports bucket seats (I-No. 388/389).

- 2 Tighten the fastening screw on the front left seat belt end fitting \Rightarrow Figure 2 -Pos. 1- to the specified torque.
 - 2.1 Remove cap from fastening screw.
 - 2.2 Tighten the fastening screw on the seat belt end fitting \Rightarrow Figure 2 -Pos. 1- to the specified torque. **tightening torque 50 Nm**

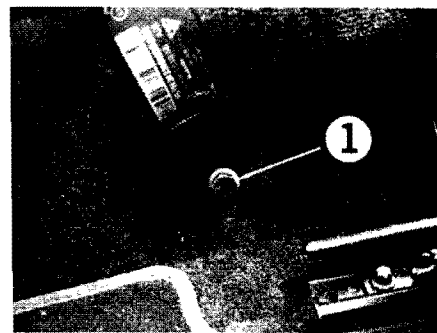

Figure 2

- 3 Check freedom of \Rightarrow Figure 3 -Pos. 1- movement of seat belt end fitting.
Twist the seat belt end fitting \Rightarrow Figure 3 -Pos. 1- to the left and right \Rightarrow Figure 3 -Pfeil-. The seat belt end fitting must be able to rotate freely around the fastening screw with a **minimum application of force**.

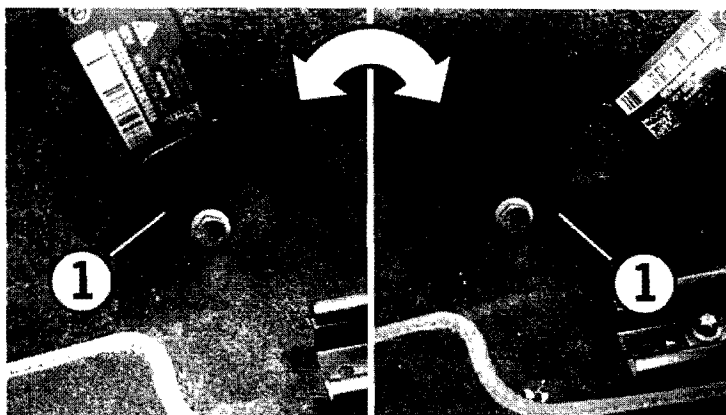

Figure 3

If the seat belt end fitting **does not** rotate, ⇒ **replace the seat belt** ⇒ *Workshop Manual '691119 Removing and reinstalling front three-point belts'*.

If the seat belt end fitting rotates without any great application of force, ⇒ **continue** with **Point 4** and check the next seat belt end fitting.

- 4 Perform steps 1 to 3 on the right seat belt end fitting.
- 5 Move both front seats back to their original positions and fold back the seat backrests.
- 6 Enter the campaign in the Warranty and Maintenance booklet.



Information

If one or more seat belts have to be replaced, the working time and spare parts needed are to be invoiced on a separate warranty claim.

- The additional warranty claim must be processed by specifying ⇒ damage code 6911 12 000, repair code 1.
- Document the work in the PQIS job by entering 6911 (front three-point belt) under "Location" and 1213 (Part replaced in accordance with PAG instructions) as the "Symptom".
- Specify that the seat belt(s) was replaced due to Action AB02 under "Further Information" for the PQIS job.

Scope:

Working time:		
Checking freedom of movement of front seat belt end fittings		Labor time: 20 TU
Includes: Tightening seat belt end fitting fastening screws to the specified torque		
Invoicing: ⇒ Damage Code AB02 99 000, Repair Code 1		

References: ⇒ *Workshop Manual '691119 Removing and reinstalling front three-point belts'*

Stop Sale Campaign AB02 - Check seat belt end fittings

Vehicle Type: **Boxster (987) / Boxster S (987) / Boxster Spyder (987)
Cayman (987) / Cayman S (987) / Cayman R (987)**

Model Year: **2012**

Concerns: Seat belt end fittings

Situation: **It is possible that seat belts in which the bore diameter in the seat belt end fitting is too small have been fitted in the affected vehicles.**

If the diameter of the seat belt end fitting bore is too small, the end fitting will not completely fit onto the fastening screw collar.
The seat belt end fitting is then pressed firmly against the body when the screw is tightened and does not rotate.

Action Required: Check that the seat belt end fitting is free to move.

Affected Vehicles: Only the vehicles assigned to the campaign (see also PIWIS Vehicle Information)

Part Nos.: No parts are required to check the seat belt end fittings.
If one or more seat belts have to be replaced, the part numbers and the color code of the seat belts needed are listed on the label of the seat belt.

Special Tools: Torque wrench Nr.90 Pos.5

Procedure:



Information

If the seat belt end fitting bore is the **correct** size, the end fitting can be ⇒ *Figure 1 -Pos. 1-***completely pushed onto** the fastening screw collar ⇒ *Figure 1 -Pos. 2-* ⇒ *Figure 1 -links-*.
The seat belt end fitting can then **rotate freely** around the fastening screw collar to ensure the optimum seat belt position for every seating position.

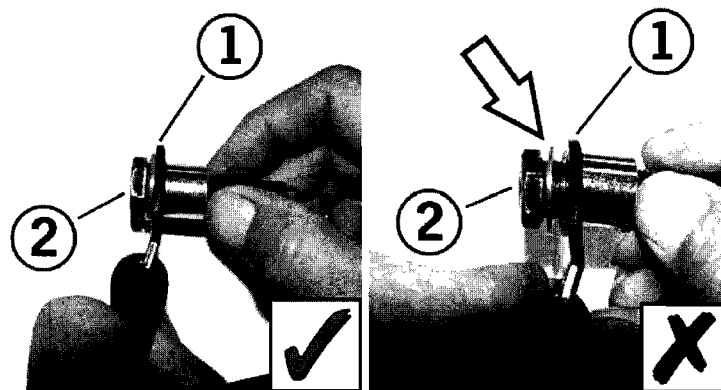

Figure 1

If the diameter of the seat belt end fitting bore is **too small**, the end fitting \Rightarrow Figure 1 -Pos. 1- **does not completely fit onto** the fastening screw collar \Rightarrow Figure 1 -Pos. 2- \Rightarrow Figure 1 -rechts, Pfeil-. The seat belt end fitting is then pressed firmly against the body when the screw is tightened and **does not rotate**.

- 1 Ensure accessibility to the seat belt end fitting fastening screw.
 - 1.1 Fold the seat backrest of the left front seat forward.
 - 1.2 Move the left front seat completely forward.

**Information**

The seat belt end fitting is affixed directly to the seat in vehicles equipped with sports bucket seats (I-No. 388/389).

- 2 Tighten the fastening screw on the front left seat belt end fitting \Rightarrow Figure 2 -Pos. 1- to the specified torque.
 - 2.1 Remove cap from fastening screw.
 - 2.2 Tighten the fastening screw on the seat belt end fitting \Rightarrow Figure 2 -Pos. 1- to the specified torque. **tightening torque 50 Nm**

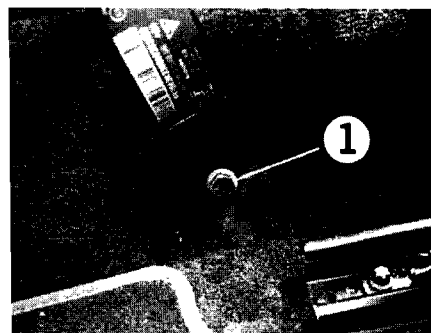

Figure 2

- 3 Check freedom of \Rightarrow Figure 3 -Pos. 1- movement of seat belt end fitting. Twist the seat belt end fitting \Rightarrow Figure 3 -Pos. 1- to the left and right \Rightarrow Figure 3 -Pfeil-. The seat belt end fitting must be able to rotate freely around the fastening screw with a **minimum application of force**.

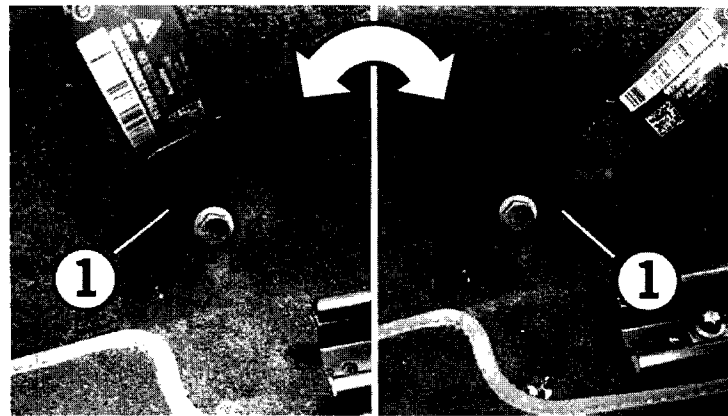

Figure 3

If the seat belt end fitting **does not** rotate, ⇒ replace **the seat belt** ⇒ *Workshop Manual '691119 Removing and reinstalling front three-point seat belts'*.

If the seat belt end fitting rotates without any great application of force, ⇒ **continue** with **Point 4** and check the next seat belt end fitting.

- 4 Perform steps 1 to 3 on the right seat belt end fitting.
- 5 Move both front seats back to their original positions and fold back the seat backrests.
- 6 Enter the campaign in the Warranty and Maintenance booklet.



Information

If one or more seat belts have to be replaced, the working time and spare parts needed are to be invoiced on a separate warranty claim.

- The additional warranty claim must be processed by specifying ⇒ damage code 6911 12 000, repair code 1.
- Document the work in the PQIS job by entering 6911 (front three-point belt) under "Location" and 1213 (Part replaced in accordance with PAG instructions) as the "Symptom".
- Specify that the seat belt(s) was replaced due to Action AB02 under "Further Information" for the PQIS job.

Scope:

Working time:		
Checking freedom of movement of front seat belt end fittings		Labor time: 20 TU
Includes: Tightening seat belt end fitting fastening screws to the specified torque		
Invoicing: ⇒ Damage Code AB02 99 000, Repair Code 1		

References: ⇒ *Workshop Manual '691119 Removing and reinstalling front three-point belts'*

Stop Sale Campaign AB02 - Check seat belt end fittings

Vehicle Type: **911 Carrera (997) / 911 Carrera S (997) / 911 Carrera GTS (997)
911 Carrera 4 (997) / 911 Carrera 4S (997) / 911 Carrera 4 GTS (997)
911 Targa 4 (997) / 911 Targa 4S (997)
911 Turbo (997) / 911 Turbo S (997)**

Model Year: **2012**

Concerns: Seat belt end fittings

Situation: **It is possible that seat belts in which the bore diameter in the seat belt end fitting is too small have been fitted in the affected vehicles.**

If the diameter of the seat belt end fitting bore is too small, the end fitting will not completely fit onto the fastening screw collar.
The seat belt end fitting is then pressed firmly against the body when the screw is tightened and does not rotate.

Action Required: Check that the seat belt end fitting is free to move.

Affected Vehicles: Only the vehicles assigned to the campaign (see also PIWIS Vehicle Information)

Part Nos.: No parts are required to check the seat belt end fittings.
If one or more seat belts have to be replaced, the part numbers and the color code of the seat belts needed are listed on the label of the seat belts.

Special Tools: Torque wrench Nr.90 Pos.5

Procedure:



Information

If the seat belt end fitting bore is the **correct** size, the end fitting can be ⇒ *Figure 1 -Pos. 1-completely pushed onto* the fastening screw collar ⇒ *Figure 1 -Pos. 2-*. ⇒ *Figure 1 -links-*.
The seat belt end fitting can then **rotate freely** around the fastening screw collar to ensure the optimum seat belt position for every seating position.

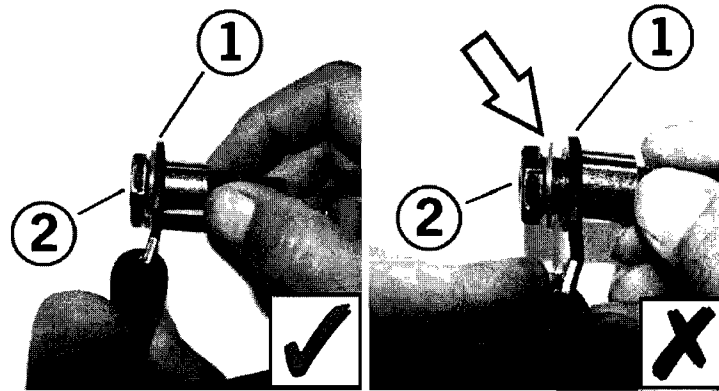

Figure 1

If the diameter of the seat belt end fitting bore is **too small**, the end fitting \Rightarrow Figure 1 -Pos. 1- **does not completely fit onto** the fastening screw collar \Rightarrow Figure 1 -Pos. 2- \Rightarrow Figure 1 -rechts, Pfeil-. The seat belt end fitting is then pressed firmly against the body when the screw is tightened and **does not rotate**.

- 1 Ensure accessibility to the seat belt end fitting fastening screw.
 - 1.1 Fold the seat backrest of the left front seat forward.
 - 1.2 Move the left front seat completely forward.

**Information**

The seat belt end fitting is affixed directly to the seat in vehicles equipped with sports bucket seats (I-No. 388/389).

- 2 Tighten the fastening screw on the front left seat belt end fitting \Rightarrow Figure 2 -Pos. 1- to the specified torque.
 - 2.1 Remove cap from fastening screw.
 - 2.2 Tighten the fastening screw on the seat belt end fitting \Rightarrow Figure 2 -Pos. 1- to the specified torque. **tightening torque 50 Nm**

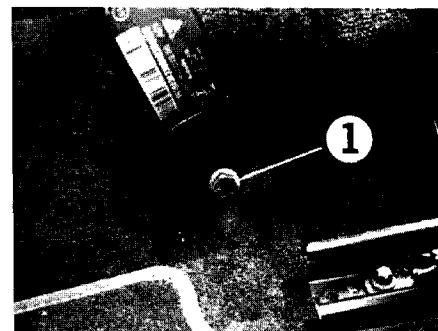

Figure 2

- 3 Check freedom of \Rightarrow Figure 3 -Pos. 1- movement of seat belt end fitting. Twist the seat belt end fitting \Rightarrow Figure 3 -Pos. 1- to the left and right \Rightarrow Figure 3 -Pfeil-. The seat belt end fitting must be able to rotate freely around the fastening screw with a **minimum application of force**.

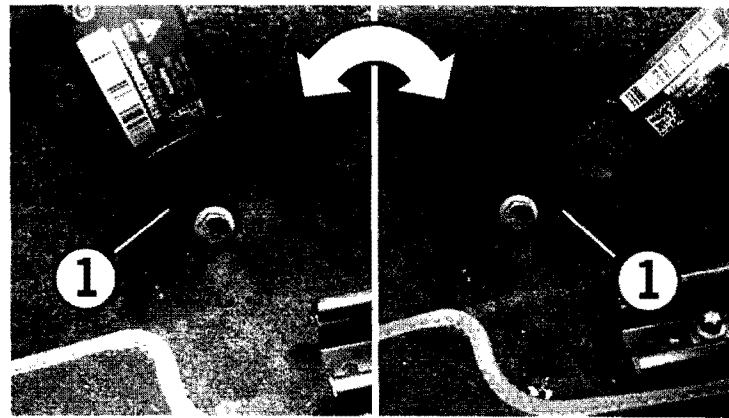

Figure 3

If the seat belt end fitting **does not** rotate, ⇒ replace **the seat belt** ⇒ *Workshop Manual '691119 Removing and reinstalling front three-point belts'*.

If the seat belt end fitting rotates without any great application of force, ⇒ **continue** with **Point 4** and check the next seat belt end fitting.

- 4 Perform steps 1 to 3 on the right front seat belt end fitting.
- 5 Check that both end fittings for the **rear** seat belts move freely.
 - 5.1 Remove both rear seat cushions ⇒ *Workshop Manual '745719 Removing and reinstalling rear seat cushions'*.
 - 5.2 Perform steps 2 and 3 on the **left** rear seat belt end fitting.
 - 5.3 Perform steps 2 and 3 on the **right** rear seat belt end fitting.
 - 5.4 Install both rear seat cushions ⇒ *Workshop Manual '745719 Removing and reinstalling rear seat cushions'*.
- 6 Move both front seats back to their original positions and fold back the seat backrests.
- 7 Enter the campaign in the Warranty and Maintenance booklet.



Information

If one or more seat belts have to be replaced, the working time and spare parts needed are to be invoiced on a separate warranty claim.

- Additional warranty claims are invoiced under ⇒ damage code 6911 12 000, repair code 1 (**front** three-point belt) or under ⇒ damage code 6912 12 000, repair code 1 (**rear** three-point belt).
- Document the work in the PQIS job by entering 6911 (front three-point belt) under "Location" and 1213 (part replaced in accordance with PAG instructions) as the "Symptom" or by entering 6912 (rear three-point belt) under "Location" and 1213 (part replaced in accordance with PAG instructions) as the "Symptom".

- Specify that the seat belt(s) was replaced due to Action AB02 under "Further Information" for the PQIS job.

Scope:

Working time:

Checking freedom of movement of both front and rear seat belt end fittings

Labor time: **20 TU**

Includes: Tightening seat belt end fitting fastening screws to the specified torque
Removing and reinstalling both rear seat cushions

Invoicing: ⇒ **Damage Code AB02 99 000, Repair Code 1**

References:

- ⇒ *Workshop Manual '691119 Removing and reinstalling front three-point belts'*
- ⇒ *Workshop Manual '745719 Removing and reinstalling rear seat cushions'*