

RECEPTION



# PAD/HALL 9

CORSO ITALIA OVEST



VIA AMERICA

VIALE LOMBARDIA SUD

COMPANY	STAND
A.I.F.M. - GALVANOTECNICA	B09
AEROEL S.R.L.	D53
AGIE CHARMILLES	D149
AGLATECH 14 SPA	A07
AKIRA-SEIKI	D173
AL.MA S.R.L.	B35
ALCHEM	B139
AMADA MACHINE TOOLS EUROPE	B96 D101
AMADA MACHINE TOOLS EUROPE GMBH	B52
AMCOL	B128
ANAFGROUP - ANAF FIRE PROTECTION S.P.A.	B00
ANNN YANG	C91
AROSIO F.LLI SRL	B07
ARS	D05
ATA TOOLS - SGS . SGSPRO	B47
ATIUR	A62
ATOMAT S.P.A.	A14
AUTOMATOR INTERNATIONAL S.R.L.	D17
AUTOMATOR SUISSE SAGL	D15
AWEA	B96 D101
AXILE BY BUFFALO MACHINERY	D173
AZOLGAS	C05
BAGGIOGROUP S.R.L.	C07
BARUFFALDI S.P.A.	C34
BASQUE MACHINE-TOOL SUPPLY CHAIN - CAMARA DE GIPUZKOA	C09
BATTAGLINO RETTIFICHE S.R.L.	A31
BAUBLYS	A62
BEHRINGER	B132
BEIJING HBS SCIENCE & TECHNOLOGY CO. LTD.	B145
BENTIVOGLIO MACCHINE UTENSILI S.R.L.	A142
BERMA MACCHINE S.R.L.	A29
BIANCO S.R.L.	C112
BLULINK	D59
BODOR	A126
BOSS	A62
BROTHER	A66 B67
CARIF SAWING MACHINES S.R.L.	A122
CAUCCHIOLI DINO CONTENITORI METALLICI	A06
CEA	B119
CEIPIEMONTE S.C.P.A.	B125
CELORIA DARIO S.R.L.	B100
CHEVALIER	B67
COMEV S.P.A.	A50
CONSTRUCTOR FINLAND OY	B121
CORREA	B96 D101
CUCCHI GIOVANNI & C. S.R.L.	C10
CUOGHI AFFILATRICI S.R.L.	C47
DANOBAT	B128
DOOSAN	B96 D101
DORFNER	A62

**COMPANY**
**STAND**

DREHMAG S.R.L.	A98
DRILLING CO. SRL	B02
DT TECHNOLOGIES CZ S.R.O.	C213
DVS GROUP	A62
ECOLE SOC. CONSORTILE A.R.L.	C02
ENCODING S.R.L.	A43
ERNST GROB	A62
ERRE BI MACCHINE S.R.L.	C91
ERRIC	A98
EUROFORNITURE S.R.L.	C197
EVERISING MACHINE	B128
EVIRT ITALIA S.R.L.	C144
EXERON	B96 D101
F.F. ITALIA SRL	A02
FAMA S.R.L.	C215
FAMAR S.R.L.	C23
FANUC GLOBAL	B47
FAUSTO MARINELLO S.R.L.	B10
FMB S.R.L.	A130
FORTE	B132
G.F. DI GERBAUDO DAVIDE & C. S.A.S.	C201
GAP LASER SYSTEMS S.R.L.	A146
GEMINIS	C29
GENTIGER	B34 C53
GF MACHINING SOLUTIONS S.P.A.	D149
GFB S.R.L.	C25
GIANA	A14
GINO OLIVARES S.R.L.	A08
GIUSEPPE GIANA S.R.L.	D71
GORATU ITALIA S.R.L.	C29
GRAVOTECH ITALIA S.R.L.	B131
GROB	A62
GURUTZPE TURNING SOLUTIONS S.L.	C06
HAAS	A62
HEMBRUG	C132 D197
HONOR SEIKI	D173
HURCO	A30 B31
HURCO S.R.L.	A30 B31
HWACHEON	D215
IBARMIA INNOVATEK	D173
IMET S.P.A.	B119
INCIPIT SRL	C03
INDASS - INDUSTRIE ASSOCIATE S.R.L.	B146 C217
INDEX-WERKE	C132 D197
INGENIA AUTOMATION	B47
INTERNATIONAL MACCHINE UTENSILI S.P.A.	A66 B67
INTERTECH MACCHINE S.R.L.	B67
ITALIFT S.R.L.	B121
JVONNE S.R.L.	B13
KAO MING	D173

COMPANY	STAND
KITAKO SHIMADA	B96 D101
KIWA	B96 D101
KOSMEK	B47
KRS	B132
KTI	A62
LAGUN	C29
LASER WORKS ITALIA - LWI S.R.L.	A126
LASIT S.P.A.	B123
LCM PRECISION TECHNOLOGY S.R.L.	A27
LEHMANN	A94 B95
LIECHTI ENGINEERING	D149
LNS	B112
LNS ITALIA S.R.L. CON SOCIO UNICO	B112
M.C.M. MADAR S.R.L.	A18
MADAULA	A94 B95
MANIVAL S.R.L.	D215
MARIC S.A.S. DI ROSSATO L. E C.	C05
MARPOSS S.P.A.	D59
MASPERO F.LLI S.R.L.	A05
MATRIX	A62
MATSUURA	A66 B67
MAXDER GROUP S.R.L.	A00
MCM - MACHINING CENTERS MANUFACTURING S.P.A.	C18
MICROLUTION	D149
MICRONFILTER S.R.L.	A42
MIKRON	D149
MITSUBISHI ELECTRIC ERODING SYSTEMS	B96 D101
MITSUI SEIKI KOGYO	D173
MKT GROUP S.R.L.	A09
MORARI GIUSEPPE E MARILENA S.N.C.	A134
MT S.R.L.	B111
MULTI-MATIC S.R.L.	A94 B95
MURATA	D05
MYLAS	B35
NACHI	B47
NAKAMURA	A66 B67
NAKANISHI - NSK	B47
NEXT TURN - GRUPPO FFG	B35
NIIGATA	B96 D101
NIKKEN	B47
NOMURA	B144
NTK	B47
NUOVA PTM MECCANICA S.R.L.	A10
O.M.P. RETTIFICA S.R.L.	A11
OCEAN	B96 D101
OFFICINE BERETTA S.R.L.	A128
OFFICINE E. BIGLIA & C. S.P.A.	D47
OK ITALY SRL	A04
OKAMOTO	B96 D101
OKK	D173

COMPANY	STAND
OMAP TOOLS	C25
OMG ZANOLETTI S.R.L.	B30
OVERMACH S.P.A.	B96 D101
PENTAMAC S.R.L.	B19
PERREL	B128
PFIFFNER - GRUPPO FFG	B35
PIETRO CARNAGHI S.P.A.	B51
PISANELLO LUIGI & C. S.N.C.	B34 C53
PMP S.R.L.	A35
POLO MESAP - SMART PRODUCTS AND MANUFACTURING - CENTRO SERVIZI INDUSTRIE S.	C01
PROBEST SERVICE	C02
PSET DI LAVELLI FABIO	B01
PULIMETAL CITTADINI S.R.L.	B139
QUASER	D173
REM INDUSTRIE S.R.L.	D49
RENISHAW	C46
RENISHAW S.P.A.	C46
RGPBALLS SRL	B05
RIBONI SEGATRICI S.R.L.	B132
RMU MARKING - REGGIANA MACCHINE UTENSILI S.R.L.	A34
ROBERT ROENTGEN GMBH & CO. KG	C165
ROBOJOB	B96 D101
ROENTGEN ITALIA	C165
RÖHM	B116
RÖHM ITALIA S.R.L.	B116
ROSSI MACCHINE UTENSILI S.P.A.	D05
ROTOMORS S.P.A.	B18
S.T.A. S.R.L.	A01
SA.VI S.R.L.	C73
SASSATELLI S.N.C.	A19
SCC S.R.L.	A13
SE.RI. S.R.L.	B144
SIC	C169
SIC MARKING ITALIA S.R.L.	C169
SIMU S.R.L.	A62
SLM	B96 D101
SMZ ITALIA S.R.L.	A23
SOCEA S.R.L.	A03
STEP-TEC	D149
STHEMMA S.R.L. - THOMAS SEGATRICI	A138
STRATASYS	B96 D101
STREPARAVA SPA	C11
SYCOTEC	A62
SYNERGON S.P.A.	C132 D197
SYSTEM 3R	D149
T.A.M.A. AERNOVA S.P.A.	C187
TACCHI GIACOMO E FIGLI S.P.A.	B46 C71
TAITRA - TIMTOS - TAIWAN EXTERNAL TRADE DEVELOPMENT COUNCIL	B133
TAIWAN TAKISAWA TECHNOLOGY	D173
TAKISAWA	D173

COMPANY	STAND
TEAMSYSTEM	B144
TECNOLOGIE FRB S.R.L.	B63
TECNOR MACCHINE S.P.A.	D173
TECNOROBOT	B119
TELESIS TECHNOLOGIES	A43
TG BI-MU	A25
TIBO	A62
TIGER-VAC EUROPA S.R.L.	A41
TONG-TAI	D173
TOP AUTOMAZIONI S.R.L.	B99
TORGIM S.N.C. DI PAOLO GIANA & C.	A17
TORNOS	B11
TORNOS TECHNOLOGIES ITALIA S.R.L.	B11
TOSHULIN	C91
TRAUB	C132 D197
TRIAG	B47
TSUGAMI	A66 B67
TSUNE	B132
UGINT	D05
UNILOCKS S.A.S.	A37
UTENSILI FRATELLI MAGONI S.P.A.	B128
VEGA INTERNATIONAL TOOLS S.R.L.	B47
VOESTALPINE CAMTEC	C05
WIKUS-SÄGENFABRIK WILHELM H. KULLMANN GMBH & CO. KG	A114
XIONEER SYSTEMS GMBH	A136
YAMAZAKI MAZAK	D77
YAMAZAKI MAZAK ITALIA S.R.L.	D77
YCM	B34 C53
ZA-BER SRL	B03
ZPS	A142

# PAD/HALL 11

CORSO ITALIA OVEST

RECEPTION

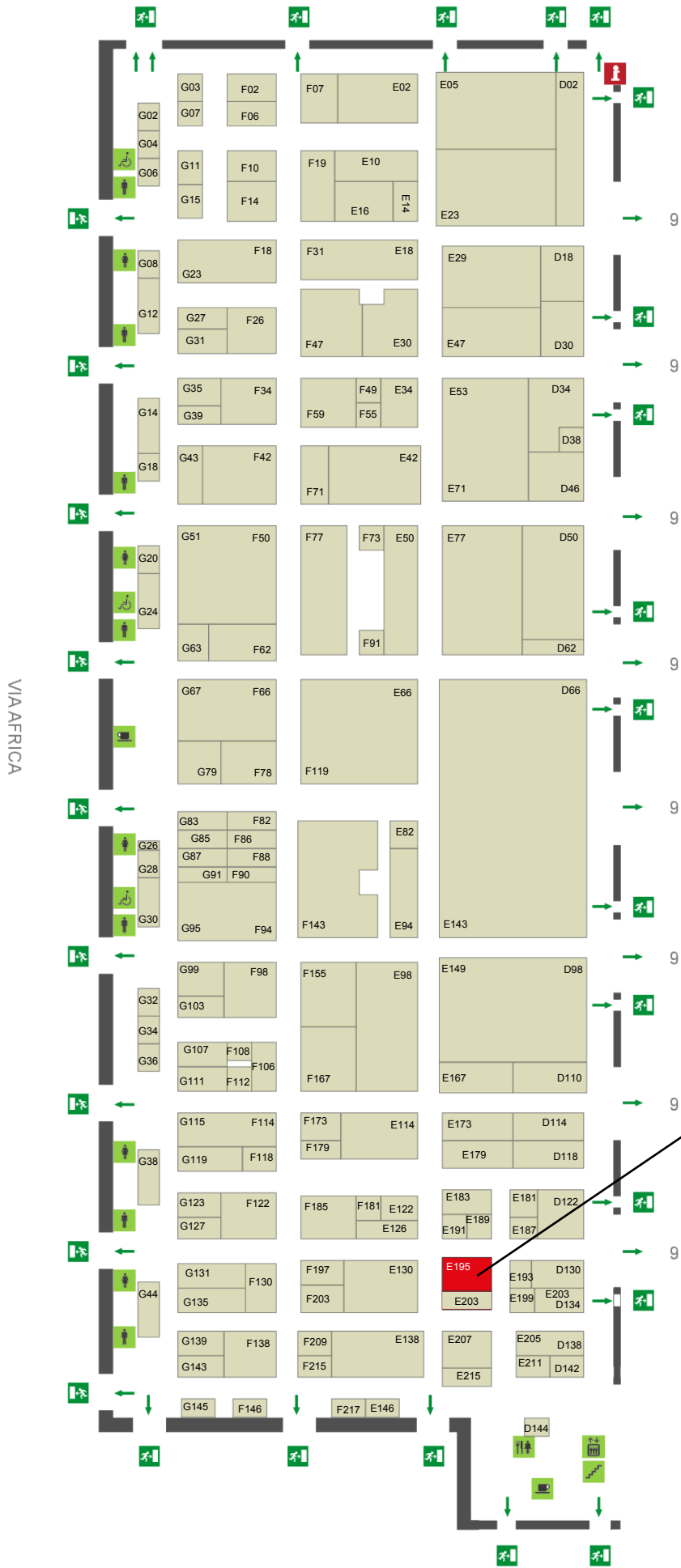

VIALE LOMBARDIA SUD

COMPANY	STAND
3DZ TREVISO S.R.L.	E193
3NTR - JDEAL-FORM S.R.L.	E181
ACCUT MACHINERY	F07
ADDITIVE INDUSTRIES	E203
AERATION & MIXING LTD	F91
AITA - ASS. ITALIANA TECNOLOGIE ADDITIVE / BI-MUPIÙ	E195
ALEX-TECH	E47
ALGRA S.P.A.	E10
AMADA MACHINE TOOLS EUROPE	D66 E143
AR FILTRAZIONI S.R.L.	E167
ARES SEIKI	D110
ARTEDAS ITALIA S.R.L.	E215
ATC EUROPE PRESSO CFT RIZZARDI S.R.L.	E82
AUTOBLOK S.P.A.	D114
AXA	E98
BALANCE SYSTEMS	F197
BENTIVOGLIO MACCHINE UTENSILI S.R.L.	G131
BENZINGER	F66 G67
BEST FINISHING S.R.L.	G04
BISON CHUCKS	G123
BISON ITALIA S.R.L.	G123
BLOHM JUNG GMBH	F90
BORER CHEMIE	F55
BUFFOLI TRANSFER S.P.A.	G63
BUMOTEC	G79
BV S.R.L.	F10
C.N.S. TRADING S.R.L.	E47
C.R. TECHNOLOGY S.R.L.	F98
CAMWORKS	G99
CAR S.R.L.	F106
CASTAGNA ANTINCENDI S.R.L.	G36
CB SERVICE S.R.L.	G32
CB SERVICETECH	G32
CEIA S.P.A. - GENERATORI AD INDUZIONE	F14
CELLE S.R.L.	F78
CIMSYSTEM S.R.L.	G99
CITIZEN MACCHINE ITALIA S.R.L.	E77
CITIZEN MACHINERY	E77
CMZ ITALIA S.R.L.	E53 E71
CMZ MACHINE TOOL MANUFACTURER	E53 E71
CODERE	G11
CSF S.R.L.	E138
CUCCHI BLT SRL	F47
D.F. EDIZIONI S.R.L.	F209
DAH LIH	F50 G51
DANOBAT	E29
DANOBAT S.R.L.	E29
DELMET S.R.L.	F06
DELTA S.R.L.	F62
DESKTOP METAL	E211



COMPANY	STAND
DETA INTERNATIONAL	E82
DETRON	E47
DMG MORI ITALIA S.R.L.	D02
DU-PUY S.R.L.	F118
EDWARD PRYOR & SON	F26
ELLEGELLE MACHINERY S.R.L.	G31
EMAG	E50
EMAG MILANO S.R.L.	E50
EMCO GMBH	E66 F119
ENERGY GROUP S.R.L.	E211
ENI S.P.A. REFINING & MARKETING	G139
EROWA	F155
EROWA TECNOLOGIE S.R.L.	F155
EUROPOLISH S.R.L.	G20
EWAG AG	F86
EXCETEK	F98
F.LLI GAIANI S.N.C.	E98
FABBRICA ITALIANA MACCHINE ATTREZZAMENTI TORINO - FIMAT S.R.L.	E30
FAT HACO	G131
FAVRETTO S.R.L.	D62
FEHLMANN	G79
FENIX S.R.L.	F181
FORMLABS	E211
FRITZ STUDER AG	F82
FUCHS LUBRIFICANTI	D02
GARZANTI SPECIALTIES S.P.A.	F55
GHIDINI MACHINES - GHIDINI FELICE ITALO & C. S.R.L.	F18 G23
GILDEMEISTER ITALIANA S.P.A.	E23
GIMA TECHNOLOGY S.R.L.	F185
GIMAX 3D S.N.C.	E187
GIULIANI, A BUCCI AUTOMATIONS S.P.A. DIVISION	E16
GMV MACCHINE UTENSILI S.R.L.	D110
GRAZIANO TORTONA S.R.L.	E05
HAAS	D66 E143
HALTER CNC AUTOMATION BV	G111
HANKOOK	F50 G51
HARDINGE	F66 G67
HECKERT	F50 G51
HILZINGER-THUM	G20
HP INC.	D134
HP ITALY S.R.L.	D134
HTS - H.T. SOLUTIONS S.R.L.	G11
HYUNDAI WIA	F50 G51
IEMCA, A BUCCI AUTOMATIONS S.P.A. DIVISION	E14
INDUSTRIAL SOLUTIONS RESEARCH I.S.R. S.R.L.	F02
INTELLIGENTIA S.R.L.	F197
INTERPROGETTI EDITORI S.R.L.	F146
IRPD AG	G91
IVET S.R.L.	G08
KADIA PRODUKTION GMBH + CO.	G43

COMPANY	STAND
KAWATATEC	E179
KENT	E47
KITAGAWA IRON WORKS	F185
KITAMURA	D110
LA PROTEC S.R.L.	F130
LAMPUGNANI SABBIATRICI S.R.L.	G02
LASEREVO S.R.L.	G127
LEAVE INDUSTRIAL	F185
L'INDUSTRIALE S.R.L.	F215
LINEA TECNICA S.R.L.	G38
LIZZINI WALLRAM GRINDTEC S.R.L.	F42
LOSMA S.P.A.	D46
LPW SOUTH EUROPE S.R.L.	E199
LPW TECHNOLOGY	E199
MACC COSTRUZIONI MECCANICHE S.R.L.	F167
MACHINERY AND GLOBAL SERVICE S.R.L.	F94 G95
MÄDER	E126
MÄGERLE AG	F88
MANDELLI SISTEMI S.P.A.	D18
MAR S.R.L.	D38
MARIO PINTO S.P.A.	D118
MARKATOR	G127
MARKFORGED	E193
MARKFORGED	E215
MASCHINEN WAGNER WERKZEUGMASCHINEN GMBH	E34
MAXLUBE S.R.L.	F112
MEBER S.R.L.	E122
MECCANO S.R.L.	F143
MECSYSTEM S.R.L.	F179
MEG S.R.L.	G18
MEP S.P.A.	E130
MICROCUT	F50 G51
MORETTI S.R.L.	G30
NABERTHERM GMBH	G07
NEWAY CNC EQUIPMENT (SUZHOU) CO., LTD.	F138
NICEM S.P.A.	G39
NIKUNI CO	F91
NITTY-GRITTY S.R.L.	G27
NOA3D - NEW OFFICE AUTOMATION S.R.L.	E191
NORBLAST S.R.L.	G12
NUOVAMACUT AUTOMAZIONE	G99
O.M.L. - OFFICINA MECCANICA LOMBARDA S.R.L.	E179
OCMUU S.P.A.	G119
OKUMA	D66 E143
ONA ELECTROEROSION	E02
ONA ELETTRROEROSIONE S.R.L.	E02
OPEN TECHNOLOGIES	G99
OTEC PRÄZISIONSFINISH GMBH	F173
OTTO SUHNER	E94
PADA S.R.L.	G14

COMPANY	STAND
PALMARY MACHINERY	D110
PEAR S.R.L.	G103
POLAT MAKINA SAN VE TIC.A.S.	G107
PORTA SOLUTIONS S.P.A.	F19
PRECITRAME	F66 G67
PRIME SERVICE S.R.L.	D144
PROTEO	F50 G51
PRYMARK S.R.L.	F26
PUBLITARGET S.A.S.	E146
QUALICHEM	F112
QUICKWOOD ESPERIA S.R.L.	F49
R.F. CELADA S.P.A.	D66 E143
REMA CONTROL S.R.L.	D98 E149
RETTIFICATRICI GHIRINGHELLI S.P.A.	D34
RICERCA CHIMICA DI MARANELLI G. & C. S.N.C.	F34
RIELLO SISTEMI S.P.A.	D30
RIMEX S.R.L.	F71
ROLLOMATIC S.A.	F122
ROLLWASCH ITALIANA S.P.A.	G28
ROMI	E114
ROMI ITALIA S.R.L.	E114
ROSA ERMANDO S.P.A.	D50
SAET S.P.A.	G03
SAMCHULLY WORKHOLDING INC.	F26
SAMSUNG	D110
SANDVIK ITALIA DIV. COROMANT	D02
SCAME FORNI INDUSTRIALI S.P.A.	G15
SCANNER 3D	E215
SCHAUDT MIKROSA GMBH	G85
SCHNEEBERGER J. MASCHINEN AG	F59
SEIT ELETTRONICA	G24
SHAREBOT S.R.L.	E189
SIBIMEX ITALIANA S.R.L.	F07
SIMU S.R.L.	E203
SISMA S.P.A.	D130
SMW-AUTOBLOK	D114
SNAP ROBOTICS	E47
SODICK	D66 E143
SOITAAB IMPIANTI S.R.L.	F114 G115
SOLIDWORKS	E215
SOLIDWORKS	D138 E205
SOLIDWORLD S.R.L.	D138 E205
SOMAUT S.R.L.	E126
SPINDELDOCTOR EGIN-HEINISCH	G32
SPINNER WERKZEUGMASCHINENFABRIK GMBH	E18 F31
STAMP'IT	E126
STAR	D66 E143
STRATASYS	E211
STRATASYS	D142
SUHNER SU-MATIC S.R.L. UNIPERSONALE	E94

COMPANY	STAND
SU-MATIC ITALIA	E94
SUNNEN	F66 G67
SUNNEN ITALIA S.R.L.	F66 G67
SUPFINA	F66 G67
SWISS-MACHINING	F217
TACHELLA	G119
TAKAMAZ	D110
TECHNIMOLD S.R.L.	D142
TECHNOMARK	E126
TECNOMAGNETE S.P.A.	G44
TELIND S.N.C.	G34
TEOMA S.R.L.	E173
TG BI-MU	G26
TIPS S.R.L.	F108
TORINO MACCHINE S.R.L.	G135
TOTAL ITALIA S.P.A.	F203
TOYODA	F94 G95
TREBI S.R.L. UNIPERSONALE	G143
TRENNJAEGER	E34
TRUMPF	D122
TRUMPF S.R.L. A SOCIO UNICO	D122
TRZ - REVISMAC S.R.L.	F73
TSUDAKOMA	E173
TURBOTECNICA S.P.A.	G06
ULTIMAKER	E207
UNITED GRINDING GMBH	G87
VEMAS S.R.L.	G79
VIBROCHIMICA S.R.L.	G35
VICTOR	E42
VIMACCHINE S.R.L.	F50 G51
VIMAK S.R.L.	E42
WALTER MASCHINENBAU GMBH	G83
WARRANT INNOVATION LAB S.C.A.R.L.	G145
WEIDA	G135
WELE	D110
WFL MILLTURN TECHNOLOGIES GMBH & CO. KG	F77
WTO	F26
XYZ PRINTING	E191
YANYANG	F98
YASDA	D66 E143
ZARE S.R.L.	E183
ZMM BULGARIA	F71
ZMM BULGARIA	F07

RECEPTION



# PAD/HALL 13

CORSO ITALIA OVEST

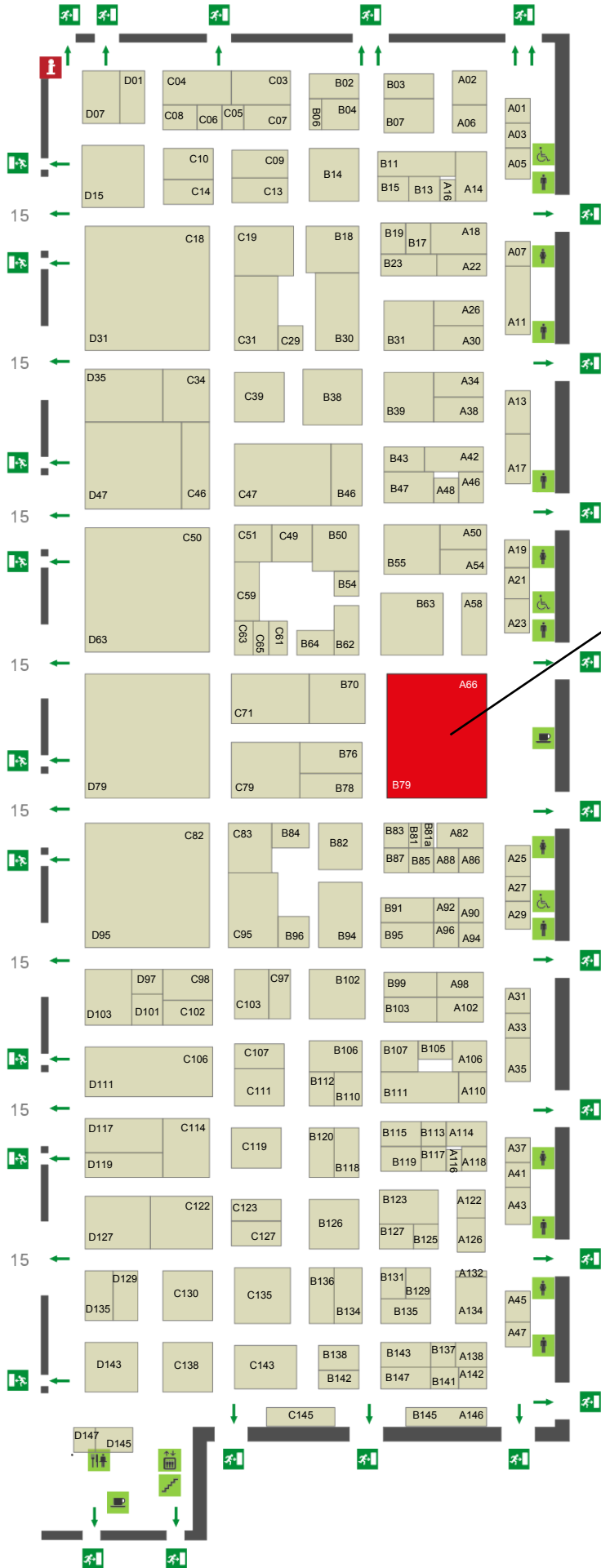

VIA AFRICA

VIALE LOMBARDIA SUD

COMPANY	STAND
3D SYSTEMS	A06
3D SYSTEMS SOFTWARE S.R.L.	A06
3DCONNEXION	A54
5TH AXIS	B115
A.M.TECH S.R.L.	C07
ABB	B15
ABL AUTOMAZIONE	C03
ACCUD	B115
ADVANTECH EUROPE BV	C61
AFFRI DI AFFRI ROBERTO	C145
AG TECHNIK S.R.L.	C107
AIDAM - ASSOCIAZIONE ITALIANA DI AUTOMAZIONE MECCATRONICA	B06
AIM - ASSOCIAZIONE ITALIANA DI METALLURGIA	B141
AIPND - ASSOCIAZIONE ITALIANA PROVE NON DISTRUTTIVE	A142
AIRTAC - ATC (ITALIA) S.R.L.	B94
ALASCOM SERVICES S.R.L.	C29
ALBA LEASING S.P.A.	A118
ALEXASOFT	B129
ALFA ROMEO - FCA ITALY S.P.A.	D79
ALICONA IMAGING GMBH	A37
ALLEANTIA S.R.L.	C63
ALLMAG S.R.L.	B43
ALMA ROBOTICS S.R.L.	B63
AMETEK S.R.L.	B82
AMO	C47
ANDANTEX S.R.L.	A29
ARCOCAD	B106
ARGO VISION	B63
ASF METROLOGY S.R.L.	B106
ASTEC LAM PLAN S.R.L.	B136
ATEQ	A90
ATEQ ITALIA S.R.L.	A90
ATM	D145
AUTODESK S.R.L.	B14
AZIMUT CAPITAL MANAGEMENT SGR S.P.A.	A88
AZZURRODIGITALE S.R.L.	B63
BALLUFF	B46
BALLUFF AUTOMATION S.R.L. CON SOCIO UNICO	B46
BALTEC MASCHINENBAU	B103
BANCA IFIS	A50
BI-MUPIÙ	A66 B79
BLUEUP S.R.L.S.	B63
BLUM NOVOTEST	B123
BLUM NOVOTEST S.R.L.	B123
BORDIN ETTORE & FIGLI S.N.C.	B47
BOSCH REXROTH S.P.A.	D35
BREVETTI STENDALTO S.P.A.	B95
BRINKMANN PUMPS	B125
BRUCKER ITALIA	B129
BUEHLER	C123

COMPANY	STAND
C.I.S.A.M. S.A.S. DI ERNST ELENA MARIA E C.	B135
CADLINE S.R.L. - MASTERCAM	B76
CALVI S.P.A.	A94
CAM2 S.R.L.	B134
CAMAR S.P.A.	B103
CARBOLITE GERO	D145
CARBOSIX BY ALUSIC - ALUSIC S.R.L.	A03
CARL ZEISS INDUSTRIELLE MESSTECHNIK	C130 C138 D143 D129
CARL ZEISS S.P.A. CON SOCIO UNICO	C130 C138 D143 D129
CGTECH S.R.L. SOCIETÀ A SOCIO UNICO	A34
CIMATRON	A06
CISCO ITALIA	B83
CMA ROBOTICS S.P.A.	B11
CMF MARELLI S.R.L.	D103
CNC SOFTWARE	B76
COAX VALVOLE ITALIA S.R.L.	B119
COGNEX	A23
COORD 3 S.R.L.	C143
COPSONIC	A58
COSBERG S.P.A.	B04
CREACTIVES	A58
CREAFORM	B82
CRIPPA	D97
CT MECA S.R.L.	B113
CYBERTEC S.R.L.	A92
D.ELECTRON S.R.L.	A38
DB INFORMATION S.R.L.	A11
DELL BOOMI - DELL S.P.A.	C65
DELLA CASA RETI S.R.L.	A18
DENSO WAVE	C04
DEUTSCHE BANK S.P.A.	C79
DRONYX S.R.L.	B63
DROPSA S.P.A.	C97
E.C.S. TDE MACNO - BDF DIGITAL S.P.A.	A30
E6POS	C19
ECOMAG S.R.L.	A41
EDGE CAM - RADAN	B126
EDIBIT S.R.L.	A47
EIT DIGITAL	A58
ELABORA S.R.L.	A25
ELBO - EREDI BASSI ARALDO S.A.S.	A05
ELESA S.P.A.	C103
E-LIOS	A21
ENGINEERING INGEGNERIA INFORMATICA	D97
E-REPAIR S.R.L.	C49
ESPEDIA S.R.L.	A16
ESPRIT BY DP TECHNOLOGY CORP.	B55
ESPRIT BY DP TECHNOLOGY ITALY S.R.L.	B55
ESTE S.R.L.	B137
ETEL	C47

COMPANY	STAND
EUROTECH S.P.A.	A21
EUTRONICA S.R.L.	B63
EXPRIVIA - ITALTEL	B87
EY	B78
FAGOR AUTOMATION	B18
FAICOM S.R.L.	B15
FANCY PIXEL S.R.L.	A27
FANUC	C18 D31
FANUC ITALIA S.R.L.	C18 D31
FARO SWISS HOLDING	B134
FINE TUNING CONSULENZA INTEGRATA S.R.L.	A86
FORTEST ITALIA S.R.L.	B142
FUTURE-TECH	A122
GECHTER	B103
GEOMAGIC	A06
GETZNER	B91
GIBBS AND ASSOCIATED	A06
GO2CAM INTERNATIONAL	C09
GOM ITALIA S.R.L.	A126
HALLEY INFORMATICA S.R.L.	A01
HAWE ITALIANA S.R.L.	A35
HEIDENHAIN	C47
HEIDENHAIN ITALIANA S.R.L.	C47
HEXAGON MANUFACTURING INTELLIGENCE	C95
HILMA ROEMHELD	B103
HILSCHER ITALIA S.R.L.	A17
HIWIN S.R.L.	C82 D95
HORSA	A21
HPC	B113
HYDROKOMP	C107
HYLASOFT	A116
HYUNDAI ROBOTICS	C04
IAI CORPORATION	B07
ICCREA BANCAIMPRESA S.P.A.	A82
ICE - AGENZIA / COLLETTIVA STARTUP ITALIANE	B63
ICIM S.P.A.	B84
ICONA S.R.L.	A48
ICOTEK	A13
ICOTEK ITALIA S.R.L.	A13
IDS INFORMATICA DATA SYSTEM S.R.L.	B54
IGUS S.R.L.	B38
IMAGE S S.P.A.	C08
IMANPACK PACKAGING & ECO SOLUTIONS S.P.A.	A02
INNOVATEST EUROPE	B111
INTESA SANPAOLO	A110
INVEST KOREA - KOTRA - CENTRO COMMERCIALE COREANO	A14
ISB BEARINGS AND COMPONENTS	B105
ITD S.R.L.	A33
ITEM S.R.L.	B31
JENOPTIK	C135



**COMPANY**
**STAND**

K.L.A.IN.ROBOTICS S.R.L.	C04
KABELSCHLEPP ITALIA S.R.L.	C83
KAESER COMPRESSORI S.R.L.	B50
KAESER KOMPRESSOREN	B50
KAMMERER GEWINDETECHNIK	D07
KARL DEUTSCH	A41
KAWASAKI	D15
KB PRUFTECHNIK	A122
KEYENCE CORPORATION	D127
KEYENCE ITALIA S.P.A.	D127
KING	B135
KIPP ITALIA S.R.L.	B13
KIPP WERK	B13
KITA SENSOR TECH	A106
KLINGELNBERG	C122
KLINGELNBERG ITALIANA S.R.L.	C122
KORTA S.A.U.	A98
KREON ITALIA SRL	B138
LAM PLAN	B136
LEANTECHNIK	C107
LEASE 2019 - ASSILEA	B81
LEASE 2019 - NEWTON S.P.A.	B81
LEICA MIKROSYSTEME	B129
LENORD, BAUER & CO	B46
LI.BE S.P.A.	B99
LITEM	C123
LK METROLOGY	B106
LTF S.P.A.	B120
MAHR	D103
MARK-10	B135
MARKFORGED	D103
MEAN WELL	A19
MECCATRONICORE S.R.L.	B63
MECMATICA S.R.L.	A146 B145
MES CONSULTING	C143
METAL WORK S.P.A.	B30
METKON INSTRUMENTS INC.	B131
METROLOGIC GROUP	C127
METROLOGIC GROUP ITALIA S.R.L.	C127
METRON	A58
MICROCONTROL N.T. S.R.L.	B129
MICROPLAN ITALIA S.R.L.	B107
MICROSONIC	B46
MICROTECH	B115
MINDSPHERE WORLD	D97
MINIBOOSTER	B103
MIRAITEK S.R.L.	B127
MISE D.G. LOTTA ALLA CONTRAFFAZIONE - UIBM	B85
MISSLER SOFTWARE	B02
MISSLER SOFTWARE ITALIA S.R.L.	B02

**COMPANY**
**STAND**

MISUMI EUROPA GMBH	C06
MITSUBISHI ELECTRIC CORPORATION	C71
MITSUBISHI ELECTRIC EUROPE BV	C71
MITUTOYO	C106 D111
MITUTOYO ITALIANA S.R.L.	C106 D111
MTT TECHNOLOGY S.R.L.	C31
MÜLLER CO-AX	B119
NCSIMUL - SPRING TECHNOLOGIES	B126
NEW GENERATION SENSORS S.R.L.	B63
NEXTEC TECHNOLOGIES 2001	C143
NEXTEMA S.R.L.	B63
NEXTOME S.R.L.	B63
NIDEC	C111
NIKON	C123
NIKON INSTRUMENTS S.P.A.	C123
NORELEM	B115
NUMERIK JENA	C47
O.S.L. S.R.L.	B23
OGP HOMMEL ITALIA S.R.L.	C135
OLMEC S.R.L.	A114
OLYMPUS ITALIA S.R.L.	A31
OMAG	C145
OMAS S.R.L.	A07
OPEN MIND TECHNOLOGIES	B39
OPEN MIND TECHNOLOGIES ITALIA S.R.L.	B39
OPPENT S.P.A.	A42
OPTO	B129
OSBORN	B103
PASCAL	C107
PHOENIX MECANO S.R.L.	B110
PMI	B102
PMITUTORING.IT - BFS PARTNER S.P.A.	B117
POLYWORKS EUROPA (ITALIA)	A43
PRIMATEK S.R.L.	B143
PROCAM GROUP S.R.L.	B126
PROCEQ	A122
PUBLITEC S.R.L. UNIPERSONALE	A134
PURITY S.R.L.	B63
PWC	B70
QFP S.R.L.	D135
QMET S.R.L.	D147
QNESS	D145
QNESS	D147
QVI - OGP	C135
RAFI S.R.L.	A19
REDEX	A29
REXROTH	D35
RITTAL	D97
ROBORIS S.R.L.	A46
ROBOTMASTER/INTERCAM S.A.	A45

COMPANY	STAND
ROBOTUNITS ITALIA S.R.L.	C05
ROBOZE S.R.L.	B63
ROEMHELD	B103
ROSA SISTEMI S.P.A.	D07
ROSE SYSTEMTECHNICH	B110
RPS METROLOGY S.R.L.	B118
RSF ELEKTRONIK	C47
RUPAC S.R.L.	B111
S.P.D. S.P.A.	C46
SACEMI - GAMAR S.R.L.	B112
SANMARCO INFORMATICA S.P.A.	B62
SCAGLIA INDEVA S.P.A.	B03
SCHNEIDER	B143
SCHNORR ITALIA S.R.L.	B96
SCHUNK INTEC S.R.L.	D47
SEA TECH DI EMMEDIEMME	C14
SEI FILTRATION S.R.L.	C13
SEIKO EPSON CORPORATION	B07
SERMAC S.R.L.	B115
SIDERVAL S.P.A.	A96
SIEMENS	C49
SIEMENS	C51
SIEMENS	D97
SIEMENS PLM SOFTWARE	A54
SIEMENS S.P.A.	C50 D63
SINICO MACHINE TOOLS MANUFACTURING	C14
SINTA S.R.L.	B07
SIRI - ASSOCIAZIONE ITALIANA DI ROBOTICA E AUTOMAZIONE	A132
SIT S.P.A.	C111
SKF INDUSTRIE S.P.A.	C102
SMC ITALIA S.P.A.	D119
SOGIMI S.P.A.	B91
SOIEL INTERNATIONAL S.R.L.	A138
SOLIDCAM	B19
SOLIDCAM ITALIA	B19
SOLIDMACHINE	B19
SOLIDWORKS	B17
SOLIDWORLD S.R.L.	B17
SONOBEACON	A58
SPECTRO	B82
STARK	B103
STÄUBLI ITALIA S.P.A.	C10
STRUERS ITALIA S.A.R.L.	D101
SYSTEM TECHNOLOGY S.R.L.	C09
TAGLIO C S.R.L.	A26
TAYLOR HOBSON	B82
TEAM3D S.R.L.	A54
TEBIS	C39
TEBIS ITALIA S.R.L.	C39
TECHMAN ROBOT	B07

COMPANY	STAND
TECHNAI TEAM S.P.A.	D117
TECMET 2000 S.R.L.	A122
TECNO PIU' S.R.L.	C14
TEEPTRAK	A58
TELEDYNE DALSA	C08
TESAR S.P.A.	B64
TG.EMME SERVICE S.R.L.	C51
THIRD DIMENSION	D135
TIESSE ROBOT S.P.A.	D15
TITAN ENGINEERING S.P.A.	A106
TRC	B115
TRINCKLE	A58
TWINHORN	C31
UNIS GROUP ITALIA S.R.L.	A22
UNIVERSAL ROBOTS A/S	C34
VERDER SCIENTIFIC S.R.L.	D145
VERO PROJECT S.R.L.	D01
VERO SOFTWARE	B126
VICIVISION - VICI & C. S.P.A.	C119
VISION ENGINEERING LTD.	B147
VISIONLINK S.R.L.	A23
WALTER UHL	B129
WENZEL GROUP	C114
WENZEL ITALIA S.R.L.	C114
WERTH ITALIA S.R.L.	C59
WERTH MESSTECHNIK	C59
WITTENSTEIN	C98
WITTENSTEIN S.P.A.	C98
WYLER	B143
ZEISS	D135
ZIMMER	C19
ZIMMER GROUP ITALIA S.R.L.	C19
ZOLLERN GMBH & CO. KG	A102
ZYGO	B82

# PAD/HALL 15

CORSO ITALIA OVEST

RECEPTION



VIA LOMBARDIA OVEST

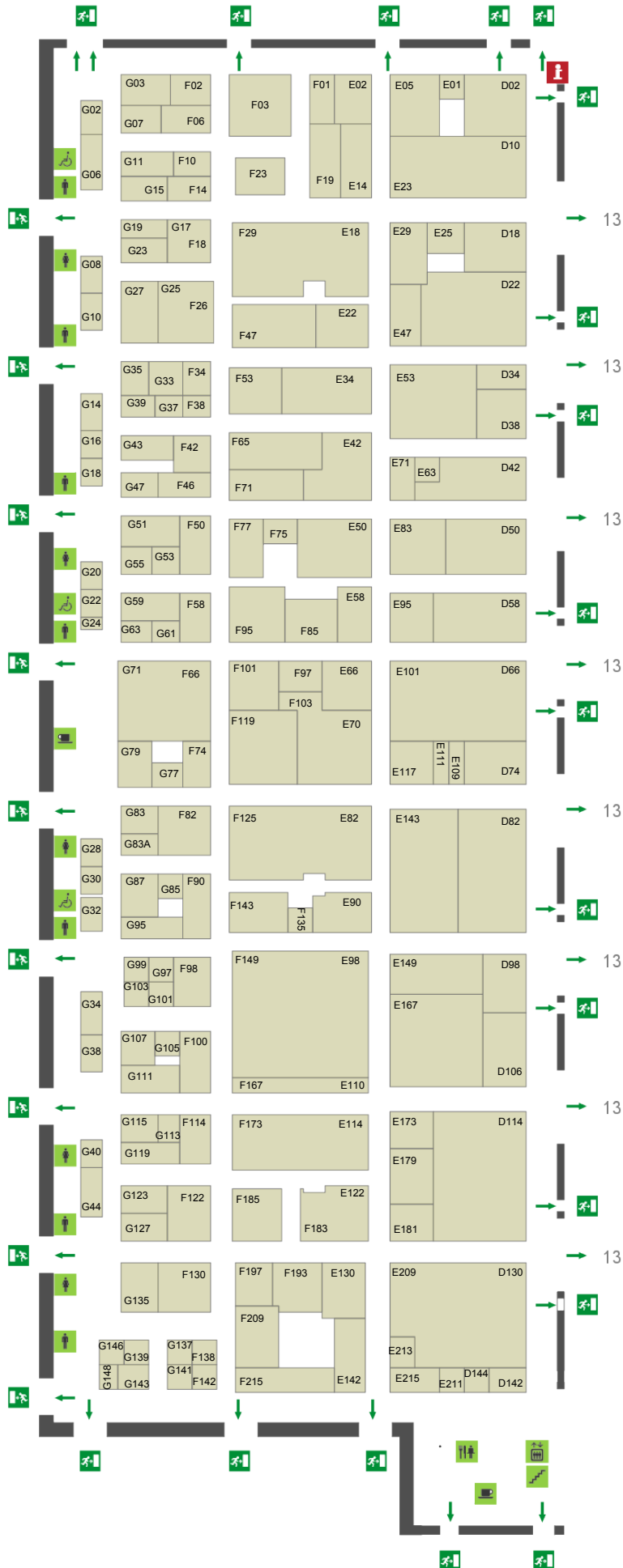

VIALE LOMBARDIA SUD

COMPANY	STAND
7-LEADERS CORP.	D58
A.M.U. PRINCIGALLI S.R.L.	G10
ACETI MACCHINE S.N.C.	E25
ACSYS	F215
ALBERTI UMBERTO S.R.L.	E71
ALESAMONTI S.R.L.	E142
ARROWELD ITALIA S.P.A.	F03
ART-ECO S.R.L.	G44
ASSFALG	F98
ATOM SAITO	D58
ATTREZZATURE AGINT S.R.L.	F98
AUTOMHA S.P.A.	F122
AVANTUNE S.R.L.	D144
BCM S.R.L.	F135
BEROY S.R.L.	G113
BIG KAISER PRECISION TOOLING LTD.	G51
BODOR	F47
BOTEK PRÄZISIONSBOHRTECHNIK	F58
BOTEK ITALIA S.R.L.	F58
BRETON	E70 F103
BRUSA & GARBOLI S.R.L.	F14
BSTUDIO S.R.L.	D66 E101
C.B.C. S.R.L.	E05
CAMU S.R.L.	F143
CARBOTOOLS	D58
CARMEX ITALIA S.R.L.	F77
CARMEX PRECISION TOOLS	F77
CBFERRARI - C.B.FERRARI S.R.L.	D74
CEEVER S.R.L.	E215
CEIT DI RUSCALLA BRUNO	G03
CERATIZIT GROUP	E173
CERATIZIT GROUP - KOMET UTENSILI S.R.L.	E173
CESARI UTENSILI S.A.S. DI CESARI G. & C.	G20
CIAMPALINI COSTRUZIONI MECCANICHE S.R.L.	F19
CLEANFIX	F85
CMS S.P.A.	D98
CONCEPT LASER	E34
CONSORZIO DISTRIBUTORI UTENSILI	F65
CORAL ENGINEERING S.R.L.	F130
COUTH	E34
CREI S.R.L./COMPOSITE SOLUTIONS & TECHNOPOLYMERS	F142
DAIWA RABING	D58
D'ANDREA S.P.A.	D18
DATRON	F215
DELFIN	F185
DELFIN S.R.L.	G07
DEMMELEL	F98
DIAMANT	G10
DIAMANTE MAGAZINE - DIAMANTE A&T MAGAZINE	G137
DIATool	G83

**COMPANY**
**STAND**

DIGITAL WAY S.A.S.	E213
ELBO CONTROLLI NIKKEN - ELBO CONTROLLI S.R.L.	E58
ELETTROLEGHE S.R.L.	G99
ERCOLINA - CML INTERNATIONAL S.P.A.	F26 G25
ERGOPACK	G34
ETA-MEC INDUSTRIAL S.R.L.	G18
F.LLI NAVA S.R.L.	G11
FACCIN S.P.A.	E22
FCS SYSTEM S.R.L.U.	G111
FEELER	D66 E101
FERRETTO GROUP S.P.A.	G79
FERVI S.P.A.	F66 G71
FFG EUROPE S.P.A.	D66 E101
FFG WERKE	D66 E101
FFG WERKE GMBH	D66 E101
FIBRO	E66
FICEP S.P.A.	E18 F29
FIERA MILANO MEDIA	F193
FOCASEIKI CORP.	F71
FPT INDUSTRIE S.P.A.	E82 F125
FRAMAG INDUSTRIEANLAGENBAU GMBH	D142
FRONIUS	F03
G M G LATHES S.R.L.	E114 F173
G.B.C. INDUSTRIAL TOOLS S.P.A.	F01
GALDABINI S.P.A.	E29
GERARDI S.P.A.	D22
GOGLIO MILLING SYSTEMS S.R.L.	F101
GOODWAY MACHINE CORP.	F71
GRINDING TECHNOLOGY S.R.L.	D66 E101
GÜHRING	D50
GYS ITALIA S.R.L.	G37
HAIMER ITALIA S.R.L.	E42
HALDER	F98
HANEL	G115
HANNA	G83
HARTMETALL ESTECH AG	D34
HERMLE	E122 F183
HERMLE ITALIA S.R.L.	E122 F183
HESSAPP	D66 E101
HEULE	G83
HG LASER	F215
HOFFMANN ITALIA S.P.A.	D10 E23
I.M.S.A. S.R.L.	E117
ICA SYSTEM S.R.L.	F85
IMAS	D66 E101
IMAS AEROMECCANICA S.R.L.	F34
INCARICOTECH S.R.L.	G115
INGERSOLL CUTTING TOOL	D58
INNSE-BERARDI S.P.A.	F119
INTERCOM S.R.L.	G127

**COMPANY**
**STAND**

IPCM INTERNATIONAL PAINT&COATING MAGAZINE	G141
ISOLGOMMA S.R.L.	G38
ISPER S.R.L.	F197
ISTITUTO ITALIANO DELLA SALDATURA	G146
ITEK VENEZIANO GROUP S.R.L.	E02
JINAN XINTIAN TECHNOLOGY CO. LTD.	G02
JOBS S.P.A.	D66 E101
JONGEN	D42
JONGEN ITALIA S.R.L.	D42
JUARISTI BORING & MILLING MACHINES SLU	F90
K	D58
KARDEX ITALIA S.P.A.	G06
KARL SCHÜSSLER GMBH & CO. KG	G63
KATO MFG	D58
KELCH	D58
KEMPER	F03
K-TEC	D58
KURODA	D58
KYOCERA UNIMERCO TOOLING S.R.L. UNIPERSONALE	F53
L.M.N. S.R.L.	F10
LAGUN	F114
LAMIERA 2019 - CEU CENTRO ESPOSIZIONI UCIMU S.P.A.	G28
LAZZATI S.P.A.	D106
LEADWELL	D66 E101
L-PEAK	F47
LTF S.P.A.	E90
LUCCHINI TOOL STEEL S.R.L.	G33
LUGHESE UTENSILERIA E MACCHINE S.R.L.	F71
M&H INPROCESS	F74
M&H ITALIA S.R.L.	F74
MAG	D66 E101
MAGNABOSCO GUIDO S.R.L.	G55
MARIO CARNAGHI S.P.A.	E181
MECANUMERIC	F209
MECANUMERIC ITALIA S.R.L.	F209
MECCANODORA	D66 E101
MEDIAPOINT & COMMUNICATIONS S.R.L. - SALDARE.INFO	F138
MESSER CUTTING SYSTEMS	G27
MESSER GRIESHEIM SALDATURA S.R.L	G27
METAL BARRE S.R.L.	G35
MEUSBURGER GEORG GMBH & CO. KG	G123
MILLUTENSIL S.R.L.	E66
MINITOR	D58
MITSUBISHI MATERIALS	E53
MITSUBISHI MATERIALS CORPORATION - MMC ITALIA S.R.L.	E53
MMC HITACHI TOOL ENGINEERING EUROPE GMBH	F95
MODUL	D66 E101
MODULA S.P.A.	G87
MODULAR ASSEMBLY TECHNOLOGY CO. LTD.	G103
MOLDMAK - HETO MANUFACTURING TECHNOLOGIES S.A.	E179



COMPANY	STAND
MORARA	D66 E101
MPA S.R.L.	F42
M-PIX	E34
MULTICONTROL S.R.L.	F50
NEWMOTOR	D58
NICE CUT FUJIGEN KOGYO	D58
NILFISK S.P.A. A SOCIO UNICO	G119
NORBAR	G39
NS	D58
NUOVA METALTRE S.R.L.	G101
O.M.G. S.R.L.	D38
O.M.V. OFFICINE MECCANICHE VENETE S.P.A.	E110 F167
OMAN S.R.L.	G95
OMAX	E02
OMERA S.R.L.	D02
OMLAT S.R.L.	F97
OMPISA S.R.L.	G14
OPEN FACTORY EDIZIONI S.R.L.	G135
OPTIMUM MASCHINEN GERMANY	E90
P.E.I. PROTEZIONI ELABORAZIONI INDUSTRIALI S.R.L.	F82
PAMA S.P.A.	D82
PARMIGIANI MACCHINE S.A.S.	E14
PARPAS S.P.A.	E98 F149
PEDRAZZOLI	F26 G25
PIFFNER	D66 E101
POLIANGOLAR S.R.L.	G47
PREALPINA S.R.L.	D58
PREZISS	G83
PROMAC S.R.L.	E143
PROTEK S.R.L.	E149
PUNTO LAVAZZA	G32
QUINE S.R.L.	G143
RAJASTHAN UDYOG & TOOLS PVT LTD.	G16
RAMBAUDI	D66 E101
REGOFIX	G83A
RELAYR GMBH	E211
REMAK S.R.L.	F215
REPI S.A.S.	G83A
RIDIX S.P.A.	E34
RIME S.R.L.	G59
RIVIT S.R.L.	F38
RÖDERS	E34
RONCHINI MASSIMO S.R.L.	F100
ROSE PLASTIC ITALIA S.R.L.	F75
RUD KETTEN RIEGER & DIETZ GMBH U. CO. KG	G08
SACHMAN	D66 E101
SAFOP S.P.A.	E109
SAMUEXPO 2020	G105
SANGCHON INTERNATIONAL CO., LTD.	G97
SC EDIT	G148

COMPANY	STAND
SCHAUBLIN MACHINES	E34
SCHOLPP MONTAGGI ITALIA S.R.L.	G23
SCHWÄBISCHE WERKZEUGMASCHINEN GMBH	E130
SCT	G61
SERVOPRESSE S.R.L.	E01
SIEGMUND	F03
SIGMA	D66 E101
SMOXH	G20
SMS	D66 E101
SOCAF S.P.A.	F185
SORALUCE S.COOP.	D114
SOWA CO.	D58
SPARK DEPO	D58
SPERONI S.P.A.	E47
SPINELLI ACCESSORI MACCHINE UTENSILI S.A.S.	G85
STAMFOR S.P.A.	G61
STAR PROGETTI TECNOLOGIE APPLICATE S.P.A.	G107
STOLLE	G10
SWISS BORE SWISS TOOL SYSTEM	D58
SWISS TOOLS	G83A
SYNCRO S.R.L.	F114
T.E.I. SERVICE ONE S.R.L.	G77
TACHELLA	D66 E101
TAEGUTEC	D58
TAG	F03
T-DRILL OY	G15
TECNICHE NUOVE S.P.A.	G53
TG BI-MU	G24
TIMGLOBAL MEDIA S.R.L.	G139
TOMMASIN UTENSILI S.R.L.	E95
TOS VARNSDORF	F114
TRANSFLUID MASCHINENBAU GMBH	G19
TREVISAN MACCHINE UTENSILI S.P.A.	E167
TRIBO HARTSTOFF GMBH	E63
TSI AM GROUP S.R.L.	F46
TUTTO PER L'IMBALLO S.P.A.	G34
UBIEMME GÜHRING ITALIA S.R.L.	D50
UCIMU-SISTEMI PER PRODURRE	G30
UVAT S.R.L.	G83
UVIT S.R.L.	G39
VDF BOEHRINGER	D66 E101
WATERJET CORPORATION S.R.L.	F18 G17
WERKZEUGMASCHINENFABRIK WALDRICH COBURG GMBH	E111
WITZIG & FRANK	D66 E101
WST S.R.L.	G43
YG1	E50
YG1 ITALY S.R.L.	E50
YHB ECO CO., LTD.	G40
YING HAN TECHNOLOGY CO. LTD.	F23
ZAYER S.A.	D130 E209

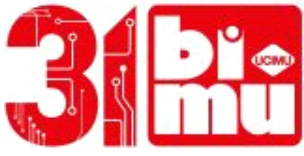

COMPANY

STAND

ZCC CUTTING TOOLS EUROPE GMBH

E83

ZECCHETTI S.R.L.

F06

ZHUZHOU LIHUA CEMENTED CARBIDE CO., LTD

G22

ZOLLER

F50