



NYPD

New York City Police Department

Police Officer Exam Tutorial

NYPDRECRUIT.COM

Please Read:

This tutorial is provided to assist you in scoring to the best of your ability on the upcoming Police Officer Exam.

There are no assurances that all of these areas will be covered or that additional areas will not be added on the actual examination.

This tutorial is not all-inclusive, many candidates find studying additional material such as reading comprehension passages, grammar, and other preparation courses beneficial.

Answer questions 1 and 2 based solely on the passage below:

Officer Finnegan and Officer McCoy are patrolling West Street when they receive a call concerning a past assault. When the officers arrive at the scene, they find a 30-year-old, Hispanic male named Jose, bleeding from the mouth. Officer Finnegan immediately calls for an ambulance over the radio. Officer McCoy asks Jose what happened. Jose states he was walking northbound on West Street when a man came up to him, punched him in the mouth, and stole his wallet. He gives a description of a 35-year-old, 6'10", Asian male, with long black hair, wearing a green cap, black shirt, and blue jeans. There are three witnesses to the assault. Officer Finnegan and McCoy begin to interview the witnesses.

Witness 1: "The man was walking northbound on West Street when an Asian guy who was about 6'10", wearing a black shirt, green hat, and blue jeans, came up to him and punched him in the mouth. He also had long black hair. After he punched him and took his wallet. He ran down Canal Street."

Witness 2: "The man was minding his business walking down Canal Street, when a tall white guy, about 5'10" feet walked up to him and punched him in the face. He was wearing a blue shirt and blue jeans, and had black hair."

Witness 3: "The man was walking northbound on West Street when an Asian guy wearing a black shirt and blue jeans came up to him and punched him in the mouth, and took his wallet. He had black hair."

1. According to the information above, which witnesses' recollection of the incident is the **LEAST ACCURATE**?

- (A) Witness 1
- (C) Witness 2

- (B) Witness 3
- (D) Jose



2. According to the information above, what direction was Jose traveling?

- (A) Northbound
- (C) Southbound

- (B) Eastbound
- (D) Westbound



Burglary

The crime of burglary is committed when a person enters or remains in a building or dwelling unlawfully, intending to commit a crime.

3. According to the definition given, which one of the following is the best example of a burglary?
- (A) Tom passes an open door to a local storage facility that has a posted sign “Authorized Persons Only”. He doesn’t see anyone, but notices a wallet on one of the desks. Although he doesn’t work at the warehouse, he enters the warehouse with the intention of stealing the wallet. When he is about to grab the wallet he hears voices in the other room, and runs away without the wallet.
 - (B) Tom enters a butcher’s market to buy pork chops. When the butcher is helping another customer, he places a package of pork chops in his jacket, and leaves the store without paying.
 - (C) Tom’s car breaks down on a deserted road at night while it is snowing. He finds an abandoned shed, and forces the shed door open to get out of the snow.
 - (D) Tom, an employee at a drug store, enters the employee locker room that he is allowed to use, and steals another employee’s wallet.



4. Solve the following expression to uncover the value of x: $8(4)+2(20)+10=X$
- (A) 72
 - (B) 50
 - (C) 62
 - (D) 82



Answer questions 5 through 7 based solely on the information below:

Uniformed members of the service when coming into contact with an individual that may have apparently overdosed while using drugs and/or alleged opioids, may have to administer department provided Naloxone. Upon arrival at a scene when an individual may be suffering from, or has died from, a suspected drug overdose, officers should follow this procedure in the order given:

- I. Request an ambulance and render reasonable aid to suspected overdose victim.
 - a. Request the response of a uniformed member of the service equipped with a Naloxone Kit, if not present at scene.
 - b. Ascertain from witnesses if Naloxone was administered to individual prior to police arrival.
- II. If individual is unresponsive, administer Naloxone, if appropriate.
 - a. Request dispatcher to notify responding Emergency Medical Service (EMS) personnel that Naloxone was administered.
 - b. If individual is not breathing and has no pulse, Cardio Pulmonary Resuscitation (CPR)/Automated External Defibrillator (AED) should be administered.
 - c. If individual has not responded to Naloxone within three to five minutes, administer one additional dose of Naloxone.
 - d. Inform EMS personnel of any attempt to revive individual (e.g., CPR, AED, etc.) and number of Naloxone doses given.

5. Police Officer Darious arrives to the scene of a suspected overdose where the victim is not responding. He administers Naloxone from his department provided kit. The victim is still not responding, but has a pulse. How long should Officer Darious wait to administer another dose of Naloxone if the victim does not respond after CPR?
- (A) Three to five minutes
 - (B) Six to eight minutes
 - (C) Three to five seconds
 - (D) Ten to fifteen minutes



6. Police Officer Darious arrives to the scene to find an unconscious male who has overdosed on opioids. Officer Darious is not equipped with his Naloxone Kit. What should Officer Darious proceed to do according to the information above?
- (A) Wait for EMS to arrive at the scene.
 - (B) Request the response of a uniformed member equipped with a Naloxone Kit.
 - (C) Ascertain from witnesses if Naloxone was administered prior to police arrival.
 - (D) Inform EMS personnel of any attempt to revive individual.



7. Officer Darious administers Naloxone, what should he do after it is administered according to the information above?
- (A) Administer another dose in the time frame mentioned above.
 - (B) Call the responding EMS personnel on his department cellphone and alert them.
 - (C) Request the dispatcher to notify responding EMS personnel Naloxone was administered.
 - (D) Request an ambulance to the scene.



8. On January 1st, 2018 at 8:00 P.M., John Daly reported a hit and run to the police. Four witnesses were interviewed by the police. They all gave different accounts of the license plate of the vehicle involved in the hit and run. Which of the following plate numbers is most likely to be correct?
- (A) 381JRZ
 - (B) 358JRZ
 - (C) 351JTZ
 - (D) 351JRZ



9. Police Officers Jayden and Tyrell respond to the scene of a burglary. Four witnesses give varying accounts of the incident. Which one of the following accounts is most likely to be correct?
- (A) “A female Caucasian, about 5’1”, 120 lbs., wearing a black sweater, kicked the door of the house in. She went in the house and ran out with a jewelry box. I saw a silver gun hanging out of her pocket. She ran southbound on Bay 10th Street.”
 - (B) “A female Caucasian, about 5’1”, 110 lbs., wearing a purple sweater, kicked the door of the house in. She went in the house and ran out with a jewelry box. She had a silver gun in her pants pocket. She ran northbound on Bay 10th Street.”
 - (C) “A female Caucasian, about 5’7”, 120 lbs., wearing a purple sweater, kicked the window in of the house. She went in the house and ran out with a jewelry box. I saw a silver gun hanging out of her pocket. She ran northbound on Bay 10th Street.”
 - (D) “A female Caucasian, about 5’1”, 120 lbs., wearing a purple sweater, kicked the door of the house in. She went in the house and ran out with a jewelry box and DVD player. She had a black gun in her pants pocket. She ran northbound on Bay 9th Street.”



10. Captain Dillon is organizing his roll calls for the upcoming New Year’s Eve detail. The following personnel is available.

RANK	NUMBER OF PERSONNEL
Police Officers	50
Sergeants	10
Lieutenants	7

One police officer is assigned to stationhouse security and is not available for the detail. If all lieutenants supervise an equal amount of police officers, how many police officers will be assigned to each lieutenant for the detail?

- (A) 8
- (B) 5
- (C) 6
- (D) 7



11. Police Officers Keen and Duvall receive a call for a male stabbed on the corner of Cortelyou Street and East 29th Street. They arrive at the scene to find a male lying on the floor with multiple stab wounds to his chest. There is a crowd of people around him. Officer Keen immediately calls for an ambulance to respond to the scene. Officer Duvall begins to apply pressure to the wounds to stop the bleeding until the ambulance arrives. You are the only unit at the scene. What should the officers’ next course of action be?

- (A) Interview the witnesses at the scene to obtain a description and to see what happened.
- (B) Alert the supervisor that you have a male stabbed, and you are applying pressure to the wounds.
- (C) Canvass for a suspect.
- (D) Look for the knife that was used to stab the man.

Answer questions 12 through 15 based solely on the passage below:

Police Officers Kennedy and Hoover are dispatched to N/E corner of Clove Road and Hylan Boulevard, on March 22, 2018, at 9:01 A.M., in response to an assault in progress reported by a Mrs. Dansby. The officers arrive at the location at 9:07 A.M., to find an unconscious Mrs. Dansby laying on the ground with abrasions and swelling to the right side of her face. Officer Kennedy immediately calls for an ambulance using his radio. The officers observe a crowd of people around Mrs. Dansby, who are all stating they observed the assault.

At 9:09 A.M., EMS responds to the scene. They carefully put Mrs. Dansby on a stretcher and into the back of the ambulance. Officer Hoover asks Technician Ferguson what Mrs. Dansby's injuries were and if they will be able to interview her. Technician Ferguson states that Mrs. Dansby looks like she sustained a traumatic head injury due to being hit with a blunt object to the right side of her face, which resulted in her being left in a coma. They will have to rush her to the nearest hospital, Clove Lake Hospital, where she will be evaluated.

Officer Kennedy proceeds to interview the witnesses at the scene. The first witness, Frank Tartenbaum, states Mrs. Dansby was walking on the N/E corner of Clove Road and Hylan Boulevard when a man, driving his gold 2002 Toyota Camry, abruptly stopped the vehicle in front of Mrs. Dansby. He then got out of the car with a bat, and hit her on the right side of the face, ran back in the car and took off southbound on Clove Road. He was a Caucasian male, 5'10", heavy set, wearing a red shirt, and had short black hair.

Officer Kennedy interviews the second witness, Joan Collio. She states a man in a gold sedan stopped his car in the middle of Clove Road and Hylan Boulevard, got out with a bat, and hit Mrs. Dansby in the side of the face. He ran back in his car and took off on Hylan Boulevard.

Officer Kennedy transmits a description of the perpetrator to the rest of the officers on patrol using his radio: Caucasian male, heavy set, red shirt, short black hair, approx. 5'10". The officers conduct a canvass in the area for the male perpetrator.

12. According to the passage, where did Mrs. Dansby sustain injuries?

- A) Right side of her face
- B) Left side of her face
- C) Entire face
- D) Forehead



13. According to the passage, what hospital was Mrs. Dansby transported to?

- A) Richmond County Hospital
- B) Richmond Lake Hospital
- C) Clove Hospital
- D) Clove Lake Hospital



14. According to the passage, what color vehicle was the perpetrator driving?

- A) Black
- B) Blue
- C) Gold
- D) White



15. According to the passage, who calls for an ambulance with his department radio?

- A) Officer Kennedy
- B) Officer Hoover
- C) Technician Ferguson
- D) Mrs. Dansby



Answer questions 16 and 17 based solely on the information below:

When a uniformed member of the service responds to a complaint involving a dangerous animal/dog, regardless of whether or not a person was injured by the animal, officers should follow this procedure in this given order:

- I. Have the Communications Section dispatcher request a unit from the Animal Care and Control of New York City respond to the scene, if the animal presents a danger or may have been left uncared for.
- II. Prepare DANGEROUS ANIMAL/BITE REPORT and, if required, AIDED REPORT (if a civilian is injured by the animal), in all instances in which responding to or becoming apprised of an incident involving an animal bite and/or dangerous animal and include the ICAD Incident number on forms.
- III. Request an Emergency Services Unit to respond to the scene, if response by A.C. & C. of New York City cannot be made expeditiously (fifteen to thirty minutes) or cannot be ascertained.
 - a. Deliver animal to an Animal Care and Control of New York City representative, if they respond to the scene.
 - b. Request patrol supervisor to respond to the scene.
- IV. Place kennel into the backseat of patrol car.
 - a. Transport animal to an Animal Care and Control of New York City intake center, and obtain a receipt once completed.

16. Police Officer Ramone responds to the scene of an aggressive dog who has been barking for hours in an abandoned lot. What report(s) must Officer Ramone complete according to the information above?

- (A) Dangerous Animal/Bite Report and Aided Card.
- (B) Aided Card.
- (C) Complaint Report.
- (D) Dangerous Animal/Bite Report.



17. Police Officer Ramone requests an Animal Care and Control of New York City unit to respond to the scene, but they are unavailable. What should Officer Ramone do if they are not able to respond according to the information above?

- (A) Place the kennel in the back seat of his patrol car.
- (B) Request the patrol supervisor to respond to the scene.
- (C) Request an Emergency Services Unit to respond to the scene.
- (D) None of the above.



Answer questions 18 and 19 based solely on the diagram below:

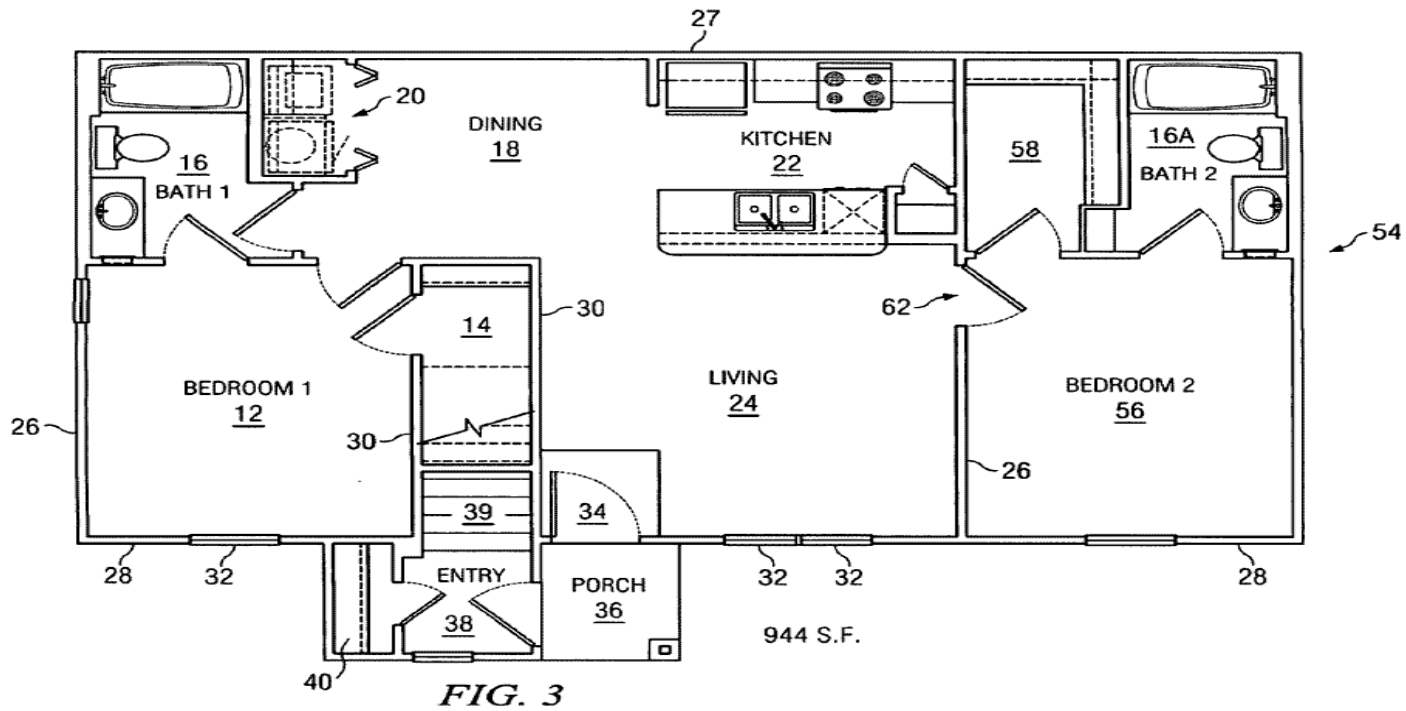

18. Based on the diagram above, how many square feet is the house?

- | | |
|----------------|--------------|
| (A) 1,000 S.F. | (B) 960 S.F. |
| (C) 944 S.F. | (D) 27 S.F. |



19. Based on the diagram above, if an officer were to respond to a call of a domestic dispute in Bath 2 (16A), what would be the most direct route to the location in the correct order?

- (A) 40,38,36,34,24,62,56,16A
 (B) 40, 38, 39, 14, 30, 24, 62, 56, 16A
 (C) 36, 34, 24, 62, 56, 58, 16A
 (D) 39, 34, 30, 24, 22, 62, 56, 16A



Answer questions 20 and 21 based solely on the passage below:

On Labor Day, Officers King and Jameson respond to a location where shots have been reported fired. Upon their arrival, the officers kick open the door to Apt. 7 of 1500 Bay Parkway. The officers observe a bald headed man, about 50 years old lying face up in his living room. The man is lying in a pool of blood. The officers tape off the crime scene, make all necessary notifications, and begin to interview five neighbors to find out if they saw or heard anything related to the death of Mr. Cain.

Mr. Mulder: “I was relaxing watching television when I heard the sound of a gunshot coming from Mr. Cain’s apartment. I called the police right away. It was about 11 A.M. It’s so sad about Mr. Cain. We would go out for drinks once a week. He was a good friend of mine. I last saw him this morning when he was going to the grocery store.”

Mrs. Scully: “It’s so sad, he was such a nice man. I last saw him around 11 A.M., when he was going to the grocery store. I spent the afternoon reading my book when I suddenly heard a gunshot coming from Mr. Cain’s apartment. I immediately called the police. It was about 1 P.M. I’ll miss him a lot.”

Mr. Scofield: “It’s so sad about Mr. Cain. He was so nice. I saw him about 8 A.M., when I came to ask him to come over for dinner. He was in a pretty good mood. He was drinking a glass of his 10-year-old scotch that he loved. About 11 A.M., I heard a shot from his apartment, and immediately called the authorities.”

Mrs. Burrows: “I last saw Mr. Cain 9:45 A.M, when he was on his way back from the grocery store. He was the nicest man you will ever meet, but he was always lonely. I was cooking lunch in my apartment, when I heard a gunshot from his apartment. It was about 10:55 A.M.”

Mr. Heckler: “It’s such a shame about Mr. Cain. I last saw him this morning about 9 A.M., when I saw him walking in the hallway. About 10:50 A.M., I heard a gunshot coming from Mr. Cain’s apartment. I called the police.”

20. According to the information above, which witnesses’ recollection of the time of the shooting differs from the rest?
- | | |
|------------------|------------------|
| (A) Mr. Mulder | (B) Mrs. Scully |
| (C) Mr. Scofield | (D) Mrs. Burrows |



21. According to the information above, at what time did Mr. Heckler last see Mr. Cain?
- | | |
|----------------|---------------|
| (A) 10:50 A.M. | (B) 11 A.M. |
| (C) 10:55 A.M. | (D) 9:00 A.M. |



22. On January 25, 2014, four people were stabbed in Central Park. Based on eye witness descriptions, it is believed by the detectives that the same person stabbed all four victims.

Eyewitnesses provided the following description of the perpetrator:

The perpetrator is a white female, approximately 110 lbs., 5'01" to 5'03" tall, long blond hair down to her knees, wearing red high heels, red lip stick, with a brown colored right eye, and blue colored left eye.

On January 28, 2014, Officer Kayan stopped four white females for questioning matching the description given by the eyewitnesses. What description would be the most helpful in identifying the suspect?

- (A) The suspect has long blonde hair down to her knees.
- (B) The suspect was wearing red lipstick.
- (C) He suspect is 5'01"-5'03" tall.
- (D) The suspect has two different colored eyes.



23. What is the mirror reflection of the shape illustrated below?

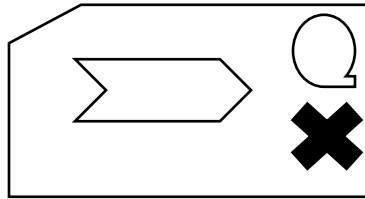

- A. B. C. D.



24. One of the jobs of a police officer is to issue parking summonses to cars that illegally park on public streets. When issuing parking summonses, police officers sometimes encounter problems. Select the correct response from choices A through D, which could be a potential problem for a police officer when attempting to write a parking summons.

- (A) Issuing a parking summons for a car parked in front of a fire hydrant with its headlights on.
- (B) Issuing a parking summons for a car parked in a "no parking" zone 12 P.M. Thursday.
- (C) Issuing a parking summons for a double parked car with a different license plate on the front than back.
- (D) Issuing a parking summons for a car parked by a meter where the time has expired.



Answer questions 25 through 27 based solely on the information below:

Police Officers often respond to scenes involving an emotionally disturbed person, abbreviated “EDP” (radio code 10-54 EDP). An emotionally disturbed person is a person who appears to be mentally ill or temporarily deranged and is conducting himself in a manner which a police officer reasonably believes is likely to result in serious injury to himself or others. When responding to a scene involving an emotionally disturbed person, officers should use the following procedure, in this order:

- I. Request “EDP location history” from dispatcher prior to arrival on scene, when responding to a call for service involving a possible EDP.
 - a. Request Communications Section to contact the complainant while en-route to location, if possible, to obtain additional information.
 - b. Alert the radio dispatcher that you have arrived at the scene with radio code “10-84”.
 - c. Carry three-foot polycarbonate shield with door bag (door rope/door wedge) affixed, if available.
- II. Request and/or ensure the response of:
 - a. Patrol supervisor.
 - b. Additional personnel/equipment (e.g., Emergency Service Unit, Ambulance etc.), if necessary.
- III. Attempt to isolate and contain the EDP while maintaining a zone of safety (20 feet) until arrival of patrol supervisor and Emergency Service Unit personnel.

25. Police Officer Jackson receives a radio call involving an emotionally disturbed person who is refusing to take his medication. Officer Jackson receives all necessary information regarding the person from the radio dispatcher before arriving to the scene. When Officer Jackson arrives at the scene of the location, what radio code should he relay to the radio dispatcher?

- | | |
|---------------|-----------|
| (A) 10-48 | (B) 10-84 |
| (C) 10-54 EDP | (D) 10-34 |



26. Police Officer Jackson alerts the patrol supervisor that he has responded to an emotionally disturbed person, and that he refuses to take his medication. According to the information above, what is Officer Jackson’s next course of action?

- (A) Attempt to isolate and contain the EDP while maintain a zone of safety.
- (B) Request the EDP location history from the dispatcher.
- (C) Alert the radio dispatcher that you have arrived at the scene.
- (D) Decide if additional personnel/ equipment is necessary.



27. According to the information above, what does EDP stand for?

- (A) Erratically Disturbed Perpetrator
- (B) Erratically Disturbed Person
- (C) Emotionally Disturbed Person
- (D) Emotionally Distracted Person



Study the picture below for the next ten minutes. (Do not look at the questions). Try to remember as many details about the people and objects as you can. During the ten minutes, you are not permitted to take any notes or write anything.

At the end of ten minutes you will be asked to answer questions pertaining to the picture (without looking back at the picture).



28. How many tires does the New York City Police Department vehicle have?

- (A) 1
- (B) 3
- (C) 2
- (D) 4



29. What precinct is displayed on the New York Police Department vehicle?

- (A) 63
- (B) 73
- (C) 62
- (D) 83



30. How many helmet(s) are hanging off the New York Police Department vehicle?

- (A) 0
- (B) 2
- (C) 1
- (D) 3



31. What number is displayed on the helmet(s)?

- (A) 3671
- (B) 31671
- (C) 3167
- (D) 63171



Answer questions 32 and 33 based solely on the diagram above:

32. Based on the diagram above, how many bath(s) are in the house?
- (A) 0
 - (B) 1
 - (C) 2
 - (D) 3

33. Based on the diagram above, the horizontal wall of the balcony is how many square feet?

- (A) 21 S.F.
- (B) 10.5 S.F.
- (C) 50 S.F.
- (D) 60.5 S.F.



34. On September 1st, 2018, several murders were committed at different locations. Based on witnesses' descriptions, it is believed the same person committed all of the homicides. Investigating police officers are given the following description: The suspect is a Hispanic male, with short black hair, approximately 300 lbs., a rose tattoo on his forearm, and is wearing a teal trench coat.

Officer Dalton has stopped three Hispanic males for questioning. Which characteristic of the perpetrator provided by the witnesses should Officer Dalton consider the most helpful in identifying the suspect?

- (A) The suspect is wearing a teal trench coat.
- (B) The suspect has short black hair.
- (C) The suspect weighs approximately 300 lbs.
- (D) The suspect has a rose tattoo on his forearm.



35. Your command issued 400 tickets in January. Twenty percent of those tickets were for speeding. How many tickets were issued for speeding in the month of January?

- (A) 80
- (B) 70
- (C) 60
- (D) 90



Answer questions 36 through 39 based solely on the paragraph below:

On July 4th, 2018, at 11:30 P.M., Police Officers James and Kerry are dispatched to 721 West End Avenue, Apt 4, in regards to a past burglary. At 11:45 P.M., the officers arrive at the apartment where they observe the door moldings and hinges have been forced off the door. Samantha Telly, the tenant who lives in apartment 4 greets the officers. She tells them that she left her apartment around 10:00 A.M., on July 4th, 2018, and returned home around 11:20 P.M. She had spent the day with a friend celebrating the holiday.

Officer James urges Mrs. Telly to refrain from touching anything in the apartment. He notifies the patrol supervisor that the apartment shows signs of being burglarized. He then uses his department radio to request the Evidence Collection Team to respond to the scene to gather prints. As Mrs. Telly is searching her apartment she realizes her DVD player, and a shoe box with about \$2,000 from under her bed is missing.

The officers escort Mrs. Telly out of the apartment, and ask her to wait until the Evidence Collection Team responds to go back in. She agrees to leave the apartment.

Officers Kerry and James agree to interview the various tenants on Mrs. Telly's floor to see if they witnessed anything out of the ordinary. Officer Kerry knocks on the door of apartment 3, but nobody answers. He then moves to apartment 2, where he is greeted by Mr. Doland. Officer Kerry explains the situation, and asks if he had seen anything out of the ordinary throughout the day. Mr. Doland states he saw one man coming in and out of apartment 4 at 9:00 P.M. He thought Mrs. Telly was having a 4th of July party, so he didn't think anything of it. He described the perpetrator as a Hispanic male, 6'07", 250 lbs., wearing a purple shirt and black sweat pants.

Officer James knocks on the door of apartment 5, and is greeted by Mrs. Chau. He explains the events of the day, and asks if she had seen anything. Mrs. Chau stated she heard banging for about 10 minutes at 9:00 P.M., but was afraid to look who it was. She states Mrs. Telly and her boyfriend argue a lot, so she assumed she had kicked him out of the apartment, and he was the one banging on the door.

The Evidence Collection Team arrives at the scene around 12:15 A.M., and proceeds to take fingerprint samples. Officers Kerry and James begin the report for burglary.

36. According to the passage above, who lives in apartment 5?

- A) Mrs. Samantha Telly
- B) Mrs. Chau
- C) Mr. Doland
- D) Unknown, they did not answer the door



37. According to the passage, at what time did Mrs. Telly leave her apartment that day?

- A) 10:00 A.M.
- B) 11:30 P.M.
- C) 11:20 P.M.
- D) 10:00 P.M.



38. According to the passage, what is missing from Mrs. Telly's apartment?

- A) Shoe box only
- B) DVD player only
- C) Shoe box with \$2,000
- D) Shoe box with \$2,000 and a DVD player



39. According to the passage, the male perpetrator is?

- A) Hispanic
- B) Caucasian
- C) African-American
- D) Asian



40. Police Officer Simmons is patrolling East 20th Street when he witnesses a yellow sedan disobey a stop sign and hit a red SUV proceeding straight down 2nd Avenue. A tractor trailer behind the red SUV proceeded to rear end the vehicle when it was struck by the yellow car that failed to stop at the stop sign. Officer Simmons hurries to the intersection of the collision, and makes sure everyone is alright. After he makes sure everyone is okay, the operators of the vehicles and a civilian witness to the collision begin to tell Officer Simmons what exactly happened. Based on the above information, which of the following statements would be the **LEAST** accurate recollection of the collision?

- A) The operator of the yellow sedan states he made a complete stop at the stop sign when the red SUV was traveling at a high rate of speed striking his vehicle in the intersection.
- B) The operator of the red SUV states he was traveling down 2nd Avenue when the yellow sedan disregarded the stop sign on East 20th Street, striking his vehicle.
- C) The operator of the tractor trailer states the collision was a result of the yellow sedan disregarding the stop sign on East 20th Street.
- D) The witness states the tractor trailer rear ended the red SUV on 2nd Avenue after the yellow sedan struck the red SUV.

ANSWER KEY

Exam Booklet

1) C	9) B	17) C	25) B	33) B
2) A	10) D	18) C	26) D	34) D
3) A	11) B	19) A	27) C	35) A
4) D	12) A	20) B	28) C	36) B
5) A	13) D	21) D	29) A	37) A
6) B	14) C	22) D	30) C	38) D
7) C	15) A	23) D	31) B	39) A
8) D	16) D	24) C	32) B	40) A

Areas covered: Memorization, Deductive Reasoning, Inductive Reasoning, Information Ordering, Visualization.

