



OE692-TY
OE652-TY
OE69C-TY
OE65C-TY

TOYOTA O.E.M. PLUG & PLAY

Application Guide

Please read through this manual to familiarize yourself with your new speakers. Should your PowerBass Autosound speaker components ever require service, you will need to have the original dated receipt.



Thank you and Congratulations

Congratulations on your purchase of PowerBass Autosound speakers. You now own a speaker of uncompromising design and engineering from a factory that truly believes in the relentless pursuit of perfection. Incorporating the highest quality parts and state-of-the-art materials, these speakers display the ultimate balance between high fidelity, performance and long-lasting reliability.



At PowerBass USA, Inc. we are confident you will have many years of outstanding enjoyment from this great Component Speaker investment. For maximum performance we recommend that you have your new PowerBass Autosound product installed by an Authorized PowerBass Autosound Dealer.

⚠ Warning ⚠

Continuous exposure to sound pressure levels in excess of 100 dB can cause permanent hearing loss. PowerBass Autosound Speakers are capable of producing sound pressure levels well over 170 dB. Please observe all local sound ordinances while listening to your PowerBass Autosound system. PowerBass USA, Inc. accepts no liability for hearing loss, bodily injury, or property damage due to the result of use or misuse of this product.

POWERBASS Toyota OEM Plug & Play FEATURES

- Injection PP Cone
- Nylon OEM Speaker Basket
- 1" Silk Dome Tweeter on Coaxials, OE652-TY and OE692-TY
- 3/4" Inverted Titanium Dome Tweeter on Components Kits, OE65C-TY and OE69C-TY
- 20 oz. Magnet

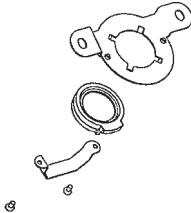

Fig 1
Bracket for tweeter,
assembly in dashboard



Fig 2
Connector for tweeter



Fig 3
Connector for Prius Tweeter

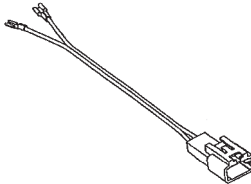

Fig 4
Extension Cable



Fig 5
Rivets

SPECIFICATIONS

(Due to Constant Improvements, Specifications and Parameters are subject to change without notice.)

Model #	Size	Nominal Impedance	Frequency Response	Sensitivity 1W/1M	Magnet Size	Mounting Depth	Power RMS/ Peak
OE692-TY	6x9"	4-ohm	65Hz - 20kHz	89 dB	20 oz.	1.8"	80W/160W
OE652-TY	6.5"	4-ohm	70Hz - 20kHz	88 dB	20 oz.	1.75"	60W/120W
OE69C-TY	6x9"	4-ohm	65Hz - 20kHz	89 dB	20 oz.	1.8"	80W/160W
OE65C-TY	6.5"	4-ohm	70Hz - 20kHz	88 dB	20 oz.	1.75"	60W/120W

Before beginning your installation, thoroughly read this guide and keep it as a reference. It will give you tips on proper placement, wiring, and installation as well as how to obtain the best sound from the PowerBass speakers you have selected.



COMPONENT TITANIUM TWEETER SPECIFICATIONS

DOMESIZE	NOMINAL IMPEDANCE	FREQUENCY RESPONSE	SENSITIVITY (1M / 1M)	POWER (RMS/PEAK)
3/4" Titanium	4Ω	3K-20Khz	91 dB	45/90

INSTALLATION EXPERIENCE

Installation of PowerBass Autosound Speakers requires experience with a variety of mechanical and electrical procedures. This manual only provides general installation and operation instructions. If you have any reservations about your installation skills or lack of the proper tools, please contact your local PowerBass Autosound dealer for assistance.

TIPS TO GET THE MOST OUT OF YOUR POWERBASS SYSTEM

Your PowerBass Autosound speakers have been meticulously engineered and designed to handle high power musical reproduction. Despite their rugged construction, it is possible to damage your speaker if they are improperly used. In general, you will hear distortion as a so-called warning before any damage occurs. If you hear distortion in your system, immediately reduce the musical level to the point where the sound retains its clarity.

1. Be sure you supply the speakers with enough unclipped amplifier power to drive them properly. **(More damage can be done to a speaker by under-powering and clipping your amplifier than any other way!)**
2. Where possible, a separate amplifier just for your speaker should be used with an electronic crossover to set the frequency range.
3. When connecting speaker wires from the amplifier or head unit to that of the speaker itself, pay attention to the polarity of the connection. This will insure optimum sound reproduction and performance.

PREPARING FOR INSTALLATION

NOTE: The tools listed below may be required for proper installation.

- An electric drill with drill bits
- Phillips-head and standard screwdrivers
- 10mm Socket
- Rivet Gun

INSTALLATION PRECAUTIONS

NOTE: Proceed only if you are a qualified installer otherwise; let your dealer do it.

- Always wear protective eyewear when using tools.
- Turn off all stereo and other electrical devices before you begin.
- Disconnect the (-) negative lead from your vehicle's battery.
- Keep the speakers in the package until final installation.

COMPONENT SYSTEM INSTALLATION

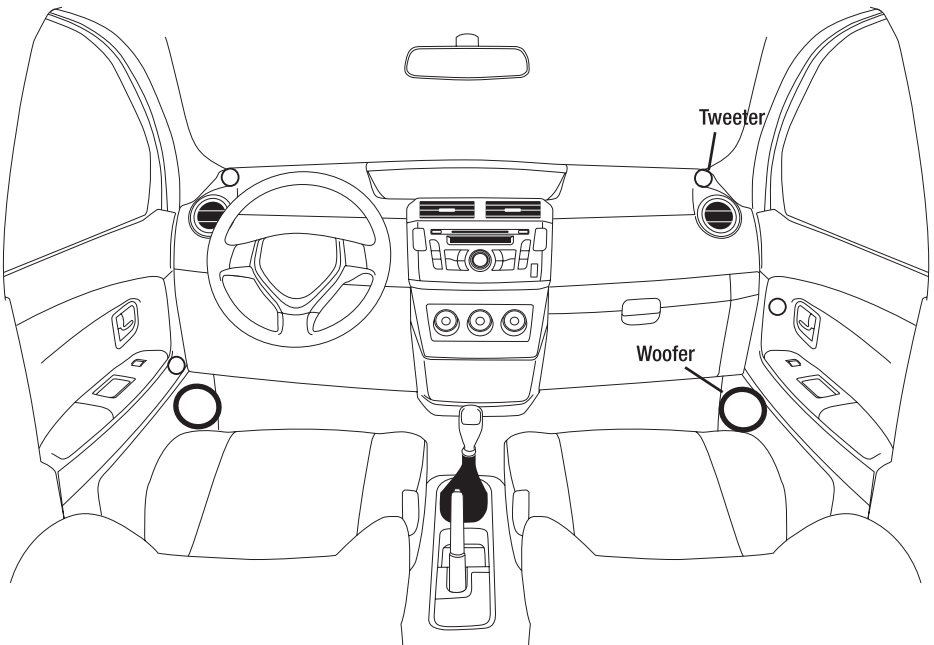

Fig 6

6X9" SPEAKER INSTALL (OE692-TY, OE69C-TY)



1. After removing the door panel, unplug speaker plug from factory speaker.



2. To remove the factory speaker either drill out the 4 rivets or unscrew the 4 x 10mm bolts (do not discard these bolts you will need them to install your new speaker).



3. Remove factory speaker.



4. Now you're ready to install your new speaker.



5. Fit speaker in place and make sure all mounting holes line up. Install with the 4 supplied rivets (see fig 5, pg 4) using a rivet gun, or the 4 x 10mm bolts you removed from the factory speaker.



6. Now plug the factory speaker plug into the new speaker. If the factory plug is not long enough try to remove some of the tape on the wire to extend it or use the supplied extension cable (see fig 4, pg 4). Reinstall door panel afterwards.

6.5" SPEAKER INSTALL (OE652-TY, OE65C-TY)



1. After removing the door panel, unplug speaker plug from factory speaker.



2. To remove the factory speaker either drill out the 3 rivets or unscrew the 3 x 10mm bolts (do not discard these bolts you will need them to install your new speaker)

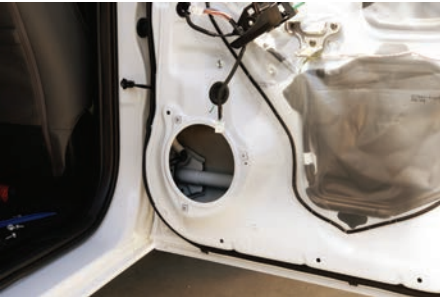

3. Remove factory speaker. Now you're ready to install your new speaker.



4. Fit speaker in place and make sure all mounting holes line up. Install with the 3 supplied rivets (see fig 5, pg 4) using a rivet gun, or the 3 x 10mm bolts you removed from the factory speaker.



5. Now plug the factory speaker plug into the new speaker. If the factory plug is not long enough try to remove some of the tape on the wire to extend it or use the supplied extension cable (see fig 4, pg 4). Reinstall door panel.

DASH TWEETER INSTALL (OE69C-TY, OE65C-TY)



1. Remove grill cover to gain access to the factory tweeter.



2. Remove the 2 x 10mm bolts unplug and remove factory tweeter (do not discard these bolts you will need them to install your new tweeters).



3. Now identify the speaker plug adapter you will need from the supplied parts (see fig 2 and fig 3, pg 4) plug the tweeter in the plug adapter then into the factory plug.



4. Install tweeter into the supplied metal adapter plate (see fig 1, pg 4) and install using the 2 x 10mm bolts you removed from the factory tweeter.



5. Reinstall factory tweeter grill cover.

DOOR TWEETER INSTALL (OE69C-TY, OE65C-TY)



1. Remove or un-clip tweeter cover/housing to gain access to the factory tweeter.



2. Unplug factory tweeter plug to remove tweeter housing.



3. Unclip factory tweeter from housing using a small pic tool.



4. Now install new tweeter by clipping it into the housing (some glue or modification may be necessary to install tweeter into factory location).



5. Now identify the tweeter plug adapter you will need from the supplied parts (see fig 2 and fig 3, pg 4) plug the tweeter into the adapter the into the factory plug.



6. Now reinstall the tweeter cover/housing back into the door.

LIST OF COMPATIBLE VEHICLES

OE652-TY | OE65C-TY

Applications

Lexus CT rear location 2009-2013
Lexus ES front and rear locations 2002-2006
Lexus GS front location 2006-2011
Lexus GX rear location 2003-2012
Lexus IS front location 2001-2012
Lexus IS rear location 2006-2012
Lexus RX front and rear locations 1999-2003
Pontiac Vibe front and rear locations 2003-2009
Scion TC front and rear locations 2005-2012
Scion XA front and rear locations 2004-2007
Scion XB front location 2004-2012
Scion XB rear location 2008-2012
Scion XD front and rear locations 2008-2011
Toyota 4Runner rear location 2003-2012
Toyota Avalon rear location 2005-2011
Toyota Celica front and rear locations 2000-2005
Toyota Corolla front location 2001-2012
Toyota Echo front location 2000-2005
Toyota Highlander rear location 2008-2012
Toyota Matrix front and rear locations 2002-2011
Toyota Prius front and rear locations 2001-2011
Toyota RAV4 front and rear locations 2001-2011
Toyota Sequoia front and rear locations 2008-2012
Toyota Sienna front and rear locations 1998-2012
Toyota Solara front location 1998-2003
Toyota Tacoma rear location 2005-2013
Toyota Tundra rear location 2000-2013
Toyota Tundra front location 2003-2006
Toyota Venza rear location 2009-2011
Toyota Yaris front location 2007-2012
Toyota Yaris lift back rear location 2007-2012

LIST OF COMPATIBLE VEHICLES

OE692-TY | OE69C-TY

Applications

Lexus CT Front Location 2009-2013
Lexus GX Front Location 2003-2014
Lexus LS Front Location 2007-2014
Lexus RX Front Location 2004-2014
Toyota 4Runner Front Location 2010-2014
Toyota 4Runner Front Location 2003-2009
Toyota Avalon Front Location 2005-2014
Toyota Camry Front Location 2002-2011
Toyota FJ Cruiser Front Location 2007-2014
Toyota Highlander Front Location 2008-2010
Toyota Land Cruiser Front Location 2008-2014
Toyota Prius Front Location 2010-2014
Toyota Sequoia Front Location 2008-2014
Toyota Solara Front Location 2004-2009
Toyota Tacoma Front Location 2005-2014
Toyota Tundra Front Location 2007-2014
Toyota Venza Front Location 2009-2014

POWERBASS AUTOSOUND LIMITED WARRANTY POLICY

PowerBass USA, Inc. offers limited warranty on PowerBass products under normal use on the following terms:

PowerBass Autosound Speakers are to be free of defects in material and workmanship for a period of one (1) year.

This warranty applies only to PowerBass products sold to consumers by Authorized PowerBass Dealers in the United States of America. Products purchased by consumers from a PowerBass dealer in another country are covered only by that country's Distributor and not by PowerBass USA.

This warranty covers only the original purchaser of PowerBass product. In order to receive service, the purchaser must provide PowerBass with the receipt stating the consumer name, dealer, product and date of purchase.

Products found to be defective during the warranty period will be repaired or replaced (with a product deemed to be equivalent) at PowerBass's discretion and will not be liable for incidental or consequential damages. PowerBass will not warranty this product under the following situations:

- **Speakers received with bent frames or water damage**
- **Abuse such as holes in the cone, surround or ripped spider**
- **Voice coil damage due to amplifier clipping or distortion**
- **Product that has not been installed according to this owners manual**

Any implied warranties including warranties of fitness for use and merchantability are limited in duration to the period of the express warranty set forth above. Some states do not allow limitations on the length of an implied warranty, so this limitation may not apply. No person is authorized to assume for PowerBass any other liability in connection with the sale of this product.

Residents of HI, AK and US territories will be charged for return shipping. All inquires regarding service and warranty should be sent to the above address.

Removed or altered serial numbers will void this warranty