

Report No.	:	XXXXXXXXXXXXXXXXXXXX	<input type="checkbox"/>	Re - Inspection
Product	:	7KG WASHING MACHINE	P/O No.	: XXXXXXXXXX
			Part.-No.	: XXXXXXXXXX
Client	:	XXXXXXXXXXXXXXXXXXXX	Order-Qty	: 150pcs
Supplier	:	XXXXXXXXXXXXXXXXXXXX		
Participants Supplier	:	/		
Date of Inspection	:	2013-10-14		
Place of Inspection	:	Jiangmen ,Guangdong,China.		

Sampling Standard	:	ANSI Z1.4-2003, Single Sampling Plan for Normal inspection, Level II								
Inspection Quantity	:	20pcs								
AQL Result	:	AQL Level			Defects Allowed			Result		
Critical: 0				Critical	Major	Minor	Critical	Major	Minor	
Major: 1.5		II	20	0	0	2	0	0	8	
Minor: 4.0		S1	3	0	0	0	0	0	0	
PSI passed	:									
PSI pending	:									
PSI failed	:			Pls see Remark No.A-B&1						

Remarks:

No.	Important Remarks	Refer Picture
A	Power cord length is 234-239cm.	
B	Hot and cord tube length is 200cm.	

No.	Defects Summary	Quantity	Refer Picture
1	Dirty on the surface	8	Pic.3-10

Red color- Critical defects Blue color- Major defects Black color- Minor defects

Inspection conducted by

Name(s) of Inspector(s)			Name of Reviewer		
2013-10-14	Chuck Shi		2013-10-15	Victor Zhang	
Date	Name	Signature	Date	Name	Signature

The inspection report reflects our findings at the time and place of inspection. This report does not relieve the seller/manufacturer of their contractual liabilities or prejudice from the buyer's right for compensation for any apparent and/or hidden defects not detected during our random inspection or occurring thereafter.

Defect Findings

1.	Critical Defects:	Description	Quantity	Picture
	<input type="checkbox"/>	None		
2.	Major Defects:	Description	Quantity	Picture
	<input type="checkbox"/>	None		
3.	Minor Defects:	Description	Quantity	Picture
	<input type="checkbox"/>	Dirty on the surface	8	Pic.1-8

Pic.1 Dirty on the surface



Pic.2 Dirty on the surface



Pic.3 Dirty on the surface



Pic.4 Dirty on the surface



Pic.5 Dirty on the surface

Pic.6 Dirty on the surface



Pic.7 Dirty on the surface



Pic.8 Dirty on the surface

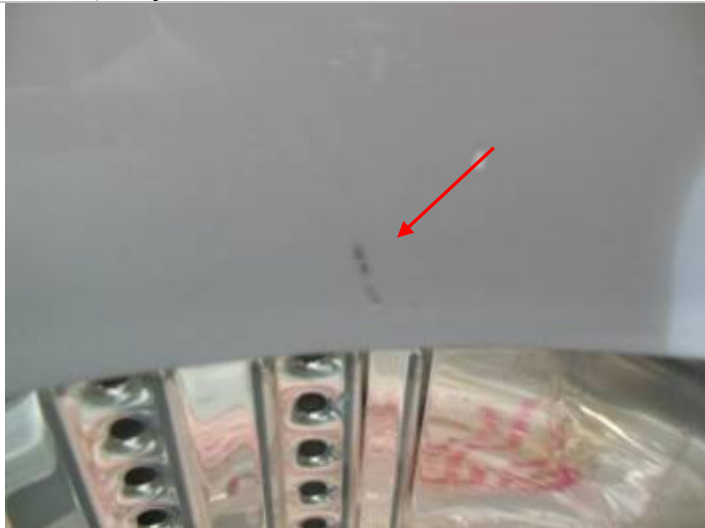

Ware house & Master carton:

Ware house view



Master carton view



Shipping mark client required

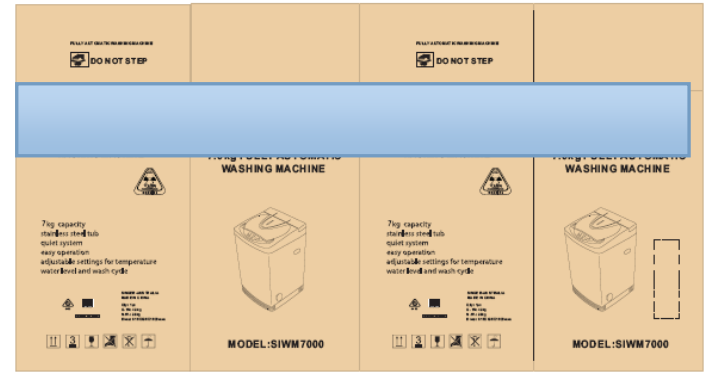

Actual shipping mark



Actual shipping mark



Actual shipping mark



Actual shipping mark

Actual shipping mark



Bar code client required

Actual bar code



Master carton packaging



Packing method:

- One product per master carton with accessories.

Report No.: **SIG0000126E**

HONOR INSPECTION
INTERNATIONAL LTD. NINGBO
REPRESENTATIVE OFFICE.

Rm.604,10th,Building,RongAnHeYuan
No.306,SongJiangDong-Road,YinZhou
Distric,NingBo City,China.

Tel: +86-574-88197698
Fax: +86-574-88197638-8

Email: report@honorinspection.com
Web: www.honorinspection.com

Drop Test ^(*):

Drop Number	Drop Orientation	Package Weight (lbs./kg)		Test Drop Height (in./cm)
		Equal to or greater than	But Less than	
1	Most fragile face-3 corner, if not known, test 2-3-5	0 / 0	21 / 10	30 / 76
2	Shortest edge radiating from the corner tested	21 / 10	41 / 19	24 / 61
3	Next longest edge radiating from the corner tested	41 / 19	61 / 28	18 / 46
4	Longest edge radiating from the corner tested	61 / 28	100 / 45	12 / 31
5	One of the smallest faces	100 / 45	150 / 68	8 / 20
6	Opposite small face	Tests may be performed using a free fall drop tester, vertical shock machine, incline impact tester or horizontal impact test system. Identify faces according to the diagram below.		
7	One of the medium faces			
8	Opposite medium face			
9	One of the largest faces			
10	Opposite large face			

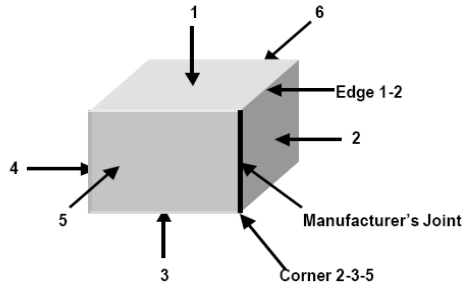







(*) SHIPPING DROP TEST I.A.W. ISTA 2A Version Date: June, 1999 - Revision Date: July, 2000

Quantity Tested: 1 carton
Carton Weight: 43 Kg
Drop Height: approx. 31 cm
Drop Sequence: 1 corners/3 edges/6 sides

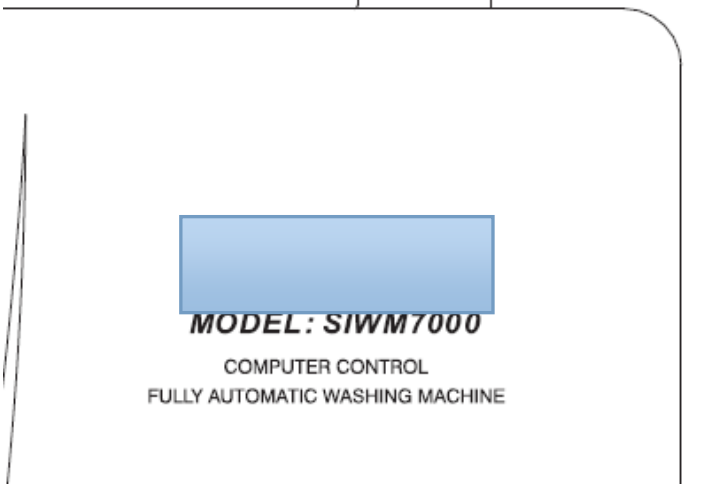
Result: N/A

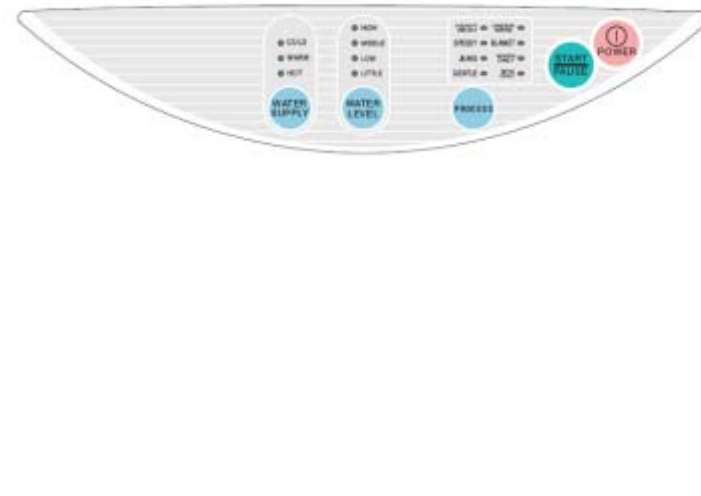
Drop test
N/A

Reference Pictures for Product:

<p>Logo client required</p> 	<p>Actual logo</p> 
<p>Imprint client required</p> 	<p>Actual imprint</p> 
<p>Warranty card client required</p> 	<p>Warning label actual view</p> 
<p>Label client required</p>	<p>Actual label</p>

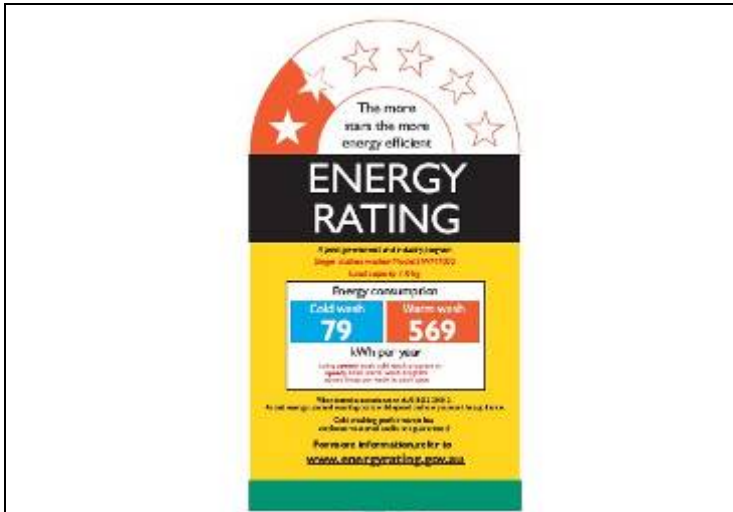

Label client required

Actual label



Rating label client required

Actual rating label

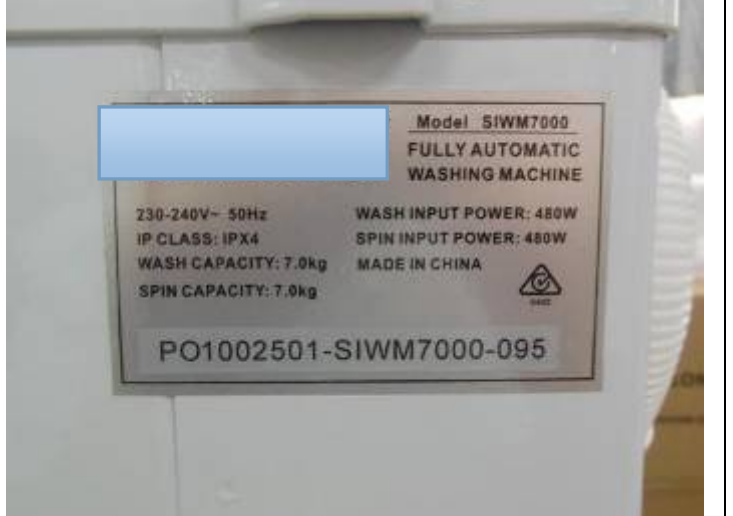
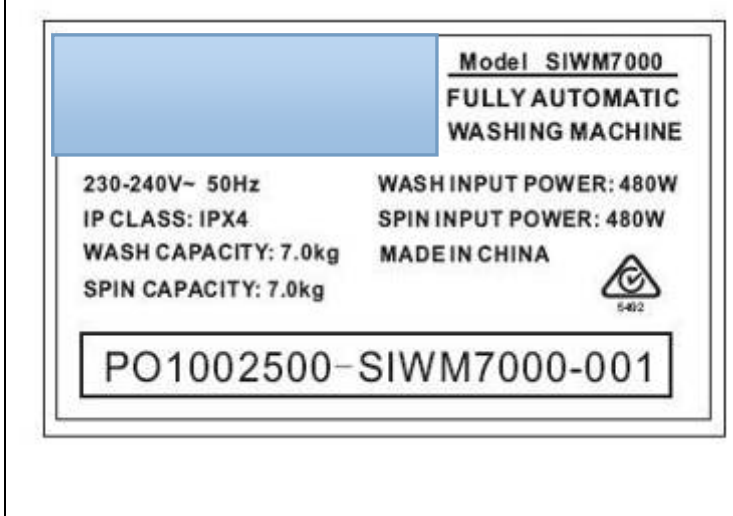

Warranty card client required

Actual warranty card

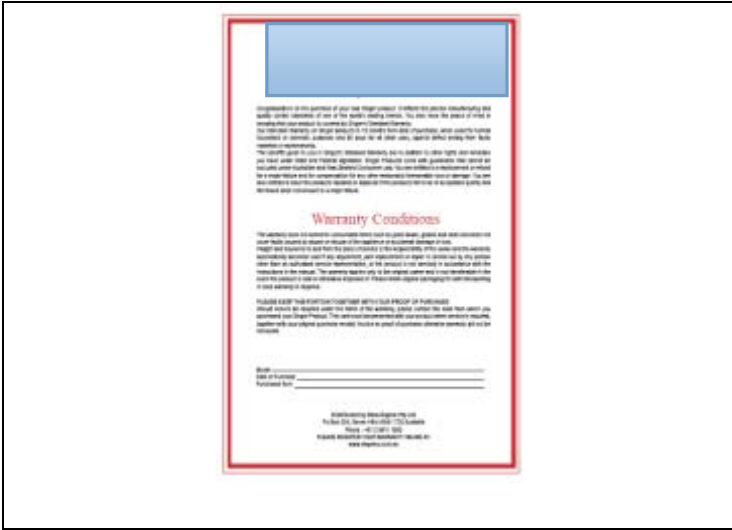

Warranty card dimension view

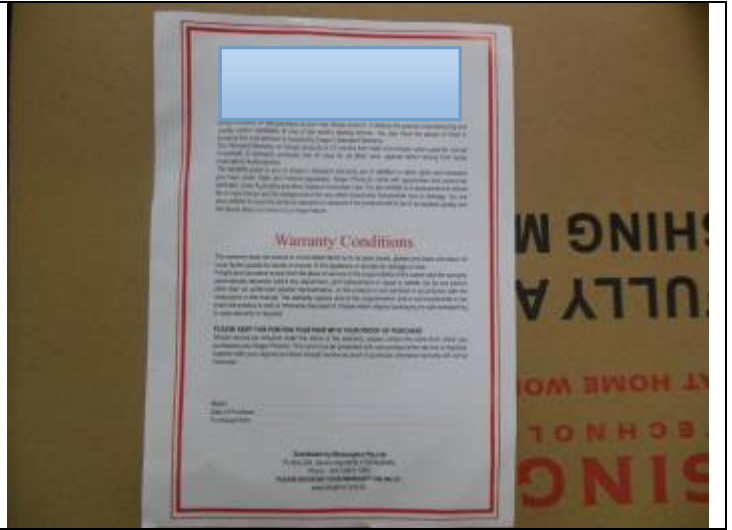

Warranty card dimension view



Product view

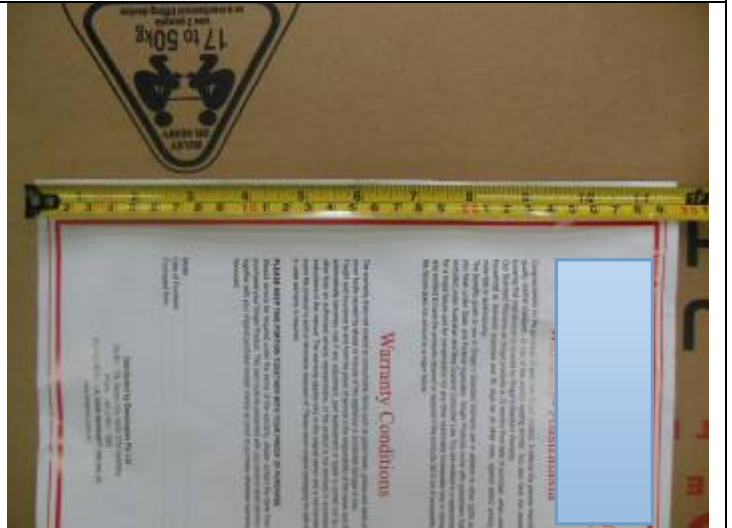

Product view



Product view



Product view



Product view



Product view



Product detail view



Product detail view



Product detail view



Product detail view



Product detail view



Product detail view



Product detail view



Product detail view



Product detail view



Product detail view



Product detail view



Product detail view



Product detail view



Product detail view



Product detail view



Product detail view



Product detail view



Product detail view



Product detail view

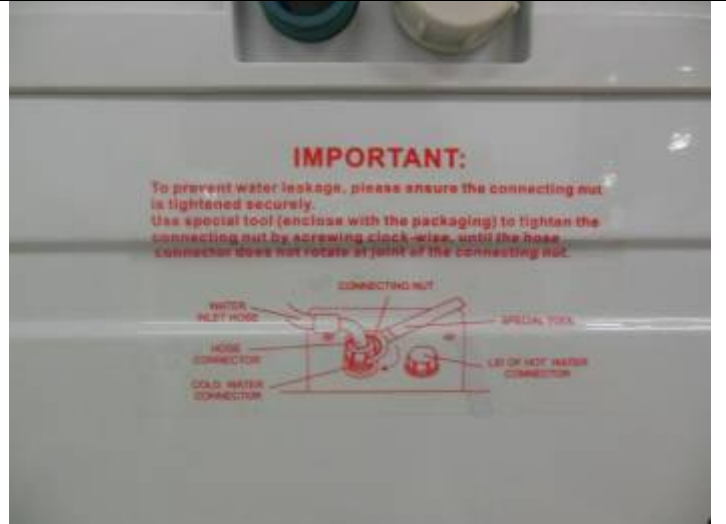

Product detail view



Accessories view



Accessories view



Accessories view



Accessories view



Accessories view



Accessories view



Accessories view



Accessories view

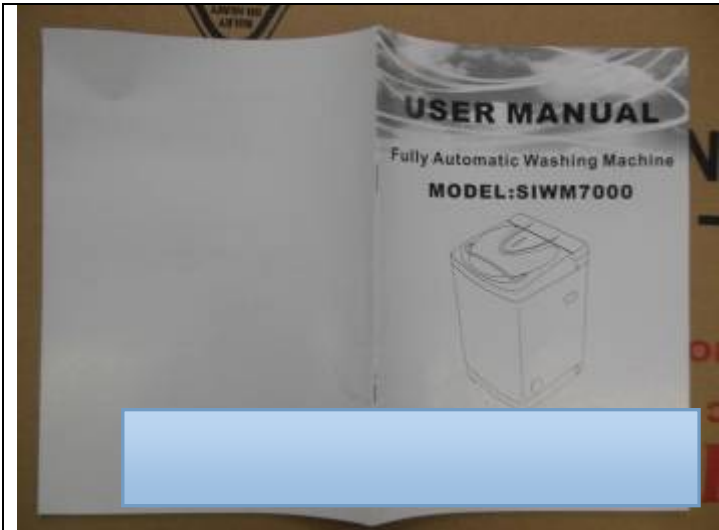

Accessories view



Accessories view



Accessories view



Reference Pictures for Testing:

Hi-pot test



Hi-pot test equipment view



Earth resistance test



Earth resistance test equipment view



Wattage test



Wattage test



Power cord tensile test

Power cord tensile test



Power cord length check



Power cord length check



1.1times rating voltage running test



1.1times rating voltage running test



0.85times rating voltage running test



0.85times rating voltage running test



Actual function check



Button sensitivity test



Button sensitivity test



Button sensitivity test



Bar code check



3M tape test

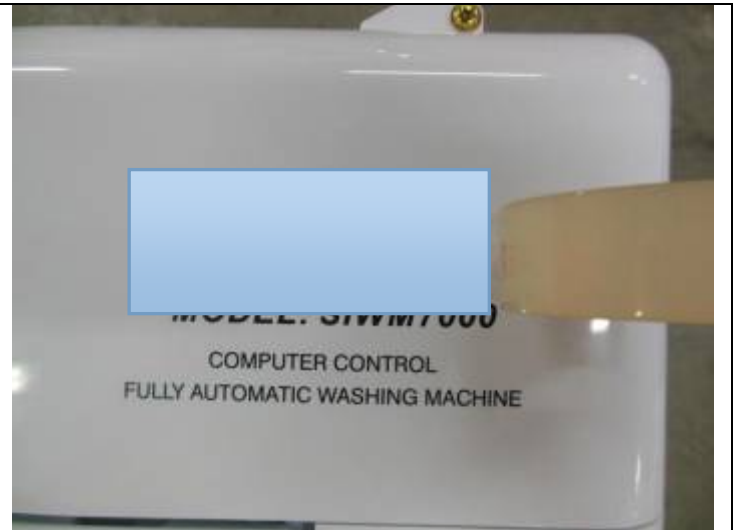

Foot adjust test

The opening height machine stop



List of Documents:

Documentation	Status			Detail
Order	<input type="checkbox"/> available	<input type="checkbox"/> not available	<input type="checkbox"/> N/A	Booking form
Specifications	<input type="checkbox"/> available	<input type="checkbox"/> not available	<input type="checkbox"/> N/A	Gift box /instruction sheet /logo etc
Drawings	<input type="checkbox"/> available	<input type="checkbox"/> not available	<input type="checkbox"/> N/A	
Production Instructions	<input type="checkbox"/> available	<input type="checkbox"/> not available	<input type="checkbox"/> N/A	
Test Instruction	<input type="checkbox"/> available	<input type="checkbox"/> not available	<input type="checkbox"/> N/A	
Instruction Manual	<input type="checkbox"/> available	<input type="checkbox"/> not available	<input type="checkbox"/> N/A	Use manual
OEM Certificate	<input type="checkbox"/> available	<input type="checkbox"/> not available	<input type="checkbox"/> N/A	
CE LVD	<input type="checkbox"/> available	<input type="checkbox"/> not available	<input type="checkbox"/> N/A	
CE MD	<input type="checkbox"/> available	<input type="checkbox"/> not available	<input type="checkbox"/> N/A	
CE EMC	<input type="checkbox"/> available	<input type="checkbox"/> not available	<input type="checkbox"/> N/A	
SAA certificate	<input type="checkbox"/> available	<input type="checkbox"/> not available	<input type="checkbox"/> N/A	SAA certificate for powder cord
Construction Data Form	<input type="checkbox"/> available	<input type="checkbox"/> not available	<input type="checkbox"/> N/A	
EMC Certificate	<input type="checkbox"/> available	<input type="checkbox"/> not available	<input type="checkbox"/> N/A	
ROHS	<input type="checkbox"/> available	<input type="checkbox"/> not available	<input type="checkbox"/> N/A	
Declaration of conformity	<input type="checkbox"/> available	<input type="checkbox"/> not available	<input type="checkbox"/> N/A	
Others	<input type="checkbox"/> available	<input type="checkbox"/> not available	<input type="checkbox"/> N/A	

This report consists of: (total 20 Pages)

<input checked="" type="checkbox"/> Annex I	Master Checklist	1 Page
<input checked="" type="checkbox"/> Annex II	Special test	1 Page
<input checked="" type="checkbox"/> Annex III	Critical & Main components list	Pages
<input checked="" type="checkbox"/> Annex IV		Page

This is the end of the report.

Annex I

Master Checklist

No. Categories	Inspection Items	Inspection comments	Cri	Maj	Min
General inspection (Level II)					
1	Quantity check	a.100% of total quantity	P		
2	Packaging check	a. Shipping mark	P		
		b. Packing method, material, assortment, and reliability	P		
3	Artworks check	a. Markings/ logos/ information on the gift-box / poly-bag/ product, barcode, etc.	P		
		b. Labels: marks, parameters, importer/ manufacturer name & address, warnings, etc.	P		
4	Appearance check	a. No sharp edge/point/burrs on accessible surface may hurt the user	P		
		b. Surface treatment: no broken/ flash/ dirt/ dust/ wet mark/ decay mark/mildew marks, etc on product surface	F		
		c. No visible assemble defects	P		
		d. Gap>1.5mm	P		
5	Safety Test	e. No components missing	P		
		a. Hi-pot test: For European: Class I: 1500Vac, 2S Class II: 3300Vac, 2S Class II transformer: 4000Vac For North America: 1500Vac, 2S	P		
		b. Leakage current test<5mA c. Earth resistance test<0.1ohm	P		
6	Function test	a. As per use manual check the function.	P		
Special test (S3/S1/1 product)					
7	Silk screen printing adhesion check	Use 3M tape test.	P		
8	Wattage test	W +5/-10% or < Rated Power.	P		
9	Temperature test	As per use manual.	N/A		
10	1.1times rating voltage running test	Function must be completely.	P		
11	0.85times rating voltage running test	Function must be completely.	P		
12	Thermal link	Thermostat short circuit, Thermal link must be work.	P		
13	Power cord tensile test	For European: <1kg, 30N;< 4kg, 60N; >4kg,100N For American: 156N,60S	P		
14	Barcode scanned test	Must be readable.	P		
15	Product inside check	As per client's bill of material list.	P		
16	Drop test on outer carton	Drop test for export carton. (1 carton)	N/A		

P -- Pass; F -- Fail; N/A -- Not applicable

Annex II

Special test

Measurement of parameter was performed on __3__ samples as below:

Item	Spec.	1	2	3			Result
1	Wattage test for washing	480W	374	374	380		P
2	Wattage test for spin	480W	267	277	270		P
3	Earth Resistance test	<0.10Ω	0.003	0.003	0.005		P
4	Cable length	>180cm	235	239	237		P
5	Button sensitivity	≤10N	2N	3N	7N		P
Remark							

Annex III

Critical & Main components list

No.	Component type	Type, characteristics, supplier	Components on the CDF	Result
1	Plug	LEONI N18514 323 7.5A 250V	Leoni Xiamen Electronics Co.,Ltd. 323 250V~7.5A AS/NZS 3112 Fair Trading 18514	P
2	Powder cord	VDE H05VV-F 3G 0.75m ² LEONI F 60227 IEC 53(RVV) 3x0.75 m ² 300/500V CCC A054065 N15071 V-75	Leoni Xiamen Electronics Co.,Ltd. H05VV-F 250/440V 3G 0.75 m ² AS/NZS3191 Fair Trading 15071	P
3	Safety switch	KXA-B 1A 250V AC 中山市小榄华能塑料电器厂 2013年05月 CQC03002003847	Zhongshan Xiaolan Hua Neng Plastic And Electric Appliance Factory KXA-B 250V~CQC03002003847	P
4	Water level sensor	Pressure Sensor CHGQ 6-H DC5V 10mA ShangHai Legang 2013Year 4Mouth	SHANGHAI LEGANG ELECTRIC CO.,LTD CHGQ6-H 5Vd.c	P
5	Water inlet valve	WV-21MD-3 AC 220-240V 50/60Hz USEONG 2013-7-29 J	Yantai Useong Electro-Mechanics Co.,Ltd WV-21MD-3 220-240V~50/60Hz	P
6	Capacitor	CBB60 12uF±5% 450V AC 05002012046 40/70/21 50/80Hz R50013434 CE 25/70/21 50/60Hz CIXI RIYI CAPACIOR FACTORY 2013 05	Cixi Riyi Capacitor Factory CBB60 450V~12uF±5% 40/70/21	P
7	Relay	SANYOU D73CG 15A 125VAC 7A 250V 10A 250V F-11 SRD-S-112DM	DONGGUAN SANYOU ELECTRICAL APPLIANCES CO.,LTD SRD-S-112DM 10A 250V~ GB/T21711.1 IEC61810-1	P
8	Motor	XDC-180A 180W T.P.L 230-240V 50Hz 1.4A CL.B 12uF/450V JLDJ 2013.8	JIANGMEN JINLING MOTOR CO.,LTD XDC-180A 230-240V 50Hz 180W Class 130(B)	P
9	Drain pump	B20-6 220-240V- 50HZ 30W CLF 2013.10	Jiangmen Idear-Hanyu Electrical joint-Stock Co.,Ltd B20-6 220-240V 50HZ 30W Class 155(F)	P
10	Electric retractor	电动式牵引器 QDYZ BTD-7 CQC03002003665 220V/50/60HZ 240V/50/60HZ 220V-240V/50/60HZ 220V-250/50/60HZ 绝缘等级 E 宁波市顺泰电器有限公司	Ningbo Shuntai Electrical Appilance Co., Ltd QDYZ 220V-250V50/60HZ	P
11	transformer	CQC Yixing 220v-240v 50/60HZ 10.1v 2W TYPE:EI-35 CQC03001003112	City Yixing Electric EI-35 220v 50HZ CQC03001003112 tested with the appliance at 230-240v ZhongshanGuZhenElectronFact ory	P

P -- Pass; F -- Fail; N/A -- Not applicable

Components photos

Plug	Cord(L=234-239cm)
------	-------------------

Report No.: SIG0000126E

Page 23 of 25

HONOR INSPECTION
INTERNATIONAL LTD. NINGBO
REPRESENTATIVE OFFICE.Rm.604,10th,Building,RongAnHeYuan
No.306,SongJiangDong-Road,YinZhou
Distric,NingBo City,China.Tel: +86-574-88197698
Fax: +86-574-88197638-8Email: report@honorinspection.com
Web: www.honorinspection.com



Safety switch

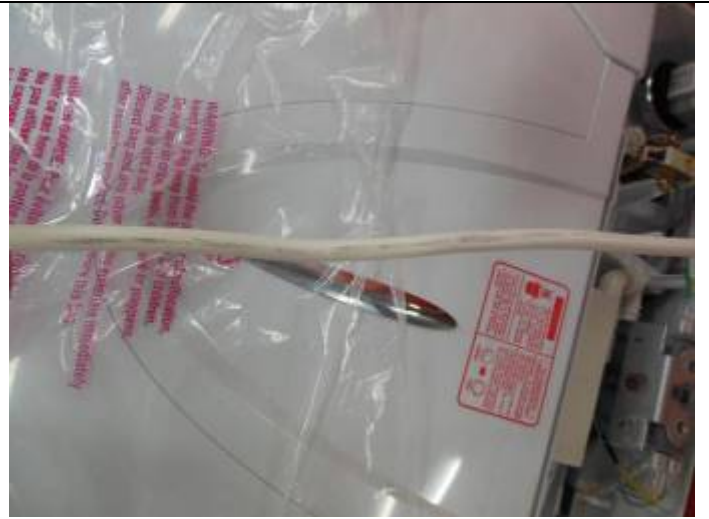

Water level sensor



Water inlet valve



Capacitor

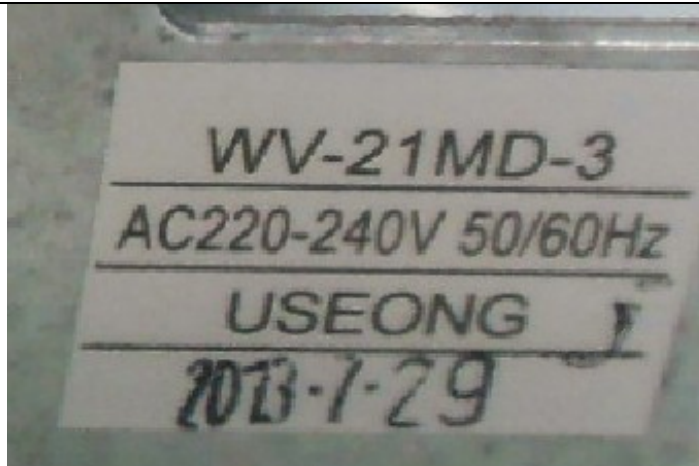

Relay



Motor



Drain pump

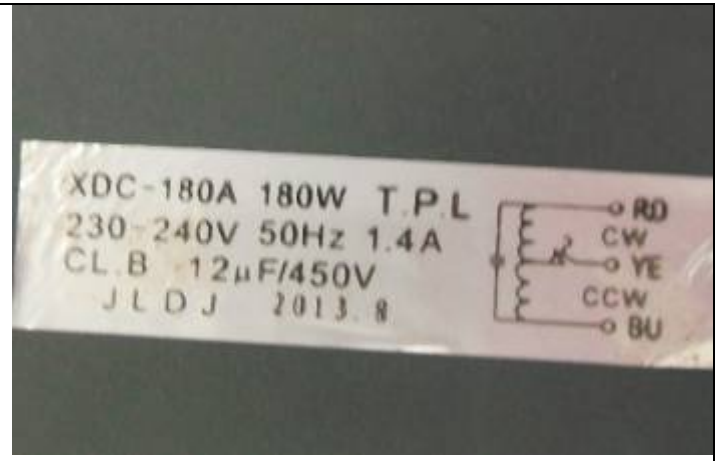

Electric traction



Transformer



This is the end of the report.