

**PRELIMINARY REPORT
on the
WINTER 2007 DRILL PROGRAM
BURNTBUSH PROPERTY
HOBLITZELL TOWNSHIP, ONTARIO**

Tri-Origin Exploration Ltd.

2.34143

**Ken Rattee, BSc
Consulting Geologist
Januray 27, 2007**

INTRODUCTION

The property is located about 20 km west of the Ontario / Québec border, approximately 120 km northeast of Cochrane, Ontario, and approximately 90 km northwest of La Sarre, Québec. Vehicle access to the property is via the all-weather gravel "Tomlinson Road", which departs north from the "Trans-Limit" road at kilometer 89 as measured from Cochrane.

The property consists of 7 unpatented contiguous claims comprised of 85 units covering a nominal 1,368 ha, in the southeast quadrant of Hoblitzell Township, Larder Lake Mining Division, Ontario. Surface rights are attached to the claims. All claims are in good standing until January 27, 2007. An area of mutual interest extends for 10 km exterior to the current claim boundaries.

The property is located in the Burntbush Greenstone Belt, which is situated in the northwest corner of the Archean age Abitibi Subprovince. The Burntbush Greenstone Belt continues eastward into adjacent Québec as the Harricana-Turgeon Greenstone Belt. This greenstone belt hosts the Matagami, Selbaie, Joutel and Casa-Berardi mining camps in Québec and the Detour Lake Mine in Ontario.

An east trending assemblage of felsic volcanic rocks and coeval porphyritic felsic intrusions post date assemblages of mafic and intermediate volcanic rocks present in the area. East-trending shear zones developed at the contacts of contrasting rock types are known locations of gold mineralization. Deformation is poorly documented in the area, but three phases of deformation are probably present, as is common in the rest of the greenstone belt.

A total of 64 historical diamond drill holes are spread over the entire length of the property and the historical gold intercepts represent targets for future drilling programs. Twenty-one of these holes reported at least one sample > 2 grams Au per tonne over a 1 metre intersection.

Gold mineralization on this property appears to be related to an oxidized hydrothermal fluid system. The gold mineralization predominantly occurs with pyritic quartz veins, hosted in felsic and mafic volcanic rocks and sediments. Alteration accompanying the gold mineralization includes sericite, hematite, magnetite, chlorite and minor tourmaline.

PROPERTY DESCRIPTION and LOCATION

The property is located about 20 km west of the Ontario / Québec border, approximately 120 km northeast of Cochrane, Ontario, and approximately 90 km northwest of La Sarre, Québec (Figure 1).

The property consists of 7 unpatented and un-surveyed contiguous claims comprised of 85 units covering a nominal 1,368 ha, in the southeast quadrant of Hoblitzell Township,

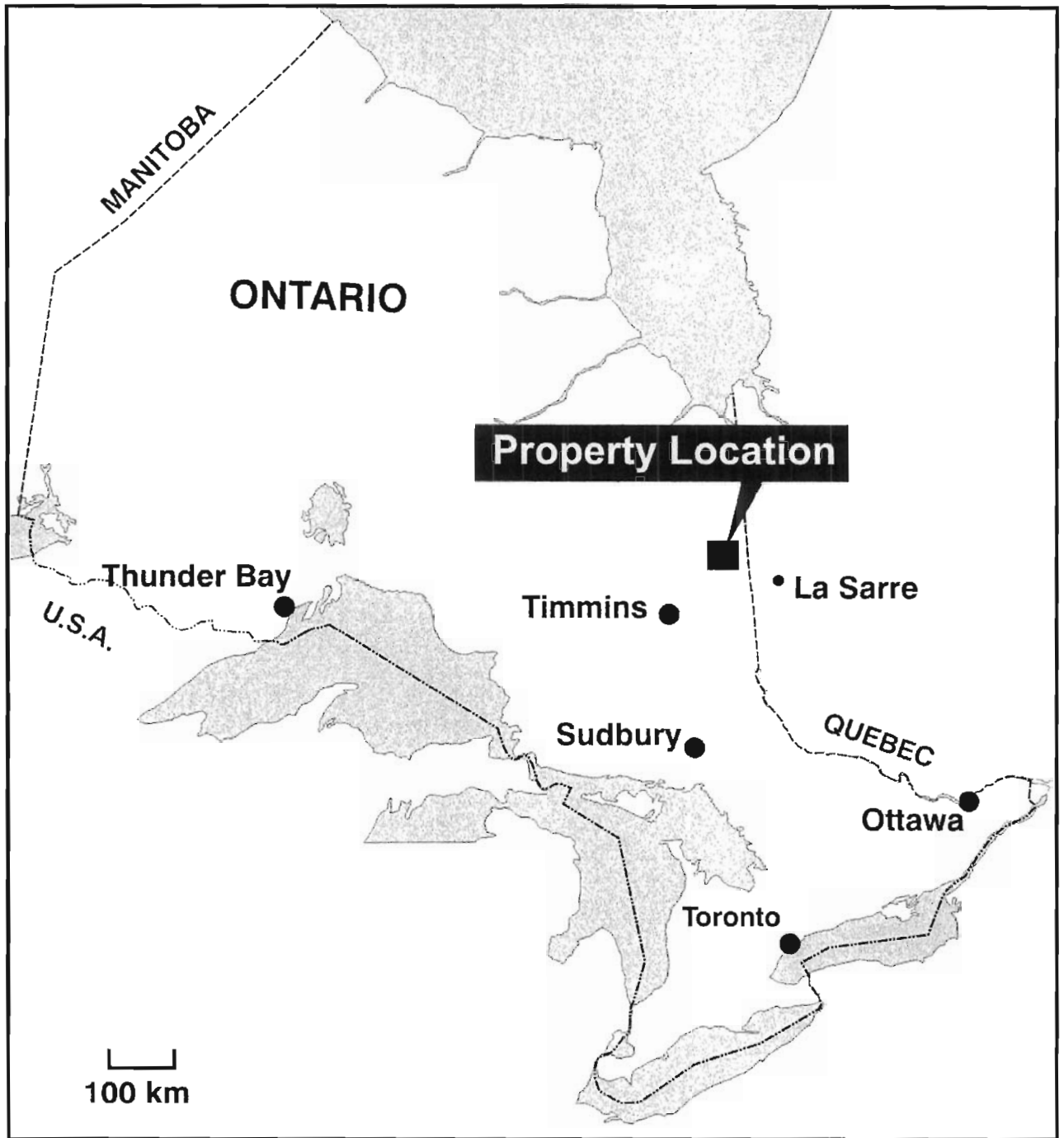

ROCKHAVEN RESOURCES INC.

General Location Map
Burntbush Project

Figure 1

Oct 2005

G.A. Harron & Associates Inc.

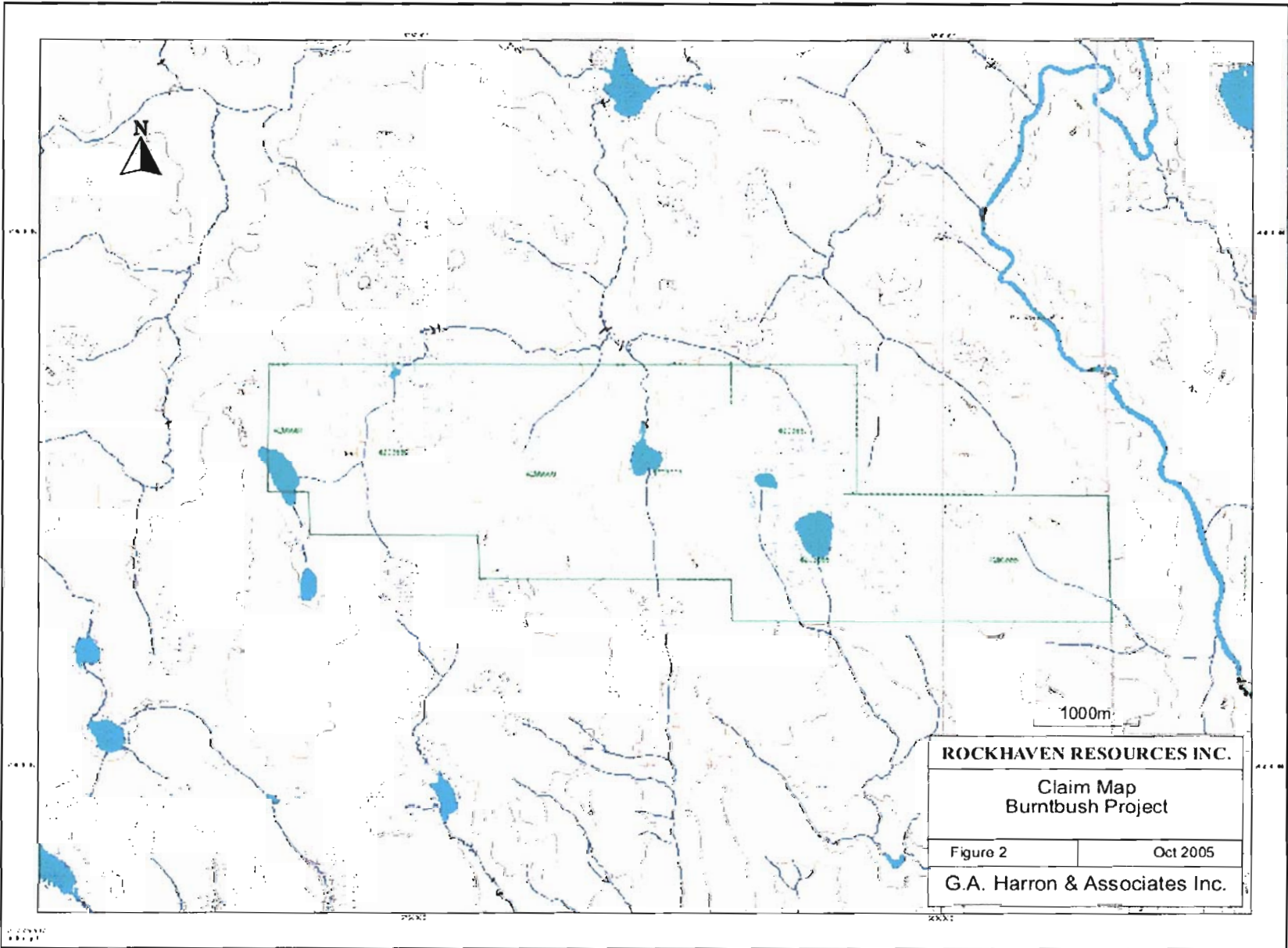

Larder Lake Mining Division, Ontario (Figure 2). Surface rights are attached to the claims.

REGIONAL GEOLOGY

The property is located in the Burntbush Greenstone Belt ("BGB") which is situated in the northwest corner of the Archean age Abitibi Subprovince. The BGB continues eastward in adjacent Québec as the Harricana-Turgeon Greenstone Belt ("HTGB"). This greenstone belt hosts the Matagami, Selbaie, Joutel and Casa-Berardi mining camps in Québec and the Detour Lake Mine in Ontario. The HTGB/BGB trends east west and is 60-90 km wide and extends over a distance of about 150 km. The northern and western boundaries correspond to the Opatica granite gneiss terrain, and the Mistawak, Boivin, Mistaouac, and Marest batholiths mark the southern boundary. Lacroix et al, (1990) provide a detailed description of the geology and mineral deposits contained in the HTGB portion of the greenstone belt.

In the Ontario portion the greenstone belt, four assemblages are recognized (Jackson and Fyon, 1991). From north to south the generally east-west trending assemblages are the Noseworthy, Blakelock, Bradette and St. Laurent (Figure 3).

The Noseworthy is comprised of sedimentary rocks dominated by upper greenschist facies argillaceous greywackes, mudstones, and conglomerates. The eastward extension of this assemblage probably corresponds with similar rocks located north of the Casa-Berardi deformation zone. On the Mine de Casa-Berardi property small volumes of gold mineralization of economic interest have been located in these rocks.

The Blakelock assemblage is characterized by a uniformly elevated magnetic signature and associated AEM conductors. It is interpreted to be mainly upper greenschist facies mafic volcanic rocks (tholeiites) with intercalated graphitic and sulphidic sedimentary rocks. Felsic volcanic rocks may underlie the eastern portion of the Blakelock assemblage (Johns, 1982). From a regional perspective, this assemblage appears to be equivalent to the mafic volcanics found in the Cartwright domain south of Mine de Casa-Berardi. The Cartwright domain composed of basaltic to komatiitic volcanic rocks interpreted as ocean floor volcanism capped by pelagic sedimentary rocks and oxide facies iron formations of the Tiabi Domain.

The Bradette assemblage consists of calc-alkalic dacitic and rhyolitic quartz phytic tuffs, lapilli tuff, pyroclastic breccia, tuff breccia and flows intercalated with graphitic sedimentary units (Johns, 1982). It is characterized by a subdued magnetic signature and numerous AEM conductors. In the eastern portion of the Bradette, a southwest-tending sinistral shear zone located near the interface between the Blakelock and Bradette assemblages is inferred on the basis deflected AEM conductors. The inferred shear zone may represent the western continuation of the Casa-Berardi deformation zone. This is plausible, as the Bradette is the probable westward continuation of the Dieppe domain in the Casa-Berardi area. The Dieppe Domain rests unconformably upon the Tiabi and

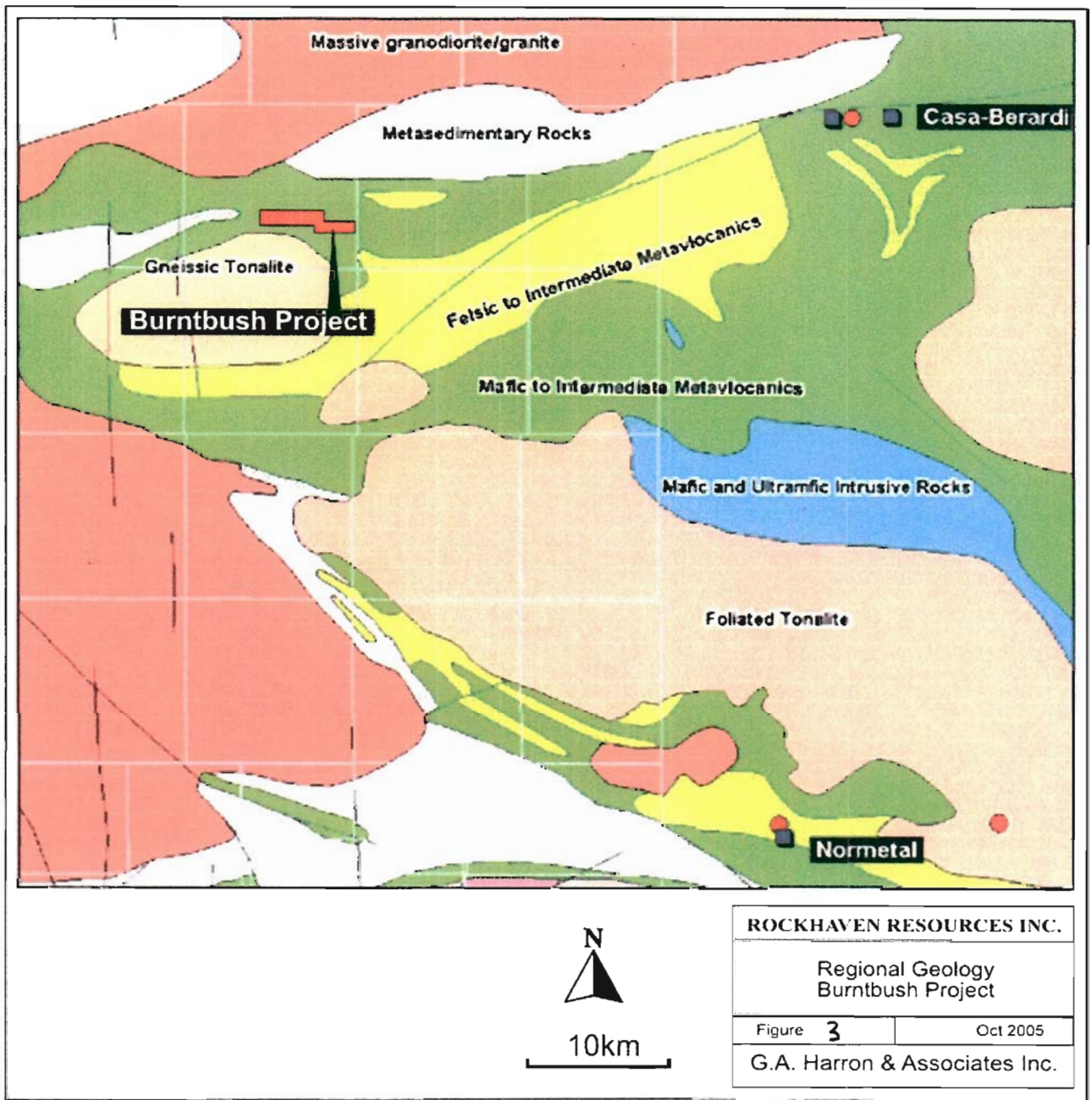

Cartwright domains. Volcanic rocks of this domain are mainly tholeiites with abundant chert horizons intercalated with the pillowed basalt rocks.

The St. Laurent assemblage consists of iron and magnesium-rich tholeiitic basalts and andesites, which are massive, pillowed, feldspar megacrystic or fragental. Minor ultramafic units are also present. The assemblage is characterized by a uniformly high magnetic signature and numerous west to northwest-trending AEM conductors. This assemblage is considered to be the western extension of the sedimentary rocks found south of the “Golden Pond Sequence”, a local component of the Taibi sedimentary domain in Casa-Berardi Township.

All of the lithotectonic domains are intruded by north-trending Proterozoic diabase dykes. Numerous deformation zones, from 100s to 1000s of m wide, traverse the HTGB/BGB terrane, with strike dimensions in the order of 10s to 100s of kms. They are highly schistose zones characterized by a dominantly ductile deformation style. The contacts of lithotectonic domains are commonly marked by graphitic sediments and are the sites of major deformation zones, such as the Casa-Berardi deformation zone.

PROPERTY GEOLOGY

The geology of the property (Figure 4) is largely known from a synthesis of drill core geology, overburden chip samples and geophysical interpretation, as the only known bedrock outcropping occurs in the L 126W vein area. Figure 5 is the first vertical derivative of the total field magnetic survey covering the current claims and illustrates the correlation between rock types and their magnetic signature. Low magnetic susceptibilities (cool colours) are related to felsic volcanic and sedimentary rocks. Higher values (hot colours) are related to mafic volcanic rocks and the development of magnetite marginal to the felsic porphyritic intrusions. Compilation maps of ground geophysical surveys have not been made for the Rockhaven property.

The northern part of the property is underlain by a mixed assemblage of felsic, intermediate and mafic volcanic rocks, which probably corresponds to the Blacklock assemblage. Felsic tuffs predominate in the western part of this belt and mafic volcanic flows and volcanoclastics are more common in the eastern part of this belt. Iron-rich sediments as banded magnetite – silica – amphibole +/- garnets occur along the northern contact of this assemblage. Drill information suggests a steep northerly dip for the lithologies. The SLSZ, which also dips north, defines the southern limit of this mixed volcanic belt.

The area to the south of the SLSZ is composed predominantly of mixed volcanic and volcanoclastic units of mafic to felsic composition intruded by the Spade Lake Porphyry. This assemblage probably correlates with Bradette assemblage. The Spade Lake Porphyry is a coarse grained felsic intrusion with a general granodiorite to granite composition.

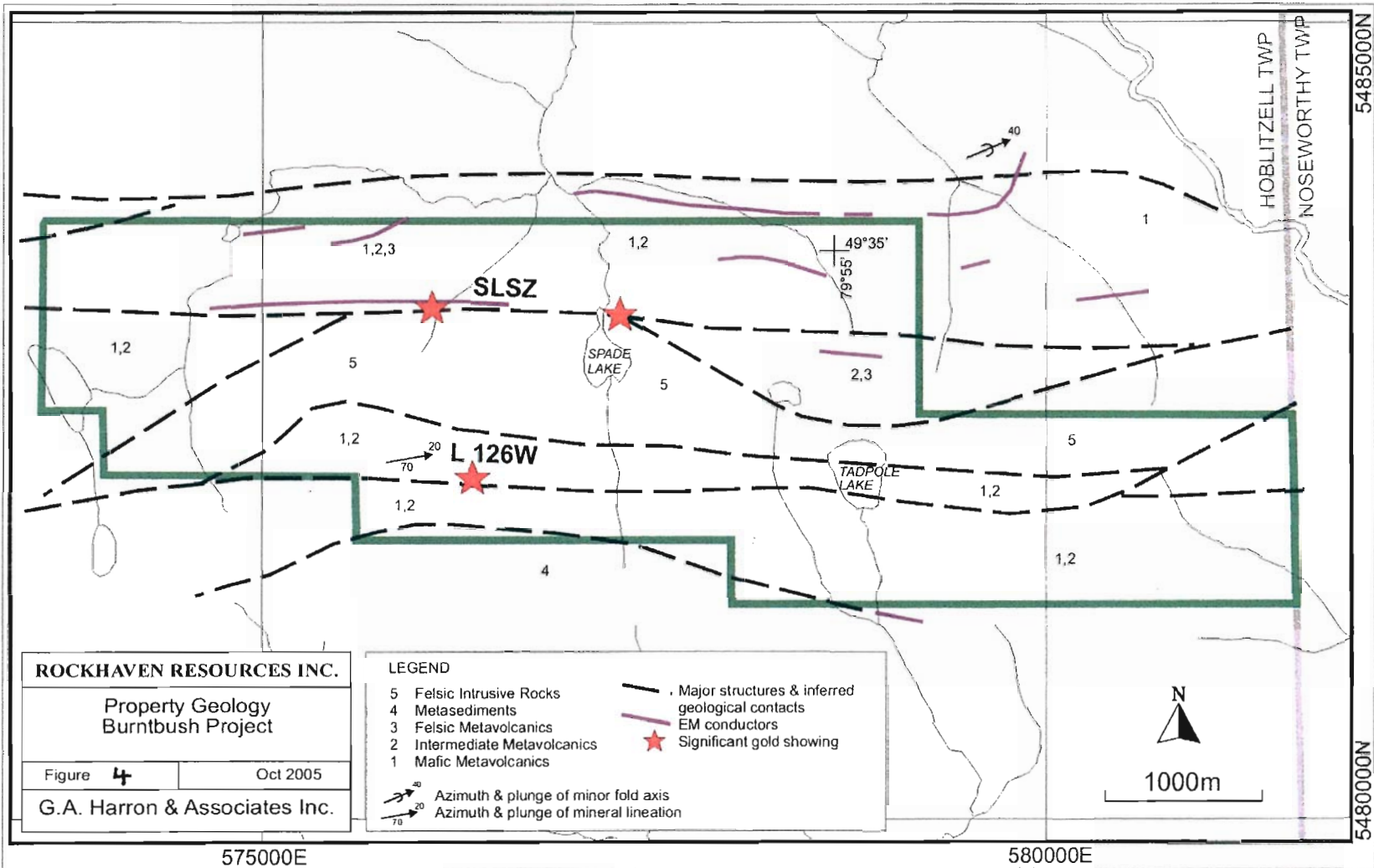

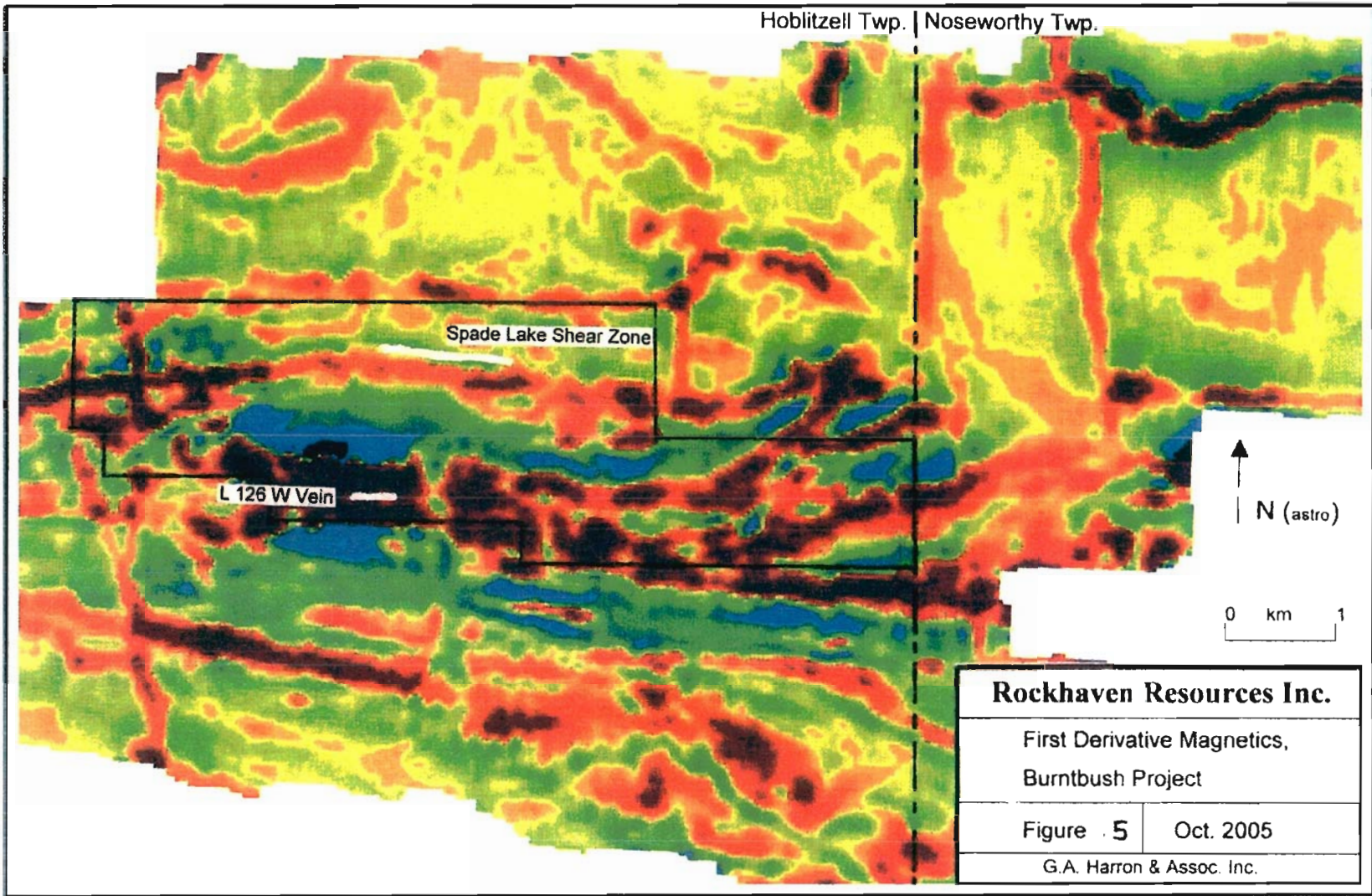

Shear zones and/or high strain zones of varying intensities appear to bound the porphyry body on both the north and south sides. Also contacts between the various lithologies are often high strain zones showing little lateral movement and offset.

Lying to the south of this belt is another mixed volcanic assemblage composed of intermediate to mafic volcanic flows, which dip steeply north and are cut by generally east-trending shear zones, such as the L 126W vein zone. A broad area of sedimentary rocks lies south of this volcanic assemblage along the southern margin of the property.

WINTER 2007 DRILL PROGRAM (PRELIMINARY)

In the winter of 2007 two holes were drilled on the property. The first hole drilled in the northern area of Claim #4203558 (DDH NA07-01) was to test the previously outlined Spade Lake Shear Zone. The second hole drilled in the southern area of Claim #4203559 (NA07-03) was to test an I.P. anomaly previously tested in a Newmont Exploration drill hole (DDH 261-86-1). It was the original intent to offset DDH NA07-03 approximately 100 metres to the east from the 261-86-1 drill hole, however poor winter conditions resulted in the planned location not being accessible for drilling and the hole was moved to a location approximately 40 metres to the east of 261-86-1.

DDH NA07-01: This hole was collared just north of Spade Lake and drilled south to test the Spade Lake Shear Zone. This mineralized zone is typically hosted in sheared felsic tuffs characterized by sericitization, hematitic alteration, recrystallization, strong foliation, disseminated pyrite and magnetite and the development of quartz-pyrite-chalcopyrite ribbons locally. The intent of this hole was to follow up on the previously drilled B98-02 drill hole drilled by Tri-Origin in 1998 which stopped short of the mineralized zone due to high azimuth down-the-hole deviation to the west.

The initial 80 metres of drill hole drilled through a sequence of felsic and crystal tuffs. Foliation and bedding measurements within this unit implies a north dip of between 55-75° for these units. Contacts between the ash and crystal tuff units were both sharp and gradational. Mineralization appeared poor in these units with only local sections of disseminated pyrite to 7% concentrations and numerous quartz-carbonate stringers to 6 cm. in thickness.

After a 12 metre section of the Spade Lake Porphyry a 78 metre section of Banded Ash Tuff was intersected corresponding to the Spade Lake Mineralized Shear Zone. Narrow sections of Spade Lake Porphyry intrude the deformed tuffs. The Banded Ash Tuff is characterized as a dark grey, fine-grained, silty to sandy ash, finely foliated and bedded throughout. Local pale grey, bleached sections impart a notable banded appearance to the unit. Narrow beds of high magnetite concentrations give the unit a high magnetic signature locally (Banded Iron Formations). Foliation and bedding measurements within this unit implies a north dip between 65-80°. Irregular quartz-carbonate stringers and veins to 40 cm. in thickness was abundant throughout this unit. Chalcopyrite and pyrite disseminations and coarse clots were often concentrated within and rimming these veins

and stringers. Chalcopyrite and pyrite mineralization was evident throughout this unit becoming notable between 92-134 metres in the hole. Pyrite commonly occurred as local disseminations to 9% concentration often adjacent to quartz-carbonate veins or as hairline stringers concordant to foliation or bedding within the tuff. Chalcopyrite commonly occurred as coarse clots to 2 cm. typically associated within or rimming quartz-carbonate veins.

The last 150 metres of the hole was dominated by the Spade Lake Porphyry. This Feldspar-Quartz Porphyry is characterized by 30-40% medium-coarse grained plagioclase and quartz phenocrysts in a finer-grained felsic matrix. The unit appeared poorly mineralized with only occasional weak disseminations of pyrite and minor coarse chalcopyrite clots associated with the occasional quartz-carbonate veins that cut the unit locally. Towards the end of the hole the porphyry was intruded by a 0.6 metre mafic dyke possibly lamprophyre. Gold and copper assays are currently pending from this hole.

DDH NA07-03: This hole was collared in the southern area of the claim group to test an I.P. anomaly outlined in earlier ground geophysics. It was initially intended that this hole would offset 100 metres east of the previously drilled hole 261-86-1, however poor winter ground conditions made this site inaccessible and the hole was moved to about 40 metres east of 261-86-01 where a site could be accessed

The initial 56 metres of drill hole drilled through a banded ash tuff unit similar to the banded tuff encountered in the Spade Lake Shear Zone approximately 1.5 kilometres to the north except pyrite and chalcopyrite mineralization was much weaker in this hole. As in the north this unit is characterized as dark to pale grey, fine-grained being a sandy ash with local sections of coarser clasts to 2 mm., and finely bedded and foliated with local sections becoming massive. Local pale grey, bleached sections impart a notable banded appearance to the unit. Beds of high magnetite concentrations give the unit a high magnetic signature locally (Banded Iron Formations). Foliation and bedding measurements within this unit implies a north dip of 65-80°. Irregular quartz-carbonate veins to 10 cm. thick are common throughout this unit generally concordant to foliation. Pyrite and chalcopyrite mineralization was most abundant as occasional coarse clots to 5 mm. rimming or within the quartz-carbonate veins though much weaker than the similar mineralization in the Spade Lake Shear Zone to the north. Only trace disseminations were evident in the tuff itself. Pyrrhotite was noted associated with 1-3 mm. quartz stringer at 53 metres. It is presumed the chalcopyrite and pyrite mineralization in this unit accounts for the moderate surface I.P. response slightly to the south of this unit in the hole which fits well with the north dip of 65-80° of this unit. The remaining 150 metres of this hole was a mix of an intermediate ash tuff and an intrusive, porphyritic granodiorite. The intrusive is characterized as a grey, medium-grained, porphyritic, somewhat siliceous unit with 10-40% plagioclase slightly coarser than the felsic matrix. Occasional quartz-carbonate veins to 10 cm. thick cut this unit. Pyrite and chalcopyrite mineralization was poor in this unit with just minor clots and trace to 5% disseminations associated with the quartz-carbonate veins.

The ash tuff is characterized as a dark grey, fine-grained, unaltered unit with fine bedding implying a north dip of 55-80°. Sulphide mineralization was weak throughout this unit with only local trace to 5% pyrite disseminations associated with the minor quartz-carbonate veining that cuts this unit. Gold assays are currently pending from this hole.

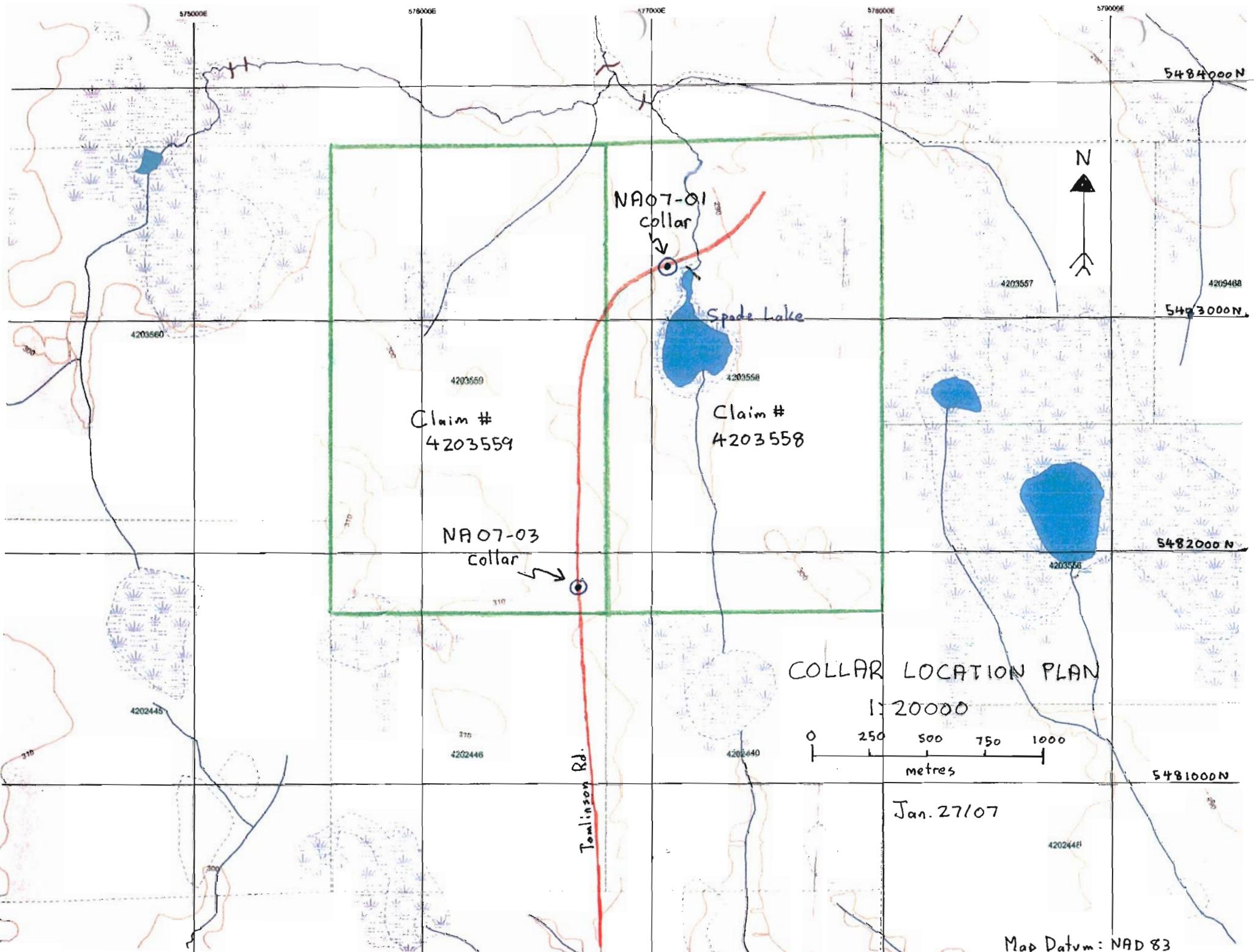

NA07-01 collar

Spade Lake

Claim #
4203559

Claim #
4203558

NA07-03 collar

Tomlinson Rd.

COLLAR LOCATION PLAN
1:20000

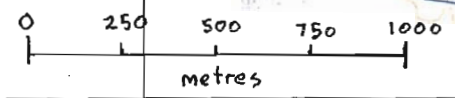

Jan. 27/07

Map Datum: NAD 83

Map Datum: NHD 83

576500E

577000E

LOCATION PLAN

NA07-03

1:2500

Jan. 27/07

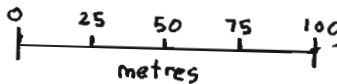

5482000N

Tamlinson Road

261-87-3
164m

261-87-7
241m

261-87-4
151m

South I.P. Anomaly

261-86-1
267m
NA07-03
200m
-45.2°

Map Datum: NAD 83

L53W



L52W

LOCATION PLAN
NA07-01
1:2500
Jan. 27/07

L51W

577100E

L50W

Spade Lake Creek

L49W

L48W

B98-03A
120m

Tomlinson Road

B98-03B
484m

B98-02
384m

Base Line

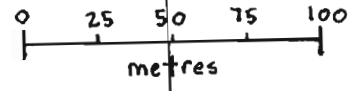

BUR-23
157m

NA07-01
281m
-44.1°

BUR-36
178m

BUR-26
202m

BUR-27
221m

BUR-19
215m

BUR-?
?

BUR-51
?

BUR-29
255m

5483100 N

Spade Lake

V. P. H.

SURFACE

188°

577075E
5483331N

bedrock
intervals sampled

- cross-section looking east
at 98°, perpendicular to the
plane of DDH NA07-01

CROSS-SECTION NA07-01

1:1000

Jan. 27/07

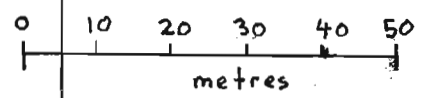

- Felsic Tuff
- Crystal Tuff
- Banded Ash Tuff (+/- Banded Fe)
- Feld.-Qtz Porphyry
- Lamprophyre Dyke

5483331N

5483200N

NA07-01
-44.1°
281.0m

SURFACE

South I.P. Anomaly

185°

576661 E
5481853 N

intervals
sampled

bedrock
cpv acv
cpv acv

po
cpv

cpv qv

qv
qtz + carb

NA07-03
-45.2°
200.0 m

- Ash Tuff
- Felsic Lapilli Tuff
- Banded Ash Tuff (+/- Banded Fe)
- Granodiorite

- cross-section looking east
at 95°, perpendicular to the
plane of DDH NA07-03

CROSS-SECTION NA07-03

1:1000

Jan. 27/07

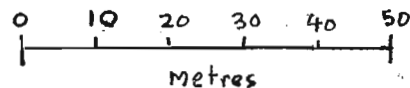

5481853 N

5481700 N

BIBLIOGRAPHY

Archer, R.A., 1986, Summary Report of 1986 Winter Field Program, Golden Shield Project – 261, Newmont Exploration of Canada Limited

Cadieux, I., 1990, Diamond Drill Results, 1990 Program, Burntbush River Project, Cogema Canada Limited, File 90-CDN-47-01

Fraser, D.C., 1987, Results of a Dighem Airborne Geophysical Survey, Burntbush River Project, for Cogema Canada Limited

Harron, G.A., 2005, Qualifying Report on Burntbush Property, Hoblitzell Township, Ontario for Rockhaven Resources Ltd.

Johns, G.W., 1982, Geology of the Burntbush-Detour Lakes Area, District of Cochrane, Ont. Geol. Surv., Report 199, 81 p., Map 2453

Learn, J., 1988a, Final Report 1987 Reverse Circulation Drilling, Burntbush River Project, Cogema Canada Limited File 87-CDN-47-04

Learn, J., 1988b, Final Report 1988, Contract Geophysics, Burntbush River Project, Cogema Canada Limited File 88-CDN-47-02

Learn, J., 1988c, Final Report 1988 Reverse Circulation Drilling, Burntbush River Project, Cogema Canada Limited File 88-CDN-47-01

Learn, J., 1989, Diamond Drill Results 1989 Program, Burntbush River Project, Cogema Canada Limited, File 89-CDN-47-02

Learn, J., 1991, Contract Geophysics 1989, 1990, Burntbush River Project, Cogema Canada Limited File 91-CDN-47-02

Learn, J., 1992, Final Report 1992 Field Program, Burntbush River Project, Cogema Canada Limited File # 92-CDN-47-01

Mandzuik, Z. and Perkins, M., 1997, Report on 1997 Exploration Program Burntbush Project for Tri Origin Exploration Ltd.

Mandzuik, Z. and Perkins, M., 1998, Report on 1998 Diamond Drill Program, Burntbush Project for Tri-Origin Exploration Ltd.

Newmont Exploration of Canada Ltd., 1987, Diamond drilling Report # 15, DDHs 261-86-1, 2

Newmont Exploration of Canada Ltd., 1988, Diamond drilling Report # 18, DDHs 261-87-1 to 8

Newmont Exploration of Canada Ltd., 1989, Diamond drilling Report # 19, DDHs 261-88-2, 7, 12

St. Jean, R. and Learn, J., 1988, Diamond Drill Results 1988, Cogema Canada Limited, File 88CDN-47-03

Smith, A.L., 1992, Report on Diamond Drilling, Hoblitzell Township, Northeastern Ontario for Aurizon Mines Limited

CERTIFICATE OF AUTHOR

I, Ken Rattee, of the town of Kirkland Lake, Ontario hereby certify:

- 1) I am a graduate from the University of Toronto, Toronto, Ontario having received a Bachelor of Science degree, Geology Major in 1980.
- 2) I have worked for 26 years as a Professional Geologist, predominately in the north-eastern Ontario area, as a production, exploration and consultant geologist.
- 3) I have no direct interest, nor do I expect to receive any interest in the 7 unpatented contiguous claims in Hoblitzell Township, Ontario that comprise the Rockhaven Resources JV with Tri-Origin Exploration Ltd.

Dated January 27, 2007



Ken Rattee, BSc

Ontario

Diamond Drilling Log / Journal de forage au diamant

Complete this form and related sketch in duplicate. Remplir en deux exemplaires la présente formule et le croquis annexé

Fill in on every page Remplir ces cases chaque page

Hole No. Forage n°: **NA07-01**
Page No. Page n°: **1**

*-units are in metres unless otherwise indicated

Drilling Company Compagnie de forage Heath & Sherwood Drilling Inc.	Core Size Dimensions de la carotte NA	Collar Elevation Élévation du collier 290 metres (surface)	Bearing of hole from true North/Position du forage par rapport au nord vrai 186.5°	Total Footage Avancement total du forage 281.0 metres	Dip of Hole at Collar 90° N Inclinaison du forage au Collar/collier -45°	Address/Location where core stored Adresse/endroit où la carotte est stockée Northern Gold Mining Inc. Office 1470 Government Rd. W. Kirkland Lake, Ont.	Map Reference No. N° de référence sur la carte G-3513	Claim No. N° de concession minière #4203558
Date Hole Started Date de commencement du forage Jan. 11, 2007	Date Completed Date d'achèvement Jan. 19/07	Date Logged Date d'inscription au journal Jan. 13-20/07	Logged by (print) Inscrit par (écrire en lettres moulées) Ken Rattee		28 m -45.1° 125m #/Pi -44.5° 242m #/Pi -42.2° FL/Pi ° FL/Pi °	Location (Twp. Lot, Con. Or Lat. And Long.) Emplacement (canton, lot, concession, ou latitude et longitude) Hoblitzell Township UTM coordinates (NAD83) 577075E 5483209N	Property Name Nom de la propriété Burntbush Property	
Drilling Co., Owner or Optionee Compagnie d'exploration, propriétaire ou titulaire d'option Tri Origin Exploration Ltd.			Logged by (Signature) Inscrit par (signature) <i>Ken Rattee</i>					

Footage/Avancement		Rock type	Description (Colour, grain size, texture, minerals, alteration, etc.)	Planar Feature Angle / Angle des caractéristiques planes	Core Specimen Footage / Longueur en pieds des carottes prélevées	Your Sample No. N° d'échantillon du prospecteur	Sample Footage Niveau de prélèvement de l'échantillon (en pieds)		Sample Length Longueur de l'échantillon	Assays/Analyses minéralurgiques
From/De	To/A	Type de roche	Description (Couleur, granulométrie, texture, minéraux, transformation, etc.)				From/De	To/A		
0.0	18.4	Casing								
18.4	19.3	Felsic Tuff	- grey, fg → mg, fairly massive with a subtle fol'n @ 60°; abundant hairline irregular chl fract's, minor carb fract's, local minor qtz. + feld. clasts to ~ 2mm, tr. fg → mg py locally conc. in Fract's, appears felsic, med. MAG			89751	18.9	19.3	0.4	
			@ 19.3 - sharp, contact with crystal tuff @ 85°							
19.3	20.4	Qtz-feld. Crystal Tuff	- grey, felsic tuff, 40% qtz. + feld., euhedral to subhedral, crystal clasts to 5mm, massive, grey, felsic tuff matrix cut by irregular chl. hairline fract's + minor carb fract's to 1cm, tr. fine py locally conc., non-MAG							
			@ 20.4 - sharply gradational contact with fel. tuff @ 65°							

2.34143

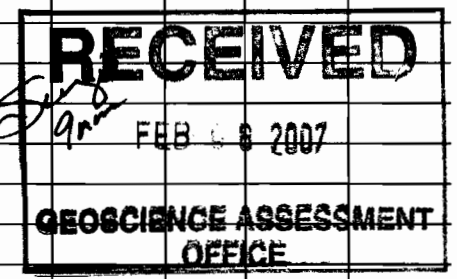

*For features such as foliation, bedding, schistosity, measured from the long axis of the core.

Drilling Company Compagnie de forage	Core Size Dimensions de la carotte	Collar Elevation Élévation du collier	Bearing of hole from true North/Position du forage par rapport au nord vrai	Total Footage Avancement total du forage	Dip of Hole at Collar 90° N Inclinaison du forage au Collar/collier	Address/Location where core stored Adresse/endroit où la carotte est stockée	Map Reference No. N° de référence sur la carte	Claim No. N° de concession minière
Date Hole Started Date de commencement du forage	Date Completed Date d'achèvement	Date Logged Date d'inscription au journal	Logged by (print) Inscrit par (écrire en lettres moulées)	FL/PI	°	Location (Twp. Lot, Con. Or Lat. And Long.) Emplacement (canton, lot, concession, ou latitude et longitude)	Property Name Nom de la propriété	
Exploration Co., Owner or Optionee Compagnie d'exploration, propriétaire ou titulaire d'option			Logged by (Signature) Inscrit par (signature)	FL/PI	°			
Tri Origin Exploration Ltd.				FL/PI	°			
				FL/PI	°			

Footage/Avancement		Rock type	Description (Colour, grain size, texture, minerals, alteration, etc.)	Planar Feature Angle * /Angle des caractéristiques planes	Core Specimen Footage / Longueur en pieds des carottes prélevées	Your Sample No. N° d'échantillon du prospecteur	Sample Footage Niveau de prélèvement de l'échantillon (en pieds)		Sample Length Longueur de l'échantillon	Assays/Analyses minéralurgiques	
From/De	To/A	Type de roche	Description (Couleur, granulométrie, texture, minéraux, transformation, etc.)				From/De	To/A			
20.4	22.4	Felsic Tuff / Crystal Tuff	-Fg, Fel. tuff with gtz-feld. crystal sections to 30 cm, up to 40% gtz → feld. crystal, subhedral to euhedral clasts locally abundant hairline chl fract's (irregular), minor carb-gtz. Fract's; crystal sections grades into clast-poor sections; non-MAG, 1-2% fine, dissem. py, locally conc.								
			21.6-22.4 - 2-3% fine py, locally conc. in fract's @ ~ 72°			89752	21.6	22.4	0.8		
			@ 22.4 - grades into a dominantly Fel tuff section								
22.4	23.5	Felsic Tuff	-dominantly Fa, Fel. tuff with only local crystal sect's. Fairly massive with a subtle fol'n @ ~ 70°, non-MAG, 2-3% fine, dissem. py			89753	22.4	23.5	1.1		
			@ 23.5 - fairly sharp cont'd with crystal tuff @ 67°								
23.5	24.1	Qtz-Feld. Crystal Tuff	-green felsic tuff, 35% gtz + feld., euhedral to subhedral crystal clasts to 5mm as described in previous section, 2-3% Fg → mag py, non MAG, 5% gtz-carb strar's @ ~ 60-80° to 5mm.			89754	23.5	24.1	0.6		

*For features such as foliation, bedding, schistosity, measured from the long axis of the core!

Drilling Company Compagnie de forage	Core Size Dimensions de la carotte	Collar Elevation Élévation du collier	Bearing of hole from true North/Position du forage par rapport au nord vrai	Total Footage Avancement total du forage	Dip of Hole at Collar 90° N Inclinaison du forage au Collar/collier	Address/Location where core stored Adresse/endroit où la carotte est stockée	Map Reference No. N° de référence sur la carte	Claim No. N° de concession minière
Date Hole Started Date de commencement du forage	Date Completed Date d'achèvement	Date Logged Date d'inscription au journal	Logged by (print) Inscrit par (écrire en lettres moulées)	°		Location (Twp. Lot, Con. Or Lat. And Long.) Emplacement (canton, lot, concession, ou latitude et longitude)	Property Name Nom de la propriété	
Exploration Co., Owner or Optionee Compagnie d'exploration, propriétaire ou titulaire d'option			Logged by (Signature) Inscrit par (signature)	°				
Tri Origin Exploration Ltd.				°				
				°				

Footage/Avancement		Rock type	Description (Colour, grain size, texture, minerals, alteration, etc.)	Planar Feature Angle / Angle des caractéristiques planes	Core Specimen Footage / Longueur en pieds des carottes prélevées	Your Sample No. / N° d'échantillon du prospecteur	Sample Footage / Niveau de prélèvement de l'échantillon (en pieds)		Sample Length / Longueur de l'échantillon	Assays/Analyses minéralurgiques		
From/De	To/À	Type de roche	Description (Couleur, granulométrie, texture, minéraux, transformation, etc.)				From/De	To/À				
			@24.1 - gradational contact with fal. tuff									
24.1	26.1	Felsic Tuff	- grey, fg to locally ma, generally massive with a slight local fol'n @ ~60-70°, local gtz + feld. clasts to 5mm, <20% clast abundance in these localized sect's, 5-7% fine dissemin py, non-MAG			89755	24.1	25.0	0.9			
						756	25.0	25.6	0.6			
						757	25.6	26.4	0.8			
			@24.4 - str. carb-chl. slip @ 67°									
			75.1-25.2 - black, fg chl mafic dyke @ 50°									
			@26.0 - sharp contact with mafic dyke @ 43°									
26.1	26.3	Chl. Mafic Dyke	- fg, black, aphanitic, chl-rich, massive, 10% hairline carb fract's @ ~50°, 1-2% fine py									
			@26.3 - sharp, contact with fal. tuff @ 55°									

*For features such as foliation, bedding, schistosity, measured from the long axis of the core.

Drilling Company Compagnie de forage	Core Size Dimensions de la carotte	Collar Elevation Élévation du collier	Bearing of hole from true North/Position du forage par rapport au nord vrai	Total Footage Avancement total du forage	Dip of Hole at Collar 90° N Inclinaison du forage au Collar/collier	Address/Location where core stored Adresse/endroit où la carotte est stockée	Map Reference No. N° de référence sur la carte	Claim No. N° de concession minière
Date Hole Started Date de commencement du forage	Date Completed Date d'achèvement	Date Logged Date d'inscription au journal	Logged by (print) Inscrit par (écrire en lettres moulées)	Logged by (Signature) Inscrit par (signature)	Location (Twp. Lot, Con. Or Lat. And Long.) Emplacement (canton, lot, concession, ou latitude et longitude)	Property Name Nom de la propriété		

Footage/Avancement		Rock type	Description (Colour, grain size, texture, minerals, alteration, etc.)	Planar Feature Angle / Angle des caractéristiques planes	Core Specimen Footage / Longueur en pieds des carottes prélevées	Your Sample No. N° d'échantillon du prospecteur	Sample Footage Niveau de prélèvement de l'échantillon (en pieds)		Sample Length Longueur de l'échantillon	Assays/Analyses minéralurgiques	
From/De	To/À	Type de roche	Description (Couleur, granulométrie, texture, minéraux, transformation, etc.)				From/De	To/À			
26.3	31.7	Felsic Tuff	grey, fg to locally mg, generally foliated with possible local bedding @ 70-80°, local bleached sect's pale grey abundant irregular hairline chl. fract's, 5-7% fg dissem. py, locally conc., non-MAG			89758	26.4	27.4	1.0		
						759	27.4	28.4	1.0		
						760	28.4	29.3	0.9		
						761	29.3	30.1	0.8		
						762	30.1	30.8	0.7		
			@ 30.8 - str. carb-chl. slip @ 75° with minor mud			763	30.8	31.7	0.9		
			@ 31.7 - sharply gradational contact with crystal tuff as clasts abruptly become prevalent								
31.7	36.9	Qtz.-Feld. Crystal Tuff	-grey felsic tuff with 20-40% qtz. + feld. euhedral to subhedral crystal clasts to 3 mm as described in previous interval, massive with a subtle fol. locally @ 55°-75°, non-MAG, 2-3% fg. dissem. py initially			89764	31.7	32.7	1.0		
						765	32.7	33.8	1.1		
			33.8-34.8 - py content increases to 5-7% fg to mg dissem.			89766	33.8	34.8	1.0		
			33.9-34.3 - 10% irregular bull qtz-carb fract's to 1cm, bleached, sericitized in this interval								

*For features such as foliation, bedding, schistosity, measured from the long axis of the core.

Ontario

Diamond Drilling Log

Journal de forage au diamant

Complete this form and related sketch in duplicate.
Remplir en deux exemplaires la présente formule et le croquis annexé

Fill in on every page
Remplir ces cases
chaque page



Hole No. Forage n°	Page No. Page n°
NA07-01	5

Drilling Company Compagnie de forage	Core Size Dimensions de la carotte	Collar Elevation Élévation du collier	Bearing of hole from true North/Position du forage par rapport au nord vrai	Total Footage Avancement total du forage	Dip of Hole at Collar 90° N Inclinaison du forage au Collar/collier	Address/Location where core stored Adresse/endroit où la carotte est stockée	Map Reference No. N° de référence sur la carte	Claim No. N° de concession minière
Date Hole Started Date de commencement du forage	Date Completed Date d'achèvement	Date Logged Date d'inscription au journal	Logged by (print) Inscrit par (écrire en lettres moulées)			Location (Twp. Lot, Con. Or Lat. And Long.) Emplacement (canton, lot, concession, ou latitude et longitude)	Property Name Nom de la propriété	
Exploration Co., Owner or Optionee Compagnie d'exploration, propriétaire ou titulaire d'option			Logged by (Signature) Inscrit par (signature)					
Tri Origin Exploration Ltd.								

Footage/Avancement		Rock type	Description (Colour, grain size, texture, minerals, alteration, etc.)	Planar Feature Angle / Angle des caractéristiques planés	Core Specimen Footage / Longueur en pieds des carottes prélevées	Your Sample No. N° d'échantillon du prospecteur	Sample Footage Niveau de prélèvement de l'échantillon (en pieds)		Sample Length Longueur de l'échantillon	Assays/Analyses minéralurgiques
From/De	To/A	Type de roche	Description (Couleur, granulométrie, texture, minéraux, transformation, etc.)				From/De	To/A		
			@ 35.3 - 2 cm. qtz. carb. Fract @ 33°			89767	34.8	35.8	1.0	
			@ 36.9 - sharply gradational contact with tel. tuff @ 68°			68	35.8	36.9	1.1	
36.9	43.3	Felsic Tuff	-grey, felsic tuff as described in previous intervals, slightly to mod. foliated throughout with possible local bedding generally @ 70-80°, non MAG, 3-7% fine dissem py locally conc.			89769	36.9	37.9	1.0	
						770	37.9	38.7	0.8	
			38.6-38.7 - 10 cm. chl. mafic dyke @ 50°, 1-2% fine py becomes highly conc. within 2 cm. of trailing contact							
			38.7-40.2 - tel. tuff becomes bleached, sericitized pale grey with primary texture somewhat obliterated							
			38.7-39.2 - 7-9% Fg, dissem. py			89771	38.7	39.2	0.5	
			39.2-40.2 - 3-5% Fg, dissem. py			89772	39.2	40.2	1.0	

*For features such as foliation, bedding, schistosity, measured from the long axis of the core.

Ontario

Diamond Drilling Log Journal de forage au diamant

Complete this form and related sketch in duplicate. Remplir en deux exemplaires la présente formule et le croquis annexé

Fill in on every page Remplir ces cases chaque page ⇒

Hole No. Forage n°	Page No. Page n°
NA 07-01	6

Drilling Company Compagnie de forage	Core Size Dimensions de la carotte	Collar Elevation Élévation du collier	Bearing of hole from true North/Position du forage par rapport au nord vrai	Total Footage Avancement total du forage	Dip of Hole at Collar 90° N Inclinaison du forage au Collar/collier	Address/Location where core stored Adresse/endroit où la carotte est stockée	Map Reference No. N° de référence sur la carte	Claim No. N° de concession minière
Date Hole Started Date de commencement du forage	Date Completed Date d'achèvement	Date Logged Date d'inscription au journal	Logged by (print) Inscrit par (écrire en lettres moulées)	FL/PI	°	Location (Twp. Lot, Con. Or Lat. And Long.) Emplacement (canton, lot, concession, ou latitude et longitude)	Property Name Nom de la propriété	
Exploration Co., Owner or Optionee Compagnie d'exploration, propriétaire ou titulaire d'option			Logged by (Signature) Inscrit par (signature)	FL/PI	°			
Tri Origin Exploration Ltd.				FL/PI	°			
				FL/PI	°			

Footage/Avancement		Rock type	Description (Colour, grain size, texture, minerals, alteration, etc.)	Planar Feature Angle / Angle des caractéristiques planes	Core Specimen Footage / Longueur en pieds des carottes prélevées	Your Sample No. N° d'échantillon du prospecteur	Sample Footage Niveau de prélèvement de l'échantillon (en pieds)		Sample Length Longueur de l'échantillon	Assays/Analyses minéralurgiques
From/De	To/A	Type de roche	Description (Couleur, granulométrie, texture, minéraux, transformation, etc.)				From/De	To/A		
			@ 39.4 - irregular 1-2 cm. qtz-chl-carb Fract @ ~10-25°							
			@ 39.6 - 3 cm. bull qtz Vn. @ 37°							
			40.2-41.7 - fel tuff with 3-5% fg, dissem py			89773	40.2	41.0	0.8	
						774	41.0	41.7	0.7	
			41.7 - 43.3 - 5-7% fg, dissem py locally conc. in hairline stringers @ 70-80°			775	41.7	42.4	0.7	
						776	42.4	43.3	0.9	
			@ 43.3 - grades into a qtz-feld. crystal tuff							
43.3	45.2	Crystal Tuff/ Felsic Tuff	50 cm. section of qtz-feld. crystal tuff (45.3-45.8) as described previously, grades into a felsic tuff as described previously, weak, subtle fol'n with the felsic tuff @ 75°, 1-2% fine py locally conc.			89777	43.3	44.3	1.0	
						778	44.3	45.2	0.9	
			@ 45.2 - fairly sharp contact with crystal tuff @ 60°							

*For features such as foliation, bedding, schistosity, measured from the long axis of the core.

Drilling Company Compagnie de forage	Core Size Dimensions de la carotte	Collar Elevation Élévation du collier	Bearing of hole from true North/Position du forage par rapport au nord vrai	Total Footage Avancement total du forage	Dip of Hole at Collar 90° N Inclinaison du forage au Collar/collier	Address/Location where core stored Adresse/endroit où la carotte est stockée	Map Reference No. N° de référence sur la carte	Claim No. N° de concession minière
Date Hole Started Date de commencement du forage	Date Completed Date d'achèvement	Date Logged Date d'inscription au journal	Logged by (print) Inscrit par (écrire en lettres moulées)	FL/PI	°	Location (Twp. Lot, Con. Or Lat. And Long.) Emplacement (canton, lot, concession, ou latitude et longitude)	Property Name Nom de la propriété	
Drilling Co., Owner or Optionee Compagnie d'exploration, propriétaire ou titulaire d'option			Logged by (Signature) Inscrit par (signature)	FL/PI	°			
Tri Origin Exploration Ltd.				FL/PI	°			
				FL/PI	°			

Footage/Avancement		Rock type	Description (Colour, grain size, texture, minerals, alteration, etc.)	Planar Feature Angle * /Angle des caractéristiques planes	Core Specimen Footage / Longueur en pieds des carottes prélevées	Your Sample No. N° d'échantillon du prospecteur	Sample Footage Niveau de prélèvement de l'échantillon (en pieds)		Sample Length Longueur de l'échantillon	Assays/Analyses minéralurgiques
From/De	To/A	Type de roche	Description (Couleur, granulométrie, texture, minéraux, transformation, etc.)				From/De	To/A		
45.2	45.9	Qtz.-Feld. Crystal Tuff	- as described previously, 25-35% Qtz + Feld, euhedral to subhedral crystal clasts to 4 mm, tr fg to mg py locally slightly conc., Non-MAG							
			@45.9 - contact with Fel. tuff lost in broken core.							
45.9	55.8	Felsic Tuff / Crystal Tuff	- Fg to locally mg fel. tuff as described previously grades into local sections of Qtz.-Feld. crystal tuff up to 50 cm in length, generally 1-2% fine, dissem py locally conc., non-MAG							
			@46.7 - 2 cm. Qtz.-carb strgr. @ 30°							
			47.0-50.0 - mix of Fel. tuff + crystal tuff with 3-5% fg to mg, dissem py			89779	47.0	48.0		
						780	48.0	49.0		
						781	49.0	50.0		
			@51.2 - 7 cm. bleached, sericitized section with a slight pink (hem? or K-spor?) alteration, moderately chl. Fractd (irregular), does not appear mineralized							

*For features such as foliation, bedding, schistosity, measured from the long axis of the core.

Ontario

Diamond Drilling Log Journal de forage au diamant

Complete this form and related sketch in duplicate. Remplir en deux exemplaires la présente formule et le croquis annexé

Fill in on every page Remplir ces cases chaque page

Hole No. Forage n°	Page No. Page n°
NA07-01	8

Drilling Company Compagnie de forage	Core Size Dimensions de la carotte	Collar Elevation Élévation du collier	Bearing of hole from true North/Position du forage par rapport au nord vrai	Total Footage Avancement total du forage	Dip of Hole at Collar 90° N Inclinaison du forage au Collar/collier	Address/Location where core stored Adresse/endroit où la carotte est stockée	Map Reference No. N° de référence sur la carte	Claim No. N° de concession minière
Date Hole Started Date de commencement du forage	Date Completed Date d'achèvement	Date Logged Date d'inscription au journal	Logged by (print) Inscrit par (écrire en lettres moulées)	FL/Pi	°	Location (Twp, Lot, Con. Or Lat. And Long.) Emplacement (canton, lot, concession, ou latitude et longitude)	Property Name Nom de la propriété	
Exploration Co., Owner or Optionee Compagnie d'exploration, propriétaire ou titulaire d'option			Logged by (Signature) Inscrit par (signature)	FL/Pi	°			
Tri Origin Exploration Ltd.				FL/Pi	°			
				FL/Pi	°			

Footage/Avancement		Rock type	Description (Colour, grain size, texture, minerals, alteration, etc.)	Planar Feature Angle / Angle des caractéristiques planes	Core Specimen Footage / Longueur en pieds des carottes prélevées	Your Sample No. N° d'échantillon du prospecteur	Sample Footage Niveau de prélèvement de l'échantillon (en pieds)		Sample Length Longueur de l'échantillon	Assays/Analyses minéralurgiques		
From/De	To/A	Type de roche	Description (Couleur, granulométrie, texture, minéraux, transformation, etc.)				From/De	To/A				
52.4	53.3		52.4-53.3 - 3-5% fine dissem py with minor ma → cg 'clots' of cpy associated with an irregular 5-10 mm qtz-carb string @ 52.5 @ ~15°			89782	52.4	53.3	0.9			
			@ 55.8 - Fairly sharp gradational contact with crystal tuff @ 75°									
55.8	56.8	Qtz.-Feld. Crystal Tuff	- as described previously with 20-35% qtz. + feld, euhedral to subhedral crystal clasts to 4 mm, tr fine dissem sulf, non-MAG									
			@ 56.8 - gradational contact with felsic tuff									
56.8	57.6	Felsic Tuff/ Crystal Tuff	- as described previously with local sections of qtz + feld, euhedral to subhedral crystal tuff to 60 cm in length, generally 1-2% fine dissem py, locally conc., locally mag @ 58.6									
			57.6-58.2 - 3-5% f ₀ to mg dissem py becomes conc. around 57.8 with clots of cg py + cpy to 2mm.			89783	57.6	58.2	0.6			

*For features such as foliation, bedding, schistosity, measured from the long axis of the core.

Drilling Company Compagnie de forage	Core Size Dimensions de la carotte	Collar Elevation Élévation du collier	Bearing of hole from true North/Position du forage par rapport au nord vrai	Total Footage Avancement total du forage	Dip of Hole at Collar 90° N Inclinaison du forage au Collar/collier	Address/Location where core stored Adresse/endroit où la carotte est stockée	Map Reference No. N° de référence sur la carte	Claim No. N° de concession minière
Date Hole Started Date de commencement du forage	Date Completed Date d'achèvement	Date Logged Date d'inscription au journal	Logged by (print) Inscrit par (écrire en lettres moulées)			Location (Twp. Lot, Con. Or Lat. And Long.) Emplacement (canton, lot, concession, ou latitude et longitude)	Property Name Nom de la propriété	
Exploration Co., Owner or Optionee Compagnie d'exploration, propriétaire ou titulaire d'option			Logged by (Signature) Inscrit par (signature)					
Tri Origin Exploration Ltd.								

Footage/Avancement		Rock type	Description (Colour, grain size, texture, minerals, alteration, etc.)	Planar Feature Angle / Angle des caractéristiques planes	Core Specimen Footage / Longueur en pieds des carottes prélevées	Your Sample No. N° d'échantillon du prospecteur	Sample Footage Niveau de prélèvement de l'échantillon (en pieds)		Sample Length Longueur de l'échantillon	Assays/Analyses minéralurgiques
From/De	To/À	Type de roche	Description (Couleur, granulométrie, texture, minéraux, transformation, etc.)				From/De	To/À		
			@59.6 - grades into a Fel. tuff							
59.6	65.7	Felsic Tuff	- grey, Fg to mg, locally highly fractured with abundant chl-carb fracture-filling, generally exhibits a subtle Fol'n @ 65.0-70. local crystal tuff sections (<10% of total length), tr-7% Fg to mg dissem. py, non-MAG							
			61.1-64.1 - 5-7% Fg to mg, dissem py with minor apy locally with fract's.			89784	61.1	62.1	1.0	
						85	62.1	63.1	1.0	
						86	63.1	64.1	1.0	
			@61.7 - 4 cm. QV @ 34°, tr py + cpy							
			@62.3 - 1 cm. q.c strgr. @ 50°							
			@63.5 - 2 cm. Qtz-carb-chl. Vn. @ 57°							
			63.7-64.1 - highly fract'd with irregular chl + carb + Qtz. Fract's + vuggy Qtz + carb filled blcks, py + cpy becomes conc. locally with fract's.							

*For features such as foliation, bedding, schistosity, measured from the long axis of the core.

Ontario

Diamond Drilling Log

Journal de forage au diamant

Complete this form and related sketch in duplicate.
Remplir en deux exemplaires la présente formule et le croquis annexé

Fill in on every page
Remplir ces cases
chaque page



Hole No. Forage n°	Page No. Page n°
N A 07-01	10

Drilling Company Compagnie de forage	Core Size Dimensions de la carotte	Collar Elevation Élévation du collier	Bearing of hole from true North/Position du forage par rapport au nord vrai	Total Footage Avancement total du forage	Dip of Hole at Collar 90° N Inclinaison du forage au Collar/collier	Address/Location where core stored Adresse/endroit où la carotte est stockée	Map Reference No. N° de référence sur la carte	Claim No. N° de concession minière
Date Hole Started Date de commencement du forage	Date Completed Date d'achèvement	Date Logged Date d'inscription au journal	Logged by (print) Inscrit par (écrire en lettres moulées)				Location (Twp. Lot, Con. Or Lat. And Long.) Emplacement (canton, lot, concession, ou latitude et longitude)	
Exploration Co., Owner or Optionee Compagnie d'exploration, propriétaire ou titulaire d'option			Logged by (Signature) Inscrit par (signature)				Property Name Nom de la propriété	
Tri Origin Exploration Ltd.								

Footage/Avancement		Rock type	Description (Colour, grain size, texture, minerals, alteration, etc.)	Planar Feature Angle / Angle des caractéristiques planes	Core Specimen Footage / Longueur en pieds des carottes prélevées	Your Sample No. N° d'échantillon du prospecteur	Sample Footage Niveau de prélèvement de l'échantillon (en pieds)		Sample Length Longueur de l'échantillon	Assays/Analyses minéralurgiques		
From/De	To/A	Type de roche	Description (Couleur, granulométrie, texture, minéraux, transformation, etc.)				From/De	To/A				
			@ 64.1 - 6 cm. QV @ 45° with tr fg to my py									
			@ 64.6 - 4 cm. Qtz. 'blow-out' associated with a 5mm qtz. string. @ 52°, doesn't appear mineralized									
			@ 65.7 - sharply gradational contact with crystal tuff @ 50°									
61.7	68.2	Qtz-Feld. Crystal Tuff	- as described previously, with 30-40% qtz + feld., euhedral to subhedral crystal clasts to 3 mm., 1-2% fg to my py, non-Mag									
			@ 66.2 - 4 cm Qtz-Carb Vn @ 53°, doesn't appear mineralized									
			67.2-67.4 - black fg, chl-rich Mafic Dyke @ 63°, abundant secondary carb									
			@ 68.2 - fairly sharp contact with fel. tuff along a 1 cm carb string @ 63°									

*For features such as foliation, bedding, schistosity, measured from the long axis of the core.

Ontario

Diamond Drilling Log

Journal de forage au diamant

Complete this form and related sketch in duplicate.
Remplir en deux exemplaires la présente formule et le croquis annexé

Fill in on every page
Remplir ces cases
chaque page



Hole No. Forage n°	Page No. Page n°
N A 07-01	11

Drilling Company Compagnie de forage	Core Size Dimensions de la carotte	Collar Elevation Élévation du collier	Bearing of hole from true North/Position du forage par rapport au nord vrai	Total Footage Avancement total du forage	Dip of Hole at Collar 90° N Inclinaison du forage au Collar/collier	Address/Location where core stored Adresse/endroit où la carotte est stockée	Map Reference No. N° de référence sur la carte	Claim No. N° de concession minière
Date Hole Started Date de commencement du forage	Date Completed Date d'achèvement	Date Logged Date d'inscription au journal	Logged by (print) Inscrit par (écrire en lettres moulées)	FL/PI	°	Location (Twp. Lot, Con. Or Lat. And Long.) Emplacement (canton, lot, concession, ou latitude et longitude)	Property Name Nom de la propriété	
Exploration Co., Owner or Optionee Compagnie d'exploration, propriétaire ou titulaire d'option			Logged by (Signature) Inscrit par (signature)	FL/PI	°			
Tri Origin Exploration Ltd.				FL/PI	°			
				FL/PI	°			

Footage/Avancement		Rock type	Description (Colour, grain size, texture, minerals, alteration, etc.)	Planar Feature Angle / Angle des caractéristiques planes	Core Specimen Footage / Longueur en pieds des carottes prélevées	Your Sample No. N° d'échantillon du prospecteur	Sample Footage Niveau de prélèvement de l'échantillon (en pieds)		Sample Length Longueur de l'échantillon	Assays/Analyses minéralurgiques	
From/De	To/A	Type de roche	Description (Couleur, granulométrie, texture, minéraux, transformation, etc.)				From/De	To/A			
68.2	75.9	Felsic Tuff	- as described previously, generally exhibits a subtle foln @ 65°-70°, local crystal tuff sections (LS% of total length), tr-zx. fg dissem. py								
			@ 70.1 - 7 cm. qtz - carb strgr. @ 52°								
			@ 72.4 - str. chl-qtz slip @ 75° (3 mm. seam)								
			@ 72.7 - 3 cm. Qtz. - Chl. Vn. @ 65°, doesn't appear mineralized								
			@ 75.6 - 1 cm. carb-qtz. strgr. @ 70°								
			@ 75.9 - sharp, contact with porph. @ 67°								
75.9	77.2	Feld.-Qtz Porphyry	- massive, greyish brown with a localized slightly red alteration, with 30-40% coarse-grained subhedral feld. + qtz. phenocrysts to 3 mm. in a finer-grained felsic (?) matrix, feld. phen's exhibit some carb replacement, minor tr. fine py, slightly MACs locally			89787 88	75.9 76.6	76.6 77.2	0.7 0.6		

*For features such as foliation, bedding, schistosity, measured from the long axis of the core.



Drilling Company Compagnie de forage	Core Size Dimensions de la carotte	Collar Elevation Élévation du collier	Bearing of hole from true North/Position du forage par rapport au nord vrai	Total Footage Avancement total du forage	Dip of Hole at Collar 90° N Inclinaison du forage au Collar/collier	Address/Location where core stored Adresse/endroit où la carotte est stockée	Map Reference No. N° de référence sur la carte	Claim No. N° de concession minière
Date Hole Started Date de commencement du forage	Date Completed Date d'achèvement	Date Logged Date d'inscription au journal	Logged by (print) Inscrit par (écrire en lettres moulées)				Location (Twp. Lot, Con. Or Lat. And Long.) Emplacement (canton, lot, concession, ou latitude et longitude)	
Drilling Co., Owner or Optionee Compagnie d'exploration, propriétaire ou titulaire d'option Tri Origin Exploration Ltd.			Logged by (Signature) Inscrit par (signature)				Property Name Nom de la propriété	

Footage/Avancement		Rock type	Description (Colour, grain size, texture, minerals, alteration, etc.)	Placer Fracture Angle * / Angle des caractéristiques planes	Core Specimen Footage / Longueur en pieds des carottes prélevées	Your Sample No. N° d'échantillon du prospecteur	Sample Footage Niveau de prélèvement de l'échantillon (en pieds)		Sample Length Longueur de l'échantillon	Assays/Analyses minéralurgiques	
From/De	To/A	Type de roche	Description (Couleur, granulométrie, texture, minéraux, transformation, etc.)				From/De	To/A			
			@ 77.2 - sharp contact with Fel. tuff @ 80°								
77.2	80.4	Felsic Tuff	- as described previously, only minor localized crustal tuff sections, more highly foliated than previous intervals (bedding) @ 60°-65°, 1-2% lg dissem py become more conc. part, non-MAG								
			@ 77.3 - 1 cm. qtz-calc strgr @ 48°								
			78.9-80.4 - 3-5% Fa to mg, dissem py locally conc, highly foliated (bedding?) @ 65-70°, py occasionally conc. along bedding strike's parallel to bedding			89789	78.9	79.6	0.7		
						790	79.6	80.4	0.8		
			@ 80.4 - sharp contact with porph. @ 67°								
80.4	92.4	Qtz-Feld. Porphyry	- as described in previous interval								
			@ 80.9 - Fract over 10 cm with irregular 1 cm qtz Fract's generally @ 45°-55°, 2-3% fa to ca br; possible tr. tourmaline; tr possible aspy			89791	80.4	81.1	0.7		

*For features such as foliation, bedding, schistosity, measured from the long axis of the core. somewhat reddened (hem.)



Drilling Company Compagnie de forage	Core Size Dimensions de la carotte	Collar Elevation Élévation du collier	Bearing of hole from true North/Position du forage par rapport au nord vrai	Total Footage Avancement total du forage	Dip of Hole at Collar 90° N Inclinaison du forage au Collar/collier	Address/Location where core stored Adresse/endroit où la carotte est stockée	Map Reference No. N° de référence sur la carte	Claim No. N° de concession minière
Date Hole Started Date de commencement du forage	Date Completed Date d'achèvement	Date Logged Date d'inscription au journal	Logged by (print) Inscrit par (écrire en lettres moulées)				Location (Twp. Lot, Con. Or Lat. And Long.) Emplacement (canton, lot, concession, ou latitude et longitude)	
Tri Origin Exploration Co., Owner or Optionee Compagnie d'exploration, propriétaire ou titulaire d'option Tri Origin Exploration Ltd.			Logged by (Signature) Inscrit par (signature)				Property Name Nom de la propriété	

Footage/Avancement		Rock type	Description (Colour, grain size, texture, minerals, alteration, etc.)	Planar Feature Angle / Angle des caractéristiques planes	Core Specimen Footage / Longueur en pieds des carottes prélevées	Your Sample No. / N° d'échantillon du prospecteur	Sample Footage / Niveau de prélèvement de l'échantillon (en pieds)		Sample Length / Longueur de l'échantillon	Assays/Analyses minéralurgiques		
From/De	To/A	Type de roche	Description (Couleur, granulométrie, texture, minéraux, transformation, etc.)				From/De	To/A				
			82.6-82.9 - slightly sheared @ 68°									
			84.5-85.0 - porph. becomes altered, reddened with primary texture somewhat obliterated associated with a 1-2 cm. irregular Qtz.-Carb. Musc. Fracture @ 45°, minor tr py			89792	84.5	85.0	0.5			
			@86.5 - 3 cm. QV @ 20°, not mineralized									
			88.4-88.8 - porph. becomes altered, reddened with primary texture somewhat obliterated associated with a series of 1 cm. Qtz. ± Musc. fract's @ irregular angle TCA, 1-2x. fg to mg py			89793	88.4	88.8	0.4			
			@90.3 - str. calc-carb slip @ 55°									
			@92.4 - sharp natural contact with banded ash tuff @ 70°									

*For features such as foliation, bedding, schistosity, measured from the long axis of the core.

Drilling Company Compagnie de forage	Core Size Dimensions de la carotte	Collar Elevation Élévation du collier	Bearing of hole from true North/Position du forage par rapport au nord vrai	Total Footage Avancement total du forage	Dip of Hole at Collar 90° N Inclinaison du forage au Collar/collier	Address/Location where core stored Adresse/endroit où la carotte est stockée	Map Reference No. N° de référence sur la carte	Claim No. N° de concession minière
Date Hole Started Date de commencement du forage	Date Completed Date d'achèvement	Date Logged Date d'inscription au journal	Logged by (print) Inscrit par (écrire en lettres moulées)				Location (Twp. Lot, Con. Or Lat. And Long.) Emplacement (canton, lot, concession, ou latitude et longitude)	
Drilling Company, Owner or Optionee Compagnie d'exploration, propriétaire ou titulaire d'option Tri Origin Exploration Ltd.			Logged by (Signature) Inscrit par (signature)				Property Name Nom de la propriété	

Footage/Avancement		Rock type	Description (Colour, grain size, texture, minerals, alteration, etc.)	Planar Feature Angle / Angle des caractéristiques planes	Core Specimen Footage / Longueur en pieds des carottes prélevées	Year Sample No. N° d'échantillon du prospecteur	Sample Footage Niveau de prélèvement de l'échantillon (en pieds)		Sample Length Longueur de l'échantillon	Assays/Analyses minéralurgiques
From/De	To/A	Type de roche	Description (Couleur, granulométrie, texture, minéraux, transformation, etc.)				From/De	To/A		
92.4	134.6	Banded Ash Tuff	- dark grey, fine-grained, silty to locally sandy ash, finely bedded + banded throughout generally @ 65-70°, moderately MAG throughout, 1-2% fg dissem py, locally conc, cut by numerous carb stringers concordant to bedding (~5% of total length)			89794	92.4	93.4	1.0	
						795	93.4	94.4	1.0	
			96.5-97.0 - 2-3% fg dissem sulf. becomes highly conc. with coarser clots to 2mm. + minor cpy around 96.7			89796	96.5	97.0	0.5	
			@ 98.3 - 2.5 cm QV @ 52°, not mineralized							
			98.5-98.9 - 1-2% fg dissem. py becomes highly conc. in a 2 cm. chl. fract. @ 98.7 @ 45°			89797	98.5	98.9	0.4	
			101.8-105.8 - banded ash tuff becomes slightly altered with local brownish sections							
			@ 102.2 - 4 cm. QV @ 55°							

*For features such as foliation, bedding, schistosity, measured from the long axis of the core.

Drilling Company Compagnie de forage		Core Size Dimensions de la carotte	Collar Elevation Élévation du collier	Bearing of hole from true North/Position du forage par rapport au nord vrai	Total Footage Avancement total du forage	Dip of Hole at Collar 90° N Inclinaison du forage au Collar/collier	Address/Location where core stored Adresse/endroit où la carotte est stockée	Map Reference No. N° de référence sur la carte	Claim No. N° de concession minière				
Date Hole Started Date de commencement du forage		Date Completed Date d'achèvement	Date Logged Date d'inscription au journal	Logged by (print) Inscrit par (écrire en lettres moulées)				Location (Twp. Lot, Con. Or Lat. And Long.) Emplacement (canton, lot, concession, ou latitude et longitude)					
Exploration Co., Owner or Optionee Compagnie d'exploration, propriétaire ou titulaire d'option Tri Origin Exploration Ltd.				Logged by (Signature) Inscrit par (signature)				Property Name Nom de la propriété					
Footage/Avancement		Rock type Type de roche	Description (Colour, grain size, texture, minerals, alteration, etc.) Description (Couleur, granulométrie, texture, minéraux, transformation, etc.)			Planar Feature Angle / Angle des caractéristiques planes	Core Specimen Footage / Longueur en pieds des carottes prélevées	Your Sample No. N° d'échantillon du prospecteur	Sample Footage Niveau de prélèvement de l'échantillon (en pieds)		Sample Length Longueur de l'échantillon	Assays/Analyses minéralurgiques	
From/De	To/A								From/De	To/A			
			@ 104.9 - bedding @ 60°										
			105.5-106.5 - banded ash tuff becomes locally mod. altered, reddish-brown, associated with carb fracturing concordant to bedding					89798	105.5	106.5	1.0		
			@ 106.3 - bedding @ 65°										
		*CPY	106.5-107.0 - tuff becomes highly fract'd, dolerized with 30% qtz-carb as irregular fract. + vug - filling to 5 cm, with massive CPY as irregular strag's to 2 cm. around 106.6, 30% cp; over 7 cm. centred @ 106.6					89799	106.5	107.0	0.5		
			107.0-109.1 - fairly fresh banded ash tuff with occasional qtz-carb strag's, 1-2% fr. disc. py+cp locally conc. in hairline strag's					89800	107.0	108.0	1.0		
								801	108.0	109.1	1.1		

*For features such as foliation, bedding, schistosity, measured from the long axis of the core.

Drilling Company Compagnie de forage	Core Size Dimensions de la carotte	Collar Elevation Élévation du collier	Bearing of hole from true North/Position du forage par rapport au nord vrai	Total Footage Avancement total du forage	Dip of Hole at Collar 90° N Inclinaison du forage au Collar/collier	Address/Location where core stored Adresse/endroit où la carotte est stockée	Map Reference No. N° de référence sur la carte	Claim No. N° de concession minière
Date Hole Started Date de commencement du forage	Date Completed Date d'achèvement	Date Logged Date d'inscription au journal	Logged by (print) Inscrit par (écrire en lettres moulées)				Location (Twp. Lot, Con. Or Lat. And Long.) Emplacement (canton, lot, concession, ou latitude et longitude)	
Tri Origin Exploration Ltd.			Logged by (Signature) Inscrit par (signature)				Property Name Nom de la propriété	

Footage/Avancement		Rock type	Description (Colour, grain size, texture, minerals, alteration, etc.)	Planar Feature Angle ° /Angle des caractéristiques planes	Core Specimen Footage / Longueur en pieds des carottes prélevées	Your Sample No. N° d'échantillon ou prospecteur	Sample Footage Niveau de prélèvement de l'échantillon (en pieds)		Sample Length Longueur de l'échantillon	Assays/Analyses minéralurgiques	
From/De	To/A	Type de roche	Description (Couleur, granulométrie, texture, minéraux, transformation, etc.)				From/De	To/A			
		* CPY	109.1-110.1 - tuff becomes altered, bleached (patchy) with 7-10% fa to ma cpz conc. locally as hairline strar's concordant to bedding @ 55°, cpz becomes highly conc. between 109.7-110.1 with ~15% cpz in this local interval as irregular strar's concordant to bedding to 3 mm associated with ptz. fract's + vugs to 8 mm centred @ 109.8 @ ~40° (banding flattens in this local interval)			89802	109.1	110.1	1.0		
		* CPY	110.1-110.9 - barren banded tuff, to fa cpz + p;			89803	110.1	110.9	0.8		
		* CPY	110.9-113.0 - tuff becomes altered, bleached (patchy) with 10-12% fa to ma cpz often conc. as hairline strar's concordant to bedding @ 65°, NOTE → bleached sections of tuff are not magnetic.			89804	110.9	112.0	1.1		
						805	112.0	113.0	1.0		
			110.9-111.1 - 15 cm. Qtz. ± calc. ± ank. Vn. @ 60°, Vn. itself appears barren.								
			@ 113.6 - 5 cm. Qtz. - Carb. Chl. Vn. @ 55°, Vn. itself appears barren								

*For features such as foliation, bedding, schistosity, measured from the long axis of the core.

Complete this form and related sketch in duplicate.
Remplir en deux exemplaires la présente formule et le croquis annexé

Fill in on every page
Remplir ces cases
chaque page



Hole No. Forage n°	Page No. Page n°
NA07-01	17

Drilling Company Compagnie de forage	Core Size Dimensions de la carotte	Collar Elevation Élévation du collier	Bearing of hole from true North/Position du forage par rapport au nord vrai	Total Footage Avancement total du forage	Dip of Hole at Collar 90° N Inclinaison du forage au Collar/collier	Address/Location where core stored Adresse/endroit où la carotte est stockée	Map Reference No. N° de référence sur la carte	Claim No. N° de concession minière
Date Hole Started Date de commencement du forage	Date Completed Date d'achèvement	Date Logged Date d'inscription au journal	Logged by (print) Inscrit par (écrire en lettres moulées)				Location (Twp. Lot, Con. Or Lat. And Long.) Emplacement (canton, lot, concession, ou latitude et longitude)	
Exploration Co., Owner or Optionee Compagnie d'exploration, propriétaire ou titulaire d'option			Logged by (Signature) Inscrit par (signature)				Property Name Nom de la propriété	
Tri Origin Exploration Ltd.								

Footage/Avancement		Rock type	Description (Colour, grain size, texture, minerals, alteration, etc.)	Planar Feature Angle / Angle des caractéristiques planes	Core Specimen Footage + Longueur en pieds des carottes prélevées	Your Sample No. N° d'échantillon du prospecteur	Sample Footage Niveau de prélèvement de l'échantillon (en pieds)		Sample Length Longueur de l'échantillon	Assays/Analyses minéralurgiques
From/De	To/A	Type de roche	Description (Couleur, granulométrie, texture, minéraux, transformation, etc.)				From/De	To/A		
			@113.0 - weak chl. FLT @ 65°							
			113.0 - 121.7 - buff altered, bleached, patchy, resulting in banded appearance) as in previous intervals, bedding generally @ 60°, 3-5% fine cpy + pt locally conc. as hairline fract's concordant to bedding, minor qtz. carb string's + blebs throughout interval			89806	113.0	114.0	1.0	
						807	114.0	115.0	1.0	
						808	115.0	116.0	1.0	
						809	116.0	116.7	0.7	
						810	116.7	117.7	1.0	
			@116.1 - 5 mm. mud seam, not sheared, @ 75°							
			@117.8 - 5 cm QV @ 45° (irregular), minor cpy with fract's			89811	117.7	118.2	0.5	
			@118.6 - cpy becomes conc. over 3 cm. as hairline fract's @ 55°			89812	118.2	119.2	1.0	
			119.6 - 120.0 - 40 cm QV with highly irregular contacts, cpy conc. as 'clots' to 5 mm along fract's, becomes highly conc. @ 119.9			89813	119.2	120.0	0.8	
						89814	120.0	120.9	0.9	

*For features such as foliation, bedding, schistosity, measured from the long axis of the core.

Ontario

Diamond Drilling Log Journal de forage au diamant

Complete this form and related sketch in duplicate. REMPLIR en deux exemplaires la présente formule et le croquis annexé

Fill in on every page REMPLIR ces cases chaque page

Hole No. Forage n° **NA07-01**
Page No. Page n° **18**

Drilling Company Compagnie de forage	Core Size Dimensions de la carotte	Collar Elevation Élévation du collier	Bearing of hole from true North/Position du forage par rapport au nord vrai	Total Footage Avancement total du forage	Dip of Hole at Collar 90° N Inclinaison du forage au Collar/collier	Address/Location where core stored Adresse/endroit où la carotte est stockée	Map Reference No. N° de référence sur la carte	Claim No. N° de concession minière
Date Hole Started Date de commencement du forage	Date Completed Date d'achèvement	Date Logged Date d'inscription au journal	Logged by (print) Inscrit par (écrire en lettres moulées)		°		Location (Twp. Lot, Con. Or Lat. And Long.) Emplacement (canton, lot, concession, ou latitude et longitude)	
Exploration Co., Owner or Optionee Compagnie d'exploration, propriétaire ou titulaire d'option			Logged by (Signature) Inscrit par (signature)		°			
Tri Origin Exploration Ltd.					°			
					°			
Property Name Nom de la propriété								

Footage/Avancement		Rock type	Description (Colour, grain size, texture, minerals, alteration, etc.)	Planar Feature Angle / Angle des caractéristiques planes	Core Specimen Footage / Longueur en pieds des carottes prélevées	Your Sample No. / N° d'échantillon du prospecteur	Sample Footage / Niveau de prélèvement de réchantillon (en pieds)		Sample Length / Longueur de réchantillon	Assays/Analyses minéralurgiques
From/De	To/A	Type de roche	Description (Couleur, granulométrie, texture, minéraux, transformation, etc.)				From/De	To/A		
			@ 120.0 - 10 cm. QV with irregular contacts @ ~30° 7-9% fg to cg cpy + py for 10 cm. Following Vn. and as coarse clots to 5mm rimming QV and in fract's.			88915	120.9	121.7	0.8	
			121.7 - 124.7 - banded tuff altered, bleached as in previous intervals, banding (fol'n? bedding?) @ 55°, 2-3% fg to mg cpy + py becomes conc. rimming Qtz. Stray's + patches, locally slightly MAG			88916	121.7	122.6	0.9	
		*CPY	@ 122.3 - 6 cm. QV with somewhat irregular contacts @ 22° with cpy 'clots' to 5mm conc. on the rims of QV							
			@ 122.9 - 4 cm. irregular Qtz. patch with minor cpy 'clots' to 4mm. rimming Qtz.			88917	122.6	123.5	0.9	
			123.1 - 123.4 - tuff becomes fract'd with chl + Qtz. Fract's generally @ 52°, 20% Qtz. in this interval as stray's @ ~50° + irregular fract's, 3-5% cpy + py conc. in fract's							

*For features such as foliation, bedding, schistosity, measured from the long axis of the core.

Drilling Company Compagnie de forage	Core Size Dimensions de la carotte	Collar Elevation Élévation du collier	Bearing of hole from true North/Position du forage par rapport au nord vrai	Total Footage Avancement total du forage	Dip of Hole at Collar 90° N Inclinaison du forage au Collar/collier	Address/Location where core stored Adresse/endroit où la carotte est stockée	Map Reference No. N° de référence sur la carte	Claim No. N° de concession minière
Date Hole Started Date de commencement du forage	Date Completed Date d'achèvement	Date Logged Date d'inscription au journal	Logged by (print) Inscrit par (écrire en lettres moulées)	FL/Pi	°	Location (Twp. Lot, Con. Or Lat. And Long.) Emplacement (canton, lot, concession, ou latitude et longitude)	Property Name Nom de la propriété	
Exploration Co., Owner or Optionee Compagnie d'exploration, propriétaire ou titulaire d'option			Logged by (Signature) Inscrit par (signature)	FL/Pi	°			
Tri Origin Exploration Ltd.				FL/Pi	°			
				FL/Pi	°			

Footage/Avancement		Rock type	Description (Colour, grain size, texture, minerals, alteration, etc.)	Planar Feature Angle / Angle des caractéristiques planes	Core Specimen Footage / Longueur en pieds des carottes prélevées	Your Sample No. N° d'échantillon du prospecteur	Sample Footage Niveau de prélèvement de l'échantillon (en pieds)		Sample Length Longueur de l'échantillon	Assays/Analyses minéralurgiques
From/De	To/A	Type de roche	Description (Couleur, granulométrie, texture, minéraux, transformation, etc.)				From/De	To/A		
			@ 123.7 - 123.9 - 50% qtz. in this interval as qtz. - Filled Fract's to 2cm generally @ 40° and irregular Fract's to 4 cm. 5-7% Fg to mg cp ₇ + py ₇ cond. locally as 'clots' rimming qtz.			89818	123.5	124.1	0.6	
			124.2 - 124.3 - 60% qtz. in this interval as irregular strat's + patches to 2 cm. generally @ 50°; 3-5% Fg to mg cp ₇ + py ₇			89819	124.1	124.7	0.6	
			124.7 - 125.4 - fairly fresh, banded ash tuff			89820	124.7	125.4	0.7	
			125.4 - 135.6 - banded tuff locally altered, bleached with numerous qtz. strat's + 'patches' throughout, 2-3% Fg to mg cp ₇ + py ₇ cond. typically rimming qtz.			89821	125.4	126.3	0.9	
			@ 126.0 - 3 cm QV @ 63° with py + cp ₇			824	126.3	127.2	0.9	
			@ 127.3 - 127.6 - 30 cm patches + irregular QV's generally @ 45°, crse cp ₇ 'clots' to 1cm (@ 127.6)			89823	127.2	128.0	0.8	
						824	128.0	129.0	1.0	

*For features such as foliation, bedding, schistosity, measured from the long axis of the core.

Diamond Drilling Log Journal de forage au diamant

Complete this form and related sketch in duplicate. Remplir en deux exemplaires la présente formule et le croquis annexé

Fill in on every page Remplir ces cases chaque page ⇒

Hole No. Forage n°	Page No. Page n°
NA07-01	20

Drilling Company Compagnie de forage	Core Size Dimensions de la carotte	Collar Elevation Élévation du collier	Bearing of hole from true North/Position du forage par rapport au nord vrai	Total Footage Avancement total du forage	Dip of Hole at Collar 90° N Inclinaison du forage au Collar/collier	Address/Location where core stored Adresse/endroit où la carotte est stockée	Map Reference No. N° de référence sur la carte	Claim No. N° de concession minière
Date Hole Started Date de commencement du forage	Date Completed Date d'achèvement	Date Logged Date d'inscription au journal	Logged by (print) Inscrit par (écrire en lettres moulées)				Location (Twp, Lot, Con. Or Lat. And Long.) Emplacement (canton, lot, concession, ou latitude et longitude)	
Exploration Co., Owner or Optionee Compagnie d'exploration, propriétaire ou titulaire d'option			Logged by (Signature) Inscrit par (signature)				Property Name Nom de la propriété	
Tri Origin Exploration Ltd.								

Footage/Avancement		Rock type	Description (Colour, grain size, texture, minerals, alteration, etc.)	Planar Feature Angle / Angle des caractéristiques planes	Core Specimen Footage / Longueur en pieds des carottes prélevées	Your Sample No. N° d'échantillon du prospecteur	Sample Footage Niveau de prélèvement de l'échantillon (en pieds)		Sample Length Longueur de l'échantillon	Assays/Analyses minéralurgiques
From/De	To/A	Type de roche	Description (Couleur, granulométrie, texture, minéraux, transformation, etc.)				From/De	To/A		
			@ 130.1 - Fol'n @ 55° (bedding?)			88825	129.0	129.8	0.8	
			@ 130.2 - 2 cm QV @ 60° with coarse cpy			826	129.8	130.8	1.0	
			@ 131.6 - 5 cm irregular QV @ ~50° with coarse cpy			827	130.8	131.8	1.0	
			@ 132.2 - 3 cm irregular QV @ ~50° with abundant coarse cpy			88828	131.8	132.8	1.0	
			@ 133.6 - Fol'n @ 68° (bedding?)			829	132.8	133.8	1.0	
			134.1 - 134.2 - 10 cm QV @ 63°			88830	133.8	134.6	0.8	
			134.4 - 134.6 - 7-9% Fg to mg py conc. in hairline string @ 55°							
			@ 134.6 - sharp, natural contact with porph @ steep but irregular angle TCA							

*For features such as foliation, bedding, schistosity, measured from the long axis of the core.

Ontario

Diamond Drilling Log Journal de forage au diamant

Complete this form and related sketch in duplicate. Remplir en deux exemplaires la présente formule et le croquis annexé

Fill in on every page Remplir ces cases chaque page



Hole No. Forage n°	Page No. Page n°
NA07-01	21

Drilling Company Compagnie de forage	Core Size Dimensions de la carotte	Collar Elevation Élévation du collier	Bearing of hole from true North/Position du forage par rapport au nord vrai	Total Footage Avancement total du forage	Dip of Hole at Collar 90° N Inclinaison du forage au Collar/collier	Address/Location where core stored Adresse/endroit où la carotte est stockée	Map Reference No. N° de référence sur la carte	Claim No. N° de concession minière
Date Hole Started Date de commencement du forage	Date Completed Date d'achèvement	Date Logged Date d'inscription au journal	Logged by (print) Inscrit par (écrire en lettres moulées)	Logged by (Signature) Inscrit par (signature)	Location (Twp. Lot, Con. Or Lat. And Long.) Emplacement (canton, lot, concession, ou latitude et longitude)	Property Name Nom de la propriété		

Footage/Avancement		Rock type	Description (Colour, grain size, texture, minerals, alteration, etc.)	Planar Feature Angle / Angle des caractéristiques planes	Core Specimen Footage / Longueur en pieds des carottes prélevées	Your Sample No. N° d'échantillon du prospecteur	Sample Footage Niveau de prélèvement de l'échantillon (en pieds)		Sample Length Longueur de l'échantillon	Assays/Analyses minéralurgiques		
From/De	To/A	Type de roche	Description (Couleur, granulométrie, texture, minéraux, transformation, etc.)				From/De	To/A				
134.6	136.2	Feld. Qtz. Porphyry	- as described in previous interval, with 30-40% qz to mg, subhedral feld. + qtz. phenocr. locally to 3 mm in a finer-grained felsic matrix, minor carb. replacement, tr. fine py									
			@ 136.2 - sharp, natural contact with tuff @ 73°									
136.2	140.9	Banded Ash Tuff mag ⇒ (BIF)	- Fine-grained, silty to locally sandy ash, finely banded throughout due to fine bedding, ± alt. fol. in general @ 55-65°. local fine beds (≤ 1cm) exhibit high MAG (BIF?), cut by minor qz's, generally 1-2%. fine cp ₁ + py locally conc.									
			136.2-137.0 - tuff highly fract'd & deformed initially with abundant chl + mag. fracture-filling, 5-7%. fg to mg cp ₁ + py locally highly conc. as hairline strgs with fract's. @ ~ 70°			89831	136.2	137.0	0.8			
			137.0-139.4 - generally bleached pale greenish to brownish-grey, somewhat vuggy with Qtz.-Carb.-Chl. filling, only minor tr cp ₁ + py evident									

*For features such as foliation, bedding, schistosity, measured from the long axis of the core.

Ontario

Diamond Drilling Log Journal de forage au diamant

Complete this form and related sketch in duplicate. Remplir en deux exemplaires la présente formule et le croquis annexé

Fill in on every page Remplir ces cases chaque page



Hole No. Forage n°	Page No. Page n°
NA07-01	22

Drilling Company Compagnie de forage	Core Size Dimensions de la carotte	Collar Elevation Élévation du collier	Bearing of hole from true North/Position du forage par rapport au nord vrai	Total Footage Avancement total du forage	Dip of Hole at Collar 90° N Inclinaison du forage au Collar/collier	Address/Location where core stored Adresse/endroit où la carotte est stockée	Map Reference No. N° de référence sur la carte	Claim No. N° de concession minière
Date Hole Started Date de commencement du forage	Date Completed Date d'achèvement	Date Logged Date d'inscription au journal	Logged by (print) Inscrit par (écrire en lettres moulées)		°		Location (Twp. Lot, Con. Or Lat. And Long.) Emplacement (canton, lot, concession, ou latitude et longitude)	
Exploration Co., Owner or Optionee Compagnie d'exploration, propriétaire ou titulaire d'option			Logged by (Signature) Inscrit par (signature)		°			
Tri Origin Exploration Ltd.					°			
					°			
Property Name Nom de la propriété								

Footage/Avancement		Rock type	Description (Colour, grain size, texture, minerals, alteration, etc.)	Planar Feature Angle / Angle des caractéristiques planes	Core Specimen Footage / Longueur en pieds des carottes prélevées	Your Sample No. N° d'échantillon du prospecteur	Sample Footage Niveau de prélèvement de l'échantillon (en pieds)		Sample Length Longueur de l'échantillon	Assays/Analyses minéralurgiques
From/De	To/A	Type de roche	Description (Couleur, granulométrie, texture, minéraux, transformation, etc.)				From/De	To/A		
			@ 137.4 - 2.5 cm vuggy Qtz-Carb Vn. @ 50°							
			@ 137.6 - 2.5 cm vuggy Qtz-Carb Vn. @ 57°							
			@ 137.9 - 4 cm. vuggy Qtz-Carb-Chl. Vn. @ 50°							
			138.4 - 139.1 - broken core							
			139.4 - 140.9 - slightly bedded (patchy), fine-grained, finely bedded ash tuff bedding @ 60°-80° 3-S.			89832	139.4	140.2	0.8	
			Fg opx + py locally conc. as hairline string concordant to bedding			33	140.2	140.9	0.7	
			@ 140.9 - sharp, natural contact with porph @ 55°							
140.9	141.7	Feld.-Qtz Porphyry	- as described previously							
			@ 141.7 - sharp, natural contact with tuff @ 75°							

*For features such as foliation, bedding, schistosity, measured from the long axis of the core.

Ontario

Diamond Drilling Log

Journal de forage au diamant

Complete this form and related sketch in duplicate.
Remplir en deux exemplaires la présente formule et le croquis annexé

Fill in on every page
Remplir ces cases
chaque page



Hole No. Forage n°	Page No. Page n°
NA07-01	23

Drilling Company Compagnie de forage	Core Size Dimensions de la carotte	Collar Elevation Élévation du collier	Bearing of hole from true North/Position du forage par rapport au nord vrai	Total Footage Avancement total du forage	Dip of Hole at Collar 90° N Inclinaison du forage au Collar/collier	Address/Location where core stored Adresse/endroit où la carotte est stockée	Map Reference No. N° de référence sur la carte	Claim No. N° de concession minière
Date Hole Started Date de commencement du forage	Date Completed Date d'achèvement	Date Logged Date d'inscription au journal	Logged by (print) Inscrit par (écrire en lettres moulées)	FL/Pi	°	Location (Twp. Lot, Con. Or Lat. And Long.) Emplacement (canton, lot, concession, ou latitude et longitude)	Property Name Nom de la propriété	
Drilling Co., Owner or Optionee Compagnie d'exploration, propriétaire ou titulaire d'option			Logged by (Signature) Inscrit par (signature)	FL/Pi	°			
Tri Origin Exploration Ltd.				FL/Pi	°			
				FL/Pi	°			

Footage/Avancement		Rock type	Description (Colour, grain size, texture, minerals, alteration, etc.)	Planar Feature Angle / Angle des caractéristiques planes	Core Specimen Footage / Longueur en pieds des carottes prélevées	Your Sample No. N° d'échantillon du prospecteur	Sample Footage Niveau de prélèvement de l'échantillon (en pieds)		Sample Length Longueur de l'échantillon	Assays/Analyses minéralurgiques
From/De	To/A	Type de roche	Description (Couleur, granulométrie, texture, minéraux, transformation, etc.)				From/De	To/A		
141.7	144.6	Banded Ash Tuff (BIF)	- fine-grained silty to sandy, finely bedded ash tuff, local sections bedded pale greyish-green, cut by occasional qtz. stringers to 5 cm, local fine black beds highly magnetic (BIF), tr. cpy + py locally conc.			89834	141.7	142.7	1.0	
			@ 142.6 - irregular 1-3 cm. QV @ ~60° with cise cpy rimming QV							
			@ 144.6 - sharp, natural contact @ 70°							
144.6	144.9	Feld. - Qtz. Porphyry	- as described in previous interval							
			@ 144.9 - sharp, natural contact with tuff @ 60°							
144.9	159.4	Banded Ash Tuff (BIF)	- as described in previous interval							
			@ 146.2 - bedding @ 53°							
			@ 147.5 - bedding @ 67°							

*For features such as foliation, bedding, schistosity, measured from the long axis of the core.

Ontario

Diamond Drilling Log

Journal de forage au diamant

Complete this form and related sketch in duplicate.
Remplir en deux exemplaires la présente formule et le croquis annexé

Fill in on every page
Remplir ces cases
chaque page

Hole No. Forage n°	Page No. Page n°
NA07-01	24

Drilling Company Compagnie de forage	Core Size Dimensions de la carotte	Collar Elevation Élévation du collier	Bearing of hole from true North/Position du forage par rapport au nord vrai	Total Footage Avancement total du forage	Dip of Hole at Collar 90° N Inclinaison du forage au Collar/collier	Address/Location where core stored Adresse/endroit où la carotte est stockée	Map Reference No. N° de référence sur la carte	Claim No. N° de concession minière
Date Hole Started Date de commencement du forage	Date Completed Date d'achèvement	Date Logged Date d'inscription au journal	Logged by (print) Inscrit par (écrire en lettres moulées)		FL/PI		Location (Twp. Lot, Con. Or Lat. And Long.) Emplacement (canton, lot, concession, ou latitude et longitude)	
Exploration Co., Owner or Optionee Compagnie d'exploration, propriétaire ou titulaire d'option			Logged by (Signature) Inscrit par (signature)		FL/PI			
Tri Origin Exploration Ltd.					FL/PI			
					FL/PI			
Property Name Nom de la propriété								

Footage/Avancement		Rock type	Description (Colour, grain size, texture, minerals, alteration, etc.)	Planar Feature Angle / Angle des caractéristiques planes	Core Specimen Footage / Longueur en pieds des carottes prélevées	Your Sample No. / N° d'échantillon du prospecteur	Sample Footage / Niveau de prélèvement de l'échantillon (en pieds)		Sample Length / Longueur de l'échantillon	Assays/Analyses minéralurgiques
From/De	To/A	Type de roche	Description (Couleur, granulométrie, texture, minéraux, transformation, etc.)				From/De	To/A		
			@ 148.9 - 5 cm. Qtz - Carb Vn. @ 65°							
			149.2 - 149.8 - 5-7% fg. dissem. py + cpy with a vuggy irregular 4 cm Qtz - Carb - Feld. Vn. @ 149.5 with crse. cpy			89835	149.2	149.8	0.6	
			150.8 - 151.3 - 5-7% fg. dissem. py + cpy locally conc. in hairline strag's concordant to bedding @ 65° with a vuggy 3 cm. Qtz = Carb Vn. @ 151.0 @ 65° with crse cpy 'clots'			89836	150.8	151.3	0.5	
			@ 154.6 - 4 cm. Qtz - Carb Vn. @ 68° with minor crse cpy							
			@ 155.2 - bedding @ 70°							
			157.3 - 158.1 - 7-9% fg. py + cpy locally conc. as hairline strag's concordant to bedding with an irregular 1-3 cm. blebby irregular QU @ 158.0 @ 65°			89837	157.3	158.1	0.8	

*For features such as foliation, bedding, schistosity, measured from the long axis of the core.

Complete this form and related sketch in duplicate.
Remplir en deux exemplaires la présente formule et le croquis annexé

Fill in on every page
Remplir ces cases
chaque page

⇒

Hole No. Forage n°	Page No. Page n°
NA07-01	25

Drilling Company Compagnie de forage	Core Size Dimensions de la carotte	Collar Elevation Élévation du collier	Bearing of hole from true North/Position du forage par rapport au nord vrai	Total Footage Avancement total du forage	Dip of Hole at Collar 90° N Inclinaison du forage au Collar/collier	Address/Location where core stored Adresse/endroit où la carotte est stockée	Map Reference No. N° de référence sur la carte	Claim No. N° de concession minière
Date Hole Started Date de commencement du forage	Date Completed Date d'achèvement	Date Logged Date d'inscription au journal	Logged by (print) Inscrit par (écrire en lettres moulées)		Ft./Pi		Location (Twp. Lot, Con. Or Lat. And Long.) Emplacement (canton, lot, concession, ou latitude et longitude)	
Exploration Co., Owner or Optionee Compagnie d'exploration, propriétaire ou titulaire d'option			Logged by (Signature) Inscrit par (signature)		Ft./Pi		Property Name Nom de la propriété	
Tri Origin Exploration Ltd.					Ft./Pi			
					Ft./Pi			

Footage/Avancement		Rock type	Description (Colour, grain size, texture, minerals, alteration, etc.)	Planar Features Angle / Angle des caractéristiques planes	Core Specimen Footage / Longueur en pieds des carottes prélevées	Your Sample No. N° d'échantillon du prospecteur	Sample Footage Niveau de prélèvement de l'échantillon (en pieds)		Sample Length Longueur de l'échantillon	Assays/Analyses minéralurgiques		
From/De	To/A	Type de roche	Description (Couleur, granulométrie, texture, minéraux, transformation, etc.)				From/De	To/A				
			@159.1 - 7 cm. grey QV @ 53°									
			@159.2 - str. chi-carb slip @ 70°									
			@159.2 - 7 cm. grey QV @ 70°, coarse cpy rims QV									
			@159.4 - sharp, natural contact with porph. @ 67°									
159.4	167.8	Feld.-Qtz. Porphyry	- greyish-brown, porphyritic with 10-35% cpy to mg, subhedral to anhedral feld + Qtz. phenos in a fine-grained felsic matrix, tr fine cpy cut occasionally by minor ≤ 1 cm qz's, non-MAG, local sections slightly reddened (hem.)									
			@167.8 - sharp, natural contact with tuff @ 63°									
167.8	169.6	Banded Ash Tuff (minor BIF)	- as described previously, black highly magnetic bands (≤ 2cm.) less prevalent than in previous intervals									

*For features such as foliation, bedding, schistosity, measured from the long axis of the core.

Ontario

Diamond Drilling Log

Journal de forage au diamant

Complete this form and related sketch in duplicate.
Remplir en deux exemplaires la présente formule et le croquis annexé

Fill in on every page
Remplir ces cases
chaque page

Hole No. Forage n° **NA07-01**
Page No. Page n° **26**

Drilling Company Compagnie de forage	Core Size Dimensions de la carotte	Collar Elevation Élévation du collier	Bearing of hole from true North/Position du forage par rapport au nord vrai	Total Footage Avancement total du forage	Dip of Hole at Collar 90° N Inclinaison du forage au Collar/collier	Address/Location where core stored Adresse/endroit où la carotte est stockée	Map Reference No. N° de référence sur la carte	Claim No. N° de concession minière
Date Hole Started Date de commencement du forage	Date Completed Date d'achèvement	Date Logged Date d'inscription au journal	Logged by (print) Inscrit par (écrire en lettres moulées)				Location (Twp. Lot, Con. Or Lat. And Long.) Emplacement (canton, lot, concession, ou latitude et longitude)	
Exploration Co., Owner or Optionee Compagnie d'exploration, propriétaire ou titulaire d'option			Logged by (Signature) Inscrit par (signature)				Property Name Nom de la propriété	
Tri Origin Exploration Ltd.								

Footage/Avancement		Rock type	Description (Colour, grain size, texture, minerals, alteration, etc.)	Planar Feature Angle / Angle des caractéristiques planes	Core Specimen Footage / Longueur en pieds des carottes prélevées	Your Sample No. N° d'échantillon du prospecteur	Sample Footage Niveau de prélèvement de l'échantillon (en pieds)		Sample Length Longueur de l'échantillon	Assays/Analyses minéralurgiques		
From/De	To/A	Type de roche	Description (Couleur, granulométrie, texture, minéraux, transformation, etc.)				From/De	To/A				
			168.8-169.6 - 2-3% fine py + cp, becomes high conc. in two black BIF bands @ 168.9 & 169.0, with coarse py + cp rimming a 2 cm. qs @ 169.0 @ 45°			89838	168.8	169.6	0.8			
			@ 169.6 - sharp, natural contact with porph. @ 63°									
169.6	210.7	Feld. - Qtz. Porphyry	- as described in previous interval, phen's become coarser to 7mm with depth @ 174.7 - 1-2 cm. irregular QV @ 35°, doesn't appear mineralized @ 185.0 - broken core over 15 cm. no evidence of significant structure									
			192.1-192.4 - broken core, no evidence of significant structure									
			192.4 - 192.9 - broken core becomes highly gravel, no evidence of significant structure									
			@ 193.1 - ground core, no evidence of significant structure.									

*For features such as foliation, bedding, schistosity, measured from the long axis of the core.

Drilling Company Compagnie de forage	Core Size Dimensions de la carotte	Collar Elevation Élévation du collier	Bearing of hole from true North/Position du forage par rapport au nord vrai	Total Footage Avancement total du forage	Dip of Hole at Collar 90° N Inclinaison du forage au Collar/collier	Address/Location where core stored Adresse/endroit où la carotte est stockée	Map Reference No. N° de référence sur la carte	Claim No. N° de concession minière
Date Hole Started Date de commencement du forage	Date Completed Date d'achèvement	Date Logged Date d'inscription au journal	Logged by (print) Inscrit par (écrire en lettres moulées)				Location (Twp. Lot, Con. Or Lat. And Long.) Emplacement (canton, lot, concession, ou latitude et longitude)	
Exploration Co., Owner or Optionee Compagnie d'exploration, propriétaire ou titulaire d'option			Logged by (Signature) Inscrit par (signature)				Property Name Nom de la propriété	
Tri Origin Exploration Ltd.								

Footage/Avancement		Rock type	Description (Colour, grain size, texture, minerals, alteration, etc.)	Planar Feature Angle ° /Angle des caractéristiques planes	Core Specimen Footage / Longueur en pieds des carottes prélevées	Your Sample No. N° d'échantillon du prospecteur	Sample Footage Niveau de prélèvement de l'échantillon (en pieds)		Sample Length Longueur de l'échantillon	Assays/Analyses minéralurgiques	
From/De	To/A	Type de roche	Description (Couleur, granulométrie, texture, minéraux, transformation, etc.)				From/De	To/A			
			196.0-196.5 - highly irregular 1-5 cm. QV centred @ 196.3 @ ~ 10° TLR with coarse cpy 'clots' to 15 mm.			89839	196.0	196.5	0.5		
			@ 200.6 - irregular 0.2-2.5 cm. QV @ 30°, doesn't appear mineralized								
			@ 202.2 - highly irregular 1-5 cm. QV @ ~ 20° with occasional 'clots' of coarse cpy + py			89840	201.8	202.4	0.6		
			208.8-208.9 - broken core, no evidence of significant structure								
			209.4-209.7 - broken core, no evidence of significant structure.								
			@ 210.7 - sharp, natural contact with banded tuff @ 45°								
210.7	222.3	Banded Ash Tuff (BIF)	- Fine-grained, sandy ash, finely bedded + banded, local sections bleached pale greenish to brownish-grey causing banded appearance. Local fine black beds, highly magnetic (BIF) though not as prevalent as previous intervals, + fine py + cpy.								

*For features such as foliation, bedding, schistosity, measured from the long axis of the core. locally conc. as hairline stringers, abundant secondary carb replacement

Drilling Company Compagnie de forage	Core Size Dimensions de la carotte	Collar Elevation Élévation du collier	Bearing of hole from true North/Position du forage par rapport au nord vrai	Total Footage Avancement total du forage	Dip of Hole at Collar 90° N Inclinaison du forage au Collar/collier	Address/Location where core stored Adresse/endroit où la carotte est stockée	Map Reference No. N° de référence sur la carte	Claim No. N° de concession minière
Date Hole Started Date de commencement du forage	Date Completed Date d'achèvement	Date Logged Date d'inscription au journal	Logged by (print) Inscrit par (écrire en lettres moulées)	Ft./Pi	°		Location (Twp. Lot, Con. Or Lat. And Long.) Emplacement (canton, lot, concession, ou latitude et longitude)	Property Name Nom de la propriété
Exploration Co., Owner or Optionee Compagnie d'exploration, propriétaire ou titulaire d'option			Logged by (Signature) Inscrit par (signature)	Ft./Pi	°			
Tri Origin Exploration Ltd.				Ft./Pi	°			
				Ft./Pi	°			

Footage/Avancement		Rock type	Description (Colour, grain size, texture, minerals, alteration, etc.)	Planar Feature Angle * /Angle des caractéristiques planes	Core Specimen Footage / Longueur en pieds des carottes prélevées	Your Sample No. N° d'échantillon du prospecteur	Sample Footage Niveau de prélèvement de l'échantillon (en pieds)		Sample Length Longueur de l'échantillon	Assays/Analyses minéralurgiques	
From/De	To/A	Type de roche	Description (Couleur, granulométrie, texture, minéraux, transformation, etc.)				From/De	To/A			
			@ 212.3 - bedding @ 52°								
			213.4-214.1 - 25% gross Qtz. throughout interval as irregular fract's to 2.5 cm. generally @ 50°, minor coarse 'clot's epq			89841	213.4	214.1	0.7		
			@ 216.8 - bedding @ 50°								
			@ 217.7 - muddy, ground core indicative of a tight chl. FLT @ 53°								
			@ 218.6 - str. carb-chl slip @ 68°								
			@ 219.1 - bedding @ 55°								
			@ 219.2 - 1-2 cm. irregular QV @ 13°, doesn't appear mineralized								
			@ 222.3 - sharp, natural contact with porph @ 43°								

*For features such as foliation, bedding, schistosity, measured from the long axis of the core.

Drilling Company Compagnie de forage	Core Size Dimensions de la carotte	Collar Elevation Élévation du collier	Bearing of hole from true North/Position du forage par rapport au nord vrai	Total Footage Avancement total du forage	Dip of Hole at Collar 90° N Inclinaison du forage au Collar/collier	Address/Location where core stored Adresse/endroit où la carotte est stockée	Map Reference No. N° de référence sur la carte	Claim No. N° de concession minière
Date Hole Started Date de commencement du forage	Date Completed Date d'achèvement	Date Logged Date d'inscription au journal	Logged by (print) Inscrit par (écrire en lettres moulées)				Location (Twp. Lot, Con. Or Lat. And Long.) Emplacement (canton, lot, concession, ou latitude et longitude)	
Exploration Co., Owner or Optionee Compagnie d'exploration, propriétaire ou titulaire d'option			Logged by (Signature) Inscrit par (signature)				Property Name Nom de la propriété	
Tri Origin Exploration Ltd.								

Footage/Avancement		Rock type	Description (Colour, grain size, texture, minerals, alteration, etc.)	Planar Feature Angle / Angle des caractéristiques planes	Core Specimen Footage / Longueur en pieds des carottes prélevées	Your Sample No. N° d'échantillon du prospecteur	Sample Footage Niveau de prélèvement de l'échantillon (en pieds)		Sample Length Longueur de l'échantillon	Assays/Analyses minéralurgiques
From/De	To/A	Type de roche	Description (Couleur, granulométrie, texture, minéraux, transformation, etc.)				From/De	To/A		
222.3	270.9	Feld. - Qtz. Porphyry	- as described in previous intervals, alteration (reddened → hem.) more prevalent than in previous intervals, primary texture becomes somewhat obliterated in the strongest hematized sections							
			@ 222.6 - irregular 0.5-3.0 cm vuggy Qtz-Carb Vn. @ 58°							
			232.0-232.6 - four irregular 0.5-2.0 cm g's generally @ 50° with minor coarse 'clots' of py rimming Qtz.			89842	232.0	232.6	0.6	
			@ 232.7 - porph freshens to a dark gray with coarse Feld. pheno's to 1.0 cm.							
			242.4-243.2 - porph. becomes reddened + fractured with 10% gray Qtz. blebs + fractures with a 5mm Qtz. strag. @ 242.4 @ 47°, minor tr py			89843	242.4	243.2	0.8	
			@ 242.7 - str. chl-carb slip @ 45°							

*For features such as foliation, bedding, schistosity, measured from the long axis of the core.

Complete this form and related sketch in duplicate. Remplir en deux exemplaires la présente formule et le croquis annexé

Fill in on every page Remplir ces cases chaque page ⇒

Drilling Company Compagnie de forage	Core Size Dimensions de la carotte	Collar Elevation Élévation du collier	Bearing of hole from true North/Position du forage par rapport au nord vrai	Total Footage Avancement total du forage	Dip of Hole at Collar 90° N Inclinaison du forage au Collar/collier	Address/Location where core stored Adresse/endroit où la carotte est stockée	Map Reference No. N° de référence sur la carte	Claim No. N° de concession minière
Date Hole Started Date de commencement du forage	Date Completed Date d'achèvement	Date Logged Date d'inscription au journal	Logged by (print) Inscrit par (écrire en lettres moulées)				Location (Twp. Lot, Con. Or Lat. And Long.) Emplacement (canton, lot, concession, ou latitude et longitude)	
Exploration Co., Owner or Optionee Compagnie d'exploration, propriétaire ou titulaire d'option			Logged by (Signature) Inscrit par (signature)				Property Name Nom de la propriété	
Tri Origin Exploration Ltd.								

Footage/Avancement		Rock type	Description (Colour, grain size, texture, minerals, alteration, etc.)	Planar Feature Angle / Angle des caractéristiques planes	Core Specimen Footage + Longueur en pieds des carottes prélevées	Your Sample No. N° d'échantillon du prospecteur	Sample Footage Niveau de prélèvement de l'échantillon (en pieds)		Sample Length Longueur de l'échantillon	Assays/Analyses minéralurgiques	
From/De	To/A	Type de roche	Description (Couleur, granulométrie, texture, minéraux, transformation, etc.)				From/De	To/A			
			@ 252.6 - 3 cm. Qtz Vn. @ 50°								
			@ 254.0 - feld. + qtz. pheno's decrease in size to ≤ 2 mm								
			257.7 - 264.0 - porph. becomes slightly altered + reddened								
			261.6 - 264.0 - core becomes highly broken + locally ground, no evidence of significant structure.								
			265.4 - 266.0 - porph. becomes fractured + slightly reddened with two irregular 1 cm. qtz. strgs. @ 265.4 + 265.5 @ 45°; doesn't appear mineralized								
			270.3 - 270.9 - porph. becomes altered + reddened, fractured with minor, irregular qz's to 3 mm throughout interval @ ~ 60° conc. around 270.7, minor tr. fine py			89845	270.3	270.9	0.6		
			@ 270.9 - sharp but irregular contact								

*For features such as foliation, bedding, schistosity, measured from the long axis of the core.

Drilling Company Compagnie de forage	Core Size Dimensions de la carotte	Collar Elevation Élévation du collier	Bearing of hole from true North/Position du forage par rapport au nord vrai	Total Footage Avancement total du forage	Dip of Hole at Collar 90° N Inclinaison du forage au Collar/collier	Address/Location where core stored Adresse/endroit où la carotte est stockée	Map Reference No. N° de référence sur la carte	Claim No. N° de concession minière
Date Hole Started Date de commencement du forage	Date Completed Date d'achèvement	Date Logged Date d'inscription au journal	Logged by (print) Inscrit par (écrire en lettres moulées)	FL/PI	°		Location (Twp. Lot, Con. Or Lat. And Long.) Emplacement (canton, lot, concession, ou latitude et longitude)	
Exploration Co., Owner or Optionee Compagnie d'exploration, propriétaire ou titulaire d'option			Logged by (Signature) Inscrit par (signature)	FL/PI	°			
Tri Origin Exploration Ltd.				FL/PI	°			
				FL/PI	°			
Property Name Nom de la propriété								

Footage/Avancement		Rock type	Description (Colour, grain size, texture, minerals, alteration, etc.)	Planar Feature Angle / Angle des caractéristiques planes	Core Specimen Footage / Longueur en pieds des carottes prélevées	Your Sample No. N° d'échantillon du prospecteur	Sample Footage Niveau de prélèvement de l'échantillon (en pieds)		Sample Length Longueur de l'échantillon	Assays/Analyses minéralurgiques		
From/De	To/A	Type de roche	Description (Couleur, granulométrie, texture, minéraux, transformation, etc.)				From/De	To/A				
270.9	271.8	Lamp. Dyke	- Fresh, black with 10-30% f.a to mg (0.5 → 2.0 mm) plaq. altered to secondary carb in a f.a to mg mafic matrix, massive, equigranular, locally slightly MAG									
			@ 271.8 - contact with porph. lost in broken core.									
271.8	274.3	Feld-Qtz. Porphyry	- as described in previous intervals, slightly reddened.									
			@ 274.3 - sharp, natural contact with lamp dyke @ 75°									
274.3	274.9	Lamp. Dyke	- as described in previous interval									
			@ 274.9 - sharp, natural contact with porph. @ 40°									
274.9	275.8	Feld-Qtz. Porphyry	- as described in previous intervals, slightly reddened									
			@ 275.8 - contact with banded, ash tuff									

*For features such as foliation, bedding, schistosity, measured from the long axis of the core.

Diamond Drilling Log Journal de forage au diamant

Complete this form and related sketch in duplicate. REMPLIR en deux exemplaires la présente formule et le croquis annexé

Fill in on every page Remplir ces cases chaque page

Hole No. Forage n° **NA07-01**
Page No. Page n° **32**

Drilling Company Compagnie de forage	Core Size Dimensions de la carotte	Collar Elevation Élévation du collier	Bearing of hole from true North/Position du forage par rapport au nord vrai	Total Footage Avancement total du forage	Dip of Hole at Collar 90° N Inclinaison du forage au Collar/collier	Address/Location where core stored Adresse/endroit où la carotte est stockée	Map Reference No. N° de référence sur la carte	Claim No. N° de concession minière
Date Hole Started Date de commencement du forage	Date Completed Date d'achèvement	Date Logged Date d'inscription au journal	Logged by (print) Inscrit par (écrire en lettres moulées)	° Ft./Pi		Location (Twp. Lot, Con. Or Lat. And Long.) Emplacement (canton, lot, concession, ou latitude et longitude)	Property Name Nom de la propriété	
Exploration Co., Owner or Optionee Compagnie d'exploration, propriétaire ou titulaire d'option			Logged by (Signature) Inscrit par (signature)	° Ft./Pi				
Tri Origin Exploration Ltd.				° Ft./Pi				
				° Ft./Pi				

Footage/Avancement		Rock type	Description (Colour, grain size, texture, minerals, alteration, etc.)	Planar Feature Angle * / Angle des caractéristiques planes	Core Specimen Footage / Longueur en pieds des carottes prélevées	Your Sample No. N° d'échantillon du prospecteur	Sample Footage Niveau de prélèvement de l'échantillon (en pieds)		Sample Length Longueur de l'échantillon	Assays/Analyses minéralurgiques	
From/De	To/A	Type de roche	Description (Couleur, granulométrie, texture, minéraux, transformation, etc.)				From/De	To/A			
275.8	278.5	Banded Ash Tuff (BIF)	- Fine-grained silt to sandy ash, locally finely bedded & banded, locally bleached pale greenish-grey causing banded appearance, block beds magnetic (BIF), abundant secondary carb replacement, as described in previous intervals								
			276.6-276.9 - highly ground, muddy chloritic possibly indicative of STR. FLT, core angle lost in ground core.								
			276.9-277.0 - 10 cm grey QV @ 60° following mud FLT, doesn't appear mineralized			89845	276.5	277.0	0.5		
			@ 278.1 - bedding @ 72°								
278.5			@ 278.5 - sharp, natural contact with porph. @ 55°								
278.5	281.0	Feld.-Qtz. Porphyry	- as described in previous intervals, slightly reddened & fractured with occasional qtz-filled fract's to 1 cm, qtz. fract's conc. 278.5-279.0 in bleached interval following contact			89846	278.5	279.0	0.5		

*For features such as foliation, bedding, schistosity, measured from the long axis of the core.

@ 281.0 - END OF HOLE



1046 Gorham Street
Thunder Bay, ON
Canada P7B 5X5

Tel: (807) 626-1630
Fax: (807) 622-7571

www.accurassay.com
assay@accurassay.com

Certificate of Analysis

Thursday, April 05, 2007

Tri-Origin Explorations
3 Centre Street, Suite 206
Markham, ON, CAN
L3P3P9

Ph#: (905) 294-9942

Fax#: (905) 294-9943

Email northerngold@ntl.sympatico.ca, explore@triorigin.com

Date Received : 30-Jan-07

Date Completed : 01-Feb-07

Job # 200740149

Reference # NA07-01

DRILLHOLE

Sample #: 96 Core

Accurassay #	Client Id	Au ppb	Au oz/t	Au g/t (ppm)
11564	89751	<5	<0.001	<0.005
11565	89752	<5	<0.001	<0.005
11566	89753	<5	<0.001	<0.005
11567	89754	<5	<0.001	<0.005
11568	89755	<5	<0.001	<0.005
11569	89756	6	<0.001	0.006
11570	89757	9	<0.001	0.009
11571	89758	13	<0.001	0.013
11572	89759	10	<0.001	0.010
11573	89760	<5	<0.001	<0.005
11574 Check	89760	<5	<0.001	<0.005
11575	89761	11	<0.001	0.011
11576	89762	<5	<0.001	<0.005
11577	89763	5	<0.001	0.005
11578	89764	<5	<0.001	<0.005
11579	89765	658	0.019	0.658
11580	89766	8	<0.001	0.008
11581	89767	<5	<0.001	<0.005
11582	89768	<5	<0.001	<0.005
11583	89769	<5	<0.001	<0.005
11584	89770	39	0.001	0.039
11585 Check	89770	43	0.001	0.043
11586	89771	269	0.008	0.269

PROCEDURE CODES: AL4Au

Certified By:

Derek Demianuk H.Bsc., Laboratory Manager

The results included on this report relate only to the items tested

The Certificate of Analysis should not be reproduced except in full, without the written approval of the laboratory

Page 1 of 5

AL903-0149-04/05/2007 03:15 PM



1046 Gorham Street
Thunder Bay, ON
Canada P7B 5X5

Tel: (807) 626-1630
Fax: (807) 622-7571

www.accurassay.com
assay@accurassay.com

Certificate of Analysis

Thursday, April 05, 2007

Tri-Origin Explorations
3 Centre Street, Suite 206
Markham, ON, CAN
L3P3P9

Ph#: (905) 294-9942

Fax#: (905) 294-9943

Email northerngold@ntl.sympatico.ca, explore@triorigin.com

Date Received : 30-Jan-07

Date Completed : 01-Feb-07

Job # 200740149

Reference * **NA 07-01 DRILLHOLE**

Sample #: 96 Core

Accurassay #	Client Id	Au ppb	Au oz/t	Au g/t (ppm)
11587	89772	507	0.015	0.507
11588	89773	197	0.006	0.197
11589	89774	43	0.001	0.043
11590	89775	15	<0.001	0.015
11591	89776	10	<0.001	0.010
11592	89777	7	<0.001	0.007
11593	89778	<5	<0.001	<0.005
11594	89779	36	0.001	0.036
11595	89780	10	<0.001	0.010
11596 Check	89780	11	<0.001	0.011
11597	89781	14	<0.001	0.014
11598	89782	25	<0.001	0.025
11599	89783	7	<0.001	0.007
11600	89784	495	0.014	0.495
11601	89785	298	0.009	0.298
11602	89786	28	<0.001	0.028
11603	89787	<5	<0.001	<0.005
11604	89788	<5	<0.001	<0.005
11605	89789	<5	<0.001	<0.005
11606	89790	<5	<0.001	<0.005
11607 Check	89790	<5	<0.001	<0.005
11608	89791	<5	<0.001	<0.005
11609	89792	10	<0.001	0.010

PROCEDURE CODES: AL4Au

Certified By:

Derek Delplanck H.Bsc., Laboratory Manager

The results included on this report relate only to the items tested

The Certificate of Analysis should not be reproduced except in full, without the written approval of the laboratory

Page 2 of 5

AL903-0149-04/05/2007 03:15 PM



1046 Gorham Street
Thunder Bay, ON
Canada P7B 5X5

Tel: (807) 626-1630
Fax: (807) 622-7571

www accurassay.com
assay@accurassay.com

Certificate of Analysis

Thursday, April 05, 2007

Tri-Origin Explorations
3 Centre Street, Suite 206
Markham, ON, CAN
L3P3P9
Ph#: (905) 294-9942
Fax#: (905) 294-9943
Email northerngold@ntl.sympatico.ca, explore@triorigin.com

Date Received : 30-Jan-07

Date Completed : 01-Feb-07

Job # 200740149

Reference # ~~NA 07-01~~ DRILLHOLE

Sample #: 96 Core

Accurassay #	Client Id	Au ppb	Au oz/t	Au g/t (ppm)
11610	89793	<5	<0.001	<0.005
11611	89794	159	0.005	0.159
11612	89795	<5	<0.001	<0.005
11613	89796	15	<0.001	0.015
11614	89797	<5	<0.001	<0.005
11615	89798	<5	<0.001	<0.005
11616	89799	16	<0.001	0.016
11617	89800	<5	<0.001	<0.005
11618 Check	89800	<5	<0.001	<0.005
11619	89801	9	<0.001	0.009
11620	89802	66	0.002	0.066
11621	89803	13	<0.001	0.013
11622	89804	87	0.003	0.087
11623	89805	100	0.003	0.100
11624	89806	112	0.003	0.112
11625	89807	64	0.002	0.064
11626	89808	47	0.001	0.047
11627	89809	40	0.001	0.040
11628	89810	70	0.002	0.070
11629 Check	89810	67	0.002	0.067
11630	89811	270	0.008	0.270
11631	89812	222	0.006	0.222
11632	89813	228	0.007	0.228

PROCEDURE CODES: AL4Au

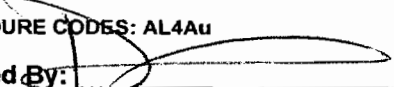
Certified By: 
Derek Demianiuk H.Bsc., Laboratory Manager

The results included on this report relate only to the items tested

The Certificate of Analysis should not be reproduced except in full, without the written approval of the laboratory

Page 3 of 5

AL903-0149-04/05/2007 03:15 PM



1046 Gorham Street
Thunder Bay, ON
Canada P7B 5X5

Tel: (807) 626-1630
Fax: (807) 622-7571

www accurassay.com
assay@accurassay.com

Certificate of Analysis

Thursday, April 05, 2007

Tri-Origin Explorations
3 Centre Street, Suite 206
Markham, ON, CAN
L3P3P9

Ph#: (905) 294-9942

Fax#: (905) 294-9943

Email northerngold@ntl.sympatico.ca, explore@triongin.com

Date Received : 30-Jan-07

Date Completed : 01-Feb-07

Job # 200740149

Reference *NA 07-01*

DRILL HOLES

Sample #: 96 Core

Accurassay #	Client Id	Au ppb	Au oz/t	Au g/t (ppm)
11633	89814	209	0.006	0.209
11634	89815	26	<0.001	0.026
11635	89816	125	0.004	0.125
11636	89817	230	0.007	0.230
11637	89818	432	0.013	0.432
11638	89819	99	0.003	0.099
11639	89820	169	0.005	0.169
11640 Check	89820	165	0.005	0.165
11641	89821	162	0.005	0.162
11642	89822	238	0.007	0.238
11643	89823	192	0.006	0.192
11644	89824	190	0.006	0.190
11645	89825	221	0.006	0.221
11646	89826	38	0.001	0.038
11647	89827	54	0.002	0.054
11648	89828	121	0.004	0.121
11649	89829	64	0.002	0.064
11650	89830	40	0.001	0.040
11651 Check	89830	38	0.001	0.038
11652	89831	57	0.002	0.057
11653	89832	20	<0.001	0.020
11654	89833	17	<0.001	0.017
11655	89834	495	0.014	0.495

PROCEDURE CODES: AL4Au

Certified By:

Derek Demianiuk H.Bsc., Laboratory Manager

The results included on this report relate only to the items tested

The Certificate of Analysis should not be reproduced except in full, without the written approval of the laboratory

Page 4 of 5

AL903-0149-04/05/2007 03:15 PM



1046 Gorham Street
Thunder Bay, ON
Canada P7B 5X5

Tel: (807) 626-1630
Fax: (807) 622-7571

www accurassay.com
assay@accurassay.com

Certificate of Analysis

Thursday, April 05, 2007

Tri-Origin Explorations
3 Centre Street, Suite 206
Markham, ON, CAN
L3P3P9
Ph#: (905) 294-9942
Fax#: (905) 294-9943
Email northerngold@ntl.sympatico.ca, explore@trionigin.com

Date Received : 30-Jan-07
Date Completed : 01-Feb-07
Job # 200740149

Reference ~~NA 07-01~~ *DRILLHOLE*
Sample #: 96 Core

Accurassay #	Client Id	Au ppb	Au oz/t	Au g/t (ppm)
11656	89835	56	0.002	0.056
11657	89836	34	0.001	0.034
11658	89837	70	0.002	0.070
11659	89838	67	0.002	0.067
11660	89839	5	<0.001	0.005
11661	89840	1039	0.030	1.039
11662 Check	89840	1037	0.030	1.037
11663	89841	1068	0.031	1.068
11664	89842	56	0.002	0.056
11665	89843	<5	<0.001	<0.005
11666	89844	7	<0.001	0.007
11667	89845	25	<0.001	0.025
11668	89846	<5	<0.001	<0.005

PROCEDURE CODES: AL4Au

Certified By:

Derek Demianiuk H.Bsc., Laboratory Manager

The results included on this report relate only to the items tested

The Certificate of Analysis should not be reproduced except in full, without the written approval of the laboratory

Ontario

Diamond Drilling Log Journal de forage au diamant

Complete this form and related sketch in duplicate. Remplir en deux exemplaires la présente formule et le croquis annexé

Fill in on every page Remplir ces cases chaque page

Hole No. Forage n° Page No. Page n°
NA07-03 1

* - units are in metres unless otherwise indicated

Drilling Company Compagnie de forage Heath & Sherwood Drilling Inc.	Core Size Dimensions de la carotte NQ	Collar Elevation Élévation du collier (surface) 304 metres	Bearing of hole from true North/Position du forage par rapport au nord vrai 185.4°	Total Footage Avancement total du forage 200.0 metres	Dip of Hole at Collar 90° N Inclinaison du forage au Collar/collier -45°	Address/Location where core stored Adresse/endroit où la carotte est stockée Northern Gold Mining Inc. Office 1470 Government Rd. W Kirkland Lake, Ont.	Map Reference No. N° de référence sur la carte G-3513	Claim No. N° de concession minière #4203559
Date Hole Started Date de commencement du forage Jan. 21, 2007	Date Completed Date d'achèvement Jan. 23/07	Date Logged Date d'inscription au journal Jan. 23-27/07	Logged by (print) Inscrit par (écrire en lettres moulées) Ken Rathee	Logged by (Signature) Inscrit par (signature) Ken Rathee	14 metres -45.2°	Location (Twp. Lot, Con. Or Lat. And Long.) Emplacement (canton, lot, concession, ou latitude et longitude) Hoblitzell Township UTM coordinates (NAD83) 576661 E 5481853 N	Property Name Nom de la propriété Burntbush Property	
Exploration Co., Owner or Optionee Compagnie d'exploration, propriétaire ou titulaire d'option Tn Origin Exploration Ltd.			125m -45.3°	FT/PI				
			FT/PI	FT/PI				

Footage/Avancement		Rock type	Description (Colour, grain size, texture, minerals, alteration, etc.)	Planar Feature Angle / Angle des caractéristiques planes	Core Specimen Footage / Longueur en pieds des carottes prélevées	Your Sample No. N° d'échantillon du prospecteur	Sample Footage Niveau de prélèvement de l'échantillon (en pieds)		Sample Length Longueur de l'échantillon	Assays/Analyses minéralurgiques
From/De	To/A	Type de roche	Description (Couleur, granulométrie, texture, minéraux, transformation, etc.)				From/De	To/A		
0.0	8.0	Casing								
8.0	56.4	Banded Ash Tuff (BIF) MAG ⇒	- dark to locally pale grey, fine-grained, sandy ash typically well-sorted, local sections of coarser clasts to 2 mm, local bleached sections imparts a foliated appearance @ ~ 55°-65° typically fr fine py + cp, locally conc, locally finely bedded @ 55-65°, local sections massive, typically highly MAG → Banded Fe, Fairly hard (probably siliceous), appears felsic							
			@ 10.9 - 4 cm. laminated Qtz-carb Vn @ 70° with 5-7% mg to cg cp + py			89847	10.7	11.3	0.6	
			@ 13.5 - 3 cm. Qtz-Carb Vn @ 65°			89848	13.3	14.3	1.0	
			@ 13.8 - 4 cm. somewhat irregular Qtz-Carb Vn @ 40°							
			@ 14.2 - 3 cm. Qtz-Carb Vn @ 50°							

2.34143

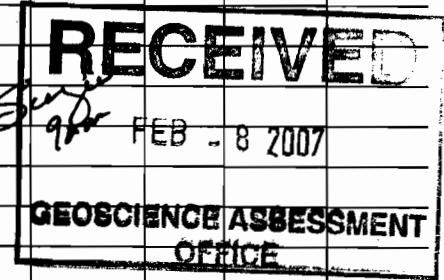

*For features such as foliation, bedding, schistosity, measured from the long axis of the core.

Drilling Company Compagnie de forage	Core Size Dimensions de la carotte	Collar Elevation Élévation du collier	Bearing of hole from true North/Position du forage par rapport au nord vrai	Total Footage Avancement total du forage	Dip of Hole at Collar 90° N Inclinaison du forage au Collar/collier	Address/Location where core stored Adresse/endroit où la carotte est stockée	Map Reference No. N° de référence sur la carte	Claim No. N° de concession minière	
Date Hole Started Date de commencement du forage	Date Completed Date d'achèvement	Date Logged Date d'inscription au journal	Logged by (print) Inscrit par (écrire en lettres moulées)	FT/PI	°				
Exploration Co., Owner or Optionee Compagnie d'exploration, propriétaire ou titulaire d'option			Logged by (Signature) Inscrit par (signature)	FT/PI	°				
1 n Origin Exploration Ltd.				FT/PI	°				
Location (Twp, Lot, Con. Or Lat. And Long.) Emplacement (canton, lot, concession, ou latitude et longitude)							Property Name Nom de la propriété		

Footage/Avancement		Rock type	Description (Colour, grain size, texture, minerals, alteration, etc.)	Planar Feature Angle * /Angle des caractéristiques planes	Core Specimen Footage / Longueur en pieds des carottes prélevées	Your Sample No. N° d'échantillon du prospecteur	Sample Footage Niveau de prélèvement de l'échantillon (en pieds)		Sample Length Longueur de l'échantillon	Assays/Analyses minéralurgiques		
From/De	To/A	Type de roche	Description (Couleur, granulométrie, texture, minéraux, transformation, etc.)				From/De	To/A				
			16.2-16.4 - becomes highly fractured with Q-C Vn's + strgr's to 6 cm @ 65°, 3-5% mg to cg py+cpy			89849	16.2	16.7	0.5			
			@ 17.8 - 7 mm. qtz. strgr. @ 55° with abundant cg cpy 'clots' to 5 mm. locally replacing qs			89850	17.6	18.0	0.4			
			@ 18.1 - bedding @ 70°									
			@ 23.6 - ground + broken core, no evidence of significant structure.									
			@ 24.1 - bedding @ 70°									
			@ 27.1 - bedding @ 73°									
			@ 29.4 - 0.5-2.0 mm. Qtz-Carb Strgr. @ 60, tr. minor fine py+cpy			89851	29.2	30.0	0.8			
			@ 29.6 - irregular 1-3 cm. Qtz-Carb Vn. @ 47° with cg cpy rimming QV									

*For features such as foliation, bedding, schistosity, measured from the long axis of the core.

Drilling Company Compagnie de forage	Core Size Dimensions de la carotte	Collar Elevation Élévation du collier	Bearing of hole from true North/Position du forage par rapport au nord vrai	Total Footage Avancement total du forage	Dip of Hole at Collar 90° N Inclinaison du forage au Collar/collier	Address/Location where core stored Adresse/endroit où la carotte est stockée	Map Reference No. N° de référence sur la carte	Claim No. N° de concession minière
Date Hole Started Date de commencement du forage	Date Completed Date d'achèvement	Date Logged Date d'inscription au journal	Logged by (print) Inscrit par (écrire en lettres moulées)		°		Location (Twp. Lot, Con. Or Lat. And Long.) Emplacement (canton, lot, concession, ou latitude et longitude)	
					°			
			Logged by (Signature) Inscrit par (signature)		°			
					°			
Exploration Co., Owner or Optionee Compagnie d'exploration, propriétaire ou titulaire d'option						Property Name Nom de la propriété		
Origin Exploration Ltd.								

Footage/Avancement		Rock type	Description (Colour, grain size, texture, minerals, alteration, etc.)	Planar Feature Angle / Angle des caractéristiques planes	Core Specimen Footage / Longueur en pieds des carottes prélevées	Your Sample No. N° d'échantillon du prospecteur	Sample Footage Niveau de prélèvement de l'échantillon (en pieds)		Sample Length Longueur de l'échantillon	Assays/Analyses minéralurgiques	
From/De	To/A	Type de roche	Description (Couleur, granulométrie, texture, minéraux, transformation, etc.)				From/De	To/A			
			@ 30.7 - bedding @ 70°								
			@ 31.9 - 7 mm. Qtz-carb strgr. @ 60° with abundant cq + mg cp + py rimming qs locally			89852	31.8	32.4	0.6		
			@ 32.2 - 5 mm. Qtz-carb strgr. @ 65° with minor fg to mg cp + py rimming qs								
			36.4-36.5 - 10 cm. Qtz-Carb Vn. with 20% caught-up, sub-angular tuff frag's, @ moderately steep but irregular angle TCA, tr. fg py+cp			89853	36.2	37.2	1.0		
			@ 37.0 - 10 cm. irregular Qtz-Carb Vn. @ ~ 70° with minor to fine py+cp								
			40.4-41.4 - tuff appears well-banded + finely bedded with alternating beds of fine + coarser grain-size and alternating bleached pale-grey to dark-grey bands, ~ 5% grey carb frags @ 65° concordant to bedding, tr. fine py+cp			89854	40.4	41.4	1.0		

*For features such as foliation, bedding, schistosity, measured from the long axis of the core.

Ontario

Diamond Drilling Log

Journal de forage au diamant

Complete this form and related sketch in duplicate.
Remplir en deux exemplaires la présente formule et le croquis annexé

Fill in on every page
Remplir ces cases
chaque page

Hole No. Forage n°	Page No. Page n°
NA07-03	4

Drilling Company Compagnie de forage	Core Size Dimensions de la carotte	Collar Elevation Élévation du collier	Bearing of hole from true North/Position du forage par rapport au nord vrai	Total Footage Avancement total du forage	Dip of Hole at Collar 90° N Inclinaison du forage au Collar/collier	Address/Location where core stored Adresse/endroit où la carotte est stockée	Map Reference No. N° de référence sur la carte	Claim No. N° de concession minière
Date Hole Started Date de commencement du forage	Date Completed Date d'achèvement	Date Logged Date d'inscription au journal	Logged by (print) Inscrit par (écrire en lettres moulées)			Location (Twp. Lot, Con. Or Lat. And Long.) Emplacement (canton, lot, concession, ou latitude et longitude)	Property Name Nom de la propriété	
Exploration Co., Owner or Optionee Compagnie d'exploration, propriétaire ou titulaire d'option			Logged by (Signature) Inscrit par (signature)					
Origin Exploration Ltd.								

Footage/Avancement		Rock type	Description (Colour, grain size, texture, minerals, alteration, etc.)	Planar Feature Angle / Angle des caractéristiques planes	Core Specimen Footage / Longueur en pieds des carottes prélevées	Your Sample No. N° d'échantillon du prospecteur	Sample Footage Niveau de prélèvement de l'échantillon (en pieds)		Sample Length Longueur de l'échantillon	Assays/Analyses minéralurgiques
From/De	To/A	Type de roche	Description (Couleur, granulométrie, texture, minéraux, transformation, etc.)				From/De	To/A		
			@ 40.7 - str. chl-carb slip @ 60° with minor mud							
			@ 40.8 - bedding @ 55°							
			@ 44.5 - 3 cm. QV @ 55°, doesn't appear mineralized							
			@ 45.5 - bedding @ 58°							
			@ 46.8 - 5 cm. vuggy Qtz-Carb Vn. @ 68°, doesn't appear mineralized							
			48.3-49.3 - tuff becomes finely bedded @ 70°, 3-5% fine py + cpy locally conc. as hairline strgs. concordant to bedding			89855	48.3	49.3	1.0	
			@ 51.9 - bedding @ 72°							

*For features such as foliation, bedding, schistosity, measured from the long axis of the core.

Drilling Company Compagnie de forage	Core Size Dimensions de la carotte	Collar Elevation Élévation du collier	Bearing of hole from true North/Position du forage par rapport au nord vrai	Total Footage Avancement total du forage	Dip of Hole at Collar 90° N Inclinaison du forage au Collar/collier	Address/Location where core stored Adresse/endroit où la carotte est stockée	Map Reference No. N° de référence sur la carte	Claim No. N° de concession minière
Date Hole Started Date de commencement du forage	Date Completed Date d'achèvement	Date Logged Date d'inscription au journal	Logged by (print) Inscrit par (écrire en lettres moulées)			Location (Twp. Lot, Con. Or Lat. And Long.) Emplacement (canton, lot, concession, ou latitude et longitude)	Property Name Nom de la propriété	
Exploration Co., Owner or Optionee Compagnie d'exploration, propriétaire ou titulaire d'option			Logged by (Signature) Inscrit par (signature)					
Origin Exploration Ltd.								

Footage/Avancement		Rock type	Description (Colour, grain size, texture, minerals, alteration, etc.)	Planar Feature Angle / Angle des caractéristiques planes	Core Specimen Footage / Longueur en pieds des carottes prélevées	Your Sample No. N° d'échantillon du prospecteur	Sample Footage Niveau de prélèvement de l'échantillon (en pieds)		Sample Length Longueur de l'échantillon	Assays/Analyses minéralurgiques
From/De	To/A	Type de roche	Description (Couleur, granulométrie, texture, minéraux, transformation, etc.)				From/De	To/A		
			52.8-52.9 - banded tuff becomes fract'd with a series of somewhat irregular 1-3 cm. qtz-carb stringers @ ~55° with minor coarse pyrrhotite becomes highly conc. around 52.8			89856	52.5	53.3	0.8	
			@ 53.0 - irregular 1-5 cm. qtz-carb vn. @ ~50°, minor tr po							
			@ 53.3 - 6 cm. irregular, fractured Qtz-Carb Vn. @ 60° with minor cg. biot.							
			55.3-56.4 - Fresh, dark grey banded ash tuff with minor qs's + qtz. frags generally concordant to bedding @ 70°, tr. fine py locally conc. as hairline stringers concordant to bedding			89857	55.3	56.4	1.1	
			@ 56.4 - sharp, natural contact with crystal tuff @ 60°							
56.4	86.9	Granodiorite	Granodiorite - grey, felsic, predominantly mg, porphyritic texture with 10-40% mg, subhedral to subhedral plagioclase in a slightly finer grained matrix, plagioclase often altered to carb. locally bleached pale grey, siliceous with 20% qtz, massive, non-MAC							

*For features such as foliation, bedding, schistosity, measured from the long axis of the core.

Drilling Company Compagnie de forage	Core Size Dimensions de la carotte	Collar Elevation Élévation du collier	Bearing of hole from true North Position du forage par rapport au nord vrai	Total Footage Avancement total du forage	Dip of Hole at Collar 90° N Inclinaison du forage au Collar/collier	Address/Location where core stored Adresse/endroit où la carotte est stockée	Map Reference No. N° de référence sur la carte	Claim No. N° de concession minière
Date Hole Started Date de commencement du forage	Date Completed Date d'achèvement	Date Logged Date d'inscription au journal	Logged by (print) Inscrit par (écrire en lettres moulées)				Location (Twp, Lot, Con. Or Lat. And Long.) Emplacement (canton, lot, concession, ou latitude et longitude)	
Exploration Co., Owner or Optionee Compagnie d'exploration, propriétaire ou titulaire d'option Origin Exploration Ltd.			Logged by (Signature) Inscrit par (signature)				Property Name Nom de la propriété	

Footage/Avancement		Rock type	Description (Colour, grain size, texture, minerals, alteration, etc.)	Planar Feature Angle ° / Angle des caractéristiques planes	Core Specimen Footage + Longueur en pieds des carottes prélevées	Your Sample No. N° d'échantillon du prospecteur	Sample Footage Niveau de prélèvement de l'échantillon (en pieds)		Sample Length Longueur de l'échantillon	Assays/Analyses minéralurgiques		
From/De	To/A	Type de roche	Description (Couleur, granulométrie, texture, minéraux, transformation, etc.)				From/De	To/A				
		cpy =>	56.4-57.3 - granodiorite initially well-fract'd with 25% highly irregular Qtz-Carb strgr's + frags to 3 cm throughout interval, 3-5% mg to cg 'clots' of cpy becomes highly conc. @ 56.5 (2x4 mm clots.)			89858	56.4	57.3	0.7			
			57.3-59.0 - granodiorite with minor Qtz-Carb strgr's + frags, 1-2% Fg to mg cpy + py			89859	57.3	58.2	0.9			
			@ 58.6 - fol'n @ 65°, bands of selectively bleached granodiorite			860	58.2	59.0	0.8			
			@ 65.1 - str. carb-chl. slip @ 45°									
			65.6-66.5 - ~10% carb-Qtz. Fract's with a 1.5 cm g-c strgr. @ 66.4 @ 53°, 1-2% Fg to cg cpy + py locally conc.			89861	65.6	66.5	0.9			
			67.2-68.0 - slightly fract'd throughout with local bleached sections, 3-5% mg to cg cpy conc. @ 67.3			89862	67.2	68.0	0.8			

*For features such as foliation, bedding, schistosity, measured from the long axis of the core.

Drilling Company Compagnie de forage	Core Size Dimensions de la carotte	Collar Elevation Élévation du collier	Bearing of hole from true North/Position du forage par rapport au nord vrai	Total Footage Avancement total du forage	Dip of Hole at Collar 90° N Inclinaison du forage au Collar/collier	Address/Location where core stored Adresse/endroit où la carotte est stockée	Map Reference No. N° de référence sur la carte	Claim No. N° de concession minière
Date Hole Started Date de commencement du forage	Date Completed Date d'achèvement	Date Logged Date d'inscription au journal	Logged by (print) Inscrit par (écrire en lettres moulées)				Location (Twp. Lot, Con. Or Lat. And Long.) Emplacement (canton, lot, concession, ou latitude et longitude)	
Exploration Co., Owner or Optionee Compagnie d'exploration, propriétaire ou titulaire d'option			Logged by (Signature) Inscrit par (signature)				Property Name Nom de la propriété	
Origin Exploration Ltd.								

Footage/Avancement		Rock type	Description (Colour, grain size, texture, minerals, alteration, etc.)	Planar Feature Angle ° /Angle des caractéristiques planes	Core Specimen Footage / Longueur en pieds des carottes prélevées	Your Sample No. N° d'échantillon du prospecteur	Sample Footage Niveau de prélèvement de l'échantillon (en pieds)		Sample Length Longueur de l'échantillon	Assays/Analyses minéralurgiques		
From/De	To/À	Type de roche	Description (Couleur, granulométrie, texture, minéraux, transformation, etc.)				From/De	To/À				
			74.1-75.7 - becomes moderately fract'd with abundant highly irregular Qtz. Strag's throughout with a 22 cm. Qtz. Vn. @ 74.2-74.4 @ 72°, minor fg to cg cpy,			89863	74.1	74.8	0.7			
			@ 75.5-11 cm. Qtz.-Carb Vn. @ 70° with a crse. 3x4 cm. Cpy 'clot'			864	74.8	75.7	0.9			
			76.6-77.6 - slightly fract'd with 10% qtz. fract's + frags throughout with a 1-2 cm QV @ 76.8 @ 61°, 2-3% mg to cg cpy + py conc. as coarse 'clot's with qtz., becomes alt. + reddened between 76.8-77.2			89865	76.6	77.6	1.0			
			82.5-82.6 - 1-10 cm. QV @ highly irregular TCR, tr. Fine py + cpy			89866	82.4	83.4	1.0			
			83.2-83.4 - highly irregular Qtz. fract's + frags to 3cm, minor tr. fine py									

*For features such as foliation, bedding, schistosity, measured from the long axis of the core.

Drilling Company Compagnie de forage	Core Size Dimensions de la carotte	Collar Elevation Élévation du collier	Bearing of hole from true North/Position du forage par rapport au nord vrai	Total Footage Avancement total du forage	Dip of Hole at Collar 90° N Inclinaison du forage au Collar/collier	Address/Location where core stored Adresse/endroit où la carotte est stockée	Map Reference No. N° de référence sur la carte	Claim No. N° de concession minière
Date Hole Started Date de commencement du forage	Date Completed Date d'achèvement	Date Logged Date d'inscription au journal	Logged by (print) Inscrit par (écrire en lettres moulées)				Location (Twp. Lot, Con. Or Lat. And Long.) Emplacement (canton, lot, concession, ou latitude et longitude)	
Exploration Co., Owner or Optionee Compagnie d'exploration, propriétaire ou titulaire d'option			Logged by (Signature) Inscrit par (signature)				Property Name Nom de la propriété	
Origin Exploration Ltd.								

Footage/Avancement		Rock type	Description (Colour, grain size, texture, minerals, alteration, etc.)	Planar Feature Angle ° /Angle des caractéristiques planes	Core Specimen Footage / Longueur en pieds des carottes prélevées	Your Sample No. N° d'échantillon du prospecteur	Sample Footage Niveau de prélèvement de l'échantillon (en pieds)		Sample Length Longueur de l'échantillon	Assays/Analyses minéralurgiques	
From/De	To/A	Type de roche	Description (Couleur, granulométrie, texture, minéraux, transformation, etc.)				From/De	To/A			
			84.1-86.9 - 25% Qtz. Frag's + highly irregular QV's generally @ 65° becomes conc. between 84.1-84.3, 84.7-85.1 + 86.1-86.4, locally altered + reddened, 1-2% fg to mg py + sp; locally conc. as coarse 'clasts' with qtz.			89867	84.1	85.0	0.9		
						68	85.0	86.0	1.0		
						69	86.0	86.9	0.9		
			@ 86.9 - sharp, natural contact with tuff @ 62°								
86.9	123.4	Ash Tuff	- dark grey, fine-grained, silty ash with only local sandy sections, well sorted, finely to very finely bedded throughout generally @ 70-80°, slightly fractured with minor carb-filled fract's throughout, local bleached pale grey sections, only very local sections slightly MAG			89870	86.9	87.9	1.0		
			@ 88.9 - bedding @ 78°								
			92.8-93.5 - becomes moderately fractured with ~ 20% carb-qtz-filled fractures to 2 cm, concordant to bedding @ 60° minor to py			89871	92.8	93.5	0.7		

*For features such as foliation, bedding, schistosity, measured from the long axis of the core.

Drilling Company Compagnie de forage		Core Size Dimensions de la carotte	Collar Elevation Élévation du collier	Bearing of hole from true North/Position du forage par rapport au nord vrai	Total Footage Avancement total du forage	Dip of Hole at Collar 90° N Inclinaison du forage au Collar/collier	Address/Location where core stored Adresse/endroit où la carotte est stockée		Map Reference No. N° de référence sur la carte	Claim No. N° de concession minière			
Date Hole Started Date de commencement du forage		Date Completed Date d'achèvement	Date Logged Date d'inscription au journal	Logged by (print) Inscrit par (écrire en lettres moulées)		Ft./Pi	Property Name Nom de la propriété		Location (Twp. Lot, Con. Or Lat. And Long.) Emplacement (canton, lot, concession, ou latitude et longitude)				
Exploration Co., Owner or Optionee Compagnie d'exploration, propriétaire ou titulaire d'option		Logged by (Signature) Inscrit par (signature)		Ft./Pi									
111 Origin Exploration Ltd.				Ft./Pi									
				Ft./Pi									
Footage/Avancement		Rock type	Description (Colour, grain size, texture, minerals, alteration, etc.)			Planar Feature Angle*	Core Specimen Footage & Length	Your Sample No.	Sample Footage		Sample Length	Assays/Analyses	
From/De	To/A	Type de roche	Description (Couleur, granulométrie, texture, minéraux, transformation, etc.)			Angle des caractéristiques planes	en pieds des carottes prélevées	N° d'échantillon du prospecteur	From/De	To/A	Longueur de l'échantillon	minéralurgiques	
			97.2-98.6 - fresh, dark grey, finely bedded, silty, ash tuff with 1-2% fine py, locally conc. as hairline stringers concordant to bedding @ 70°					89872	97.2	97.8	0.6		
								873	97.8	98.6	0.8		
			100.0-101.0 - fresh tuff as described above with 1-2% vty dissemin. sulf. locally conc. as hairline stringers concordant to bedding @ 70°					89874	100.0	101.0	1.0		
			@ 101.5 - bedding @ 73°										
			@ 105.4 - ground & broken core, no evidence of significant structure.										
			@ 106.3 - bedding @ 78°										
			106.7-107.3 - becomes fract'd with an irregular 14 cm					89875	106.7	107.3	0.6		
			QV's => QV @ 106.7-106.9 @ ~65°, a 6cm. QV @ 107.0 @ 70° and a 2cm. QV @ 107.3 @ 48°, 2-3% fine py conc. rimming Qtz.										

*For features such as foliation, bedding, schistosity, measured from the long axis of the core.

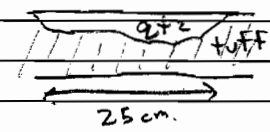
Drilling Company Compagnie de forage		Core Size Dimensions de la carotte	Collar Elevation Élévation du collier	Bearing of hole from true North/Position du forage par rapport au nord vrai	Total Footage Avancement total du forage	Dip of Hole at Collar 90° N Inclinaison du forage au Collar/collier	Address/Location where core stored Adresse/endroit où la carotte est stockée		Map Reference No. N° de référence sur la carte	Claim No. N° de concession minière			
Date Hole Started Date de commencement du forage		Date Completed Date d'achèvement	Date Logged Date d'inscription au journal	Logged by (print) Inscrit par (écrire en lettres moulées)		° Fl./Pi		Location (Twp. Lot, Con. Or Lat. And Long.) Emplacement (canton, lot, concession, ou latitude et longitude)					
Exploration Co., Owner or Optionee Compagnie d'exploration, propriétaire ou titulaire d'option ... Origin Exploration Ltd.				Logged by (Signature) Inscrit par (signature)		° Fl./Pi		Property Name Nom de la propriété					
Footage/Avancement		Rock type Type de roche	Description (Colour, grain size, texture, minerals, alteration, etc.) Description (Couleur, granulométrie, texture, minéraux, transformation, etc.)				Planar Feature Angle / Angle des caractéristiques planes	Core Specimen Footage / Longueur en pieds des carottes prélevées	Your Sample No. N° d'échantillon du prospecteur	Sample Footage Niveau de prélèvement de l'échantillon (en pieds)	Sample Length Longueur de l'échantillon	Assays/Analyses minéralurgiques	
From/De	To/A									From/De	To/A		
			@ 109.8 - bedding @ 70°										
			110.4 - 111.1 - black, fresh tuff with a 1.5 cm Qtz. str. @ 110.6 @ 47° + a 1-3 cm. Qtz. Vn. @ 110.7 @ 42°, 3-5% fine py (po?) with Qtz.						89876	110.4	111.1	0.7	
			@ 111.0 - bedding @ 63°										
			112.2 - 112.8 - black, fresh tuff with a 2.5 cm. Qtz. - Carb Frag evident in just half the core with 3-5% fg to mg py, conc. rimming Qtz.						89877	112.2	112.8	0.6	
													
			112.8 - 113.5 - ground + broken core, no evidence of significant structure										
			@ 116.7 - bedding @ 47°										

*For features such as foliation, bedding, schistosity, measured from the long axis of the core.

Ontario

Diamond Drilling Log

Journal de forage au diamant

Complete this form and related sketch in duplicate. REMPLIR en deux exemplaires la présente formule et le croquis annexé

Fill in on every page REMPLIR ces cases chaque page

Hole No. Forage n°	Page No. Page n°
NA07-03	11

Drilling Company Compagnie de forage	Core Size Dimensions de la carotte	Collar Elevation Élévation du collier	Bearing of hole from true North/Position du forage par rapport au nord vrai	Total Footage Avancement total du forage	Dip of Hole at Collar 90° N Inclinaison du forage au Collar/collier	Address/Location where core stored Adresse/endroit où la carotte est stockée	Map Reference No. N° de référence sur la carte	Claim No. N° de concession minière	
Date Hole Started Date de commencement du forage	Date Completed Date d'achèvement	Date Logged Date d'inscription au journal	Logged by (print) Inscrit par (écrire en lettres moulées)				Location (Twp. Lot, Con. Or Lat. And Long.) Emplacement (canton, lot, concession, ou latitude et longitude)		
Exploration Co., Owner or Optionee Compagnie d'exploration, propriétaire ou titulaire d'option			Logged by (Signature) Inscrit par (signature)					Property Name Nom de la propriété	
Origin Exploration Ltd.									

Footage/Avancement		Rock type	Description (Colour, grain size, texture, minerals, alteration, etc.) Description (Couleur, granulométrie, texture, minéraux, transformation, etc.)	Planar Feature Angle / Angle des caractéristiques planes	Core Specimen Footage / Longueur en pieds des carottes prélevées	Your Sample No. N° d'échantillon du prospecteur	Sample Footage Niveau de prélèvement de l'échantillon (en pieds)		Sample Length Longueur de l'échantillon	Assays/Analyses minéralurgiques		
From/De	To/A	Type de roche					From/De	To/A				
			@120.0 - series of hairline carb fract's @63° with abundant cg to mg, cpy + py with fract's			89878	119.7	120.4	0.7			
			122.6-123.4 - fresh, grey, banded ash tuff with local, selective bleached bands with 2-3% dissem. cg cpy			89879	122.6	123.4	0.8			
			@123.3 - bedding @60°									
			@123.4 - sharp, natural contact with granodiorite @57°									
123.4	162.5	Granodiorite	-as described in previous interval, porphyritic texture with 40-50% mg to cg plag phen's in a slightly finer-grained, mg plag, qtz, matrix, only 5-10% mafics, locally slightly MAC, initially slightly altered + reddened, freshens to grey at depth									
			@123.6 - str. chl - carb slip @53°									

*For features such as foliation, bedding, schistosity, measured from the long axis of the core.

Drilling Company Compagnie de forage	Core Size Dimensions de la carotte	Collar Elevation Élévation du collier	Bearing of hole from true North/Position du forage par rapport au nord vrai	Total Footage Avancement total du forage	Dip of Hole at Collar 90° N Inclinaison du forage au Collar/collier	Address/Location where core stored Adresse/endroit où la carotte est stockée	Map Reference No. N° de référence sur la carte	Claim No. N° de concession minière
Date Hole Started Date de commencement du forage	Date Completed Date d'achèvement	Date Logged Date d'inscription au journal	Logged by (print) Inscrit par (écrire en lettres moulées)	FL/PI	°	Location (Twp. Lot, Con. Or Lat. And Long.) Emplacement (canton, lot, concession, ou latitude et longitude)	Property Name Nom de la propriété	
Exploration Co., Owner or Optionee Compagnie d'exploration, propriétaire ou titulaire d'option			Logged by (Signature) Inscrit par (signature)	FL/PI	°			
Origin Exploration Ltd.				FL/PI	°			
				FL/PI	°			

Footage/Avancement		Rock type	Description (Colour, grain size, texture, minerals, alteration, etc.)	Planar Feature Angle / Angle des caractéristiques planes	Core Specimen Footage / Longueur en pieds des carottes prélevées	Your Sample No. N° d'échantillon du prospecteur	Sample Footage Niveau de prélèvement de l'échantillon (en pieds)		Sample Length Longueur de l'échantillon	Assays/Analyses minéralurgiques	
From/De	To/A	Type de roche	Description (Couleur, granulométrie, texture, minéraux, transformation, etc.)				From/De	To/A			
			126.9-129.2 - granodiorite altered & reddened with primary texture obliterated locally with more intense alteration, locally fract'd generally @ 45° with minor carb-gtz. Fracture-filling, minor fine py with fract's.			89880	126.9	127.7	0.8		
						881	127.7	128.4	0.7		
						882	128.4	129.2	0.8		
			@ 128.1 - str. chl. slip @ 45°								
			@ 131.0 - granodiorite freshens, grey								
			135.1-136.5 - broken core, no evidence of significant structure.								
			139.8-141.9 - bleached, mafic-poor, light-gray cut by the occasional 1-2 cm. gtz.-strgr's generally @ 50°, doesn't appear mineralized			89883	139.8	140.8	1.0		
						884	140.8	141.9	1.1		
			@ 143.4 - str. chl. slip @ 35°								

*For features such as foliation, bedding, schistosity, measured from the long axis of the core.

Ontario

Diamond Drilling Log

Journal de forage au diamant

Complete this form and related sketch in duplicate. REMPLIR en deux exemplaires la présente formule et le croquis annexé

Fill in on every page REMPLIR ces cases chaque page

Hole No. Forage n° **NA07-03**
Page No. Page n° **13**

Drilling Company Compagnie de forage	Core Size Dimensions de la carotte	Collar Elevation Élévation du collier	Bearing of hole from true North/Position du forage par rapport au nord vrai	Total Footage Avancement total du forage	Dip of Hole at Collar 90° N Inclinaison du forage au Collar/collier	Address/Location where core stored Adresse/endroit où la carotte est stockée	Map Reference No. N° de référence sur la carte	Claim No. N° de concession minière
Date Hole Started Date de commencement du forage	Date Completed Date d'achèvement	Date Logged Date d'inscription au journal	Logged by (print) Inscrit par (écrire en lettres moulées)	FL/Pi	°	Location (Twp. Lot, Con. Or Lat. And Long.) Emplacement (canton, lot, concession, ou latitude et longitude)	Property Name Nom de la propriété	
Exploration Co., Owner or Optionee Compagnie d'exploration, propriétaire ou titulaire d'option			Logged by (Signature) Inscrit par (signature)	FL/Pi	°			
Origin Exploration Ltd.				FL/Pi	°			
				FL/Pi	°			

Footage/Avancement		Rock type	Description (Colour, grain size, texture, minerals, alteration, etc.)	Planar Feature Angle / Angle des caractéristiques planes	Core Specimen Footage / Longueur en pieds des carottes prélevées	Your Sample No. N° d'échantillon du prospecteur	Sample Footage Niveau de prélèvement de l'échantillon (en pieds)		Sample Length Longueur de l'échantillon	Assays/Analyses minéralurgiques
From/De	To/A	Type de roche	Description (Couleur, granulométrie, texture, minéraux, transformation, etc.)				From/De	To/A		
			145.4-147.3 - pale grey, relatively fresh granodiorite with a 4 cm. QV @ 145.6 @ 48°, an irregular 2-4 cm. Qtz. frag @ 146.9, a 5 cm QV @ 147. Ne 50°, and a 1-4 cm. irregular Qtz. Vn. @ ~45°, minor tr. fine py locally conc. rimming Qtz.			89885	145.4	146.3	0.9	
						886	146.3	147.3	1.0	
			@ 152.4 - str. chl-carb slip @ 15°							
			@ 152.9 - 1-2 cm. pink carb-chl-Qtz. fracture @ <10°							
			152.9-154.4 - broken core, locally ground, no evidence of significant structure.							
			@ 160.1 - 1 cm. carb-chl. fracture @ 23°							
			161.5-162.5 - 5% irregular Qtz. strags + frags to 2 cm., tr. fg to mg, cpy+py locally conc. with Qtz.			89887	161.5	162.5	1.0	
			@ 162.5 - sharp natural contact with tuff @ 53°							

*For features such as foliation, bedding, schistosity, measured from the long axis of the core.

Drilling Company Compagnie de forage	Core Size Dimensions de la carotte	Collar Elevation Élévation du collier	Bearing of hole from true North/Position du forage par rapport au nord vrai	Total Footage Avancement total du forage	Dip of Hole at Collar 90° N Inclinaison du forage au Collar/collier	Address/Location where core stored Adresse/endroit où la carotte est stockée	Map Reference No. N° de référence sur la carte	Claim No. N° de concession minière
Date Hole Started Date de commencement du forage	Date Completed Date d'achèvement	Date Logged Date d'inscription au journal	Logged by (print) Inscrit par (écrire en lettres moulées)				Location (Twp. Lot, Con. Or Lat. And Long.) Emplacement (canton, lot, concession, ou latitude et longitude)	
Exploration Co., Owner or Optionee Compagnie d'exploration, propriétaire ou titulaire d'option			Logged by (Signature) Inscrit par (signature)				Property Name Nom de la propriété	
... Origin Exploration Ltd.								

Footage/Avancement		Rock type	Description (Colour, grain size, texture, minerals, alteration, etc.)	Planar Feature Angle / Angle des caractéristiques planes	Core Specimen Footage / Longueur en pieds des carottes prélevées	Your Sample No. N° d'échantillon du prospecteur	Sample Footage Niveau de prélèvement de rééchantillon (en pieds)		Sample Length Longueur de rééchantillon	Assays/Analyses minéralurgiques
From/De	To/A	Type de roche	Description (Couleur, granulométrie, texture, minéraux, transformation, etc.)				From/De	To/A		
162.5	182.3	Ash Tuff	-dark grey, fine-grained, silty ash, as described in previous interval, locally banded with selective pale-grey, bleached bands & local fine-bedded, non-MAG							
			162.5-163.9 - dark grey, silty ash, ~15% mg to cg (1-2mm), chl-carb, sub-rounded clasts, 3-5% fg py often conc. in the chl-carb clasts			89888	162.5	163.2	0.7	
						89	163.2	163.9	0.7	
			@164.1 - bedding @ 73°							
			165.7-168.7 - dark grey, fresh, silty ash tuff with 1-2% fg py, locally conc. in hairline string's concordant to bedding @ 55°, minor cg 'clots' of py to 3mm conc. around 166.9, minor irregular carb-filled tracts to 1cm.			89890	165.7	166.7	1.0	
						91	166.7	167.7	1.0	
						92	167.7	168.7	1.0	
			@167.8 - bedding @ 55°							
			@177.0 - 5 cm. laminated carb fracture @ 65°							

*For features such as foliation, bedding, schistosity, measured from the long axis of the core.

Drilling Company Compagnie de forage	Core Size Dimensions de la carotte	Collar Elevation Élévation du collier	Bearing of hole from true North/Position du forage par rapport au nord vrai	Total Footage Avancement total du forage	Dip of Hole at Collar 90° N Inclinaison du forage au Collar/collier	Address/Location where core stored Adresse/endroit où la carotte est stockée	Map Reference No. N° de référence sur la carte	Claim No. N° de concession minière
Date Hole Started Date de commencement du forage	Date Completed Date d'achèvement	Date Logged Date d'inscription au journal	Logged by (print) Inscrit par (écrire en lettres moulées)		Ft./Pi		Location (Twp. Lot, Con. Or Lat. And Long.) Emplacement (canton, lot, concession, ou latitude et longitude)	
Exploration Co., Owner or Optionee Compagnie d'exploration, propriétaire ou titulaire d'option Origin Exploration Ltd.			Logged by (Signature) Inscrit par (signature)		Ft./Pi		Property Name Nom de la propriété	

Footage/Avancement		Rock type	Description (Colour, grain size, texture, minerals, alteration, etc.)	Planar Feature Angle ° / Angle des caractéristiques planes	Core Specimen Footage / Longueur en pieds des carottes prélevées	Your Sample No. N° d'échantillon du prospecteur	Sample Footage Niveau de prélèvement de l'échantillon (en pieds)		Sample Length Longueur de l'échantillon	Assays/Analyses minéralurgiques		
From/De	To/À	Type de roche	Description (Couleur, granulométrie, texture, minéraux, transformation, etc.)				From/De	To/À				
			@178.0 - bedding @ 63°									
			@180.9 - 2-3 cm. Qtz.-Carb.-Chl.-Vn. @ 55°, doesn't appear mineralized									
			@182.3 - sharp, natural, bedded contact with lapilli tuff @ 30°									
182.3	183.3	Felsic Lapilli Tuff	- ~40% sub-rounded lithic & volc. frag's to 1 cm, cemented in a fine-ash matrix abundant replaced by secondary carb, reacts vigorously to HCl, frag's appear felsic in composition, massive, non-MAG									
			@183.3 - somewhat sharp, irregular contact with ash tuff									
183.3	200.0	Ash Tuff	- dark grey, fine-grained, silty ash tuff as described in previous interval, non-MAG									

*For features such as foliation, bedding, schistosity, measured from the long axis of the core.

Diamond Drilling Log Journal de forage au diamant

Complete this form and related sketch in duplicate.
Remplir en deux exemplaires la présente formule et le croquis annexé

Fill in on every page
Remplir ces cases
chaque page

Hole No. Forage n° **NA07-03**
Page No. Page n° **16**

Drilling Company Compagnie de forage	Core Size Dimensions de la carotte	Collar Elevation Élévation du collier	Bearing of hole from true North/Position du forage par rapport au nord vrai	Total Footage Avancement total du forage	Dip of Hole at Collar 90° N Inclinaison du forage au Collar/collier	Address/Location where core stored Adresse/endroit où la carotte est stockée	Map Reference No. N° de référence sur la carte	Claim No. N° de concession minière
Date Hole Started Date de commencement du forage	Date Completed Date d'achèvement	Date Logged Date d'inscription au journal	Logged by (print) Inscrit par (écrire en lettres moulées)			Location (Twp. Lot, Con. Or Lat. And Long.) Emplacement (canton, lot, concession, ou latitude et longitude)	Property Name Nom de la propriété	
Exploration Co., Owner or Optionee Compagnie d'exploration, propriétaire ou titulaire d'option			Logged by (Signature) Inscrit par (signature)					
Origin Exploration Ltd.								

Footage/Avancement		Rock type	Description (Colour, grain size, texture, minerals, alteration, etc.)	Planar Feature Angle / Angle des caractéristiques planes	Core Specimen Footage / Longueur en pieds des carottes prélevées	Your Sample No. N° d'échantillon du prospecteur	Sample Footage Niveau de prélèvement de l'échantillon (en pieds)		Sample Length Longueur de l'échantillon	Assays/Analyses minéralurgiques	
From/De	To/A	Type de roche	Description (Couleur, granulométrie, texture, minéraux, transformation, etc.)				From/De	To/A			
			@ 183.9 - 2-3 cm QV @ 65° with fg py conc. rimming QV			89893	183.3	184.3	1.0		
			185.5-186.8 - Fresh, dark grey, fg ash tuff, ~5% highly irregular, carb. fract's to 2 cm. conc. between 186.1-186.7 with 3-5% fg to mg py becoming highly conc. with carb fract's.			89894	185.5	186.1	0.6		
						95	186.1	186.8	0.7		
			188.6-189.6 - tuff becomes fract'd, slightly bleached with ~10% carb-filled fract's to 1cm, fract's irregular with the most common orientation = 35°, 2-3% dissem fg sulf only occasionally			89896	188.6	189.6	1.0		
			@ 190.8 - 1-2 cm. highly irregular Qtz-Carb. fracture with abundant fg-mg py + cp, 1-2% py throughout interval locally conc. in hairline fract's			89897	190.3	191.0	0.7		
			@ 195.0 - bedding @ 45°								
			@ 200.0 - END OF HOLE								

*For features such as foliation, bedding, schistosity, measured from the long axis of the core.



1046 Gorham Street
Thunder Bay, ON
Canada P7B 5X5

Tel: (807) 626-1630
Fax: (807) 622-7571

www accurassay.com
assay@accurassay.com

Certificate of Analysis

Thursday, April 05, 2007

Tri-Origin Explorations
3 Centre Street, Suite 206
Markham, ON, CAN
L3P3P9
Ph#: (905) 294-9942
Fax#: (905) 294-9943
Email northerngold@ntl.sympatico.ca, explore@triorigin.com

Date Received : 09-Mar-07
Date Completed : 20-Mar-07
Job # 200740568
Reference : *NA 07-03.*
Sample #: 136 Core

NA 07-03

Accurassay #	Client Id	Au ppb	Au oz/t	Au g/t (ppm)
46467	89847	10	<0.001	0.010
46468	89848	43	0.001	0.043
46469	89849	55	0.002	0.055
46470	89850	461	0.013	0.461
46471	89851	22	<0.001	0.022
46472	89852	179	0.005	0.179
46473	89853	20	<0.001	0.020
46474	89854	15	<0.001	0.015
46475	89855	27	<0.001	0.027
46476	89856	15	<0.001	0.015
46477	Check 89856	15	<0.001	0.015
46478	89857	7	<0.001	0.007
46479	89858	265	0.008	0.265
46480	89859	7	<0.001	0.007
46481	89860	<5	<0.001	<0.005
46482	89861	<5	<0.001	<0.005
46483	89862	444	0.013	0.444
46484	89863	7	<0.001	0.007
46485	89864	43	0.001	0.043
46486	89865	78	0.002	0.078
46487	89866	89	0.003	0.089
46488	Check 89866	98	0.003	0.098
46489	89867	6	<0.001	0.006

PROCEDURE CODES: AL4Au

Certified By:

[Signature]
Derek Demaniuk H.Bsc., Laboratory Manager

The results included on this report relate only to the items tested

The Certificate of Analysis should not be reproduced except in full, without the written approval of the laboratory

Page 1 of 7



ACCURASSAY
LABORATORIES

1046 Gorham Street
Thunder Bay, ON
Canada P7B 5X5

Tel: (807) 626-1630
Fax: (807) 622-7571

www accurassay.com
assay@accurassay.com

Certificate of Analysis

Thursday, April 05, 2007

Tri-Origin Explorations
3 Centre Street, Suite 206
Markham, ON, CAN
L3P3P9
Ph#: (905) 294-9942
Fax#: (905) 294-9943
Email northerngold@ntl.sympatico.ca, explore@triorigin.com

Date Received : 09-Mar-07
Date Completed : 20-Mar-07
Job # 200740568
Reference : *NA 07-03*
Sample #: 136 Core

NA 07-03

Accurassay #	Client Id	Au ppb	Au oz/t	Au g/t (ppm)
46490	89868	<5	<0.001	<0.005
46491	89869	28	<0.001	0.028
46492	89870	7	<0.001	0.007
46493	89871	<5	<0.001	<0.005
46494	89872	<5	<0.001	<0.005
46495	89873	10	<0.001	0.010
46496	89874	<5	<0.001	<0.005
46497	89875	12	<0.001	0.012
46498	89876	28	<0.001	0.028
46499 Check	89876	27	<0.001	0.027
46500	89877	7	<0.001	0.007
46501	89878	<5	<0.001	<0.005
46502	89879	9	<0.001	0.009
46503	89880	<5	<0.001	<0.005
46504	89881	5	<0.001	0.005
46505	89882	<5	<0.001	<0.005
46506	89883	<5	<0.001	<0.005
46507	89884	<5	<0.001	<0.005
46508	89885	<5	<0.001	<0.005
46509	89886	7	<0.001	0.007
46510 Check	89886	<5	<0.001	<0.005
46511	89887	<5	<0.001	<0.005
46512	89888	8	<0.001	0.008

PROCEDURE CODES: AL4Au

Page 2 of 7

Certified By:

[Signature]
Derek Demianiuk H.Bsc., Laboratory Manager

The results included on this report relate only to the items tested

The Certificate of Analysis should not be reproduced except in full, without the written approval of the laboratory

AL903-0149-04/05/2007 03:15 PM



1046 Gorham Street
Thunder Bay, ON
Canada P7B 5X2

Tel: (807) 626-1630
Fax: (807) 622-7571

www accurassay.com
assay@accurassay.com

Certificate of Analysis

Thursday, April 05, 2007

Tri-Origin Explorations
3 Centre Street, Suite 206
Markham, ON, CAN
L3P3P9
Ph#: (905) 294-9942
Fax#: (905) 294-9943
Email northerngold@ntl.sympatico.ca, explore@triorigin.com

Date Received : 09-Mar-07
Date Completed : 20-Mar-07
Job # 200740568
Reference : *NA 07-03*
Sample #: 136 Core

NA 07-03

Accurassay #	Client Id	Au ppb	Au oz/t	Au g/t (ppm)
46513	89889	7	<0.001	0.007
46514	89890	<5	<0.001	<0.005
46515	89891	<5	<0.001	<0.005
46516	89892	<5	<0.001	<0.005
46517	89893	6	<0.001	0.006
46518	89894	<5	<0.001	<0.005
46519	89895	<5	<0.001	<0.005
46520	89896	<5	<0.001	<0.005
46521 Check	89896	<5	<0.001	<0.005
46522	89897	<5	<0.001	<0.005
46523	89898	<5	<0.001	<0.005
46524	89899	<5	<0.001	<0.005
46525	89900	<5	<0.001	<0.005
46526	809001	<5	<0.001	<0.005
46527	809002	<5	<0.001	<0.005
46528	809003	<5	<0.001	<0.005
46529	809004	<5	<0.001	<0.005
46530	809005	<5	<0.001	<0.005
46531	809006	20	<0.001	0.020
46532 Check	809006	18	<0.001	0.018
46533	809007	<5	<0.001	<0.005
46534	809008	<5	<0.001	<0.005
46535	809009	<5	<0.001	<0.005

PROCEDURE CODES: AL4Au

Page 3 of 7

Certified By:
Derek Demianuk H.Bsc., Laboratory Manager

The results included on this report relate only to the items tested
The Certificate of Analysis should not be reproduced except in full, without the written approval of the laboratory