

PRODIGIO&MILK MY MACHINE

NESPRESSO®



Job: NES-432001-2003Q-3 ProdigioMilk

Objekt: pCover

Version: --

Seite: p1

Datum: 15-06-05

Uhrzeit: 15:03:42

von: timea.trojko

Ⓝ	Instruction manual	Ⓧ	Manuel d'instructions	3
Ⓞ	Manual de instrucciones	Ⓟ	Manual de instruções	32
Ⓝ	Brukerhåndbok	Ⓞ	Bruksanvisning	64
Ⓝ	Brugermanual	Ⓧ	Käyttöohje	96
Ⓝ	Kullanım kilavuzu	Ⓧ	Инструкция по эксплуатации	128



Job: NES-432001-2003Q-3 ProdigioMilk

Objekt: pCover

Version: --

Seite: p2

Datum: 15-06-05

Uhrzeit: 15:03:42

von: timea.trojko

Nespresso Prodigio&Milk So much more than coffee

Nespresso Prodigio&Milk So much more than coffee

Congratulations on getting Nespresso Prodigio&Milk, the first connected coffee machine by Nespresso. This machine allows you to brew a perfect coffee time after time while living a unique connected experience with your Smartphone or Tablet. To start your connected journey, you will need to get the Nespresso App and paired your Smartphone to your Nespresso Prodigio&Milk machine.

Congratulations on getting Nespresso Prodigio&Milk, the first connected Nespresso machine. This machine allows you to brew a perfect coffee time after time while living a unique connected experience via your Smartphone or Tablet. To start your connected journey, you will need to get the Nespresso App and paired your Smartphone to your Nespresso Prodigio&Milk machine.

Nespresso Prodigio&Milk is compatible with:
Nespresso Prodigio&Milk is compatible with:



iPhone 4S and newer
 iPhone 4S and newer



iPad 3rd Generation and newer
 iPad 3rd Generation and newer
 iPod touch 5th Generation and newer
 iPod touch 5th Generation and newer
 iPad mini
 iPad mini



Select Android devices
 compatible **Bluetooth®** Smart
 Select Android devices
 compatible **Bluetooth®** Smart
 Android 4.3 and newer
 Android 4.3 and newer



Job: NES-432001-2003Q-3 ProdigioMilk
Objekt: qInlet
Version: --
Seite: q1

Datum: 15-06-05
Uhrzeit: 15:03:42
von: timea.trojko

EN Get the App / Get the App

FR

- 1 **Download** the *Nespresso* App
If you have it already, please update the App

Download the *Nespresso* App
If you have it already, please update the App



- 2 **Launch** the App

Launch the App



- 3 **Click** on the Machine Icon.

Click on the Machine Icon.



Pairing / Pairing

i **Please remember** that the *Bluetooth®* mode must be activated beforehand on your smartphone or tablet.

Please remember that the *Bluetooth®* mode must be activated beforehand on your smartphone or tablet.

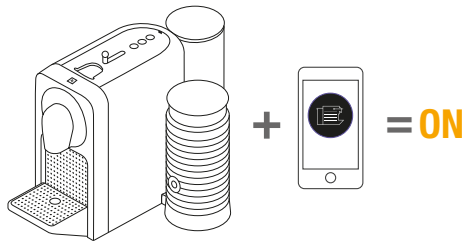

When the pairing is completed, the *Nespresso* Light will blink 3 times.

When the pairing is completed, the *Nespresso* Light will blink 3 times.

Connectivity Functions / Connectivity Functions

WHAT ARE THEY?

- Capsules stock management
- Schedule a coffee brewing
- Brew Now
- Maintenance notifications
- Descaling alert
- And more to see via the App

WHAT ARE THEY?

- Capsules stock management
- Schedule a coffee brewing
- Brew Now
- Maintenance notifications
- Descaling alert
- And more to see via the App



Job: NES-432001-2003Q-3 ProdigioMilk
Objekt: qInlet
Version: --
Seite: q2

Datum: 15-06-05
Uhrzeit: 15:03:42
von: timea.trojko

Packaging Content / Packaging Content

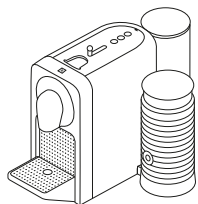

1 **Prodigio&Milk** Coffee Machine

Prodigio&Milk Coffee Machine



X16

2 **Tasting Box** of Nespresso
Grands Crus Capsules

Tasting Box of Nespresso
Grands Crus Capsules

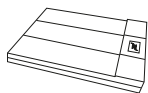

3 **Nespresso** Welcome Folder

Nespresso Welcome Folder

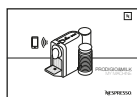

4 **User** Manual

User Manual



5 **Water Hardness** Test Stick

Water Hardness Test Stick

Prodigio&Milk

EN

FR

INSTRUCTION MANUAL

Nespresso is an exclusive system creating the perfect Espresso, time after time. All Nespresso machines are equipped with a unique extraction system that guarantees up to 19 bar pressure. Each parameter has been calculated with great precision to ensure that all the aromas from each Grand Cru can be extracted, to give the coffee body and create an exceptionally thick and smooth crema.

CAUTION: when you see this sign, please refer to the safety precautions to avoid possible harm and damage.

INFORMATION: when you see this sign, please take note of the advice for the correct and safe usage of your coffee machine.

INFORMATION: when you see this sign, please note that you can also use the App for this function. Consult App for more information.

Specifications / Specifications

~ 220V-240V, 50-60 Hz, <1260 W

Pmax 19 bar

kg ~ 4 kg / 8 lbs

0.8 L / 27 oz

21.84 cm 25.53 cm 37.4 cm
8.6 in 10.53 in 14.7 in



Job: NES-432001-2003Q-3 ProdigioMilk
Objekt: qInlet
Version: --
Seite: q3

Datum: 15-06-05
Uhrzeit: 15:03:42
von: timea.trojko



Prodigio&Milk

MANUEL D'INSTRUCTIONS

Nespresso, is an exclusive system creating the perfect Espresso, time after time. All Nespresso machines are equipped with a unique extraction system that guarantees up to 19 bar pressure. Each parameter has been calculated with great precision to ensure that all the aromas from each Grand Cru can be extracted, to give the coffee body and create an exceptionally thick and smooth crema.

⚠ AVERTISSEMENT: lorsque ce symbole apparait, veuillez consulter les consignes de sécurité pour éviter d'éventuels dangers et dommages.

i INFORMATION: lorsque ce symbole apparait, veuillez prendre connaissance du conseil pour une utilisation sûre et conforme de votre appareil.

 **INFORMATION:** when you see this sign, please note that you can also use the App for this function. Consult App for more information.

Content / Content

<i>Nespresso Prodigio&Milk / Nespresso Prodigio&Milk</i>	3
<i>Get the App / Get the App</i>	4
<i>Pairing / Pairing</i>	4
<i>Connectivity Functions / Connectivity Functions</i>	4
<i>Packaging Content / Packaging Content</i>	5
<i>Prodigio&Milk / Prodigio&Milk</i>	5-6
<i>Specifications / Specifications</i>	5
<i>Safety Precautions / Safety Precautions</i>	7-13
<i>Machine Overview / Machine Overview</i>	14
<i>First Use / First Use</i>	15-16
<i>Regular Coffee Preparation / Regular Coffee Preparation</i>	17-18
<i>Milk Froth Preparation / Milk Froth Preparation</i>	19
<i>Energy Saving Concept / Energy Saving Concept</i>	20
<i>Programming the Water Volume / Programming the Water Volume</i>	20
<i>Reset to Factory Setting / Reset to Factory Setting</i>	21
<i>Emptying the System / Emptying the System</i>	21
<i>Cleaning / Cleaning</i>	22
<i>Descaling / Descaling</i>	23-25
<i>Troubleshooting / Troubleshooting</i>	26-27
<i>Troubleshooting Milk Froth Preparation / Troubleshooting Milk Froth Preparation</i>	28
<i>Contact Nespresso Club / Contact Nespresso Club</i>	29
<i>The Positive Cup: Our approach to sustainability / The Positive Cup: Notre stratégie de développement durable</i>	29
<i>Disposal and Environmental Protection / Disposal and Environmental Protection</i>	30
<i>Limited Guarantee / Limited Guarantee</i>	31



Job: NES-432001-2003Q-3 ProdigioMilk
Objekt: qInlet
Version: --
Seite: q4

Datum: 15-06-05
Uhrzeit: 15:03:42
von: timea.trojko

Safety Precautions



⚠ CAUTION: the safety precautions are part of the appliance. Read them carefully before using your new appliance for the first time. Keep them in a place where you can find and refer to them later on.

⚠ CAUTION: when you see this sign, please refer to the safety precautions to avoid possible harm and damage.

i INFORMATION: when you see this sign, please take note of the advice for the correct and safe usage of your appliance.

- The appliance is intended to prepare beverages according to these instructions.
- Do not use the appliance for other than its intended use.
- This appliance has been designed for indoor and non-extreme temperature conditions use only.
- Protect the appliance from direct sunlight effect, prolonged water splash and humidity.
- This appliance is intended to be used in households and similar.
- This appliance may be used by children of at least 8 years of age, as long as they are supervised and have been given instructions about using the appliance safely and are fully aware of the dangers involved. Cleaning and user maintenance shall not be made by children unless they are older than 8 and they are supervised by an adult.
- Keep the appliance and its cord out of reach of children under 8 years of age.
- This appliance may be used by persons with reduced physical, sensory or mental capabilities, or whose experience or knowledge is not sufficient, provided they are supervised or have received instruction to use the appliance safely and understand the dangers.
- Children shall not use the device as a toy.
- The manufacturer accepts no responsibility and the warranty will not apply for any commercial use, inappropriate handling or use of the appliance, any damage resulting from use for other purposes, faulty operation, non-professionals repair or failure to comply with the instructions.

Avoid risk of fatal electric shock and fire.

- In case of an emergency: immediately remove the plug from the power socket.
- Only plug the appliance into suitable, easily accessible, earthed mains connections. Make sure that the voltage of the power source is the same as that specified on the rating plate. The use of an incorrect connection voids the warranty.
- Do not put in the dishwasher and do not immerse into water for cleaning purposes, do not water the bottom part of the Aeroccino which contains the electrical plug, but clean the interior of the Aeroccino with the detergent and rinse with warm/hot water.



EN Safety Precautions

- Dry all Aeroccino with a fresh and clean towel, cloth or paper and reassemble all parts.
- If the bottom part of the Aeroccino is wet, dry it before putting it back in contact with the plug.

The appliance must only be connected after installation.

- Do not pull the cord over sharp edges, clamp it or allow it to hang down.
- Keep the cord away from heat and damp.
- If the supply cord is damaged, it must be replaced by the manufacturer, its service agent or similarly qualified persons, in order to avoid all risks.
- If the cord is damaged, do not operate the appliance.

- Return the appliance to the *Nespresso Club* or to a *Nespresso* authorised representative.
- If an extension cord is required, use only an earthed cord with a conductor cross-section of at least 1.5 mm² or matching input power.
- To avoid hazardous damage, never place the appliance on or beside hot surfaces such as radiators, stoves, ovens, gas burners, open flame, or similar.
- Always place it on a horizontal, stable and even surface. The surface must be resistant to heat and fluids, like water, coffee, descaler or similar liquids.
- Disconnect the appliance from the mains when not in use for a long period. Disconnect by pulling out the plug and not by pulling the cord itself or the cord may become damaged.
- Before cleaning and servicing, remove the plug from the mains socket and let the appliance cool down.
- Never touch the cord with wet hands.
- Never immerse the appliance or part of it in water or other liquid.
- Never put the appliance or part of it in a dishwasher.
- Electricity and water together is dangerous and can lead to fatal electrical shocks.
- Do not open the appliance. Hazardous voltage inside!
- Do not put anything into any openings. Doing so may cause fire or electrical shock!
- Use cold milk for better quality foam.
- Use UHT Milk (or minimum

- fresh pasteurized).
- Clean after each preparation. Use detergent and rinse with warm/hot water. For Aeroccinos, remove seal from lid and remove whisk.
- Use dishwasher for dishwasher components. If not, use a non-abrasive cloth.

Avoid possible harm when operating the appliance.

- Never leave the appliance unattended during operation.
- Do not use the appliance if it is damaged or not operating perfectly. Immediately remove the plug from the power socket. Contact the *Nespresso Club* or *Nespresso* authorised representative for examination, repair or adjustment.
- A damaged appliance can



Safety Precautions

- cause electrical shocks, burns and fire.
- Always completely close the slider and never open it during operation. Scalding may occur.
 - Do not put fingers under coffee outlet, risk of scalding.
 - Do not put fingers into capsule compartment or the capsule shaft. Danger of injury!
 - Water could flow around a capsule when not perforated by the blades and damage the appliance.
 - Never use a damaged or deformed capsule. If a capsule is blocked in the capsule compartment, turn the machine off and unplug it before any operation. Call the *Nespresso Club* or *Nespresso* authorised representative.
 - Fill the water tank only with fresh and potable water.
 - Empty water tank if the appliance will not be used for an extended time (holidays, etc.).
 - Replace water in water tank when the appliance is not operated for a weekend or a similar period of time.
 - Do not use the appliance without the drip tray and drip grid to avoid spilling any liquid on surrounding surfaces. This machine contains magnets.
 - Do not use any strong cleaning agent or solvent cleaner. Use a damp cloth and mild cleaning agent to clean the surface of the appliance.
 - To clean machine, use only clean cleaning tools.
 - When unpacking the machine, remove the plastic film and dispose.
 - This appliance is designed for *Nespresso* coffee capsules available exclusively through the *Nespresso Club* or your *Nespresso* authorised representative.
 - All *Nespresso* appliances pass stringent controls. Reliability tests under practical conditions are performed randomly on selected units. This can show traces of any previous use.
 - *Nespresso* reserves the right to change instructions without prior notice.
 - This machine contains magnets.
- experience is as perfect as the first day. For the correct amount and procedure to follow, consult the dedicated user manual for your machine included in the *Nespresso* descaling kit.
- For coffee & coffee&milk machines, descale according user manual recommendations or specific alerts.

SAVE THESE INSTRUCTIONS
Pass them on to any subsequent user.
This instruction manual is also available as a PDF at nespresso.com

Descaling

- *Nespresso* descaling agent, when used correctly, helps ensure the proper functioning of your machine over its lifetime and that your coffee



FR Consignes de Sécurité



⚠ AVERTISSEMENT: les consignes de sécurité font partie de l'appareil. Veuillez les lire attentivement avant d'utiliser votre nouvel appareil. Gardez-les dans un endroit où vous pourrez les retrouver et vous y référer ultérieurement.

⚠ AVERTISSEMENT: lorsque ce symbole apparaît, veuillez consulter les mesures de sécurité pour éviter d'éventuels dangers et dommages.

i INFORMATION: lorsque ce symbole apparaît, veuillez prendre connaissance du conseil pour une utilisation sûre et conforme de votre appareil.

- L'appareil est conçu pour préparer des boissons conformément à ces instructions.
- N'utilisez pas l'appareil pour d'autres usages que ceux prévus.
- Cet appareil a été conçu seulement pour un usage intérieur, pour un usage dans des conditions de températures non extrêmes.
- Protégez votre appareil des effets directs des rayons du soleil, des éclaboussures d'eau et de l'humidité.
- This appliance is intended to be used in households and similar.
- Cet appareil est prévu seulement pour une utilisation domestique et des utilisations similaires comme: les espaces cuisine dans les magasins, les bureaux

- ou autres environnements de travail, les fermes; une utilisation par les clients dans les hôtels, les chambres d'hôtes et autres environnements résidentiels ou du type bed&breakfast.
- Cet appareil peut être utilisé par des enfants âgés d'au moins 8 ans, à condition qu'ils bénéficient d'une surveillance ou qu'ils aient reçu des instructions quant à l'utilisation de l'appareil en toute sécurité et qu'ils comprennent bien les dangers encourus. Le nettoyage et l'entretien par l'utilisateur ne doivent pas être effectués par des enfants, à moins qu'ils ne soient âgés de plus de 8 ans et qu'ils soient sous la surveillance d'un adulte.
- Conservez l'appareil et son

câble hors de portée des enfants âgés de moins de 8 ans.

- Cet appareil peut être utilisé par des personnes dont les capacités physiques, sensorielles ou mentales sont réduites ou dont l'expérience ou les connaissances ne sont pas suffisantes, à condition qu'ils bénéficient d'une surveillance ou qu'ils aient reçu des instructions quant à l'utilisation de l'appareil en toute sécurité et en comprenant bien les dangers potentiels.
- Les enfants ne doivent pas utiliser l'appareil comme un jouet.
- Le fabricant décline toute responsabilité et la garantie ne s'appliquera pas en cas d'usage commercial, d'utilisations ou de



Consignes de Sécurité

manipulations inappropriées, de dommages résultant d'un usage incorrect, d'un fonctionnement erroné, d'une réparation par un non professionnel ou du non respect des instructions.

Évitez les risques d'incendie et de choc électrique fatal.

- En cas d'urgence: débranchez immédiatement l'appareil de la prise électrique.
- Branchez l'appareil uniquement à des prises adaptées, facilement accessibles et reliées à la terre. Assurez-vous que la tension de la source d'énergie soit la même que celle indiquée sur la plaque signalétique. L'utilisation d'un branchement inadapté

annule la garantie.

- Do not put in the dishwasher and do not immerse into water for cleaning purposes, do not water the bottom part of the Aeroccino which contains the electrical plug, but clean the interior of the Aeroccino with the detergent and rinse with warm/hot water.
- Dry all Aeroccino with a fresh and clean towel, cloth or paper and reassemble all parts.
- If the bottom part of the Aeroccino is wet, dry it before putting it back in contact with the plug.

L'appareil doit être connecté uniquement après l'installation.

- Ne tirez pas le cordon d'alimentation sur des bords

tranchants, attachez-le ou laissez-le pendre.

- Gardez le cordon d'alimentation loin de la chaleur et de l'humidité.
- Si le cordon d'alimentation est endommagé, il doit être remplacé par le fabricant, son agent après-vente ou des personnes de même qualification, afin d'éviter tous risques.
- Si le cordon d'alimentation est endommagé, ne faites pas fonctionner l'appareil, afin d'éviter un danger.
- Retournez votre appareil au Club *Nespresso* ou à un revendeur *Nespresso* agréé.
- Si une rallonge électrique s'avère nécessaire, n'utilisez qu'un câble relié à la terre, dont le conducteur a une section d'au moins 1.5 mm².
- Afin d'éviter de dangereux

dommages, ne placez jamais l'appareil sur ou à côté de surfaces chaudes telles que les radiateurs, les cuisinières, les fours, les brûleurs à gaz, les feux nus, ou des sources de chaleur similaires.

- Placez-le toujours sur une surface horizontale, stable et régulière. La surface doit être résistante à la chaleur et aux fluides comme: l'eau, café, le détartrant ou autres.
- Débranchez l'appareil de la prise électrique lorsqu'il n'est pas utilisé pendant une période prolongée.
- Débranchez en tirant par la fiche et non par le cordon d'alimentation ou il pourrait être endommagé.
- Avant le nettoyage et l'entretien de votre appareil, débranchez-le de la prise électrique et laissez-le



FR Consignes de Sécurité

refroidir.

- Ne touchez jamais le fil électrique avec des mains mouillées.
- Ne plongez jamais l'appareil, en entier ou en partie, dans l'eau ou dans d'autres liquides.
- Ne mettez jamais l'appareil ou une partie de celui-ci dans un lave-vaisselle.
- L'électricité et l'eau ensemble sont dangereux et peuvent conduire à des chocs électriques mortels.
- N'ouvrez pas l'appareil. Voltage dangereux à l'intérieur.
- Ne mettez rien dans les ouvertures. Cela pourrait provoquer un incendie ou un choc électrique!
- Use cold milk for better quality foam.
- Use UHT Milk (or minimum

fresh pasteurized).

- Clean after each preparation. Use detergent and rinse with warm/hot water. For Aeroccinos, remove seal from lid and remove whisk.
- Use dishwasher for dishwasher components. If not, use a non-abrasive cloth.
- Évitez les dommages possibles lors de l'utilisation de l'appareil.
- Ne laissez jamais l'appareil sans surveillance pendant son fonctionnement.
- N'utilisez pas l'appareil s'il est endommagé ou ne fonctionne pas parfaitement. Débranchez-le immédiatement de la prise électrique. Contactez le Club *Nespresso* ou un revendeur *Nespresso* agréé, pour la réparation ou le réglage de

votre appareil.

- Un appareil endommagé peut provoquer des chocs électriques, brûlures et incendies.
- Refermez toujours complètement la fenêtre coulissante et ne l'ouvrez jamais pendant le fonctionnement, des brûlures peuvent se produire.
- Ne mettez pas vos doigts sous la sortie café, il y a un risque de brûlure.
- Ne mettez pas vos doigts dans le compartiment à capsules ou dans le bac de récupération des capsules. Il existe un risque de blessure.
- L'eau peut s'écouler autour d'une capsule, quand celle-ci n'a pas été perforée par les lames, et endommager l'appareil.
- N'utilisez jamais une capsule

endommagée ou déformée.

- Si une capsule est bloquée dans le compartiment à capsules, éteignez l'appareil et débranchez-le avant toute opération. Appelez le Club *Nespresso* ou un revendeur *Nespresso* agréé.
- Remplissez toujours le réservoir avec de l'eau fraîche, potable et froide.
 - Videz le réservoir d'eau si l'appareil n'est pas utilisé pendant une durée prolongée (vacances etc. . .).
 - Remplacez l'eau du réservoir d'eau quand l'appareil n'est pas utilisé pendant un week-end ou une période de temps similaire.
 - N'utilisez pas l'appareil sans le bac d'égouttage et sa grille afin d'éviter de renverser du liquide sur les surfaces environnantes.



Consignes de Sécurité

- Ne nettoyez jamais votre appareil avec un produit d'entretien ou un solvant. Utilisez un chiffon humide et un détergent doux pour nettoyer la surface de l'appareil.
- Pour nettoyer votre machine, utiliser un chiffon propre et doux.
- Lors du déballage de l'appareil, retirer le film plastique sur la grille d'égouttage.
- Cet appareil est conçu pour des capsules de café *Nespresso* disponibles exclusivement via le Club *Nespresso* ou votre revendeur *Nespresso* agréé.
- Tous les appareils *Nespresso* sont soumis à des contrôles sévères. Des tests de fiabilité, dans des conditions réelles d'utilisation, sont

effectués au hasard sur des unités sélectionnées. Certains appareils peuvent donc montrer des traces d'une utilisation antérieure.

- *Nespresso* se réserve le droit de modifier sans préavis la notice d'utilisation.
- This machine contains magnets.

Détartrage

- Lorsqu'il est utilisé correctement, le détartrant *Nespresso*, permet d'assurer le bon fonctionnement de votre appareil tout au long de sa vie et vous permet de maintenir une expérience café aussi parfaite qu'au premier jour. Pour le dosage exact et la procédure à suivre, consultez le manuel d'utilisation inclus dans le kit de détartrage *Nespresso*.

CONSERVEZ LES INSTRUCTIONS SUIVANTES
Transmettez-les aux utilisateurs ultérieurs.
Ce manuel d'instruction est également disponible en version PDF sur nespresso.com



EN

FR

Machine Overview / Machine Overview

Maintenance Light
Maintenance Light

Coffee Buttons (Ristretto, Espresso & Lungo)
Coffee Buttons (Ristretto, Espresso & Lungo)

Slider for Capsule Insertion
Fenêtre coulissante pour
insertion de la capsule

Nespresso Light
Nespresso Light

Adjustable
Cup Support
& Drip Grid
Support de
tasse ajustable
et grille d'égouttage

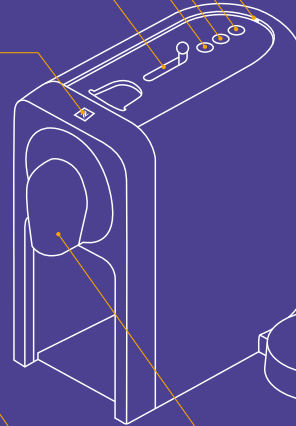
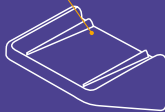
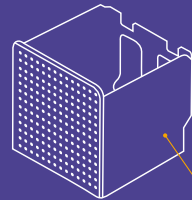

Coffee Outlet
Orifice de sortie du café

Used Capsule Container & Drip Tray
Collecteur de capsules usagées
& bac d'égouttage



Water Tank & Lid
Réservoir d'eau
& couvercle

Adjustable Water Tank &
Milk Frother Arm
Base ajustable du réservoir
d'eau et du mouseur à lait



Mixer (for hot milk)
Mélangeur (à lait chaud)



Frothing Spring (for Milk
Froth)
Spirale à mousse (pour la
mousse de lait)



Lid
Couvercle



Seal
Joint



Aeroccino Milk Frother
Mousseur à lait
Aeroccino

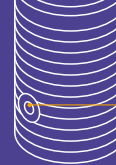

Start/Stop Button
Bouton marche arrêt



Job: NES-432001-2003Q-3 ProdigioMilk

Objekt: qInlet

Version: --

Seite: q12

Datum: 15-06-05

Uhrzeit: 15:03:43

von: timea.trojko

First Use / First Use

- i** **Read the safety** precautions first to avoid risks of fatal electrical shock and fire.
Read the safety precautions first to avoid risks of fatal electrical shock and fire.

- 1 Choose position** for water tank.

Choose position for water tank.

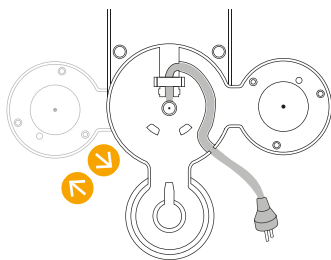

- 2 Remove** the Aeroccino, water tank and capsule container to clean them.

Remove the Aeroccino, water tank and capsule container to clean them.

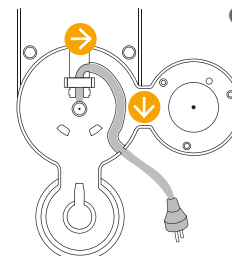

- 3 Insert the remaining cable** in the guide under water tank left or right socket, depending on the position chosen for the water tank. Ensure machine is in the upright position.

Insert the remaining cable in the guide under water tank left or right socket, depending on the position chosen for the water tank. Ensure machine is in the upright position..

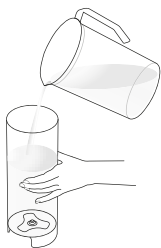

- 4 Rinse the water tank** before filling it with potable water.

Rinse the water tank before filling it with potable water.

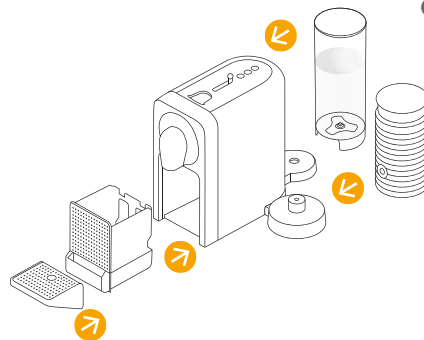

- 5 Place the water tank**, insert the drip tray, Aeroccino and the capsule container in position. For your safety, operate the machine only with drip tray and capsule container in position.

Place the water tank, insert the drip tray, Aeroccino and the capsule container in position. For your safety, operate the machine only with drip tray and capsule container in position.

- 6 Plug the machine** into the mains.

Plug the machine into the mains.

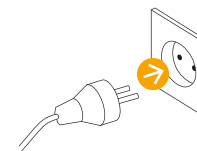

EN First Use / First Use

FR

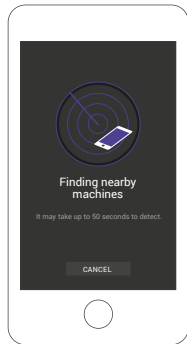

- 7 **To connect your machine**, please follow the instructions in sections «Get the App» and «Pairing» on page 4.
Multiple devices can be connected to your Prodigio&Milk machine only if using a unique club members number. To pair these additional devices, please follow the instructions in sections «Get the App» and «Pairing» on page 4.

To connect your machine, please follow the instructions in sections «Get the App» and «Pairing» on page 4.
Multiple devices can be connected to your Prodigio&Milk machine only if using a unique club members number. To pair these additional devices, please follow the instructions in sections «Get the App» and «Pairing» on page 4.

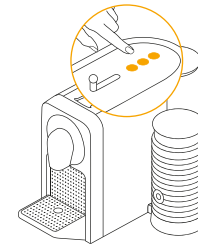

- 8 **Turn the machine ON** by pressing any coffee button. Lights will blink. Heating up takes approximately 25 seconds. Steady lights: machine is ready.

Turn the machine ON by pressing any coffee button. Lights will blink. Heating up takes approximately 25 seconds. Steady lights: machine is ready.

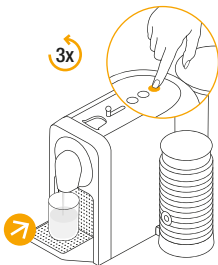

- 9 **Before making any coffee**, make sure to rinse your machine by:
1. Placing a container under coffee outlet.
 2. Closing the slider and pressing the Lungo button to rinse the machine.
 3. Repeat three times.

Before making any coffee, make sure to rinse your machine by:

1. Placing a container under coffee outlet.
2. Closing the slider and pressing the Lungo button to rinse the machine.
3. Repeat three times.

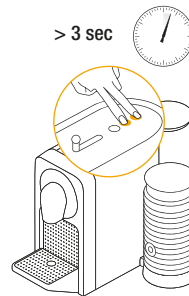

- 10 **To turn OFF your machine**, ensure all the 3 coffee buttons are ON. Press and hold Lungo and Espresso buttons simultaneously for 3 seconds.

To turn OFF your machine, ensure all the 3 coffee buttons are ON. Press and hold Lungo and Espresso buttons simultaneously for 3 seconds.



Job: NES-432001-2003Q-3 ProdigioMilk
Objekt: qInlet
Version: --
Seite: q14

Datum: 15-06-05
Uhrzeit: 15:03:43
von: timea.trojko



Regular Coffee Preparation / Regular Coffee Preparation

EN
FR

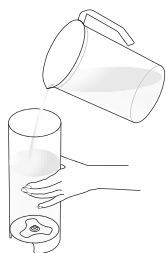

1 Fill the water tank with potable water.

Fill the water tank with potable water.

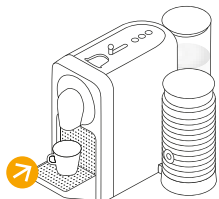

2 Place a cup under the coffee outlet.

Place a cup under the coffee outlet.

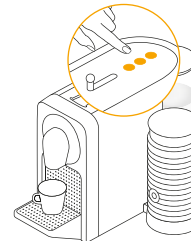

3 Turn machine ON by pressing any coffee button. Lights will blink. Heating up for approximately 25 seconds. Steady lights: ready.

Turn machine ON by pressing any coffee button. Lights will blink. Heating up for approximately 25 seconds. Steady lights: ready.

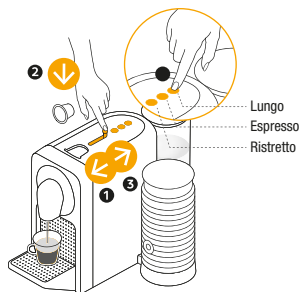

4 Open the slider, insert a capsule and close the slider. Select your coffee size based on the chosen Grand Cru:

- Ristretto (25ml / 0.84 oz)
- Espresso (40 ml / 1.35 oz)
- Lungo (110 ml / 3.7 oz)

You can select the desired coffee button, by pressing it, even while the machine is still heating up. The selected coffee button will blink and becomes steady on when machine is ready to brew. The coffee will then flow.

Open the slider, insert a capsule and close the slider. Select your coffee size based on the chosen Grand Cru:

- Ristretto (25ml / 0.84 oz)
- Espresso (40 ml / 1.35 oz)
- Lungo (110 ml / 3.7 oz)

You can select the desired coffee button, by pressing it, even while the machine is still heating up. The selected coffee button will blink and becomes steady on when machine is ready to brew. The coffee will then flow.



Job: NES-432001-2003Q-3 ProdigioMilk
Objekt: qInlet
Version: --
Seite: q15

Datum: 15-06-05
Uhrzeit: 15:03:43
von: timea.trojko



Regular Coffee Preparation / Regular Coffee Preparation

5 **The machine** selects the most frequently chosen cup size (based on last 11 coffees), Espresso as factory setting. You can change this by selecting any other button.

The machine selects the most frequently chosen cup size (based on last 11 coffees), Espresso as factory setting. You can change this by selecting any other button.

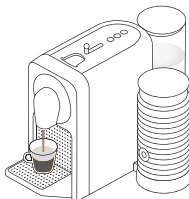

6 **Preparation** will stop automatically. The capsule will eject automatically.

Preparation will stop automatically. The capsule will eject automatically.



7 **To stop the coffee flow** before, press the selected coffee button or move the slider towards the back of the machine until the coffee flow stops.

To stop the coffee flow before, press the selected coffee button or move the slider towards the back of the machine until the coffee flow stops.

Max 10 sec



8 **To manually top up** your coffee, touch any of the coffee buttons within 10 seconds from end of preparation.

To manually top up your coffee, touch any of the coffee buttons within 10 seconds from end of preparation.

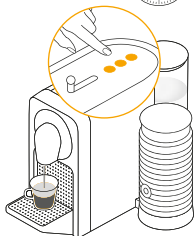

9 **To change the selected cup size** during brewing select the new desired coffee button.

The machine will immediately stop if the coffee volume extracted is larger than new desired coffee size.

To change the selected cup size during brewing select the new desired coffee button. The machine will immediately stop if the coffee volume extracted is larger than new desired coffee size.

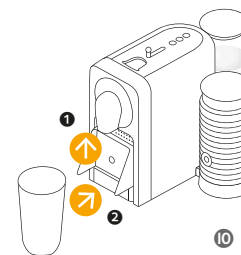

10 **To accommodate** a milk recipe glass, lift the cup support.

To accommodate a milk recipe glass, lift the cup support.



Milk Froth Preparation / Milk Froth Preparation

EN

FR

i **Only use** the Aeroccino with the base provided.
Only use the Aeroccino with the base provided.

i **TIP:** For optimal milk froth, use whole or semi skimmed milk at refrigerated temperature (about 4-6 °C).
TIP: For optimal milk froth, use whole or semi skimmed milk at refrigerated temperature (about 4-6 °C).

⚠ WARNING: Do not put the Aeroccino in the dishwasher. Risk of electrical shock and fire! Make sure the under side of the milk frother is dry.

⚠ WARNING: Do not put the Aeroccino in the dishwasher. Risk of electrical shock and fire! Make sure the under side of the milk frother is dry.

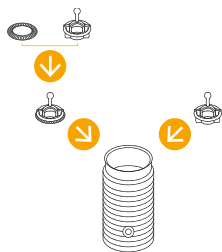

1 Attach the relevant whisk.

Attach the relevant whisk.

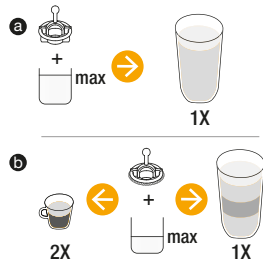

2 Fill milk frother up to one of the two «max» level indicators:

- a) Lowest «max foam» level indicator (110 ml/ 3.72 oz) is for milk froth preparations.
- b) Highest «max milk» level indicator (230 ml/ 7.78 oz) is for hot milk preparations.

Fill milk frother up to one of the two «max» level indicators:

- a) Lowest «max foam» level indicator (110 ml/ 3.72 oz) is for milk froth preparations.
- b) Highest «max milk» level indicator (230 ml/ 7.78 oz) is for hot milk preparations.

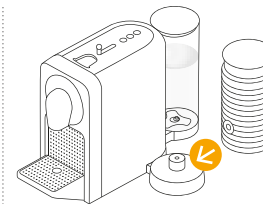

3 Close the Aeroccino with its lid and place it on the base.

Close the Aeroccino with its lid and place it on the base.

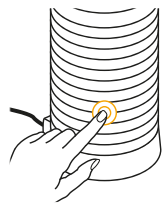

4 For a hot preparation, briefly press button to start.
 - Button lights up red.
 Takes approx. 70-80 sec.

For cold milk froth, keep button pressed for approx. 2 seconds.
 - Button lights up blue.
 Takes approx. 60 sec.

For a hot preparation, briefly press button to start.
 - Button lights up red.
 Takes approx. 70-80 sec.

For cold milk froth, keep button pressed for approx. 2 seconds.
 - Button lights up blue.
 Takes approx. 60 sec.

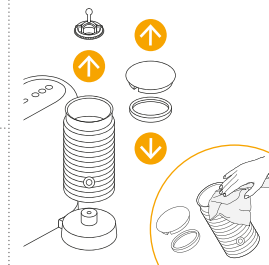

5 Clean after each preparation.

Only use non abrasive cloth, never use a brush. Jug is waterproof. Do not put in dishwasher.

Clean after each preparation.

Only use non abrasive cloth, never use a brush. Jug is waterproof. Do not put in dishwasher.



Job: NES-432001-2003Q-3 ProdigioMilk
Objekt: qInlet
Version: --
Seite: q17

Datum: 15-06-05
Uhrzeit: 15:03:43
von: timea.trojko

EN Energy Saving Concept / Energy Saving Concept

FR

< 9 min



- 1 **Automatic OFF mode:** the machine will turn into OFF mode automatically after 9 minutes of non use.

Automatic OFF mode: the machine will turn into OFF mode automatically after 9 minutes of non use.

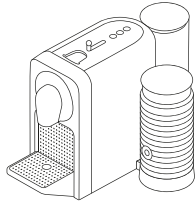

> 3 sec



- 2 **To change automatic OFF mode from 9 to 30 minutes:**
- Ensure the machine is turned OFF
 - Press and hold both the Lungo and Ristretto buttons for more than 3 sec.
 - Espresso button flashes 3 times for confirmation.

To revert back to 9 minutes, repeat the same procedure.
Espresso button flashes once for confirmation.

To change automatic OFF mode from 9 to 30 minutes:

- Ensure the machine is turned OFF
- Press and hold both the Lungo and Ristretto buttons for more than 3 sec.
- Espresso button flashes 3 times for confirmation.

To revert back to 9 minutes, repeat the same procedure.
Espresso button flashes once for confirmation.

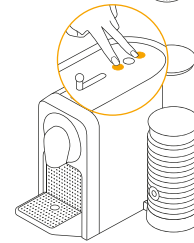

Programming the Water Volume / Programming the water volume

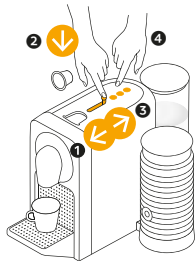

- 1 **Any coffee button can be programmed.**

1. Ristretto button: from 15 to 30 ml / 0.5-1 oz.
2. Espresso button: from 30 to 70 ml / 1 to 2.33 oz.
3. Lungo button: from 70 to 130 ml / 2.33 to 3 oz.

- - Ensure the machine is ON
- Open the slider and insert the capsule.
 - Close the slider.
 - Press and hold the selected coffee button.
 - Release the button when desired volume is reached.
 - The other 2 buttons flash for confirmation.
 - Water volume is now stored for the button used during programming.

Any coffee button can be programmed.

1. Ristretto button: from 15 to 30 ml / 0.5-1 oz.
2. Espresso button: from 30 to 70 ml / 1 to 2.33 oz.
3. Lungo button: from 70 to 130 ml / 2.33 to 3 oz.

- - Ensure the machine is ON
- Open the slider and insert the capsule.
 - Close the slider.
 - Press and hold the selected coffee button.
 - Release the button when desired volume is reached.
 - The other 2 buttons flash for confirmation.
 - Water volume is now stored for the button used during programming.





Reset to Factory Settings / Reset to Factory Settings

Min 4 sec

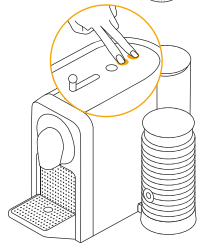

i If reset to factory setting, this will cancel the pairing, reset the capsules stock management and the descaling alert.

If reset to factory setting, this will cancel the pairing, reset the capsules stock management and the descaling alert.

1 Factory settings are:

- Lungo, Espresso, Ristretto coffee buttons 110ml / 3.7oz, 40ml / 1.35 oz., 25ml / 0.84 oz.
- Automatic OFF mode after 9 minutes.
- The water hardness set by default is hard, which corresponds to around 1000 Espresso cups.

To do it via your machine:

1. Ensure the machine is turned OFF.
2. Press and hold Espresso & Lungo buttons for at least 5 seconds.

All the coffee buttons and LEDs will blink once as confirmation. To unpair your machine, please refer to the «Troubleshooting section».

Factory settings are:

- Lungo, Espresso, Ristretto coffee buttons 110ml / 3.7oz, 40ml / 1.35 oz., 25ml / 0.84 oz.
- Automatic OFF mode after 9 minutes.
- The water hardness set by default is hard, which corresponds to around 1000 Espresso cups.

To do it via your machine:

1. Ensure the machine is turned OFF.
2. Press and hold Espresso & Lungo buttons for at least 5 seconds.

All the coffee buttons and LEDs will blink once as confirmation. To unpair your machine, please refer to the «Troubleshooting section».

Emptying the System before a period of non-use or for frost protection / Emptying the System before a period of non-use or for frost protection



To note, the machine remains blocked for 10 minutes after emptying!
To note, the machine remains blocked for 10 minutes after emptying!

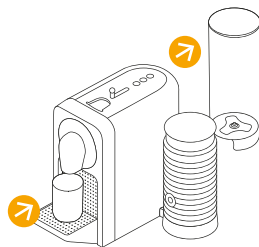

- 1 Remove the water tank. Place a container under the coffee outlet.

Remove the water tank. Place a container under the coffee outlet.

> 6 sec

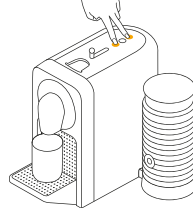

- 2 Ensure the machine is ON, press and hold the Ristretto & Lungo buttons together for at least 6 seconds.

Ensure the machine is ON, press and hold the Ristretto & Lungo buttons together for at least 6 seconds.

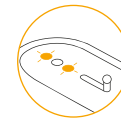

- 3 The Ristretto and Lungo coffee buttons will flash for confirmation. Then close the slider to start procedure. If the slider was already closed, the emptying process starts automatically. When the procedure is finished, clean the drip tray and the cup support. Machine turns to OFF mode automatically when empty.

The Ristretto and Lungo coffee buttons will flash for confirmation. Then close the slider to start procedure. If the slider was already closed, the emptying process starts automatically. When the procedure is finished, clean the drip tray and the cup support. Machine turns to OFF mode automatically when empty.



EN Cleaning / Cleaning

FR

i To ensure hygienic conditions, it is highly recommended emptying and cleaning the used capsule container every day.
To ensure hygienic conditions, it is highly recommended emptying and cleaning the used capsule container every day.

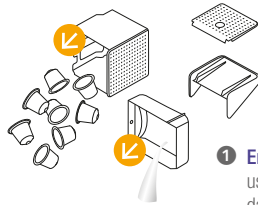

- 1 Empty the drip tray and the used capsule container every day.

Empty the drip tray and the used capsule container every day.

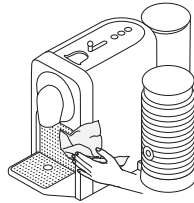

- 2 Clean the coffee outlet and inside the machine regularly with a damp cloth.

Clean the coffee outlet and inside the machine regularly with a damp cloth.



- 3 Never immerse the appliance or part of it in water.

Never immerse the appliance or part of it in water.

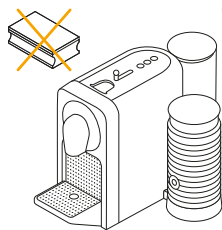

- 4 Do not use any strong or abrasive solvent, sponge or cream cleaner. Do not put in the dishwasher.

Do not use any strong or abrasive solvent, sponge or cream cleaner. Do not put in the dishwasher.





Descaling / Descaling

EN

FR



Duration approximately 15 minutes.

Duration approximately 15 minutes.



Read the safety precautions on the descaling package and refer to the table for the frequency of use. The descaling solution can be harmful. Avoid contact with eyes, skin and surfaces. Never use any product other than the *Nespresso* descaling kit available at the *Nespresso Club* to avoid damage to your machine. The following table will indicate the descaling frequency required for the optimum performance of your machine, based on water hardness. For any additional questions you may have regarding descaling, please contact the *Nespresso Club*.

Read the safety precautions on the descaling package and refer to the table for the frequency of use. The descaling solution can be harmful. Avoid contact with eyes, skin and surfaces. Never use any product other than the *Nespresso* descaling kit available at the *Nespresso Club* to avoid damage to your machine. The following table will indicate the descaling frequency required for the optimum performance of your machine, based on water hardness. For any additional questions you may have regarding descaling, please contact the *Nespresso Club*.



Job: NES-432001-2003Q-3 ProdigioMilk

Objekt: qInlet

Version: --

Seite: q21

Datum: 15-06-05

Uhrzeit: 15:03:43

von: timea.trojko

EN

FR



Descaling / Descaling

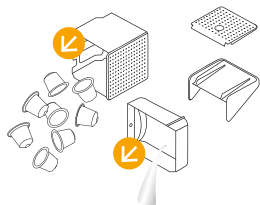

- 1 Empty the drip tray** and the used capsule container.

Empty the drip tray and the used capsule container.

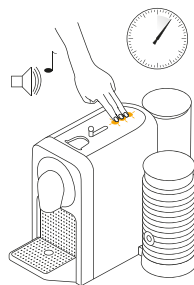

- 2 To enter the descaling mode**, ensure the machine is ON, press and hold the 3 coffee buttons for 6 seconds until the confirmation with a beep. The 3 buttons will start blinking (buttons will flash until the exit of this mode).

To enter the descaling mode, ensure the machine is ON, press and hold the 3 coffee buttons for 6 seconds until the confirmation with a beep. The 3 buttons will start blinking (buttons will flash until the exit of this mode).



Info: maintenance light is ON during the descaling process.
Info: maintenance light is ON during the descaling process.

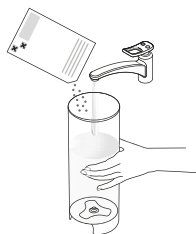

- 3 Fill the water tank** with 1 unit of *Nespresso* descaling liquid and add 0.5 L / 17 oz of water.

Fill the water tank with 1 unit of *Nespresso* descaling liquid and add 0.5 L / 17 oz of water.

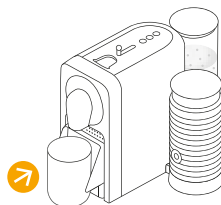

- 4 Place a container** (minimum volume: 0.8L / 27oz) under the coffee outlet.

Place a container (minimum volume: 0.8L / 27oz) under the coffee outlet.

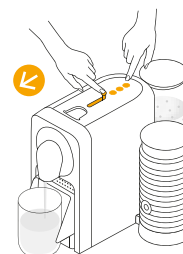

- 5 Ensure the slider is closed** and press any coffee button to start the descaling cycle, pump will run. Machine will stop automatically when water tank is empty.

Ensure the slider is closed and press any coffee button to start the descaling cycle, pump will run. Machine will stop automatically when water tank is empty.





Descaling / Descaling

EN

FR

- 6 Refill the water tank** with the used descaling agent (already passed in the machine) collected into the container.

Refill the water tank with the used descaling agent (already passed in the machine) collected into the container.

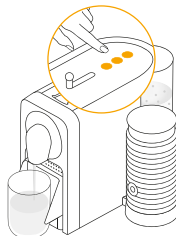

- 7 Press any button to start** descaling a second time. Machine will stop automatically when the water tank is empty. Empty and rinse the water tank, drip tray and cup support thoroughly to avoid any residue.

Press any button to start descaling a second time. Machine will stop automatically when the water tank is empty. Empty and rinse the water tank, drip tray and cup support thoroughly to avoid any residue.

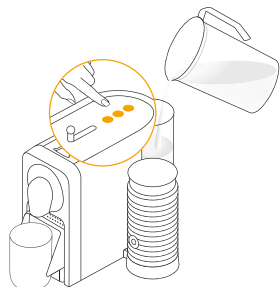

- 8 Refill the water tank** with fresh potable water. Press any button to start rinsing the machine, pump will run. Machine will stop automatically when the water tank is empty. Repeat this twice.

Refill the water tank with fresh potable water. Press any button to start rinsing the machine, pump will run. Machine will stop automatically when the water tank is empty. Repeat this twice.

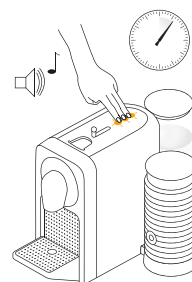

- 9 To exit the descaling mode**, press and hold the 3 buttons for 6 seconds until the confirmation with a beep. The machine is now ready for use.

To exit the descaling mode, press and hold the 3 buttons for 6 seconds until the confirmation with a beep. The machine is now ready for use.

Water hardness:*/ Dureté de l'eau:*

fH	dH	CaCO ₃	
36	20	360 mg/l	1000
< 18	< 10	180 mg/l	2000
0	0	0 mg/l	4000

Descaling after:*/ Détartrez après:

fH French degree
Degré français
dH German Grade
Degré allemand
CaCO₃ Calcium Carbonate
Carbonate de calcium

Nespresso descaling kit:
Ref. 3035/CBU-2

Nespresso descaling kit:
Ref. 3035/CBU-2

*On the App, the water hardness can be adjusted any time under "Water status".
*On the App, the water hardness can be adjusted any time under "Water status".



Job: NES-432001-2003Q-3 ProdigioMilk
Objekt: qInlet
Version: --
Seite: q23

Datum: 15-06-05
Uhrzeit: 15:03:43
von: timea.trojko

EN Troubleshooting

 **Videos are available** on the App and on www.nespresso.com - Got to section «services».

Pairing has not succeed.	<ul style="list-style-type: none"> - Check that the Bluetooth® on the smartphone or tablet is activated. - Check the compatibility of your smartphone or tablet with the machine (see the page 3). 	<ul style="list-style-type: none"> - Ensure the smartphone or tablet is placed next to the machine during the pairing - Make sure to not turn ON any microwave close to the machine during pairing.
If you want to unpair your machine, via the app:	<ul style="list-style-type: none"> - Go on the App «Name», click on «Machine status», then click on «Unpair this machine». - Click on «unpair this device» to confirm the unpairing. 	<ul style="list-style-type: none"> - Note: In case of a unpairing, all the setups and specifications will be lost and the machine will be reset to factory settings.
If you want to unpair your machine, via the machine:	<ul style="list-style-type: none"> - Press simultaneously Ristretto and Espresso buttons and remove the plug from the mains. 	<ul style="list-style-type: none"> - Note: this action will deactivate the <i>Bluetooth®</i> function from the machine.
If you want to reactivate the <i>Bluetooth®</i> on your machine, via the machine:	<ul style="list-style-type: none"> - Please do reset to factory settings. See paragraph on «Reset to Factory Settings». 	
No light on the coffee buttons.	<ul style="list-style-type: none"> - Machine turns OFF automatically. See paragraph on «Energy Saving Concept». 	<ul style="list-style-type: none"> - Check the mains: plug, voltage, fuse.
No coffee, no water, unusual coffee flow.	<ul style="list-style-type: none"> - Check if the water tank is correctly positioned, if empty, fill with potable water. - Descale it if necessary. 	
Coffee is not hot enough.	<ul style="list-style-type: none"> - Preheat cup. 	<ul style="list-style-type: none"> - Descale the machine if necessary.
The slider does not close completely or the machine doesn't start brewing.	<ul style="list-style-type: none"> - Empty the capsule container. 	<ul style="list-style-type: none"> - Check that no capsule is blocked inside the machine. - (Note: do not put the finger inside the machine)
Leakage (water under the machine).	<ul style="list-style-type: none"> - Empty drip tray if full. 	<ul style="list-style-type: none"> - If problem persists, call the <i>Nespresso</i> Club.
Maintenance light is ON.	<ul style="list-style-type: none"> - Empty the used capsule container and check no capsules are blocked. - Check the water tank. If empty, fill with potable water and brew a coffee. 	<ul style="list-style-type: none"> - If problem persists, call the <i>Nespresso</i> Club.
<i>Nespresso</i> light is ON.	<ul style="list-style-type: none"> - It means your capsules stock is empty. You can order capsules via the App or <i>Nespresso</i> website. 	
3 coffee buttons flash quickly.	<ul style="list-style-type: none"> - To exit the descaling mode, press and hold the 3 buttons for 6 seconds until the confirmation with a beep. 	<ul style="list-style-type: none"> - If problem persists, call the <i>Nespresso</i> Club, or check the App for more information.
Water or coffee flow does not stop even by pushing any coffee button.	<ul style="list-style-type: none"> - Gently move the slider towards the back of the machine to stop the flow. 	
No coffee flow, water goes directly into the drip tray (despite inserted capsule).	<ul style="list-style-type: none"> - Pull the slider to ensure it is closed. 	<ul style="list-style-type: none"> - If problem persists, call the <i>Nespresso</i> Club.
Machine turns to OFF mode.	<ul style="list-style-type: none"> - To save energy the machine will turn to OFF mode after 9 minutes of non use. - See paragraph on «Energy Saving Concept». 	<ul style="list-style-type: none"> - Press one of the coffee buttons to turn to «ON-mode».



Troubleshooting

i Videos are available on the App and on www.nespresso.com - Got to section «services».

Pairing has not succeed.

- Check that the Bluetooth® on the smartphone or tablet is activated.
- Check the compatibility of your smartphone or tablet with the machine (see the page 3).
- Ensure the smartphone or tablet is placed next to the machine during the pairing
- Make sure to not turn ON any microwave close to the machine during pairing.

If you want to unpair your machine, via the app:

- Go on the App «Name», click on «Machine status», then click on «Unpair this machine».
- Click on «unpair this device» to confirm the unpairing.
- **Note:** In case of a unpairing, all the setups and specifications will be lost and the machine will be reset to factory settings.

If you want to unpair your machine, via the machine:

- Press simultaneously Ristretto and Espresso buttons and remove the plug from the mains.
- **Note:** this action will deactivate the *Bluetooth®* function from the machine.

If you want to reactivate the Bluetooth® on your machine, via the machine:

- Please do reset to factory settings. See paragraph on «reset to factory settings».

No light on the coffee buttons.

- Machine turns OFF automatically. See paragraph on «Energy saving concept».
- Check the mains: plug, voltage, fuse.

No coffee, no water, unusual coffee flow.

- Check if the water tank is correctly positioned, if empty, fill with potable water.
- Descale it if necessary.

Coffee is not hot enough.

- Preheat cup.
- Descale the machine if necessary.

The slider does not close completely or the machine doesn't start brewing.

- Empty the capsule container.
- Check that no capsule is blocked inside the machine. (**Note:** do not put the finger inside the machine)

Leakage (water under the machine).

- Empty drip tray if full.
- If problem persists, call the *Nespresso* Club.

Maintenance light is ON.

- Empty the used capsule container and check no capsules are blocked.
- Check the water tank. If empty, fill with potable water and brew a coffee.
- If problem persists, call the *Nespresso* Club.

Nespresso light is ON.

- It means your capsules stock is empty. You can order capsules via the App or *Nespresso* website.

3 coffee buttons flash quickly.

- To exit the descaling mode, press and hold the 3 buttons for 6 seconds until the confirmation with a beep.
- If problem persists, call the *Nespresso* Club, or check the App for more information.

Water or coffee flow does not stop even by pushing any coffee button.

- Move gently the slider towards the back of the machine to stop the flow.

No coffee flow, water goes directly into the drip tray (despite inserted capsule).

- Pull the slider to ensure it is closed.
- If problem persists, call the *Nespresso* Club.

Machine turns to OFF mode.

- To save energy the machine will turn to OFF mode after 9 minutes of non use.
- Press one of the coffee buttons to turn to «ON-mode».
- See paragraph on «Energy saving concept».



EN Troubleshooting Milk Froth Preparation /
 FR Troubleshooting Milk Froth Preparation

Aeroccino does not start.

- Be sure to position the jug correctly on a clean base. Be sure to attach the whisk to the jug correctly.

Quality of milk froth not up to standard.

- Be sure to use whole or semi-skimmed milk at refrigerated temperature (about 4-6 °C). For a best result, the milk must be newly opened.

- Be sure to use the appropriate whisk and the jug is clean.

Red Button blinking.

- a) The appliance is too hot.
Rinse it under cool water.

b) Whisk is missing.
c) Not enough milk. Fill milk frother up to one of the two «max» level.

Milk Overflows.

- Be sure to use the appropriate whisk.
- Check the corresponding indicator level.

Aeroccino does not start.

- Be sure to position the jug correctly on a clean base. Be sure to attach the whisk to the jug correctly.

Quality of milk froth not up to standard.

- Be sure to use whole or semi-skimmed milk at refrigerated temperature (about 4-6 °C). For a best result, the milk must be newly opened.

- Be sure to use the appropriate whisk and the jug is clean.

Red Button blinking.

- a) The appliance is too hot.
Rinse it under cool water.

b) Whisk is missing.
c) Not enough milk. Fill milk frother up to one of the two «max» level.

Milk Overflows.

- Be sure to use the appropriate whisk.
- Check the corresponding indicator level.



Contact the *Nespresso Club* / Contact the *Nespresso Club*

As we may not have foreseen all uses of your appliance, should you need any additional information, in case of problems or simply to seek advice, call the *Nespresso Club* or your *Nespresso* authorised representative. Contact details for your *Nespresso Club* or your *Nespresso* authorised representative can be found in the «Welcome to *Nespresso*» folder in your machine box or at nespresso.com

As we may not have foreseen all uses of your appliance, should you need any additional information, in case of problems or simply to seek advice, call the *Nespresso Club* or your *Nespresso* authorised representative. Contact details for your *Nespresso Club* or your *Nespresso* authorised representative can be found in the «Welcome to *Nespresso*» folder in your machine box or at nespresso.com

The *Positive Cup*: our approach to sustainability / The *Positive Cup*: notre stratégie de développement durable

At *Nespresso*, we believe that each cup of coffee can not only deliver a moment of pleasure, but also restore, replenish and revive environmental resources and communities. As a company, sustainability is our way of doing business and is at the heart of everything we do.

Through our sustainability strategy *The Positive Cup*, we are aiming to reach our 2020 goal of making every cup of *Nespresso* a positive cup. To realise this vision, *Nespresso* has set itself ambitious commitments:

Coffee: 100% sustainably sourced coffee
Capsules: 100% sustainably managed aluminum
Climate: 100% carbon insetting

For more information www.nespresso.com/positive

Chez *Nespresso*, nous avons la conviction que chaque tasse de café peut offrir un moment de plaisir tout en restaurant, reconstituant et sublimant les ressources et les communautés environnementales et humaines. En tant qu'entreprise, le développement durable est notre modèle d'affaire, en plus d'être au cœur de tout ce que nous faisons.

Grâce à notre stratégie de développement durable *The Positive Cup*, nous nous engageons à faire de chaque tasse *Nespresso* une tasse à l'impact positif d'ici 2020. Pour concrétiser cette vision, *Nespresso* s'est fixé des objectifs ambitieux:

Café: Un café issu à 100% de sources durables
Capsules: Aluminium géré de manière 100% durable
Climat: Empreinte carbone 100% neutre

Pour plus d'info www.nespresso.com/positive



Job: NES-432001-2003Q-3 ProdigioMilk
Objekt: qInlet
Version: --
Seite: q27

Datum: 15-06-05
Uhrzeit: 15:03:44
von: timea.trojko

EN Disposal and environmental protection /
FR Disposal and environmental protection

This appliance complies with the EU Directive 2012/19/EC. Packaging materials and appliance contain recyclable materials. Your appliance contains valuable materials that can be recovered or can be recyclable. Separation of the remaining waste materials into different types facilitates the recycling of valuable raw materials. Leave the appliance at a collection point. You can obtain information on disposal from your local authorities.

This appliance complies with the EU Directive 2012/19/EC. Packaging materials and appliance contain recyclable materials. Your appliance contains valuable materials that can be recovered or can be recyclable. Separation of the remaining waste materials into different types facilitates the recycling of valuable raw materials. Leave the appliance at a collection point. You can obtain information on disposal from your local authorities.



Limited Guarantee / Limited Garantie

Nespresso guarantees this product against defects in materials and workmanship for a period of 2 years. The warranty period begins on the date of purchase and *Nespresso* requires presentation of the original proof of purchase to ascertain the date. During the warranty period, *Nespresso* will either repair or replace, at its discretion, any defective product at no charge to the owner. Replacement products or repaired parts will be warranted only for the unexpired portion of the original warranty or six months, whichever is greater. This limited warranty does not apply to any defect resulting from negligence, accident, misuse, or any other reason beyond *Nespresso's* reasonable control, including but not limited to: normal wear and tear, negligence or failure to follow the product instructions, improper or inadequate maintenance, calcium deposits or descaling, connection to improper power supply, unauthorised product modification or repair, use for commercial purposes, fire, lightning, flood or other external causes. This warranty is valid only in the country of purchase or in such other countries where *Nespresso* sells or services the same model with identical technical specifications. Warranty service outside the country of purchase is limited to the terms and conditions of the corresponding warranty in the country of service. Should the cost of repairs or replacement not be covered by this warranty, *Nespresso* will advise the owner and the cost shall be charged to the owner. This limited warranty shall be the full extent of *Nespresso's* liability however caused. Except to the extent allowed by applicable law, the terms of this limited warranty do not exclude, restrict or modify the mandatory statutory rights applicable to the sale of this product and are in addition to those rights. If you believe your product is defective, contact *Nespresso* for instructions on how to proceed with a repair. Please visit our website at www.nespresso.com for contact details.

Nespresso garantit ce produit contre les défauts de matériels et de fabrication pour une période de deux années. La période de garantie commence à la date d'achat et *Nespresso* exige la présentation de la preuve originale d'achat pour en constater la date. Durant la période de garantie, *Nespresso* réparera ou remplacera, à sa discrétion, tout produit défectueux sans frais pour le propriétaire. Les produits échangés et les pièces réparées seront garantis uniquement pendant la durée restante de la garantie originale ou durant six mois, l'échéance la plus lointaine faisant foi. Cette garantie limitée ne s'applique pas à tout défaut résultant d'une négligence, d'un accident, d'une utilisation inadaptée ou de toute autre raison hors du contrôle raisonnable de *Nespresso*, y compris mais sans s'y limiter : l'usure normale, la négligence ou le non-respect du mode d'emploi du produit, l'entretien inadapté ou inadéquat, les dépôts calcaires ou le détartrage, le branchement à une sortie électrique inadaptée, la modification ou la réparation non autorisée du produit, l'utilisation à des fins commerciales, les dommages causés par le feu, la foudre, les inondations ou toute autre cause extérieure. Cette garantie est valide seulement dans le pays d'achat ou tout autre pays où *Nespresso* vend ou assure l'après-vente du même modèle avec les spécifications techniques identiques. Le service de garantie hors du pays d'achat se limite aux conditions de la garantie correspondante dans le pays où l'entretien est effectué. Si le coût des réparations ou de remplacement n'est pas couvert par cette garantie, *Nespresso* informera le propriétaire qui devra honorer ces frais. Cette garantie limitée constituera l'intégralité de la responsabilité de *Nespresso*, quelque soit la cause. Les conditions de la présente garantie limitée s'ajoutent aux droits statutaires obligatoires applicables à la vente du produit et ne les excluent, ni ne les restreignent ou modifient en rien, sauf dans les limites autorisées par la loi. Si vous pensez que votre produit est défectueux, veuillez contacter *Nespresso* pour obtenir des renseignements concernant la marche à suivre pour le faire réparer. Veuillez consulter notre site Internet au www.nespresso.com pour obtenir les coordonnées de contact.

We chose aluminium as the material for our capsules because it protects the coffee and aromas of the *Nespresso* Grands Crus. Aluminium is also indefinitely recyclable, without losing any of its qualities.

Nespresso is committed to designing and making appliances that are innovative, high-performing and user-friendly. Now we are engineering environmental benefits into the design of our new and future machine ranges.



Job: NES-432001-2003Q-3 ProdigioMilk
Objekt: pCover
Version: --
Seite: p3

Datum: 15-06-05
Uhrzeit: 15:03:44
von: timea.trojko



PRODIGIO&MILK
by Nespresso



Job: NES-432001-2003Q-3 ProdigioMilk

Objekt: pCover

Version: --

Seite: p4

Datum: 15-06-05

Uhrzeit: 15:03:44

von: timea.trojko