

Queen Elizabeth Deck Plans



Queen Elizabeth Deck Plans.
1 August 2014 (Q412) - 11 May 2015 (Q507)

[Click here.](#)



Queen Elizabeth Deck Plans.
27 May 2015 (Q508) - 22 December 2015 (Q601)

[Click here.](#)



Queen Elizabeth Deck Plans

1 August 2014 (Q412) - 11 May 2015 (Q507)



Stateroom Category

Grand Suites		
Aft	High Decks 6,7	Q1
Master Suites		
Midships	High Deck 7	Q2
Penthouse		
Midships	High Decks 4,5,6,8	Q3
Midships	High Deck 7	Q4
Queens Suites		
Aft	High Decks 4,5,8	Q5
Forward/Aft	High Decks 4,5,7,8	Q6
Princess Suites		
Midships	High Decks 7,8	P1
Midships/Forward	High Decks 4,5,6	P2
Club Balcony		
Midships	High Deck 8	AA
Balcony		
Midships	High Decks 4,5,6,7,8	BA
Forward/Aft	High Decks 4,5,6,7,8	BC
Balcony (partially obstructed view)*		
Midships	High Deck 5	CA
Oceanview		
Midships	Low Deck 1	EB
Forward	High Deck 6	ED
Forward/Aft	Low Deck 1	ED
Oceanview (obstructed view)*		
Midships	High Deck 4	FA
Deluxe Inside		
Midships	High Deck 6,8	GA
Midships	Low Deck 1	GB
Standard Inside		
Midships	High Decks 7,8	IA
Forward/Aft	High Decks 4,5,6,7,8	IC
Single Cabins		
Inside	Deck 2	LC
Oceanview	Deck 2	KC

Deck 12

Deck 11

Deck 10

Deck 9

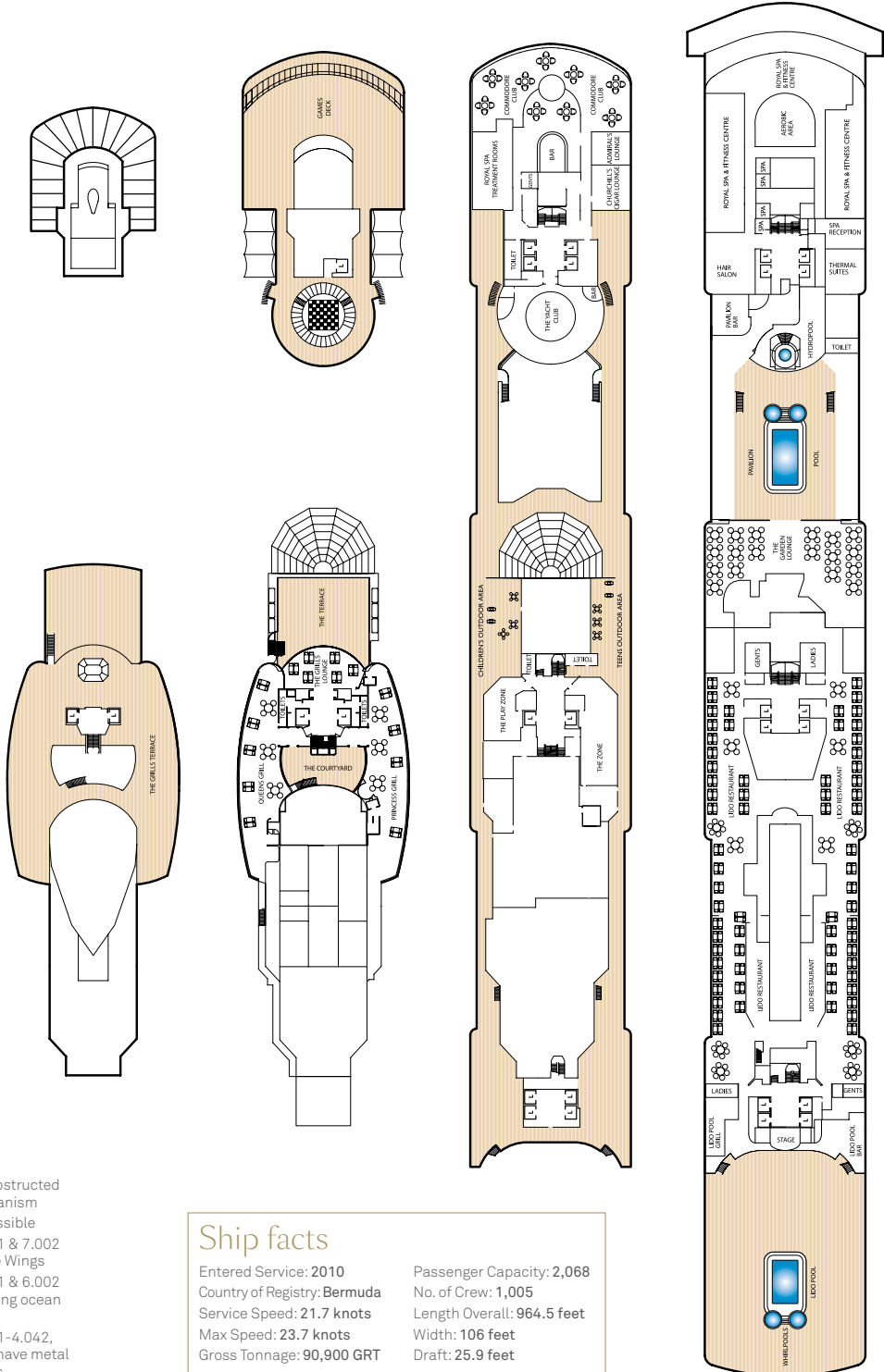

Key to symbols

- L Lift
- † Indicates 2 lower berths and 1 upper berth
- + Indicates 3rd berth is a single sofa bed
- ‡ Indicates 3rd and 4th berth is a single sofa bed and one upper bed
- * Staterooms have views obstructed by lifeboats
- × Views partially obstructed by lifeboat mechanism
- ▲ Wheelchair accessible
- Staterooms 7.001 & 7.002 shaded by Bridge Wings
- ◆ Staterooms 6.001 & 6.002 have forward facing ocean views
- Staterooms 4.001-4.042, Deck 4 Forward, have metal fronted balconies

Ship facts

Entered Service: 2010	Passenger Capacity: 2,068
Country of Registry: Bermuda	No. of Crew: 1,005
Service Speed: 21.7 knots	Length Overall: 964.5 feet
Max Speed: 23.7 knots	Width: 106 feet
Gross Tonnage: 90,900 GRT	Draft: 25.9 feet

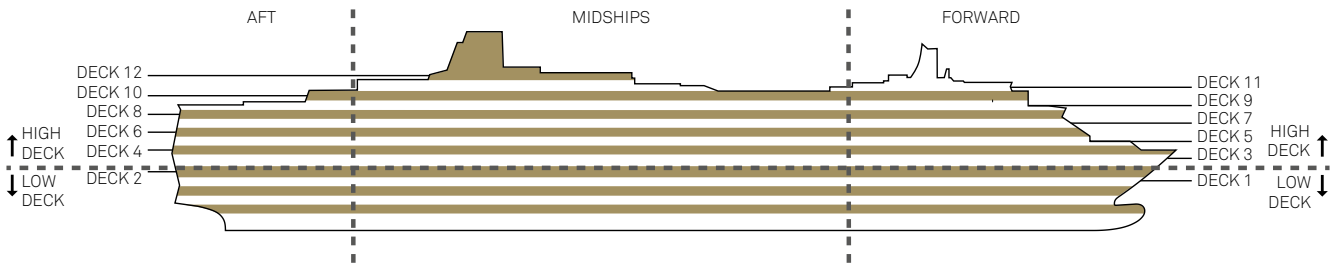

Deck 8 (High)
(Penthouses, Queens & Princess Suites & Staterooms 8.001-8.181)

Deck 7 (High)
(Grand, Master & Princess Suites, Penthouses & Staterooms 7.001-7.177)

Deck 6 (High)
(Grand Suites, Penthouses, Princess Suites & Staterooms 6.001-6.213)

Deck 5 (High)
(Penthouses, Queens & Princess Suites & Staterooms 5.001-5.198)

Deck 4 (High)
(Penthouses, Queens & Princess Suites & Staterooms 4.001-4.195)

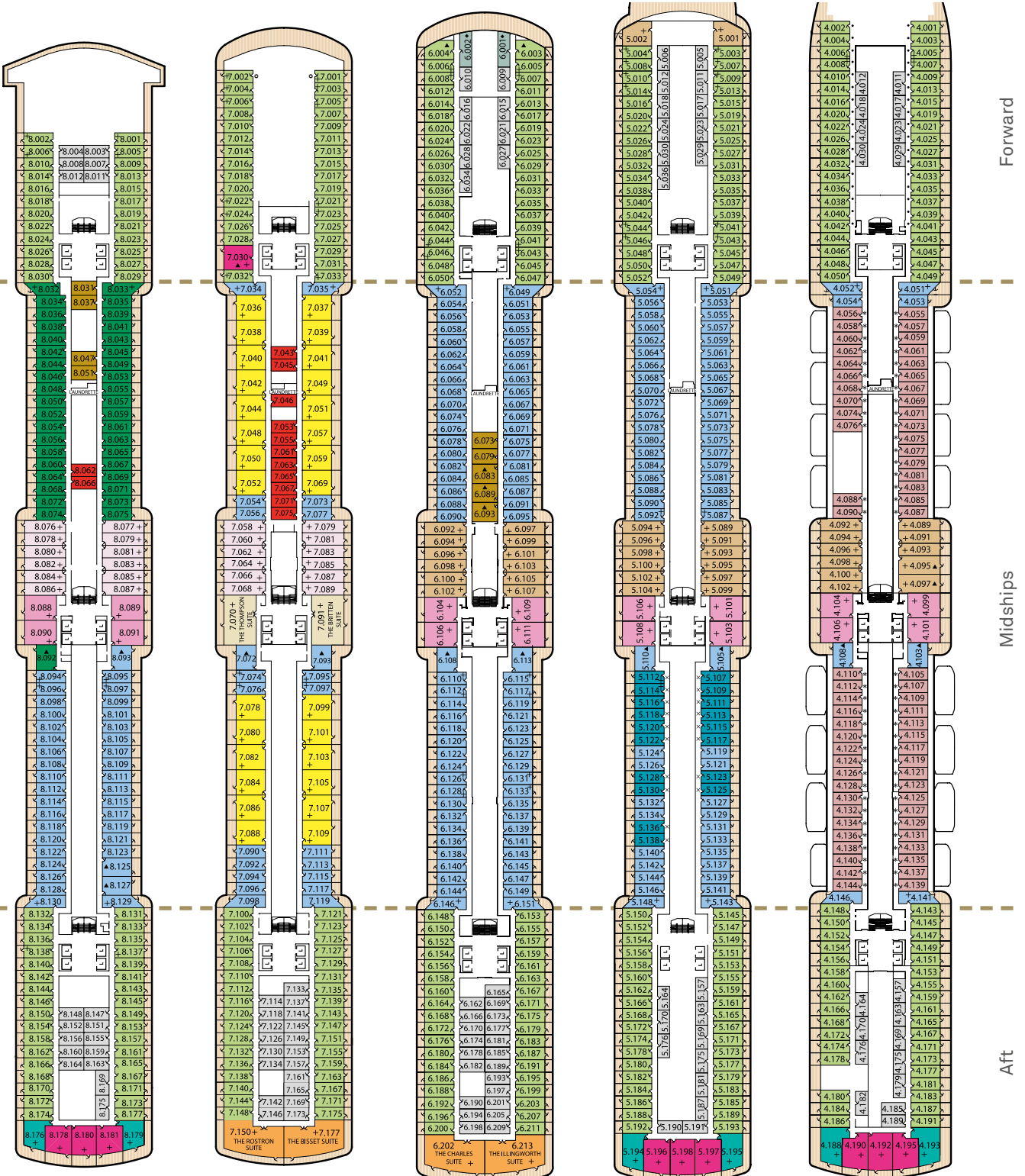



Queen Elizabeth Deck Plans

1 August 2014 (Q412) - 11 May 2015 (Q507)

Stateroom Category

Grand Suites		
Aft	High Decks 6,7	Q1
Master Suites		
Midships	High Deck 7	Q2
Penthouse		
Midships	High Decks 4,5,6,8	Q3
Midships	High Deck 7	Q4
Queens Suites		
Aft	High Decks 4,5,8	Q5
Forward/Aft	High Decks 4,5,7,8	Q6
Princess Suites		
Midships	High Decks 7,8	P1
Midships/Forward	High Decks 4,5,6	P2
Club Balcony		
Midships	High Deck 8	AA
Balcony		
Midships	High Decks 4,5,6,7,8	BA
Forward/Aft	High Decks 4,5,6,7,8	BC
Balcony (partially obstructed view)*		
Midships	High Deck 5	CA
Oceanview		
Midships	Low Deck 1	EB
Forward	High Deck 6	ED
Forward/Aft	Low Deck 1	ED
Oceanview (obstructed view)*		
Midships	High Deck 4	FA
Deluxe Inside		
Midships	High Deck 6,8	GA
Midships	Low Deck 1	GB
Standard Inside		
Midships	High Decks 7,8	IA
Forward/Aft	High Decks 4,5,6,7,8	IC
Single Cabins		
Inside	Deck 2	LC
Oceanview	Deck 2	KC

Deck 3

Deck 2

Deck 1 (Low)
(Staterooms 1.001-1.111)

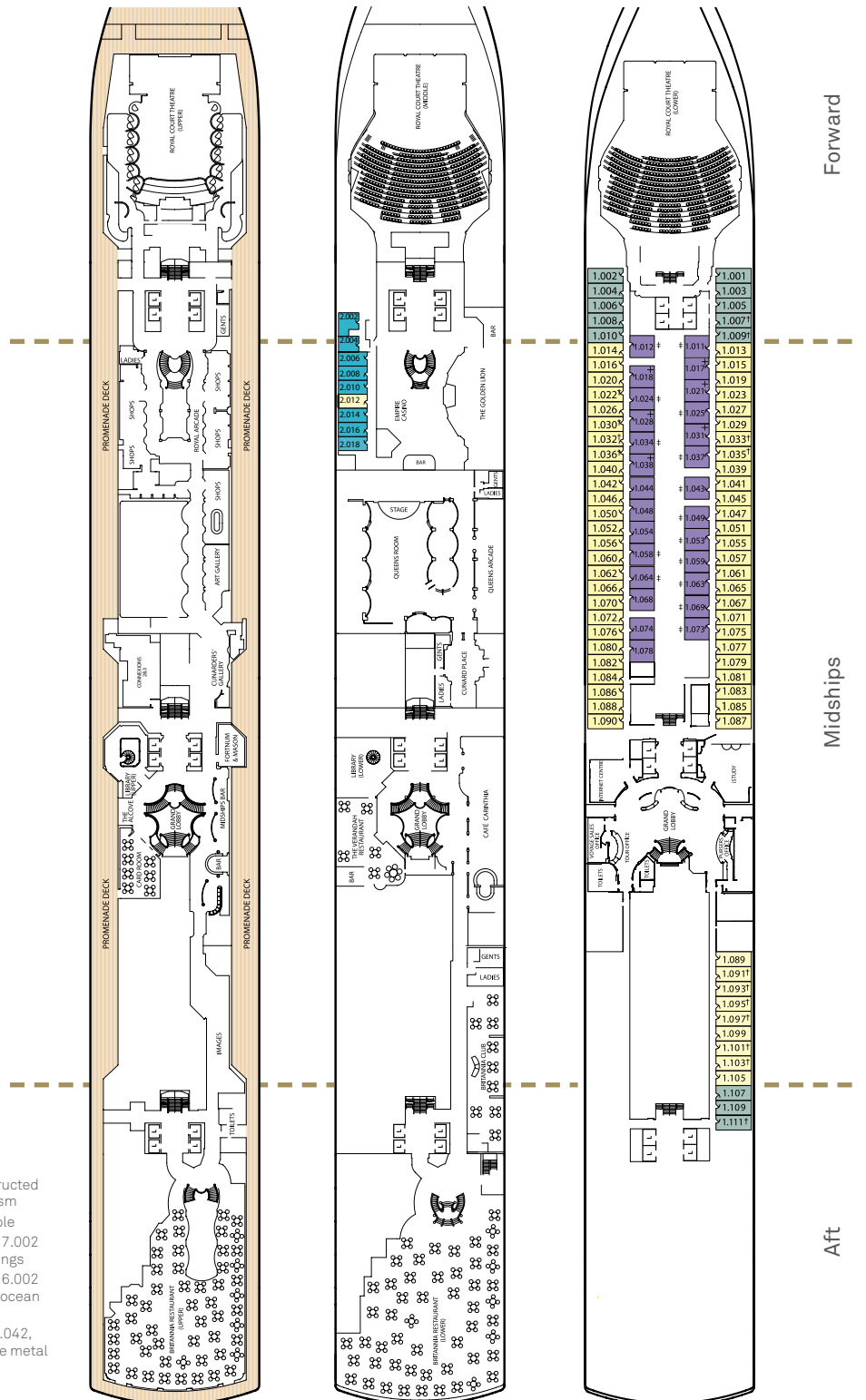

Key to symbols

- L Lift
- † Indicates 2 lower berths and 1 upper berth
- + Indicates 3rd berth is a single sofa bed
- ‡ Indicates 3rd and 4th berth is a single sofa bed and one upper bed
- * Staterooms have views obstructed by lifeboats
- × Views partially obstructed by lifeboat mechanism
- ▲ Wheelchair accessible
- Staterooms 7.001 & 7.002 shaded by Bridge Wings
- ◆ Staterooms 6.001 & 6.002 have forward facing ocean views
- Staterooms 4.001-4.042, Deck 4 Forward, have metal fronted balconies



Queen Elizabeth Deck Plans

27 May 2015 (Q508) - 22 December 2015 (Q601)



Stateroom Category

Grand Suites		
Aft	High Decks 6,7	Q1
Master Suites		
Midships	High Deck 7	Q2
Penthouse		
Midships	High Decks 4,5,6,8	Q3
Midships	High Deck 7	Q4
Queens Suites		
Aft	High Decks 4,5,8	Q5
Forward/Aft	High Decks 4,5,7,8	Q6
Princess Suites		
Midships	High Decks 7,8	P1
Midships/Forward	High Decks 4,5,6	P2
Club Balcony		
Midships	High Deck 8	A1
Midships	High Deck 8	A2
Balcony		
Midships	High Decks 5,6,7	BA
Midships	High Decks 5,6,7,8	BB
Midships	High Decks 4,8	BC
Aft	High Decks 5,6,7	BD
Forward/Aft	High Decks 4,5,6,7,8	BE
Forward	High Decks 4,8	BF
Balcony (partially obstructed view)*		
Midships	High Deck 5	CA
Midships	High Deck 4, 5	CB
Oceanview		
Midships	Low Deck 1	EB
Midships/Aft	Low Deck 1	EC
Forward	Low Deck 1, 6	EF
Oceanview (obstructed view)*		
Midships	High Deck 4	FB
Midships	High Deck 4	FC
Deluxe Inside		
Midships	High Deck 6,8	GA
Midships	Low Deck 1	GB
Midships	Low Deck 1	GC
Standard Inside		
Midships	High Decks 7,8	IA
Aft	High Decks 5,6,7	ID
Forward/Aft	High Decks 4,5,6,8	IE
Forward	High Decks 4,8	IF
Single Cabins		
Inside	Deck 2	LC
Oceanview	Deck 2	KC

Key to symbols

- L Lift
- † Indicates 2 lower berths and 1 upper berth
- + Indicates 3rd berth is a single sofa bed
- ‡ Indicates 3rd and 4th berth is a single sofa bed and one upper bed
- * Staterooms have views obstructed by lifeboats
- × Views partially obstructed by lifeboat mechanism
- ▲ Wheelchair accessible
- Staterooms 7.001 & 7.002 shaded by Bridge Wings
- ◆ Staterooms 6.001 & 6.002 have forward facing ocean views
- Staterooms 4.001-4.042, Deck 4 Forward, have metal fronted balconies

Deck 12

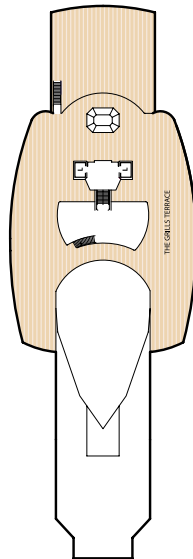
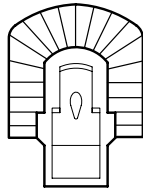

Deck 11

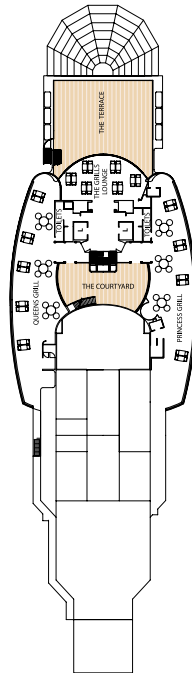
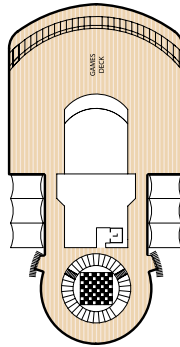

Deck 10

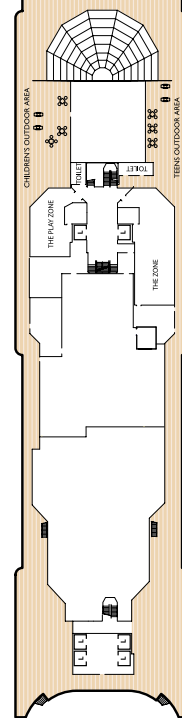
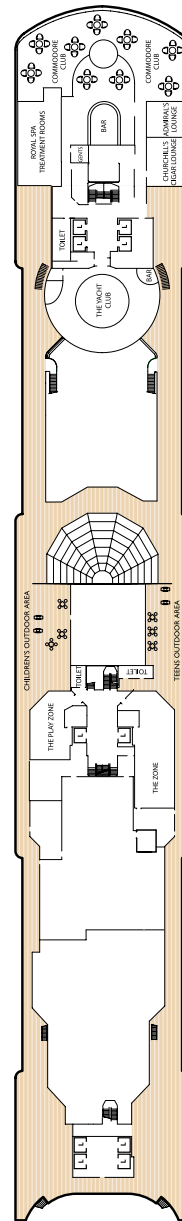

Deck 9

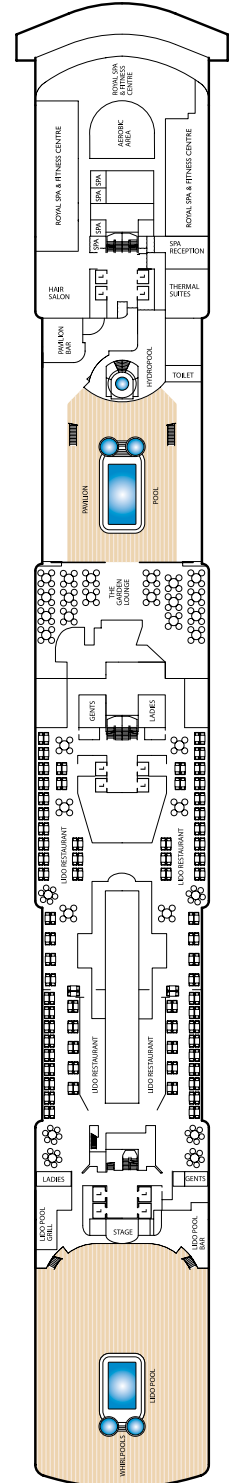

Ship facts

Entered Service: 2010	Passenger Capacity: 2,068
Country of Registry: Bermuda	No. of Crew: 1,005
Service Speed: 21.7 knots	Length Overall: 964.5 feet
Max Speed: 23.7 knots	Width: 106 feet
Gross Tonnage: 90,900 GRT	Draft: 25.9 feet





Queen Elizabeth Deck Plans

27 May 2015 (Q508) - 22 December 2015 (Q601)

Stateroom Category

Grand Suites		
Aft	High Decks 6,7	Q1
Master Suites		
Midships	High Deck 7	Q2
Penthouse		
Midships	High Decks 4,5,6,8	Q3
Midships	High Deck 7	Q4
Queens Suites		
Aft	High Decks 4,5,8	Q5
Forward/Aft	High Decks 4,5,7,8	Q6
Princess Suites		
Midships	High Decks 7,8	P1
Midships/Forward	High Decks 4,5,6	P2
Club Balcony		
Midships	High Deck 8	A1
Midships	High Deck 8	A2
Balcony		
Midships	High Decks 5,6,7	BA
Midships	High Decks 5,6,7,8	BB
Midships	High Decks 4,8	BC
Aft	High Decks 5,6,7	BD
Forward/Aft	High Decks 4,5,6,7,8	BE
Forward	High Decks 4,8	BF
Balcony (partially obstructed view)*		
Midships	High Deck 5	CA
Midships	High Deck 4, 5	CB
Oceanview		
Midships	Low Deck 1	EB
Midships/Aft	Low Deck 1	EC
Forward	Low Deck 1, 6	EF
Oceanview (obstructed view)*		
Midships	High Deck 4	FB
Midships	High Deck 4	FC
Deluxe Inside		
Midships	High Deck 6,8	GA
Midships	Low Deck 1	GB
Midships	Low Deck 1	GC
Standard Inside		
Midships	High Decks 7,8	IA
Aft	High Decks 5,6,7	ID
Forward/Aft	High Decks 4,5,6,8	IE
Forward	High Decks 4,8	IF
Single Cabins		
Inside	Deck 2	LC
Oceanview	Deck 2	KC

Key to symbols

- L Lift
- † Indicates 2 lower berths and 1 upper berth
- + Indicates 3rd berth is a single sofa bed
- ‡ Indicates 3rd and 4th berth is a single sofa bed and one upper bed
- * Staterooms have views obstructed by lifeboats
- × Views partially obstructed by lifeboat mechanism
- ▲ Wheelchair accessible
- Staterooms 7.001 & 7.002 shaded by Bridge Wings
- ◆ Staterooms 6.001 & 6.002 have forward facing ocean views
- Staterooms 4.001-4.042, Deck 4 Forward, have metal fronted balconies

Deck 8 (High)
(Penthouses, Queens & Princess Suites & Staterooms 8.001-8.181)

Deck 7 (High)
(Grand, Master & Princess Suites, Penthouses & Staterooms 7.001-7.177)

Deck 6 (High)
(Grand Suites, Penthouses, Princess Suites & Staterooms 6.001-6.213)

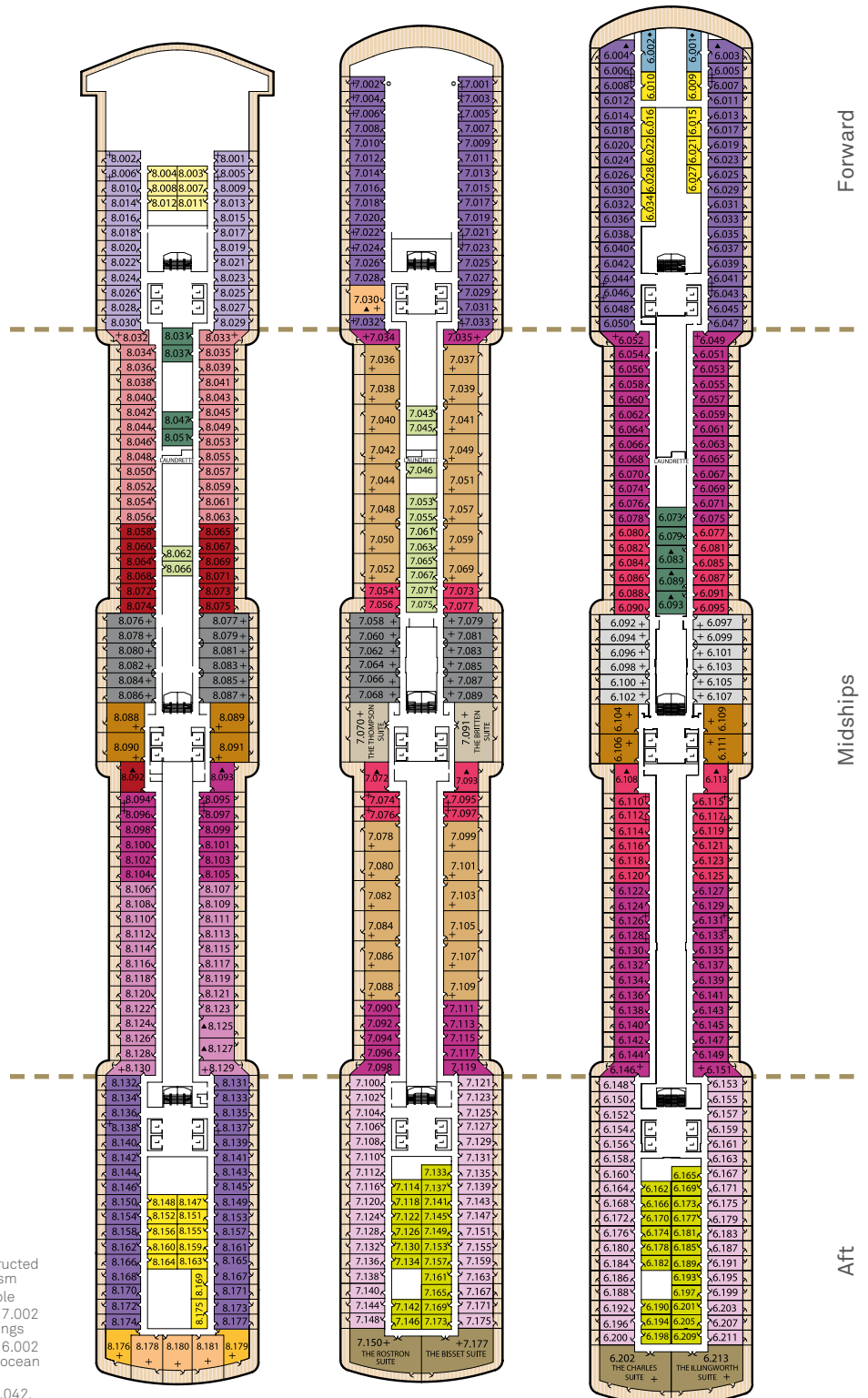

Forward

Midships

Aft

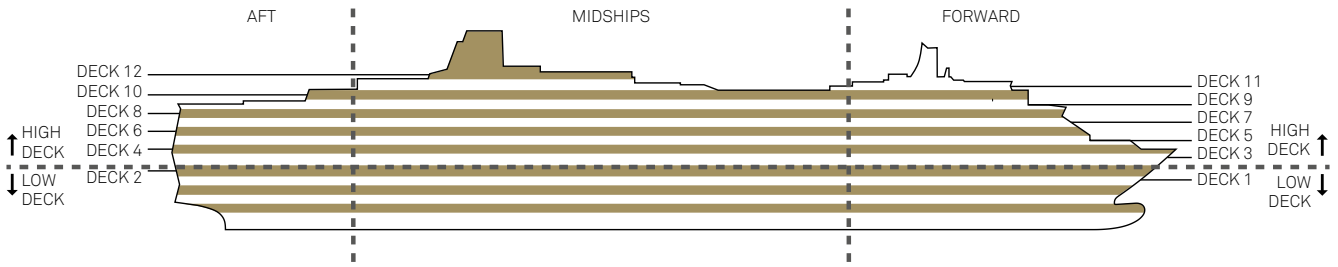

Deck 5 (High)
(Penthouses, Queens & Princess Suites & Staterooms 5.001-5.198)

Deck 4 (High)
(Penthouses, Queens & Princess Suites & Staterooms 4.001-4.195)

Deck 3

Deck 2

Deck 1 (Low)
(Staterooms 1.001-1.111)

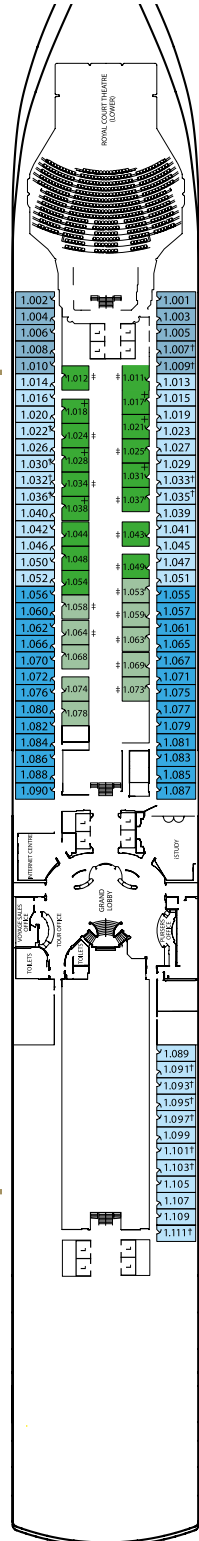
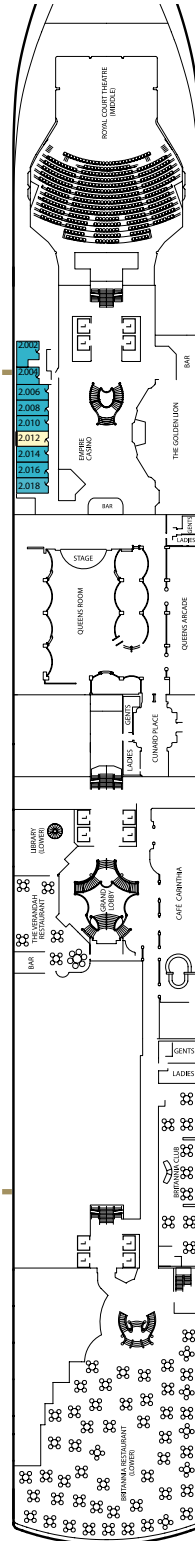
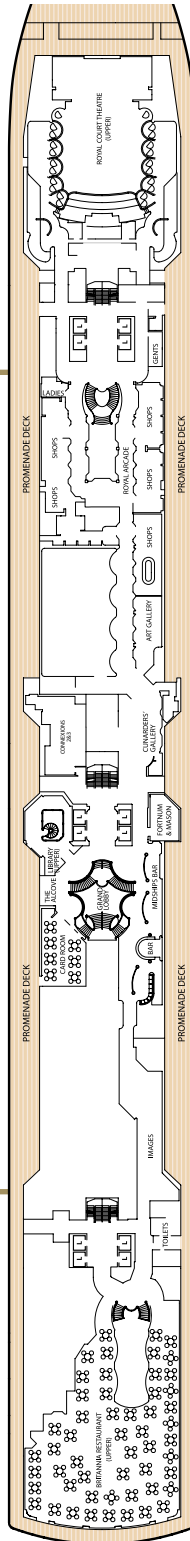
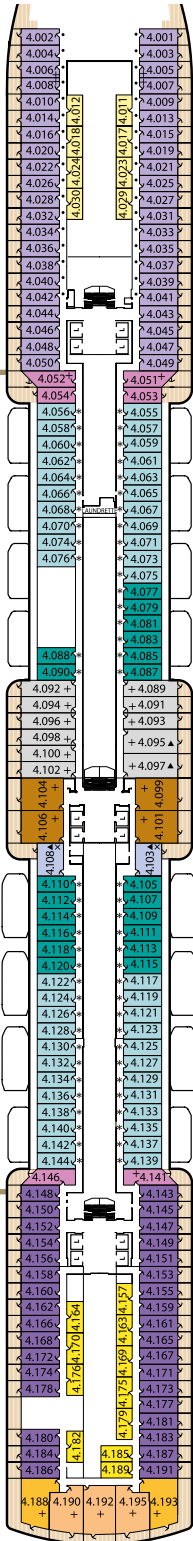
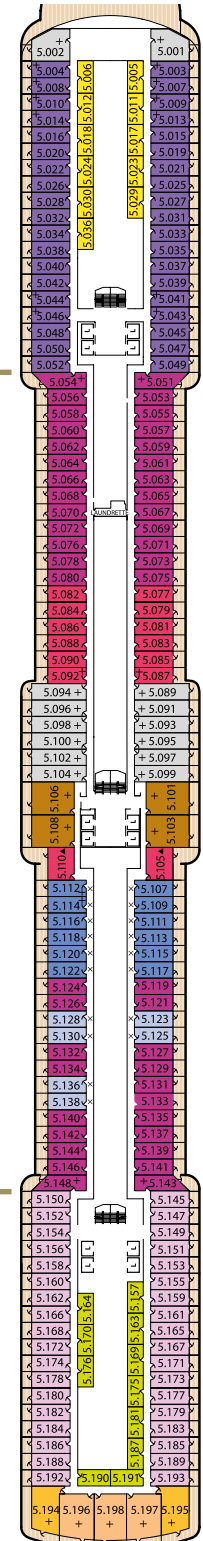

Forward

Midships

Aft