

Quick Couplings

Together, We Can Make
a Quick Connection



Connect Fluid Lines Quickly and Easily

General purpose couplings are used across the spectrum of fluid system applications. Couplings can be found wherever fluid lines need to be connected or disconnected more efficiently, eliminating the need for additional tools to make the connection.

Parker offers a broad range of coupling products for nearly every design requirement; including industrial, agricultural and mobile hydraulic systems.

Couplings are available in steel, stainless steel, aluminum and other materials. Parker manufactures the largest volume of quick coupling products in the industry and offers a wide variety of special port options and sealing materials for numerous applications.



Quick Coupling Product Range:

- **General purpose**
- **Non-spill**
- **Connect under pressure**



- general industrial applications
- mobile applications
- in-plant machinery
- production equipment
- chemical lines
- paper mills

60 Series

General Purpose Quick Couplings

Parker 60 Series couplings meet ISO 7241-1, Series B interchange and are used across a wide spectrum of hydraulic applications. These double shut-off couplings can be used anywhere that fluid transfer lines are regularly connected and disconnected, and where a minimum loss of fluid is desirable. The product is primarily used with hydraulic fluid; however, general purpose 60 Series couplings are also used with chemicals, water, steam, and gas transfer lines.

- ISO 7241 Series B standard
- Sizes: 1/8" – 2 1/2" (1 1/2" and 2 1/2" not shown – contact Division)
- Rated pressure up to 5,000 PSI
- Temperature range -40 to +250° F
- Standard seal material is nitrile
- Available in steel, brass, 303 & 316 stainless steel and aluminum



Specifications (steel material only)

Body Size (in.)	1/8	1/4	3/8	1/2	3/4	1
Rated Pressure (PSI)	5000	5000	4000	4000	2500	2000
Rated Flow (GPM)	.8	3	6	12	28	50

Performance

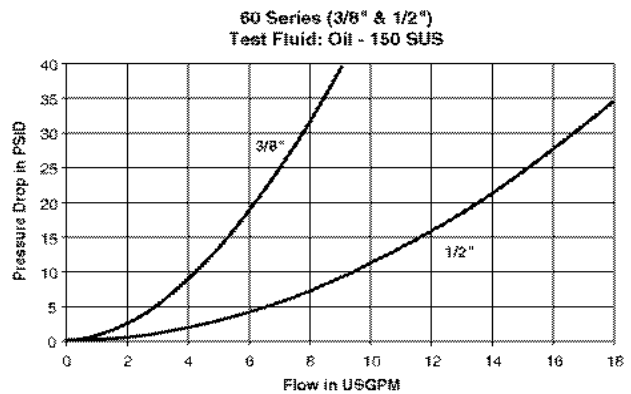
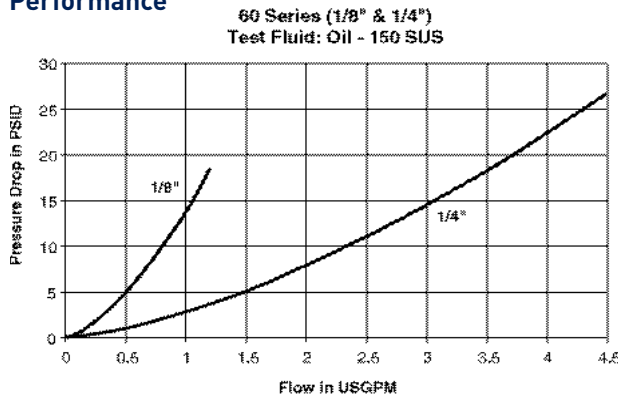

Aluminum couplings are color coded to indicate seal material.

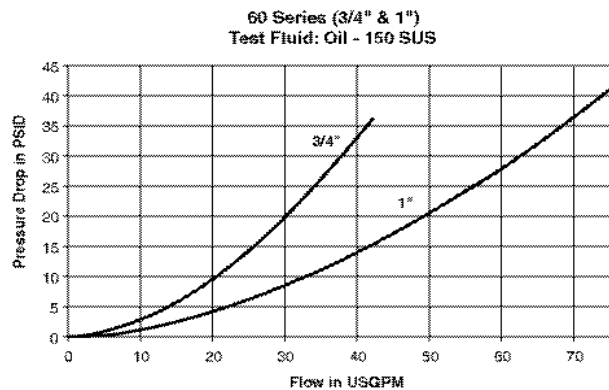

60 Series

General Purpose Quick Couplings

Couplers; Steel

Female Thread



Body Size (in.)	Part Number	Thread Size	Dimensions (inches)		
			Overall Length	Wrench Flats	Largest Diameter
			A	B	C
1/8	H1-62	.125-27 NPFT	1.90	0.68	0.96
1/8	H1-62-T4	.437-20 ORB	2.06	0.68	0.96
1/4	H2-62	.250-18 NPFT	2.26	0.81	1.14
1/4	H2-62-T6	.562-18 ORB	2.41	0.81	1.14
3/8	H3-62	.375-18 NPFT	2.49	0.88	1.40
3/8	H3-62-T8	.750-16 ORB	2.75	1.00	1.40
1/2	H4-62	.500-14 NPFT	2.87	1.12	1.77
1/2	H4-62-T10	.875-14 ORB	3.05	1.12	1.77
3/4	H6-62	.750-14 NPFT	3.56	1.31	2.14
3/4	H6-62-T12	1.062-12 ORB	3.56	1.31	2.14
1	H8-62	1.000-11.5 NPFT	4.18	1.62	2.52
1	H8-62-T16	1.312-12 ORB	4.18	1.62	2.52

Contact Division for other body sizes, materials and seal options.

Nipples; Steel

Female Thread



Body Size (in.)	Part Number	Thread Size	Dimensions (inches)		
			Overall Length	Hex Size	Largest Diameter
			D	E	F
1/8	H1-63	.125-27 NPFT	1.26	0.56	0.65
1/8	H1-63-T4	.437-20 ORB	1.41	0.69	0.79
1/4	H2-63	.250-18 NPFT	1.54	0.75	0.87
1/4	H2-63-T6	.562-18 ORB	1.69	0.88	1.01
3/8	H3-63	.375-18 NPFT	1.68	0.88	1.01
3/8	H3-63-T8	.750-16 ORB	1.94	1.00	1.15
1/2	H4-63	.500-14 NPFT	1.94	1.12	1.30
1/2	H4-63-T10	.875-14 ORB	2.12	1.19	1.37
3/4	H6-63	.750-14 NPFT	2.43	1.38	1.59
3/4	H6-63-T12	1.062-12 ORB	2.54	1.34	1.59
1	H8-63	1.000-11.5 NPFT	2.91	1.62	1.88
1	H8-63-T16	1.312-12 ORB	2.91	1.62	1.88

Contact Division for other body sizes, materials and seal options.

Dust Plugs & Caps



Body Size (in.)	Dust Plug Part No.	Dust Plug Part No.	Dust Cap Part No.	
			Aluminum	Rubber
			Aluminum	Rubber
1/8	H1-65	H1-65M	H1-66	H1-66M
1/4	H2-65	H2-65M	H2-66	H2-66M
3/8	H3-65	H3-65M	H3-66	H3-66M
1/2	H4-65	H4-65M	H4-66	H4-66M
3/4	H6-65	H6-65M	H6-66	H6-66M
1	H8-65	H8-65M	H8-66	H8-66M

- truck & off-highway
- forestry equipment
- in-plant hydraulic systems
- mining
- asphalt paving

IB Series

General Purpose Connect Under Pressure Couplings

The IB Series Pressure Eliminator complements our standard 60 Series product offering. This series meets the ISO 7241-1, Series B industrial interchange specifications, while providing a connect-under-pressure feature.

The unique integrated Pressure Eliminator valve makes it possible to complete a connection under trapped, residual pressure up to 1450 PSI.

- ISO 7241-1, Series B interchange
- Steel & Brass construction
- Sizes from 1/4" to 1"
- Pressure rated up to 4060 PSI
- Temperature range: -40 to +212° F
- Double shut-off poppet style valve
- Standard seal material is nitrile
- Port configurations: NPTF, UNF & BSPP



Use Parker's IB Series to connect under the force of built-up pressure when mating with a 60 Series or other ISO, Series B coupler or nipple.

Specifications

Body Size (in.)	1/4	3/8	1/2	3/4	1
Working Pressure (PSI)					
Coupled	4060	4000	3625	2500	2000
Uncoupled	5800	4640	4350	4350	4350
Connect under pressure up to	1450	1450	1450	1450	1450

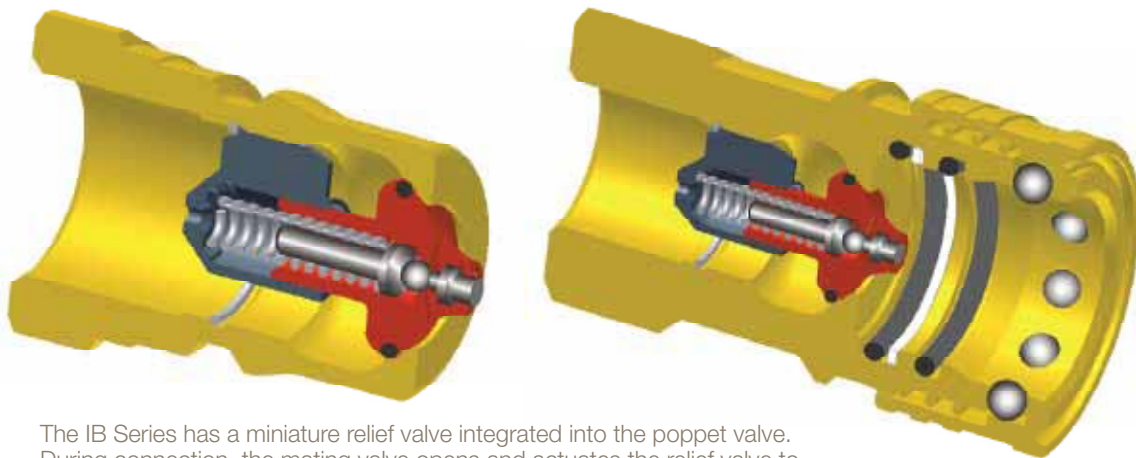

The IB Series has a miniature relief valve integrated into the poppet valve. During connection, the mating valve opens and actuates the relief valve to reduce the excess pressure.

IB Series

Connect Under Pressure Quick Couplings

Couplers

Female Thread



Body Size (in.)	Part Number	Thread Size	Dimensions (inches)		
			Overall Length	Wrench Hex	Largest Diameter
			A	B	C
1/4	IB2511 NPT	.250-18 NPFT	2.24	0.94	1.10
3/8	IB3811 NPT	.375-18 NPFT	2.48	1.18	1.34
1/2	IB5011 NPT	.500-14 NPFT	2.60	1.30	1.57
3/4	IB7511 NPT	.750-14 NPFT	3.19	1.81	2.05
1	IB10011 NPT	1.000-11.5 NPFT	3.70	1.97	2.44

Nipples

Female Thread

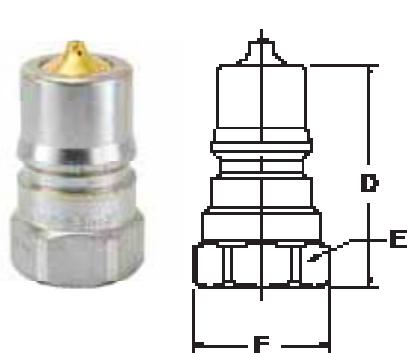

Body Size (in.)	Part Number	Thread Size	Dimensions (inches)		
			Overall Length	Wrench Hex	Largest Diameter
			D	E	F
1/4	IB2521 NPT	.250-18 NPFT	1.38	0.75	0.83
3/8	IB3821 NPT	.375-18 NPFT	1.50	0.87	0.96
1/2	IB5021 NPT	.500-14 NPFT	1.63	1.10	1.21
3/4	IB7521 NPT	.750-14 NPFT	2.09	1.42	1.54
1	IB10021 NPT	1.000-11.5 NPFT	2.48	1.65	1.81

Dust Plugs & Caps

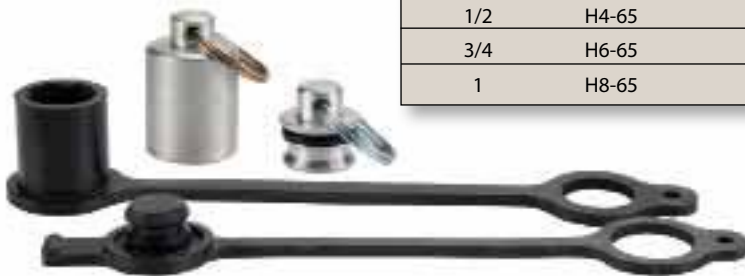

Body Size (in.)	Dust Plug Part No.	Dust Plug Part No.	Dust Cap Part No.	Dust Cap Part No.
	Aluminum	Rubber	Aluminum	Rubber
1/8	H1-65	H1-65M	H1-66	H1-66M
1/4	H2-65	H2-65M	H2-66	H2-66M
3/8	H3-65	H3-65M	H3-66	H3-66M
1/2	H4-65	H4-65M	H4-66	H4-66M
3/4	H6-65	H6-65M	H6-66	H6-66M
1	H8-65	H8-65M	H8-66	H8-66M

- construction equipment
- manufacturing machinery
- paper mills
- refuse hauling
- mining
- asphalt paving

6600 Series

General Purpose Quick Couplings

Parker 6600 Series couplers meet the ISO 7241-1, Series A interchange and offer a double shut-off solution for higher pressure general purpose applications. The sleeve and nipple body are hardened to resist damage from brinelling and mechanical shock. The 6600 Series' rugged construction makes this product a great choice for a wide range of applications.

- ISO 7241-1 Series A standard
- Steel construction
- Sizes: 1/4" to 1"
- Rated pressure up to 5,000 PSI
- Temperature range: -40 to +250° F
- Standard seal material is nitrile
- Port configurations: NPTF & SAE ORB



Specifications

Body Size (in.)	1/4	3/8	1/2	3/4	1
Rated Pressure (PSI)	5000	4000	4000	4000	4000
Rated Flow (GPM)	0.8	6	12	28	50

Performance

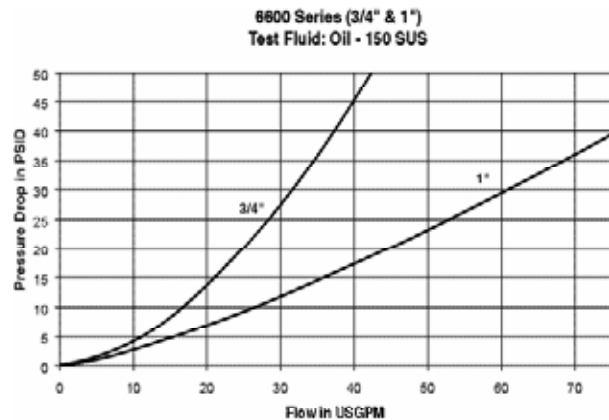
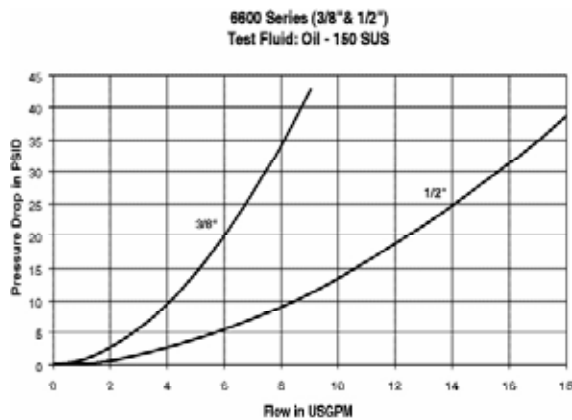
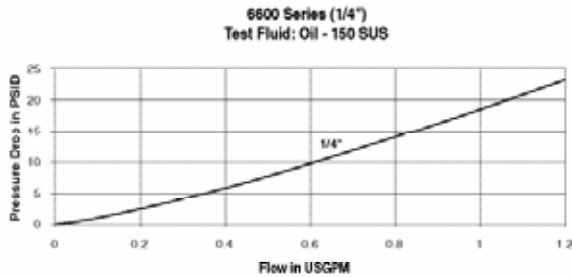

6600 Series

General Purpose Quick Couplings

Couplers Female Thread

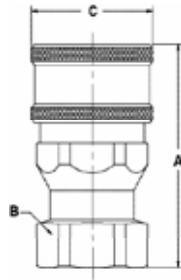

Body Size (in.)	Part Number	Thread Size	Dimensions (inches)		
			Overall Length	Hex Size	Largest Diameter
			A	B	C
1/4	6601-2-4	.125-27 NPTF	1.85	.88	1.08
1/4	6601-4-4	.250-18 NPTF	1.85	.88	1.08
3/8	6601-6-6	.375-18 NPTF	2.18	1.06	1.27
3/8	6608-6-6	.562-18 ORB	2.18	1.06	1.27
1/2	6601-8-10	.500-14 NPTF	2.75	1.25	1.52
1/2	6601-12-10	.750-14 NPTF	2.88	1.38	1.52
1/2	6608-8-10	.750-16 ORB	2.74	1.25	1.52
1/2	6608-10-10	.875-14 ORB	2.79	1.25	1.52
1/2	6608-12-10	1.062-12 ORB	3.01	1.38	1.52
3/4	6601-12-12	.750-14 NPTF	3.36	1.62	1.90
3/4	6608-12-12	1.062-12 ORB	3.35	1.62	1.90
1	6601-16-16	1.000-11.5 NPTF	4.11	1.88	2.14
1	6608-16-16	1.312-12 ORB	4.11	1.88	2.14

Nipples Female Thread

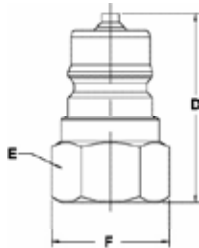

Body Size (in.)	Part Number	Thread Size	Dimensions (inches)		
			Overall Length	Hex Size	Largest Diameter
			D	E	F
1/4	6602-2-4	.125-27 NPTF	1.41	.56	.65
1/4	6602-4-4	.250-18 NPTF	1.41	.75	.87
3/8	6602-6-6	.375-18 NPTF	1.63	.88	1.01
3/8	66010-6-6	.562-18 ORB	1.63	.88	1.01
1/2	6602-8-10	.500-14 NPTF	2.08	1.06	1.23
1/2	6602-12-10	.750-14 NPTF	2.30	1.38	1.59
1/2	66010-8-10	.750-16 ORB	2.08	1.06	1.23
1/2	66010-10-10	.875-14 ORB	2.08	1.12	1.30
1/2	66010-12-10	1.062-12 ORB	2.30	1.38	1.59
3/4	6602-12-12	.750-14 NPTF	2.55	1.38	1.59
3/4	66010-12-12	1.062-12 ORB	2.55	1.38	1.59
1	6602-16-16	1.000-11.5 NPTF	3.10	1.62	1.88
1	66010-16-16	1.312-12 ORB	3.10	1.62	2.17

Dust Plugs & Caps



Body Size (in.)	Dust Plug Part No.	Dust Cap Part No.
	Rubber	Rubber
1/4	H1-65M	H1-66M
3/8	TR-37	TR-37
1/2	5205-4M	5209-4M
3/4	6659-12M	6657-12M
1	6659-16M	6657-16M

4000 Series

General Purpose Quick Couplings

The 4000 Series is an industry proven double shut-off coupler. This general purpose series features a rugged design for use in heavy duty hydraulic applications.

It is available in either a ball or poppet valve design. Critical parts are induction hardened for durability and for a long service life. A dependable ball locking mechanism reduces hose twisting. This product features a single acting sleeve, and must be retracted when connecting and disconnecting.

These couplers are the ideal choice for industrial, agricultural, mobile and other demanding applications.

- Flows rated from 3 to 50 GPM
- Rated to 3000 PSI for all sizes
- Temperature range:
-40 to +250° F
- Available from 1/4" to 1"
- Single Acting Sleeve
- Nitrile Seals



Specifications

Body Size (in.)	1/4	3/8	1/2	3/4	1
Rated Pressure (PSI)	3000	3000	3000	3000	3000
Rated Flow (GPM)	3	6	12	28	50

Performance

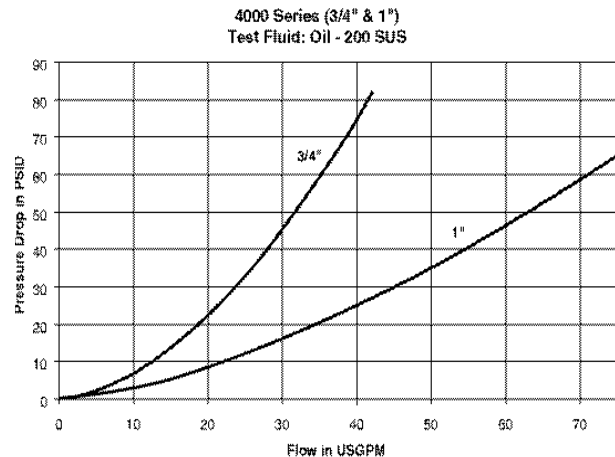
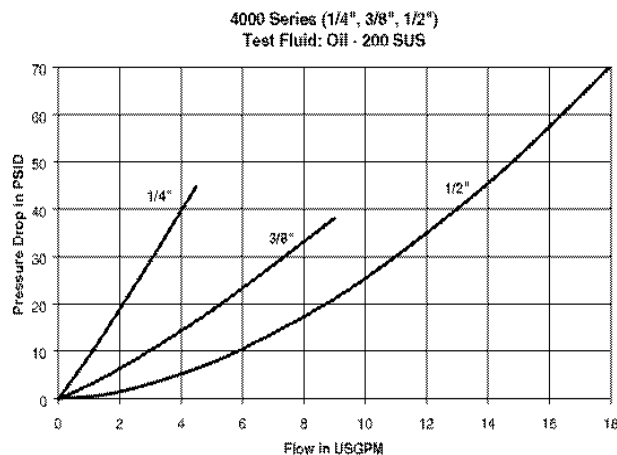

4000 Series

General Purpose Quick Couplings

Couplers

Female Thread

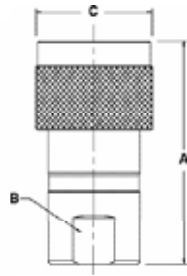

Body Size (in.)	Part Number*	Thread Size	Dimensions (inches)		
			Overall Length	Wrench Flats	Largest Diameter
			A	B	C
1/4	4050-2P	.250-18 NPTF	2.18	0.88	1.06
1/4	4050-2P-T8M	.750-16 ORB (Male)	1.80	0.88	1.06
1/4	4050-T6	.562-18 ORB	2.18	0.88	1.06
1/4	4050P-T6**	.562-18 ORB	2.43	0.81	1.33
3/8	4050-3P	.375-18 NPTF	2.31	0.94	1.33
1/2	4050-4	.500-14 NPTF	2.60	1.06	1.52
1/2	4050-4P	.500-14 NPTF	2.60	1.06	1.52
1/2	4050-5	.750-14 NPTF	2.69	1.13	1.52
1/2	4050-5P	.750-14 NPTF	2.69	1.13	1.52
1/2	4050-15	.750-16 ORB	2.81	1.06	1.52
1/2	4050-15P	.750-16 ORB	2.81	1.06	1.52
1/2	4050-16	.875-14 ORB	2.75	1.06	1.52
1/2	4050-16P	.875-14 ORB	2.75	1.06	1.52
1/2	4050-29	.500-14 BSPP	2.68	1.06	1.52
3/4	4150-5	.750-14 NPTF	3.50	1.38	1.90
1	4050-6P	1.000-11.5 NPTF	3.84	1.63	2.08

* P in part number designates Poppet design ** Push-to-Connect design.

Nipples

Female Thread

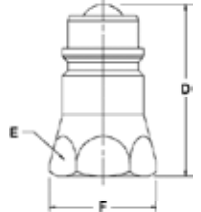
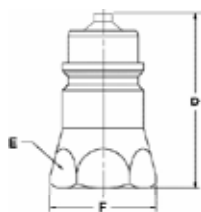

Body Size (in.)	Part Number*	Thread Size	Dimensions (inches)		
			Overall Length	Hex Size	Largest Diameter
			D	E	F
1/4	4010-2P	.250-18 NPTF	1.39	0.75	0.87
1/4	4010-T6	.562-18 ORB	1.49	0.75	0.87
3/8	4010-3P	.375-18 NPTF	1.50	0.94	1.08
1/2	8010-4	.500-14 NPTF	1.95	1.06	1.23
1/2	8010-4P	.500-14 NPTF	1.95	1.06	1.23
1/2	8010-5	.750-14 NPTF	2.14	1.25	1.44
1/2	8010-5P	.750-14 NPTF	2.14	1.25	1.44
1/2	8010-15	.750-16 ORB	2.06	1.06	1.23
1/2	8010-15P	.750-16 ORB	2.06	1.06	1.23
1/2	8010-16	.875-14 ORB	2.05	1.06	1.23
1/2	8010-16P	.875-14 ORB	2.05	1.06	1.23
1/2	8010-29	.500-14 BSPP	1.95	1.06	1.18
3/4	4110-5	.750-14 NPTF	1.81	1.31	1.52
1	4010-6P	1.000-11.5 NPTF	2.79	1.63	1.88

* P in part number designates Poppet design; without P designates ball valve

Nipples

(Connect-Under-Pressure)

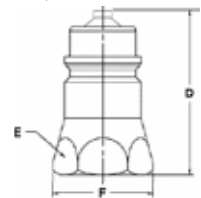

Body Size (in.)	Part Number*	Thread Size	Dimensions (inches)		
			Overall Length	Hex Size	Largest Diameter
			D	E	F
1/2	8010-4P-DC	.500-14 NPTF	1.80	1.06	1.16
1/2	8010-15P-DC	.750-14 ORB	1.80	1.06	1.16

* P in part number designates Poppet design; without P designates ball valve

Dust Plugs & Caps

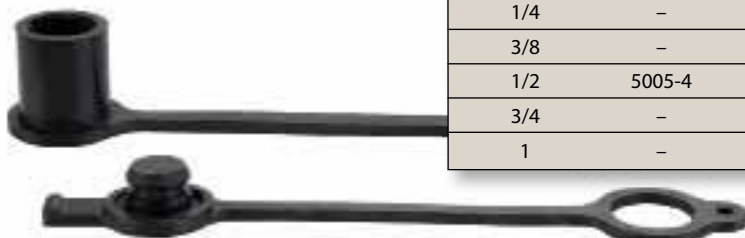

Body Size (in.)	Dust Plug Part No.	Dust Plug Part No.	Dust Cap Part No.	Dust Cap Part No.
1/4	-	5205-2M	-	5209-2M
3/8	-	5205-3M	-	5209-3M
1/2	5005-4	5205-4M	5509-4	5209-4M
3/4	-	5205-5M	-	5209-5M
1	-	5205-6M	-	5209-6M

4200 Series

General Purpose Quick Couplings

The 4200 Series is a double shut-off coupler designed for bracket mounted break-away applications. This series features a rugged double acting sleeve, which when bracket mounted allows easy one handed push/pull operation.

It is available in either a ball or poppet valve design. Critical parts are induction hardened for durability and for a long service life. A dependable ball locking mechanism reduces hose twisting.

These couplers are the ideal choice for industrial, agricultural, mobile and other demanding breakaway applications.

- Flows rated from 6 to 12 GPM
- Rated to 3000 PSI for all sizes
- Available in 3/8" & 1/2"
- Temperature range: -40 to +250° F
- Double Acting Sleeve
- Nitrile (Buna N) Seals
- Requires clamp mounting



Specifications

Body Size (in.)	3/8	1/2
Rated Pressure (PSI)	3000	3000
Rated Flow (GPM)	6	12

Performance

4200 Series (3/8" & 1/2")
Test Fluid: Oil - 200 SUS

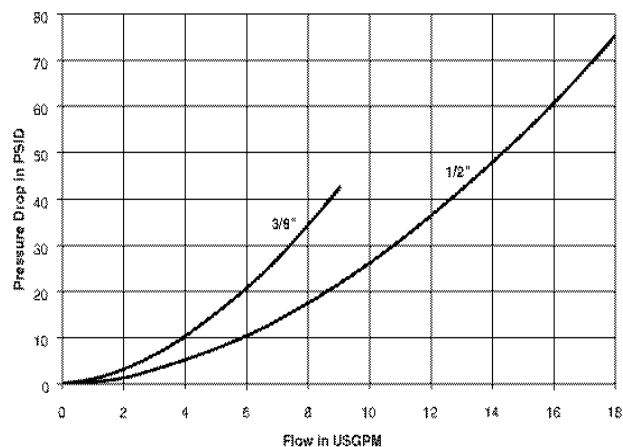

4200 Series

General Purpose Quick Couplings

Couplers

Female Thread

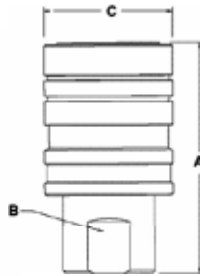

Body Size (in.)	Part Number*	Thread Size	Dimensions (inches)		
			Overall Length	Wrench Flats	Largest Diameter
			A	B	C
3/8	4250-3P	.375-18 NPTF	2.31	0.81	1.31
1/2	4250-4	.500-14 NPTF	2.68	0.94	1.50
1/2	4250-4P	.500-14 NPTF	2.68	0.94	1.50
1/2	4250-15	.750-16 ORB	2.68	0.94	1.50
1/2	4250-15P	.750-16 ORB	2.68	0.94	1.50

* P in part number designates Poppet design

Nipples

Female Thread

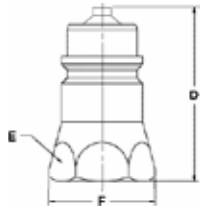

Body Size (in.)	Part Number*	Thread Size	Dimensions (inches)		
			Overall Length	Hex Size	Largest Diameter
			D	E	F
3/8	4010-3P	.375-18 NPTF	1.60	0.94	1.31
1/2	8010-4	.500-14 NPTF	1.95	1.06	1.23
1/2	8010-4P	.500-14 NPTF	1.95	1.06	1.23
1/2	8010-15	.750-16 ORB	2.06	1.06	1.23
1/2	8010-15P	.750-16 ORB	2.06	1.06	1.23

* P in part number designates Poppet design; without P designates ball valve

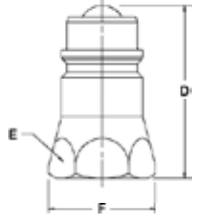

Nipples

(Connect-Under-Pressure)

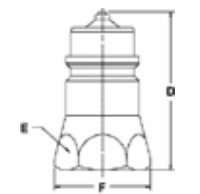

Body Size (in.)	Part Number*	Thread Size	Dimensions (inches)		
			Overall Length	Hex Size	Largest Diameter
			D	E	F
1/2	8010-4P-DC	.500-14 NPTF	1.80	1.06	1.16
1/2	8010-15P-DC	.750-14 ORB	1.80	1.06	1.16

Dust Plugs & Caps

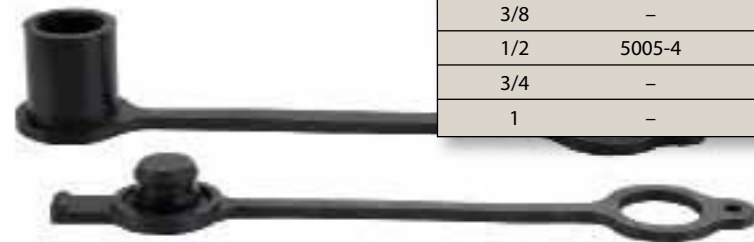

Body Size (in.)	Dust Plug Part No.	Dust Plug Part No.	Dust Cap Part No.	Dust Cap Part No.
	Steel	Rubber	Steel	Rubber
1/4	–	5205-2M	–	5209-2M
3/8	–	5205-3M	–	5209-3M
1/2	5005-4	5205-4M	5509-4	5209-4M
3/4	–	5205-5M	–	5209-5M
1	–	5205-6M	–	5209-6M

- construction and agricultural equipment
- skid steer loaders, mini excavators, hydraulic attachments
- utility vehicles
- fork lifts, aerial lifts

FEM Series

Non-Spill Quick Couplings

Parker FEM Series couplings are manufactured to meet the stringent design and pressure requirements of ISO 16028. The FEM two-piece modular design also facilitates a wide variety of port options. As with all Parker non-spill designs, the flush-face valving virtually eliminates hydraulic spillage and limits air inclusion upon connection. The FEM Series is ideal for applications where global interchangeability is important.

- ISO 16028 global standard
- Steel construction
- Sizes: 1/4" to 1"
- Rated pressure up to 4568 PSI (315 bar)
- Temperature range: -40 to +250° F
- Standard seal material is nitrile
- Port configurations: NPTF & UNF



Specifications

Body Size (in.)	1/4	3/8	1/2	5/8	3/4	1
Rated Pressure (PSI)	4568	3625	3625	3625	3625	2900
Rated Flow (GPM)	3	6	12	20	26	50
Temperature Range (std.seals)	-40 to +250° F					
Spillage (ML) (max. per disconnect)	0.015	0.015	0.020	0.030	0.150	0.200
Air Inclusion (ML) (max. per connect)	0.020	0.020	0.070	0.070	0.100	0.150

Performance

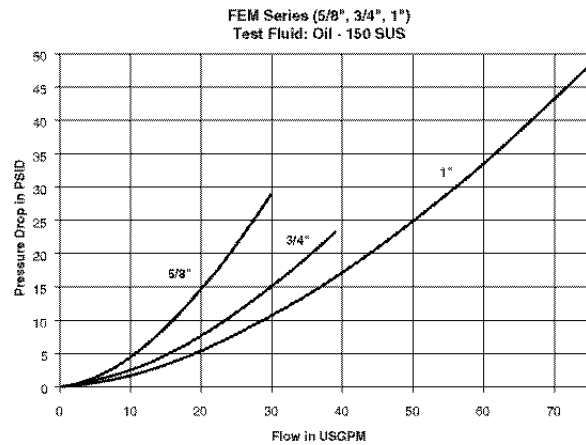
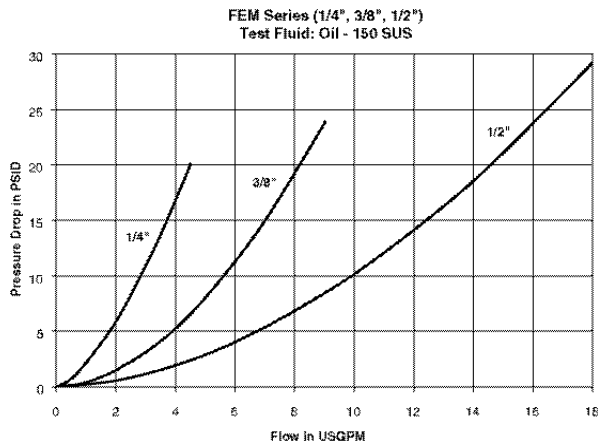

FEM Series

Non-Spill Quick Couplings

Couplers



Body Size (in.)	Part Number	Thread Size	Dimensions (inches)		
			Overall Length	Hex Size	Largest Diameter
			A	B	C
1/4	FEM-251-4FP-NL	.250-18 NPSF	1.96	1.00	1.06
1/4	FEM-251-6FO-NL	.562-18 UNF	2.08	1.00	1.06
3/8	FEM-371-6FP-NL	.375-18 NPSF	2.89	1.06	1.19
3/8	FEM-371-8FO-NL	.750-16 UNF	2.89	1.06	1.19
1/2	FEM-501-8FP-NL	.500-14 NPSF	3.04	1.06	1.19
1/2	FEM-501-10BMS-NL	1.000-14 UNS	4.02	1.38	1.58
1/2	FEM-501-10BMF-NL	.875-14 UNF	4.03	1.38	1.58
1/2	FEM-501-10FO-NL	.875-14 UNF	3.04	1.25	1.58
1/2	FEM-501-12FO-NL	1.062-12 UN	3.24	1.38	1.58
5/8	FEM-621-12FO-NL	1.062-12 UNF	3.70	1.50	1.70
3/4	FEM-751-12FP-NL	.750-14 NPSF	3.95	1.75	1.95
3/4	FEM-751-12FO-NL	1.062-12 UNF	3.95	1.75	1.95
1	FEM-1001-16FP-NL	1.000-11.5 NPSF	4.21	2.00	2.25
1	FEM-1001-16FO-NL	1.312-12 UNF	4.21	2.00	2.25

Nipples



Body Size (in.)	Part Number	Thread Size	Dimensions (inches)		
			Overall Length	Hex Size	Largest Diameter
			D	E	F
1/4	FEM-252-4FP	.250-18 NPSF	1.71	1.00	1.06
3/8	FEM-372-6FP	.375-18 NPSF	2.48	1.06	1.16
3/8	FEM-372-8FO	.750-16 UNF	2.48	1.06	1.16
1/2	FEM-502-8FP	.500-14 NPSF	2.85	1.38	1.50
1/2	FEM-502-10FO	.875-14 UNF	2.85	1.38	1.50
1/2	FEM-502-10BMS	1.000-14 UNS	3.84	1.38	1.50
1/2	FEM-502-10BMF	.875-14 UNF	3.85	1.38	1.50
1/2	FEM-502-12FO	1.062-12 UN	3.05	1.38	1.50
5/8	FEM-622-12FO	1.062-12 UN	3.09	1.50	1.65
3/4	FEM-752-12FP	.750-14 NPSF	3.38	1.75	1.94
3/4	FEM-752-12FO	1.062-12 UN	3.38	1.75	1.94
1	FEM-1002-16FP	1.000-11.5 NPSF	3.85	2.00	2.25
1	FEM-1002-16FO	1.312-12 UN	3.85	2.00	2.25

Dust Plugs & Caps

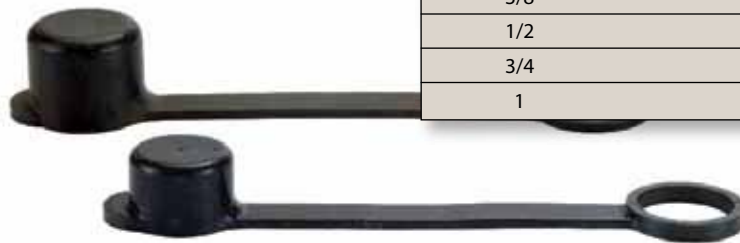

Body Size (in.)	Dust Plug Part No.	Dust Cap Part No.
	Rubber	Rubber
1/4	FR-25	FR-25
3/8	NR-50	NR-37
1/2	FR-501	FR-502
3/4	FR-751	FR-752
1	FR-1001	

Standard Port Configurations

FP - Female Pipe Thread
 FO - Female Straight Thread
 BMF - Bulkhead Male Flare 37° JIC
 BMS - Bulkhead Male Seal-Iok
 Other fitting port configurations available upon request.

- construction and agricultural equipment
- skid steer loaders, mini excavators, hydraulic attachments
- utility vehicles
- fork lifts, aerial lifts

IF Series

Non-Spill Connect Under Pressure Quick Couplings

The IF Series Pressure Eliminator complements our standard FEM Series product offering. This series meets the ISO 16028 specifications, while providing a connect-under-pressure feature.

The unique integrated Pressure Eliminator valve makes it possible to complete a connection under residual pressure up to 2900 PSI.

- ISO 16028
- Steel construction
- Sizes from 1/4" to 1"
- Pressure rated up to 4630 PSI
- Temperature range: -40 to +250° F
- Standard seal material is nitrile
- Port configurations: NPTF, UNF & BSPP
- Sleeve lock is standard



Specifications

Body Size (in.)	1/4	3/8	1/2	5/8	3/4	1
Rated Pressure (PSI)	4630	3675	3675	3675	3675	2940
Rated Flow (GPM)	3	6	12	20	26	50
Temperature Range (std.seals)	-40 to +250° F					
Spillage (ML) (max. per disconnect)	0.015	0.015	0.020	0.030	0.150	0.200
Air Inclusion (ML) (max. per connect)	0.020	0.020	0.070	0.070	0.100	0.150

IF Series (1/4")

Viscosity for 32cSt at 104°F as per ISO 7241/2-2000

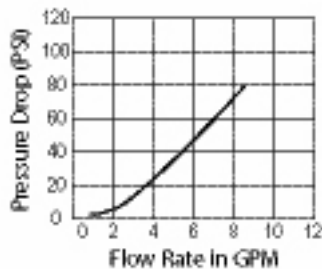

IF Series (3/8")

Viscosity for 32cSt at 104°F as per ISO 7241/2-2000

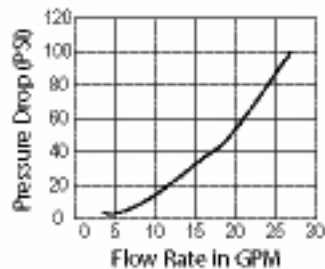

IF Series (1/2")

Viscosity for 32cSt at 104°F as per ISO 7241/2-2000

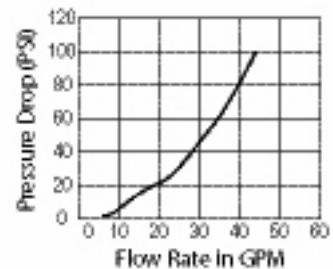

IF Series

Non-Spill Connect Under Pressure Quick Couplings

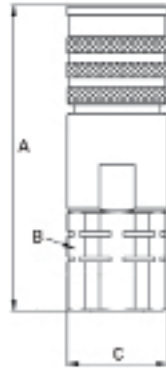

Body Size (in.)	Part Number*	Thread Size	Dimensions (inches)		
			Overall Length	Hex Size	Largest Diameter
			A	B	C
1/4	IF2511N	1/4 - 18 NPTF	3.58	1.06	1.16
1/4	IF2511	G1/4 (BSPP)	3.58	1.06	1.16
1/4	IF2511U	9/16 - 18 UNF	3.58	1.06	1.16
3/8	IF3811N	3/8 - 18 NPTF	3.90	1.18	1.26
3/8	IF3811	G 3/8 IG (BSPP)	3.90	1.18	1.26
3/8	IF3811U	3/4 - 16 UNF	4.00	1.18	1.26
1/2	IF5011N	1/2 - 14 NPTF	4.55	1.57	1.69
1/2	IF5011	G 1/2 (BSPP)	4.41	1.57	1.69
1/2	IF5011U	7/8 - 14 UNF	4.51	1.57	1.69
5/8	IF6311	G 3/4 (BSPP)	4.61	1.57	1.69
3/4	IF7511N	3/4 - 14 NPTF	5.17	1.97	2.12
3/4	IF7511	G 3/4 (BSPP)	5.11	1.97	2.12
3/4	IF7511U	1-1/16 - 12 UNF	5.27	1.97	2.12
1	IF10011N	1 - 11.5 NPTF	5.66	2.16	2.36
1	IF10011	G 1 (BSPP)	5.63	2.16	2.36

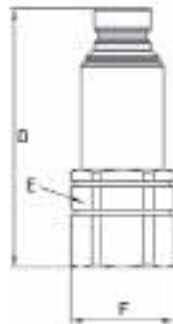

Body Size (in.)	Part Number*	Thread Size	Dimensions (inches)		
			Overall Length	Hex Size	Largest Diameter
			A	B	C
1/4	IF2521N	1/4 - 18 NPTF	2.91	1.06	1.16
1/4	IF2521	G 1/4 (BSPP)	2.91	1.06	1.16
1/4	IF2521U	9/16 - 18 UNF	2.91	1.06	1.16
3/8	IF3821N	3/8 - 18 NPTF	3.42	1.18	1.26
3/8	IF3821	G 3/8 IG (BSPP)	3.42	1.18	1.26
3/8	IF3821U	3/4 - 16 UNF	3.54	1.18	1.26
1/2	IF5021N	1/2 - 14 NPTF	4.00	1.57	1.69
1/2	IF5021	G 1/2 (BSPP)	3.86	1.57	1.69
1/2	IF5021U	7/8 - 14 UNF	3.96	1.57	1.69
5/8	IF6321	G 3/4 (BSPP)	3.98	1.57	1.69
5/8	IF6321U	1-1/16 - 12 UNF	4.17	1.57	1.69
3/4	IF7521N	3/4 - 14 NPTF	4.53	1.97	2.12
3/4	IF7521	G 3/4 (BSPP)	4.49	1.97	2.12
3/4	IF7521U	1-1/16 - 12 UNF	4.63	1.97	2.12
1	IF10021N	1 - 11.5 NPTF	5.01	2.16	2.36
1	IF10021	G 1 (BSPP)	4.96	2.16	2.36
1	IF10021U	1-5/16 - 12 UNF	5.01	2.16	2.36

IF Series (5/8")

Viscosity for 32cSt at 104°F as per ISO 7241/2-2000

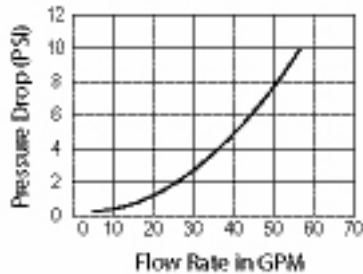

IF Series (3/4")

Viscosity for 32cSt at 104°F as per ISO 7241/2-2000

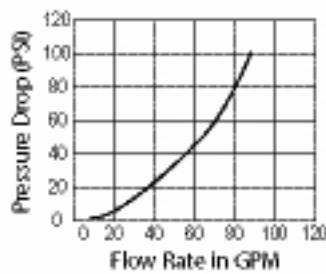

IF Series (1")

Viscosity for 32cSt at 104°F as per ISO 7241/2-2000

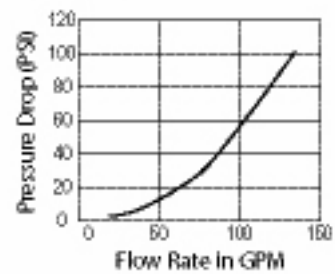

- truck and off-highway
- mobile cooling systems
- industrial and injection mold cooling

FA Series

Non-Spill Aluminum Quick Couplings

Parker FA couplings are designed to be a lightweight, corrosion resistant alternative to our traditional non-spill couplers.

The simple push-to-connect operation is quick and saves valuable time when mating fluid lines. As with all Parker flush-face designs, the non-spill feature eliminates fluid spillage and minimizes air inclusion when connecting or disconnecting the couplings. FA Series' modular design enables wide variations in fitting options to meet each customer's needs.

Parker's FA Series is ideal for use wherever lightweight construction and high corrosion resistance are needed.



- **Lightweight, corrosion-resistant aluminum construction (up to 60% lighter than comparable steel couplings)**
- **Modular two-piece design allows for a wide variety of end configurations**
- **Flush face valving with positive stop to prevent flow checking**
- **Suitable for both pressure and vacuum applications**
- **Smooth flow path with low pressure drop**
- **Anodized coating provides a hard surface and color options to help identify mating lines or seal materials (consult QCD for availability)**

Specifications

Size	Rated Operating Pressure		Rated Flow		Pressure Drop @ Rated Flow	
	Bar	PSI	L/min	GPM	Bar	PSI
1/4	137.9	1000	12	3	0.82	12.0
3/8	137.9	1000	23	6	1.15	16.7
1/2	137.9	1000	45	12	1.25	18.1
5/8	137.9	1000	72	19	1.00	14.5
3/4	137.9	1000	98	26	1.09	16.0
1	68.9	1000	189	50	1.30	18.8

Performance

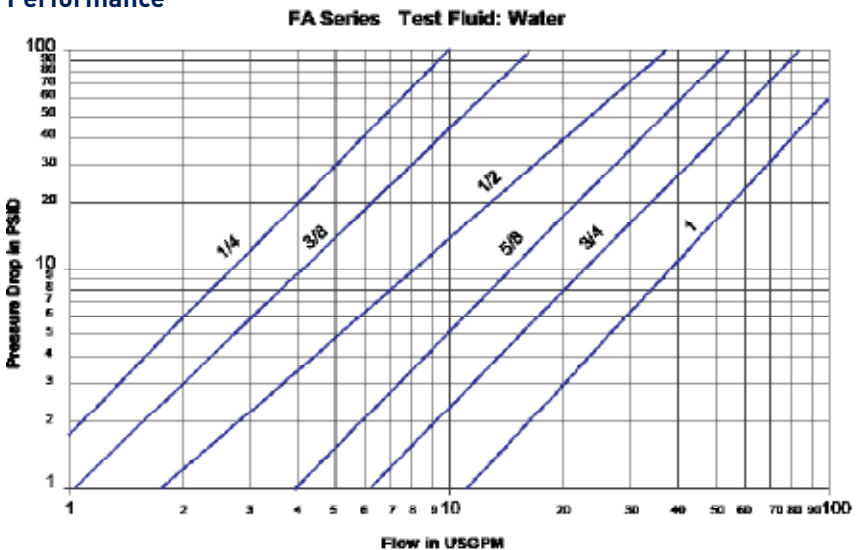

FA Series

Non-Spill Aluminum Quick Couplings

Couplers

Female Thread

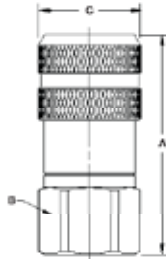

Body Size (in.)	Part Number*	Thread Size	Dimensions (inches)		
			Overall Length	Hex Size	Largest Diameter
			A	B	C
1/4	FA-251-4FP	.250-18 NPSF	1.78	1.00	1.06
3/8	FA-371-6FP	.375-18 NPSF	2.83	1.06	1.30
3/8	FA-371-6FO	.562-18 UNF	2.83	1.06	1.30
1/2	FA-501-8FP	.500-14 NPSF	2.87	1.38	1.50
1/2	FA-501-8FO	.750-16 UNF	2.87	1.38	1.50
5/8	FA-621-10FO	.875-14 UNF	3.62	1.50	1.63
3/4	FA-751-12FO	1.062-12 UN	4.20	1.75	1.94
1	FA-1001-16FP	1.000-11.5 NPSF	4.68	1.87	2.23
1	FA-1001-16FO	1.312-12 UN	4.68	1.87	2.23

Nipples

Female Thread

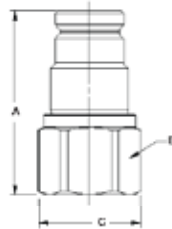

Body Size (in.)	Part Number*	Thread Size	Dimensions (inches)		
			Overall Length	Hex Size	Largest Diameter
			A	B	C
1/4	FA-252-4FP	.250-18 NPSF	1.78	1.00	1.06
3/8	FA-372-6FP	.375-18 NPSF	2.55	1.06	1.16
3/8	FA-372-6FO	.562-18 UNF	2.55	1.06	1.16
1/2	FA-502-8FP	.500-14 NPSF	3.06	1.38	1.58
1/2	FA-502-8FO	.750-16 UNF	3.06	1.38	1.58
5/8	FA-622-10FO	.875-14 UNF	3.09	1.50	1.63
3/4	FA-752-12FO	1.062-12 UN	3.51	1.75	1.87
1	FA-1002-16FP	1.000-11.5 NPSF	3.73	1.87	2.06
1	FA-1002-16FO	1.312-12 UN	3.73	1.87	2.06

Dust Plugs & Caps



Body Size (in.)	Dust Plug Part No.	Dust Cap Part No.
	Rubber	Rubber
1/4	FR-25	FR-25
3/8	NR-50	NR-37
1/2	FR-501	FR-502
3/4	FR-751	FR-752
1	FR-1001	

Materials of Construction:

Body	Aluminum with blue anodize coating
Valve	Aluminum with blue anodize coating
Seals	Fluorocarbon (standard) other options are available
Backup Washers	PTFE
Springs	Stainless steel
Lock Rings	Stainless steel
Locking Balls	Stainless steel

- chemical transfer
- bulk tank transfer
- water systems

PF Series

Non-Spill, Thermoplastic, Chemical Transfer Couplings

These Dry Disconnect couplings virtually eliminate fluid loss upon disconnection and are designed to help meet the demand for closed system transfer and dispensing of chemicals and fluids with minimal environmental contamination. They can be used with concentrated or diluted industrial chemicals, fertilizers, herbicides, insecticides, fungicides or pesticides when transferring from bulk storage tanks, returnable containers, applicators, etc.

The PF Series 2" body size is ideal for large bulk transfer of fluids and eliminating fluid spillage when connecting and disconnecting.

- **Rugged Glass filled Polypropylene construction for chemical compatibility and reduced cost**
- **Push-to-connect design**
- **Flush face valves exhibit minimal spillage upon connect or disconnect and air inclusion on connect, and enables ease of cleaning**
- **PTFE coated Fluorocarbon tank gasket for improved chemical compatibility**
- **1" coupler has non-wetted springs**



Performance

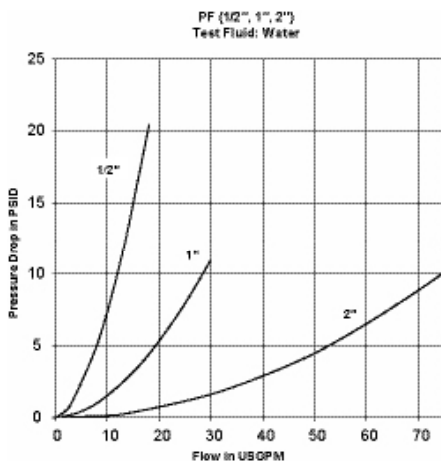

Specifications

Body Size	1/2"	1"	2"
Materials:			
Body		Polypropylene	
Springs		316 Stainless Steel	
Seals		Fluorocarbon*	
Rated Pressure (at 68° F)	100 PSI	60 PSI	100 PSI
Rated Flow	12 GPM	20 GPM	50 GPM
Pressure Drop at Rated Flow	11.3 PSI	3.4 PSI	4 PSI
Force to Connect	32 lbs.	41 lbs.	54 lbs.
Force to Disconnect	12 lbs.	17 lbs.	17 lbs.
Operating Temp.	+40°F to +140°F		
Storage Temp.	-20°F to +140°F		
Maximum Spillage per Disconnect	0.14 ml .01 cu. in.	1 ml .06 cu. in. (1 cc)	9 ml .5 cu. in.
Vacuum Rating	27.4 Hg	Contact Factory	Contact Factory

* Also available in EPDM, Nitrile, Neoprene, Perfluoroelastomer

PF Series

Non-Spill, Thermoplastic, Chemical Transfer Couplings

Couplers Female Thread

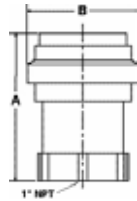

Body Size (in.)	Part Number	Port* Thread	Dimensions (inches)		
			Overall Length	Largest Diameter	Wrench Flats
			A	B	
1/2	PF-501-8FP	1/2" NPT	3.02	1.88	1.38
1	PF-1001-16FP	1" NPT	3.99	3.00	1.99
2	PF-2001-32FP	2" NPT	6.63	5.00	

* Female NPT Threads standard. For other port options, contact Division.

Nipples Female Thread

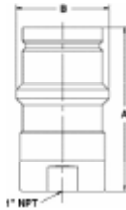

Body Size (in.)	Part Number	Port* Thread	Tank Mount Thread	Dimensions (inches)		
				Overall Length	Largest Diameter	Wrench Flats
				A	B	
1/2	PF-502-8FP	1/2" NPT	None	2.96	1.33	1.24
1	PF-1002-16FP	1" NPT	None	3.92	2.20	1.87
2	PF-2002-32FP	2" NPT	None	5.71	3.55	

* Female NPT Threads standard. For other port options, contact Division.

Nipples - Tank Mount Female Thread

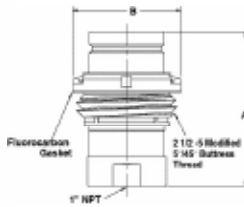

Body Size (in.)	Part Number	Port* Thread	Tank Mount Thread	Dimensions (inches)		
				Overall Length	Largest Diameter	Wrench Flats
				A	B	
1	PF-1002-32MB	1" NPT	Modified Buttress	3.92	2.75	1.87

* Female NPT Threads standard. For other port options, contact Division.

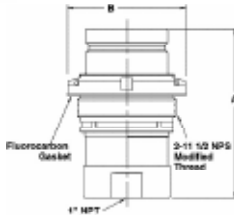

Body Size (in.)	Part Number	Port* Thread	Tank Mount Thread	Dimensions (inches)		
				Overall Length	Largest Diameter	Wrench Flats
				A	B	
1	PF-1002-32MP	1" NPT	Modified NPS	3.92	2.75	1.87

* Female NPT Threads standard. For other port options, contact Division.

Dust Plugs & Caps



Body Size (in.)	Coupler Dust Cap Part No.	Nipple Dust Cap Part No.	Material
1/2	FR-501	FR-502	Synthetic Rubber
1	-	PFR-1002	Ethylene Propylene
1	-	PFR-1002-NS*	Ethylene Propylene

* For use with Tank Mount Nipples

8200 Series

Connect Under Pressure Quick Couplings

The 8200 Series is a double shut-off, connect-under-pressure coupler designed for bracket mounted break-away applications. The valve design permits connection while the coupler, nipple, or both are under pressure.

This series features a rugged double acting sleeve, that when bracket mounted will allow easy one handed push/pull operation. The 8200 Series couplers will connect with all ISO-5675 male tips.

These couplers are the ideal choice for industrial, agricultural, mobile and other demanding break-away applications.

- Connects with ISO 5675 Tips
- Connect under pressure (both sides)
- Temperature range: -40 to +212° F
- Rated to 3000 PSI for all sizes
- 1/2" body size only
- Double Acting Sleeve
- Nitrile (Buna N) Seals
- Requires clamp mounting



Specifications

Body Size (in.)	1/2
Rated Pressure (PSI)	3000
Rated Flow (GPM)	12

Performance

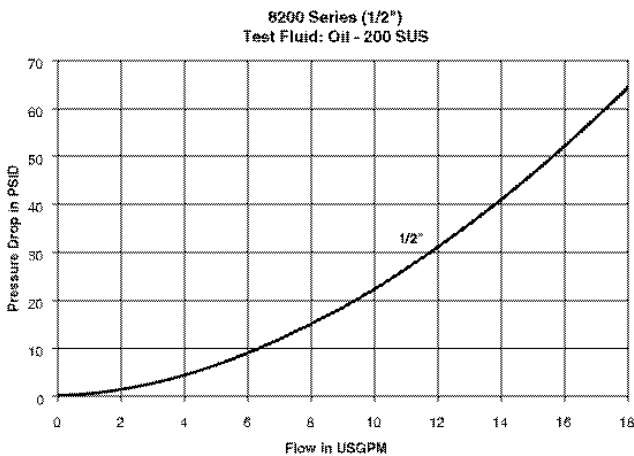

8200 Series

Connect Under Pressure Quick Couplings

Couplers

Female Thread



Body Size (in.)	Part Number*	Thread Size	Dimensions (inches)		
			Overall Length	Wrench Flats	Largest Diameter
			A	B	C
1/2	8250-4	.500-14 NPTF	3.29	0.87	1.50
1/2	8250-15	.750-16 ORB	3.29	0.87	1.50
1/2	8250-16	.875-14 ORB	3.29	0.87	1.50

Nipples

Female Thread



Body Size (in.)	Part Number*	Thread Size	Dimensions (inches)		
			Overall Length	Hex Size	Largest Diameter
			D	E	F
1/2	8010-4	.500-14 NPTF	1.95	1.06	1.23
1/2	8010-4P	.500-14 NPTF	1.95	1.06	1.23
1/2	8010-15	.750-16 ORB	2.06	1.06	1.23
1/2	8010-15P	.750-16 ORB	2.06	1.06	1.23
1/2	8010-16	.875-14 ORB	2.05	1.06	1.23
1/2	8010-16P	.875-14 ORB	2.05	1.06	1.23

* P in part number designates Poppet design; without P designates ball valve

Nipples

(Connect-Under-Pressure)



Body Size (in.)	Part Number*	Thread Size	Dimensions (inches)		
			Overall Length	Hex Size	Largest Diameter
			D	E	F
1/2	8010-4P-DC	.500-14 NPTF	1.80	1.06	1.16
1/2	8010-15P-DC	.750-14 ORB	1.80	1.06	1.16

* P in part number designates Poppet design; without P designates ball valve

Dust Plugs & Caps

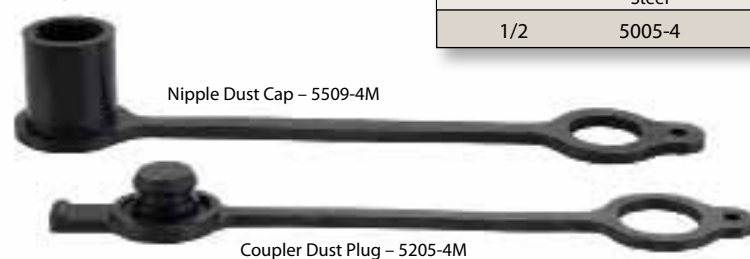

Nipple Dust Cap – 5509-4M

Coupler Dust Plug – 5205-4M

Body Size (in.)	Dust Plug Part No.	Dust Plug Part No.	Dust Cap Part No.	Dust Cap Part No.
	Steel	Rubber	Steel	Rubber
1/2	5005-4	5205-4M	5509-4	5209-4M

Steel Dust Cap and Dust Plug not shown