



ROGATOR

RG900C / RG1100C / RG1300C

Parts and Service Guide

ROGATOR Specifications

MODELS	RG900C	RG1100C	RG1300C
SYSTEMS			
Combo chassis	Yes	Yes	Yes
Std. volume liquid system	186 gpm	186 gpm	186 gpm
High volume liquid system	N/A	299 gpm	299 gpm
LiquidLogic liquid management	FlowLogic recirculating boom; NozzleLogic™ at-nozzle shut-off; OptiLoad™ level sensor, keypad w/ display and in-terminal readout; OptiMotion™ auto-scaled agitation; Opt. ClearFlow™ boom clean out/recovery		
Booms – ft. (m)	90/100/120 (27.4/30.5/36.6) Std.: stainless steel recirculating plumbing 120/132 (36.6/40.2) aluminum boom with stainless steel recirculating plumbing for 20 in. (.5 m) spacing		
Dry Systems – ft. ³ (m ³)	New Leader® Edge spinner 258 (7.3), MultiApplier Ready or MultiApplier Complete		AirMax 180 w/ or w/o granular; New Leader Edge spinner 258 (7.3) or 299 (8.5), MultiApplier Ready or MultiApplier Complete
WEIGHTS*			
Weights (full fuel) – lbs. (kg.)	27,850 (12,633) 90 ft. steel booms	28,390 (12,878) 120 ft. steel booms	31,890 (14,465) 120 ft. steel booms
FLUID CAPACITIES			
Fuel – U.S. gal. (L)	150 (567)		
BRAKES			
Primary	Hydrostatic dynamic braking		
ENGINE			
Make	AGCO Power™	AGCO Power	AGCO Power
Number of cylinders	6	6	6
HP @ 2,100 RPM (kW)	280 (209)	315 (235)	339 (253)

*Specifications are manufacturer's estimates at time of publication and are subject to change without prior notification. Actual weight will vary depending on optional equipment.

ROGATOR Parts List

ITEM	PART NUMBER	QTY	DESCRIPTION	TECHNICAL SPECIFICATION
1	V837091129	1	Fuel Filter Kit	
2	567588D1	1	Air Filter Element	
3	72437627	1	Safety Cartridge	
4	556654D1K	1	Carbon Filter Element	
5	556653D1	1	Cab Filter	
6	AG718281	1	Air Filter Element	Particle
7	AG121778	1	Hydraulic Tank Filter Breather	
8	AG133231	1	Oil Filter Element	
9	563588D1	2	Hydraulic Filter Element	
10	V836679586	1	Engine Oil Filter	RG900C
	V837074523	1		RG1100C / RG1300C
11	V837091530	1	Def Filter	
12	588347D1	1	Serpentine Belt – Severe Duty Fan and Alternator	Severe Duty
	564691D1	1	Belt – A/C and Water Pump	1366mm
13	557871D1	1	Fuel Filter Element	60 micron

TO ORDER:

Call or visit your nearest Ziegler location. Visit www.zieglercat.com/locations for a directory.

ROGATOR Machine Diagram

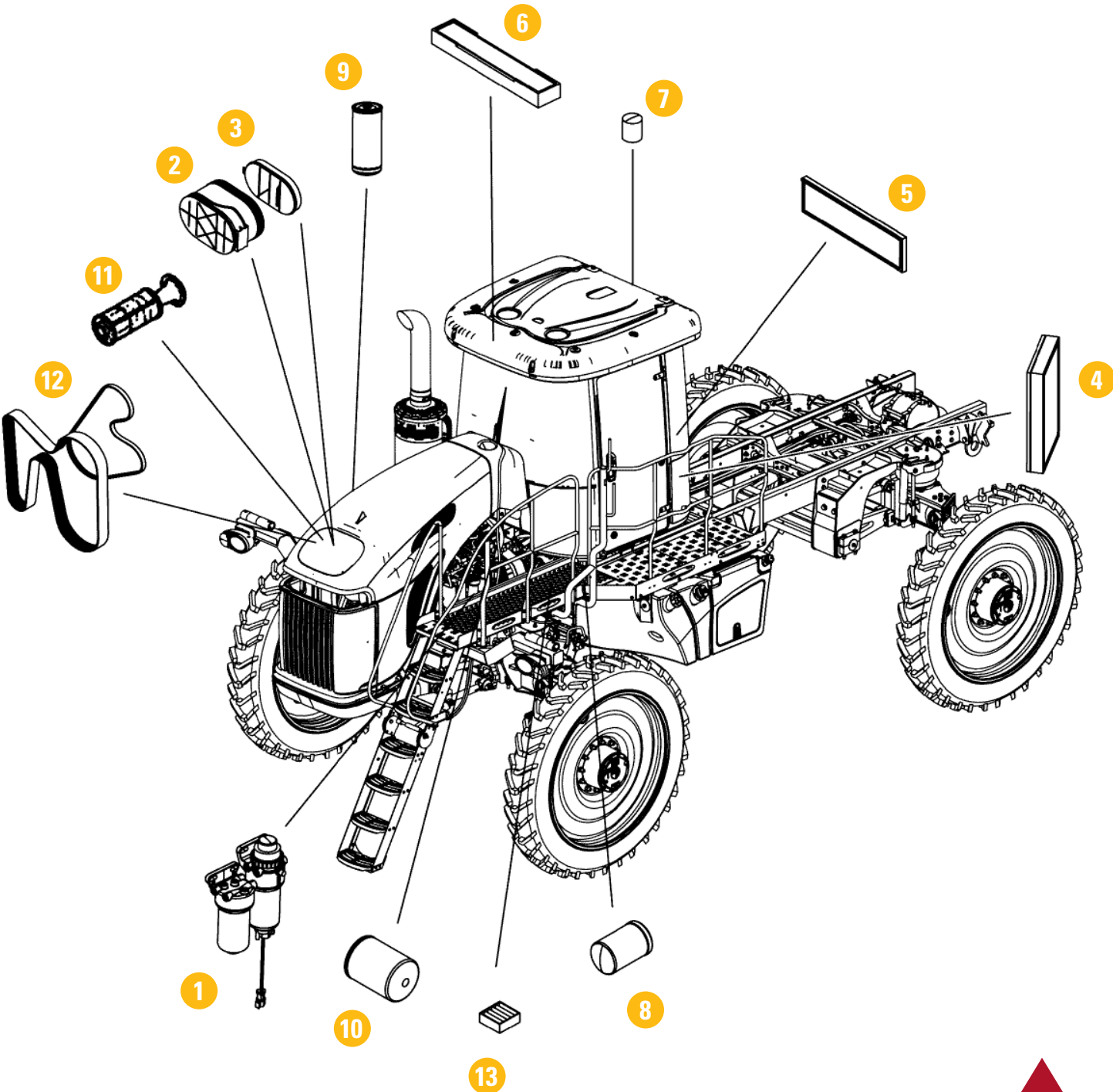

ROGATOR C Service Guide

SERVICE ITEMS	VALID FOR	INITIAL		EVERY									PARTS & LUBRICANTS		
		Initial 50	Initial 100	100	250	400	500	800	1000	1200	Annual	Comprehensive	Part # / Charge Code	Qty	Description
Check tightness of fuel tank bolts		X	X	X	X	X	X	X	X	X		X			
Check hydraulic system for leaks		X	X	X	X	X	X	X	X	X		X			
Clean battery cables		X	X	X	X	X	X	X	X	X		X			
Inspect and adjust outer axle shims		X			X		X		X			X			
Check tightness wheel drive gearbox mounting bolts		X					X		X			X			
Tighten wheel mounting bolts		X					X		X			X			
Replace pressure washer pump oil (if equipped)		X					X		X			X			
Inspect engine belts		X	X	X		X	X	X	X	X		X			
Change fuel filter and prefilter	RG900C								X		X	X	V837091129	1	Fuel Filter Kit
	RG1100C/ RG1300C							X			X	X	V837091129	1	Fuel Filter Kit
Change additional fuel water separator filter (if equipped)	RG900C	X							X			X	557871D1	1	Fuel Filter Element
	RG1100C/ RG1300C	X							X			X	557871D1	1	Fuel Filter Element
Adjust valve						X									
Clean cooling system from outside			X	X		X	X	X	X	X		X			
Check battery fluid level			X	X		X	X	X	X	X		X			
Check cab mounts			X	X		X	X	X	X	X		X			
Check tightness of torque arm bolts			X			X		X		X		X			
Replace hydraulic oil filters			X				X		X			X	AG133231 563588D1	1 2	Hydraulic filter Hydraulic filters
Replace gear box oil			X				X		X		X	X	79036525 79034596 SAMPLE	1 1 4	AGCO 75W-140 Syn – 1 qt AGCO 75W-140 Syn – 2.5 gal Gearbox oil samples
Remove bottom plug of fuel tanks and remove sediment					X		X		X			X			
Clean cab air filters					X		X		X						
Replace cab air filters										X		X	556654D1K AG718281 556653D1	1 1 1	Cab filter Cab filter Cab filter
Rotate tires						X		X		X		X			
Replace the engine oil and filter	RG900C						X		X			X	V836679586	1	Engine oil filter
	RG1100C/ RG1300C					X		X		X		X	V837074523 SAMPLE	1 6 1	Engine oil filter AGCO 15W-40 Multigard Engine oil sample
Change hydraulic tank breather							X		X			X	AG121778	1	Hydraulic tank breather
Replace hydraulic oil							X		X		X	X	SAMPLE	36 1	AGCO Permatran 821XL Hydraulic oil sample
Drain water out of fuel tank								X			X	X			
Replace pressure washer strainer (if equipped)									X		X	X			
Change high volume air dryer desiccant cartridge (if equipped)									X		X	X			
Replace both air cleaner elements										X		X	567588D1 72437627	1 1	Primary air filter Secondary air filter
Change SCR supply module main filter										X	X	X	V837091530	1	SCR filter

ROGATOR C Service Guide

SERVICE ITEMS	VALID FOR	EVERY					PARTS & LUBRICANTS		
		2000	2400	4000	4800	6000	Part # / Charge Code	Qty	Description
Check tightness of fuel tank bolts		X	X	X	X	X			
Check hydraulic system for leaks		X	X	X	X	X			
Clean battery cables		X	X	X	X	X			
Inspect and adjust outer axle shims		X		X		X			
Check tightness wheel drive gearbox mounting bolts		X		X		X			
Tighten wheel mounting bolts		X		X		X			
Replace pressure washer pump oil (if equipped)		X		X		X			
Inspect engine belts		X	X	X	X	X			
Change fuel filter and prefilter	RG900C	X		X		X	V837091129	1	Fuel Filter Kit
	RG1100C/ RG1300C		X	X	X		V837091129	1	Fuel Filter Kit
Change additional fuel water separator filter (if equipped)	RG900C	X		X		X	557871D1	1	Fuel Filter Element
	RG1100C/ RG1300C	X		X		X	557871D1	1	Fuel Filter Element
Adjust valve		X							
Clean cooling system from outside		X	X	X	X	X			
Check battery fluid level		X	X	X	X	X			
Check cab mounts		X	X	X	X	X			
Check tightness of torque arm bolts		X	X	X	X	X			
Replace hydraulic oil filters		X		X		X	AG133231 563588D1	1 2	Hydraulic filter Hydraulic filters
Replace gear box oil		X		X		X	79036525	1	AGCO 75W-140 Syn – 1 qt
							79034596	1	AGCO 75W-140 Syn – 2.5 gal
							SAMPLE	4	Gearbox oil samples
Remove bottom plug of fuel tanks and remove sediment		X		X		X			
Clean cab air filters		X		X		X			
Replace cab air filters			X		X	X	556654D1K	1	Cab filter
							AG718281	1	Cab filter
							556653D1	1	Cab filter
Rotate tires		X	X	X	X	X			
Replace the engine oil and filter	RG900C	X		X		X	V836679586	1	Engine oil filter
	RG1100C/ RG1300C	X	X	X	X	X	V837074523 SAMPLE	1 6 1	Engine oil filter AGCO 15W-40 Multigard Engine oil sample
Change hydraulic tank breather		X		X		X	AG121778	1	Hydraulic tank breather
Replace hydraulic oil		X		X		X	SAMPLE	36 1	AGCO Permatran 821XL Hydraulic oil sample
Drain water out of fuel tank			X	X	X				
Replace pressure washer strainer (if equipped)		X		X		X			
Change high volume air dryer desiccant cartridge (if equipped)		X		X		X			
Replace both air cleaner elements			X		X	X	567588D1	1	Primary air filter
							72437627	1	Secondary air filter
Change SCR supply module main filter			X		X	X	V837091530	1	SCR filter

LUBRICANTS					
Component	Oil Type/ Class	Viscosity	US GAL	# of components	Description
Chassis hydraulic reservoir	Permatran 821XL	10W-30	36 gal	1	AGCO Permatran 821XL
Engine coolant	50/50 Water & Ethylene Glycol w/o stop leak add.		6.7	1	Zerex premix
Engine oil	CJ-4	15W-40	6	1	AGCO 15W-40 Multigard
Grease		Multi-Purpose Lithium Base Grease, EP, NLGI #2			AGCO Moly EP Grease
Wheel drive gear boxes	GL-5	75W-140 syn	0.66/box, 2.64 total	4	AGCO Syn Gear Oil 75W-140 – 1 qt AGCO Syn Gear Oil 75W-140 – 2.5 gal
Pressure washer pump (if equipped)		30W Non Detergent	12 oz.	1	PROCURE LOCALLY