



42A02NW0074 63.4270 MCNEIL

Report Of Work Breakdown - pg. 1 of 2

I. MANUAL WORK-

Using hand stripping equipment, significant clearing of trees, and overburden stripping was completed over the following two showings:

- (1) Rogers Vein (See location on attached Drawing S-84-1)
- (2) Copeland Showing (same map as above)

This hand stripping was accomplished by the following individuals, on the dates noted below:

<u>INDIVIDUALS</u>	<u>DATES OF WORK</u>	<u>TOTAL DAYS</u>
Mr. Robert McGrath 701 Alanbrook St. London, Ont. N6J 3B5	July 9 to 16, 1984	8
Mr. Jack Copeland 500 Densmuir St. Vancouver, B.C.	Aug. 18 to 29, 1984	12
	Total	<u>20</u>

Total 20 Days x 12 hours = 240 ÷ 6 = 40 DAYS

-----  
II. POWER STRIPPING-

A. Stripping using a D7 and D6 LGP tractor, in the process of road construction. Stripping Locations are shown on the attached Drawing No. S-84-1.

B. Stripping of 6 trenches as shown on the attached Drawings S-84-2 and S-84-1.

<u>CONTRACTORS</u>	<u>DATES OF WORK</u>	<u>TOTAL \$ EXPENDED</u>
A. Leo Alarie & Sons Ltd. PO Box 130, Matheson, Ont.	July 3 to 11, 1984	1,646.50(1
B. John P. Larche 721 Churchill St. Timmins, Ont. P4N 5G4	August 7 to 12, 1984	3,904.10(1
	TOTAL	<u>5,550.60</u>

ie \$5,550.60 ÷ \$10 = 550 Days

-----

Report Of Work Breakdown - pg. 2 of 2

III. COMPRESSED AIR-Etc.

Using a Cobra Drill, the following trenches (as shown on Drawing S-84-2) were drilled and blasted. The trenches blasted are marked in red color, and this work was accomplished on the following dykes: EIGHT FOOT DYKE, SOUTH DYKE, and SCOTCH DYKE.

<u>INDIVIDUALS</u>	<u>DATES OF WORK</u>	<u>TOTAL DAYS</u>
Mr. Jack Copeland 500 Dunsmuir St. Vancouver, B.C.	Aug. 7 to 12 incl.	6
Mr. John Oliver 470 Granville St. Vancouver, B.C. V6B 1C5	" " "	6
	Total	<u>12</u>

12 Days x 12 hours = 144 ÷ 3 = 48 DAYS

SUMMARY OF TOTAL HOURS IN  
FOREGOING SECTIONS I, II, & III.

<u>HEADING</u>	<u>TOTAL DAYS</u>
I. MANUAL WORK	40
III. POWER STRIPPING	550
IV. COMPRESSED AIR	48
TOTAL	<u>638</u>

Applying these days to the 12 claims listed on the covering REPORT OF WORK form, a total of 53.1 days per claim is calculated (  $638 \div 12 = 53.1$  )

TELEPHONE  
703-264-2460

MAILING ADDRESS  
721 CHURCHILL ST.  
TIMMINS, ONTARIO  
P4N 5G4

**JOHN P. LARCHE**  
MINING EXPLORATION

August 16<sup>th</sup>, 1984

Mr. John H. Oliver  
President  
Argyle Ventures Inc.  
Penthouse Suite  
470 Granville Street  
Vancouver B.C. V6B 1C5

RE: Stripping and trenching on your property in McNeil township,  
using a backhoe mounted on a S model Bombardier Muskeg Tractor and  
support equipment, from August 7<sup>th</sup> to 12<sup>th</sup>.

*Stripping  
See 77(14)  
Delite -  
see mat 6  
5/23/84*

Backhoe including fuel, 350.00 per day, X 6 days = .....	\$2,100.00	#
Operator, 175.00 per day, X 6½ days = .....	1,137.50	
Water pump and hoses, 50.00 per day X 6 = .....	300.00	
Cobra plugger and steel, 50.00 per day X 6 = .....	300.00	
Truck and float, 95 miles at 1.15 per = .....	109.25	39c
Dynamite, fuse and igniter cord, = .....	66.60	x

Total, ..... \$4,013.35

192

Yours truly

*J. P. Larche*  
John P. Larche

MATHESON: PHONE 273-2435  
P. O. BOX 130

TIMMINS: PHONE 264-1515  
P. O. BOX 912



# LEO ALARIE AND SONS LTD.

GENERAL CONTRACTORS

MATHESON, ONTARIO

Argyle Ventures Inc., Chutine Resources Ltd.  
Att'n: John H. Oliver, President  
M Vancouver, B.C.

DATE July 13th, 1984

AND  
Manville Canada Inc.  
Matheson, Ont.

TERMS: NET

1% INTEREST PER MONTH AFTER 30 DAY

DATE	DESCRIPTION	AMOUNT
<u>1984</u>		
July 3	D7 Dozer 3 1/2 hrs	
" 6	D7 2 1/2 "	
	Total .. 6 hours at \$58/hr	\$ 348.00
July 6	D6LGP 3 hrs	
" 7	" 9 "	
" 8	" 8 "	
" 9	" 8 "	
" 10	" 14 "	
" 11	" 5 1/2 "	
	Total .. 47 1/2 hours at \$62/hr	\$2,945.00
July 3	Float - Move D7F 7 hrs	
" 6	" - Move D6LGP 7 "	
" 12	" - Move out D6LGP 7 1/2 "	
" 13	" - Move out D7F 7 1/2 "	
	Total .. 29 hours at \$46.50/hr	\$1,348.50
	<b>GRAND TOTAL ..</b>	<b>\$4,641.50</b>

50% - Argyle Pd 50%  
50% - Manville Pd July 13/84. Road Construction  
Exploration Acct.

**PAID**  
3

N.B. Argyle APPLICABLE COSTS: \$2,320.75 - 674.25 = 1,646.50

\* Manville COSTS - 1,348.50 - 2 = 674.25

37602-004  
THE TRADING & COMMISSION BANK  
745 THE QUEEN ST. W. & ALGONQUIN ST. W.  
6 FINE ST. P.O. BOX 19  
TORONTO, ONTARIO M5H 7C5  
JULY 13 1984

No. 3

# MONTO-DOMINION BANK

CURRENT ACCOUNT

100 J. S. & ALGONQUIN BLVD.  
TORONTO, ONTARIO M4N 7C5

July 13, 1984

PAY TO THE ORDER OF

LEO ALARIE & SONS LTD. \$ 2320.75

two thousand three hundred & twenty <sup>75</sup>/<sub>100</sub> DOLLARS

*J. Alarie*

⑆37602⑉004⑆

ACC# 329124

⑆0000232075⑆

37602-004  
THE TRADING & COMMISSION BANK  
745 THE QUEEN ST. W. & ALGONQUIN ST. W.  
6 FINE ST. P.O. BOX 19  
TORONTO, ONTARIO M5H 7C5  
JULY 13 1984  
37602-004

5000.00

5000.00

5000.00

#172 McNeil  
 723375 Minin

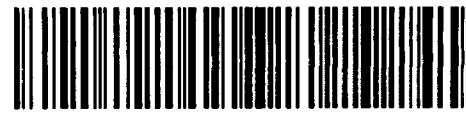

900

Name and Postal Address of Recorded Holder  
 Argyle Ventures Inc.

Penthouse Suite, 470 Granville St., Vancouver, B.C., V6B 1C5

Summary of Work Performance and Distribution of Credits

Total Work Days Cr. claimed 637.2	Mining Claim			Mining Claim			Mining Claim		
	Prefix	Number	Work Days Cr.	Prefix	Number	Work Days Cr.	Prefix	Number	Work Days Cr.
For Performance of the following work. (Check one only) <input checked="" type="checkbox"/> Manual Work <input type="checkbox"/> Shaft Sinking Drifting or other Lateral Work. <input checked="" type="checkbox"/> Compressed Air, other Power driven or mechanical equip. <input checked="" type="checkbox"/> Power Stripping <input type="checkbox"/> Diamond or other Core drilling <input type="checkbox"/> Land Survey		723375	53.1		725014	53.1			
		724365	53.1		725016	53.1			
		725925	53.1		725018	53.1			
		724927	53.1		758921	53.1			
		724929	53.1		724953	53.1			
		724951	53.1						
		724985	53.1						

All the work was performed on Mining Claim(s):

Required Information eg: type of equipment, Names, Addresses, etc. (See Table Below)

Please see the attached two sheets "Report of Work Breakdown" for a detailed description of the work and other required data.

1. manual labour. 3.3 days per claim
2. Mechanical 4 days per claim
3. Powerstripping 45.8 days per claim

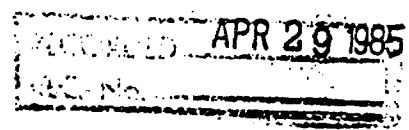
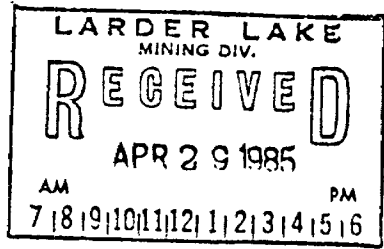

Date of Report: April 20, 1985  
 Name or Agent (Signature): R.V. Stewart

Certification Verifying Report of Work

I hereby certify that I have a personal and intimate knowledge of the facts set forth in the Report of Work annexed hereto, having performed the work or witnessed same during and/or after its completion and the annexed report is true.

Name and Postal Address of Person Certifying  
 Ralph V. Stewart, 15 Deerbrook Trail, Agincourt, Ont. M1W 1W3  
 Date Certified: April 20, 1985  
 Certified by (Signature): *Ralph V. Stewart*

Table of Information/ Attachments Required by the Mining Recorder

Type of Work	Specific information per type	Other information (Common to 2 or more types)	Attachments
Manual Work	Nil	Names and addresses of men who performed manual work /operated equipment, together with dates and hours of employment.	Work Sketch: these are required to show the location and extent of work in relation to the nearest claim post.
Shaft Sinking, Drifting or other Lateral Work			
Compressed air, other power driven or mechanical equip.	Type of equipment	Names and addresses of owner or operator together with dates when drilling/stripping done.	
Power Stripping	Type of equipment and amount expended. Note: Proof of actual cost must be submitted within 30 days of recording.		
Diamond or other core drilling	Signed core log showing; footage, diameter of core, number and angles of holes.		Work Sketch (as above) in duplicate

GRAVEL  
FL 80449

GRAVEL  
FL 180443

McNert trap  
M300

Whitefish  
River

River

5M

4M

2M  
6400ft

2M

1M

Wis Lake

Skoodos  
Lake

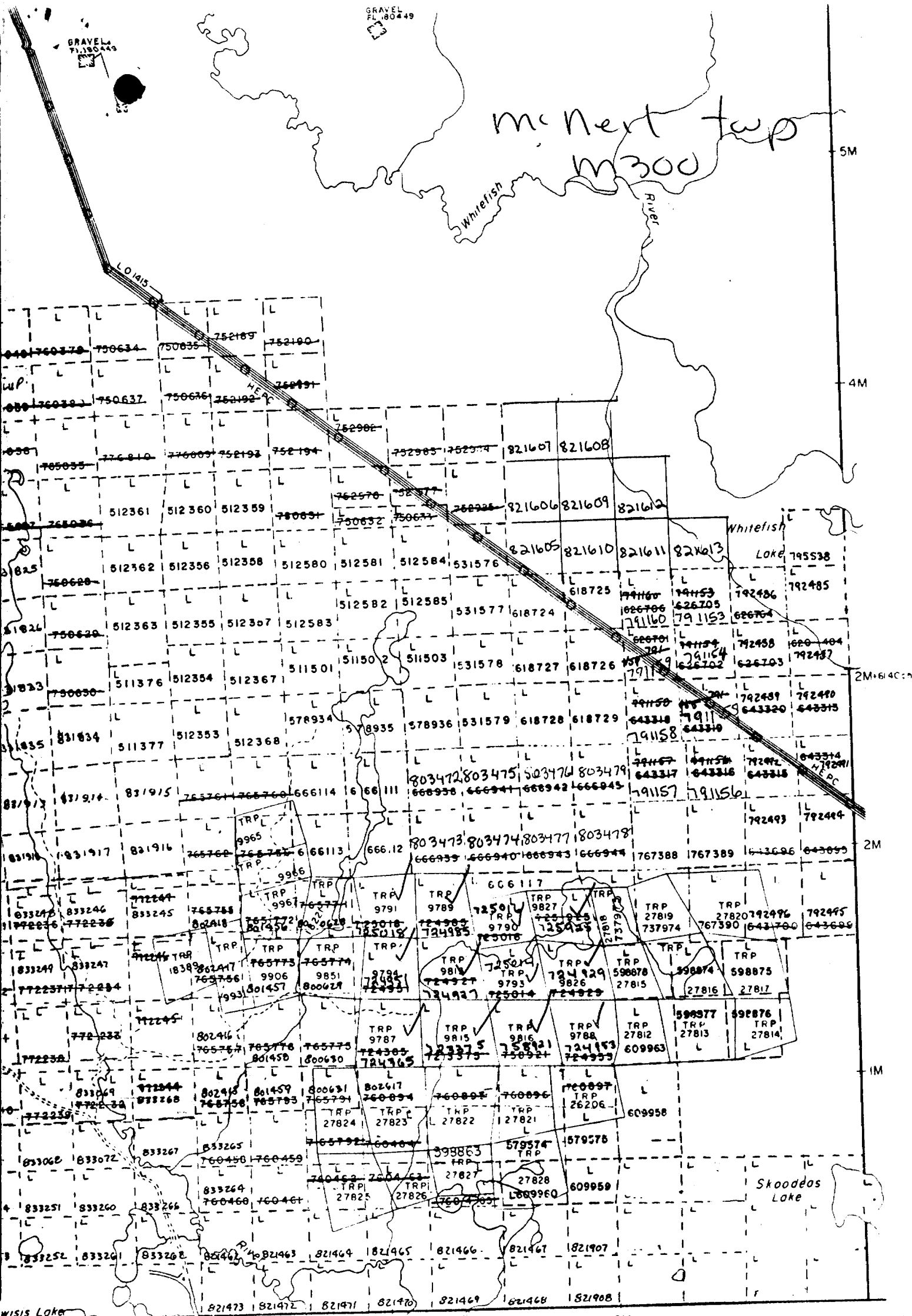



**LOCATION PLAN**  
(MINING CLAIMS)

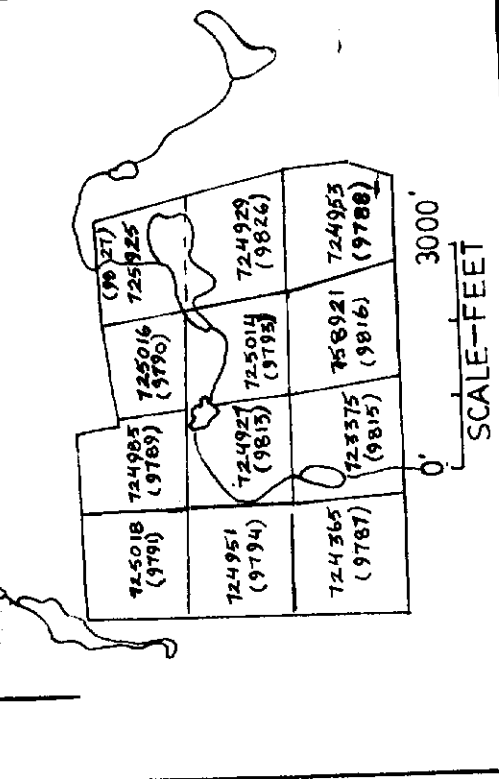

**Symbols**

- AREA OF BEDROCK OUTCROP
- ACCESS ROAD
- TOPOGRAPHIC BOUNDARY
- GEOLOGICAL CONTACT (INTERPRETED)
- GEOLOGICAL CONTACT (ASSUMED)
- AREA ENCLOSING FELSITE INTRUSIVES
  - Interpreted
  - Projected
- FOLIATION and/or SCHISTOSITY
- LAVA FLOW (DIRECTION & DIP)
- PILLOWED LAVA
- BOULDER(S)
- BEAVER DAM
- SWAMP
- SHAFT
- DRILL HOLE CASING
  - Located
  - Approximate
- OLD TRENCH
- SAMPLE LOCATION (1984)
- STRIPPING & SAMPLE LOCATION (1984)
- GEOLOGICAL FAULT (Interpreted)
- MAJOR SHEAR ZONE
- CLAIM POSTS (Approximate) - old patented Cls.

**Legend**

- 7 FELSIC INTRUSIVES
  - 7a Quartz Porphyry
  - 7b Feldspar Porphyry
  - 7c Quartz-Carbonate
- 6 ACID to INTERMEDIATE INTRUSIVES
  - 6a DIORITE/META-DIORITE
  - 6b LAMPROPHYRY
- 5 MAFIC INTRUSIVES
  - 5a HORNBLENDE DYKE
  - 5b GABBRO
  - 5c DIABASE
- 4 ACID to INTERMEDIATE META-VOLCANICS
  - 4a AGGLOMERATE
  - 4b RHYOLITE or DACITE
- 3 INTERMEDIATE META-VOLCANICS (ANDESITE)
  - 3 MASSIVE
  - 3a PILLOWED
  - 3b VARIOLITIC
  - 3c FLOW BANDED
  - 3d CARBONATIZED
- 2 INTERMEDIATE to BASIC FLOWS (Coarse to Fine Grained Meta-Diorite or Diabase)
- 1 MAFIC META-VOLCANICS
  - 1a MASSIVE
  - 1b PILLOWED
  - 1c CARBONATIZED

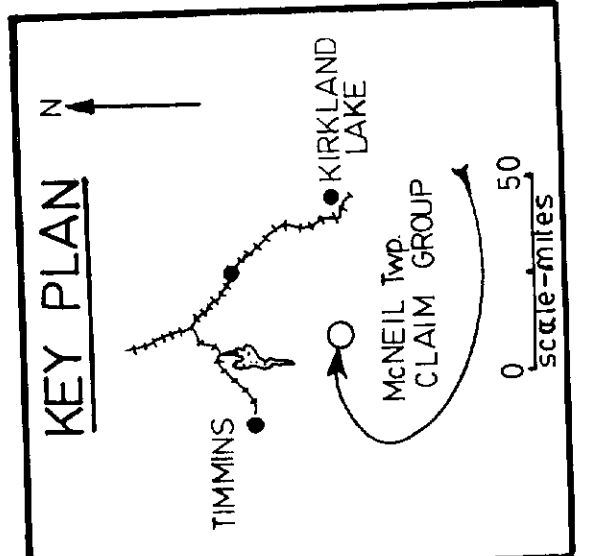

INDICATES STRIPPING LOCATION IN PROCESS OF ROAD CONSTRUCTION.

N.B. :

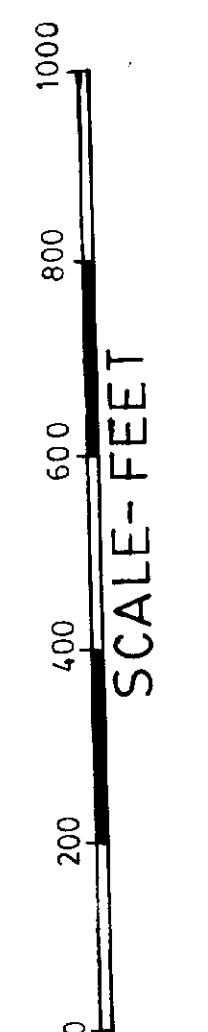
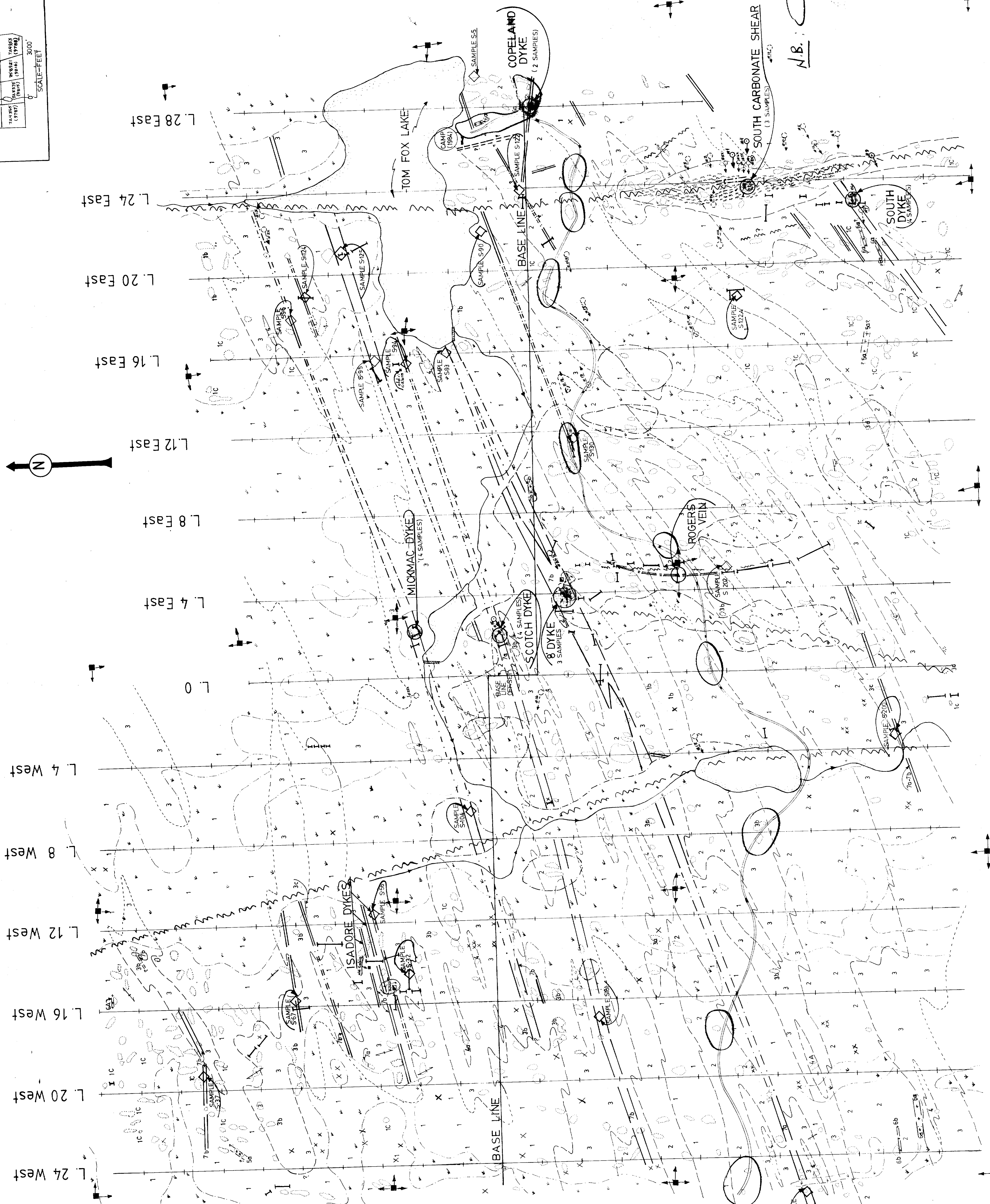

63-44270

ARGYLE VENTURES INC.  
VANCOUVER B.C.

GEOLOGICAL PLAN  
OF  
TOM FOX LAKE CLAIMS, McNEIL Twp. Ont.

DWG. No. S 84-3  
SCALE 1"=200'  
SEPTEMBER 10/1984

GEOLOGY by R.V. STEWART  
DRAWN by R.V. STEWART

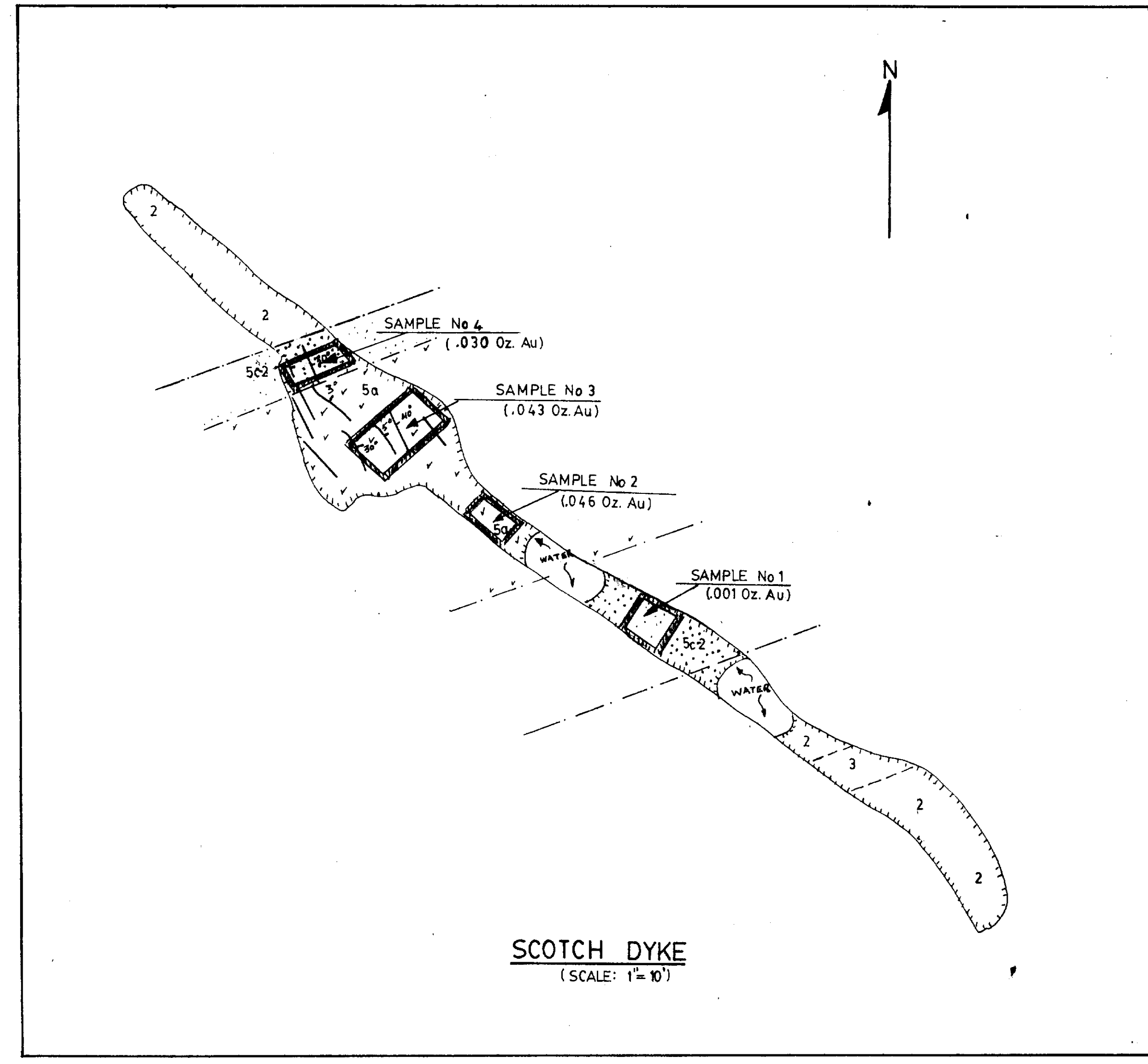
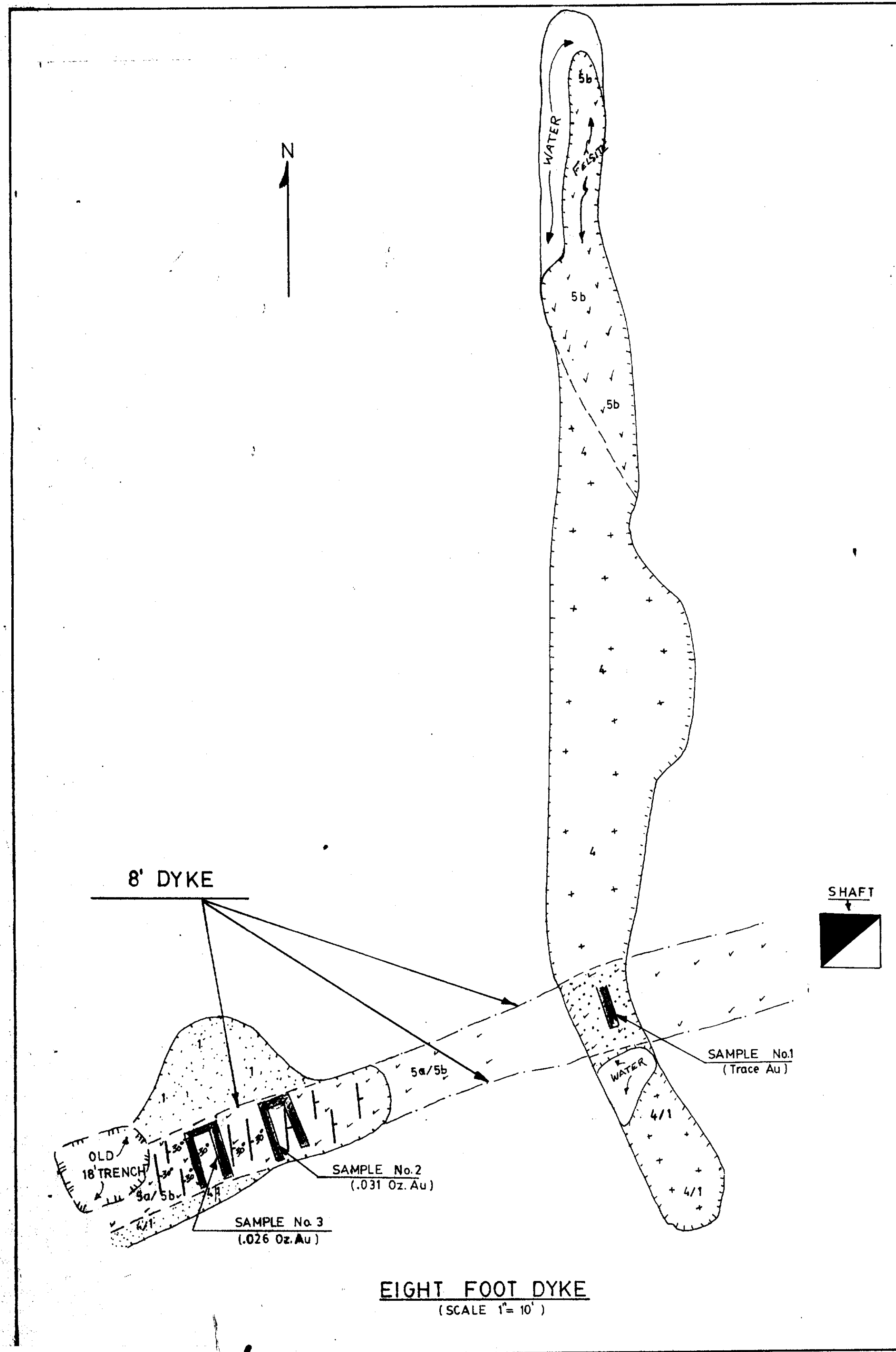
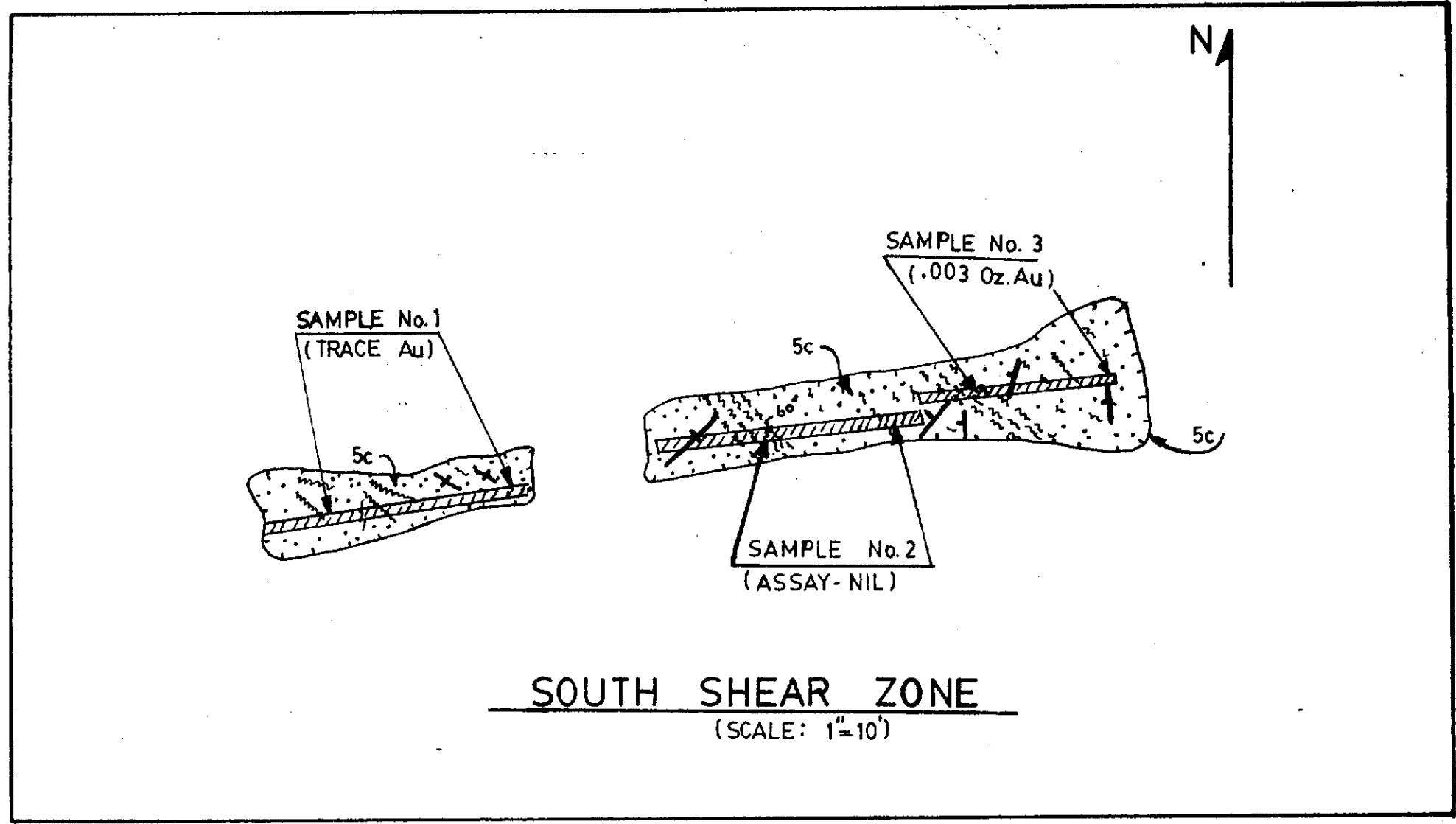
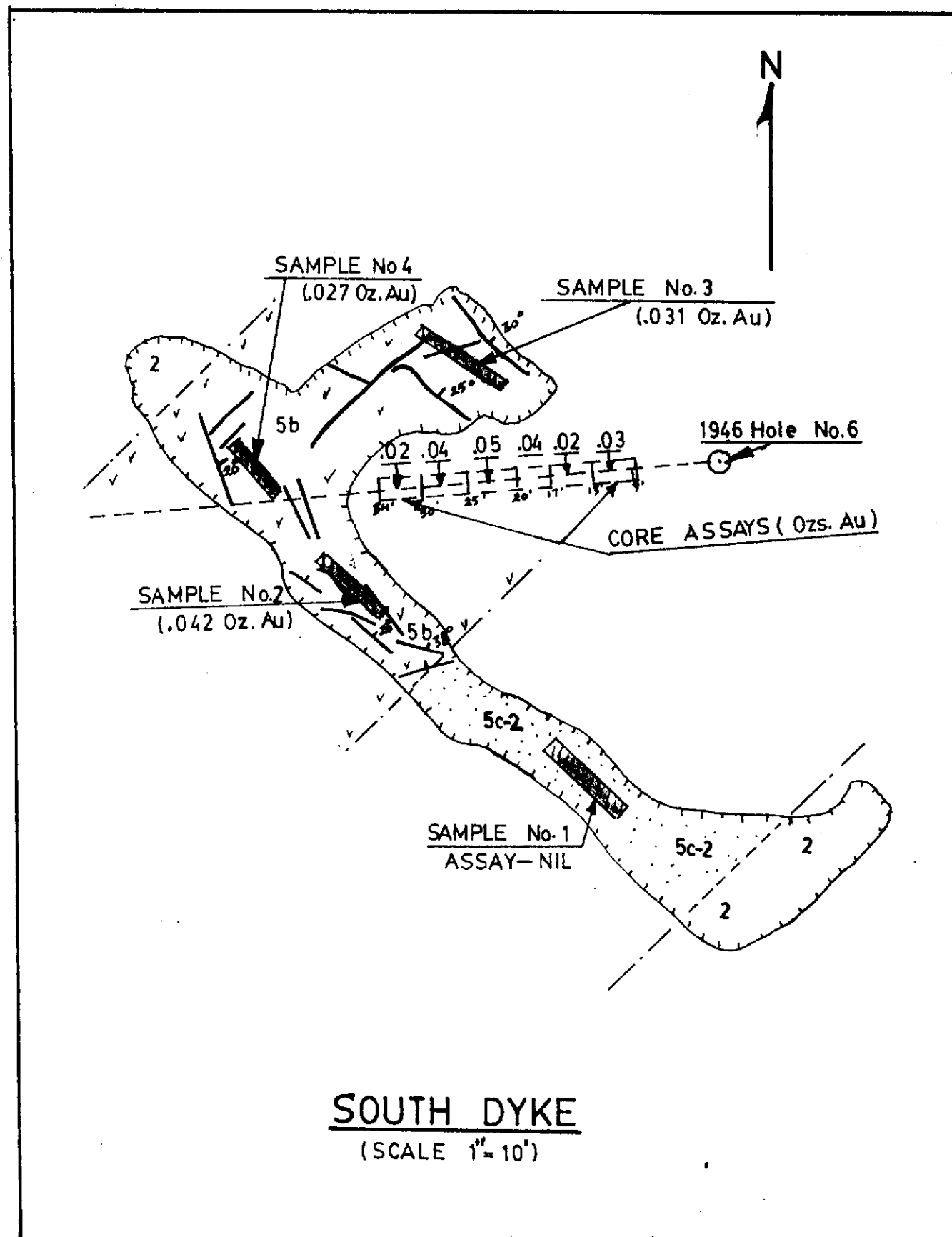
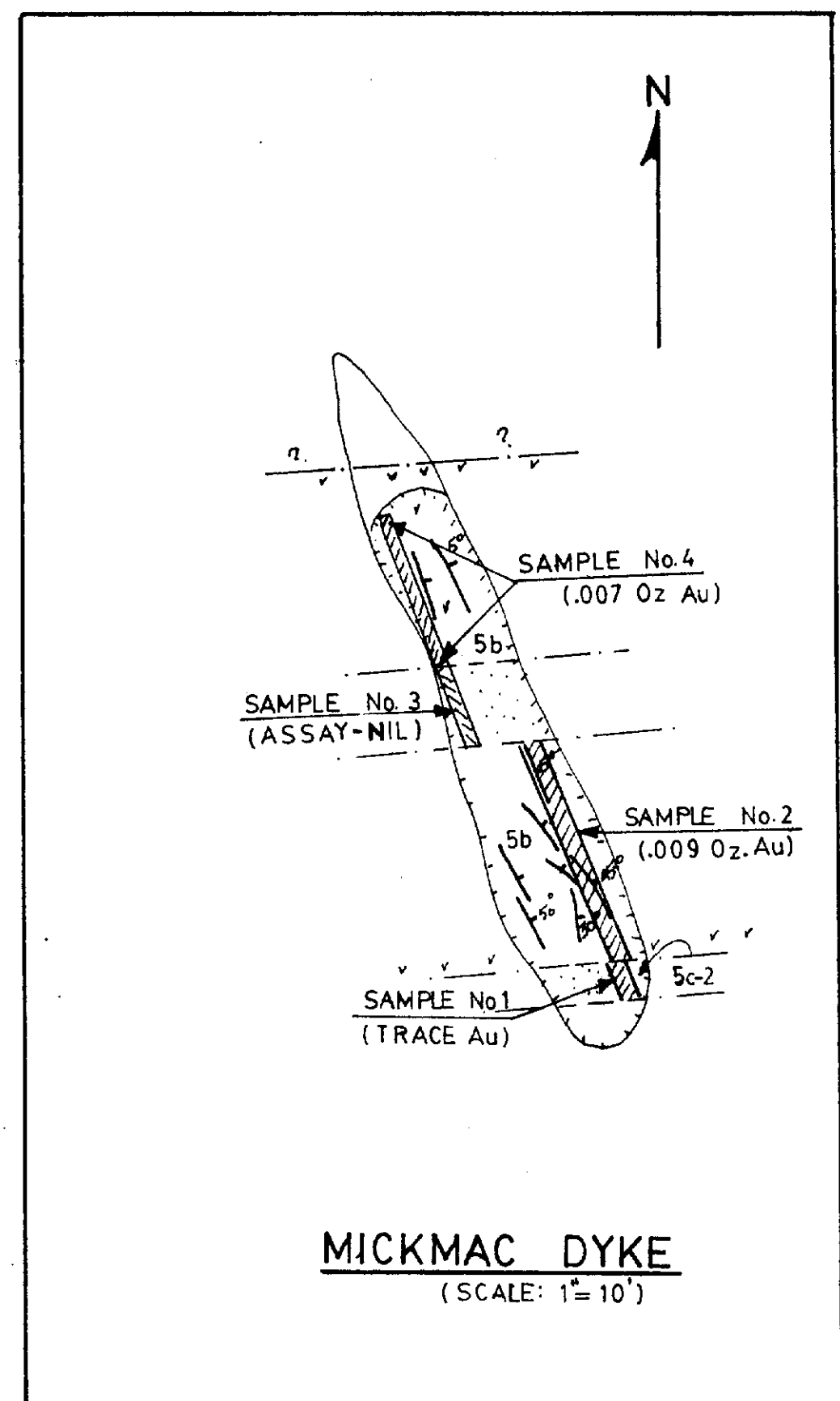
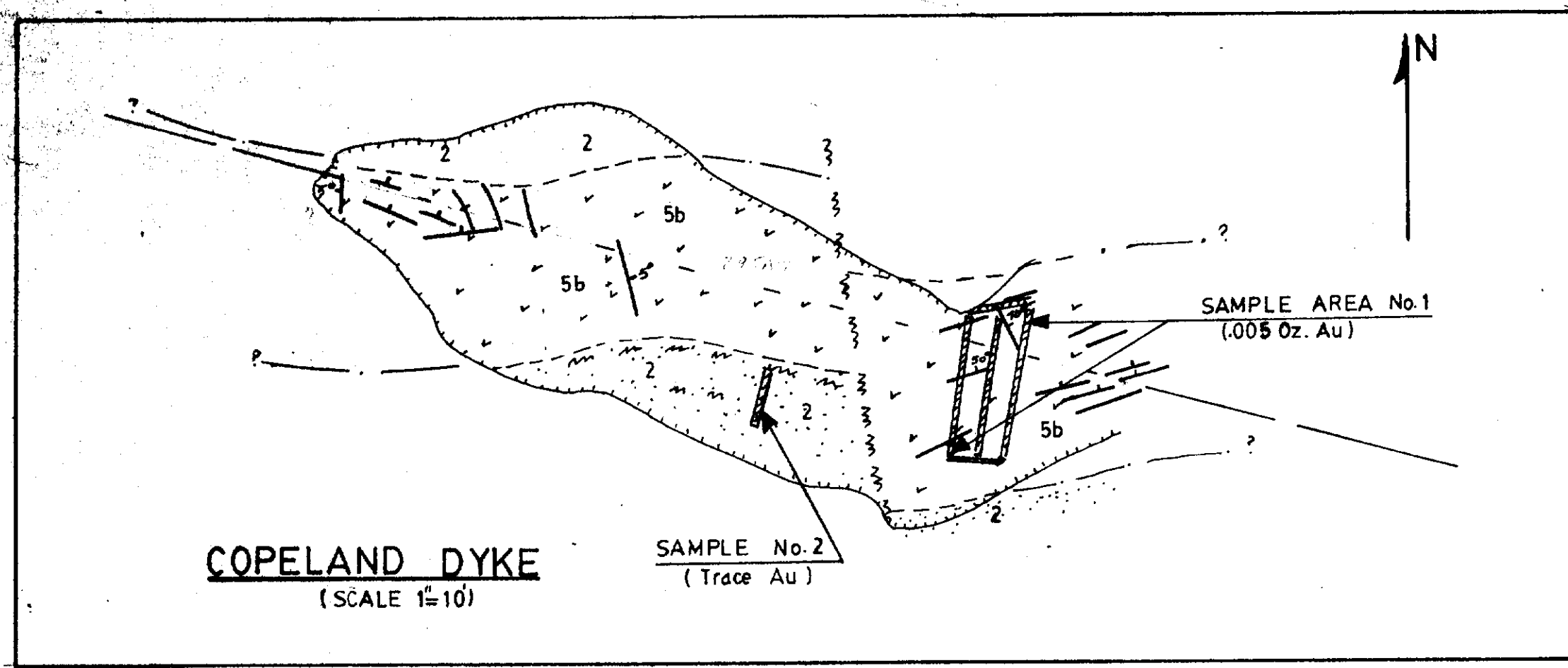

**SYMBOLS**

- BEDROCK EXPOSED (STRIPPED)
- SAMPLE AREA AND NUMBER (WITH ASSAY)
- GEOLOGICAL CONTACT
- QUARTZ VEINS (W/DIP DIRECTION)
- FAULT
- SHEAR ZONE
- DIAMOND DRILL HOLE

**LEGEND**

- FELSIC INTRUSIVES
  - 5a QUARTZ PORPHYRY
  - 5b FELDSPAR PORPHYRY
  - 5c QUARTZ CARBONATE
- MAFIC INTRUSIVES (DIABASE)
- ACID META-VOLCANICS (RHYOLITE)
- INTERMEDIATE META-VOLCANICS (ANDESITE)
- INTERMEDIATE TO BASIC FLOWS (META-DIABASE or DIORITE)
- INDICATES CARBONATIZATION

63.4270

**ARGYLE VENTURES INC.**  
VANCOUVER, B.C.

**GEOLOGICAL PLANS**  
OF  
**AREAS STRIPPED AND SAMPLED (1984)**  
TOM FOX LAKE CLAIMS, McNEIL TWP, ONTARIO.

SCALE 1"=10'	DWG. No. S.84-2	GEOLOGY by R.V. STEWART
	SEPTEMBER 10th 1984	DRAWN by R.V. STEWART