

**NOTE:**

1. STATIONING IS BASED UPON IFC ALIGNMENT.
2. EXACT PIPELINE ALIGNMENT SUBJECT TO CHANGE, WITHIN THE EXTENTS OF THE PERMANENT EASEMENT, DEPENDING ON FIELD CONDITIONS. MVP WILL MAINTAIN ELEVATIONS AND MINIMUM DISTANCES FROM RESOURCES AS SHOWN.
3. LOCATION OF TRAVEL LANE AND ASSOCIATED TIMBER MAT/TEMPORARY CONSTRUCTION ACCESS BRIDGE IS FIELD DEPENDENT.
4. FIELD CONDITIONS MAY CHANGE THE LOCATION OF COFFERDAM. LOCATION OF PUMPS AND ENERGY DISSIPATER WILL BE IDENTIFIED IN THE FIELD AND WITHIN THE LOD. APPROVED E&SC BMPS HAVE BEEN REMOVED FOR CLARITY.
5. SPOIL FROM CROSSING TO BE LOCATED MINIMUM 10' FROM BANK.



**LEGEND**

- ORDINARY HIGH WATER MARK
- PROPOSED LIMIT OF DISTURBANCE
- PROPOSED PERMANENT R.O.W.
- CONSTRUCTION BASELINE

ENCOMPASS SERVICES, LLC  
1370 WASHINGTON PIKE, SUITE 308  
BRIDGEVILLE, PA 15017

RESOURCE CROSSING  
RESOURCE NAME: S-H88  
LAT./LONG.= 38.1366977, -80.7305441  
STATION = 6899+15  
COUNTY / STATE: NICHOLAS COUNTY, WV  
REFER TO TABLE 2 (STREAMS) AND TABLE 3 (WETLANDS) IN THE INDIVIDUAL PERMIT APPLICATION

DATE:	02/12/21
PROJECT NO.:	61538
DRAWN BY:	JGG
CHECKED BY:	JAW
APPROVED BY:	TN
SHEET:	1 OF 2
DRAWING NUMBER E-BP-WV-NI-089-OC-REV1	

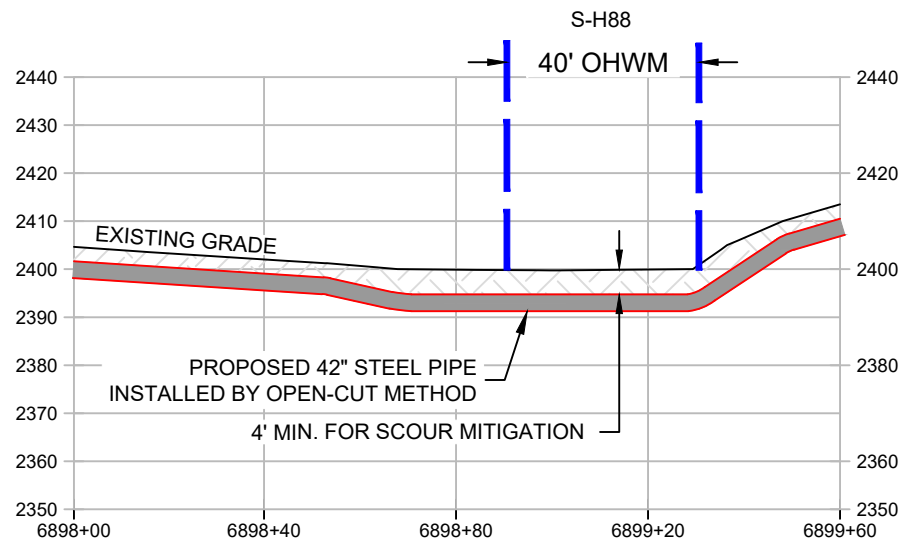

**NOTE:**

1. MINIMUM 3' COVER BETWEEN STREAMBED AND TOP OF PIPELINE UNLESS OTHERWISE NOTED.
2. PROPOSED FILL WILL BE IN TRENCH AND WILL BE RESTORED TO PRE-CONSTRUCTION ELEVATIONS.



ENCOMPASS SERVICES, LLC  
1370 WASHINGTON PIKE, SUITE 308  
BRIDGEVILLE, PA 15017



RESOURCE CROSSING  
RESOURCE NAME: S-H88  
LAT./LONG. = 38.1366977, -80.7305441  
STATION = 6899+15  
COUNTY / STATE: NICHOLAS COUNTY, WV  
REFER TO TABLE 2 (STREAMS) AND TABLE 3  
(WETLANDS) IN THE INDIVIDUAL PERMIT  
APPLICATION

DATE:	02/12/21
PROJECT NO.:	61538
DRAWN BY:	JGG
CHECKED BY:	JAW
APPROVED BY:	TN
SHEET:	2 OF 2

DRAWING NUMBER  
E-BP-WV-NI-089-OC-REV1

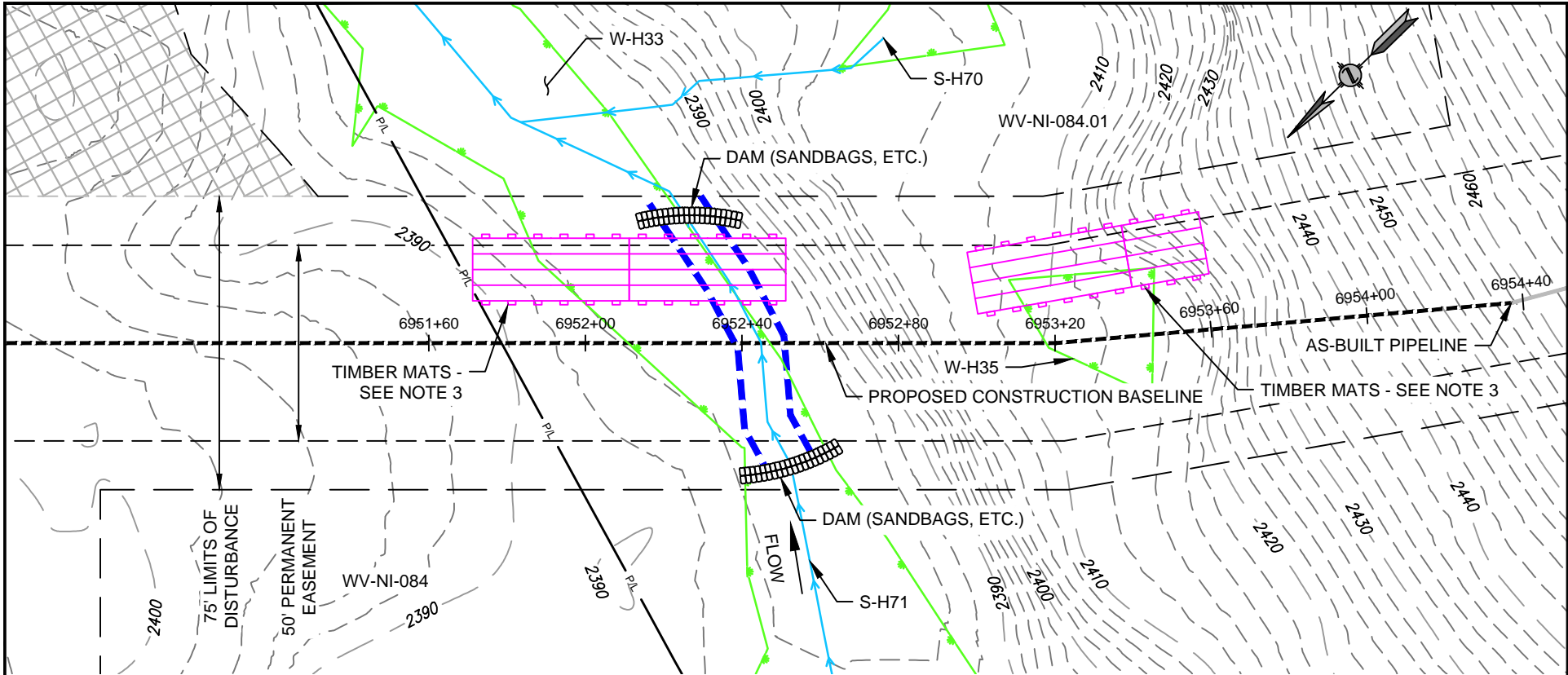

**NOTE:**

1. STATIONING IS BASED UPON IFC ALIGNMENT.
2. EXACT PIPELINE ALIGNMENT SUBJECT TO CHANGE, WITHIN THE EXTENTS OF THE PERMANENT EASEMENT, DEPENDING ON FIELD CONDITIONS. MVP WILL MAINTAIN ELEVATIONS AND MINIMUM DISTANCES FROM RESOURCES AS SHOWN.
3. LOCATION OF TRAVEL LANE AND ASSOCIATED TIMBER MAT/TEMPORARY CONSTRUCTION ACCESS BRIDGE IS FIELD DEPENDENT.
4. FIELD CONDITIONS MAY CHANGE THE LOCATION OF COFFERDAM. LOCATION OF PUMPS AND ENERGY DISSIPATER WILL BE IDENTIFIED IN THE FIELD AND WITHIN THE LOD. APPROVED E&SC BMPS HAVE BEEN REMOVED FOR CLARITY.
5. SPOIL FROM CROSSING TO BE LOCATED MINIMUM 10' FROM BANK.



**LEGEND**

- ORDINARY HIGH WATER MARK
- PROPOSED LIMIT OF DISTURBANCE
- PROPOSED PERMANENT R.O.W.
- CONSTRUCTION BASELINE



ENCOMPASS SERVICES, LLC  
1370 WASHINGTON PIKE, SUITE 308  
BRIDGEVILLE, PA 15017



RESOURCE CROSSING  
RESOURCE NAME: S-H71 / W-H33 / W-H35  
LAT./LONG. = 38.124297, -80.735821  
STATION = 6952+44  
COUNTY / STATE: NICHOLAS COUNTY, WV  
REFER TO TABLE 2 (STREAMS) AND TABLE 3 (WETLANDS) IN THE INDIVIDUAL PERMIT APPLICATION

DATE:	02/03/21
PROJECT NO.:	61538
DRAWN BY:	AMM
CHECKED BY:	JAW
APPROVED BY:	TN
SHEET:	1 OF 2
DRAWING NUMBER E-BP-WV-NI-084.01-OC-REV1	

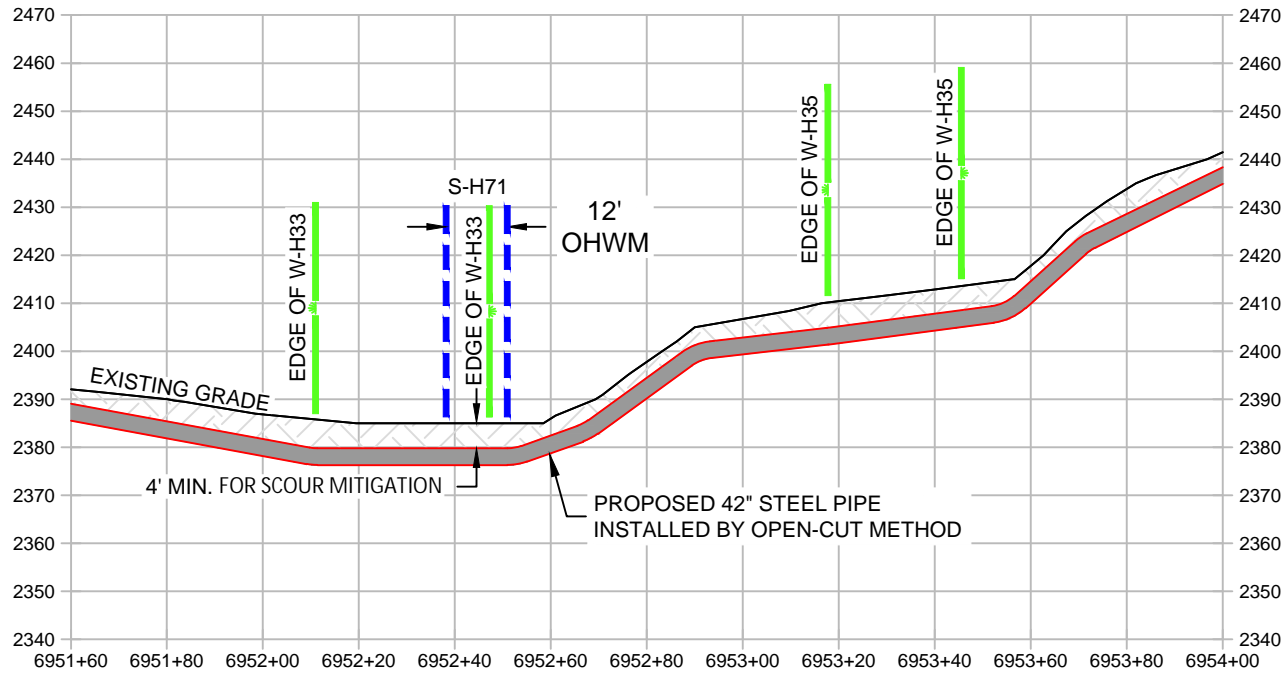

**NOTE:**

1. MINIMUM 3' COVER BETWEEN STREAMBED AND TOP OF PIPELINE UNLESS OTHERWISE NOTED.
2. PROPOSED FILL WILL BE IN TRENCH AND WILL BE RESTORED TO PRE-CONSTRUCTION ELEVATIONS.



ENCOMPASS SERVICES, LLC  
1370 WASHINGTON PIKE, SUITE 308  
BRIDGEVILLE, PA 15017



RESOURCE CROSSING  
RESOURCE NAME: S-H71 / W-H33 / W-H35  
LAT./LONG. = 38.124297, -80.735821  
STATION = 6952+44  
COUNTY / STATE: NICHOLAS COUNTY, WV  
REFER TO TABLE 2 (STREAMS) AND TABLE 3 (WETLANDS) IN THE INDIVIDUAL PERMIT APPLICATION

DATE:	02/03/21
PROJECT NO.:	61538
DRAWN BY:	AMM
CHECKED BY:	JAW
APPROVED BY:	TN
SHEET:	2 OF 2

DRAWING NUMBER  
E-BP-WV-NI-084.01-OC-REV1

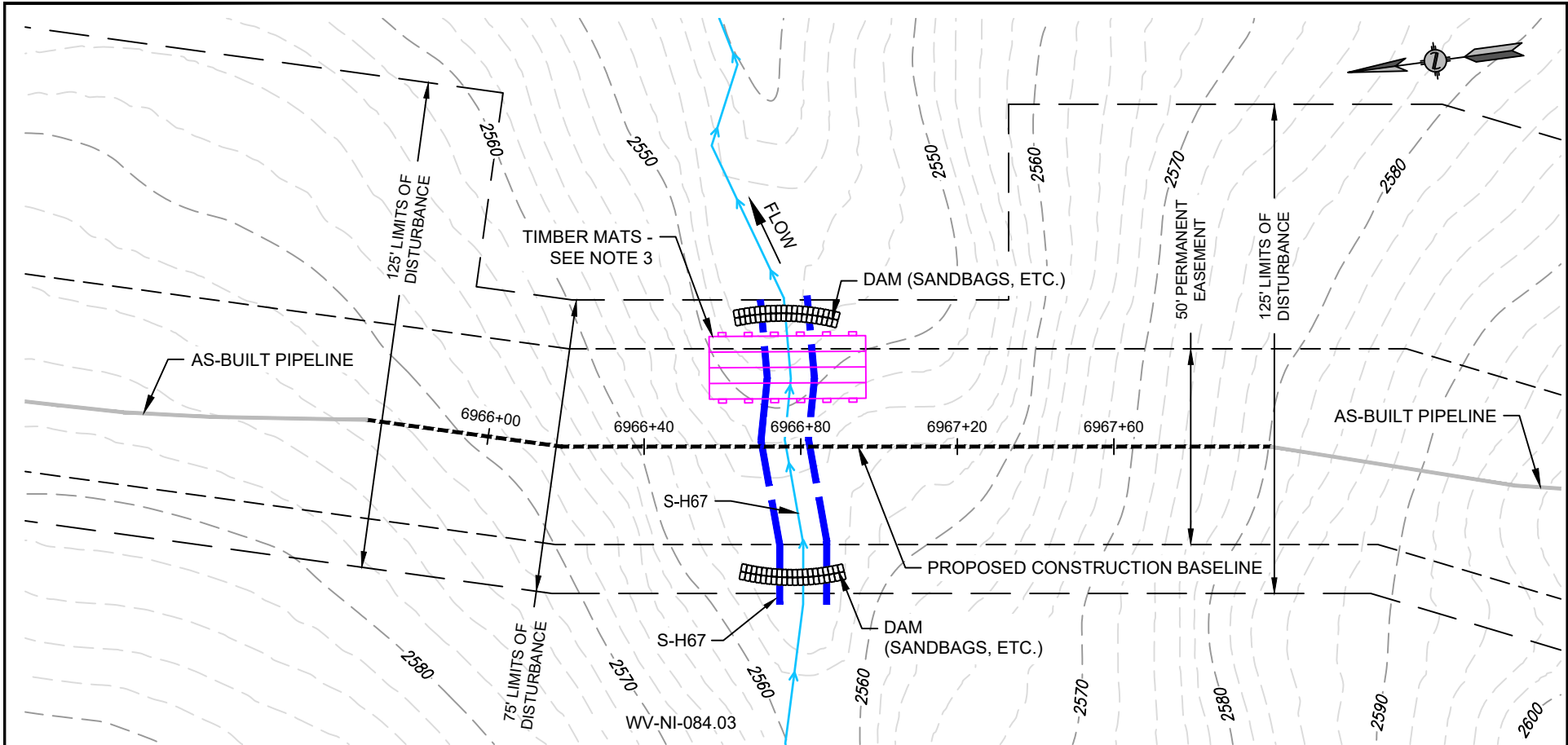

**NOTE:**

1. STATIONING IS BASED UPON IFC ALIGNMENT.
2. EXACT PIPELINE ALIGNMENT SUBJECT TO CHANGE, WITHIN THE EXTENTS OF THE PERMANENT EASEMENT, DEPENDING ON FIELD CONDITIONS. MVP WILL MAINTAIN ELEVATIONS AND MINIMUM DISTANCES FROM RESOURCES AS SHOWN.
3. LOCATION OF TRAVEL LANE AND ASSOCIATED TIMBER MAT/TEMPORARY CONSTRUCTION ACCESS BRIDGE IS FIELD DEPENDENT.
4. FIELD CONDITIONS MAY CHANGE THE LOCATION OF COFFERDAM. LOCATION OF PUMPS AND ENERGY DISSIPATER WILL BE IDENTIFIED IN THE FIELD AND WITHIN THE LOD. APPROVED E&SC BMPS HAVE BEEN REMOVED FOR CLARITY.
5. SPOIL FROM CROSSING TO BE LOCATED MINIMUM 10' FROM BANK.



**LEGEND**

- ORDINARY HIGH WATER MARK
- PROPOSED LIMIT OF DISTURBANCE
- PROPOSED PERMANENT R.O.W.
- CONSTRUCTION BASELINE

ENCOMPASS SERVICES, LLC  
1370 WASHINGTON PIKE, SUITE 308  
BRIDGEVILLE, PA 15017

RESOURCE CROSSING  
RESOURCE NAME: S-H67  
LAT./LONG. = 38.1205744, -80.7367848  
STATION = 6966+76  
COUNTY / STATE: NICHOLAS COUNTY, WV  
REFER TO TABLE 2 (STREAMS) AND TABLE 3 (WETLANDS) IN THE INDIVIDUAL PERMIT APPLICATION

DATE:	02/13/21
PROJECT NO.:	61538
DRAWN BY:	RW
CHECKED BY:	JAW
APPROVED BY:	TN
SHEET:	1 OF 2
DRAWING NUMBER E-BP-WV-NI-084.03-OC-REV1	

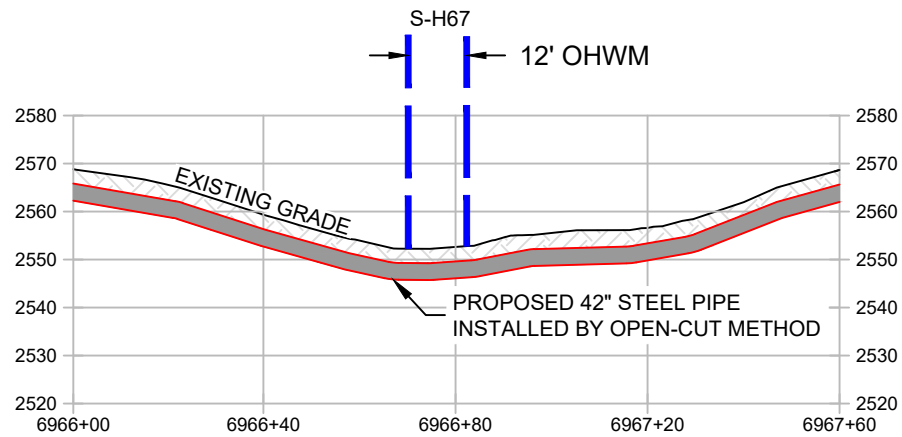

**NOTE:**

1. MINIMUM 3' COVER BETWEEN STREAMBED AND TOP OF PIPELINE UNLESS OTHERWISE NOTED.
2. PROPOSED FILL WILL BE IN TRENCH AND WILL BE RESTORED TO PRE-CONSTRUCTION ELEVATIONS.



ENCOMPASS SERVICES, LLC  
1370 WASHINGTON PIKE, SUITE 308  
BRIDGEVILLE, PA 15017



RESOURCE CROSSING  
RESOURCE NAME: S-H67  
LAT./LONG.= 38.1205744, -80.7367848  
STATION = 6966+76  
COUNTY / STATE: NICHOLAS COUNTY, WV  
REFER TO TABLE 2 (STREAMS) AND TABLE 3 (WETLANDS) IN THE INDIVIDUAL PERMIT APPLICATION

DATE:	02/13/21
PROJECT NO.:	61538
DRAWN BY:	RW
CHECKED BY:	JAW
APPROVED BY:	TN
SHEET:	2 OF 2

DRAWING NUMBER  
E-BP-WV-NI-084.03-OC-REV1

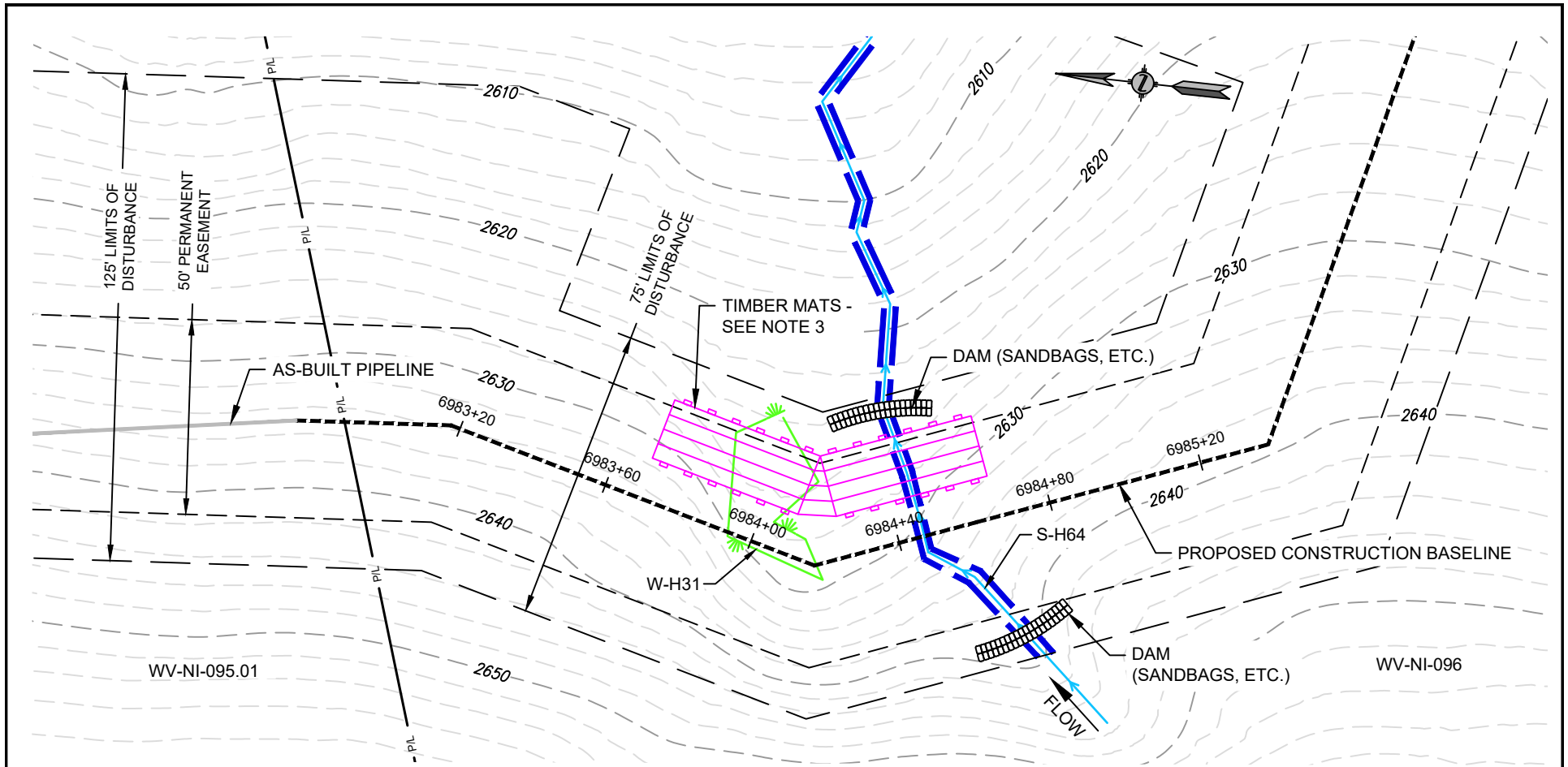

**NOTE:**

1. STATIONING IS BASED UPON IFC ALIGNMENT.
2. EXACT PIPELINE ALIGNMENT SUBJECT TO CHANGE, WITHIN THE EXTENTS OF THE PERMANENT EASEMENT, DEPENDING ON FIELD CONDITIONS. MVP WILL MAINTAIN ELEVATIONS AND MINIMUM DISTANCES FROM RESOURCES AS SHOWN.
3. LOCATION OF TRAVEL LANE AND ASSOCIATED TIMBER MAT/TEMPORARY CONSTRUCTION ACCESS BRIDGE IS FIELD DEPENDENT.
4. FIELD CONDITIONS MAY CHANGE THE LOCATION OF COFFERDAM. LOCATION OF PUMPS AND ENERGY DISSIPATER WILL BE IDENTIFIED IN THE FIELD AND WITHIN THE LOD. APPROVED E&SC BMPS HAVE BEEN REMOVED FOR CLARITY.
5. SPOIL FROM CROSSING TO BE LOCATED MINIMUM 10' FROM BANK.



**LEGEND**

- ORDINARY HIGH WATER MARK
- PROPOSED LIMIT OF DISTURBANCE
- PROPOSED PERMANENT R.O.W.
- CONSTRUCTION BASELINE

ENCOMPASS SERVICES, LLC  
1370 WASHINGTON PIKE, SUITE 308  
BRIDGEVILLE, PA 15017

RESOURCE CROSSING  
RESOURCE NAME: W-H31 & S-H64  
LAT./LONG.= 38.1163396, -80.7353463  
STATION = 6984+18  
COUNTY / STATE: NICHOLAS COUNTY, WV  
REFER TO TABLE 2 (STREAMS) AND TABLE 3 (WETLANDS) IN THE INDIVIDUAL PERMIT APPLICATION

DATE:	02/13/21
PROJECT NO.:	61538
DRAWN BY:	RW
CHECKED BY:	JAW
APPROVED BY:	TN
SHEET:	1 OF 2
DRAWING NUMBER E-BP-WV-NI-096-OC-REV1	

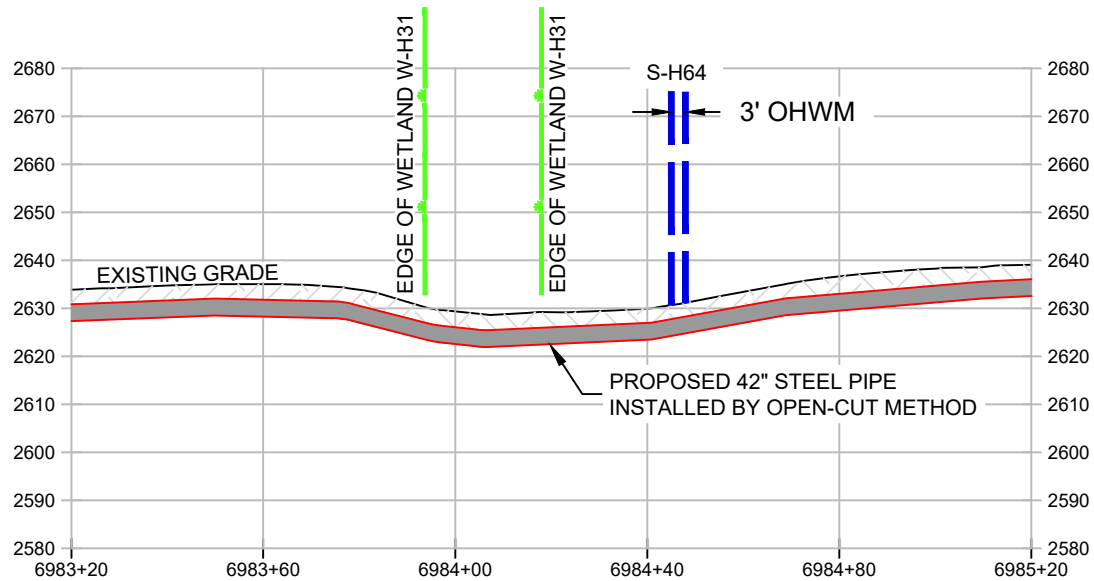

**NOTE:**

1. MINIMUM 3' COVER BETWEEN STREAMBED AND TOP OF PIPELINE UNLESS OTHERWISE NOTED.
2. PROPOSED FILL WILL BE IN TRENCH AND WILL BE RESTORED TO PRE-CONSTRUCTION ELEVATIONS.



ENCOMPASS SERVICES, LLC  
1370 WASHINGTON PIKE, SUITE 308  
BRIDGEVILLE, PA 15017



RESOURCE CROSSING  
RESOURCE NAME: W-H31 & S-H64  
LAT./LONG.= 38.1163396, -80.7353463  
STATION = 6984+18  
COUNTY / STATE: NICHOLAS COUNTY, WV  
REFER TO TABLE 2 (STREAMS) AND TABLE 3  
(WETLANDS) IN THE INDIVIDUAL PERMIT  
APPLICATION

DATE:	02/13/21
PROJECT NO.:	61538
DRAWN BY:	RW
CHECKED BY:	JAW
APPROVED BY:	TN
SHEET:	2 OF 2

DRAWING NUMBER  
E-BP-WV-NI-096-OC-REV1



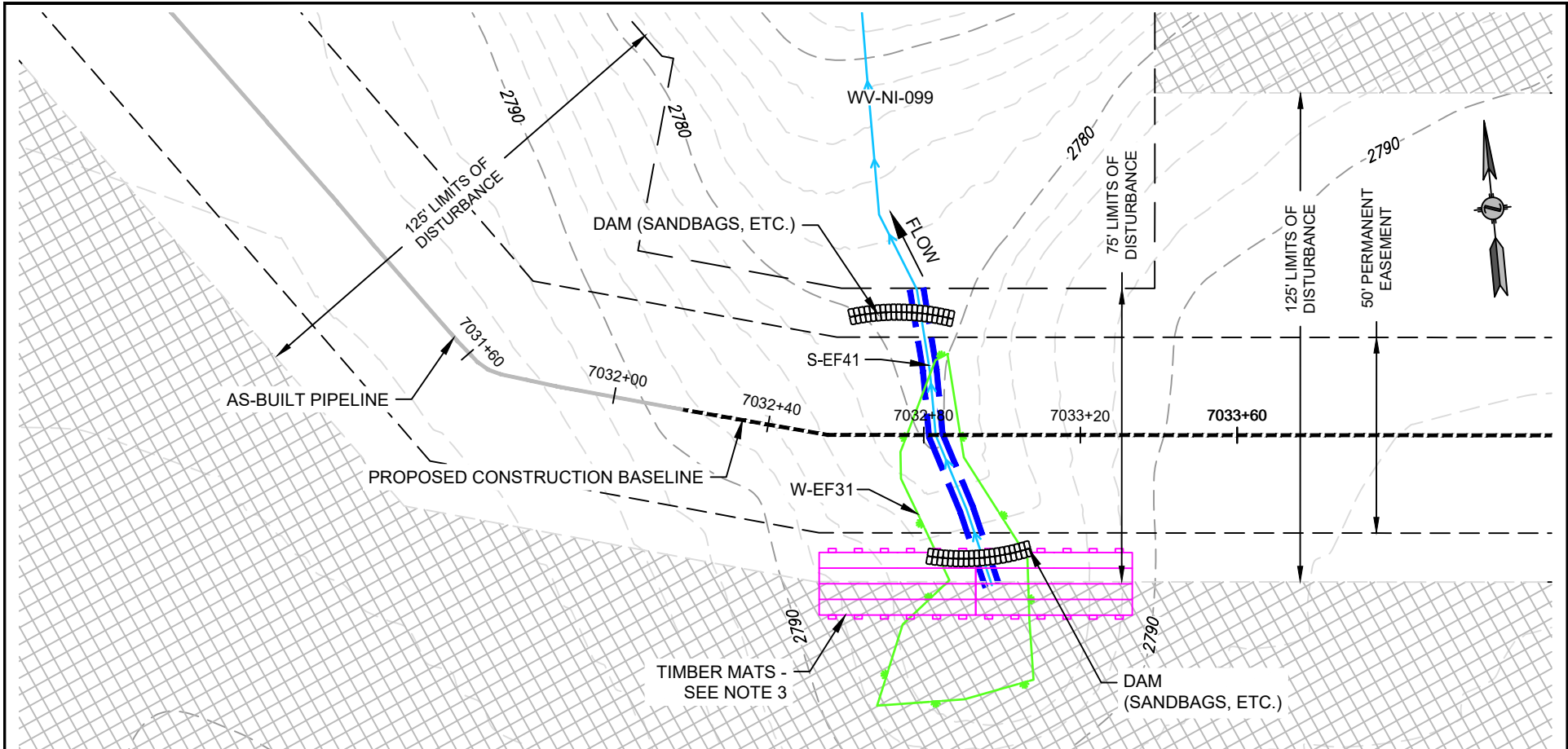

**NOTE:**

1. STATIONING IS BASED UPON IFC ALIGNMENT.
2. EXACT PIPELINE ALIGNMENT SUBJECT TO CHANGE, WITHIN THE EXTENTS OF THE PERMANENT EASEMENT, DEPENDING ON FIELD CONDITIONS. MVP WILL MAINTAIN ELEVATIONS AND MINIMUM DISTANCES FROM RESOURCES AS SHOWN.
3. LOCATION OF TRAVEL LANE AND ASSOCIATED TIMBER MAT/TEMPORARY CONSTRUCTION ACCESS BRIDGE IS FIELD DEPENDENT.
4. FIELD CONDITIONS MAY CHANGE THE LOCATION OF COFFERDAM. LOCATION OF PUMPS AND ENERGY DISSIPATER WILL BE IDENTIFIED IN THE FIELD AND WITHIN THE LOD. APPROVED E&SC BMPS HAVE BEEN REMOVED FOR CLARITY.
5. SPOIL FROM CROSSING TO BE LOCATED MINIMUM 10' FROM BANK.



**LEGEND**

- ORDINARY HIGH WATER MARK
- PROPOSED LIMIT OF DISTURBANCE
- PROPOSED PERMANENT R.O.W.
- CONSTRUCTION BASELINE



ENCOMPASS SERVICES, LLC  
1370 WASHINGTON PIKE, SUITE 308  
BRIDGEVILLE, PA 15017



RESOURCE CROSSING  
RESOURCE NAME: S-EF41 & W-EF31  
LAT./LONG.= 38.107580, -80.726311  
STATION = 7032+84  
COUNTY / STATE: NICHOLAS COUNTY, WV  
REFER TO TABLE 2 (STREAMS) AND TABLE 3 (WETLANDS) IN THE INDIVIDUAL PERMIT APPLICATION

DATE:	02/12/21
PROJECT NO.:	61538
DRAWN BY:	JGG
CHECKED BY:	JAW
APPROVED BY:	TN
SHEET:	1 OF 2
DRAWING NUMBER E-BP-WV-NI-099-OC-REV1	

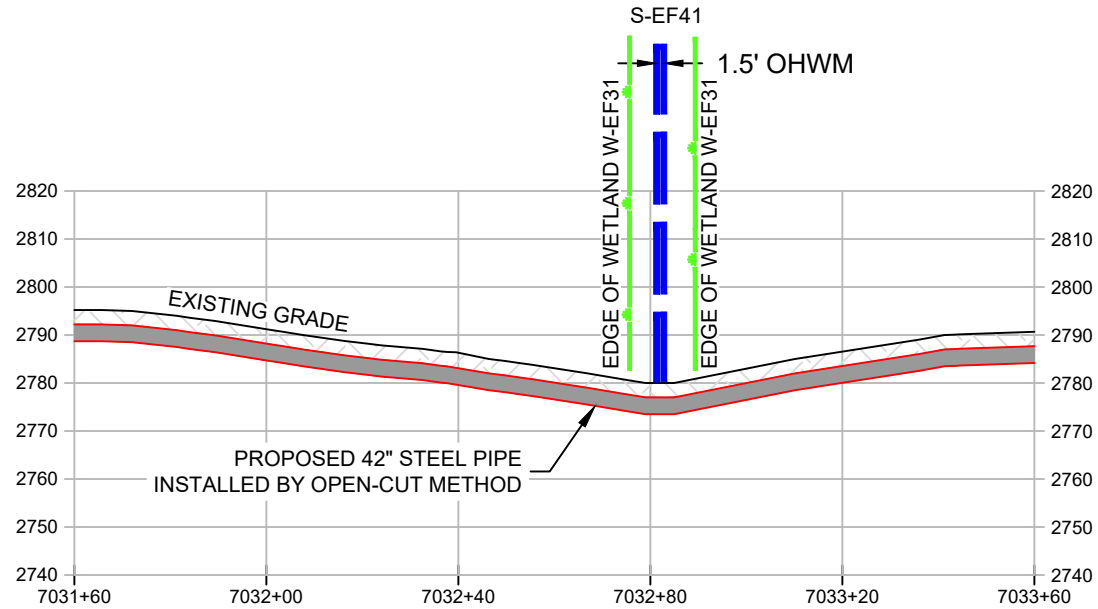

- NOTE:
1. MINIMUM 3' COVER BETWEEN STREAMBED AND TOP OF PIPELINE UNLESS OTHERWISE NOTED.
  2. PROPOSED FILL WILL BE IN TRENCH AND WILL BE RESTORED TO PRE-CONSTRUCTION ELEVATIONS.



ENCOMPASS SERVICES, LLC  
 1370 WASHINGTON PIKE, SUITE 308  
 BRIDGEVILLE, PA 15017



RESOURCE CROSSING  
 RESOURCE NAME: S-EF41 & W-EF31  
 LAT./LONG.= 38.107580, -80.726311  
 STATION = 7032+84  
 COUNTY / STATE: NICHOLAS COUNTY, WV  
 REFER TO TABLE 2 (STREAMS) AND TABLE 3  
 (WETLANDS) IN THE INDIVIDUAL PERMIT  
 APPLICATION

DATE:	02/12/21
PROJECT NO.:	61538
DRAWN BY:	JGG
CHECKED BY:	JAW
APPROVED BY:	TN
SHEET:	2 OF 2

DRAWING NUMBER  
 E-BP-WV-NI-099-OC-REV1

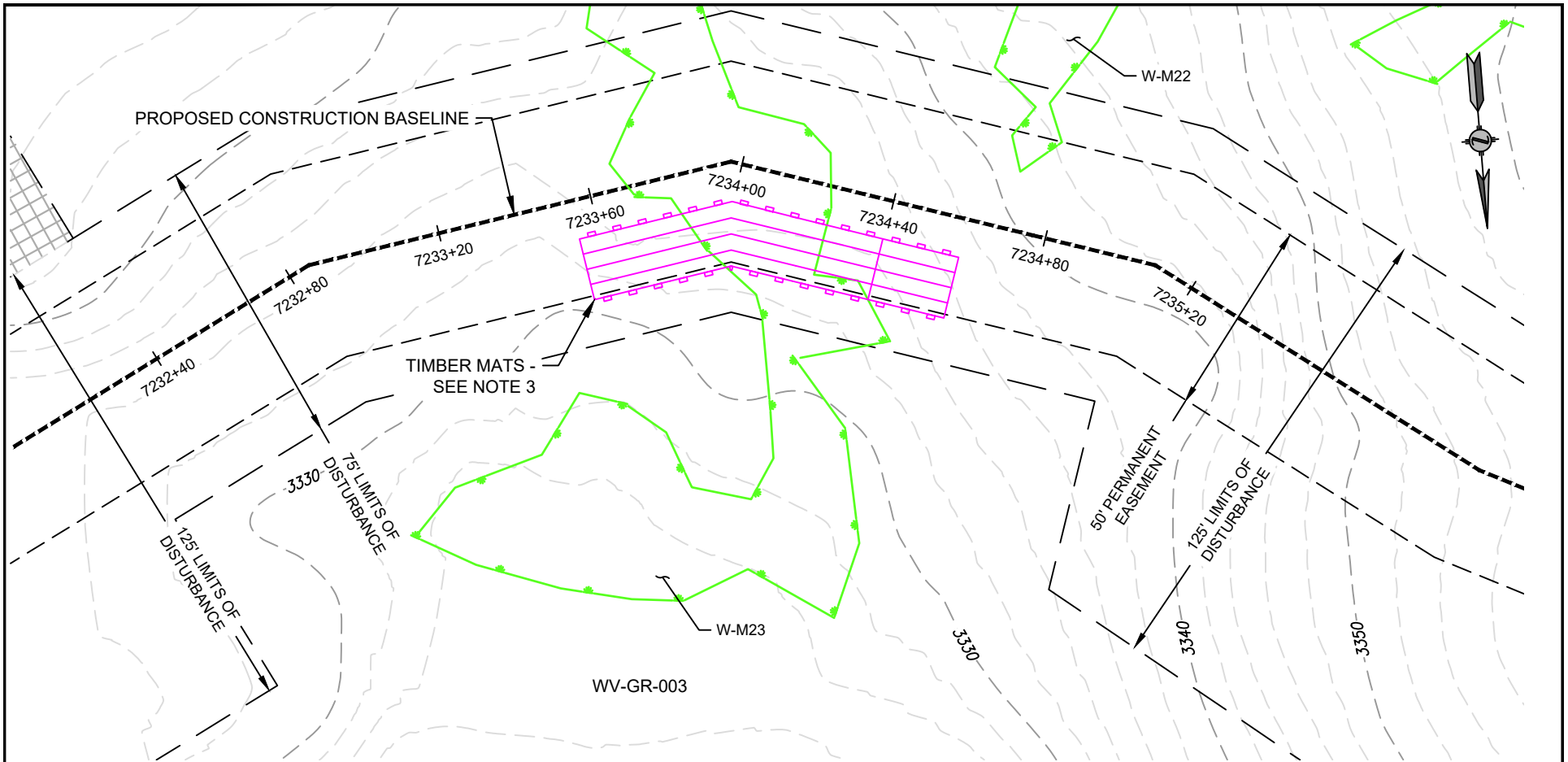

**NOTE:**

1. STATIONING IS BASED UPON IFC ALIGNMENT.
2. EXACT PIPELINE ALIGNMENT SUBJECT TO CHANGE, WITHIN THE EXTENTS OF THE PERMANENT EASEMENT, DEPENDING ON FIELD CONDITIONS. MVP WILL MAINTAIN ELEVATIONS AND MINIMUM DISTANCES FROM RESOURCES AS SHOWN.
3. LOCATION OF TRAVEL LANE AND ASSOCIATED TIMBER MAT/TEMPORARY CONSTRUCTION ACCESS BRIDGE IS FIELD DEPENDENT.
4. FIELD CONDITIONS MAY CHANGE THE LOCATION OF COFFERDAM. LOCATION OF PUMPS AND ENERGY DISSIPATER WILL BE IDENTIFIED IN THE FIELD AND WITHIN THE LOD. APPROVED E&SC BMPS HAVE BEEN REMOVED FOR CLARITY.
5. SPOIL FROM CROSSING TO BE LOCATED MINIMUM 10' FROM BANK.



**LEGEND**

- ORDINARY HIGH WATER MARK
- PROPOSED LIMIT OF DISTURBANCE
- PROPOSED PERMANENT R.O.W.
- CONSTRUCTION BASELINE



ENCOMPASS SERVICES, LLC  
1370 WASHINGTON PIKE, SUITE 308  
BRIDGEVILLE, PA 15017



RESOURCE CROSSING  
RESOURCE NAME: W-M23  
LAT./LONG.= 38.0606677, -80.7223426  
STATION = 7233+69  
COUNTY / STATE: GREENBRIER COUNTY, WV  
REFER TO TABLE 2 (STREAMS) AND TABLE 3 (WETLANDS) IN THE INDIVIDUAL PERMIT APPLICATION

DATE:	02/11/21
PROJECT NO.:	61538
DRAWN BY:	RW
CHECKED BY:	JAW
APPROVED BY:	TN
SHEET:	1 OF 2

DRAWING NUMBER  
E-BP-WV-GR-003-3-OC-REV1

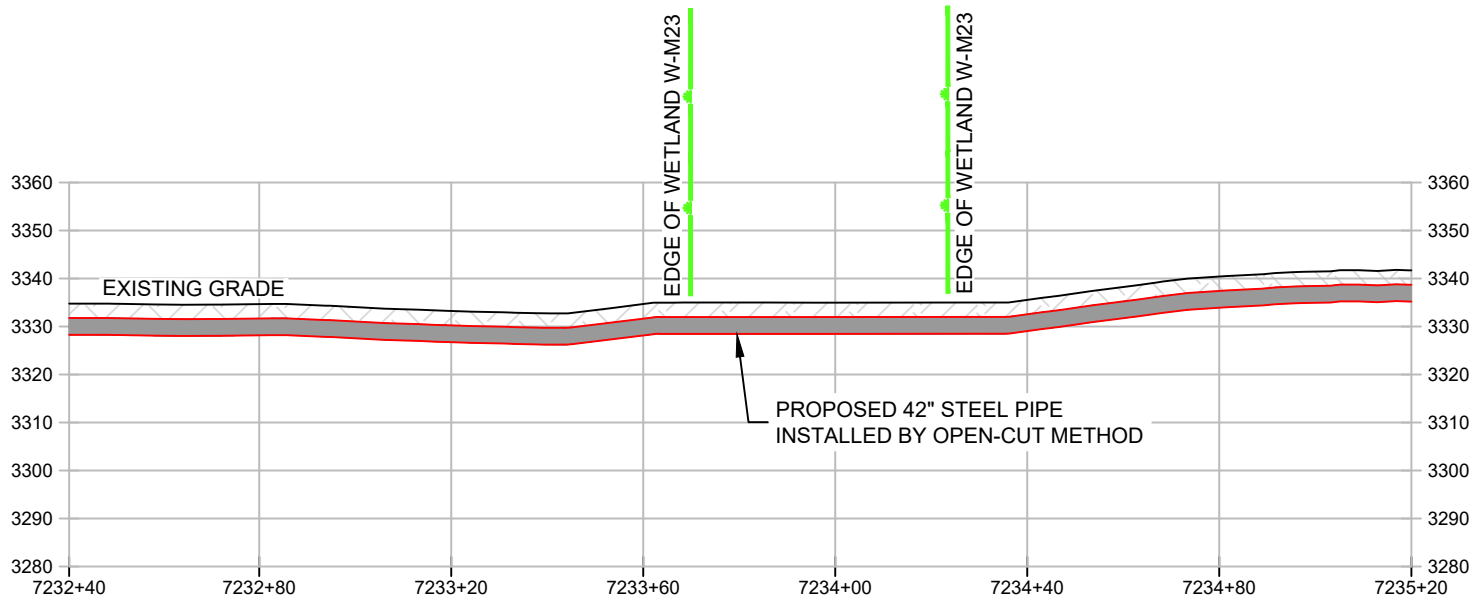

**NOTE:**

1. MINIMUM 3' COVER BETWEEN STREAMBED AND TOP OF PIPELINE UNLESS OTHERWISE NOTED.
2. PROPOSED FILL WILL BE IN TRENCH AND WILL BE RESTORED TO PRE-CONSTRUCTION ELEVATIONS.



ENCOMPASS SERVICES, LLC  
1370 WASHINGTON PIKE, SUITE 308  
BRIDGEVILLE, PA 15017





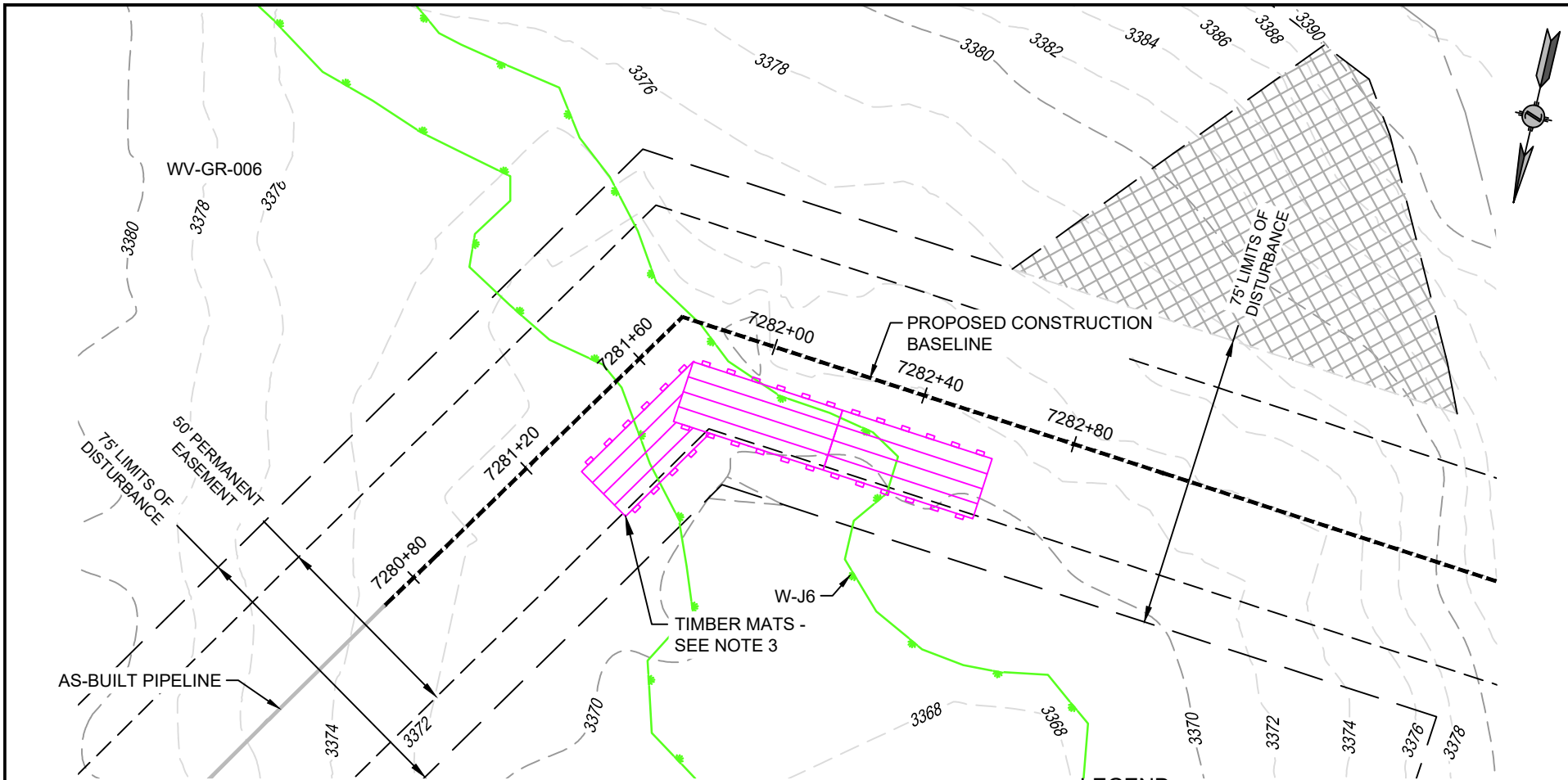

RESOURCE CROSSING  
RESOURCE NAME: W-M23  
LAT./LONG.= 38.0606677, -80.7223426  
STATION = 7233+69  
COUNTY / STATE: GREENBRIER COUNTY, WV  
REFER TO TABLE 2 (STREAMS) AND TABLE 3 (WETLANDS) IN THE INDIVIDUAL PERMIT APPLICATION

DATE:	02/11/21
PROJECT NO.:	61538
DRAWN BY:	RW
CHECKED BY:	JAW
APPROVED BY:	TN
SHEET:	2 OF 2

DRAWING NUMBER  
E-BP-WV-GR-003-3-OC-REV1

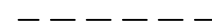

**LEGEND**

-  ORDINARY HIGH WATER MARK
-  PROPOSED LIMIT OF DISTURBANCE
-  PROPOSED PERMANENT R.O.W.
-  CONSTRUCTION BASELINE

- NOTE:**
1. STATIONING IS BASED UPON IFC ALIGNMENT.
  2. EXACT PIPELINE ALIGNMENT SUBJECT TO CHANGE, WITHIN THE EXTENTS OF THE PERMANENT EASEMENT, DEPENDING ON FIELD CONDITIONS. MVP WILL MAINTAIN ELEVATIONS AND MINIMUM DISTANCES FROM RESOURCES AS SHOWN.
  3. LOCATION OF TRAVEL LANE AND ASSOCIATED TIMBER MAT/TEMPORARY CONSTRUCTION ACCESS BRIDGE IS FIELD DEPENDENT.
  4. FIELD CONDITIONS MAY CHANGE THE LOCATION OF COFFERDAM. LOCATION OF PUMPS AND ENERGY DISSIPATER WILL BE IDENTIFIED IN THE FIELD AND WITHIN THE LOD. APPROVED E&SC BMPS HAVE BEEN REMOVED FOR CLARITY.
  5. SPOIL FROM CROSSING TO BE LOCATED MINIMUM 10' FROM BANK.





ENCOMPASS SERVICES, LLC  
1370 WASHINGTON PIKE, SUITE 308  
BRIDGEVILLE, PA 15017

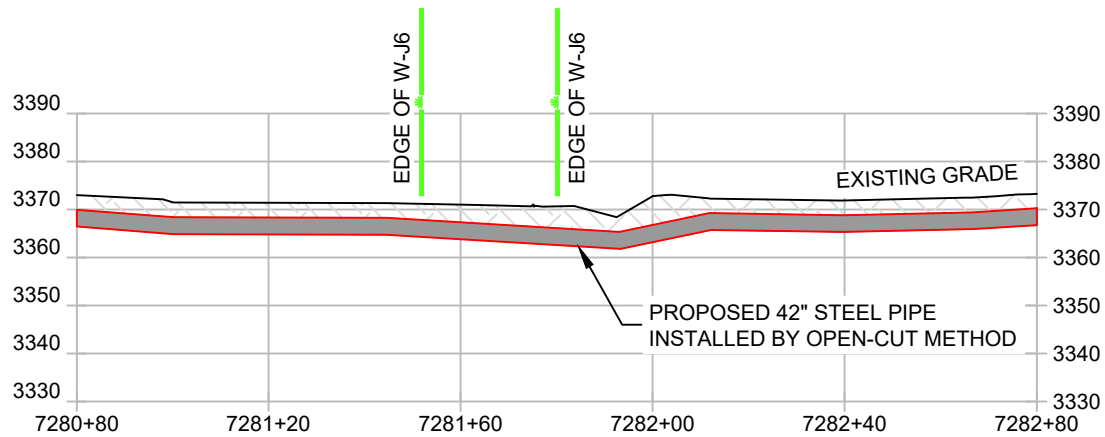

**RESOURCE CROSSING**  
RESOURCE NAME: W-J6  
LAT./LONG. = 38.053341, -80.732161  
STATION = 7281+66  
COUNTY / STATE: GREENBRIER COUNTY, WV  
REFER TO TABLE 2 (STREAMS) AND TABLE 3 (WETLANDS) IN THE INDIVIDUAL PERMIT APPLICATION

DATE:	02/15/21
PROJECT NO.:	61538
DRAWN BY:	CB
CHECKED BY:	JAW
APPROVED BY:	TN
SHEET:	1 OF 2
DRAWING NUMBER E-BP-WV-GR-006-OC-REV3	



**NOTE:**

1. MINIMUM 3' COVER BETWEEN STREAMBED AND TOP OF PIPELINE UNLESS OTHERWISE NOTED.
2. PROPOSED FILL WILL BE IN TRENCH AND WILL BE RESTORED TO PRE-CONSTRUCTION ELEVATIONS.



ENCOMPASS SERVICES, LLC  
1370 WASHINGTON PIKE, SUITE 308  
BRIDGEVILLE, PA 15017



RESOURCE CROSSING  
RESOURCE NAME: W-J6  
LAT./LONG.= 38.053341, -80.732161  
STATION = 7281+66  
COUNTY / STATE: GREENBRIER COUNTY, WV  
REFER TO TABLE 2 (STREAMS) AND TABLE 3 (WETLANDS) IN THE INDIVIDUAL PERMIT APPLICATION

DATE:	02/15/21
PROJECT NO.:	61538
DRAWN BY:	CB
CHECKED BY:	JAW
APPROVED BY:	TN
SHEET:	2 OF 2

DRAWING NUMBER  
E-BP-WV-GR-006-OC-REV3

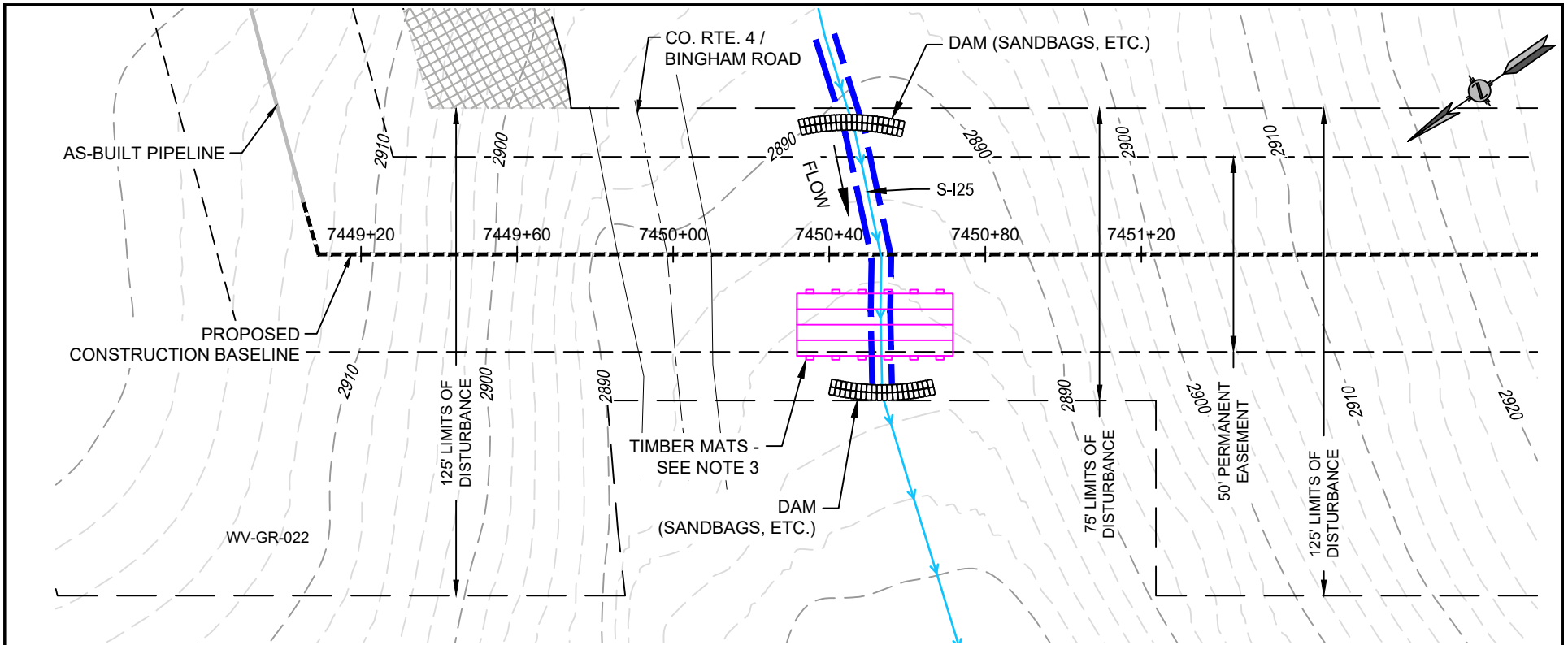

**NOTE:**

1. STATIONING IS BASED UPON IFC ALIGNMENT.
2. EXACT PIPELINE ALIGNMENT SUBJECT TO CHANGE, WITHIN THE EXTENTS OF THE PERMANENT EASEMENT, DEPENDING ON FIELD CONDITIONS. MVP WILL MAINTAIN ELEVATIONS AND MINIMUM DISTANCES FROM RESOURCES AS SHOWN.
3. LOCATION OF TRAVEL LANE AND ASSOCIATED TIMBER MAT/TEMPORARY CONSTRUCTION ACCESS BRIDGE IS FIELD DEPENDENT.
4. FIELD CONDITIONS MAY CHANGE THE LOCATION OF COFFERDAM. LOCATION OF PUMPS AND ENERGY DISSIPATER WILL BE IDENTIFIED IN THE FIELD AND WITHIN THE LOD. APPROVED E&SC BMPS HAVE BEEN REMOVED FOR CLARITY.
5. SPOIL FROM CROSSING TO BE LOCATED MINIMUM 10' FROM BANK.



**LEGEND**

- ORDINARY HIGH WATER MARK
- PROPOSED LIMIT OF DISTURBANCE
- PROPOSED PERMANENT R.O.W.
- CONSTRUCTION BASELINE

ENCOMPASS SERVICES, LLC  
1370 WASHINGTON PIKE, SUITE 308  
BRIDGEVILLE, PA 15017

**RESOURCE CROSSING**  
RESOURCE NAME: S-I25  
LAT./LONG.= 38.0204252, -80.7531983  
STATION = 7450+53  
COUNTY / STATE: GREENBRIER COUNTY, WV  
REFER TO TABLE 2 (STREAMS) AND TABLE 3 (WETLANDS) IN THE INDIVIDUAL PERMIT APPLICATION

DATE:	02/15/21
PROJECT NO.:	61538
DRAWN BY:	CB
CHECKED BY:	JAW
APPROVED BY:	TN
SHEET:	1 OF 2
DRAWING NUMBER E-BP-WV-GR-022-1-OC_REV2	

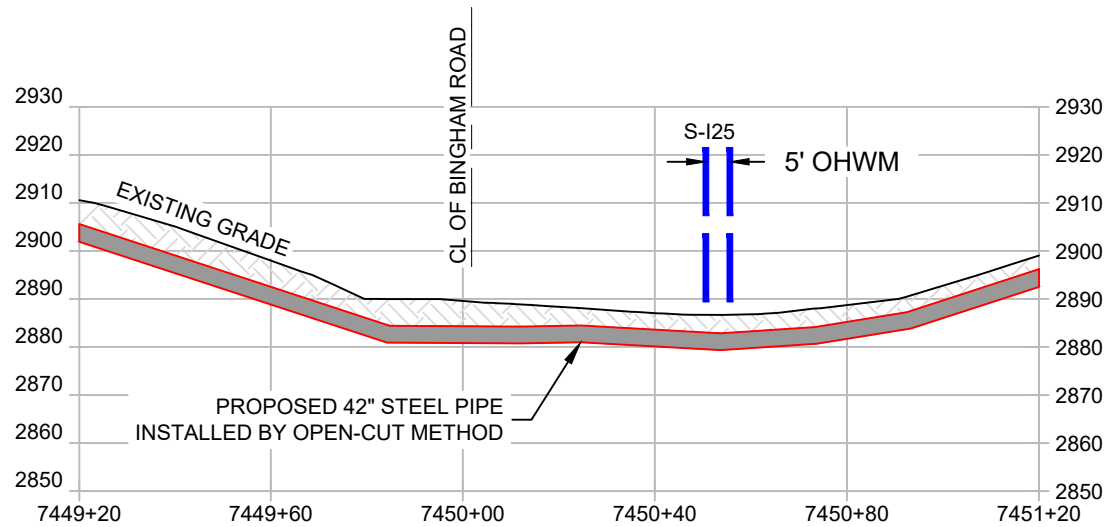

**NOTE:**

1. MINIMUM 3' COVER BETWEEN STREAMBED AND TOP OF PIPELINE UNLESS OTHERWISE NOTED.
2. PROPOSED FILL WILL BE IN TRENCH AND WILL BE RESTORED TO PRE-CONSTRUCTION ELEVATIONS.



ENCOMPASS SERVICES, LLC  
1370 WASHINGTON PIKE, SUITE 308  
BRIDGEVILLE, PA 15017



RESOURCE CROSSING  
RESOURCE NAME: S-I25  
LAT./LONG. = 38.0204252, -80.7531983  
STATION = 7450+53  
COUNTY / STATE: GREENBRIER COUNTY, WV  
REFER TO TABLE 2 (STREAMS) AND TABLE 3 (WETLANDS) IN THE INDIVIDUAL PERMIT APPLICATION

DATE:	02/15/21
PROJECT NO.:	61538
DRAWN BY:	CB
CHECKED BY:	JAW
APPROVED BY:	TN
SHEET:	2 OF 2

DRAWING NUMBER  
E-BP-WV-GR-022-1-OC\_REV2



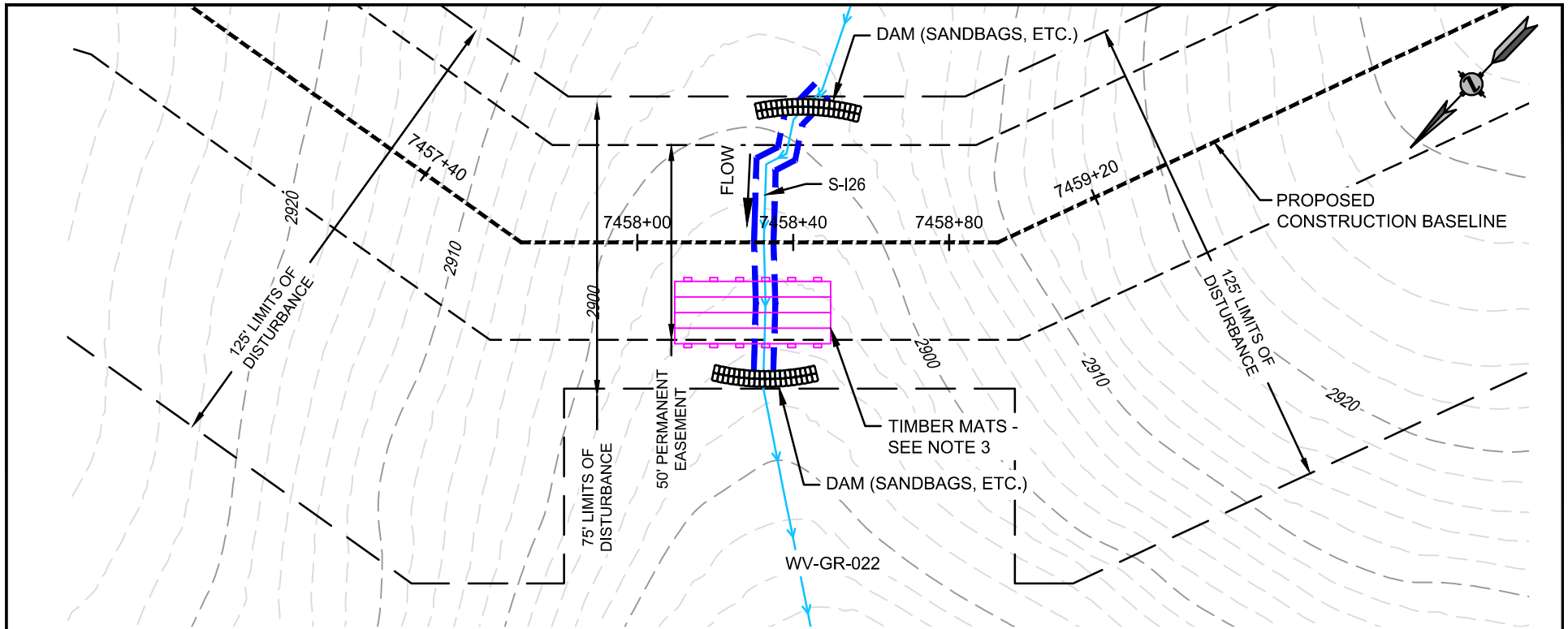

**NOTE:**

1. STATIONING IS BASED UPON IFC ALIGNMENT.
2. EXACT PIPELINE ALIGNMENT SUBJECT TO CHANGE, WITHIN THE EXTENTS OF THE PERMANENT EASEMENT, DEPENDING ON FIELD CONDITIONS. MVP WILL MAINTAIN ELEVATIONS AND MINIMUM DISTANCES FROM RESOURCES AS SHOWN.
3. LOCATION OF TRAVEL LANE AND ASSOCIATED TIMBER MAT/TEMPORARY CONSTRUCTION ACCESS BRIDGE IS FIELD DEPENDENT.
4. FIELD CONDITIONS MAY CHANGE THE LOCATION OF COFFERDAM. LOCATION OF PUMPS AND ENERGY DISSIPATER WILL BE IDENTIFIED IN THE FIELD AND WITHIN THE LOD. APPROVED E&SC BMPS HAVE BEEN REMOVED FOR CLARITY.
5. SPOIL FROM CROSSING TO BE LOCATED MINIMUM 10' FROM BANK.



**LEGEND**

- ORDINARY HIGH WATER MARK
- PROPOSED LIMIT OF DISTURBANCE
- PROPOSED PERMANENT R.O.W.
- CONSTRUCTION BASELINE



ENCOMPASS SERVICES, LLC  
1370 WASHINGTON PIKE, SUITE 308  
BRIDGEVILLE, PA 15017



**RESOURCE CROSSING**  
RESOURCE NAME: S-I26  
LAT./LONG.= 38.019127, -80.755217  
STATION = 7458+33  
COUNTY / STATE: GREENBRIER COUNTY, WV  
REFER TO TABLE 2 (STREAMS) AND TABLE 3 (WETLANDS) IN THE INDIVIDUAL PERMIT APPLICATION

DATE:	02/11/21
PROJECT NO.:	61538
DRAWN BY:	CB
CHECKED BY:	JAW
APPROVED BY:	TN
SHEET:	1 OF 2
DRAWING NUMBER E-BP-WV-GR-022-OC_REV1	

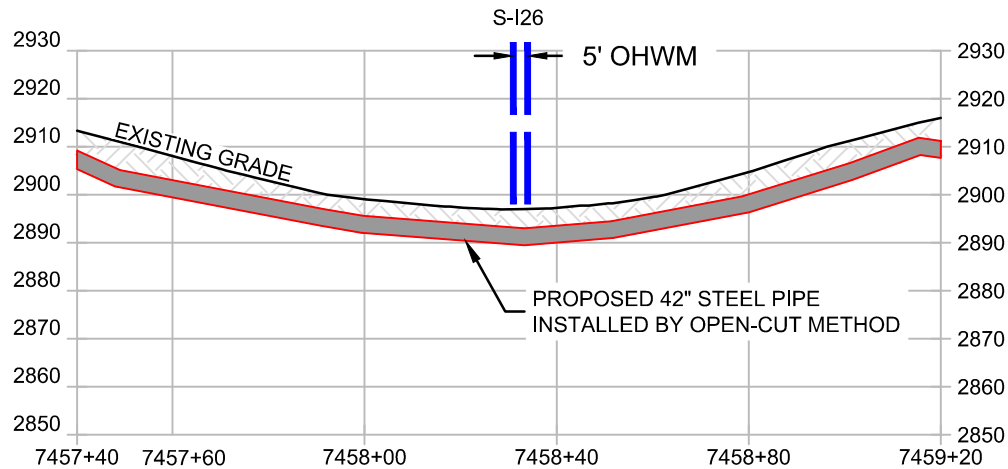

**NOTE:**

1. MINIMUM 3' COVER BETWEEN STREAMBED AND TOP OF PIPELINE UNLESS OTHERWISE NOTED.
2. PROPOSED FILL WILL BE IN TRENCH AND WILL BE RESTORED TO PRE-CONSTRUCTION ELEVATIONS.



ENCOMPASS SERVICES, LLC  
1370 WASHINGTON PIKE, SUITE 308  
BRIDGEVILLE, PA 15017



RESOURCE CROSSING  
RESOURCE NAME: S-I26  
LAT./LONG.= 38.019127, -80.755217  
STATION = 7458+33  
COUNTY / STATE: GREENBRIER COUNTY, WV  
REFER TO TABLE 2 (STREAMS) AND TABLE 3  
(WETLANDS) IN THE INDIVIDUAL PERMIT  
APPLICATION

DATE:	02/11/21
PROJECT NO.:	61538
DRAWN BY:	CB
CHECKED BY:	JAW
APPROVED BY:	TN
SHEET:	2 OF 2

DRAWING NUMBER  
E-BP-WV-GR-022-OC\_REV1

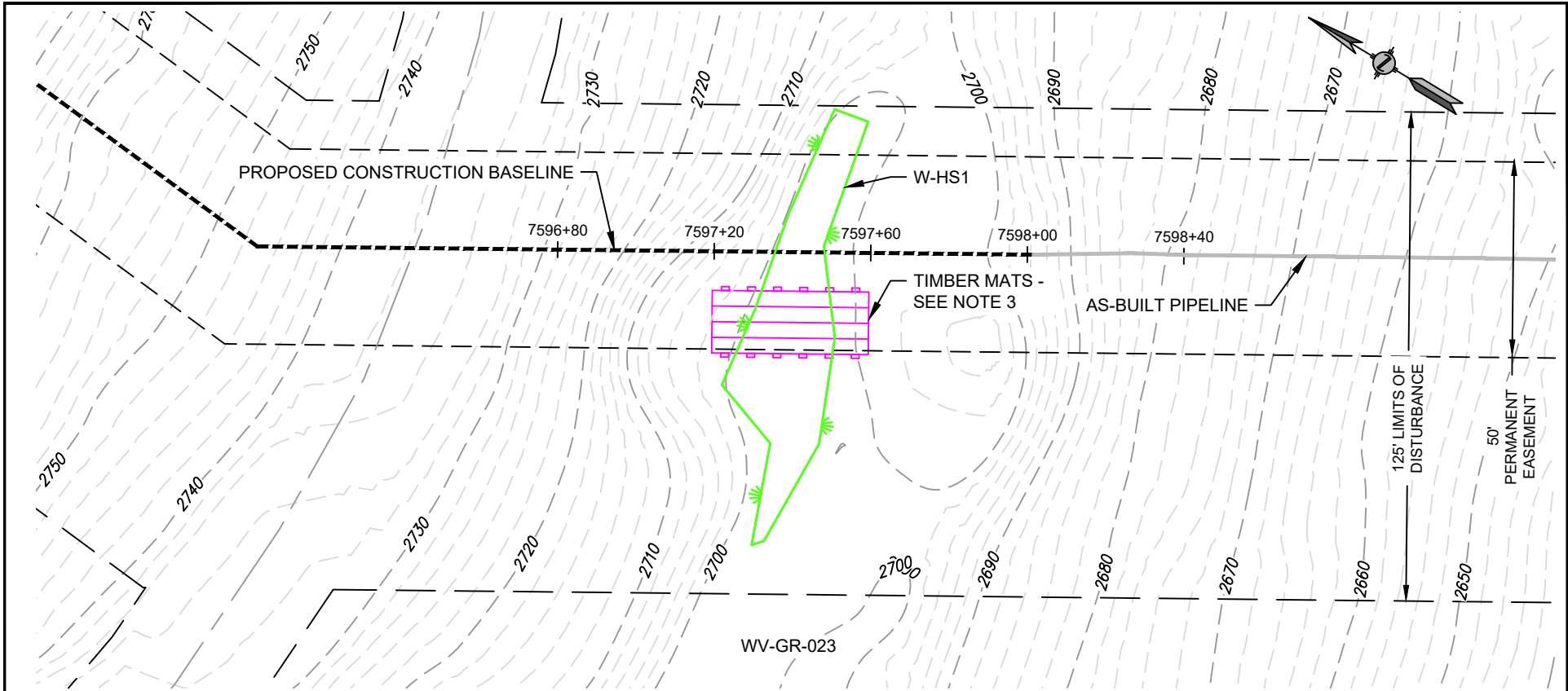

**NOTE:**

1. STATIONING IS BASED UPON IFC ALIGNMENT.
2. EXACT PIPELINE ALIGNMENT SUBJECT TO CHANGE, WITHIN THE EXTENTS OF THE PERMANENT EASEMENT, DEPENDING ON FIELD CONDITIONS. MVP WILL MAINTAIN ELEVATIONS AND MINIMUM DISTANCES FROM RESOURCES AS SHOWN.
3. LOCATION OF TRAVEL LANE AND ASSOCIATED TIMBER MAT/TEMPORARY CONSTRUCTION ACCESS BRIDGE IS FIELD DEPENDENT.
4. FIELD CONDITIONS MAY CHANGE THE LOCATION OF COFFERDAM. LOCATION OF PUMPS AND ENERGY DISSIPATER WILL BE IDENTIFIED IN THE FIELD AND WITHIN THE LOD. APPROVED E&SC BMPS HAVE BEEN REMOVED FOR CLARITY.
5. SPOIL FROM CROSSING TO BE LOCATED MINIMUM 10' FROM BANK.



**LEGEND**

- ORDINARY HIGH WATER MARK
- PROPOSED LIMIT OF DISTURBANCE
- PROPOSED PERMANENT R.O.W.
- CONSTRUCTION BASELINE

ENCOMPASS SERVICES, LLC  
1370 WASHINGTON PIKE, SUITE 308  
BRIDGEVILLE, PA 15017

RESOURCE CROSSING  
RESOURCE NAME: W-HS1  
LAT./LONG.= 37.9864745, -80.7583565  
STATION = 7597+44  
COUNTY / STATE: GREENBRIER COUNTY, WV  
REFER TO TABLE 2 (STREAMS) AND TABLE 3 (WETLANDS) IN THE INDIVIDUAL PERMIT APPLICATION

DATE:	02/11/21
PROJECT NO.:	61538
DRAWN BY:	RW
CHECKED BY:	JAW
APPROVED BY:	TN
SHEET:	1 OF 2
DRAWING NUMBER E-BP-WV-GR-023-OC_REV1	

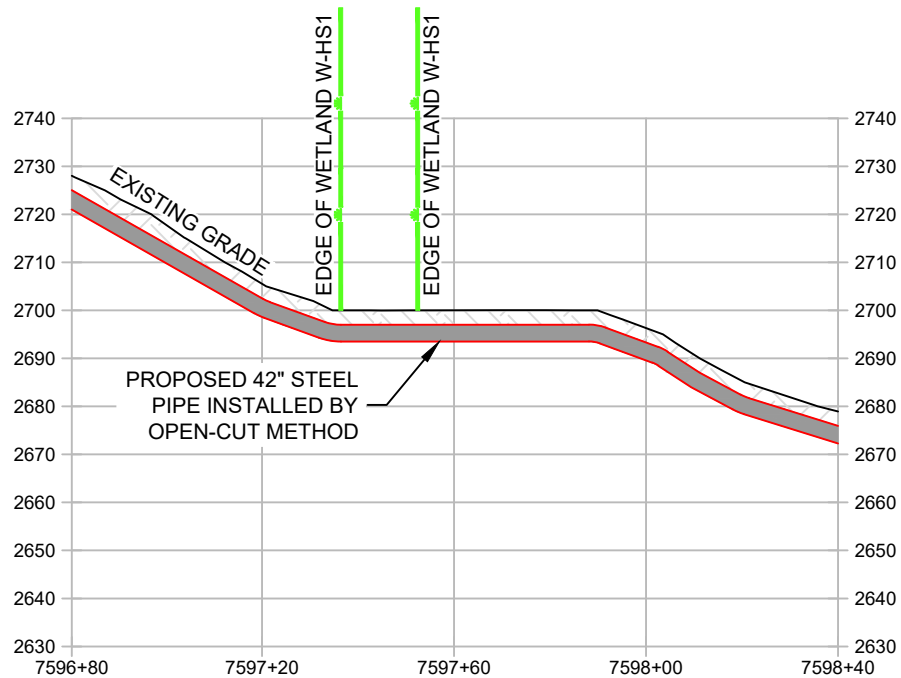

**NOTE:**

1. MINIMUM 3' COVER BETWEEN STREAMBED AND TOP OF PIPELINE UNLESS OTHERWISE NOTED.
2. PROPOSED FILL WILL BE IN TRENCH AND WILL BE RESTORED TO PRE-CONSTRUCTION ELEVATIONS.



ENCOMPASS SERVICES, LLC  
1370 WASHINGTON PIKE, SUITE 308  
BRIDGEVILLE, PA 15017



RESOURCE CROSSING  
RESOURCE NAME: W-HS1  
LAT./LONG.= 37.9864745, -80.7583565  
STATION = 7597+44  
COUNTY / STATE: GREENBRIER COUNTY, WV  
REFER TO TABLE 2 (STREAMS) AND TABLE 3 (WETLANDS) IN THE INDIVIDUAL PERMIT APPLICATION

DATE:	02/11/21
PROJECT NO.:	61538
DRAWN BY:	RW
CHECKED BY:	JAW
APPROVED BY:	TN
SHEET:	2 OF 2

DRAWING NUMBER  
E-BP-WV-GR-023-OC\_REV1

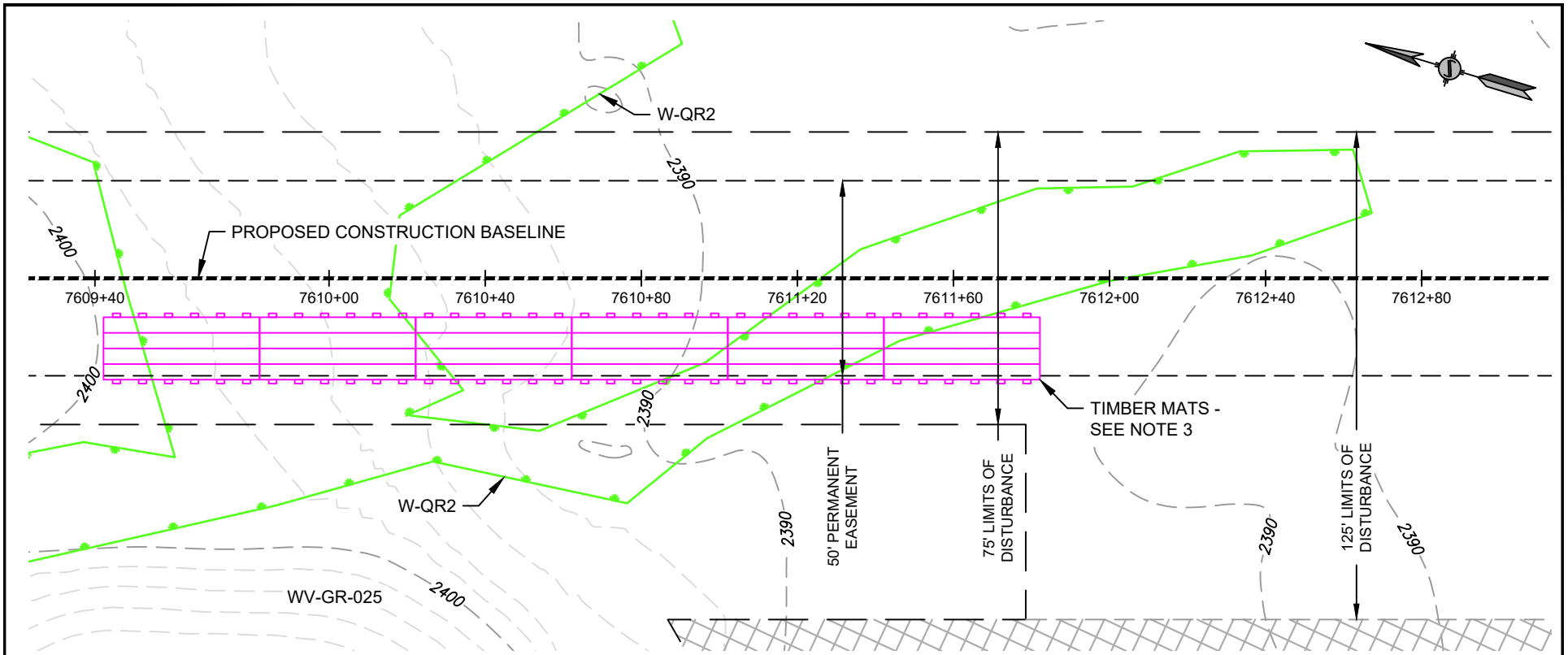

**NOTE:**

1. STATIONING IS BASED UPON IFC ALIGNMENT.
2. EXACT PIPELINE ALIGNMENT SUBJECT TO CHANGE, WITHIN THE EXTENTS OF THE PERMANENT EASEMENT, DEPENDING ON FIELD CONDITIONS. MVP WILL MAINTAIN ELEVATIONS AND MINIMUM DISTANCES FROM RESOURCES AS SHOWN.
3. LOCATION OF TRAVEL LANE AND ASSOCIATED TIMBER MAT/TEMPORARY CONSTRUCTION ACCESS BRIDGE IS FIELD DEPENDENT.
4. FIELD CONDITIONS MAY CHANGE THE LOCATION OF COFFERDAM. LOCATION OF PUMPS AND ENERGY DISSIPATER WILL BE IDENTIFIED IN THE FIELD AND WITHIN THE LOD. APPROVED E&SC BMPS HAVE BEEN REMOVED FOR CLARITY.
5. SPOIL FROM CROSSING TO BE LOCATED MINIMUM 10' FROM BANK.



**LEGEND**

- ORDINARY HIGH WATER MARK
- PROPOSED LIMIT OF DISTURBANCE
- PROPOSED PERMANENT R.O.W.
- CONSTRUCTION BASELINE



ENCOMPASS SERVICES, LLC  
1370 WASHINGTON PIKE, SUITE 308  
BRIDGEVILLE, PA 15017



RESOURCE CROSSING  
RESOURCE CROSSING: W-QR2  
LAT./LONG.= 37.9831815, -80.7560910  
STATION = 7610+76  
COUNTY / STATE: GREENBRIER COUNTY, WV  
REFER TO TABLE 2 (STREAMS) AND TABLE 3 (WETLANDS) IN THE INDIVIDUAL PERMIT APPLICATION

DATE:	02/16/21
PROJECT NO.:	61538
DRAWN BY:	RW
CHECKED BY:	JAW
APPROVED BY:	TN
SHEET:	1 OF 2
DRAWING NUMBER E-BP-WV-GR-025-OC_REV3	

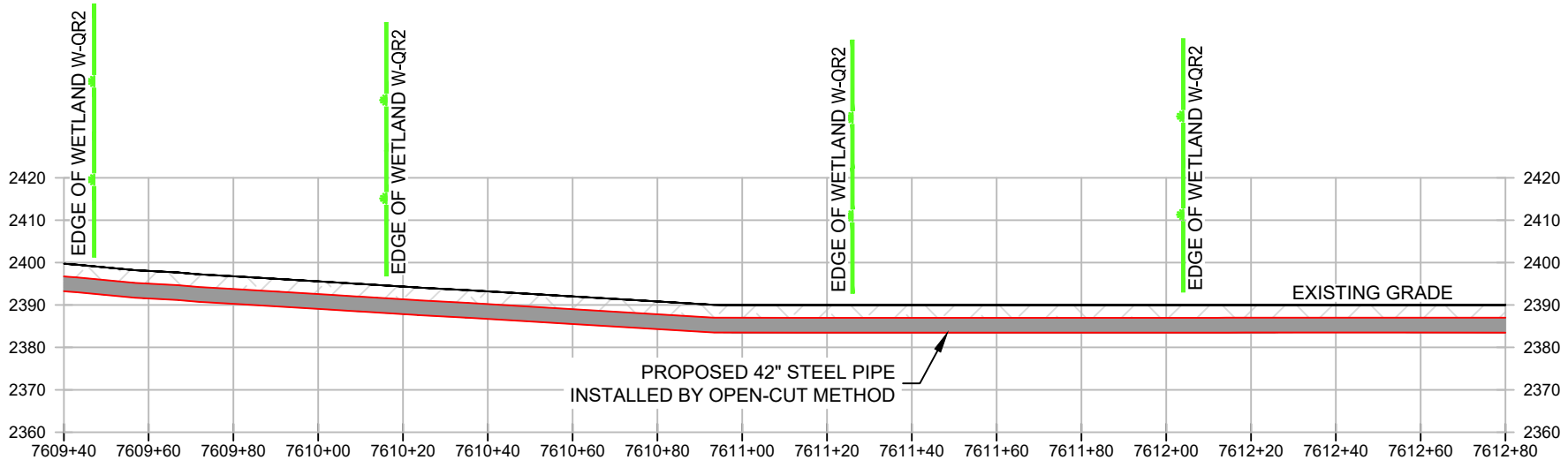

**NOTE:**

1. MINIMUM 3' COVER BETWEEN STREAMBED AND TOP OF PIPELINE UNLESS OTHERWISE NOTED.
2. PROPOSED FILL WILL BE IN TRENCH AND WILL BE RESTORED TO PRE-CONSTRUCTION ELEVATIONS.



ENCOMPASS SERVICES, LLC  
1370 WASHINGTON PIKE, SUITE 308  
BRIDGEVILLE, PA 15017



RESOURCE CROSSING  
RESOURCE CROSSING: W-QR2  
LAT./LONG.= 37.9831815, -80.7560910  
STATION = 7610+76  
COUNTY / STATE: GREENBRIER COUNTY, WV  
REFER TO TABLE 2 (STREAMS) AND TABLE 3  
(WETLANDS) IN THE INDIVIDUAL PERMIT  
APPLICATION

DATE:	02/16/21
PROJECT NO.:	61538
DRAWN BY:	RW
CHECKED BY:	JAW
APPROVED BY:	TN
SHEET:	2 OF 2

DRAWING NUMBER  
E-BP-WV-GR-025-OC\_REV3

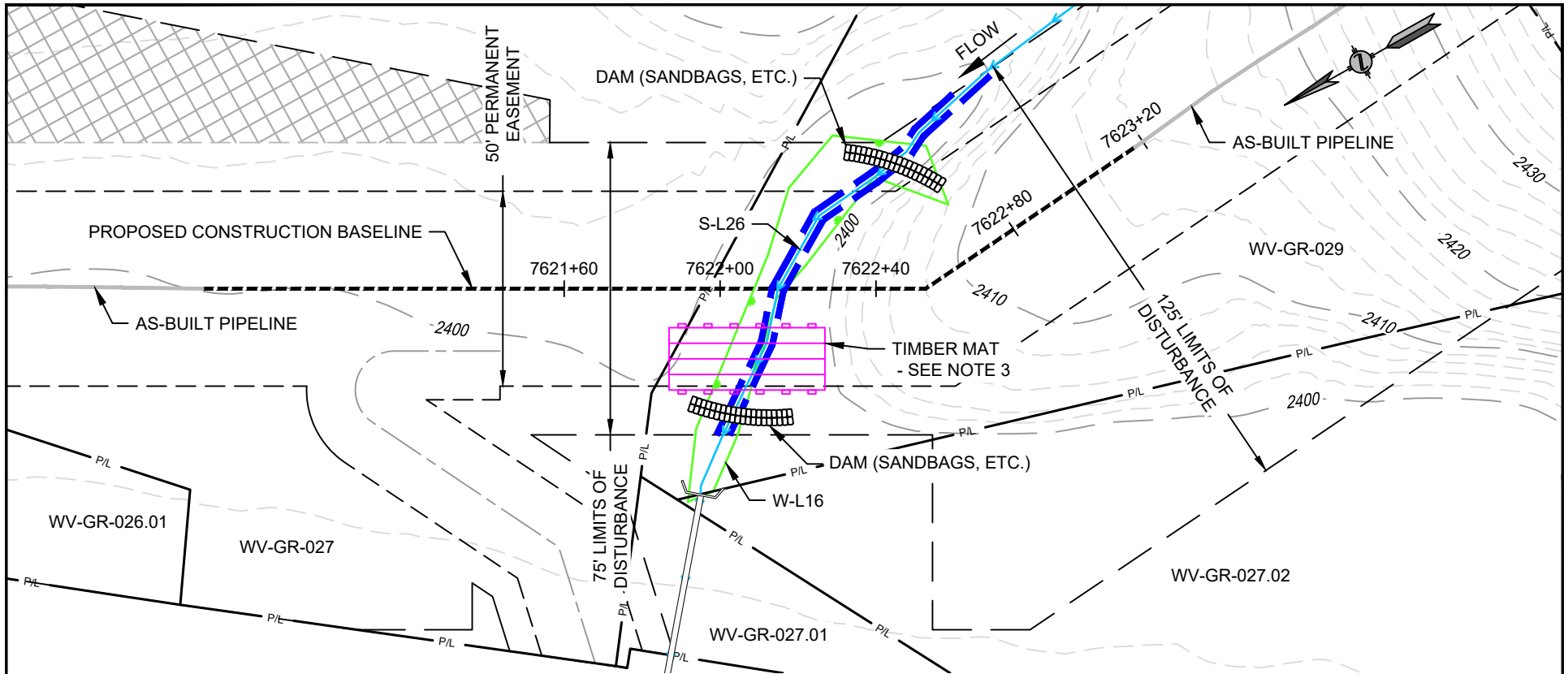

**NOTE:**

1. STATIONING IS BASED UPON IFC ALIGNMENT.
2. EXACT PIPELINE ALIGNMENT SUBJECT TO CHANGE, WITHIN THE EXTENTS OF THE PERMANENT EASEMENT, DEPENDING ON FIELD CONDITIONS. MVP WILL MAINTAIN ELEVATIONS AND MINIMUM DISTANCES FROM RESOURCES AS SHOWN.
3. LOCATION OF TRAVEL LANE AND ASSOCIATED TIMBER MAT/TEMPORARY CONSTRUCTION ACCESS BRIDGE IS FIELD DEPENDENT.
4. FIELD CONDITIONS MAY CHANGE THE LOCATION OF COFFERDAM. LOCATION OF PUMPS AND ENERGY DISSIPATER WILL BE IDENTIFIED IN THE FIELD AND WITHIN THE LOD. APPROVED E&SC BMPS HAVE BEEN REMOVED FOR CLARITY.
5. SPOIL FROM CROSSING TO BE LOCATED MINIMUM 10' FROM BANK.



**LEGEND**

- ORDINARY HIGH WATER MARK
- PROPOSED LIMIT OF DISTURBANCE
- PROPOSED PERMANENT R.O.W.
- CONSTRUCTION BASELINE

ENCOMPASS SERVICES, LLC  
1370 WASHINGTON PIKE, SUITE 308  
BRIDGEVILLE, PA 15017

**RESOURCE CROSSING**  
RESOURCE NAME: S-L26 / W-L16  
LAT./LONG. = 37.980684, -80.754924  
STATION = 7622+15  
COUNTY / STATE: GREENBRIER COUNTY, WV  
REFER TO TABLE 2 (STREAMS) AND TABLE 3 (WETLANDS) IN THE INDIVIDUAL PERMIT APPLICATION

DATE:	02/16/21
PROJECT NO.:	61538
DRAWN BY:	AMM
CHECKED BY:	JAW
APPROVED BY:	TN
SHEET:	1 OF 2
DRAWING NUMBER E-BP-WV-GR-027-OC_REV2	

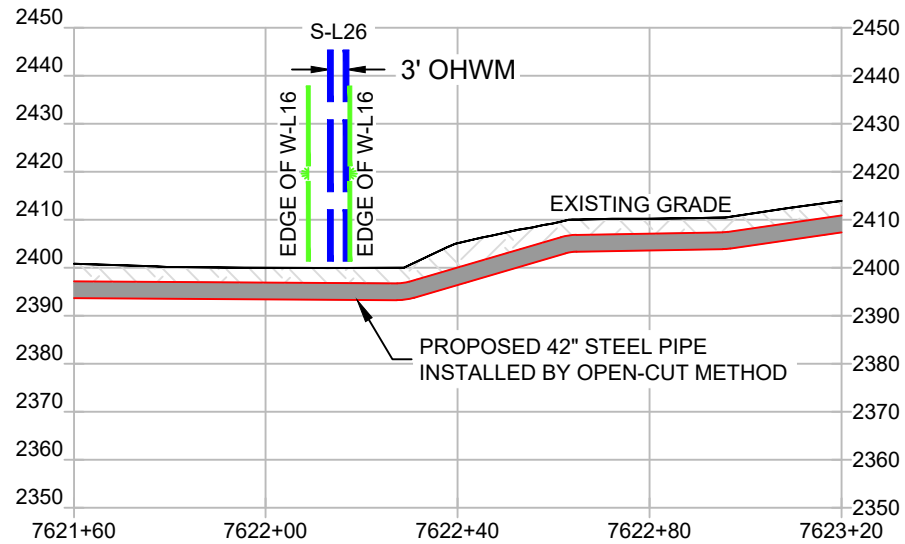

**NOTE:**

1. MINIMUM 3' COVER BETWEEN STREAMBED AND TOP OF PIPELINE UNLESS OTHERWISE NOTED.
2. PROPOSED FILL WILL BE IN TRENCH AND WILL BE RESTORED TO PRE-CONSTRUCTION ELEVATIONS.



ENCOMPASS SERVICES, LLC  
 1370 WASHINGTON PIKE, SUITE 308  
 BRIDGEVILLE, PA 15017



RESOURCE CROSSING  
 RESOURCE NAME: S-L26 / W-L16  
 LAT./LONG.= 37.980684, -80.754924  
 STATION = 7622+15  
 COUNTY / STATE: GREENBRIER COUNTY, WV  
 REFER TO TABLE 2 (STREAMS) AND TABLE 3  
 (WETLANDS) IN THE INDIVIDUAL PERMIT  
 APPLICATION

DATE:	02/16/21
PROJECT NO.:	61538
DRAWN BY:	AMM
CHECKED BY:	JAW
APPROVED BY:	TN
SHEET:	2 OF 2

DRAWING NUMBER  
 E-BP-WV-GR-027-OC\_REV2





**NOTE:**

1. STATIONING IS BASED UPON IFC ALIGNMENT.
2. EXACT PIPELINE ALIGNMENT SUBJECT TO CHANGE, WITHIN THE EXTENTS OF THE PERMANENT EASEMENT, DEPENDING ON FIELD CONDITIONS. MVP WILL MAINTAIN ELEVATIONS AND MINIMUM DISTANCES FROM RESOURCES AS SHOWN.
3. LOCATION OF TRAVEL LANE AND ASSOCIATED TIMBER MAT/TEMPORARY CONSTRUCTION ACCESS BRIDGE IS FIELD DEPENDENT.
4. FIELD CONDITIONS MAY CHANGE THE LOCATION OF COFFERDAM. LOCATION OF PUMPS AND ENERGY DISSIPATER WILL BE IDENTIFIED IN THE FIELD AND WITHIN THE LOD. APPROVED E&SC BMPS HAVE BEEN REMOVED FOR CLARITY.
5. SPOIL FROM CROSSING TO BE LOCATED MINIMUM 10' FROM BANK.



**LEGEND**

- ORDINARY HIGH WATER MARK
- PROPOSED LIMIT OF DISTURBANCE
- PROPOSED PERMANENT R.O.W.
- CONSTRUCTION BASELINE

ENCOMPASS SERVICES, LLC  
1370 WASHINGTON PIKE, SUITE 308  
BRIDGEVILLE, PA 15017

**RESOURCE CROSSING**  
RESOURCE NAME: S-L30, W-L19, W-L12, W-L13, S-L22  
LAT./LONG.= 37.9539758, -80.7398882  
STATION =7771+03  
COUNTY / STATE: GREENBRIER COUNTY, WV  
REFER TO TABLE 2 (STREAMS) AND TABLE 3 (WETLANDS) IN THE INDIVIDUAL PERMIT APPLICATION

DATE:	02/13/21
PROJECT NO.:	61538
DRAWN BY:	JGG
CHECKED BY:	JAW
APPROVED BY:	TN
SHEET:	1 OF 2
DRAWING NUMBER E-BP-WV-GR-035-OC_REV1	

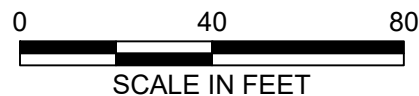
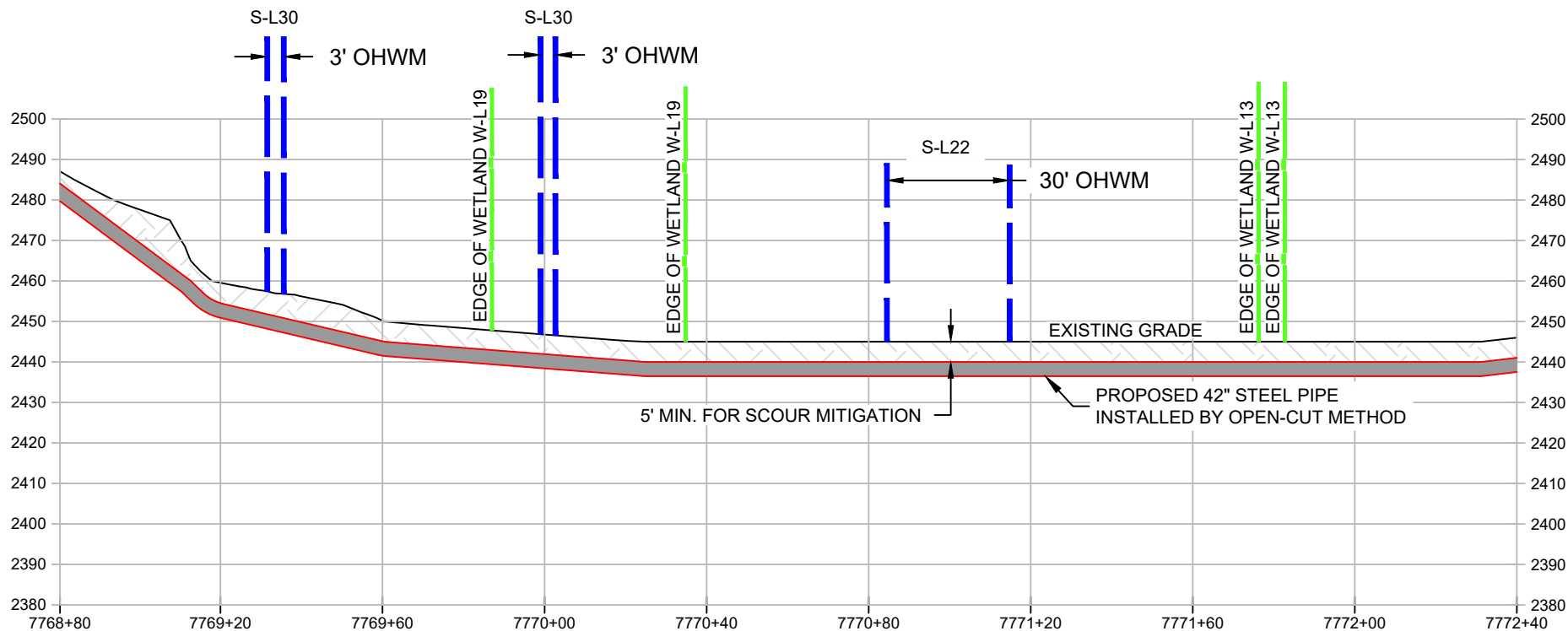

**NOTE:**

1. MINIMUM 3' COVER BETWEEN STREAMBED AND TOP OF PIPELINE UNLESS OTHERWISE NOTED.
2. PROPOSED FILL WILL BE IN TRENCH AND WILL BE RESTORED TO PRE-CONSTRUCTION ELEVATIONS.



ENCOMPASS SERVICES, LLC  
1370 WASHINGTON PIKE, SUITE 308  
BRIDGEVILLE, PA 15017



**RESOURCE CROSSING**  
RESOURCE NAME: S-L30, W-L19, W-L12, W-L13, S-L22  
LAT./LONG.= 37.9539758, -80.7398882  
STATION =7771+03  
COUNTY / STATE: GREENBRIER COUNTY, WV  
REFER TO TABLE 2 (STREAMS) AND TABLE 3 (WETLANDS) IN THE INDIVIDUAL PERMIT APPLICATION

DATE:	02/13/21
PROJECT NO.:	61538
DRAWN BY:	JGG
CHECKED BY:	JAW
APPROVED BY:	TN
SHEET:	2 OF 2

DRAWING NUMBER  
E-BP-WV-GR-035-OC\_REV1

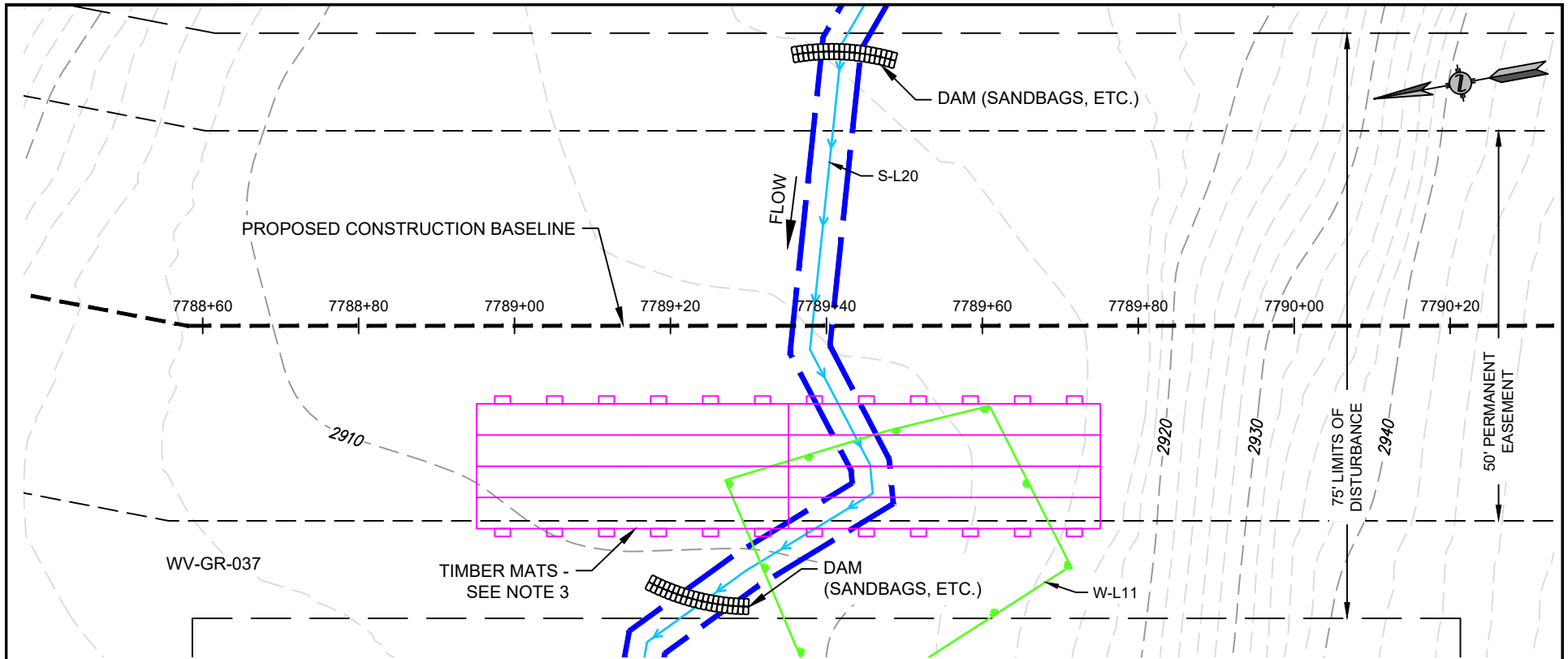

**NOTE:**

1. STATIONING IS BASED UPON IFC ALIGNMENT.
2. EXACT PIPELINE ALIGNMENT SUBJECT TO CHANGE, WITHIN THE EXTENTS OF THE PERMANENT EASEMENT, DEPENDING ON FIELD CONDITIONS. MVP WILL MAINTAIN ELEVATIONS AND MINIMUM DISTANCES FROM RESOURCES AS SHOWN.
3. LOCATION OF TRAVEL LANE AND ASSOCIATED TIMBER MAT/TEMPORARY CONSTRUCTION ACCESS BRIDGE IS FIELD DEPENDENT.
4. FIELD CONDITIONS MAY CHANGE THE LOCATION OF COFFERDAM. LOCATION OF PUMPS AND ENERGY DISSIPATER WILL BE IDENTIFIED IN THE FIELD AND WITHIN THE LOD. APPROVED E&SC BMPS HAVE BEEN REMOVED FOR CLARITY.
5. SPOIL FROM CROSSING TO BE LOCATED MINIMUM 10' FROM BANK.



**LEGEND**

- ORDINARY HIGH WATER MARK
- PROPOSED LIMIT OF DISTURBANCE
- PROPOSED PERMANENT R.O.W.
- CONSTRUCTION BASELINE

ENCOMPASS SERVICES, LLC  
1370 WASHINGTON PIKE, SUITE 308  
BRIDGEVILLE, PA 15017

RESOURCE CROSSING  
RESOURCE NAME: S-L20  
LAT./LONG.= 37.9495779, -80.7426208  
STATION = 7789+39  
COUNTY / STATE: GREENBRIER COUNTY, WV  
REFER TO TABLE 2 (STREAMS) AND TABLE 3 (WETLANDS) IN THE INDIVIDUAL PERMIT APPLICATION

DATE:	02/16/21
PROJECT NO.:	61538
DRAWN BY:	RW
CHECKED BY:	JAW
APPROVED BY:	TN
SHEET:	1 OF 2
DRAWING NUMBER E-BP-WV-GR-037-OC_REV3	

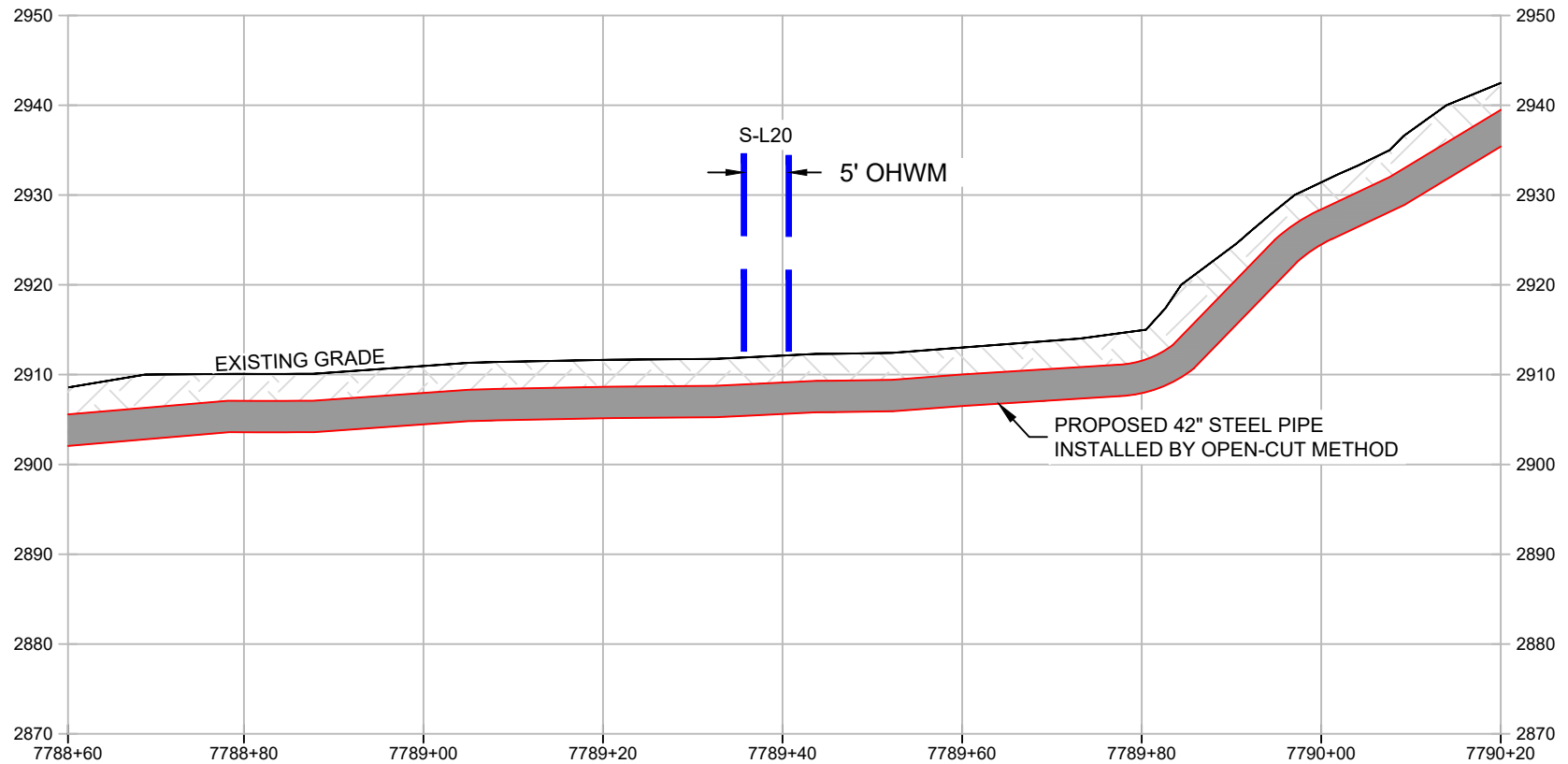

**NOTE:**

1. MINIMUM 3' COVER BETWEEN STREAMBED AND TOP OF PIPELINE UNLESS OTHERWISE NOTED.
2. PROPOSED FILL WILL BE IN TRENCH AND WILL BE RESTORED TO PRE-CONSTRUCTION ELEVATIONS.



ENCOMPASS SERVICES, LLC  
1370 WASHINGTON PIKE, SUITE 308  
BRIDGEVILLE, PA 15017



RESOURCE CROSSING  
RESOURCE NAME: S-L20  
LAT./LONG.= 37.9495779, -80.7426208  
STATION = 7789+39  
COUNTY / STATE: GREENBRIER COUNTY, WV  
REFER TO TABLE 2 (STREAMS) AND TABLE 3 (WETLANDS) IN THE INDIVIDUAL PERMIT APPLICATION

DATE:	02/16/21
PROJECT NO.:	61538
DRAWN BY:	RW
CHECKED BY:	JAW
APPROVED BY:	TN
SHEET:	2 OF 2

DRAWING NUMBER  
E-BP-WV-GR-037-OC\_REV3

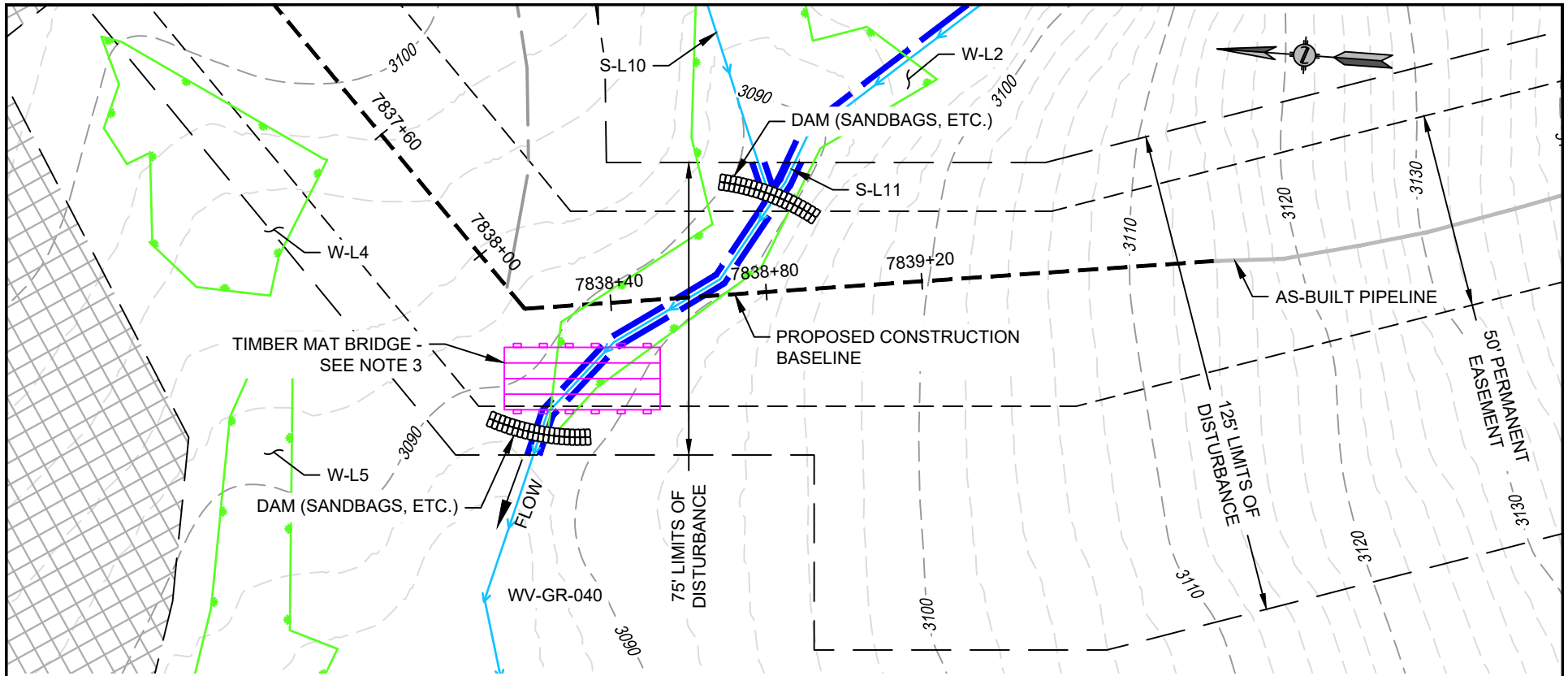

**NOTE:**

1. STATIONING IS BASED UPON IFC ALIGNMENT.
2. EXACT PIPELINE ALIGNMENT SUBJECT TO CHANGE, WITHIN THE EXTENTS OF THE PERMANENT EASEMENT, DEPENDING ON FIELD CONDITIONS. MVP WILL MAINTAIN ELEVATIONS AND MINIMUM DISTANCES FROM RESOURCES AS SHOWN.
3. LOCATION OF TRAVEL LANE AND ASSOCIATED TIMBER MAT/TEMPORARY CONSTRUCTION ACCESS BRIDGE IS FIELD DEPENDENT.
4. FIELD CONDITIONS MAY CHANGE THE LOCATION OF COFFERDAM. LOCATION OF PUMPS AND ENERGY DISSIPATER WILL BE IDENTIFIED IN THE FIELD AND WITHIN THE LOD. APPROVED E&SC BMPS HAVE BEEN REMOVED FOR CLARITY.
5. SPOIL FROM CROSSING TO BE LOCATED MINIMUM 10' FROM BANK.



**LEGEND**

- ORDINARY HIGH WATER MARK
- PROPOSED LIMIT OF DISTURBANCE
- PROPOSED PERMANENT R.O.W.
- CONSTRUCTION BASELINE



ENCOMPASS SERVICES, LLC  
1370 WASHINGTON PIKE, SUITE 308  
BRIDGEVILLE, PA 15017



RESOURCE CROSSING  
RESOURCE NAME: S-L10 / W-L2  
LAT./LONG.= 37.938282, -80.746997  
STATION = 7838+60  
COUNTY / STATE: GREENBRIER COUNTY, WV  
REFER TO TABLE 2 (STREAMS) AND TABLE 3 (WETLANDS) IN THE INDIVIDUAL PERMIT APPLICATION

DATE:	02/16/21
PROJECT NO.:	61538
DRAWN BY:	AMM
CHECKED BY:	JAW
APPROVED BY:	TN
SHEET:	1 OF 2
DRAWING NUMBER E-BP-WV-GR-040-OC_REV3	

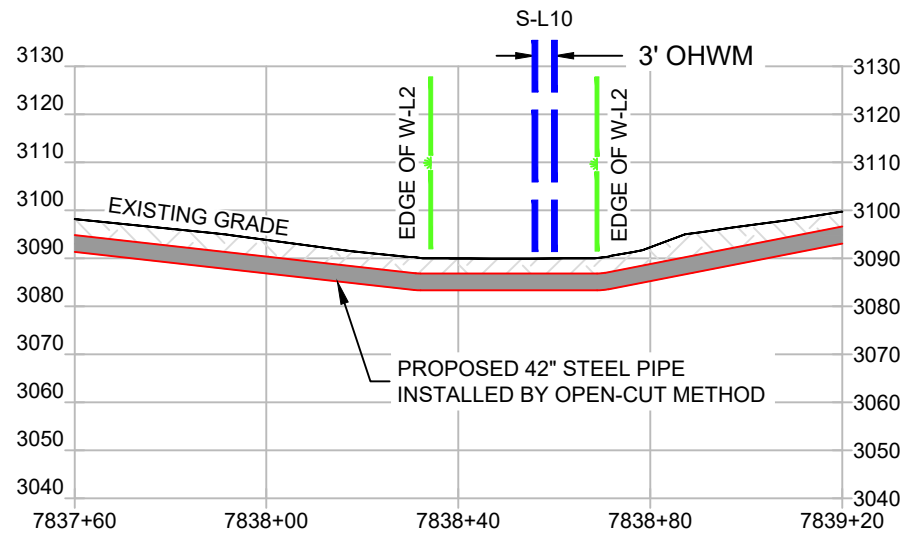

**NOTE:**

1. MINIMUM 3' COVER BETWEEN STREAMBED AND TOP OF PIPELINE UNLESS OTHERWISE NOTED.
2. PROPOSED FILL WILL BE IN TRENCH AND WILL BE RESTORED TO PRE-CONSTRUCTION ELEVATIONS.



ENCOMPASS SERVICES, LLC  
 1370 WASHINGTON PIKE, SUITE 308  
 BRIDGEVILLE, PA 15017



RESOURCE CROSSING  
 RESOURCE NAME: S-L10 / W-L2  
 LAT./LONG.= 37.938282, -80.746997  
 STATION = 7838+60  
 COUNTY / STATE: GREENBRIER COUNTY, WV  
 REFER TO TABLE 2 (STREAMS) AND TABLE 3  
 (WETLANDS) IN THE INDIVIDUAL PERMIT  
 APPLICATION

DATE:	02/16/21
PROJECT NO.:	61538
DRAWN BY:	AMM
CHECKED BY:	JAW
APPROVED BY:	TN
SHEET:	2 OF 2

DRAWING NUMBER  
 E-BP-WV-GR-040-OC\_REV3

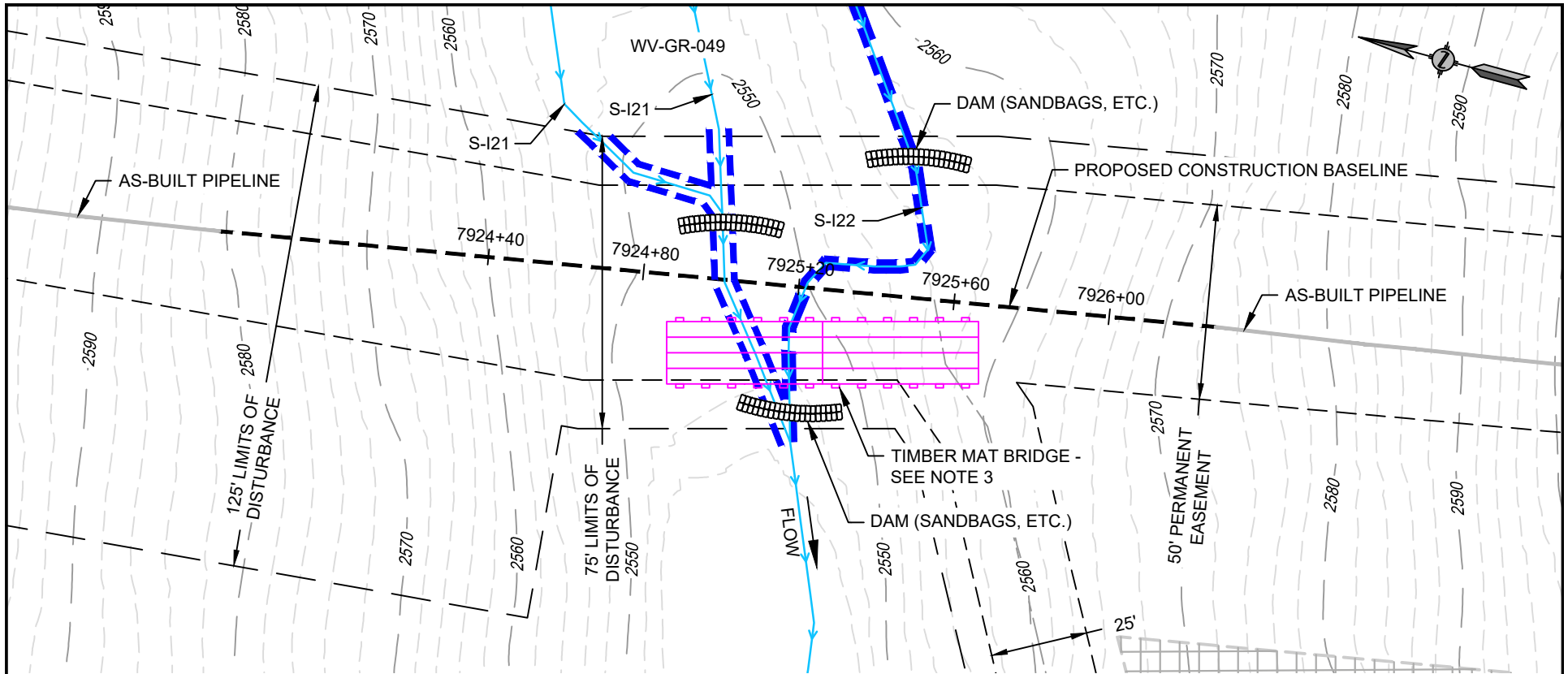

**NOTE:**

1. STATIONING IS BASED UPON IFC ALIGNMENT.
2. EXACT PIPELINE ALIGNMENT SUBJECT TO CHANGE, WITHIN THE EXTENTS OF THE PERMANENT EASEMENT, DEPENDING ON FIELD CONDITIONS. MVP WILL MAINTAIN ELEVATIONS AND MINIMUM DISTANCES FROM RESOURCES AS SHOWN.
3. LOCATION OF TRAVEL LANE AND ASSOCIATED TIMBER MAT/TEMPORARY CONSTRUCTION ACCESS BRIDGE IS FIELD DEPENDENT.
4. FIELD CONDITIONS MAY CHANGE THE LOCATION OF COFFERDAM. LOCATION OF PUMPS AND ENERGY DISSIPATER WILL BE IDENTIFIED IN THE FIELD AND WITHIN THE LOD. APPROVED E&SC BMPS HAVE BEEN REMOVED FOR CLARITY.
5. SPOIL FROM CROSSING TO BE LOCATED MINIMUM 10' FROM BANK.



**LEGEND**

- ORDINARY HIGH WATER MARK
- PROPOSED LIMIT OF DISTURBANCE
- PROPOSED PERMANENT R.O.W.
- CONSTRUCTION BASELINE

ENCOMPASS SERVICES, LLC  
1370 WASHINGTON PIKE, SUITE 308  
BRIDGEVILLE, PA 15017

RESOURCE CROSSING  
RESOURCE NAME: S-I21 & S-I22  
LAT./LONG. = 37.918143, -80.736846  
STATION = 7925+12  
COUNTY / STATE: GREENBRIER COUNTY, WV  
REFER TO TABLE 2 (STREAMS) AND TABLE 3 (WETLANDS) IN THE INDIVIDUAL PERMIT APPLICATION

DATE:	02/06/21
PROJECT NO.:	61538
DRAWN BY:	AMM
CHECKED BY:	JAW
APPROVED BY:	TN
SHEET:	1 OF 2
DRAWING NUMBER E-BP-WV-GR-049-OC_REV1	

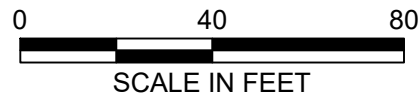
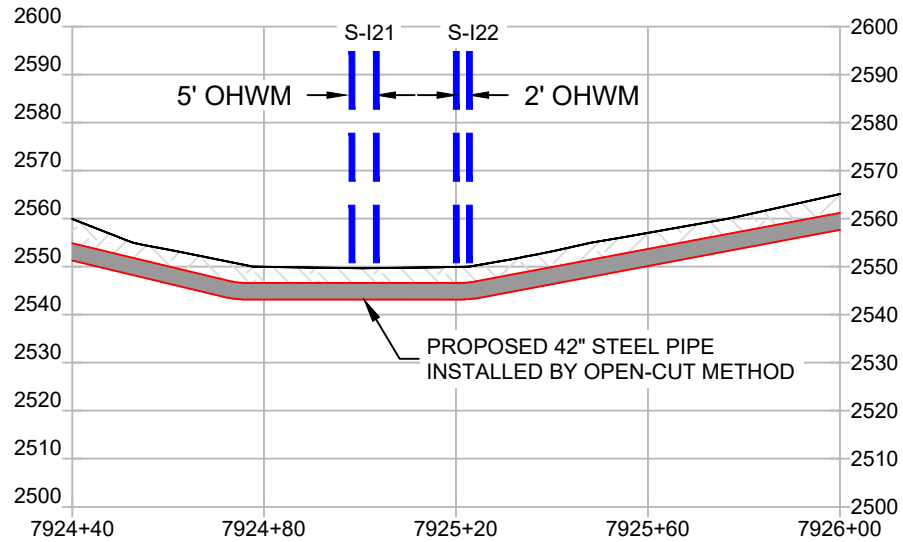

**NOTE:**

1. MINIMUM 3' COVER BETWEEN STREAMBED AND TOP OF PIPELINE UNLESS OTHERWISE NOTED.
2. PROPOSED FILL WILL BE IN TRENCH AND WILL BE RESTORED TO PRE-CONSTRUCTION ELEVATIONS.



ENCOMPASS SERVICES, LLC  
1370 WASHINGTON PIKE, SUITE 308  
BRIDGEVILLE, PA 15017



RESOURCE CROSSING  
RESOURCE NAME: S-I21 & S-I22  
LAT./LONG.= 37.918143, -80.736846  
STATION = 7925+12  
COUNTY / STATE: GREENBRIER COUNTY, WV  
REFER TO TABLE 2 (STREAMS) AND TABLE 3 (WETLANDS) IN THE INDIVIDUAL PERMIT APPLICATION

DATE:	02/06/21
PROJECT NO.:	61538
DRAWN BY:	AMM
CHECKED BY:	JAW
APPROVED BY:	TN
SHEET:	2 OF 2

DRAWING NUMBER  
E-BP-WV-GR-049-OC\_REV1