



**SCDF**  
The Life Saving Force

# SCIC - SCDF Dialogue 2017

COMMON FIRE SAFETY ENFORCEMENT FINDINGS

ENFORCEMENT & PROSECUTION BRANCH  
CENTRAL ENFORCEMENT DEPARTMENT





# Scope of Presentation

- Introduction
- Fire Hazard
- Fire Safety Offence
- Case Sharing



# Introduction

To create a fire safe environment by enforcing the FSA and achieved through

-  Scheduled fire safety checks
-  Responding to public feedbacks
-  Concerted joint efforts by SCDF, building managements, owners, FSMs and CERTs



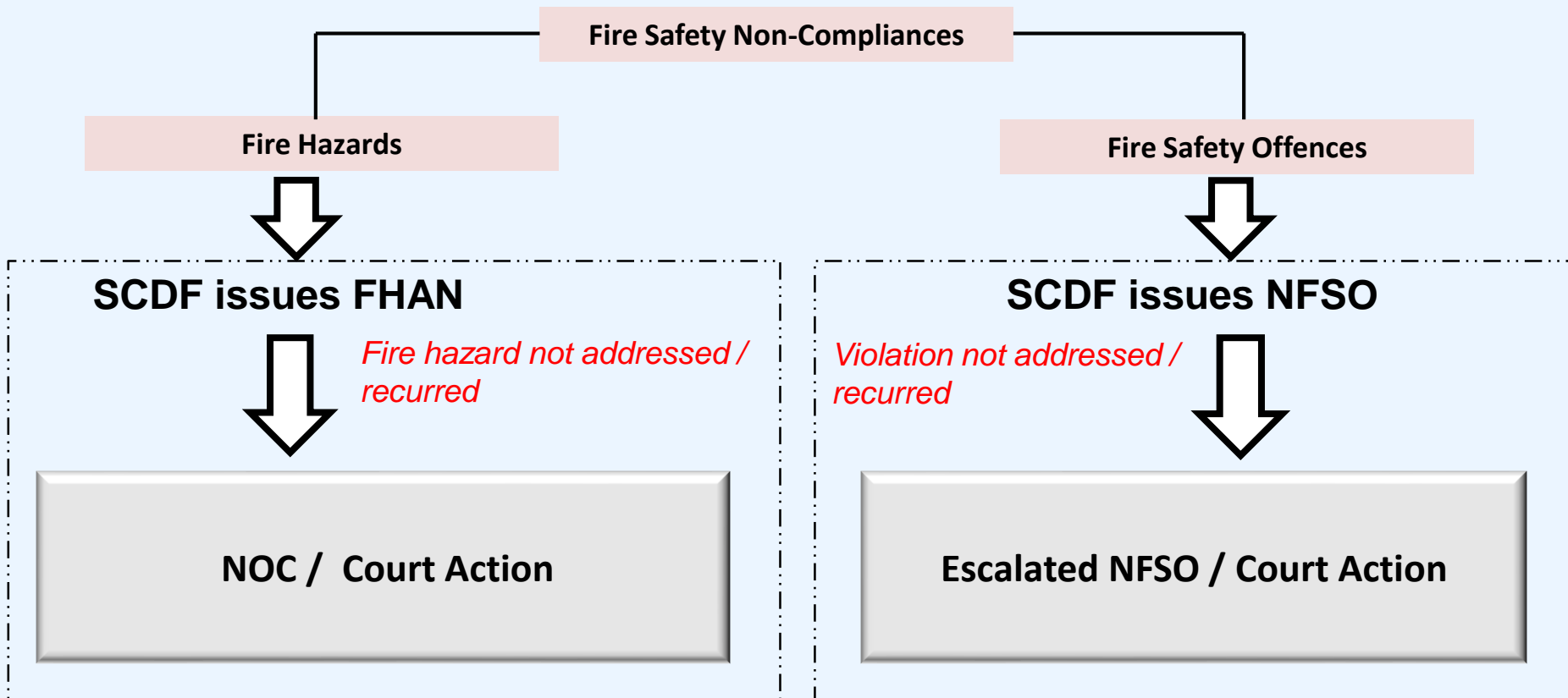

# Fire Safety Enforcement Action





**SCDF**  
The Life Saving Force

## STATE OF FIRE SAFETY IN OUR BUILDINGS

-  **7294** fire safety inspections conducted in Jan - Jun 2017
-  **1050** FHANs and **1094** NFSOs issued

# Enforcement Checks

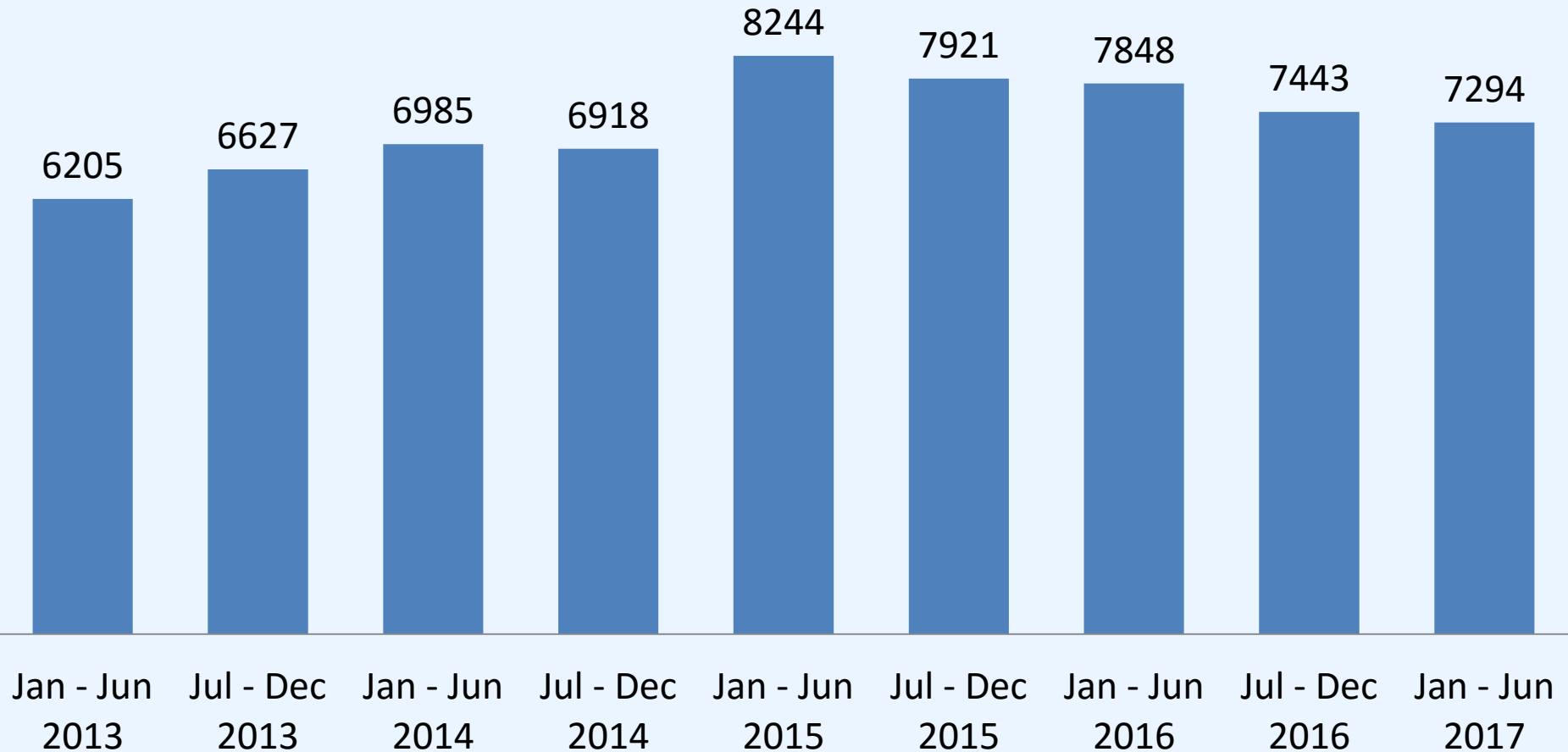

**Ensure the awareness of the importance of fire safety**



# Common Fire Safety Non-Compliances



# Fire Hazard

Any matter or circumstances which materially increase the likelihood of fire or the danger to life or property that would result from the outbreak of fire and includes



**Obstruction to means of escape**



**Obstruction to fire safety measures**



**Non-maintenance of fire safety measures**



**Missing / removal of fire safety measures**



**Storage / Placement of combustible material along staircase/escape route**





# Fire Extinguisher



- Obstruction to fire extinguisher

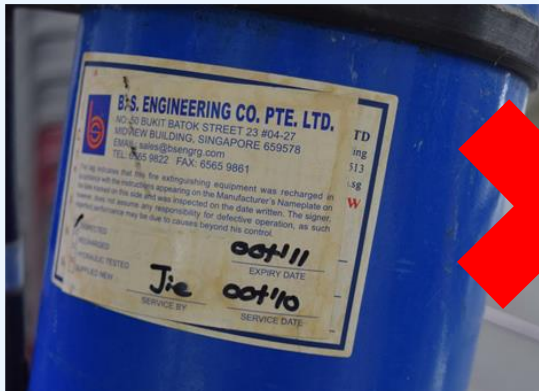

- Fire extinguisher not in efficient working order e.g. not serviced annually



# Fire Extinguisher



Key to the fire extinguisher should be readily available

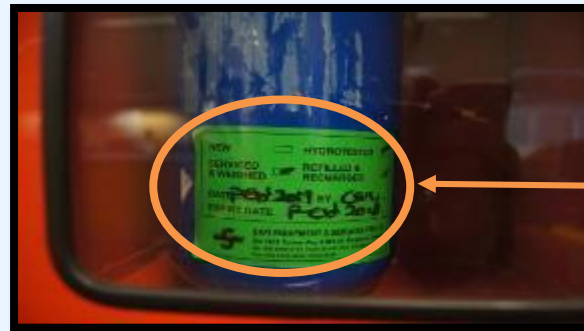

Fire extinguishers are to be maintained annually.



# Hosereel



- Obstruction to hosereel

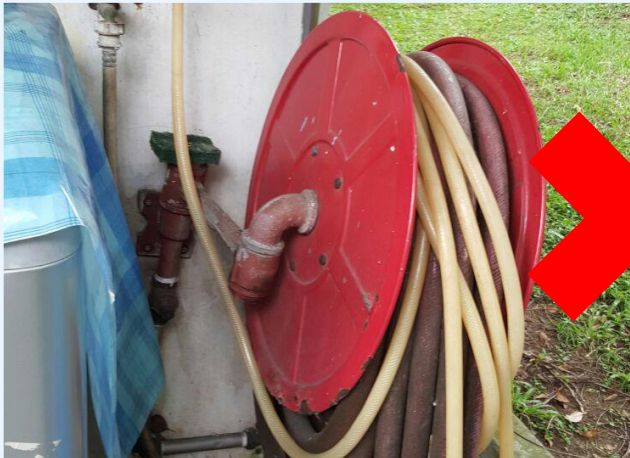

- Hosereel not in efficient working order



# Hosereel



Hosereel is tested regularly with adequate throwing distance (i.e. jet discharge of at least **6m**)



# Emergency Light



- Emergency light not in efficient working order e.g. not illuminated when the test button is depressed



# Emergency Light



Emergency lightings are to be in working conditions during power outage or failure.



Emergency lights is efficient working order when it is lit when the “test” button is depressed.



# Exit Sign



- Obstruction to exit sign



- Exit Sign not in efficient working order e.g. not illuminated when the test button is depressed



# Exit Sign

Exit signs are to be illuminated at all times



Exit signs should also be lit when the “test” button is depressed.





# Smoke / Heat Detector



- Smoke / Heat detector should be in efficient working order



# Manual Call Point



- Obstruction to manual call point



- Manual call point not in efficient working order



# Fire Alarm System



Fire Alarm System is to be "ON" and operationally ready at all times



Isolation / Fault showing at fire alarm panel should be investigated promptly and be rectified

# Fire Alarm System



Fire Alarm System is to be "ON" and operationally ready at all times



# Fireman Access Panel



- Fireman Access Panel should not be obstructed



# Sprinkler Head



- Sprinkler head should not be obstructed (i.e. at least 0.5m unobstructed)



# Escape Route



- Escape route not be obstructed e.g. passageway which serve as escape route and staircase

# Storage / Placement of Combustible Material

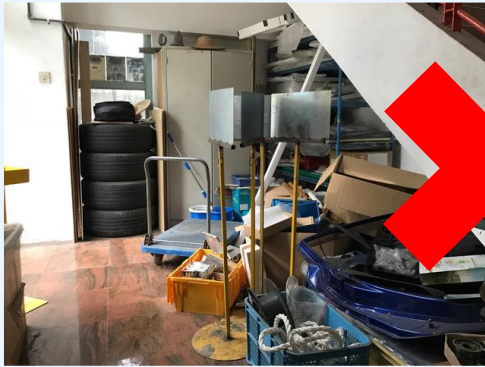

- No placement / storage of combustible material such as under staircase ramp, electrical room





# Fire Safety Offence

## Contravention to requirements in Fire Safety Act and its regulations



**Change the use of premises**



**Carrying out fire safety works without approval of plans**



**Storage of Petroleum and Flammable Material (P&FM) without a valid storage license**



- Fire Safety Works without approval of plans (tent)
- Change the use of vehicle parking area to storage area

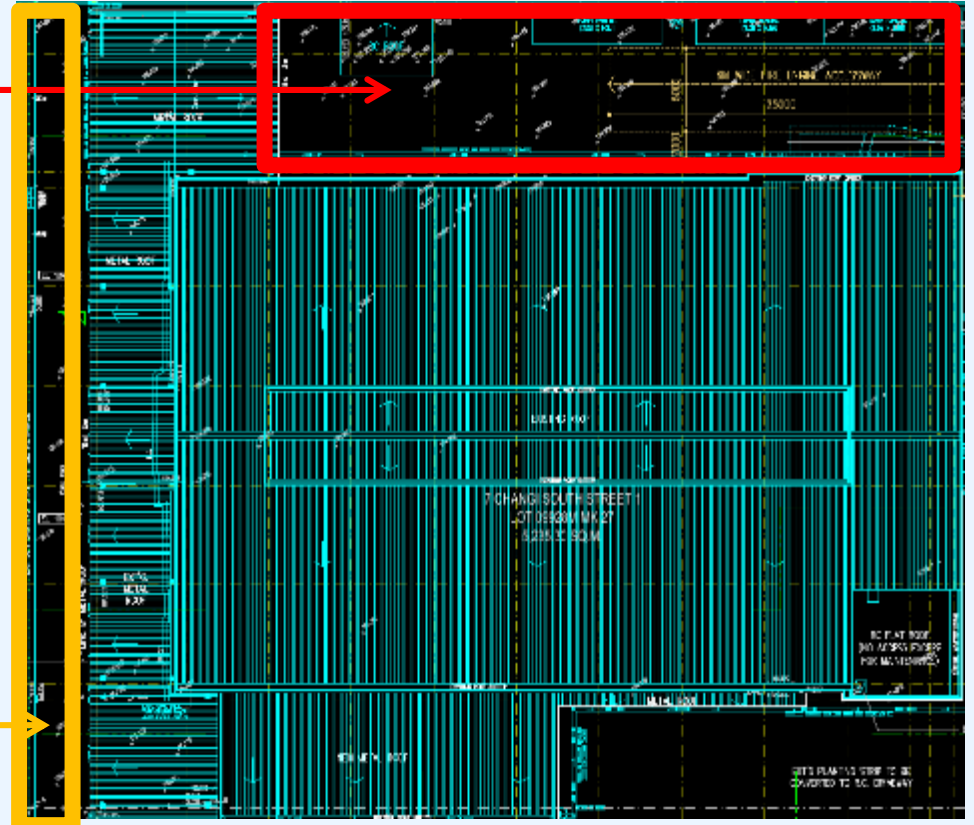

- Change the use of vehicle parking area to storage area / area of business activities

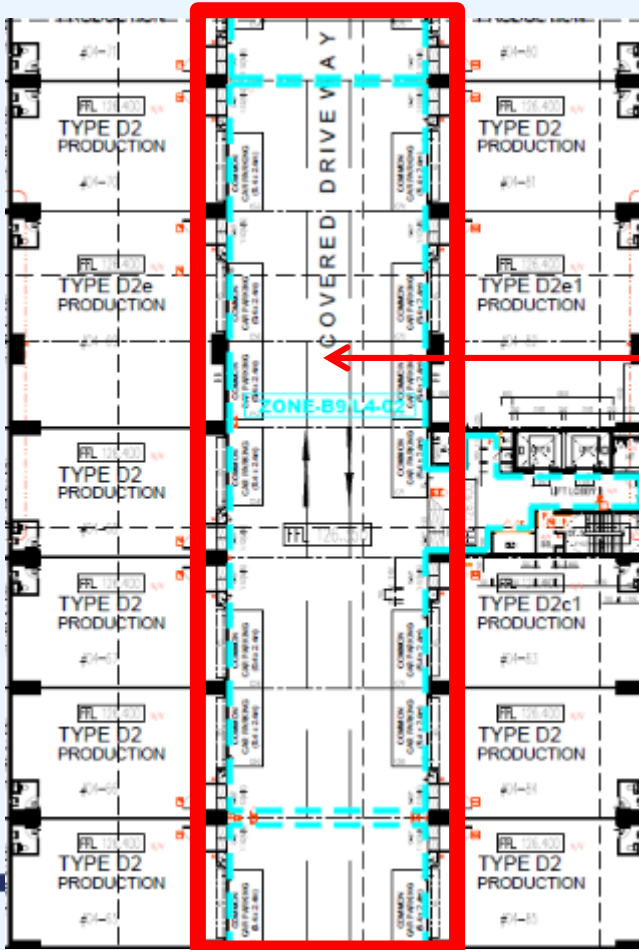

- Change the use of store / lunch room to office

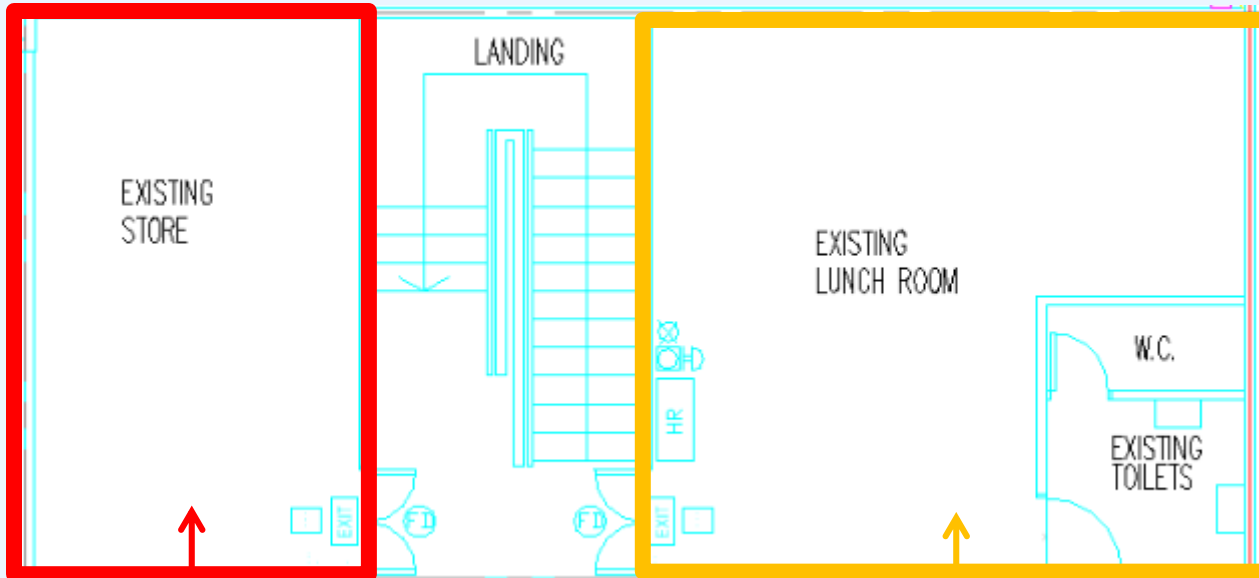

# Fire Safety Works without approval of plans (mezzanine)

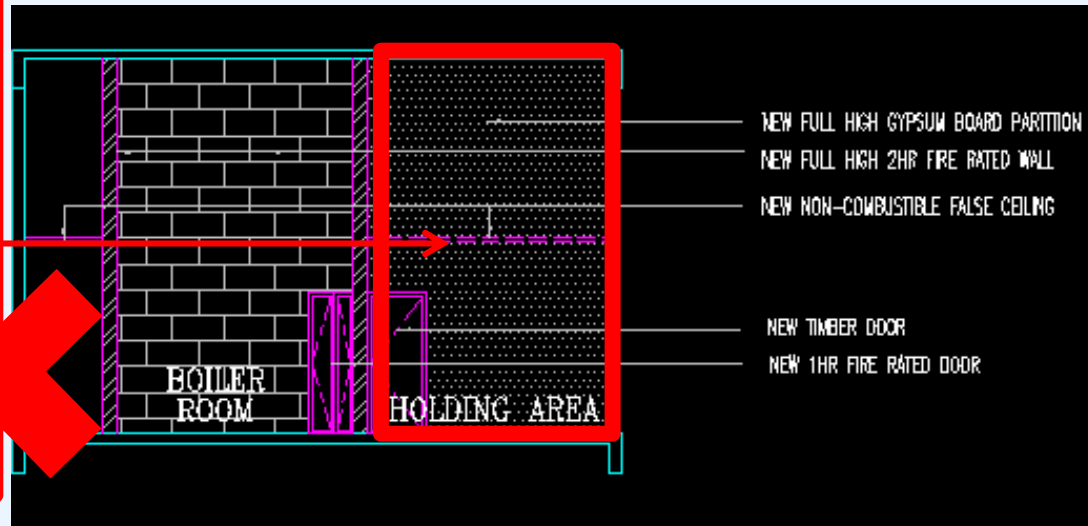
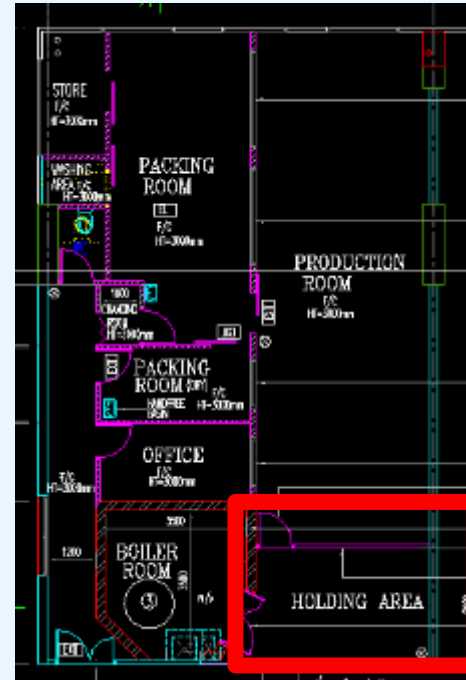

NEW FULL HIGH GYPSUM BOARD PARTITION  
NEW FULL HIGH 2HR FIRE RATED WALL  
NEW NON-COMBUSTIBLE FALSE CEILING

NEW TIMBER DOOR  
NEW 1HR FIRE RATED DOOR

- Change the use of premises to dormitory

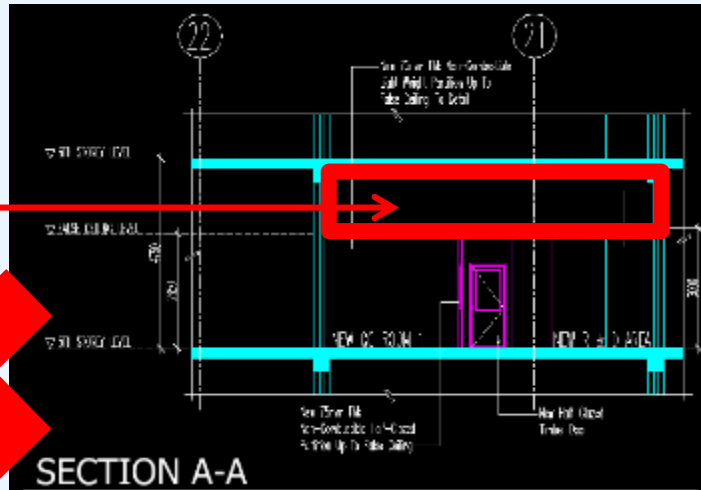
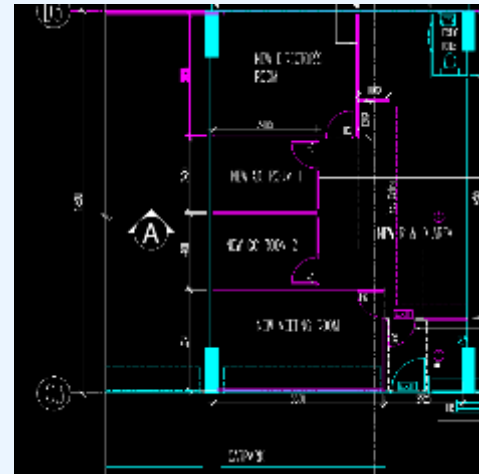
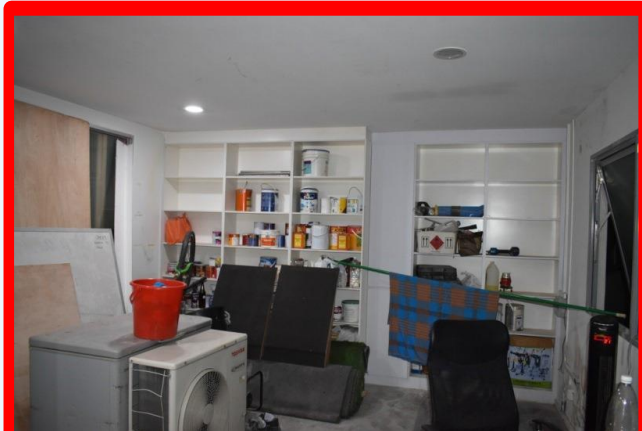

# Petroleum & Flammable Material



- **STORAGE OF ACETYLENE AT INDUSTRIAL PREMISES**

<b>Flammable Materials</b>	<b>General Manufacturing, etc, purpose</b>
<b>Acetylene</b>	<b>10L</b>





- STORAGE OF ETHANOL / METHANOL AT INDUSTRIAL PREMISES

Flammable Materials	General Manufacturing, etc, purpose
Ethanol	20L



- **STORAGE OF ETHANOL / METHANOL AT INDUSTRIAL PREMISES**

<b>Type of Usage</b>	<b>Class III Petroleum</b>
<b>(ii) For use in a factory</b>	<b>Not more than 1500 litres</b>



- Fire Safety Works without approval of plans (diesel tank)
- Storage of P&FM without valid storage licence



# CASE STUDIES – SHOPPING MALL

- Escalator fire on a Sunday afternoon
- **No alarm system log record**
- **Fire alarm was isolated and disabled**
- **Alarm sounders not triggered**
- **Alarm signal not sent to DECAMS**
- **Alarm signal not sent to SCDF**
- **Did not call 995**

*Did building owner, managing agent, FSM ensure fire safety measures are in efficient working order?*



# CASE STUDIES – LIGHT INDUSTRIAL BUILDING



- Fire started around lunch time
- Security guard answer DECAMS verification call and **reported false alarm without checking**
- Erection of office without approval
- Change of use of toilets to storage area

*Did FSM perform daily checks?*

*Did FSM supervise fire safety works?*

*Did building owner ensure CERT is formed?*



# CASE STUDIES – SPECIAL INDUSTRIAL BUILDING

- CERT alerted to fire around 6am
- Tried to fight fire but incident escalated
- **20 minutes later, finally informed SCDF when situation is out of control**

*Did CERT inform SCDF immediately?*

- Change of driveway to storage area
- Change of parking to storage area
- Storage of P&FM without license
- Did not obtain Fire Safety Certificate
- Addition of container as storage area

*Did FSM carry out his/her duty?*



**Thank you**

