



**SECTION - C - INDEX
PATIO DOORS**

	PAGE NUMBER
OPEN (USE FOR NOTES)	C- 2
VARIATION & ADDS FOR DOOR & PATIO UNITS	C-3 - C-5
NEW CONSTRUCTION PATIO DOOR SPECIFICATIONS	C- 6
DOUBLE UNIT PRICING	C-7 - C-8
TRIPLE UNIT PRICING	C-9 - C-10
VARIATIONS & ADDS FOR RETRO FIT PATIO DOOR UNIT	C-11
RETRO FIT PATIO DOOR SPECIFICATIONS	C-12
SINGLE UNIT PRICING	C-13 - C-14
DOUBLE UNIT PRICING	C-15 - C-16
TRIPLE UNIT PRICING	C-17 - C-18
PATIO DOOR ONLY PRICING	
NEW CONSTRUCTION SLABS	C-19
RETRO FIT SLABS	C-19
PATIO DOOR SIZES WITH HINGE AND LOCK SPECS	C-20



**INFINITY HINGED PATIO UNIT
VARIATIONS & ADDS**

<u>JAMB VARIATIONS</u>	<u>4 9/16" ONE PIECE JAMB</u>		<u>6 9/16" ONE PIECE JAMB</u>	
	<u>Single</u>	<u>Double</u>	<u>Single</u>	<u>Double</u>
CLEAR PINE	\$26.00	\$37.00	\$61.00	\$86.00
PRIMED			\$35.00	\$49.00
MAHOGANY	\$323.00	\$378.00	\$381.00	\$529.00
FIR	\$227.00	\$274.00	\$265.00	\$335.00

For Jambes > 6 9/16" Wall Thickness (ALL Thicknesses > 6 9/16" will be 2 Piece)

	<u>ADD to 6 9/16" JAMB PRICE</u>	
CLEAR PINE	\$30.00	\$36.00
PRIMED	\$26.00	\$33.00
MAHOGANY	\$147.00	\$161.00
FIR	\$82.00	\$91.00
<u>CUT BACK CHARGE For Less than 4 9/16", 6 9/16" or 8 9/16" Wall Thickness</u>	<u>ADD</u>	<u>\$20.00</u>

<u>COMPOSITE PRIMED JAMB & PVC BRICKMOULD</u>	<u>4-9/16" Wall Only</u>		<u>6-9/16" Wall Only</u>	
	<u>Single</u>	<u>Double</u>	<u>Single</u>	<u>Double</u>
NEW CONSTRUCTION UNITS	\$28.00	\$33.00	\$52.00	\$66.00
RETRO FIT UNITS	\$28.00	\$67.00	\$52.00	\$105.00

<u>WHITE CAP INFINITY ULTRA Jamb & Brickmould</u>	<u>4 9/16" Wall Only</u>		<u>6 9/16" Wall Only</u>	
	<u>Single</u>	<u>Double</u>	<u>Single</u>	<u>Double</u>
NEW CONSTRUCTION UNITS	\$91.00	\$114.00	\$149.00	\$177.00
RETRO FIT UNITS	\$91.00	\$153.00	\$149.00	\$216.00

Note: For SWING OUT Units Add Swing Out Unit Variations on Page C-5

BRICK MOULD ONLY VARIATIONS

Clear #180 Brick Mould	ADD	\$6.00	\$11.00
Clear 5/4" x 3" Face	ADD	\$32.00	\$37.00
Clear 5/4" x 4" Face	ADD	\$46.00	\$53.00
Primed 5/4" x 3" Face	ADD	\$27.00	\$30.00
Primed 5/4" x 4" Face	ADD	\$38.00	\$44.00
PVC 5/4" x 4" Trim Board (Textured / Smooth)	ADD	\$50.00	\$62.00
PVC 5/4" x 6" Trim Board (Textured / Smooth)	ADD	\$80.00	\$90.00
No BRICK MOULD	DEDUCT	(\$26.00)	(\$30.00)

Note: To figure Variations for Multiple Units other than Singles or Doubles Multiply number of units times single Unit Variations.

Price Subject to Change without Notice



**INFINITY HINGED PATIO UNIT
VARIATIONS & ADDS**

Miscellaneous Variations

		<u>Single</u>	<u>Double</u>
For WHITE Compression Weather-strip	ADD	(Same as Bronze)	
For No Weather-strip	DEDUCT	(\$7.00)	(\$9.00)
Fixed Unit	ADD	\$34.00	\$68.00

INSERT INSTALLATION

		<u>DOOR</u>	<u>SIDELIGHT</u>
ALL Inserts (Cutout for and install insert)	ADD	\$30.00	\$30.00
Labor to Install Insert in Door that is Already Cutout	ADD	\$13.00	\$13.00

Swing In SILL Variations

No Sill	DEDUCT	(\$19.00)	(\$52.00)
Bronze Anodized Adjustable	ADD	\$11.00	\$19.00

Sill Extenders (Swing In Only)

<u>Mill</u>	4 5/8" to 5 3/8"	ADD	\$6.00	\$11.00
	5 7/16" to 6 9/16"	ADD	\$8.00	\$15.00
	6 5/8" to 7 9/16"	ADD	\$9.00	\$18.00
<u>Bronze</u>	4 5/8" to 5 3/8"	ADD	\$11.00	\$21.00
	5 7/16" to 6 9/16"	ADD	\$14.00	\$28.00
	6 5/8" to 7 9/16"	ADD	\$14.00	\$29.00

Swing In ADA Compliant Sills

Mill Finish	For 4 9/16" Wall	(NO SCREEN TRACK)	ADD	\$13.00	\$17.00
	For 6 9/16" Wall	(NO SCREEN TRACK)	ADD	\$24.00	\$22.00
Bronze Finish	For 4 9/16" Wall	(NO SCREEN TRACK)	ADD	\$32.00	\$42.00
	For 6 9/16" Wall	(NO SCREEN TRACK)	ADD	\$60.00	\$97.00

Note: To figure Variations for Multiple Units other than Singles or Doubles Multiply number of units times single Unit Variations.

Price Subject to Change without Notice



**INFINITY HINGED PATIO UNIT
VARIATIONS & ADDS**

Special Finish HINGE ADDERS

Single

Double

To Standard Unit with US-2CD Brushed Silver Hinges

US-3	Polished	Solid Brass	6'8"	ADD	\$36.00	\$72.00
			8'0"	ADD	\$52.00	\$104.00
US-32D	Brushed Stainless Steel		6'8"	ADD	\$18.00	\$36.00
			8'0"	ADD	\$22.00	\$44.00

The following Hinge Finishes are available at Standard unit Pricing

US-2D Brass Tone Cichromate	US-1D Black	US-5 Antique Brass
US-10R Matte Laquere Antique Bronze	US-3 Bright Brass	US-15A Antique Nickel

Note: Other Finishes are available as SPECIAL ORDER ONLY

Swing Out Unit Variations

Mill Fixed (Bumper)	(NO SCREEN TRACK)	ADD	\$18.00	\$23.00
Bronze Anodized (Bumper)	(NO SCREEN TRACK)	ADD	\$25.00	\$30.00

Swing Out ADA Compliant Sills

Mill Finish	For 4 9/16" Wall	(NO SCREEN TRACK)	ADD	\$21.00	\$26.00
	For 6 9/16" Wall	(NO SCREEN TRACK)	ADD	\$26.00	\$35.00
Bronze Finish	For 4 9/16" Wall	(NO SCREEN TRACK)	ADD	\$35.00	\$58.00
	For 6 9/16" Wall	(NO SCREEN TRACK)	ADD	\$48.00	\$81.00

Note: Above Swing Out Adders include 1 each Rivited Pin Hinge of one of the following Finishes per Door Panel US2CD Brushed Silver, US1D Satin Black, US-3 Polished Brass, ABA Antique Brass, US10R Matt Lacquer Antique Bronze or US-15A Antique Nickel

For Additional Rivited Pin Hinge of any of the above finishes

ADD	Per Hinge	\$8.00	\$15.00
-----	-----------	--------	---------

Special Finish HINGE ADDERS

To Standard Unit with US-2CD Brushed Silver Hinges

US-3-SB	Swing Out with 1 ea. NRP Hinge	6'8"	ADD	\$37.00	\$74.00
	Swing Out with 1 ea. NRP Hinge	8'0"	ADD	\$53.00	\$106.00
US-32D	Swing Out with 1 ea. NRP Hinge	6'8"	ADD	\$22.00	\$44.00
	Swing Out with 1 ea. NRP Hinge	8'0"	ADD	\$31.00	\$62.00

FOR OUT SWING SECURITY FLANGE

		White Aluminum	Veneer Wrapped
6'8"	ADD	\$35.00	\$71.00
8'0"	ADD	\$44.00	\$76.00

Note: To figure Variations for Multiple Units other than Singles or Doubles Multiply number of units times single Unit Variations.

Price Subject to Change without Notice



**NEW CONSTRUCTION SIZE
INFINITY HINGED PATIO UNIT
UNIT DIMENSIONS**

Available in: STEEL & SMOOTH WHITE FIBERGLASS FULL LITE Doors with Inserts Installed

NOMINAL WIDTH		UNIT OUTSIDE OF		SUGGESTED ROUGH
		Frame	Brickmould	OPENING
5'0" (pr. 2'6")	Wood Jamb	61 15/16"	64 7/16"	63"
	Ultra Jamb	62 3/16"	64 11/16"	63 1/4"
5'4" (pr. 2'8")	Wood Jamb	65 15/16"	68 7/16"	67"
	Ultra Jamb	66 3/16"	68 11/16"	67 1/4"
6'0" (pr. 3'0")	Wood Jamb	73 15/16"	76 7/16"	75"
	Ultra Jamb	74 3/16"	76 11/16"	75"
7'6"	Wood Jamb	92 7/16"	94 15/16"	93 1/2"
	Ultra Jamb	92 15/16"	95 7/16"	94"
9'0"	Wood Jamb	110 7/16"	112 15/16"	111 1/2"
	Ultra Jamb	110 15/16"	113 7/16"	112"

NOMINAL HEIGHT	ACTUAL Door Size		UNIT OUTSIDE OF		SUGGESTED ROUGH
	Fixed	Active	Frame	Brickmould	OPENING
6'8" Swing In	79 1/4"	79 1/4"	82"	83 1/4"	82 1/2"
6'8" Swing OUT	79 1/4"	79 1/4"	81 1/4"	82 3/4"	81 3/4"

Price Subject to Change without Notice



**NEW CONSTRUCTION SIZE
INFINITY HINGED PATIO UNIT**

By Barnett Millworks Inc.

INCLUDES: Primed 4 9/16" Jamb, PVC Brickmould, Bronze Weather-strip, Mill Sill with Vinly ADJUSTABLE Threshold, In-Swing Only, Tempered Insulated Glass, Bore for Lock & Deadbolt, No Locks, In-swing only. Doors in these units are 1/4" under size in Width and 3/4" under size in Height.

DOUBLE UNITS		5068	5468	6068
S-687-CL-1	L/H or R/H	\$803.00		
FS-687-CL-1	"	\$864.00		
S-686-CL-1	L/H or R/H		\$806.00	\$810.00
FS-686-CL-1	"		\$867.00	\$873.00
S-687-CLLE-1	LOW - E L/H or R/H	\$883.00		
FS-687-CLLE-1	" "	\$944.00		
S-686-CLLE-1	LOW - E L/H or R/H		\$886.00	\$891.00
FS-686-CLLE-1	" "		\$947.00	\$954.00
S-627-CLEG-10	L/H or R/H	\$807.00		
FS-627-CLEG-10	"	\$868.00		
S-628-CLEG-10	L/H or R/H		\$810.00	\$815.00
FS-628-CLEG-10	"		\$871.00	\$877.00
S-688-CLEG-15	L/H or R/H	\$807.00		
FS-688-CLEG-15	"	\$868.00		
S-689-CLEG-15	L/H or R/H		\$810.00	\$815.00
FS-689-CLEG-15	"		\$871.00	\$877.00
S-688-LEEG-15	LOW - E L/H or R/H	\$907.00		
FS-688-LEEG-15	" "	\$968.00		
S-689-LEEG-15	LOW - E L/H or R/H		\$910.00	\$915.00
FS-689-LEEG-15	" "		\$971.00	\$975.00
HEAVY DUTY WHITE Screen for New Construction Unit		\$86.00	\$87.00	\$89.00

S = Steel Flush

FS = Fiberglass Smooth Flush

NOTE: (1) ALL LIGHTS HAVE TEMPERED GLASS
(2) FOR OTHER VARIATIONS SEE PAGE C- 3 & C- 4
Price Subject to Change without Notice



Page: C- 8
2/18/19

**NEW CONSTRUCTION SIZE
INFINITY HINGED PATIO UNIT**

By Barnett Millworks Inc.

INCLUDES: Primed 4 9/16" Jamb, PVC Brickmould, Schlegel Weather-strip, Mill Sill with Vinly ADJUSTABLE Threshold, In-Swing Only, Tempered Insulated Glass, Bore for Lock & Deadbolt, No Locks, In-swing only. Doors in these units are 1/4" under size in Width and 3/4" under size in Height.

DOUBLE UNITS			5068	5468	6068
S-687-WM-10	(7/8" White Clear Insul)	L/H or R/H	\$859.00		
FS-687-WM-10	"	"	\$920.00		
S-686-WM-10	(7/8" White Clear Insul)	L/H or R/H		\$862.00	\$867.00
FS-686-WM-10	"	"		\$923.00	\$928.00
S-687-WM-15	(7/8" White Clear Insul)	L/H or R/H	\$859.00		
FS-687-WM-15	"	"	\$920.00		
S-686-WM-15	(7/8" White Clear Insul)	L/H or R/H		\$862.00	\$867.00
FS-686-WM-15	"	"		\$923.00	\$928.00
S-687-WM-10	(7/8" Tan LOW " E " Insul)	L/H or R/H	\$909.00		
FS-687-WM-10	"	"	\$970.00		
S-686-WM-10	(7/8" Tan LOW " E " Insul)	L/H or R/H		\$912.00	\$917.00
FS-686-WM-10	"	"		\$973.00	\$978.00
S-687-WM-15	(7/8" Tan LOW " E " Insul)	L/H or R/H	\$909.00		
FS-687-WM-15	"	"	\$970.00		
S-686-WM-15	(7/8" Tan LOW " E " Insul)	L/H or R/H		\$912.00	\$917.00
FS-686-WM-15	"	"		\$973.00	\$978.00
S-687- RLB-1		L/H or R/H	\$1,140.00		
FS-687- RLB-1		"	\$1,200.00		
S-686- RLB-1		L/H or R/H		\$1,143.00	\$1,147.00
FS-686- RLB-1		"		\$1,204.00	\$1,208.00
HEAVY DUTY WHITE Screen for New Construction Unit			\$86.00	\$87.00	\$89.00

S = Steel Flush

FS = Fiberglass Smooth Flush

NOTE: (1) ALL LIGHTS HAVE TEMPERED GLASS
(2) FOR OTHER VARIATIONS SEE PAGE C- 8, C- 9 & C-10
Price Subject to Change without Notice



NEW CONSTRUCTION SIZE INFINITY HINGED PATIO UNIT

By Barnett Millworks Inc.

INCLUDES: Primed 4 9/16" Jamb, PVC Brickmould, Schlegel Weather-strip, Mill Sill with Vinly ADJUSTABLE Threshold, In-Swing Only, Tempered Insulated Glass, Bore for Lock & Deadbolt, No Locks, In-swing only. Doors in these units are 1/4" under size in Width and 3/4" under size in Height.

TRIPLE UNITS		7668	9068
S-687-CL-1	L/H or R/H	\$1,245.00	
FS-687-CL-1	"	\$1,336.00	
S-686-CL-1	L/H or R/H		\$1,250.00
FS-686-CL-1	"		\$1,342.00
S-687-CLLE-1	<i>LOW - E</i> L/H or R/H	\$1,366.00	
FS-687-CLLE-1	" "	\$1,457.00	
S-686-CLLE-1	<i>LOW - E</i> L/H or R/H		\$1,371.00
FS-686-CLLE-1	" "		\$1,462.00
S-627-CLEG-10	L/H or R/H	\$1,252.00	
FS-627-CLEG-10	"	\$1,343.00	
S-628-CLEG-10	L/H or R/H		\$1,257.00
FS-628-CLEG-10	"		\$1,348.00
S-688-CLEG-15	L/H or R/H	\$1,252.00	
FS-688-CLEG-15	"	\$1,343.00	
S-689-CLEG-15	L/H or R/H		\$1,257.00
FS-689-CLEG-15	"		\$1,348.00
S-688-LEEG-15	<i>LOW - E</i> L/H or R/H	\$1,402.00	
FS-688-LEEG-15	" "	\$1,493.00	
S-689-LEEG-15	<i>LOW - E</i> L/H or R/H		\$1,407.00
FS-689-LEEG-15	" "		\$1,498.00
HEAVY DUTY WHITE Screen for New Construction Unit		\$86.00	\$89.00

S = Steel Flush

FS = Fiberglass Smooth Flush

NOTE: (1) ALL LIGHTS HAVE TEMPERED GLASS
(2) FOR OTHER VARIATIONS SEE PAGE C- 8, C- 9 & C-10
Price Subject to Change without Notice



**NEW CONSTRUCTION SIZE
INFINITY HINGED PATIO UNIT**

By Barnett Millworks Inc.

INCLUDES: Primed 4 9/16" Jamb, PVC Brickmould, Schlegel Weather-strip, Mill Sill with Vinly ADJUSTABLE Threshold, In-Swing Only, Tempered Insulated Glass, Bore for Lock & Deadbolt, No Locks, In-swing only. Doors in these units are 1/4" under size in Width and 3/4" under size in Height.

TRIPLE UNITS			7668	9068
S-687-WM-10	(7/8" White Clear Insul)	L/H or R/H	\$1,330.00	
FS-687-WM-10	"	"	\$1,421.00	
S-686-WM-10	(7/8" White Clear Insul)	L/H or R/H		\$1,335.00
FS-686-WM-10	"	"		\$1,427.00
S-687-WM-15	(7/8" White Clear Insul)	L/H or R/H	\$1,330.00	
FS-687-WM-15	"	"	\$1,421.00	
S-686-WM-15	(7/8" White Clear Insul)	L/H or R/H		\$1,335.00
FS-686-WM-15	"	"		\$1,427.00
S-687-WM-10	(7/8" Tan LOW " E " Insul)	L/H or R/H	\$1,405.00	
FS-687-WM-10	"	"	\$1,496.00	
S-686-WM-10	(7/8" Tan LOW " E " Insul)	L/H or R/H		\$1,410.00
FS-686-WM-10	"	"		\$1,502.00
S-687-WM-15	(7/8" Tan LOW " E " Insul)	L/H or R/H	\$1,405.00	
FS-687-WM-15	"	"	\$1,496.00	
S-686-WM-15	(7/8" Tan LOW " E " Insul)	L/H or R/H		\$1,410.00
FS-686-WM-15	"	"		\$1,502.00
S-687- RLB-1		L/H or R/H	\$1,750.00	
FS-687- RLB-1		"	\$1,842.00	
S-686- RLB-1		L/H or R/H		\$1,756.00
FS-686- RLB-1		"		\$1,847.00
HEAVY DUTY WHITE Screen for New Construction Unit			\$86.00	\$89.00

S = Steel Flush

FS = Fiberglass Smooth Flush

NOTE: (1) ALL LIGHTS HAVE TEMPERED GLASS
(2) FOR OTHER VARIATIONS SEE PAGE C- 8, C- 9 & C-10
Price Subject to Change without Notice



**INFINITY
RETRO-FIT SIZE HINGED PATIO UNIT
VARIATIONS & ADDS**

For Replacement Size Double French Unit	ADD	\$81.00
	To Respective Patio Unit Priced in this Section	
For Open Out Patio Unit	ADD	\$32.00
	To Respective Patio Unit Priced in this Section	
For Wide Jambs up to 6 9/16" (NOT INSTALLED)	ADD	\$49.00
	Note: Extenders will be shipped loose and must be job applied to inside of jamb.	
For Clear Jamb and Brickmould		See Page C- 6

**INFINITY RETRO-FIT HINGED PATIO UNIT
MISCELLANEOUS INFORMATION**

- NOTE:
- (1) Screen Frame is **WHITE !! Only !!**
 - (2) Screen **!!! NOT AVAILABLE !!!** for Double French Units.
 - (3) Screen **!!! NOT AVAILABLE !!!** for Open Out Units.
 - (4) 7'6" and 9'0" units can be ordered as End or Center Swing.
 - (5) Doors for the Infinity RETRO-FIT Patio system have specifications that allow them to be used with this system **ONLY**.
 - (6) Infinity RETRO-FIT Patio doors available as O-bore or 2-bore **ONLY**.
 - (7) One Bore Infinity RETRO-FIT Patio door **!! NOT AVAILABLE !!** (due to Width of panel used with this system.
 - (8) Infinity RETRO-FIT Patio doors use same inserts as standard Infinity doors.

- NOTE:
- (1) ALL LIGHTS HAVE TEMPERED GLASS
 - (2) FOR OTHER VARIATIONS SEE PAGE C- 8, C- 9 & C-10

Price Subject to Change without Notice



**INFINITY
RETRO-FIT SIZE HINGED PATIO UNIT**

UNIT DIMENSIONS

Available in: STEEL & SMOOTH WHITE FIBERGLASS FULL LITE Doors with Inserts Installed

NOMINAL WIDTH	ACTUAL Door Size		Frame	UNIT OUTSIDE OF	
	Fixed	Active		Brickmould	ROUGH OPENING
2'6"	28 11/16"	28 1/2"	30 3/16"	32 11/16"	31 1/4"
3'0"	34 11/16"	34 1/2"	36 3/16"	38 11/16"	37 1/4"
5'0"	Wood Jamb		59 5/8"	62 1/8"	60 3/4"
	Ultra Jamb		59 7/8"	62 3/8"	61"
6'0"	Wood Jamb		71 5/8"	74 1/8"	72 3/4"
	Ultra Jamb		71 7/8"	74 3/8"	73"
7'6"	Wood Jamb		89 1/16"	91 9/16"	90 1/4"
	Ultra Jamb		89 9/16"	92 1/16"	90 1/2"
9'0"	Wood Jamb		107 1/16"	109 9/16"	108 1/4"
	Ultra Jamb		107 9/16"	110 1/16"	108 1/2"

NOMINAL HEIGHT	ACTUAL Door Size		Frame	Brickmould	ROUGH OPENING
	Fixed	Active			
6'8" Swing In	77"	77"	79 3/4"	81"	80 1/4"
6'8" Swing Out	77"	77"	79"	80 1/2"	79 1/2"

Price Subject to Change without Notice



INFINITY
RETRO-FIT SIZE HINGED PATIO UNIT
By Barnett Millworks Inc.

INCLUDES: Primed 4 9/16" Jamb, WHITE EXCEL 180 Face, Schlegel Weather-strip, Mill Swing In Sill with Vinyl !!! ADJUSTABLE !!! Threshold, Tempered Insulated Glass, Bore for Deadbolt, No Locks, In-swing only.

SINGLE UNITS			2668	3068
SP-687-CL-1		L/H or R/H	\$404.00	
FSP-687-CL-1		"	\$486.00	
SP-686-CL-1		L/H or R/H		\$405.00
FSP-686-CL-1		"		\$487.00
SP-687-CLLE-1	LOW - E	L/H or R/H	\$444.00	
FSP-687-CLLE-1	"	"	\$527.00	
SP-686-CLLE-1	LOW - E	L/H or R/H		\$445.00
FSP-686-CLLE-1	"	"		\$528.00
SP-627-CLEG-10		L/H or R/H	\$406.00	
FSP-627-CLEG-10		"	\$489.00	
SP-628-CLEG-10		L/H or R/H		\$407.00
FSP-628-CLEG-10		"		\$490.00
SP-688-CLEG-15		L/H or R/H	\$406.00	
FSP-688-CLEG-15		"	\$489.00	
SP-689-CLEG-15		L/H or R/H		\$407.00
FSP-689-CLEG-15		"		\$490.00
SP-688-LEEG-15	LOW - E	L/H or R/H	\$456.00	
FSP-688-LEEG-15	"	"	\$539.00	
SP-689-LEEG-15	LOW - E	L/H or R/H		\$457.00
FSP-689-LEEG-15	"	"		\$540.00

SP = Steel Patio

FSP = Fiberglass Smooth Patio

NOTE: (1) ALL LIGHTS HAVE TEMPERED GLASS
(2) FOR OTHER VARIATIONS SEE PAGE C- 8, C- 9, C-10 & C-18

Price Subject to Change without Notice



INFINITY
RETRO-FIT SIZE HINGED PATIO UNIT
By Barnett Millworks Inc.

INCLUDES: Primed 4 9/16" Jamb, WHITE EXCEL 180 Face, Schlegel Weather-strip, Mill Swing In Sill with Vinyl !!! ADJUSTABLE !!! Threshold, Tempered Insulated Glass, Bore for Deadbolt, No Locks, In-swing only.

SINGLE UNITS			2668	3068
SP-687-WM-10	(7/8" White Clear Insul)	L/H or R/H	\$432.00	
FSP-687-WM-10	"	"	\$515.00	
SP-686-WM-10	(7/8" White Clear Insul)	L/H or R/H		\$433.00
FSP-686-WM-10	"	"		\$516.00
SP-687-WM-15	(7/8" White Clear Insul)	L/H or R/H	\$432.00	
FSP-687-WM-15	"	"	\$515.00	
SP-686-WM-15	(7/8" White Clear Insul)	L/H or R/H		\$433.00
FSP-686-WM-15	"	"		\$516.00
SP-687-WM-10	(7/8" Tan LOW " E " Insul)	L/H or R/H	\$457.00	
FSP-687-WM-10	"	"	\$540.00	
SP-686-WM-10	(7/8" Tan LOW " E " Insul)	L/H or R/H		\$458.00
FSP-686-WM-10	"	"		\$541.00
SP-687-WM-15	(7/8" Tan LOW " E " Insul)	L/H or R/H	\$457.00	
FSP-687-WM-15	"	"	\$540.00	
SP-686-WM-15	(7/8" Tan LOW " E " Insul)	L/H or R/H		\$458.00
FSP-686-WM-15	"	"		\$541.00
SP-687- RLB-1		L/H or R/H	\$572.00	
FSP-687- RLB-1		"	\$655.00	
SP-686- RLB-1		L/H or R/H		\$573.00
FSP-686- RLB-1		"		\$656.00

SP = Steel Patio

FSP = Fiberglass Smooth Patio

NOTE: (1) ALL LIGHTS HAVE TEMPERED GLASS
(2) FOR OTHER VARIATIONS SEE PAGE C- 8, C- 9, C-10 & C-18

Price Subject to Change without Notice



INFINITY
RETRO-FIT SIZE HINGED PATIO UNIT
By Barnett Millworks Inc.

INCLUDES: Primed 4 9/16" Jamb, WHITE EXCEL 180 Face, Schlegel Weather-strip, Mill Swing In Sill with Vinyl !!! ADJUSTABLE !!! Threshold, Tempered Insulated Glass, Bore for Deadbolt, No Locks, In-swing only.

DOUBLE UNITS		5068	6068
SP-687-CL-1	L/H or R/H	\$803.00	
FSP-687-CL-1	"	\$959.00	
SP-686-CL-1	L/H or R/H		\$810.00
FSP-686-CL-1	"		\$967.00
SP-687-CLLE-1	LOW - E L/H or R/H	\$883.00	
FSP-687-CLLE-1	" "	\$1,040.00	
SP-686-CLLE-1	LOW - E L/H or R/H		\$891.00
FSP-686-CLLE-1	" "		\$1,047.00
SP-627-CLEG-10	L/H or R/H	\$807.00	
FSP-627-CLEG-10	"	\$964.00	
SP-628-CLEG-10	L/H or R/H		\$815.00
FSP-628-CLEG-10	"		\$971.00
SP-688-CLEG-15	L/H or R/H	\$807.00	
FSP-688-CLEG-15	"	\$964.00	
SP-689-CLEG-15	L/H or R/H		\$815.00
FSP-689-CLEG-15	"		\$971.00
SP-688-LEEG-15	LOW - E L/H or R/H	\$907.00	
FSP-688-LEEG-15	" "	\$1,064.00	
SP-689-LEEG-15	LOW - E L/H or R/H		\$915.00
FSP-689-LEEG-15	" "		\$1,071.00
HEAVY DUTY WHITE Screen for Retro-Fit Unit		\$87.00	\$89.00

SP = Steel Patio

FSP = Fiberglass Smooth Patio

NOTE: (1) ALL LIGHTS HAVE TEMPERED GLASS
(2) FOR OTHER VARIATIONS SEE PAGE C- 8, C- 9, C-10 & C-18
Price Subject to Change without Notice



INFINITY
RETRO-FIT SIZE HINGED PATIO UNIT
By Barnett Millworks Inc.

INCLUDES: Primed 4 9/16" Jamb, WHITE EXCEL 180 Face, Schlegel Weather-strip, Mill Swing In Sill with Vinyl !!! ADJUSTABLE !!! Threshold, Tempered Insulated Glass, Bore for Deadbolt, No Locks, In-swing only.

DOUBLE UNITS			5068	6068
SP-687-WM-10	(7/8" White Clear Insul)	L/H or R/H	\$859.00	
FSP-687-WM-10	"	"	\$1,016.00	
SP-686-WM-10	(7/8" White Clear Insul)	L/H or R/H		\$867.00
FSP-686-WM-10	"	"		\$1,023.00
SP-687-WM-15	(7/8" White Clear Insul)	L/H or R/H	\$859.00	
FSP-687-WM-15	"	"	\$1,016.00	
SP-686-WM-15	(7/8" White Clear Insul)	L/H or R/H		\$867.00
FSP-686-WM-15	"	"		\$1,023.00
SP-687-WM-10	(7/8" Tan LOW " E " Insul)	L/H or R/H	\$909.00	
FSP-687-WM-10	"	"	\$1,066.00	
SP-686-WM-10	(7/8" Tan LOW " E " Insul)	L/H or R/H		\$917.00
FSP-686-WM-10	"	"		\$1,073.00
SP-687-WM-15	(7/8" Tan LOW " E " Insul)	L/H or R/H	\$909.00	
FSP-687-WM-15	"	"	\$1,066.00	
SP-686-WM-15	(7/8" Tan LOW " E " Insul)	L/H or R/H		\$917.00
FSP-686-WM-15	"	"		\$1,073.00
SP-687- RLB-1		L/H or R/H	\$1,140.00	
FSP-687- RLB-1		"	\$1,296.00	
SP-686- RLB-1		L/H or R/H		\$1,147.00
FSP-686- RLB-1		"		\$1,304.00
HEAVY DUTY WHITE Screen for Retro-Fit Unit			\$87.00	\$89.00

SP = Steel Patio

FSP = Fiberglass Smooth Patio

NOTE: (1) ALL LIGHTS HAVE TEMPERED GLASS
(2) FOR OTHER VARIATIONS SEE PAGE C- 8, C- 9, C-10 & C-18
Price Subject to Change without Notice



INFINITY
RETRO-FIT SIZE HINGED PATIO UNIT
By Barnett Millworks Inc.

INCLUDES: Primed 4 9/16" Jamb, WHITE EXCEL 180 Face, Schlegel Weather-strip, Mill Swing In Sill with Vinyl !!! ADJUSTABLE !!! Threshold, Tempered Insulated Glass, Bore for Deadbolt, No Locks, In-swing only.

TRIPLE UNITS			7668	9068
<i>SP-687-CL-1</i>		L/H or R/H	\$1,245.00	
<i>FSP-687-CL-1</i>		"	\$1,475.00	
<i>SP-686-CL-1</i>		L/H or R/H		\$1,250.00
<i>FSP-686-CL-1</i>		"		\$1,481.00
<i>SP-687-CLLE-1</i>	<i>LOW - E</i>	L/H or R/H	\$1,366.00	
<i>FSP-687-CLLE-1</i>	"	"	\$1,596.00	
<i>SP-686-CLLE-1</i>	<i>LOW - E</i>	L/H or R/H		\$1,371.00
<i>FSP-686-CLLE-1</i>	"	"		\$1,602.00
<i>SP-627-CLEG-10</i>		L/H or R/H	\$1,421.00	
<i>FSP-627-CLEG-10</i>		"	\$1,808.00	
<i>SP-628-CLEG-10</i>		L/H or R/H		\$1,335.00
<i>FSP-628-CLEG-10</i>		"		\$1,566.00
<i>SP-688-CLEG-15</i>		L/H or R/H	\$1,252.00	
<i>FSP-688-CLEG-15</i>		"	\$1,482.00	
<i>SP-689-CLEG-15</i>		L/H or R/H		\$1,257.00
<i>FSP-689-CLEG-15</i>		"		\$1,487.00
<i>SP-688-LEEG-15</i>	<i>LOW - E</i>	L/H or R/H	\$1,402.00	
<i>FSP-688-LEEG-15</i>	"	"	\$1,632.00	
<i>SP-689-LEEG-15</i>	<i>LOW - E</i>	L/H or R/H		\$1,407.00
<i>FSP-689-LEEG-15</i>				\$1,637.00
HEAVY DUTY WHITE Screen for Retro-Fit Unit			\$87.00	\$89.00

SP = Steel Patio

FSP = Fiberglass Smooth Patio

NOTE: (1) ALL LIGHTS HAVE TEMPERED GLASS
(2) FOR OTHER VARIATIONS SEE PAGE C- 8, C- 9, C-10 & C-18
Price Subject to Change without Notice



INFINITY
RETRO-FIT SIZE HINGED PATIO UNIT
By Barnett Millworks Inc.

INCLUDES: Primed 4 9/16" Jamb, WHITE EXCEL 180 Face, Schlegel Weather-strip, Mill Swing In Sill with Vinyl !!! ADJUSTABLE !!! Threshold, Tempered Insulated Glass, Bore for Deadbolt, No Locks, In-swing only.

TRIPLE UNITS			7668	9068
SP-687-WM-10	(7/8" White Clear Insul)	L/H or R/H	\$1,330.00	
FSP-687-WM-10	"	"	\$1,560.00	
SP-686-WM-10	(7/8" White Clear Insul)	L/H or R/H		\$1,335.00
FSP-686-WM-10	"	"		\$1,566.00
SP-687-WM-15	(7/8" White Clear Insul)	L/H or R/H	\$1,330.00	
FSP-687-WM-15	"	"	\$1,560.00	
SP-686-WM-15	(7/8" White Clear Insul)	L/H or R/H		\$1,335.00
FSP-686-WM-15	"	"		\$1,566.00
SP-687-WM-10	(7/8" Tan LOW " E " Insul)	L/H or R/H	\$1,405.00	
FSP-687-WM-10	"	"	\$1,635.00	
SP-686-WM-10	(7/8" Tan LOW " E " Insul)	L/H or R/H		\$1,410.00
FSP-686-WM-10	"	"		\$1,641.00
SP-687-WM-15	(7/8" Tan LOW " E " Insul)	L/H or R/H	\$1,405.00	
FSP-687-WM-15	"	"	\$1,635.00	
SP-686-WM-15	(7/8" Tan LOW " E " Insul)	L/H or R/H		\$1,410.00
FSP-686-WM-15	"	"		\$1,641.00
SP-687- RLB-1		L/H or R/H	\$1,750.00	
FSP-687- RLB-1		"	\$1,981.00	
SP-686- RLB-1		L/H or R/H		\$1,756.00
FSP-686- RLB-1		"		\$1,986.00
HEAVY DUTY WHITE Screen for Retro-Fit Unit			\$87.00	\$89.00

SP = Steel Patio

FSP = Fiberglass Smooth Patio

NOTE: (1) ALL LIGHTS HAVE TEMPERED GLASS
(2) FOR OTHER VARIATIONS SEE PAGE C- 8, C- 9, C-10 & C-18
Price Subject to Change without Notice



INFINTY PATIO STEEL & FIBERGLASS PANELS

WHITE ONLY

By Barnett Millworks Inc.

INCLUDES: *Door Panel ONLY cut out for Glass Inserts.*

NOTE: (1) *!!! NET DOOR SIZE !!! of ALL New Constructions Doors is 1/4" under Size in width and 79 1/4" in Height.*

NEW CONSTRUCTION PANELS		2'6"	2'8"	3'0"
S-2165	21 X 65	\$143.00		
FS-2165	"	\$188.00		
S-2365	23 X 65		\$143.00	\$143.00
FS-2365	"		\$188.00	\$188.00

INCLUDES: *Door Panel ONLY cut out for Glass Inserts.*

NOTE: (1) *!!! NET DOOR SIZE !!! of ALL Retro Fit Door width is based on function of panel and 77" in Height.*

RETRO FIT PANELS		2'6" x 6'5"	3'0" x 6'5"
SP-2165		\$165.00	
FSP-2165	No Bore	\$222.00	
FSP-2165	2 Bore	\$231.00	
SP-2365			\$165.00
FSP-2365	No Bore		\$222.00
FSP-2365	2 Bore		\$231.00

NOTE: (1) ALL LIGHTS HAVE TEMPERED GLASS
(2) FOR OTHER VARIATIONS SEE PAGE C- 8, C- 9, C-10 & C-18

Price Subject to Change without Notice



INFINTY PATIO STEEL & FIBERGLASS PANEL
NET SIZE, HINGE, LOCK and DEAD BOLT
SPECIFICATIONS

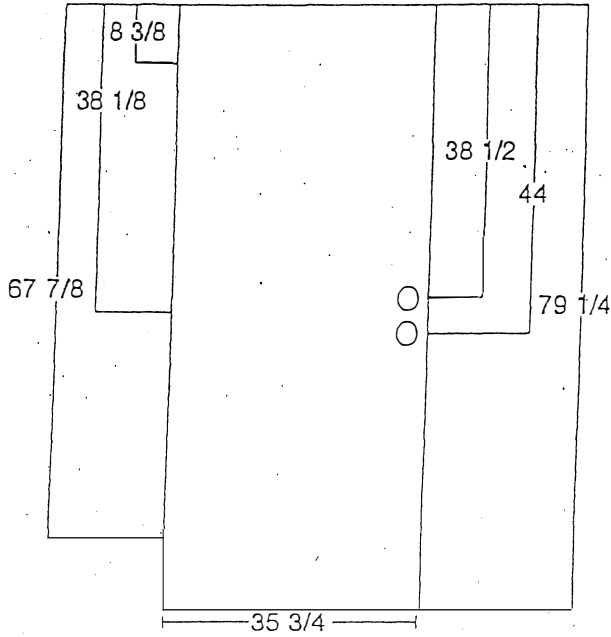

*For New
Construction Patio
UNITS*

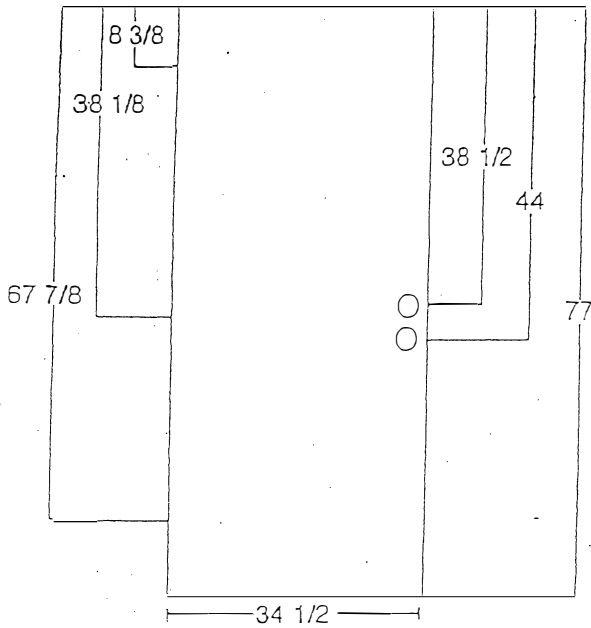

*For
RETRO FIT PATIO
UNITS*