

# Self-Contained Compactors



**CRAM-A-LOT®**  
J.V. Manufacturing, Inc.  
Solid Waste & Recycling Equipment



ENVIRONMENTAL INDUSTRY  
ASSOCIATIONS



**GSA**  
Federal Supply Service



**“Equipping The World For A Better Environment”**

# Features

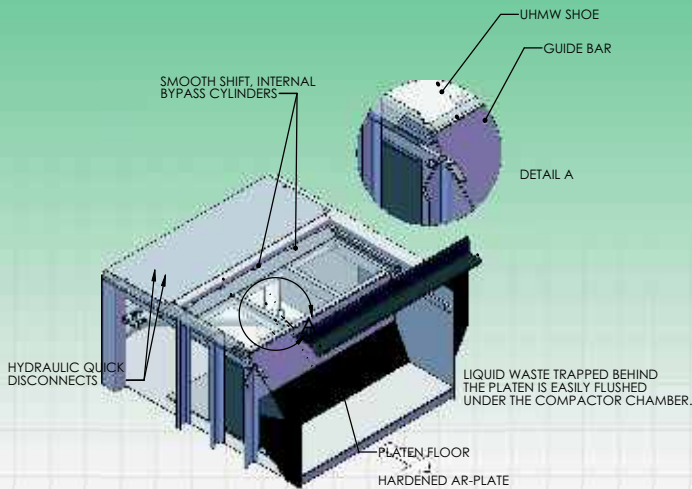

## Ram Guide System

The Self-Contained cross cylinder ram features side mounted full length Ultra-High Molecular Weight (UHMW) guides to support the ram providing uncompromising longevity and reliability.

## Door Protector

Prevents roll-off hoist cable from contacting the door frame, preventing bent doors and leaking seals.

## Lockable Door Latch

Hopper door can be locked preventing unauthorized usage.

## Sub Floor Sump

Self-Contained Compactor sub floor is separated from the container floor to form a tunnel to allow liquids to drain from behind the ram when emptying.

## Programmable Relay Controls

Self-Contained Compactors by Cram-A-Lot are designed to use a readily available non-proprietary programmable relay.

## Single Piece Side Sheet and Floor

Cram-A-lot's manufacturing plant uses a 30 foot 500 ton press break to form sides and floors allowing no vertical seams.

## Rear Gate Hinge & Seal

Self-Contained Compactors have a full door seal and a 3 point door latch that provides excellent compression and sealing properties.

## Rust Inhibiting Primer

Self-Contained Compactors are primed with rust inhibiting red oxide primer to reduce corrosion.

**All Cram-A-Lot compactors conform to all current ANSI Z 245.2 safety standards**

All information is subject to engineering and/or other changes without notice.



**500 Ton 30 ft Press Break >**

**< Remote Power Unit**



**Door Protector >**



**< Door Latch w/Padlock Hasp**

**Door Custom Fitted to Container >**



**< Catch Latch**



**< Full Door Seal**

**Rust Inhibiting Primer**

# Special Options Available



**Remote Controls**



**Color Coded Pressure Gauge**

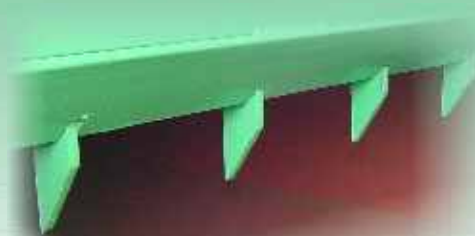

**Hinged Breaker Bar Teeth**

## Key Operation

All compactors, come with on/off switch as mandated by ANSI Z 245.2 safety standards. Cram-A-lot offers additional options for increased levels of safety.

## Color Coded Pressure Gauge

The color coded gauge indicates 50%, 75% and 100% fullness. The gauge is more accurate than fullness lights.

## Oil Heater

Ideal for cold climate areas. The oil heater automatically maintains the oil at 70 degrees.

## Hinged Breaker Bar Teeth

Hinged breaker bar teeth hold trash in place, preventing trash from springing back into the chamber.

## Ozone Odor Neutralizer

Odor neutralizers like the Sonozaire circulate the ozone, permitting it to search out and destroy odor molecules. The result is a clean-smelling area, which does not harbor and protect bacteria ending odor complaints and assuring customer satisfaction.



**Oil Heater**



**Odor Neutralizer**

# Warranty

## Cram-A-Lot® 1-2-3 Warranty

J.V. Manufacturing will furnish without charge:

- 1) All parts and labor expenses through the first year of ownership to remedy any faults proven to be the result of defective materials or workmanship.
- 2) All parts through the second year of ownership to remedy any faults proven to be the result of defective materials or workmanship.
- 3) All labor expenses through the third year of ownership to remedy any structural faults proven to be the result of defective materials or workmanship.

This warranty does not apply to any damage caused by negligence, misuse, modifications, alterations, or accidents by purchaser or third parties.

Refer to operation manual for specific warranty coverage.



# Standard and Special Applications



**Hydraulic Tailgate**



**Integral Rear Feed  
Cart Dumper**



**Side Load  
Through-The-Wall  
Break-A-Way Hopper**



**Walk-On  
Full Enclosure**



**Rear Load  
Through-The-Wall  
Break-A-Way Hopper**



# CRAM-A-LOT®

J.V. Manufacturing, Inc.

Solid Waste & Recycling Equipment

## ELECTRICAL FEATURES ON ALL MODELS

UL Listed Control Panel

Only Major Brand Electrical Components Used

Weather Tight Electrical Enclosure

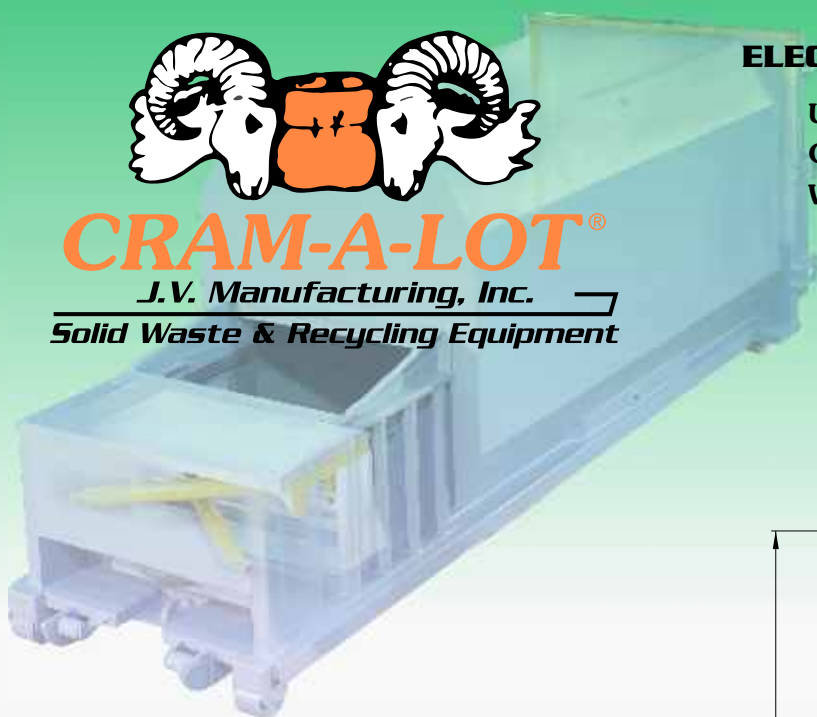

## ONE YARD SELF-CONTAINED COMPACTOR Specifications

		SC-T1-10/15/20	SC-T1-16/20/25-HTG
Charge Box Capacity		1 Cu Yd	1 Cu Yd
WASTEC Rating		0.75 Cu Yd	0.75 Cu Yd
Clear Top Opening		31"	31"
Theoretical Cycle Time		28 Sec	28 Sec
Total Force	Normal	42,700 lbs	42,700 lbs
	Maximum	51,200 lbs	51,200 lbs
Ram Face Pressure	Normal	38.7 Psi	38.7 Psi
	Maximum	46.4 Psi	46.4 Psi
Ram Face Dimensions, W X H		48" x 23"	48" x 23"
Ram Penetration		6"	6"
Motor - 3Phase - 208/230/460 Vac		10 Hp	10 Hp
Pump Capacity		10.5 Gpm	10.5 Gpm
Hydraulic Reservoir Capacity		22 gal	22 gal
Hydraulic Cylinder	Bore Dia.	Two, 4"	Two, 4"
	Stroke	26"	26"
	Rod Dia.	2"	2"
Operating Pressure	Normal	2000 Psi	2000 Psi
	Maximum	2400 Psi	2400 Psi

DIMENSIONS	(A) OVER ALL LENGTH	(B) CLEAR TOP LENGTH	(C) PACKER LENGTH	BASE UNIT WEIGH	NORMAL CONTAINER CAPACITY
SC-T1-10	13' - 2"	31"	60"	6,500 lbs	10 CU YD
SC-T1-15	16' - 6"	31"	60"	7,000 lbs	15 CU YD
SC-T1-20	19' - 10"	31"	60"	7,500 lbs	20 CU YD
SC-T1-16-HTG	18'	31"	60"	8,000 lbs	16 CU YD
SC-T1-20-HTG	19' 8"	31"	60"	8,200 lbs	20 CU YD

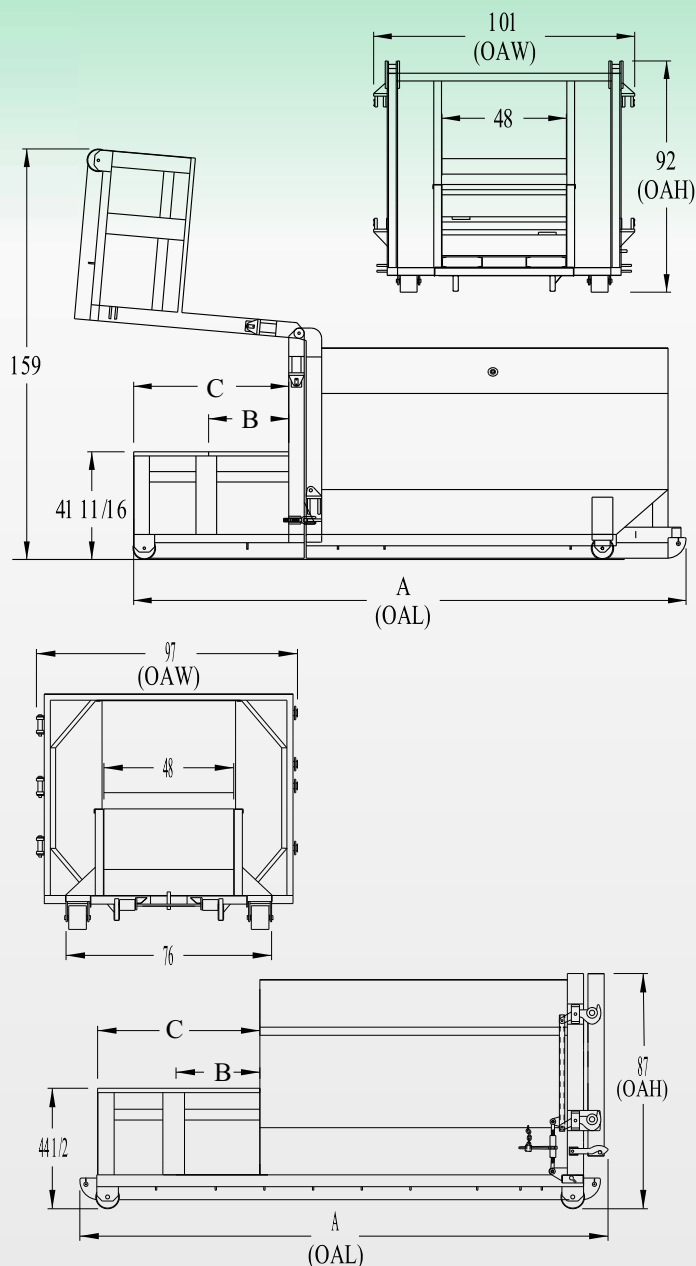

\*\* Above drawings are shown with universal understructures. \*\*

Self-Contained Compactors Units can be custom designed and factory installed to suit your special applications

**Leasing and Rental Programs Available**



# CRAM-A-LOT®

J.V. Manufacturing, Inc.

Solid Waste & Recycling Equipment

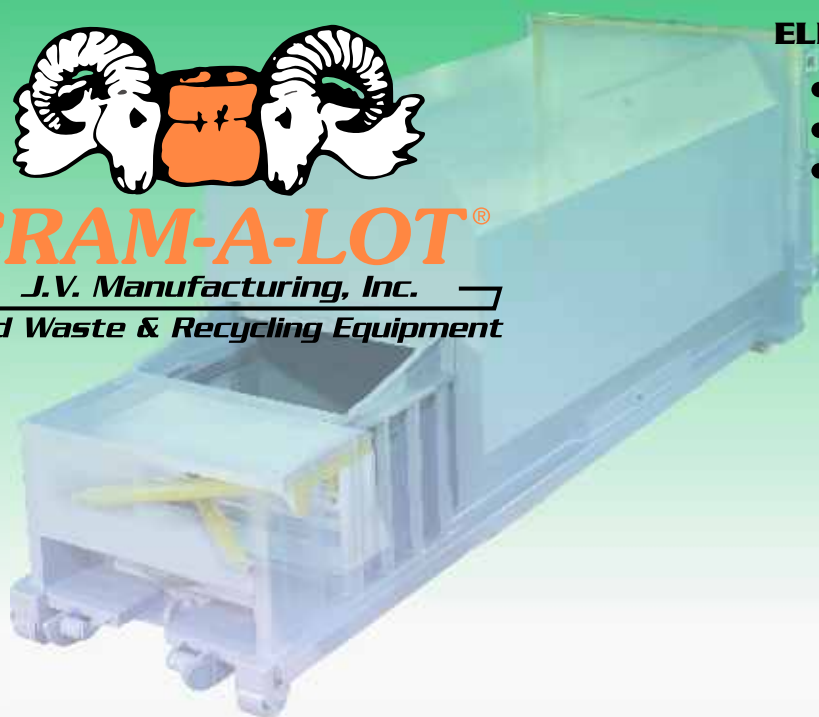

## ELECTRICAL FEATURES ON ALL MODELS

- UL Listed Control Panel
- Only Major Brand Electrical Components Used
- Weather Tight Electrical Enclosure

## TWO YARD SELF-CONTAINED COMPACTOR

### Specifications

		SC-T2-20/25/30/34/38	SC-02-20/25/30/34	SC-T2-20/25/30/34-HTG
Charge Box Capacity		2 Cubic Yard	2 Cubic Yard	2 Cubic Yard
WASTEC Rating		1.52	1.31	1.52
Clear Top Opening		41" x 58"	34" x 58"	41" x 58"
Theoretical Cycle Time		37 Sec	32 Sec	37 Sec
Total Force				
	Normal	42,700 lbs	39,300 lbs	42,700 lbs
	Maximum	51,250 lbs	47,100 lbs	51,250 lbs
Ram Face Pressure				
	Normal	24.5 Psi	22.6 Psi	24.5 Psi
	Maximum	29.5 Psi	27.1 Psi	29.5 Psi
Ram Face Dimensions, W X H		60" x 29"	60" x 29"	60" x 29"
Ram Penetration		8"	5.5"	8"
Motor - 3Phase - 208/230/460 Vac		10 Hp	10 Hp	10 Hp
Pump Capacity		10.5 Gpm	10.5 Gpm	10.5 Gpm
Hydraulic Reservoir Capacity		22 GAL	22 Gal	22 Gal
Hydraulic Cylinder				
	Bore Dia.	Two - 4"	5"	Two - 4"
	Stroke	34"	40"	34"
	Rod Dia.	2"	3"	2"
Operating Pressure				
	Normal	2000 Psi	2000 Psi	2000 Psi
	Maximum	2400 Psi	2400 Psi	2400 Psi

DIMENSIONS	(A) OVER ALL LENGTH	(B) CLEAR TOP LENGTH	(C) PACKER LENGTH	BASE UNIT WEIGHT	NORMAL CONTAINER CAPACITY
SC-T2-20	17' 4"	41"	71"	9800 lbs	20 CU YD
SC-T2-25	19' - 11"	41"	71"	10,000 lbs	25 CU YD
SC-T2-30	22' - 1"	41"	71"	10,800 lbs	30 CU YD
SC-T2-34	23' 9"	41"	71"	10,900 lbs	34 CU YD
SC-T2-38	25' - 10"	41"	71"	12,000 lbs	38 CU YD
SC-02-20	19'	34"	90 1/2"	9,860 lbs	20 CU YD
SC-02-25	21' - 7"	34"	90 1/2"	10,100 lbs	25 CU YD
SC-02-30	23' - 9"	34"	90 1/2"	10,800 lbs	30 CU YD
SC-02-34	25' - 5"	34"	90 1/2"	10,900 lbs	34 CU YD
SC-T2-20-HTG	17'	41"	71"	10,260 lbs	20 CU YD
SC-T2-25-HTG	19' - 8"	41"	71"	10,900 lbs	25 CU YD
SC-T2-30-HTG	21' 9"	41"	71"	11,540 lbs	30 CU YD

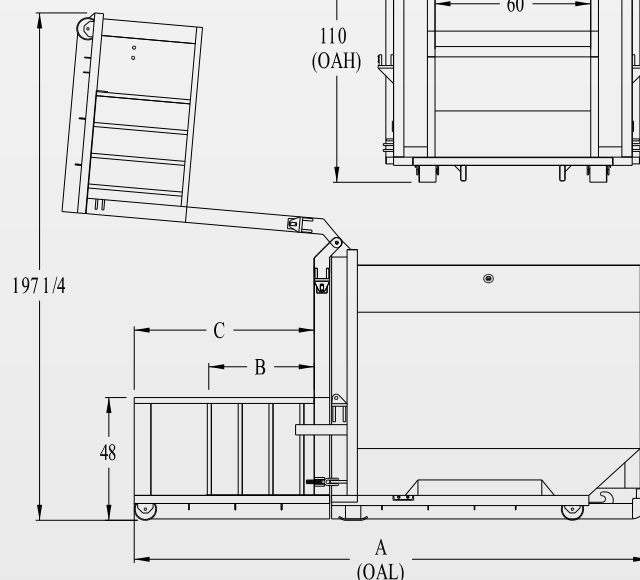
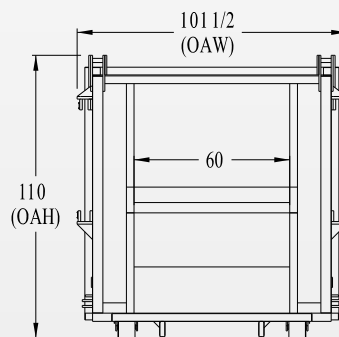
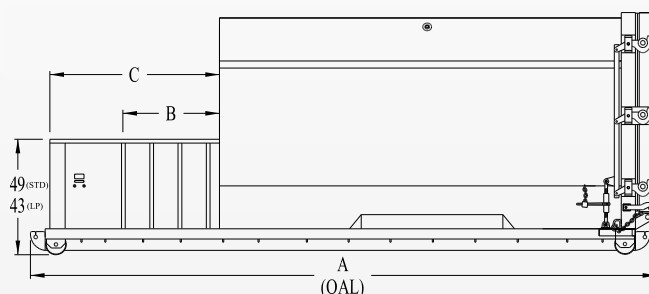
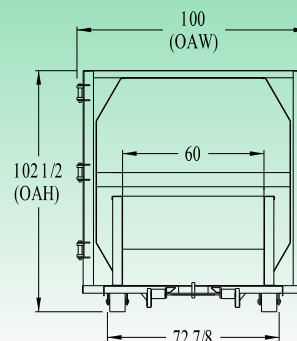

\*\* Above drawings are shown with universal understructures. \*\*

### CORPORATE

### CRAM-A-LOT® CENTRAL

### CRAM-A-LOT® WEST

### DISTRIBUTED BY:

701 Butterfield Coach Road  
P.O. Box 229  
Springdale, AR 72765  
1-800-678-7320  
479-751-7320  
479-751-7774 (fax)

108 Hwy 365 S.  
Conway, AR 72032  
1-800-653-6780  
501-327-6560  
501-329-7931 (fax)

8501 Weyand Ave.  
Sacramento, CA 95828  
1-888-431-3094  
916-381-1600  
916-381-6400 (fax)